

Appendix N

Utilities Technical Report

**4th and Hewitt
401 South Hewitt Street
Utilities Technical Report**

February 23, 2022

Prepared by:

**David J. Curtis, P.E., ENV SP
PSOMAS
555 South Flower Street, Suite 4300
Los Angeles, California 90071
(213) 223-1400
(213) 223-1444 Fax**

TABLE OF CONTENTS

1.0 OVERVIEW 3

2.0 METHODOLOGY 3

3.0 UTILITIES..... 3

4.0 GRADING / EARTHWORK 4

 4.1 Existing Site 4

 4.2 Project Site 4

5.0 STORM DRAIN 4

 5.1 Existing Infrastructure 4

 5.2 Proposed Infrastructure 4

6.0 SEWER 5

 6.1 Existing Infrastructure 5

 6.2 Proposed Infrastructure 5

7.0 WATER 6

 7.1 Existing Infrastructure 6

 7.2 Proposed Infrastructure 7

8.0 ELECTRICITY 8

 8.1 Existing Infrastructure 8

 8.2 Proposed Infrastructure 8

9.0 NATURAL GAS 8

 9.1 Existing Infrastructure 8

 9.2 Proposed Infrastructure 9

10.0 COMMUNICATIONS/TELEPHONE 9

 10.1 Existing Infrastructure 9

 10.2 Proposed Infrastructure 9

11.0 OTHERS 10

 11.1 Existing Infrastructure 10

 11.2 Proposed Infrastructure 10

12.0 APPENDIX 11

1.0 OVERVIEW

The 4th and Hewitt Project (Project) involves the development of a commercial-use 18-story building with 3 levels of underground parking and 5 levels of above ground parking on a 1.31-acre site. The Project will consist of approximately 8,149 square feet of ground level food and beverage space, 311,682 square feet of office space, and 16,294 square feet of interior and exterior common areas. The Project Site currently includes surface parking lots and four buildings. One existing one-story building on the northwest corner of the Project Site will remain and the three other buildings on-site will be demolished. A new commercial building will be built on the eastern portion of the site with frontage along 4th Street and Hewitt Street, largely on what is currently an existing parking lot. A paseo area closed to vehicular traffic will be an added amenity for visitors. The Project Site is bounded by 4th Street to the north, Colyton Street to the west, Hewitt Street to the east, and existing properties to the south.

2.0 METHODOLOGY

This Utilities Technical Report, as supporting information to the Environmental Impact Report, documents the results of Psomas' research regarding the Project. Psomas performed a conceptual level review of the capacities of the nearby infrastructure and reviewed the need for potential upgrades. Final capacity confirmation includes will serve letters and capacity requests from various private utility companies, the City of Los Angeles, and a Fire Flow Availability study from the Los Angeles Department of Water and Power (LADWP).

3.0 UTILITIES

The following is a list of existing utilities and their service providers that are within the proximity of the Project Site found from a DigAlert request:

- Storm Drain – City of Los Angeles
- Sanitary Sewer – City of Los Angeles
- Water – Los Angeles Department of Water and Power
- Electricity – Los Angeles Department of Water and Power
- Natural Gas – Southern California Gas Company
- Communications / Telephone
 - Charter Communications
 - Crown Castle

4.0 GRADING / EARTHWORK

4.1 Existing Site

Currently, the existing Project Site is comprised of four existing one-story structures and an at grade parking lot totaling approximately 1.31 acres with an average imperviousness of 98.5%. The Project Site is bounded by 4th Street to the north, Hewitt Street to the east, Colyton to the west, and private property to the south.

4.2 Project Site

No unusual grading requirements from a civil standpoint should be expected. The Project Site is not located within a flood zone; therefore, this property should not require flood mitigation or additional flood insurance.

The proposed building will have a subterranean basement which will yield an approximate export of 72,500 cy of soil.

5.0 STORM DRAIN

5.1 Existing Infrastructure

There is an existing 90" Los Angeles County storm drain main line running along the northerly side of 4th Street with a connected catch basin inlet on the southerly curb of 4th Street. There is an existing 12" underground storm drain in Colyton Street with an inlet located south of the Project limits along the valley gutter. There are no other storm drain pipes along Hewitt Street. All onsite stormwater sheet flows either north to 4th Street, west to Colyton Street, or east to Hewitt Street into the existing street gutter system.

5.2 Proposed Infrastructure

The Project Site shall continue to drain either north to 4th Street, west to Colyton Street, or east to Hewitt Street. City of Los Angeles Low Impact Development (LID) standards will be required to be implemented for the Project. These standards require that the volume generated from a 0.75-inch or 85th percentile 24-hr storm event, whichever is greater, be mitigated within the Project Site, in order of preference, through infiltration, capture and use, or biofiltration methods. Based on these requirements, it is estimated that

approximately 3,926 cubic feet (29,366 gallons) of stormwater must be infiltrated or retained on-site. The remainder of the stormwater runoff may be discharged through the existing curb face or surface flow.

6.0 SEWER

6.1 Existing Infrastructure

There are existing 8” public mains along Colyton Street, Hewitt Street, and 4th Street. The 8” sewer main along 4th Street terminates at an existing manhole located approximately mid-block of the Project Site. The 8” sewer main along Colyton Street terminates at an existing manhole located approximately 80 ft south of the intersection of the Colyton Street and 4th Street centerlines. The Colyton Street and Hewitt Street sewers combine at Palmetto Street into a 10-inch main and flow west to a 20-inch main in Alameda. The Alameda sewer increases to 22-inches as it flows south before discharging into a 40-inch line in 8th Street. The findings of the WWSI provided by the City on November 15, 2019 state that the downstream 8-inch in Hewitt Street, 10-inch in Palmetto Street, 20-inch, 22-inch, and 40-in sewer pipes within Alameda Street are flowing at 47%, 44%, 41%, 39%, and 25% existing capacity respectively.

6.2 Proposed Infrastructure

Using the Project’s latest Entitlement Set dated 10/02/19, the table below shows the proposed Project’s wastewater flows by land use type:

Proposed Use	Proposed Number of Units	Sewer Generation Factor ^(a)	Average Daily Flow (GPD)
Museum	7,800 SF	30 /1,000 SF	234
Restaurant	8,149 SF	300 /1,000 SF	2,445
Office	311,682 SF	170 /1,000 SF	52,986
Common Areas (lounge)	16,294 SF	50 /1,000 SF	815
Total	-	-	56,480

(a) The average daily flow based on City of Los Angeles’ sewer generation factors dated April 6, 2012.

Because the museum is an existing use that already discharges into the sewer system, the Project will discharge a net additional flow of approximately 56,246 GPD into the sewer system. A Wastewater Service Information (WWSI) request was sent to Bureau of Sanitation and approved on November 15, 2019. The project proposes to discharge its wastewater to an 8-inch sewer main in Hewitt Street. The sewage of the 8-inch main in Hewitt Street eventually discharges into a 22-inch sewer line in Alameda Street before discharging into a 40-inch line in 8th Street. The findings of the WWSI provided by the City on November 15, 2019 state that the downstream 22-inch and 40-inch sewer pipes are flowing at 39% capacity and 25% respectively. Based on using the 50% design capacity table provided by the City of Los Angeles Bureau of Sanitation's WWSI results, approximately 0.7 MGD and 5.6 MGD of remaining sewerage capacity exists in the 22-inch and 40-inch sewer mains respectively. Considering the more restrictive condition of the 8-inch main, 256,391 gpd of remaining capacity in the sewer main is more than the proposed 56,480 gpd of the project (i.e., the Project would utilize approximately 22% of the remaining capacity of the 8-inch sewer main). Furthermore, the WWSI capacity summary for downstream sewer mains are below that of the 8-inch Hewitt Street sewer main. Therefore, the project's contributions have no appreciable impact on downstream 22-inch and 40-inch sewer mains in Alameda and 8th Streets. This sewer demand will likely require multiple 6" sewer house connections from the Project. Laterals of this size typically require B-permit approval through the Bureau of Engineering for the sewer connection to the City's main.

7.0 WATER

7.1 Existing Infrastructure

There is an existing 6" water main on 4th Street, an 8" water main on Colyton Street, and 8" water main on Hewitt Street. There are two existing fire hydrants on 4th Street at the corners of Colyton Street and Hewitt Street, and one existing fire hydrant mid-block of Colyton Street between 4th Street and 5th Street. There are currently three existing hydrants within 300 feet of the Project Site.

7.2 Proposed Infrastructure

The Project requested a Fire Flow Availability study with the City of Los Angeles Department of Water and Power. The results provided state that the Project can provide 5,902 gallons per minute (gpm) for 6 hydrants flowing simultaneously. Per the City of Los Angeles Fire Code Table 507.3.1, a high-rise is required to meet 6,000 to 9,000 gpm for 4-6 hydrants flowing simultaneously. The City of Los Angeles Fire Department defines a high-rise building as a building having floors used for human occupancy located more than 75 feet above the lowest floor level having building access.

From an in-person discussion with Inspector Carter of the Los Angeles Fire Department, Hydrants and Access Section, on December 5, 2019, based on the general land use, the Project will require at least 7,500 gallons per minute from 5 fire hydrants flowing simultaneously during a fire to provide proper hydrant coverage. This ultimately results in two new additional public fire hydrants to meet the required number of fire hydrants.

Based on an initial LADWP evaluation of local water delivery infrastructure near the Project Site, it is anticipated that a water line upgrade would be required to provide pressures to supply a minimum of 7,500 gpm for 5 public hydrants flowing simultaneously around the perimeter of the Project. LADWP suggests that 200 feet of 8-inch pipe for both Colyton Street and Hewitt Street and 350 feet of 6-inch pipe in 4th Street be upgraded to 12-inch mains to provide the required flow that meets a minimum pressure of 20 pounds per square inch (psi) at each hydrant. If it is concluded through additional study by LADWP that less water upgrades are required to meet the 7,500 gpm requirement, then this alternative should stand as a suitable solution to meet the fire requirements. A new fire service connection for the Project would also consist of a separate dedicated firewater service connection with a second fire connection to provide the required redundancy for all high-rise structures per the Los Angeles Building Code. Hydrants, water lines, and water tanks would be installed per Division 7, Section 57.09.06 of the Fire Code requirements for the Project. In addition, the Project Applicant would be required to submit the proposed plot plans for the Project to the LAFD for review for compliance with applicable Los Angeles Fire Code, California Fire Code, and Los Angeles Building Code requirements, thereby ensuring that the Project would not create any undue fire hazard. LAFD review is a legal prerequisite, with which the Project

would be required to comply prior to the issuance of building permit. Furthermore, the Project Site is not located within an Inadequate Fire Hydrant Service Area recognized by the City. As such, with respect to fire flows, fire protection services would be considered adequate by LAFD standards. Therefore, Project impacts regarding fire flow would be less than significant.

8.0 ELECTRICITY

8.1 Existing Infrastructure

The existing power service in the vicinity of the Project Site is supplied LADWP. Existing overhead electric lines supply service to the existing buildings. Southern California Edison was also contacted, however they have confirmed that the Project Site is out of their territory. In a response to our request, LADWP has redirected us to the substructure maps found on NavigateLA. Based on the existing substructure maps, there are existing overhead electrical lines around the site on Colyton Street, 4th Street, and Hewitt Street with service connections leading into the Project Site.

8.2 Proposed Infrastructure

New service connection is not an issue with LADWP and was confirmed with a will serve letter dated March 02, 2017. The will serve letter for electrical service is included in the Appendix. As stated in the will serve letter, the estimated power requirement for the Project is part of the total load growth forecast for the City of Los Angeles and has been taken into account in the planned growth of the City's power system.

9.0 NATURAL GAS

9.1 Existing Infrastructure

The existing natural gas service in the vicinity of the Project Site is supplied by Southern California Gas Company (So Cal Gas). There is a 4" gas line in Colyton Street, a 4" gas line in 4th Street, and a 2" gas line on Hewitt Street. A utility notice request was sent out on October 10, 2016 to the utility company based on contacts obtained via DigAlert.

9.2 Proposed Infrastructure

According to the will serve letter received on February 22, 2017, So Cal Gas confirmed it has facilities in the area to serve the Project Site. Gas service to the Project will be provided in accordance with State and Federal regulations, including those of the California Public Utilities Commission, which has jurisdiction over So Cal Gas. The will serve letter is included in the Appendix.

10.0 COMMUNICATIONS/TELEPHONE

10.1 Existing Infrastructure

There are existing facilities in all adjacent streets. A utility notice request was sent to the utility companies based on contacts obtained via DigAlert. As of the date of this report, we have received responses from AT&T Transmission TCA, AT&T Long Distance, Century Link, Charter Communications, Crown Castle, Frontier Communications, Verizon, Sprint, Wilcon, and XO Communications. Below is a summary of responses:

- AT&T Transmission TCA – There are no aerial or underground fiber facilities in the area
- AT&T Long Distance – There are no aerial or underground facilities in the area
- Century Link – There are no aerial or underground fiber facilities in the area
- Charter Communications – There are aerial and underground facilities in the area
- Crown Castle – There are underground fiber utilities along 4th Street
- Frontier Communications – There are no utilities in the area
- MCI So Cal (Verizon Business) – There are no utilities in the area
- Sprint – There are no utilities in the area
- Wilcon – There are utilities in the area in 4th Street
- XO Communications – There are no utilities in the area

10.2 Proposed Infrastructure

Charter Communications and Crown Castle have aerial and underground facilities in the immediate vicinity to serve the Project Site. No upgrades are expected.

11.0 OTHERS

11.1 Existing Infrastructure

A utility notice request was sent out on October 10, 2016 to the utility company based on contacts obtained via DigAlert. As of the date of this report, we have received responses from Chevron, Kinder Morgan Energy, Plains All American Pipeline, and Shell. Below is a summary of responses:

- Chevron – There are no utilities in the area
- Kinder Morgan Energy Partners – There are no utilities in the area
- Plains All American Pipeline – There are no utilities in the area
- Shell – There are no utilities in the area

11.2 Proposed Infrastructure

There are no existing facilities near the Project Site that require removal and relocation. No upgrades are expected.

12.0 APPENDIX

PROJECT SITE

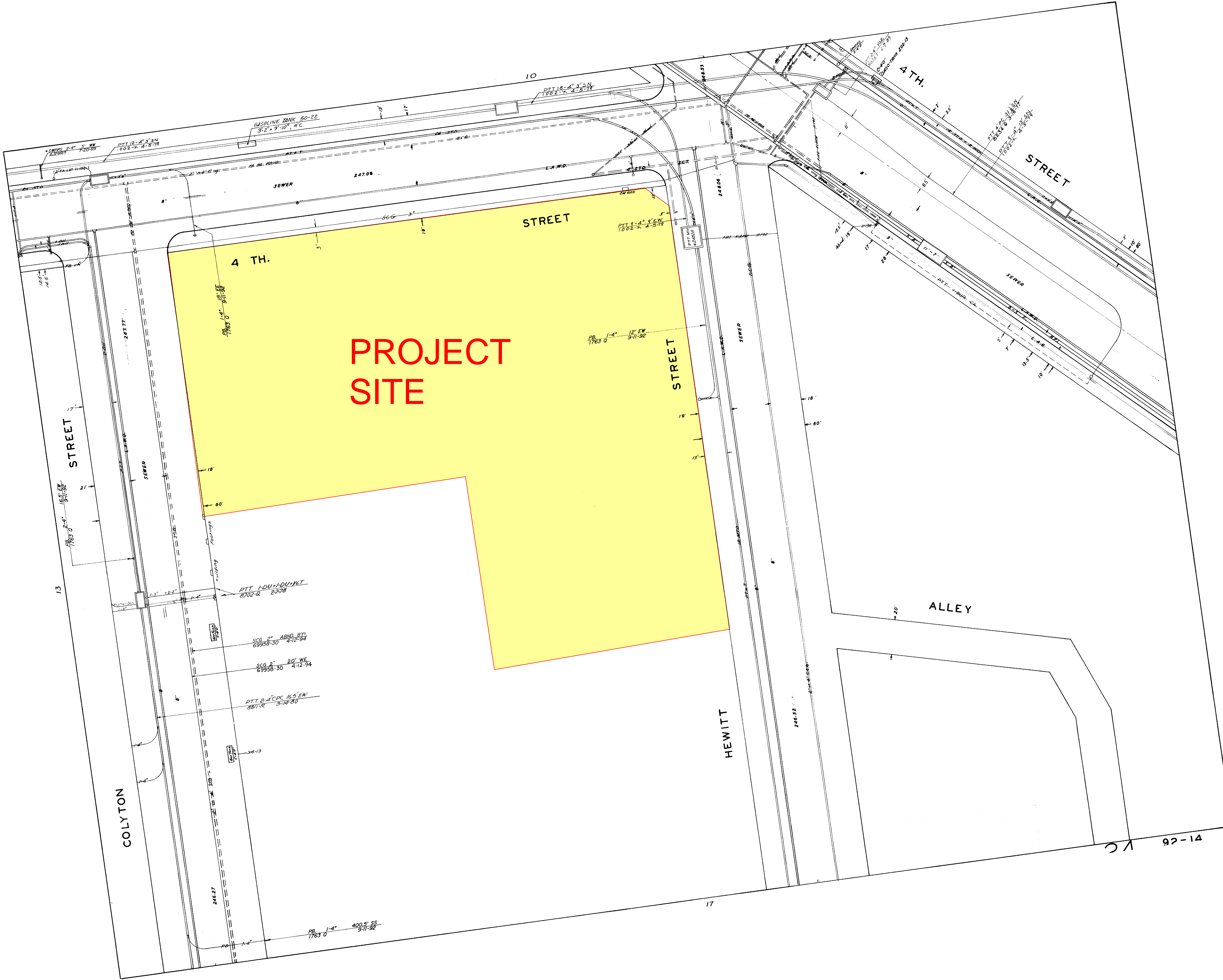

92-14

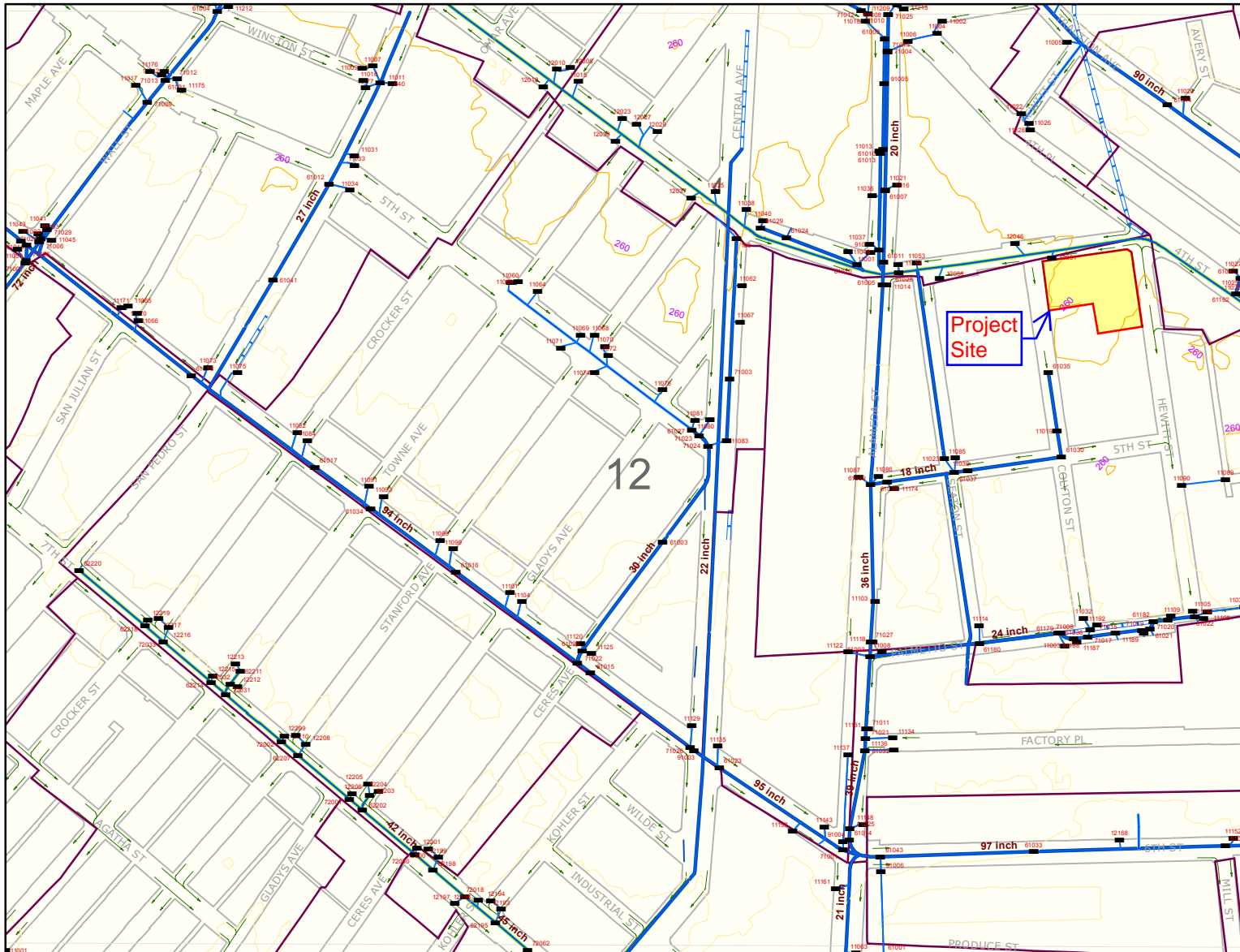

Drainage Map No. 516
Quadrant No. 4
Grid No. 12

- Inlet
- Flow Direction
- Relief Sewer
- Abandoned Pipe
- Miscellaneous Pipe
- Buildings and Cultural Features
- Coast / Stormwater Channel
- City of Los Angeles
- Subarea
- Railroad
- Jetty
- Los Angeles City Limit

- Contour Elevation Level**
- 20 foot interval
 - Other

- Stormwater Pipe Ownership**
- City of Los Angeles
 - County of Los Angeles
 - State of California
 - Other

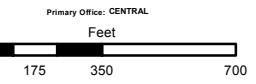
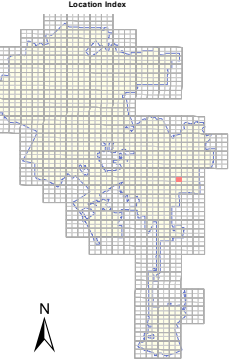

Landbase data is from the City of Los Angeles Survey and Mapping Division. Contours are derived from USGS digital elevation models. Drainage features are digitized from Stormwater Management drainage maps. Coordinate system is shown in California State Plane, NAD83, Zone 5 (feet). Cultural data are from Thomas Brothers maps digital data.

Drainage feature revised date: October, 2016
 Landbase revised date: October, 2016
 Contour revised date: September, 2006
 Date Plotted: 10/6/2016

CITY OF LOS ANGELES

CALIFORNIA



ERIC GARCETTI
MAYOR

**BOARD OF PUBLIC WORKS
MEMBERS**

KEVIN JAMES
PRESIDENT

AURA GARCIA
VICE PRESIDENT

DR. MICHAEL R. DAVIS
PRESIDENT PRO TEMPORE

JESSICA M. CALOZA
COMMISSIONER

M. TERESA VILLEGAS
COMMISSIONER

BUREAU OF SANITATION

ENRIQUE C. ZALDIVAR
DIRECTOR

TRACI J. MINAMIDE
CHIEF OPERATING OFFICER

LISA B. MOWERY
CHIEF FINANCIAL OFFICER

MAS DOJIRI
JOSE P. GARCIA
ALEXANDER E. HELOU
ASSISTANT DIRECTORS

TIMEYIN DAFETA
HYPERION EXECUTIVE PLANT MANAGER

**WASTEWATER ENGINEERING
SERVICES DIVISION**
2714 MEDIA CENTER DRIVE
LOS ANGELES, CA 90065
FAX: (323) 342-6210
WWW.LACITYSAN.ORG

November 15, 2019

Ms. Daisy Rosas, E.I.T
PSOMAS
555 S Flower Street, Suite 4300
Los Angeles, CA 90071

Dear Ms. Rosas,

**401 HEWITT STREET PROJECT - REQUEST FOR WASTEWATER SERVICE
INFORMATION**

This is in response to your October 30, 2019 letter requesting a review of your proposed mixed-use project located at 401 S Hewitt Street, Los Angeles, CA 90013. The project will consist of museum, restaurants, office building, and common area. LA Sanitation has conducted a preliminary evaluation of the potential impacts to the wastewater and stormwater systems for the proposed project.

WASTEWATER REQUIREMENT

LA Sanitation, Wastewater Engineering Services Division (WESD) is charged with the task of evaluating the local sewer conditions and to determine if available wastewater capacity exists for future developments. The evaluation will determine cumulative sewer impacts and guide the planning process for any future sewer improvement projects needed to provide future capacity as the City grows and develops.

Projected Wastewater Discharges for the Proposed Project:

Type Description	Average Daily Flow per Type Description (GPD/UNIT)	Proposed No. of Units	Average Daily Flow (GPD)
Existing			
Museum	30 GPD/1000 SQ.FT	7,800 SQ.FT	(234)
Total Exist Flow			(234)
Proposed			
Museum	30 GPD/1000 SQ.FT	7,800 SQ.FT	234
Food & Beverage (take out)	300 GPD/1000 SQ.FT	8,149 SQ.FT	2,445
Office Building w/cooling tower	170 GPD/1000 SQ.FT	311,682 SQ.FT	52,986
Common Area	50 GPD/1000 SQ.FT	16,294 SQ.FT	815
Total Proposed Flow			56,480
Net Proposed Flow			56,246

zero waste • one water

AN EQUAL EMPLOYMENT OPPORTUNITY - AFFIRMATIVE ACTION EMPLOYER



SEWER AVAILABILITY

The sewer infrastructure in the vicinity of the proposed project includes an existing 8-inch line on Hewitt St. The sewage of the existing 8-inch line discharges into a 22-inch sewer line on Alameda St before discharging into a 40-inch line on 8TH St. Figure 1 shows the details of the sewer system within the vicinity of the project.

The current approximate flow level (d/D) and the design capacities at d/D of 50% in the sewer system are as follows:

Pipe Diameter (in)	Pipe Location	Current Gauging d/D (%)	50% Design Capacity
8	Hewitt St	47	256,391 GPD
10	Palmetto St.	44	415,790 GPD
20	Alameda St.	41	2.21 MGD
22	Alameda St.	39	3.09 MGD
40	8TH St.	25	11.25 MGD

Based on the estimated flows, it appears the sewer system might be able to accommodate the total flow for your proposed project. Further detailed gauging and evaluation will be needed as part of the permit process to identify a specific sewer connection point. If the public sewer has insufficient capacity, then the developer will be required to build sewer lines to a point in the sewer system with sufficient capacity. Any sewer ejector shall be reviewed by LASAN staff prior to City of Los Angeles Department of Building and Safety (LADBS) approval. A final approval for sewer capacity and connection permit will be made at that time. Ultimately, this sewage flow will be conveyed to the Hyperion Water Reclamation Plant, which has sufficient capacity for the project.

If you have any questions, please call Christopher DeMonbrun at (323) 342-1567 or email at chris.demonbrun@lacity.org.

STORMWATER REQUIREMENTS

LA Sanitation, Stormwater Program is charged with the task of ensuring the implementation of the Municipal Stormwater Permit requirements within the City of Los Angeles. We anticipate the following requirements would apply for this project.

POST-CONSTRUCTION MITIGATION REQUIREMENTS

In accordance with the Municipal Separate Storm Sewer (MS4) National Pollutant Discharge Elimination System (NPDES) Permit (Order No. R4-2012-0175, NPDES No. CAS004001) and the City of Los Angeles Stormwater and Urban Runoff Pollution Control requirements (Chapter VI, Article 4.4, of the Los Angeles Municipal Code), the Project shall comply with all mandatory provisions to the Stormwater Pollution Control Measures for Development Planning (also known as Low Impact Development [LID] Ordinance). Prior to issuance of grading or building permits, the applicant shall submit a LID Plan to the City of Los Angeles, Public Works, LA Sanitation, Stormwater Program for review and approval. The LID Plan shall be prepared consistent with the requirements of the Planning and Land Development Handbook for Low Impact Development.

Current regulations prioritize infiltration, capture/use, and then biofiltration as the preferred stormwater control measures. The relevant documents can be found at: www.lacitysan.org. It is

advised that input regarding LID requirements be received in the preliminary design phases of the project from plan-checking staff. Additional information regarding LID requirements can be found at: www.lacitysan.org or by visiting the stormwater public counter at 201 N. Figueroa, 2nd Fl, Suite 280.

GREEN STREETS

The City is developing a Green Street Initiative that will require projects to implement Green Street elements in the parkway areas between the roadway and sidewalk of the public right-of-way to capture and retain stormwater and urban runoff to mitigate the impact of stormwater runoff and other environmental concerns. The goals of the Green Street elements are to improve the water quality of stormwater runoff, recharge local ground water basins, improve air quality, reduce the heat island effect of street pavement, enhance pedestrian use of sidewalks, and encourage alternate means of transportation. The Green Street elements may include infiltration systems, biofiltration swales, and permeable pavements where stormwater can be easily directed from the streets into the parkways and can be implemented in conjunction with the LID requirements. Green Street standard plans can be found at: www.eng2.lacity.org/techdocs/stdplans/

CONSTRUCTION REQUIREMENTS

All construction sites are required to implement a minimum set of BMPs for erosion control, sediment control, non-stormwater management, and waste management. In addition, construction sites with active grading permits are required to prepare and implement a Wet Weather Erosion Control Plan during the rainy season between October 1 and April 15. Construction sites that disturb more than one-acre of land are subject to the NPDES Construction General Permit issued by the State of California, and are required to prepare, submit, and implement the Storm Water Pollution Prevention Plan (SWPPP).

If there are questions regarding the stormwater requirements, please call WPP's plan-checking counter at (213) 482-7066. WPD's plan-checking counter can also be visited at 201 N. Figueroa, 2nd Fl, Suite 280.

GROUNDWATER DEWATERING REUSE OPTIONS

The Los Angeles Department of Water and Power (LADWP) is charged with the task of supplying water and power to the residents and businesses in the City of Los Angeles. One of the sources of water includes groundwater. The majority of groundwater in the City of Los Angeles is adjudicated, and the rights of which are owned and managed by various parties. Extraction of groundwater within the City from any depth by law requires metering and regular reporting to the appropriate Court-appointed Watermaster. LADWP facilitates this reporting process, and may assess and collect associated fees for the usage of the City's water rights. The party performing the dewatering should inform the property owners about the reporting requirement and associated usage fees.

On April 22, 2016 the City of Los Angeles Council passed Ordinance 184248 amending the City of Los Angeles Building Code, requiring developers to consider beneficial reuse of groundwater as a conservation measure and alternative to the common practice of discharging groundwater to the storm drain (SEC. 99.04.305.4). It reads as follows: "Where groundwater is being extracted and discharged, a system for onsite reuse of the groundwater, shall be developed and constructed. Alternatively, the groundwater may be discharged to the sewer."

Groundwater may be beneficially used as landscape irrigation, cooling tower make-up, and construction (dust control, concrete mixing, soil compaction, etc.). Different applications may require various levels of treatment ranging from chemical additives to filtration systems. When onsite reuse is not available the groundwater may be discharged to the sewer system. This allows the water to be potentially reused as recycled water once it has been treated at a water reclamation plant. If groundwater is discharged into the storm drain it offers no potential for reuse. The onsite beneficial reuse of groundwater can reduce or eliminate costs associated with sewer and storm drain permitting and monitoring. Opting for onsite reuse or discharge to the sewer system are the preferred methods for disposing of groundwater.

To help offset costs of water conservation and reuse systems, LADWP offers Technical Assistance Program (TAP), which provides engineering and technical assistance for qualified projects. Financial incentives are also available. Currently, LADWP provides an incentive of \$1.75 for every 1,000 gallons of water saved during the first two years of a five-year conservation project. Conservation projects that last 10 years are eligible to receive the incentive during the first four years. Other water conservation assistance programs may be available from Metropolitan Water District of Southern California. To learn more about available water conservation assistance programs, please contact LADWP Rebate Programs 1-888-376-3314 and LADWP TAP 1-800-544-4498, selection "3".

For more information related to beneficial reuse of groundwater, please contact Greg Reed, Manager of Water Rights and Groundwater Management, at (213)367-2117 or greg.reed@ladwp.com.

SOLID RESOURCE REQUIREMENTS

The City has a standard requirement that applies to all proposed residential developments of four or more units or where the addition of floor areas is 25 percent or more, and all other development projects where the addition of floor area is 30 percent or more. Such developments must set aside a recycling area or room for onsite recycling activities. For more details of this requirement, please contact LA Sanitation Solid Resources Recycling hotline 213-922-8300.

Sincerely,

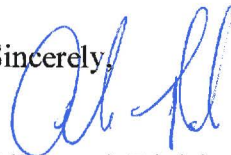

Ali Poosti, Division Manager
Wastewater Engineering Services Division
LA Sanitation and Environment

AP/CD: sa

Attachment: Figure 1 - Sewer Map

c: Kosta Kaporis, LASAN
Cyrous Gilani, LASAN
Christopher DeMonbrun, LASAN



Wastewater Engineering Services Division
Bureau of Sanitation
City of Los Angeles



Figure 1
401 Hewitt Street Project
Sewer Map

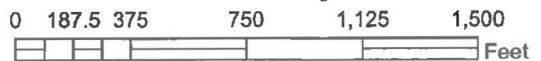

**BOARD OF PUBLIC WORKS
MEMBERS**

KEVIN JAMES
PRESIDENT

HEATHER MARIE REPENNING
VICE PRESIDENT

MICHAEL R. DAVIS
PRESIDENT PRO TEMPORE

JOEL F. JACINTO
COMMISSIONER

LUZ M. RIVAS
COMMISSIONER

FERNANDO CAMPOS
EXECUTIVE OFFICER

**CITY OF LOS ANGELES
CALIFORNIA**



ERIC GARCETTI
MAYOR

**DEPARTMENT OF
PUBLIC WORKS**

**BUREAU OF
ENGINEERING**

GARY LEE MOORE, PE, ENV SP
CITY ENGINEER

1149 S BROADWAY, SUITE 700
LOS ANGELES, CA 90015-2213

<http://eng.lacity.org>

01/03/2017

LINDA LUU
555 S FLOWER ST #4300
LOS ANGELES, CA, 90071

Dear LINDA LUU,

SEWER AVAILABILITY: 405 S HEWITT st

The Bureau of Sanitation has reviewed your request of 12/22/2016 for sewer availability at **405 S HEWITT ST**. Based on their analysis, it has been determined on 01/03/2017 that there is capacity available to handle the anticipated discharge from your proposed project(s) as indicated in the attached copy of the Sewer Capacity Availability Request (SCAR) .

This determination is valid for 180 days from the date shown on the Sewer Capacity Availability request (SCAR) approved by the Bureau of Sanitation.

While there is hydraulic capacity available in the local sewer system at this time, availability of sewer treatment capacity will be determined at the Bureau of Engineering Public Counter upon presentation of this letter. A Sewer Connection Permit may also be obtained at the same counter provided treatment capacity is available at the time of application.

A Sewerage Facilities Charge is due on all new buildings constructed within the City. The amount of this charge will be determined when application is made for your building permit and the Bureau of Engineering has the opportunity to review the building plans. To facilitate this determination a preliminary set of plans should be submitted to Bureau of Engineering District Office, Public Counter.

Provision for a clean out structure and/or a sewer trap satisfactory to the Department of Building and Safety may be required as part of the sewer connection permit.

Sincerely,

Adrian Sanchez

Central District, Bureau of Engineering

City of Los Angeles
Bureau of Engineering

SEWER CAPACITY AVAILABILITY REVIEW FEE (SCARF) - Frequently Asked Questions

SCAR stands for Sewer Capacity Availability Review that is performed by the Department of Public Works, Bureau of Sanitation. This review evaluates the existing sewer system to determine if there is adequate capacity to safely convey sewage from proposed development projects, proposed construction projects, proposed groundwater dewatering projects and proposed increases of sewage from existing facilities. The SCAR Fee (SCARF) recovers the cost, incurred by the City, in performing the review for any SCAR request that is expected to generate 10,000 gallons per day (gpd) of sewage.

The SCARF is based on the effort required to perform data collection and engineering analysis in completing a SCAR. A brief summary of that effort includes, but is not limited to, the following:

1. Research and trace sewer flow levels upstream and downstream of the point of connection.
2. Conduct field surveys to observe and record flow levels. Coordinate with maintenance staff to inspect sewer maintenance holes and conduct smoke and dye testing if necessary.
3. Review recent gauging data and in some cases closed circuit TV inspection (CCTV) videos.
4. Perform gauging and CCTV inspection if recent data is not available.
5. Research the project location area for other recently approved SCARs to evaluate the cumulated impact of all known SCARs on the sewer system.
6. Calculate the impact of the proposed additional sewage discharge on the existing sewer system as it will be impacted from the approved SCARs from Item 6 above. This includes tracing the cumulative impacts of all known SCARs, along with the subject SCAR, downstream to insure sufficient capacity exist throughout the system.
7. Correspond with the applicant for additional information and project and clarification as necessary.
8. Work with the applicant to find alternative sewer connection points and solutions if sufficient capacity does not exist at the desired point of connection.

Questions and Answers:

1. When is the SCARF applied, or charged?

It applies to all applicants seeking a Sewer Capacity Availability Review (SCAR). SCARs are generally required for Sewer Facility Certificate applications exceeding 10,000 gpd, or request from a property owner seeking to increase their discharge thru their existing connection by 10,000 gpd or more, or any groundwater related project that discharges 10,000 gpd or more, or any proposed or future development for a project that could result in a discharge of 10,000 gpd.

2. Why is the SCARF being charged now when it has not been in the past?

The City has seen a dramatic increase in the number of SCARs over 10,000 gpd in the last few years and has needed to increase its resources, i.e., staff and gauging efforts, to respond to them. The funds collected thru SCARF will help the City pay for these additional resources and will be paid by developers and property owners that receive the benefit from the SCAR effort.

3. Where does the SCARF get paid?

The Department of Public Works, Bureau of Engineering (BOE) collects the fee at its public counters. Once the fee is paid then BOE prepares a SCAR request and forwards it to the BOS where it is reviewed and then returned to BOE. BOE then informs the applicant of the result. In some cases, BOS works directly with the applicant during the review of the SCAR to seek additional information and work out alternative solutions

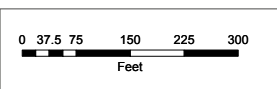
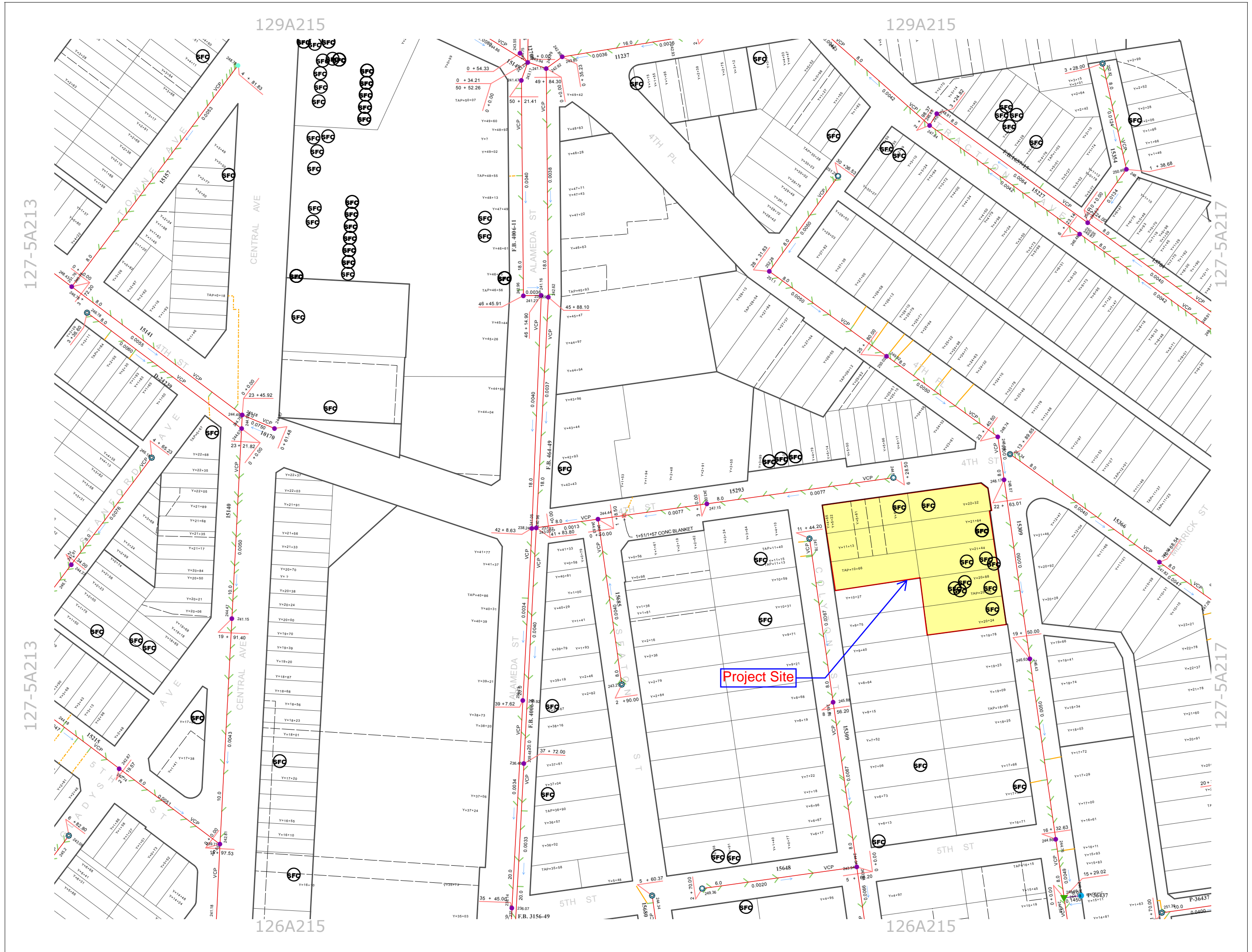

Notes:



CENTRAL DISTRICT SEWER WYE MAP



Plotted Date: 10/20/2014
Revised :

127-5A215



A  Sempra Energy utility®
February 22, 2017

PSOMAS
555 S. Flower St., Suite 4300
Los Angeles CA 90071
Attn: Linda Luu
I.D. #43-2016-11-00011 405 S. Hewitt, Los Angeles CA 90013

Ms. Luu,

Thank you for inquiring about the availability of natural gas service for your project. We are pleased to inform you that the Southern California Gas Company has facilities in the area where the above named project is proposed. The service would be in accordance with the Company's policies and extension rules on file with the California Public Utilities Commission at the time contractual arrangements are made.

This letter is not a contractual commitment to serve the proposed project, but is only provided as an informational service. The availability of natural gas service is based upon conditions of gas supply and regulatory agencies. As a public utility, Southern California Gas Company is under the jurisdiction of the California Public Utilities Commission. Our ability to serve can also be affected by actions of federal regulatory agencies. Should these agencies take any action, which affects gas supply or the conditions under which service is available, gas service will be provided in accordance with the revised conditions. This letter is also provided without considering any conditions or non-utility laws and regulations (such as environmental regulations), which could affect actual construction of a main or service line extension (for example, if hazardous wastes were encountered in the process of installing the line). Those, of course, can only be determined around the time contractual arrangements are made and construction is begun.

If you need assistance choosing the appropriate gas equipment for your project, or would like to discuss the most effective applications of energy efficiency techniques, please contact our area Service Center at 800-427-2000.

Thank you again for choosing clean, reliable, and safe natural gas, your best energy value.

Sincerely,

Gayle Joyoni, Pacific Region, Will Serve Request, Planning Associate

Los Angeles  Department of Water & Power

ERIC GARCETTI
Mayor

Commission
MEL LEVINE, *President*
WILLIAM W. FUNDERBURK JR., *Vice President*
JILL BANKS BARAD
MICHAEL F. FLEMING
CHRISTINA E. NOONAN
BARBARA E. MOSCHOS, *Secretary*

MARCIE L. EDWARDS
General Manager

March 1, 2017

Ms. Linda Lu
PSOMAS
555 South Flower Street, Suite 4300
Los Angeles, CA 90071

Subject: 401 Hewitt

Dear Ms. Lu:

This is in response to your submittal regarding electric service for the proposed project located at the above address.

Electric Service is available and will be provided in accordance with the Los Angeles Department of Water and Power's (Department) Rules Governing Water and Electric Service. The availability of electricity is dependent upon adequate generating capacity and adequate fuel supplies. The estimated power requirement for this proposed project is part of the total load growth forecast for the City of Los Angeles and has been taken into account in the planned growth of the City's power system.

If you have any questions regarding this matter, please contact our design engineer Mr. Don Alecxih, at telephone number (213) 367-8019.

Sincerely,



VINCENT G. ZABUKOVEC
Engineer of Customer Station Design

DA:sl

C/enc:
ENGR: Mr. Don Alecxih
FileNet

Los Angeles Aqueduct Centennial Celebrating 100 Years of Water 1913-2013

111 N. Hope Street, Los Angeles, California 90012-2607 Mailing address: Box 51111, Los Angeles, CA 90051-5700
Telephone: (213) 367-4211 www.LADWP.com



City of Los Angeles

Los Angeles Department of Water and Power - Water System

INFORMATION OF FIRE FLOW AVAILABILITY

9,000 GPM

Water Service Map No.: 126-213

LAFD Fire Flow Requirement: 6 hydrants flowing simultaneously

LAFD Signature: _____

Date Signed: _____

Applicant: Daisy Rosas
 Company Name: PSOMAS
 Address: 555 South Flower Street STE 4300
 Telephone: (213) 223-1498
 Email Address: daisy.rosas@psomas.com

	F- 9430	F- 9429	F- PROPOSED
Location:	SW corner of 4th St and Hewitt St	SW corner of 4th St and Colyton St	East side of Colyton St 300 feet S of 4th St
Distance from Nearest Pipe Location (feet):	11	10	37
Hydrant Size:	4D	4D	2 1/2 X4D
Water Main Size (in):	8	6	8
Static Pressure (psi):	61	60	61
Residual Pressure (psi):	20	20	27
Flow at 20 psi (gpm):	381	29	1,500

NOTE: Data obtained from hydraulic analysis using peak hour.

Remarks: 6 hydrants run simultaneously.
5,902 gpm total flow available.

ECMR No. W20190111009

Water Purveyor: Los Angeles Department of Water & Power Date: 11/6/19

Signature: [Signature] Title: CIVIL ENGINEERING ASSOCIATE

Requests must be made by submitting this completed application, along with a \$230.00 check payable to:

"Los Angeles Department of Water and Power", and mailed to:

Los Angeles Department of Water and Power

Distribution Engineering Section - Water

Attn: Business Arrangements

P.O. Box 51111 - Room 1425

Los Angeles, CA 90051-5700

* If you have any questions, please contact us at (213) 367-2130 or visit our web site at <http://www.ladwp.com>.



City of Los Angeles

Los Angeles Department of Water and Power - Water System

INFORMATION OF FIRE FLOW AVAILABILITY

9,000 GPM

Water Service Map No.: 128-216

LAFD Fire Flow Requirement: 6 hydrants flowing simultaneously

LAFD Signature: _____

Date Signed: _____

Applicant: Daisy Rosas
 Company Name: PSOMAS
 Address: 555 South Flower Street STE 4300
 Telephone: (213) 223-1498
 Email Address: daisy.rosas@psomas.com

	F- PROPOSED	F- PROPOSED	F- PROPOSED
Location:	W of Hewitt Street and 250 ft S of 4th Street	N of 4th Street and 275 ft W of Hewitt Street	SE of Hewitt Street and 4th Street
Distance from Nearest Pipe Location (feet):	19	27	21
Hydrant Size:	2 1/2 X4D	2 1/2 X4D	2 1/2 X4D
Water Main Size (in):	8	6	8
Static Pressure (psi):	<i>61</i>	<i>60</i>	<i>62</i>
Residual Pressure (psi):	<i>20</i>	<i>27</i>	<i>20</i>
Flow at 20 psi (gpm):	<i>1,107</i>	<i>1,500</i>	<i>1,385</i>

NOTE: Data obtained from hydraulic analysis using peak hour.

Remarks: See notes on first page. ECMR No. W 2019 011 009

Water Purveyor: Los Angeles Department of Water & Power Date: _____

Signature: _____ Title: _____

Requests must be made by submitting this completed application, along with a \$230.00 check payable to: "Los Angeles Department of Water and Power", and mailed to:

**Los Angeles Department of Water and Power
 Distribution Engineering Section - Water
 Attn: Business Arrangements
 P.O. Box 51111 - Room 1425
 Los Angeles, CA 90051-5700**

* If you have any questions, please contact us at (213) 367-2130 or visit our web site at <http://www.ladwp.com>.

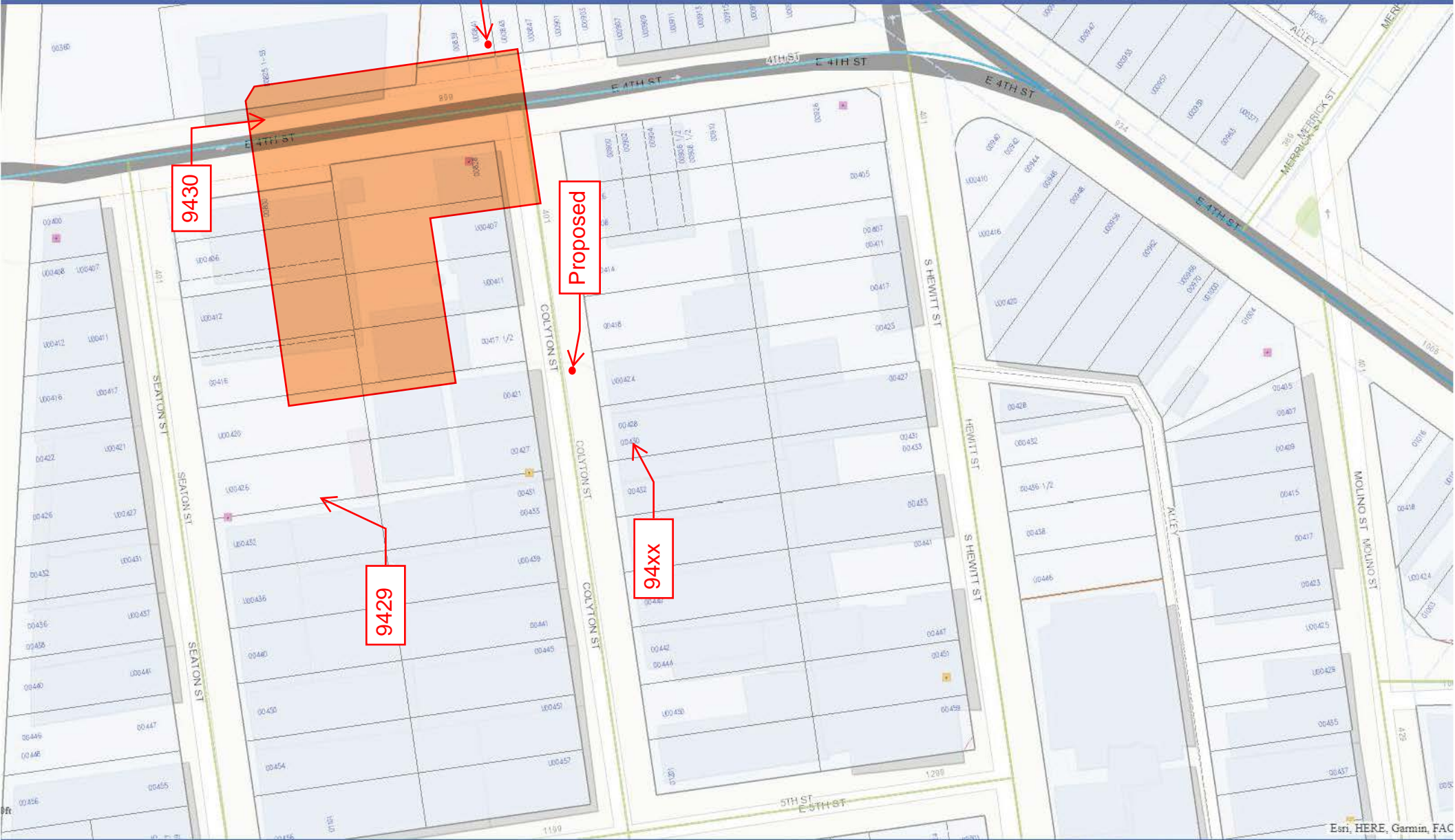

Linda Luu

From: GUZMAN, MARIA <mg1371@att.com>
Sent: Monday, October 10, 2016 3:22 PM
To: Linda Luu
Cc: TCGLosAngelesUtilityCon
Subject: FW: 405 S. Hewitt, Los Angeles, CA 90013 - Utility Records and Will Serve Letter
Attachments: 16-1010_4th Hewitt Utility Letters_ATT Transmission TCA.pdf; 4th Hewitt Thomas Guide.pdf

Follow Up Flag: Follow up
Flag Status: Flagged

NEW mailing address.

AT&T

ATTN: MARIA GUZMAN
420 S GRAND AVE, RM 707
LOS ANGELES, CA 90071

Email: mg1371@att.com and cc: g05131@att.com

This response is for "AT&T-TCA" only. **Name change from TCG (Teleport Communications Group) to TCA (Teleport Communications America, LLC) - Effective date of the merger is January 1, 2013**

There are no aerial or underground fiber facilities owned by AT&T-TCA within the project location – 405 S. Hewitt, Los Angeles, CA.

Thank you,
Maria Guzman
Utility Information Contact - LA, SF/Bay Area and Oregon

"This e-mail and any files transmitted with it are AT&T property, are confidential, and are intended solely for the use of the individual or entity to whom this e-mail is addressed. If you are not one of the named recipient(s) or otherwise have reason to believe that you have received this message in error, please notify the sender and delete this message immediately from your computer. Any other uses, retention, dissemination, forwarding, printing, or copying of this email is strictly prohibited."

From: Linda Luu [mailto:linda.luu@psomas.com]
Sent: Monday, October 10, 2016 1:55 PM
To: GUZMAN, MARIA <mg1371@att.com>
Subject: 405 S. Hewitt, Los Angeles, CA 90013 - Utility Records and Will Serve Letter

Good Afternoon,

We are in the process of gathering as-built utility information for our project located at **405 S. Hewitt St, Los Angeles, CA 90013**. Your company was listed on the DigAlert design lookup and we are looking to obtain information on any of your service utilities that may be in conflict with our project improvements. Attached is a Utility Notice letter and a copy of the Los Angeles Thomas Guide Map outlining the vicinity of our project.

If you are not the person of contact for this request, please direct me to the appropriate contact. Thank you very much for your time.

Regards,

Linda Luu, PE, QSD/QSP, ENV SP

PSOMAS | Balancing the Natural and Built Environment

Professional Engineer

Facilities, Infrastructure and Development

555 South Flower Street, Suite 4300

Los Angeles, CA 90071 | 213.223.1449

www.Psomas.com

Linda Luu

From: Zerler, Dave A [Spectrum Land Services] <DaveZerler@chevron.com>
Sent: Tuesday, October 18, 2016 9:20 AM
To: Linda Luu
Cc: Baquet, John W
Subject: Project at 405 S Hewitt Street, Los Angeles
Attachments: 2016-351 docs.pdf

Follow Up Flag: Follow up
Flag Status: Flagged

Attached are documents pertaining to your project.

PLEASE SEND ALL FUTURE CHEVRON PIPE LINE COMPANY UTILITY REQUESTS TO ME AT THE FOLLOWING EMAIL ADDRESS: DaveZerler@chevron.com

Dave Zerler
Conflict Inquiry Specialist
Spectrum Land Services
DaveZerler@chevron.com

Contractor for Chevron Pipe Line
2600 Homestead Pl
Rancho Dominguez, CA 90220
Tel +1 310 669 4014
Fax +1 310 669 4040



Dave Zerler
Conflict Inquiry Specialist

October 18, 2016

To: Linda Luu:

Chevron Pipe Line Company has determined that it has no facilities inside the scope of your proposed **project at 405 S Hewitt Street, Los Angeles**. If you would like further confirmation of this, utilize the USA system and a Chevron inspector will respond.

Sincerely,

A handwritten signature in blue ink that reads "Dave Zerler".

Dave Zerler (Contractor)
Chevron Pipe Line Company

October 10, 2016

Chuck Johnson
Chevron
2600 Homestead Way
Rancho Dominguez, CA 90220

Subject: 405 S. Hewitt Street
Los Angeles, CA 90013
As-Built and Will Serve Request

Dear Chuck Johnson,

We are in the process of gathering as-built utility and will-serve information on the subject location. In running a DigAlert Design Lookup, we have you listed as a regional utility provider. Attached for your use please find a highlighted copy of the Los Angeles Thomas Guide Map page 634 G5 and 634 H5, indicating the project limits and location. As shown in the attached sheet, the project is located along the southerly side of 4th Street in Los Angeles between Colyton Street and Hewitt Street.

If possible, we'd request that you please provide us with any as-builts or plans of record disclosing lines or structures you may have in the project area. In addition we are requesting if you could provide us with the procedure for getting will serve approval. Your prompt attention to this matter will be greatly appreciated. Please feel free to contact me if there are any questions regarding the project limits or type of information required.

Sincerely,

PSOMAS



Linda Luu, PE, ENV SP
Professional Engineer

Direct Dial 213.223.1449
Email linda.luu@psomas.com

555 South Flower Street
Suite 4300
Los Angeles, CA 90071-2405

Tel 213.223.1400
www.psomas.com

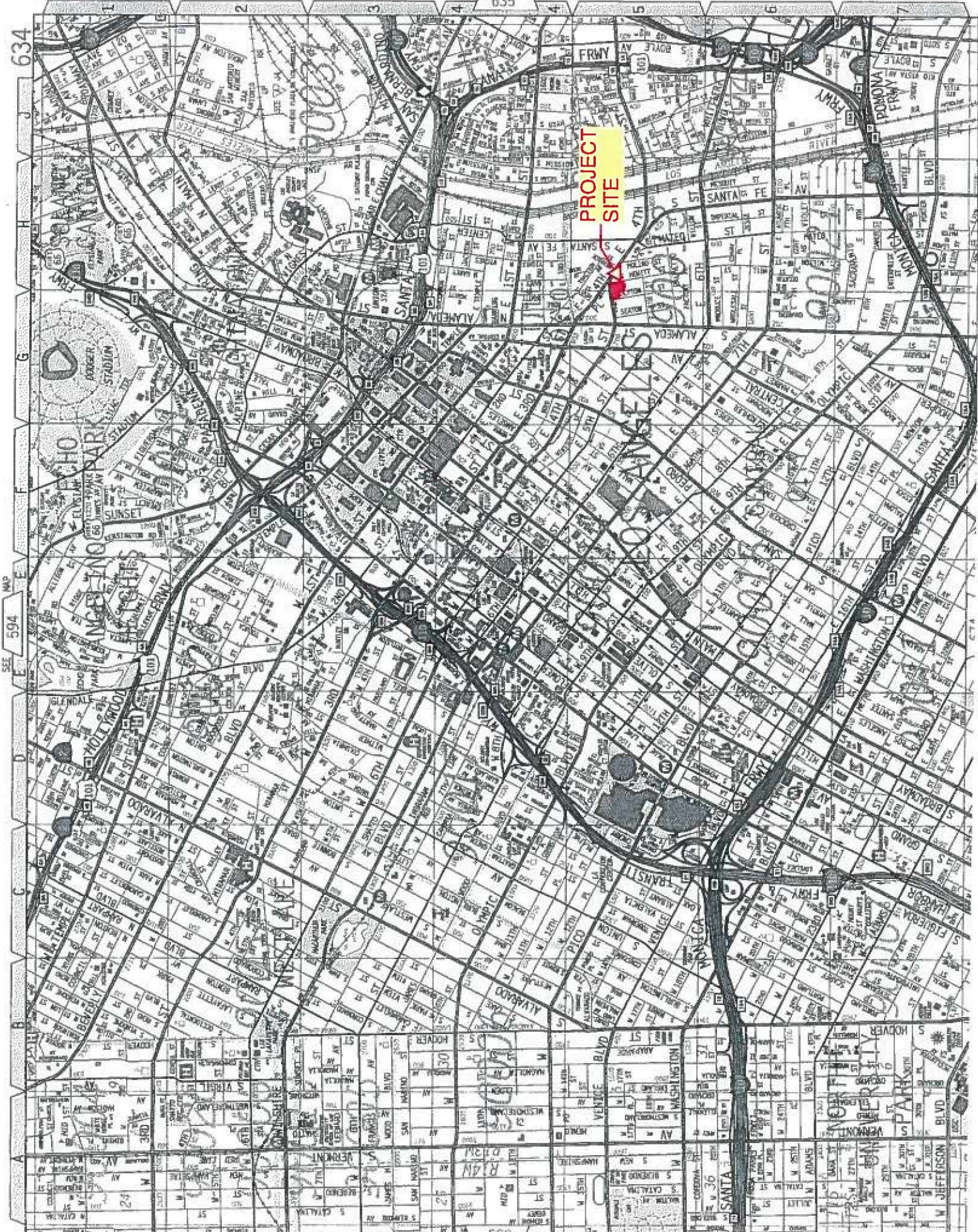

PROJECT SITE

SEE 594 MAP

634

Linda Luu

From: Antol, David <David.Antol@crowncastle.com>
Sent: Wednesday, October 12, 2016 3:09 PM
To: Linda Luu
Cc: Fiber Dig Facilities
Subject: RE: 405 S. Hewitt, Los Angeles, CA 90013 - Utility Records and Will Serve Letter-Fiber Follow Up...
Attachments: Scrn Shot-AS BUILT UTR-1016-044 405 S Hewitt LA.PDF

Follow Up Flag: Follow up
Flag Status: Flagged

Good day, Linda.

Enclosed are the results for Crown Castle's fiber facilities within this project's limits.

If there are any questions, feel free to contact us.

Sincerely,

DAVID ANTOL
Utility Coordinator
(724) 416-2180

CROWN CASTLE
2000 Corporate Dr. | Canonsburg, PA 15317
Fiberdigfacilities@CrownCastle.com

From: Linda Luu [mailto:linda.luu@psomas.com]
Sent: Monday, October 10, 2016 4:56 PM
To: Fiber Dig Team <FiberDigTeam@crowncastle.com>
Subject: 405 S. Hewitt, Los Angeles, CA 90013 - Utility Records and Will Serve Letter

Good Afternoon,

We are in the process of gathering as-built utility information for our project located at **405 S. Hewitt St, Los Angeles, CA 90013**. Your company was listed on the DigAlert design lookup and we are looking to obtain information on any of your service utilities that may be in conflict with our project improvements. Attached is a Utility Notice letter and a copy of the Los Angeles Thomas Guide Map outlining the vicinity of our project.

If you are not the person of contact for this request, please direct me to the appropriate contact. Thank you very much for your time.

Regards,

Linda Luu, PE, QSD/QSP, ENV SP
PSOMAS | Balancing the Natural and Built Environment
Professional Engineer

Facilities, Infrastructure and Development
555 South Flower Street, Suite 4300
Los Angeles, CA 90071 | 213.223.1449
www.Psomas.com

This email may contain confidential or privileged material. Use or disclosure of it by anyone other than the recipient is unauthorized. If you are not an intended recipient, please delete this email.

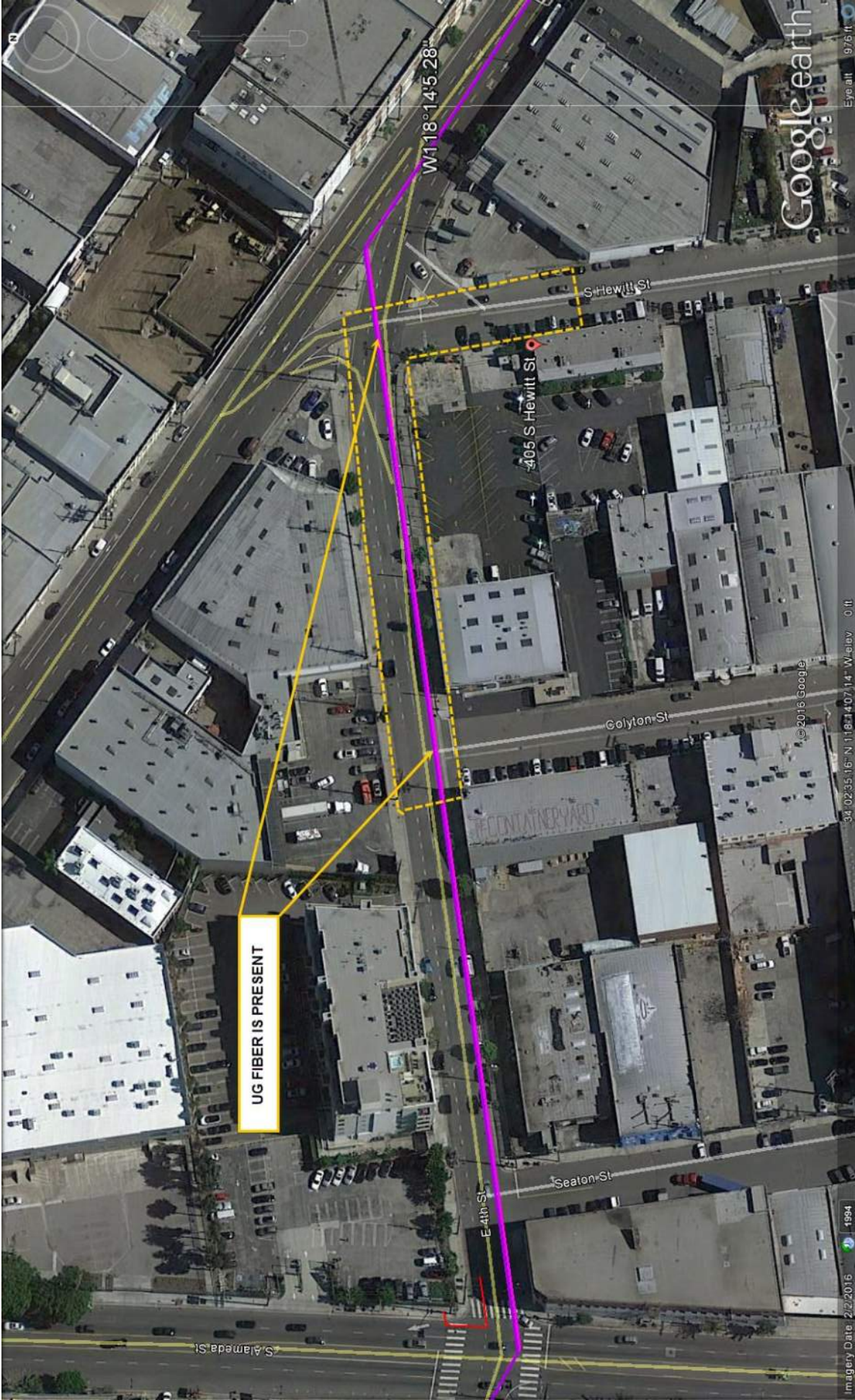

Crown Castle UG Fiber IS PRESENT along 4th Street, between S. Hewitt St. & Colyton St.

PSOMAS

Project: 405 S. Hewitt Street

Los Angeles, CA

UTR-1016-044

David Antol

Utility Coordinator

2000 Corporate Dr. | Canonsburg, PA 15317

Fiberdifactilities@CrownCastle.com



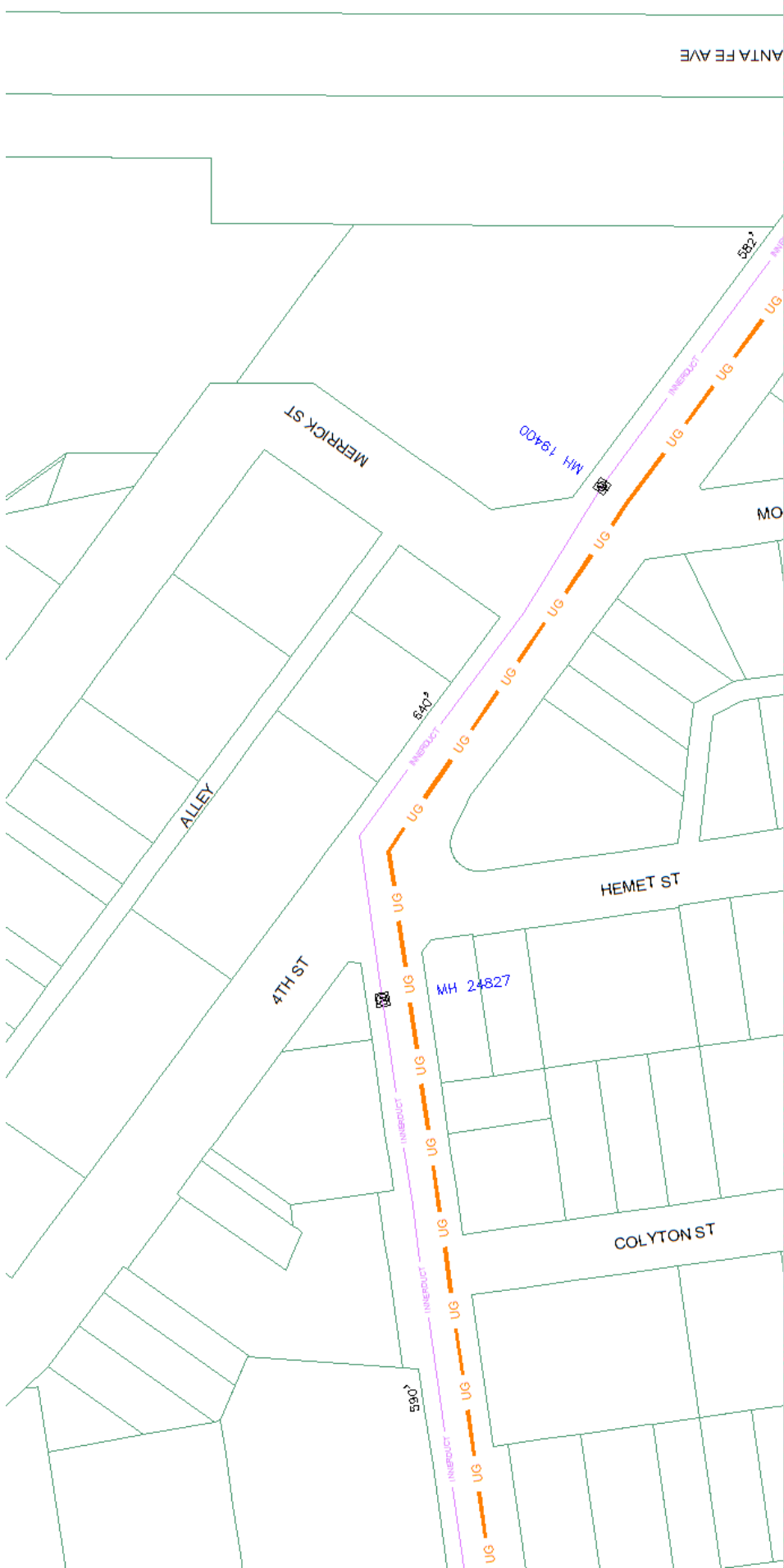

PLEASE NOTE! THE ORANGE FIBER LINES IN THE MIDDLE OF THE STREET ARE USED FOR SCHEMATIC ONLY, THE FIBERS ARE IN EXISTING UG OR ATTACHED TO STRAND LINES.

SYL	DESCRIPTION	SYL	DESCRIPTION	SYL	DESCRIPTION	SYL	DESCRIPTION	SYL	DESCRIPTION	SYL	DESCRIPTION
0	TELEPHONE POLE	1	STEEL POLE	2	EXTENSION ARM	3	OVERHEAD CUP	4	NEW SPAN	5	EXISTING OVERHEAD FIBER OPTIC LINE
6	POWER POLE	7	CONCRETE POLE	8	ANCHOR	9	POLE TO POLE CUP	10	EXISTING UNDERGROUND FIBER OPTIC LINE	11	EXISTING UNDERGROUND FIBER OPTIC LINE
12	JOINT POLE	13	POLE - TEMPORARY	14	CAWENS POST ANCHOR	15	SPAN NOT STANDED	16	EXISTING CROWN CASTLE UNDERGROUND CONDUIT	17	EXISTING CROWN CASTLE UNDERGROUND CONDUIT
18	TRANSFORMER POLE	19	PUSH-PULL BRACE	20	TREE ANCHOR	21	GROUND LOCATION	22	LEADS UNDERGROUND WITH ATTENTION	23	LEADS UNDERGROUND WITH ATTENTION
24	JOINT TRANSFORMER POLE	25	LIGHT POLE	26	ROCK ANCHOR	27	LEAD LOCATION	28	EXISTING FIBER OPTIC IN DUCT	29	EXISTING FIBER OPTIC IN DUCT
30	CITY POLE	31	FIBER - R-1/4" x 1/2"	32	BUILDING ANCHOR	33	EXISTING SPAN	34	EXISTING UNDERGROUND EQUIPMENT	35	EXISTING UNDERGROUND EQUIPMENT

Legend

CROWN CASTLE

N
E
S
W

Google Earth Colors



-  YELLOW- AERIAL FIBER – AS BUILT
-  PURPLE – UG FIBER – AS BUILT
-  BROWN – UG FIBER – FTTC – AS BUILT
-  DK BLUE – LEASED FIBER
-  RED – EXACT UG LOCATION

We Are Solutions

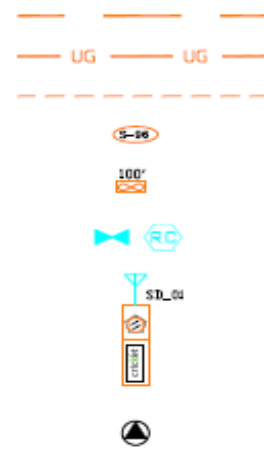
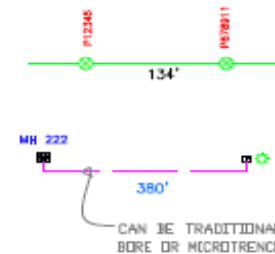

Legend

TYPICAL AERIAL/UNDERGROUND INFRASTRUCTURE

TYPICAL AERIAL
POLES WITH STRAND, POLE# & FOOTAGE

TYPICAL UNDERGROUND
MANHOLE TO SPLICE BOX, WITH UG CONSTRUCTION TYPE,
UG FOOTAGE, WITH STREETLIGHT

TYPICAL FIBER INFRASTRUCTURE

FIBER MAIN – AERIAL

FIBER MAIN-UG

FIBER TAIL

FIBER COUNT

FIBER SLACK SPAN

FIBER SPLICE/RING CUT

FIBER NODE (REMOTE) WITH ANTENNA

FIBER HUB (CABINET)

PSOMAS
Project: 405 S. Hewitt Street
Los Angeles, CA
UTR-1016-044

David Antol
 Utility Coordinator
 2000 Corporate Dr. | Canonsburg, PA 15317
Fiberdigfacilities@CrownCastle.com



Linda Luu

From: Rodriquez, Anthony <Anthony.Rodriquez@ladwp.com>
Sent: Tuesday, October 18, 2016 11:45 AM
To: Linda Luu
Subject: 405 South Hewitt Street Project

Follow Up Flag: Follow up
Flag Status: Completed

Dear Linda,

We received your utility request regarding the project mentioned in the subject

Due to the large volume of requests and the lack of adequate labor resources, the LADWP Power System is not able to respond to general blanket inquiries or research requests. However, we have found, in a majority of instances, BOE substructure record maps usually contains sufficient information to fulfill such requests.

At this stage of your project, and in an effort to prioritize your work, we will first ask that you utilize the BOE substructure record maps available at City of Los Angeles, Bureau of Engineering's NaviGateLA website (<http://navigatela.lacity.org/index.cfm>). Also, for overhead power facilities such as poles, the best way to gather information is to perform your own project field survey or use aerial photography available on the internet. If LADWP–Power substructures and/or overhead facilities are pre-identified in this process, you can then send your utility drawings in for review and verification that they are shown correctly.

If, after utilizing available substructure resources, you discover the desired information is unavailable, please provide a copy of the substructure map(s) with the power facility and/or area of interest highlighted. Also, please provide a brief description of the proposed infrastructure improvements to determine the level of information required.

If a substructure map does not exist or is unavailable online for the area of concern, please let me know.

For new services click on the [Find The Right Person](#) for your job link, enter your project address and contact the Service Planning Engineer. The LADWP's Electric Service Requirements may be found online at [Electric Service Requirements](#) and you're the job status of your electrical service may be checked online at [Track Service Requests](#).

If you have any questions please contact Edgar Mercado at edgar.mercado@ladwp.com or 213.367.4957

Sincerely,

Anthony Rodriquez

-----Confidentiality Notice-----

This electronic message transmission contains information from the Los Angeles Department of Water and Power, which may be confidential. If you are not the intended recipient, be aware that any disclosure, copying, distribution or use of the content of this information is prohibited. If you have received this communication in error, please notify us immediately by e-mail and delete the original message and any attachment without reading or saving in any manner.

Linda Luu

From: Bachelder, John <john.bachelder@verizon.com>
Sent: Tuesday, November 01, 2016 1:01 PM
To: Linda Luu
Subject: RE: 405 S. Hewitt, Los Angeles, CA 90013 - Utility Records and Will Serve Letter

Follow Up Flag: Follow up
Flag Status: Flagged

Linda,
Verizonbusiness (MCI) has NO Facilities at the project location.

PLEASE DO NOT REPLY TO THIS MESSAGE. THIS E-MAIL DOES NOT ACCEPT MESSAGES.
PLEASE SEND INQUIRIES TO Investigations@verizon.com

Thanks,
John Bachelder

From: Investigations [mailto:Investigations@one.verizon.com]
Sent: Monday, October 10, 2016 3:57 PM
To: Bachelder, John
Subject: FW: 405 S. Hewitt, Los Angeles, CA 90013 - Utility Records and Will Serve Letter

From: Linda Luu[SMTP:LINDA.LUU@PSOMAS.COM]
Sent: Monday, October 10, 2016 4:57:09 PM
To: Investigations
Subject: 405 S. Hewitt, Los Angeles, CA 90013 - Utility Records and Will Serve Letter
Auto forwarded by a Rule

Good Afternoon,

We are in the process of gathering as-built utility information for our project located at **405 S. Hewitt St, Los Angeles, CA 90013**. Your company was listed on the DigAlert design lookup and we are looking to obtain information on any of your service utilities that may be in conflict with our project improvements. Attached is a Utility Notice letter and a copy of the Los Angeles Thomas Guide Map outlining the vicinity of our project.

If you are not the person of contact for this request, please direct me to the appropriate contact. Thank you very much for your time.

Regards,

Linda Luu, PE, QSD/QSP, ENV SP

PSOMAS | Balancing the Natural and Built Environment

Professional Engineer
Facilities, Infrastructure and Development
555 South Flower Street, Suite 4300

Linda Luu

From: Paula J Bawden <pjbawden@paalp.com>
Sent: Monday, October 10, 2016 2:57 PM
To: Linda Luu
Subject: RE: 405 S. Hewitt, Los Angeles, CA 90013 - Utility Records and Will Serve Letter

Follow Up Flag: Follow up
Flag Status: Flagged

Dear Ms. Luu,

Plains All American Pipeline does not have any facilities in the project area you describe in your e-mail below. Our nearest facilities are in Alameda Street west of your project area.

If you have any questions, please do not hesitate to contact me.

Paula Bawden
Right of Way Clerk
Plains All American Pipeline
5900 Cherry Avenue
Long Beach, CA 90805
(562) 728-2371
pjbawden@paalp.com

From: Linda Luu [mailto:linda.luu@psomas.com]
Sent: Monday, October 10, 2016 2:01 PM
To: Paula J Bawden
Subject: 405 S. Hewitt, Los Angeles, CA 90013 - Utility Records and Will Serve Letter [External]

Good Afternoon,

We are in the process of gathering as-built utility information for our project located at **405 S. Hewitt St, Los Angeles, CA 90013**. Your company was listed on the DigAlert design lookup and we are looking to obtain information on any of your service utilities that may be in conflict with our project improvements. Attached is a Utility Notice letter and a copy of the Los Angeles Thomas Guide Map outlining the vicinity of our project.

If you are not the person of contact for this request, please direct me to the appropriate contact. Thank you very much for your time.

Regards,

Linda Luu, PE, QSD/QSP, ENV SP

PSOMAS | Balancing the Natural and Built Environment

Professional Engineer
Facilities, Infrastructure and Development
555 South Flower Street, Suite 4300

Attention:

The information contained in this message and/or attachments is intended only for the person or entity to which it is addressed and may contain confidential and/or privileged material. If you received this in error, please contact the Plains Service Desk at 713-646-4444 and delete the material from any system and destroy any copies.

This footnote also confirms that this email message has been scanned for Viruses and Content and cleared.

Linda Luu

From: clarinda.maldonado@shell.com
Sent: Tuesday, November 01, 2016 10:35 AM
To: Linda Luu
Subject: No Conflict Letter - PSOMAS - 405 S. Hewitt Street - Inquiry 15546
Attachments: 20161101125445082.pdf

Follow Up Flag: Follow up
Flag Status: Flagged

Linda,

Please see the attached No Conflict Letter.

Thanks.

Clarinda Maldonado
Shell Pipeline Company LP
Encroachment Specialist
910 Louisiana | OSP 41082C | Houston, TX 77002
Office: 713-241-9259
Clarinda.Maldonado@shell.com



Shell Pipeline Company LP

910 Louisiana, OSP 41st Floor
Houston, Texas 77002
Tel 1-800-438-7752
Email SPLC-
Encroachments@shell.com

November 1, 2016

PSOMAS LA
Attn: Linda Luu
555 South Flower Street, Suite 4300
Los Angeles, CA 90071

Dear Linda Luu:

SUBJECT: Your Project: As-Built and Will Serve Request - 405 S. Hewitt Street, Los Angeles
Shell's Pipeline(s): NONE
Shell's Inquiry Record No. 15546
Thomas Brothers Map Book Page 634 Grid G5, H5

Please refer to your correspondence dated 10/10/2016 concerning your subject project. Shell Pipeline Company LP (Shell) has determined that no Shell facilities are located within your project area.

Sincerely,

A handwritten signature in black ink, appearing to read 'Clarinda Maldonado', is written over the typed name.

Clarinda Maldonado
Encroachment Specialist

Linda Luu

From: Laky, Tibor F Sr [CTO] <Tibor.X.Laky@sprint.com>
Sent: Monday, October 10, 2016 3:12 PM
To: Linda Luu
Cc: Fry, Jack R [Cascade Design Contractor for Sprint]; Preston, Kevin A [Cascade Design Contractor for Sprint]
Subject: FW: 405 S. Hewitt, Los Angeles, CA 90013 - Utility Records and Will Serve Letter
Attachments: 4th Hewitt Thomas Guide.pdf; 16-1010_4th Hewitt Utility Letters_Sprint.pdf

Follow Up Flag: Follow up
Flag Status: Flagged

Thank you for including Sprint on your inquiry. According to my records, Sprint has no facilities within the limits of the inquiry. Sprint does have an extensive fiber optic system and Cellular communication system in Los Angeles but not within the area delineated for this inquiry.

Please let us know if your project's limits change or you encounter an unknown facility.

Please have all contractors utilize the Dig Alert procedures before excavating, CALL BEFORE YOU DIG 811 or 800-227-2600

Tibor Laky

Facilities Engineer, OSP Engineering & Const – West
O: 714-617-9598, M: 949-842-9315
2592 Dupont Drive, Irvine, CA 92612
tibor.x.laky@sprint.com

#gettingbettereveryday



From: Linda Luu [mailto:linda.luu@psomas.com]
Sent: Monday, October 10, 2016 2:03 PM
To: Laky, Tibor F Sr [CTO] <Tibor.X.Laky@sprint.com>
Subject: 405 S. Hewitt, Los Angeles, CA 90013 - Utility Records and Will Serve Letter

Good Afternoon,

We are in the process of gathering as-built utility information for our project located at **405 S. Hewitt St, Los Angeles, CA 90013**. Your company was listed on the DigAlert design lookup and we are looking to obtain information on any of your service utilities that may be in conflict with our project improvements. Attached is a Utility Notice letter and a copy of the Los Angeles Thomas Guide Map outlining the vicinity of our project.

If you are not the person of contact for this request, please direct me to the appropriate contact. Thank you very much for your time.

Regards,

Linda Luu, PE, QSD/QSP, ENV SP

PSOMAS | Balancing the Natural and Built Environment

Professional Engineer

Facilities, Infrastructure and Development

555 South Flower Street, Suite 4300

Los Angeles, CA 90071 | 213.223.1449

www.Psomas.com

This e-mail may contain Sprint proprietary information intended for the sole use of the recipient(s). Any use by others is prohibited. If you are not the intended recipient, please contact the sender and delete all copies of the message.

Linda Luu

From: Hugo Alvarado <halvarado@wilcon.com>
Sent: Friday, December 16, 2016 7:18 AM
To: Linda Luu
Cc: Wilcon Fiber Engineering
Subject: 405 S. Hewitt, Los Angeles, CA 90013 - Utility Records and Will Serve Letter
Attachments: Wilcon_405 S. Hewitt.PNG; 4th Hewitt Thomas Guide.pdf; 16-1010_4th Hewitt Utility Letters_Wilcon.pdf

Follow Up Flag: Follow up
Flag Status: Flagged

Good morning Linda,
please see attached to see Wilcon's substructure indicated in green. Our fiber is located in AT&T conduit. Manhole locations and numbers are also shown. If you need any additional information, you would need to contact AT&T directly. I apologize for the delay in our response, we're extremely busy. Please let us know if there's anything else we can do to help.

Thank you...

Hugo Alvarado
Fiber Engineer

T 1.213.542.0484
E halvarado@wilcon.com

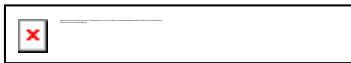

624 South Grand Avenue, Suite 2500, Los Angeles, CA 90017
www.wilcon.com | **T** +1.888.600.2800 | **E** info@wilcon.com

Confidentiality Notice: The information contained in this e-mail (including attachments) is only for the personal and confidential use of the sender and recipient named above. If the reader is not the intended recipient, you are notified that you have received this message in error and that any review, dissemination, copying or distribution is prohibited. If you have received this communication in error, please notify the sender immediately by e-mail and delete or destroy the original message and all copies. Thank you.

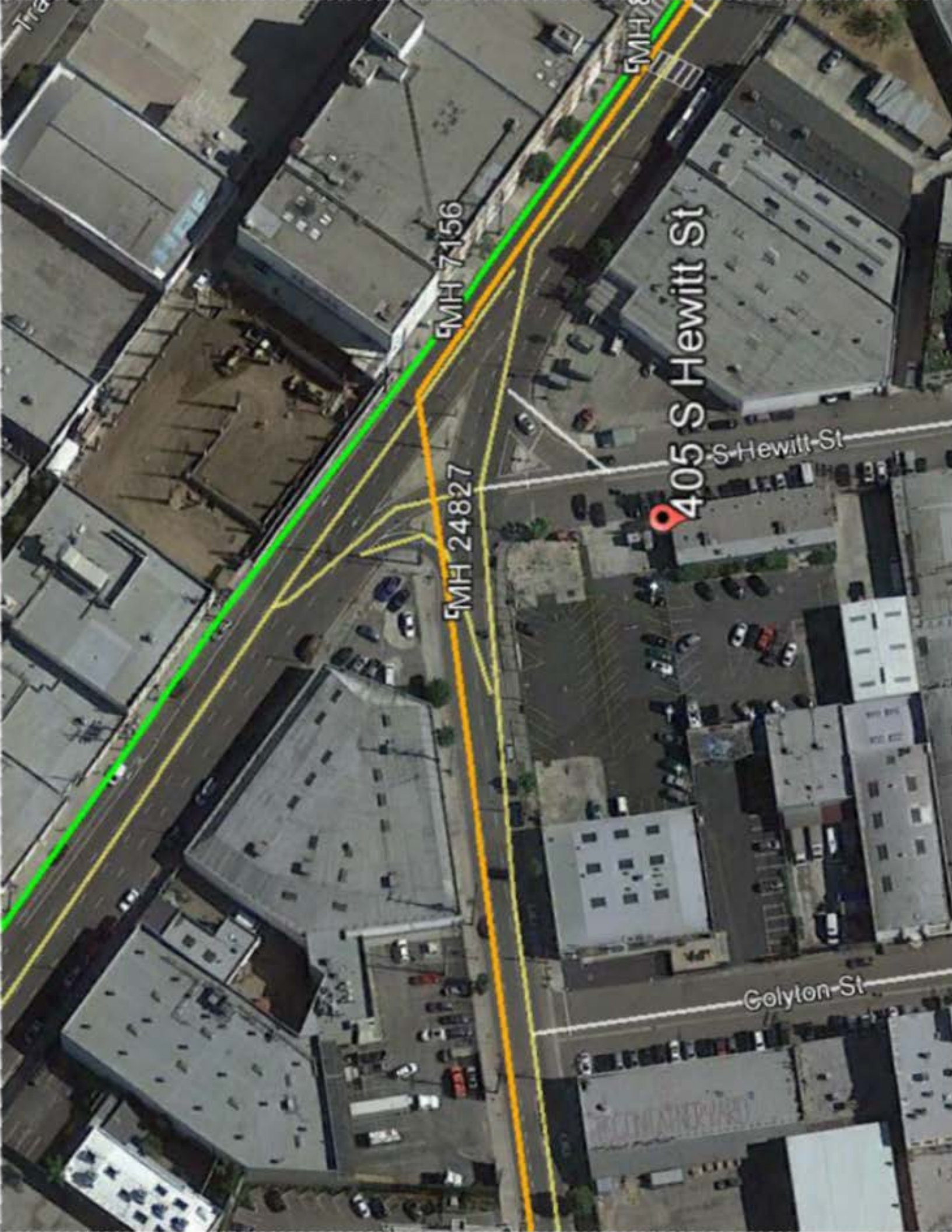

MH 8

MH 7156

MH 24827

405 S Hewitt St

S Hewitt St

Golyton St

Linda Luu

From: Bergine, Matt <matt.bergine@xo.com>
Sent: Tuesday, October 11, 2016 8:11 AM
To: Linda Luu
Subject: RE: 405 S. Hewitt, Los Angeles, CA 90013 - Utility Records and Will Serve Letter

Follow Up Flag: Follow up
Flag Status: Flagged

XO Communications Services LLC has no Facilities in the area designated on the drawing provided.

Thank you.

MATT BERGINE
IMPLEMENTATION ENGINEER
XO COMMUNICATIONS SERVICES, LLC.
600 W. 7TH ST. SUITE 300, LOS ANGELES, CA. 90017
PHONE: (949) 417-7841
CELL: (714) 822-6207
EMAIL: MATT.BERGINE@XO.COM

From: Linda Luu [mailto:linda.luu@psomas.com]
Sent: Monday, October 10, 2016 2:10 PM
To: Bergine, Matt <matt.bergine@xo.com>
Subject: 405 S. Hewitt, Los Angeles, CA 90013 - Utility Records and Will Serve Letter

Good Afternoon,

We are in the process of gathering as-built utility information for our project located at **405 S. Hewitt St, Los Angeles, CA 90013**. Your company was listed on the DigAlert design lookup and we are looking to obtain information on any of your service utilities that may be in conflict with our project improvements. Attached is a Utility Notice letter and a copy of the Los Angeles Thomas Guide Map outlining the vicinity of our project.

If you are not the person of contact for this request, please direct me to the appropriate contact. Thank you very much for your time.

Regards,

Linda Luu, PE, QSD/QSP, ENV SP
PSOMAS | Balancing the Natural and Built Environment
Professional Engineer
Facilities, Infrastructure and Development
555 South Flower Street, Suite 4300
Los Angeles, CA 90071 | 213.223.1449
www.Psomas.com



22311 Brookhurst Street Suite203
Huntington Beach Ca 92646

NO CONFLICT

June 5, 2019

Psomas
Attn: Daisy Rosas
555 S. Flower St. #4300
Los Angeles, CA 90071

Re: 405 S. Hewitt St. Los Angeles, CA

Dear Ms. Rosas,

This is in response to your Inquiry Letter dated June 4, 2019, regarding the above referenced project. After reviewing your location maps, please be advised that AT&T Network Services (long distance) has no active facilities (Transcontinental Fiber Optics Lines) within the vicinity of this project.

Thank you for notifying AT&T of the pending project referenced above. Notification of future proposed work, performed in this vicinity should be directed to:

AT&T INQUIRIES
22311 Brookhurst Street, Suite 203
Huntington Beach, CA 92646
joef@forkertengineering.com

Should you have any questions or concerns regarding this project, please contact Mr. Joseph Forkert at (714) 963-7964 or me at your earliest convenience.

Please Note

AT&T Drawings are Proprietary Information Pursuant to Company instructions—This Office does not distribute drawings for Pre-Planning and Design Engineering purposes.

Please contact your local City, County, Utility Notification Center or AT&T on Site Plant Protection Workforce to identify AT&T facilities prior to contacting AT&T Engineering. If you are referred to our office because of a possible conflict with AT&T lines, we will confirm and provide you with the appropriate drawings and pertinent information required to avoid a conflict with AT&T lines prior to the start of your construction project.

Sincerely,

Joseph Forkert for
Tanya Hernandez
OSP Maintenance Engineer
(619) 200-7896

Daisy Rosas

From: Zetina, Kendall <kendall.zetina@centurylink.com>
Sent: Monday, July 8, 2019 3:21 PM
To: Daisy Rosas
Subject: No Facilities: Utility Request - 405 S. Hewitt St
Attachments: Utility Map.pdf

Daisy,

CenturyLink Communications, LLC (National Fiber Optic longhaul/metro network) has received your utility notice. After reviewing the information you provided it has been determined that CenturyLink does not have facilities within the scope of the Project. Therefore it will not be necessary for CenturyLink to relocate or adjust the facilities.

Any changes or additions to the Project plans or parameters should be submitted to CenturyLink for review of potential new impacts to the CenturyLink facilities. Please reference the file number **159007 CA** with any future communications.

Thank you,

Kendall Williams-Zetina

Business Analyst
Relocations Department
CenturyLink
100 S. Cinninnati Ave., Suite 1200
Tulsa, OK 74103
p: 918-547-0547
e: Kendall.Zetina@centurylink.com



Please send all initial requests to NationalRelo@centurylink.com to ensure visibility by the department.

From: Daisy Rosas <daisy.rosas@psomas.com>
Sent: Tuesday, June 4, 2019 5:28 PM
To: King, Caleb <caleb.king@level3.com>
Subject: Utility Request - 405 S. Hewitt St

To whom it may concern,

We are in the process of gathering as-built utility information for our project located at 405 S. Hewitt Street, Los Angeles, CA 90013. Your company was listed on the Dig alert design lookup, and we are looking to obtain information on any of your service utilities that may be in conflict with our project improvements. Attached is a Utility Notice letter and a copy of the Los Angeles Thomas Guide Map.

If you are not the person of contact for this request, please direct me to the appropriate contact. Thank you very much for your time.

Regards,

Daisy Rosas, E.I.T.

PSOMAS | [Balancing the Natural and Built Environment](#)

Civil Engineer Designer

Facilities, Infrastructure and Development

555 S. Flower Street, Suite 4300

Los Angeles, CA 90071

Direct Office: 213.223.1498

www.Psomas.com

This communication is the property of CenturyLink and may contain confidential or privileged information. Unauthorized use of this communication is strictly prohibited and may be unlawful. If you have received this communication in error, please immediately notify the sender by reply e-mail and destroy all copies of the communication and any attachments.

6/5/2019

Daisy Rosas
Psomas
555 S. Flower Street, Suite 4300
Los Angeles, CA 90071

Requester Project: Map request
Project Name: 405 S. Hewitt Steet
DOCK/PRISM Project Name: E. 4th Street & S.Hewitt Steet
Conflict: YES

Thank you for your recent Utility Request to Charter Communications for: 405 S. Hewitt Steet

Please review the attached maps for any possible conflicts with Charter facilities.
There **ARE** existing Charter aerial/or underground facilities within the project limits.

We have provided maps showing where our services are located but cannot make any comment on how to deal with possible conflicts during construction. This type of information should come from the Construction Manager, Supervisor or Construction Coordinator for the area in question.

If you should require any field meet or any further coordination of the project with Charter please contact the Construction Manager listed below.

Construction Manager Contact:

Scharrer, David
Construction Manager - Zones 5 and 11C
1041 E. Route 66
Glendora, CA 91740
626-639-1622
david.scharrer@charter.com

If you have any questions about the maps provided, please contact DL-socal-charter-engineering@charter.com. This communication is for a project being handled by Charter Communications or Spectrum, a Charter Communications brand name, or Legacy Time Warner Cable.

Sincerely,

Dave Dolney

Dave Dolney
Sr. Manager, PACWEST Construction
Charter Communications
12051 Industry Street
Garden Grove, CA 92841

405 S. Hewitt Street
Map
Los Angeles, CA 90013

Red-existing Charter aerial facilities within project limits.

Green-existing Charter underground facilities within project limits.

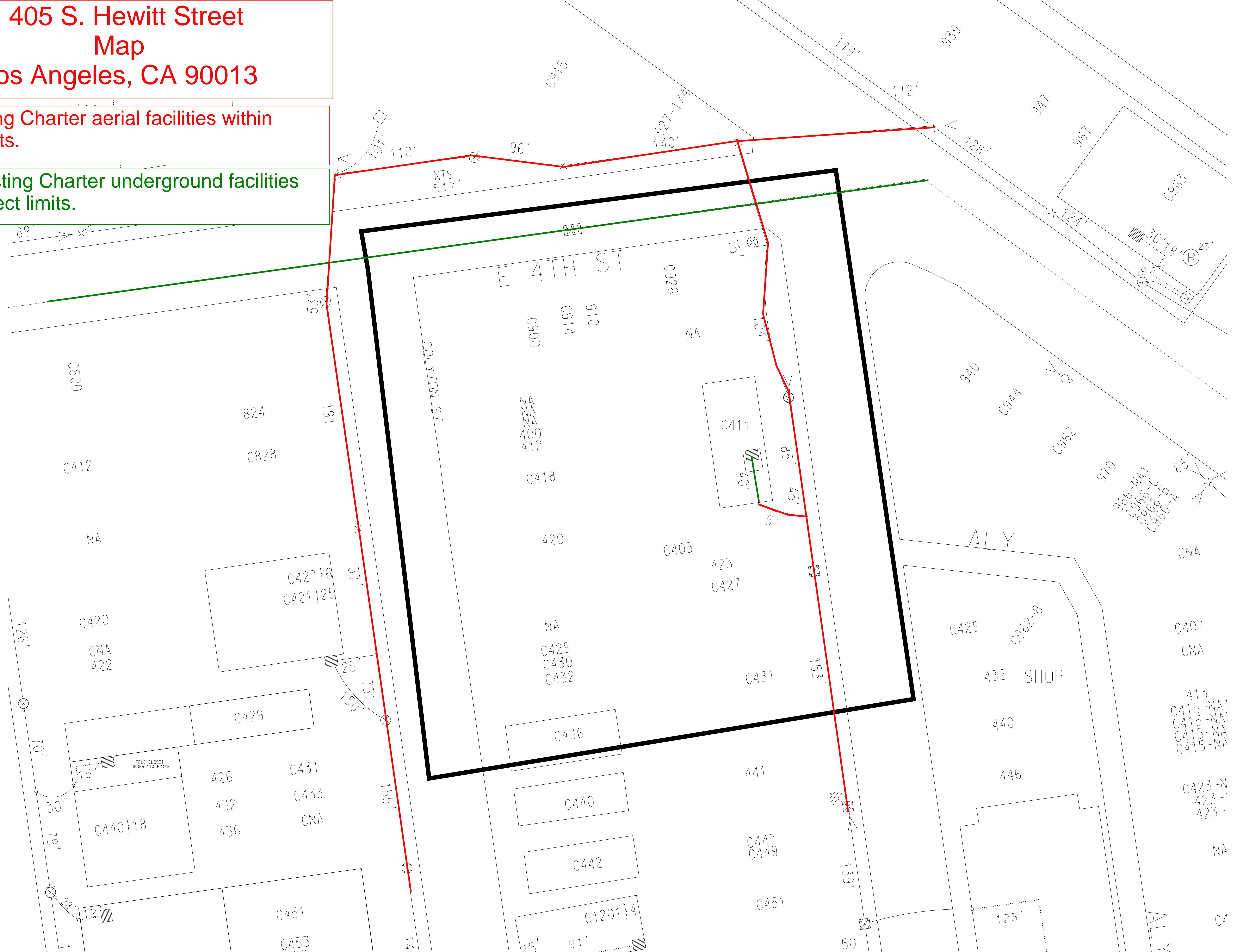



SOUTHERN CALIFORNIA
EDISON
An EDISON INTERNATIONAL Company

June 20, 2019

Attn: Daisy Rosas
Psomas
555 South Flower St Ste 4300
Los Angeles, CA 90071-2405

RE: Out of SCE Territory (405 S HEWITT ST)

Our records indicate that there are no existing Southern California Edison overhead or underground facilities inventory maps covering the area of your proposed project. The project site is outside SCE service territory.

Thank you, and if you have any further questions, please call me at (714) 796-9932.

Kim Gurule
Facilities Mapping
Power Distribution

Enclosures

Bldg D
P.O. Box 11982
Santa Ana, Ca 92711-1982

Daisy Rosas

From: Troyer, Steven (Contractor) <Steven_Troyer@kindermorgan.com>
Sent: Friday, August 2, 2019 11:04 AM
To: Daisy Rosas
Subject: RE: Utility Request - 405 S. Hewitt St
Attachments: GeoSpatial Map.jpg

August 2, 2019

Daisy Rosas, EITT
P S O M A S
Civil Engineer Designer
555 South Flower Street, Suite 4300
daisy.rosas@psomas.com

Re: 405 S. Hewitt Street
Los Angeles, CA 90013
As-Built Request

Dear Ms. Rosas,

This correspondence is in response to your inquiry email dated June 4, 2019, regarding the project referenced above.

Based upon the information provided, Kinder Morgan (KM) has no facilities within the specified project area and therefore has no conflict with the proposed project

In the event the scope of your project changes, please submit an updated information request.

Sincerely,

Steven Troyer
Engineering Technician / Contractor
Kinder Morgan
Pipeline Protection
(713) 420-6399

From: Daisy Rosas <daisy.rosas@psomas.com>
Sent: Wednesday, June 5, 2019 9:58 AM
To: PipelineInquiries <PipelineInquiries@kindermorgan.com>
Subject: Utility Request - 405 S. Hewitt St

[This email message was received from the Internet and came from outside of Kinder Morgan]

To whom it may concern,

We are in the process of gathering as-built utility information for our project located at 405 S. Hewitt Street, Los Angeles, CA 90013. Your company was listed on the Dig alert design lookup, and we are looking to obtain information on any of your service utilities that may be in conflict with our project improvements. Attached is a Utility Notice letter and a copy of the Los Angeles Thomas Guide Map.

If you are not the person of contact for this request, please direct me to the appropriate contact. Thank you very much for your time.

Regards,

Daisy Rosas, E.I.T.

PSOMAS | Balancing the Natural and Built Environment

Civil Engineer Designer

Facilities, Infrastructure and Development

555 S. Flower Street, Suite 4300

Los Angeles, CA 90071

Direct Office: 213.223.1498

www.Psomas.com

Daisy Rosas

From: Santangelo, Lewis <lewis.h.santangelo@ftr.com>
Sent: Wednesday, August 7, 2019 9:13 AM
To: Daisy Rosas
Cc: Riggs, Cory
Subject: RE: Utility Request - 405 S. Hewitt St

Daisy,

The is not in our service area and we have no facilities in this vicinity.

Lewis Santangelo
Frontier California
Network Engineering and Ops
[Lewis.h.santangelo@ftr.com](mailto:lewis.h.santangelo@ftr.com)
818-837-0394 (o)

From: Daisy Rosas <daisy.rosas@psomas.com>
Sent: Wednesday, August 07, 2019 8:25 AM
To: Santangelo, Lewis <lewis.h.santangelo@ftr.com>
Cc: Riggs, Cory <cory.riggs@ftr.com>
Subject: RE: Utility Request - 405 S. Hewitt St

Hello,

This is a follow up of the utility request made on 6/4/19 for the address: 405 S. Hewitt St, Los Angeles, CA.

Regards,

Daisy Rosas, E.I.T.

PSOMAS | Balancing the Natural and Built Environment

Civil Engineer Designer
Facilities, Infrastructure and Development

555 S. Flower Street, Suite 4300
Los Angeles, CA 90071
Direct Office: 213.223.1498
www.Psomas.com

From: Riggs, Cory <cory.riggs@ftr.com>
Sent: Thursday, June 6, 2019 8:03 AM
To: Santangelo, Lewis <lewis.h.santangelo@ftr.com>
Cc: Daisy Rosas <daisy.rosas@psomas.com>
Subject: FW: Utility Request - 405 S. Hewitt St

Lew,

This one is OOF.

Thank you

Cory Riggs | Frontier Communications
Sr. Network Engineer
1450 S Bundy Dr
Los Angeles, CA 90025
O: 310-264-5123 | C: 310-210-9882
Cory.Riggs@ftr.com
Frontier.com



From: Daisy Rosas <daisy.rosas@psomas.com>
Sent: Tuesday, June 4, 2019 3:50 PM
To: Riggs, Cory <cory.riggs@ftr.com>
Subject: Utility Request - 405 S. Hewitt St

WARNING: External email. Please verify sender before opening attachments or clicking on links.

To whom it may concern,

We are in the process of gathering as-built utility information for our project located at 405 S. Hewitt Street, Los Angeles, CA 90013. Your company was listed on the Dig alert design lookup, and we are looking to obtain information on any of your service utilities that may be in conflict with our project improvements. Attached is a Utility Notice letter and a copy of the Los Angeles Thomas Guide Map.

If you are not the person of contact for this request, please direct me to the appropriate contact. Thank you very much for your time.

Regards,

Daisy Rosas, E.I.T.

PSOMAS | Balancing the Natural and Built Environment

Civil Engineer Designer

Facilities, Infrastructure and Development

555 S. Flower Street, Suite 4300

Los Angeles, CA 90071

Direct Office: 213.223.1498

www.Psomas.com

This communication is confidential. Frontier only sends and receives email on the basis of the terms set out at http://www.frontier.com/email_disclaimer.