

Appendix C

Biological Communities Maps

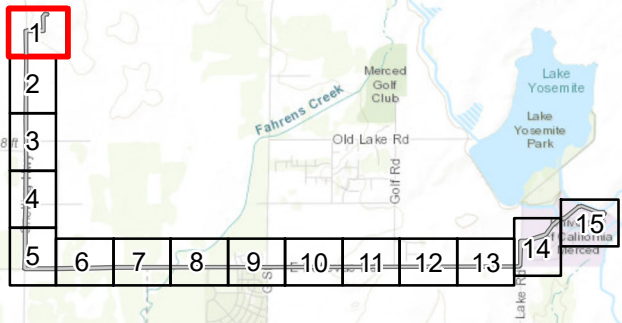

MERCED LANDFILL PIPELINE - BIOLOGICAL COMMUNITIES

—

FIGURE 1.4-1 SHEET 1

Legend

- Biological Communities**
- Agriculture (9.10 Acres)
 - Depressional Seasonal Wetland (0.25 Acres)
 - Non-Native Annual Grassland (24.99 Acres)
 - Ruderal/Developed (91.87 Acres)
 - Study Area ±129 Acres
 - Culvert

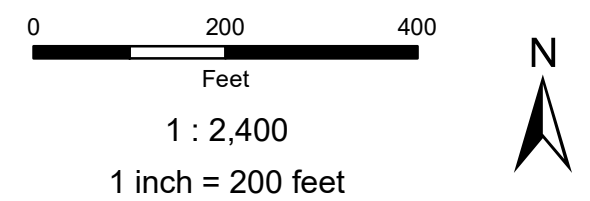

FOOTHILL ASSOCIATES
 ENVIRONMENTAL CONSULTING • PLANNING • LANDSCAPE ARCHITECTURE
 Drawn By: MUB QA/QC: AMP Date: 5/2/2019
 © 2019



Aerial Imagery Date: 3/12/2017 & 6/28/2017
 Aerial Imagery Source: Vivid, Digital Globe, ESRI

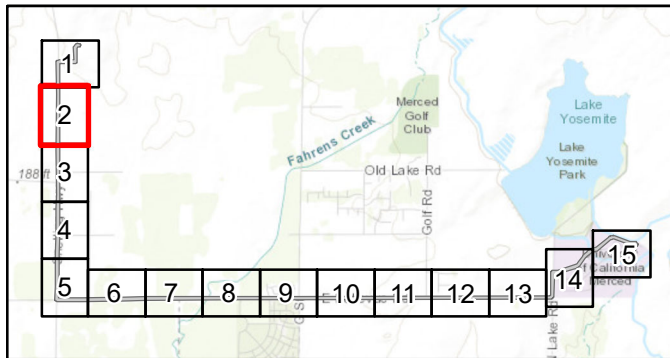

MERCED LANDFILL PIPELINE - BIOLOGICAL COMMUNITIES

—

FIGURE 1.4-1 SHEET 2

Legend

Biological Communities

- Agriculture (9.10 Acres)
- Depressional Seasonal Wetland (0.25 Acres)
- Ruderal/Developed (91.87 Acres)
- Study Area ±129 Acres
- X Culvert

0 200 400

Feet

1 : 2,400

1 inch = 200 feet



FOOTHILL ASSOCIATES

ENVIRONMENTAL CONSULTING • PLANNING • LANDSCAPE ARCHITECTURE

Drawn By: MUB QA/QC: AMP Date: 5/2/2019

© 2019

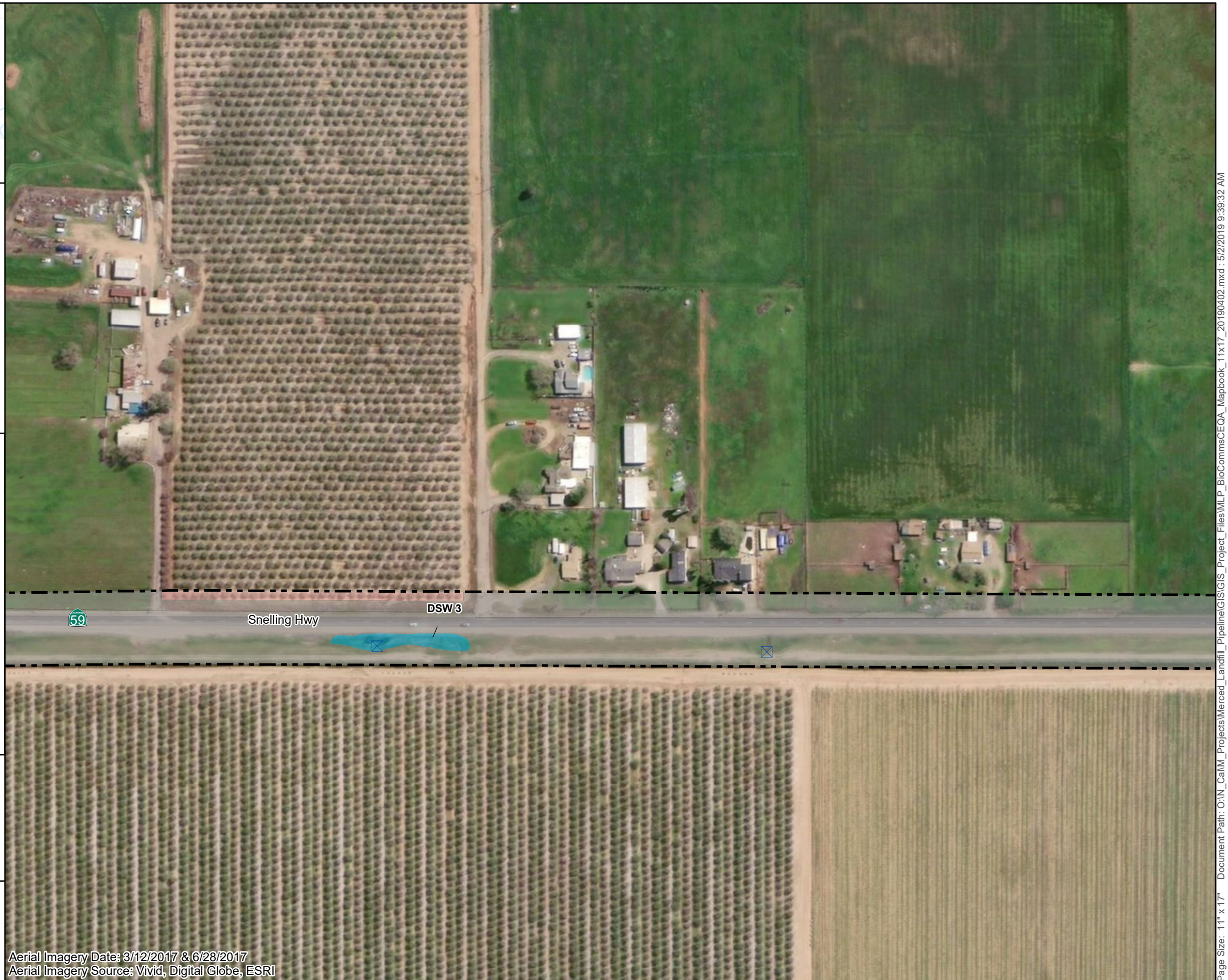

Aerial Imagery Date: 3/12/2017 & 6/28/2017
Aerial Imagery Source: Vivid, Digital Globe, ESRI

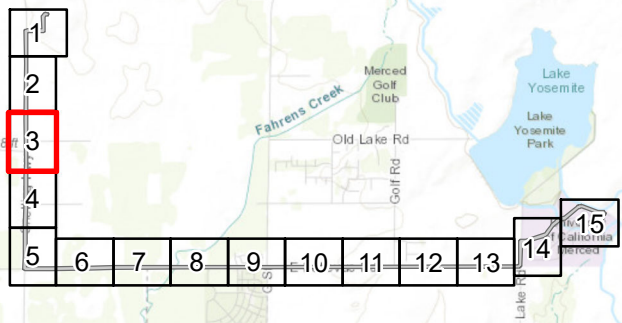



MERCED LANDFILL PIPELINE - BIOLOGICAL COMMUNITIES

—
**FIGURE 1.4-1
SHEET 3**

Legend

Biological Communities

-  Ruderal/Developed (91.87 Acres)
-  Study Area ±129 Acres

0 200 400



Feet

1 : 2,400

1 inch = 200 feet



 **FOOTHILL ASSOCIATES**

ENVIRONMENTAL CONSULTING • PLANNING • LANDSCAPE ARCHITECTURE

Drawn By: MUB QA/QC: AMP Date: 5/2/2019

© 2019



Aerial Imagery Date: 3/12/2017 & 6/28/2017
Aerial Imagery Source: Vivid, Digital Globe, ESRI

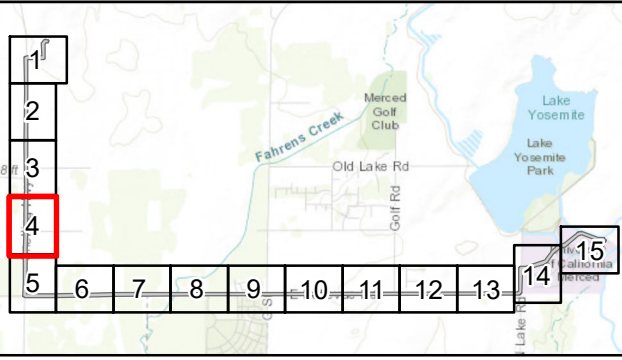

MERCED LANDFILL PIPELINE - BIOLOGICAL COMMUNITIES

—

FIGURE 1.4-1 SHEET 4

Legend

- Biological Communities**
- Agriculture (9.10 Acres)
 - Irrigation Ditch (0.28 Acres)
 - Ruderal/Developed (91.87 Acres)
 - Study Area ±129 Acres
 - Culvert

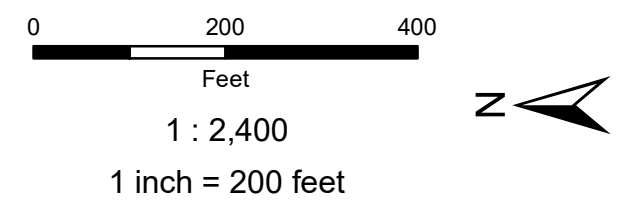

FOOTHILL ASSOCIATES
 ENVIRONMENTAL CONSULTING • PLANNING • LANDSCAPE ARCHITECTURE
 Drawn By: MUB QA/QC: AMP Date: 5/2/2019
 © 2019



Aerial Imagery Date: 3/12/2017 & 6/28/2017
 Aerial Imagery Source: Vivid, Digital Globe, ESRI

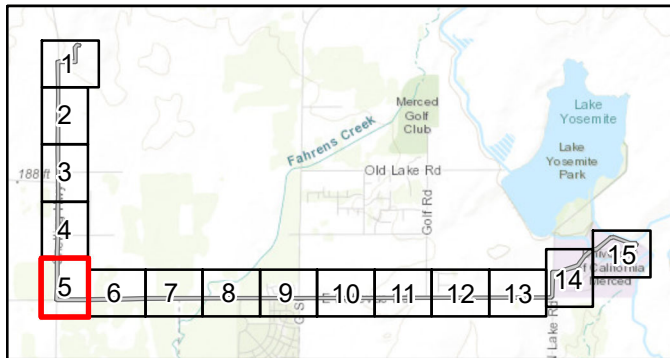



MERCED LANDFILL PIPELINE - BIOLOGICAL COMMUNITIES

FIGURE 1.4-1 SHEET 5

Legend

Biological Communities

-  Irrigation Ditch (0.28 Acres)
-  Ruderal/Developed (91.87 Acres)
-  Study Area ±129 Acres

0 200 400

Feet

1 : 2,400

1 inch = 200 feet



 **FOOTHILL ASSOCIATES**

ENVIRONMENTAL CONSULTING • PLANNING • LANDSCAPE ARCHITECTURE

Drawn By: MUB QA/QC: AMP Date: 5/2/2019

© 2019



Aerial Imagery Date: 3/12/2017 & 6/28/2017
Aerial Imagery Source: Vivid, Digital Globe, ESRI

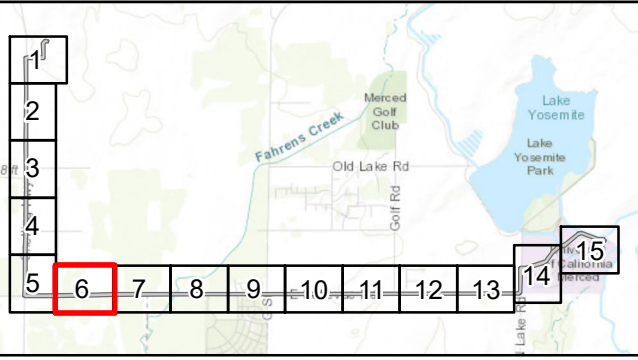

MERCED LANDFILL PIPELINE - BIOLOGICAL COMMUNITIES

—

FIGURE 1.4-1 SHEET 6

Legend

- Biological Communities**
- Agriculture (9.10 Acres)
 - Ruderal/Developed (91.87 Acres)
 - Study Area ±129 Acres

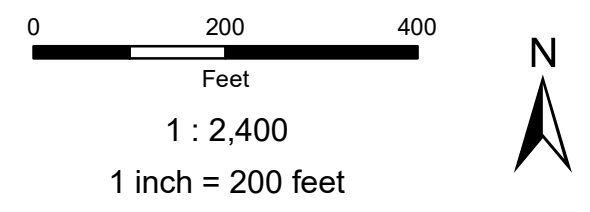

FOOTHILL ASSOCIATES
 ENVIRONMENTAL CONSULTING • PLANNING • LANDSCAPE ARCHITECTURE
 Drawn By: MUB QA/QC: AMP Date: 5/2/2019
 © 2019



Aerial Imagery Date: 3/12/2017 & 6/28/2017
 Aerial Imagery Source: Vivid, Digital Globe, ESRI

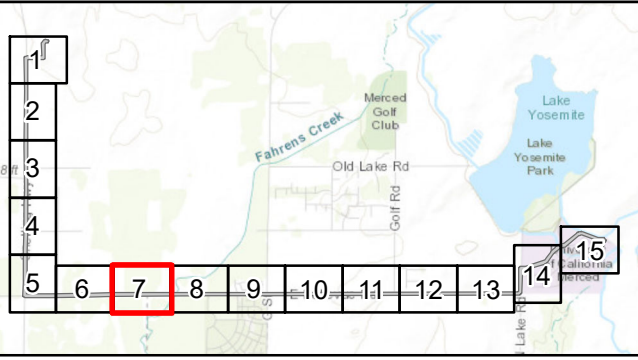

MERCED LANDFILL PIPELINE - BIOLOGICAL COMMUNITIES

—

FIGURE 1.4-1 SHEET 7

Legend

- Biological Communities**
- Agriculture (9.10 Acres)
 - Ruderal/Developed (91.87 Acres)
 - Study Area ±129 Acres
 - Creek
 - Potential Giant Garter Snake Habitat

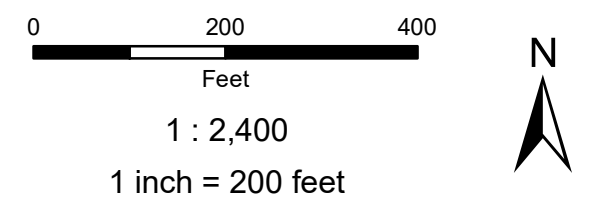

FOOTHILL ASSOCIATES
ENVIRONMENTAL CONSULTING • PLANNING • LANDSCAPE ARCHITECTURE

Drawn By: MUB QA/QC: AMP Date: 5/2/2019
© 2019



Aerial Imagery Date: 3/12/2017 & 6/28/2017
Aerial Imagery Source: Vivid, Digital Globe, ESRI

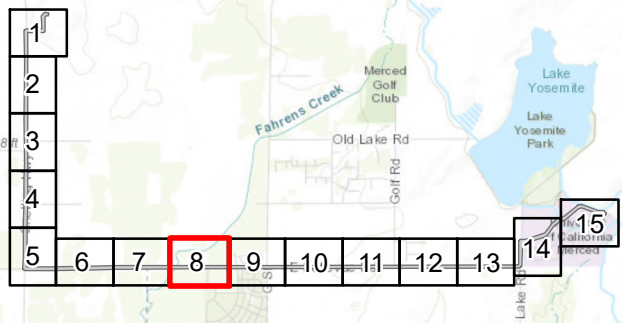

MERCED LANDFILL PIPELINE - BIOLOGICAL COMMUNITIES

—
FIGURE 1.4-1
SHEET 8

Legend

Biological Communities

- Agriculture (9.10 Acres)
- Riparian (0.26 Acres)
- Ruderal/Developed (91.87 Acres)
- Study Area ±129 Acres
- Creek
- Canal
- Potential Giant Garter Snake Habitat

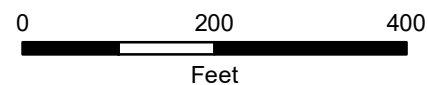

1 : 2,400

1 inch = 200 feet



Drawn By: MUB QA/QC: AMP Date: 5/2/2019

© 2019



Aerial Imagery Date: 3/12/2017 & 6/28/2017
Aerial Imagery Source: Vivid, Digital Globe, ESRI

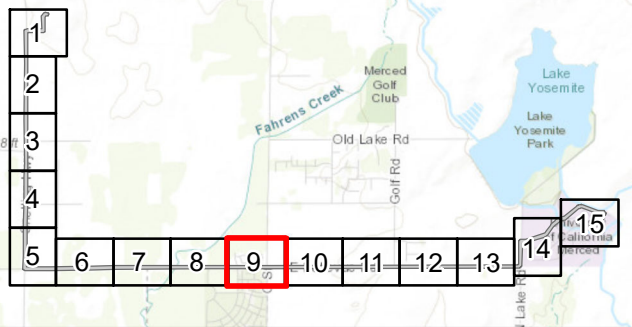

MERCED LANDFILL PIPELINE - BIOLOGICAL COMMUNITIES

—
FIGURE 1.4-1
SHEET 9

Legend

Biological Communities

- Agriculture (9.10 Acres)
- Non-Native Annual Grassland (24.99 Acres)
- Ruderal/Developed (91.87 Acres)
- Study Area ±129 Acres
- Canal
- Canal (Underground)

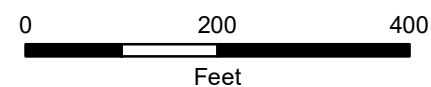

1 : 2,400
1 inch = 200 feet



FOOTHILL ASSOCIATES
ENVIRONMENTAL CONSULTING • PLANNING • LANDSCAPE ARCHITECTURE

Drawn By: MUB QA/QC: AMP Date: 5/2/2019
© 2019



Aerial Imagery Date: 3/12/2017 & 6/28/2017
Aerial Imagery Source: Vivid, Digital Globe, ESRI

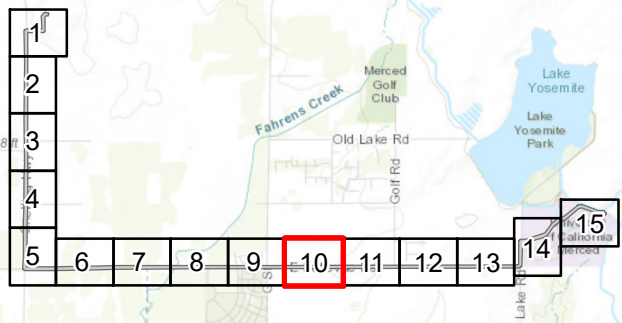

MERCED LANDFILL PIPELINE - BIOLOGICAL COMMUNITIES

—
**FIGURE 1.4-1
SHEET 10**

Legend

Biological Communities

- Agriculture (9.10 Acres)
- Non-Native Annual Grassland (24.99 Acres)
- Ruderal/Developed (91.87 Acres)
- Study Area ±129 Acres
- Canal

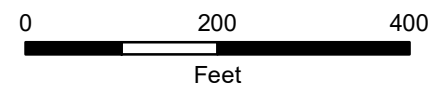

1 : 2,400
1 inch = 200 feet



Drawn By: MUB QA/QC: AMP Date: 5/2/2019
© 2019

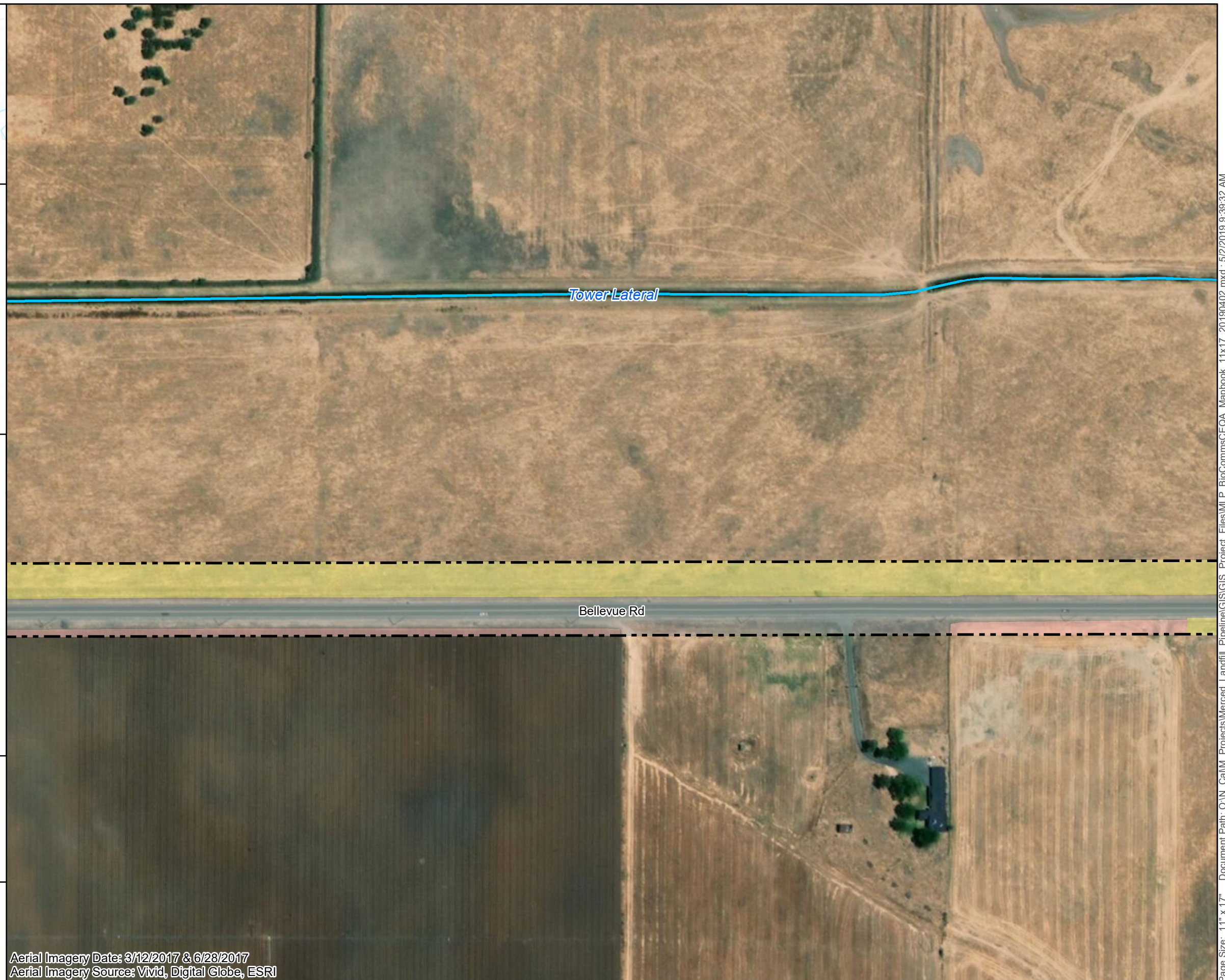

Aerial Imagery Date: 3/12/2017 & 6/28/2017
Aerial Imagery Source: Vivid, Digital Globe, ESRI

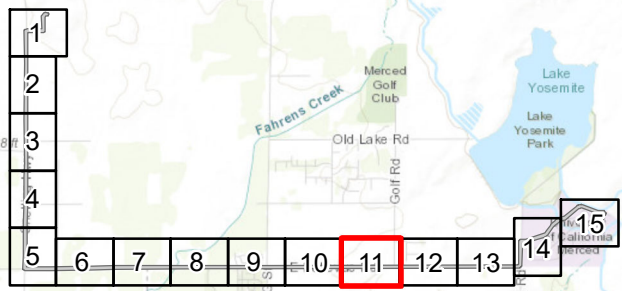

MERCED LANDFILL PIPELINE - BIOLOGICAL COMMUNITIES

—
**FIGURE 1.4-1
SHEET 11**

Legend

Biological Communities

- Agriculture (9.10 Acres)
- Non-Native Annual Grassland (24.99 Acres)
- Ruderal/Developed (91.87 Acres)
- Study Area ±129 Acres
- Canal

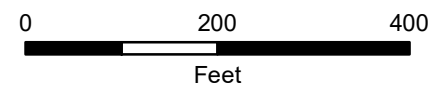

1 : 2,400
1 inch = 200 feet



Drawn By: MUB QA/QC: AMP Date: 5/2/2019
© 2019

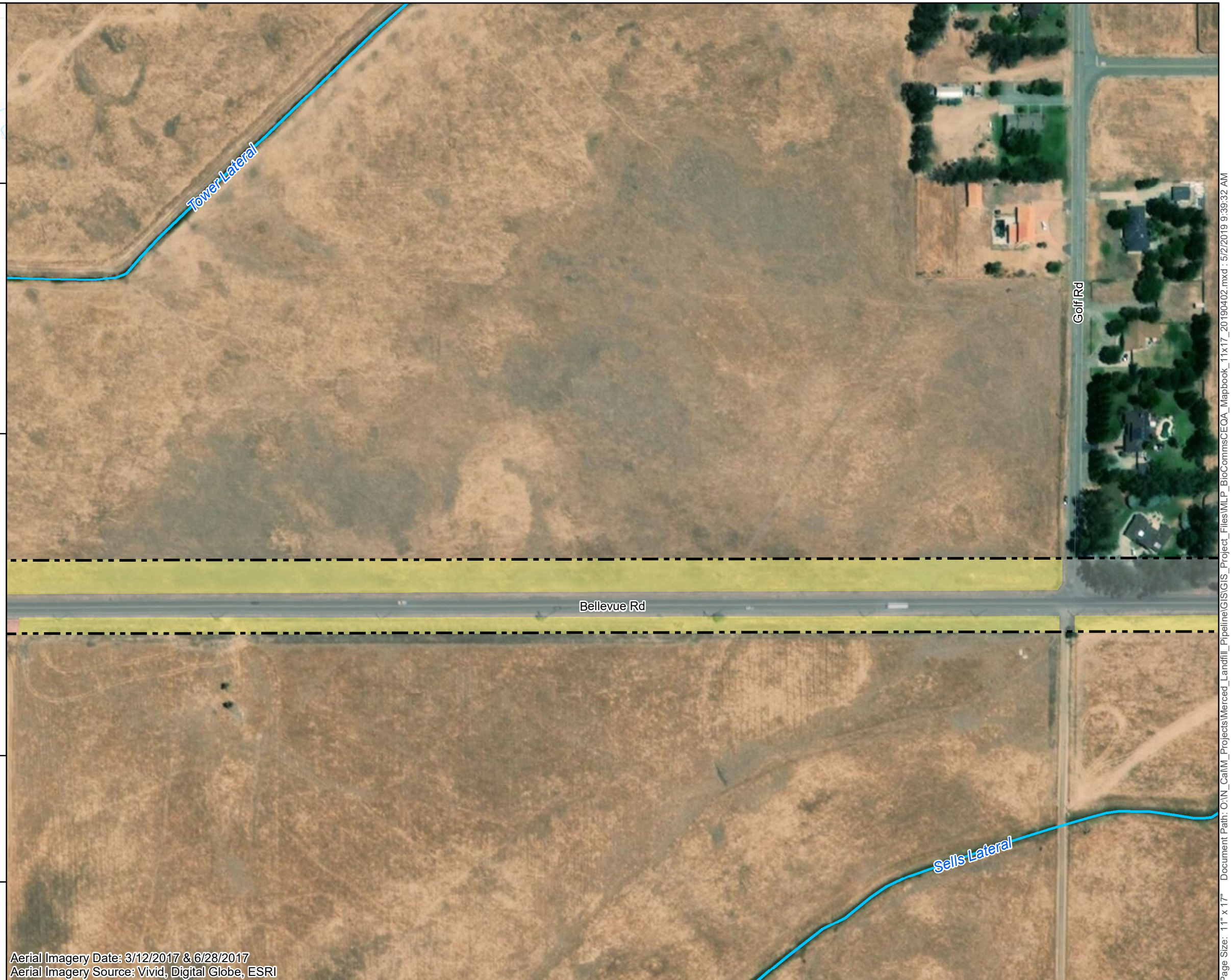

Aerial Imagery Date: 3/12/2017 & 6/28/2017
Aerial Imagery Source: Vivid, Digital Globe, ESRI

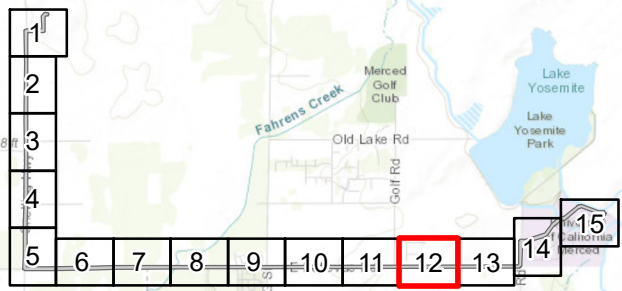

MERCED LANDFILL PIPELINE - BIOLOGICAL COMMUNITIES

—
**FIGURE 1.4-1
SHEET 12**

Legend

Biological Communities

- Riverine Seasonal Wetland (0.15 Acres)
- Non-Native Annual Grassland (24.99 Acres)
- Ruderal/Developed (91.87 Acres)
- Study Area ±129 Acres
- Canal
- Canal (Underground)

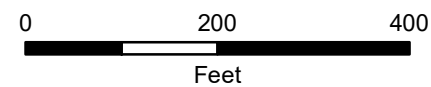

1 : 2,400
1 inch = 200 feet



Drawn By: MUB QA/QC: AMP Date: 5/2/2019
© 2019



Aerial Imagery Date: 3/12/2017 & 6/28/2017
Aerial Imagery Source: Vivid, Digital Globe, ESRI

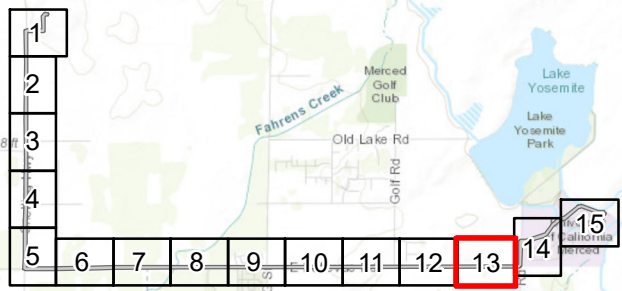

MERCED LANDFILL PIPELINE - BIOLOGICAL COMMUNITIES

—
**FIGURE 1.4-1
SHEET 13**

Legend

- Biological Communities**
- Vernal Pool (1.20 Acres)
 - Riverine Seasonal Wetland (0.15 Acres)
 - Canal (1.02 Acres)
 - Non-Native Annual Grassland (24.99 Acres)
 - Ruderal/Developed (91.87 Acres)
 - Study Area ±129 Acres
 - X Culvert
 - Canal

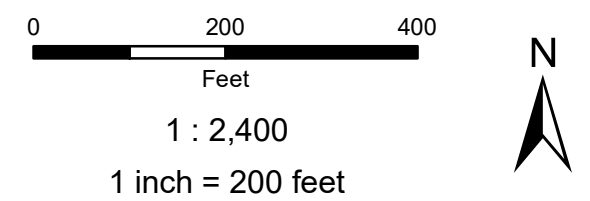

FOOTHILL ASSOCIATES
 ENVIRONMENTAL CONSULTING • PLANNING • LANDSCAPE ARCHITECTURE
 Drawn By: MUB QA/QC: AMP Date: 5/2/2019
 © 2019





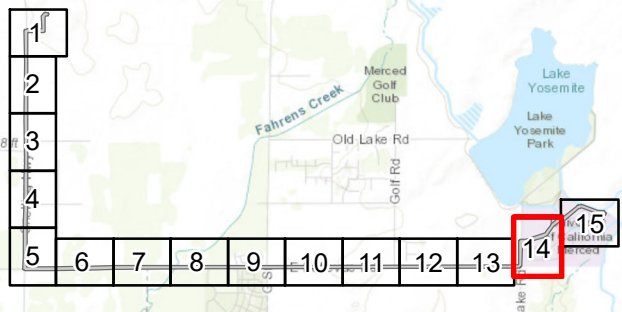

Aerial Imagery Date: 3/12/2017 & 6/28/2017
 Aerial Imagery Source: Vivid, Digital Globe, ESRI

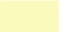
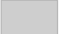

MERCED LANDFILL PIPELINE - BIOLOGICAL COMMUNITIES

FIGURE 1.4-1 SHEET 14

Legend

- Biological Communities**
-  Canal (1.02 Acres)
 -  Non-Native Annual Grassland (24.99 Acres)
 -  Ruderal/Developed (91.87 Acres)
 -  Study Area ±129 Acres
 -  Canal
 -  Potential Giant Garter Snake Habitat

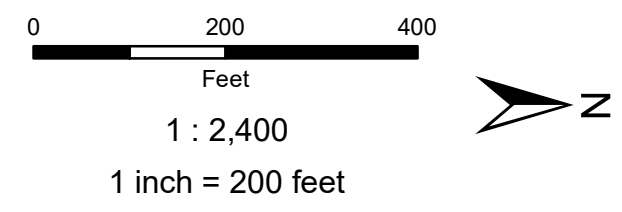

FOOTHILL ASSOCIATES
 ENVIRONMENTAL CONSULTING • PLANNING • LANDSCAPE ARCHITECTURE
 Drawn By: MUB QA/QC: AMP Date: 5/2/2019
 © 2019

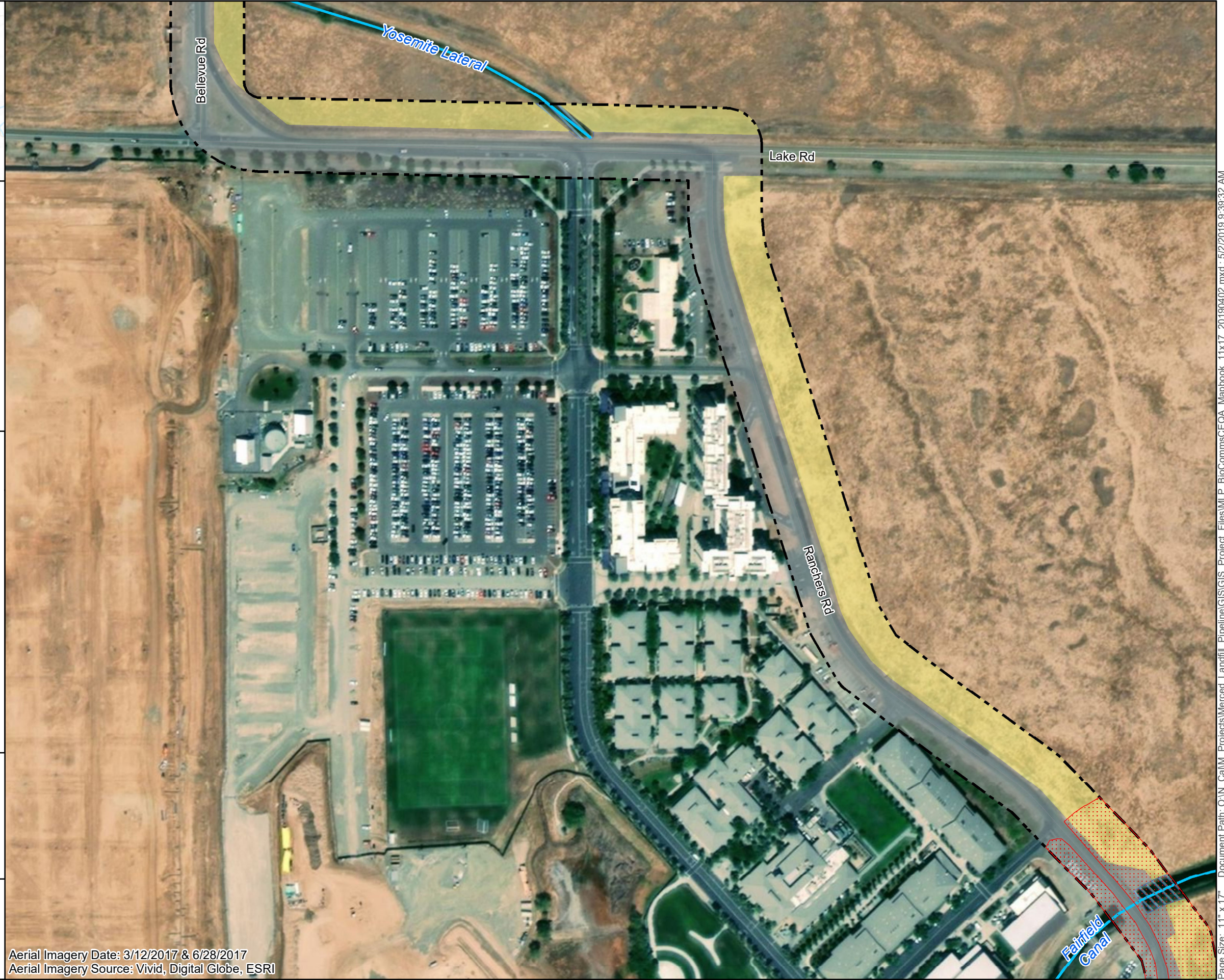

Aerial Imagery Date: 3/12/2017 & 6/28/2017
 Aerial Imagery Source: Vivid, Digital Globe, ESRI

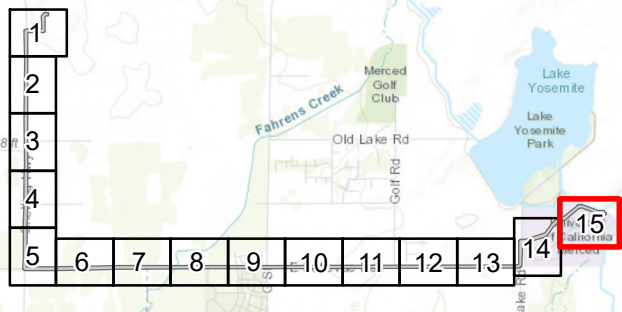

MERCED LANDFILL PIPELINE - BIOLOGICAL COMMUNITIES

FIGURE 1.4-1 SHEET 15

Legend

- Biological Communities**
- Canal (1.02 Acres)
 - Non-Native Annual Grassland (24.99 Acres)
 - Ruderal/Developed (91.87 Acres)
 - Study Area ±129 Acres
 - Canal
 - Potential Giant Garter Snake Habitat

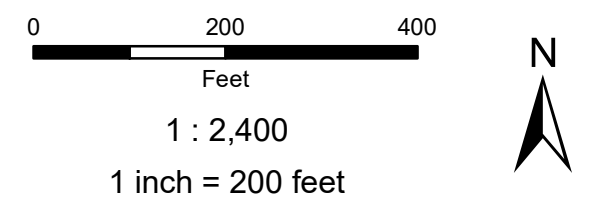

FOOTHILL ASSOCIATES
 ENVIRONMENTAL CONSULTING • PLANNING • LANDSCAPE ARCHITECTURE
 Drawn By: MUB QA/QC: AMP Date: 5/2/2019
 © 2019



Aerial Imagery Date: 3/12/2017 & 6/28/2017
 Aerial Imagery Source: Vivid, Digital Globe, ESRI