

**SAN BERNARDINO COUNTY
INITIAL STUDY/MITIGATED NEGATIVE DECLARATION
ENVIRONMENTAL CHECKLIST FORM**

This form and the descriptive information in the application package constitute the contents of Initial Study pursuant to County Guidelines under Ordinance 3040 and Section 15063 of the State CEQA Guidelines.

PROJECT LABEL:

APNs: 0298-411-97	USGS Quad: Yucaipa
Applicant: Ramzi Dughman 523 E. Payson Street Glendora, CA 91740	Lat/Long: 34°04'10.00"N, -117°07'22.74"W T, R, Section: T 01S R 02W SEC 19
Project No: P201900107	Community Plan: Mentone
Staff: Anthony DeLuca, Senior Planner	LUZD: CG-SCp
Rep: N/A	Overlays: Biotic – Burrowing Owl
Proposal: A Minor Use Permit (MUP) for the development of a gas station/car wash, and convenience store on the southwest corner of Crafton Avenue and Mentone Boulevard (HWY 38) in the community of Mentone, within the City of Redlands Sphere of Influence.	

PROJECT CONTACT INFORMATION:

Lead agency: County of San Bernardino
Land Use Services Department
385 N. Arrowhead Avenue, 1st Floor
San Bernardino, CA 92415-0182

Contact person: Anthony DeLuca, Senior Planner
Phone No: (909) 387-3067 **Fax No:** (909) 387-3223
E-mail: Anthony.DeLuca@lus.sbcounty.gov

PROJECT DESCRIPTION:

Summary

A Minor Use Permit (MUP) for the development of a gas station/car wash, and convenience store on the southwest corner of Crafton Avenue and Mentone Boulevard (Hwy 38) in the community of Mentone, within the City of Redlands Sphere of Influence; the property is assigned the Assessor Parcel Number: 0298-411-97

Surrounding Land Uses and Setting

Land uses on the project site and surrounding parcels are governed by the San Bernardino County General Plan/Development Code. The following table lists the existing land uses and zoning districts. The property is zoned General Commercial-Sign Control primary. The property to the north is zoned the same and consists of a mini storage facility and a convenience store. A retail establishment to the east is also zoned General Commercial-Sign Control primary. To the

west is a vacant lot with the same zoning as the subject property, and to the south is a residential development zoned Multiple Residential.

Existing Land Use and Land Use Zoning Districts		
Location	Existing Land Use	Land Use Zoning District
Project Site	Vacant	CG-SCp
North	Self-Storage and Service Station	CG-SCp
South	Single Family Residential Subdivision	RM
East	Commercial	CG-SCp
West	(2) Single Family Residences	CG-SCp

Project Site Location, Existing Site Land Uses and Conditions

The site is located on the southwest corner of Mentone Boulevard (Hwy 38), and Crafton Avenue, in the community of Mentone. The proposed project consists of a 2,920 square foot convenience store, a 3,100 square foot gas pump canopy and a 4,419 square foot car wash on 1.3 acres. The project is located within the City of Redlands Sphere of Influence and is zoned General Commercial-Sign Control primary (CG-SCp) per the County of San Bernardino Development Code. The project site is generally flat with slopes less than 5% with minimal native vegetation, and no known animal habitats, or historical features. There are no defined watercourses on the site.

Site Photographs



Figure 1 View North from Property



Figure 2 View South into Property



Figure 3 View East from Property



Figure 4 View West from Property

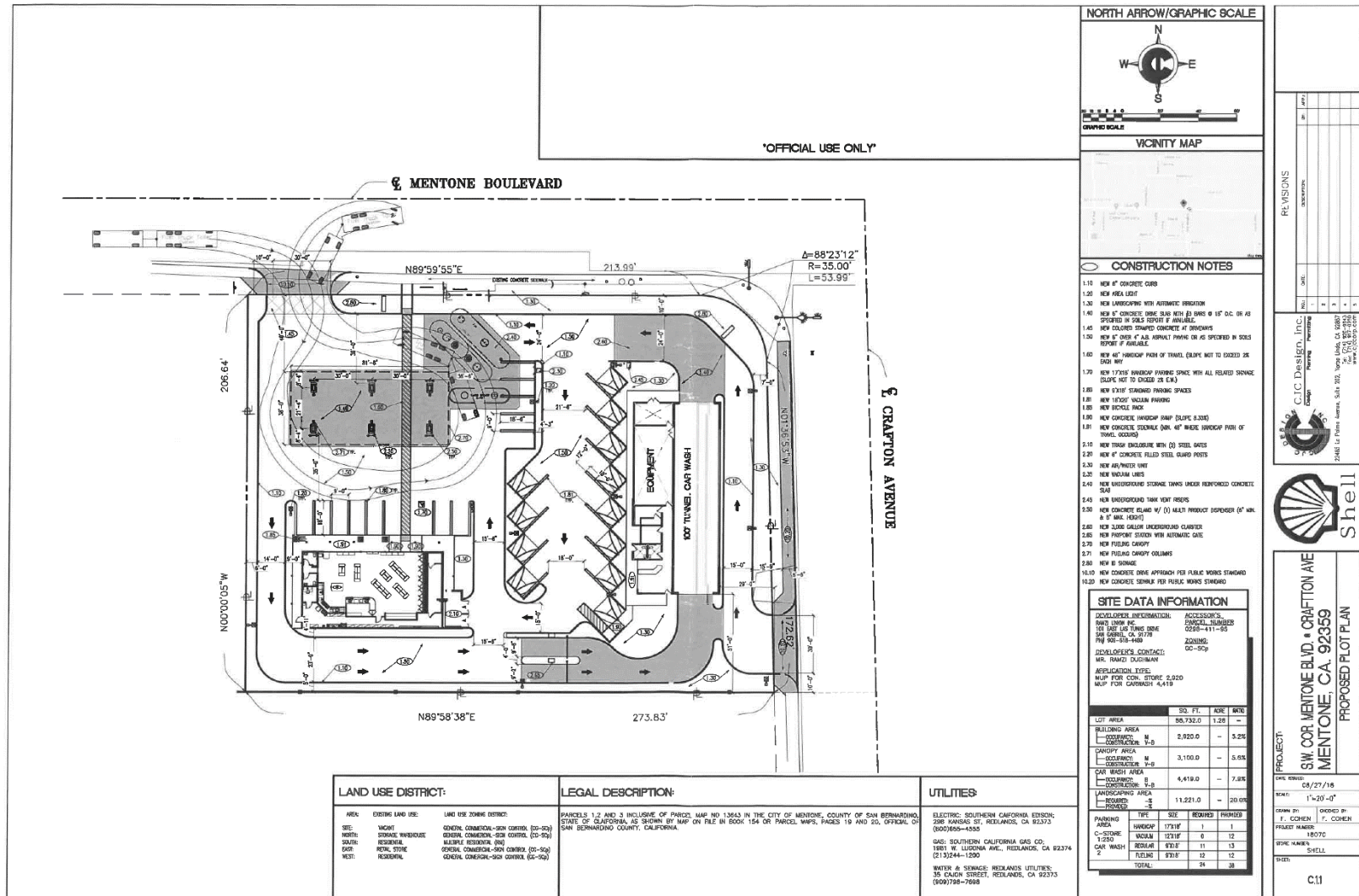

Figure 5 Site Plan

ADDITIONAL APPROVAL REQUIRED BY OTHER PUBLIC AGENCIES

Other public agencies whose approval may be required (e.g., permits, financing approval, or participation agreement.):

Federal: N/A

State of California: CA Fish & Wildlife, SCAQMD

County of San Bernardino: Land Use Services – Building and Safety, Traffic, Land Development Engineering – Roads/Drainage; Public Health – Environmental Health Services; Public Works, Surveyor; and County Fire

Local: City of Redlands

CONSULTATION WITH CALIFORNIA NATIVE AMERICAN TRIBES

Have California Native American tribes traditionally and culturally affiliated with the project area requested consultation pursuant to Public Resources Code section 21080.3.1? If so, has consultation begun? The required notification of affected tribes has occurred. Consultation was not requested at this time, however standard language regarding mitigation of inadvertent discovery of tribal cultural resources including human remains has been provided for future development on the site.

Note: Conducting consultation early in the CEQA process allows tribal governments, lead agencies, and project proponents to discuss the level of environmental review, identify and address potential adverse impacts to tribal cultural resources, and reduce the potential for delay and conflict in the environmental review process. (See Public Resources Code section 21083.3.2.) Information may also be available from the California Native American Heritage Commission’s Sacred Lands File per Public Resources Code section 5097.96 and the California Historical Resources Information System administered by the California Office of Historic Preservation. Please also note that Public Resources Code section 21082.3(c) contains provisions specific to confidentiality.

EVALUATION FORMAT

This Initial Study is prepared in compliance with the California Environmental Quality Act (CEQA) pursuant to Public Resources Code Section 21000, et seq. and the State CEQA Guidelines (California Code of Regulations Section 15000, et seq.). Specifically, the preparation of an Initial Study is guided by Section 15063 of the State CEQA Guidelines. This format of the study is presented as follows. The project is evaluated based on its effect on 20 major categories of environmental factors. Each factor is reviewed by responding to a series of questions regarding the impact of the project on each element of the overall factor. The Initial Study checklist provides a formatted analysis that provides a determination of the effect of the project on the factor and its elements. The effect of the project is categorized into one of the following four categories of possible determinations:

Potentially Significant Impact	Less than Significant With Mitigation Incorporated	Less than Significant	No Impact
--------------------------------	--	-----------------------	-----------

Substantiation is then provided to justify each determination. One of the four following conclusions is then provided as a summary of the analysis for each of the major environmental factors.

1. **No Impact:** No impacts are identified or anticipated and no mitigation measures are required.
2. **Less than Significant Impact:** No significant adverse impacts are identified or anticipated and no mitigation measures are required.
3. **Less than Significant Impact with Mitigation Incorporated:** Possible significant adverse impacts have been identified or anticipated and the following mitigation measures are required as a condition of project approval to reduce these impacts to a level below significant. The required mitigation measures are: (List of mitigation measures)
4. **Potentially Significant Impact:** Significant adverse impacts have been identified or anticipated. An Environmental Impact Report (EIR) is required to evaluate these impacts, which are (List of the impacts requiring analysis within the EIR).

At the end of the analysis the required mitigation measures are restated and categorized as being either self- monitoring or as requiring a Mitigation Monitoring and Reporting Program.

ENVIRONMENTAL FACTORS POTENTIALLY AFFECTED:

The environmental factors checked below will be potentially affected by this project, involving at least one impact that is a "Potentially Significant Impact" as indicated by the checklist on the following pages.

<input type="checkbox"/>	Aesthetics	<input type="checkbox"/>	Agriculture and Forestry Resources	<input type="checkbox"/>	Air Quality
<input type="checkbox"/>	Biological Resources	<input checked="" type="checkbox"/>	Cultural Resources	<input type="checkbox"/>	Energy
<input type="checkbox"/>	Geology/Soils	<input type="checkbox"/>	Greenhouse Gas Emissions	<input checked="" type="checkbox"/>	Hazards & Hazardous Materials
<input type="checkbox"/>	Hydrology/Water Quality	<input type="checkbox"/>	Land Use/Planning	<input type="checkbox"/>	Mineral Resources
<input checked="" type="checkbox"/>	Noise	<input type="checkbox"/>	Population/Housing	<input type="checkbox"/>	Public Services
<input type="checkbox"/>	Recreation	<input checked="" type="checkbox"/>	Transportation	<input checked="" type="checkbox"/>	Tribal Cultural Resources
<input type="checkbox"/>	Utilities/Service Systems	<input type="checkbox"/>	Wildfire	<input checked="" type="checkbox"/>	Mandatory Findings of Significance

DETERMINATION: (To be completed by the Lead Agency)

On the basis of this initial evaluation, the following finding is made:

<input type="checkbox"/>	The proposed project COULD NOT have a significant effect on the environment, and a NEGATIVE DECLARATION shall be prepared.
<input checked="" type="checkbox"/>	Although the proposed project could have a significant effect on the environment, there shall not be a significant effect in this case because revisions in the project have been made by or agreed to by the project proponent. A MITIGATED NEGATIVE DECLARATION shall be prepared.
<input type="checkbox"/>	The proposed project MAY have a significant effect on the environment, and an ENVIRONMENTAL IMPACT REPORT is required.
<input type="checkbox"/>	The proposed project MAY have a "potentially significant impact" or "potentially significant unless mitigated" impact on the environment, but at least one effect 1) has been adequately analyzed in an earlier document pursuant to applicable legal standards, and 2) has been addressed by mitigation measures based on the earlier analysis as described on attached sheets. An ENVIRONMENTAL IMPACT REPORT is required, but it must analyze only the effects that remain to be addressed.
<input type="checkbox"/>	Although the proposed project could have a significant effect on the environment, because all potentially significant effects (a) have been analyzed adequately in an earlier EIR or NEGATIVE DECLARATION pursuant to applicable standards, and (b) have been avoided or mitigated pursuant to that earlier EIR or NEGATIVE DECLARATION, including revisions or mitigation measures that are imposed upon the proposed project, nothing further is required.

 Signature: (prepared by Anthony De Luca, Senior Planner)

7-3-19
 Date

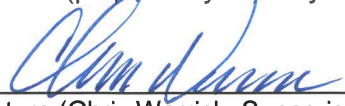
 Signature: (Chris Warrick, Supervising Planner)

7-3-19
 Date

Issues	Potentially Significant Impact	Less than Significant with Mitigation Incorporated	Less than Significant	No Impact
I. AESTHETICS – Except as provided in Public Resources Code Section 21099, would the project:				
a) Have a substantial adverse effect on a scenic vista?	<input type="checkbox"/>	<input type="checkbox"/>	<input checked="" type="checkbox"/>	<input type="checkbox"/>
b) Substantially damage scenic resources, including but not limited to trees, rock outcroppings, and historic buildings within a state scenic highway?	<input type="checkbox"/>	<input type="checkbox"/>	<input type="checkbox"/>	<input checked="" type="checkbox"/>
c) In non-urbanized areas, substantially degrade the existing visual character or quality of public views of the site and its surroundings? (Public views are those that are experienced from a publicly accessible vantage point). If the project is in an urbanized area, would the project conflict with applicable zoning and other regulations governing scenic quality?	<input type="checkbox"/>	<input type="checkbox"/>	<input type="checkbox"/>	<input checked="" type="checkbox"/>
d) Create a new source of substantial light or glare, which will adversely affect day or nighttime views in the area?	<input type="checkbox"/>	<input type="checkbox"/>	<input checked="" type="checkbox"/>	<input type="checkbox"/>

SUBSTANTIATION: (Check if project is located within the view-shed of any Scenic Route listed in the General Plan): **San Bernardino General Plan, 2007; Submitted Project Materials**

- a) **Less than Significant Impact.** The proposed project is located within an area where surrounding lands are developed with commercial as well as residential uses. An existing six (6) foot wall on the south boundary where the project is adjacent to residential use will remain. Given the height of the project, there would be minimal obstruction to the north from the rear of these residences. The project will have a less than significant impact.
- b) **No Impact.** The site is not adjacent to a state scenic highway. There are no protected trees, rock outcroppings, or historic buildings on the project site; therefore, the proposed project would not substantially damage scenic resources, including, but not limited to, trees, rock outcroppings, and historic buildings.
- c) **No Impact.** The proposed project would not substantially degrade the existing visual character of the site and its surroundings. The proposed commercial use is similar in scale and character as the existing commercial uses in the immediate vicinity of the site, and is not in conflict with existing zoning. The conditions of approval will include requirements for the development to comply with all County Development Codes and ordinances. The proposed project would have a less than significant impact on the existing visual character and quality of the site and its surroundings.

- d) **Less than Significant Impact.** All proposed development must comply with SBCC Chapter 83.13 Sign Regulations and SBCC§ 83.07.030 “Glare and Outdoor Lighting – Valley Region”, which includes light trespass onto abutting residential properties, shielding, direction, and type. Adherence will result in a less than significant impact.

Therefore, no significant adverse impacts are identified or anticipated and no mitigation measures are required.

	<i>Issues</i>	<i>Potentially Significant Impact</i>	<i>Less than Significant with Mitigation Incorporated</i>	<i>Less than Significant</i>	<i>No Impact</i>
II.	AGRICULTURE AND FORESTRY RESOURCES - In determining whether impacts to agricultural resources are significant environmental effects, lead agencies may refer to the California Agricultural Land Evaluation and Site Assessment Model (1997) prepared by the California Dept. of Conservation as an optional model to use in assessing impacts on agriculture and farmland. In determining whether impacts to forest resources, including timberland, are significant environmental effects, lead agencies may refer to information compiled by the California Department of Forestry and Fire Protection regarding the state’s inventory of forest land, including the Forest and Range Assessment Project and the Forest Legacy Assessment project; and forest carbon measurement methodology provided in Forest Protocols adopted by the California Air Resources Board. Would the project:				
a)	Convert Prime Farmland, Unique Farmland, or Farmland of Statewide Importance (Farmland) as shown on the maps prepared pursuant to the Farmland Mapping and Monitoring Program of the California Resources Agency, to non-agricultural use?	<input type="checkbox"/>	<input type="checkbox"/>	<input type="checkbox"/>	<input checked="" type="checkbox"/>
b)	Conflict with existing zoning for agricultural use, or a Williamson Act contract?	<input type="checkbox"/>	<input type="checkbox"/>	<input type="checkbox"/>	<input checked="" type="checkbox"/>
c)	Conflict with existing zoning for, or cause rezoning of, forest land (as defined in Public Resources Code section 12220(g)), timberland (as defined by Public Resources Code section 4526), or timberland zoned Timberland Production (as defined by Government Code section 51104(g))?	<input type="checkbox"/>	<input type="checkbox"/>	<input type="checkbox"/>	<input checked="" type="checkbox"/>
d)	Result in the loss of forest land or conversion of forest land to non-forest use?	<input type="checkbox"/>	<input type="checkbox"/>	<input type="checkbox"/>	<input checked="" type="checkbox"/>
e)	Involve other changes in the existing environment which, due to their location or nature, could result in conversion of Farmland, to non-agricultural use or conversion of forest land to non-forest use?	<input type="checkbox"/>	<input type="checkbox"/>	<input type="checkbox"/>	<input checked="" type="checkbox"/>

SUBSTANTIATION: (Check if project is located in the Important Farmlands Overlay):
San Bernardino County General Plan, 2007; California Department of Conservation Farmland Mapping and Monitoring Program; Submitted Project Materials

- a) **No Impact.** The California Department of Conservation, Farmland Mapping and Monitoring Program, is responsible with mapping Prime Farmland, Unique Farmland, Farmland of Statewide Importance, and Farmland of Local Importance (Farmland) across the state. This site is designated as “Urban Built Up Land” land surrounded by the same in the area. As proposed the project would not convert Farmland to non-agricultural use. There will be no impact.
- b) **No Impact.** The proposed project would not conflict with existing zoning for agricultural use, or a Williamson Act contract. The proposed project area is not under a Williamson Act contract. There is no impact and no further analysis is warranted. No impact is expected.
- c) **No Impact.** The proposed project would not conflict with existing zoning for, or cause rezoning of, forest land, timberland, or timberland zoned Timberland Production. The proposed project area has never been designated as forest land or timberland because the site is within the valley region which does not contain forested lands. There will be no impact.
- d) **No Impact.** The proposed project would not result in the loss of forest land or conversion of forest land to non-forest use. The proposed project site is within the valley region of the county and does not contain forested lands. There is no impact and no further analysis is warranted. There will be no impact.
- e) **No Impact.** The proposed project would not involve other changes in the existing environment which, due to their location or nature, could result in conversion of Farmland to non-agricultural use. The proposed project site does not contain forested lands. There is no impact and no further analysis is warranted. There will be no impact.

Therefore, no significant adverse impacts are identified or anticipated and no mitigation measures are required.

<i>Issues</i>	<i>Potentially Significant Impact</i>	<i>Less than Significant with Mitigation Incorporated</i>	<i>Less than Significant</i>	<i>No Impact</i>
III. AIR QUALITY - Where available, the significance criteria established by the applicable air quality management or air pollution control district might be relied upon to make the following determinations. Would the project:				
a) Conflict with or obstruct implementation of the applicable air quality plan?	<input type="checkbox"/>	<input type="checkbox"/>	<input type="checkbox"/>	<input checked="" type="checkbox"/>
b) Result in a cumulatively considerable net increase of any criteria pollutant for which the Project region is non-attainment under an applicable federal or state ambient air quality standard?	<input type="checkbox"/>	<input type="checkbox"/>	<input type="checkbox"/>	<input checked="" type="checkbox"/>

- | | | | | | |
|----|--|--------------------------|--------------------------|-------------------------------------|--------------------------|
| c) | Expose sensitive receptors to substantial pollutant concentrations? | <input type="checkbox"/> | <input type="checkbox"/> | <input checked="" type="checkbox"/> | <input type="checkbox"/> |
| d) | Result in other emissions (such as those leading to odors adversely affecting a substantial number of people?) | <input type="checkbox"/> | <input type="checkbox"/> | <input checked="" type="checkbox"/> | <input type="checkbox"/> |

SUBSTANTIATION: *(Discuss conformity with the South Coast Air Quality Management Plan, if applicable): Air Quality and Greenhouse Gas Impact Analysis, LSA Associates, Inc., April 2019 (Appendix A); California Emissions Estimator Model (CalEEMod; Version 2016.3.2); Southern California Air Quality Management District 2017 (SCAQMD); San Bernardino County General Plan, 2007; Submitted Project Materials*

- a) **No Impact.** A project is consistent with a regional Air Quality Management Plan (AQMP) if it does not exceed the SCAQMD daily threshold or cause a significant impact on air quality, or if the project is already included in the AQMP projection. Emissions with regional effects during project construction, calculated with the CalEEMod; Version 2016.3.2, would not exceed criteria pollutant thresholds established by the South Coast Air Quality Management District (SCAQMD). Compliance with SCAQMD Rules and Regulations during construction would reduce construction-related air quality impacts from fugitive dust emissions and construction equipment emissions. Construction emissions for the proposed project would not exceed the localized significance thresholds (LSTs) at the closest existing residences south of the project site.

Pollutant emissions from project operation, also calculated with CalEEMod, would not exceed the SCAQMD criteria pollutant thresholds. LSTs would not be exceeded by long-term emissions from project operations. Historical air quality data show that existing carbon monoxide (CO) levels for the project area and the general vicinity do not exceed either federal or State ambient air quality standards. The proposed project would not result in substantial increases in CO concentrations at intersections in the project vicinity that would result in the exceedance of federal or State CO concentration standards.

The proposed use is consistent with the County's zoning designation for the project site and its surrounding area, which is consistent with the County's General Plan. The County's General Plan is consistent with the Southern California Association of Governments (SCAG) Regional Comprehensive Plan Guidelines and the SCAQMD Air Quality Management Plan (AQMP). Thus, the proposed project would be consistent with the regional AQMP.

- b) **No Impact.** SCAQMD has established daily emissions thresholds for construction and operation of a proposed project in the Basin. The emissions thresholds were established based on the attainment status of the Basin with regard to air quality standards for specific criteria pollutants. Because the concentration standards were set at a level that protects public health within an adequate margin of safety (SCAQMD 2017), these emissions thresholds are regarded as conservative and would overstate an individual project's contribution to health risks.

CEQA significance thresholds for construction and operational emissions established for the Basin are shown in **Table 1** below.

Emissions Source	Table 1: Pollutant Emissions Threshold (lbs/day)					
	VOC	NO _x	CO	PM ₁₀	PM _{2.5}	SO _x
Construction Activities	75	100	550	150	55	150
Operation Activities	55	55	550	150	55	150
CO: carbon monoxide lbs/day: pounds per day NO _x : nitrogen oxides PM ₁₀ : particulate matter less than 10 microns in size			PM _{2.5} : particulate matter less than 2.5 microns in size SCAQMD: South Coast Air Quality Management District SO _x : sulfur oxides VOC: volatile organic compounds			

Source: SCAQMD. Air Quality Significance Thresholds. Website: <http://www.aqmd.gov/docs/default-source/ceqa/handbook/scaqmd-air-quality-significance-thresholds.pdf> (accessed April 2019).

Projects in the Basin with construction- or operation-related emissions that exceed any of their respective emission thresholds would be considered significant under SCAQMD guidelines. These thresholds, which SCAQMD developed and that apply throughout the Basin, apply as both project and cumulative thresholds. If a project exceeds these standards, it is considered to have a project-specific and cumulative impact.

- c) **Less than Significant Impact.** SCAQMD published its Final Localized Significance Threshold (LST) Methodology in June 2003 and updated it in July 2008 (SCAQMD 2008), recommending that all air quality analyses include an assessment of both construction and operational impacts on the air quality of nearby sensitive receptors. LSTs represent the maximum emissions from a project site that are not expected to result in an exceedance of the NAAQS or the CAAQS for CO, NO₂, PM₁₀ and PM_{2.5}. LSTs are based on the ambient concentrations of that pollutant within the project Source Receptor Area (SRA) and the distance to the nearest sensitive receptor. For this project, the appropriate SRA is the East San Bernardino Valley area (SRA 35).

The LST Methodology uses look-up tables based on site acreage to determine the significance of emissions for CEQA purposes. Based on the SCAQMD recommended methodology and the construction equipment planned, no more than 1 acre would be disturbed on any one day; thus, the 1-acre LSTs have been used for construction emissions. On-site operational emissions would occur from stationary and mobile sources. Because the project operation area would be less than 1-acre, the 1-acre thresholds would apply during project operations.

Sensitive receptors include residences, schools, hospitals, and similar uses that are sensitive to adverse air quality. The closest residences are within 20 feet (6 meters) from the southern boundary of construction. SCAQMD LST Methodology specifies, "Projects with boundaries located closer than 25 meters to the nearest receptor should use the LSTs for receptors located at 25 meters." **Table 2** and **Table 3** below show that the localized significance thresholds for project construction and operational emissions would not be exceeded for the existing residences near the project.

Emissions Source Construction	Table 2: Construction Localized Impact Analysis (lbs/day)			
	NO _x	CO	PM ₁₀	PM _{2.5}
Construction Emissions	10.31	8.14	1.40	0.96
Localized Significance Threshold (LST)	118	750	4	4
Exceeds Threshold?	No	No	No	No

Emissions Source Operation	Table 3: Operational Localized Impact Analysis (lbs/day)			
	NO _x	CO	PM ₁₀	PM _{2.5}
Operation Emissions	1.5	2.3	0.4	0.1
Localized Significance Threshold (LST)	118	750	1	1
Exceeds Threshold?	No	No	No	No

d) **Less than Significant Impact.** Construction: Heavy-duty equipment in the project area during construction would emit odors, primarily from the equipment exhaust. However, the construction activity would cease to occur after construction is completed. No other sources of objectionable odors have been identified for the proposed project, and no mitigation measures are required. SCAQMD Rule 402 regarding nuisances states: "A person shall not discharge from any source whatsoever such quantities of air contaminants or other material which cause injury, detriment, nuisance, or annoyance to any considerable number of persons or to the public, or which endanger the comfort, repose, health or safety of any such persons or the public, or which cause, or have a natural tendency to cause, injury or damage to business or property." The proposed uses are not anticipated to emit any objectionable odors. Therefore, objectionable odors posing a health risk to potential on-site and existing off-site uses would not occur as a result of the proposed project.

Operation: The gas station could release localized odors; however, all the gasoline dispensers would be equipped with vapor recovery systems. In addition, such odors in general would be confined mainly to the project site and would readily dissipate. Therefore, objectionable odors affecting a substantial number of people would not occur as a result of the project. The impacts associated with odors would be less than significant and no mitigation measures are required.

Therefore, no significant adverse impacts are identified or anticipated and no mitigation measures are required.

<i>Issues</i>	<i>Potentially Significant Impact</i>	<i>Less than Significant with Mitigation Incorporated</i>	<i>Less than Significant</i>	<i>No Impact</i>
IV. BIOLOGICAL RESOURCES - Would the project:				
a) Have substantial adverse effects, either directly or through habitat modifications, on any species identified as a candidate, sensitive or special status species in local or regional plans, policies, or regulations, or by the California Department of Fish and Wildlife or U.S. Fish and Wildlife Service?	<input type="checkbox"/>	<input type="checkbox"/>	<input type="checkbox"/>	<input checked="" type="checkbox"/>
b) Have a substantial adverse effect on any riparian habitat or other sensitive natural community identified in local or regional plans, policies, and regulations or by the California Department of Fish and Wildlife or US Fish and Wildlife Service?	<input type="checkbox"/>	<input type="checkbox"/>	<input type="checkbox"/>	<input checked="" type="checkbox"/>
c) Have a substantial adverse effect on state or federally protected wetlands as (including, but not limited to, marsh, vernal pool, coastal, etc.) through direct removal, filling, hydrological interruption, or other means?	<input type="checkbox"/>	<input type="checkbox"/>	<input type="checkbox"/>	<input checked="" type="checkbox"/>
d) Interfere substantially with the movement of any native resident or migratory fish or wildlife species or with established native resident or	<input type="checkbox"/>	<input type="checkbox"/>	<input type="checkbox"/>	<input checked="" type="checkbox"/>

- migratory wildlife corridors, or impede the use of native wildlife nursery sites?
- e) Conflict with any local policies or ordinances protecting biological resources, such as a tree preservation policy or ordinance?
- f) Conflict with the provisions of an adopted Habitat Conservation Plan, Natural Community Conservation Plan, or other approved local, regional or state habitat conservation plan?

SUBSTANTIATION: (Check if project is located in the Biological Resources Overlay or contains habitat for any species listed in the California Natural Diversity Database): **Biological Resources Assessment, LSA Associates, Inc. April 2019; San Bernardino County General Plan, 2007 (Appendix B); Submitted Project Materials; Focused Survey for Desert Tortoise and Mojave Ground Squirrel Habitat Assessment, RCA Associates, Inc. and Phoenix Ecological Consulting on 03/16/2009, updated 2018**

- a) **No Impact.** City and County General Plans and development ordinances may include regulations or policies governing biological resources. For example, policies may include tree preservation, locally designated species survey areas, local species of interest, and significant ecological areas. The project site does not have trees or shrubs that could provide nesting habitat for birds; nor does it contain suitable habitat for burrowing owl. The project will not conflict with local policies or ordinances related to biological resources. The project is not within an adopted Habitat Conservation Plan area. The project will not have substantial adverse effects, either directly or through habitat modifications, on any species identified as a candidate, sensitive or special status species in local or regional plans, policies, or regulations, or by the California Department of Fish and Wildlife or U.S. Fish and Wildlife Service.
- b) **No Impact.** This project will not have a substantial adverse effect on any riparian habitat or other sensitive natural community identified in local or regional plans, policies, regulations or by the California Department of Fish and Game or US Fish and Wildlife Service because no such habitat has been identified or is known to exist on the project site. There are no defined watercourses on the site.
- c) **No Impact.** This project will not have a substantial adverse effect on federally protected wetlands as defined by Section 404 of the Clean Water Act (including, but not limited to, marsh, vernal pool, coastal, etc.) through direct removal, filling, hydrological interruption, or other means, because the project is not within an identified protected wetland. There are no defined watercourses on the site.
- d) **No Impact.** This project will not interfere substantially with the movement of any native resident or migratory fish or wildlife species or with established native resident or migratory wildlife corridors, or impede the use of native wildlife nursery sites, because there are no such corridors or nursery sites within or near the project site. The required building setbacks and maximum lot coverage requirements will allow for sufficient migration through the site.

- e) **No Impact.** The existing vegetation does not include trees or any plant species that are considered rare. This project will not conflict with any local policies or ordinances protecting biological resources, such as a tree preservation policy or ordinance. There will be no impact.
- f) **No Impact.** This project will not conflict with the provisions of an adopted Habitat Conservation Plan, Natural Community Conservation Plan, or other approved local, regional, or state habitat conservation plan, because no such plan has been adopted in the area of the project site. There will be no impact.

Therefore, no significant adverse impacts are identified or anticipated and no mitigation measures are required.

<i>Issues</i>	<i>Potentially Significant Impact</i>	<i>Less than Significant with Mitigation Incorporated</i>	<i>Less than Significant</i>	<i>No Impact</i>
V. CULTURAL RESOURCES - Would the project:				
a) Cause a substantial adverse change in the significance of a historical resource pursuant to §15064.5?	<input type="checkbox"/>	<input type="checkbox"/>	<input type="checkbox"/>	<input checked="" type="checkbox"/>
b) Cause a substantial adverse change in the significance of an archaeological resource pursuant to §15064.5?	<input type="checkbox"/>	<input checked="" type="checkbox"/>	<input type="checkbox"/>	<input type="checkbox"/>
c) Disturb any human remains, including those outside of formal cemeteries?	<input type="checkbox"/>	<input checked="" type="checkbox"/>	<input type="checkbox"/>	<input type="checkbox"/>

SUBSTANTIATION: (Check if the project is located in the Cultural or Paleontological Resources overlays or cite results of cultural resource review):
Cultural Resources Assessment, LSA Associates, April 2019 (Appendix C); San Bernardino County General Plan, 2007; Cultural Historical Resources Information System (CHRIS), South Central Coast Information Center, California State University, Fullerton; Submitted Project Materials

- a) **No Impact.** On April 4, 2019, the cultural resources records search was conducted for the project area by the South Central Coastal Information Center (SCCIC) located at California State University, Fullerton. It included a review of all recorded historic and prehistoric archaeological sites within one mile of the project, as well as a review of known cultural resource survey and excavation reports. In addition, the California State Historic Property Data File (HPD), which includes the National Register of Historic Places (National Register), California Historical Landmarks (CHL), and California Points of Historical Interest (CPHI), was searched.

Data from the SCCIC indicate there have been 23 cultural resource studies previously conducted within one mile of the proposed project, none of which included the project area. Although no resources were documented within the project area, 29 resources have been recorded within one mile, including a historic period Native American camp site/cemetery, foundations and refuse scatters, water conveyance features, groves, road segments, and built environment properties.

- b) **Less than Significant Impact with Mitigation.** On March 29, 2019, LSA Archaeologist Riordan Goodwin completed an intensive pedestrian survey of the project parcel. The property was surveyed in systematic parallel transects spaced by approximately 10 meters (approximately 35 feet). Special attention was paid to areas of exposed soil for surface artifacts and features and rodent burrows for evidence of archaeosols. The purpose of this survey was to identify and document, prior to the beginning of ground-disturbing activities, any cultural resources and thus also to identify any area(s) that might be sensitive for buried cultural resources. Sparse modern refuse was noted on the surface at the edges the project parcel. Soils are silty alluvium. Compliance with mitigation measure **CUL-1b** described below, and monitoring recommendations would reduce impacts to archaeological resources to less than significant.
- c) **Less than Significant Impact with Mitigation.** The project area is located in the vicinity of a 19th century agricultural worker's camp and cemetery constructed by Native Americans. Therefore, sensitivity for undocumented subsurface resources related to Native American Tribal cultural heritage within the project area may be inferred. Compliance with mitigation measure **CUL-2c** described below, and monitoring recommendations would reduce impacts to the inadvertent discovery of human remains to less than significant.

Mitigation/Monitoring Measures:

CUL 1b: In the event that archaeological materials are encountered during construction, all construction work should be halted and a qualified archaeologist consulted to determine the appropriate treatment of the discovery (California Code of Regulations, Title 14, Chapter 3, Section 15064.5(f)). Work on the other portions of the project outside of the buffered area may continue during this assessment period. Additionally, the San Manuel Band of Mission Indians Cultural Resources Department (SMBMI) shall be contacted, as detailed within **TCR-1 and TCR-2**, regarding any pre-contact/contact-era/historic finds and be provided information after the archaeologist makes his/her initial assessment of the nature of the find, so as to provide Tribal input with regards to significance and treatment.

If significant cultural resources, as defined by CEQA (as amended, 2015), are discovered and avoidance cannot be ensured, the archaeologist shall develop a Monitoring and Treatment Plan, the drafts of which shall be provided to SMBMI for review and comment, as detailed within TCR-1. The archaeologist shall monitor the remainder of the project and implement the Plan accordingly.

Monitoring: Monitoring of earthmoving activities by a qualified archaeologist and/or tribal monitor (including initial grubbing and vegetation removal) is recommended to mitigate potential impacts to undocumented archaeological resources.

CUL 2c: In the event human remains are encountered, State Health and Safety Code Section 7050.5 states that no further disturbance shall occur until the County Coroner has made a determination of origin and disposition pursuant to Public Resources Code Section 5097.98. The County Coroner must be notified of the find immediately. If the remains are determined to be Native American, the County Coroner will notify the NAHC, which will determine and notify an MLD. With the permission of the landowner or his/her authorized representative, the MLD may inspect the site of the discovery. The MLD shall

complete the inspection within 48 hours of notification by the NAHC. The MLD will have the opportunity to offer recommendations for the disposition of the remains.

Monitoring: Monitoring of earthmoving activities by a qualified archaeologist and/or tribal monitor (including initial grubbing and vegetation removal) is recommended to mitigate potential impacts to undiscovered human remains.

Therefore, no impacts are identified or anticipated and no mitigation measures are required.

<i>Issues</i>	<i>Potentially Significant Impact</i>	<i>Less than Significant with Mitigation Incorporated</i>	<i>Less than Significant</i>	<i>No Impact</i>
VI. ENERGY – Would the project:				
a) Result in potentially significant environmental impact due to wasteful, inefficient, or unnecessary consumption of energy resources, during project construction or operation?	<input type="checkbox"/>	<input type="checkbox"/>	<input checked="" type="checkbox"/>	<input type="checkbox"/>
b) Conflict with or obstruct a state or local plan for renewable energy or energy efficiency?	<input type="checkbox"/>	<input type="checkbox"/>	<input checked="" type="checkbox"/>	<input type="checkbox"/>

SUBSTANTIATION: San Bernardino County General Plan, 2007; Renewable Energy and Conservation Element of the General Plan 2017; California Energy Commission Title 24

- a) **Less than Significant Impact.** Construction will be limited to the hours of 7:00 a.m. to 7:00 p.m., Monday through Saturday in accordance with the County of San Bernardino Development Code standards. No construction activities are permitted outside of these hours or on Sundays and Federal holidays. The proposed project will be conditioned to comply with GHG operational standards during temporary construction. Adherence would ensure that there would not be a significant environmental impact due to wasteful, inefficient, or unnecessary consumption of energy resources, during project construction or operation.
- b) **Less than Significant Impact.** The County of San Bernardino adopted a Renewable Energy and Conservation Element (RECE) as part of the County’s General Plan August 8, 2017. The proposed project would be required to meet Title 24 Energy Efficiency requirements. Adherence would ensure that the project would not conflict with or obstruct the recently adopted RECE or any other state or local plan for renewable energy or energy efficiency.

Therefore, no impacts are identified or anticipated and no mitigation measures are required.

<i>Issues</i>	<i>Potentially Significant Impact</i>	<i>Less than Significant with Mitigation Incorporated</i>	<i>Less than Significant</i>	<i>No Impact</i>
VII. GEOLOGY AND SOILS - Would the project:				
a) Directly or indirectly cause potential substantial adverse effects, including the risk of loss, injury, or death involving:				
i. Rupture of a known earthquake fault, as delineated on the most recent Alquist-Priolo Earthquake Fault Zoning Map Issued by the State Geologist for the area or based on other substantial evidence of a known fault? Refer to Division of Mines and Geology Special Publication 42.	<input type="checkbox"/>	<input type="checkbox"/>	<input checked="" type="checkbox"/>	<input type="checkbox"/>
ii. Strong seismic ground shaking?	<input type="checkbox"/>	<input type="checkbox"/>	<input checked="" type="checkbox"/>	<input type="checkbox"/>
iii. Seismic-related ground failure, including liquefaction?	<input type="checkbox"/>	<input type="checkbox"/>	<input checked="" type="checkbox"/>	<input type="checkbox"/>
iv. Landslides?	<input type="checkbox"/>	<input type="checkbox"/>	<input type="checkbox"/>	<input checked="" type="checkbox"/>
b) Result in substantial soil erosion or the loss of topsoil?	<input type="checkbox"/>	<input type="checkbox"/>	<input checked="" type="checkbox"/>	<input type="checkbox"/>
c) Be located on a geologic unit or soil that is unstable, or that would become unstable as a result of the project, and potentially result in on or off site landslide, lateral spreading, subsidence, liquefaction or collapse?	<input type="checkbox"/>	<input type="checkbox"/>	<input checked="" type="checkbox"/>	<input type="checkbox"/>
d) Be located on expansive soil, as defined in Table 18-1-B of the Uniform Building Code (1994), creating substantial direct or indirect risks to life or property?	<input type="checkbox"/>	<input type="checkbox"/>	<input checked="" type="checkbox"/>	<input type="checkbox"/>
e) Have soils incapable of adequately supporting the use of septic tanks or alternative wastewater disposal systems where sewers are not available for the disposal of wastewater?	<input type="checkbox"/>	<input type="checkbox"/>	<input checked="" type="checkbox"/>	<input type="checkbox"/>

SUBSTANTIATION: (Check if project is located in the Geologic Hazards Overlay District): **San Bernardino County General Plan, 2007; Submitted Project Materials; California Building Code; Public Resources Code; Environmental Hazards Report, Property I.D. March 15, 2018; Preliminary Soils Investigation, Soil Exploration Company, Inc., November 5, 2018**

- a) i) **Less than Significant Impact.** The project site is not located within an official earthquake fault zone or within a quarter of a mile of a mapped fault however, all of Southern California is subject to major earthquake activity. In terms of proximity to an active fault the impact can be considered less than significant.
- ii) **Less than Significant Impact.** The subject property is within an area that is subject to severe ground shaking as is most of Southern California. Adherence to California Building Code Seismic Design Standards, Chapter 16: *Structural Design* help to assure a less than significant impact.
- iii) **Less than Significant Impact.** The project site is not located in an area of high liquefaction susceptibility however, adherence to California Building Code Seismic Design Standards, Chapter 16: *Structural Design* would further assure a less than significant impact due to liquefaction.
- iv) **No Impact.** The project site is in a generally level area of the Valley and is not in close proximity to hillsides, foothills or mountains that could have the potential to slide during a ground disturbing event such as an earthquake. There would be no impact.
- b) **Less than Significant Impact.** The near surface sandy soils may be subject to water erosion. Positive drainage should be provided around the perimeter of all structures and all foundations toward streets or approved drainage devices to minimize water infiltrating into the underlying natural and engineered fill soils. Erosion control plans and grading plans will be required to be submitted, approved, and implemented for the proposed development. A less than significant impact is expected.
- c) **Less than Significant Impact.** The project is not identified as being located on a geologic unit or soil that has been identified as being unstable or having the potential to result in on- or off- site landslide, lateral spreading, subsidence, liquefaction, or collapse based on the Soils Investigation performed by Soils Exploration Company in November 2018. Impacts would thus be less than significant.
- d) **Less than Significant Impact.** The project site is not located in an area that has been identified by the County Building and Safety Geologist as having the potential for expansive soils. According to the Soils Investigation performed by Soils Exploration Company in November 2018, the expansion index of the existing soils on the project is very low. The impact would be less than significant.
- e) **Less than Significant Impact.** According to the Soils Investigation performed by Soils Exploration Company in November 2018, the project site has soils capable of adequately supporting the use of septic tanks or alternative wastewater disposal systems where sewers are not available for the disposal of wastewater The County Environmental Health Services Department will require a percolation test prior to onsite wastewater treatment system installation. Therefore, no significant adverse impacts expected.

No significant impacts are identified or anticipated and no mitigation measures are required.

<i>Issues</i>	<i>Potentially Significant Impact</i>	<i>Less than Significant with Mitigation Incorporated</i>	<i>Less than Significant</i>	<i>No Impact</i>
VIII. GREENHOUSE GAS EMISSIONS – Would the project:				
a) Generate greenhouse gas emissions, either directly or indirectly, that may have a significant impact on the environment?	<input type="checkbox"/>	<input type="checkbox"/>	<input checked="" type="checkbox"/>	<input type="checkbox"/>
b) Conflict with any applicable plan, policy or regulation of an agency adopted for the purpose of reducing the emissions of greenhouse gases?	<input type="checkbox"/>	<input type="checkbox"/>	<input type="checkbox"/>	<input checked="" type="checkbox"/>

SUBSTANTIATION: Air Quality and Greenhouse Gas Impact Analysis, LSA Associates, Inc., April 2019 (Appendix A); California Emissions Estimator Model (CalEEMod; Version 2016.3.2); Southern California Air Quality Management District 2017 (SCAQMD); San Bernardino County General Plan, 2007; Submitted Project Materials

- a) **Less than Significant Impact.** Construction and operation of the proposed project would generate Greenhouse Gas (GHG) emissions, with the majority of energy consumption (and associated generation of GHG emissions) occurring during the project's operation. Typically, more than 80 percent of the total energy consumption takes place during the use of buildings and less than 20 percent of energy is consumed during construction. The following activities associated with the proposed project could directly or indirectly contribute to the generation of GHG emissions.

Construction Activities: During construction of the project, GHGs would be emitted through the operation of construction equipment and from worker and vendor vehicles, each of which typically uses fossil-based fuels to operate. The combustion of fossil-based fuels creates GHGs (e.g., CO₂, CH₄, and N₂O). Furthermore, CH₄ is emitted during the fueling of heavy equipment.

Gas, Electricity, and Water Use: Natural gas use results in the emission of two GHGs: CH₄ (the major component of natural gas) and CO₂ (from the combustion of natural gas). Electricity use can result in GHG production if the electricity is generated by combusting fossil fuel. California's water conveyance system is energy-intensive. Water-related electricity use is 48 terawatt hours per year and accounts for nearly 20 percent of California's total electricity consumption.

Solid Waste Disposal: Solid waste generated by the project could contribute to GHG emissions in a variety of ways. Landfilling and other methods of disposal use energy for transporting and managing the waste, and they produce additional GHGs to varying degrees. Landfilling, the most common waste management practice, results in the release of CH₄ from the anaerobic decomposition of organic materials. CH₄ is 28 times more potent a GHG than CO₂. However, landfill CH₄ can also be a source of energy. In addition, many materials in landfills do not decompose fully and the carbon that remains is sequestered in the landfill and not released into the atmosphere.

Motor Vehicle Use: Transportation associated with the proposed project would result in GHG emissions from the combustion of fossil fuels in daily automobile and truck trips.

GHG emissions related to temporary construction activities are detailed in **Table 4** below.

Construction Phase	Table 4: GHG Emissions: Total Temporary Construction Emissions			Total Emissions per Phase (MT CO ₂ e/year)
	CO ₂	CH ₄	N ₂ O	
Site Preparation	0.46	0.0001	0	0.47
Grading	1.15	0.0002	0	1.16
Building Construction	61.20	0.0167	0	61.62
Paving	2.85	0.0007	0	2.87
Architectural Coatings	0.69	0.0001	0	0.69
Total Emissions for Entire Construction Process				66.80
Total Construction Emissions Amortized over 30 years				2.23

Operational Activities: Mobile source emissions of GHGs would include project-generated vehicle trips associated with on-site facilities and customers/visitors to the project site. Area source emissions would be associated with activities including landscaping and maintenance of proposed land uses, natural gas for heating, and other sources. Increases in stationary source emissions would also occur at off-site utility providers as a result of demand for electricity, natural gas, and water by the proposed project. As shown in **Table 5**, the project will result in GHG emissions of 2,035 MT CO₂e/yr, which is lower than the County DRP review standard of 3,000 MT CO₂e/yr.

Long-term operational greenhouse Gas Emissions are represented in **Table 5** below.

Source	Table 5: Pollutant Emissions (MT/yr)					
	Bio-CO ₂	NBio-CO ₂	Total CO ₂	CH ₄	N ₂ O	CO ₂ e
Area	0	<0.01	<0.01	0	0	<0.01
Energy	0	48.59	48.59	<0.01	<0.01	48.78
Mobile	0	1,966.90	1,966.90	0.15	0	1,970.62
Waste	3.43	0	3.43	0.20	0	8.49
Water	0.34	5.59	5.93	0.03	<0.01	7.06
Total Project Emissions	3.77	2,021.08	2,024.85	0.38	0	2,034.95
Bio-CO ₂ : biologically generated CO ₂ CH ₄ = methane CO ₂ : carbon dioxide CO ₂ e: carbon dioxide equivalent			MT/yr: metric tons per year N ₂ O: nitrous oxide NBio-CO ₂ : non-biologically generated CO ₂ SCAQMD: South Coast Air Quality Management District			

- b) **No Impact.** A project’s incremental contribution to a cumulative GHG effect is not cumulatively considerable if the project complies with the requirements in a previously adopted plan or mitigation program under specified circumstances. In 2011, the County adopted the GHG Emissions Reduction Plan, and in 2016, the County adopted the GHG DRP. The GHG Emissions Reduction Plan qualifies as a plan for the reduction of GHG emissions pursuant to the State CEQA Guidelines, and the DRP is a guideline for the GHG Emissions Reduction Plan. The DRP identifies local GHG performance standards that need to be applied to the project. The proposed project incorporates all performance standards as design features. **Table 6** below details the project design features that are necessary to ensure consistency with applicable local reduction measures of the GHG Emissions Reduction Plan. With implementation of these project design features, the project would be consistent with the GHG Emissions Reduction Plan. Therefore, through consistency with a qualified Climate Action Plan (CAP), the project would generate GHG emissions that would have a less significant impact.

Table 6 County of San Bernardino GHG Emissions Reduction Plan and Development Review Process Consistency Analysis	
Performance Standard	Consistency Analysis
Energy	
<p>3.a) Meet Title 24 Energy Efficiency requirements implemented July 1, 2014. The Developer shall document that the design of the proposed structures meets the current Title 24 energy-efficiency requirements. County Planning shall coordinate this review with the County Building and Safety. Any combination of the following design features may be used to fulfill this requirement, provided that the total increase in efficiency meets or exceeds the cumulative goal (100%+ of Title 24) for the entire project (Title 24, Part 6 of the California Code of Regulations; Energy Efficiency Standards for Residential and Non Residential Buildings, as amended January 24, 2013; Cool Roof Coatings performance standards as amended January 24, 2013):</p> <ul style="list-style-type: none"> • Incorporate dual-paned or other energy-efficient windows, • Incorporate energy-efficient space heating and cooling equipment, • Incorporate energy-efficient light fixtures, photocells, and motion detectors, • Incorporate energy-efficient appliances, • Incorporate energy-efficient domestic hot water systems, • Incorporate solar panels into the electrical system, • Incorporate cool roofs/light colored roofing, • Incorporate other measures that will increase energy efficiency, • Increase insulation to reduce heat transfer and thermal bridging, 	<p>Consistent. The proposed project would comply with the requirements of the 2016 California Building Energy Efficiency Standards (Title 24, Part 6), which is more stringent than the 2014 Title 24 as specified in the GHG Emissions Reduction Plan. The requirements include measures to incorporate energy-efficient building design features detailed in Subchapter 3 (Nonresidential Mandatory Requirements), Section 120.7 (Mandatory Insulation Requirements) and Section 120.8 (Nonresidential Building Commissioning).</p>

<ul style="list-style-type: none"> Limit air leakage throughout the structure and within the heating and cooling distribution system to minimize energy consumption. 	
<p>3.c) Lighting. Lighting design for building interiors shall support the use of:</p> <ul style="list-style-type: none"> Compact fluorescent light bulbs or equivalently efficient lighting. Natural day lighting through site orientation and the use of reflected light. Skylight/roof window systems. Light colored building materials and finishes shall be used to reflect natural and artificial light with greater efficiency and less glare. A multi-zone programmable dimming system shall be used to control lighting to maximize the energy efficiency of lighting requirements at various times of the day. Provide a minimum of 2.5 percent of the project's electricity needs by on-site solar panels. 	
<p>3.d) Building Design. Building design and construction shall incorporate the following elements:</p> <ul style="list-style-type: none"> Orient building locations to best utilize natural cooling/heating with respect to the sun and prevailing winds/natural convection to take advantage of shade, day lighting and natural cooling opportunities. Utilize natural, low maintenance building materials that do not require finishes and regular maintenance. Roofing materials shall have a solar reflectance index of 78 or greater. All supply duct work shall be sealed and leak-tested. Oval or round ducts shall be used for at least 75 percent of the supply duct work, excluding risers. Energy Star or equivalent appliances shall be installed. A building automation system including outdoor temperature/humidity sensors will control public area heating, vent, and air conditioning units. 	
Water	
<p>3.b) Plumbing. All plumbing shall incorporate the following:</p> <ul style="list-style-type: none"> All showerheads, lavatory faucets, and sink faucets shall comply with the California Energy Conservation flow rate standards. 	<p>Consistent. The proposed project will install water-efficient irrigation systems and devices, low-flow plumbing fixtures, water-efficient car wash fixtures, and drought-tolerant landscaping.</p>

<ul style="list-style-type: none"> • Low flush toilets shall be installed where applicable as specified in California State Health and Safety Code Section 17921.3. • All hot water piping and storage tanks shall be insulated. Energy efficient boilers shall be used. 	
<p>3.f) Irrigation. The developer shall submit irrigation plans that are designed, so that all common area irrigation areas shall be capable of being operated by a computerized irrigation system, which includes either an on-site weather station, ET gauge or ET-based controller capable of reading current weather data and making automatic adjustments to independent run times for each irrigation valve based on changes in temperature, solar radiation, relative humidity, rain and wind. In addition, the computerized irrigation system shall be equipped with flow sensing capabilities, thus automatically shutting down the irrigation system in the event of a mainline break or broken head. These features will assist in conserving water, eliminating the potential of slope failure due to mainline breaks and eliminating over-watering and flooding due to pipe and/or head breaks.</p>	
Solid Waste	
<p>1.a) Waste Stream Reduction. The developer shall provide to all tenants and project employees County-approved informational materials about methods and need to reduce the solid waste stream and listing available recycling services.</p>	<p>Consistent. The proposed project will comply with California Green Building Standards Code requirements. At least 50 percent of all nonhazardous construction waste generated by the proposed project (including, but not limited to, soil, vegetation, concrete, lumber, metal, and cardboard) will be recycled and/or salvaged.</p>
<p>3.g) Recycling. Exterior storage areas for recyclables and green waste shall be provided. Where recycling pickup is available, adequate recycling containers shall be located in public areas. Construction and operation waste shall be collected for reuse and recycling.</p>	
Transportation	
<p>1.b) Vehicle Trip Reduction. The developer shall provide to all tenants and project employees County-approved informational materials about the need to reduce vehicle trips and the program elements this project is implementing. Such elements may include: participation in established ride-sharing programs, creating a new ride-share employee vanpool, designating preferred parking spaces for ride-sharing vehicles, designating adequate passenger loading and unloading for ride-sharing vehicles with benches in waiting areas, and/or providing a web site or message board for coordinating rides.</p>	<p>Consistent. The proposed project will provide commute trip reduction materials to employees. Because the proposed project is a gas station with car wash, customer bicycling, ride-sharing, and transit would not be applicable.</p>
<p>3.h) Transportation Demand Management (TDM) Program. The project shall include</p>	

<p>adequate bicycle parking near building entrances to promote cyclist safety, security, and convenience. Preferred carpool/vanpool spaces shall be provided and, if available, mass transit facilities shall be provided (e.g. bus stop bench/shelter). The developer shall demonstrate that the TDM program has been instituted for the project or that the buildings will join an existing program located within a quarter-mile radius from the project site that provides a cumulative 20% reduction in unmitigated employee commute trips. The TDM Program shall publish ride-sharing information for ride-sharing vehicles and provide a website or message board for coordinating rides. The Program shall ensure that appropriate bus route information is placed in each building.</p>	
<p>Area Source</p>	
<p>1.d) Landscape Equipment. The developer shall require in the landscape maintenance contract and/or in onsite procedures that a minimum of 20% of the landscape maintenance equipment shall be electric-powered.</p>	<p>Consistent. The proposed project will provide drought-tolerant landscaping, and use electric-powered landscape maintenance equipment where possible.</p>
<p>3.e) Landscaping. The developer shall submit for review and obtain approval from County Planning of landscape and irrigation plans that are designed to include drought tolerant and smog tolerant trees, shrubs, and groundcover to ensure the long-term viability and to conserve water and energy. The landscape plans shall include shade trees around main buildings, particularly along southern and western elevations, where practical.</p>	
<p>Education</p>	
<p>1.c) Provide Educational Materials. The developer shall provide to all tenants and staff education materials and other publicity about reducing waste and available recycling services. The education and publicity materials/program shall be submitted to County Planning for review and approval. The developer shall also provide to all tenants and require that the tenants shall display in their stores current transit route information for the project area in a visible and convenient location for employees and customers. The specific transit routes displayed shall include Omni Trans Route 8, San Bernardino-Mentone-Yucaipa.</p>	<p>Consistent. The proposed project will provide waste reduction and recycling materials to employees and customers. Because the proposed project is a gas station with car wash, the transit routes materials are not applicable.</p>

Source: County of San Bernardino Greenhouse Gas Emissions Reduction Plan. Adopted September 2011.
 County of San Bernardino Greenhouse Gas Emissions Development Review Processes. Updated March 2015.
 Compiled by LSA (April 2019).

Therefore, no significant adverse impacts are identified or anticipated and no mitigation measures are required.

<i>Issues</i>	<i>Potentially Significant Impact</i>	<i>Less than Significant with Mitigation Incorporated</i>	<i>Less than Significant</i>	<i>No Impact</i>
IX. HAZARDS AND HAZARDOUS MATERIALS – Would the project:				
a) Create a significant hazard to the public or the environment through the routine transport, use, or disposal of hazardous materials?	<input type="checkbox"/>	<input checked="" type="checkbox"/>	<input type="checkbox"/>	<input type="checkbox"/>
b) Create a significant hazard to the public or the environment through reasonably foreseeable upset and accident conditions involving the release of hazardous materials into the environment?	<input type="checkbox"/>	<input checked="" type="checkbox"/>	<input type="checkbox"/>	<input type="checkbox"/>
c) Emit hazardous emissions or handle hazardous or acutely hazardous materials, substances, or waste within one-quarter mile of an existing or proposed school?	<input type="checkbox"/>	<input checked="" type="checkbox"/>	<input type="checkbox"/>	<input type="checkbox"/>
d) Be located on a site which is included on a list of hazardous materials sites compiled pursuant to Government Code Section 65962.5 and, as a result, would it create a significant hazard to the public or the environment?	<input type="checkbox"/>	<input type="checkbox"/>	<input type="checkbox"/>	<input checked="" type="checkbox"/>
e) For a project located within an airport land use plan or, where such a plan has not been adopted, within two miles of a public airport or public use airport, will the project result in a safety hazard for people residing or working in the project area?	<input type="checkbox"/>	<input type="checkbox"/>	<input checked="" type="checkbox"/>	<input type="checkbox"/>
f) Impair implementation of or physically interfere with an adopted emergency response plan or emergency evacuation plan?	<input type="checkbox"/>	<input type="checkbox"/>	<input type="checkbox"/>	<input checked="" type="checkbox"/>
g) Expose people or structures, either directly or indirectly, to a significant risk of loss, injury or death involving wildland fires?	<input type="checkbox"/>	<input type="checkbox"/>	<input type="checkbox"/>	<input checked="" type="checkbox"/>

SUBSTANTIATION: Environmental Hazards Report, Property I.D. March 15, 2018; Preliminary Soils Investigation, Soil Exploration Company, INC. November 5, 2018; San Bernardino County General Plan, 2007; Submitted Project Materials

- a) **Less than Significant Impact with Mitigation.** Through mitigation, the project would have a less than significant impact to the public or the environment through the routine transport, use, or disposal of hazardous materials. All such uses proposed on-site in the will be subject to permit and inspection by the Hazardous Materials Division of the County Fire Department and in some instances additional land use review.
- b) **Less than Significant Impact with Mitigation.** Through mitigation, the project would have a less than significant impact to the environment through reasonably foreseeable upset and accident conditions involving the release of hazardous materials into the

environment. The use and storage of all hazardous materials is subject to permit and inspection by the Hazardous Materials Division of the County Fire Department.

- c) **Less than Significant Impact with Mitigation.** Through mitigation, emissions and handling of hazardous or acutely hazardous materials, or substances, would have a less than significant impact on any existing or proposed schools that are within a quarter mile from the project site. The nearest schools are, Mentone Elementary, approximately one tenth of a mile northeast of the project site, and Redlands East Valley High School approximately 0.70 miles southwest of the project site.
- d) **No Impact.** The project site is not included on the San Bernardino County list of hazardous materials sites compiled pursuant to Government Code 65962.5 and therefore, will not create a significant hazard to the public or environment.
- e) **Less than Significant Impact.** The project site is located within 2 miles of an FAA approved landing facility; Redlands Municipal Airport. The property may be subject to some of the annoyances or inconveniences associated with proximity to airport operations, such as noise, vibration, or odors. Per the California Code of Regulations Section 5006, the level of noise acceptable to a reasonable person residing in the vicinity of an airport is established as a community noise equivalent level (CNEL) value of 65 dB.
- f) **No Impact.** The project site is not within the vicinity or approach/departure flight path of a private airstrip. Therefore there will be no impact.
- g) **No Impact.** The project will not impair implementation of or physically interfere with an adopted emergency response plan or emergency evacuation plan, because the project has adequate access from two or more directions.

Mitigation Measures

HAZ-1 (a-c). Prior to occupancy, the business operator shall be required to apply for one or more of the following permits, or apply for an exemption from hazardous material permitting requirements: Hazardous Material Permit, Hazardous Waste Permit, Aboveground Storage Tank Permit or an Underground Storage Tank Permit. Application for one or more of these permits shall occur by submitting a hazardous materials business plan using the California Environmental Reporting System (CERS) <http://cers.calepa.ca.gov/>

HAZ-2 (a-c). Underground storage tank (UST) systems storing hazardous substances in the County of San Bernardino shall conform to standards issued by the San Bernardino County Fire Protection District. Written approval shall be obtained from this Department prior to the installation of any new UST system(s) and/or modifications to existing UST systems. Prior to installation, plans for underground storage tank systems shall be reviewed and approved by Office of the Fire Marshal, Hazardous Materials Division. For additional information please contact (909) 386-8401.

HAZ-3 (a-c). Facilities handling greater than 1320 gallons of petroleum products in aboveground storage tanks (shell capacity) shall prepare and implement a Spill Prevention, Control, and Countermeasures (SPCC) Plan in accordance with 40 CFR 112.3 and CHSC 25270.4.5(a).

<i>Issues</i>	<i>Potentially Significant Impact</i>	<i>Less than Significant with Mitigation Incorporated</i>	<i>Less than Significant</i>	<i>No Impact</i>
X. HYDROLOGY AND WATER QUALITY - Would the project:				
a) Violate any water quality standards or waste discharge requirements or otherwise substantially degrade surface or ground water quality?	<input type="checkbox"/>	<input type="checkbox"/>	<input checked="" type="checkbox"/>	<input type="checkbox"/>
b) Substantially decrease groundwater supplies or interfere substantially with groundwater recharge such that the project may impede sustainable groundwater management of the basin?	<input type="checkbox"/>	<input type="checkbox"/>	<input type="checkbox"/>	<input checked="" type="checkbox"/>
c) Substantially alter the existing drainage pattern of the site or area, including through the alteration of the course of a stream or river or through the addition of impervious surfaces, in a manner which would:				
i. result in substantial erosion or siltation on- or off-site;	<input type="checkbox"/>	<input type="checkbox"/>	<input checked="" type="checkbox"/>	<input type="checkbox"/>
ii. substantially increase the rate or amount of surface runoff in a manner which would result in flooding on or offsite;	<input type="checkbox"/>	<input type="checkbox"/>	<input checked="" type="checkbox"/>	<input type="checkbox"/>
iii. create or contribute runoff water which would exceed the capacity of existing or planned stormwater drainage systems or provide substantial additional sources of runoff; or	<input type="checkbox"/>	<input type="checkbox"/>	<input checked="" type="checkbox"/>	<input type="checkbox"/>
iv. impede or redirect flood flows?	<input type="checkbox"/>	<input type="checkbox"/>	<input checked="" type="checkbox"/>	<input type="checkbox"/>
d) In flood hazard, tsunami, or seiche zones, risk release of pollutants due to project inundation?	<input type="checkbox"/>	<input type="checkbox"/>	<input type="checkbox"/>	<input checked="" type="checkbox"/>
e) Conflict with or obstruct implementation of a water quality control plan or sustainable groundwater management plan?	<input type="checkbox"/>	<input type="checkbox"/>	<input type="checkbox"/>	<input checked="" type="checkbox"/>

SUBSTANTIATION: *Preliminary Water Quality Management Plan, Anacal Engineering February 2, 2019; Hydrology and Hydraulic Calculations, Anacal Engineering, April 4, 2019; San Bernardino County General Plan, 2007; Submitted Project Materials*

- a) **Less than Significant Impact.** The project will not violate any water quality standards or waste discharge requirements because the on-site waste water treatment systems must be approved by the County Environmental Health Services based on requirements by the Santa Ana Region Water Quality Control Board.

- b) **No Impact.** The project will not substantially deplete groundwater supplies or interfere substantially with groundwater recharge such that there would be a net deficit in aquifer volume or a lowering of the local groundwater table level, because the project will be served by the City of Redlands, which has indicated that there is currently sufficient capacity in the existing water system to serve the anticipated needs of this project.
- c) **Less than Significant Impact.** The existing drainage flowed to neighboring lots. The proposed design allows drainage to flow away from the neighboring lots and filtration through underground retention basins. Underground chambers will be incorporated into construction to help treat water. Proposed alterations to the existing drainage pattern of the site will benefit current and future developments in the area.
 - i. Based on the Project Specific Water Quality Management Plan (PWQMP), and Hydrology Report both prepared by Anacal Engineering, implementation of the proposed drainage improvements for the site would not result in substantial erosion or siltation on- or off-site.
 - ii. Although impervious surfaces will be added to the site, implementation of the proposed drainage improvements as outlined in the PWQMP and Hydrology Report would reduce impacts due to increased surface runoff and would not result in flooding on or offsite
 - iii. The proposed project would not create or contribute runoff water which would exceed the capacity of existing or planned stormwater drainage systems or provide substantial additional sources of runoff; based on the findings of the PWQMP and Hydrology Report prepared by Anacal Engineering.
 - iv. The proposed design would redirect flows allowing drainage to flow away from the neighboring lots and filtration through underground retention basins. Underground chambers will be incorporated into construction to help treat water. Proposed alterations to the existing drainage pattern of the site will benefit current and future developments in the area. No streams or rivers have been identified onsite. LID/BMPs will provide direction of surface runoff in a manner which would prevent flooding on or off-site.
- d) **No Impact.** The project will not substantially alter any existing drainage pattern of the site or area, including through the alteration of the course of a stream or river, or substantially increase the rate or amount of surface runoff in a manner which would result in flooding on or off-site because the project does not propose any alteration to a drainage pattern, stream or river. There are no defined watercourses on the site.
- e) **No Impact.** The proposed development will not create or contribute runoff water that would exceed the capacity of existing or planned storm water drainage systems because the drainage of the residences will be handled by the natural drainage courses on the property. County Public Works has reviewed the proposed project drainage and has determined that the existing and proposed systems are adequate to handle anticipated flows. There will be adequate capacity in the local and regional drainage systems, so that downstream properties are not negatively impacted by any increases or changes in volume, velocity or direction of storm water flows originating from or altered by the project.

Therefore, no significant adverse impacts are identified or anticipated and no mitigation measures are required.

<i>Issues</i>	<i>Potentially Significant Impact</i>	<i>Less than Significant with Mitigation Incorporated</i>	<i>Less than Significant</i>	<i>No Impact</i>
XI. LAND USE AND PLANNING - Would the project:				
a) Physically divide an established community?	<input type="checkbox"/>	<input type="checkbox"/>	<input type="checkbox"/>	<input checked="" type="checkbox"/>
b) Cause a significant environmental impact due to a conflict with any applicable land use plan, policy, or regulation adopted for the purpose of avoiding or mitigating an environmental effect?	<input type="checkbox"/>	<input type="checkbox"/>	<input type="checkbox"/>	<input checked="" type="checkbox"/>

SUBSTANTIATION: San Bernardino County General Plan, 2007; Submitted Project Materials

- a) **No Impact.** The project will not physically divide an established community, because the project is a logical and orderly extension of the planned land uses and development that are established within the surrounding area. The proposed project will create a commercial development that conforms to the existing General Commercial (CG) land use district, which allows for such development.
- b) **No Impact.** The project will not conflict with any applicable land use plan, policy, or regulation of an agency with jurisdiction over the project adopted for the purpose of avoiding or mitigating an environmental effect because the project is consistent with all applicable land use policies and regulations of the County Development Code, and General Plan. The project complies with all hazard protection, resource preservation, and land-use-modifying Overlay District regulations.

Therefore, no significant adverse impacts are identified or anticipated and no mitigation measures are required.

<i>Issues</i>	<i>Potentially Significant Impact</i>	<i>Less than Significant with Mitigation Incorporated</i>	<i>Less than Significant</i>	<i>No Impact</i>
XII. MINERAL RESOURCES - Would the project:				
a) Result in the loss of availability of a known mineral resource that will be of value to the region and the residents of the state?	<input type="checkbox"/>	<input type="checkbox"/>	<input checked="" type="checkbox"/>	<input type="checkbox"/>
b) Result in the loss of availability of a locally important mineral resource recovery site delineated on a local general plan, specific plan or other land use plan?	<input type="checkbox"/>	<input type="checkbox"/>	<input checked="" type="checkbox"/>	<input type="checkbox"/>

SUBSTANTIATION: (Check if project is located within the Mineral Resource Zone Overlay): San Bernardino County General Plan, 2007; Submitted Project Materials; California Department of Conservation: Mineral Land Classification Maps

- a) **Less than Significant Impact.** The project site lies within the Mineral Resources Zone-2 (MRZ-2) within the San Bernardino County Production-Consumption (P-C) Region. These are areas where adequate information indicates that significant mineral deposits are present, or where it is judged that a high likelihood for their presence exists. Aggregate production takes place within this region. The subject property is within one mile of mining operations (Seven Oaks Dam Impervious-Sand and Gravel Open Pit-Reclaimed), abandoned mining operations, and within a quarter mile of a mine site identified by the U.S. Geological Survey. The proposed project would not interfere with current mining operations.
- b) **Less than Significant Impact.** The proposed project will not result in the loss of availability of a locally important mineral resource recovery site delineated on a local general plan, specific plan or other land use plan. The project site lies within the Mineral Resources Zone (MRZ-2) where adequate information indicates that significant mineral deposits are present, or where it is judged that a high likelihood for their presence exists.

Therefore, no significant adverse impacts are identified or anticipated and no mitigation measures are required.

<i>Issues</i>	<i>Potentially Significant Impact</i>	<i>Less than Significant with Mitigation Incorporated</i>	<i>Less than Significant</i>	<i>No Impact</i>
XIII. NOISE - Would the project result in:				
a) Generation of a substantial temporary or permanent increase in ambient noise levels in the vicinity of the project in excess of standards established in the local general plan or noise ordinance, or applicable standards of other agencies?	<input type="checkbox"/>	<input checked="" type="checkbox"/>	<input type="checkbox"/>	<input type="checkbox"/>
b) Generation of excessive groundborne vibration or groundborne noise levels?	<input type="checkbox"/>	<input type="checkbox"/>	<input checked="" type="checkbox"/>	<input type="checkbox"/>
c) For a project located within the vicinity of a private airstrip or an airport land use plan or, where such a plan has not been adopted, within two miles of a public airport or public use airport, would the Project expose people residing or working in the project area to excessive noise levels?	<input type="checkbox"/>	<input type="checkbox"/>	<input checked="" type="checkbox"/>	<input type="checkbox"/>

SUBSTANTIATION: (Check if the project is located in the Noise Hazard Overlay District or is subject to severe noise levels according to the General Plan Noise Element): **Noise Assessment, GMEP Engineers, October 22, 2018; San Bernardino County General Plan, 2007; Submitted Project Materials**

- a) **Less than Significant Impact with Mitigation.** The subject site consists of a proposed car wash tunnel, a convenience store, and several fuel dispensers. The major noise source would be the blower for the car wash. Residential (noise sensitive) land uses at the south side of the property are approximately 60 feet from the entrance to the car

wash. The blowers would be placed at the end of the tunnel or exit which is approximately another 100 feet to the north. There is an existing 6' CMU wall on the south property line separating the two land districts. Noise at this end of the property would need to be mitigated as directed by the County Development Code. The noise level at the property line would be required to be less than 55 dBA during the hours of 7 am and 10 pm, and 50 dBA between 10 pm and 7 am. The car wash operating hours are proposed to be 7 am to 7pm, and 6 am to 11 pm for the gas station, and convenience store, 7 days a week. Mitigation measures below would ensure that noise generated from operation of the proposed development would be reduced to less than significant and would comply with the County Development Code.

- b) **Less than Significant Impact.** The project will not create exposure of persons to or generation of excessive ground borne vibration or ground borne noise levels. The project is required to comply with the vibration standards of the County Development Code. No vibration exceeding these standards is anticipated to be generated by the proposed uses.
- c) **Less than Significant Impact.** The proposed project is within 2 miles of the Redlands Municipal Airport, but not within the Airport Safety Review Area. Also, there are no private airstrips within the project vicinity. There will be a less than significant impact.

Mitigation Measures

NOI-1 (a). Install “silence package” at the blower to further reduce noise.

NOI-2 (a). Enhance 6' CMU block wall between properties with vegetation to further reduce noise as well as visual character.

<i>Issues</i>	<i>Potentially Significant Impact</i>	<i>Less than Significant with Mitigation Incorporated</i>	<i>Less than Significant</i>	<i>No Impact</i>
XIV. POPULATION AND HOUSING - Would the project:				
a) Induce substantial unplanned population growth in an area, either directly (for example, by proposing new homes and businesses) or indirectly (for example, through extension of roads or other infrastructure)?	<input type="checkbox"/>	<input type="checkbox"/>	<input checked="" type="checkbox"/>	<input type="checkbox"/>
b) Displace substantial numbers of existing people or housing, necessitating the construction of replacement housing elsewhere?	<input type="checkbox"/>	<input type="checkbox"/>	<input type="checkbox"/>	<input checked="" type="checkbox"/>

SUBSTANTIATION: San Bernardino County General Plan, 2007; Submitted Project Materials.

- a) **Less than Significant Impact.** The project will not induce substantial population growth in an area either directly or indirectly. As a proposed commercial development, the project could attract more people to the area in search of the services provided by the project but is in an area that is highly developed and would not be expected to induce population growth or the development of new homes or roads.

- b) **No Impact.** The proposed use will not displace any housing units, necessitating the construction of replacement housing because no housing units are proposed to be demolished as a result of this proposal.

Therefore, no significant adverse impacts are identified or anticipated and no mitigation measures are required.

<i>Issues</i>	<i>Potentially Significant Impact</i>	<i>Less than Significant with Mitigation Incorporated</i>	<i>Less than Significant</i>	<i>No Impact</i>
XV. PUBLIC SERVICES				
a) Would the project result in substantial adverse physical impacts associated with the provision of new or physically altered governmental facilities, need for new or physically altered governmental facilities, the construction of which could cause significant environmental impacts, in order to maintain acceptable service ratios, response times or other performance objectives for any of the public services:				
Fire Protection?	<input type="checkbox"/>	<input type="checkbox"/>	<input checked="" type="checkbox"/>	<input type="checkbox"/>
Police Protection?	<input type="checkbox"/>	<input type="checkbox"/>	<input checked="" type="checkbox"/>	<input type="checkbox"/>
Schools?	<input type="checkbox"/>	<input type="checkbox"/>	<input checked="" type="checkbox"/>	<input type="checkbox"/>
Parks?	<input type="checkbox"/>	<input type="checkbox"/>	<input checked="" type="checkbox"/>	<input type="checkbox"/>
Other Public Facilities?	<input type="checkbox"/>	<input type="checkbox"/>	<input checked="" type="checkbox"/>	<input type="checkbox"/>

SUBSTANTIATION: San Bernardino County General Plan, 2007; Submitted Project Materials

- a) **Less than Significant Impact.** The proposed project will not result substantial adverse physical impacts associated with the provision of new or physically altered governmental facilities, need for new or physically altered governmental facilities, the construction of which could cause significant environmental impacts, in order to maintain acceptable service ratios, response times or other performance objectives for any of the public services, including fire and police protection, schools, parks, or other public facilities. The proposed development will increase property tax revenues to provide a source of funding that is sufficient to offset any increases in the anticipated demands for public services generated by this project. Public services will be provided by the City of Redlands as the project is within the city's sphere and is required to provide an agreement for possible future annexation.

Therefore, no significant adverse impacts are identified or anticipated and no mitigation measures are required.

<i>Issues</i>	<i>Potentially Significant Impact</i>	<i>Less than Significant with Mitigation Incorporated</i>	<i>Less than Significant</i>	<i>No Impact</i>
XVI. RECREATION				
a) Would the project increase the use of existing neighborhood and regional parks or other recreational facilities such that substantial physical deterioration of the facility will occur or be accelerated?	<input type="checkbox"/>	<input type="checkbox"/>	<input checked="" type="checkbox"/>	<input type="checkbox"/>
b) Does the project include recreational facilities or require the construction or expansion of recreational facilities which might have an adverse physical effect on the environment?	<input type="checkbox"/>	<input type="checkbox"/>	<input checked="" type="checkbox"/>	<input type="checkbox"/>

SUBSTANTIATION: San Bernardino County General Plan, 2007; Submitted Project Materials

- a) **Less than Significant Impact.** This project will not increase the use of existing neighborhood and regional parks or other recreational facilities such that substantial physical deterioration of the facility would occur or be accelerated.
- b) **Less than Significant Impact.** This project does not include recreational facilities or require the construction or expansion of recreational facilities that might have an adverse physical effect on the environment, because the type of project proposed will not result in an increased demand for recreational facilities.

Therefore, no significant adverse impacts are identified or anticipated and no mitigation measures are required.

<i>Issues</i>	<i>Potentially Significant Impact</i>	<i>Less than Significant with Mitigation Incorporated</i>	<i>Less than Significant</i>	<i>No Impact</i>
XVII. TRANSPORTATION – Would the project:				
a) Conflict with a program plan, ordinance or policy addressing the circulation system, including transit, roadway, bicycle and pedestrian facilities?	<input type="checkbox"/>	<input checked="" type="checkbox"/>	<input type="checkbox"/>	<input type="checkbox"/>
b) Would the project conflict or be inconsistent with CEQA Guidelines section 15064.3 subdivision (b)?	<input type="checkbox"/>	<input checked="" type="checkbox"/>	<input type="checkbox"/>	<input type="checkbox"/>
c) Substantially increase hazards due to a geometric design feature (e.g., sharp curves or dangerous intersections) or incompatible uses (e.g., farm equipment)?	<input type="checkbox"/>	<input type="checkbox"/>	<input type="checkbox"/>	<input checked="" type="checkbox"/>
d) Result in inadequate emergency access?	<input type="checkbox"/>	<input type="checkbox"/>	<input checked="" type="checkbox"/>	<input type="checkbox"/>

SUBSTANTIATION: Traffic Impact Study, David Evans and Associates, May 7, 2019; San Bernardino County General Plan, 2007; Submitted Project Materials

- a) **Less than Significant Impact with Mitigation.** The future development may cause an increase in traffic. Local roads are currently operating at a level of service at or above the standard established by the County General Plan. The property is located within the Mentone Community Plan as well as the Regional Transportation Facilities Fee Plan for the City of Redlands Sphere of Influence. The developer will be required to contribute to that plan before building permits are issued. Fees collected by the plan will be used for road improvements and maintenance within the plan area.
- b) **Less than Significant Impact with Mitigation.** According to the Traffic Study prepared for the project, the existing plus project conditions at all of the study intersections are anticipated to operate at acceptable level of service (LOS) utilizing the existing and proposed intersection geometrics. County Public Works – Traffic Division has reviewed the traffic generation of the proposed project and anticipates that traffic service will remain at an LOS of “B” at the intersection of Mentone Blvd and Crafton Avenue during AM and PM peak hours, a LOS “C” at the driveway proposed on Mentone Blvd during AM and PM peak hours, and a LOS “B” at the proposed driveway on Crafton Avenue during peak AM and PM hours.
- c) **No Impact.** The project will not substantially increase hazards due to a design feature or incompatible uses because the project site is adjacent to an established road that is accessed at points with good site distance and properly controlled intersections. There are no incompatible uses proposed by the project that will impact surrounding land uses.
- d) **Less than Significant Impact.** The proposed project will provide two points of access to the site. One driveway on Mentone Blvd (Driveway “A”, full access), and one driveway on Crafton Avenue (Driveway “B”, entrance only). The project will not result in inadequate access for emergency purposes.

Mitigation Measures

TRA-1 (a-b): Extend eastbound right turn lane on Mentone Boulevard.

TRA-2 (a-b): Provide a two-way left turn along Crafton Avenue into the project site at Driveway “B” as Identified in the Traffic Impact Study prepared by David Evans and Associates.

TRA-3 (a-b): Stripe the second southbound through lane along Crafton Avenue.

<i>Issues</i>	<i>Potentially Significant Impact</i>	<i>Less than Significant with Mitigation Incorporated</i>	<i>Less than Significant</i>	<i>No Impact</i>
---------------	---------------------------------------	---	------------------------------	------------------

XVIII. TRIBAL CULTURAL RESOURCES

- a) Would the Project cause a substantial adverse change in the significance of a tribal cultural resource, defined in Public Resources Code section 21074 as either a site, feature, place, cultural landscape that is geographically defined in terms of the size and scope of the landscape, sacred place, or object with cultural value to a California Native American tribe, and that is:

- | | | | | | |
|-----|--|--------------------------|-------------------------------------|--------------------------|--------------------------|
| i) | Listed or eligible for listing in the California Register of Historical Resources, or in a local register of historical resources as defined in Public Resources Code section 5020.1(k), or | <input type="checkbox"/> | <input checked="" type="checkbox"/> | <input type="checkbox"/> | <input type="checkbox"/> |
| ii) | A resource determined by the lead agency, in its discretion and supported by substantial evidence, to be significant pursuant to criteria set forth in subdivision (c) of Public Resources Code Section 5024.1. In applying the criteria set forth in subdivision (c) of Public Resource Code Section 5024.1, the lead agency shall consider the significance of the resource to a California Native American tribe? | <input type="checkbox"/> | <input checked="" type="checkbox"/> | <input type="checkbox"/> | <input type="checkbox"/> |

SUBSTANTIATION: *Cultural Resources Assessment, LSA Associates, April 2019; San Bernardino County General Plan, 2007; Cultural Historical Resources Information System (CHRIS), South Central Coast Information Center, California State University, Fullerton; Submitted Project Materials*

Assembly Bill (AB) 52 took effect on July 1, 2015. AB 52 requires a lead agency to make best efforts to avoid, preserve, and protect tribal cultural resources.

Conducting consultation early in the CEQA process allows tribal governments, lead agencies, and project proponents to discuss the level of environmental review, identify and address potential adverse impacts to tribal cultural resources, and reduce the potential for delay and conflict in the environmental review process. (See Public Resources Code section 21083.3.2.) Information may also be available from the California Native American Heritage Commission's Sacred Lands File per Public Resources Code section 5097.96 and the California Historical Resources Information System administered by the California Office of Historic Preservation. Public Resources Code section 21082.3(c) also contains provisions specific to confidentiality.

Prior to the release of the CEQA document for a project, AB 52 requires the lead agency to initiate consultation with a California Native American tribe that is traditionally and culturally affiliated with the geographic area of the proposed project if: (1) the California Native American tribe requested the lead agency, in writing, to be informed by the lead agency through formal notification of proposed project in the geographic area that is traditionally and through formal notification of proposed projects in the geographic area that is traditionally and culturally affiliated with the tribe, and (2) the California Native American tribe responds, in writing, within 30 days of receipt of the formal notification, and requests the consultation.

Tribal consultation request letters were sent to the San Manuel Band of Mission Indians, Morongo Band of Mission Indians, Colorado River Indian Tribes, and Twenty-Nine Palms Band of Mission Indians. The San Manuel, and Gabrieleno tribes requested consultation. The Morongo tribe differed to the San Manuel tribe. No comments were received from the Colorado River Indian Tribe or the Twenty-Nine Palms Band of Mission Indians. Consultation with the San Manuel tribe took place on June 13, 2019. Consultation with the Gabrieleno Tribe is ongoing. Concerns for disturbance of culturally significant finds were minimal as it was discovered that the site contained several feet of fill material that was not native to the site. Language was

provided by the tribal representative, and added as mitigation for the inadvertent discovery of tribal cultural resources.

- a) **Less than Significant Impact with Mitigation.** A records search conducted in coordination with the Cultural Resources Assessment prepared by LSA Associates found that there were no listed or eligible for listing in the California Register of Historical Resources, or in a local register of historical resources as defined in Public Resources Code section 5020.1(k) within the project site. However, two sites related to Native American cultural heritage were recorded within one-mile of the project site which give the project some potential for subsurface features, artifacts, and residues. In their conclusion summary of the Cultural Resource Assessment, LSA recommends monitoring of earthmoving activities by a qualified archaeologist to mitigate potential impacts to undocumented archaeological resources. Adherence to mitigation measures TCR-1 and TCR-2 will reduce any impacts to tribal cultural resources to a less than significant level.
- b) **Less than Significant Impact with Mitigation.** The project proponent shall consider the significance of any possible resource to a California Native American tribe. With required mitigation and/or monitoring requested by tribes with ancestral interest in the project area, the impact will be reduced to a less than significant level.

Tribal comments received include protocol, and procedures in the event human remains or other cultural resources are discovered once the properties are sold and subsequently developed. These comments are incorporated into the projects final conditions of approval.

Mitigation Measures

TCR-1: The San Manuel Band of Mission Indians Cultural Resources Department (SMBMI) shall be contacted, as detailed in CR-1, of any pre-contact/contact-era/historic cultural resources discovered during project implementation, and be provided information regarding the nature of the find, so as to provide Tribal input with regards to significance and treatment. Should the find be deemed significant, as defined by CEQA (as amended, 2015), a cultural resources Monitoring and Treatment Plan shall be created by the archaeologist, in coordination with SMBMI, and all subsequent finds shall be subject to this Plan. This Plan shall allow for a monitor to be present that represents SMBMI for the remainder of the project, should SMBMI elect to place a monitor on-site.

TCR-2: Any and all archaeological/cultural documents created as a part of the project (isolate records, site records, survey reports, testing reports, etc.) shall be supplied to the applicant and Lead Agency for dissemination to SMBMI. The Lead Agency and/or applicant shall, in good faith, consult with SMBMI throughout the life of the project.

<i>Issues</i>	<i>Potentially Significant Impact</i>	<i>Less than Significant with Mitigation Incorporated</i>	<i>Less than Significant</i>	<i>No Impact</i>
XIX. UTILITIES AND SERVICE SYSTEMS - Would the project:				

- a) Require or result in the relocation or construction of new or expanded water, wastewater treatment or storm water drainage, electric power, natural gas, or

<input type="checkbox"/>	<input type="checkbox"/>	<input type="checkbox"/>	<input checked="" type="checkbox"/>
--------------------------	--------------------------	--------------------------	-------------------------------------

- | | | | | | |
|----|--|--------------------------|--------------------------|-------------------------------------|-------------------------------------|
| | telecommunications facilities, the construction or relocation of which could cause significant environmental effects? | | | | |
| b) | Have sufficient water supplies available to serve the Project and reasonably foreseeable future development during normal, dry and multiple dry years? | <input type="checkbox"/> | <input type="checkbox"/> | <input type="checkbox"/> | <input checked="" type="checkbox"/> |
| c) | Result in a determination by the wastewater treatment provider which serves or may serve the Project that it has adequate capacity to serve the Project's projected demand in addition to the provider's existing commitments? | <input type="checkbox"/> | <input type="checkbox"/> | <input type="checkbox"/> | <input checked="" type="checkbox"/> |
| d) | Generate solid waste in excess of state or local standards, or in excess of the capacity of local infrastructure, or otherwise impair the attainment of solid waste reduction goals? | <input type="checkbox"/> | <input type="checkbox"/> | <input type="checkbox"/> | <input checked="" type="checkbox"/> |
| e) | Comply with federal, state, and local management and reduction statutes and regulations related to solid waste? | <input type="checkbox"/> | <input type="checkbox"/> | <input checked="" type="checkbox"/> | <input type="checkbox"/> |

SUBSTANTIATION: County of San Bernardino General Plan 2007; Submitted Project Materials

- a) **No Impact.** The proposed project does not exceed wastewater treatment requirements of the Regional Water Quality Control Board, Santa Ana Region, as determined by County Public Health – Environmental Health Services.
- b-c) **No Impact.** The proposed project will not require or result in the construction of new water or wastewater treatment facilities or expansion of existing facilities. The proposed project will have sufficient water supplies available to serve the project from existing entitlements and resources, as the City of Redlands has given assurance that it has adequate water service capacity and wastewater capacity to serve the projected demand for the project, in addition to the provider's existing commitments.
- d) **No Impact.** The proposed project will have sufficient water supplies available to serve the project from existing entitlements and resources, as the City of Redlands has given assurance that it has adequate water service capacity to serve the projected demand for the project, in addition to the provider's existing commitments.
- e) **Less than Significant Impact.** This project falls within a County Franchise Area. If subscribing for the collection and removal of construction and demolition waste from the project site, all developers, contractors, and subcontractors shall be required to receive services through the grantee holding a franchise agreement in the corresponding County Franchise Area (Burrtec-Empire Disposal). The developer shall provide adequate space and storage bins for both refuse and recycling materials. This requirement is to assist the County in compliance with the recycling requirements of Assembly Bill (AB) 2176. A Construction Waste Management Plan will be prepared in two parts to show adequate handling of waste materials; disposal, reuse, or recycling

as required by the County Department of Public Works Solid Waste Management Department.

Therefore, no significant adverse impacts are identified or anticipated and no mitigation measures are required.

<i>Issues</i>	<i>Potentially Significant Impact</i>	<i>Less than Significant with Mitigation Incorporated</i>	<i>Less than Significant</i>	<i>No Impact</i>
XX. WILDFIRE: If located in or near state responsibility areas or lands classified as very high fire hazard severity zones, would the project:				
a) Substantially impair an adopted emergency response plan or emergency evacuation plan?	<input type="checkbox"/>	<input type="checkbox"/>	<input type="checkbox"/>	<input checked="" type="checkbox"/>
b) Due to slope, prevailing winds, and other factors, exacerbate wildfire risks, and thereby expose project occupants to, pollutant concentrations from wildfire or the uncontrolled spread of a wildfire?	<input type="checkbox"/>	<input type="checkbox"/>	<input type="checkbox"/>	<input checked="" type="checkbox"/>
c) Require the installation or maintenance of associated infrastructure (such as roads, fuel breaks, emergency water resources, power lines or other utilities) that may exacerbate fire risk or that may result in temporary or ongoing impacts to the environment?	<input type="checkbox"/>	<input type="checkbox"/>	<input type="checkbox"/>	<input checked="" type="checkbox"/>
d) Expose people or structures to significant risks, including downslope or downstream flooding or landslides, as a result of runoff, post-fire slope instability, or drainage changes?	<input type="checkbox"/>	<input type="checkbox"/>	<input type="checkbox"/>	<input checked="" type="checkbox"/>

SUBSTANTIATION: County of San Bernardino General Plan 2007; Bear Valley Community Plan; Submitted Project Materials

- a) **No Impact.** The proposed Project would not substantially impair an adopted emergency response plan or emergency evacuation plan, there will be no impact.
- b) **No Impact.** The proposed project is not within a Fire Hazard Severity Zone. According to the Countywide Plan Policy Map HZ-5, the subject parcel is within an urban un-zoned area of the county. Implementation of the proposed Project will not cause a significant impact due to slope, prevailing winds, and other factors, exacerbate wildfire risks, thereby exposing project occupants to, pollutant concentrations from wildfire or the uncontrolled spread of a wildfire.
- c) **No Impact.** The proposed Project will not require the installation or maintenance of associated infrastructure (such as roads, fuel breaks, emergency water resources, power lines or other utilities). The project is not expected to exacerbate fire risk that may result in temporary or ongoing impacts to the environment.

- d) **No Impact.** The proposed Project will not expose people or structures to significant risks, including downslope or downstream flooding or landslides, as a result of runoff, post-fire slope instability, or drainage changes.

<i>Issues</i>	<i>Potentially Significant Impact</i>	<i>Less than Significant with Mitigation Incorporated</i>	<i>Less than Significant</i>	<i>No Impact</i>
XXI. MANDATORY FINDINGS OF SIGNIFICANCE:				

- | | | | | |
|--|--------------------------|--------------------------|-------------------------------------|--------------------------|
| a) Does the project have the potential to substantially degrade the quality of the environment, substantially reduce the habitat of a fish or wildlife species, cause a fish or wildlife population to drop below self-sustaining levels, threaten to eliminate a plant or animal community, substantially reduce the number or restrict the range of a rare or endangered plant or animal or eliminate important examples of the major periods of California history or prehistory? | <input type="checkbox"/> | <input type="checkbox"/> | <input checked="" type="checkbox"/> | <input type="checkbox"/> |
| b) Does the project have impacts that are individually limited, but cumulatively considerable? (“Cumulatively considerable” means that the incremental effects of a project are considerable when viewed in connection with the effects of past projects, the effects of other current projects, and the effects of probable future projects)? | <input type="checkbox"/> | <input type="checkbox"/> | <input checked="" type="checkbox"/> | <input type="checkbox"/> |
| c) Does the project have environmental effects, which would cause substantial adverse effects on human beings, either directly or indirectly? | <input type="checkbox"/> | <input type="checkbox"/> | <input checked="" type="checkbox"/> | <input type="checkbox"/> |

- a) **Less than Significant Impact.** The project site does not have trees or shrubs that could provide nesting habitat for birds; nor does it contain suitable habitat for burrowing owl. The project will not conflict with local policies or ordinances related to biological resources. The project is not within an adopted Habitat Conservation Plan area. The project will not have substantial adverse effects, either directly or through habitat modifications, on any species identified as a candidate, sensitive or special status species in local or regional plans, policies, or regulations, or by the California Department of Fish and Wildlife or U.S. Fish and Wildlife Service.
- b) **Less than Significant Impact.** The project does not have impacts that are individually limited, but cumulatively considerable. The sites of projects in the area to which this project would add cumulative impacts have either existing or planned infrastructure that is sufficient for all planned uses. These sites either are occupied or are capable of absorbing such uses without generating any cumulatively significant impacts.

- c) **Less than Significant Impact.** The project will not have environmental effects that will cause substantial adverse effects on human beings, either directly or indirectly, as there are no such impacts identified by the studies conducted for this project or identified by review of other sources or by other agencies.

All potential impacts have been thoroughly evaluated and have been deemed to be neither individually significant nor cumulatively considerable in terms of any adverse effects upon the region, the local community or its inhabitants. At a minimum, the project will be required to meet the conditions of approval for the project to be implemented. It is anticipated that all such conditions of approval will further insure that no potential for adverse impacts will be introduced by construction activities, initial or future land uses authorized by the project approval.

MITIGATION/MONITORING MEASURES:

CUL 1b: In the event that archaeological materials are encountered during construction, all construction work should be halted and a qualified archaeologist consulted to determine the appropriate treatment of the discovery (California Code of Regulations, Title 14, Chapter 3, Section 15064.5(f)). Work on the other portions of the project outside of the buffered area may continue during this assessment period. Additionally, the San Manuel Band of Mission Indians Cultural Resources Department (SMBMI) shall be contacted, as detailed within **TCR-1 and TCR-2**, regarding any pre-contact/contact-era/historic finds and be provided information after the archaeologist makes his/her initial assessment of the nature of the find, so as to provide Tribal input with regards to significance and treatment.

If significant cultural resources, as defined by CEQA (as amended, 2015), are discovered and avoidance cannot be ensured, the archaeologist shall develop a Monitoring and Treatment Plan, the drafts of which shall be provided to SMBMI for review and comment, as detailed within TCR-1. The archaeologist shall monitor the remainder of the project and implement the Plan accordingly.

Monitoring: Monitoring of earthmoving activities by a qualified archaeologist and/or tribal monitor (including initial grubbing and vegetation removal) is recommended to mitigate potential impacts to undocumented archaeological resources.

CUL 2c: In the event human remains are encountered, State Health and Safety Code Section 7050.5 states that no further disturbance shall occur until the County Coroner has made a determination of origin and disposition pursuant to Public Resources Code Section 5097.98. The County Coroner must be notified of the find immediately. If the remains are determined to be Native American, the County Coroner will notify the NAHC, which will determine and notify an MLD. With the permission of the landowner or his/her authorized representative, the MLD may inspect the site of the discovery. The MLD shall complete the inspection within 48 hours of notification by the NAHC. The MLD will have the opportunity to offer recommendations for the disposition of the remains.

Monitoring: Monitoring of earthmoving activities by a qualified archaeologist and/or tribal monitor (including initial grubbing and vegetation removal) is recommended to mitigate potential impacts to undiscovered human remains.

HAZ-1 (a-c). Prior to occupancy, the business operator shall be required to apply for one or more of the following permits, or apply for an exemption from hazardous material permitting requirements: Hazardous Material Permit, Hazardous Waste Permit, Aboveground Storage Tank Permit or an Underground Storage Tank Permit. Application for one or more

of these permits shall occur by submitting a hazardous materials business plan using the California Environmental Reporting System (CERS) <http://cers.calepa.ca.gov/>

HAZ-2 (a-c). Underground storage tank (UST) systems storing hazardous substances in the County of San Bernardino shall conform to standards issued by the San Bernardino County Fire Protection District. Written approval shall be obtained from this Department prior to the installation of any new UST system(s) and/or modifications to existing UST systems. Prior to installation, plans for underground storage tank systems shall be reviewed and approved by Office of the Fire Marshal, Hazardous Materials Division. For additional information please contact (909) 386-8401.

HAZ-3 (a-c). Facilities handling greater than 1320 gallons of petroleum products in aboveground storage tanks (shell capacity) shall prepare and implement a Spill Prevention, Control, and Countermeasures (SPCC) Plan in accordance with 40 CFR 1 112.3 and CHSC 25270.4.5(a).

NOI-1 (a). Install “silence package” at the blower to further reduce noise.

NOI-2 (a). Enhance 6’ CMU block wall between properties with vegetation to further reduce noise as well as visual character.

TRA-1 (a-b): Extend eastbound right turn lane on Mentone Boulevard.

TRA-2 (a-b): Provide a two-way left turn along Crafton Avenue into the project site at Driveway “B” as Identified in the Traffic Impact Study prepared by David Evans and Associates.

TRA-3 (a-b): Stripe the second southbound through lane along Crafton Avenue.

TCR-1: The San Manuel Band of Mission Indians Cultural Resources Department (SMBMI) shall be contacted, as detailed in CR-1, of any pre-contact/contact-era/historic cultural resources discovered during project implementation, and be provided information regarding the nature of the find, so as to provide Tribal input with regards to significance and treatment. Should the find be deemed significant, as defined by CEQA (as amended, 2015), a cultural resources Monitoring and Treatment Plan shall be created by the archaeologist, in coordination with SMBMI, and all subsequent finds shall be subject to this Plan. This Plan shall allow for a monitor to be present that represents SMBMI for the remainder of the project, should SMBMI elect to place a monitor on-site.

TCR-2: Any and all archaeological/cultural documents created as a part of the project (isolate records, site records, survey reports, testing reports, etc.) shall be supplied to the applicant and Lead Agency for dissemination to SMBMI. The Lead Agency and/or applicant shall, in good faith, consult with SMBMI throughout the life of the project.

GENERAL REFERENCES

California Department of Conservation, California Geological Survey, Mineral Resources and Mineral Hazards

County of San Bernardino 2007 Development Code

County of San Bernardino Geologic Hazards Overlays Map

County of San Bernardino Hazard Overlay Map

County of San Bernardino Identified Hazardous Materials Waste Sites List, April 1998.

County of San Bernardino, Countywide Integrated Waste Management Plan, March 1995.

San Bernardino County General Plan, 2007.

San Bernardino County General Plan, 2007; Environmental Impact Report

County of San Bernardino, Greenhouse Gas Emissions Reduction Plan, January 6, 2012.

County of San Bernardino, *San Bernardino County Storm Water Program, Model Water Quality Management Plan Guidance*.

County of San Bernardino Road Planning and Design Standards.

Federal Emergency Management Agency Flood Insurance Rate Map and Flood Boundary Map.

South Coast Air Quality Management District, CEQA Air Quality Handbook, November 1993.

U.S. Department of Agriculture, Natural Resources Conservation Service. Web Soil Survey. Available at <http://websoilsurvey.nrcs.usda.gov/>

PROJECT-SPECIFIC REFERENCES

Air Quality and Greenhouse Gas Analysis, LSA Associates Inc., April 2019

Biological Resource Assessment, LSA Associates Inc., April 2019

Cultural Resources Assessment, LSA Associates Inc., April 2019

Mandatory Residential Disclosure Report, Environmental Hazards Report, Property I.D., March 15, 2018

Noise Assessment, GMEP Engineers, October 22, 2018

Preliminary Hydrology and Hydraulic Calculations, Anacal Engineering Co., April 2019

Preliminary Water Quality Management Plan, Anacal Engineering Co., February 2, 2019

Soil Investigation and Infiltration Tests Report, Soil Exploration Company, Inc., November 5, 2018

South Central Coast Information Center, California State University, Fullerton

Traffic Impact Study, David Evans and Associates Inc., May 15, 2019