

EROSION CONTROL NOTES:

- 1 INSTALL STABILIZED CONSTRUCTION ENTRANCE PER DETAIL SHEET 4. CONTRACTOR TO DIRECT CONSTRUCTION TRAFFIC THROUGH THE STABILIZED CONSTRUCTION ENTRANCE AT ALL TIMES.
- 2 INSTALL EREX CORB NILET GUARD PER DETAIL SHEET 4 OR EQUIVALENT.
- 3 INSTALL FIBER ROLLS AT TOE OF SLOPE PER DETAIL SHEET 4.
- 4 APPLY HYDROSEED WITH BONDED FIBER MATRIX ON SLOPES FOR EROSION CONTROL PURPOSES.
- 5 INSTALL SILT FENCE AT PROPERTY LINE PER DETAIL SHEET 4.
- 6 INSTALL FIBER ROLLS WITHIN PARKING LOT AND PRIVATE ACCESS WAY AT THE APPROXIMATE MATERIALS SHOWN PER PLAN. CONSTRUCTION MAY REMOVE AND RE-INSTALL AS NECESSARY FOR SITE ACCESS.
- 7 INSTALL FIBER ROLL AT TYPE 'F' CATCH BASIN OPENING.
- 8 INSTALL FIBER ROLLS IN BLADED SWALE PER EROSION CONTROL NOTES ON SHEET 3.
- 9 INSTALL FIBER ROLL CIRCLE AROUND PROPOSED CATCH BASIN PER DETAIL SHEET 4.
- 10 INSTALL FIBER ROLL CIRCLE AROUND EXISTING CATCH BASIN.

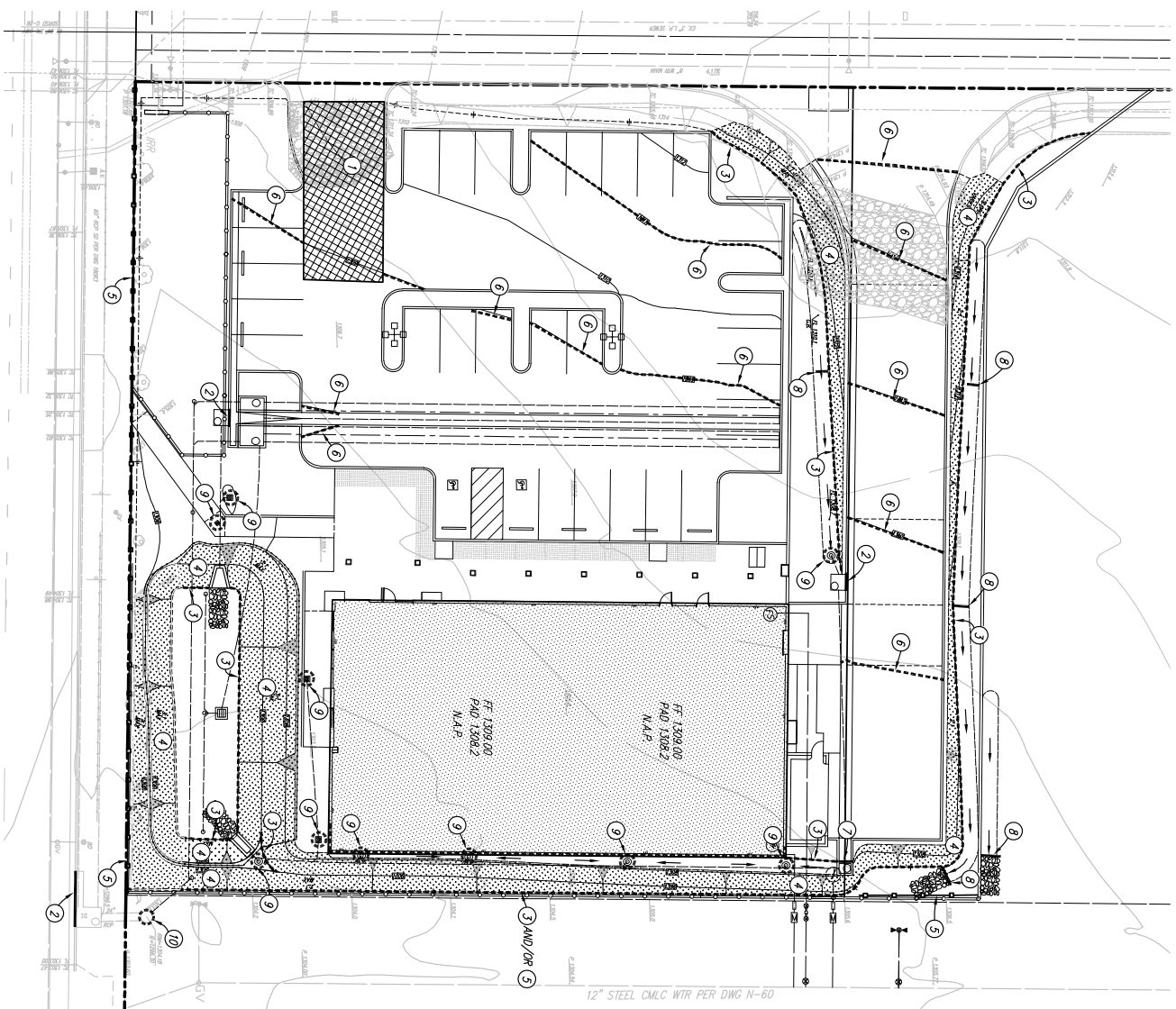

SEE SHEET 3 FOR EASEMENT IDENTIFICATION NOTES

SEE SHEETS 7 & 8 FOR GRADING PLANS

ALL EXISTING IMPROVEMENTS, LANDSCAPING & UTILITIES SHALL BE MAINTAINED AND PROPERLY DISPOSED OF OFF-SITE UNLESS NOTED OTHERWISE. SEE LANDSCAPING AND IRRIGATION PLANS FOR ADDITIONAL INFORMATION.

CONTRACTOR SHALL ADJUST ALL EXISTING AND PROPOSED UTILITY LINES TO FINISHED GRADE EXCEPT WITHIN THE PROPOSED BOTTLENECK BASINS OR UNLESS SHOWN OTHERWISE.

CAUTION 1 THE LOCATION OF THE EXISTING UTILITIES ON THESE PLANS ARE APPROXIMATE AND SHALL BE VERIFIED BY THE CONTRACTOR PRIOR TO CONSTRUCTION.

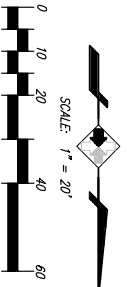

SCALE: 1" = 20'

RECORD PLAN

BY: _____ NAME _____ DATE: _____

R.C.E. _____

EXPIRES: _____

NO.	DESCRIPTION:	APPROVED BY:	DATE:

Alidade ENGINEERING

41743 ENTERPRISE CIRCLE NORTH, SUITE 209
 TEMECULA, CA 92590
 PH: (951) 587-2020
 FAX: (951) 587-2626

BENCH MARK

DESCRIPTION: COUNTY MONUMENT ES-151, 1.27' IRON PIN
 LOCATION: 24' SOUTH OF MOORS VALLEY ROAD, 1.27 MILES EAST ALONG MOORS VALLEY ROAD FROM THE INTERSECTION OF MOORS VALLEY ROAD AND VALLEY CENTER ROAD
 RECORD FROM: COUNTY OF SAN DIEGO
 ELEVATION: 1392.342 M.S.L.

PRIVATE CONTRACT	
SHEET 9	COUNTY OF SAN DIEGO DEPARTMENT OF PUBLIC WORKS
EROSION CONTROL PLANS FOR:	
AUTOZONE STORE 6173	
CALIFORNIA COORDINATE INDEX 378-1755	ENGINEER OF WORK DATE: _____
APPROVED FOR WILLIAM P. JORGENSEN, COUNTY ENGINEER	DATE: _____
DATE: _____	DATE: _____
PS25017-LOGRMA-30144	BRENT C. JORDAN, R.C.E. 59121
GRADING PERMIT NO.	GRADING PERMIT NO.



LEGEND:

DESCRIPTION	SYMBOL
STABILIZED CONSTRUCTION ENTRANCE (TC-1)	[Cross-hatched box]
SILT FENCE (SC-1)	[Line with cross-ticks]
FIBER ROLLS (SC-5)	[Dashed line]
ENERGY DISSIPATER OUTLET PROTECTION (EC-10)	[Stippled area]
CONCRETE WASTE MANAGEMENT* (WM-6 & WM-8)	[Box with diagonal lines]
SANITARY WASTE MANAGEMENT* (WM-9)	[Box with horizontal lines]
CONCRETE WASHOUT FACILITIES* (WM-8)	[Box with vertical lines]
WASTE MANAGEMENT FACILITIES* (WM 5 & 10)	[Box with diagonal lines]
MATERIAL DELIVERY AND STORAGE* (WM-1)	[Box with diagonal lines]
STREET SWEEPING AND VACUUMING* (SE-7)	[Box with diagonal lines]
STOCKPILE MANAGEMENT* (MM-3)	[Box with diagonal lines]
VEHICLE STORAGE AND SERVICE AREA* (NS 8, 9 & 10)	[Box with diagonal lines]
EQUIPMENT STORAGE AND SERVICE AREA* (NS 8, 9 & 10)	[Box with diagonal lines]
SPILL PREVENTION AND CONTROL* (MM-4)	[Box with diagonal lines]
WATER CONSERVATION PRACTICES* (NS-1)	[Box with diagonal lines]

* CONTRACTOR TO DETERMINE LOCATION(S) IN FIELD. LOCATIONS MAY CHANGE THROUGHOUT THE DURATION OF CONSTRUCTION.

FLAT AREAS OF LESS THAN 5% (LIKE BUILDING PADS, PARKING AREAS, LEACH FIELDS) SHALL HAVE TOOK PROTECTION USING GEOTEXTILES MATS (EC-7), OR OTHER MATERIALS APPROVED BY THE TOWN FOR STABILIZING SLOPES, OR USING TRACKING AND SOIL STABILIZERS/BONDERS (EC-5), TEMPORARY SEEDING (EC-4), MULCH/MOOD CHIPS (EC-3, EC-6, EC-8), OR LIME MATTING (EC-2). AREAS OF GRADED PADS THAT HAVE ACTIVE STRUCTURE CONSTRUCTION UNDERWAY MAY BE PROTECTED BY ROLLED PLASTIC AS PART OF A WEATHER-PROTECTED ACTION PLAN UNTIL THE STRUCTURE'S ROOF HAS BEEN COMPLETED. THE REMAINDER OF THE PAD AREA MUST CONTINUE TO BE PROTECTED USING EROSION CONTROL MEASURES DETERMINED ABOVE.

APPLY BONDED FIBER MATRIX TO ALL SLOPES OVER 3' HEIGHT PER SAN DIEGO COUNTY STANDARDS. SEE BONDED FIBER MATRIX NOTES ON SHEET 3.