

199752A-R1 Colton Soccer Park

Colton, CA

Lighting System

Pole / Fixture Summary						
Pole ID	Pole Height	Mtg Height	Fixture Qty	Luminaire Type	Load	Circuit
S1-S4	60'	60'	2	TLC-LED-1200	2.34 kW	A
S5-S8	70'	70'	5	TLC-LED-1500	7.15 kW	B
S9-S10	70'	70'	4	TLC-LED-1500	5.72 kW	C
S11	80'	80'	5	TLC-LED-1500	7.15 kW	C
		80'	5	TLC-LED-1500	7.15 kW	D
		80'	1	TLC-LED-900	0.89 kW	C
		80'	1	TLC-LED-900	0.89 kW	D
S12	80'	80'	5	TLC-LED-1500	7.15 kW	D
		80'	5	TLC-LED-1500	7.15 kW	C
		80'	1	TLC-LED-900	0.89 kW	D
		80'	1	TLC-LED-900	0.89 kW	C
S13-S14	70'	70'	4	TLC-LED-1500	5.72 kW	D
S15-S18	60'	60'	2	TLC-LED-1200	2.34 kW	E
18			76		102.36 kW	

Circuit Summary			
Circuit	Description	Load	Fixture Qty
A	1ASoccer	9.36 kW	8
B	2ASoccer	28.6 kW	20
C	3ASoccer	27.52 kW	20
D	4ASoccer	27.52 kW	20
E	5ASoccer	9.36 kW	8

Fixture Type Summary							
Type	Source	Wattage	Lumens	L90	L80	L70	Quantity
TLC-LED-900	LED 5700K - 75 CRI	890W	89,600	>81,000	>81,000	>81,000	4
TLC-LED-1500	LED 5700K - 75 CRI	1430W	160,000	>81,000	>81,000	>81,000	56
TLC-LED-1200	LED 5700K - 75 CRI	1170W	136,000	>81,000	>81,000	>81,000	16

Light Level Summary

Calculation Grid Summary								
Grid Name	Calculation Metric	Illumination					Circuits	Fixture Qty
		Ave	Min	Max	Max/Min	Ave/Min		
1ASoccer	Horizontal Illuminance	36.6	31	43	1.40	1.18	A	8
2ASoccer	Horizontal Illuminance	34.2	23	42	1.82	1.49	B	20
3ASoccer	Horizontal Illuminance	31.9	23	43	1.87	1.39	C	20
4ASoccer	Horizontal Illuminance	31.5	22	42	1.95	1.43	D	20
5ASoccer	Horizontal Illuminance	35.1	30	41	1.39	1.17	E	8
Far side E. Congress St. Spill	Horizontal	0	0	0.02	15620.67		A,B	28
Far side E. Congress St. Spill	Max Vertical Illuminance Metric	0.01	0	0.04	5546.19		A,B	28
Property Spill Line	Horizontal	0.08	0	1.01	0.00		A,B,C,D,E	76
Property Spill Line	Max Vertical Illuminance Metric	0.15	0	1.55	0.00		A,B,C,D,E	76

From Hometown to Professional

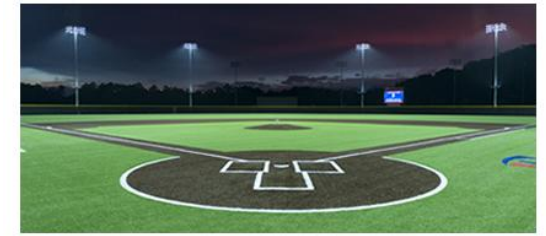

We Make It Happen.

Not to be reproduced in whole or part without the written consent of Musco Sports Lighting, LLC. ©1981, 2019 Musco Sports Lighting, LLC.

EQUIPMENT LIST FOR AREAS SHOWN								
Pole			Luminaires					
QTY	LOCATION	SIZE	GRADE ELEVATION	MOUNTING HEIGHT	LUMINAIRE TYPE	QTY / POLE	THIS GRID	OTHER GRIDS
4	S1-S4	60'	-	60'	TLC-LED-1200	2	2	0
4	TOTALS							
						8	8	0

199752A-R1 Colton Soccer Park
Colton, CA

GRID SUMMARY	
Name:	1ASoccer
Size:	195' x 120'
Spacing:	30.0' x 30.0'
Height:	3.0' above grade

ILLUMINATION SUMMARY			
MAINTAINED HORIZONTAL FOOTCANDLES			
Entire Grid			
Guaranteed Average:	30		
Scan Average:	36.56		
Maximum:	43		
Minimum:	31		
Avg / Min:	1.19		
Guaranteed Max / Min:	2		
Max / Min:	1.40		
UG (adjacent pts):	1.38		
CU:	0.74		
No. of Points:	24		
LUMINAIRE INFORMATION			
Color / CRI:	5700K - 75 CRI		
Luminaire Output:	136,000 lumens		
No. of Luminaires:	8		
Total Load:	9.36 kW		
Lumen Maintenance			
Luminaire Type	L90 hrs	L80 hrs	L70 hrs
TLC-LED-1200	>81,000	>81,000	>81,000
Reported per TM-21-11. See luminaire datasheet for details.			

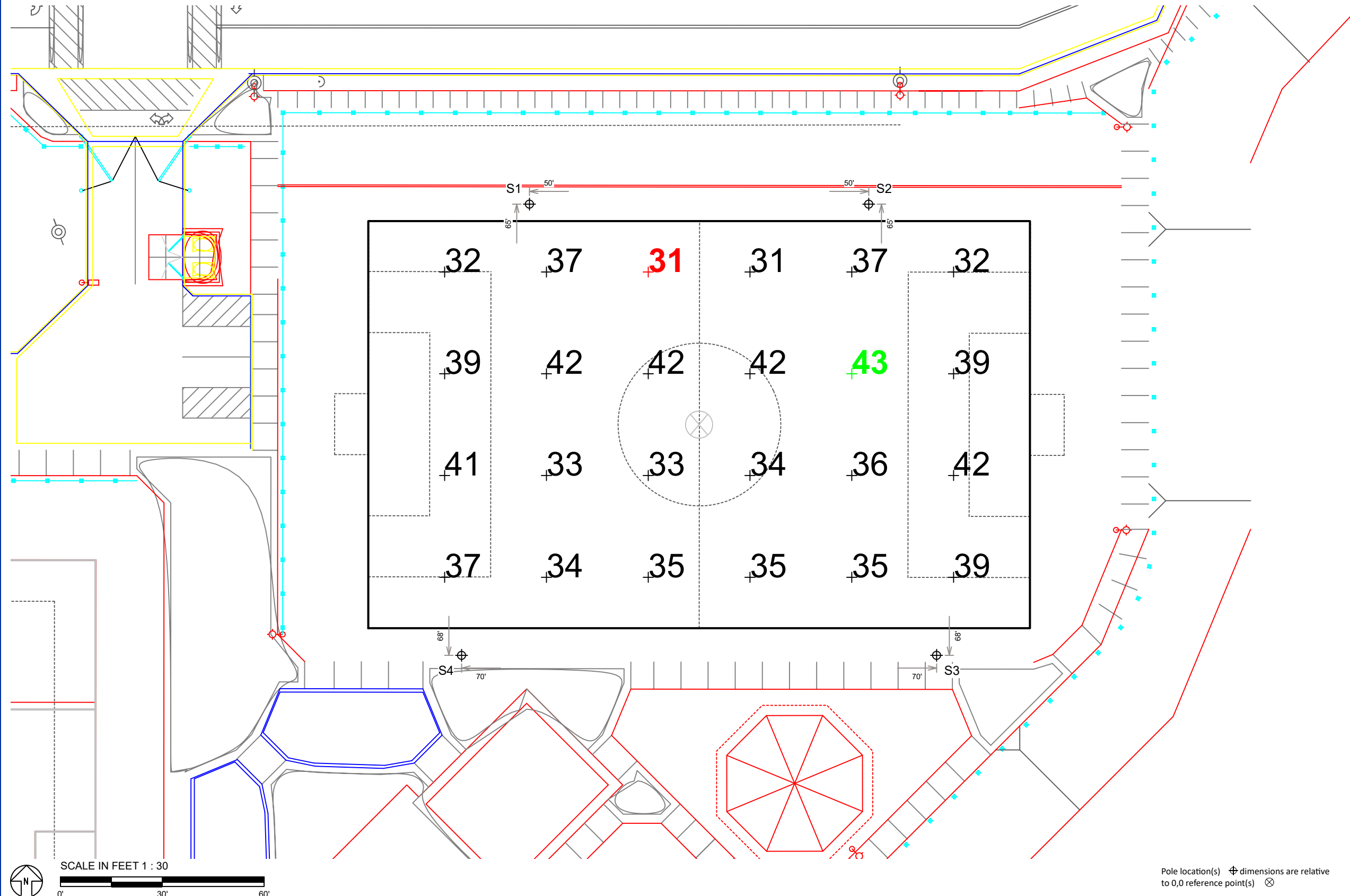

Guaranteed Performance: The ILLUMINATION described above is guaranteed per your Musco Warranty document and includes a 0.95 dirt depreciation factor.

Field Measurements: Individual field measurements may vary from computer-calculated predictions and should be taken in accordance with IESNA RP-6-15.

Electrical System Requirements: Refer to Amperage Draw Chart and/or the "Musco Control System Summary" for electrical sizing.

Installation Requirements: Results assume ± 3% nominal voltage at line side of the driver and structures located within 3 feet (1m) of design locations.

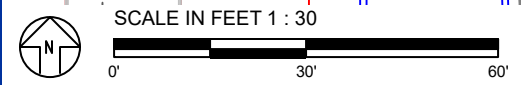

Pole location(s) Ⓢ dimensions are relative to 0,0 reference point(s) ⊗



EQUIPMENT LIST FOR AREAS SHOWN								
Pole			Luminaires					
QTY	LOCATION	SIZE	GRADE ELEVATION	MOUNTING HEIGHT	LUMINAIRE TYPE	QTY / POLE	THIS GRID	OTHER GRIDS
4	S5-S8	70'	-	70'	TLC-LED-1500	5	5	0
4	TOTALS							
						20	20	0

199752A-R1 Colton Soccer Park
Colton, CA

GRID SUMMARY	
Name:	2ASoccer
Size:	330' x 220'
Spacing:	30.0' x 30.0'
Height:	3.0' above grade

ILLUMINATION SUMMARY	
MAINTAINED HORIZONTAL FOOTCANDLES	
Entire Grid	
Guaranteed Average:	30
Scan Average:	34.21
Maximum:	42
Minimum:	23
Avg / Min:	1.49
Guaranteed Max / Min:	2
Max / Min:	1.82
UG (adjacent pts):	1.55
CU:	0.86
No. of Points:	88

LUMINAIRE INFORMATION				
Color / CRI:	5700K - 75 CRI			
Luminaire Output:	160,000 lumens			
No. of Luminaires:	20			
Total Load:	28.6 kW			
Lumen Maintenance				
Luminaire Type	L90 hrs	L80 hrs	L70 hrs	
TLC-LED-1500	>81,000	>81,000	>81,000	

Reported per TM-21-11. See luminaire datasheet for details.

Guaranteed Performance: The ILLUMINATION described above is guaranteed per your Musco Warranty document and includes a 0.95 dirt depreciation factor.

Field Measurements: Individual field measurements may vary from computer-calculated predictions and should be taken in accordance with IESNA RP-6-15.

Electrical System Requirements: Refer to Amperage Draw Chart and/or the "Musco Control System Summary" for electrical sizing.

Installation Requirements: Results assume ± 3% nominal voltage at line side of the driver and structures located within 3 feet (1m) of design locations.

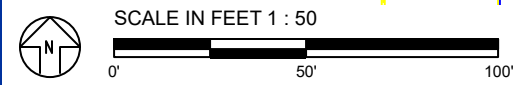
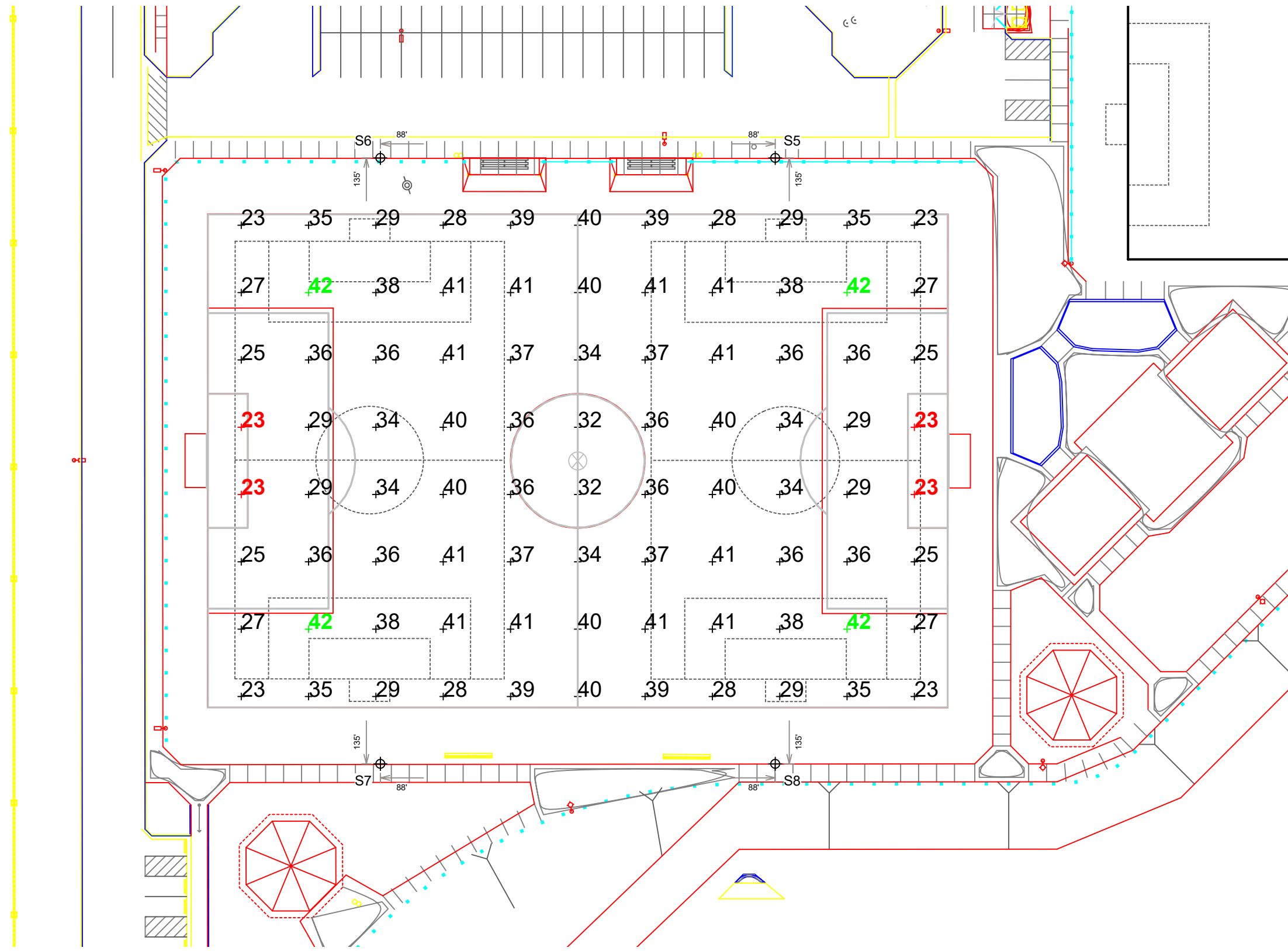

Pole location(s) Ⓢ dimensions are relative to 0,0 reference point(s) ⊗



EQUIPMENT LIST FOR AREAS SHOWN

Pole		Luminaires							
QTY	LOCATION	SIZE	GRADE ELEVATION	MOUNTING HEIGHT	LUMINAIRE TYPE	QTY / POLE	THIS GRID	OTHER GRIDS	
4	S1-S4	60'	-	60'	TLC-LED-1200	2	2	0	
4	S5-S8	70'	-	70'	TLC-LED-1500	5	5	0	
8	TOTALS						28	28	0

199752A-R1 Colton Soccer Park

Colton, CA

GRID SUMMARY

Name: Far side E. Congress St. Spill
 Spacing: 30.0'
 Height: 3.0' above grade

ILLUMINATION SUMMARY

HORIZONTAL FOOTCANDLES	
Entire Grid	0.0028
Scan Average:	0.02
Maximum:	0.00
Minimum:	0.00
No. of Points:	29

LUMINAIRE INFORMATION	
Color / CRI:	5700K - 75 CRI
Luminaire Output:	160,000 / 136,000 lumens
No. of Luminaires:	28
Total Load:	37.96 kW

Luminaire Type	Lumen Maintenance		
	L90 hrs	L80 hrs	L70 hrs
TLC-LED-1500	>81,000	>81,000	>81,000
TLC-LED-1200	>81,000	>81,000	>81,000

Reported per TM-21-11. See luminaire datasheet for details.

Guaranteed Performance: The ILLUMINATION described above is guaranteed per your Musco Warranty document.

Field Measurements: Individual field measurements may vary from computer-calculated predictions and should be taken in accordance with IESNA RP-6-15.

Electrical System Requirements: Refer to Amperage Draw Chart and/or the "Musco Control System Summary" for electrical sizing.

Installation Requirements: Results assume ± 3% nominal voltage at line side of the driver and structures located within 3 feet (1m) of design locations.

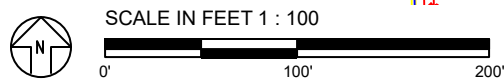
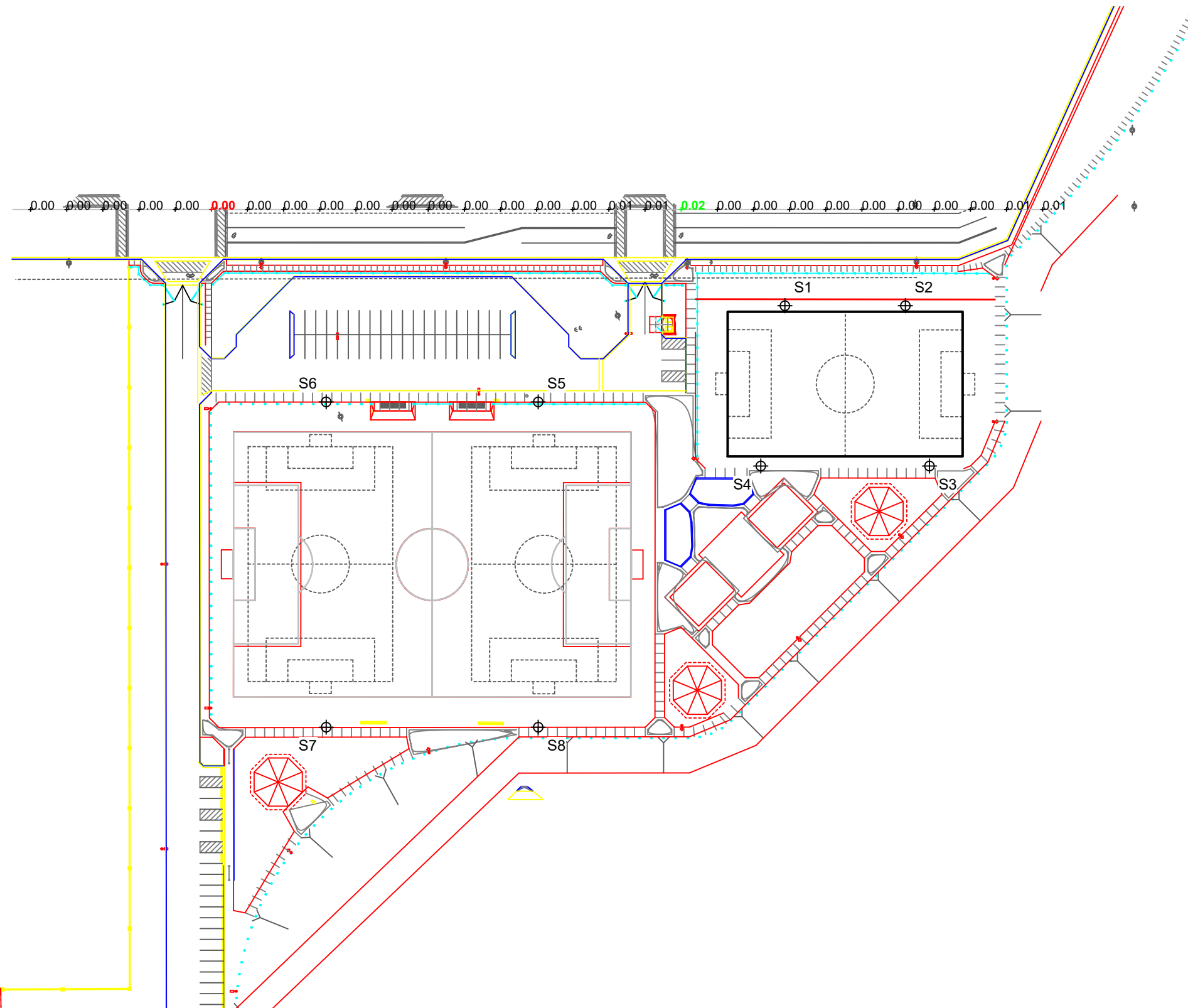

Pole location(s) Ⓢ dimensions are relative to 0,0 reference point(s) ⊗



We Make It Happen.

Not to be reproduced in whole or part without the written consent of Musco Sports Lighting, LLC. ©1981, 2019 Musco Sports Lighting, LLC.

EQUIPMENT LIST FOR AREAS SHOWN

Pole		Luminaires							
QTY	LOCATION	SIZE	GRADE ELEVATION	MOUNTING HEIGHT	LUMINAIRE TYPE	QTY / POLE	THIS GRID	OTHER GRIDS	
4	S1-S4	60'	-	60'	TLC-LED-1200	2	2	0	
4	S5-S8	70'	-	70'	TLC-LED-1500	5	5	0	
8	TOTALS						28	28	0

199752A-R1 Colton Soccer Park

Colton, CA

GRID SUMMARY

Name: Far side E. Congress St. Spill
 Spacing: 30.0'
 Height: 3.0' above grade

ILLUMINATION SUMMARY

MAX VERTICAL FOOTCANDLES	
Entire Grid	0.0077
Scan Average:	0.04
Maximum:	0.00
Minimum:	0.00
No. of Points:	29

LUMINAIRE INFORMATION	
Color / CRI:	5700K - 75 CRI
Luminaire Output:	160,000 / 136,000 lumens
No. of Luminaires:	28
Total Load:	37.96 kW

Luminaire Type	Lumen Maintenance		
	L90 hrs	L80 hrs	L70 hrs
TLC-LED-1500	>81,000	>81,000	>81,000
TLC-LED-1200	>81,000	>81,000	>81,000

Reported per TM-21-11. See luminaire datasheet for details.

Guaranteed Performance: The ILLUMINATION described above is guaranteed per your Musco Warranty document.

Field Measurements: Individual field measurements may vary from computer-calculated predictions and should be taken in accordance with IESNA RP-6-15.

Electrical System Requirements: Refer to Amperage Draw Chart and/or the "Musco Control System Summary" for electrical sizing.

Installation Requirements: Results assume ± 3% nominal voltage at line side of the driver and structures located within 3 feet (1m) of design locations.

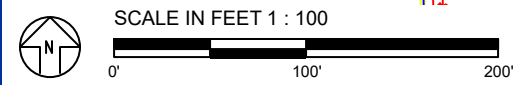
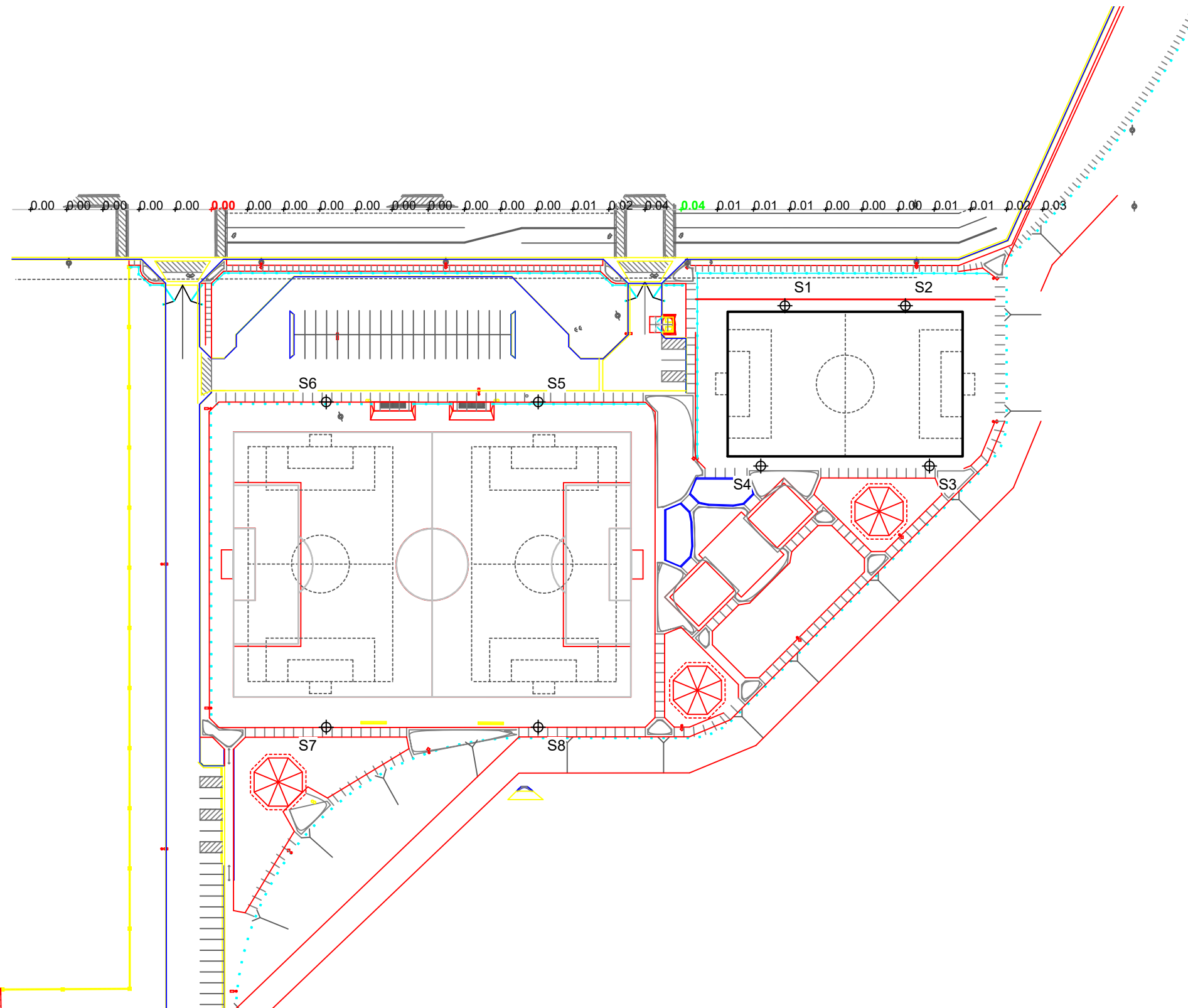

Pole location(s) Ⓢ dimensions are relative to 0,0 reference point(s) ⊗



EQUIPMENT LIST FOR AREAS SHOWN

Pole		Luminaires						
QTY	LOCATION	SIZE	GRADE ELEVATION	MOUNTING HEIGHT	LUMINAIRE TYPE	QTY / POLE	THIS GRID	OTHER GRIDS
8	S1-S4 S15-S18	60'	-	60'	TLC-LED-1200	2	2	0
4	S5-S8	70'	-	70'	TLC-LED-1500	5	5	0
3	S9, S13-S14	70'	-	70'	TLC-LED-1500	4	4	0
1	S10	70'	-	70'	TLC-LED-1500	4	4	0
2	S11-S12	80'	-	80'	TLC-LED-1500	10	10	0
				80'	TLC-LED-900	2	2	0
18	TOTALS					76	76	0

199752A-R1 Colton Soccer Park

Colton, CA

GRID SUMMARY

Name: Property Spill Line
 Spacing: 30.0'
 Height: 3.0' above grade

ILLUMINATION SUMMARY

HORIZONTAL FOOTCANDLES			
		Entire Grid	
Scan Average:	0.0771		
Maximum:	1.01		
Minimum:	0.00		
No. of Points:	239		
LUMINAIRE INFORMATION			
Color / CRI:		5700K - 75 CRI	
Luminaire Output:		89,600 / 160,000 / 136,000 lumens	
No. of Luminaires:		76	
Total Load:		102.36 kW	
Lumen Maintenance			
Luminaire Type	L90 hrs	L80 hrs	L70 hrs
TLC-LED-900	>81,000	>81,000	>81,000
TLC-LED-1500	>81,000	>81,000	>81,000
TLC-LED-1200	>81,000	>81,000	>81,000
Reported per TM-21-11. See luminaire datasheet for details.			

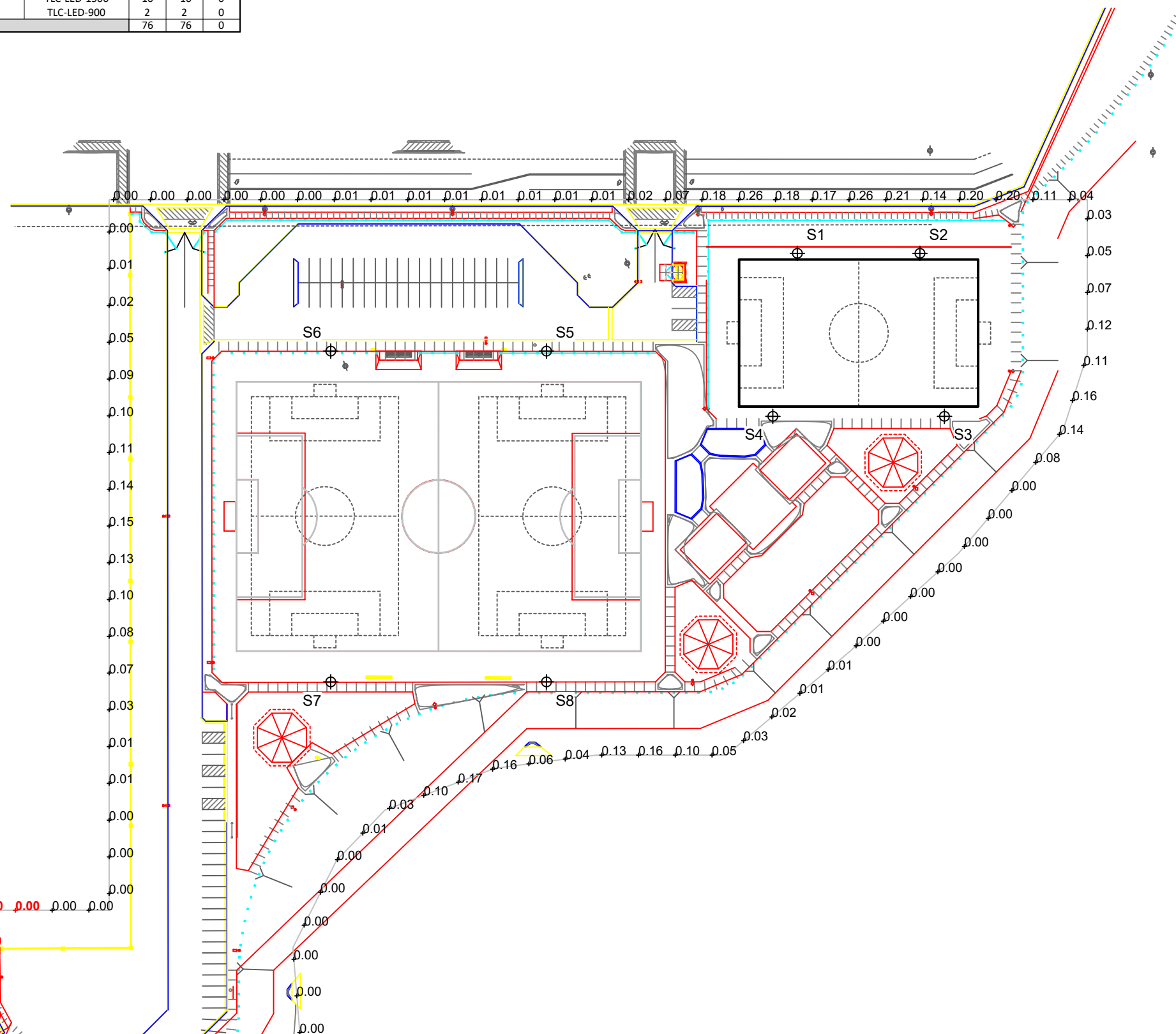

Guaranteed Performance: The ILLUMINATION described above is guaranteed per your Musco Warranty document.

Field Measurements: Individual field measurements may vary from computer-calculated predictions and should be taken in accordance with IESNA RP-6-15.

Electrical System Requirements: Refer to Amperage Draw Chart and/or the "Musco Control System Summary" for electrical sizing.

Installation Requirements: Results assume ± 3% nominal voltage at line side of the driver and structures located within 3 feet (1m) of design locations.

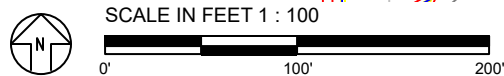

Pole location(s) ⊕ dimensions are relative to 0,0 reference point(s) ⊗



We Make It Happen.

Not to be reproduced in whole or part without the written consent of Musco Sports Lighting, LLC. ©1981, 2019 Musco Sports Lighting, LLC.

EQUIPMENT LIST FOR AREAS SHOWN

Pole		Luminaires						
QTY	LOCATION	SIZE	GRADE ELEVATION	MOUNTING HEIGHT	LUMINAIRE TYPE	QTY / POLE	THIS GRID	OTHER GRIDS
8	S1-S4 S15-S18	60'	-	60'	TLC-LED-1200	2	2	0
4	S5-S8	70'	-	70'	TLC-LED-1500	5	5	0
3	S9, S13-S14	70'	-	70'	TLC-LED-1500	4	4	0
1	S10	70'	-	70'	TLC-LED-1500	4	4	0
2	S11-S12	80'	-	80'	TLC-LED-1500	10	10	0
				80'	TLC-LED-900	2	2	0
18	TOTALS					76	76	0

199752A-R1 Colton Soccer Park

Colton, CA

GRID SUMMARY

Name: Property Spill Line
 Spacing: 30.0'
 Height: 3.0' above grade

ILLUMINATION SUMMARY

MAX VERTICAL FOOTCANDLES			
Entire Grid			
Scan Average:	0.1485		
Maximum:	1.55		
Minimum:	0.00		
No. of Points:	239		
LUMINAIRE INFORMATION			
Color / CRI:	5700K - 75 CRI		
Luminaire Output:	89,600 / 160,000 / 136,000 lumens		
No. of Luminaires:	76		
Total Load:	102.36 kW		
Lumen Maintenance			
Luminaire Type	L90 hrs	L80 hrs	L70 hrs
TLC-LED-900	>81,000	>81,000	>81,000
TLC-LED-1500	>81,000	>81,000	>81,000
TLC-LED-1200	>81,000	>81,000	>81,000
Reported per TM-21-11. See luminaire datasheet for details.			

Guaranteed Performance: The ILLUMINATION described above is guaranteed per your Musco Warranty document.

Field Measurements: Individual field measurements may vary from computer-calculated predictions and should be taken in accordance with IESNA RP-6-15.

Electrical System Requirements: Refer to Amperage Draw Chart and/or the "Musco Control System Summary" for electrical sizing.

Installation Requirements: Results assume ± 3% nominal voltage at line side of the driver and structures located within 3 feet (1m) of design locations.

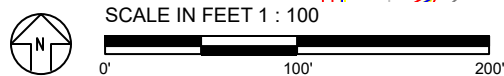
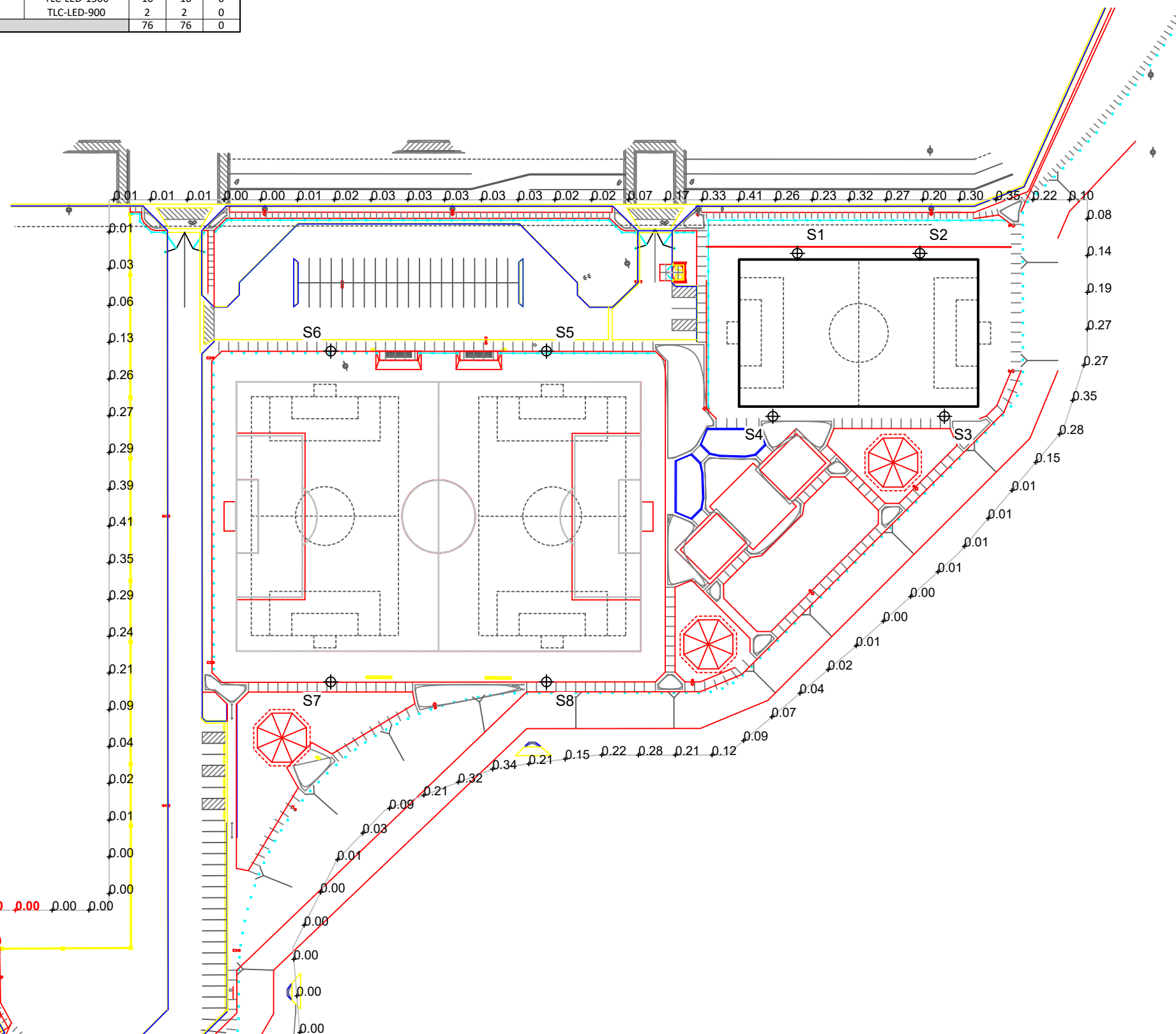

Pole location(s) ⊕ dimensions are relative to 0,0 reference point(s) ⊗



We Make It Happen.

Not to be reproduced in whole or part without the written consent of Musco Sports Lighting, LLC. ©1981, 2019 Musco Sports Lighting, LLC.

EQUIPMENT LIST FOR AREAS SHOWN

Pole				Luminaires				
QTY	LOCATION	SIZE	GRADE ELEVATION	MOUNTING HEIGHT	LUMINAIRE TYPE	QTY / POLE	THIS GRID	OTHER GRIDS
1	S9	70'	-	70'	TLC-LED-1500	4	4	0
1	S10	70'	-	70'	TLC-LED-1500	4	4	0
2	S11-S12	80'	-	80'	TLC-LED-1500	10	5	5
				80'	TLC-LED-900	2	1	1
4	TOTALS					32	20	12

199752A-R1 Colton Soccer Park

Colton, CA

GRID SUMMARY

Name: **3ASoccer**
 Size: 330' x 220'
 Spacing: 30.0' x 30.0'
 Height: 3.0' above grade

ILLUMINATION SUMMARY

MAINTAINED HORIZONTAL FOOTCANDLES			
Entire Grid			
Guaranteed Average:	30		
Scan Average:	31.87		
Maximum:	43		
Minimum:	23		
Avg / Min:	1.37		
Guaranteed Max / Min:	2		
Max / Min:	1.87		
UG (adjacent pts):	1.49		
CU:	0.74		
No. of Points:	77		
LUMINAIRE INFORMATION			
Color / CRI:	5700K - 75 CRI		
Luminaire Output:	89,600 / 160,000 lumens		
No. of Luminaires:	20		
Total Load:	27.52 kW		
Lumen Maintenance			
Luminaire Type	L90 hrs	L80 hrs	L70 hrs
TLC-LED-900	>81,000	>81,000	>81,000
TLC-LED-1500	>81,000	>81,000	>81,000

Reported per TM-21-11. See luminaire datasheet for details.

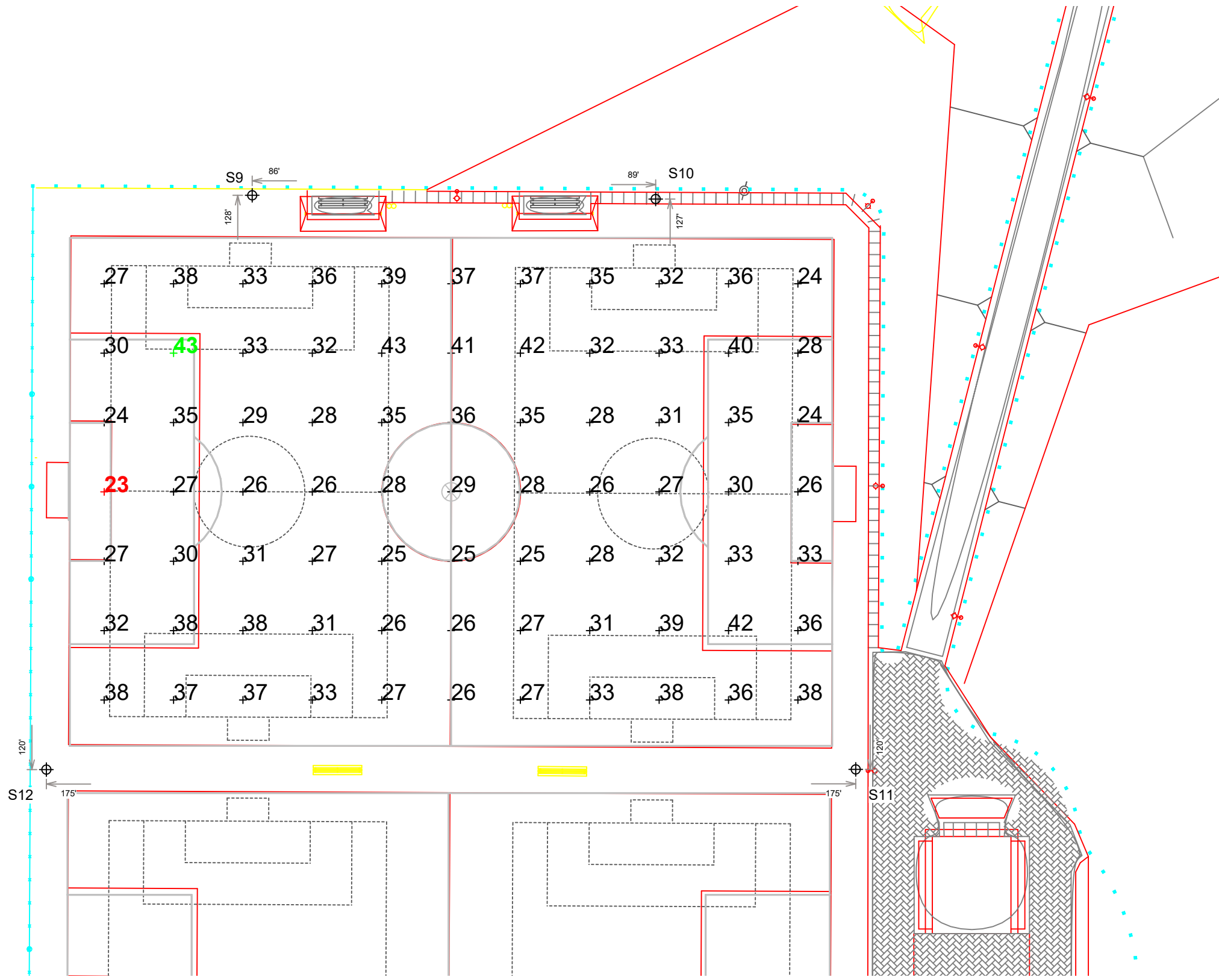

Guaranteed Performance: The ILLUMINATION described above is guaranteed per your Musco Warranty document and includes a 0.95 dirt depreciation factor.

Field Measurements: Individual field measurements may vary from computer-calculated predictions and should be taken in accordance with IESNA RP-6-15.

Electrical System Requirements: Refer to Amperage Draw Chart and/or the "Musco Control System Summary" for electrical sizing.

Installation Requirements: Results assume ± 3% nominal voltage at line side of the driver and structures located within 3 feet (1m) of design locations.

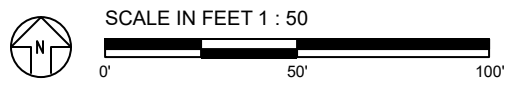

We Make It Happen.

EQUIPMENT LIST FOR AREAS SHOWN							
Pole			Luminaires				
QTY	LOCATION	SIZE	GRADE ELEVATION	MOUNTING HEIGHT	LUMINAIRE TYPE	QTY / POLE	THIS GRID / OTHER GRIDS
2	S11-S12	80'	-	80'	TLC-LED-1500	10	5 / 5
				80'	TLC-LED-900	2	1 / 1
2	S13-S14	70'	-	70'	TLC-LED-1500	4	4 / 0
4	TOTALS					32	20 / 12

199752A-R1 Colton Soccer Park

Colton, CA

GRID SUMMARY	
Name:	4ASoccer
Size:	330' x 220'
Spacing:	30.0' x 30.0'
Height:	3.0' above grade

ILLUMINATION SUMMARY			
MAINTAINED HORIZONTAL FOOTCANDLES			
Entire Grid			
Guaranteed Average:	30		
Scan Average:	31.51		
Maximum:	42		
Minimum:	22		
Avg / Min:	1.45		
Guaranteed Max / Min:	2		
Max / Min:	1.95		
UG (adjacent pts):	1.47		
CU:	0.73		
No. of Points:	77		
LUMINAIRE INFORMATION			
Color / CRI:	5700K - 75 CRI		
Luminaire Output:	89,600 / 160,000 lumens		
No. of Luminaires:	20		
Total Load:	27.52 kW		
Lumen Maintenance			
Luminaire Type	L90 hrs	L80 hrs	L70 hrs
TLC-LED-900	>81,000	>81,000	>81,000
TLC-LED-1500	>81,000	>81,000	>81,000
Reported per TM-21-11. See luminaire datasheet for details.			

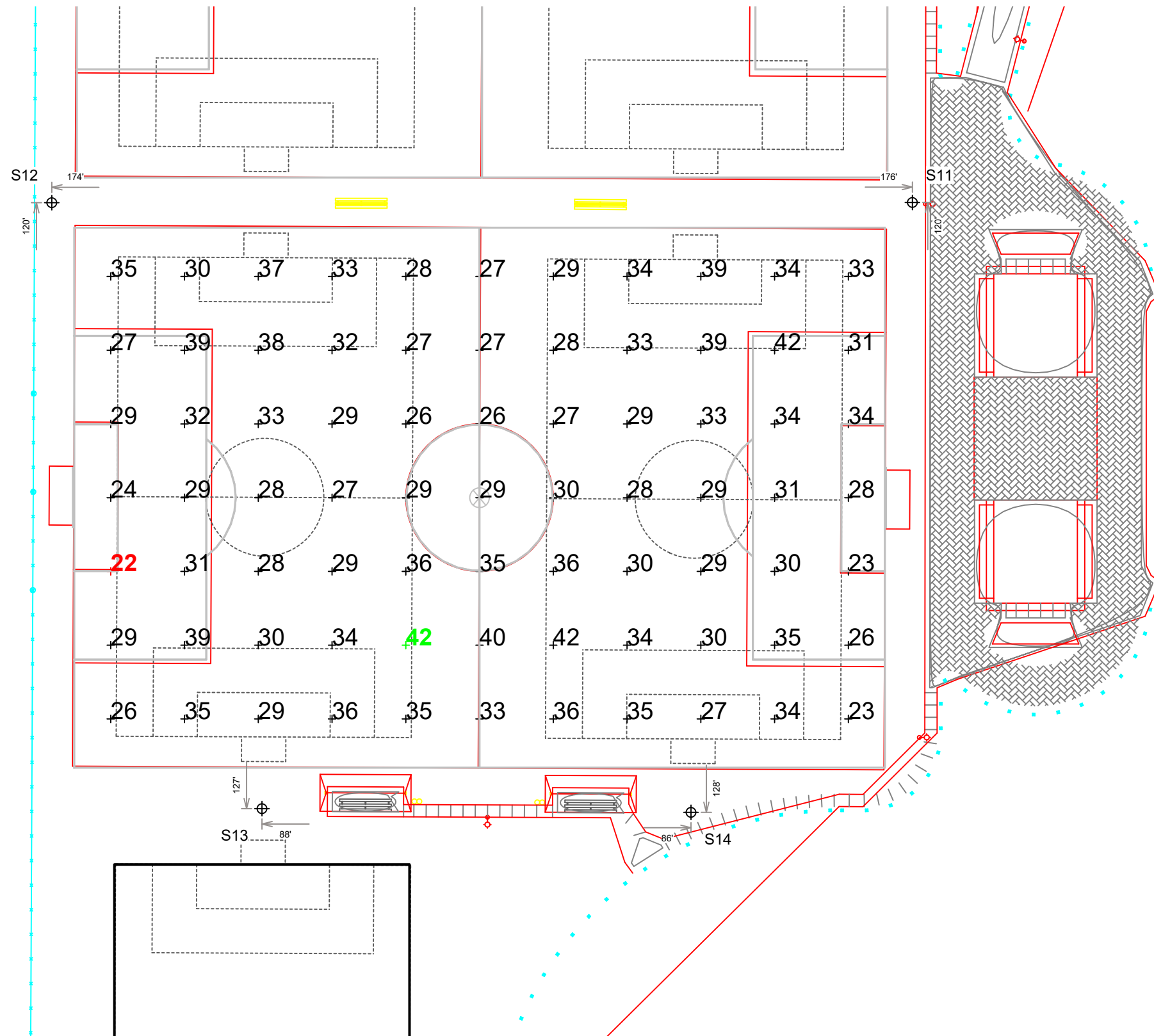

Guaranteed Performance: The ILLUMINATION described above is guaranteed per your Musco Warranty document and includes a 0.95 dirt depreciation factor.

Field Measurements: Individual field measurements may vary from computer-calculated predictions and should be taken in accordance with IESNA RP-6-15.

Electrical System Requirements: Refer to Amperage Draw Chart and/or the "Musco Control System Summary" for electrical sizing.

Installation Requirements: Results assume ± 3% nominal voltage at line side of the driver and structures located within 3 feet (1m) of design locations.

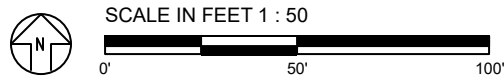

Pole location(s) ⊕ dimensions are relative to 0,0 reference point(s) ⊗



We Make It Happen.

Not to be reproduced in whole or part without the written consent of Musco Sports Lighting, LLC. ©1981, 2019 Musco Sports Lighting, LLC.

ILLUMINATION SUMMARY

EQUIPMENT LIST FOR AREAS SHOWN								
Pole				Luminaires				
QTY	LOCATION	SIZE	GRADE ELEVATION	MOUNTING HEIGHT	LUMINAIRE TYPE	QTY / POLE	THIS GRID	OTHER GRIDS
4	S15-S18	60'	-	60'	TLC-LED-1200	2	2	0
4	TOTALS					8	8	0

199752A-R1 Colton Soccer Park
Colton, CA

GRID SUMMARY	
Name:	5ASoccer
Size:	195' x 120'
Spacing:	30.0' x 30.0'
Height:	3.0' above grade

ILLUMINATION SUMMARY	
MAINTAINED HORIZONTAL FOOTCANDLES	
Entire Grid	
Guaranteed Average:	30
Scan Average:	35.06
Maximum:	41
Minimum:	30
Avg / Min:	1.19
Guaranteed Max / Min:	2
Max / Min:	1.39
UG (adjacent pts):	1.35
CU:	0.71
No. of Points:	24

LUMINAIRE INFORMATION			
Color / CRI:	5700K - 75 CRI		
Luminaire Output:	136,000 lumens		
No. of Luminaires:	8		
Total Load:	9.36 kW		
Lumen Maintenance			
Luminaire Type	L90 hrs	L80 hrs	L70 hrs
TLC-LED-1200	>81,000	>81,000	>81,000

Reported per TM-21-11. See luminaire datasheet for details.

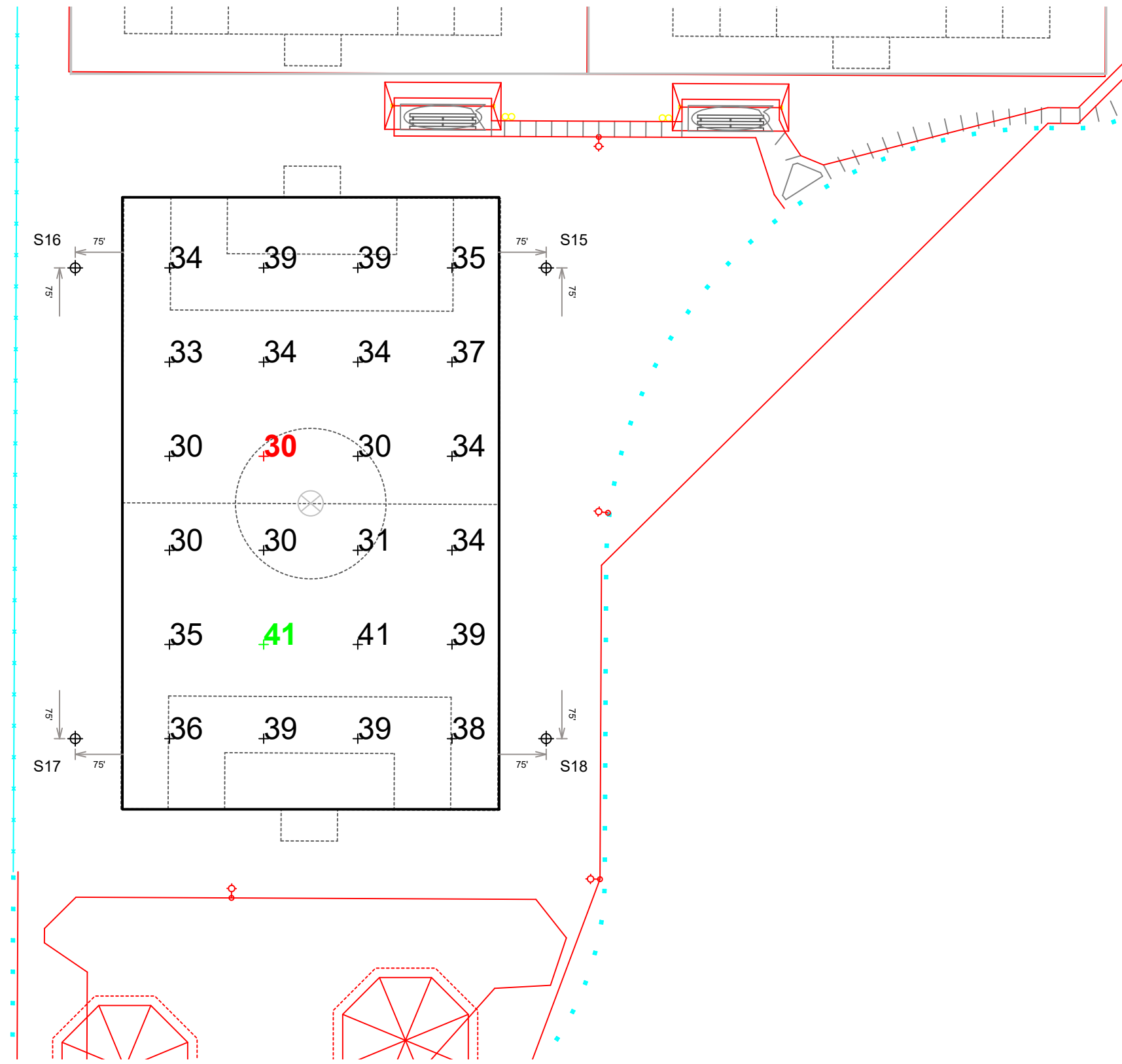

Guaranteed Performance: The ILLUMINATION described above is guaranteed per your Musco Warranty document and includes a 0.95 dirt depreciation factor.

Field Measurements: Individual field measurements may vary from computer-calculated predictions and should be taken in accordance with IESNA RP-6-15.

Electrical System Requirements: Refer to Amperage Draw Chart and/or the "Musco Control System Summary" for electrical sizing.

Installation Requirements: Results assume ± 3% nominal voltage at line side of the driver and structures located within 3 feet (1m) of design locations.

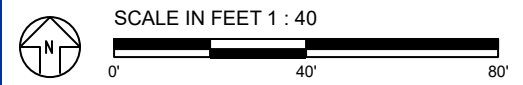

Pole location(s) ⊕ dimensions are relative to 0,0 reference point(s) ⊗



EQUIPMENT LIST FOR AREAS SHOWN

Pole		Luminaires						
QTY	LOCATION	SIZE	GRADE ELEVATION	MOUNTING HEIGHT	LUMINAIRE TYPE	QTY / POLE	THIS GRID	OTHER GRIDS
8	S1-S4 S15-S18	60'	-	60'	TLC-LED-1200	2	2	0
4	S5-S8	70'	-	70'	TLC-LED-1500	5	5	0
3	S9, S13-S14	70'	-	70'	TLC-LED-1500	4	4	0
1	S10	70'	-	70'	TLC-LED-1500	4	4	0
2	S11-S12	80'	-	80'	TLC-LED-1500	10	10	0
				80'	TLC-LED-900	2	2	0
18	TOTALS					76	76	0

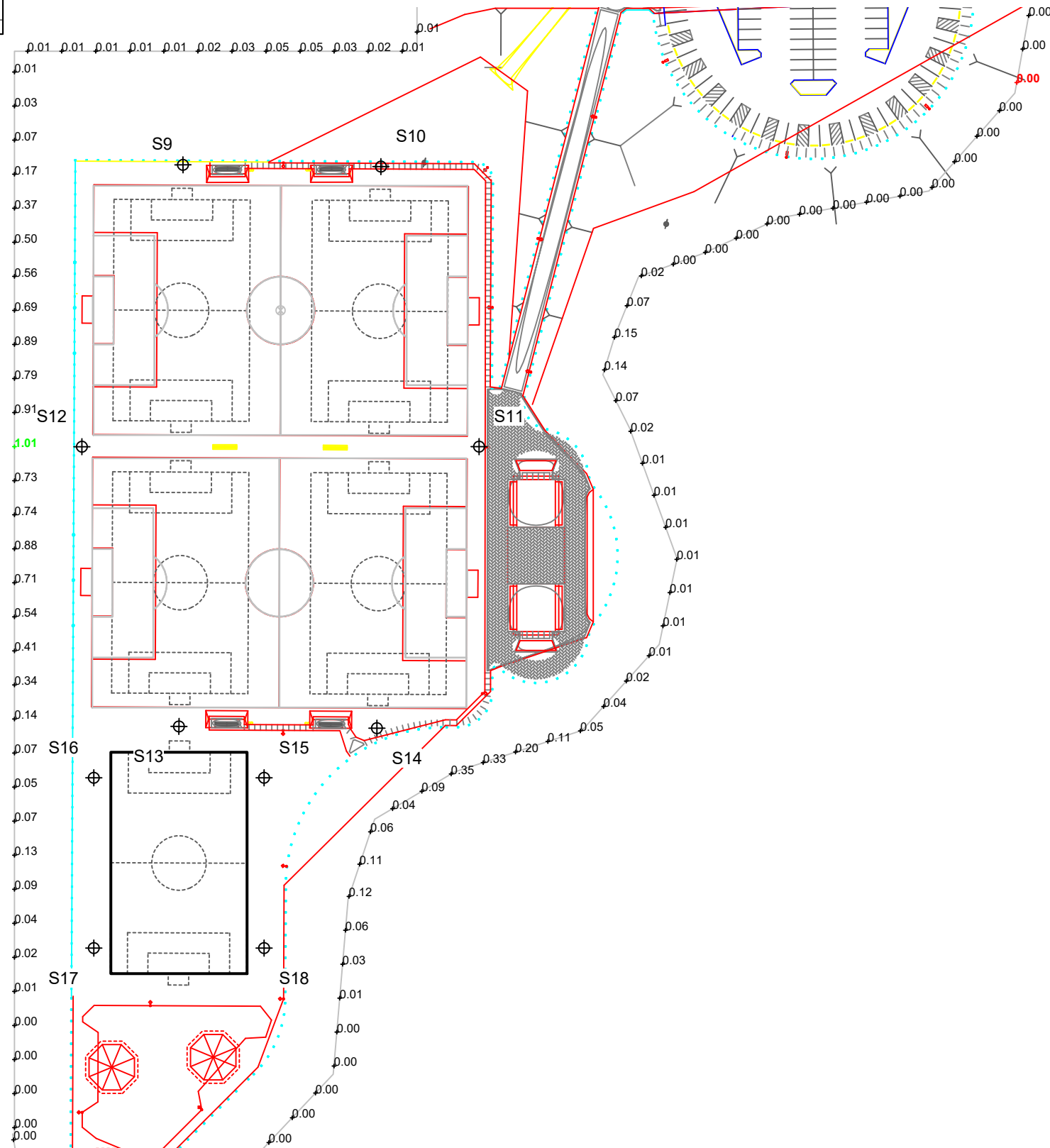

199752A-R1 Colton Soccer Park

Colton, CA

GRID SUMMARY	
Name:	Property Spill Line
Spacing:	30.0'
Height:	3.0' above grade

ILLUMINATION SUMMARY			
HORIZONTAL FOOTCANDLES			
Entire Grid			
Scan Average:	0.0778		
Maximum:	1.01		
Minimum:	0.00		
No. of Points:	239		
LUMINAIRE INFORMATION			
Color / CRI:	5700K - 75 CRI		
Luminaire Output:	89,600 / 160,000 / 136,000 lumens		
No. of Luminaires:	76		
Total Load:	102.36 kW		
Lumen Maintenance			
Luminaire Type	L90 hrs	L80 hrs	L70 hrs
TLC-LED-900	>81,000	>81,000	>81,000
TLC-LED-1500	>81,000	>81,000	>81,000
TLC-LED-1200	>81,000	>81,000	>81,000
Reported per TM-21-11. See luminaire datasheet for details.			

Guaranteed Performance: The ILLUMINATION described above is guaranteed per your Musco Warranty document.

Field Measurements: Individual field measurements may vary from computer-calculated predictions and should be taken in accordance with IESNA RP-6-15.

Electrical System Requirements: Refer to Amperage Draw Chart and/or the "Musco Control System Summary" for electrical sizing.

Installation Requirements: Results assume ± 3% nominal voltage at line side of the driver and structures located within 3 feet (1m) of design locations.

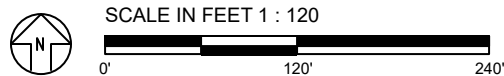

ENGINEERED DESIGN By: Isaac Sanders • File #199752A-R1 • 18-Jun-19

Pole location(s) ⊕ dimensions are relative to 0,0 reference point(s) ⊗



We Make It Happen.

Not to be reproduced in whole or part without the written consent of Musco Sports Lighting, LLC. ©1981, 2019 Musco Sports Lighting, LLC.

ILLUMINATION SUMMARY

EQUIPMENT LIST FOR AREAS SHOWN								
Pole				Luminaires				
QTY	LOCATION	SIZE	GRADE ELEVATION	MOUNTING HEIGHT	LUMINAIRE TYPE	QTY / POLE	THIS GRID	OTHER GRIDS
8	S1-S4 S15-S18	60'	-	60'	TLC-LED-1200	2	2	0
4	S5-S8	70'	-	70'	TLC-LED-1500	5	5	0
3	S9, S13-S14	70'	-	70'	TLC-LED-1500	4	4	0
1	S10	70'	-	70'	TLC-LED-1500	4	4	0
2	S11-S12	80'	-	80'	TLC-LED-1500	10	10	0
				80'	TLC-LED-900	2	2	0
18	TOTALS					76	76	0

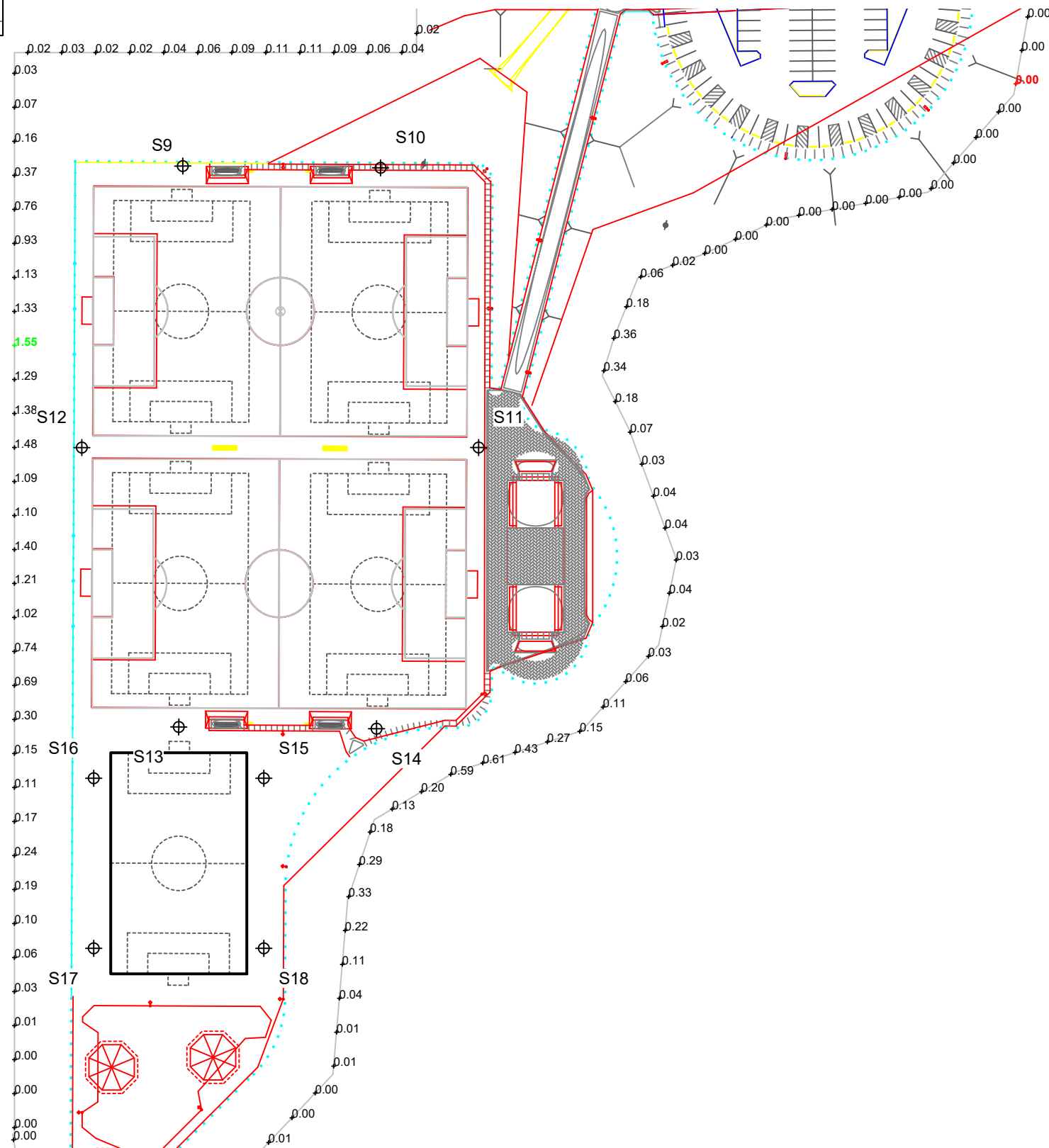

199752A-R1 Colton Soccer Park

Colton, CA

GRID SUMMARY	
Name:	Property Spill Line
Spacing:	30.0'
Height:	3.0' above grade

ILLUMINATION SUMMARY			
MAX VERTICAL FOOTCANDLES			
Entire Grid			
Scan Average:	0.1511		
Maximum:	1.55		
Minimum:	0.00		
No. of Points:	239		
LUMINAIRE INFORMATION			
Color / CRI:	5700K - 75 CRI		
Luminaire Output:	89,600 / 160,000 / 136,000 lumens		
No. of Luminaires:	76		
Total Load:	102.36 kW		
Lumen Maintenance			
Luminaire Type	L90 hrs	L80 hrs	L70 hrs
TLC-LED-900	>81,000	>81,000	>81,000
TLC-LED-1500	>81,000	>81,000	>81,000
TLC-LED-1200	>81,000	>81,000	>81,000
Reported per TM-21-11. See luminaire datasheet for details.			

Guaranteed Performance: The ILLUMINATION described above is guaranteed per your Musco Warranty document.

Field Measurements: Individual field measurements may vary from computer-calculated predictions and should be taken in accordance with IESNA RP-6-15.

Electrical System Requirements: Refer to Amperage Draw Chart and/or the "Musco Control System Summary" for electrical sizing.

Installation Requirements: Results assume ± 3% nominal voltage at line side of the driver and structures located within 3 feet (1m) of design locations.

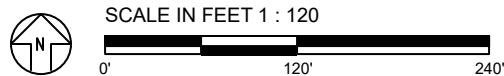

Pole location(s) ⊕ dimensions are relative to 0.0 reference point(s) ⊗



We Make It Happen.

199752A-R1 Colton Soccer Park
Colton, CA

EQUIPMENT LAYOUT

INCLUDES:

- 1ASoccer
- 2ASoccer
- 3ASoccer
- 4ASoccer
- 5ASoccer

Electrical System Requirements: Refer to Amperage Draw Chart and/or the "Musco Control System Summary" for electrical sizing.

Installation Requirements: Results assume ± 3% nominal voltage at line side of the driver and structures located within 3 feet (1m) of design locations.

EQUIPMENT LIST FOR AREAS SHOWN

QTY	LOCATION	Pole		Luminaires		QTY / POLE
		SIZE	GRADE ELEVATION	MOUNTING HEIGHT	LUMINAIRE TYPE	
8	S1-S4 S15-S18	60'	-	60'	TLC-LED-1200	2
4	S5-S8	70'	-	70'	TLC-LED-1500	5
1	S10	70'	-	70'	TLC-LED-1500	4
2	S11-S12	80'	-	80'	TLC-LED-1500	10
3	S13-S14 S9	70'	-	70'	TLC-LED-900	2
18	TOTALS					76

SINGLE LUMINAIRE AMPERAGE DRAW CHART

Ballast Specifications (.90 min power factor)	Line Amperage Per Luminaire (max draw)					
	208 (60)	220 (60)	240 (60)	277 (60)	347 (60)	480 (60)
Single Phase Voltage	208 (60)	220 (60)	240 (60)	277 (60)	347 (60)	480 (60)
TLC-LED-900-A	5.3	5.0	4.6	4.0	3.2	2.9
TLC-LED-1500	8.5	8.1	7.4	6.4	5.1	4.7
TLC-LED-1200	7.0	6.6	6.1	5.2	4.2	3.8

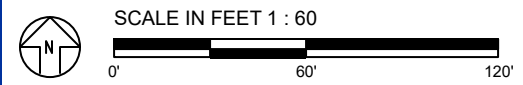
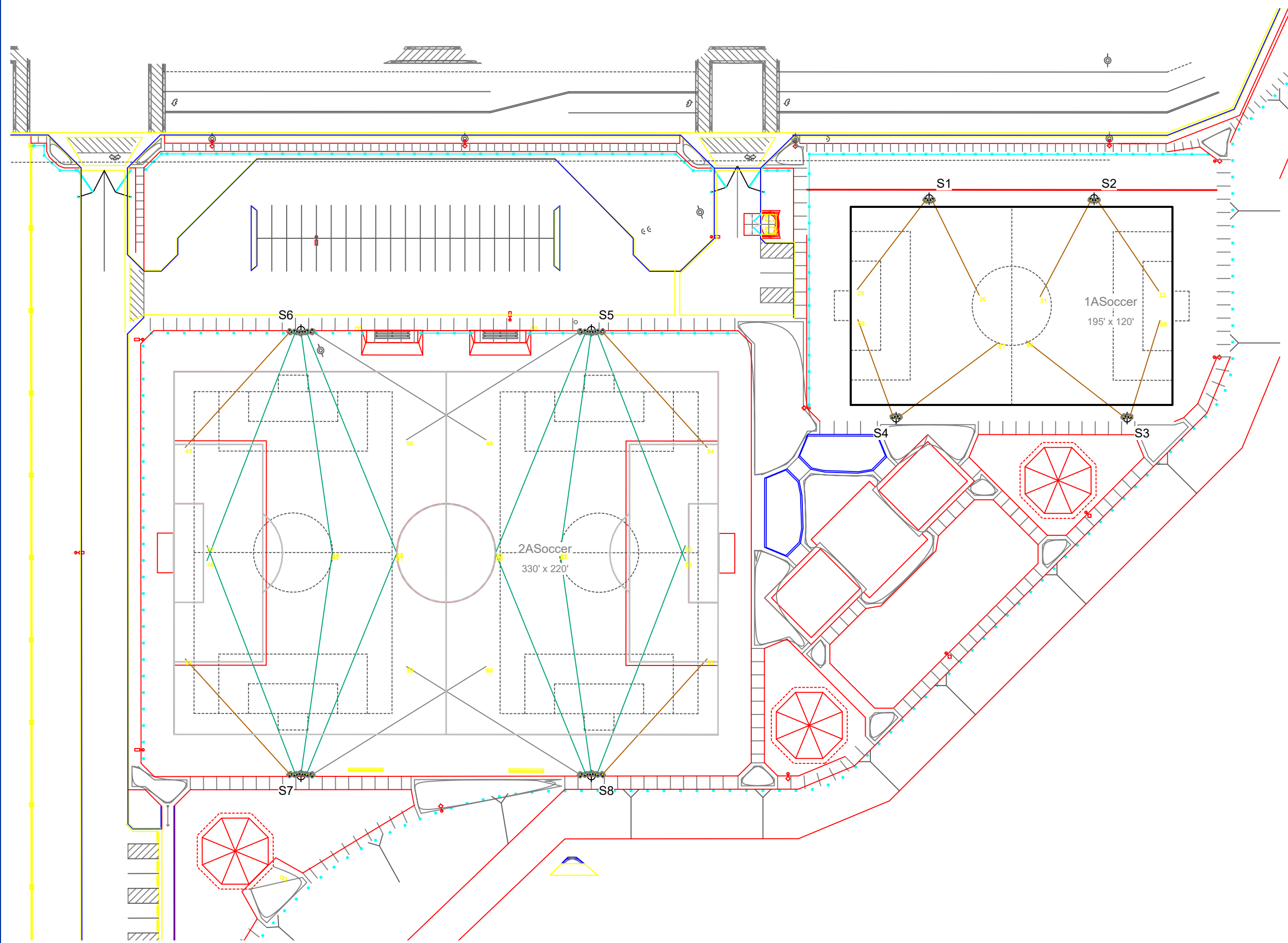

Pole location(s) ⚡ dimensions are relative to 0,0 reference point(s) ⊗



199752A-R1 Colton Soccer Park
Colton, CA

EQUIPMENT LAYOUT

INCLUDES:

- 1ASoccer
- 2ASoccer
- 3ASoccer
- 4ASoccer
- 5ASoccer

Electrical System Requirements: Refer to Amperage Draw Chart and/or the "Musco Control System Summary" for electrical sizing.

Installation Requirements: Results assume ± 3% nominal voltage at line side of the driver and structures located within 3 feet (1m) of design locations.

EQUIPMENT LIST FOR AREAS SHOWN

QTY	LOCATION	Pole		Luminaires		QTY / POLE
		SIZE	GRADE ELEVATION	MOUNTING HEIGHT	LUMINAIRE TYPE	
8	S1-S4 S15-S18	60'	-	60'	TLC-LED-1200	2
4	S5-S8	70'	-	70'	TLC-LED-1500	5
1	S10	70'	-	70'	TLC-LED-1500	4
2	S11-S12	80'	-	80'	TLC-LED-1500	10
				80'	TLC-LED-900	2
3	S13-S14 S9	70'	-	70'	TLC-LED-1500	4
18	TOTALS					76

SINGLE LUMINAIRE AMPERAGE DRAW CHART

Ballast Specifications (.90 min power factor)	Line Amperage Per Luminaire (max draw)						
	208 (60)	220 (60)	240 (60)	277 (60)	347 (60)	380 (60)	480 (60)
TLC-LED-900-A	5.3	5.0	4.6	4.0	3.2	2.9	2.3
TLC-LED-1500	8.5	8.1	7.4	6.4	5.1	4.7	3.7
TLC-LED-1200	7.0	6.6	6.1	5.2	4.2	3.8	3.0

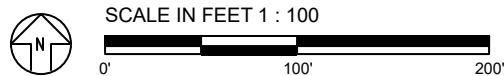
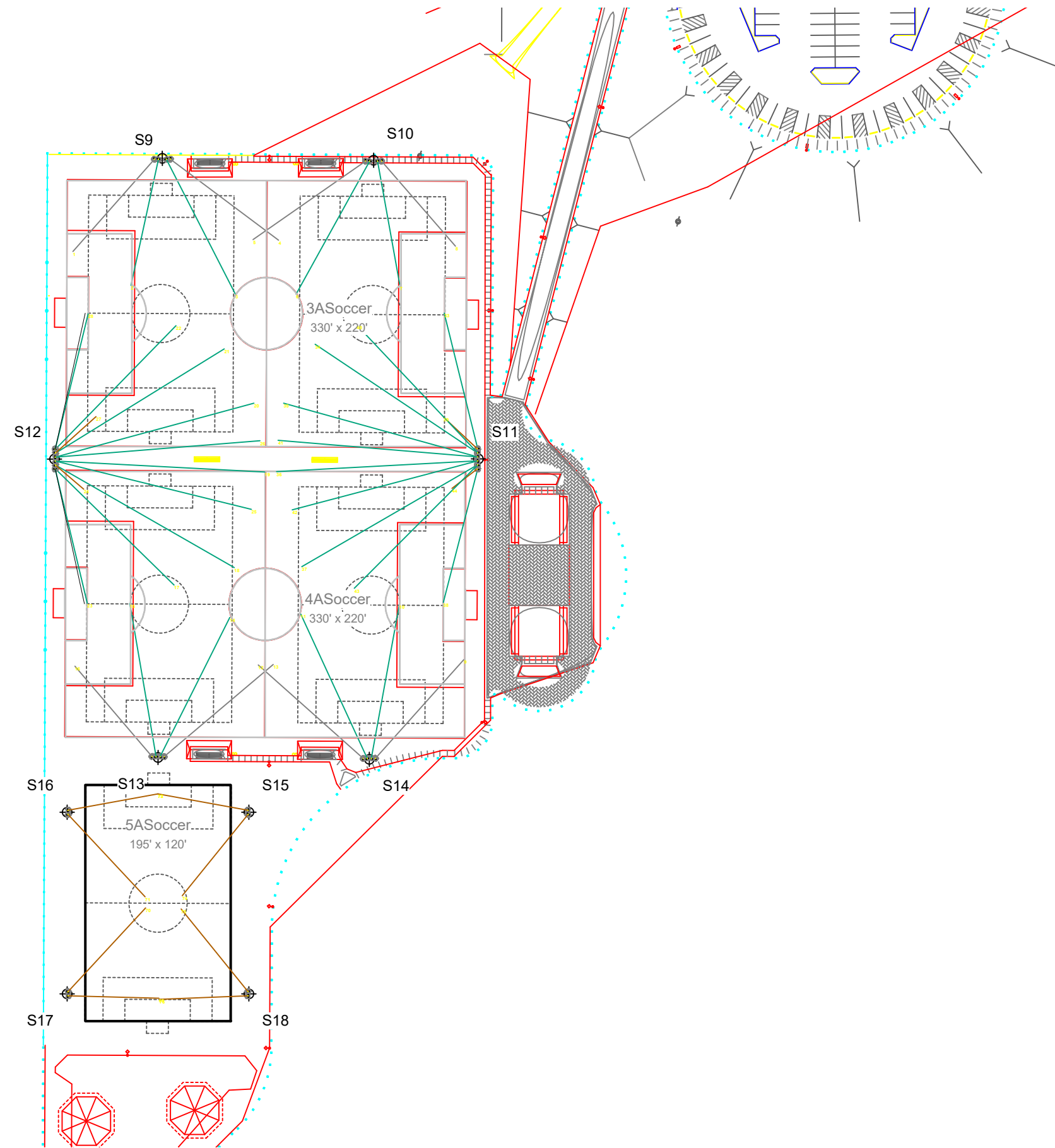

ENGINEERED DESIGN By: Isaac Sanders • File #199752A-R1 • 18-Jun-19

Pole location(s) Ⓢ dimensions are relative to 0,0 reference point(s) ⊗



We Make It Happen.

Not to be reproduced in whole or part without the written consent of Musco Sports Lighting, LLC. ©1981, 2019 Musco Sports Lighting, LLC.