

DATE FILED & POSTED
Posted On: 9/30/19

Removed On: 11/12/19

Receipt No: 36-09302019-686

CEQA: California Environmental Quality Act

NOTICE OF EXEMPTION

To: Office of Planning and Research
1400 Tenth Street, Room 121
Sacramento, CA 95814

From: Colton Joint Unified School District
1212 Valencia Drive
Colton, CA 92324

County Clerk
County of San Bernardino
385 N. Arrowhead Ave., 2nd Floor
San Bernardino, CA 92415

Colton High School Baseball/Softball Field Renovation Project
Project Title

777 W. Valley Blvd.
Project Location - Specific

Colton San Bernardino
Project Location - City Project Location - County

The proposed project consists of renovations to the existing parking lot, baseball and softball fields at Colton High School to improve student athletic facilities and accessibility.
Description of Nature, Purpose, and Beneficiaries of Project

Colton Joint Unified School District
Name of Public Agency Approving Project

Colton Joint Unified School District
Name of Person or Agency Carrying Out Project

Exempt Status: (check one below)

- Ministerial (Sec. 21080(b)(1); 15268);
- Declared Emergency (Sec. 21080(b)(3); 15269(a));
- Emergency Project (Sec. 21080(b)(4); 15269(b)(c));
- Categorical Exemption. State type and section number: Class 2, CCR §15302, Replacement and Reconstruction, and Class 3, CCR §15303, New Construction or Conversion of Small Structures
- Statutory Exemptions. State code number: _____

COUNTY OF SAN BERNARDINO
 CALIFORNIA
 2019 SEP 30 AM 9:32
 CLERK OF THE BOARD OF SUPERVISORS

The project involves demolition and construction efforts to renovate the existing varsity and junior varsity softball and baseball fields, as well as parking lot improvements. Field renovations include new turf, bleachers, dugouts, pavement, fencing and 60-foot netting. No expansion of existing school capacity or changes in facility use would occur; therefore, the project is exempt from CEQA under Section 15302 and 15303. The proposed project was also reviewed for possible exceptions under Section 15300.2 and found that the exceptions do not apply. See Attachment to Notice of Exemption for further explanation of the evaluation (available at the District Facilities and Construction Office, 325 Hermosa Street, Colton, CA 92324).

Reasons why project is exempt

Owen Chang

909.580.6643

Contact Person:

Area Code/Telephone/Extension:

If filed by applicant:

1. Attach certified document of exemption findings
2. Has a Notice of Exemption been filed by the public agency approving the project Yes No

Date
Received for
Filing:

Signature:

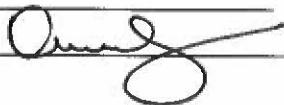

Title:

DIRECTOR

Governor's Office of Planning & Research

SEP 30 2019

STATE CLEARINGHOUSE

Attachment to Notice of Exemption
COLTON HIGH SCHOOL BASEBALL/SOFTBALL FIELD RENOVATION PROJECT

Colton Joint Unified School District

SUPPLEMENTAL INFORMATION

The Colton Joint Unified School District (District) proposes various improvements to the baseball and softball fields at Colton High School including new or replacement backstops, bleachers, fencing, dugouts, turf and irrigation systems. This supplemental information provides justification for the Categorical Exemption pursuant to the California Environmental Quality Act (CEQA) Guidelines under California Code of Regulations, Title 14 § 15302 and 15303.

1. EXISTING CONDITIONS

PROJECT LOCATION

Colton High School is at 777 West Valley Boulevard at the northeast corner of Valley Boulevard and Rancho Avenue in the City of Colton. The Interstate 10 (I-10) freeway passes approximately 400 feet south of the campus; access from the I-10 to the campus is via ramps at Rancho Avenue (see Figure 1, 2 and 3).

EXISTING CONDITIONS

Colton High School opened in 1913 and is a traditional comprehensive high school, one of three such schools in the District. Enrollment in the 2017-18 school year was 1,956 (CDE 2018). The campus supports academic and administrative buildings, varsity and junior varsity softball and baseball fields, a football stadium, gymnasium and parking lots. The school's academic buildings, softball fields, and tennis courts are east of Rancho Avenue, with the softball fields and tennis courts in the northern part of the campus. The school's baseball fields, stadium with track and field, and gymnasium are west of Rancho Avenue. The District bus garage is located east of the campus across 2nd Street. A pedestrian bridge near the intersection of Rancho Avenue with G Street links the two portions of the campus. The campus spans approximately 43 acres: approximately 27 acres east of Rancho Avenue and 16 acres west of Rancho Avenue. The staff parking lot is in the southeast corner of the campus, with access from 3rd Street. Student parking is in the northeast corner of the west part of the campus, with access from Rancho Avenue. The football/soccer stadium, immediately north of the two baseball fields, was completed in January 2019.

The District operates 18 elementary schools, one state preschool, four middle schools, three traditional comprehensive high schools, one continuation high school and one alternative high school. The District spans about 46.8 square miles including the cities of Colton and Grand Terrace; parts of the cities of San Bernardino, Rialto, and Fontana; and some unincorporated areas of San Bernardino County including the Community of Bloomington. Districtwide enrollment in the 2017-18 school year was 22,561 (CDE 2018).

SURROUNDING LAND USES

The school is surrounded by commercial and residential uses opposite Valley Boulevard to the south; residential uses (mostly single-family) opposite 3rd Street to the east; residential uses opposite F Street to the north; and residential uses opposite Grand Avenue to the west.

2. PROJECT DESCRIPTION

The project consists of improvements to the baseball and softball fields and accessible parking lots (see Figure 4, *Site Plan*). The varsity and junior varsity softball fields would receive improvements including new concrete walkways, new chain link fences and dugout upgrades, including shaded chain-link fencing, roofing and benches. Existing softball bleachers and existing backstops would remain in place.

The varsity and junior varsity baseball fields would receive renovations and improvements, including new masonry backstops, coach boxes, concrete paving, walkways and driveways, natural turf, grading and irrigation systems, new and salvaged chain-link fence enclosures, batting cage enclosures, dugout improvements, and bleachers. Masonry backstops on both fields would have 30-foot tall netting with a 40-foot tall pullback pole with tension tieback.

The varsity baseball field would receive new masonry dugouts and a masonry backstop, while the junior varsity baseball field would receive shaded chain link dugouts. Bleachers at the varsity field would be replaced with 8-row and 5-row bleachers, while bleachers at the junior varsity field would be replaced with 5-row bleachers. New 8-foot chain link fencing with 52-foot safety netting along Grand Ave west of the varsity field would total 60 feet in height to protect residents to the west from flyover baseballs (see Figure 5, *Safety Netting*).

In addition to field upgrades, parking and sidewalk renovations southwest of the softball fields will take place under the proposed project. Parking renovations will include new concrete paving, new striping and signage, adding two additional parking spaces and renovating ADA accessible parking stalls (see Figure 6, *Parking Improvements*).

Parking improvements and sports field improvements would be contained onsite and would not expand into other parts of the campus or result in additional off-site improvements. The project does not involve an increase in student capacity.

CONSTRUCTION

Sports field and parking improvements will be implemented in late April 2020. School administration and the construction contractor will work together to coordinate and stay informed about construction activities, location, and schedule. Contractors will adhere to construction noise regulations to avoid disruption to campus operations.

3. REASONS WHY THE PROJECT IS EXEMPT

The project is exempt from further environmental review under the requirements of the California Environmental Quality Act (Public Resources Code §§ 21000 et seq.) because it is consistent with Class 2, Replacement and Reconstruction, and Class 3, New Construction or Conversion of Small Structures, as explained below.

- » **Class 2, Replacement and Reconstruction (CEQA Guidelines § 15302)** Class 2 consists of replacement or reconstruction of existing structures and facilities where the new structure will be located on the same site as the structure replaced and will have substantially the same purpose and capacity as the structure replaced.
- » **Class 3, New Construction or Conversion of Small Structures (Section 15303)** Class 3 consists of construction and location of limited numbers of new, small facilities or structures; installation of small new equipment and facilities in small structures; and the conversion of existing small structures from one use to another where only minor modifications are made in the exterior of the structure. The numbers of structures described in this section are the maximum allowable on any legal parcel.

The project consists of new improvements and replacement of existing components of the baseball and softball fields. No changes in occupancy capacities or square footage increases will occur, and no off-campus improvements will occur. Existing uses of the facility would stay the same under the proposed project.

4. REVIEW OF EXCEPTIONS TO THE CATEGORICAL EXEMPTION

The project has been reviewed under CEQA Guidelines § 15300.2 - Exceptions, for any characteristics or circumstances that might invalidate findings that the project is exempt from CEQA. Each exception is listed below followed by an assessment of whether that exception applies to the project.

- (a) **Location.** Classes 3,4,5,6 and 11 are qualified by consideration of where the project would be located—a project that is ordinarily insignificant in its impact on the environment may in a particularly sensitive environment be significant. Therefore, these classes are considered to apply all instances, except where the project may impact on an environmental resource of hazardous or critical concern where designated, precisely mapped and officially adopted pursuant to law by federal, state, or local agencies.

The project site is fully developed as a high school in a built-out urban environment. The campus has buildings, asphalt hardcourts and parking lots, concrete driveways and walkways, turf playfields, and ornamental landscaping. Due to the school's developed nature and frequent human disturbance, it does not contain any sensitive biological species or habitat. No mapped wetlands exist on the site (FWS 2019). Additionally, there is no risk of hazardous materials or substances on the site (see section (e) below). Therefore, this exception does not apply to the project.

- (b) **Cumulative Impacts.** All exemptions for these classes are inapplicable when the cumulative impact of successive projects of the same type in the same place, over time is significant.

A \$225 million bond fund, Measure G, for needed repairs, upgrades and new construction projects within the district, was approved by voters in 2008. The following related projects at Colton High School are/were financed in whole or in part through Measure G:

- **New Math & Science Building:** completed 2011
- **Stadium Renovation:** completed January 2019
- **Kitchen and Multipurpose Room Renovation**
- **Pedestrian Bridge Repair**
- **Painting**

Impacts of the proposed project would not combine with impacts of related projects to cause significant cumulative impacts. Only one of the four related projects consists of athletic facilities improvements (the stadium modernization). The seasons for the sports played on the stadium field (football and soccer) differ from that for baseball and softball. The pedestrian bridge crosses Rancho Avenue between the baseball fields to the west and the softball fields to the east. Bridge repairs will facilitate access between the baseball and softball fields and impacts of the bridge repair project will not combine with those of the proposed project to cause significant cumulative impacts.

Measure G improvements have been made, and others are planned, at schools throughout the District. The District encompasses about 47 square miles spanning approximately 23 miles east to west. Thus, impacts from Measure G projects at one school (such as traffic or noise) would not combine with impacts of projects at other schools to cause significant cumulative impacts. The cumulative impacts exception does not apply to the proposed project.

- (c) **Significant Effects.** A categorical exemption shall not be used for an activity where there is a reasonable possibility that the activity will have a significant effect on the environment due to unusual circumstances.

The project site is fully developed as a high school in a built-out urban environment. No unusual circumstances are present on or near the site, and project implementation would not cause significant impacts due to unusual circumstances. The Significant Effects exception does not apply to the proposed project.

- (d) **Scenic Highways.** A categorical exemption shall not be used for a project which may result in damage to scenic resources, including but not limited to, trees, historic buildings, rock outcroppings or similar resources, within a highway officially designated as a state scenic highway.

There are no designated state scenic highways near the Colton High School campus. According to the California Department of Transportation (Caltrans) California Scenic Highway Mapping System, the nearest designated state scenic highway to the school is State Route 2 (SR-2, the Angeles Crest Highway) about 27 miles to the northwest (Caltrans 2019). Project implementation would not impact scenic resources in SR-2. The project site is developed with baseball and softball fields; there are no scenic resources onsite that would be impacted by project implementation. Therefore, the scenic highways exception would not apply to the proposed project.

- (e) **Hazardous Waste Sites.** A categorical exemption shall not be used for a project located on a site which is included on any list compiled pursuant to Government Code § 65962.5.

California Government Code Section 65962.5 requires the compiling of lists of the following types of hazardous materials sites: hazardous waste facilities subject to corrective action; hazardous waste discharges for which the State Water Quality Control Board has issued certain types of orders; public drinking water wells containing detectable levels of organic contaminants; underground storage tanks with reported unauthorized releases; and solid waste disposal facilities from which hazardous waste has migrated.

Five environmental databases were searched for hazardous materials sites and within a quarter mile radius:

- » GeoTracker. State Water Resources Control Board (SWRCB 2015)
- » EnviroStor. Department of Toxic Substances Control (DTSC 2019)
- » EIScreen. US Environmental Protection Agency (USEPA 2018)
- » EnviroMapper. US Environmental Protection Agency (USEPA n.d.)
- » Solid Waste Information System. California Department of Resources Recycling and Recovery (CalRecycle 2019)
- » The database search returned six sites within a 0.25-mile (1,320 feet) radius, presented in Table 1.

Table 1 Hazardous Waste Sites within 0.25 mile

Site Name & Address	Database	Identifier	Cleanup Status	Proximity to site
Colton High School (Colton Joint Unified School District) 777 W. Valley Blvd.	GeoTracker	Leaking Underground Storage Tank (LUST)	Diesel release affected soil; case closed 1997	Project Site
	EnviroStor	School site investigation for lead in soil from lead- based paint	No Further Action determination 2005	Project Site
ARCO PETROLEUM PROD #1569 (and Arco #1569 Former)	GeoTracker	Permitted Underground Storage Tank (UST)	n/a	900 feet South
	GeoTracker	LUST	Gasoline release affected drinking water aquifer; case closed 1994	900 feet South
	GeoTracker	LUST	Gasoline release affected drinking water aquifer; case closed 2015	900 feet South
C R PIER MFG; 275 Rancho Ave.	EnviroMapper	Small Quantity Generator of	n/a	500 feet south

		hazardous wastes (SQG)		
--	--	------------------------	--	--

The two cases on the Colton High School campus—a leaking underground storage tank (LUST) case and a school site investigation—have been closed. While the LUST site is one of the types of sites listed pursuant to California Government Code Section 65962.5, the site is not currently an environmental concern either for the school or the proposed project. The Hazardous Waste Sites exception does not apply to the proposed project.

- (f) **Historical Resources.** A categorical exemption shall not be used for a project which may cause a substantial adverse change in the significance of historical resources. Under Public Resource Code § 21084.1, a historical resource is a resource listed in or determined to be eligible for listing in the California Register of Historical Resources. Additionally, historical resources included in a local register of historical resources are presumed to be historically or culturally significant, and a lead agency can determine whether the resource may be an historical resource.

Colton High School is not listed on the National Register of Historic Places (NPS 2018) or as a California Historical Landmark or California Point of Historical Interest (OHS 2018). Colton High School is described on a City of Colton *Colton School History* webpage; but is not identified on that page as being listed on a City register of historical resources (City of Colton 2018). Project development would not damage a listed historical resource, and the Historic Sites exception does not apply to the proposed project.

5. CONCLUSION

The proposed project at Colton High School is exempt from CEQA review pursuant to CEQA Guidelines Section 15302 and 15303. As substantiated in this document, the proposed project would not meet the conditions specified in § 15300.2, Exceptions, of the CEQA Guidelines, and the project is categorically exempt under Class 2 and Class 3.

6. REFERENCES

California Department of Education (CDE). 2018, October 5. Dataquest. <http://dq.cde.ca.gov/dataquest/>.

California Department of Resources Recycling and Recovery (CalRecycle). 2019. SWIS Facticity/Site Search. <https://www2.calrecycle.ca.gov/SWFacilities/Directory>

California Department of Transportation (Caltrans). 2011, September 7. California Scenic Highway Mapping System. http://www.dot.ca.gov/hq/LandArch/16_livability/scenic_highways/.

City of Colton. 2018, October 18. Colton School History. http://coltonsd.com/?page_id=34.

Department of Toxic Substances Control (DTSC). 2019. EnviroStor. <http://www.envirostor.dtsc.ca.gov/public/>.

National Park Service (NPS). 2018, October 18. National Register of Historic Places. <https://www.nps.gov/maps/full.html?mapId=7ad17cc9-b808-4ff8-a2f9-a99909164466>.

State Water Resources Control Board (SWRCB). 2015. GeoTracker. <http://geotracker.waterboards.ca.gov/>.

Office of Historic Preservation (OHP). 2018, October 18. California Historical Resources. <http://ohp.parks.ca.gov/listedresources/>.

US Environmental Protection Agency (USEPA). 2018. EJSCREEN. <https://ejscreen.epa.gov/mapper/>.

US Environmental Protection Agency (USEPA). n.d. EnviroMapper for EnviroFacts. <https://www3.epa.gov/enviro/index.html>.

U.S. Fish & Wildlife Service (FWS). 2019, May 5. National Wetlands Inventory – Wetlands Mapper. <https://www.fws.gov/wetlands/data/mapper.HTML>.

Figure 1 - Regional Location
1. Introduction

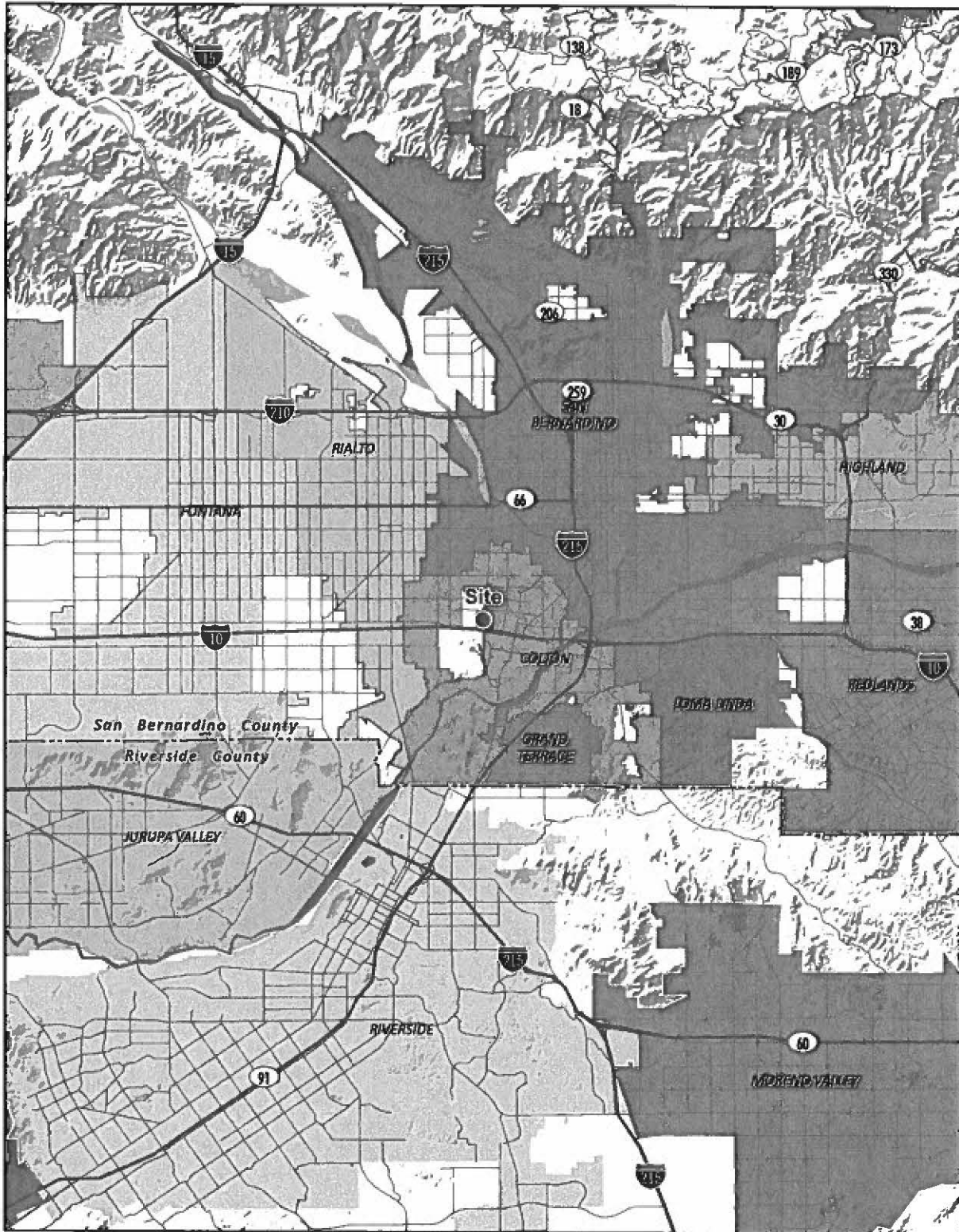

Note: Unincorporated county areas are shown in white.
Source: ESRI, 2019

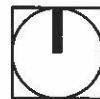
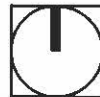

Figure 2 - Local Vicinity
1. Introduction



0 2,000
Scale (Feet)



Source: ESRI, 2019

PlaceWorks

Figure 3 - Aerial Photograph
1. Introduction



..... Project Boundary

----- Project Boundary

0 400
Scale (Feet)

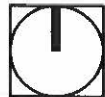

Source: Nearnap, 2019

Figure 4 - Site Plan
1. Introduction

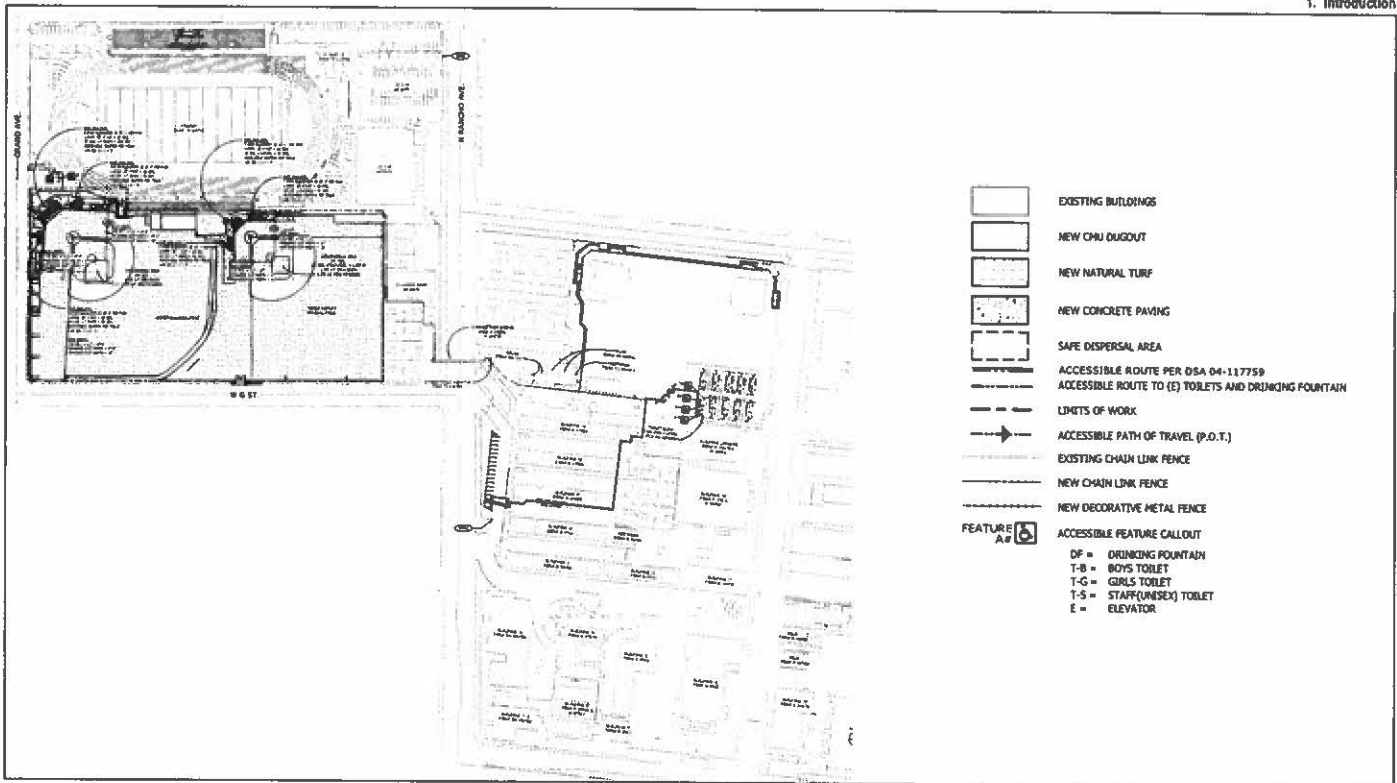

Figure 5 - Baseball Netting
1. Introduction

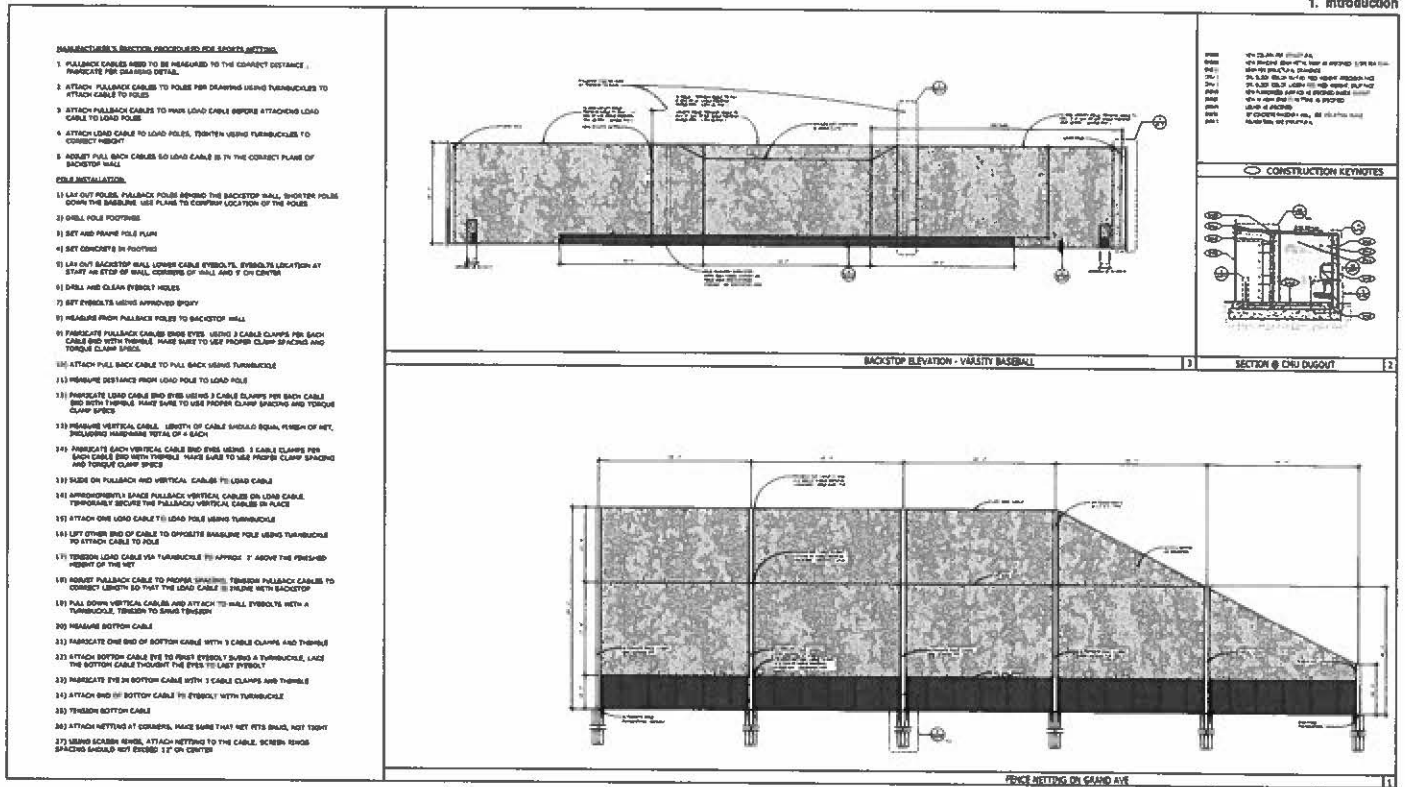

Figure 5 - Parking Improvements
1. Introduction

