

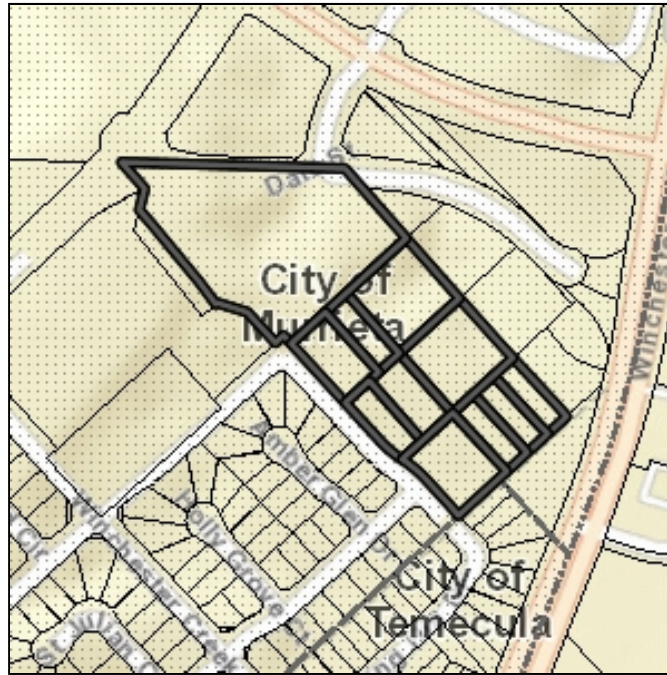

Riverside County Parcel Report

APN(s) 913210005, 913210006, 913210007, 913210010, 913210011, 913210012, 913210013, 913210032
913210034, 913210035

MAPS/IMAGES



PARCEL

APN

- [913-210-005-7](#)
- [913-210-006-8](#)
- [913-210-007-9](#)
- [913-210-010-1](#)
- [913-210-011-2](#)
- [913-210-012-3](#)
- [913-210-013-4](#)
- [913-210-032-1](#)
- [913-210-033-2](#)
- [913-210-034-3](#)
- [913-210-035-4](#)

Previous APN

- 200-800-551
- 200-800-550
- 200-800-549
- 200-800-540
- 200-800-541
- 200-800-548
- 200-800-719
- 913-210-031
- 000-000-000
- 000-000-000
- 000-000-000

Owners Not Available Online

Address

913-210-005
NOT AVAILABLE

913-210-006
NOT AVAILABLE

913-210-007
NOT AVAILABLE

913-210-010
NOT AVAILABLE

913-210-011
NOT AVAILABLE

913-210-012
NOT AVAILABLE

913-210-013
NOT AVAILABLE

913-210-032
NOT AVAILABLE

913-210-033
NOT AVAILABLE

913-210-034
NOT AVAILABLE

913-210-035
NOT AVAILABLE

Mailing Address

913-210-005
1133 N RAMONA BLV
SAN JACINTO CA 92582

913-210-006
1133 N RAMONA BLV
SAN JACINTO CA 92582

913-210-007
1133 N RAMONA BLV
SAN JACINTO CA 92582

913-210-010
31938 TEMECULA PKY A439
TEMECULA CA 92592

913-210-011
31938 TEMECULA PKY A369
TEMECULA CA 92592

913-210-012
31938 TEMECULA PKY A369
TEMECULA CA 92592

913-210-013
31938 TEMECULA PKY A369
TEMECULA CA 92592

913-210-032
P O BOX 1152
TEMECULA CA 92593

913-210-033
31938 TEMECULA PKY A369
TEMECULA CA 92592

913-210-034
31938 TEMECULA PKY A369
TEMECULA CA 92592

913-210-035
1133 N RAMONA BLV
SAN JACINTO CA 92582

Legal Description

913-210-005
Recorded Book/Page: [MB 8/359](#)
Subdivision Name: TR T L W C

Lot/Parcel: 191
Block:
Tract Number: 0

913-210-006
Recorded Book/Page: [MB 8/359](#)
Subdivision Name: TR T L W C

Lot/Parcel: 191
Block:
Tract Number: 0

913-210-007
Recorded Book/Page: [MB 8/359](#)
Subdivision Name: TR T L W C

Lot/Parcel: 191
Block:
Tract Number: 0

913-210-010
Recorded Book/Page: [MB 8/359](#)
Subdivision Name: TR T L W C

Lot/Parcel: 191
Block:
Tract Number: 0

913-210-011
Recorded Book/Page: [MB 8/359](#)
Subdivision Name: TR T L W C

Lot/Parcel: 191
Block:
Tract Number: 0

913-210-012
Recorded Book/Page: [MB 8/359](#)
Subdivision Name: TR T L W C

Lot/Parcel: 191
Block:
Tract Number: 0

913-210-013
Recorded Book/Page: [MB 8/359](#)
Subdivision Name: TR T L W C

Lot/Parcel: 191
Block:
Tract Number: 0

913-210-032
Recorded Book/Page: [MB 8/359](#)
Subdivision Name: TR T L W C

Lot/Parcel: 191
Block:
Tract Number: 0

913-210-033
Recorded Book/Page: [MB 8/359](#)
Subdivision Name: TR T L W C

Lot/Parcel: 191
Block:
Tract Number: 0

913-210-034
Recorded Book/Page: [MB 8/359](#)
Subdivision Name: TR T L W C

Lot/Parcel: 191
Block:
Tract Number: 0

913-210-035
Recorded Book/Page: [MB 8/359](#)
Subdivision Name: TR T L W C

Lot/Parcel: 191
Block:
Tract Number: 0

Lot Size

913-210-005
Recorded lot size is 0.38 acres

913-210-006
Recorded lot size is 0.36 acres

913-210-007
Recorded lot size is 0.36 acres

913-210-010
Recorded lot size is 0.55 acres

913-210-011
Recorded lot size is 1.1 acres

913-210-012
Recorded lot size is 1.1 acres

913-210-013
Recorded lot size is 0.37 acres

913-210-032
Recorded lot size is 5.06 acres

913-210-033
Recorded lot size is 0.58 acres

913-210-034
Recorded lot size is 0.38 acres

913-210-035
Recorded lot size is 0.86 acres

Roof Type: UNKNOWN
Number of Stories:
Pool: NO
Central Cool: NO
Central Heat: NO

913-210-011
Year Constructed: 0000
Number of Baths: 0
Number of Bedrooms: 0
Construction Type: SPECIAL CONSTRUCTION

Garage Type:
Property Area (sq ft): 0
Roof Type: UNKNOWN
Number of Stories:
Pool: NO
Central Cool: NO
Central Heat: NO

913-210-012
Year Constructed: 0000
Number of Baths: 0
Number of Bedrooms: 0
Construction Type: SPECIAL CONSTRUCTION

Garage Type:
Property Area (sq ft): 0
Roof Type: UNKNOWN
Number of Stories:
Pool: NO
Central Cool: NO
Central Heat: NO

913-210-013
Year Constructed: 0000
Number of Baths: 0
Number of Bedrooms: 0
Construction Type: SPECIAL CONSTRUCTION

Garage Type:
Property Area (sq ft): 0
Roof Type: UNKNOWN
Number of Stories:
Pool: NO
Central Cool: NO
Central Heat: NO

913-210-032
Year Constructed: 0000
Number of Baths: 0
Number of Bedrooms: 0
Construction Type: SPECIAL CONSTRUCTION

Garage Type:
Property Area (sq ft): 0
Roof Type: UNKNOWN
Number of Stories:
Pool: NO
Central Cool: NO
Central Heat: NO

913-210-033
Year Constructed: 0000
Number of Baths: 0
Number of Bedrooms: 0
Construction Type: SPECIAL CONSTRUCTION

Garage Type:
Property Area (sq ft): 0

Property Characteristics

913-210-005
Year Constructed: 0000
Number of Baths: 0
Number of Bedrooms: 0
Construction Type: SPECIAL CONSTRUCTION

Garage Type:
Property Area (sq ft): 0
Roof Type: UNKNOWN
Number of Stories:
Pool: NO
Central Cool: NO
Central Heat: NO

913-210-006
Year Constructed: 0000
Number of Baths: 0
Number of Bedrooms: 0
Construction Type: SPECIAL CONSTRUCTION

Garage Type:
Property Area (sq ft): 0
Roof Type: UNKNOWN
Number of Stories:
Pool: NO
Central Cool: NO
Central Heat: NO

913-210-007
Year Constructed: 0000
Number of Baths: 0
Number of Bedrooms: 0
Construction Type: SPECIAL CONSTRUCTION

Garage Type:
Property Area (sq ft): 0
Roof Type: UNKNOWN
Number of Stories:
Pool: NO
Central Cool: NO
Central Heat: NO

913-210-010
Year Constructed: 0000
Number of Baths: 0
Number of Bedrooms: 0
Construction Type: SPECIAL CONSTRUCTION

Garage Type:
Property Area (sq ft): 0

Garage Type:
 Property Area (sq ft): 0
 Roof Type: UNKNOWN
 Number of Stories:
 Pool: NO
 Central Cool: NO
 Central Heat: NO

913-210-034
 Year Constructed: 0000
 Number of Baths: 0
 Number of Bedrooms: 0
 Construction Type: SPECIAL CONSTRUCTION

Garage Type:
 Property Area (sq ft): 0
 Roof Type: UNKNOWN
 Number of Stories:
 Pool: NO
 Central Cool: NO
 Central Heat: NO

913-210-035
 Year Constructed: 0000
 Number of Baths: 0
 Number of Bedrooms: 0
 Construction Type: SPECIAL CONSTRUCTION

Garage Type:
 Property Area (sq ft): 0
 Roof Type: UNKNOWN
 Number of Stories:
 Pool: NO
 Central Cool: NO
 Central Heat: NO

| | |
|--|--|
| General Plan Policy Overlays | Not in a General Plan Policy Area |
| Area Plan (RCIP) | Southwest Area |
| General Plan Policy Areas | Not in a General Plan Policy Area |
| Zoning Classifications (ORD. 348) | Zoning: In a city CZ Number: |
| Zoning Overlays | Not in a Zoning Overlay |
| Historical Preservation Districts | Not in a Historical Preservation District |
| Agricultural Preserve | Not in an Agricultural Preserve |
| Airport Influence Areas | FRENCH VALLEY |
| Airport Compatibility Zones | FRENCH VALLEY, ZONE D |
| Zoning Districts/Areas | Not in a Zone District/Area |
| Community Advisory Councils | Not in a Community Advisory Council |
| Residential Permit Statistics | N/A Expected Units: BRS Permit Units: Final Issued Active Current Permits: Cumulative Total: % of Expected: |
| ENVIRONMENTAL more... | |
| CVMSHCP (Coachella Valley Multi-Species Habitat Conservation Plan) Plan Area | NOT IN THE COACHELLA VALLEY MSHCP FEE |
| CVMSHCP (Coachella Valley Multi-Species Habitat Conservation Plan) Conservation Area | NOT COACHELLA VALLEY CONSERVATION |
| CVMSHCP Fluvial Sand Transport Special Provision Areas | NOT IN A FLUVIAL SAND TRANSPORT |
| WRMSHCP (Western Riverside County Multi-Species Habitat Conservation Plan) Plan Area | WESTERN RIVERSIDE COUNTY |
| WRMSHCP (Western Riverside County Multi-Species Habitat Conservation Plan) Cell Group | Not in a Cell Group |
| WRMSHCP Cell Number | Not in a Cell Number |

| | |
|-------------------------------------|---|
| Supervisorial District | CHUCK WASHINGTON, DISTRICT 3 |
| Township/Range | T7SR3W SEC 24 RHO |
| Elevation Range (ft.) | 1120 - 1172 |
| Thomas Bros. Maps Page/Grid | Page: 928 GRID: J6 Page: 928 GRID: J7 |
| Indian Tribal Land | Not in a Tribal Land |
| City Boundary | MURRIETA |
| City Spheres of Influence | Not in a city sphere |
| Annexation Date | 11/21/2001 12:00:00 AM |
| LAFCO Case | 2001-15-3 |
| Proposals | N/A |
| March Joint Powers Authority | Not in the jurisdiction of the March Joint Powers Authority |
| County Service Area | Not in a County Service Area |
| PLANNING more... | |
| Specific Plans | Not in a Specific Plan |
| Land Use Designations | CITY |

| | |
|---|--|
| HANS/ERP (Habitat Acquisition and Negotiation Strategy/Expedited Review Process) | Project: N/A Conserve: Status: Notes: Intake Num: LMS Case: |
|---|--|

| | |
|--------------------------|--|
| Vegetation (2005) | California Buckwheat Alliance Urban Interface Mapping Unit Urban or development Mapping Unit |
|--------------------------|--|

FIRE

| | |
|---|---------------------------|
| Fire Hazard Classification (Ord. 787) | Not in a Fire Hazard Zone |
|---|---------------------------|

| | |
|---------------------------------|-----------------------------------|
| Fire Responsibility Area | Not in a Fire Responsibility Area |
|---------------------------------|-----------------------------------|

DEVELOPMENT FEES

| | |
|---|---------------------------------------|
| CVMSHCP (Coachella Valley Multi-Species Habitat Conservation Plan) Fee Area (Ord 875) | NOT IN THE COACHELLA VALLEY MSHCP FEE |
|---|---------------------------------------|

| | |
|---|--------------------------|
| WRMSHCP (Western Riverside County Multi-Species Habitat Conservation Plan) Fee Area (Ord 810) | WESTERN RIVERSIDE COUNTY |
|---|--------------------------|

| | |
|---|---|
| Western TUMF (Transportation Uniform Mitigation Fee Ord. 824) | IN OR PARTIALLY WITHIN A TUMF FEE AREA. |
|---|---|

| | |
|--|----------------------------------|
| Eastern TUMF (Transportation Uniform Mitigation Fee Ord. 673) | NOT IN THE EASTERN TUMF FEE AREA |
|--|----------------------------------|

| | |
|---|--|
| Road & Bridge Benefit District | NOT IN AN ROAD/BRIDGE BENEFIT DISTRICT |
|---|--|

| | |
|--|-------------------------|
| DIF (Development Impact Fee Area Ord. 659) | SOUTHWEST AREA, AREA 19 |
|--|-------------------------|

| | |
|--|---|
| SKR Fee Area (Stephen's Kagaroo Rat Ord. 663.10) | In or partially within the SKR Fee Area |
|--|---|

| | |
|-------------------------------|---|
| Development Agreements | Agreement # 29 Amendment # Expiration Date Line Agreement # 29 Amendment # Expiration Date Line Agreement # 29 Amendment # Expiration Date Line |
|-------------------------------|---|

TRANSPORTATION more...

Circulation Element

| | |
|--|--------------------------------------|
| Circulation Element Ultimate Right-of-Way | IN OR PARTIALLY WITHIN A CIRCULATION |
|--|--------------------------------------|

| | |
|-----------------------|------|
| Road Book Page | 128C |
|-----------------------|------|

| | |
|----------------------------------|---|
| Transportation Agreements | Contract Number: Not in a Trans Agreement |
|----------------------------------|---|

| | |
|---|--|
| CETAP (Community and Environmental Transportation Acceptability Process) Corridors | In or partially within a CETAP Corridor. |
|---|--|

HYDROLOGY

| | |
|---------------------------|--------------------------------|
| Flood Plain Review | OUTSIDE FLOODPLAIN, REVIEW NOT |
|---------------------------|--------------------------------|

| | |
|-------------------------------|--------------------------------|
| Flood Control District | RIVERSIDE COUNTY FLOOD CONTROL |
|-------------------------------|--------------------------------|

| | |
|------------------|-----------------|
| Watershed | SANTA MARGARITA |
|------------------|-----------------|

| | |
|-----------------------|----------------------------------|
| Water District | EASTERN MUNICIPAL WATER DISTRICT |
|-----------------------|----------------------------------|

GEOLOGIC

| | |
|-------------------|---------------------|
| Fault Zone | NOT IN A FAULT ZONE |
|-------------------|---------------------|

| | |
|---------------|---------------------|
| Faults | NOT IN A FAULT LINE |
|---------------|---------------------|

| | |
|-------------------------------|-------------------------------------|
| Liquefaction Potential | High Low Moderate Very low |
|-------------------------------|-------------------------------------|

| | |
|-------------------|-------------|
| Subsidence | Susceptible |
|-------------------|-------------|

| | |
|------------------------------------|--|
| Paleontological Sensitivity | HIGH SENSITIVITY (HIGH A): BASED ON GEOLOGIC FORMATIONS OR MAPPABLE ROCK UNITS THAT ARE ROCKS THAT CONTAIN FOSSILIZED BODY ELEMENTS, AND TRACE FOSSILS SUCH AS TRACKS, NESTS AND EGGS. THESE FOSSILS OCCUR ON OR BELOW THE SURFACE |
|------------------------------------|--|

MISCELLANEOUS

| | |
|-------------------------|-------------------------|
| School Districts | MURRIETA VALLEY UNIFIED |
|-------------------------|-------------------------|

| | |
|--------------------|--------------------|
| Communities | Not in a community |
|--------------------|--------------------|

| | |
|-------------------------------------|---------|
| Lighting (Ord. 655) | Zone: B |
|-------------------------------------|---------|

| | |
|--------------------------|-----|
| 2010 Census Tract | 505 |
|--------------------------|-----|

| | |
|-----------------|---|
| Farmland | LOCAL IMPORTANCE URBAN-BUILT UP LAND |
|-----------------|---|

| | |
|----------------------|------------------|
| Special Notes | NO SPECIAL NOTES |
|----------------------|------------------|

| | |
|--|---|
| Tax Rate Area & District Name | 024256 - CITY OF MURRIETA 024256 - CITY OF MURRIETA LIBRARY 024256 - CSA 152 024256 - ELS MURRIETA ANZA RESOURCE |
|--|---|

024256 - ELSINORE AREA ELEM SCHOOL
 024256 - EMWD
 024256 - EMWD IMP DIST B
 024256 - EMWD IMP DIST U-8
 024256 - FLOOD CONTROL ADMIN
 024256 - FLOOD CONTROL ZN 7
 024256 - GENERAL
 024256 - GENERAL PURPOSE
 024256 - MT SAN JACINTO JR COLLEGE
 024256 - MURRIETA CITY CSD
 024256 - MURRIETA FIRE PROT DIST-CITY
 024256 - MURRIETA UNIFIED
 024256 - MURRIETA UNIFIED B&I
 024256 - MWD EAST 1301999
 024256 - RCWD JT WATER
 024256 - RCWD R DIV DS
 024256 - RIV CO REGIONAL PARK & OPEN SF
 024256 - RIVERSIDE CO OFC OF EDUCATION
 024256 - SO. CALIF,JT(19,30,33,36,37,56)
 024256 - TEMECULA PUBLIC CEMETERY
 024256 - VALLEY HEALTH SYSTEM HOSP
 024257 - CITY OF MURRIETA
 024257 - CITY OF MURRIETA LIBRARY
 024257 - CSA 152
 024257 - ELS MURRIETA ANZA RESOURCE
 024257 - ELSINORE AREA ELEM SCHOOL
 024257 - EMWD
 024257 - EMWD IMP DIST B
 024257 - EMWD IMP DIST U-8
 024257 - FLOOD CONTROL ADMIN
 024257 - FLOOD CONTROL ZN 7
 024257 - GENERAL
 024257 - GENERAL PURPOSE
 024257 - MT SAN JACINTO JR COLLEGE
 024257 - MURRIETA CITY CSD
 024257 - MURRIETA FIRE PROT DIST-CITY
 024257 - MURRIETA UNIFIED
 024257 - MURRIETA UNIFIED B&I
 024257 - MWD EAST 1301999
 024257 - RCWD JT WATER
 024257 - RCWD R DIV DS
 024257 - RIV CO REGIONAL PARK & OPEN SF
 024257 - RIVERSIDE CO OFC OF EDUCATION
 024257 - SO. CALIF,JT(19,30,33,36,37,56)
 024257 - TEMECULA PUBLIC CEMETERY
 024257 - VALLEY HEALTH SYSTEM HOSP

PLUS PERMITS & CASES

Administrative Cases

| Case | Case Description | Status |
|----------|------------------------|--------|
| MT010678 | PM29082 PHASES 1 AND 2 | PAID |

Building and Safety Cases

| Case | Case Description | Status |
|-----------|-----------------------------|---------|
| BGR000103 | ROUGH GRADING FOR PM29082-1 | EXPIRED |

Code Cases

| Case | Case Description | Status |
|------|------------------|--------|
| N/A | N/A | N/A |

Fire Cases

| Case | Case Description | Status |
|-------------|------------------|--------|
| FHAZ0006783 | | CLOSED |
| FHAZ0109674 | | CLOSED |
| FHAZ9407633 | | CLOSED |
| FHAZ9507013 | | CLOSED |
| FHAZ9603068 | | CLOSED |
| FHAZ9708515 | | CLOSED |
| FHAZ9808303 | | CLOSED |

Planning Cases

| Case | Case Description | Status |
|-----------|---|----------|
| CZ06491 | CHANGE ZONE TO CONFORM WITH SP | APPROVED |
| EA37559 | EA FOR PM29082 | APPROVED |
| EA37817 | EA FOR CZ06491 | APPROVED |
| LLA04300 | ADJUST ONE LOT LINE FOR PHASING OF PM29082 | APPROVED |
| LLA04491 | ADJ LL BETWEEN LOTS TO ACCOMMODATE FUTURE BLDGS | APPROVED |
| PM29082 | DIVIDE 17.67 ACRES INTO 19 COMMERCIAL LOTS | APPROVED |
| SP00220A4 | RECONFIG & CHANGE LAND USE IN PA 20,21 & 22 SP220 | APPROVED |
| UPH00196 | PHASE 1 OF 3 FOR COMMERCIAL PM29082 | APPROVED |
| UPH00197 | PHASE 2 OF 3 FOR COMMERCIAL PM29082 | APPROVED |

Survey Cases

| Case | Case Description | Status |
|----------|------------------|--------|
| MAP29082 | | ISSUED |

Transportation Cases

| Case | Case Description | Status |
|------|------------------|--------|
| N/A | N/A | N/A |

DEPARTMENT of ENVIRONMENTAL HEALTH PERMITS**Septic Permits**

| Record Id | Application Date | Plan Check Approved Date | Final Inspection Date | Approved Date |
|-----------|------------------|--------------------------|-----------------------|---------------|
| N/A | N/A | N/A | N/A | N/A |

Well Water Permits

| Record Id | PE | Permit Paid Date | Permit Approved Date | Well Finaled Date |
|-----------|-----|------------------|----------------------|-------------------|
| N/A | N/A | N/A | N/A | N/A |

*** DISCLAIMER ***

Maps, permit information and data are to be used for reference purposes only. Map features are approximate, and are not necessarily accurate to surveying or engineering standards. The County of Riverside makes no warranty or guarantee as to the content (the source is often third party), accuracy, timeliness, or completeness of any of the data provided, and assumes no legal responsibility for the information contained on this map. Any use of this product with respect to accuracy and precision shall be the sole responsibility of the user.