

NOTICE OF PREPARATION

To: State Clearinghouse;
Responsible and Trustee Agencies;
Interested Individuals

From: Mountain View/Los Altos Union High School District
1299 Bryant Avenue
Mountain View, CA 94040
Contact: Mike Mathiesen, Associate Superintendent
(650) 940-4667

Subject: Notice of Preparation of a Draft Environmental Impact Report

The Mountain View/Los Altos Union High School District (District) will be the Lead Agency and will prepare an environmental impact report for the project identified below. The District welcomes your input regarding the scope and content of the environmental information that is relevant to your area of interest, or to your agency's statutory responsibilities in connection with the proposed project. If you are affiliated with a public agency, this EIR may be used by your agency when considering subsequent approvals related to the project.

The project description, location, and probable environmental effects that will be analyzed in the EIR for the project are attached. According to state law, the deadline for your response is 30 days after receipt of this notice. However, we would appreciate an earlier response, if possible.

If you have any comments on this Notice of Preparation or the proposed project, please identify a contact person and send your correspondence to:

Mountain View/Los Altos Union High School District
Attn: Mike Mathiesen, Associate Superintendent
1299 Bryant Avenue, Mountain View, CA 94040
Phone: (650) 940-4667, e-mail: mike.mathiesen@mvla.net

The Draft EIR for the Mountain View High School Lighting Project is currently being prepared. A separate EIR Notice of Availability will circulate when the Draft EIR becomes available for public review and comments.

The District will hold a neighborhood meeting and an EIR public scoping meeting to describe the proposed project and the environmental review process, and to obtain your input on the EIR analysis for the proposal. The meeting will be held at 7:00 p.m. on February 10, 2020 at the District Office at 1299 Bryant Avenue, Mountain View, CA 94040.

Project Title: Mountain View High School Stadium Lights & Public Address System

Date: January 17, 2020

Signature: 
Title: Associate Superintendent
Telephone: (650) 940-4667

**NOTICE OF PREPARATION OF
A DRAFT ENVIRONMENTAL IMPACT REPORT
FOR THE MOUNTAIN VIEW HIGH SCHOOL STADIUM LIGHTS & PUBLIC ADDRESS
SYSTEM PROJECT**

January 2020

Introduction

The purpose of an Environmental Impact Report (EIR) is to inform decision makers and the general public of the environmental effects of the proposed project that an agency may implement or approve. The EIR process is intended to provide information sufficient to evaluate a project and its potential for significant impacts on the environment; to examine methods of reducing adverse impacts; and to consider alternatives to the project.

The EIR for the proposed project will be prepared and processed in accordance with the California Environmental Quality Act (CEQA) of 1970, as amended. In accordance with the requirements of CEQA, the EIR will include the following:

- A summary of the project;
- A project description;
- A description of the existing environmental setting, environmental impacts, and mitigation measures for the project;
- Alternatives to the project as proposed; and
- Environmental consequences, including (a) any significant environmental effects which cannot be avoided if the project is implemented; (b) any significant irreversible and irretrievable commitment of resources; (c) the growth inducing impacts of the proposed project; and (d) cumulative impacts

Project Location

The project site is the track and sports field at the Mountain View High School campus at 3535 Truman Avenue in the City of Mountain View. The field is located at the southwestern corner of campus and is bounded by Truman Avenue to the west and Oak Avenue to the south. Regional and vicinity maps of the project site are shown on Figure 1 and Figure 2, respectively.

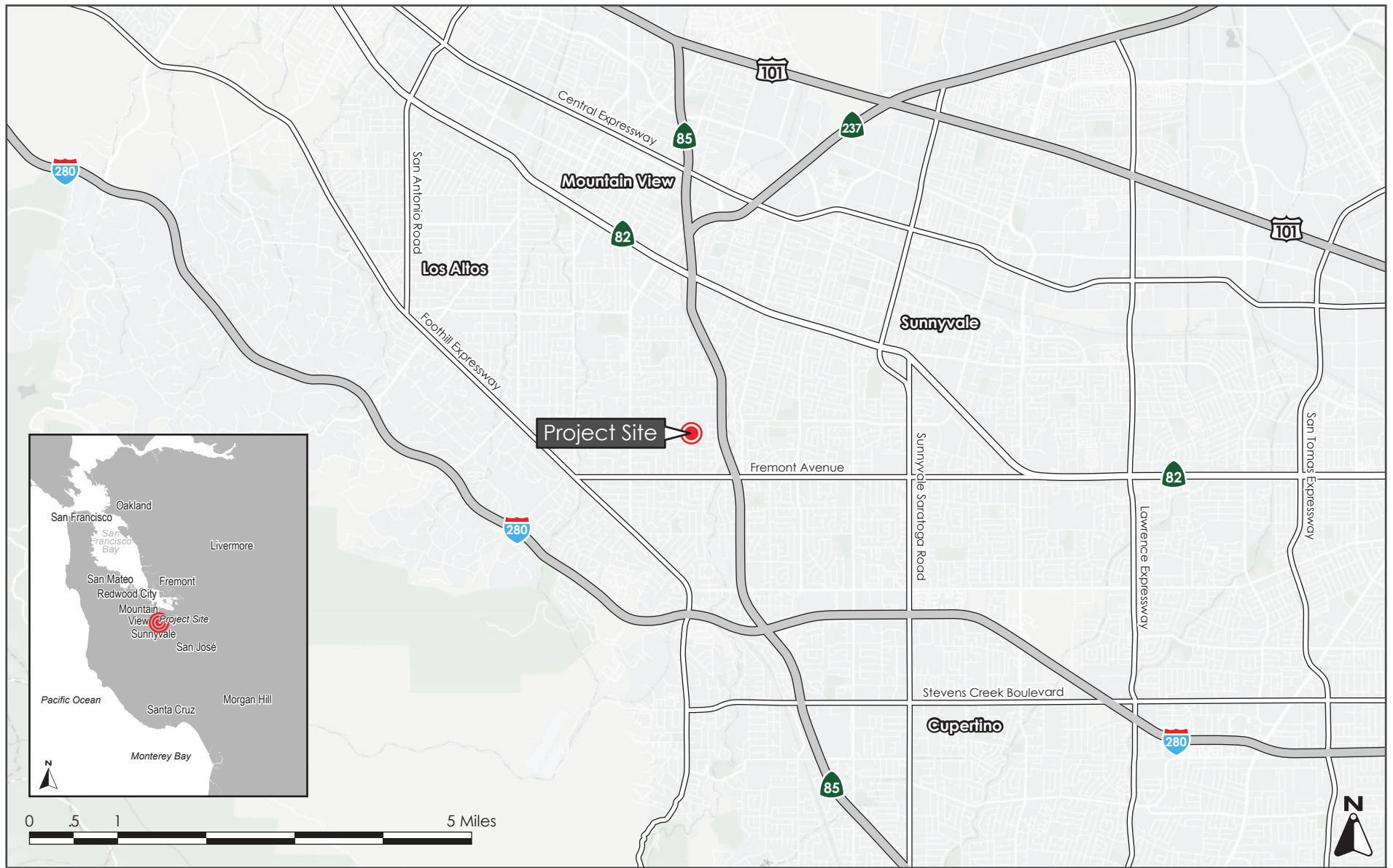

REGIONAL MAP

FIGURE 1

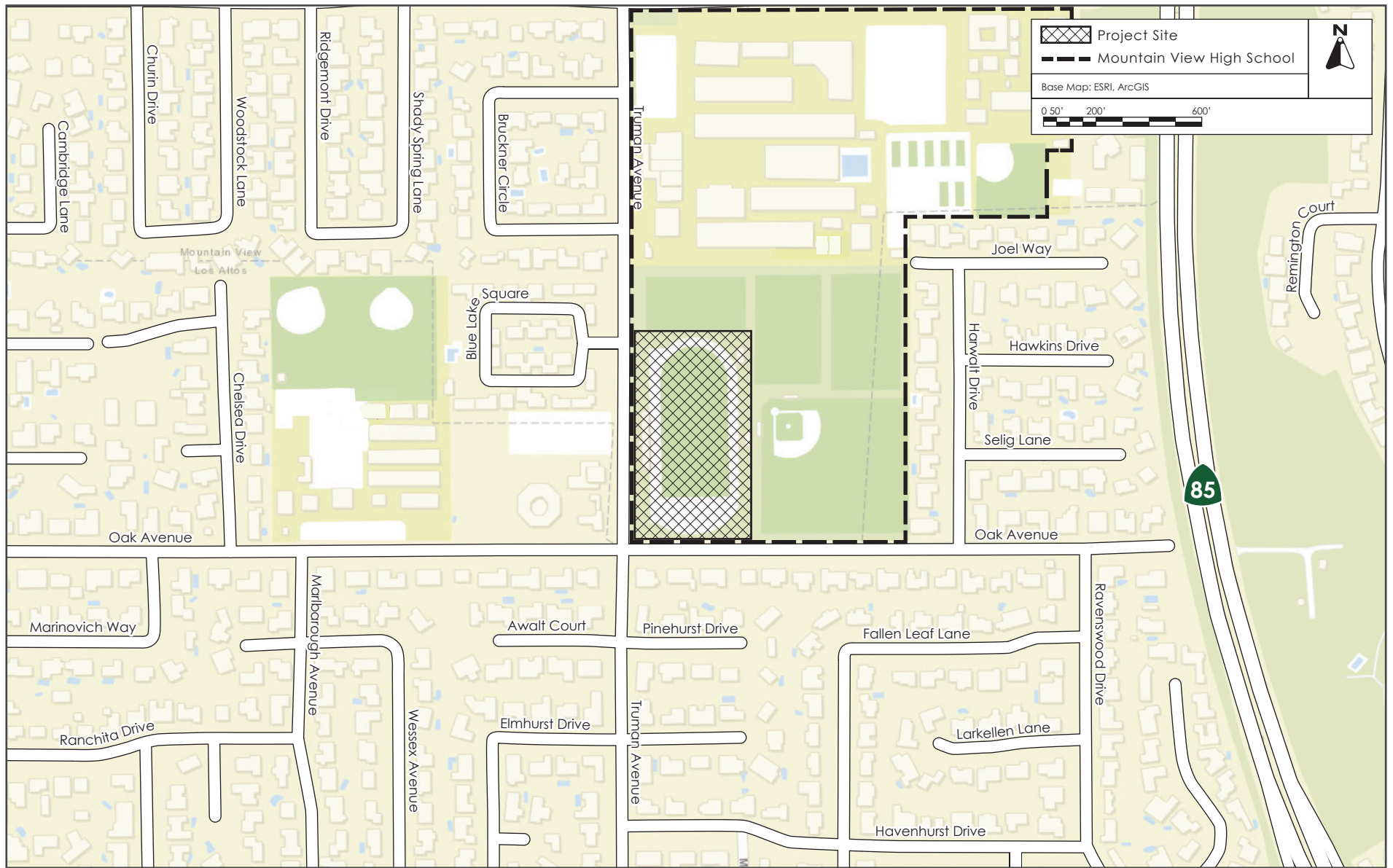

VICINITY MAP

FIGURE 2

Existing Conditions

The project site is a track and sports field located at the southwestern corner of the Mountain View High School campus. The project site consists of a rubberized track, turf athletic field, and metal bleachers on the eastern and western sides of the track. In addition, there is an approximately 20-foot tall scorekeeping booth (i.e. press box) adjacent to the western bleachers, two approximately 25-foot tall pole-mounted loudspeakers on the western side of the track, a scoreboard, and various auxiliary single-story buildings. The pole-mounted loudspeakers have been abandoned and are not in use; the current system consists of three speakers which are attached to the press box at the western bleachers.

MVHS currently uses portable, temporary lights for two to five football games per year. The highest attendance is typically for football games, with an approximate 1,500 attendees for most football games, increasing to over 2,000 attendees for a rivalry or homecoming game.¹ All other sporting events, marching band activities, and special events are currently held on campus without the use of portable lights (i.e. during daylight hours). The approximate attendance for these other events is up to 200 people.

Description of Proposed Project

The project applicant, the Mountain View-Los Altos Union High School District (District), proposes to install four pole-mounted sports lights at the existing track and sports field. The lights would generally be located on either side of the metal bleachers on the eastern and western sides of the track and sports field. The project also includes the installation and operation of a public address (PA) system. The PA system consists of pole-mounted speakers, located on the east and west sides of the field. The site plan for the proposed project is shown on Figure 3.

The lights would provide for safe and flexible nighttime use of the field for various sporting and marching band activities, including practices and games. The field lights would also allow for evening special events, such as commencement exercises. The PA system will be used for sporting events, marching band, and school activities during daytime hours. A select amount of nighttime events would include the use of a PA system. The use of the stadium field lights and public address system would be guided by the District's Board Policy 7325 and Administrative Regulations 7325. The proposed uses of the field lights and schedule of use is summarized in Table 1 below.

The use of the stadium lights and the public address system will be restricted to weekdays and Saturdays; the stadium lights and the public address system will not be used on Sundays, unless under unusual circumstances approved by the Superintendent or designee.

¹ Mike Mathiesen. Associate Superintendent Business Services, MVLA High School District. *Personal Communication*. October 2, 2019.

Table 1: Proposed Use of the Field Lights and Public Address System		
Proposed Use of Field	Use of Field Lights	Use of Public Address System
Sports Games	Five nights of varsity/junior varsity interscholastic competition per annual season, concluding by 10:00 PM at the latest ¹	Yes (play-by-play commentary only permitted during football games). All other athletic competitions shall limit the use of the public address systems to announcements, warm-up music or similar uses without running commentary.
Sports Practices	Monday through Friday, concluding by 8:00 PM. Not during weekend nights unless under unusual circumstances approved by the Superintendent or designee	No
Marching Band Practice	Two weeknights per week between August and November; one practice concluding by 8:00 PM and one practice concluding by 6:30 PM. ²	Yes
Marching Band Performance	Five night athletic competitions, commencement, and up to three special evening events.	Yes
Special Events	Commencement and up to three special evening events per year, concluding by 9:00 PM.	Yes
Holiday Use	The stadium field lights will not be used on school holidays, or in the period of time between commencement ceremonies and the beginning of sports practice for the fall season, as permitted by California Interscholastic Federation (CIF) rules. ⁴	Use would be limited by all provisions described in BP 7325 policy and shall require prior approval by the superintendent or designee. Use of public address systems during holidays shall not begin prior to 10:00 AM ³ ; shall be limited to necessary and occasional announcements, and occasional music played at volumes low enough not to interfere with ordinary conversation at the school site's boundary lines; and shall end by 2:00 PM.

¹ Football competitions would typically end by 10:00 PM; all other competitions would typically end by 8:30 PM. Adequate lighting (non-competition level) would be maintained after games to allow for safe exiting of the field.

² Marching band practices would not occur within 12 hours of each other. Practices could be extended in the event of postseason regional or national competitions, but not beyond December 31, except by permission of the Superintendent or designee. Marching band practice may be held during morning, afternoon and Saturday hours without stadium lights with no restriction.

³ The one exception being Thanksgiving morning (Turkey Trot event, where sound equipment would be in use by 8:00 AM)

⁴ CIF schedule shows the first day of practice as August 9, 2020 for fall sports.

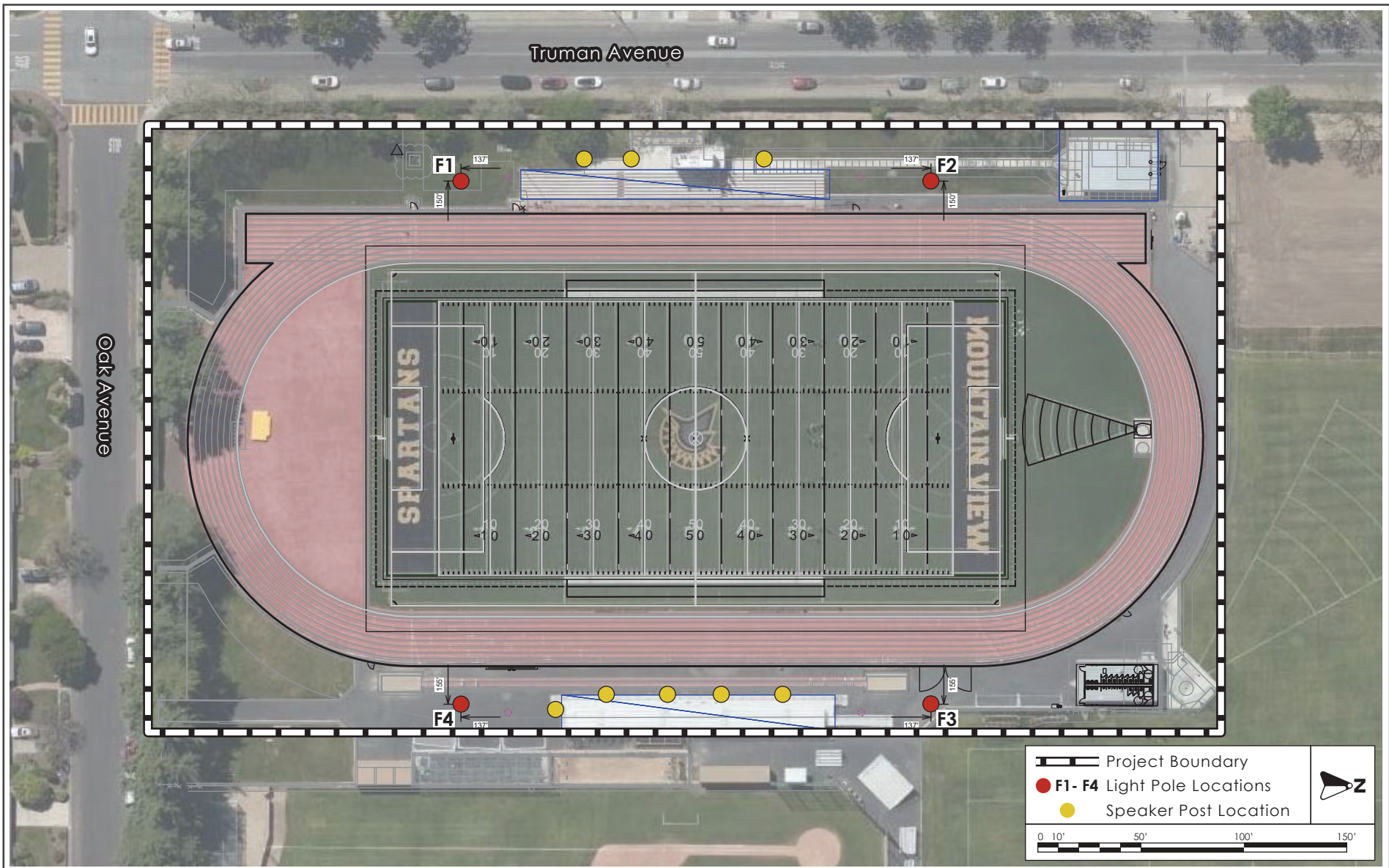

CONCEPTUAL SITE PLAN

FIGURE 3

The physical elements of the proposed athletic lighting includes four 90-foot tall light poles. Two light poles would be located on the eastern and western sides of the track and sports field, adjacent to each end of the home and away bleachers. The light poles would be affixed with LED luminaires.² Each of the light poles would include lighting fixtures at varying heights to illuminate different areas of the track and sports field (i.e. bleachers, playing field, entryways), with the majority of luminaires installed at the poles' maximum height.

The public address system would be comprised of eight pole-mounted speakers, between 12 and 18 feet in height, located on the east and west sides of the field. The proposed development will only be utilizing the new pole-mounted speakers and usage will abide by the new policies that have been adopted. The public address system would be designed to conform to the exterior noise limits section of the City of Mountain View Municipal Code and 2030 General Plan and Los Altos Noise Control Ordinance.

Attendance

The estimated attendance for athletic competitions upon installation of the proposed field lights would vary by sport and other factors, such as level of competition (e.g. regular season v/s postseason) and weather conditions. An increase in number of sporting events is not anticipated with the installation of the stadium lights. However, an increase in number of attendees is expected by having games at night as opposed to afternoon events. A select few football games are currently hosted with portable lights at MVHS and attendance would not increase with the proposed project. For all other events, attendance is expected to increase from approximately 200 attendees to 500 attendees.

Parking

At MVHS, a total of 493 standard parking stalls and 15 accessible stalls are available for attendees of sporting events. Available parking is distributed between three parking lots on-campus. As the most highly attended events would bring more attendees to the campus than are available parking spaces, some overflow parking would occur onto surrounding streets, primarily Truman Avenue and Oak Avenue. As it exists, daytime events or night games at MVHS hosted with portable lights have resulted in the surrounding street parking being utilized, in addition to use of the Foothill Covenant Church parking lot, located at 1555 Oak Avenue in Los Altos, across Truman Avenue from the stadium. No additional parking is proposed as part of the lighting project.

Possible Required Project Approvals:

1. California Division of the State Architect Approval

² A luminaire, otherwise known as a light fixture, is defined as complete lighting unit, comprised of a light source (lamp or lamps), together with the parts that distribute and direct the light, position and protect the lamps, and connect the lamps to the power supply.

Potential Environmental Impacts of the Project

The EIR will identify the significant environmental effects anticipated to result from development of the project as proposed. Mitigation measures will be identified for significant impacts, as warranted. The EIR will include the following specific environmental categories as related to the proposed project:

1. Aesthetics

The project site is currently developed with a track and sports field, metal bleachers, and various single-story auxiliary buildings. The proposed field lights would introduce new structures at the site which are taller than existing development and would be visible from public vantage points in the area. The EIR will address the visual impact of the field lights and resultant light and glare. Mitigation measures to reduce the aesthetic impact of the project will be identified, as necessary.

2. Air Quality

The EIR will address the regional air quality conditions in the Bay Area and discuss the proposed project's construction and operational emissions impacts to local and regional air quality in accordance with the 2017 Bay Area Air Quality Management District (BAAQMD) CEQA guidelines and thresholds.

3. Cultural Resources

This area of Mountain View is not considered a sensitive area for prehistoric and historic resources. No buildings on-site or within the immediate vicinity of the site have been listed in the City's Register of Historic Resources. The EIR will address the impacts to known and unknown buried archaeological resources on-site, as well as impacts to potential historic structures on and/or near the site.

4. Energy

Implementation of the proposed project would result in increased energy expenditures at the site. The EIR will estimate the increase in energy usage on-site and describe proposed design measures to reduce energy consumption.

5. Geology

The project site is located in the most seismically active region in the United States. The EIR will discuss the possible geological impacts associated with seismic activity and the existing soil conditions on the project site.

6. Greenhouse Gas Emissions

The EIR will address the project's contribution to regional and global greenhouse gas (GHG) emissions based on BAAQMD thresholds. The project will not be constructed and operational until after the year 2020; therefore, project greenhouse gas (GHG) emissions will be evaluated for the

State's proposed 2030 targets, based on SB 32. Proposed design measures to reduce energy consumption, which in turn would reduce GHG emissions, will be discussed.

7. Hazards and Hazardous Materials

The EIR will summarize known hazardous materials conditions on and adjacent to the project site and will address the potential for hazardous materials impacts to result from implementation of the proposed project. Mitigation measures to avoid or reduce hazardous materials impacts will be identified, as appropriate.

8. Land Use

The project site is located within a developed suburban area of Mountain View surrounded primarily by single-family residential neighborhoods. The EIR will describe the existing land uses adjacent to and within the project area. Land use impacts that would occur as a result of the proposed project will be analyzed, including the consistency of the project with District design standards and compatibility of the proposed and existing land uses in the project area.

9. Noise and Vibration

The EIR will discuss noise that would result from operation of the proposed project, including a discussion of the increase in nighttime noise levels that would result from the most highly attended sporting events, and the impact of any noise increase on nearby sensitive receptors. The EIR will also discuss temporary construction noise. Noise levels will be evaluated for consistency with applicable standards and guidelines in the City of Mountain View and Los Altos.

10. Transportation

The EIR will examine the existing traffic conditions in the immediate vicinity of the project site and impacts of the project on the transportation system. Evaluation of transportation impacts of the project will be based upon the City of Mountain View and City of Los Altos level of service (LOS) standards. A Local Transportation Analysis (LTA) will be completed to identify transportation operational issues in the surrounding area that may arise due to project operation. The EIR will also include an analysis of site access and circulation, and pedestrian and transit facilities. Vehicle Miles Traveled (VMT) will be discussed qualitatively.

11. Other Topic Areas

The EIR will also address the project's impacts on agricultural resources, biological resources, hydrology and water quality, population and housing, mineral resources, public services, tribal cultural resources, utilities, and wildfire. These discussions will be based, in part, upon information provided by the project applicant, as well as the City's General Plan EIR and other available technical data.

12. Alternatives

The EIR will examine alternatives to the proposed project including a “No Project” alternative and one or more alternative development scenarios depending on the impacts identified. Alternatives discussed will be chosen based on their ability to reduce or avoid identified significant impacts of the proposed project while achieving most of the identified objectives of the project.

13. Significant Unavoidable Impacts

The EIR will identify any significant impacts that cannot be avoided or reduced to less than significant levels with mitigation, if the project is implemented as proposed.

14. Cumulative Impacts

The EIR will include a Cumulative Impacts section that will address the potentially significant cumulative impacts of the project when considered with other past, present, and reasonably foreseeable future projects in the development area.

In conformance with the CEQA Guidelines, the EIR will also include the following sections: 1) consistency with local and regional plans and policies, 2) growth inducing impacts, 3) significant irreversible environmental changes, 4) references and organizations/persons consulted, and 5) EIR authors.