

Notice of Completion & Environmental Document Transmittal

Mail to: State Clearinghouse, P.O. Box 3044, Sacramento, CA 95812-3044 (916) 445-0613
 For Hand Delivery/Street Address: 1400 Tenth Street, Sacramento, CA 95814

SCH #

Project Title: CD Project No. 3.19.4 - Belle Terrace Park Improvements; CD Project No. 3.20.4 - Belle Terrace Park Improvements (Phase II)
Lead Agency: County of Kern **Contact Person:** James Golden, Planner III
Mailing Address: 2700 M Street, Suite 250 **Phone:** (661) 862-5130
City: Bakersfield **Zip:** 93301-2323 **County:** Kern

Project Location: County: Kern **City/Nearest Community:** Bakersfield/Cottonwood
Cross Streets: East Belle Terrace and Citadel Street **Zip Code:** 93307
Longitude/Latitude (degrees, minutes and seconds): 35 ° 20 ' 46.55 " N / -118 ° 59 ' 18.99 " W **Total Acres:** 9.64-acres
Assessor's Parcel No.: 168-200-29 **Section:** 5 **Twp.:** 30S **Range:** R28E **Base:** MDBM
Within 2 Miles: **State Hwy #:** 58 **Waterways:** N/A
Airports: Bakersfield Municipal Airport **Railways:** SJVRRR/BT 316.0-Kayandee **Schools:** Citadel (Under Construction)

Document Type:

CEQA: <input type="checkbox"/> NOP	<input type="checkbox"/> Draft EIR	NEPA: <input type="checkbox"/> NOI	Other: <input checked="" type="checkbox"/> Joint Document
<input type="checkbox"/> Early Cons	<input type="checkbox"/> Supplement/Subsequent EIR	<input type="checkbox"/> EA	<input type="checkbox"/> Final Document
<input type="checkbox"/> Neg Dec	(Prior SCH No.) _____	<input type="checkbox"/> Draft EIS	<input type="checkbox"/> Other: _____
<input checked="" type="checkbox"/> Mit Neg Dec	Other: _____	<input checked="" type="checkbox"/> FONSI	

Local Action Type:

<input type="checkbox"/> General Plan Update	<input type="checkbox"/> Specific Plan	<input type="checkbox"/> Rezone	<input type="checkbox"/> Annexation
<input type="checkbox"/> General Plan Amendment	<input type="checkbox"/> Master Plan	<input type="checkbox"/> Prezone	<input type="checkbox"/> Redevelopment
<input type="checkbox"/> General Plan Element	<input type="checkbox"/> Planned Unit Development	<input type="checkbox"/> Use Permit	<input type="checkbox"/> Coastal Permit
<input type="checkbox"/> Community Plan	<input checked="" type="checkbox"/> Site Plan	<input type="checkbox"/> Land Division (Subdivision, etc.)	<input type="checkbox"/> Other: _____

Development Type:

<input type="checkbox"/> Residential: Units _____ Acres _____	<input type="checkbox"/> Transportation: Type _____
<input type="checkbox"/> Office: Sq.ft. _____ Acres _____ Employees _____	<input type="checkbox"/> Mining: Mineral _____
<input type="checkbox"/> Commercial: Sq.ft. _____ Acres _____ Employees _____	<input type="checkbox"/> Power: Type _____ MW _____
<input type="checkbox"/> Industrial: Sq.ft. _____ Acres _____ Employees _____	<input type="checkbox"/> Waste Treatment: Type _____ MGD _____
<input type="checkbox"/> Educational: _____	<input type="checkbox"/> Hazardous Waste: Type _____
<input checked="" type="checkbox"/> Recreational: 10,000 sq feet	<input type="checkbox"/> Other: _____
<input type="checkbox"/> Water Facilities: Type _____ MGD _____	

Project Issues Discussed in Document:

<input checked="" type="checkbox"/> Aesthetic/Visual	<input type="checkbox"/> Fiscal	<input checked="" type="checkbox"/> Recreation/Parks	<input checked="" type="checkbox"/> Vegetation
<input checked="" type="checkbox"/> Agricultural Land	<input checked="" type="checkbox"/> Flood Plain/Flooding	<input checked="" type="checkbox"/> Schools/Universities	<input type="checkbox"/> Water Quality
<input checked="" type="checkbox"/> Air Quality	<input type="checkbox"/> Forest Land/Fire Hazard	<input type="checkbox"/> Septic Systems	<input checked="" type="checkbox"/> Water Supply/Groundwater
<input checked="" type="checkbox"/> Archeological/Historical	<input type="checkbox"/> Geologic/Seismic	<input checked="" type="checkbox"/> Sewer Capacity	<input type="checkbox"/> Wetland/Riparian
<input checked="" type="checkbox"/> Biological Resources	<input type="checkbox"/> Minerals	<input checked="" type="checkbox"/> Soil Erosion/Compaction/Grading	<input checked="" type="checkbox"/> Growth Inducement
<input checked="" type="checkbox"/> Coastal Zone	<input checked="" type="checkbox"/> Noise	<input checked="" type="checkbox"/> Solid Waste	<input checked="" type="checkbox"/> Land Use
<input checked="" type="checkbox"/> Drainage/Absorption	<input type="checkbox"/> Population/Housing Balance	<input checked="" type="checkbox"/> Toxic/Hazardous	<input checked="" type="checkbox"/> Cumulative Effects
<input checked="" type="checkbox"/> Economic/Jobs	<input checked="" type="checkbox"/> Public Services/Facilities	<input checked="" type="checkbox"/> Traffic/Circulation	<input checked="" type="checkbox"/> Other: <u>Environmental Justice</u>

Present Land Use/Zoning/General Plan Designation:
Recreation/OS-Open Space/3.1- Public or Private Recreation Areas

Project Description: *(please use a separate page if necessary)*

(Phase I) Design and construction of park related improvements and upgrades which may include: rehabilitation of pedestrian paths of travel, planting of trees, playground renovations installation of: irrigation, decorative fencing, new soccer field, new tot play structure, two additional play structures and four (4) shade canopies of, seven (7) exercise equipment stations. Sand play area surfacing may be replaced with rubberized play surface materials, demolition of existing restroom and related improvements.

(Phase II) Provides additional CDBG funding for the design, construction and installation of park related improvements and upgrades to include park benches and shade structures at Belle Terrace Park.

Reviewing Agencies Checklist

Lead Agencies may recommend State Clearinghouse distribution by marking agencies below with an "X".
If you have already sent your document to the agency please denote that with an "S".

- | | |
|---|--|
| <input type="checkbox"/> Air Resources Board | <input checked="" type="checkbox"/> Office of Historic Preservation |
| <input type="checkbox"/> Boating & Waterways, Department of | <input checked="" type="checkbox"/> Office of Public School Construction |
| <input type="checkbox"/> California Emergency Management Agency | <input checked="" type="checkbox"/> Parks & Recreation, Department of |
| <input type="checkbox"/> California Highway Patrol | <input type="checkbox"/> Pesticide Regulation, Department of |
| <input type="checkbox"/> Caltrans District # _____ | <input type="checkbox"/> Public Utilities Commission |
| <input type="checkbox"/> Caltrans Division of Aeronautics | <input checked="" type="checkbox"/> Regional WQCB # _____ |
| <input type="checkbox"/> Caltrans Planning | <input type="checkbox"/> Resources Agency |
| <input type="checkbox"/> Central Valley Flood Protection Board | <input type="checkbox"/> Resources Recycling and Recovery, Department of |
| <input type="checkbox"/> Coachella Valley Mtns. Conservancy | <input type="checkbox"/> S.F. Bay Conservation & Development Comm. |
| <input type="checkbox"/> Coastal Commission | <input type="checkbox"/> San Gabriel & Lower L.A. Rivers & Mtns. Conservancy |
| <input type="checkbox"/> Colorado River Board | <input type="checkbox"/> San Joaquin River Conservancy |
| <input type="checkbox"/> Conservation, Department of | <input type="checkbox"/> Santa Monica Mtns. Conservancy |
| <input type="checkbox"/> Corrections, Department of | <input type="checkbox"/> State Lands Commission |
| <input type="checkbox"/> Delta Protection Commission | <input type="checkbox"/> SWRCB: Clean Water Grants |
| <input type="checkbox"/> Education, Department of | <input type="checkbox"/> SWRCB: Water Quality |
| <input type="checkbox"/> Energy Commission | <input type="checkbox"/> SWRCB: Water Rights |
| <input checked="" type="checkbox"/> Fish & Game Region # _____ | <input type="checkbox"/> Tahoe Regional Planning Agency |
| <input type="checkbox"/> Food & Agriculture, Department of | <input type="checkbox"/> Toxic Substances Control, Department of |
| <input type="checkbox"/> Forestry and Fire Protection, Department of | <input type="checkbox"/> Water Resources, Department of |
| <input type="checkbox"/> General Services, Department of | |
| <input type="checkbox"/> Health Services, Department of | Other: _____ |
| <input checked="" type="checkbox"/> Housing & Community Development | Other: _____ |
| <input checked="" type="checkbox"/> Native American Heritage Commission | |

Local Public Review Period (to be filled in by lead agency)

Starting Date 6/16/20 Ending Date 7/16/20

Lead Agency (Complete if applicable):

Consulting Firm: N/A Applicant: N/A
 Address: _____ Address: _____
 City/State/Zip: _____ City/State/Zip: _____
 Contact: _____ Phone: _____
 Phone: _____

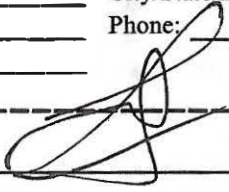
Signature of Lead Agency Representative:  Date: 6/16/20

Authority cited: Section 21083, Public Resources Code. Reference: Section 21161, Public Resources Code.



U.S. Department of Housing and Urban
Development
451 Seventh Street, SW
Washington, DC 20410
www.hud.gov
espanol.hud.gov

Environmental Assessment Determinations and Compliance Findings for HUD-assisted Projects 24 CFR Part 58

Project Information

Project Name: #3.19.4 – Belle Terrace Park Improvements; #3.20.4 – Belle Terrace Park Improvements (Phase II)

Responsible Entity: County of Kern

Grant Recipient (if different than Responsible Entity): N/A

State/Local Identifier: CA

Preparer: James Golden, Planner III

Certifying Officer Name and Title: Lorelei H. Oviatt, AICP, Director

Grant Recipient (if different than Responsible Entity): N/A

Consultant (if applicable): N/A

Direct Comments to: James Golden, Planner III –

Contact email: goldenj@kerncounty.com; (661) 204-2034

Project Location: Belle Terrace Park, 1101 East Belle Terrace, Bakersfield

Description of the Proposed Project [24 CFR 50.12 & 58.32; 40 CFR 1508.25]:

(Phase I) Design and construction of park related improvements and upgrades which may include: rehabilitation of pedestrian paths of travel, planting of trees, playground renovations installation of: irrigation, decorative fencing, new soccer field, new tot play structure, two additional play structures and four (4) shade canopies of, seven (7) exercise equipment stations. Sand play area surfacing may be replaced with rubberized play surface materials, demolition of existing restroom and related improvements.

(Phase II) Provides additional CDBG funding for the design, construction and installation of park related improvements and upgrades to include park benches and shade structures at Belle Terrace Park.

Statement of Purpose and Need for the Proposal [40 CFR 1508.9(b)]: Belle Terrace Park is located in Census Tract 25, a qualified low income census tract, and its facilities and improvements are dated and in need of rehabilitation and improvement. The proposed park related improvements proposed are intended to improve the image of the area, improve safety and encourage residents to enjoy park amenities within their neighborhood. Planned improvements to the County owned park are likely to encourage investment, renew interest in the neighborhood and reduce some of the long-standing issues in the area. Additionally, a new STEM school is currently being built that will provide new resources and opportunities to area residents. There has been a need expressed for installation of benches and trees within the park that may be available for use by parents that wait to pickup children.

Existing Conditions and Trends [24 CFR 58.40(a)]: There is a growing community awareness that the neighborhood areas surrounding Belle Terrace park, generally known as Cottonwood, may be served in a more comprehensive way if the area is not isolated into pockets or mixed incorporated areas. The park is located within the City of Bakersfield, and owned by the County of Kern. Adjacent parcels on the east boundary are located within the unincorporated area of Kern.

Funding Information

Grant Number	HUD Program	Funding Amount
B-19-UC-06-0502	CDBG	\$840,000
B-20-UC-06-0502	CDBG	\$125,902

Estimated Total HUD Funded Amount:

\$965,902 in CDBG funds

Estimated Total Project Cost (HUD and non-HUD funds) [24 CFR 58.32(d)]:

\$965,902 in CDBG funds

Compliance with 24 CFR 50.4, 58.5, and 58.6 Laws and Authorities

Record below the compliance or conformance determinations for each statute, executive order, or regulation. Provide credible, traceable, and supportive source documentation for each authority. Where applicable, complete the necessary reviews or consultations and obtain or note applicable permits of approvals. Clearly note citations, dates/names/titles of contacts, and page references. Attach additional documentation as appropriate.

Compliance Factors: Statutes, Executive Orders, and Regulations listed at 24 CFR §58.5 and §58.6	Are formal compliance steps or mitigation required?	Compliance determinations
STATUTES, EXECUTIVE ORDERS, AND REGULATIONS LISTED AT 24 CFR 50.4 and 58.6		
Airport Hazards 24 CFR Part 51 Subpart D	Yes No <input type="checkbox"/> <input checked="" type="checkbox"/>	The airport that is nearest to the project site is Bakersfield Municipal Airport (BMA). According to the Airport Land Use Compatibility Plan (ALUCP), BMA airport Zone A (Runway Protection Zone-RPZ) is located more than 4,500 feet from the area of the project. The project is located in the C-Zone or Common Traffic Pattern Zone. Within the C-Zone, parks and playgrounds are listed as Normally Acceptable Uses. There are no military airports located within 15,000 feet of the project site. Based on the separation distance that is greater than 2,500 feet and a review of the applicable provisions of the ALUCP, the project location is considered compliant and no further review for compliance with this factor is required.
Coastal Barrier Resources Coastal Barrier Resources Act, as amended by the Coastal Barrier Improvement Act of 1990 [16 USC 3501]	Yes No <input type="checkbox"/> <input checked="" type="checkbox"/>	The project site is within HUD Region IX. There are no Coastal Barrier Resources located within HUD Region IX. No further review for compliance with this factor is required.
Flood Insurance Flood Disaster Protection Act of 1973 and National Flood Insurance Reform Act of 1994 [42 USC 4001-4128 and 42 USC 5154a]	Yes No <input type="checkbox"/> <input checked="" type="checkbox"/>	The area for project implementation is designated Zone X, as shown in Federal Insurance Rate Map (FIRM) Panel #06029C2325E, effective 9/26/08, the site is not located within a 100-year flood zone. Consequently, no flood insurance is required.

STATUTES, EXECUTIVE ORDERS, AND REGULATIONS LISTED AT 24 CFR 50.4 & 58.5

<p>Clean Air</p> <p>Clean Air Act, as amended, particularly section 176(c) & (d); 40 CFR Parts 6, 51, 93</p>	<p>Yes No</p> <p><input checked="" type="checkbox"/> <input type="checkbox"/></p>	<p>The project is located within the administrative boundaries of the San Joaquin Valley Air Pollution Control District (District).</p> <p>On September 17, 2019, the District commented on the initial environmental consultation for the project. The District noted that the project was not expected to exceed any of the District significance thresholds for criteria pollutants regulated under the Clean Air Act (CAA), nitrogen oxide (NOx), reactive organic gases (ROG), or particulate matter (PM 10/2.5 – in size of 10 microns or 2.5 microns or less). The project would also not exceed District thresholds for other State and District regulated pollutants, carbon monoxide (CO) and oxides of sulfur (SO). The project is therefore considered to have a less than significant impact, would not contribute to new air quality violations and in conformance with the State Implementation Plan (SIP) for attainment of criteria pollutants.</p> <p>However, the District noted that the project may be subject to the following air management regulations District Rule 9510 – Indirect Source Review (ISR), <i>Regulation VIII (Fugitive PM10 prohibitions)</i>, <i>Rule 4102 (Nuisance)</i>, <i>Rule 4601 (Architectural Coatings)</i> and <i>Rule 4641 (Cutback, Slow Cure and Emulsified Asphalt, Paving and Maintenance Operations)</i>. <i>In the event that an existing building will be renovated, partially demolished, or removed, the project may be subject to District Rule 4002 National Emission Standards for Hazardous Air Pollutants (NESHAP).</i></p> <p>The Responsible Entity contacted the District regarding application of the ISR rule to the project. Further clarification was provided regarding the project size and scope.</p>
---	---	--

		<p>On November 13, 2019, the District provided additional comment noting that District determined that Rule 9510 and related requirements and fees will not apply to the project. The District further noted that changes in land use or increase in intensity may exceed the applicability threshold.</p> <p>As to the 2020 – Phase II improvements, which were not part of the original consultation, the additional improvements include installation of park benches and shade structures at Belle Terrace Park. The RE determined the modifications will not affect the District ISR determination, as the structures are merely appurtenant to the established use. Furthermore, the improvements will not exceed the 20,000 square foot ISR District threshold as the original determination was based on 8,000 square feet of planned Phase I improvements. The Phase II proposal for benches and shaded covered structures will be far less than the remaining 12,000 square feet under the ISR threshold.</p> <p>Based on the review above and application of the applicable District rules, the project will be in compliance with the Clean Air Act and local clean air rules and regulations.</p>
<p>Coastal Zone Management</p> <p>Coastal Zone Management Act, sections 307(c) & (d)</p>	<p>Yes No</p> <p><input type="checkbox"/> <input checked="" type="checkbox"/></p>	<p>The area of project effect or APE is not located within or in the vicinity of any Coastal Zone Management Area. The project has no potential to effect any Coastal Management area or Plan.</p>
<p>Contamination and Toxic Substances</p> <p>24 CFR Part 50.3(i) & 58.5(i)(2)</p>	<p>Yes No</p> <p><input type="checkbox"/> <input checked="" type="checkbox"/></p>	<p>NEPAssist notes there are three Hazardous Waste (RCRA) operator sites and one water discharger regulated under the Clean Water Act (CWA) as part of the National Pollutant Discharge and Elimination System, all of which are located within one half mile of the project site.</p> <p>The Enforcement and Compliance History Online (ECHO) system notes that due to issues with compliance tracking, the CWA permit was terminated as of 9/02/14.</p>

		<p>Two of the RCRA operations are located north of Highway 58. The other operations is located east of Cottonwood Road. No violations were identified by the ECHO system for the operators.</p> <p>There is one facility noted on the State of California Envirostor Database located on an adjacent parcel. However, on 11/22/2016 a “No Further Action” determination was issued by the State Department of Toxic Substances Control (DTSC) for the site. The NFA determination was updated and reissued on 7/16/2018 due to the use of import fill onsite during construction.</p> <p>There are two open Cleanup program sites located on the State Geotracker website; however, the sites are located more than one half mile west of the nearest project site boundary an on the other side of railroad tracks. Due to the separation provide there are no concerns as to the location of the project.</p> <p>Based on the foregoing evaluation, it can be determined that the site is not contaminated and no further evaluation for compliance with this factor is needed.</p>
<p>Endangered Species</p> <p>Endangered Species Act of 1973, particularly section 7; 50 CFR Part 402</p>	<p>Yes No</p> <p><input checked="" type="checkbox"/> <input type="checkbox"/></p>	<p>Both the US Fish and Wildlife Service (USFWS) and the California Department of Fish and Wildlife (CDFW) were contacted during the early consultation for the project. On August 26, 2019, a species list was generated USFWS ECOS-IPaC website tool under Consultation Code 08ESMF00-2019-SLI-2845, that species list was subsequently updated on January 15, 2020. The species list generated indicates that there may be nine federally threatened and/or endangered species listed under the Endangered Species Act (ESA) in the area of the project. No critical habitats for protected species were found within the area of the project. Listed species that may be present in the area of the project include; San Joaquin Kit Fox (E), Tipton Kangaroo Rat (E), Southwestern Willow Flycatcher (E), Blunt-nosed Leopard</p>

		<p>Lizard (E), Giant Garter Snake (T), California Red-Legged Frog (T), Delta Smelt (T), and Vernal Pool Fairy Shrimp (T), and Bakersfield Cactus (E). The previous species list was subsequently updated on June 9, 2020, under Event Code 08ESMF00-2020-E-06556. The update was necessary to account for the addition of Phase II improvements and to ensure the accuracy of the list after more than ninety days timeframe. Based on the update generated, there were no changes to the listed species.</p> <p>The responsible agency has determined that with the inclusion of mitigation and with adherence to the provisions below the project “may affect, but is not likely to adversely affect” protected species. Additionally, the project is a covered action under the Metro Bakersfield Habitat Conservation Plan and issued incidental take permit.</p> <p>The CDFW noted in a consultation letter dated September 27, 2019, that species present include the San Joaquin Kit Fox, State of California protected Burrowing Owl and nesting birds and that consequently project implementation and timing are important project level considerations; however, for this factor SKJF mitigation is included with the project and consistent with related steps of the MBHCP. CDFW comments on non-federally listed species are considered further under the assessment factor <i>vegetation and wildlife</i> section of this report for borrowing owls and nesting birds.</p> <p>A mitigation measure shall be applied to the project to address any potential to impact protected species and/or habitat upon implementation in accordance with the Metro Bakersfield Habitat Conservation Plan and incidental take permit issued for the area of the project.</p>
<p>Explosive and Flammable Hazards</p> <p>24 CFR Part 51 Subpart C</p>	<p>Yes No</p> <p><input type="checkbox"/> <input checked="" type="checkbox"/></p>	<p>The project does not include activities that will result in an increase in residential density or result in a conversion of land use.</p>

		Therefore, no further evaluation for this factor is needed.
Farmlands Protection Farmland Protection Policy Act of 1981, particularly sections 1504(b) and 1541; 7 CFR Part 658	Yes No <input type="checkbox"/> <input checked="" type="checkbox"/>	The project is for the rehabilitation of an existing park and park related amenities and does not include any activities that will convert one land use to another. Therefore, no further evaluation for this factor is needed.
Floodplain Management Executive Order 11988, particularly section 2(a); 24 CFR Part 55	Yes No <input type="checkbox"/> <input checked="" type="checkbox"/>	The area for project implementation is designated Zone X, as shown in Federal Insurance Rate Map (FIRM) Panel #06029C2325E, effective 9/26/08, the site is not located within a 100-year flood zone. No further compliance is needed.
Historic Preservation National Historic Preservation Act of 1966, particularly sections 106 and 110; 36 CFR Part 800	Yes No <input checked="" type="checkbox"/> <input type="checkbox"/>	<p>On August 29, 2019 Southern San Joaquin Information Center (SSJVIC) was contacted regarding historic preservation in the area of the project. SSJVIC conducted Record Search 19-339 and to the request for consultation noting that there has been no previous cultural studies conducted within the project area. SSJVIC noted there have been nine previous studies within one half mile radius of the project site, KE-02211, 02278, 02708, 03132, 03208, 03412. 03444. 0358 and 04160. The report noted that there are no known resources within the project area and that it is not known if any exist there. The search found eight recorded resources within one half mile radius, P-15-0020050, 008025, 008030, 008079, 008080, 008136, 012430, and 012431. The resources consist of an historic era railroad and single-family residences. The search found no historic resources listed in the National Register of Historic Places, the California Register of Historic Resources, the California Points of Historic Interest, California Inventory of Historic Resources, and California State Historic Landmarks.</p> <p>SSJVIC noted that due to the age of the park the park should be assessed for historical significance. Although the age of the park is over fifty years, the park does not contain any obvious cultural features or other unique</p>

		<p>characteristics that warrant further consideration prior to proceeding with the undertaking.</p> <p>However, In consideration of SSJVIC comments, the following and will be included as mitigation for the project: <i>should any cultural resources be unearthed during ground disturbing activities, all work must halt in the area of the find and a qualified, professional consultant be called out to assess the findings and make appropriate recommendations.</i></p> <p>On January 14, 2020, SHPO was sent a letter of consultation, but as of March 11, 2020 no response to the request for consultation was received.</p> <p>On January 21, 2020, a Sacred Inventory list was obtained from the Native American Heritage Commission (NAHC). Tribal Authorities identified on the NAHC list were contacted regarding the project and any potential to affect tribal resources. On February 14, 2020, one tribal authority, San Manuel Band of Mission Indians, responded to the request for consultation noting that the project was outside the tribal boundaries. No other tribal requests for consultation were received.</p> <p>Based on the response from SSJVIC, no SHPO comments and tribal outreach which resulted in no further request for inquires, the responsible entity has concluded that with the inclusion and compliance with the condition to address any unknown resources encountered as a result of implementation, that compliance with the historic preservation will be achieved.</p>
<p>Noise Abatement and Control</p> <p>Noise Control Act of 1972, as amended by the Quiet Communities Act of 1978; 24 CFR Part 51 Subpart B</p>	<p>Yes No</p> <p><input type="checkbox"/> <input checked="" type="checkbox"/></p>	<p>The project is located within a community park located to the south of a residential community. There is a railroad spur located approximately 1,750 feet from the edge of the project site and rail traffic data was obtained from the U.S. Department of Transportation Crossing Inventory for the crossing at Belle</p>

		<p>Terrace. Cottonwood Road is located approximately 460 feet east of the Project Site Boundary is an Arterial (Major) Roadway and according to the Kern Council of Governments Transportation Data Management System averages 15,232 vehicle trips a day. Finally, Bakersfield Municipal Airport is located approximately 4,500 ft. to the southwest of the project site.</p> <p><i>Section 51.101(8) Exterior Noise Goals states: It is a HUD goal that exterior noise levels do not exceed a day-night average sound level of 55 decibels. This level is recommended by the Environmental Protection Agency as a goal for outdoors in residential areas. The levels recommended by EPA are not standards and do not take into account cost or feasibility. For the purposes of this regulation and to meet other program objectives, sites with a day-night average sound level of 65 and below are acceptable and are allowable (see Standards in § 51.103(c)).</i></p> <p>The HUD Noise Calculator was used to determine the combined DNL for the project site. The Calculator provided a total noise level of 61.4913 DNL.</p> <p>East Belle Terrace was not included in the Noise Calculation, as traffic volume is low (Kern Council of Governments Transportation Data Management System records indicate the roadway has 3,307 average daily trips for 2018) and the roadway is classified as a Collector Road.</p> <p>As the site DNL is below 65 DNL, the exterior noise level is considered within the acceptable for rehabilitation activities at an existing park.</p>
<p>Sole Source Aquifers</p> <p>Safe Drinking Water Act of 1974, as amended, particularly section 1424(e); 40 CFR Part 149</p>	<p>Yes No</p> <p><input type="checkbox"/> <input checked="" type="checkbox"/></p>	<p>The EPA has not identified any sole source aquifers within Kern County or in the vicinity of the project site. There is no need for further evaluation for compliance with this factor.</p>

Wetlands Protection Executive Order 11990, particularly sections 2 and 5	Yes No <input type="checkbox"/> <input checked="" type="checkbox"/>	There is one NWI wetland located to the west of the project site. The site is a drainage basin for the surrounding area.
Wild and Scenic Rivers Wild and Scenic Rivers Act of 1968, particularly section 7(b) and (c)	Yes No <input type="checkbox"/> <input checked="" type="checkbox"/>	The project is located on the Kern River, however, the project is not near any stretch of the Kern River which has been designated as Wild and Scenic (WSR). The nearest section of the Kern River designated as a WSR is the South Fork of the Kern River, located in Tulare County. Consequently, no further evaluation for the WSR factor is required.
ENVIRONMENTAL JUSTICE		
Environmental Justice Executive Order 12898	Yes No <input type="checkbox"/> <input checked="" type="checkbox"/>	The project is located in a medium sized community park that is available for use by persons from all demographic and income related groups from the County. Improvements and amenities will support the nearby school under construction and be available for use to all persons from a broad spectrum of categories. The improvements will enhance and improve the existing park and create a greater sense of community for the low to moderate-income area. For these reasons, the project presents no concerns as to environmental justice.

Environmental Assessment Factors [24 CFR 58.40; Ref. 40 CFR 1508.8 & 1508.27] Recorded below is the qualitative and quantitative significance of the effects of the proposal on the character, features and resources of the project area. Each factor has been evaluated and documented, as appropriate and in proportion to its relevance to the proposed action. Verifiable source documentation has been provided and described in support of each determination, as appropriate. Credible, traceable and supportive source documentation for each authority has been provided. Where applicable, the necessary reviews or consultations have been completed and applicable permits of approvals have been obtained or noted. Citations, dates/names/titles of contacts, and page references are clear. Additional documentation is attached, as appropriate. **All conditions, attenuation or mitigation measures have been clearly identified.**

Impact Codes: Use an impact code from the following list to make the determination of impact for each factor.

- (1) Minor beneficial impact
- (2) No impact anticipated
- (3) Minor Adverse Impact – May require mitigation
- (4) Significant or potentially significant impact requiring avoidance or modification which may require an Environmental Impact Statement

Environmental Assessment Factor	Impact Code	Impact Evaluation
LAND DEVELOPMENT		
Conformance with Plans / Compatible Land Use and Zoning / Scale and Urban Design	2	The project is for rehabilitation of an existing community park. There will be no change in land use and the proposal is consistent with the applicable Metropolitan Bakersfield General Plan (MBGP). Under the MBGP, the site is designated as OS-P - Parks and Recreation Facilities. The site is a county owned park located within the boundary of the incorporated area of City of Bakersfield. The site is zoned as OS (Open Space) by the City of Bakersfield.
Soil Suitability/ Slope/ Erosion/ Drainage/ Storm Water Runoff	2	As there is no change to the established land use, the project will not increase erosion, drainage, slope or storm water runoff on or in the vicinity of the project site. As the park has been in place for several decades, soils in the area are well suited for the park and park facilities.
Hazards and Nuisances including Site Safety and Noise	1	The proposed development will not result in new hazards, nuisances, or result in an increase risk to site safety or result in noise experienced in the area of the project. The park has historically been a source of crime in the neighborhood. The project is intended to reduce opportunities for crime, threats to public safety and improve the public perception of the park.
Energy Consumption	2	Although the proposal includes a change to existing park amenities, the project will not result in any significant change in energy consumption at the park.

Environmental Assessment Factor	Impact Code	Impact Evaluation
SOCIOECONOMIC		
Employment and Income Patterns	2	The park will not have any direct impacts on employment or income patterns in the area of the project.
Demographic Character Changes, Displacement	1	There will be no change in the demographics of the area. The project is intended to have a beneficial impact on the character and perception of the neighborhood. No displacement of persons or services will result due to project implementation.

Environmental Assessment Factor	Impact Code	Impact Evaluation
COMMUNITY FACILITIES AND SERVICES		
Educational and Cultural Facilities	1	The proposed improvements will benefit the adjacent school, currently under construction, and provide opportunities for

		outdoor recreation and education. No cultural facilities will be affected by the undertaking.
Commercial Facilities	2	The project will not have any direct impacts on any commercial facilities in the area of the project.
Health Care and Social Services	2	The project will not impact and health care and/or social services in the area of the project.
Solid Waste Disposal / Recycling	1	The existing project may include the removal of the existing restroom. In the past, the park restroom has provided a harbor for crime and been the subject of vandalism. The project will not negatively affect any recycling program.
Waste Water / Sanitary Sewers	2	As to drainage, the project is located within the Bakersfield Urbanized MS4 Boundary and will not result in additional waste water or runoff. Furthermore, the property directly west of the site is utilized as a drainage basin for the nearby community.
Water Supply	2	As use of the site will not change as a result of implementation, no change in water use or demand is anticipated.
Public Safety - Police, Fire and Emergency Medical	1	The project is intended to improve safety at the site, encourage local pride and increase use by residents of the community. A reduction in crime and related nuisance like vandalism is expected due to implementation. There will be no direct need for increased public safety services as a result of implementation.
Parks, Open Space and Recreation	1	It is hoped that the investment in facility improvements will encourage residents to increase park use and have more opportunities to for recreation.
Transportation and Accessibility	1	Transportation improvements including improvements to local streets and related park off-street parking areas may encourage additional park use by local residents. Additional pedestrian pathways will improve access and accessibility within the park for walking, jogging and for those with limits to mobility.

Environmental Assessment Factor	Impact Code	Impact Evaluation
NATURAL FEATURES		
Unique Natural Features, Water Resources	2	Since the site will continue to be used as open space, there is no expected change to natural resources or water resources as a result of implementation.
Vegetation, Wildlife	3	As noted under the ESA requirement above, the burrowing owl is a State of California listed species. The California Department of Fish and Wildlife (CDFW) has noted that burrowing owls have been documented within 700 feet of the project site, located in undeveloped grassland habitat

		<p>adjacent to the project site and the habitat may support small mammal burrows and support foraging habitat for burrowing owls. It is noted that Western Burrowing Owl is a covered species under the MBHCP.</p> <p>In addition to the MBHCP plan requirements, the CDFW has noted that the project area shall be evaluated by a biologist for compliance with the Migratory Bird Treaty Act and/or relevant Fish and Wildlife codes should ground-disturbing activities occur during the breeding season of February through mid-September.</p> <p>a) No more than 10 days prior to the start of ground disturbing, a qualified biologist shall conduct a pre-activity survey in order to maximize the probability that nests that could potentially be impacted are detected. The surveys shall cover a sufficient area around the work site to identify if nests are present and determine their status. Prior to construction, a qualified biologist shall conduct a survey to establish a behavioral baseline of all identified nests. During construction, that the biologist shall monitor nests to detect behavioral changes resulting from the project. If said changes occur, CDFW shall be consulted for additional avoidance and minimization measures.</p> <p>b) If continuous monitoring is not feasible, a disturbance buffer of 250 feet shall be established around active nests of non-listed birds and a 500 foot no-disturbance buffer around active nests for non-listed raptors. The buffers shall remain in place until the breeding season has ended or a qualified biologist has determined that the birds are fledged and are no longer reliant on upon the nest or parental care for survival. Variance from the no-disturbance buffers is possible when there is compelling biological or ecological reason to do so, such as when the construction area will be concealed from the nest by topography. A variance shall be supported by a qualified biologist and notify CDFW in advance of implementation of the variance.</p>
Other Factors	2	There are no other factors that require consideration for the purposes of implementation of the project.

Additional Studies Performed: N/A

Field Inspection (Date and completed by): 6/09/2020, James Golden, Planner III

List of Sources, Agencies and Persons Consulted [40 CFR 1508.9(b)]:

1. Airport Land Use Compatibility Plan; County of Kern
2. NEPAAssist; Project Site search
3. FEMA Federal Insurance Rate Maps (FIRM)
4. USFWS ECOS-IPaC website tool under Consultation Code 08ESMF00-2019-SLI-2845, Event Codes 08ESMF00-2020-E-02458 and 08ESMF00-2020-E-06556
5. State of California ENVIROSTOR AND GEOTRACKER websites
6. City of Bakersfield Website; City Maps <http://docs.bakersfieldcity.us/weblink/Browse.aspx?startid=990235&cr=1>; Zoning and Metro Bakersfield General Plan Map
7. Bakersfield City School District Website search “ Martin Luther” Family and Community Engagement; District Advisory Committee Meeting (DAC) - Meeting Minutes from December 3, 2019
8. Bakersfield Californian Website Article WHERE WE LIVE: Cottonwood still fighting stigma of gangs, poverty and despair; https://www.bakersfield.com/columnists/robert-price/where-we-live-cottonwood-still-fighting-stigma-of-gangs-poverty/article_9794c4d8-f52d-11e9-9098-f3b446bdfc49.html;

State of California

CalTrans District 6; California Dept. of Conservation - DOGGER (Bakersfield); California Reg. Water Quality Control Board - Central Valley; California Dept. of Fish and Wildlife; California Dept. of Conservation; Caltrans; State Historic Preservation Office (SHPO); Southern San Joaquin Valley Information Center (SSJVIC)

Other

AT&T California; OSP Engineering/ROW; Native Amer. Heritage Preservation Council; Kern Co Center on Race, Poverty, and the Environment (Oakland); Center on Race, Poverty, and the Environment (Delano); Pacific Gas & Electric (Bakersfield)

Local

Bakersfield City School District; Kern Union High School District; Golden Empire Transit District; Kern Mosquito and Vector Control District; Kern County Superintendent of Schools; Kern County Water Agency; San Joaquin Valley Unified APCD; California Water Service Co.; Bakersfield City School District

County

Kern County General Services Division; Kern County Airports; Kern County Fire Department; Kern County ESPS; Kern County Environmental Health Services; Kern County Sheriff

Federal

Bureau of Land Management - Bakersfield Office; US Fish & Wildlife, Sacramento Office; U.S. Department of Agriculture; Environmental Protection Agency

City of Bakersfield

Bakersfield City, Dept. of Public Works; Bakersfield SOI (Planning Department); Bakersfield Municipal Airport SOI; Kern River Groundwater Sustainability Agency

Tribal Contacts

Big Paiute Tribe of the Owens Valley; Chumash Council of Bakersfield; Kern Valley Indian Community; Kitanemuk and Yowlumne Tejon Indians; San Manuel Band of Mission Indians; Santa Rosa Rancheria Tachi Yokut Tribe; Tejon Indian Tribe; Tubatulabals of Kern Valley; Tule

River Indian Tribe; Wuksache Indian Tribe/Eshom Valley Band; Kern Valley Indian Council; Native Amer. Heritage Preservation Council

List of Permits Obtained: The General Services Division of the County of Kern is the lead agency for the project implementation and will act as project manager for construction purposes. Due to the project location, the project developer will need to apply for and obtain grading and building permits with the City of Bakersfield prior to undertaking the activity. Furthermore, the project is located in the MBHCP area and will need to demonstrate compliance with the applicable regulations upon implementation.

Public Outreach [24 CFR 50.23 & 58.43]: The project was included in the Annual Action Plan (AAP) and AAP public notices are advertised in twelve newspapers in circulation throughout the County of Kern. Prior to adoption of the AAP, a public hearing is conducted and the public is provided an opportunity to comment on the AAP. Furthermore, a substantial amendment to the project description was advertised in three local newspapers which includes El Popular's Spanish edition, and Bakersfield News Observer to insure that all persons are provided an opportunity to review the proposed revision to the activities.

Cumulative Impact Analysis [24 CFR 58.32]: The project is part of a larger effort to address the need for facility improvements within a low to moderate income Census Tract that encompasses the Cottonwood community. A new Bakersfield City School District Pre-Kindergarten through Sixth grade STEM school is under development to the south and west of the project site, with completion expected in August of 2020. The new school would include shared use of roads in the area of the project, including Citadel Street and the roadway to be named adjacent to the south boundary of the project site, the address of the school is to be 1100 Citadel Street. Additionally, under consideration is the annexation of isolated unincorporated pockets in the area known as Cottonwood, near Cottonwood Road. The impacts of the planned facility related improvements and other ongoing projects will benefit the community as a whole; by improving access to public safety and services, providing for new educational opportunities and promoting prosperity and growth. Additional cumulative impacts include impacts to local traffic patterns with planned increased use, increase in water and energy use to facilitate the new school. The current project is not expected to be the major contributing factor in the increase of traffic, water supply and use and additional energy as the facilities, which require the planned improvements are in place.

Alternatives [24 CFR 58.40(e); 40 CFR 1508.9] Alternatives to installation of proposed park improvements at Belle Terrace Park include (1) improving other nearby neighborhood and/or community parks in the area of the project; and (2) Reducing the scope of activities proposed for improvement; and (3) the no project alternative. Under the first alternative considered, another park in proximity to the Belle Terrace location would be improved with HUD funds. However, the park located nearest to the site, Casa Loma Park, is located within the Airport Land Use Compatibility Plan (ALUCP) - B1 Zone (Approach and Departure Zone) for Bakersfield Municipal Airport and therefore less suited for rehabilitation for the proposed outdoor activities under ALUCP guidelines. Due to the proximity of the airport, the site would be subject to low altitude flight patterns, noise and other nuisances from the nearby airport activities. The site is also not in proximity to the planned school and for these reasons rejected. The second alternative which includes reducing the scope of the activities, would achieve some of the intended goals and outcomes of the project. However, if selected, the proposal would leave additional community

needs unaddressed and it is likely that an additional phase or another project would be needed to address the gaps left without the facility investment as proposed and residents may be dissatisfied with implementation of the efforts to achieve the improvements desired within the neighborhood.

No Action Alternative [24 CFR 58.40(e)]: Under the no action alternative, no improvements proposed under the project would be implemented. If this alternative was selected, the planned funding would likely be appropriated to another project and the condition of facilities at Belle Terrace Park would continue to decline. There would be no improvements to public safety, placing students at the planned school at risk to crime, gangs, drug use and other symptoms of neglect. For these reasons, the no action alternative is rejected.

Summary of Findings and Conclusions: The planned improvements will provide new opportunities and support education and development of children and foster long overdue growth in the economically challenged and diverse community of Cottonwood. There are very few physical constraints to undertaking the proposed improvements and constraints which are present, have been addressed through the implementation of reasonable measures to address the concerns noted in this document.

Mitigation Measures and Conditions [40 CFR 1505.2(c)]

Summarize below all mitigation measures adopted by the Responsible Entity to reduce, avoid, or eliminate adverse environmental impacts and to avoid non-compliance or non-conformance with the above-listed authorities and factors. These measures/conditions must be incorporated into project contracts, development agreements, and other relevant documents. The staff responsible for implementing and monitoring mitigation measures should be clearly identified in the mitigation plan.

Law, Authority, or Factor	Mitigation Measure
Clean Air	<p><u>Prior the issuance of any grading or building permits</u>, all required air quality permits shall be obtained from San Joaquin Valley Air Pollution Control District (District): The District has noted that the Project may be subject to the following District Rules: Regulation VIII (Fugitive PM10 prohibitions), Rule 4102 (Nuisance), Rule 4601 (Architectural Coatings) and Rule 4641 (Cutback, Slow Cure and Emulsified Asphalt, Paving and Maintenance Operations).</p> <p>In the event that an existing building will be renovated, partially demolished, or removed, the project may be subject to District Rule 4002 - National Emission Standards for Hazardous Air Pollutants (NESHAP).</p>
Endangered Species	<p><u>14 to 30 days prior to the commencement of operations or other ground disturbing activities</u>, the project developer shall ensure that a preconstruction survey, is performed by a qualified biologist. A qualified biologist shall use the most current Project Grading Plan to develop a survey area that includes:</p> <ul style="list-style-type: none"> - All areas to be permanently disturbed; - Any temporary disturbance areas (e.g., staging areas, utility undergrounding footprints, etc.); and - 50-foot buffer of both the permanent and temporary disturbance area. <p>The Qualified Biologist shall map the Survey Area onto the grading plan or other ground-disturbance plan, and includes it in the Biological Clearance Survey Report.</p> <p>If survey conducted finds covered species within the survey area, then the developer is required to provide notice of intent to action to the City of Bakersfield, as required by the City steps to compliance. Additionally, the Community Development Division of the Planning and Natural Resources Department shall be notified at least five business days prior to disturbance and after minimization measures are implemented. If after survey is conducted, if no covered species are found, then no notice is required.</p> <p>The results of the survey shall be summarized in a Biological Clearance Survey Report that shall include site-specific recommendations. Minimization measures shall be specific for San Joaquin Kit Fox and Bakersfield Cactus, as applicable.</p>

	<p>A copy of the biological report shall be submitted to the Kern County Planning and Natural Resources Department – Community Development Division for transmittal to the California Department of Fish and Wildlife and the U.S. Fish and Wildlife Service. Additionally, exclusion zones shall be established and maintained until all construction activities are complete, unless trustee agencies provide comment noting that special status species be avoided, removed and/or relocated, in accordance with said agencies adopted guidelines or standard procedures.</p>
<p>Historic Preservation</p>	<p><u>During all ground disturbing related activities</u>, should any cultural resources be unearthed, all work must halt in the area of the find and a qualified, professional consultant be called out to assess the findings and make appropriate recommendations prior to commencement of operations within the area of the find.</p>
<p>Vegetation, Wildlife</p>	<p>1) <u>If ground-disturbing actions are to take place during the breeding season of February through mid-September</u>, the project area shall be evaluated for compliance with the Migratory Bird Treaty Act and/or relevant Fish and Wildlife codes.</p> <p>2) <u>No more than 10 days prior to the start of ground disturbing activities</u>, a qualified biologist shall conduct a pre-activity survey in order to maximize the probability that nests that could potentially be impacted are detected. The surveys shall cover a sufficient area around the work site to identify if nests are present and determine their status.</p> <p>Prior to construction, a qualified biologist shall conduct a survey to establish a behavioral baseline of all identified nests. During construction, that the biologist shall monitor nests to detect behavioral changes resulting from the project. If said changes occur, California Department of Fish and Wildlife (CDFW) shall be consulted for additional avoidance and minimization measures.</p> <p>If continuous monitoring is not feasible, a disturbance buffer of 250 feet shall be established around active nests of non-listed birds and a 500 foot no-disturbance buffer around active nests for non-listed raptors. The buffers shall remain in place until the breeding season has ended or a qualified biologist has determined that the birds are fledged and are no longer reliant on upon the nest or parental care for survival. Variance from the no-disturbance buffers is possible when there is compelling biological or ecological reason to do so, such as when the</p>

	construction area will be concealed from the nest by topography. A variance shall be supported by a qualified biologist and notify CDFW in advance of implementation of the variance.
--	---

Determination:

Finding of No Significant Impact [24 CFR 58.40(g)(1); 40 CFR 1508.27]
The project will not result in a significant impact on the quality of the human environment.

Finding of Significant Impact [24 CFR 58.40(g)(2); 40 CFR 1508.27]
The project may significantly affect the quality of the human environment.

Preparer Signature:  _____ Date: 6/10/20 _____

Name/Title/Organization: James Golden/Planner III/ Kern County Planning and Natural Resources-Community Development Division _____

Certifying Officer Signature:  _____ Date: 6/10/20 _____

Name/Title: Lorelei H. Oviatt, AICP, Director of Planning and Natural Resources

This original, signed document and related supporting material must be retained on file by the Responsible Entity in an Environmental Review Record (ERR) for the activity/project (ref: 24 CFR Part 58.38) and in accordance with recordkeeping requirements for the HUD program(s).

Mitigation Monitoring Program

Consultation Requests and Responses



United States Department of the Interior



FISH AND WILDLIFE SERVICE
Sacramento Fish And Wildlife Office
Federal Building
2800 Cottage Way, Room W-2605
Sacramento, CA 95825-1846
Phone: (916) 414-6600 Fax: (916) 414-6713

In Reply Refer To:

June 09, 2020

Consultation Code: 08ESMF00-2019-SLI-2845

Event Code: 08ESMF00-2020-E-06556

Project Name: Belle Terrace Park Improvements

Subject: Updated list of threatened and endangered species that may occur in your proposed project location, and/or may be affected by your proposed project

To Whom It May Concern:

The enclosed species list identifies threatened, endangered, proposed and candidate species, as well as proposed and final designated critical habitat, under the jurisdiction of the U.S. Fish and Wildlife Service (Service) that may occur within the boundary of your proposed project and/or may be affected by your proposed project. The species list fulfills the requirements of the Service under section 7(c) of the Endangered Species Act (Act) of 1973, as amended (16 U.S.C. 1531 *et seq.*).

Please follow the link below to see if your proposed project has the potential to affect other species or their habitats under the jurisdiction of the National Marine Fisheries Service:

http://www.nwr.noaa.gov/protected_species/species_list/species_lists.html

New information based on updated surveys, changes in the abundance and distribution of species, changed habitat conditions, or other factors could change this list. Please feel free to contact us if you need more current information or assistance regarding the potential impacts to federally proposed, listed, and candidate species and federally designated and proposed critical habitat. Please note that under 50 CFR 402.12(e) of the regulations implementing section 7 of the Act, the accuracy of this species list should be verified after 90 days. This verification can be completed formally or informally as desired. The Service recommends that verification be completed by visiting the ECOS-IPaC website at regular intervals during project planning and implementation for updates to species lists and information. An updated list may be requested through the ECOS-IPaC system by completing the same process used to receive the enclosed list.

The purpose of the Act is to provide a means whereby threatened and endangered species and the ecosystems upon which they depend may be conserved. Under sections 7(a)(1) and 7(a)(2) of the Act and its implementing regulations (50 CFR 402 *et seq.*), Federal agencies are required to utilize their authorities to carry out programs for the conservation of threatened and endangered species and to determine whether projects may affect threatened and endangered species and/or designated critical habitat.

A Biological Assessment is required for construction projects (or other undertakings having similar physical impacts) that are major Federal actions significantly affecting the quality of the human environment as defined in the National Environmental Policy Act (42 U.S.C. 4332(2) (c)). For projects other than major construction activities, the Service suggests that a biological evaluation similar to a Biological Assessment be prepared to determine whether the project may affect listed or proposed species and/or designated or proposed critical habitat. Recommended contents of a Biological Assessment are described at 50 CFR 402.12.

If a Federal agency determines, based on the Biological Assessment or biological evaluation, that listed species and/or designated critical habitat may be affected by the proposed project, the agency is required to consult with the Service pursuant to 50 CFR 402. In addition, the Service recommends that candidate species, proposed species and proposed critical habitat be addressed within the consultation. More information on the regulations and procedures for section 7 consultation, including the role of permit or license applicants, can be found in the "Endangered Species Consultation Handbook" at:

<http://www.fws.gov/endangered/esa-library/pdf/TOC-GLOS.PDF>

Please be aware that bald and golden eagles are protected under the Bald and Golden Eagle Protection Act (16 U.S.C. 668 *et seq.*), and projects affecting these species may require development of an eagle conservation plan (http://www.fws.gov/windenergy/eagle_guidance.html). Additionally, wind energy projects should follow the wind energy guidelines (<http://www.fws.gov/windenergy/>) for minimizing impacts to migratory birds and bats.

Guidance for minimizing impacts to migratory birds for projects including communications towers (e.g., cellular, digital television, radio, and emergency broadcast) can be found at: <http://www.fws.gov/migratorybirds/CurrentBirdIssues/Hazards/towers/towers.htm>; <http://www.towerkill.com>; and <http://www.fws.gov/migratorybirds/CurrentBirdIssues/Hazards/towers/comtow.html>.

We appreciate your concern for threatened and endangered species. The Service encourages Federal agencies to include conservation of threatened and endangered species into their project planning to further the purposes of the Act. Please include the Consultation Tracking Number in the header of this letter with any request for consultation or correspondence about your project that you submit to our office.

Attachment(s):

- Official Species List

Official Species List

This list is provided pursuant to Section 7 of the Endangered Species Act, and fulfills the requirement for Federal agencies to "request of the Secretary of the Interior information whether any species which is listed or proposed to be listed may be present in the area of a proposed action".

This species list is provided by:

Sacramento Fish And Wildlife Office

Federal Building

2800 Cottage Way, Room W-2605

Sacramento, CA 95825-1846

(916) 414-6600

Project Summary

Consultation Code: 08ESMF00-2019-SLI-2845

Event Code: 08ESMF00-2020-E-06556

Project Name: Belle Terrace Park Improvements

Project Type: RECREATION CONSTRUCTION / MAINTENANCE

Project Description: (Phase 1) Design and construction of park related improvements and upgrades which may include: rehabilitation of pedestrian paths of travel, planting of trees, playground renovations installation of: irrigation, decorative fencing, new soccer field, new tot play structure, two additional play structures and four (4) shade canopies of, seven (7) exercise equipment stations. Sand play area surfacing may be replaced with rubberized play surface materials, demolition of existing restroom. (Phase II) Provides additional CDBG funding for the design, construction and installation of park related improvements and upgrades to include park benches and shade structures at Belle Terrace Park

Project Location:

Approximate location of the project can be viewed in Google Maps: <https://www.google.com/maps/place/35.34547814196327N118.98791223253517W>

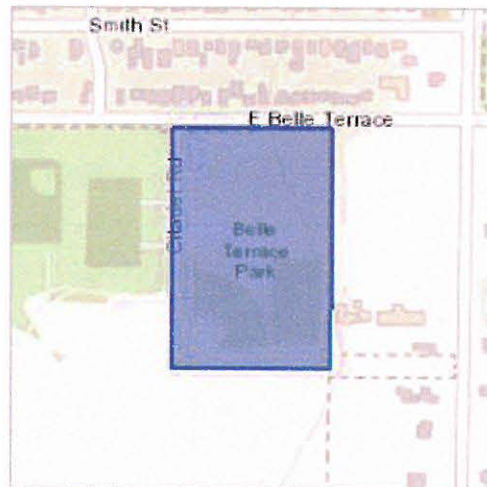

Counties: Kern, CA

Endangered Species Act Species

There is a total of 9 threatened, endangered, or candidate species on this species list.

Species on this list should be considered in an effects analysis for your project and could include species that exist in another geographic area. For example, certain fish may appear on the species list because a project could affect downstream species.

IPaC does not display listed species or critical habitats under the sole jurisdiction of NOAA Fisheries¹, as USFWS does not have the authority to speak on behalf of NOAA and the Department of Commerce.

See the "Critical habitats" section below for those critical habitats that lie wholly or partially within your project area under this office's jurisdiction. Please contact the designated FWS office if you have questions.

-
1. [NOAA Fisheries](#), also known as the National Marine Fisheries Service (NMFS), is an office of the National Oceanic and Atmospheric Administration within the Department of Commerce.

Mammals

NAME	STATUS
San Joaquin Kit Fox <i>Vulpes macrotis mutica</i> No critical habitat has been designated for this species. Species profile: https://ecos.fws.gov/ecp/species/2873	Endangered
Tipton Kangaroo Rat <i>Dipodomys nitratooides nitratooides</i> No critical habitat has been designated for this species. Species profile: https://ecos.fws.gov/ecp/species/7247 Species survey guidelines: https://ecos.fws.gov/ipac/guideline/survey/population/40/office/11420.pdf	Endangered

Birds

NAME	STATUS
Southwestern Willow Flycatcher <i>Empidonax traillii extimus</i> There is final critical habitat for this species. Your location is outside the critical habitat. Species profile: https://ecos.fws.gov/ecp/species/6749	Endangered

Lorelei H. Oviatt, AICP, Director
2700 "M" Street, Suite 250
Bakersfield, CA 93301-2323
Phone: (661) 862-5050
Fax: (661) 862-5052 TTY Relay 1-800-735-2929
Email: kerncd@kerncounty.com
Web Address: <http://kernplanning.com>



**PLANNING AND NATURAL
RESOURCES DEPARTMENT**

Planning
Community Development
Administrative Operations

January 14, 2019

File: Environmental Review Record (ERR)

State Historic Preservation Officer, Office of Historic Preservation
Department of Parks and Recreation
1416 9th Street, Room 1442
P.O. Box 942896
Sacramento, CA 94296-0001
Attn: Ms. Lucinda Woodward

**Re: CD Activity No. 3.19.4 - Belle Terrace Park Improvements Project, County of Kern, East
Bakersfield Area**

Dear Ms. Woodward:

This letter is a request pursuant to Section 106 of the National Historic Preservation Act. Specifically we ask for your views and concurrence with regard to identification of historic resources (36 CFR 800.4) and assessment of adverse effects (36 CFR 800.5). The Area of Potential Effects (APE), as defined at 36 CFR 800.16 (d), is Belle Terrace Park within the City of Bakersfield; a County owned Park located within the City of Bakersfield.

The proposed Project consists of the design and construction of park related improvements and upgrades which may include: rehabilitation of pedestrian paths of travel, planting of trees, playground renovations installation of: irrigation, decorative fencing, new soccer field, new tot play structure, two additional play structures and four (4) shade canopies of, seven (7) exercise equipment stations. Sand play area surfacing may be replaced with rubberized play surface materials and activities may include the demolition of the existing restroom.

Aerial photos of the site indicate that in 1956 the site was used for two separate uses. The northerly portion of the site was used as a multi-family residence and the bulk of the southerly portion of the site was used as an auto-storage and/or wrecking yard. The most westerly portion of the site remained vacant and undeveloped. 1967 Aerial photos indicate that the site use was converted to its current use as a park.

A record search was requested from Southern San Joaquin Information Center (SSJVIC). SSJVIC noted that there are no previous cultural resource studies conducted within the project site. However there have been nine studies within a one half mile radius of the site, KE02211, 02278, 02078, 03132, 03208, 03412, 03444, 03528 and 04160. Furthermore, SSJVIC noted there are no recorded cultural resources within the area of the project, and it is not known if any exist there. Eight recorded resources within a one-half mile radius, P-15-002050, 008025, 008030, 008079, 008080, 008136, 012430 and 012431. The resources noted consist of historic era railroad, and single-family residences. SSJVIC noted there are no recorded cultural resources within the project area that are listed in the National Register of Historic Places, the California Register of Historical Resources, the California Points of Historical Interest, California Inventory of Historic Resources, or the California State Historic Landmarks.

SSJVIC has noted that due to the age of the park, the site be recorded and evaluated for historical significance. However, Staff has determined that park is consistent with other parks of its era and proposed rehabilitation activities will encourage enhance safety and add or improve park amenities and encourage new interest from local residents. Based on SSJVIC comments regarding to cultural

resources, Staff will include a provision to address cultural resources, and halt work in the area of the find, should any cultural resources be unearthed as a result of implementation. A project location map and photos of the site have been included with this determination.

Based on the foregoing evaluation, we have made the following finding(s) regarding the proposed undertaking and its impact on Historic Properties within the Area of Potential Effects for the project:

[X] No Historic Properties, as defined at 36 CFR 800.16 (l), will be affected by the undertakings.

[] The undertaking **will not** have an adverse effect, as defined at 36 CFR 800.5, on Historic Properties.

[] The undertaking **will** have an adverse effect on Historic Properties, as defined at 36 CFR 800.5 (a), and requires further consultation and resolution between this Agency, SHPO and the Advisory Council on Historic Preservation, in accordance with 36 CFR 800.6.

If you have questions or require further documentation, please contact me at (661) 862-5130 or email me at goldenj@kerncounty.com. Thank You.

Sincerely,



James Golden, Planner III
Planning and Natural Resources Department
Community Development Division
Enclosure; Site and Related Project Maps

I:\CEDD\PLANNING\Golden\Environmental Reviews\2019-20\Belle Terrace\SHPO_Ltr1.docx

James Golden

From: CD, Kern
Sent: Friday, February 14, 2020 7:37 AM
To: James Golden
Subject: FW: Early consultation for CD Activity # 3.19.4 - Belle Terrace Park Improvement Project

From: Alexandra McCleary <Alexandra.McCleary@sanmanuel-nsn.gov>
Sent: Thursday, February 13, 2020 5:23 PM
To: CD, Kern <KERNCD@kerncounty.com>
Subject: Early consultation for CD Activity # 3.19.4 - Belle Terrace Park Improvement Project

CAUTION: This email originated from outside of the organization. Do not click links, open attachments, or provide information unless you recognize the sender and know the content is safe.

Dear James Golden,

Thank you for contacting the San Manuel Band of Mission Indians (SMBMI) regarding the above-referenced project. SMBMI appreciates the opportunity to review the project documentation, which was received by the Cultural Resources Management Department on January 27, 2020. The proposed project is located outside of Serrano ancestral territory and, as such, SMBMI will not be requesting consulting party status with the lead agency or requesting to participate in the scoping, development, and/or review of documents created pursuant to legal and regulatory mandates.

Kind regards,
Alexandra McCleary

Alexandra McCleary
TRIBAL ARCHAEOLOGIST
O: (909) 864-8933 x502023
M: (909) 633-0054
26569 Community Center Drive Highland CA 92346
SAN MANUEL
BAND OF MISSION INDIANS

THIS MESSAGE IS INTENDED ONLY FOR THE USE OF THE INDIVIDUAL OR ENTITY TO WHICH IT IS ADDRESSED AND MAY CONTAIN INFORMATION THAT IS PRIVILEGED, CONFIDENTIAL AND EXEMPT FROM DISCLOSURE UNDER APPLICABLE LAW. If the reader of this message is not the intended recipient or agent responsible for delivering the message to the intended recipient, you are hereby notified that any dissemination or copying of this communication is strictly prohibited. If you have received this electronic transmission in error, please delete it from your system without copying it and notify the sender by reply e-mail so that the email address record can be corrected. Thank You



NATIVE AMERICAN HERITAGE COMMISSION

January 21, 2020

James Golden
County of Kern

Via Email to: goldenj@kerncounty.com

Re: 3.19.4 – Belle Terrace Park Improvement Project, Kern County

Dear Mr. Golden:

A record search of the Native American Heritage Commission (NAHC) Sacred Lands File (SLF) was completed for the information you have submitted for the above referenced project. The results were negative. However, the absence of specific site information in the SLF does not indicate the absence of cultural resources in any project area. Other sources of cultural resources should also be contacted for information regarding known and recorded sites.

Attached is a list of Native American tribes who may also have knowledge of cultural resources in the project area. This list should provide a starting place in locating areas of potential adverse impact within the proposed project area. I suggest you contact all of those indicated; if they cannot supply information, they might recommend others with specific knowledge. By contacting all those listed, your organization will be better able to respond to claims of failure to consult with the appropriate tribe. If a response has not been received within two weeks of notification, the Commission requests that you follow-up with a telephone call or email to ensure that the project information has been received.

If you receive notification of change of addresses and phone numbers from tribes, please notify me. With your assistance, we can assure that our lists contain current information.

If you have any questions or need additional information, please contact me at my email address: Andrew.Green@nahc.ca.gov.

Sincerely,

Andrew Green
Staff Services Analyst

Attachment

CHAIRPERSON
Laura Miranda
Luiseño

VICE CHAIRPERSON
Reginald Pagaling
Chumash

SECRETARY
Merri Lopez-Kelfer
Luiseño

PARLIAMENTARIAN
Russell Attebery
Karuk

COMMISSIONER
Marshall McKay
Wintun

COMMISSIONER
William Mungary
Paiute/White Mountain
Apache

COMMISSIONER
Joseph Myers
Pomo

COMMISSIONER
**Julie Tumamait-
Stenslie**
Chumash

COMMISSIONER
[Vacant]

EXECUTIVE SECRETARY
Christina Snider
Pomo

NAHC HEADQUARTERS
1550 Harbor Boulevard
Suite 100
West Sacramento,
California 95691
(916) 373-3710
nahc@nahc.ca.gov
NAHC.ca.gov

**Native American Heritage Commission
Native American Contacts List
January 21, 2020**

Santa Rosa Rancheria Tachi Yokut Tribe
Leo Sisco, Chairperson
P.O. Box 8
Lemoore CA 93245
(559) 924-1278
(559) 924-3583 Fax

Tache
Tachi
Yokut

Wuksache Indian Tribe/Eshom Valley Band
Kenneth Woodrow, Chairperson
1179 Rock Haven Ct.
Salinas CA 93906
kwood8934@aol.com
(831) 443-9702

Foothill Yokuts
Mono
Wuksache

Tejon Indian Tribe
Octavio Escobedo, Chairperson
1731 Hasti-acres Drive, Suite 108 Kitanemuk
Bakersfield CA 93309
oescobedo@tejonindiantribe-nsn.gov
(661) 834-8566
(661) 834-8564 Fax

Tejon Indian Tribe
Colin Rambo, Cultural Resources Management
1731 Hasti-Acres Drive, Suite 108 Kitanemuk
Bakersfield CA 93309
colin.rambo@tejonindiantribe-nsn.gov
(661) 834-8566
(484) 515-4790 Cell

Tubatulabals of Kern Valley
Robert L. Gomez, Jr., Tribal Chairperson
P.O. Box 226 Tubatulabal
Lake Isabella CA 93240
(760) 379-4590
(760) 379-4592 Fax

Tule River Indian Tribe
Neil Peyron, Chairperson
P.O. Box 589 Yokuts
Porterville CA 93258
neil.peyron@tulerivertribe-nsn.gov
(559) 781-4271
(559) 781-4610 Fax

This list is current as of the date of this document and is based on the information available to the Commission on the date it was produced.

Distribution of this list does not relieve any person of statutory responsibility as defined in Section 7050.5 of the Health and Safety Code, Section 5097.94 of the Public Resources Code, or Section 5097.98 of the Public Resources Code.

This list is only applicable for contacting local Native Americans Tribes for the proposed:
3.19.4 – Belle Terrace Park Improvement Project, Kern County.

**Native American Heritage Commission
Native American Contacts List
January 21, 2020**

<p>Big Pine Paiute Tribe of the Owens Valley James Rambeau, Sr., Chairperson P.O. Box 700 Big Pine CA 93513 j.rambeau@bigpinepaiute.org (760) 938-2003 (976) 938-2942 Fax</p>	<p>Paiute - Shoshone</p>	<p>Kern Valley Indian Community Robert Robinson, Chairperson P.O. Box 1010 Lake Isabella CA 93240 bbutterbredt@gmail.com (760) 378-2915 Cell</p>	<p>Tubatulabal Kawaiisu</p>
<p>Big Pine Paiute Tribe of Owens Valley Sally Manning, Environmental Director P.O. Box 700 Big Pine CA 93513 s.manning@bigpinepaiute.org (760) 938-2003 (760) 938-2942 Fax</p>	<p>Paiute</p>	<p>Kern Valley Indian Community Brandy Kendricks 30741 Foxridge Court Tehachapi CA 93561 krazykendricks@hotmail.com (661) 821-1733 (661) 972-0445</p>	<p>Kawaiisu Tubatulabal</p>
<p>Big Pine Paiute Tribe of the Owens Valley Danelle Gutierrez THPO P.O. Box 700 Big Pine CA 93513 d.gutierrez@bigpinepaiute.org (760) 938-2003, ext. 228 (760) 938-2942 Fax</p>	<p>Paiute</p>	<p>Kitanemuk & Yowlumne Tejon Indians Delia Dominguez, Chairperson 115 Radio Street Bakersfield CA 93305 2deedominguez@gmail.com (626) 339-6785</p>	<p>Yowlumne Kitanemuk</p>
<p>Chumash Council of Bakersfield Julio Quair, Chairperson 729 Texas Street Bakersfield CA 93307 chumashtribe@sbcglobal.net (661) 322-0121</p>	<p>Chumash</p>	<p>San Manuel Band of Mission Indians Lee Clauss, Director-CRM Dept. 26569 Community Center Drive Highland CA 92346 lclauss@sanmanuel-nsn.gov (909) 864-8933 (909) 864-3370 Fax</p>	<p>Serrano</p>
<p>Kern Valley Indian Community Julie Turner, Secretary P.O. Box 1010 Lake Isabella CA 93240 (661) 340-0032 Cell</p>	<p>Kawaiisu Tubatulabal</p>	<p>San Manuel Band of Mission Indians Lynn Valbuena, Chairwoman 26569 Community Center Dr. Highland CA 92346 (909) 864-8933</p>	<p>Serrano</p>

This list is current as of the date of this document and is based on the information available to the Commission on the date it was produced.

Distribution of this list does not relieve any person of statutory responsibility as defined in Section 7050.5 of the Health and Safety Code, Section 5097.94 of the Public Resources Code, or Section 5097.98 of the Public Resources Code.

This list is only applicable for contacting local Native Americans Tribes for the proposed:
3.19.4 – Belle Terrace Park Improvement Project, Kern County.



San Joaquin Valley

AIR POLLUTION CONTROL DISTRICT

NOV 13 2019



Dennis McNamara
County of Kern
Planning and Natural Resources Department
2700 "M" Street, Suite 100
Bakersfield, CA 93301

Subject: Applicability of Indirect Source Review (ISR) Rule 9510: Not Subject
Project Name: Belle Terrace Park Improvements
ISR Determination Project No.: C20190513

Dear Mr. McNamara:

The San Joaquin Valley Air Pollution Control District (District) is in receipt of your correspondence dated November 6, 2019, requesting determination of the applicability of District Rule 9510 (Indirect Source Review) to the above referenced. The project consists of the rehabilitation of pedestrian paths, planting trees, playground renovations, updated irrigation, decorative fencing, new soccer fields, new tot play structure, two additional play structures, four shade canopies, and seven exercise equipment stations for a total of 8,000 square feet located at E Belle Terrace and Cottonwood Rd, in Bakersfield, CA.

The District has reviewed the information provided and has determined the project size is below the District Rule 9510, section 2.1 applicability threshold of 20,000 square feet for a recreational development. Therefore, District Rule 9510 requirements and related fees do not apply to the project referenced above.

Please be aware that changes to the project, i.e., change in land use type or increase in use intensity may exceed an applicability threshold, resulting in the project being subject to District Rule 9510.

Also, enclosed is a document with answers to frequently asked questions regarding Indirect Source Review (ISR). This may be used as a reference to better understand ISR and how the District processes applications. Should the project become subject to Rule 9510, an Air Impact Assessment (AIA) application must be submitted to the District, consistent with Section 5.0 of District Rule 9510. The AIA application can be downloaded from the District's website at <http://www.valleyair.org/ISR/ISRFormsAndApplications.htm>.

RECEIVED

NOV 18 2019

Samir Sheikh
Executive Director/Air Pollution Control Officer

Kern County Planning &
Natural Resources Dept.

Northern Region
4800 Enterprise Way
Modesto, CA 95356-8718
Tel: (209) 557-6400 FAX: (209) 557-6475

Central Region (Main Office)
1990 E. Gettysburg Avenue
Fresno, CA 93726-0244
Tel: (559) 230-6000 FAX: (559) 230-6061

Southern Region
34946 Flyover Court
Bakersfield, CA 93308-9725
Tel: 661-392-5500 FAX: 661-392-5585

Please pay close attention to the following additional information:

- Dust Control Plan. Please be aware that you may be required to submit a Construction Notification Form or submit and receive approval of a Dust Control Plan prior to commencing any earthmoving activities as described in District Rule 8021 – *Construction, Demolition, Excavation, Extraction, and Other Earthmoving Activities*. Information on how to comply with Regulation VIII can be found online at: http://www.valleyair.org/busind/comply/PM10/compliance_PM10.htm.
- Asbestos Requirements for Demolitions. In the event an existing building will be renovated, partially demolished or removed, the Project may be subject to District Rule 4002. This rule requires a thorough inspection for asbestos to be conducted before any regulated facility is demolished or renovated. Information on how to comply with District Rule 4002 can be found online at: <http://www.valleyair.org/busind/comply/asbestosbuln.htm>.

To identify other District rules or regulations that apply to this project or to obtain information about District rules and permit requirements, the applicant is strongly encouraged to visit www.valleyair.org or contact the District Small Business Assistance office at:

Fresno office: (559) 230-5888
Modesto office: (209) 557-6446
Bakersfield office: (661) 392-5665

Thank you for your cooperation in this matter. If you have any questions or require further information, please call District Technical Services staff at (559) 230-6000.

Sincerely,

Arnaud Marjollet
Director of Permit Services

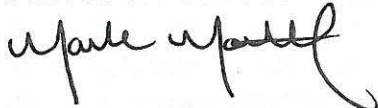

: Robert Gilles
Program Manager

AM: em

Enclosure: FAQ ISR



SEP 17 2019

Lorelei H. Oviatt
County of Kern
Planning and Natural Resources Department
2700 "M" Street, Suite 250
Bakersfield, CA, 93301-2323

Project: Early Environmental Consultation for the Belle Terrace Park Improvement Project

District CEQA Reference No: 20191084

Dear Ms. Oviatt:

The San Joaquin Valley Unified Air Pollution Control District (District) has reviewed the project referenced above consisting of rehabilitation of pedestrian paths, planting trees, playground renovations, updated irrigation, decorative fencing, new soccer fields, new tot play structure, two additional play structures, four (4) shade canopies, and seven (7) exercise equipment stations (Project) located at East Belle Terrace, in Bakersfield, CA. The District offers the following comments:

District Comments

- 1) Based on information provided to the District, Project specific annual emissions of criteria pollutants are not expected to exceed any of the following District significance thresholds: 100 tons per year of carbon monoxide (CO), 10 tons per year of oxides of nitrogen (NOx), 10 tons per year of reactive organic gases (ROG), 27 tons per year of oxides of sulfur (SOx), 15 tons per year of particulate matter of 10 microns or less in size (PM10), or 15 tons per year of particulate matter of 2.5 microns or less in size (PM2.5). Therefore, the District concludes that the Project would have a less than significant impact on air quality when compared to the above-listed annual criteria pollutant emissions significance thresholds.
- 2) Per District Rule 9510 (Indirect Source Review) is intended to mitigate a project's impact on air quality through project design elements or by payment of applicable off-site fees. The proposed Project is subject to District Rule 9510 if (1) it has or will receive a project-level discretionary approval from a public agency and will equal or exceed 20,000 square feet of recreational space, or (2) if it has or will receive a project-level approval from a public agency and will equal or exceed 100,000 square feet of recreational space. If subject to the rule, an Air Impact Assessment (AIA)

Samir Sheikh
Executive Director/Air Pollution Control Officer

Northern Region
4800 Enterprise Way
Modesto, CA 95356-8718
Tel: (209) 567-6400 FAX: (209) 557-6475

Central Region (Main Office)
1990 E. Gettysburg Avenue
Fresno, CA 93726-0244
Tel: (559) 230-6000 FAX: (559) 230-6061

Southern Region
34946 Flyover Court
Bakersfield, CA 93308-9725
Tel: 661-392-5500 FAX: 661-392-5585

application is required prior to applying for project-level approval from a public agency. In this case, if not already done, please inform the project proponent to immediately submit an AIA application to the District to comply with District Rule 9510.

In the case the Project is subject to District Rule 9510 an AIA application is required and the District recommends that demonstration of compliance with District Rule 9510, before issuance of the first building permit, be made a condition of Project approval. Information about how to comply with District Rule 9510 can be found online at: <http://www.valleyair.org/ISR/ISRHome.htm>. The AIA application form can be found online at: <http://www.valleyair.org/ISR/ISRFormsAndApplications.htm>.

- 3) The proposed Project may be subject to the following District rules: Regulation VIII (Fugitive PM10 Prohibitions), Rule 4102 (Nuisance), Rule 4601 (Architectural Coatings), and Rule 4641 (Cutback, Slow Cure, and Emulsified Asphalt, Paving and Maintenance Operations). In the event an existing building will be renovated, partially demolished or removed, the Project may be subject to District Rule 4002 (National Emission Standards for Hazardous Air Pollutants).
- 4) The District recommends that a copy of the District's comments be provided to the Project proponent.

The above list of rules is neither exhaustive nor exclusive. To identify other District rules or regulations that apply to this Project or to obtain information about District permit requirements, the applicant is strongly encouraged to contact the District's Small Business Assistance Office at (559) 230-5888. Current District rules can be found online at: www.valleyair.org/rules/1ruleslist.htm.

District staff is available to meet with you and/or the applicant to further discuss the regulatory requirements that are associated with this Project. If you have any questions or require further information, please call Eric McLaughlin at (559) 230-5808.

Sincerely,

Arnaud Marjollet
Director of Permit Services

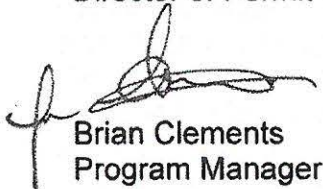

Brian Clements
Program Manager

AM: EM



State of California – The Natural Resources Agency
DEPARTMENT OF FISH AND WILDLIFE
Central Region
1234 East Shaw Avenue
Fresno, California 93710
(559) 243-4005
www.wildlife.ca.gov

GAVIN NEWSOM, Governor
CHARLTON H. BONHAM, Director



September 27, 2019

James Golden
Kern County Planning and Natural Resources Department
2700 M Street, Suite 250
Bakersfield, California 93301-2323

**Subject: CD Activity # 3.19.4 - Belle Terrace Park Improvements Project (Project),
EARLY ENVIRONMENTAL CONSULTATION REVIEW**

Dear Mr. Golden:

The California Department of Fish and Wildlife (CDFW) received an Early Environmental Consultation Review from the Kern County Planning and Natural Resources Department for the above-referenced Project pursuant the California Environmental Quality Act (CEQA) and CEQA Guidelines.¹

Thank you for the opportunity to provide comments and recommendations regarding those activities involved in the Project that may affect California fish and wildlife. Likewise, CDFW appreciates the opportunity to provide comments regarding those aspects of the Project that CDFW, by law, may be required to carry out or approve through exercise of its own regulatory authority under the Fish and Game Code.

CDFW ROLE

CDFW is California's **Trustee Agency** for fish and wildlife resources, and holds those resources in trust by statute for all the people of the State. (Fish & G. Code, §§ 711.7, subd. (a) & 1802; Pub. Resources Code, § 21070; CEQA Guidelines § 15386, subd. (a).) CDFW, in its trustee capacity, has jurisdiction over the conservation, protection, and management of fish, wildlife, native plants, and habitat necessary for biologically sustainable populations of those species. (*Id.*, § 1802.) Similarly, for purposes of CEQA, CDFW is charged by law to provide, as available, biological expertise during public agency environmental review efforts, focusing specifically on projects and related activities that have the potential to adversely affect fish and wildlife resources.

CDFW is also submitting comments as a **Responsible Agency** under CEQA. (Pub. Resources Code, § 21069; CEQA Guidelines, § 15381.) CDFW expects that it may

¹ CEQA is codified in the California Public Resources Code in section 21000 et seq. The "CEQA Guidelines" are found in Title 14 of the California Code of Regulations, commencing with section 15000.

James Golden
Kern County
September 27, 2019
Page 2

need to exercise regulatory authority as provided by the Fish and Game Code. As proposed, for example, construction associated with the Project may be subject to CDFW's lake and streambed alteration regulatory authority. (Fish & G. Code, § 1600 *et seq.*) Likewise, to the extent implementation of the Project as proposed may result in "take" as defined by State law of any species protected under the California Endangered Species Act (CESA) (Fish & G. Code, § 2050 *et seq.*), related authorization as provided by the Fish and Game Code will be required.

PROJECT DESCRIPTION SUMMARY

Proponent: Kern County Planning and Natural Resources Department (County)

Objective: The proposed Project at Belle Terrace Park includes the design and construction of park related improvements and upgrades which may include rehabilitation of pedestrian paths of travel, planting of trees, playground renovations, and the installation of irrigation, decorative fencing, new soccer field, new tot play structure, two additional play structures and four shade canopies of seven exercise equipment stations. Sand play area surfacing may be replaced with rubberized play surface materials. The Project also includes the demolition of the existing restroom.

Location: The project is located at Belle Terrace Park, 1101 East Belle Terrace, Bakersfield, California in Kern County.

Timeframe: Unspecified

COMMENTS AND RECOMMENDATIONS

CDFW offers the comments and recommendations below to assist Kern County in adequately identifying and/or mitigating the Project's significant, or potentially significant, direct and indirect impacts on fish and wildlife (biological) resources. Editorial comments or other suggestions may also be included to improve the document.

I. Environmental Setting and Related Impact

CDFW understands that the County is conducting an environmental review of the Project to identify any potential environmental effects and to determine if a Categorical Exemption from CEQA is appropriate. In the absence of additional information, CDFW cannot concur that a Categorical Exemption is appropriate for the Project at this time. CDFW is concerned regarding potential of the Project to impact special-status species including, but not limited to, the State Threatened and federally Endangered San Joaquin kit fox (*Vulpes macrotis mutica*) and the State Species of Special Concern burrowing owl (*Athene cunicularia*). Therefore, CDFW recommends the County prepare a CEQA document that analyzes potential impacts to biological resources and that also

identifies whether the Project will be covered by the Metropolitan Bakersfield Habitat Conservation Plan and companion Incidental Take Permit (MBHCP/ITP). Should the Project not be covered by the MBHCP/ITP, CDFW's recommendations are outlined below.

COMMENT 1: San Joaquin kit fox (SJKF)

Issue: SJKF are known to occur throughout the metropolitan Bakersfield area in a wide variety of urban habitats, including parks. They have also been documented in the vicinity of the Project site (CDFW 2019). SJKF may be attracted to the Project site due to the type and level of ground-disturbing activities and the loose, friable soils resulting from intensive ground disturbance. For these reasons, there is potential for SJKF to colonize the Project site.

Specific impact: Without appropriate avoidance and minimization measures for SJKF, potential significant impacts resulting from ground- and vegetation-disturbing activities associated with construction of the Project include den collapse, inadvertent entrapment or entanglement, reduced reproductive success, reduction in health and vigor of young, and direct mortality of individuals.

Evidence impact is potentially significant: Habitat loss resulting from agricultural, urban, and industrial development is the primary threat to SJKF (Cypher et al. 2013). Very little suitable habitat remains in Kern County (Cypher et al. 2013). Therefore, ground-disturbing activities within the Project site have the potential to significantly impact local SJKF populations.

Recommended Potentially Feasible Mitigation Measure(s) (Regarding Environmental Setting and Related Impact Shortcoming)

To evaluate potential Project-related impacts to SJKF, CDFW recommends conducting the following evaluation of the Project site and including the following measures in the CEQA document.

Recommended Mitigation Measure 1: SJKF Surveys

CDFW recommends assessing presence/absence of SJKF by conducting surveys following the U.S. Fish and Wildlife Service "Standardized recommendations for protection of the San Joaquin kit fox prior to or during ground disturbance" (2011). Specifically, CDFW advises conducting these surveys in all areas of potentially suitable habitat no less than 14 days and no more than 30 days prior to beginning of ground disturbing activities.

Recommended Mitigation Measure 2: SJKF Take Authorization

SJKF detection warrants consultation with CDFW to discuss how to avoid take, or if avoidance is not feasible, to acquire an Incidental Take Permit prior to ground-disturbing activities, pursuant to Fish and Game Code § 2081(b).

Recommended Mitigation Measure 3: Soccer Nets and Similar Structures

Soccer nets, batting cage nets, and similar structures have been a regularly observed source of injury and mortality for SJKF (B. Cypher, PhD; personal communication, December 3, 2018). SJKF become entangled in the nets and if not freed quickly may suffocate or suffer permanent injury due to blood loss to limbs. CDFW recommends that authorization of the project include a mitigation measure that requires that all soccer nets, etc., be removed or raised at least 3 feet off the ground when not in use. Alternatively, nets can use a smaller mesh (maximum size 2 inches) for the lower 3 feet to prevent a head or limb from becoming entangled in the net.

COMMENT 2: Burrowing Owl (BUOW)

Issue: BUOW have been documented within 700 feet of the Project site. The undeveloped grassland habitat adjacent to the Project site may support small mammal burrows, a requisite habitat feature for BUOW. Habitat both within and surrounding the Project site may also provide suitable foraging habitat for BUOW, increasing the likelihood of BUOW occurrence.

Specific impact: Potentially significant direct impacts associated with the Project's construction include burrow collapse, inadvertent entrapment, nest abandonment, reduced reproductive success, reduction in health and vigor of eggs and/or young, and direct mortality of individuals.

Evidence impact is potentially significant: BUOW rely on burrow habitat year-round for their survival and reproduction. Habitat loss and degradation are considered the greatest threats to BUOW in California's Central Valley (Gervais et al. 2008). The Project site is within the range of BUOW and suitable burrow habitat is present on or in the vicinity of the Project area. Therefore, the Project has the potential to significantly impact local BUOW populations.

Recommended Potentially Feasible Mitigation Measure(s) (Regarding Environmental Setting and Related Impact)

To evaluate potential Project-related impacts to BUOW, CDFW recommends conducting the following evaluation of the Project site and including the following measures in the CEQA document.

Recommended Mitigation Measure 4: BUOW Surveys

CDFW recommends assessing presence/absence of BUOW by having a qualified biologist conduct surveys following the California Burrowing Owl Consortium's "Burrowing Owl Survey Protocol and Mitigation Guidelines" (CBOC 1993) and CDFW's *Staff Report on Burrowing Owl Mitigation*" (CDFG 2012). In addition, CDFW advises that surveys include a 500-foot buffer around the Project site.

Recommended Mitigation Measure 5: BUOW Avoidance

CDFW recommends no-disturbance buffers, as outlined in the "*Staff Report on Burrowing Owl Mitigation*" (CDFG 2012), be implemented prior to and during any ground-disturbing activities associated with Project implementation. Specifically, CDFW's Staff Report recommends that impacts to occupied burrows be avoided in accordance with the following table unless a qualified biologist approved by CDFW verifies through non-invasive methods that either: 1) the birds have not begun egg laying and incubation; or 2) that juveniles from the occupied burrows are foraging independently and are capable of independent survival.

Location	Time of Year	Level of Disturbance		
		Low	Med	High
Nesting sites	April 1-Aug 15	200 m*	500 m	500 m
Nesting sites	Aug 16-Oct 15	200 m	200 m	500 m
Nesting sites	Oct 16-Mar 31	50 m	100 m	500 m

* meters (m)

Recommended Mitigation Measure 6: BUOW Passive Relocation and Mitigation

If BUOW are found to occupy the Project site and avoidance is not possible, it is important to note that according to the Staff Report (CDFG 2012), exclusion is not a minimization or mitigation method and is considered a potentially significant impact under CEQA. However, if necessary, CDFW recommends that burrow exclusion be conducted by qualified biologists and only during the non-breeding season, before breeding behavior is exhibited and after the burrow is confirmed empty through non-invasive methods, such as surveillance. CDFW recommends replacement of occupied burrows with artificial burrows at a ratio of 1 burrow collapsed to 1 artificial burrow constructed (1:1) as mitigation for the potentially significant impact of evicting BUOW. BUOW may attempt to colonize or re-colonize an area that will be impacted; thus, CDFW recommends ongoing surveillance of the Project site during Project activities, at a rate that is sufficient to detect BUOW if they return.

II. Editorial Comments and/or Suggestions

Federally Listed Species: CDFW recommends consulting with the United States Fish and Wildlife Service (USFWS) on potential impacts to federally listed species including, but not limited to, SJKF. Take under the Federal Endangered Species Act (FESA) is more broadly defined than CESA; take under FESA also includes significant habitat modification or degradation that could result in death or injury to a listed species by interfering with essential behavioral patterns such as breeding, foraging, or nesting. Consultation with the USFWS in order to comply with FESA is advised well in advance of any ground disturbing activities.

Nesting birds: CDFW encourages Project implementation occur during the bird non-nesting season. However, if ground-disturbing activities must occur during the breeding season (February through mid-September), the Project's applicant is responsible for ensuring that implementation of the Project does not result in violation of the Migratory Bird Treaty Act or relevant Fish and Game Codes as referenced above.

To evaluate Project-related impacts on nesting birds, CDFW recommends that a qualified wildlife biologist conduct pre-activity surveys for active nests no more than 10 days prior to the start of ground disturbance to maximize the probability that nests that could potentially be impacted are detected. CDFW also recommends that surveys cover a sufficient area around the work site to identify nests and determine their status. A sufficient area means any area potentially affected by the Project. In addition to direct impacts (i.e. nest destruction), noise, vibration, and movement of workers or equipment could also affect nests. Prior to initiation of construction activities, CDFW recommends a qualified biologist conduct a survey to establish a behavioral baseline of all identified nests. Once construction begins, CDFW recommends a qualified biologist continuously monitor nests to detect behavioral changes resulting from the Project. If behavioral changes occur, CDFW recommends the work causing that change cease and CDFW consulted for additional avoidance and minimization measures.

If continuous monitoring of identified nests by a qualified wildlife biologist is not feasible, CDFW recommends a minimum no-disturbance buffer of 250 feet around active nests of non-listed bird species and a 500-foot no-disturbance buffer around active nests of non-listed raptors. These buffers are advised to remain in place until the breeding season has ended or until a qualified biologist has determined that the birds have fledged and are no longer reliant upon the nest or parental care for survival. Variance from these no-disturbance buffers is possible when there is compelling biological or ecological reason to do so, such as when the construction area would be concealed from a nest site by topography. CDFW recommends that a qualified wildlife biologist advise and support any variance from these buffers and notify CDFW in advance of implementing a variance.

James Golden
Kern County
September 27, 2019
Page 7

ENVIRONMENTAL DATA

CEQA requires that information developed in environmental impact reports and negative declarations be incorporated into a database that may be used to make subsequent or supplemental environmental determinations. (Pub. Resources Code, § 21003, subd. (e)). Accordingly, please report any special status species and natural communities detected during Project surveys to the California Natural Diversity Database (CNDDDB). The CNDDDB field survey form can be found at the following link: <https://www.wildlife.ca.gov/Data/CNDDDB/Submitting-Data>. The completed form can be mailed electronically to CNDDDB at the following email address: CNDDDB@wildlife.ca.gov. The types of information reported to CNDDDB can be found at the following link: <https://www.wildlife.ca.gov/Data/CNDDDB/Plants-and-Animals>.

FILING FEES

The Project, as proposed, has the potential to impact fish and/or wildlife, and assessment of filing fees may be necessary. Fees are payable upon filing of the Notice of Determination by the Lead Agency and serve to help defray the cost of environmental review by CDFW. Payment of the fee is required in order for the underlying project approval to be operative, vested, and final. (Cal. Code Regs, tit. 14, § 753.5; Fish & G. Code, § 711.4; Pub. Resources Code, § 21089.)

CONCLUSION

CDFW appreciates the opportunity to comment on the Early Environmental Consultation Review to assist Kern County in identifying and mitigating subsequent project's impacts on biological resources.

Questions regarding this letter or further coordination should be directed to Jennifer Giannetta, Environmental Scientist, at the address provided on this letterhead, by telephone at (559) 243-4014 extension 216, or by electronic mail at Jennifer.Giannetta@wildlife.ca.gov.

Sincerely,



Julie A. Vance
Regional Manager

REFERENCES

- California Burrowing Owl Consortium (CBOC), 1993. Burrowing owl survey protocol and mitigation guidelines. Pages 171-177 in Lincer, J. L. and K. Steenhof (editors). 1993. The burrowing owl, its biology and management. Raptor Research Report Number 9.
- California Department of Fish and Game (CDFG), 2012. Staff Report on Burrowing Owl Mitigation. California Department of Fish and Game. March 7, 2012.
- California Department of Fish and Wildlife (CDFW), 2019. Biogeographic Information and Observation System (BIOS). <https://www.wildlife.ca.gov/Data/BIOS>. Accessed September 10, 2019.
- Cypher, B.L., S.E. Phillips, and P.A. Kelly, 2013. Quantity and distribution of suitable habitat for endangered San Joaquin kit foxes: conservation implications. *Canid Biology & Conservation* 16(7): 25-31.
http://www.canids.org/CBC/16/San_Joaquin_kit_fox_habitat_suitability.pdf
- Gervais, J. A., D. K. Rosenberg, and L. A. Comrack, 2008. Burrowing Owl (*Athene cunicularia*) In California Bird Species of Special Concern: A ranked assessment of species, subspecies, and distinct populations of birds of immediate conservation concern in California (W. D. Shuford and T. Gardali, editors). Studies of Western Birds 1. Western Field Ornithologists, Camarillo, California, and California Department of Fish and Game, Sacramento.
- United States Fish and Wildlife Service, 2011. Standard Recommendations for the Protection of the San Joaquin Kit Fox Prior to or During Ground Disturbance. United States Fish and Wildlife Service, January 2011.

James Golden

From: Mendoza, Yvan@DOC <Yvan.Mendoza@conservation.ca.gov>
Sent: Wednesday, September 4, 2019 2:16 PM
To: James Golden
Subject: DOGGR comments on Construction Site Review - Early Environmental Consultation Review for CD Activity # 3.19.4 - Belle Terrace Park Improvement Project
Attachments: 1011677_20190904_080043_CSWR Report.pdf

Good afternoon Mr. Golden,

Please find attached comments from the Division of Oil, Gas, and Geothermal Resources regarding:

Early Environmental Consultation Review for CD Activity # 3.19.4 - Belle Terrace Park Improvement Project

Regards,



Yvan Mendoza

Engineering Geologist | Inland District

California Department of Conservation
Division of Oil, Gas and Geothermal Resources
4800 Stockdale Hwy Ste 100
Bakersfield, CA 93309
T: (661) 326-6050
C: (661) 201-9551
E: yvan.mendoza@conservation.ca.gov





09/04/2019

County: Kern - Kern County Planning and Natural Resources Department
Yvan Mendoza
4800 Stockdale Highway, Suite 417, Bakersfield, CA 93309, USA
Yvan.Mendoza@conservation.ca.gov

Construction Site Well Review (CSWR) ID: 1011677

Assessor Parcel Number(s): 16820029

Property Owner(s): unknown unknown

Project Location Address: 465 ft SW from the intersection of, E Belle Terrace and Cottonwood Rd,
Bakersfield, California, 93307

Project Title: Early Environmental Consultation Review for CD Activity # 3.19.4 - Belle Terrace Park
Improvement Pk

Public Resources Code (PRC) § 3208.1 establishes well reabandonment responsibility when a previously plugged and abandoned well will be impacted by planned property development or construction activities. Local permitting agencies, property owners, and/or developers should be aware of, and fully understand, that significant and potentially dangerous issues may be associated with development near oil, gas, and geothermal wells.

The Division of Oil, Gas, and Geothermal Resources (Division) has received and reviewed the above referenced project dated 9/3/2019. To assist local permitting agencies, property owners, and developers in making wise land use decisions regarding potential development near oil, gas, or geothermal wells, the Division provides the following well evaluation.

The project is located in Kern County, within the boundaries of the following fields:

Our records indicate there are 0 known oil or gas wells located within the project boundary as identified in the application.

- Number of wells Not Abandoned to Current Division Requirements as Prescribed by Law and Projected to Be Built Over or Have Future Access Impeded by this project: 0
- Number of wells Not Abandoned to Current Division Requirements as Prescribed by Law and Not Projected to Be Built Over or Have Future Access Impeded by this project: 0
- Number of wells Abandoned to Current Division Requirements as Prescribed by Law and Projected to Be Built Over or Have Future Access Impeded by this project: 0
- Number of wells Abandoned to Current Division Requirements as Prescribed by Law and Not Projected to Be Built Over or Have Future Access Impeded by this project: 0

As indicated in PRC § 3106, the Division has statutory authority over the drilling, operation,



California
Department of Conservation
Division of Oil, Gas, and Geothermal Resources

Gavin Newsom, Governor
David Bunn, Director
801 K Street, MS 18-05
Sacramento, CA 95814
T: (916) 445-9686

maintenance, and abandonment of oil, gas, and geothermal wells, and attendant facilities, to prevent, as far as possible, damage to life, health, property, and natural resources; damage to underground oil, gas, and geothermal deposits; and damage to underground and surface waters suitable for irrigation or domestic purposes. In addition to the Division's authority to order work on wells pursuant to PRC §§ 3208.1 and 3224, it has authority to issue civil and criminal penalties under PRC §§ 3236, 3236.5, and 3359 for violations within the Division's jurisdictional authority. The Division does not regulate grading, excavations, or other land use issues.

If during development activities, any wells are encountered that were not part of this review, the property owner is expected to immediately notify the Division's construction site well review engineer in the Inland district office, and file for Division review an amended site plan with well casing diagrams. The District office will send a follow-up well evaluation letter to the property owner and local permitting agency.

Should you have any questions, please contact me at (661) 326-6016 or via email at Victor.Medrano@conservation.ca.gov

Sincerely,

Cameron Campbell
District Deputy

**Office of the Fire Marshal
Kern County Fire Department**

Fire Prevention

2820 M St. • Bakersfield, CA 93301 • www.kerncountyfire.org

Telephone 661-391-3310 • FAX 661-636-0466/67 • TTY Relay 800-735-2929



September 5, 2019

Kern County Planning and Natural Resources Department
2800 M St., Bakersfield, CA 93301
Attn.: James Golden

Re: Kern County Fire Department Comments Regarding Planning Department Project

To Whom It May Concern,

The Kern County Fire Department, as the local fire authority, has received a request for comments regarding Early Environmental Consultation Review 3.19.4. Upon initial review it has been determined that there are no Fire Code concerns regarding this project. A more detailed review and project comments will be conducted when the building permit is pulled and plans are submitted.

Please feel free to call our Fire Prevention Office at 661-391-3310 with any questions.

Sincerely,
Michael Nicholas
Assistant Fire Marshal
Kern County Fire Department

Office Memorandum

KERN COUNTY

To: Planning and Natural Resources
Department
James Golden

Date: September 3, 2019

From: Public Works Department
Floodplain Management Section
Kevin Hamilton, by Brian Blase

Phone: (661) 862-5098
Email: BlaseB@kerncounty.com

Subject: Early Environmental Consultation Review - CD Activity #3.19.4
Belle Terrace Park Improvements Project

From the information supplied with the Notice of Public Hearing, we have no comments or recommendations regarding the above project.



To: James Golden
Kern County Planning & Natural Resources Dept.
2700 M Street, Suite 250
Bakersfield, CA 93301

Record Search 19-339

Date: August 29, 2019

Re: CD Program Project 3.19.4 – Belle Terrace Park Improvements Project

County: Kern

Map(s): Lamont 7.5'

CULTURAL RESOURCES RECORDS SEARCH

The California Office of Historic Preservation (OHP) contracts with the California Historical Resources Information System's (CHRIS) regional Information Centers (ICs) to maintain information in the CHRIS inventory and make it available to local, state, and federal agencies, cultural resource professionals, Native American tribes, researchers, and the public. Recommendations made by IC coordinators or their staff regarding the interpretation and application of this information are advisory only. Such recommendations do not necessarily represent the evaluation or opinion of the State Historic Preservation Officer in carrying out the OHP's regulatory authority under federal and state law.

The following are the results of a search of the cultural resource files at the Southern San Joaquin Valley Information Center. These files include known and recorded cultural resources sites, inventory and excavation reports filed with this office, and resources listed on the National Register of Historic Places, Historic Property Directory, California State Historical Landmarks, California Register of Historical Resources, California Inventory of Historic Resources, and California Points of Historical Interest. Due to processing delays and other factors, not all of the historical resource reports and resource records that have been submitted to the Office of Historic Preservation are available via this records search. Additional information may be available through the federal, state, and local agencies that produced or paid for historical resource management work in the search area.

PRIOR CULTURAL RESOURCE STUDIES CONDUCTED WITHIN THE PROJECT AREA AND THE ONE-HALF MILE RADIUS

According to the information in our files, there have been no previous cultural resource studies conducted within the project area. There have been nine studies within the one-half mile radius, KE-02211, 02278, 02708, 03132, 03208, 03412, 03444, 03528, and 04160.

KNOWN/RECORDED CULTURAL RESOURCES WITHIN THE PROJECT AREA AND THE ONE-HALF MILE RADIUS

There are no recorded cultural resources within the project area, and it is not known if any exist there. There are eight recorded resources within the one-half mile radius, P-15-002050, 008025, 008030, 008079, 008080, 008136, 012430, and 012431. These resources consist of an historic era railroad and historic era single-family residences.

There are no recorded cultural resources within the project area that are listed in the National Register of Historic Places, the California Register of Historical Resources, the California Points of Historical Interest, California Inventory of Historic Resources, or the California State Historic Landmarks.

COMMENTS AND RECOMMENDATIONS

We understand this project consists of design and construction of park related improvements and upgrades at an existing park. Further, we understand the park has been in use since at least 1967. According to our records, the park has never been recorded or evaluated for historical significance. Because this park is more than 50 years old, prior to project activities, we recommend if first be recorded and evaluated for historical significance by a qualified, professional consultant. If any cultural resources are unearthed during ground disturbance activities, all work must halt in the area of the find and a qualified, professional consultant should be called out to assess the findings and make the appropriate mitigation recommendations. A list of qualified consultants can be found at www.chrisinfo.org.

We also recommend that you contact the Native American Heritage Commission in Sacramento. They will provide you with a current list of Native American individuals/organizations that can assist you with information regarding cultural resources that may not be included in the CHRIS Inventory and that may be of concern to the Native groups in the area. The Commission can consult their "Sacred Lands Inventory" file in order to determine what sacred resources, if any, exist within this project area and the way in which these resources might be managed. Finally, please consult with the lead agency on this project to determine if any other cultural resource investigation is required. If you need any additional information or have any questions or concerns, please contact our office at (661) 654-2289.

By:



Celeste M. Thomson, Coordinator

Date: August 29, 2019

Please note that invoices for Information Center services will be sent under separate cover from the California State University, Bakersfield Accounting Office.

Maps

Project 3.19.4 - Belle Terrace Site Map

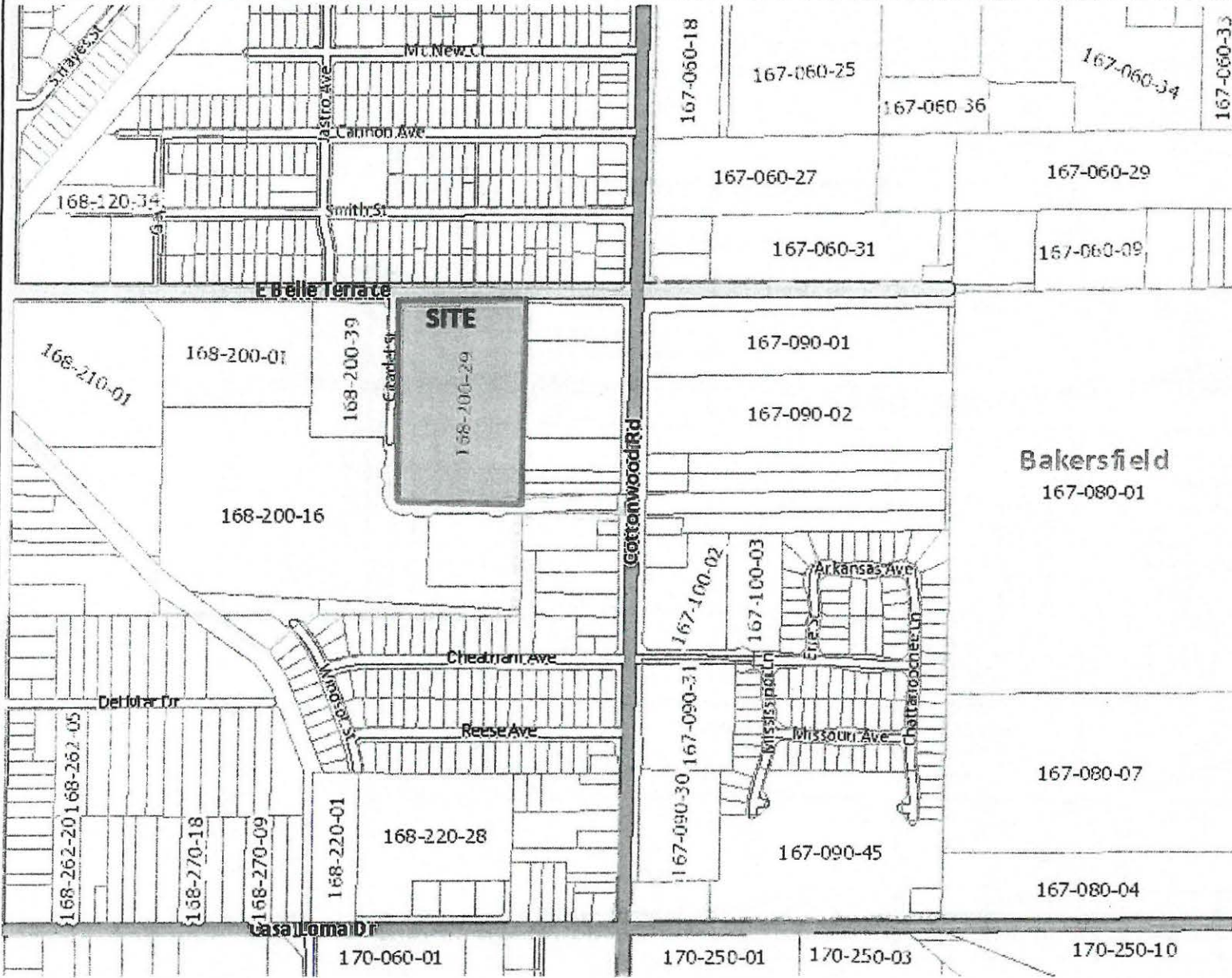

Legend

- Parcels Land
- Roads 5k-10k
 - Freeway
 - Highway
 - Major
 - Minor
 - Local
 - Ramp
 - Unpaved
- City Incorporated
- Townsites Unincorporated Area

1:9,028

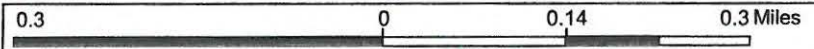

This map is a user generated static output from an Internet mapping site and is for general reference only. The County of Kern assumes no liability for damages, incurred by the user of this information, which occur directly or indirectly as a result of errors, omissions or discrepancies in the information.

Notes

U.S. DEPARTMENT OF THE INTERIOR
U. S. GEOLOGICAL SURVEY

LAMONT QUADRANGLE
CALIFORNIA-KERN CO.
7.5-MINUTE SERIES

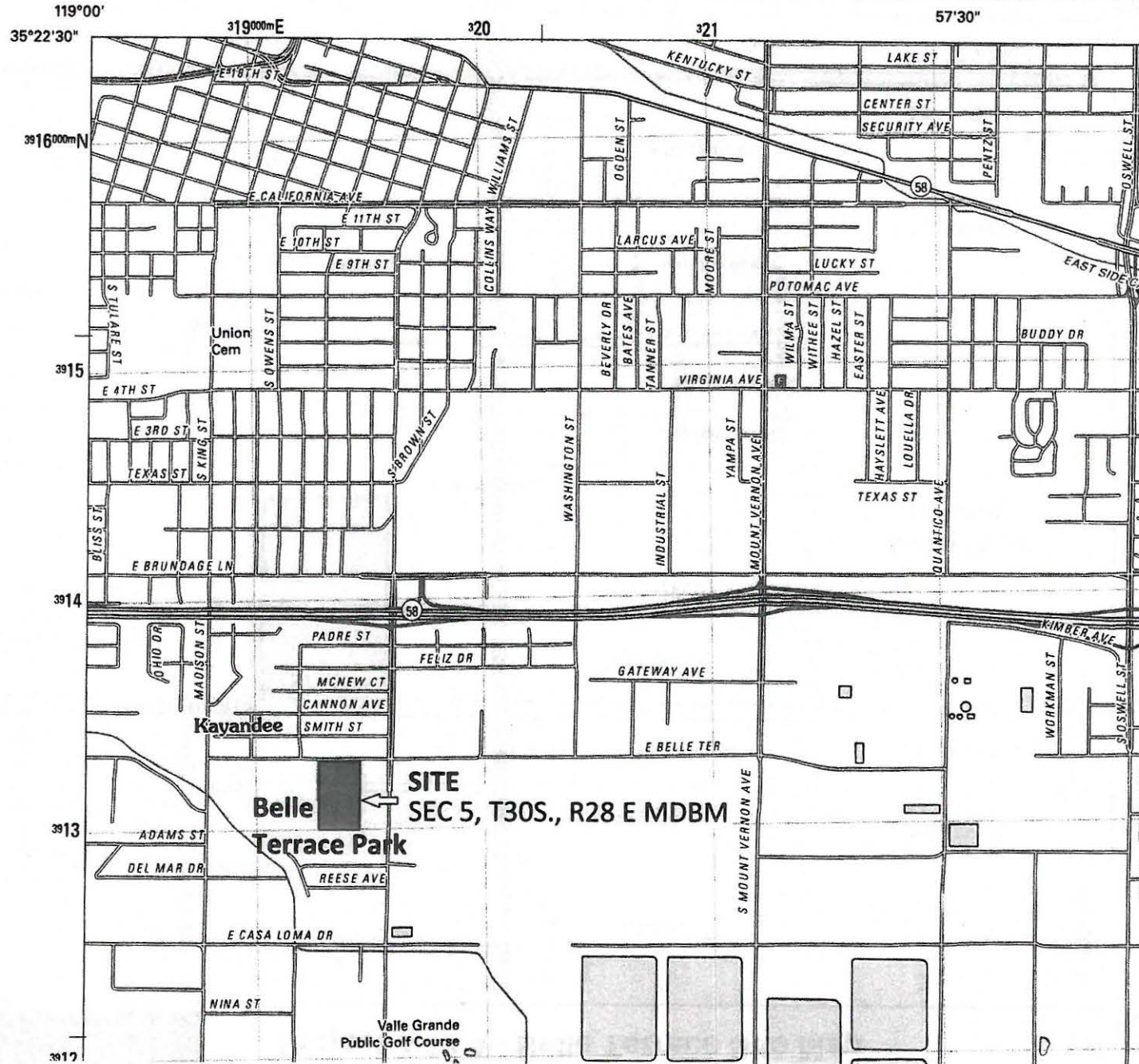

Project Area Map

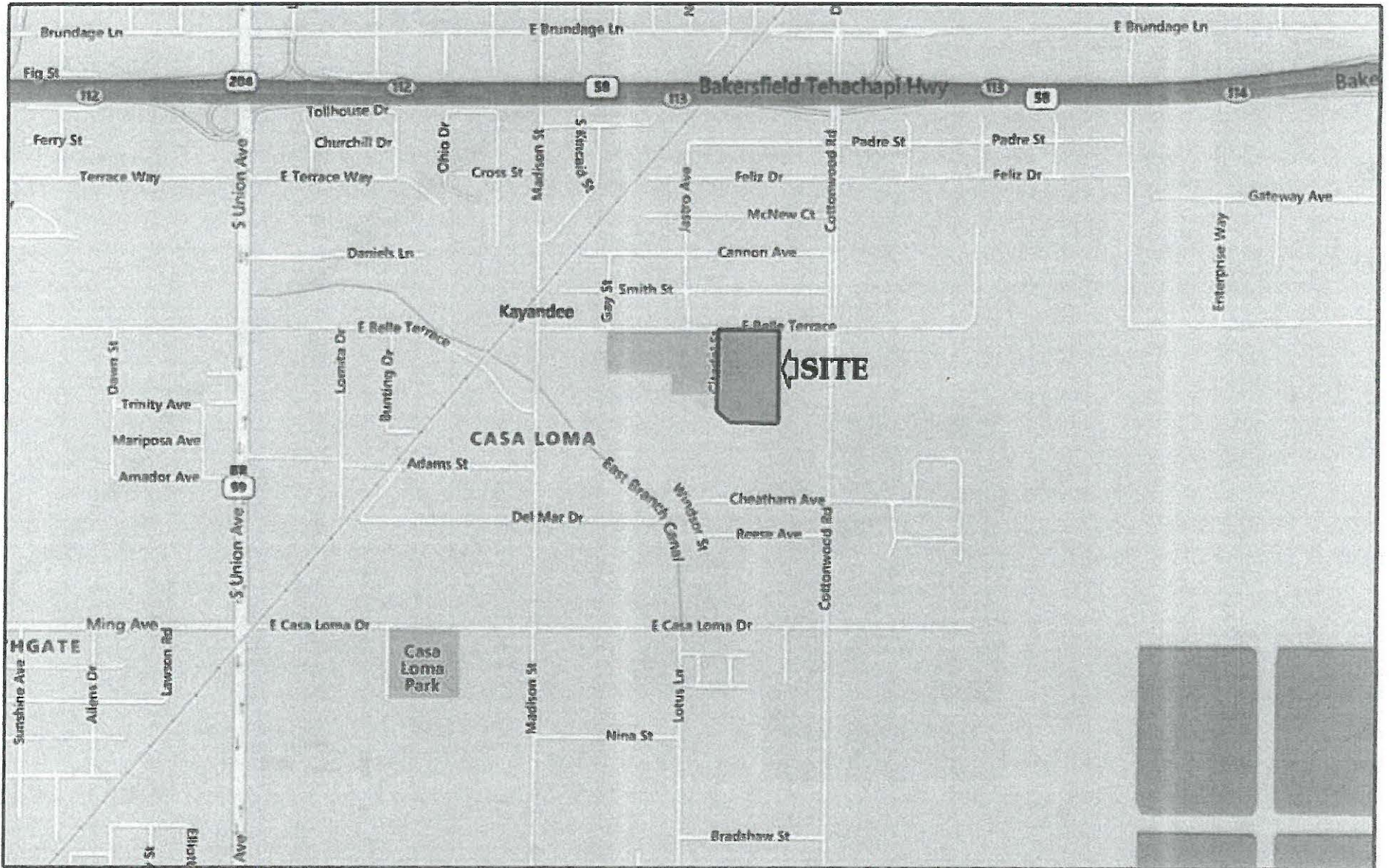

January 14, 2020



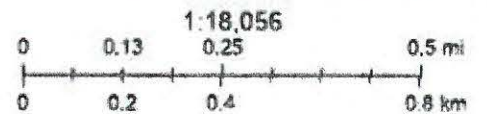



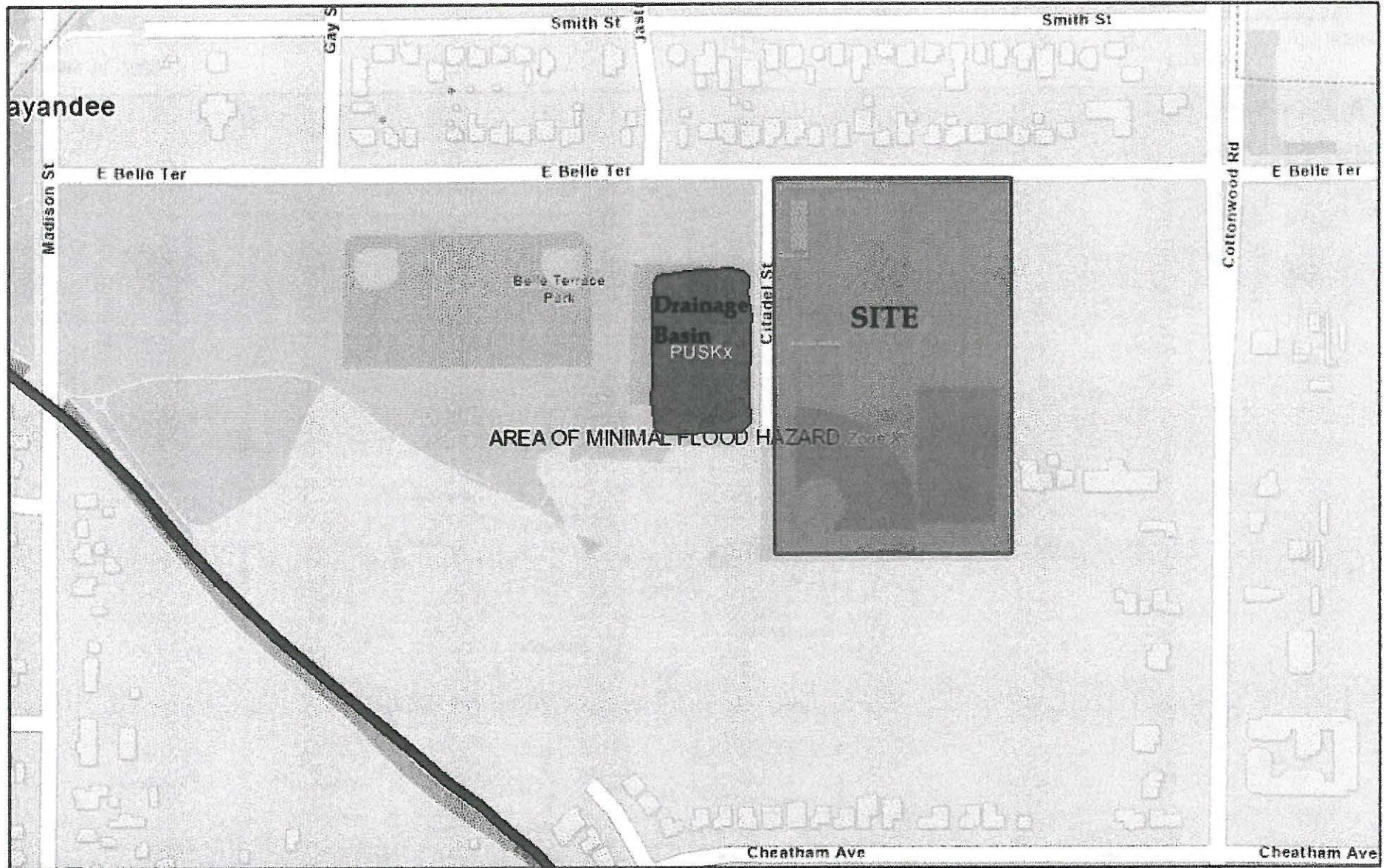

 Project 1



NWI Wetlands Map



January 21, 2020

- | | | | |
|---|---|---|--|
|  Project 1 |  Estuarine and Marine Wetland |  Freshwater Pond |  Riverine |
| Wetlands |  Freshwater Emergent Wetland |  Lake | |
|  Estuarine and Marine Deepwater |  Freshwater Forested/Shrub Wetland |  Other | |

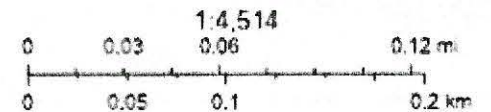

U.S. Fish and Wildlife Service, National Standards and Support Team, wetlands_team@fws.gov. Sources: Esri, HERE, Garmin, FAO, NOAA.

National Flood Hazard Layer FIRMette



35°21'1.56"N



Legend

SEE FIS REPORT FOR DETAILED LEGEND AND INDEX MAP FOR FIRM PANEL LAYOUT

SPECIAL FLOOD HAZARD AREAS		Without Base Flood Elevation (BFE) Zone A, V, A99
		With BFE or Depth Zone AE, AO, AH, VE, AR
		Regulatory Floodway

OTHER AREAS OF FLOOD HAZARD		0.2% Annual Chance Flood Hazard, Area of 1% annual chance flood with average depth less than one foot or with drainage areas of less than one square mile (Zone J)
		Future Conditions 1% Annual Chance Flood Hazard (Zone X)
		Area with Reduced Flood Risk due to Levee. See Notes, (Zone X)
		Area with Flood Risk due to Levee (Zone D)

OTHER AREAS		NO SCREEN Area of Minimal Flood Hazard
		Effective LOMRs
		Area of Undetermined Flood Hazard (Zone)

GENERAL STRUCTURES		Channel, Culvert, or Storm Sewer
		Levee, Dike, or Floodwall

OTHER FEATURES		20.2 Cross Sections with 1% Annual Chance Water Surface Elevation
		17.5 Coastal Transect
		Base Flood Elevation Line (BFE)
		Limit of Study
		Jurisdiction Boundary

OTHER FEATURES		Coastal Transect Baseline
		Profile Baseline
		Hydrographic Feature

MAP PANELS		Digital Data Available
		No Digital Data Available
		Unmapped

The pin displayed on the map is an approximate point selected by the user and does not represent an authoritative property location.

This map complies with FEMA's standards for the use of digital flood maps if it is not void as described below. The basemap shown complies with FEMA's basemap accuracy standards

The flood hazard information is derived directly from the authoritative NFHL web services provided by FEMA. This map was exported on 1/16/2020 at 12:02:43 PM and does not reflect changes or amendments subsequent to this date and time. The NFHL and effective information may change or become superseded by new data over time.

This map image is void if the one or more of the following map elements do not appear: basemap imagery, flood zone labels, legend, scale bar, map creation date, community identifiers, FIRM panel number, and FIRM effective date. Map images for unmapped and unmodernized areas cannot be used for regulatory purposes.

USGS The National Map: Orthoimagery, Data refreshed April, 2019

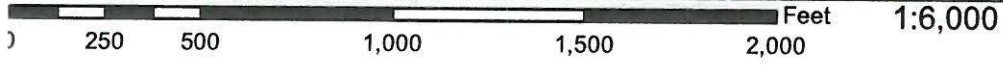

35°20'32.21"N

118-590-02-N

Hazardous Materials Map

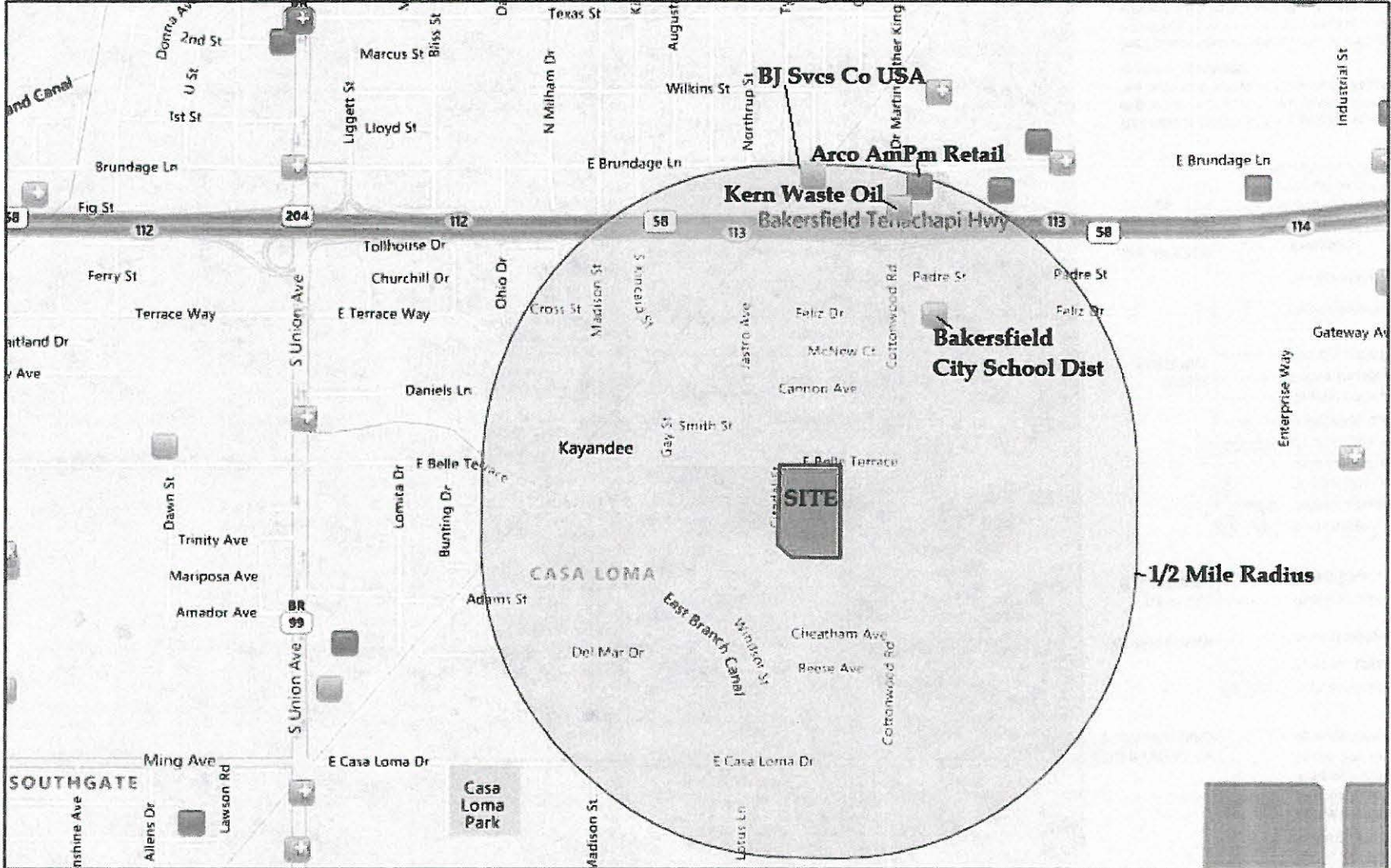

January 15, 2020

-
- Hazardous Waste (RCRAInfo)
 Toxic Releases (TRI)
 Project 1
- Hazardous Waste (RCRAInfo)
 Water Dischargers (NPDES)
 Airport Polygons
- Toxic Releases (TRI)
 Water Dischargers (NPDES)

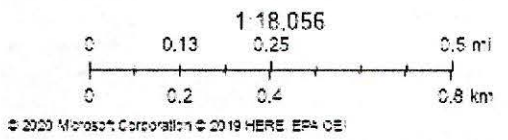

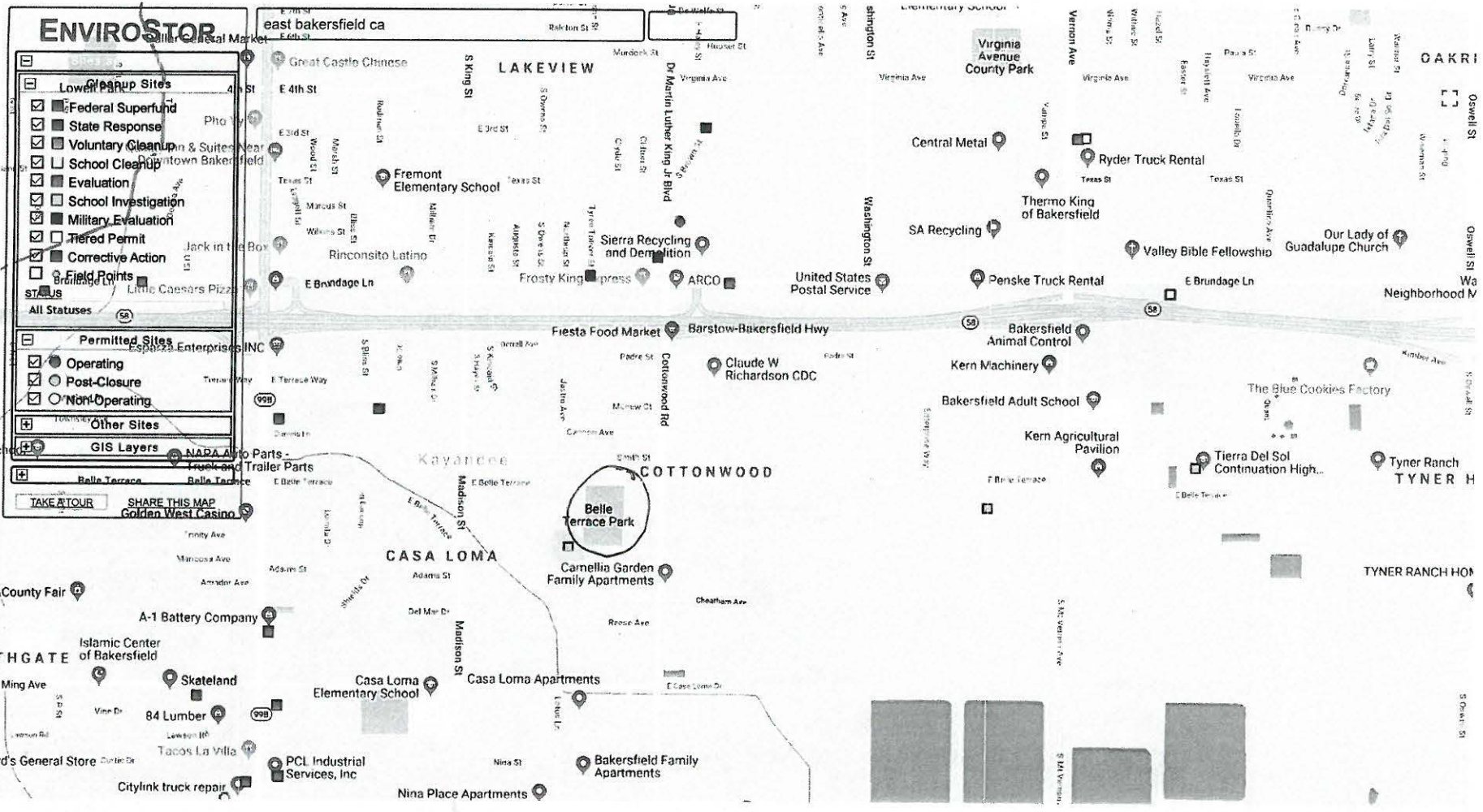

Google

PROJECT NAME	STATUS	PROJECT TYPE	ADDRESS	CITY
[CITADEL ROAD] NEW ELEMENTARY SCHOOL NO. 2	NO FURTHER ACTION	SCHOOL INVESTIGATION	CITADEL ROAD, SOUTH OF E. BELLE TERRACE PARK	BAKERSFIELD
A-C PLATING	INACTIVE - NEEDS EVALUATION	EVALUATION	317 MOUNT VERNON AVENUE	BAKERSFIELD
A-1 BATTERY	INACTIVE - NEEDS EVALUATION	EVALUATION	1230 S. UNION AVENUE	BAKERSFIELD
AC PLATING/SUM INC.	INACTIVE - NEEDS EVALUATION	TIERED PERMIT	317 MT. VERNON	BAKERSFIELD
BAKERSFIELD GAUZYULE PROCESSING MILL	INACTIVE - NEEDS EVALUATION	MILITARY EVALUATION		BAKERSFIELD
BAKERSFIELD TRANSFER INC	OPERATING PERMIT	OPERATING	1620 E BRUNDAGE LN	BAKERSFIELD
BAKERSFIELD VEGETABLE DEHYDRATION	NO FURTHER ACTION	MILITARY EVALUATION		BAKERSFIELD
BC CHEMICALS	REFER: RWQCB	EVALUATION	1511 SOUTH UNION AVENUE	BAKERSFIELD
BENHAM AND JOHNSON	ACTIVE	STATE RESPONSE	340 DANIELS LN	BAKERSFIELD
CUSTOM CLEANERS	REFER: EPA	EVALUATION	300 NORTH H STREET	BAKERSFIELD
DARRELL'S AUTOMOTIVE	INACTIVE - NEEDS EVALUATION	EVALUATION	927 BRUNDAGE AVENUE	BAKERSFIELD
DICKS MUFFLER AND AUTOMOTIVE	INACTIVE - NEEDS EVALUATION	EVALUATION	1231 BRUNDAGE AVENUE	BAKERSFIELD
FREEMAN'S CLEANERS (VOGUE CLEANERS)	REFER: EPA	EVALUATION	555 BRUNDAGE LANE	OLD DALE
IIIAREZ BROTHERS TRUCKING	REFER: EPA	EVALUATION	1400 S. UNION AVENUE	BAKERSFIELD

GEOTRACKER

Legend

Cleanup Sites - INFO

- LUST Cleanup Sites
- Cleanup Program Sites
- Military Cleanup Sites
- DTSC Cleanup Sites

Permitted Facilities

- Waste Discharge Requirements (WDR) Sites
- Permitted USTs - INFO
- DTSC Hazardous Waste Sites
- Bridge Ln Land Disposal Sites
- Irrigated Lands Regulatory Program Sites
- Oil / Gas Sites
- Confined Animal Sites

Other Sites

- Project Sites
- Non-Case Information Sites
- Sampling Points - Public
- Field Points
- ASLand Domestic Wells

SIGNIFIES A CLOSED SITE

Tools

Map Coverages

[TAKE A TOUR](#) [VIEW ON GAMA](#)



Airport Land Use Compatibility Plan (ALUCP)

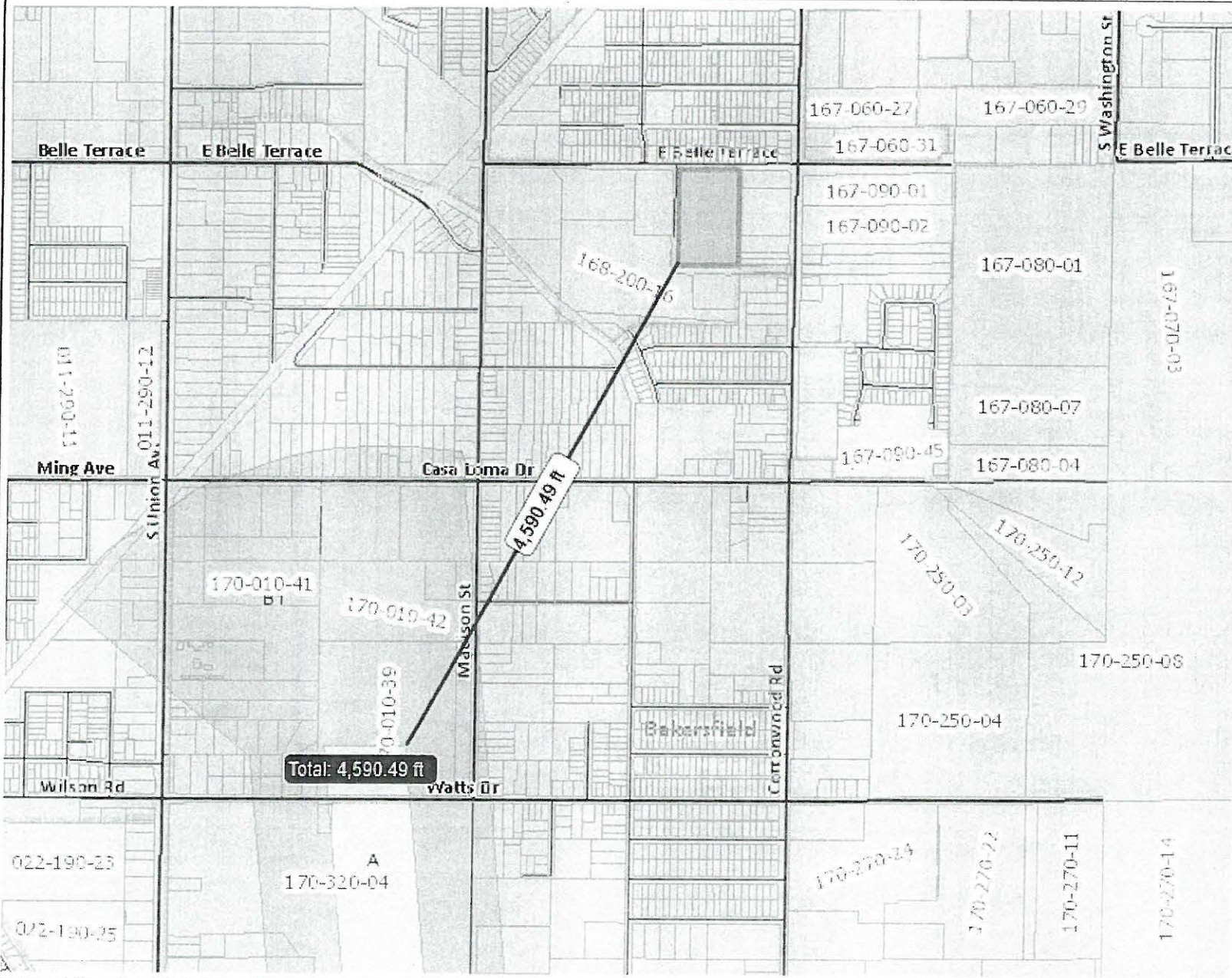
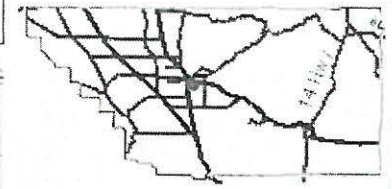

Legend

- Parcels Land
- Roads 10k-24k**
 - Freeway
 - Highway
 - Major
 - Minor
 - Local
 - Ramp
 - Unpaved
- City Incorporated 100k**
 - CITIES
 - CITY OF BAKERSFIELD
- Townsites Unincorporated Area
- Airport Land Use Plan**
 - A
 - B1
 - B2
 - C
 - D
 - D+
 - E1
 - E2

1: 18,056

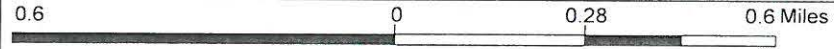

This map is a user generated static output from an Internet mapping site and is for general reference only. The County of Kern assumes no liability for damages, incurred by the user of this information, which occur directly or indirectly as a result of errors, omissions or discrepancies in the information.

Notes

Site here

Background Data /

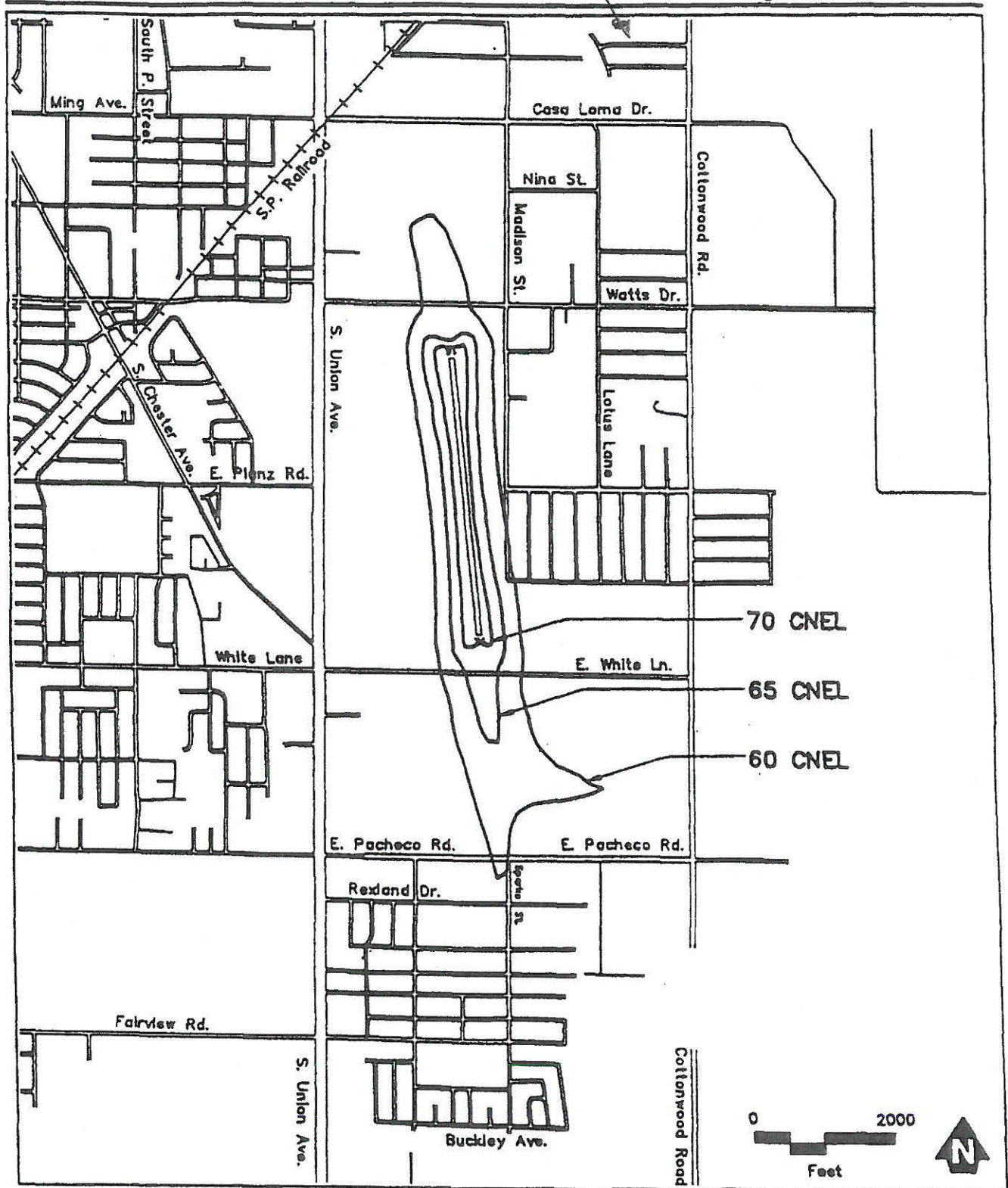

Figure 4 - 4

Noise Contours
Bakersfield Municipal Airport

Noise Analysis and Noise Maps

Home (/) > Programs (/programs/) > Environmental Review (/programs/environmental-review/) > DNL Calculator

DNL Calculator

WARNING: HUD recommends the use of Microsoft Internet Explorer for performing noise calculations. The HUD Noise Calculator has an error when using Google Chrome unless the cache is cleared before each use of the calculator. HUD is aware of the problem and working to fix it in the programming of the calculator.

The Day/Night Noise Level Calculator is an electronic assessment tool that calculates the Day/Night Noise Level (DNL) from roadway and railway traffic. For more information on using the DNL calculator, view the [Day/Night Noise Level Calculator Electronic Assessment Tool Overview \(/programs/environmental-review/daynight-noise-level-electronic-assessment-tool/\)](/programs/environmental-review/daynight-noise-level-electronic-assessment-tool/).

Guidelines

- To display the Road and/or Rail DNL calculator(s), click on the "Add Road Source" and/or "Add Rail Source" button(s) below.
- All Road and Rail input values must be positive non-decimal numbers.
- All Road and/or Rail DNL value(s) must be calculated separately before calculating the Site DNL.
- All checkboxes that apply must be checked for vehicles and trains in the tables' headers.
- **Note #1:** Tooltips, containing field specific information, have been added in this tool and may be accessed by hovering over all the respective data fields (site identification, roadway and railway assessment, DNL calculation results, roadway and railway input variables) with the mouse.
- **Note #2:** DNL Calculator assumes roadway data is always entered.

DNL Calculator

Site ID Belle Terrace Park

Record Date 1/16/2020

User's Name James Golden

Road # 1 Name: Cottonwood Road

Road #1

Vehicle Type	Cars <input checked="" type="checkbox"/>	Medium Trucks <input checked="" type="checkbox"/>	Heavy Trucks <input checked="" type="checkbox"/>
Effective Distance	460	460	460
Distance to Stop Sign			
Average Speed	40	40	40
Average Daily Trips (ADT)	12032	2000	1200
Night Fraction of ADT	15	15	15
Road Gradient (%)			0
Vehicle DNL	51.8139	54.0208	59.6611
Calculate Road #1 DNL	61.2804	Reset	

Railroad #1 Track Identifier:

Rail # 1

Train Type Electric Diesel

Effective Distance

1042

Average Train Speed

25

Engines per Train

2

Railway cars per Train

50

Average Train Operations (ATO)

4

Night Fraction of ATO

50

Railway whistles or horns?

Yes: No:

Yes: No:

Bolted Tracks?

Yes: No:

Yes: No:

Train DNL

47.4977

Calculate Rail #1 DNL

47.4977

Reset

Add Road Source

Add Rail Source

Airport Noise Level

40

Loud Impulse Sounds?

Yes No

Combined DNL for all
Road and Rail sources

61.4913

Combined DNL including Airport

61.4913

Site DNL with Loud Impulse Sound

Calculate

Mitigation Options

If your site DNL is in Excess of 65 decibels, your options are:

- **No Action Alternative:** Cancel the project at this location
- **Other Reasonable Alternatives:** Choose an alternate site
- **Mitigation**
 - **Contact your Field or Regional Environmental Officer** (</programs/environmental-review/hud-environmental-staff-contacts/>)
 - Increase mitigation in the building walls (only effective if no outdoor, noise sensitive areas)
 - Reconfigure the site plan to increase the distance between the noise source and noise-sensitive uses
 - Incorporate natural or man-made barriers. See *The Noise Guidebook* (</resource/313/hud-noise-guidebook/>)
 - Construct noise barrier. See the **Barrier Performance Module** (</programs/environmental-review/bpm-calculator/>)

Tools and Guidance

Day/Night Noise Level Assessment Tool User Guide (</resource/3822/day-night-noise-level-assessment-tool-user-guide/>)

Day/Night Noise Level Assessment Tool Flowcharts (</resource/3823/day-night-noise-level-assessment-tool-flowcharts/>)

DOT CROSSING INVENTORY FORM 1

DEPARTMENT OF TRANSPORTATION
FEDERAL RAILROAD ADMINISTRATION

OMB No. 2130-0017

Instructions for the initial reporting of the following types of new or previously unreported crossings: For public highway-rail grade crossings, complete the entire inventory Form. For private highway-rail grade crossings, complete the Header, Parts I and II, and the Submission Information section. For public pathway grade crossings (including pedestrian station grade crossings), complete the Header, Parts I and II, and the Submission Information section. For private pathway grade crossings, complete the Header, Parts I and II, and the Submission Information section. For grade-separated highway-rail or pathway crossings (including pedestrian station crossings), complete the Header, Part I, and the Submission Information section. For changes to existing data, complete the Header, Part I Items 1-3, and the Submission Information section, in addition to the updated data fields. Note: For private crossings only, Part I Item 20 and Part III Item 2.K. are required unless otherwise noted. An asterisk * denotes an optional field.

A. Revision Date (MM/DD/YYYY) 05 / 10 / 2018	B. Reporting Agency <input checked="" type="checkbox"/> Railroad <input type="checkbox"/> Transit <input type="checkbox"/> State <input type="checkbox"/> Other	C. Reason for Update (Select only one) <input checked="" type="checkbox"/> Change in Data <input type="checkbox"/> New Crossing <input type="checkbox"/> Closed <input type="checkbox"/> Re-Open <input type="checkbox"/> Date Change Only <input type="checkbox"/> Change in Primary Operating RR	D. DOT Crossing Inventory Number 750960U <input type="checkbox"/> No Train Traffic <input type="checkbox"/> Quiet Zone Update <input type="checkbox"/> Admin. Correction
---	--	---	--

Part I: Location and Classification Information

1. Primary Operating Railroad San Joaquin Valley Railroad Company [SJVR]		2. State CALIFORNIA		3. County KERN	
4. City / Municipality <input type="checkbox"/> In <input checked="" type="checkbox"/> Near BAKERSFIELD		5. Street/Road Name & Block Number BELLE TERRACE <small>(Street/Road Name) *(Block Number)</small>		6. Highway Type & No. NA	
7. Do Other Railroads Operate a Separate Track at Crossing? <input type="checkbox"/> Yes <input checked="" type="checkbox"/> No If Yes, Specify RR			8. Do Other Railroads Operate Over Your Track at Crossing? <input type="checkbox"/> Yes <input checked="" type="checkbox"/> No If Yes, Specify RR		
9. Railroad Division or Region <input type="checkbox"/> None PACIFIC		10. Railroad Subdivision or District <input type="checkbox"/> None BUTTONWILLOW		11. Branch or Line Name <input checked="" type="checkbox"/> None	
12. RR Milepost 0316.02 <small>(prefix) (nnnn.nnn) (suffix)</small>		13. Line Segment * BT 316.0			
14. Nearest RR Timetable Station * KAYANDEE		15. Parent RR (if applicable) <input checked="" type="checkbox"/> N/A		16. Crossing Owner (if applicable) <input checked="" type="checkbox"/> N/A	
17. Crossing Type <input checked="" type="checkbox"/> Public <input type="checkbox"/> Private	18. Crossing Purpose <input checked="" type="checkbox"/> Highway <input type="checkbox"/> Pathway, Ped. <input type="checkbox"/> Station, Ped.	19. Crossing Position <input checked="" type="checkbox"/> At Grade <input type="checkbox"/> RR Under <input type="checkbox"/> RR Over	20. Public Access (if Private Crossing) <input type="checkbox"/> Yes <input type="checkbox"/> No	21. Type of Train <input checked="" type="checkbox"/> Freight <input type="checkbox"/> Intercity Passenger <input type="checkbox"/> Commuter	<input type="checkbox"/> Transit <input type="checkbox"/> Shared Use Transit <input type="checkbox"/> Tourist/Other
22. Average Passenger Train Count Per Day <input type="checkbox"/> Less Than One Per Day <input type="checkbox"/> Number Per Day 0					
23. Type of Land Use <input type="checkbox"/> Open Space <input type="checkbox"/> Farm <input checked="" type="checkbox"/> Residential <input type="checkbox"/> Commercial <input type="checkbox"/> Industrial <input type="checkbox"/> Institutional <input type="checkbox"/> Recreational <input type="checkbox"/> RR Yard					
24. Is there an Adjacent Crossing with a Separate Number? <input type="checkbox"/> Yes <input checked="" type="checkbox"/> No If Yes, Provide Crossing Number			25. Quiet Zone (FRA provided) <input checked="" type="checkbox"/> No <input type="checkbox"/> 24 Hr <input type="checkbox"/> Partial <input type="checkbox"/> Chicago Excused Date Established		
26. HSR Corridor ID <input checked="" type="checkbox"/> N/A		27. Latitude in decimal degrees (WGS84 std: nn.nnnnnnn) 35.3458171		28. Longitude in decimal degrees (WGS84 std: -nnn.nnnnnnn) -118.9959691	
29. Lat/Long Source <input checked="" type="checkbox"/> Actual <input type="checkbox"/> Estimated					
30.A. Railroad Use *			31.A. State Use *		
30.B. Railroad Use *			31.B. State Use *		
30.C. Railroad Use *			31.C. State Use *		
30.D. Railroad Use *			31.D. State Use *		
32.A. Narrative (Railroad Use) *			32.B. Narrative (State Use) *		
33. Emergency Notification Telephone No. (posted) 800-800-2203		34. Railroad Contact (Telephone No.) 800-800-2203		35. State Contact (Telephone No.) 415-703-3722	

Part II: Railroad Information

1. Estimated Number of Daily Train Movements				
1.A. Total Day Thru Trains (6 AM to 6 PM) 2	1.B. Total Night Thru Trains (6 PM to 6 AM) 2	1.C. Total Switching Trains 0	1.D. Total Transit Trains 0	1.E. Check if Less Than One Movement Per Day <input type="checkbox"/> How many trains per week? 18
2. Year of Train Count Data (YYYY) 2016		3. Speed of Train at Crossing 3.A. Maximum Timetable Speed (mph) 25 3.B. Typical Speed Range Over Crossing (mph) From 0 to 25		
4. Type and Count of Tracks Main 1 Siding 0 Yard 0 Transit 0 Industry 0				
5. Train Detection (Main Track only) <input type="checkbox"/> Constant Warning Time <input type="checkbox"/> Motion Detection <input type="checkbox"/> AFO <input type="checkbox"/> PTC <input type="checkbox"/> DC <input type="checkbox"/> Other <input checked="" type="checkbox"/> None				
6. Is Track Signaled? <input type="checkbox"/> Yes <input checked="" type="checkbox"/> No		7.A. Event Recorder <input type="checkbox"/> Yes <input type="checkbox"/> No		7.B. Remote Health Mon <input type="checkbox"/> Yes <input type="checkbox"/> No

U. S. DOT CROSSING INVENTORY FORM

A. Revision Date (MM/DD/YYYY) 05/10/2018 PAGE 2 D. Crossing Inventory Number (7 char.)
750960U

Part III: Highway or Pathway Traffic Control Device Information

1. Are there Signs or Signals? <input checked="" type="checkbox"/> Yes <input type="checkbox"/> No		2. Types of Passive Traffic Control Devices associated with the Crossing				
2.A. Crossbuck Assemblies (count) <u>2</u>		2.B. STOP Signs (R1-1) (count) <u>0</u>	2.C. YIELD Signs (R1-2) (count)	2.D. Advance Warning Signs (Check all that apply; include count) <input checked="" type="checkbox"/> None		
				<input type="checkbox"/> W10-1 <input type="checkbox"/> W10-2	<input type="checkbox"/> W10-3 <input type="checkbox"/> W10-4	
				<input type="checkbox"/> W10-11	<input type="checkbox"/> W10-12	
2.E. Low Ground Clearance Sign (W10-5) <input checked="" type="checkbox"/> Yes (count <u> </u>) <input type="checkbox"/> No		2.F. Pavement Markings <input checked="" type="checkbox"/> Stop Lines <input type="checkbox"/> Dynamic Envelope <input checked="" type="checkbox"/> RR Xing Symbols <input type="checkbox"/> None		2.G. Channelization Devices/Medians <input type="checkbox"/> All Approaches <input type="checkbox"/> Median <input type="checkbox"/> One Approach <input type="checkbox"/> None	2.H. EXEMPT Sign (R15-3) <input type="checkbox"/> Yes <input type="checkbox"/> No	
					2.I. ENS Sign (I-13) Displayed <input checked="" type="checkbox"/> Yes <input type="checkbox"/> No	
2.J. Other MUTCD Signs <input type="checkbox"/> Yes <input checked="" type="checkbox"/> No			2.K. Private Crossing Signs (if private) <input type="checkbox"/> Yes <input type="checkbox"/> No	2.L. LED Enhanced Signs (List types)		
Specify Type _____ Count _____ Specify Type _____ Count _____ Specify Type _____ Count _____						
3. Types of Train Activated Warning Devices at the Grade Crossing (specify count of each device for all that apply)						
3.A. Gate Arms (count) Roadway <u>0</u> Pedestrian _____	3.B. Gate Configuration <input type="checkbox"/> 2 Quad <input type="checkbox"/> Full (Barrier) <input type="checkbox"/> 3 Quad Resistance <input type="checkbox"/> 4 Quad <input type="checkbox"/> Median Gates	3.C. Cantilevered (or Bridged) Flashing Light Structures (count) Over Traffic Lane <u>0</u> <input type="checkbox"/> Incandescent Not Over Traffic Lane <u>0</u> <input type="checkbox"/> LED		3.D. Mast Mounted Flashing Lights (count of masts) <u>0</u> <input type="checkbox"/> Incandescent <input type="checkbox"/> LED <input type="checkbox"/> Back Lights Included <input type="checkbox"/> Side Lights Included	3.E. Total Count of Flashing Light Pairs <u>0</u>	
3.F. Installation Date of Current Active Warning Devices: (MM/YYYY) ____/____/____ <input checked="" type="checkbox"/> Not Required		3.G. Wayside Horn <input type="checkbox"/> Yes Installed on (MM/YYYY) ____/____/____ <input type="checkbox"/> No		3.H. Highway Traffic Signals Controlling Crossing <input type="checkbox"/> Yes <input checked="" type="checkbox"/> No	3.I. Bells (count) <u>0</u>	
3.J. Non-Train Active Warning <input type="checkbox"/> Flagging/Flagman <input type="checkbox"/> Manually Operated Signals <input type="checkbox"/> Watchman <input type="checkbox"/> Floodlighting <input type="checkbox"/> None				3.K. Other Flashing Lights or Warning Devices Count <u>0</u> Specify type _____		
4.A. Does nearby Hwy Intersection have Traffic Signals? <input type="checkbox"/> Yes <input type="checkbox"/> No	4.B. Hwy Traffic Signal Interconnection <input type="checkbox"/> Not Interconnected <input type="checkbox"/> For Traffic Signals <input type="checkbox"/> For Warning Signs	4.C. Hwy Traffic Signal Preemption <input type="checkbox"/> Simultaneous <input type="checkbox"/> Advance	5. Highway Traffic Pre-Signals <input type="checkbox"/> Yes <input type="checkbox"/> No Storage Distance * _____ Stop Line Distance * _____	6. Highway Monitoring Devices (Check all that apply) <input type="checkbox"/> Yes - Photo/Video Recording <input type="checkbox"/> Yes - Vehicle Presence Detection <input type="checkbox"/> None		

Part IV: Physical Characteristics

1. Traffic Lanes Crossing Railroad Number of Lanes <u>2</u>	<input type="checkbox"/> One-way Traffic <input type="checkbox"/> Two-way Traffic <input type="checkbox"/> Divided Traffic	2. Is Roadway/Pathway Paved? <input checked="" type="checkbox"/> Yes <input type="checkbox"/> No	3. Does Track Run Down a Street? <input type="checkbox"/> Yes <input checked="" type="checkbox"/> No	4. Is Crossing Illuminated? (Street lights within approx. 50 feet from nearest rail) <input type="checkbox"/> Yes <input type="checkbox"/> No
5. Crossing Surface (on Main Track, multiple types allowed) Installation Date * (MM/YYYY) ____/____/____ Width * _____ Length * _____				
<input type="checkbox"/> 1 Timber <input checked="" type="checkbox"/> 2 Asphalt <input type="checkbox"/> 3 Asphalt and Timber <input type="checkbox"/> 4 Concrete <input type="checkbox"/> 5 Concrete and Rubber <input type="checkbox"/> 6 Rubber <input type="checkbox"/> 7 Metal <input type="checkbox"/> 8 Unconsolidated <input type="checkbox"/> 9 Composite <input type="checkbox"/> 10 Other (specify) _____				
6. Intersecting Roadway within 500 feet? <input type="checkbox"/> Yes <input checked="" type="checkbox"/> No If Yes, Approximate Distance (feet) _____		7. Smallest Crossing Angle <input type="checkbox"/> 0° - 29° <input type="checkbox"/> 30° - 59° <input checked="" type="checkbox"/> 60° - 90°		8. Is Commercial Power Available? * <input checked="" type="checkbox"/> Yes <input type="checkbox"/> No

Part V: Public Highway Information

1. Highway System <input type="checkbox"/> (01) Interstate Highway System <input checked="" type="checkbox"/> (02) Other Nat Hwy System (NHS) <input type="checkbox"/> (03) Federal AID, Not NHS <input type="checkbox"/> (08) Non-Federal Aid	2. Functional Classification of Road at Crossing <input type="checkbox"/> (0) Rural <input checked="" type="checkbox"/> (1) Urban <input type="checkbox"/> (1) Interstate <input checked="" type="checkbox"/> (5) Major Collector <input type="checkbox"/> (2) Other Freeways and Expressways <input type="checkbox"/> (3) Other Principal Arterial <input type="checkbox"/> (6) Minor Collector <input type="checkbox"/> (4) Minor Arterial <input type="checkbox"/> (7) Local		3. Is Crossing on State Highway System? <input type="checkbox"/> Yes <input checked="" type="checkbox"/> No	4. Highway Speed Limit _____ MPH <input type="checkbox"/> Posted <input type="checkbox"/> Statutory
7. Annual Average Daily Traffic (AADT) Year <u>1989</u> AADT <u>001500</u>	8. Estimated Percent Trucks <u>05</u> %	9. Regularly Used by School Buses? <input type="checkbox"/> Yes <input checked="" type="checkbox"/> No Average Number per Day <u>0</u>		10. Emergency Services Route <input type="checkbox"/> Yes <input type="checkbox"/> No

Submission Information - This information is used for administrative purposes and is not available on the public website.

Submitted by _____ Organization _____ Phone _____ Date _____

Public reporting burden for this information collection is estimated to average 30 minutes per response, including the time for reviewing instructions, searching existing data sources, gathering and maintaining the data needed and completing and reviewing the collection of information. According to the Paperwork Reduction Act of 1995, a federal agency may not conduct or sponsor, and a person is not required to, nor shall a person be subject to a penalty for failure to comply with, a collection of information unless it displays a currently valid OMB control number. The valid OMB control number for information collection is 2130-0017. Send comments regarding this burden estimate or any other aspect of this collection, including for reducing this burden to: Information Collection Officer, Federal Railroad Administration, 1200 New Jersey Ave. SE, MS-25 Washington, DC 20590.



Distance to Major Roadway Cottonwood Road

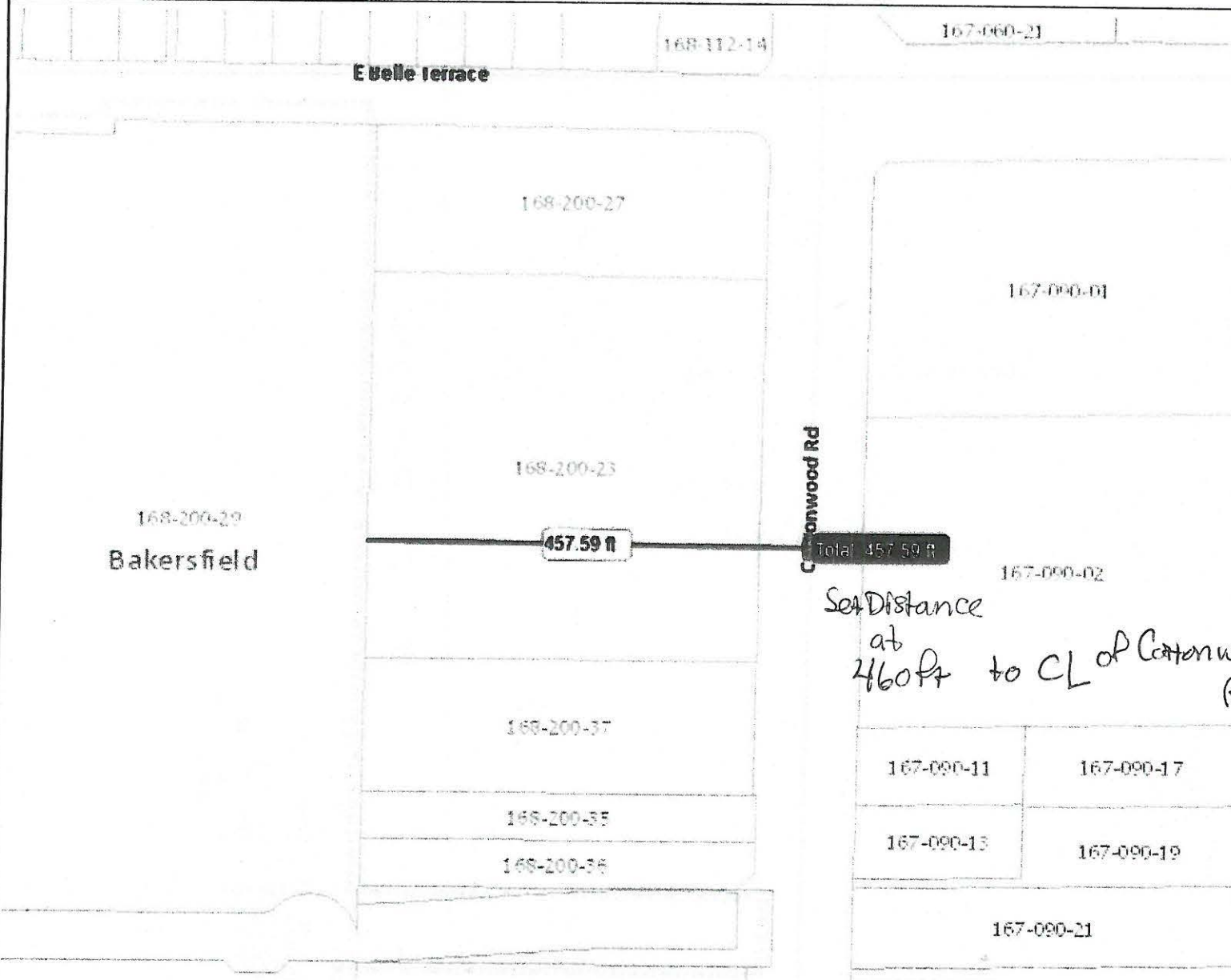
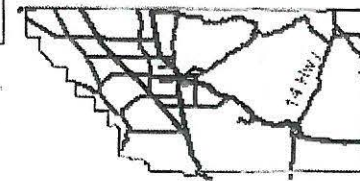

Legend

- Parcels Land
- Roads**
 - ▬ Freeway
 - ▬ Highway
 - ▬ Major
 - ▬ Minor
 - ▬ Local
 - ▬ Ramp
 - ▬ Unpaved
- + Railroad
- ⊕ City Incorporated
- Townsites Unincorporated Area

Scale: 1:2,257

North Arrow

See Distance at 460ft to CL of Cottonwood Rd

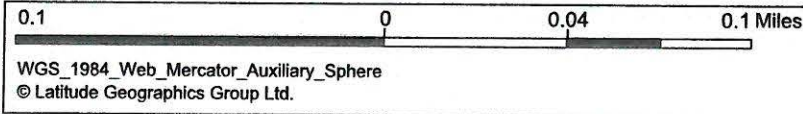

This map is a user generated static output from an Internet mapping site and is for general reference only. The County of Kern assumes no liability for damages, incurred by the user of this information, which occur directly or indirectly as a result of errors, omissions or discrepancies in the information.

Notes

All Stations

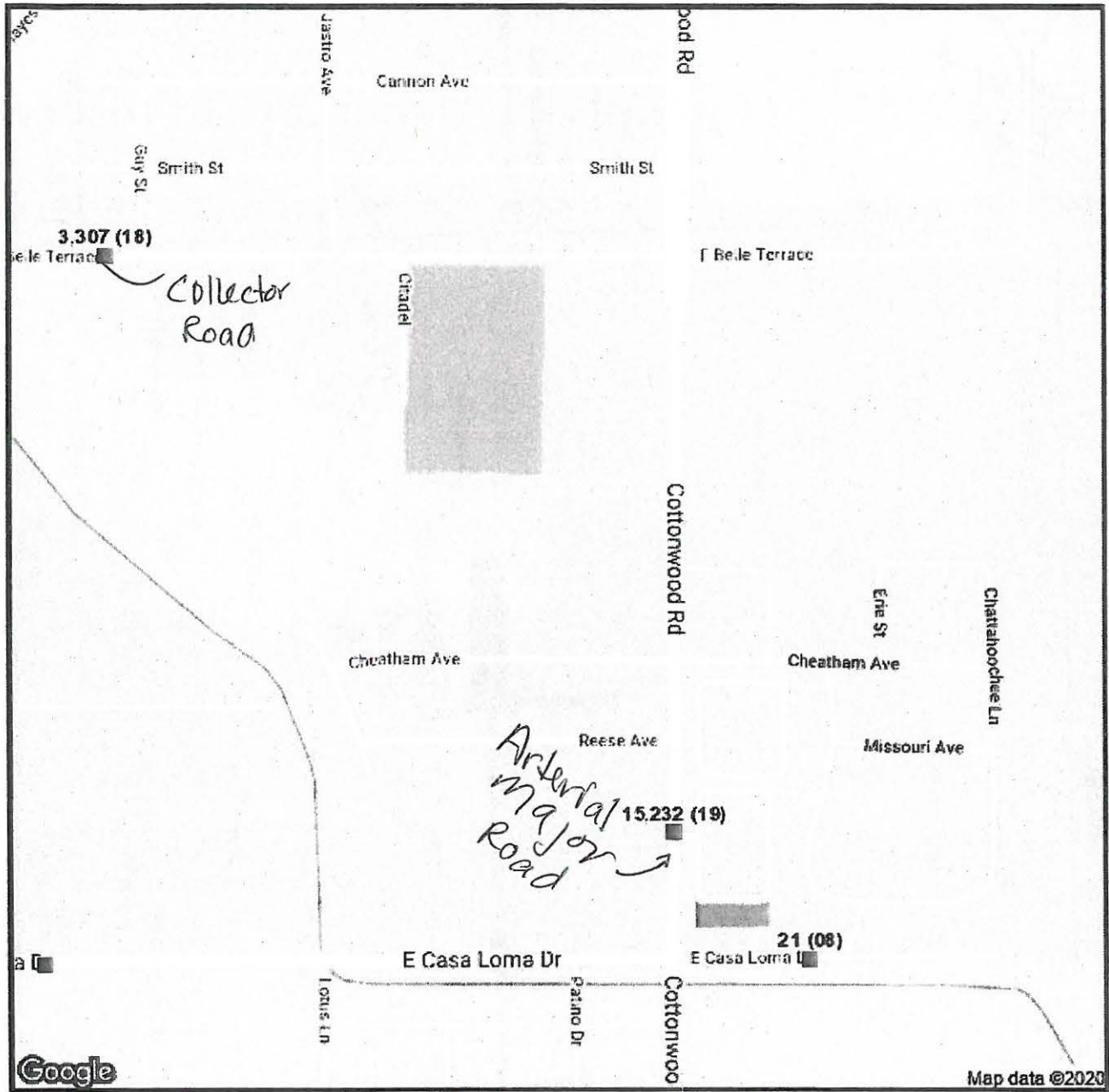

Google

Map data ©2020

0 750 1500



Feet



TCDS Locations

- Short
- Continuous
- WIM
- Located Short
- Located Continuous
- Located WIM
- Inactive Location



1/16/2020

Disclaimer: The data provided through this resource represents accurate reproductions of the records on file with Kern Council of Governments; however, Kern COG cannot guarantee the accuracy of the underlying data, nor will Kern COG assume any liability for the misuse, misinterpretation or misrepresentation of any requested data...
[more](#)

List View All DIRs

		<input type="text"/> go	
Location ID	2082	MPO ID	18
Type	SPOT	HPMS ID	
On NHS	No	On HPMS	No
LRS ID		LRS Loc Pt.	
SF Group	18	Route Type	
AF Group		Route	
GF Group		Active	Yes
Class Dist Grp		Category	Class
Seas Class Grp			
WIM Group			
QC Group	Default		
Funct'l Class	-	Milepost	
Located On	Cottonwood Road		
Loc On Alias			
NORTH OF	Casa Loma Driver		
	PR	MP	PT ▼
	0		
More Detail ▶			

Directions: 2-WAY NB SB ?

Year	AADT	DHV-30	K %	D %	PA	BC	Src
2019	15,232				14,884 (98%)	347 (2%)	
2018	12,998	1,117	9	57	12,700 (98%)	297 (2%)	
2017	12,292	979	8	56	12,085 (98%)	206 (2%)	
2016	12,396	1,070	9	57	12,106 (98%)	289 (2%)	
2015	11,596	986	9	54	11,328 (98%)	267 (2%)	

Navigation: |<<| <| >| >>| 1-5 of 12

Model Year	Model AADT	AM PHV	AM PPV	MD PHV	MD PPV	PM PHV	PM PPV	NT PHV	NT PPV
------------	------------	--------	--------	--------	--------	--------	--------	--------	--------

Date	Int	Total
Thu 9/19/2019	60	15,386
Wed 5/9/2018	60	12,985
Wed 6/21/2017	60	12,304
Wed 12/7/2016	60	12,086
Wed 6/15/2016	60	12,635

Year	Annual Growth
2019	17%
2018	6%
2017	-1%
2016	7%
2015	2%

Distance to Railroad Line

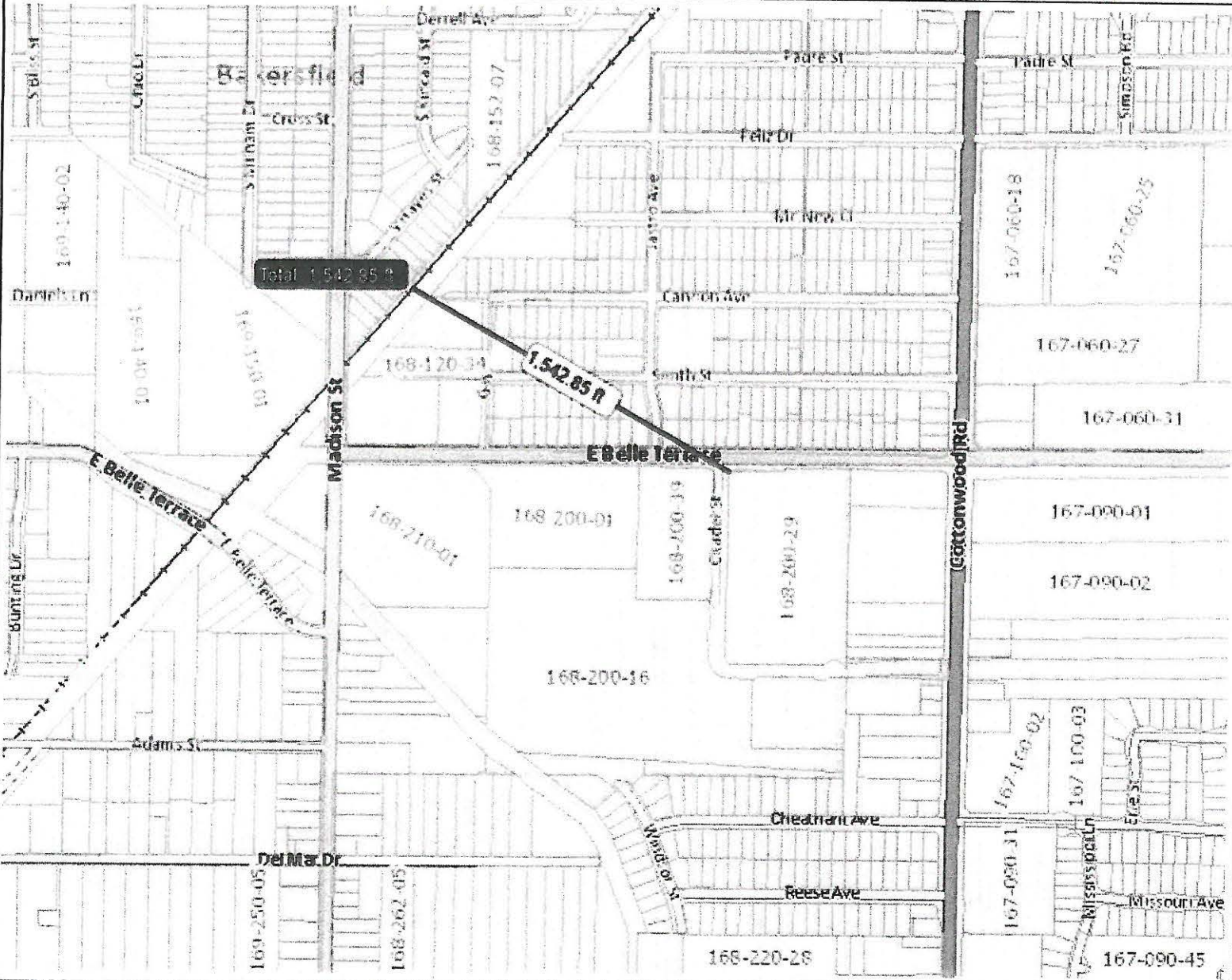
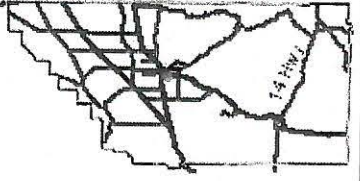

Legend

- Parcels Land
- Roads 5k-10k**
 - Freeway
 - Highway
 - Major
 - Minor
 - Local
 - Ramp
 - Unpaved
- Railroad
- City Incorporated
- Townsites Unincorporated Area

1:9,028

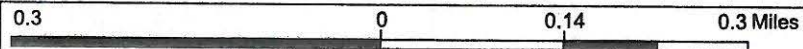

WGS_1984_Web_Mercator_Auxiliary_Sphere
© Latitude Geographics Group Ltd.

This map is a user generated static output from an Internet mapping site and is for general reference only. The County of Kern assumes no liability for damages, incurred by the user of this information, which occur directly or indirectly as a result of errors, omissions or discrepancies in the information.

Notes