

FILED
KERN COUNTY

SEP 25 2024

NOTICE OF DETERMINATION
(CALIFORNIA ENVIRONMENTAL QUALITY ACT OF 1970)

AIMEE X. ESPINOZA
AUDITOR CONTROLLER-COUNTY CLERK
BY FILED 14 DEPUTY

TO WHOM IT MAY CONCERN:

1. The Board of Supervisors of the County of Kern has approved the following described project in the County of Kern, State of California:

- a. Applicant, or sponsoring agency or department: Clean Harbors Buttonwillow, LLC;
- b. Name of Project: Clean Harbors Solid Waste Disposal Facility - (a) General Plan Amendment Case No. 7, Map 97; (b) Amendment of Zoning Map 97, Zone Change Case No. 2; (c) Modification to Conditional Use Permit No. 4, Map 97; (d) Alteration of the Boundaries of Agricultural Preserve No. 2- Exclusion, Map 97;
- c. Street Address/Cross-Street of Project: 2500 West Lokern Road, Buttonwillow, CA

Map of Project (if no street address): Attached

- d. Description of Project: The Clean Harbors Buttonwillow Facility is an existing commercial waste management facility that accepts solid, semi-solid, and liquid hazardous and non-hazardous wastes for treatment, storage, or disposal. The proposed project includes modification of existing land use authorizations to include an expanded permitted disposal area to facilitate the construction and operation of additional non-hazardous waste landfill units and construction of additional ancillary on-site buildings. Implementation of the proposed project includes the following requests: (a) Amend the Land Use, Open Space and Conservation Element of the Kern County General Plan from Map Code 8.3 (Extensive Agriculture) to Map Code 3.4 (Solid Waste Facilities) for approximately 320 acres and amend the Kern County General Plan Appendix "E" "Petroleum Waste Management" map to show the current "Clean Harbors" name and revised permitted facility boundary, with designated buffer property area (GPA No. 7, Map 97); (b) A change in Zone Classification from A (Exclusive Agriculture) to M-3 (Heavy Industrial) or a more restrictive district on 640 acres (ZCC No. 2, Map 97); (c) A modification to Conditional Use Permit No. 4, Map 97 to include: (1) an increase in the permitted facility boundary from 320 acres to 640 acres to include the expansion parcel for a soil stockpile area; (2) an increase in permitted disposal area from 160 acres to 193.3 acres for the addition of non-hazardous waste landfill units (WMU 36, 37, 38) within existing facility boundary; (3) an increase in permitted disposal capacity from 13,250,000 cubic yards to 16,674,000 for the addition of non-hazardous waste landfill units (WMUs 36, 37, 38) within existing facility boundary; (4) construction of four new hazardous waste treatment buildings (tank treatment buildings) to support modifications proposed in a Hazardous Waste Facility Permit renewal application; and (5) construction of one latex paint recycling building; and (d) An Agricultural Exclusion of 640 acres within the boundaries of Agricultural Preserve No. 2, Map 97

2. Approval – Summary of Proceedings:

Adoption date September 24, 2024, Item No. 3 2:00 p.m.

3. The Board of Supervisors of the County of Kern has determined that the project in its approved form will have a significant effect on the environment.

Notice of Environmental Approval
Posted by County Clerk on SEP 25 2024
and for 30 days thereafter, Pursuant to
Section 21152(C), Public Resources Code

25177

4. An Environmental Impact Report (EIR) and a Mitigation Monitoring and Reporting Program were prepared pursuant to California Environmental Quality Act of 1970 (CEQA) and the State CEQA Guidelines and were received and considered by this Board and certified as required by Section 15090 the State CEQA Guidelines.
5. Mitigation measures and a Mitigation Monitoring and Reporting Program were made as conditions of approval of the project. Findings were made pursuant to Section 15091 of the State CEQA Guidelines. A Statement of Overriding Considerations was adopted for the project, pursuant to Section 15093 of the State CEQA Guidelines.
6. A copy of the EIR may be examined by any interested person during regular business hours at the following location: Kern County Administrative Center, 1115 Truxtun Avenue, Fifth Floor, Bakersfield, California 93301, Telephone No. 868-3585.

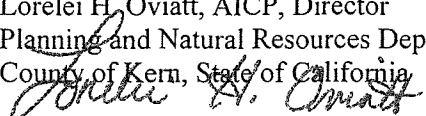
Lorelei H. Oviatt, AICP, Director
Planning and Natural Resources Department
County of Kern, State of California

Telephone No. 862-8600







By: _____

JKM:an

GPA 7, Map 97
 ZCC 2, Map 97
 Mod to CUP 4, Map 97
 Ag Preserve Exclusion 2

Vicinity Map

Clean Harbors Buttonwillow, LLC

-  Project Site
-  State Hwy
-  Arterials
-  Kern County Boundary
-  Township/Range
-  Sections
-  Water Courses

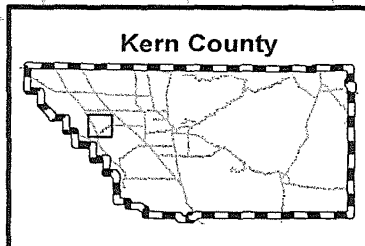
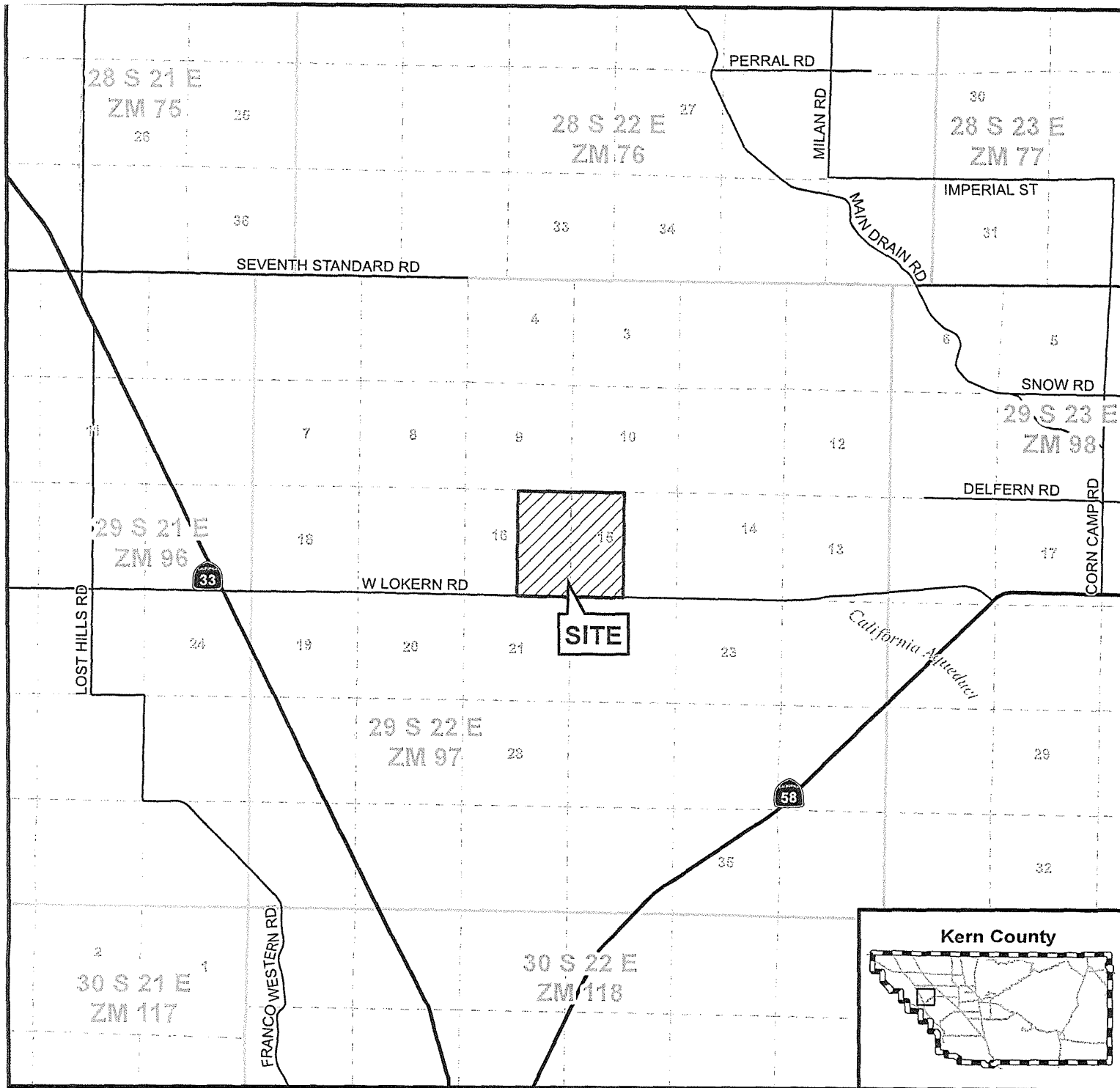

APN: 099-261-32, 099-290-17
 T29S/R22E - Sec. 15-16

Created on: 6/6/2024

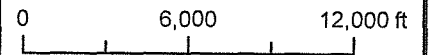

Kern County
 Planning & Natural
 Resources Department



GPA 7, Map 97
 ZCC 2, Map 97
 Mod to CUP 4, Map 97
 Ag Preserve Exclusion 2

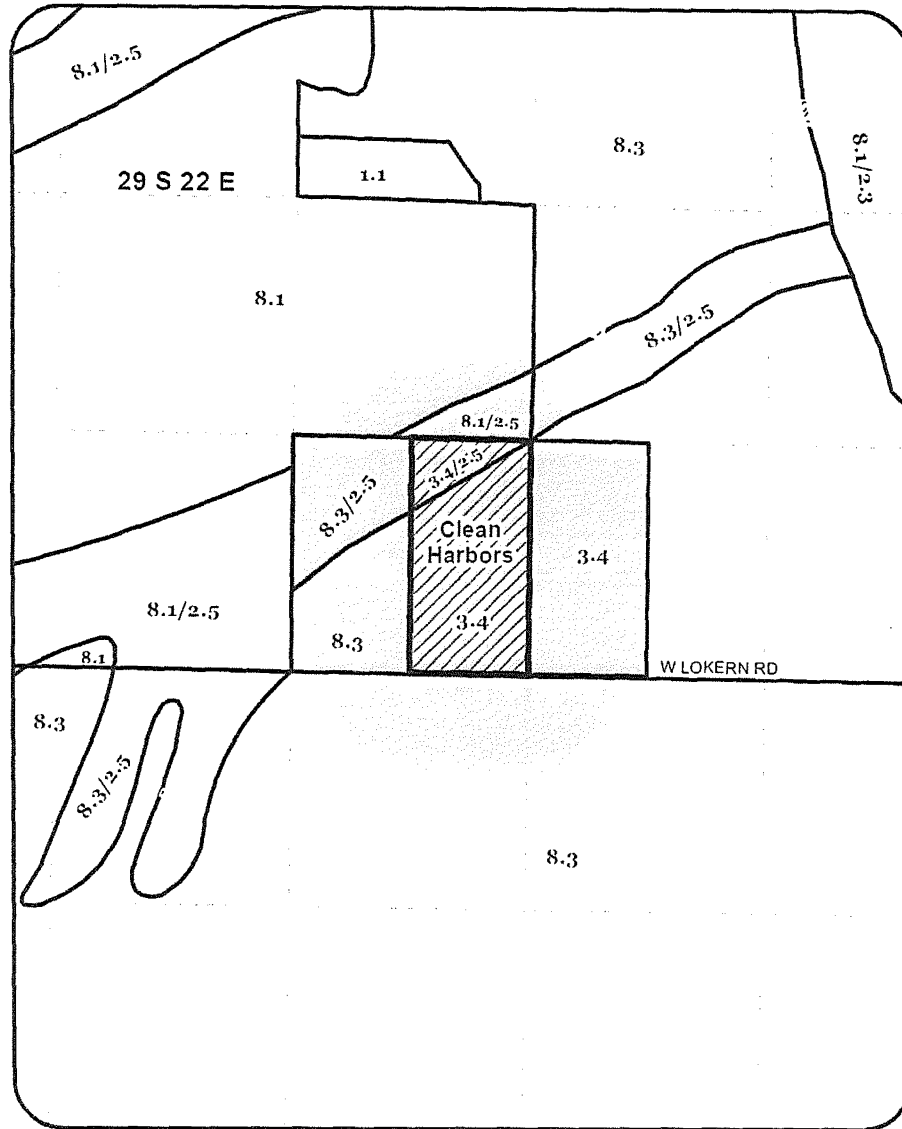

Proposed Appendix
 "E" Map
 Clean Harbors Buttonwillow,
 LLC

CLEAN HARBORS BUTTONWILLOW, LLC

LEGEND		SITE LOCATION	
	Landfill	E 1/2 of Section 16, W 1/2 of Section 15,	
	2000 ft Buffer	T.29S., R.22E., M.D.B & M.	
	GP DESIGNATIONS	 	
	Sections		
See Kern County Planning Dept. for "Official" General Plan Map Code Designations			



Kern County
 Planning & Natural
 Resources Department

SITE PLAN

CLEAN HARBORS BUTTOWILLOW, LLC
FACILITY
BUTTOWILLOW, CALIFORNIA

Proposed Expanded
Non-Hazardous Waste Disposal

Proposed Soil Stockpiles

Proposed Paint Care

Proposed Container Storage Area

Proposed Tank Treatment Buildings
x4

Legend

- Site Boundary
- Proposed Expanded Non-Hazardous Waste Disposal
- Proposed Soil Stockpiles
- Proposed Paint Care
- Proposed Container Storage Area
- Proposed Tank Treatment Buildings x4
- Existing Waste Management Units (Landfill)



0 500

SCALE IN FEET

WMU = Waste Management Units
2024 Kern County Aerial Imagery

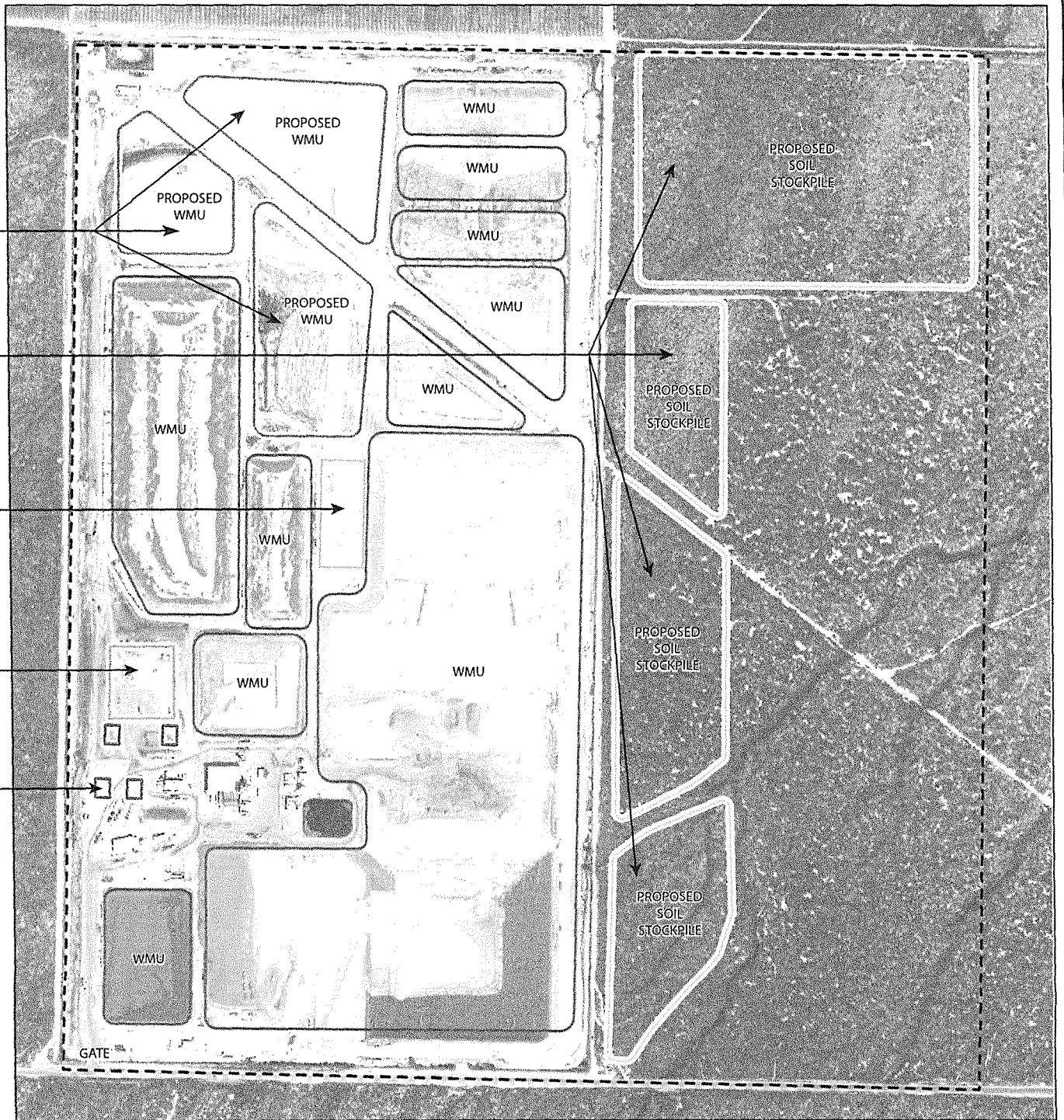



State of California - Department of Fish and Wildlife
2024 ENVIRONMENTAL DOCUMENT FILING FEE

CASH RECEIPT

DFW 753.5a (REV. 01/01/24) Previously DFG 753.5a

RECEIPT NUMBER:
 15 — 09252024 — 15150976
 STATE CLEARINGHOUSE NUMBER (if applicable)

SEE INSTRUCTIONS ON REVERSE. TYPE OR PRINT CLEARLY.

LEAD AGENCY KERN COUNTY PLANNING AND NATURAL RESOURCES DEPARTMENT	LEAD AGENCY EMAIL	DATE 9/25/2024
COUNTY/STATE AGENCY OF FILING Kern	DOCUMENT NUMBER 25177	

PROJECT TITLE
PP17117 - CLEAN HARBORS WMU SOLID WASTE DISPOSAL FACILITY

PROJECT APPLICANT NAME CLEAN HARBORS BUTTONWILLOW, LLC	PROJECT APPLICANT EMAIL	PHONE NUMBER (661) 762-6200
PROJECT APPLICANT ADDRESS 2500 WEST LOKERN ROAD	CITY BUTTONWILLOW	STATE CA
		ZIP CODE 93206

PROJECT APPLICANT (Check appropriate box)

- Local Public Agency
 School District
 Other Special District
 State Agency
 Private Entity

CHECK APPLICABLE FEES:

- | | | | |
|---|------------|----|-------------------|
| <input checked="" type="checkbox"/> Environmental Impact Report (EIR) | \$4,051.25 | \$ | <u>4,051.25</u> |
| <input type="checkbox"/> Mitigated/Negative Declaration (MND)(ND) | \$2,916.75 | \$ | <u>0.00</u> |
| <input type="checkbox"/> Certified Regulatory Program (CRP) document - payment due directly to CDFW | \$1,377.25 | \$ | <u>0.00</u> |
|
 | | | |
| <input type="checkbox"/> Exempt from fee | | | |
| <input type="checkbox"/> Notice of Exemption (attach) | | | |
| <input type="checkbox"/> CDFW No Effect Determination (attach) | | | |
| <input type="checkbox"/> Fee previously paid (attach previously issued cash receipt copy) | | | |
| <hr/> | | | |
| <input type="checkbox"/> Water Right Application or Petition Fee (State Water Resources Control Board only) | \$850.00 | \$ | <u>0.00</u> |
| <input checked="" type="checkbox"/> County documentary handling fee | | \$ | <u>50.00</u> |
| <input checked="" type="checkbox"/> Other | | \$ | <u> </u> |

PAYMENT METHOD:

- Cash
 Credit
 Check
 Other
 TOTAL RECEIVED
 \$ 4,101.25

SIGNATURE X <i>M.H</i>	AGENCY OF FILING PRINTED NAME AND TITLE M. HERNANDEZ, KERN COUNTY CLERK, FSS
----------------------------------	---