

SITE PLAN

Application # PA 2000077

Received By AG On 4-27-2020

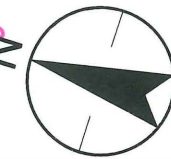

SCALE: 1' = 800'

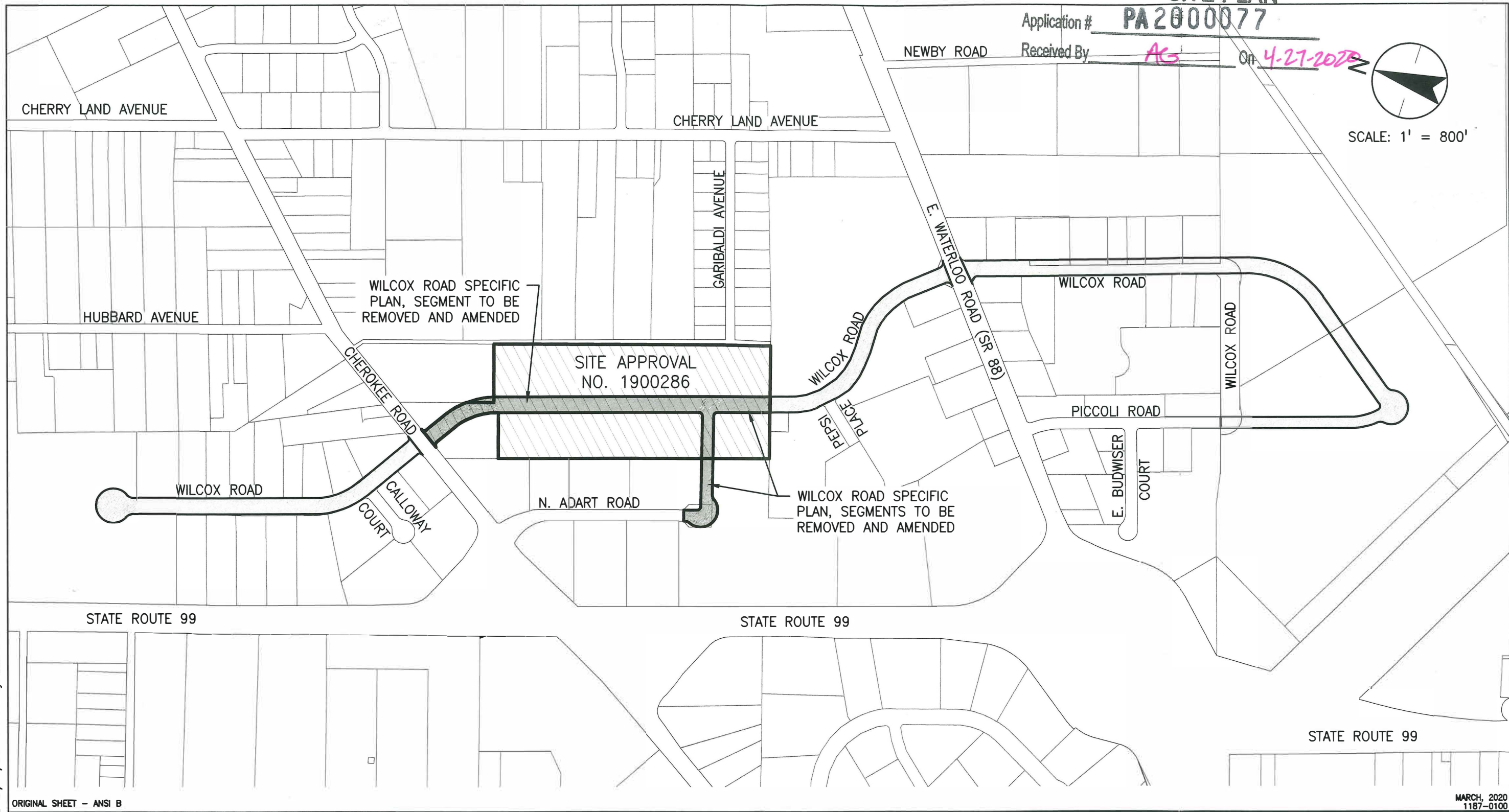





W:\11870100\civil\exhibits\WILCOX_SP_AMENDMENT.dwg
2020/03/24 1:32 PM By: Adam Reed

ORIGINAL SHEET - ANSI B

MARCH, 2020
1187-0100



430 10th Street Modesto, CA 95354
Tel.: 209.568.4477 Fax: 209.568.4478

-  WILCOX ROAD SPECIFIC PLAN
-  WILCOX ROAD SPECIFIC PLAN SEGMENTS TO BE REMOVED AND AMENDED
-  EXISTING RIGHT OF WAY
-  EXISTING PARCEL LINES
-  SITE APPROVAL NO. 1900286

Client/Project
XTRA LEASE
STOCKTON LEASING FACILITY

Figure No.
1.0

Title
WILCOX ROAD
SPECIFIC PLAN AMENDMENT