



July 30, 2020

Original sent via Certified US Mail
Copy sent via email to:
rgoff@campo-nsn.gov

Mr. Ralph Goff
Chairperson
Campo Band of Diegueno Mission Indians
36190 Church Road, Suite 1
Campo, CA 91906

Subject: Project Notification Pursuant to Assembly Bill (AB) 52 for the Hoag Hospital Irvine Expansion project (00816357-PCPM) in the City of Irvine, County of Orange, California (Assessor Parcel Number: 466-091-19)

Dear Mr. Goff:

The City of Irvine is the lead agency, pursuant to the California Environmental Quality Act (CEQA), for the conditional use permit modification (00816357-PCPM) request for Hoag Hospital Irvine (HHI). HHI is seeking a conditional use permit modification to expand their existing hospital campus. The existing campus was first approved in December 1983 for a maximum entitlement of 565,359 square feet of hospital with up to 500 hospital beds, support uses, and medical offices. The project site is currently comprised of a 249,794 square-foot hospital with 166 hospital beds, a 10-story, 115,762 square-foot medical office building, and surface parking on approximately 24.5 acres located at 16200 Sand Canyon Avenue in the City of Irvine (see Attachment 1 – Existing Project Site).

The proposed conditional use permit modification seeks to increase the number of hospital beds from 166 to 391, and increase the hospital intensity from the originally approved 565,359 square feet up to approximately 1,123,293 square feet on the existing project site. At project build-out, the proposal would exceed the previous entitlement for the project site by up to approximately 557,934 square feet (see Attachment 2 – Proposed Project Site). Specifically, the proposed project would allow development to occur in two phases and consist of the following major components:

Phase 1:

- Addition of 356,740 square feet of hospital services with 161 beds to support the relocation of the pharmacy, clinical laboratory, intensive care unit, surgical suite, café, medical records, cashier, registration, worship center, gift shop and lobby;
- Addition of 130,000 square feet of hospital support facility;
- Addition of two, five-level parking structures (over 700 stalls in each structure;

- Addition of 47,550 square feet of new central utility plant along with cooling; and towers and emergency power generators at grade level.

Phase 2:

- Addition of 8,000 square feet of auditorium and conference center;
- Addition of 260,000 square feet of hospital support facilities;
- Addition of 80,000 square feet of hospital services to support 64 additional in-patient beds; and
- Parking structure expansion to provide 486 additional parking stalls.

AB 52 requires lead agencies to consult with California Native American Tribes that request such consultation in writing prior to the agency's release of a Notice of Preparation (NOP) of an Environmental Impact Report (EIR), or notice of a Mitigated Negative Declaration (MND), or Negative Declaration (ND) on or after July 1, 2015. Pursuant to Public Resources Code section 21080.3.1, a list of California Native American Tribes was provided to the City of Irvine that are traditionally and culturally affiliated with geographic area of the proposed project. This letter is intended as formal notification of the proposed project pursuant to Assembly Bill (AB) 52.

Pursuant to the provisions of Assembly Bill (AB) 52, the City hereby extends an invitation to consult on the California Environmental Quality Act (CEQA) review of this proposed project in order to assist with identifying and/or preserving and/or mitigating project impacts to Native American cultural places including:

- Native American sanctified cemetery, place of worship, religious or ceremonial site, or sacred shrine; and
- Native American historic, cultural, or sacred site that is listed or may be eligible for listing in the California Register of Historical Resources including historic or prehistoric ruins and any burial ground, archaeological, or historic site.

If you desire to consult with the City on the CEQA review of this project, please respond in writing within thirty (30) days of the date of this letter by either letter and/or email. Please direct your email to hdesantos@cityofirvine.org or any correspondence on this matter to:

Hernan DeSantos
Senior Planner
City of Irvine – Community Development Department
P.O. Box 19575
Irvine, CA 92623

Should we not receive a response within thirty (30) days, we will presume that you have declined consultation. Please do not hesitate to let me know if you have any questions

Mr. Ralph Goff
July 30, 2020
Page 3 of 3

or would like to discuss this proposed project. I can be reached by email at hdesantos@cityofirvine.org.

Sincerely,

Hernan DeSantos

Hernan DeSantos
Senior Planner

Enclosures:

1. Existing Project Site
2. Proposed Project Site

ec: Pete Carmichael, Director of Community Development
Tim Gehrich, Deputy Director of Community Development
Bill Rodrigues, Principal Planner
Chad Beckstrom, ICF (Chad.Beckstrom@icf.com)
Tanya Jones, ICF (Tanya.Jones@icf.com)

Files: 00816357-PCPM

Enclosure 1 – Existing Project Site

Existing Campus



- A Ancillary Hospital Services
- B Nursing Tower
- C Emergency Department
- D Medical Office

Enclosure 2 – Proposed Project Site

Stage 2 / Campus Plan



Existing

- A. HHI/HOI
- B. Inpatient wing
- C. Emergency Department
- D. Rhodes Development MOB

Proposed

- 1. Women's Hospital
- 2. Women's Hospital Support Facility
- 3. Digestive Health Hospital
- 4. East Wing (ICU, Pharmacy, Lab)
- 5. East Parking Structure
- 6. Digestive Hospital Support Facility
- 7. Hospital Support Facility
- 8. Hospital Support Facility
- 9. Replacement Auditorium and Conf.
- 10. Central Utility Plan
- 11. West Wing Hospital
- 12. West Parking Structure
- 13. HHI Lobby (Café, Registration, Worship Center)
- 14. Interventional Platform



July 30, 2020

Original sent via Certified US Mail
Copy sent via email to:
wmicklin@leaningrock.net

Mr. Robert Pinto
Chairperson
Ewiiapaayp Band of Kumeyaay Indians
4054 Willows Road
Alpine, CA 91901

Subject: Project Notification Pursuant to Assembly Bill (AB) 52 for the Hoag Hospital Irvine Expansion project (00816357-PCPM) in the City of Irvine, County of Orange, California (Assessor Parcel Number: 466-091-19)

Dear Mr. Pinto:

The City of Irvine is the lead agency, pursuant to the California Environmental Quality Act (CEQA), for the conditional use permit modification (00816357-PCPM) request for Hoag Hospital Irvine (HHI). HHI is seeking a conditional use permit modification to expand their existing hospital campus. The existing campus was first approved in December 1983 for a maximum entitlement of 565,359 square feet of hospital with up to 500 hospital beds, support uses, and medical offices. The project site is currently comprised of a 249,794 square-foot hospital with 166 hospital beds, a 10-story, 115,762 square-foot medical office building, and surface parking on approximately 24.5 acres located at 16200 Sand Canyon Avenue in the City of Irvine (see Attachment 1 – Existing Project Site).

The proposed conditional use permit modification seeks to increase the number of hospital beds from 166 to 391, and increase the hospital intensity from the originally approved 565,359 square feet up to approximately 1,123,293 square feet on the existing project site. At project build-out, the proposal would exceed the previous entitlement for the project site by up to approximately 557,934 square feet (see Attachment 2 – Proposed Project Site). Specifically, the proposed project would allow development to occur in two phases and consist of the following major components:

Phase 1:

- Addition of 356,740 square feet of hospital services with 161 beds to support the relocation of the pharmacy, clinical laboratory, intensive care unit, surgical suite, café, medical records, cashier, registration, worship center, gift shop and lobby;
- Addition of 130,000 square feet of hospital support facility;
- Addition of two, five-level parking structures (over 700 stalls in each structure);
- Addition of 47,550 square feet of new central utility plant along with cooling; and towers and emergency power generators at grade level.

Phase 2:

- Addition of 8,000 square feet of auditorium and conference center;
- Addition of 260,000 square feet of hospital support facilities;
- Addition of 80,000 square feet of hospital services to support 64 additional in-patient beds; and
- Parking structure expansion to provide 486 additional parking stalls.

AB 52 requires lead agencies to consult with California Native American Tribes that request such consultation in writing prior to the agency's release of a Notice of Preparation (NOP) of an Environmental Impact Report (EIR), or notice of a Mitigated Negative Declaration (MND), or Negative Declaration (ND) on or after July 1, 2015. Pursuant to Public Resources Code section 21080.3.1, a list of California Native American Tribes was provided to the City of Irvine that are traditionally and culturally affiliated with geographic area of the proposed project. This letter is intended as formal notification of the proposed project pursuant to Assembly Bill (AB) 52.

Pursuant to the provisions of Assembly Bill (AB) 52, the City hereby extends an invitation to consult on the California Environmental Quality Act (CEQA) review of this proposed project in order to assist with identifying and/or preserving and/or mitigating project impacts to Native American cultural places including:

- Native American sanctified cemetery, place of worship, religious or ceremonial site, or sacred shrine; and
- Native American historic, cultural, or sacred site that is listed or may be eligible for listing in the California Register of Historical Resources including historic or prehistoric ruins and any burial ground, archaeological, or historic site.

If you desire to consult with the City on the CEQA review of this project, please respond in writing within thirty (30) days of the date of this letter by either letter and/or email. Please direct your email to hdesantos@cityofirvine.org or any correspondence on this matter to:

Hernan DeSantos
Senior Planner
City of Irvine – Community Development Department
P.O. Box 19575
Irvine, CA 92623

Should we not receive a response within thirty (30) days, we will presume that you have declined consultation. Please do not hesitate to let me know if you have any questions

Mr. Robert Pinto
July 30, 2020
Page 3 of 3

or would like to discuss this proposed project. I can be reached by email at hdesantos@cityofirvine.org.

Sincerely,

Hernan DeSantos

Hernan DeSantos
Senior Planner

Enclosures:

1. Existing Project Site
2. Proposed Project Site

ec: Pete Carmichael, Director of Community Development
Tim Gehrich, Deputy Director of Community Development
Bill Rodrigues, Principal Planner
Chad Beckstrom, ICF (Chad.Beckstrom@icf.com)
Tanya Jones, ICF (Tanya.Jones@icf.com)

Files: 00816357-PCPM

Enclosure 1 – Existing Project Site

Existing Campus

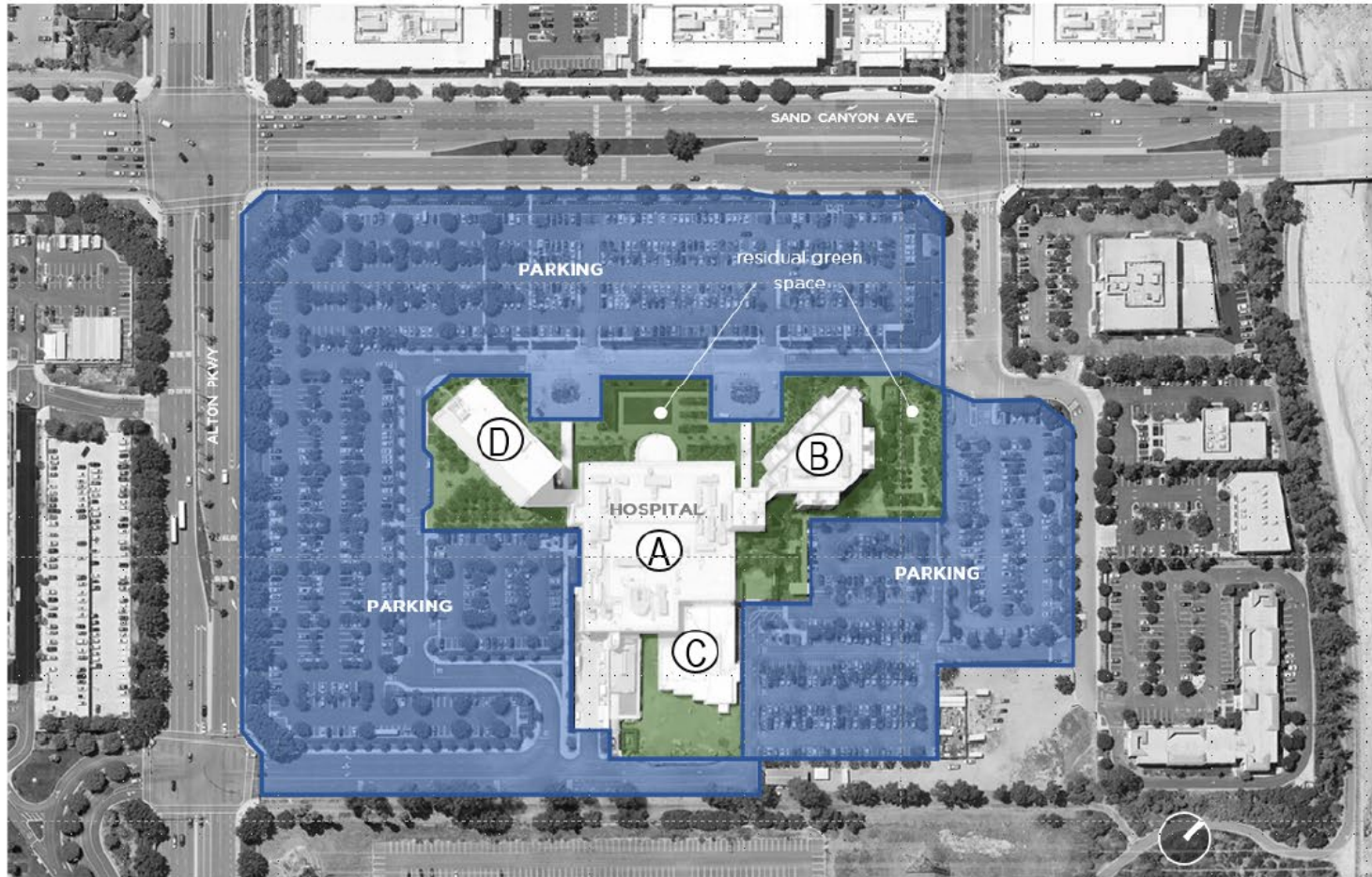

- A Ancillary Hospital Services
- B Nursing Tower
- C Emergency Department
- D Medical Office

Enclosure 2 – Proposed Project Site

Stage 2 / Campus Plan



Existing

- A. HHI/HOI
- B. Inpatient wing
- C. Emergency Department
- D. Rhodes Development MOB

Proposed

- 1. Women's Hospital
- 2. Women's Hospital Support Facility
- 3. Digestive Health Hospital
- 4. East Wing (ICU, Pharmacy, Lab)
- 5. East Parking Structure
- 6. Digestive Hospital Support Facility
- 7. Hospital Support Facility
- 8. Hospital Support Facility
- 9. Replacement Auditorium and Conf.
- 10. Central Utility Plan
- 11. West Wing Hospital
- 12. West Parking Structure
- 13. HHI Lobby (Café, Registration, Worship Center)
- 14. Interventional Platform



July 30, 2020

Original sent via Certified US Mail
Copy sent via email to:
michaelg@leaningrock.net

Mr. Michael Garcia
Vice-Chairperson
Ewiiapaayp Band of Kumeyaay Indians
Alpine, CA 91901

Subject: Project Notification Pursuant to Assembly Bill (AB) 52 for the Hoag Hospital Irvine Expansion project (00816357-PCPM) in the City of Irvine, County of Orange, California (Assessor Parcel Number: 466-091-19)

Dear Mr. Garcia:

The City of Irvine is the lead agency, pursuant to the California Environmental Quality Act (CEQA), for the conditional use permit modification (00816357-PCPM) request for Hoag Hospital Irvine (HHI). HHI is seeking a conditional use permit modification to expand their existing hospital campus. The existing campus was first approved in December 1983 for a maximum entitlement of 565,359 square feet of hospital with up to 500 hospital beds, support uses, and medical offices. The project site is currently comprised of a 249,794 square-foot hospital with 166 hospital beds, a 10-story, 115,762 square-foot medical office building, and surface parking on approximately 24.5 acres located at 16200 Sand Canyon Avenue in the City of Irvine (see Attachment 1 – Existing Project Site).

The proposed conditional use permit modification seeks to increase the number of hospital beds from 166 to 391, and increase the hospital intensity from the originally approved 565,359 square feet up to approximately 1,123,293 square feet on the existing project site. At project build-out, the proposal would exceed the previous entitlement for the project site by up to approximately 557,934 square feet (see Attachment 2 – Proposed Project Site). Specifically, the proposed project would allow development to occur in two phases and consist of the following major components:

Phase 1:

- Addition of 356,740 square feet of hospital services with 161 beds to support the relocation of the pharmacy, clinical laboratory, intensive care unit, surgical suite, café, medical records, cashier, registration, worship center, gift shop and lobby;
- Addition of 130,000 square feet of hospital support facility;
- Addition of two, five-level parking structures (over 700 stalls in each structure);
- Addition of 47,550 square feet of new central utility plant along with cooling; and towers and emergency power generators at grade level.

Phase 2:

- Addition of 8,000 square feet of auditorium and conference center;
- Addition of 260,000 square feet of hospital support facilities;
- Addition of 80,000 square feet of hospital services to support 64 additional in-patient beds; and
- Parking structure expansion to provide 486 additional parking stalls.

AB 52 requires lead agencies to consult with California Native American Tribes that request such consultation in writing prior to the agency's release of a Notice of Preparation (NOP) of an Environmental Impact Report (EIR), or notice of a Mitigated Negative Declaration (MND), or Negative Declaration (ND) on or after July 1, 2015. Pursuant to Public Resources Code section 21080.3.1, a list of California Native American Tribes was provided to the City of Irvine that are traditionally and culturally affiliated with geographic area of the proposed project. This letter is intended as formal notification of the proposed project pursuant to Assembly Bill (AB) 52.

Pursuant to the provisions of Assembly Bill (AB) 52, the City hereby extends an invitation to consult on the California Environmental Quality Act (CEQA) review of this proposed project in order to assist with identifying and/or preserving and/or mitigating project impacts to Native American cultural places including:

- Native American sanctified cemetery, place of worship, religious or ceremonial site, or sacred shrine; and
- Native American historic, cultural, or sacred site that is listed or may be eligible for listing in the California Register of Historical Resources including historic or prehistoric ruins and any burial ground, archaeological, or historic site.

If you desire to consult with the City on the CEQA review of this project, please respond in writing within thirty (30) days of the date of this letter by either letter and/or email. Please direct your email to hdesantos@cityofirvine.org or any correspondence on this matter to:

Hernan DeSantos
Senior Planner
City of Irvine – Community Development Department
P.O. Box 19575
Irvine, CA 92623

Should we not receive a response within thirty (30) days, we will presume that you have declined consultation. Please do not hesitate to let me know if you have any questions

Mr. Michael Garcia
July 30, 2020
Page 3 of 3

or would like to discuss this proposed project. I can be reached by email at hdesantos@cityofirvine.org.

Sincerely,

Hernan DeSantos

Hernan DeSantos
Senior Planner

Enclosures:

1. Existing Project Site
2. Proposed Project Site

ec: Pete Carmichael, Director of Community Development
Tim Gehrich, Deputy Director of Community Development
Bill Rodrigues, Principal Planner
Chad Beckstrom, ICF (Chad.Beckstrom@icf.com)
Tanya Jones, ICF (Tanya.Jones@icf.com)

Files: 00816357-PCPM

Enclosure 1 – Existing Project Site

Existing Campus

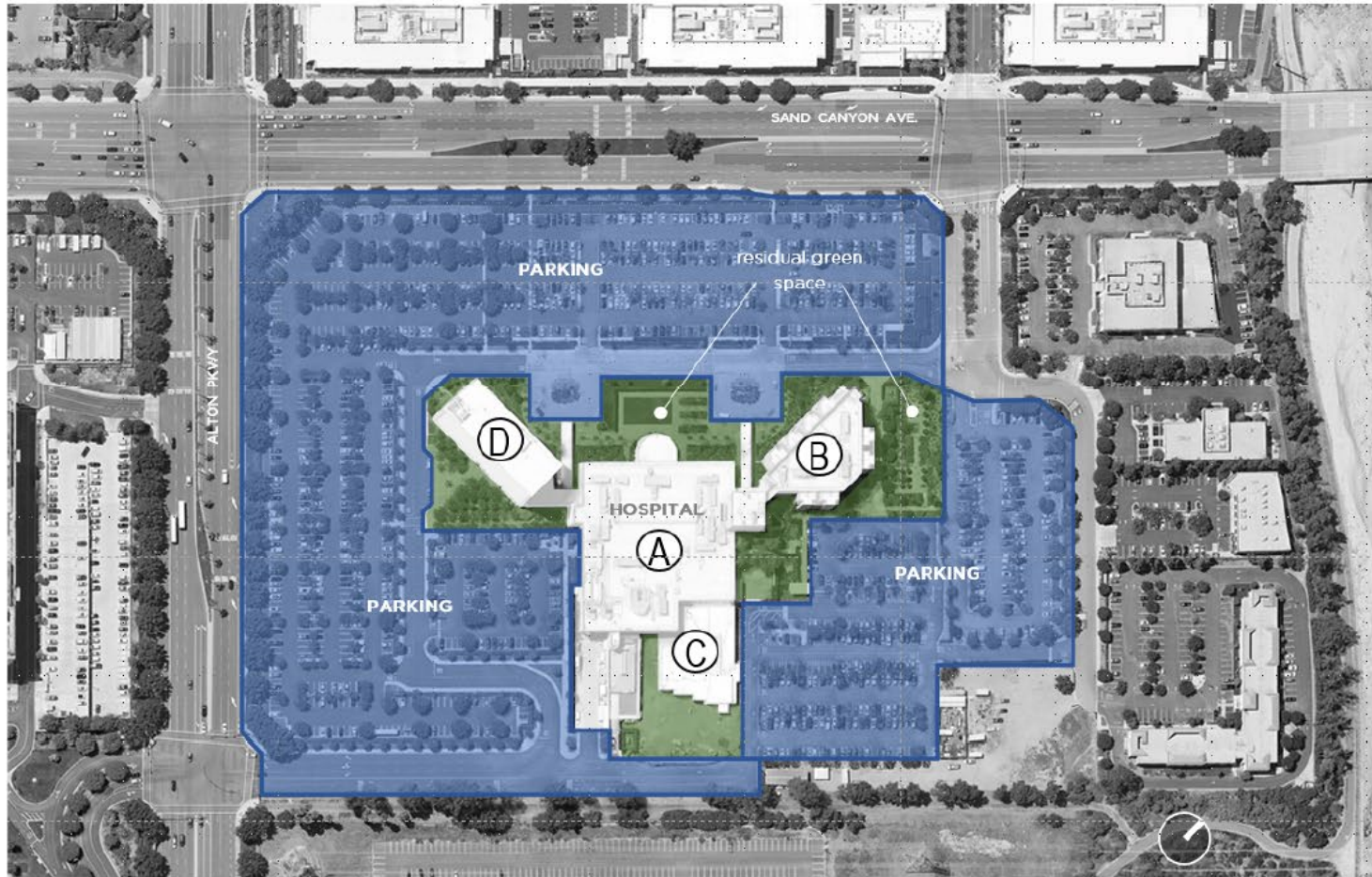

- A Ancillary Hospital Services
- B Nursing Tower
- C Emergency Department
- D Medical Office

Enclosure 2 – Proposed Project Site

Stage 2 / Campus Plan



Existing

- A. HHI/HOI
- B. Inpatient wing
- C. Emergency Department
- D. Rhodes Development MOB

Proposed

- 1. Women's Hospital
- 2. Women's Hospital Support Facility
- 3. Digestive Health Hospital
- 4. East Wing (ICU, Pharmacy, Lab)
- 5. East Parking Structure
- 6. Digestive Hospital Support Facility
- 7. Hospital Support Facility
- 8. Hospital Support Facility
- 9. Replacement Auditorium and Conf.
- 10. Central Utility Plan
- 11. West Wing Hospital
- 12. West Parking Structure
- 13. HHI Lobby (Café, Registration, Worship Center)
- 14. Interventional Platform



July 30, 2020

Original sent via Certified US Mail
Copy sent via email to:
admin@gabrielenoindians.org

Mr. Andrew Salas
Chairperson
Gabrieleno Band of Mission Indians – Kizh Nation
P.O. Box 393
Covina, CA 91723

Subject: Project Notification Pursuant to Assembly Bill (AB) 52 for the Hoag Hospital Irvine Expansion project (00816357-PCPM) in the City of Irvine, County of Orange, California (Assessor Parcel Number: 466-091-19)

Dear Mr. Salas:

The City of Irvine is the lead agency, pursuant to the California Environmental Quality Act (CEQA), for the conditional use permit modification (00816357-PCPM) request for Hoag Hospital Irvine (HHI). HHI is seeking a conditional use permit modification to expand their existing hospital campus. The existing campus was first approved in December 1983 for a maximum entitlement of 565,359 square feet of hospital with up to 500 hospital beds, support uses, and medical offices. The project site is currently comprised of a 249,794 square-foot hospital with 166 hospital beds, a 10-story, 115,762 square-foot medical office building, and surface parking on approximately 24.5 acres located at 16200 Sand Canyon Avenue in the City of Irvine (see Attachment 1 – Existing Project Site).

The proposed conditional use permit modification seeks to increase the number of hospital beds from 166 to 391, and increase the hospital intensity from the originally approved 565,359 square feet up to approximately 1,123,293 square feet on the existing project site. At project build-out, the proposal would exceed the previous entitlement for the project site by up to approximately 557,934 square feet (see Attachment 2 – Proposed Project Site). Specifically, the proposed project would allow development to occur in two phases and consist of the following major components:

Phase 1:

- Addition of 356,740 square feet of hospital services with 161 beds to support the relocation of the pharmacy, clinical laboratory, intensive care unit, surgical suite, café, medical records, cashier, registration, worship center, gift shop and lobby;
- Addition of 130,000 square feet of hospital support facility;
- Addition of two, five-level parking structures (over 700 stalls in each structure);
- Addition of 47,550 square feet of new central utility plant along with cooling; and towers and emergency power generators at grade level.

Phase 2:

- Addition of 8,000 square feet of auditorium and conference center;
- Addition of 260,000 square feet of hospital support facilities;
- Addition of 80,000 square feet of hospital services to support 64 additional in-patient beds; and
- Parking structure expansion to provide 486 additional parking stalls.

AB 52 requires lead agencies to consult with California Native American Tribes that request such consultation in writing prior to the agency's release of a Notice of Preparation (NOP) of an Environmental Impact Report (EIR), or notice of a Mitigated Negative Declaration (MND), or Negative Declaration (ND) on or after July 1, 2015. Pursuant to Public Resources Code section 21080.3.1, a list of California Native American Tribes was provided to the City of Irvine that are traditionally and culturally affiliated with geographic area of the proposed project. This letter is intended as formal notification of the proposed project pursuant to Assembly Bill (AB) 52.

Pursuant to the provisions of Assembly Bill (AB) 52, the City hereby extends an invitation to consult on the California Environmental Quality Act (CEQA) review of this proposed project in order to assist with identifying and/or preserving and/or mitigating project impacts to Native American cultural places including:

- Native American sanctified cemetery, place of worship, religious or ceremonial site, or sacred shrine; and
- Native American historic, cultural, or sacred site that is listed or may be eligible for listing in the California Register of Historical Resources including historic or prehistoric ruins and any burial ground, archaeological, or historic site.

If you desire to consult with the City on the CEQA review of this project, please respond in writing within thirty (30) days of the date of this letter by either letter and/or email. Please direct your email to hdesantos@cityofirvine.org or any correspondence on this matter to:

Hernan DeSantos
Senior Planner
City of Irvine – Community Development Department
P.O. Box 19575
Irvine, CA 92623

Should we not receive a response within thirty (30) days, we will presume that you have declined consultation. Please do not hesitate to let me know if you have any questions

Mr. Andrew Salas

July 30, 2020

Page 3 of 3

or would like to discuss this proposed project. I can be reached by email at hdesantos@cityofirvine.org.

Sincerely,

Hernan DeSantos

Hernan DeSantos

Senior Planner

Enclosures:

1. Existing Project Site
2. Proposed Project Site

ec: Pete Carmichael, Director of Community Development
Tim Gehrich, Deputy Director of Community Development
Bill Rodrigues, Principal Planner
Chad Beckstrom, ICF (Chad.Beckstrom@icf.com)
Tanya Jones, ICF (Tanya.Jones@icf.com)

Files: 00816357-PCPM

Enclosure 1 – Existing Project Site

Existing Campus

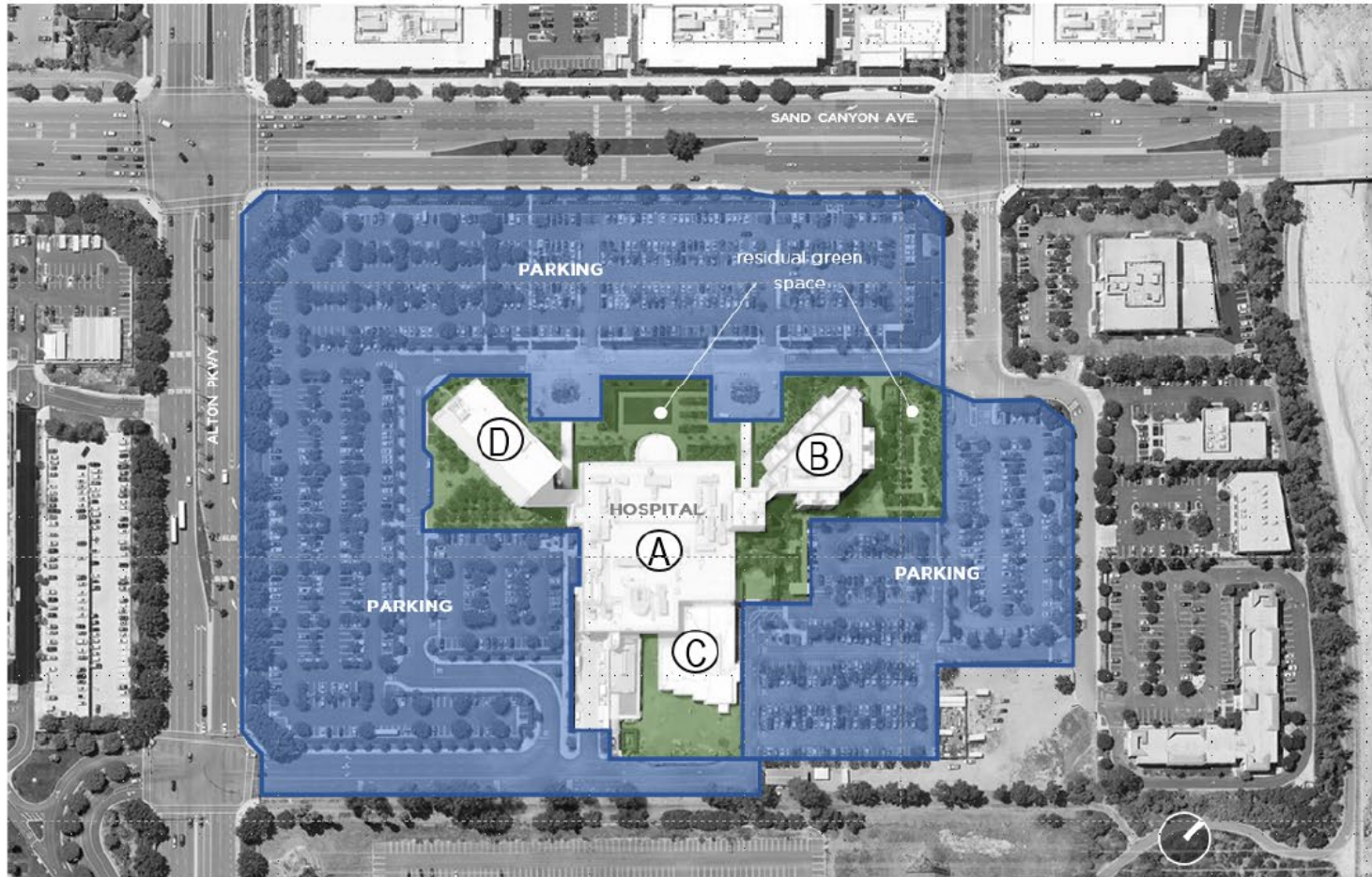

- A Ancillary Hospital Services
- B Nursing Tower
- C Emergency Department
- D Medical Office

Enclosure 2 – Proposed Project Site

Stage 2 / Campus Plan



Existing

- A. HHI/HOI
- B. Inpatient wing
- C. Emergency Department
- D. Rhodes Development MOB

Proposed

- 1. Women's Hospital
- 2. Women's Hospital Support Facility
- 3. Digestive Health Hospital
- 4. East Wing (ICU, Pharmacy, Lab)
- 5. East Parking Structure
- 6. Digestive Hospital Support Facility
- 7. Hospital Support Facility
- 8. Hospital Support Facility
- 9. Replacement Auditorium and Conf.
- 10. Central Utility Plan
- 11. West Wing Hospital
- 12. West Parking Structure
- 13. HHI Lobby (Café, Registration, Worship Center)
- 14. Interventional Platform



July 30, 2020

Original sent via Certified US Mail
Copy sent via email to:
gtongva@gmail.com

Mr. Robert Dorame
Chairperson
Gabrielino Tongva Indians of California Tribal Council
P.O. Box 490
Bellflower, CA 90707

Subject: Project Notification Pursuant to Assembly Bill (AB) 52 for the Hoag Hospital Irvine Expansion project (00816357-PCPM) in the City of Irvine, County of Orange, California (Assessor Parcel Number: 466-091-19)

Dear Mr. Dorame:

The City of Irvine is the lead agency, pursuant to the California Environmental Quality Act (CEQA), for the conditional use permit modification (00816357-PCPM) request for Hoag Hospital Irvine (HHI). HHI is seeking a conditional use permit modification to expand their existing hospital campus. The existing campus was first approved in December 1983 for a maximum entitlement of 565,359 square feet of hospital with up to 500 hospital beds, support uses, and medical offices. The project site is currently comprised of a 249,794 square-foot hospital with 166 hospital beds, a 10-story, 115,762 square-foot medical office building, and surface parking on approximately 24.5 acres located at 16200 Sand Canyon Avenue in the City of Irvine (see Attachment 1 – Existing Project Site).

The proposed conditional use permit modification seeks to increase the number of hospital beds from 166 to 391, and increase the hospital intensity from the originally approved 565,359 square feet up to approximately 1,123,293 square feet on the existing project site. At project build-out, the proposal would exceed the previous entitlement for the project site by up to approximately 557,934 square feet (see Attachment 2 – Proposed Project Site). Specifically, the proposed project would allow development to occur in two phases and consist of the following major components:

Phase 1:

- Addition of 356,740 square feet of hospital services with 161 beds to support the relocation of the pharmacy, clinical laboratory, intensive care unit, surgical suite, café, medical records, cashier, registration, worship center, gift shop and lobby;
- Addition of 130,000 square feet of hospital support facility;
- Addition of two, five-level parking structures (over 700 stalls in each structure);
- Addition of 47,550 square feet of new central utility plant along with cooling; and towers and emergency power generators at grade level.

Phase 2:

- Addition of 8,000 square feet of auditorium and conference center;
- Addition of 260,000 square feet of hospital support facilities;
- Addition of 80,000 square feet of hospital services to support 64 additional in-patient beds; and
- Parking structure expansion to provide 486 additional parking stalls.

AB 52 requires lead agencies to consult with California Native American Tribes that request such consultation in writing prior to the agency's release of a Notice of Preparation (NOP) of an Environmental Impact Report (EIR), or notice of a Mitigated Negative Declaration (MND), or Negative Declaration (ND) on or after July 1, 2015. Pursuant to Public Resources Code section 21080.3.1, a list of California Native American Tribes was provided to the City of Irvine that are traditionally and culturally affiliated with geographic area of the proposed project. This letter is intended as formal notification of the proposed project pursuant to Assembly Bill (AB) 52.

Pursuant to the provisions of Assembly Bill (AB) 52, the City hereby extends an invitation to consult on the California Environmental Quality Act (CEQA) review of this proposed project in order to assist with identifying and/or preserving and/or mitigating project impacts to Native American cultural places including:

- Native American sanctified cemetery, place of worship, religious or ceremonial site, or sacred shrine; and
- Native American historic, cultural, or sacred site that is listed or may be eligible for listing in the California Register of Historical Resources including historic or prehistoric ruins and any burial ground, archaeological, or historic site.

If you desire to consult with the City on the CEQA review of this project, please respond in writing within thirty (30) days of the date of this letter by either letter and/or email. Please direct your email to hdesantos@cityofirvine.org or any correspondence on this matter to:

Hernan DeSantos
Senior Planner
City of Irvine – Community Development Department
P.O. Box 19575
Irvine, CA 92623

Should we not receive a response within thirty (30) days, we will presume that you have declined consultation. Please do not hesitate to let me know if you have any questions

Mr. Robert Dorame

July 30, 2020

Page 3 of 3

or would like to discuss this proposed project. I can be reached by email at hdesantos@cityofirvine.org.

Sincerely,

Hernan DeSantos

Hernan DeSantos

Senior Planner

Enclosures:

1. Existing Project Site
2. Proposed Project Site

ec: Pete Carmichael, Director of Community Development
Tim Gehrich, Deputy Director of Community Development
Bill Rodrigues, Principal Planner
Chad Beckstrom, ICF (Chad.Beckstrom@icf.com)
Tanya Jones, ICF (Tanya.Jones@icf.com)

Files: 00816357-PCPM

Enclosure 1 – Existing Project Site

Existing Campus

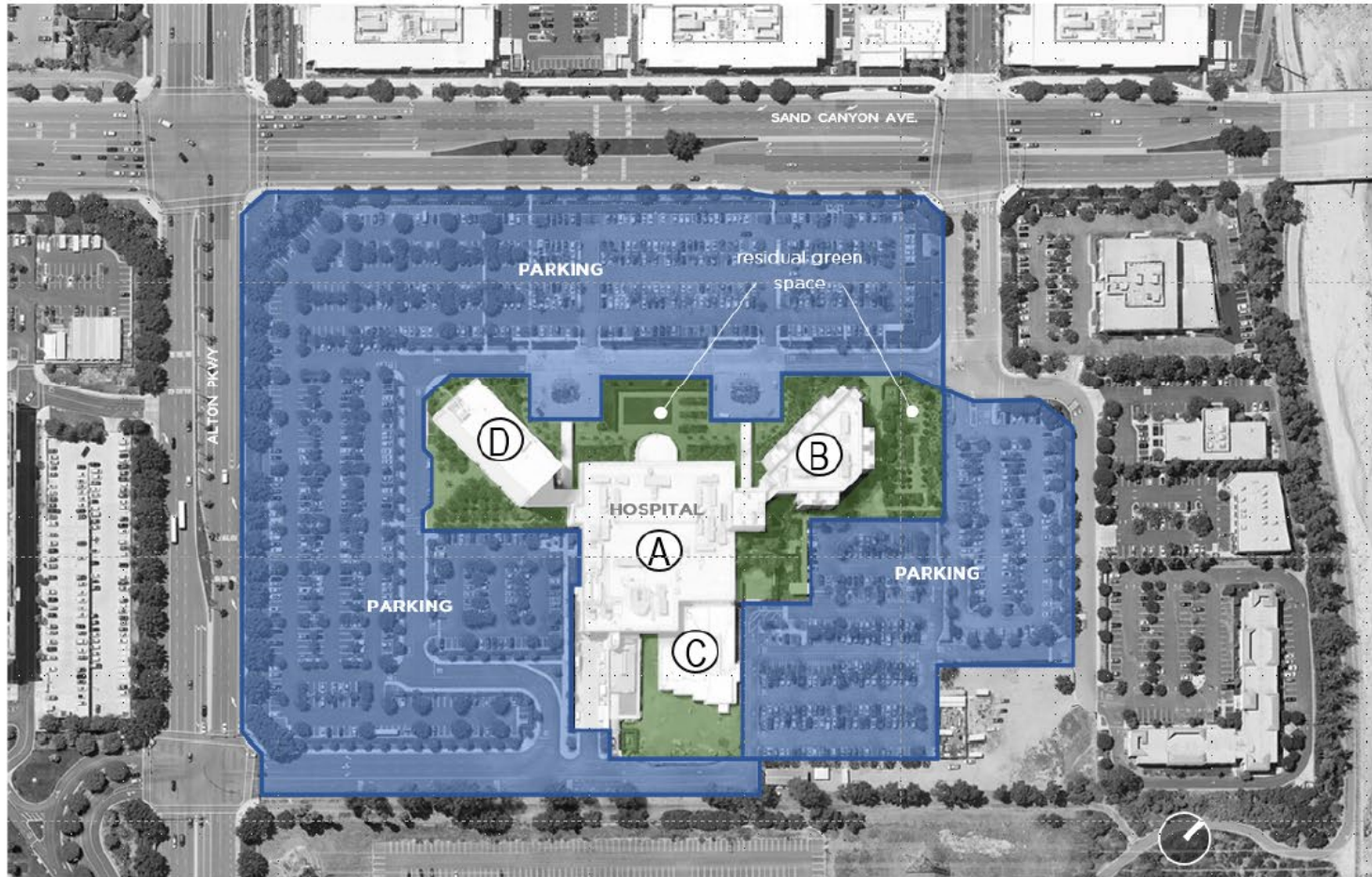

- A Ancillary Hospital Services
- B Nursing Tower
- C Emergency Department
- D Medical Office

Enclosure 2 – Proposed Project Site

Stage 2 / Campus Plan



Existing

- A. HHI/HOI
- B. Inpatient wing
- C. Emergency Department
- D. Rhodes Development MOB

Proposed

- 1. Women's Hospital
- 2. Women's Hospital Support Facility
- 3. Digestive Health Hospital
- 4. East Wing (ICU, Pharmacy, Lab)
- 5. East Parking Structure
- 6. Digestive Hospital Support Facility
- 7. Hospital Support Facility
- 8. Hospital Support Facility
- 9. Replacement Auditorium and Conf.
- 10. Central Utility Plan
- 11. West Wing Hospital
- 12. West Parking Structure
- 13. HHI Lobby (Café, Registration, Worship Center)
- 14. Interventional Platform



July 30, 2020

Original sent via Certified US Mail
Copy sent via email to:
sgoad@gabrielino-tongva.com

Mr. Sandonne Goad
Chairperson
Gabrielino/Tongva Nation
106 ½ Judge John Aiso Street, #231
Los Angeles, CA 90012

Subject: Project Notification Pursuant to Assembly Bill (AB) 52 for the Hoag Hospital Irvine Expansion project (00816357-PCPM) in the City of Irvine, County of Orange, California (Assessor Parcel Number: 466-091-19)

Dear Mr. Goad:

The City of Irvine is the lead agency, pursuant to the California Environmental Quality Act (CEQA), for the conditional use permit modification (00816357-PCPM) request for Hoag Hospital Irvine (HHI). HHI is seeking a conditional use permit modification to expand their existing hospital campus. The existing campus was first approved in December 1983 for a maximum entitlement of 565,359 square feet of hospital with up to 500 hospital beds, support uses, and medical offices. The project site is currently comprised of a 249,794 square-foot hospital with 166 hospital beds, a 10-story, 115,762 square-foot medical office building, and surface parking on approximately 24.5 acres located at 16200 Sand Canyon Avenue in the City of Irvine (see Attachment 1 – Existing Project Site).

The proposed conditional use permit modification seeks to increase the number of hospital beds from 166 to 391, and increase the hospital intensity from the originally approved 565,359 square feet up to approximately 1,123,293 square feet on the existing project site. At project build-out, the proposal would exceed the previous entitlement for the project site by up to approximately 557,934 square feet (see Attachment 2 – Proposed Project Site). Specifically, the proposed project would allow development to occur in two phases and consist of the following major components:

Phase 1:

- Addition of 356,740 square feet of hospital services with 161 beds to support the relocation of the pharmacy, clinical laboratory, intensive care unit, surgical suite, café, medical records, cashier, registration, worship center, gift shop and lobby;
- Addition of 130,000 square feet of hospital support facility;
- Addition of two, five-level parking structures (over 700 stalls in each structure);
- Addition of 47,550 square feet of new central utility plant along with cooling; and towers and emergency power generators at grade level.

Mr. Sandonne Goad

July 30, 2020

Page 2 of 3

Phase 2:

- Addition of 8,000 square feet of auditorium and conference center;
- Addition of 260,000 square feet of hospital support facilities;
- Addition of 80,000 square feet of hospital services to support 64 additional in-patient beds; and
- Parking structure expansion to provide 486 additional parking stalls.

AB 52 requires lead agencies to consult with California Native American Tribes that request such consultation in writing prior to the agency's release of a Notice of Preparation (NOP) of an Environmental Impact Report (EIR), or notice of a Mitigated Negative Declaration (MND), or Negative Declaration (ND) on or after July 1, 2015. Pursuant to Public Resources Code section 21080.3.1, a list of California Native American Tribes was provided to the City of Irvine that are traditionally and culturally affiliated with geographic area of the proposed project. This letter is intended as formal notification of the proposed project pursuant to Assembly Bill (AB) 52.

Pursuant to the provisions of Assembly Bill (AB) 52, the City hereby extends an invitation to consult on the California Environmental Quality Act (CEQA) review of this proposed project in order to assist with identifying and/or preserving and/or mitigating project impacts to Native American cultural places including:

- Native American sanctified cemetery, place of worship, religious or ceremonial site, or sacred shrine; and
- Native American historic, cultural, or sacred site that is listed or may be eligible for listing in the California Register of Historical Resources including historic or prehistoric ruins and any burial ground, archaeological, or historic site.

If you desire to consult with the City on the CEQA review of this project, please respond in writing within thirty (30) days of the date of this letter by either letter and/or email.

Please direct your email to hdesantos@cityofirvine.org or any correspondence on this matter to:

Hernan DeSantos
Senior Planner
City of Irvine – Community Development Department
P.O. Box 19575
Irvine, CA 92623

Should we not receive a response within thirty (30) days, we will presume that you have declined consultation. Please do not hesitate to let me know if you have any questions

Mr. Sandonne Goad

July 30, 2020

Page 3 of 3

or would like to discuss this proposed project. I can be reached by email at hdesantos@cityofirvine.org.

Sincerely,

Hernan DeSantos

Hernan DeSantos

Senior Planner

Enclosures:

1. Existing Project Site
2. Proposed Project Site

ec: Pete Carmichael, Director of Community Development
Tim Gehrich, Deputy Director of Community Development
Bill Rodrigues, Principal Planner
Chad Beckstrom, ICF (Chad.Beckstrom@icf.com)
Tanya Jones, ICF (Tanya.Jones@icf.com)

Files: 00816357-PCPM

Enclosure 1 – Existing Project Site

Existing Campus

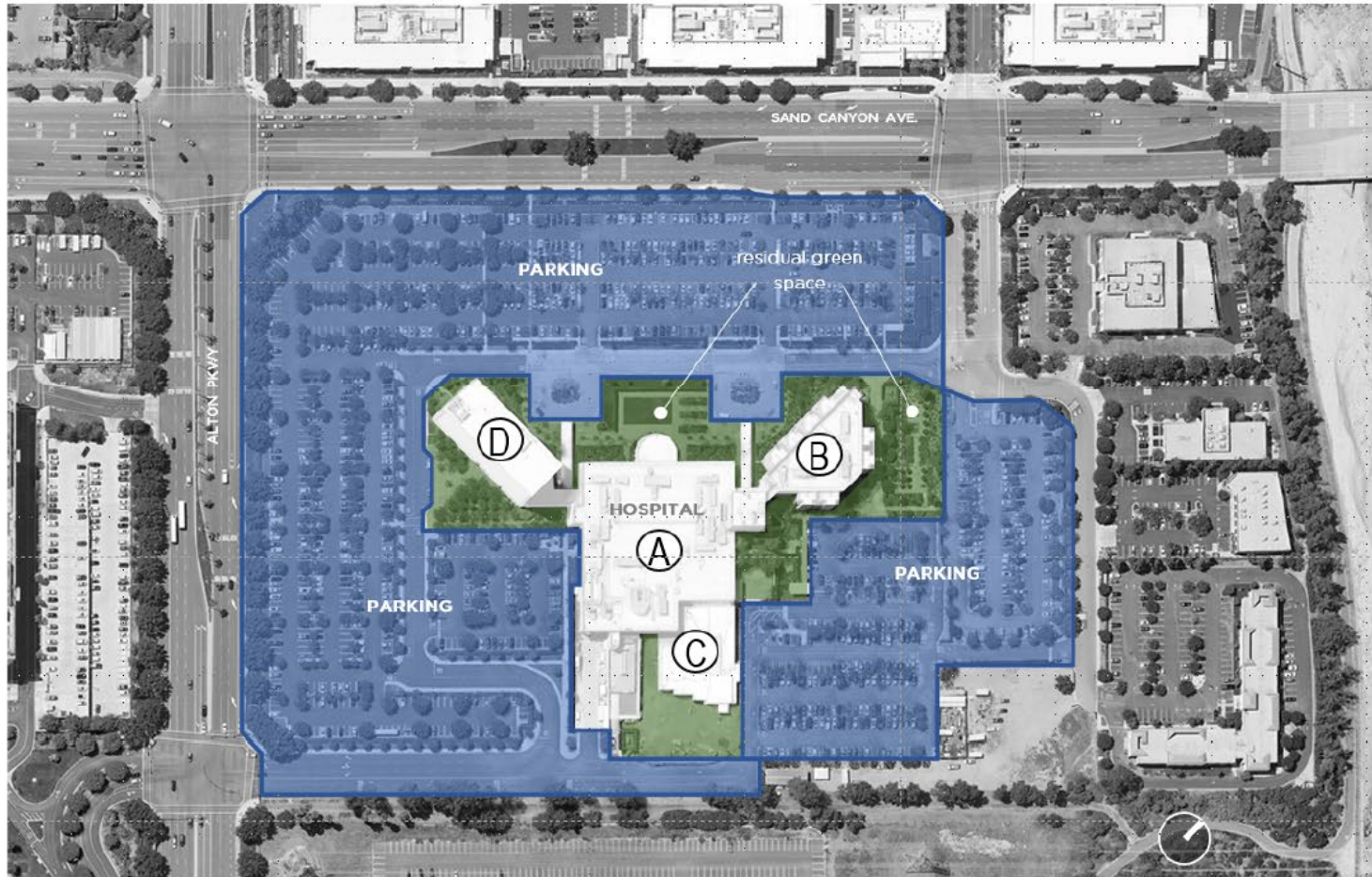

- A Ancillary Hospital Services
- B Nursing Tower
- C Emergency Department
- D Medical Office

Enclosure 2 – Proposed Project Site

Stage 2 / Campus Plan



Existing

- A. HHI/HOI
- B. Inpatient wing
- C. Emergency Department
- D. Rhodes Development MOB

Proposed

- 1. Women's Hospital
- 2. Women's Hospital Support Facility
- 3. Digestive Health Hospital
- 4. East Wing (ICU, Pharmacy, Lab)
- 5. East Parking Structure
- 6. Digestive Hospital Support Facility
- 7. Hospital Support Facility
- 8. Hospital Support Facility
- 9. Replacement Auditorium and Conf.
- 10. Central Utility Plan
- 11. West Wing Hospital
- 12. West Parking Structure
- 13. HHI Lobby (Café, Registration, Worship Center)
- 14. Interventional Platform



July 30, 2020

Original sent via Certified US Mail
Copy sent via email to:
GTTRibalcouncil@aol.com

Mr. Anthony Morales
Chairperson
Gabrieleno/Tongva San Gabriel Band of Mission Indians
P.O. Box 693
San Gabriel, CA 91778

Subject: Project Notification Pursuant to Assembly Bill (AB) 52 for the Hoag Hospital Irvine Expansion project (00816357-PCPM) in the City of Irvine, County of Orange, California (Assessor Parcel Number: 466-091-19)

Dear Mr. Morales:

The City of Irvine is the lead agency, pursuant to the California Environmental Quality Act (CEQA), for the conditional use permit modification (00816357-PCPM) request for Hoag Hospital Irvine (HHI). HHI is seeking a conditional use permit modification to expand their existing hospital campus. The existing campus was first approved in December 1983 for a maximum entitlement of 565,359 square feet of hospital with up to 500 hospital beds, support uses, and medical offices. The project site is currently comprised of a 249,794 square-foot hospital with 166 hospital beds, a 10-story, 115,762 square-foot medical office building, and surface parking on approximately 24.5 acres located at 16200 Sand Canyon Avenue in the City of Irvine (see Attachment 1 – Existing Project Site).

The proposed conditional use permit modification seeks to increase the number of hospital beds from 166 to 391, and increase the hospital intensity from the originally approved 565,359 square feet up to approximately 1,123,293 square feet on the existing project site. At project build-out, the proposal would exceed the previous entitlement for the project site by up to approximately 557,934 square feet (see Attachment 2 – Proposed Project Site). Specifically, the proposed project would allow development to occur in two phases and consist of the following major components:

Phase 1:

- Addition of 356,740 square feet of hospital services with 161 beds to support the relocation of the pharmacy, clinical laboratory, intensive care unit, surgical suite, café, medical records, cashier, registration, worship center, gift shop and lobby;
- Addition of 130,000 square feet of hospital support facility;
- Addition of two, five-level parking structures (over 700 stalls in each structure);
- Addition of 47,550 square feet of new central utility plant along with cooling; and towers and emergency power generators at grade level.

Mr. Anthony Morales

July 30, 2020

Page 2 of 3

Phase 2:

- Addition of 8,000 square feet of auditorium and conference center;
- Addition of 260,000 square feet of hospital support facilities;
- Addition of 80,000 square feet of hospital services to support 64 additional in-patient beds; and
- Parking structure expansion to provide 486 additional parking stalls.

AB 52 requires lead agencies to consult with California Native American Tribes that request such consultation in writing prior to the agency's release of a Notice of Preparation (NOP) of an Environmental Impact Report (EIR), or notice of a Mitigated Negative Declaration (MND), or Negative Declaration (ND) on or after July 1, 2015. Pursuant to Public Resources Code section 21080.3.1, a list of California Native American Tribes was provided to the City of Irvine that are traditionally and culturally affiliated with geographic area of the proposed project. This letter is intended as formal notification of the proposed project pursuant to Assembly Bill (AB) 52.

Pursuant to the provisions of Assembly Bill (AB) 52, the City hereby extends an invitation to consult on the California Environmental Quality Act (CEQA) review of this proposed project in order to assist with identifying and/or preserving and/or mitigating project impacts to Native American cultural places including:

- Native American sanctified cemetery, place of worship, religious or ceremonial site, or sacred shrine; and
- Native American historic, cultural, or sacred site that is listed or may be eligible for listing in the California Register of Historical Resources including historic or prehistoric ruins and any burial ground, archaeological, or historic site.

If you desire to consult with the City on the CEQA review of this project, please respond in writing within thirty (30) days of the date of this letter by either letter and/or email. Please direct your email to hdesantos@cityofirvine.org or any correspondence on this matter to:

Hernan DeSantos
Senior Planner
City of Irvine – Community Development Department
P.O. Box 19575
Irvine, CA 92623

Should we not receive a response within thirty (30) days, we will presume that you have declined consultation. Please do not hesitate to let me know if you have any questions

Mr. Anthony Morales

July 30, 2020

Page 3 of 3

or would like to discuss this proposed project. I can be reached by email at hdesantos@cityofirvine.org.

Sincerely,

Hernan DeSantos

Hernan DeSantos

Senior Planner

Enclosures:

1. Existing Project Site
2. Proposed Project Site

ec: Pete Carmichael, Director of Community Development
Tim Gehrich, Deputy Director of Community Development
Bill Rodrigues, Principal Planner
Chad Beckstrom, ICF (Chad.Beckstrom@icf.com)
Tanya Jones, ICF (Tanya.Jones@icf.com)

Files: 00816357-PCPM

Enclosure 1 – Existing Project Site

Existing Campus

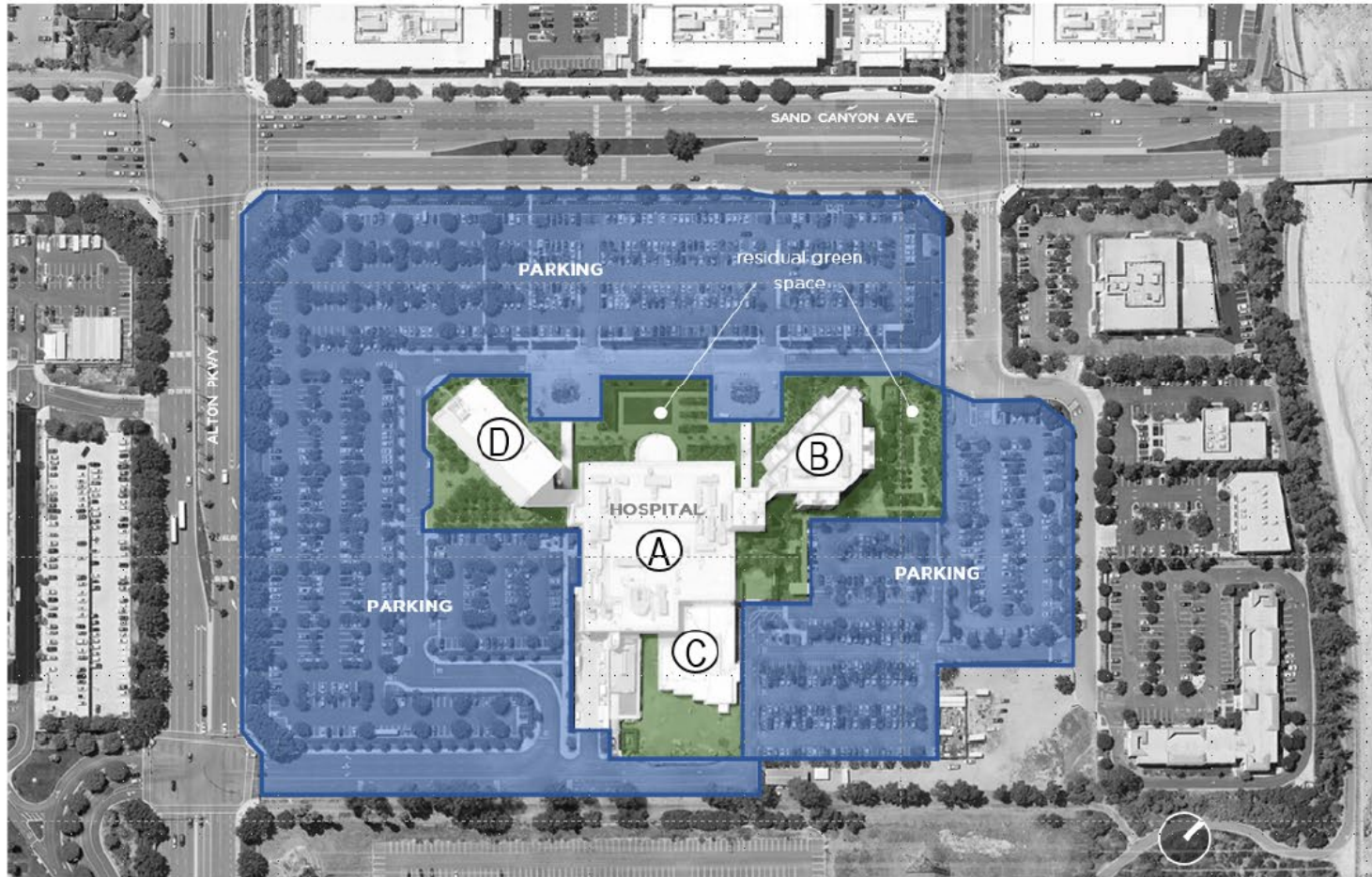

- A Ancillary Hospital Services
- B Nursing Tower
- C Emergency Department
- D Medical Office

Enclosure 2 – Proposed Project Site

Stage 2 / Campus Plan



Existing

- A. HHI/HOI
- B. Inpatient wing
- C. Emergency Department
- D. Rhodes Development MOB

Proposed

- 1. Women's Hospital
- 2. Women's Hospital Support Facility
- 3. Digestive Health Hospital
- 4. East Wing (ICU, Pharmacy, Lab)
- 5. East Parking Structure
- 6. Digestive Hospital Support Facility
- 7. Hospital Support Facility
- 8. Hospital Support Facility
- 9. Replacement Auditorium and Conf.
- 10. Central Utility Plan
- 11. West Wing Hospital
- 12. West Parking Structure
- 13. HHI Lobby (Café, Registration, Worship Center)
- 14. Interventional Platform



July 30, 2020

Original sent via Certified US Mail
Copy sent via email to:
roadkingcharles@aol.com

Mr. Charles Alvarez
Chairperson
Gabrielino-Tongva Tribe
23454 Vanowen Street
West Hills, CA 91307

Subject: Project Notification Pursuant to Assembly Bill (AB) 52 for the Hoag Hospital Irvine Expansion project (00816357-PCPM) in the City of Irvine, County of Orange, California (Assessor Parcel Number: 466-091-19)

Dear Mr. Alvarez:

The City of Irvine is the lead agency, pursuant to the California Environmental Quality Act (CEQA), for the conditional use permit modification (00816357-PCPM) request for Hoag Hospital Irvine (HHI). HHI is seeking a conditional use permit modification to expand their existing hospital campus. The existing campus was first approved in December 1983 for a maximum entitlement of 565,359 square feet of hospital with up to 500 hospital beds, support uses, and medical offices. The project site is currently comprised of a 249,794 square-foot hospital with 166 hospital beds, a 10-story, 115,762 square-foot medical office building, and surface parking on approximately 24.5 acres located at 16200 Sand Canyon Avenue in the City of Irvine (see Attachment 1 – Existing Project Site).

The proposed conditional use permit modification seeks to increase the number of hospital beds from 166 to 391, and increase the hospital intensity from the originally approved 565,359 square feet up to approximately 1,123,293 square feet on the existing project site. At project build-out, the proposal would exceed the previous entitlement for the project site by up to approximately 557,934 square feet (see Attachment 2 – Proposed Project Site). Specifically, the proposed project would allow development to occur in two phases and consist of the following major components:

Phase 1:

- Addition of 356,740 square feet of hospital services with 161 beds to support the relocation of the pharmacy, clinical laboratory, intensive care unit, surgical suite, café, medical records, cashier, registration, worship center, gift shop and lobby;
- Addition of 130,000 square feet of hospital support facility;
- Addition of two, five-level parking structures (over 700 stalls in each structure;

- Addition of 47,550 square feet of new central utility plant along with cooling; and towers and emergency power generators at grade level.

Phase 2:

- Addition of 8,000 square feet of auditorium and conference center;
- Addition of 260,000 square feet of hospital support facilities;
- Addition of 80,000 square feet of hospital services to support 64 additional in-patient beds; and
- Parking structure expansion to provide 486 additional parking stalls.

AB 52 requires lead agencies to consult with California Native American Tribes that request such consultation in writing prior to the agency's release of a Notice of Preparation (NOP) of an Environmental Impact Report (EIR), or notice of a Mitigated Negative Declaration (MND), or Negative Declaration (ND) on or after July 1, 2015. Pursuant to Public Resources Code section 21080.3.1, a list of California Native American Tribes was provided to the City of Irvine that are traditionally and culturally affiliated with geographic area of the proposed project. This letter is intended as formal notification of the proposed project pursuant to Assembly Bill (AB) 52.

Pursuant to the provisions of Assembly Bill (AB) 52, the City hereby extends an invitation to consult on the California Environmental Quality Act (CEQA) review of this proposed project in order to assist with identifying and/or preserving and/or mitigating project impacts to Native American cultural places including:

- Native American sanctified cemetery, place of worship, religious or ceremonial site, or sacred shrine; and
- Native American historic, cultural, or sacred site that is listed or may be eligible for listing in the California Register of Historical Resources including historic or prehistoric ruins and any burial ground, archaeological, or historic site.

If you desire to consult with the City on the CEQA review of this project, please respond in writing within thirty (30) days of the date of this letter by either letter and/or email. Please direct your email to hdesantos@cityofirvine.org or any correspondence on this matter to:

Hernan DeSantos
Senior Planner
City of Irvine – Community Development Department
P.O. Box 19575
Irvine, CA 92623

Should we not receive a response within thirty (30) days, we will presume that you have declined consultation. Please do not hesitate to let me know if you have any questions

Mr. Charles Alvarez
July 30, 2020
Page 3 of 3

or would like to discuss this proposed project. I can be reached by email at hdesantos@cityofirvine.org.

Sincerely,

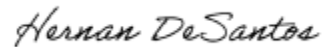

Hernan DeSantos
Senior Planner

Enclosures:

1. Existing Project Site
2. Proposed Project Site

ec: Pete Carmichael, Director of Community Development
Tim Gehrich, Deputy Director of Community Development
Bill Rodrigues, Principal Planner
Chad Beckstrom, ICF (Chad.Beckstrom@icf.com)
Tanya Jones, ICF (Tanya.Jones@icf.com)

Files: 00816357-PCPM

Enclosure 1 – Existing Project Site

Existing Campus

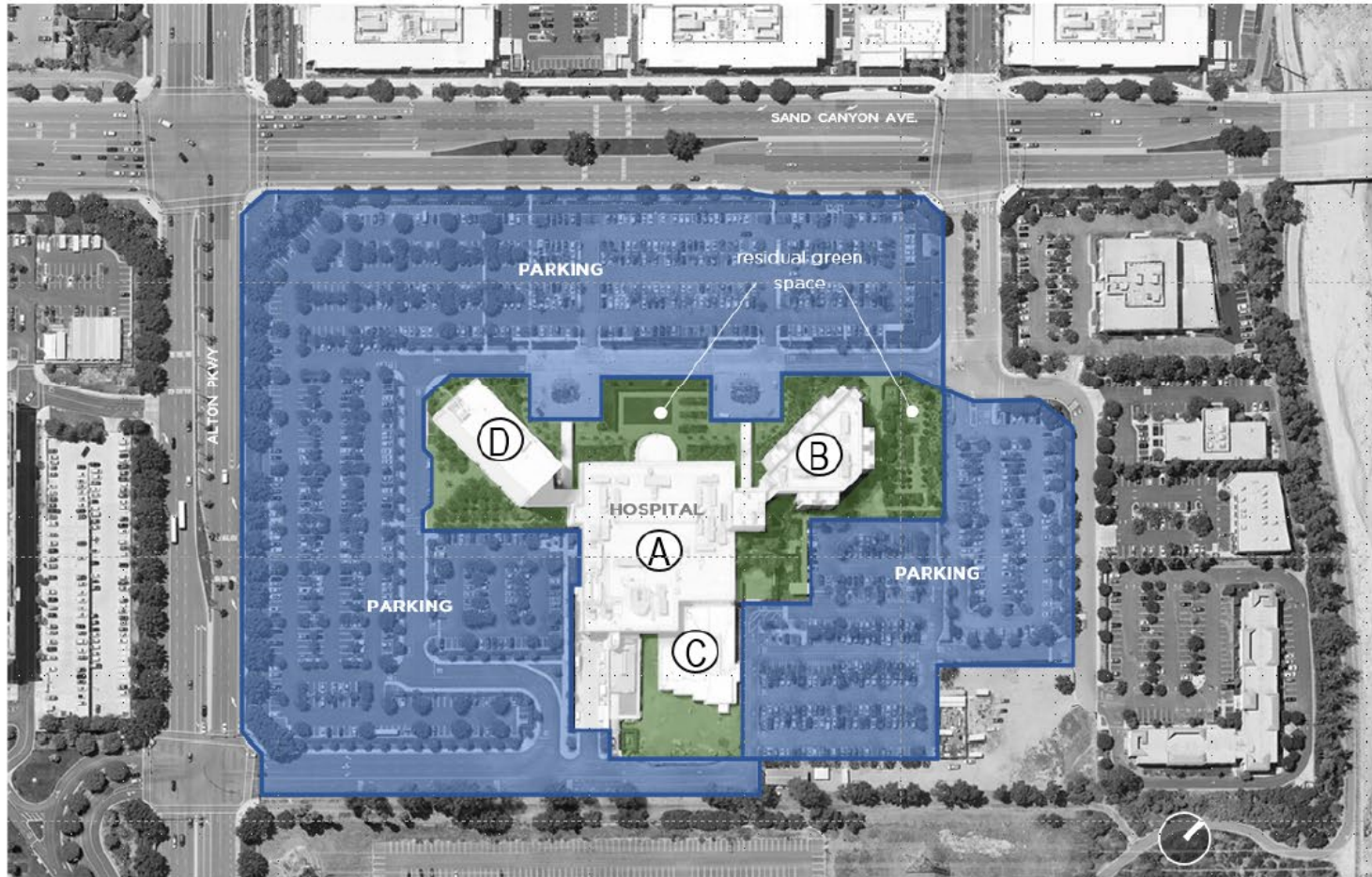

- A Ancillary Hospital Services
- B Nursing Tower
- C Emergency Department
- D Medical Office

Enclosure 2 – Proposed Project Site

Stage 2 / Campus Plan



Existing

- A. HHI/HOI
- B. Inpatient wing
- C. Emergency Department
- D. Rhodes Development MOB

Proposed

- 1. Women's Hospital
- 2. Women's Hospital Support Facility
- 3. Digestive Health Hospital
- 4. East Wing (ICU, Pharmacy, Lab)
- 5. East Parking Structure
- 6. Digestive Hospital Support Facility
- 7. Hospital Support Facility
- 8. Hospital Support Facility
- 9. Replacement Auditorium and Conf.
- 10. Central Utility Plan
- 11. West Wing Hospital
- 12. West Parking Structure
- 13. HHI Lobby (Café, Registration, Worship Center)
- 14. Interventional Platform



July 30, 2020

Original sent via Certified US Mail
Copy sent via email to:
kaamalam@gmail.com

Mr. Matias Belardes
Chairperson
Juaneno Band of Mission Indians Acjachemen Nation-Belardes
32161 Avenida Los Amigos
San Juan Capistrano, CA 92675

Subject: Project Notification Pursuant to Assembly Bill (AB) 52 for the Hoag Hospital Irvine Expansion project (00816357-PCPM) in the City of Irvine, County of Orange, California (Assessor Parcel Number: 466-091-19)

Dear Mr. Belardes:

The City of Irvine is the lead agency, pursuant to the California Environmental Quality Act (CEQA), for the conditional use permit modification (00816357-PCPM) request for Hoag Hospital Irvine (HHI). HHI is seeking a conditional use permit modification to expand their existing hospital campus. The existing campus was first approved in December 1983 for a maximum entitlement of 565,359 square feet of hospital with up to 500 hospital beds, support uses, and medical offices. The project site is currently comprised of a 249,794 square-foot hospital with 166 hospital beds, a 10-story, 115,762 square-foot medical office building, and surface parking on approximately 24.5 acres located at 16200 Sand Canyon Avenue in the City of Irvine (see Attachment 1 – Existing Project Site).

The proposed conditional use permit modification seeks to increase the number of hospital beds from 166 to 391, and increase the hospital intensity from the originally approved 565,359 square feet up to approximately 1,123,293 square feet on the existing project site. At project build-out, the proposal would exceed the previous entitlement for the project site by up to approximately 557,934 square feet (see Attachment 2 – Proposed Project Site). Specifically, the proposed project would allow development to occur in two phases and consist of the following major components:

Phase 1:

- Addition of 356,740 square feet of hospital services with 161 beds to support the relocation of the pharmacy, clinical laboratory, intensive care unit, surgical suite, café, medical records, cashier, registration, worship center, gift shop and lobby;
- Addition of 130,000 square feet of hospital support facility;
- Addition of two, five-level parking structures (over 700 stalls in each structure);
- Addition of 47,550 square feet of new central utility plant along with cooling; and towers and emergency power generators at grade level.

Mr. Matias Belardes

July 30, 2020

Page 2 of 3

Phase 2:

- Addition of 8,000 square feet of auditorium and conference center;
- Addition of 260,000 square feet of hospital support facilities;
- Addition of 80,000 square feet of hospital services to support 64 additional in-patient beds; and
- Parking structure expansion to provide 486 additional parking stalls.

AB 52 requires lead agencies to consult with California Native American Tribes that request such consultation in writing prior to the agency's release of a Notice of Preparation (NOP) of an Environmental Impact Report (EIR), or notice of a Mitigated Negative Declaration (MND), or Negative Declaration (ND) on or after July 1, 2015. Pursuant to Public Resources Code section 21080.3.1, a list of California Native American Tribes was provided to the City of Irvine that are traditionally and culturally affiliated with geographic area of the proposed project. This letter is intended as formal notification of the proposed project pursuant to Assembly Bill (AB) 52.

Pursuant to the provisions of Assembly Bill (AB) 52, the City hereby extends an invitation to consult on the California Environmental Quality Act (CEQA) review of this proposed project in order to assist with identifying and/or preserving and/or mitigating project impacts to Native American cultural places including:

- Native American sanctified cemetery, place of worship, religious or ceremonial site, or sacred shrine; and
- Native American historic, cultural, or sacred site that is listed or may be eligible for listing in the California Register of Historical Resources including historic or prehistoric ruins and any burial ground, archaeological, or historic site.

If you desire to consult with the City on the CEQA review of this project, please respond in writing within thirty (30) days of the date of this letter by either letter and/or email.

Please direct your email to hdesantos@cityofirvine.org or any correspondence on this matter to:

Hernan DeSantos
Senior Planner
City of Irvine – Community Development Department
P.O. Box 19575
Irvine, CA 92623

Should we not receive a response within thirty (30) days, we will presume that you have declined consultation. Please do not hesitate to let me know if you have any questions

Mr. Matias Belardes

July 30, 2020

Page 3 of 3

or would like to discuss this proposed project. I can be reached by email at hdesantos@cityofirvine.org.

Sincerely,

Hernan DeSantos

Hernan DeSantos

Senior Planner

Enclosures:

1. Existing Project Site
2. Proposed Project Site

ec: Pete Carmichael, Director of Community Development
Tim Gehrich, Deputy Director of Community Development
Bill Rodrigues, Principal Planner
Chad Beckstrom, ICF (Chad.Beckstrom@icf.com)
Tanya Jones, ICF (Tanya.Jones@icf.com)

Files: 00816357-PCPM

Enclosure 1 – Existing Project Site

Existing Campus



- A Ancillary Hospital Services
- B Nursing Tower
- C Emergency Department
- D Medical Office

Enclosure 2 – Proposed Project Site

Stage 2 / Campus Plan



Existing

- A. HHI/HOI
- B. Inpatient wing
- C. Emergency Department
- D. Rhodes Development MOB

Proposed

- 1. Women's Hospital
- 2. Women's Hospital Support Facility
- 3. Digestive Health Hospital
- 4. East Wing (ICU, Pharmacy, Lab)
- 5. East Parking Structure
- 6. Digestive Hospital Support Facility
- 7. Hospital Support Facility
- 8. Hospital Support Facility
- 9. Replacement Auditorium and Conf.
- 10. Central Utility Plan
- 11. West Wing Hospital
- 12. West Parking Structure
- 13. HHI Lobby (Café, Registration, Worship Center)
- 14. Interventional Platform



July 30, 2020

Original sent via Certified US Mail
Copy sent via email to:
LP13boots@aol.com

Ms. Gwendolyn Parada
Chairperson
La Posta Band of Diegueno Mission Indians
8 Crestwood Road
Boulevard, CA 91905

Subject: Project Notification Pursuant to Assembly Bill (AB) 52 for the Hoag Hospital Irvine Expansion project (00816357-PCPM) in the City of Irvine, County of Orange, California (Assessor Parcel Number: 466-091-19)

Dear Ms. Parada:

The City of Irvine is the lead agency, pursuant to the California Environmental Quality Act (CEQA), for the conditional use permit modification (00816357-PCPM) request for Hoag Hospital Irvine (HHI). HHI is seeking a conditional use permit modification to expand their existing hospital campus. The existing campus was first approved in December 1983 for a maximum entitlement of 565,359 square feet of hospital with up to 500 hospital beds, support uses, and medical offices. The project site is currently comprised of a 249,794 square-foot hospital with 166 hospital beds, a 10-story, 115,762 square-foot medical office building, and surface parking on approximately 24.5 acres located at 16200 Sand Canyon Avenue in the City of Irvine (see Attachment 1 – Existing Project Site).

The proposed conditional use permit modification seeks to increase the number of hospital beds from 166 to 391, and increase the hospital intensity from the originally approved 565,359 square feet up to approximately 1,123,293 square feet on the existing project site. At project build-out, the proposal would exceed the previous entitlement for the project site by up to approximately 557,934 square feet (see Attachment 2 – Proposed Project Site). Specifically, the proposed project would allow development to occur in two phases and consist of the following major components:

Phase 1:

- Addition of 356,740 square feet of hospital services with 161 beds to support the relocation of the pharmacy, clinical laboratory, intensive care unit, surgical suite, café, medical records, cashier, registration, worship center, gift shop and lobby;
- Addition of 130,000 square feet of hospital support facility;
- Addition of two, five-level parking structures (over 700 stalls in each structure;

Ms. Gwendolyn Parada

July 30, 2020

Page 2 of 3

- Addition of 47,550 square feet of new central utility plant along with cooling; and towers and emergency power generators at grade level.

Phase 2:

- Addition of 8,000 square feet of auditorium and conference center;
- Addition of 260,000 square feet of hospital support facilities;
- Addition of 80,000 square feet of hospital services to support 64 additional in-patient beds; and
- Parking structure expansion to provide 486 additional parking stalls.

AB 52 requires lead agencies to consult with California Native American Tribes that request such consultation in writing prior to the agency's release of a Notice of Preparation (NOP) of an Environmental Impact Report (EIR), or notice of a Mitigated Negative Declaration (MND), or Negative Declaration (ND) on or after July 1, 2015. Pursuant to Public Resources Code section 21080.3.1, a list of California Native American Tribes was provided to the City of Irvine that are traditionally and culturally affiliated with geographic area of the proposed project. This letter is intended as formal notification of the proposed project pursuant to Assembly Bill (AB) 52.

Pursuant to the provisions of Assembly Bill (AB) 52, the City hereby extends an invitation to consult on the California Environmental Quality Act (CEQA) review of this proposed project in order to assist with identifying and/or preserving and/or mitigating project impacts to Native American cultural places including:

- Native American sanctified cemetery, place of worship, religious or ceremonial site, or sacred shrine; and
- Native American historic, cultural, or sacred site that is listed or may be eligible for listing in the California Register of Historical Resources including historic or prehistoric ruins and any burial ground, archaeological, or historic site.

If you desire to consult with the City on the CEQA review of this project, please respond in writing within thirty (30) days of the date of this letter by either letter and/or email. Please direct your email to hdesantos@cityofirvine.org or any correspondence on this matter to:

Hernan DeSantos
Senior Planner
City of Irvine – Community Development Department
P.O. Box 19575
Irvine, CA 92623

Should we not receive a response within thirty (30) days, we will presume that you have declined consultation. Please do not hesitate to let me know if you have any questions

Ms. Gwendolyn Parada

July 30, 2020

Page 3 of 3

or would like to discuss this proposed project. I can be reached by email at hdesantos@cityofirvine.org.

Sincerely,

Hernan DeSantos

Hernan DeSantos

Senior Planner

Enclosures:

1. Existing Project Site
2. Proposed Project Site

ec: Pete Carmichael, Director of Community Development
Tim Gehrich, Deputy Director of Community Development
Bill Rodrigues, Principal Planner
Chad Beckstrom, ICF (Chad.Beckstrom@icf.com)
Tanya Jones, ICF (Tanya.Jones@icf.com)

Files: 00816357-PCPM

Enclosure 1 – Existing Project Site

Existing Campus

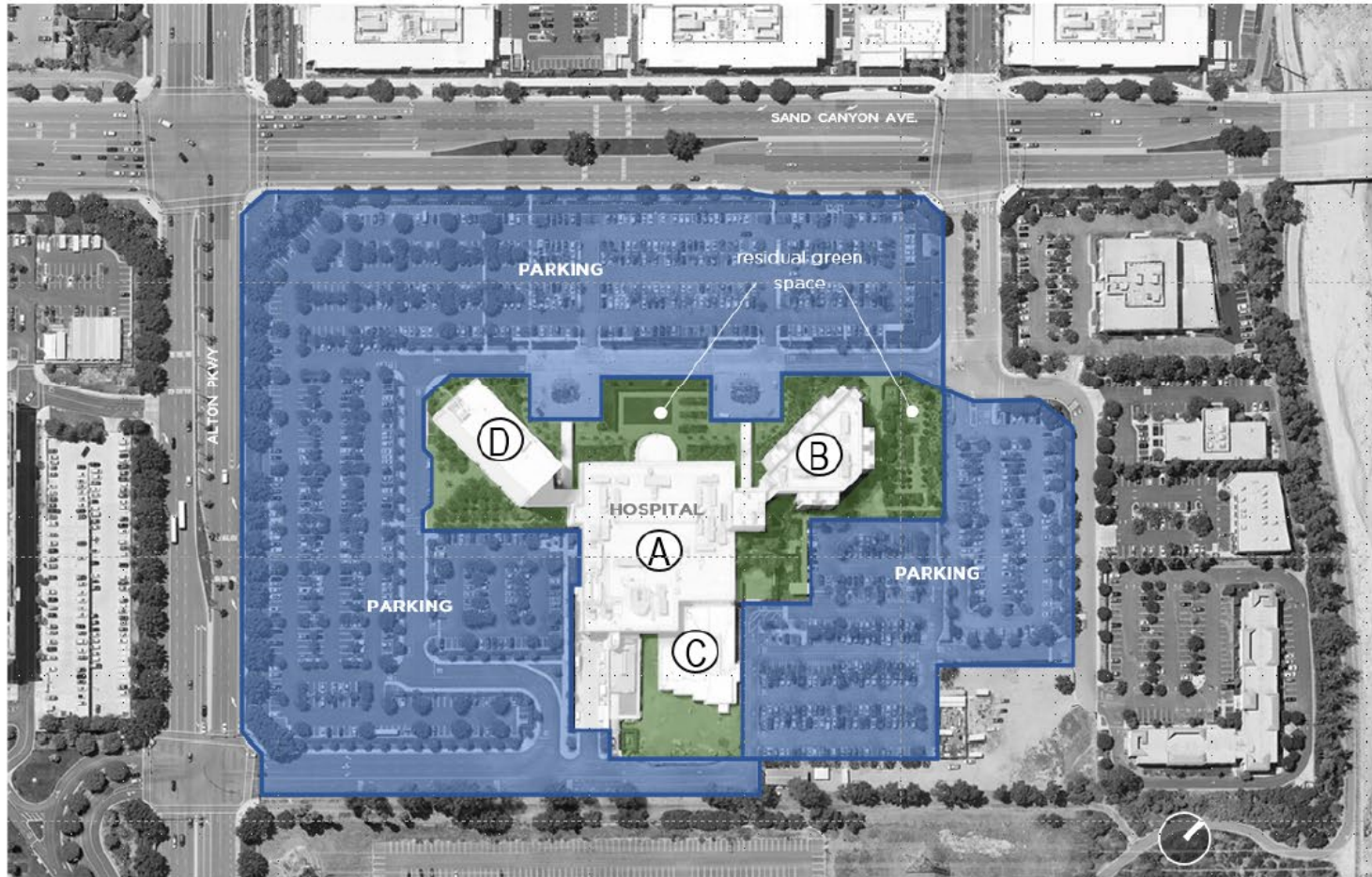

- A Ancillary Hospital Services
- B Nursing Tower
- C Emergency Department
- D Medical Office

Enclosure 2 – Proposed Project Site

Stage 2 / Campus Plan



Existing

- A. HHI/HOI
- B. Inpatient wing
- C. Emergency Department
- D. Rhodes Development MOB

Proposed

- 1. Women's Hospital
- 2. Women's Hospital Support Facility
- 3. Digestive Health Hospital
- 4. East Wing (ICU, Pharmacy, Lab)
- 5. East Parking Structure
- 6. Digestive Hospital Support Facility
- 7. Hospital Support Facility
- 8. Hospital Support Facility
- 9. Replacement Auditorium and Conf.
- 10. Central Utility Plan
- 11. West Wing Hospital
- 12. West Parking Structure
- 13. HHI Lobby (Café, Registration, Worship Center)
- 14. Interventional Platform



July 30, 2020

Original sent via Certified US Mail
Copy sent via email to:
jmiller@LPtribe.net

Mr. Javaughn Miller
Tribal Administrator
La Posta Band of Diegueno Mission Indians
8 Crestwood Road
Boulevard, CA 91905

Subject: Project Notification Pursuant to Assembly Bill (AB) 52 for the Hoag Hospital Irvine Expansion project (00816357-PCPM) in the City of Irvine, County of Orange, California (Assessor Parcel Number: 466-091-19)

Dear Mr. Miller:

The City of Irvine is the lead agency, pursuant to the California Environmental Quality Act (CEQA), for the conditional use permit modification (00816357-PCPM) request for Hoag Hospital Irvine (HHI). HHI is seeking a conditional use permit modification to expand their existing hospital campus. The existing campus was first approved in December 1983 for a maximum entitlement of 565,359 square feet of hospital with up to 500 hospital beds, support uses, and medical offices. The project site is currently comprised of a 249,794 square-foot hospital with 166 hospital beds, a 10-story, 115,762 square-foot medical office building, and surface parking on approximately 24.5 acres located at 16200 Sand Canyon Avenue in the City of Irvine (see Attachment 1 – Existing Project Site).

The proposed conditional use permit modification seeks to increase the number of hospital beds from 166 to 391, and increase the hospital intensity from the originally approved 565,359 square feet up to approximately 1,123,293 square feet on the existing project site. At project build-out, the proposal would exceed the previous entitlement for the project site by up to approximately 557,934 square feet (see Attachment 2 – Proposed Project Site). Specifically, the proposed project would allow development to occur in two phases and consist of the following major components:

Phase 1:

- Addition of 356,740 square feet of hospital services with 161 beds to support the relocation of the pharmacy, clinical laboratory, intensive care unit, surgical suite, café, medical records, cashier, registration, worship center, gift shop and lobby;
- Addition of 130,000 square feet of hospital support facility;
- Addition of two, five-level parking structures (over 700 stalls in each structure);
- Addition of 47,550 square feet of new central utility plant along with cooling; and towers and emergency power generators at grade level.

Phase 2:

- Addition of 8,000 square feet of auditorium and conference center;
- Addition of 260,000 square feet of hospital support facilities;
- Addition of 80,000 square feet of hospital services to support 64 additional in-patient beds; and
- Parking structure expansion to provide 486 additional parking stalls.

AB 52 requires lead agencies to consult with California Native American Tribes that request such consultation in writing prior to the agency's release of a Notice of Preparation (NOP) of an Environmental Impact Report (EIR), or notice of a Mitigated Negative Declaration (MND), or Negative Declaration (ND) on or after July 1, 2015. Pursuant to Public Resources Code section 21080.3.1, a list of California Native American Tribes was provided to the City of Irvine that are traditionally and culturally affiliated with geographic area of the proposed project. This letter is intended as formal notification of the proposed project pursuant to Assembly Bill (AB) 52.

Pursuant to the provisions of Assembly Bill (AB) 52, the City hereby extends an invitation to consult on the California Environmental Quality Act (CEQA) review of this proposed project in order to assist with identifying and/or preserving and/or mitigating project impacts to Native American cultural places including:

- Native American sanctified cemetery, place of worship, religious or ceremonial site, or sacred shrine; and
- Native American historic, cultural, or sacred site that is listed or may be eligible for listing in the California Register of Historical Resources including historic or prehistoric ruins and any burial ground, archaeological, or historic site.

If you desire to consult with the City on the CEQA review of this project, please respond in writing within thirty (30) days of the date of this letter by either letter and/or email. Please direct your email to hdesantos@cityofirvine.org or any correspondence on this matter to:

Hernan DeSantos
Senior Planner
City of Irvine – Community Development Department
P.O. Box 19575
Irvine, CA 92623

Should we not receive a response within thirty (30) days, we will presume that you have declined consultation. Please do not hesitate to let me know if you have any questions

Mr. Javaughn Miller
July 30, 2020
Page 3 of 3

or would like to discuss this proposed project. I can be reached by email at hdesantos@cityofirvine.org.

Sincerely,

Hernan DeSantos

Hernan DeSantos
Senior Planner

Enclosures:

1. Existing Project Site
2. Proposed Project Site

ec: Pete Carmichael, Director of Community Development
Tim Gehrich, Deputy Director of Community Development
Bill Rodrigues, Principal Planner
Chad Beckstrom, ICF (Chad.Beckstrom@icf.com)
Tanya Jones, ICF (Tanya.Jones@icf.com)

Files: 00816357-PCPM

Enclosure 1 – Existing Project Site

Existing Campus

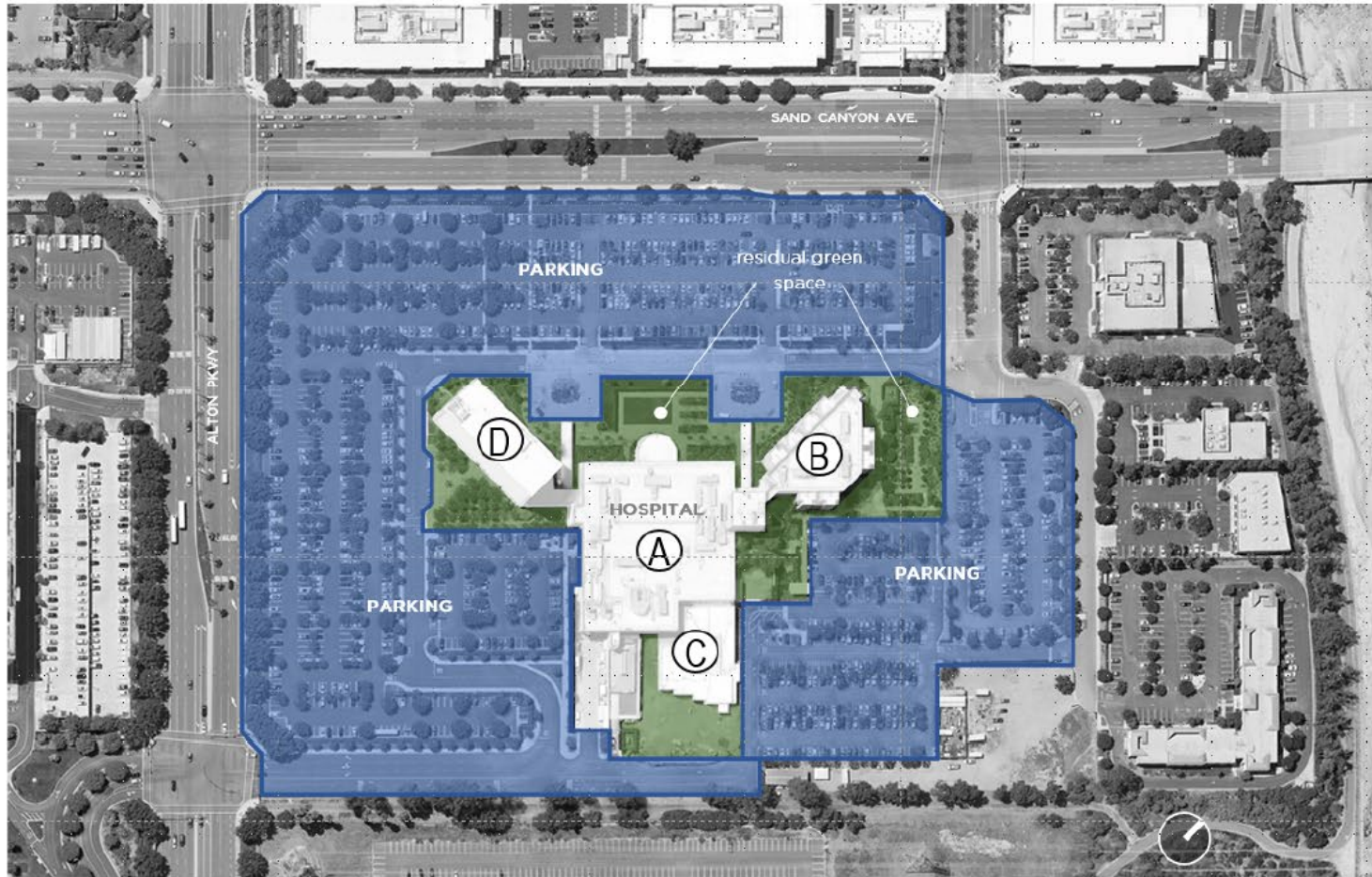

- A Ancillary Hospital Services
- B Nursing Tower
- C Emergency Department
- D Medical Office

Enclosure 2 – Proposed Project Site

Stage 2 / Campus Plan



- Existing**
- A. HHI/HOI
 - B. Inpatient wing
 - C. Emergency Department
 - D. Rhodes Development MOB
-
- Proposed**
- 1. Women's Hospital
 - 2. Women's Hospital Support Facility
 - 3. Digestive Health Hospital
 - 4. East Wing (ICU, Pharmacy, Lab)
 - 5. East Parking Structure
 - 6. Digestive Hospital Support Facility
 - 7. Hospital Support Facility
 - 8. Hospital Support Facility
 - 9. Replacement Auditorium and Conf.
 - 10. Central Utility Plan
 - 11. West Wing Hospital
 - 12. West Parking Structure
 - 13. HHI Lobby (Café, Registration, Worship Center)
 - 14. Interventional Platform



July 30, 2020

Original sent via Certified US Mail

Ms. Angela Elliott Santos
Chairperson
P.O. Box 1302
Boulevard, CA, 91905

Subject: Project Notification Pursuant to Assembly Bill (AB) 52 for the Hoag Hospital Irvine Expansion project (00816357-PCPM) in the City of Irvine, County of Orange, California (Assessor Parcel Number: 466-091-19)

Dear Ms. Santos:

The City of Irvine is the lead agency, pursuant to the California Environmental Quality Act (CEQA), for the conditional use permit modification (00816357-PCPM) request for Hoag Hospital Irvine (HHI). HHI is seeking a conditional use permit modification to expand their existing hospital campus. The existing campus was first approved in December 1983 for a maximum entitlement of 565,359 square feet of hospital with up to 500 hospital beds, support uses, and medical offices. The project site is currently comprised of a 249,794 square-foot hospital with 166 hospital beds, a 10-story, 115,762 square-foot medical office building, and surface parking on approximately 24.5 acres located at 16200 Sand Canyon Avenue in the City of Irvine (see Attachment 1 – Existing Project Site).

The proposed conditional use permit modification seeks to increase the number of hospital beds from 166 to 391, and increase the hospital intensity from the originally approved 565,359 square feet up to approximately 1,123,293 square feet on the existing project site. At project build-out, the proposal would exceed the previous entitlement for the project site by up to approximately 557,934 square feet (see Attachment 2 – Proposed Project Site). Specifically, the proposed project would allow development to occur in two phases and consist of the following major components:

Phase 1:

- Addition of 356,740 square feet of hospital services with 161 beds to support the relocation of the pharmacy, clinical laboratory, intensive care unit, surgical suite, café, medical records, cashier, registration, worship center, gift shop and lobby;
- Addition of 130,000 square feet of hospital support facility;
- Addition of two, five-level parking structures (over 700 stalls in each structure);
- Addition of 47,550 square feet of new central utility plant along with cooling; and towers and emergency power generators at grade level.

Phase 2:

- Addition of 8,000 square feet of auditorium and conference center;
- Addition of 260,000 square feet of hospital support facilities;
- Addition of 80,000 square feet of hospital services to support 64 additional in-patient beds; and
- Parking structure expansion to provide 486 additional parking stalls.

AB 52 requires lead agencies to consult with California Native American Tribes that request such consultation in writing prior to the agency's release of a Notice of Preparation (NOP) of an Environmental Impact Report (EIR), or notice of a Mitigated Negative Declaration (MND), or Negative Declaration (ND) on or after July 1, 2015. Pursuant to Public Resources Code section 21080.3.1, a list of California Native American Tribes was provided to the City of Irvine that are traditionally and culturally affiliated with geographic area of the proposed project. This letter is intended as formal notification of the proposed project pursuant to Assembly Bill (AB) 52.

Pursuant to the provisions of Assembly Bill (AB) 52, the City hereby extends an invitation to consult on the California Environmental Quality Act (CEQA) review of this proposed project in order to assist with identifying and/or preserving and/or mitigating project impacts to Native American cultural places including:

- Native American sanctified cemetery, place of worship, religious or ceremonial site, or sacred shrine; and
- Native American historic, cultural, or sacred site that is listed or may be eligible for listing in the California Register of Historical Resources including historic or prehistoric ruins and any burial ground, archaeological, or historic site.

If you desire to consult with the City on the CEQA review of this project, please respond in writing within thirty (30) days of the date of this letter by either letter and/or email. Please direct your email to hdesantos@cityofirvine.org or any correspondence on this matter to:

Hernan DeSantos
Senior Planner
City of Irvine – Community Development Department
P.O. Box 19575
Irvine, CA 92623

Should we not receive a response within thirty (30) days, we will presume that you have declined consultation. Please do not hesitate to let me know if you have any questions

Ms. Santos
July 30, 2020
Page 3 of 3

or would like to discuss this proposed project. I can be reached by email at hdesantos@cityofirvine.org.

Sincerely,

Hernan DeSantos

Hernan DeSantos
Senior Planner

Enclosures:

1. Existing Project Site
2. Proposed Project Site

ec: Pete Carmichael, Director of Community Development
Tim Gehrich, Deputy Director of Community Development
Bill Rodrigues, Principal Planner
Chad Beckstrom, ICF (Chad.Beckstrom@icf.com)
Tanya Jones, ICF (Tanya.Jones@icf.com)

Files: 00816357-PCPM



July 30, 2020

Original sent via Certified US Mail
Copy sent via email to:
mesagrandeband@msn.com

Mr. Michael Linton
Chairperson
Mesa Grande Band of Diegueno Mission Indians
P.O. Box 270
Santa Ysabel, CA 91905

Subject: Project Notification Pursuant to Assembly Bill (AB) 52 for the Hoag Hospital Irvine Expansion project (00816357-PCPM) in the City of Irvine, County of Orange, California (Assessor Parcel Number: 466-091-19)

Dear Mr. Linton:

The City of Irvine is the lead agency, pursuant to the California Environmental Quality Act (CEQA), for the conditional use permit modification (00816357-PCPM) request for Hoag Hospital Irvine (HHI). HHI is seeking a conditional use permit modification to expand their existing hospital campus. The existing campus was first approved in December 1983 for a maximum entitlement of 565,359 square feet of hospital with up to 500 hospital beds, support uses, and medical offices. The project site is currently comprised of a 249,794 square-foot hospital with 166 hospital beds, a 10-story, 115,762 square-foot medical office building, and surface parking on approximately 24.5 acres located at 16200 Sand Canyon Avenue in the City of Irvine (see Attachment 1 – Existing Project Site).

The proposed conditional use permit modification seeks to increase the number of hospital beds from 166 to 391, and increase the hospital intensity from the originally approved 565,359 square feet up to approximately 1,123,293 square feet on the existing project site. At project build-out, the proposal would exceed the previous entitlement for the project site by up to approximately 557,934 square feet (see Attachment 2 – Proposed Project Site). Specifically, the proposed project would allow development to occur in two phases and consist of the following major components:

Phase 1:

- Addition of 356,740 square feet of hospital services with 161 beds to support the relocation of the pharmacy, clinical laboratory, intensive care unit, surgical suite, café, medical records, cashier, registration, worship center, gift shop and lobby;
- Addition of 130,000 square feet of hospital support facility;
- Addition of two, five-level parking structures (over 700 stalls in each structure);
- Addition of 47,550 square feet of new central utility plant along with cooling; and towers and emergency power generators at grade level.

Phase 2:

- Addition of 8,000 square feet of auditorium and conference center;
- Addition of 260,000 square feet of hospital support facilities;
- Addition of 80,000 square feet of hospital services to support 64 additional in-patient beds; and
- Parking structure expansion to provide 486 additional parking stalls.

AB 52 requires lead agencies to consult with California Native American Tribes that request such consultation in writing prior to the agency's release of a Notice of Preparation (NOP) of an Environmental Impact Report (EIR), or notice of a Mitigated Negative Declaration (MND), or Negative Declaration (ND) on or after July 1, 2015. Pursuant to Public Resources Code section 21080.3.1, a list of California Native American Tribes was provided to the City of Irvine that are traditionally and culturally affiliated with geographic area of the proposed project. This letter is intended as formal notification of the proposed project pursuant to Assembly Bill (AB) 52.

Pursuant to the provisions of Assembly Bill (AB) 52, the City hereby extends an invitation to consult on the California Environmental Quality Act (CEQA) review of this proposed project in order to assist with identifying and/or preserving and/or mitigating project impacts to Native American cultural places including:

- Native American sanctified cemetery, place of worship, religious or ceremonial site, or sacred shrine; and
- Native American historic, cultural, or sacred site that is listed or may be eligible for listing in the California Register of Historical Resources including historic or prehistoric ruins and any burial ground, archaeological, or historic site.

If you desire to consult with the City on the CEQA review of this project, please respond in writing within thirty (30) days of the date of this letter by either letter and/or email. Please direct your email to hdesantos@cityofirvine.org or any correspondence on this matter to:

Hernan DeSantos
Senior Planner
City of Irvine – Community Development Department
P.O. Box 19575
Irvine, CA 92623

Should we not receive a response within thirty (30) days, we will presume that you have declined consultation. Please do not hesitate to let me know if you have any questions

Mr. Michael Linton
July 30, 2020
Page 3 of 3

or would like to discuss this proposed project. I can be reached by email at hdesantos@cityofirvine.org.

Sincerely,

Hernan DeSantos

Hernan DeSantos
Senior Planner

Enclosures:

1. Existing Project Site
2. Proposed Project Site

ec: Pete Carmichael, Director of Community Development
Tim Gehrich, Deputy Director of Community Development
Bill Rodrigues, Principal Planner
Chad Beckstrom, ICF (Chad.Beckstrom@icf.com)
Tanya Jones, ICF (Tanya.Jones@icf.com)

Files: 00816357-PCPM

Enclosure 1 – Existing Project Site

Existing Campus

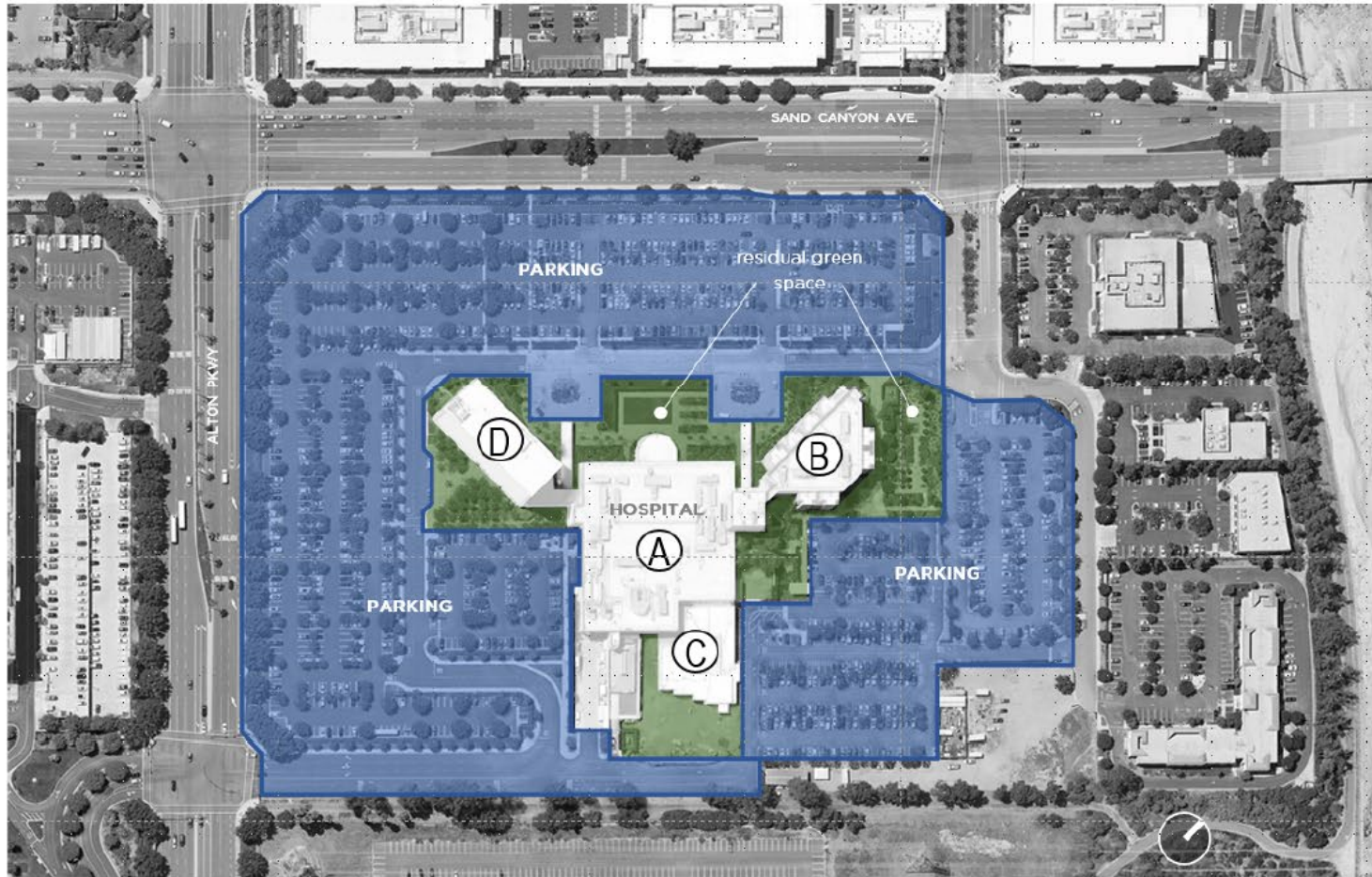

- A Ancillary Hospital Services
- B Nursing Tower
- C Emergency Department
- D Medical Office

Enclosure 2 – Proposed Project Site

Stage 2 / Campus Plan



Existing

- A. HHI/HOI
- B. Inpatient wing
- C. Emergency Department
- D. Rhodes Development MOB

Proposed

- 1. Women's Hospital
- 2. Women's Hospital Support Facility
- 3. Digestive Health Hospital
- 4. East Wing (ICU, Pharmacy, Lab)
- 5. East Parking Structure
- 6. Digestive Hospital Support Facility
- 7. Hospital Support Facility
- 8. Hospital Support Facility
- 9. Replacement Auditorium and Conf.
- 10. Central Utility Plan
- 11. West Wing Hospital
- 12. West Parking Structure
- 13. HHI Lobby (Café, Registration, Worship Center)
- 14. Interventional Platform



July 30, 2020

Original sent via Certified US Mail
Copy sent via email to:
sgaughen@palatribe.com

Shasta Gaughen
Tribal Historic Preservation Officer
Pala Band of Mission Indians
PMB 50
35008 Pala Temecula Road
Pala, CA 92059

Subject: Project Notification Pursuant to Assembly Bill (AB) 52 for the Hoag Hospital Irvine Expansion project (00816357-PCPM) in the City of Irvine, County of Orange, California (Assessor Parcel Number: 466-091-19)

Dear Shasta:

The City of Irvine is the lead agency, pursuant to the California Environmental Quality Act (CEQA), for the conditional use permit modification (00816357-PCPM) request for Hoag Hospital Irvine (HHI). HHI is seeking a conditional use permit modification to expand their existing hospital campus. The existing campus was first approved in December 1983 for a maximum entitlement of 565,359 square feet of hospital with up to 500 hospital beds, support uses, and medical offices. The project site is currently comprised of a 249,794 square-foot hospital with 166 hospital beds, a 10-story, 115,762 square-foot medical office building, and surface parking on approximately 24.5 acres located at 16200 Sand Canyon Avenue in the City of Irvine (see Attachment 1 – Existing Project Site).

The proposed conditional use permit modification seeks to increase the number of hospital beds from 166 to 391, and increase the hospital intensity from the originally approved 565,359 square feet up to approximately 1,123,293 square feet on the existing project site. At project build-out, the proposal would exceed the previous entitlement for the project site by up to approximately 557,934 square feet (see Attachment 2 – Proposed Project Site). Specifically, the proposed project would allow development to occur in two phases and consist of the following major components:

Phase 1:

- Addition of 356,740 square feet of hospital services with 161 beds to support the relocation of the pharmacy, clinical laboratory, intensive care unit, surgical suite, café, medical records, cashier, registration, worship center, gift shop and lobby;
- Addition of 130,000 square feet of hospital support facility;
- Addition of two, five-level parking structures (over 700 stalls in each structure;

- Addition of 47,550 square feet of new central utility plant along with cooling; and towers and emergency power generators at grade level.

Phase 2:

- Addition of 8,000 square feet of auditorium and conference center;
- Addition of 260,000 square feet of hospital support facilities;
- Addition of 80,000 square feet of hospital services to support 64 additional in-patient beds; and
- Parking structure expansion to provide 486 additional parking stalls.

AB 52 requires lead agencies to consult with California Native American Tribes that request such consultation in writing prior to the agency's release of a Notice of Preparation (NOP) of an Environmental Impact Report (EIR), or notice of a Mitigated Negative Declaration (MND), or Negative Declaration (ND) on or after July 1, 2015. Pursuant to Public Resources Code section 21080.3.1, a list of California Native American Tribes was provided to the City of Irvine that are traditionally and culturally affiliated with geographic area of the proposed project. This letter is intended as formal notification of the proposed project pursuant to Assembly Bill (AB) 52.

Pursuant to the provisions of Assembly Bill (AB) 52, the City hereby extends an invitation to consult on the California Environmental Quality Act (CEQA) review of this proposed project in order to assist with identifying and/or preserving and/or mitigating project impacts to Native American cultural places including:

- Native American sanctified cemetery, place of worship, religious or ceremonial site, or sacred shrine; and
- Native American historic, cultural, or sacred site that is listed or may be eligible for listing in the California Register of Historical Resources including historic or prehistoric ruins and any burial ground, archaeological, or historic site.

If you desire to consult with the City on the CEQA review of this project, please respond in writing within thirty (30) days of the date of this letter by either letter and/or email. Please direct your email to hdesantos@cityofirvine.org or any correspondence on this matter to:

Hernan DeSantos
Senior Planner
City of Irvine – Community Development Department
P.O. Box 19575
Irvine, CA 92623

Should we not receive a response within thirty (30) days, we will presume that you have declined consultation. Please do not hesitate to let me know if you have any questions

Shasta Gaughen
July 30, 2020
Page 3 of 3

or would like to discuss this proposed project. I can be reached by email at hdesantos@cityofirvine.org.

Sincerely,

Hernan DeSantos

Hernan DeSantos
Senior Planner

Enclosures:

1. Existing Project Site
2. Proposed Project Site

ec: Pete Carmichael, Director of Community Development
Tim Gehrich, Deputy Director of Community Development
Bill Rodrigues, Principal Planner
Chad Beckstrom, ICF (Chad.Beckstrom@icf.com)
Tanya Jones, ICF (Tanya.Jones@icf.com)

Files: 00816357-PCPM

Enclosure 1 – Existing Project Site

Existing Campus

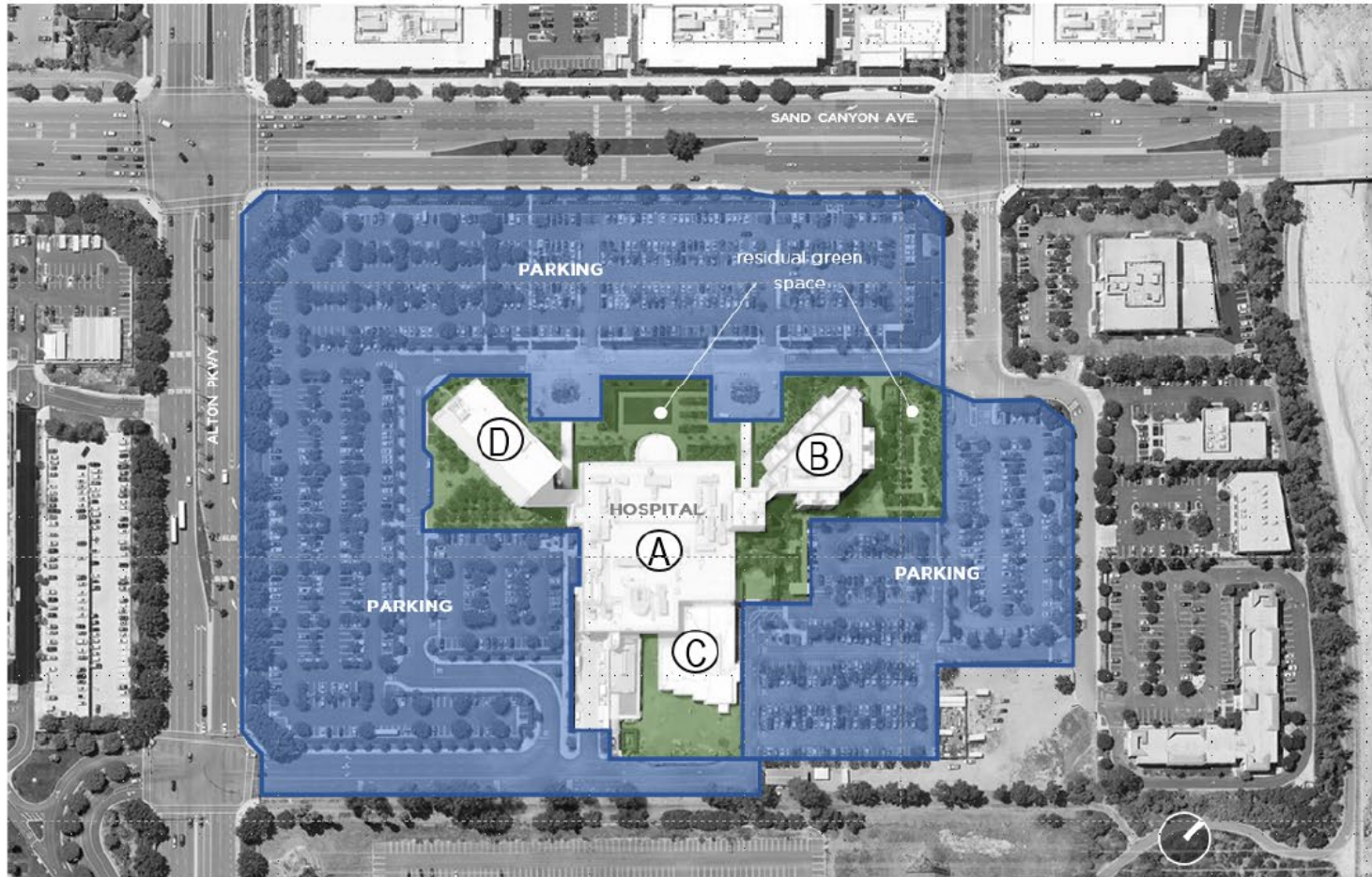

- A Ancillary Hospital Services
- B Nursing Tower
- C Emergency Department
- D Medical Office

Enclosure 2 – Proposed Project Site

Stage 2 / Campus Plan



Existing

- A. HHI/HOI
- B. Inpatient wing
- C. Emergency Department
- D. Rhodes Development MOB

Proposed

- 1. Women's Hospital
- 2. Women's Hospital Support Facility
- 3. Digestive Health Hospital
- 4. East Wing (ICU, Pharmacy, Lab)
- 5. East Parking Structure
- 6. Digestive Hospital Support Facility
- 7. Hospital Support Facility
- 8. Hospital Support Facility
- 9. Replacement Auditorium and Conf.
- 10. Central Utility Plan
- 11. West Wing Hospital
- 12. West Parking Structure
- 13. HHI Lobby (Café, Registration, Worship Center)
- 14. Interventional Platform



July 30, 2020

Original sent via Certified US Mail
Copy sent via email to:
jontiveros@soboba-nsn.gov

Mr. Scott Cozart
Chairperson
Soboba Band of Luiseno Indians
P.O. Box 487
San Jacinto, CA 92583

Subject: Project Notification Pursuant to Assembly Bill (AB) 52 for the Hoag Hospital Irvine Expansion project (00816357-PCPM) in the City of Irvine, County of Orange, California (Assessor Parcel Number: 466-091-19)

Dear Mr. Cozart:

The City of Irvine is the lead agency, pursuant to the California Environmental Quality Act (CEQA), for the conditional use permit modification (00816357-PCPM) request for Hoag Hospital Irvine (HHI). HHI is seeking a conditional use permit modification to expand their existing hospital campus. The existing campus was first approved in December 1983 for a maximum entitlement of 565,359 square feet of hospital with up to 500 hospital beds, support uses, and medical offices. The project site is currently comprised of a 249,794 square-foot hospital with 166 hospital beds, a 10-story, 115,762 square-foot medical office building, and surface parking on approximately 24.5 acres located at 16200 Sand Canyon Avenue in the City of Irvine (see Attachment 1 – Existing Project Site).

The proposed conditional use permit modification seeks to increase the number of hospital beds from 166 to 391, and increase the hospital intensity from the originally approved 565,359 square feet up to approximately 1,123,293 square feet on the existing project site. At project build-out, the proposal would exceed the previous entitlement for the project site by up to approximately 557,934 square feet (see Attachment 2 – Proposed Project Site). Specifically, the proposed project would allow development to occur in two phases and consist of the following major components:

Phase 1:

- Addition of 356,740 square feet of hospital services with 161 beds to support the relocation of the pharmacy, clinical laboratory, intensive care unit, surgical suite, café, medical records, cashier, registration, worship center, gift shop and lobby;
- Addition of 130,000 square feet of hospital support facility;
- Addition of two, five-level parking structures (over 700 stalls in each structure);
- Addition of 47,550 square feet of new central utility plant along with cooling; and towers and emergency power generators at grade level.

Phase 2:

- Addition of 8,000 square feet of auditorium and conference center;
- Addition of 260,000 square feet of hospital support facilities;
- Addition of 80,000 square feet of hospital services to support 64 additional in-patient beds; and
- Parking structure expansion to provide 486 additional parking stalls.

AB 52 requires lead agencies to consult with California Native American Tribes that request such consultation in writing prior to the agency's release of a Notice of Preparation (NOP) of an Environmental Impact Report (EIR), or notice of a Mitigated Negative Declaration (MND), or Negative Declaration (ND) on or after July 1, 2015. Pursuant to Public Resources Code section 21080.3.1, a list of California Native American Tribes was provided to the City of Irvine that are traditionally and culturally affiliated with geographic area of the proposed project. This letter is intended as formal notification of the proposed project pursuant to Assembly Bill (AB) 52.

Pursuant to the provisions of Assembly Bill (AB) 52, the City hereby extends an invitation to consult on the California Environmental Quality Act (CEQA) review of this proposed project in order to assist with identifying and/or preserving and/or mitigating project impacts to Native American cultural places including:

- Native American sanctified cemetery, place of worship, religious or ceremonial site, or sacred shrine; and
- Native American historic, cultural, or sacred site that is listed or may be eligible for listing in the California Register of Historical Resources including historic or prehistoric ruins and any burial ground, archaeological, or historic site.

If you desire to consult with the City on the CEQA review of this project, please respond in writing within thirty (30) days of the date of this letter by either letter and/or email. Please direct your email to hdesantos@cityofirvine.org or any correspondence on this matter to:

Hernan DeSantos
Senior Planner
City of Irvine – Community Development Department
P.O. Box 19575
Irvine, CA 92623

Should we not receive a response within thirty (30) days, we will presume that you have declined consultation. Please do not hesitate to let me know if you have any questions

Mr. Scott Cozart
July 30, 2020
Page 3 of 3

or would like to discuss this proposed project. I can be reached by email at hdesantos@cityofirvine.org.

Sincerely,

Hernan DeSantos

Hernan DeSantos
Senior Planner

Enclosures:

1. Existing Project Site
2. Proposed Project Site

ec: Pete Carmichael, Director of Community Development
Tim Gehrich, Deputy Director of Community Development
Bill Rodrigues, Principal Planner
Chad Beckstrom, ICF (Chad.Beckstrom@icf.com)
Tanya Jones, ICF (Tanya.Jones@icf.com)

Files: 00816357-PCPM

Enclosure 1 – Existing Project Site

Existing Campus

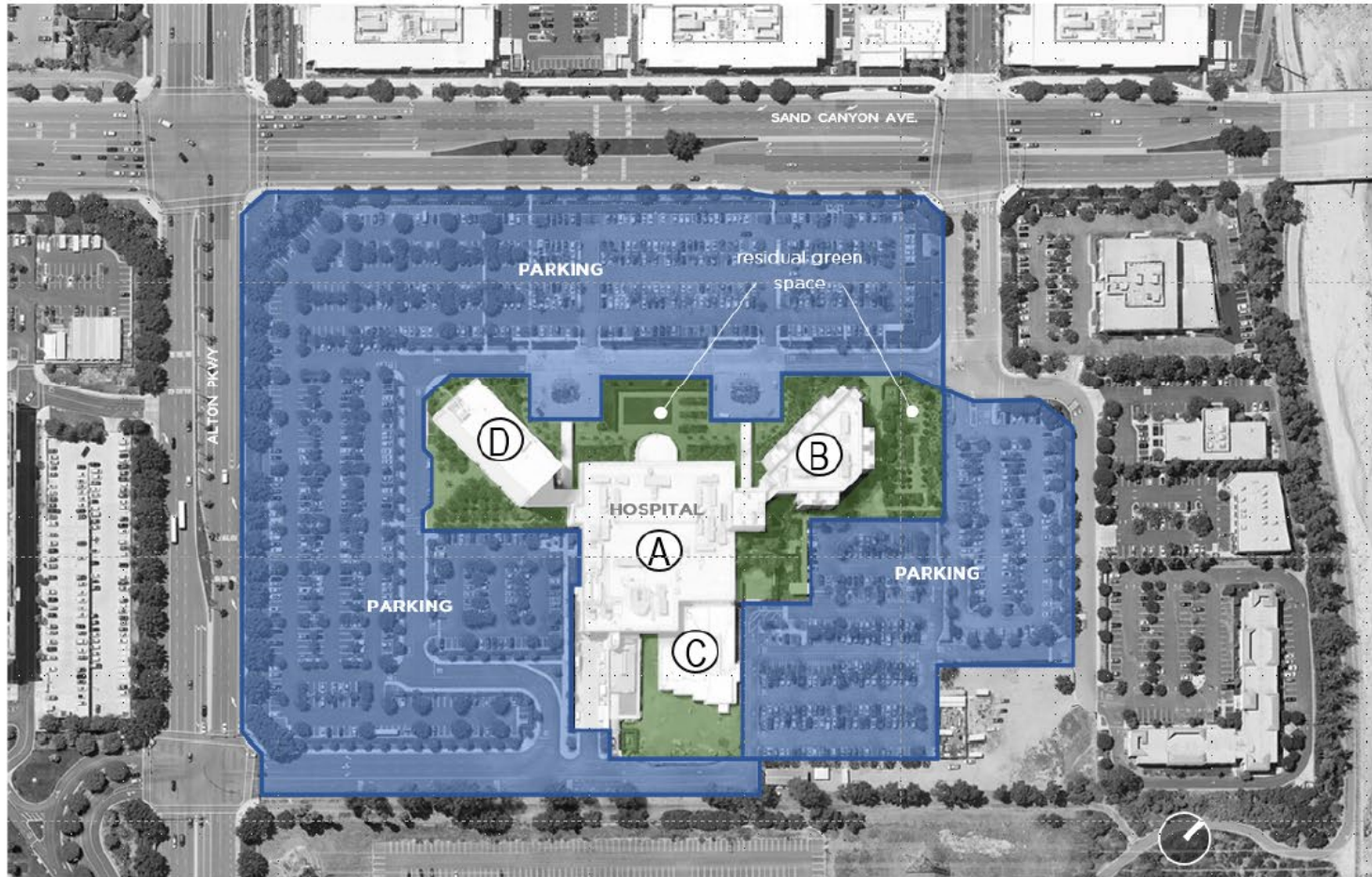

- A Ancillary Hospital Services
- B Nursing Tower
- C Emergency Department
- D Medical Office

Enclosure 2 – Proposed Project Site

Stage 2 / Campus Plan



Existing

- A. HHI/HOI
- B. Inpatient wing
- C. Emergency Department
- D. Rhodes Development MOB

Proposed

- 1. Women's Hospital
- 2. Women's Hospital Support Facility
- 3. Digestive Health Hospital
- 4. East Wing (ICU, Pharmacy, Lab)
- 5. East Parking Structure
- 6. Digestive Hospital Support Facility
- 7. Hospital Support Facility
- 8. Hospital Support Facility
- 9. Replacement Auditorium and Conf.
- 10. Central Utility Plan
- 11. West Wing Hospital
- 12. West Parking Structure
- 13. HHI Lobby (Café, Registration, Worship Center)
- 14. Interventional Platform



July 30, 2020

Original sent via Certified US Mail
Copy sent via email to:
ssilva@sycuan-nsn.gov

Mr. Cody Martinez
Chairperson
Sycuan Band of the Kumeyaay Nation
1 Kwaaypaay Court
El Cajon, CA 92019

Subject: Project Notification Pursuant to Assembly Bill (AB) 52 for the Hoag Hospital Irvine Expansion project (00816357-PCPM) in the City of Irvine, County of Orange, California (Assessor Parcel Number: 466-091-19)

Dear Mr. Martinez:

The City of Irvine is the lead agency, pursuant to the California Environmental Quality Act (CEQA), for the conditional use permit modification (00816357-PCPM) request for Hoag Hospital Irvine (HHI). HHI is seeking a conditional use permit modification to expand their existing hospital campus. The existing campus was first approved in December 1983 for a maximum entitlement of 565,359 square feet of hospital with up to 500 hospital beds, support uses, and medical offices. The project site is currently comprised of a 249,794 square-foot hospital with 166 hospital beds, a 10-story, 115,762 square-foot medical office building, and surface parking on approximately 24.5 acres located at 16200 Sand Canyon Avenue in the City of Irvine (see Attachment 1 – Existing Project Site).

The proposed conditional use permit modification seeks to increase the number of hospital beds from 166 to 391, and increase the hospital intensity from the originally approved 565,359 square feet up to approximately 1,123,293 square feet on the existing project site. At project build-out, the proposal would exceed the previous entitlement for the project site by up to approximately 557,934 square feet (see Attachment 2 – Proposed Project Site). Specifically, the proposed project would allow development to occur in two phases and consist of the following major components:

Phase 1:

- Addition of 356,740 square feet of hospital services with 161 beds to support the relocation of the pharmacy, clinical laboratory, intensive care unit, surgical suite, café, medical records, cashier, registration, worship center, gift shop and lobby;
- Addition of 130,000 square feet of hospital support facility;
- Addition of two, five-level parking structures (over 700 stalls in each structure);
- Addition of 47,550 square feet of new central utility plant along with cooling; and towers and emergency power generators at grade level.

Phase 2:

- Addition of 8,000 square feet of auditorium and conference center;
- Addition of 260,000 square feet of hospital support facilities;
- Addition of 80,000 square feet of hospital services to support 64 additional in-patient beds; and
- Parking structure expansion to provide 486 additional parking stalls.

AB 52 requires lead agencies to consult with California Native American Tribes that request such consultation in writing prior to the agency's release of a Notice of Preparation (NOP) of an Environmental Impact Report (EIR), or notice of a Mitigated Negative Declaration (MND), or Negative Declaration (ND) on or after July 1, 2015. Pursuant to Public Resources Code section 21080.3.1, a list of California Native American Tribes was provided to the City of Irvine that are traditionally and culturally affiliated with geographic area of the proposed project. This letter is intended as formal notification of the proposed project pursuant to Assembly Bill (AB) 52.

Pursuant to the provisions of Assembly Bill (AB) 52, the City hereby extends an invitation to consult on the California Environmental Quality Act (CEQA) review of this proposed project in order to assist with identifying and/or preserving and/or mitigating project impacts to Native American cultural places including:

- Native American sanctified cemetery, place of worship, religious or ceremonial site, or sacred shrine; and
- Native American historic, cultural, or sacred site that is listed or may be eligible for listing in the California Register of Historical Resources including historic or prehistoric ruins and any burial ground, archaeological, or historic site.

If you desire to consult with the City on the CEQA review of this project, please respond in writing within thirty (30) days of the date of this letter by either letter and/or email. Please direct your email to hdesantos@cityofirvine.org or any correspondence on this matter to:

Hernan DeSantos
Senior Planner
City of Irvine – Community Development Department
P.O. Box 19575
Irvine, CA 92623

Should we not receive a response within thirty (30) days, we will presume that you have declined consultation. Please do not hesitate to let me know if you have any questions

Mr. Cody Martinez
July 30, 2020
Page 3 of 3

or would like to discuss this proposed project. I can be reached by email at hdesantos@cityofirvine.org.

Sincerely,

Hernan DeSantos

Hernan DeSantos
Senior Planner

Enclosures:

1. Existing Project Site
2. Proposed Project Site

ec: Pete Carmichael, Director of Community Development
Tim Gehrich, Deputy Director of Community Development
Bill Rodrigues, Principal Planner
Chad Beckstrom, ICF (Chad.Beckstrom@icf.com)
Tanya Jones, ICF (Tanya.Jones@icf.com)

Files: 00816357-PCPM

Enclosure 1 – Existing Project Site

Existing Campus

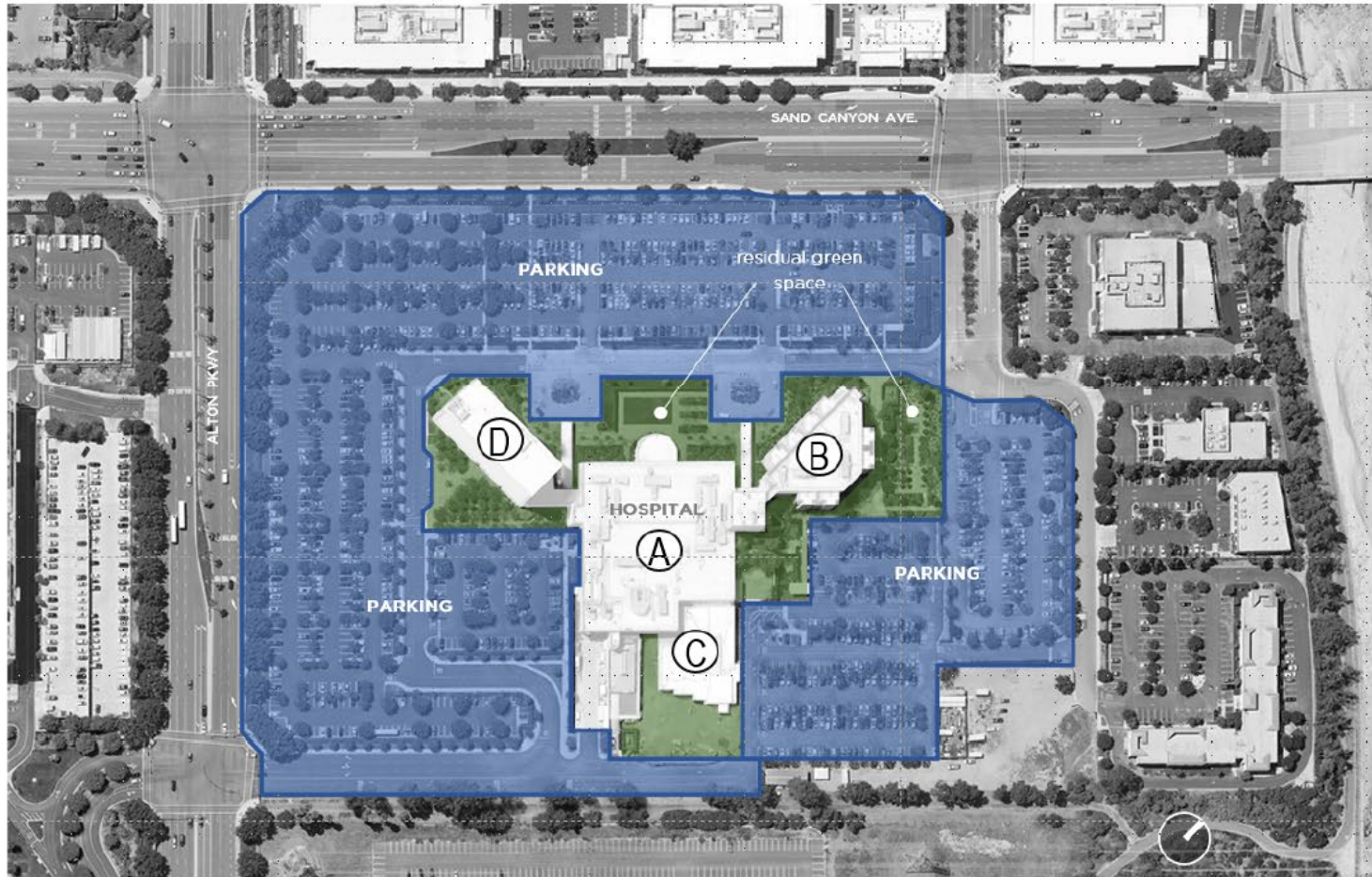

- A Ancillary Hospital Services
- B Nursing Tower
- C Emergency Department
- D Medical Office

Enclosure 2 – Proposed Project Site

Stage 2 / Campus Plan



- Existing**
- A. HHI/HOI
 - B. Inpatient wing
 - C. Emergency Department
 - D. Rhodes Development MOB
- Proposed**
- 1. Women's Hospital
 - 2. Women's Hospital Support Facility
 - 3. Digestive Health Hospital
 - 4. East Wing (ICU, Pharmacy, Lab)
 - 5. East Parking Structure
 - 6. Digestive Hospital Support Facility
 - 7. Hospital Support Facility
 - 8. Hospital Support Facility
 - 9. Replacement Auditorium and Conf.
 - 10. Central Utility Plan
 - 11. West Wing Hospital
 - 12. West Parking Structure
 - 13. HHI Lobby (Café, Registration, Worship Center)
 - 14. Interventional Platform



GABRIELENO BAND OF MISSION INDIANS - KIZH NATION
Historically known as The Gabrielino Tribal Council - San Gabriel Band of Mission Indians
recognized by the State of California as the aboriginal tribe of the Los Angeles basin

August 5, 2020

Project Name: Hoag Hospital Irvine Expansion Project City of Irvine

Dear Hernan DeSantos,

Thank you for your letter dated July 30, 2020 regarding AB52 consultation. The above proposed project location is within our Ancestral Tribal Territory; therefore, our Tribal Government requests to schedule a consultation with you as the lead agency, to discuss the project and the surrounding location in further detail.

Please contact us at your earliest convenience. ***Please Note: AB 52, "consultation" shall have the same meaning as provided in SB 18 (Govt. Code Section 65352.4).***

Thank you for your time,

Andrew Salas, Chairman
Gabrieleno Band of Mission Indians – Kizh Nation
1(844)390-0787

Andrew Salas, Chairman
Albert Perez, treasurer I

Nadine Salas, Vice-Chairman
Martha Gonzalez Lemos, treasurer II

Dr. Christina Swindall Martinez, secretary
Richard Gradias, Chairman of the council of Elders

PO Box 393 Covina, CA 91723

admin@gabrielenoindians.org