



### NOTICE OF EXEMPTION

**TO:** Office of Planning and Research  
1400 Tenth Street  
Sacramento, CA 95814

**FROM:** Department of Parks and Recreation  
1416 Ninth Street  
P.O. Box 942896  
Sacramento, CA 94296-0001

**PROJECT TITLE:** Lake Perris Dam Fishing Dock Replacements (FY 2021-IE-01)

**LOCATION:** Lake Perris State Recreation Area      **COUNTY:** Riverside

**DESCRIPTION OF THE NATURE AND PURPOSE OF PROJECT:** Floating docks used for fishing recreation at the southern shore of Lake Perris, on the northern side of the dam have been removed due to their deteriorated condition. Replacement docks will be constructed offsite then floated in place by boat. The docks will be connected to existing concrete ramps and cable footings with winches and anchored to the bottom of the lake. Measures to be implemented to avoid impact may be obtained by submitting a request to the project Environmental Coordinator listed below.

**PUBLIC AGENCY APPROVING THE PROJECT:** California Department of Parks and Recreation

**NAME OF DIVISION OR DISTRICT CARRYING OUT THE PROJECT:** Inland Empire

**EXEMPT STATUS:**

- Declared Emergency (Section 15269(a))
- Emergency Project (Section 15269(b) and (c))
- Statutory Exemption (Section        )
- Categorical Exemption

Class: 2

Section: 15302 – Replacement or Reconstruction

**REASONS WHY PROJECT IS EXEMPT:** No potential for significant impact to the environment is anticipated in compliance with CEQA §15300.4. If the project is implemented as indicated within the CDPR Project Evaluation Form, then it is exempt under CEQA §15302–Existing Facilities. The action falls under the Departmental List of Exempt activities according to CEQA §15300.4 as the replacement or reconstruction of existing facilities.

**CONTACT:** Harmony Gugino, Environmental Coordinator  
Inland Empire District

**PHONE NO.:** (951) 503-3376  
**EMAIL:** harmony.gugino@parks.ca.gov

  
\_\_\_\_\_  
Kelly Elliott  
District Superintendent  
Inland Empire District

10/28/20  
\_\_\_\_\_  
DATE



# Lake Perris Dam Fishing Dock Replacements Project

7.5' Topographic Map

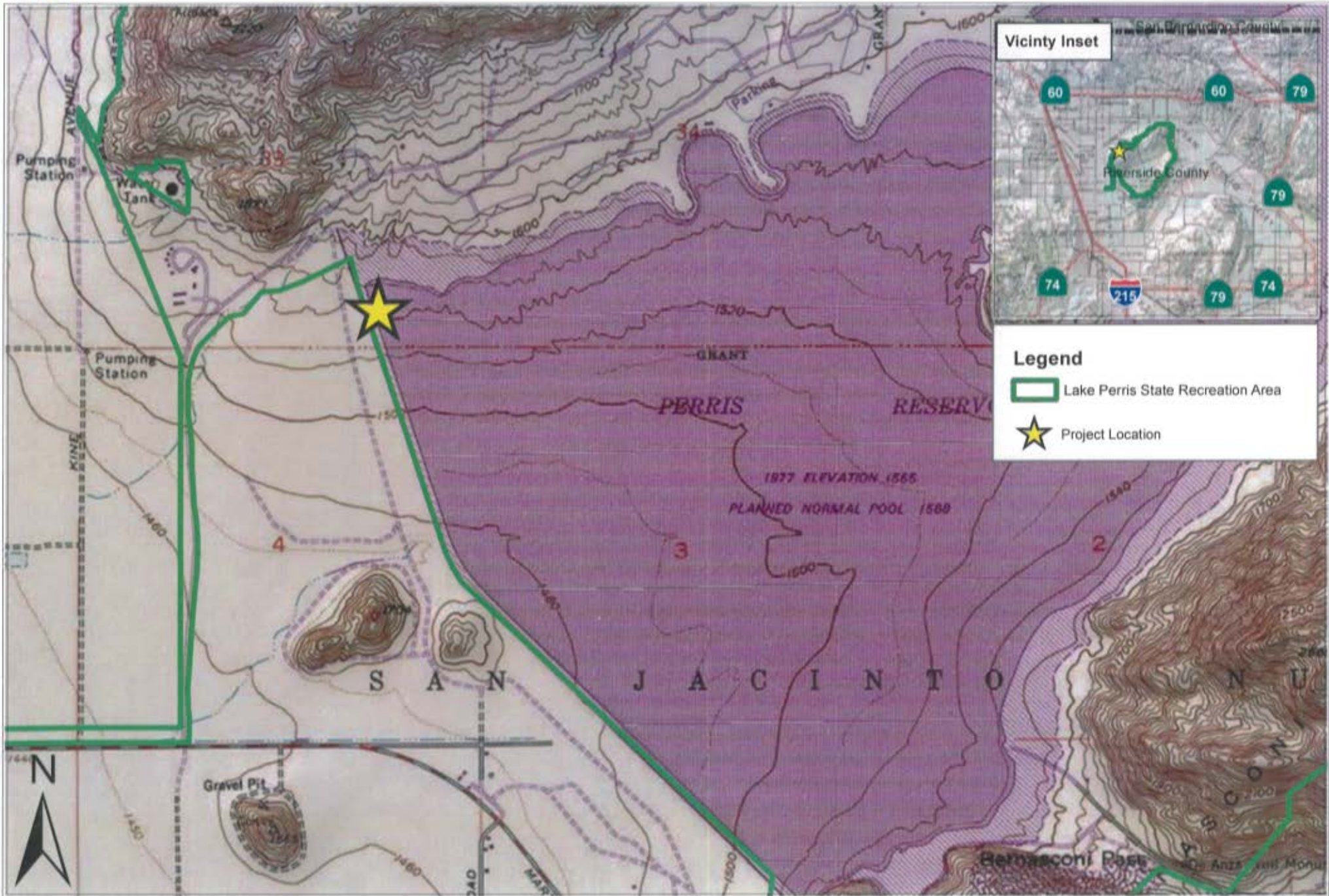

Vicinity Inset

Legend

-  Lake Perris State Recreation Area
-  Project Location

0 2,000 4,000 Feet

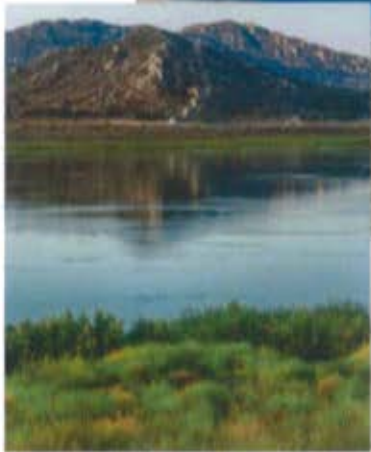
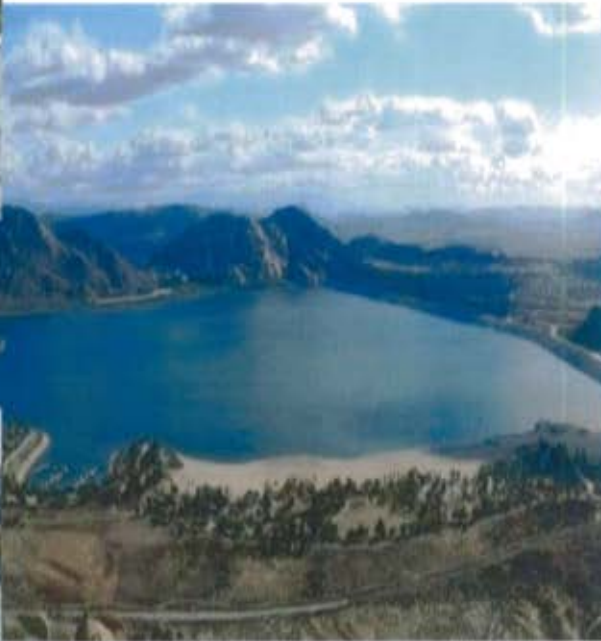

# LAKE PERRIS FISHING PIERS

LAKE PERRIS  
State Recreation Area

Design Presentation



LAKE PERRIS SRA  
PERRIS, CALIFORNIA 92571

LAKE PERRIS  
FISHING PIERS

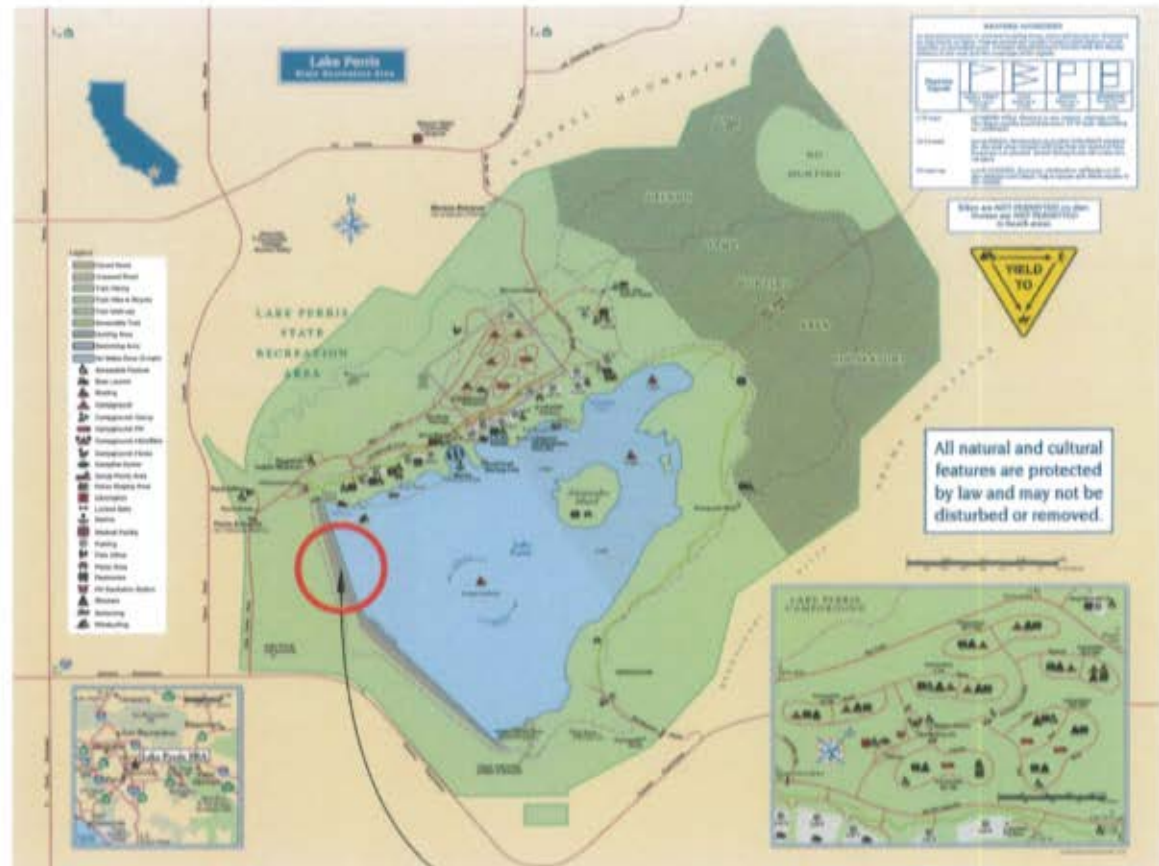

PROPOSED FISHING PIER LOCATION

## SHEET INDEX

- COVER SHEET
- A 01 SITE MAP / PROJECT LOCATION
- A 02 EXISTING CONDITIONS
- A 03 DESIGN LAYOUT - PLAN VIEW
- A 04 DESIGN LAYOUT - ISOMETRIC VIEW
- A 05 DESIGN LAYOUT - MATERIALS

## SITE MAP / PROJECT LOCATION





**VIEW LOOKING DOWN  
EXISTING RAMP**

EXISTING CONCRETE RAMP TO BE POINT OF CONNECT FOR PROPOSED FISHING PIER (FLOATING DOCK AND RAMP).



**SIDE VIEW OF EXISTING RAMP**

EXISTING CONCRETE RAMP AND METAL RAILING ARE LOCATED ON THE FACE OF DAM.

OTHER EXISTING AMENITIES CONSIST OF BOLLARDS, SHADE STRUCTURE, PICNIC TABLE, AND CHEMICAL TOILET AT TOP OF RAMP.



**EXISTING RAMP AT WATER LINE**

7 FOOT WIDE CONCRETE RAMP EXTENDS APPROXIMATELY 150' BEYOND METAL RAILING.

**EXISTING CONDITIONS**



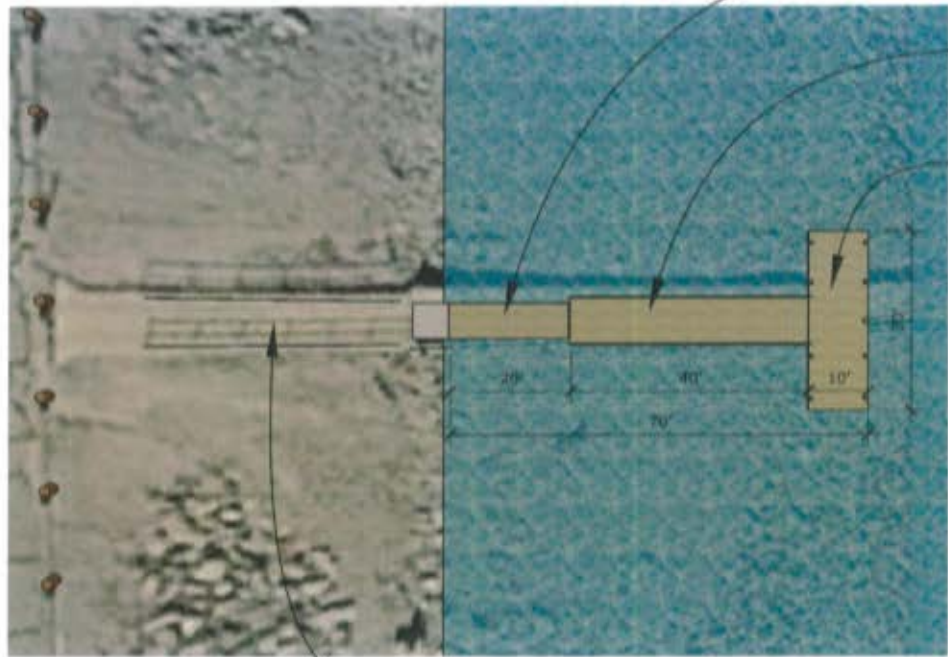

**TRANSITION RAMP**  
 6' X 20' RAMP SECTION CONNECTING TO  
 EXISTING CONCRETE RAMP AT WATER LINE.

**FLOATING RAMP**  
 8' X 40' RAMP SECTION WITH METAL  
 RAILINGS TO MATCH EXISTING.

**FLOATING DOCK**  
 10' X 30' WOOD/METAL DOCK WITH  
 PONTOON FLOATS. CABLE ANCHORING  
 SYSTEM TO STABILIZE DOCK.

**EXISTING 7' CONCRETE RAMP**  
 EXISTING CONCRETE RAMP AND  
 METAL RAILING

**DESIGN LAYOUT - PLAN VIEW**



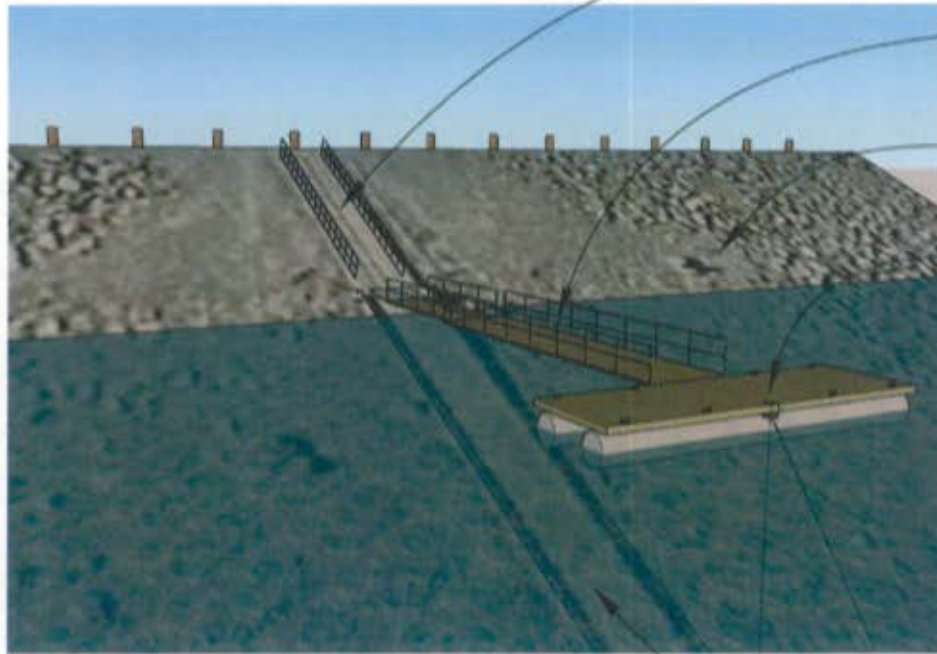

**EXISTING RAMP AND RAILING**  
EXISTING CONCRETE RAMP RUNNING DOWN  
THE FACE OF DAM.

**FLOATING RAMP**  
8' X 40' RAMP SECTION WITH METAL  
RAILINGS TO MATCH EXISTING.

**EXISTING DAM**  
ROCK FACE AND BOLLARDS BORDERING  
ROAD ON TOP OF DAM.

**FLOATING DOCK**  
10' X 30' WOOD/METAL DOCK WITH  
PONTOON FLOATS. STABILIZING CABLE  
SYSTEM IS TO BE ANCHORED TO  
CONCRETE WEIGHT AT END OF EXISTING  
CONCRETE RAMP.

**EXISTING CONCRETE RAMP (UNDER WATER)**  
EXISTING CONCRETE RAMP EXTENDING  
APPROXIMATELY 150' BEYOND METAL RAILING.

## DESIGN LAYOUT - ISOMETRIC VIEW

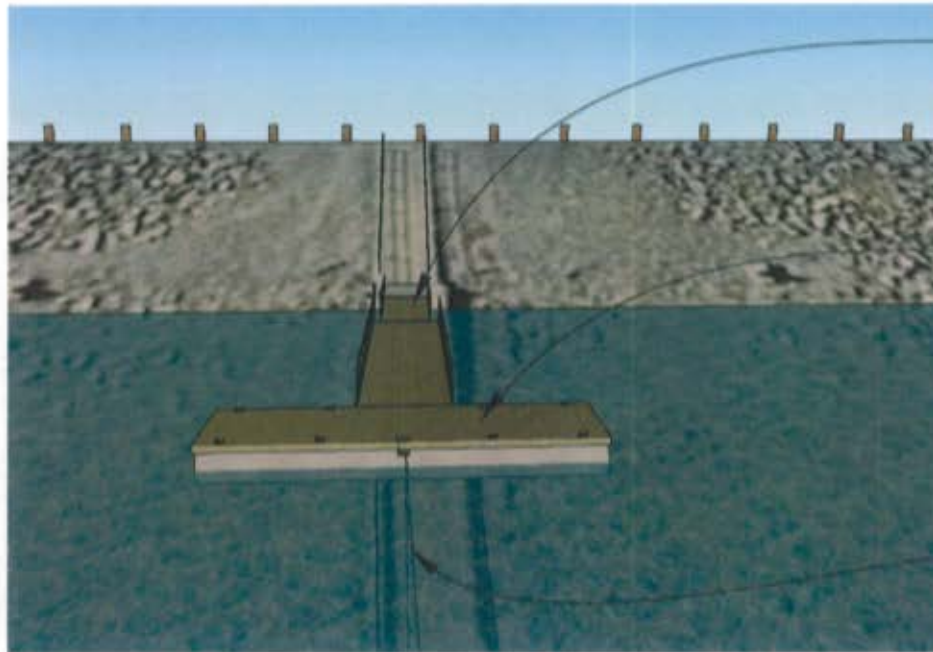

**FLOATING RAMPS**

ALUMINUM PONTOON ATTACHED METAL SUB-STRUCTURE WITH WOOD TRIM FINISH AND DECKING. RAILING SHALL BE STAINLESS STEEL OR GALVANIZED STEEL ATTACHED TO SUB-STRUCTURED.

**10' X 30' FLOATING DOCK**

ALUMINUM PONTOON ATTACHED METAL SUB-STRUCTURE WITH WOOD TRIM FINISH AND DECKING. SIX CLEATS ATTACHED TO METAL SUB-STRUCTURE.

**CABLE ANCHORING SYSTEM**

CABLE ANCHORING SYSTEM IS TO BE ATTACHED TO CONCRETE WEIGHT PLACED AT END OF EXISTING CONCRETE RAMP. ADJUSTMENT CONTROL BOX ACCESSED FROM DOCK.

**DESIGN LAYOUT - MATERIALS**