

Appendix A
Photometric Plan

| Symbol | Qty | Label | Arrangement | Total Lamp Lumens | LLF | Description | Mounting Height |
|--------|-----|-------|----------------|-------------------|-------|---|-----------------|
| UC | 52 | UC | SINGLE | N.A. | 0.810 | CPY250-B-xx-F-UL-xx-57K | GANOPY RECESSED |
| OS | 13 | OS | SINGLE | N.A. | 0.810 | CPY250-B-xx-F-A-UL-xx-57K CONFIGURED FROM CPY250-B-xx-F-A-UL-xx-30K | 10'-6" |
| FL | 9 | FL | SINGLE | N.A. | 0.810 | XSPW-B-xx-2ME-4L-40K-UL CONFIGURED FROM XSPW-B-xx-2ME-8L-40K-UL | 11'-6" |
| SBC | 6 | SBC | SINGLE | N.A. | 0.810 | OSQ-A-xx-4ME-U-57K-UL-xx-xx CONFIGURED FROM OSQ-A-xx-4ME-U-40K-UL-xx-xx | 20'-0" |
| SB | 6 | SB | SINGLE | N.A. | 0.810 | OSQ-A-xx-4ME-B-57K-UL-xx-xx CONFIGURED FROM OSQ-A-xx-4ME-B-30K-UL-xx-xx | 15'-0" |
| SD | 4 | SD | SINGLE | N.A. | 0.810 | OSQ-A-xx-2ME-T-57K-UL-xx-xx CONFIGURED FROM OSQ-A-xx-2ME-U-40K-UL-xx-xx | 25'-0" |
| SBS | 9 | SBS | SINGLE | N.A. | 0.810 | OSQ-A-xx-4ME-B-57K-UL-xx-xx w OSQ-BLSMF CONFIGURED FROM OSQ-A-xx-4ME-U-57K-UL-xx-xx | 15'-0" |
| SBZ | 5 | SBZ | BACK-BACK | N.A. | 0.810 | OSQ-A-xx-4ME-T-57K-UL-xx-xx CONFIGURED FROM OSQ-A-xx-4ME-U-40K-UL-xx-xx | 25'-0" |
| SB1 | 10 | SB1 | SINGLE | N.A. | 0.810 | OSQ-A-xx-4ME-T-57K-UL-xx-xx CONFIGURED FROM OSQ-A-xx-4ME-U-40K-UL-xx-xx | 25'-0" |
| SB2a | 4 | SB2a | BACK-BACK | N.A. | 0.810 | OSQ-A-xx-4ME-B-57K-UL-xx-xx CONFIGURED FROM OSQ-A-xx-4ME-B-30K-UL-xx-xx | 15'-0" |
| SB4 | 2 | SB4 | 4 @ 90 DEGREES | N.A. | 0.810 | OSQ-A-xx-4ME-B-57K-UL-xx-xx CONFIGURED FROM OSQ-A-xx-4ME-B-30K-UL-xx-xx | 15'-0" |

| Label | CalcType | Units | Avg | Max | Min | Avg/Min | Max/Min |
|--------------------------------|------------|-------|------|------|-----|---------|---------|
| CalcPts 1 | illumiance | Fc | 0.69 | 53.1 | 0.0 | N.A. | N.A. |
| WEST PROPERTY LINE (AUTO AREA) | illumiance | Fc | 0.97 | 2.8 | 0.0 | N.A. | N.A. |
| WEST PROPERTY LINE TRUCK AREA) | illumiance | Fc | 0.00 | 0.0 | 0.0 | N.A. | N.A. |
| AUTO PARKING AREA | illumiance | Fc | 4.91 | 25.8 | 0.3 | 16.37 | 86.00 |
| TRUCK PARKING AREA | illumiance | Fc | 3.54 | 42.2 | 0.2 | 17.70 | 211.00 |

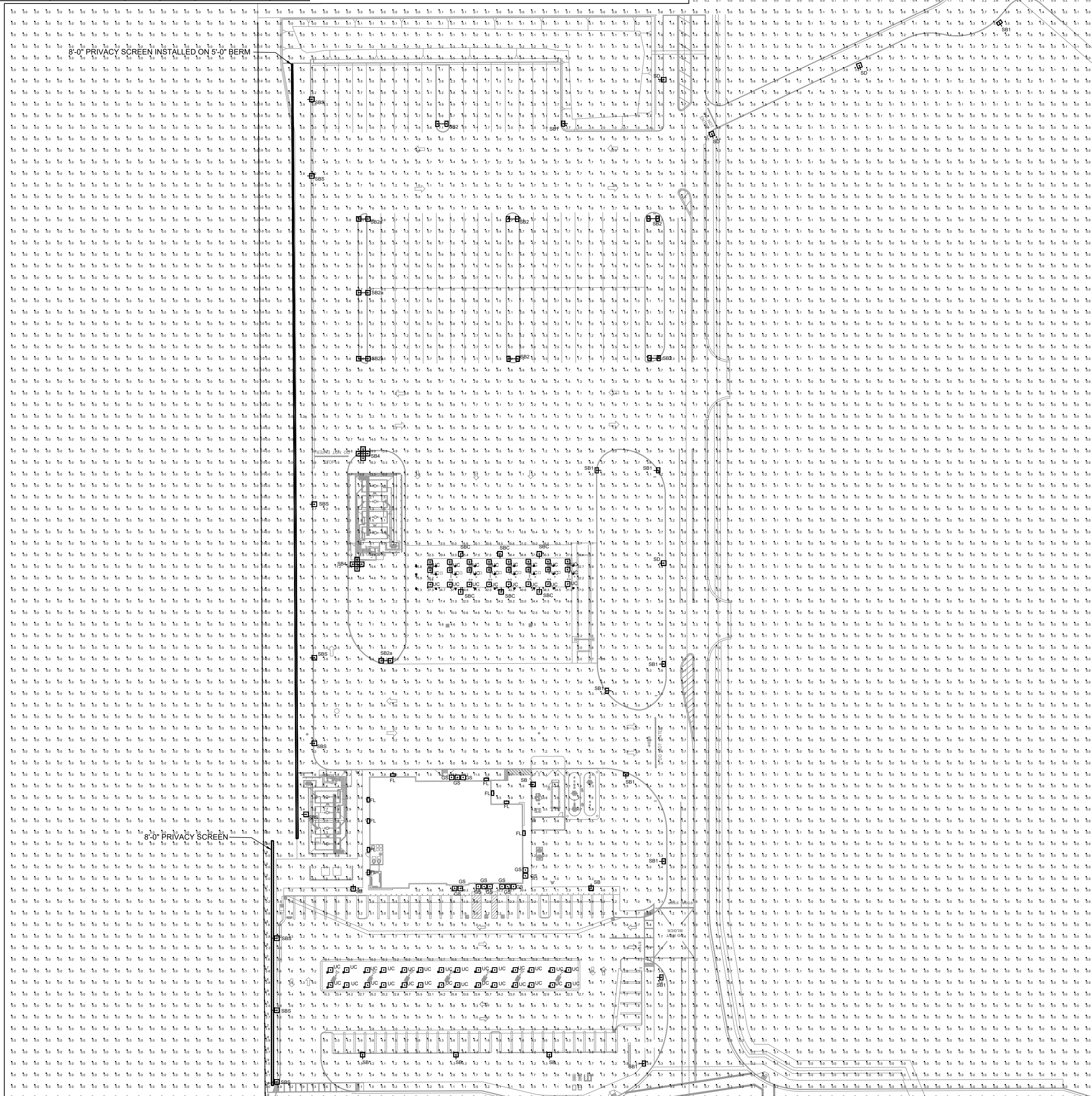

1 SITE PLAN - PHOTOMETRIC
SCALE: 1"=50'-0"

CONTRACTOR NOTE

- THIS LIGHTING DESIGN IS BASED ON INFORMATION SUPPLIED BY OTHERS TO PAGE INTERWORKS, P.A. SITE DETAILS PROVIDED HEREON ARE REPRODUCED ONLY AS A VISUALIZATION AID. FIELD DEVIATIONS MAY SIGNIFICANTLY AFFECT PREDICTED PERFORMANCE. PRIOR TO INSTALLATION, CRITICAL SITE INFORMATION (POLE LOCATIONS, ORIENTATION, MOUNTING HEIGHT, ETC.) SHOULD BE COORDINATED WITH THE CONTRACTOR AND/OR SPECIFIER RESPONSIBLE FOR THE PROJECT.
- LUMINAIRE DATA IS TESTED TO INDUSTRY STANDARDS UNDER LABORATORY CONDITIONS. OPERATING VOLTAGE AND NORMAL MANUFACTURING TOLERANCES OF LAMP, BALLAST, AND LUMINAIRE MAY AFFECT FIELD RESULTS.

WIFI POWER POLE NOTES

- CONTRACTOR IS TO SUPPLY 4"x4"x20" ALUMINUM POLE TO MOUNT WIRELESS ACCESS POINT EQUIPMENT TO IF SITE LIGHTING POLE IS NOT AVAILABLE.
- CONTRACTOR SHALL PROVIDE A 12"x12"x6" NEMA 3R JUNCTION BOX. JUNCTION BOX SHALL HOUSE THE OWNER SUPPLIED CISCO POWER INJECTOR. PROVIDE A CONTINUOUSLY POWERED 110V GFCI RECEPTACLE MOUNTED INSIDE THE JUNCTION BOX TO POWER THE CISCO POWER INJECTOR. JUNCTION SHALL BE NO MORE THAN 1' AWAY FROM THE WIRELESS ACCESS POINT (CISCO MR66).
- CONTRACTOR TO INSTALL OWNER SUPPLIED WIRELESS ACCESS POINT (ROUTER, CISCO MR66) ABOVE THE NEMA 3R JUNCTION BOX. ROUTE CAT 5E CABLES FOR CISCO POWER INJECTOR OUTPUT INTO WIRELESS ACCESS POINT.
- CONTRACTOR IS TO INSTALL OWNER SUPPLIED ANTENNA AT LEAST 20' ABOVE GRADE. ANTENNA HAS FOUR (4) CABLES THAT WILL CONNECT TO THE FOUR (4) INPUT PORTS ON THE WIRELESS ACCESS POINT.
- CONTRACTOR SHALL VERIFY POLE BASE REQUIREMENTS WITH STRUCTURAL ENGINEER BASED ON SITE SOIL CONDITIONS.

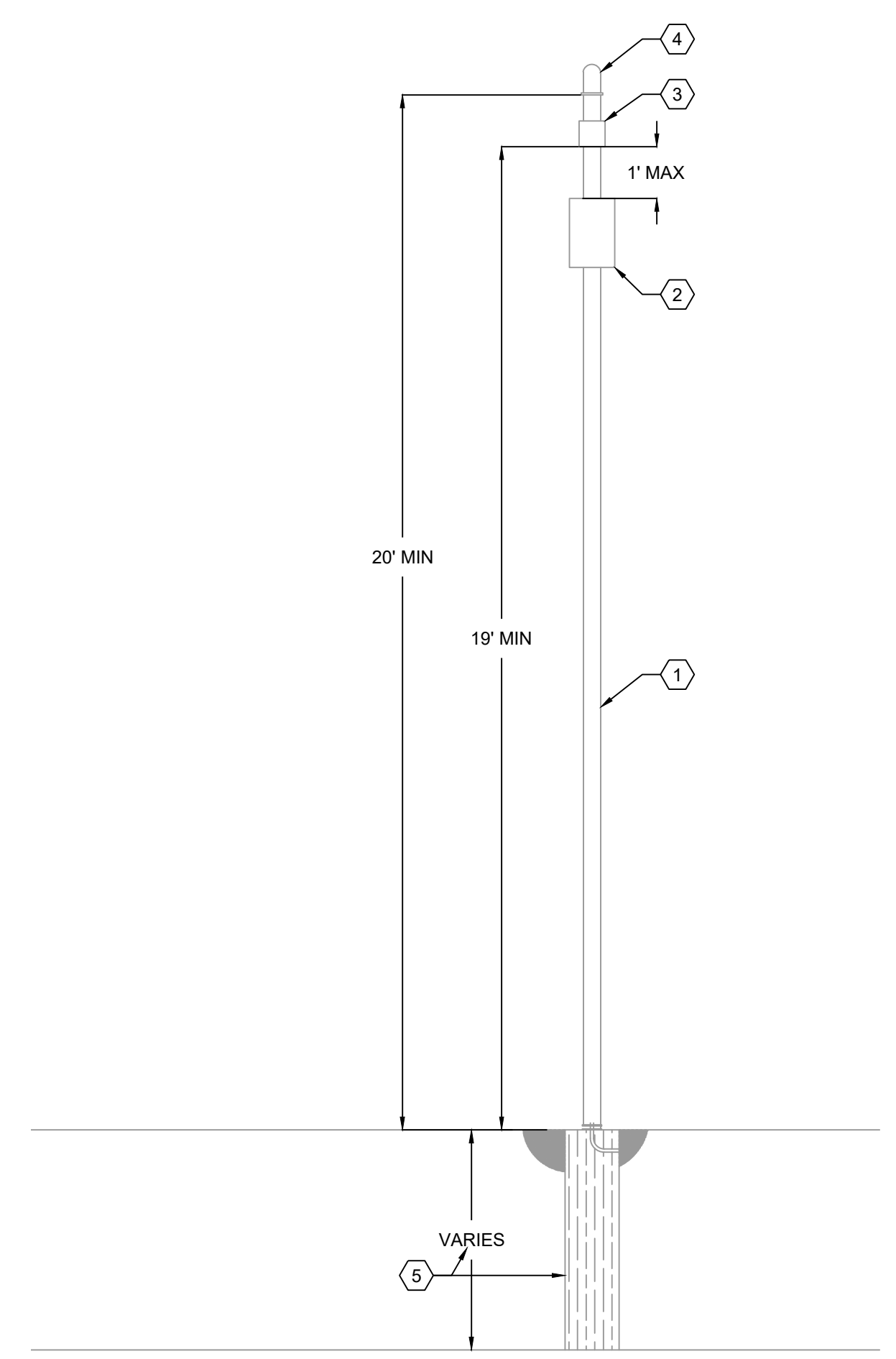

2 WIFI POWER POLE
SCALE: 3/8" = 1'-0"

FOR REFERENCE ONLY
2/24/2021

PILOT FLYING J
DESIGN DEPARTMENT
5508 LOMAS ROAD
KNOXVILLE, TENNESSEE 37909
(865) 688-7488

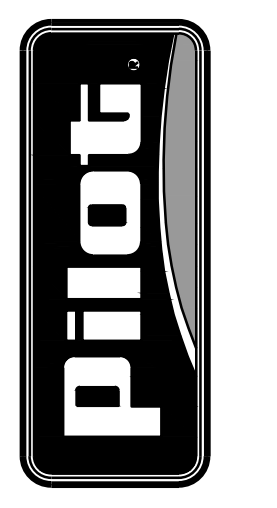

SITE PLAN
PHOTOMETRIC
PILOT TRAVEL CENTER
ADDRESS
PALMDALE, CA

| | | |
|-----------------------|----------------|------------------|
| DATE: 07/03/20 | DRAWN BY: REC | PROJECT: 1267-01 |
| DESIGN: LBY, JAP | DATE: 07/03/20 | DESIGN: 2018Z |
| REVISION DESCRIPTION: | | |

CONFIDENTIAL
NO USE OR DISCLOSURE OF THIS DRAWING IS PERMITTED WITHOUT EXPRESS AUTHORIZATION BY PILOT FLYING J

SHEET:
ES1.2

PAGE
INTERWORKS, P.A.
ENGINEERS & CONSULTANTS
923 MAIN STREET, NORTH WILKESBORO, NC 28669
PHONE: 336-667-4225