

# PROPOSED PERMANENT PARKING FOR:

## VIAGGIO ESTATE & WINERY

### 108 E. TADDEI RD. ACAMPO, CALIFORNIA 95220

REVISED SITE PLAN  
Application # PA1800074#  
Received By CS On 1/14/2020

PROJECT DATA:	
PROJECT OWNER	LARRY M. LAWRENCE 100 E. TADDEI RD. ACAMPO, CALIFORNIA
PROJECT LOCATION	VIAGGIO ESTATE & WINERY 108 E. TADDEI RD. ACAMPO, CALIFORNIA
PROJECT DESCRIPTION	NEW PERMANENT EVENT PARKING
APN #	031-130-23
OCCUPANCY	N/A
CONSTRUCTION TYPE	IIB
<b>PERMANENT PARKING:</b>	
DISABLED PARKING	5 (2-VAN ACCESSIBLE)
STANDARD PARKING	104
TOTAL SPACES	109
<b>UTILITIES:</b>	
WATER	DOMESTIC WELL
SEWER	ON SITE
STORM	ON-SITE RETENTION

CODE COMPLIANCE
ALL WORK PERFORMED SHALL BE IN ACCORDANCE TO THE LATEST EDITION OF APPLICABLE CODES, INCLUDING BUT NOT LIMITED TO:
<ul style="list-style-type: none"> <li>• 2019 CALIFORNIA BUILDING CODE, (CBC)</li> <li>• 2019 CALIFORNIA ELECTRICAL CODE, (CEC)</li> <li>• 2019 CALIFORNIA GREEN BUILDING CODE, (CGBC)</li> <li>• 2019 CALIFORNIA MECHANICAL CODE, (CMC)</li> <li>• 2019 CALIFORNIA PLUMBING CODE, (CPC)</li> <li>• 2019 CALIFORNIA ENERGY CODE, (CEC)</li> <li>• 2019 CALIFORNIA FIRE CODE, (CFC)</li> <li>• 2019 CALIFORNIA HISTORICAL BUILDING CODE</li> <li>• 2019 CALIFORNIA EXISTING BUILDING CODE</li> <li>• 2019 CALIFORNIA REFERENCED STANDARDS CODE</li> </ul>

- NOTES:**
- ALL PROPERTY LINES, EASEMENTS AND BUILDINGS AREA SHOWN ON THIS SITE PLAN.
  - (E) 8'-0" TALL CHAIN LINK FENCE SURROUNDS PERIMETER OF PROPERTY.

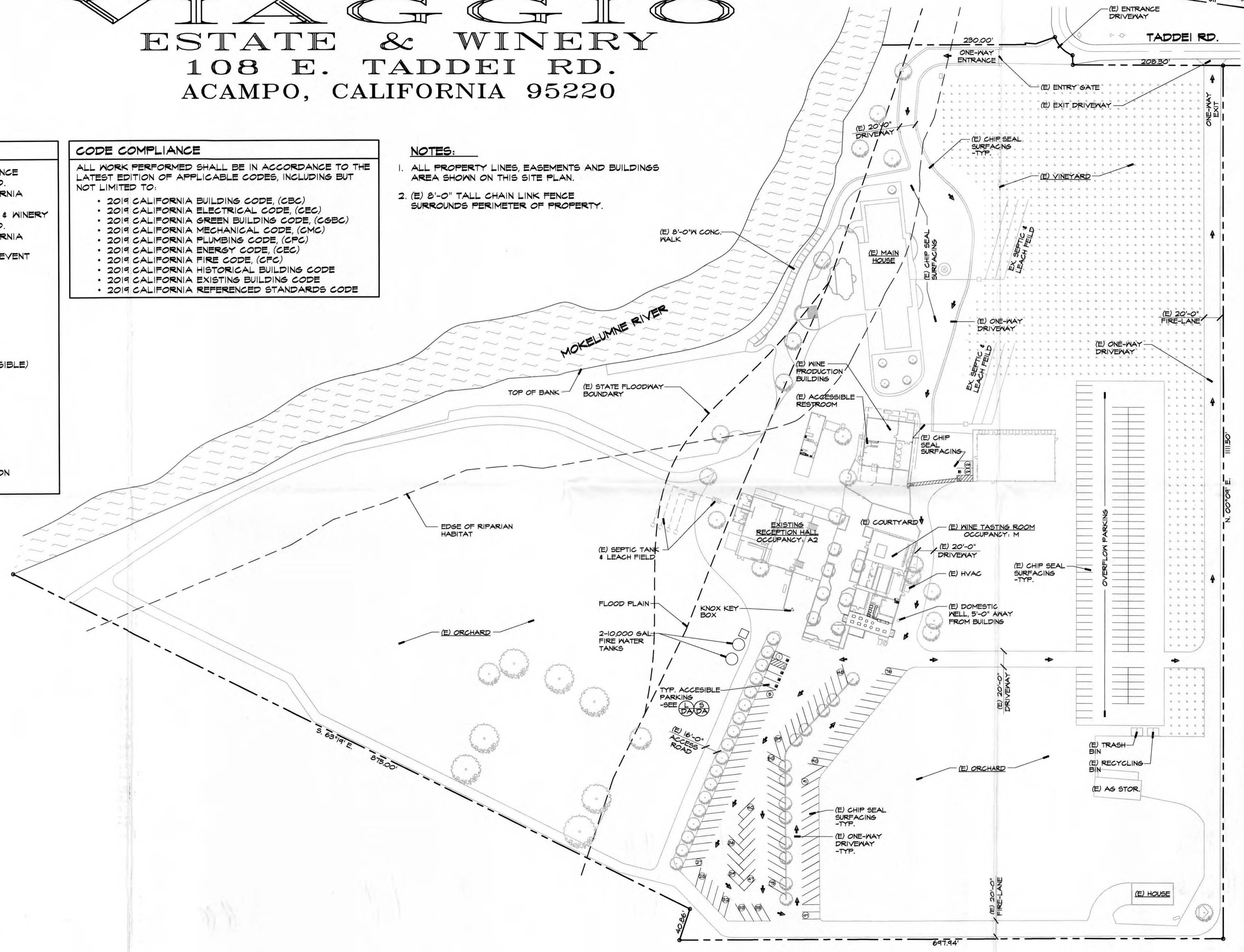

**SITE PLAN**

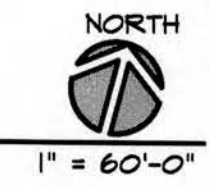

REVISIONS	BY

**MIKE SMITH ENGINEERING, INC.**  
4 NORTH MAIN STREET  
LODI, CALIFORNIA 95240  
PHONE (209) 934-2332

TITLE:  
**SITE PLAN**

PROJECT:  
**PROPOSED PARKING FOR:  
VIAGGIO ESTATE & WINERY**  
PROJECT LOCATION:  
100 E. TADDEI RD.  
ACAMPO, CA 95220

STAMP  
REGISTERED PROFESSIONAL ENGINEER  
MICHAEL W. SMITH  
NO. 0044590  
EXP. 3-31-22  
CIVIL  
STATE OF CALIFORNIA

Digitally signed by Michael W. Smith  
Reason: I am approving this document  
Date: 2020.07.10 09:02:31 -07'00'

DRAWN	KH
CHECKED	MS
DATE	2/19/20
SCALE	AS NOTED
JOB NO.	20015
SHEET	