



E202110000083

County of Fresno

DEPARTMENT OF PUBLIC WORKS AND PLANNING
STEVEN E. WHITE, DIRECTOR

NOTICE OF EXEMPTION

- TO: Office of Planning and Research
1400 Tenth Street, Room 121
Sacramento, CA 95814
- County Clerk, County of Fresno
2221 Kern Street
Fresno, CA 93721

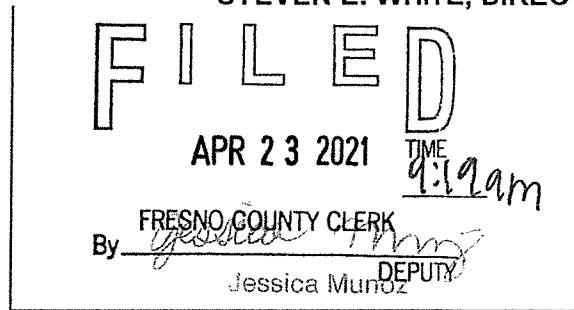

For County Clerk's Stamp

FROM: Fresno County Department of Public Works and Planning
Development Services and Capital Projects Division
2220 Tulare Street (corner of Tulare and "M") Suite "A", Fresno, CA 93721

PROJECT TITLE: Environmental Review Application No. 7973

PROJECT APPLICANT/SPONSOR: Christian Montoya, Design Division

PROJECT LOCATION – COUNTY: The project site encompasses multiple parcels located along S. San Mateo Avenue and W. Clarkson Avenue. See attached exhibits.

DESCRIPTION OF PROJECT: The project proposes to amend the County Service Area (CSA) No. 32 Sphere of Influence (SOI) and annex into CSA 32 all properties now receiving or planned to receive service from CSA 32. The SOI will expand from 63.09 acres to 97.16 acres in size.

NAME OF PUBLIC AGENCY APPROVING PROJECT: Fresno County Board of Supervisors

NAME OF PERSON OR AGENCY CARRYING OUT PROJECT: Fresno County Department of Public Works and Planning, Design Division

EXEMPT STATUS: Categorical exemption: Section 15319(a) *Annexations of Existing Facilities and Lots for Exempt Facilities* and Section 15320 *Changes in Organization of Local Agencies*

REASONS WHY THE PROJECT IS EXEMPT: The subject application proposes to expand the sphere of influence (SOI) of a County Service Area (CSA) and annex properties under the expanded SOI to provide services to the annexed properties. There is no construction or expansion of facilities proposed, therefore no impact to historical or cultural resources will occur. There is no listed hazardous waste/material facility located in vicinity of the project site. The project site is not located in a special flood hazard area. There is no expansion of CSA facilities involved with this project that would generate transportation, air quality, or greenhouse gas emission impacts.

LEAD AGENCY

CONTACT PERSON: Thomas Kobayashi

AREA CODE/TELEPHONE: (559) 600-4224

E202110000083

If filed by the applicant:

1. Attach certified document of exemption finding.
2. Has a Notice of Exemption been filed by the public agency approving the project?
 Yes No

Signature: 
David Randall, Senior Planner

Date: 4.12.21

- Signed by Lead Agency Date received for filing at OPR: _____
- Signed by Applicant

G:\4360Devs&Pin\PROJSEC\PROJDOCS\Environmental\Exemptions - Exclusions - CE(N)ST7000-7999\ER 7973 CSA 32 SOI Amendment and Annexation\ER 7973 NOE.docx

CSA 32 ANNEXATION NO. 1 - BOUNDARY

EXHIBIT B

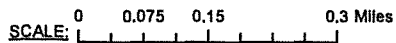
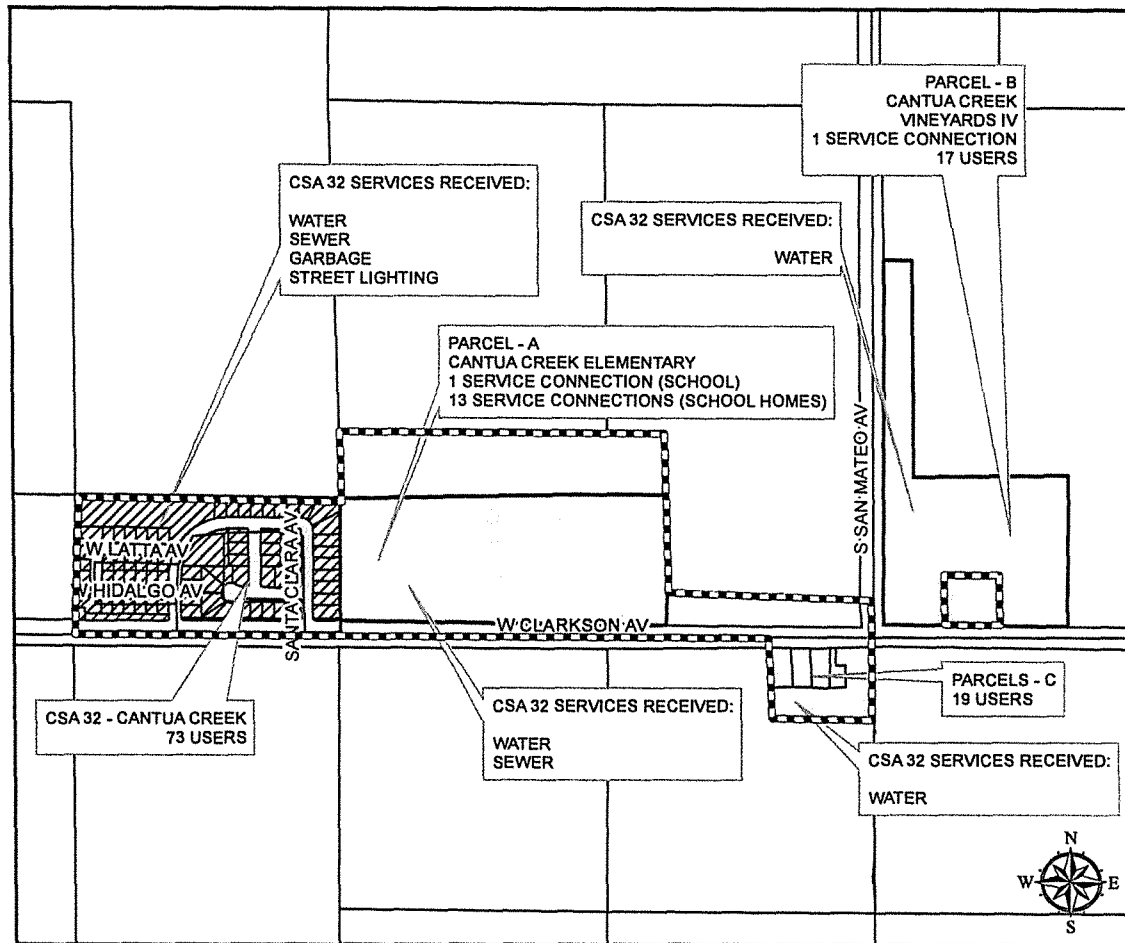
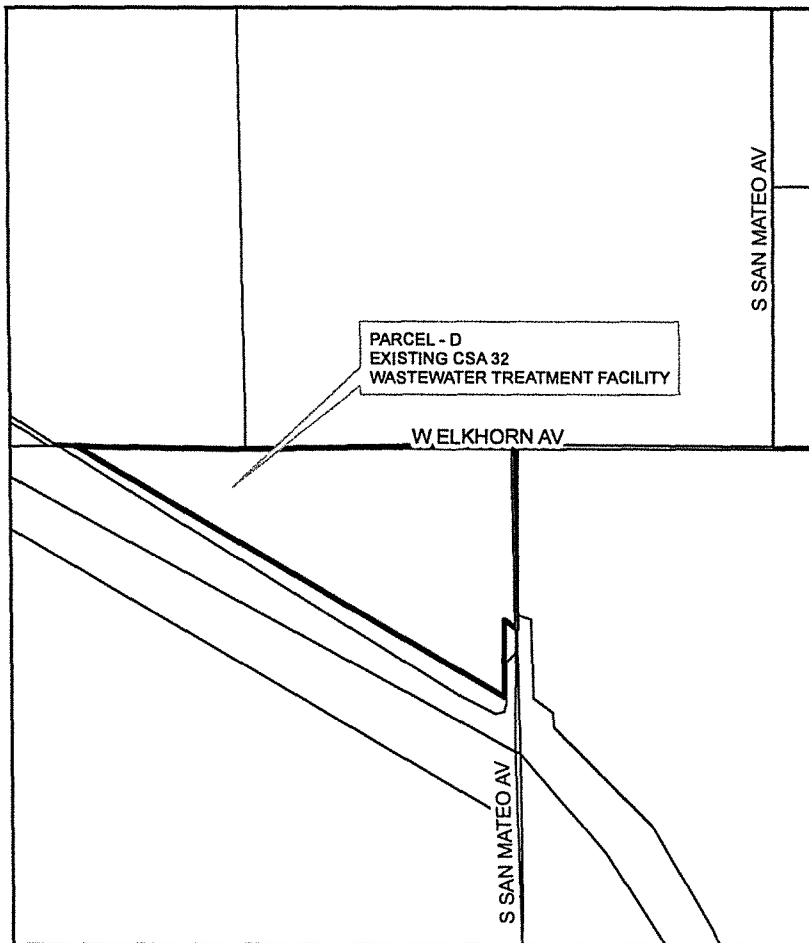

DEPARTMENT OF PUBLIC WORKS
AND PLANNING

PARCEL SUMMARY

- PARCEL - A: PORTION OF SECTION 27
T. 16 S., R. 15 E., M.D.B. & M.
- PARCEL - B: PORTION OF SECTION 28
T. 16 S., R. 15 E., M.D.B. & M.
- PARCEL - C: PORTION OF SECTION 34
T. 16 S., R. 15 E., M.D.B. & M.
- PARCEL - D: PORTION OF SECTION 3
T. 17 S., R. 15 E., M.D.B. & M.

LEGEND

- 000-000-00(X) ASSESSOR PARCEL NUMBER (A.P.N.)
- PARCEL LOCATED WITHIN EXISTING COUNTY SERVICE AREA (CSA)
- EXISTING SPHERE OF INFLUENCE (SOI)
- PARCEL LOCATED WITHIN PROPOSED BOUNDARY
- PARCEL LINE
- PROPOSED BOUNDARY LINE

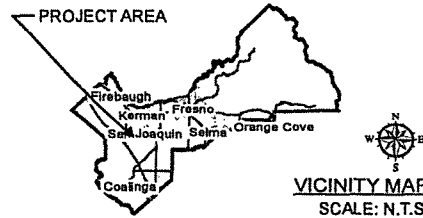

E 202110000093