

# Vertical Integration - Shell Creek 2 Site Plan

Permit Number: DRC 2020-00011

PROJECT DESCRIPTION: 3 acres outdoor cannabis cultivation in 3.75 acres of hoop structures

## VICINITY MAP

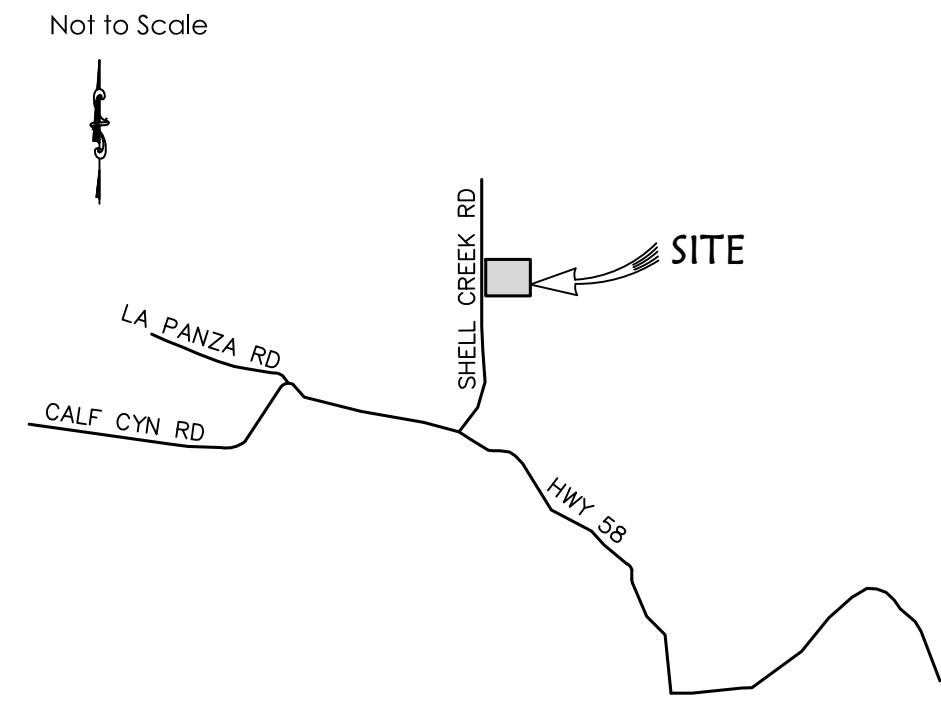

## INDEX MAP

SCALE: 1" = 1000'

FOR THE FOLLOWING: P-12 SCHOOL, LIBRARY, PARK, PLAYGROUND, RECREATION OR YOUTH CENTER, LICENSED DRUG OR ALCOHOL RECOVERY FACILITY, OR LICENSED SOBER LIVING FACILITY, ALL THESE FACILITIES ARE GREATER THAN 1,000 FEET FROM THE PROPOSED PROJECT.

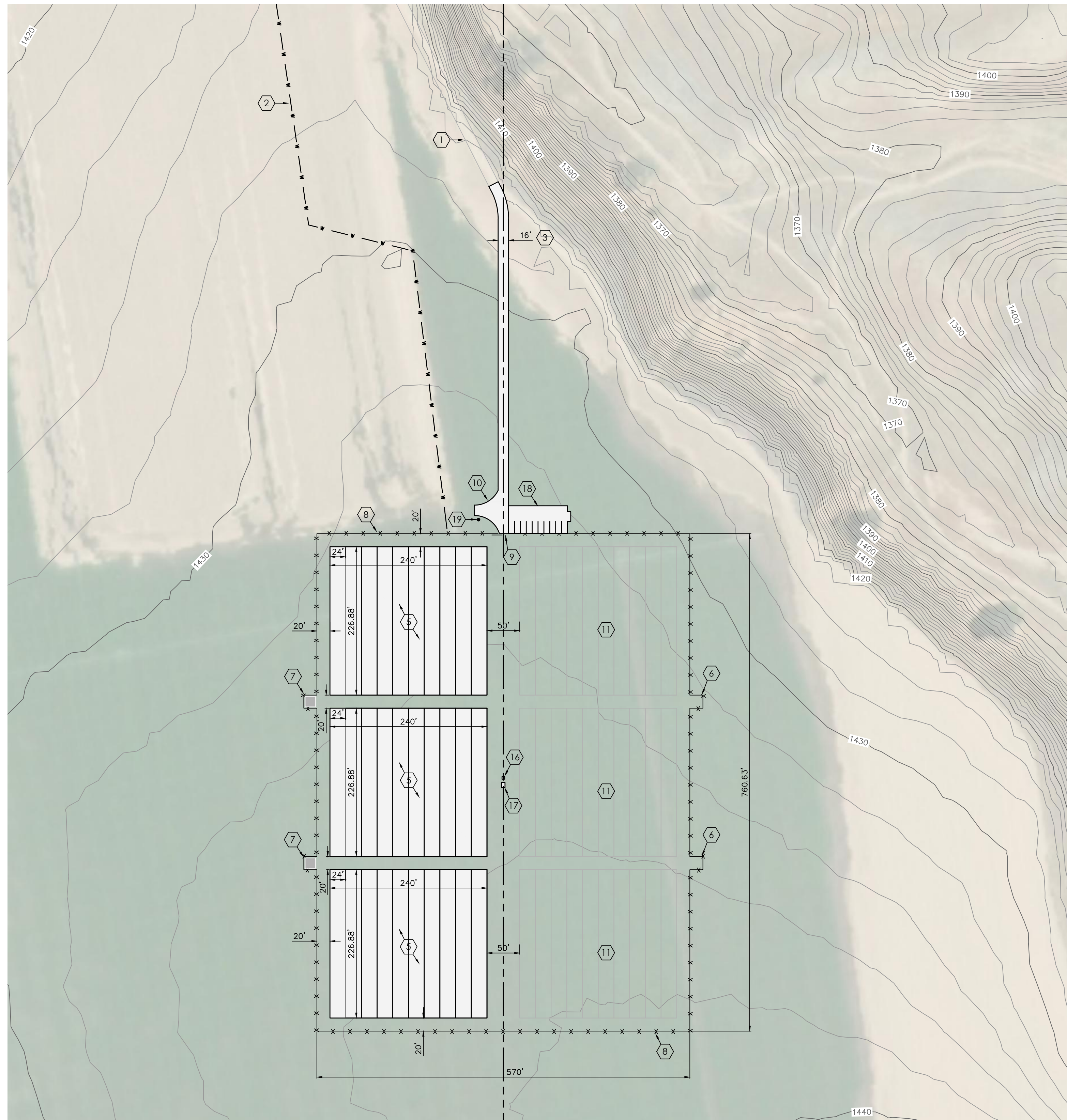
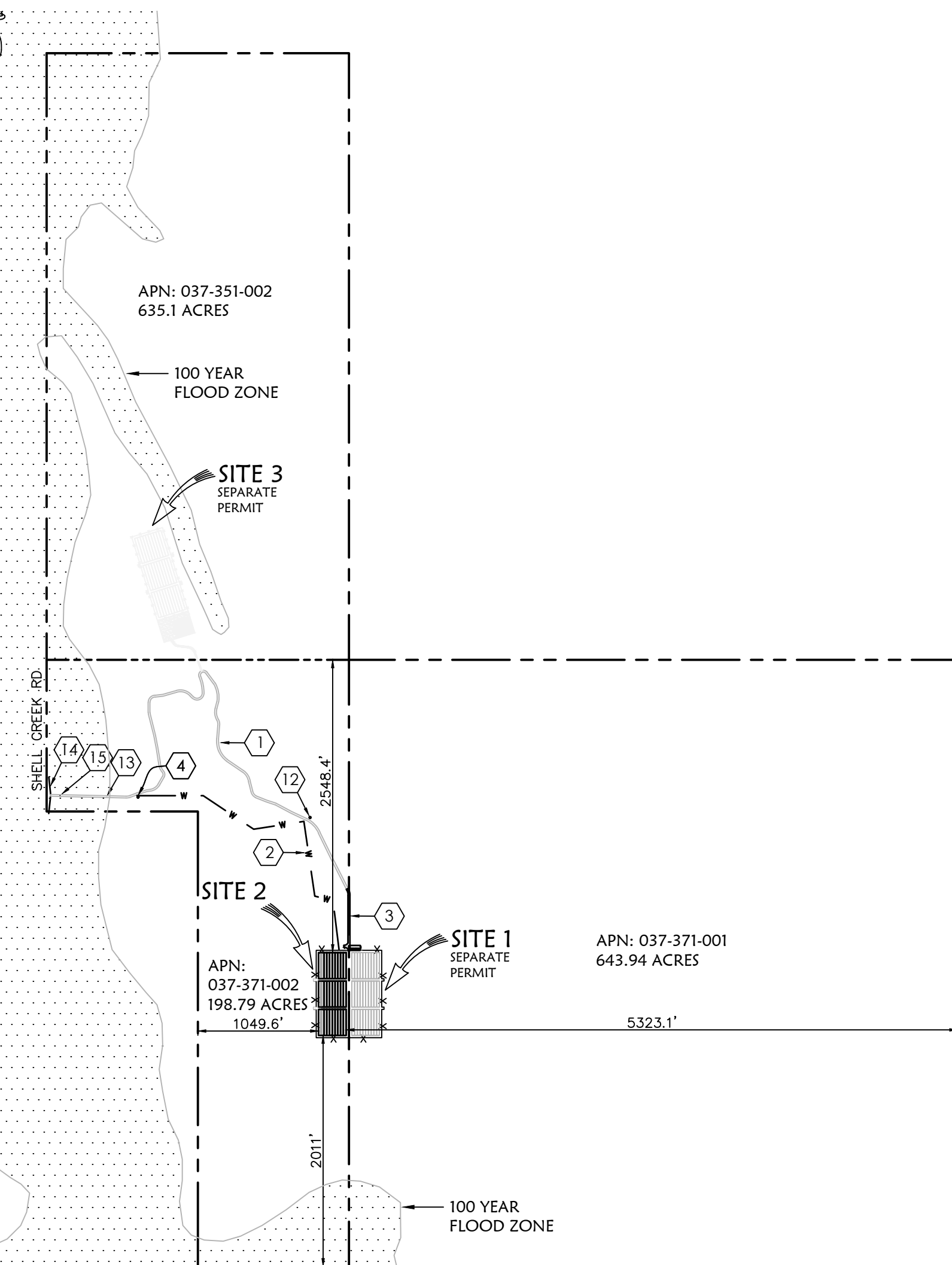

## SITE PLAN AND INDEX MAP NOTES

- 1 EXISTING 16' WIDE DG BASE ACCESS ROAD TO REMAIN.
- 2 EXISTING 10" TO 6" BELOW GROUND PVC IRRIGATION PIPE.
- 3 PROPOSED 16' DG BASE ACCESS ROAD TO CULTIVATION SITE PER CAL FIRE STANDARDS.
- 4 EXISTING WELL LOCATION = 35.4953093°, 120.3264312°. SEE INDEX MAP FOR LOCATION. WELL OUTPUT = 1000 GPM WITH 175HP PUMP. SEE DETAIL SHEET FOR WATER TREATMENT AND IRRIGATION PLAN.
- 5 NEW CULTIVATION SITE, 3 SETS OF 10 HOOP HOUSES AT 226.9' L X 240' W X 12' H, FOR 3 ACRES CANOPY IN 3.75 ACRE FOOTPRINT.
- 6 PROPOSED COMPOST AREA, 20'X20'
- 7 PROPOSED 10'X20' SEATRIN FOR EQUIPMENT STORAGE. SEE DETAIL SHEET.
- 8 6' HIGH GALVANIZED STEEL FENCE WITH BEIGE PRIVACY SLATS IN 10 ACRE FOOTPRINT. SEE DETAIL SHEET.
- 9 CONSTRUCT 16' WIDE SLIDING GATE.
- 10 CONSTRUCT CAL FIRE TURN AROUND PER CAL FIRE STANDARDS.
- 11 ADJACENT CULTIVATION SITE DRC2020-00012 ON PAN 037-371-001 TO UTILIZE SHARED ACCESS AND FACILITIES.
- 12 INSTALL NEW 10,000 GALLON METAL WATER TANK ON 8" OF CL II AB COMPACTED TO 90%, TO BE SHARED BY ALL THREE SITES.
- 13 VENDOR MEETING LOCATION, SEE INDEX MAP.
- 14 PROPOSED COUNTY STD. B-1a RURAL DRIVEWAY, SEE INDEX MAP.
- 15 6' HIGH SECURITY GATE WITH KNOX BOX.
- 16 PORTABLE TOILET.
- 17 SOLID WASTE BIN.
- 18 CLASS II AG BASE PARKING AREA, 10 SPACES, 9'X18'.
- 19 CAL FIRE APPROVED WHARF HEAD HYDRANT.

## SITE DISTURBANCE TABLE \*

	AREA OF DISTURBANCE (SF)	EARTHWORK (CUT/FILL) (CY)
ACCESS 16' ROAD EXTENSION	8576	317 / 244
FENCING	5610	9 / 0
STORAGE	550	4 / 3
WATER TREATMENT	3000	0 / 0
PARKING AREA	3855	214 / 165
TOTAL=	21,591	544 / 412

\* SITE DISTURBANCE IS FOR SHARED USE WITH PROJECT AND DRC2020-00012

## OWNER

ROBERT AND GARRETT MORRISON  
9330 CAMAITA CREEK ROAD  
SANTA MARGARITA, CA 93465  
(805) 235-0820

APN: 037-371-002

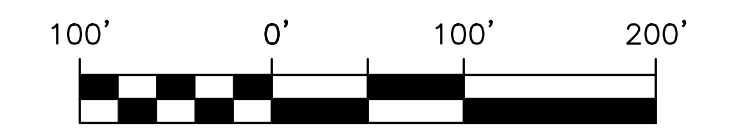

SCALE: 1" = 100'

Roberts Engineering, Inc.

DRC2020-00011 FOR APN 037-371-002 - SANTA MARGARITA

Vertical Integration - Shell Creek 2 Site Plan

Design/Drawn TR / SEB	County Plan Checker	Approved for County Requirements
Job # 20-05	County W.O. No.	Development Services Engineer Date 5/18/2020
California Coordinates (CCS83, Zone 5) 2373217 N 5870824 E	County Road #	Timothy P. Roberts, RCE 35366 exp 09/30/21 Date 1



**Roberts Engineering**  
Timothy P. Roberts  
Civil Engineer - RCE 35366  
2015 Vista de la Vina  
Templeton, CA 93465  
Phone (805) 239-0664  
Fax (805) 238-6148  
Email tim@robertsenginc.com  
Website robertsenginc.com

Record Drawings	
Timothy P. Roberts, RCE 35366 exp 09/30/21	Date
Revisions This Sheet:	
1	
2	
3	
4	
5	
6	

5/18/2020 12:44 PM

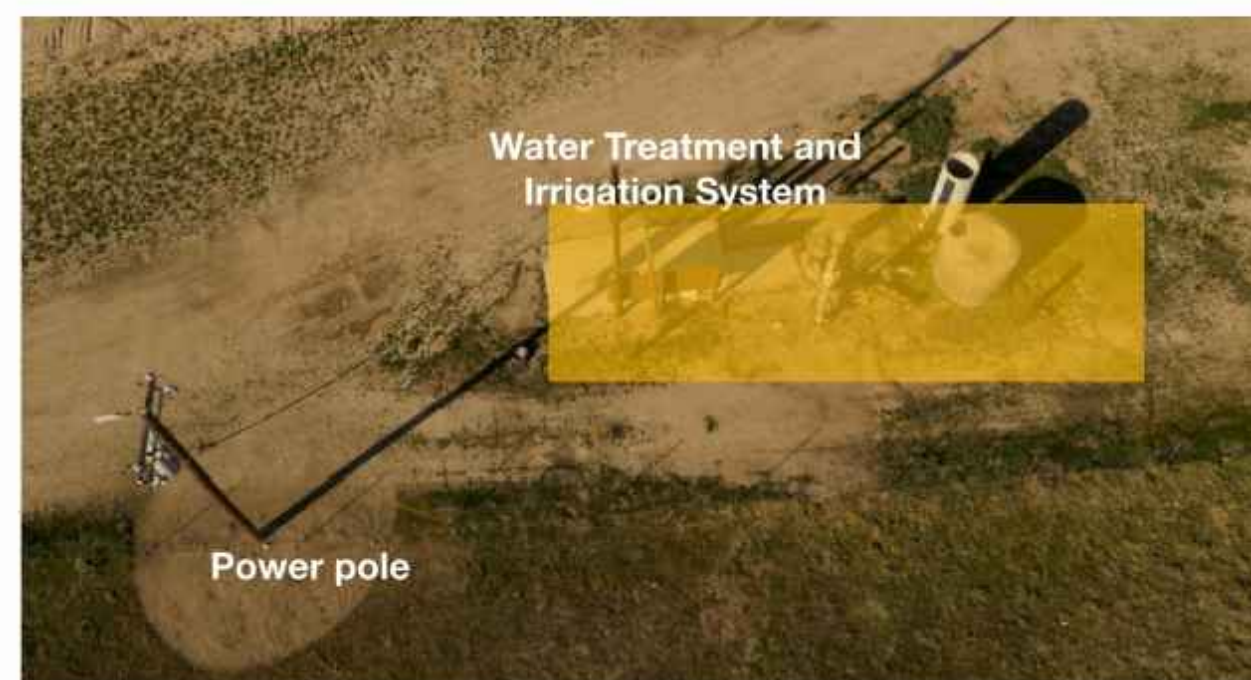
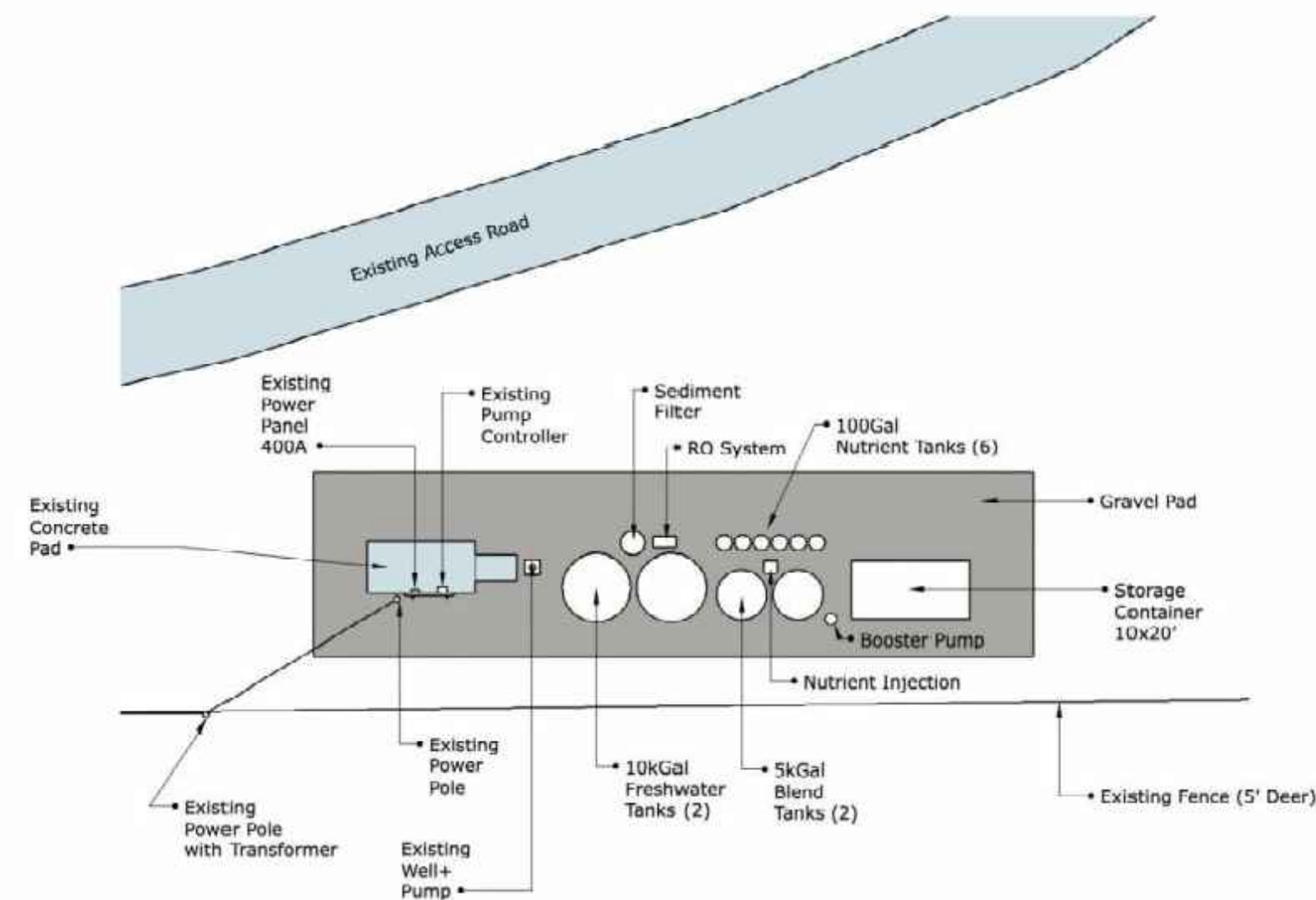
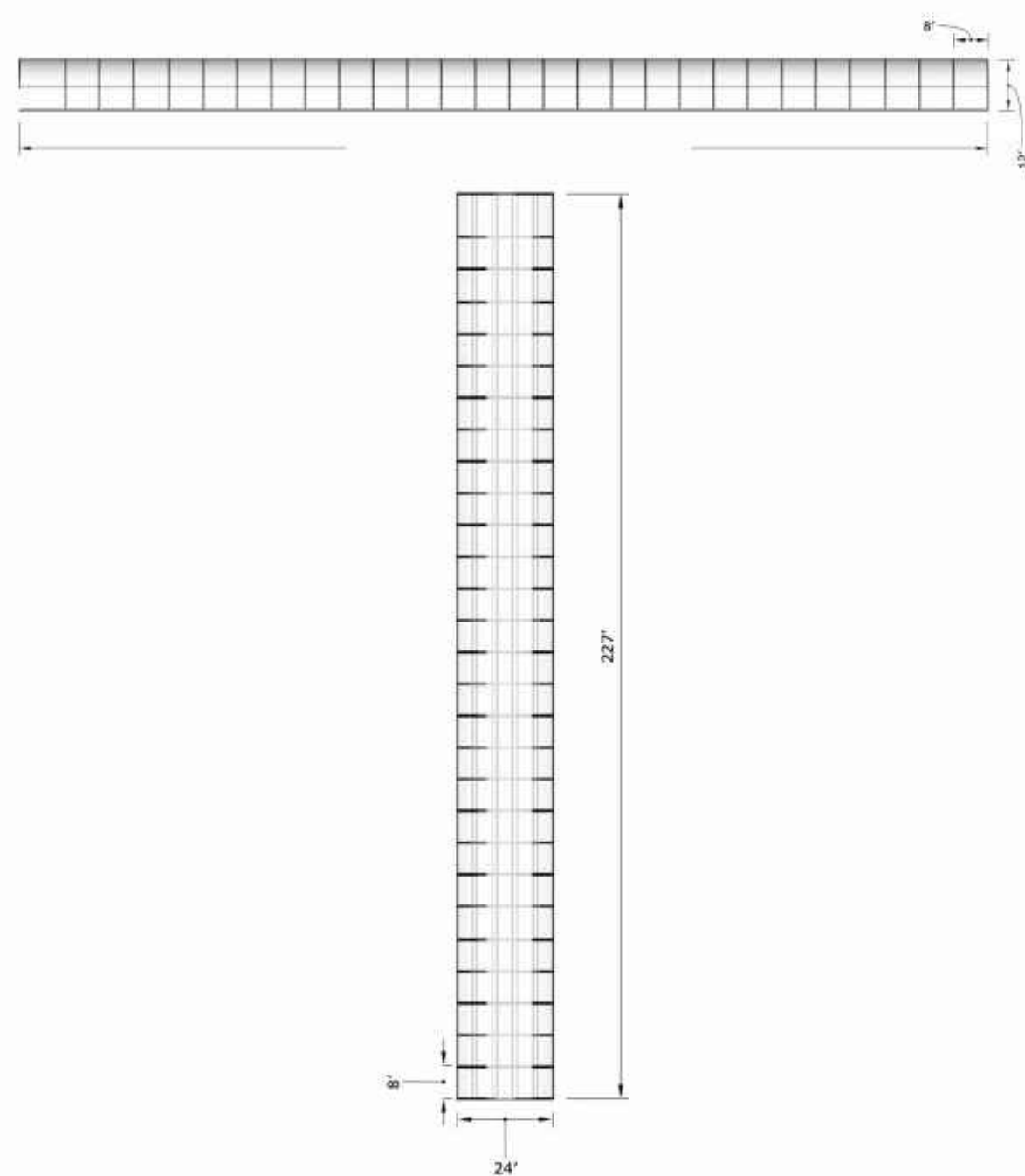

WATER TREATMENT AND IRRIGATION DETAILS



FENCING DETAIL



EQUIPMENT STORAGE DETAILS

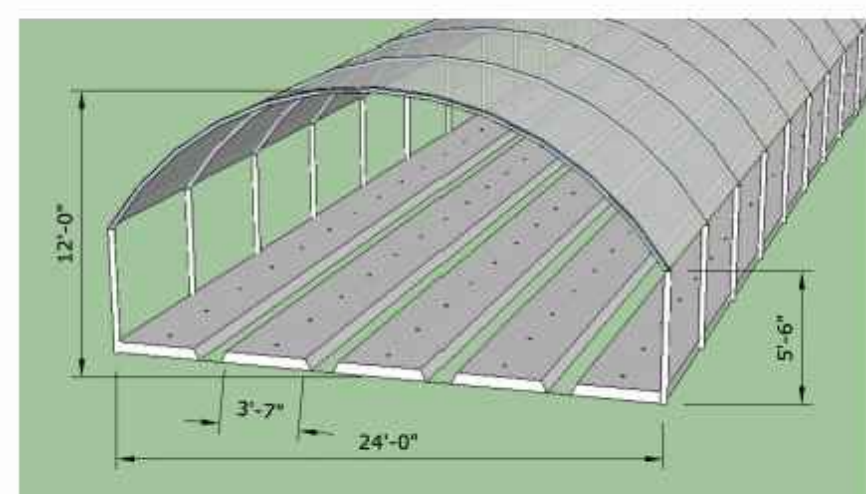

HOOP STRUCTURE DETAILS

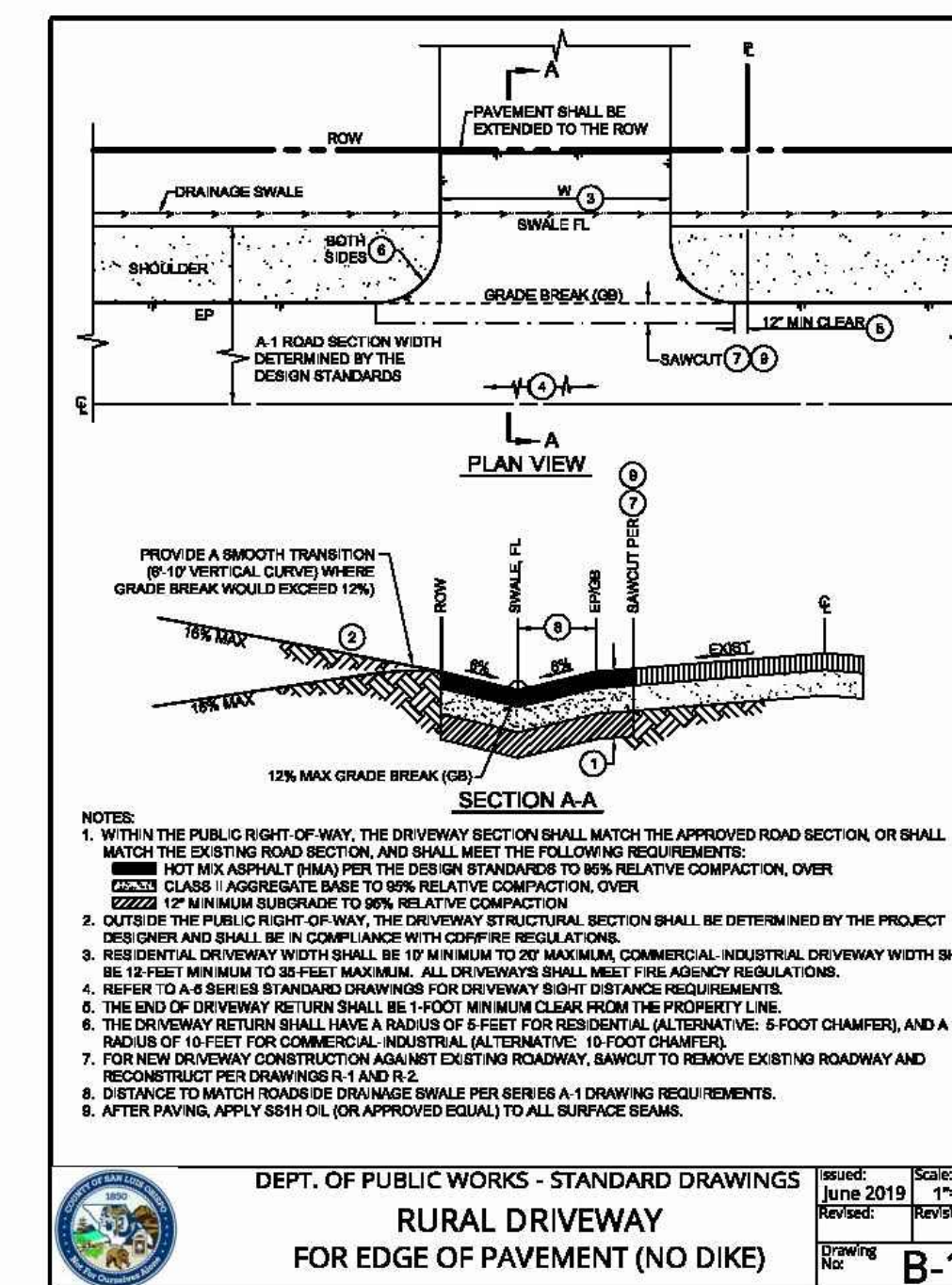
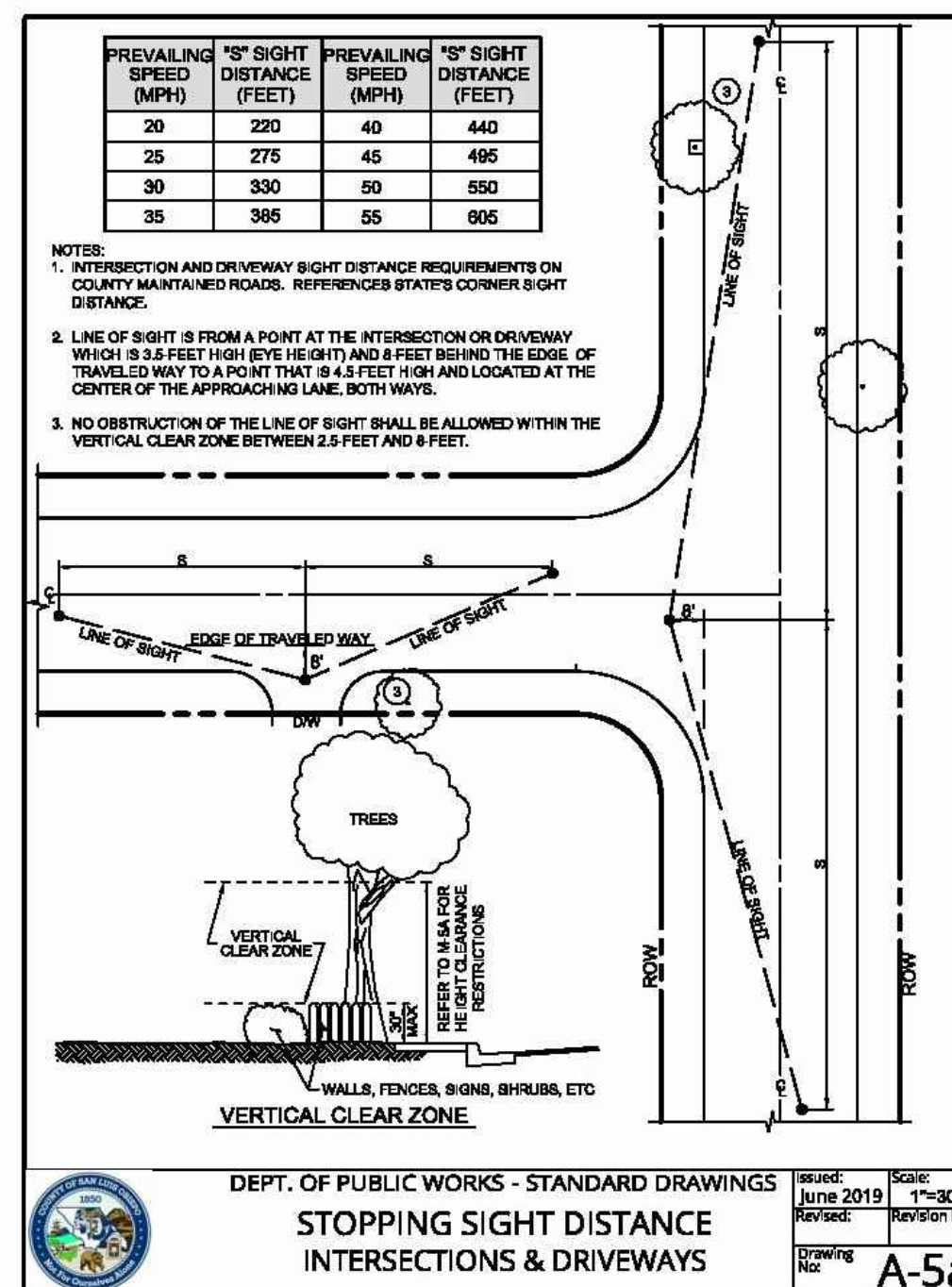

Roberts Engineering, Inc.  
DRC2020-00011 FOR APN 037-371-002 - SANTA MARGARITA

Detail Sheet

Design/Drawn TR / SEB	County Plan Checker	Approved for County Requirements
Job # 20-05	County W.O. No.	Development Services Engineer Date: 5/18/2020
California Coordinates (CCS83, Zone 5)	County Road #	Timothy P. Roberts, RCE 35366 exp 09/30/21 Date: 5/18/2020
2373217 N 5870824 E		2 of 2

Roberts Engineering  
Timothy P. Roberts  
Civil Engineer - RCE 35366  
2015 Vista de la Vina  
Templeton, CA 93465  
Phone (805) 239-0664  
Fax (805) 238-6148  
Email tim@robtsenginc.com  
Website: robertsenginc.com

Record Drawings

Timothy P. Roberts, RCE 35366 exp 09/30/21	Date
Revisions This Sheet:	
1	
2	
3	
4	
5	

5/15/2020 12:44 PM