

# Appendix D

---

1957 Forebay Design

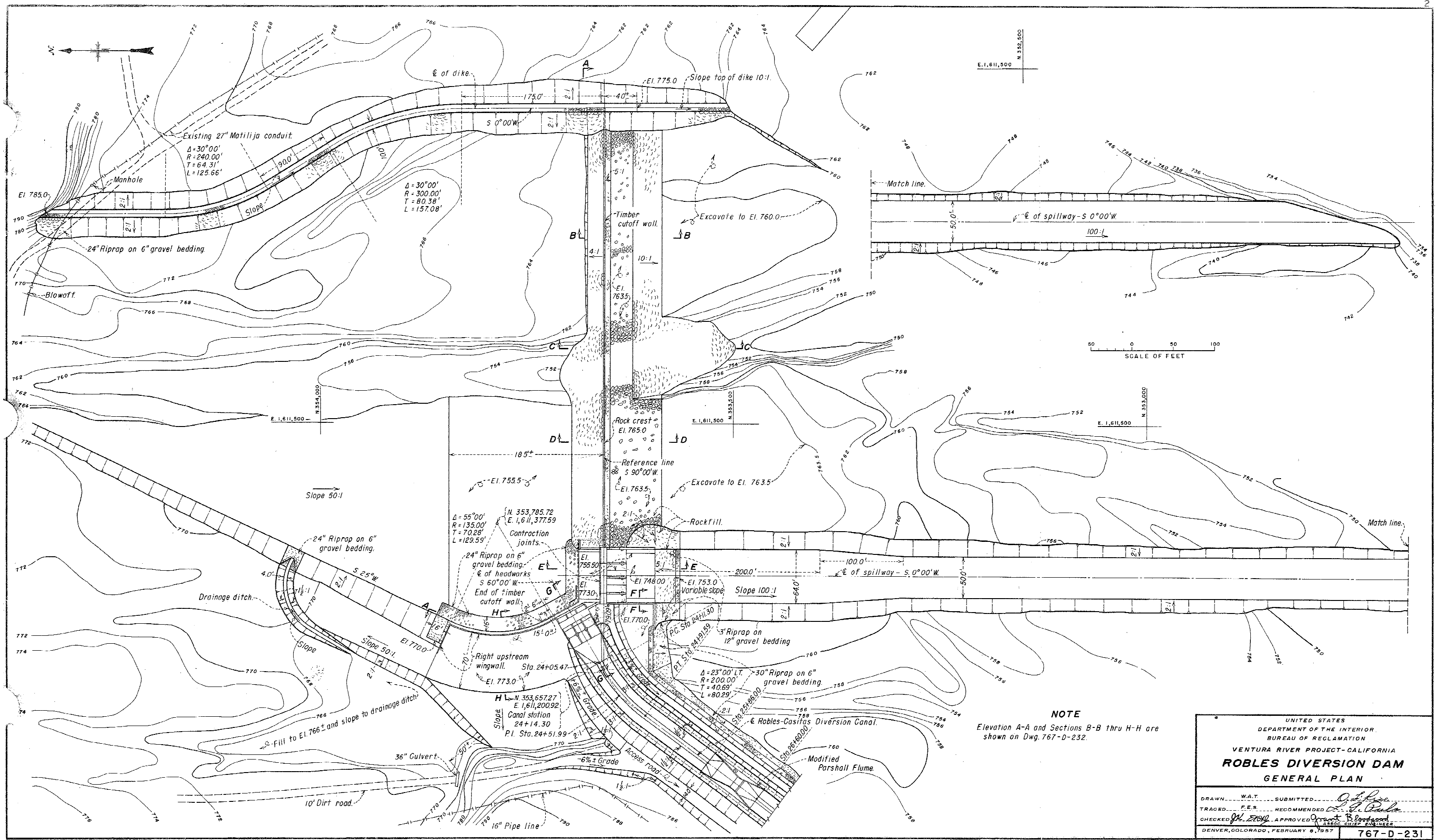

**NOTE**  
Elevation A-A and Sections B-B thru H-H are shown on Dwg. 767-D-232.

UNITED STATES  
DEPARTMENT OF THE INTERIOR  
BUREAU OF RECLAMATION  
VENTURA RIVER PROJECT-CALIFORNIA  
**ROBLES DIVERSION DAM**  
GENERAL PLAN

---

DRAWN W.A.T. SUBMITTED [Signature]  
 TRACED F.E.S. RECOMMENDED [Signature]  
 CHECKED [Signature] APPROVED [Signature]  
 ASSOC. CHIEF ENGINEER

DENVER, COLORADO, FEBRUARY 8, 1957 **767-D-231**