

JAN 30 2023

RECEIVED WITH FEE  
RECEIPT # 151491103

NOTICE OF DETERMINATION  
(CALIFORNIA ENVIRONMENTAL QUALITY ACT OF 1970) AIMEE X. ESPINOZA  
AUDITOR CONTROLLER-COUNTY CLERK  
BY [Signature] DEPUTY

TO WHOM IT MAY CONCERN:

1. The Board of Supervisors of the County of Kern has approved the following described project in the County of Kern, State of California:
  - a. Applicant, or sponsoring agency or department: Erin Hambrick & Phillip Moores (original applicant – CalPortland Company by Harrison, Temblador, Hungerford & Guernsey);
  - b. Name of Project: Appeal No. 3, Map No. 214 ;
  - c. Street Address/Cross-Street of Project: West side of Mojave Tropico Road, approximately two (2) miles south of Backus Road; unincorporated Eastern Kern County  
  
Map of Project (if no street address): Attached
  - d. Description of Project An appeal of the decision of the Planning Commission approving Conditional Use Permit No. 45, Map No. 214 (approved November 10, 2022; Resolution No. 99-22) which allowed surface mining operations, including associated reclamation plan for the Gem Hill Quarry on a 210-acre project site that includes a maximum disturbance area of 82 acres in accordance with the Surface Mining and Reclamation Act (SMARA) of 1975 (Section 19.12.030.G) in an A (Exclusive Agriculture) District. The project includes an off-site access road connecting the project site to Mojave Tropico Road.
2. Approval – Summary of Proceedings: Deny appeal; Certify the Environmental Impact Report; Adopt section 15091 findings of fact and section 15093 statement of overriding considerations; Adopt Mitigation Measure Monitoring Program; Adopt resolution and recommended findings approving Condition Use Permit No. 45, Map No. 214, subject to recommended revised conditions.

Adoption date January 24, 2023, Item No. 5 2:00 p.m.

3. The Board of Supervisors of the County of Kern has determined that the project in its approved form will have a significant effect on the environment.
4. An Environmental Impact Report (EIR) and a Mitigation Measure Monitoring Program were prepared pursuant to California Environmental Quality Act of 1970 (CEQA) and the State CEQA Guidelines and were received and considered by this Board and certified as required by Section 15090 the State CEQA Guidelines.
5. Mitigation measures and a Mitigation Measure Monitoring Program were made as conditions of approval of the project. Findings were made pursuant to Section 15091 of the State CEQA Guidelines. A Statement of Overriding Considerations was adopted for the project, pursuant to Section 15093 of the State CEQA Guidelines.

230295

6. A copy of the EIR may be examined by any interested person during regular business hours at the following location: Kern County Administrative Center, 1115 Truxtun Avenue, Fifth Floor, Bakersfield, California 93301, Telephone No. 868-3585.

Lorelei H. Oviatt, AICP, Director  
Planning and Natural Resources Department  
County of Kern, State of California

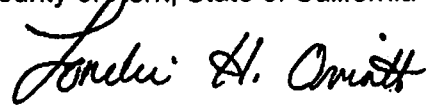

Telephone No. 862-8600

By: \_\_\_\_\_

RPC:cc (01/25/2023)

**FINAL**  
**Environmental Impact Report**

SCH# 2021110076

**Volume 1**  
Chapters 1 through 11

**GEM HILL QUARRY PROJECT**  
by CalPortland Company (PP21404)

Conditional Use Permit No. 45, Map No. 214



Kern County  
Planning and Natural Resources Department  
Bakersfield, California

November 10, 2022

**Figure 1**  
**Appeal No. 3,**  
**Map No. 214**

**Vicinity Map**

Gem Hill Quarry  
 By: CalPortland Company

 210.75-acre Project Site  
 (210-acre Mine and  
 Reclamation Plan  
 Boundary plus  
 0.75-acre Primary  
 Access Road)

 STATE HWY

 Arterials

 Kern County Boundary

 Township/Range

 Sections

Created on: 12/14/22

APN's:  
 345-031-02, 345-032-02,  
 345-032-05, 345-032-31  
 & 345-294-17

T10N/R13W - Sec. 25, 26, 35, 36



0 2,900 5,800 8,700 11,600 Feet



Kern County  
 Planning & Natural  
 Resources Department

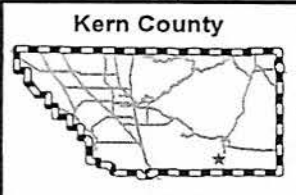
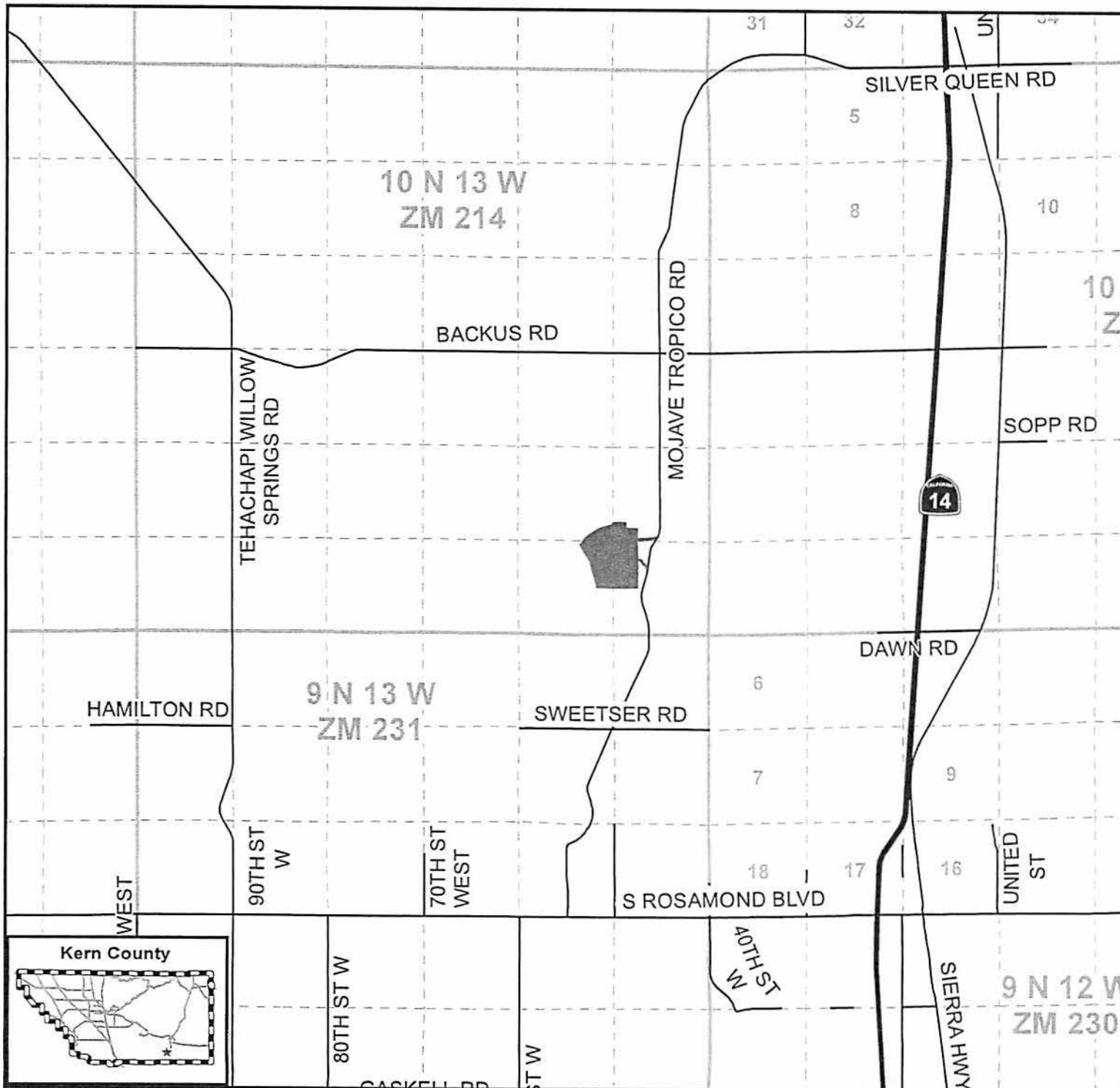

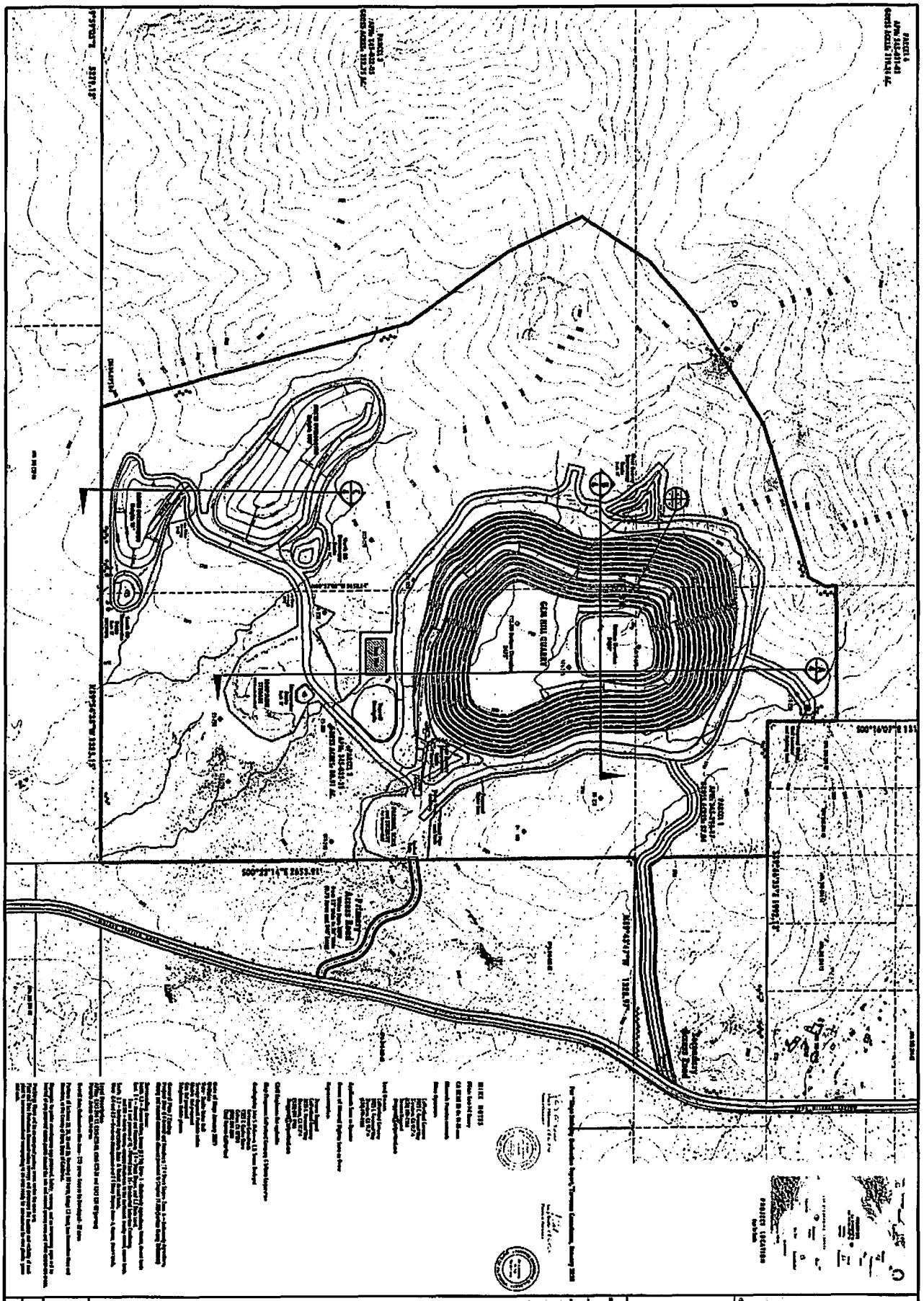

**Figure 6**  
**Appeal No. 3, Map No. 214**  
**Mine Plan**

Scale 1:25,000  
 Date 1968  
 Sheet 2 of 4

**LEGEND**

- Contour Lines
- Roads
- Paths
- Utility Lines
- Structures
- Water Features
- Vegetation
- Other Symbols

**APPENDIX**

**LIBURN**

1968 Survey, to 1968 of 1968





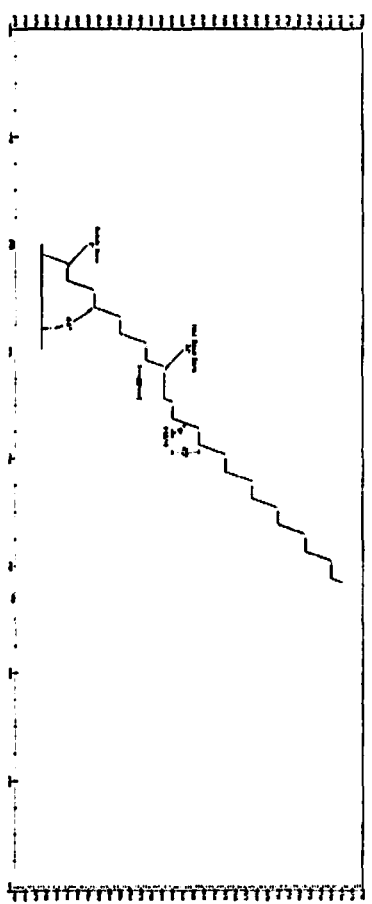
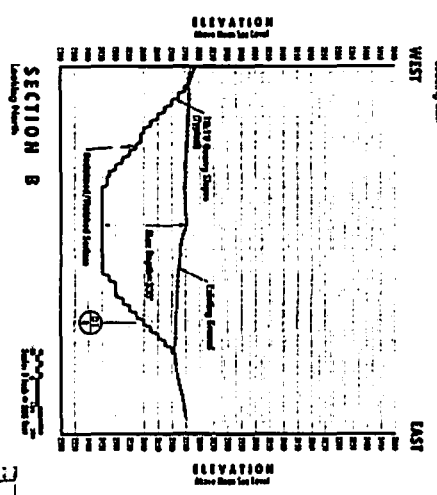
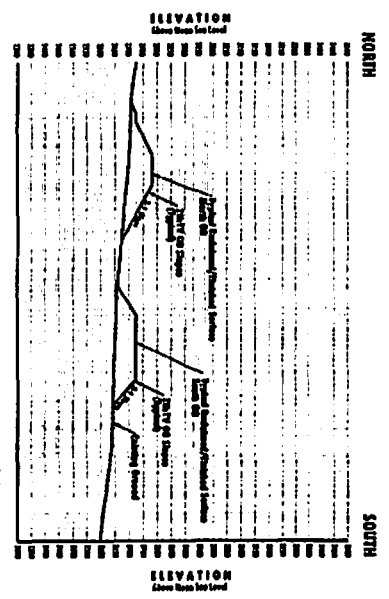
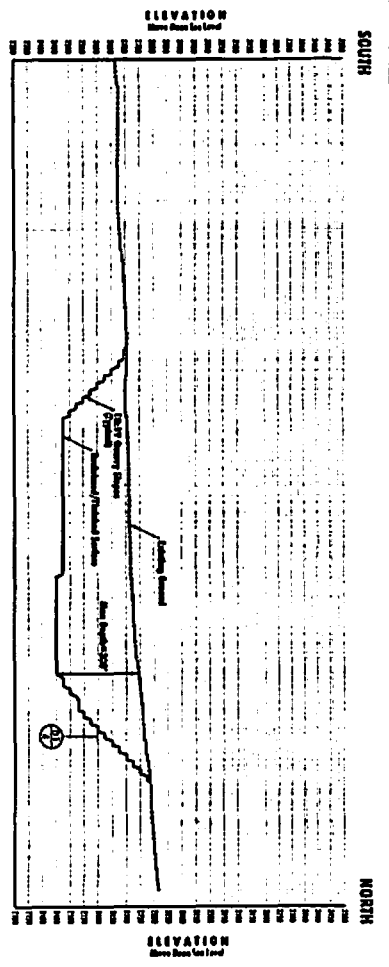

Typical Band Profile  
 Typical Band Profile with Pipe

**Figure 8**  
**Appeal No. 3, Map No. 214**  
**Cross Sections and Details**

**LEGEND**



State of California - Department of Fish and Wildlife  
**2022 ENVIRONMENTAL FILING FEE CASH RECEIPT**  
 DFW 753.5a (Rev. 1/01/22) Previously DFG 753.5a

RECEIPT NUMBER: 15 — 11152022 — 15148686
STATE CLEARINGHOUSE NUMBER (if applicable)

SEE INSTRUCTIONS ON REVERSE. TYPE OR PRINT CLEARLY.

LEAD AGENCY KERN COUNTY PLANNING AND NATURAL RESOURCES		LEAD AGENCY EMAIL		DATE 11/15/2022
COUNTY/STATE AGENCY OF FILING Kern				DOCUMENT NUMBER 22689
PROJECT TITLE PP21404- GEM HILL QUARRY PROJECT (PP21404); CUP NO. 45, MAP NO. 214 (SCH #2021110076)				
PROJECT APPLICANT NAME CALPORTLAND COMPANY		PROJECT APPLICANT EMAIL		PHONE NUMBER ( 626 ) 691-1966
PROJECT APPLICANT ADDRESS 2025 E. FINANCIAL WAY		CITY GLENORA	STATE CA	ZIP CODE 91741
PROJECT APPLICANT (check appropriate box)				
<input type="checkbox"/> Local Public Agency <input type="checkbox"/> School District <input type="checkbox"/> Other Special District <input type="checkbox"/> State Agency <input checked="" type="checkbox"/> Private Entity				

CHECK APPLICABLE FEES:

<input checked="" type="checkbox"/> Environmental Impact Report (EIR)	\$3,539.25	\$	<u>3539.25</u>	<u>3,343.25</u>
<input type="checkbox"/> Mitigated/Negative Declaration (MND)(ND)	\$2,548.00	\$		<u>0.00</u>
<input type="checkbox"/> Certified Regulatory Program document (CRP)	\$1,203.25	\$		<u>0.00</u>

- Exempt from fee
- Notice of Exemption (attach)
  - CDFW No Effect Determination (attach)
- Fee previously paid (attach previously issued cash receipt copy)

<input type="checkbox"/> Water Right Application or Petition Fee (State Water Resources Control Board only)	\$850.00	\$		<u>0.00</u>
<input checked="" type="checkbox"/> County documentary handling fee		\$		<u>50.00</u>
<input type="checkbox"/> Other		\$		

PAYMENT METHOD:

- Cash     Credit     Check     Other

TOTAL RECEIVED \$ 3539.25 3,539.25

SIGNATURE  X                      JL	AGENCY OF FILING PRINTED NAME AND TITLE J. LOZANO, KERN COUNTY CLERK, ADMINSTR COORD
--------------------------------------------	-----------------------------------------------------------------------------------------





State of California - Department of Fish and Wildlife  
**2023 ENVIRONMENTAL FILING FEE CASH RECEIPT**  
 DFW 753.5a (Rev. 1/01/23) Previously DFG 753.5a

RECEIPT NUMBER: — 01302023 — 15149663
STATE CLEARINGHOUSE NUMBER (if applicable)

SEE INSTRUCTIONS ON REVERSE. TYPE OR PRINT CLEARLY.

LEAD AGENCY KERN COUNTY PLANNING AND NATURAL RESOURCES	LEAD AGENCY EMAIL	DATE 1/30/2023
COUNTY/STATE AGENCY OF FILING Kern	DOCUMENT NUMBER 23695	

PROJECT TITLE  
 PP21404-GEM HILL QUARRY PROJECT (PP21404); APPEAL NO. 3, MAP NO. 214 (APPEAL OF CUP NO.45, MAP NO. 214)

PROJECT APPLICANT NAME APPELLANT: ERIN HAMBRICK & PHILLIP MOORES; ORIGIN	PROJECT APPLICANT EMAIL	PHONE NUMBER ( 626 ) 691-1966
-----------------------------------------------------------------------------	-------------------------	----------------------------------

PROJECT APPLICANT ADDRESS 2025 E. FINANCIAL WAY	CITY GLENDDORA	STATE CA	ZIP CODE 91741
----------------------------------------------------	-------------------	-------------	-------------------

PROJECT APPLICANT (check appropriate box)

Local Public Agency   
  School District   
  Other Special District   
  State Agency   
  Private Entity

CHECK APPLICABLE FEES:

<input type="checkbox"/> Environmental Impact Report (EIR)	\$3,839.25	\$	_____
<input type="checkbox"/> Mitigated/Negative Declaration (MND)(ND)	\$2,764.00	\$	_____
<input type="checkbox"/> Certified Regulatory Program document (CRP)	\$1,305.25	\$	_____

Exempt from fee  
      Notice of Exemption (attach)  
      CDFW No Effect Determination (attach)  
 Fee previously paid (attach previously issued cash receipt copy)

<input type="checkbox"/> Water Right Application or Petition Fee (State Water Resources Control Board only)	\$850.00	\$	_____
<input checked="" type="checkbox"/> County documentary handling fee		\$	_____ 50.00
<input type="checkbox"/> Other _____		\$	_____

PAYMENT METHOD:

Cash   
  Credit   
  Check   
  Other

**TOTAL RECEIVED**    \$    \_\_\_\_\_ 50.00

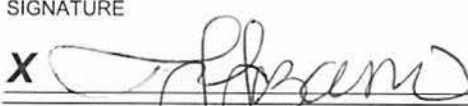
SIGNATURE 	AGENCY OF FILING PRINTED NAME AND TITLE J. LOZANO, KERN COUNTY CLERK, ADMINISTR COORD
-------------------------------------------------------------------------------------------------	------------------------------------------------------------------------------------------

0123.793

RECEIVED WITH FEE  
CEQA Transmittal #5582  
RECEIPT # 15149403  
Submitted to # 1/27/2023 8:03:38 AM by TORRES, ALYSSA A  
Department

JAN 30 2023

AIMEE X. ESPINOZA  
AUDITOR CONTROLLER-COUNTY CLERK  
BY [Signature] DEPUTY

Enter CEQA Information

Lead Agency: KERN COUNTY PLANNING AND NATURAL RESOURCES DEPARTMENT

Project Title: PP21404-GEM HILL QUARRY PROJECT (PP21404); APPEAL NO. 3, MAP NO. 214

Project Applicant Name: APPELLANT: ERIN HAMBRICK & PHILL... Phone Number: (626) 691-1966

Address: 2025 E. FINANCIAL WAY City: GLENDORA

State: CA ZIP: 91741

Posting Period:  30 Days  45 Days  Other 30

Project Applicant Type: Private Entity

Select Fee

Notice of Intent  Notice of Availability

Notice of Public Hearing  Notice of Preparation

Mitigated Negative Declaration/Negative Declaration  Notice of Exemption

Environmental Impact Report

Other

No Fish & Wildlife Fee Previously paid on F&W ReceiptNumber: 1511152022...

Total: \$50.00

Proof of Payment

Please enter Proof of Payment:

Additional Information

Reference Number:

JV ACCT STRING  
24010/ 2750 /5730 \$ 50.00

Notes:

Enter JV Information (if needed)

JV Sequence Number 837408 (/journalvouchers/CreateJV.aspx?jvHeaderId=837408)

OK/IMG

23095

Kern County  
Clerks Office  
1115 Truxtun Ave  
Bakersfield CA 93301  
661-868-3588

CEQA  
County Clerk Fee  
#23695

1 @ \$50.00  
**\$50.00**

**Total**

**\$50.00**

JV #837408

\$50.00

Change

\$0.00

ORDER NO: 555357  
MAIL  
1/30/2023 9:27:30 AM  
BAKERSFIELD  
JENNIFER LOZANO