



E202110000218

County of Fresno

DEPARTMENT OF PUBLIC WORKS AND PLANNING
STEVEN E. WHITE, DIRECTOR

NOTICE OF EXEMPTION

- TO: Office of Planning and Research
1400 Tenth Street, Room 121
Sacramento, CA 95814
- County Clerk, County of Fresno
2221 Kern Street
Fresno, CA 93721

FILED
SEP 08 2021 TIME 9:17am
By *[Signature]*
FRESNO COUNTY CLERK
Jessica Munoz DEPUTY
For County Clerk's Stamp

FROM: Fresno County Department of Public Works and Planning
Development Services and Capital Projects Division
2220 Tulare Street (corner of Tulare and "M") Suite "A", Fresno, CA 93721

PROJECT TITLE: Environment Review No. 8010 – Slurry Seal 20-2021

PROJECT APPLICANT/SPONSOR: Christian Montoya, Fresno County Department of Public Works and Planning, Design Division

PROJECT LOCATION – COUNTY: See attached List of Locations and a Location Map.

DESCRIPTION OF PROJECT: The project proposes to place slurry seals, crack sealing, crack filing, and small asphalt patching on approximately 24.424 miles of existing residential roads in Fresno County.

NAME OF PUBLIC AGENCY APPROVING PROJECT: Fresno County Board of Supervisors

NAME OF PERSON OR AGENCY CARRYING OUT PROJECT: County of Fresno

EXEMPT STATUS: Categorical exemption: Section 15301(c), Existing Facilities

REASONS WHY THE PROJECT IS EXEMPT: The subject application proposes to place slurry seals, crack sealing, crack filing, and small asphalt patching on approximately 24.424 miles of existing residential roads in Fresno County. There is no ground-disturbance, development, or increase to traffic lanes proposed, therefore no impact to cultural, historical, or transportation facilities will occur. The project is not located within a special flood hazard/wetland area. The work involved will be located within existing right-of-way, therefore no impacts to biological resources or hazardous waste sites will occur.

LEAD AGENCY CONTACT PERSON: Ejaz Ahmad AREA CODE/TELEPHONE: (559) 600-4204

If filed by the applicant:

- Attach certified document of exemption finding.
- Has a Notice of Exemption been filed by the public agency approving the project?
 Yes No

Signature: *[Signature]* Date: 2-11-21
David Randall, Senior Planner

- Signed by Lead Agency Date received for filing at OPR: _____
 Signed by Applicant

G:\4360Devs&PIn\PROJSEC\PROJDOCS\Environmental\Exemptions - Exclusions - CE(N)\ST\8000-8999\ER 8010 Slurry Seal 20-2021\ER 8010 NOE.docx

LOCATION MAP

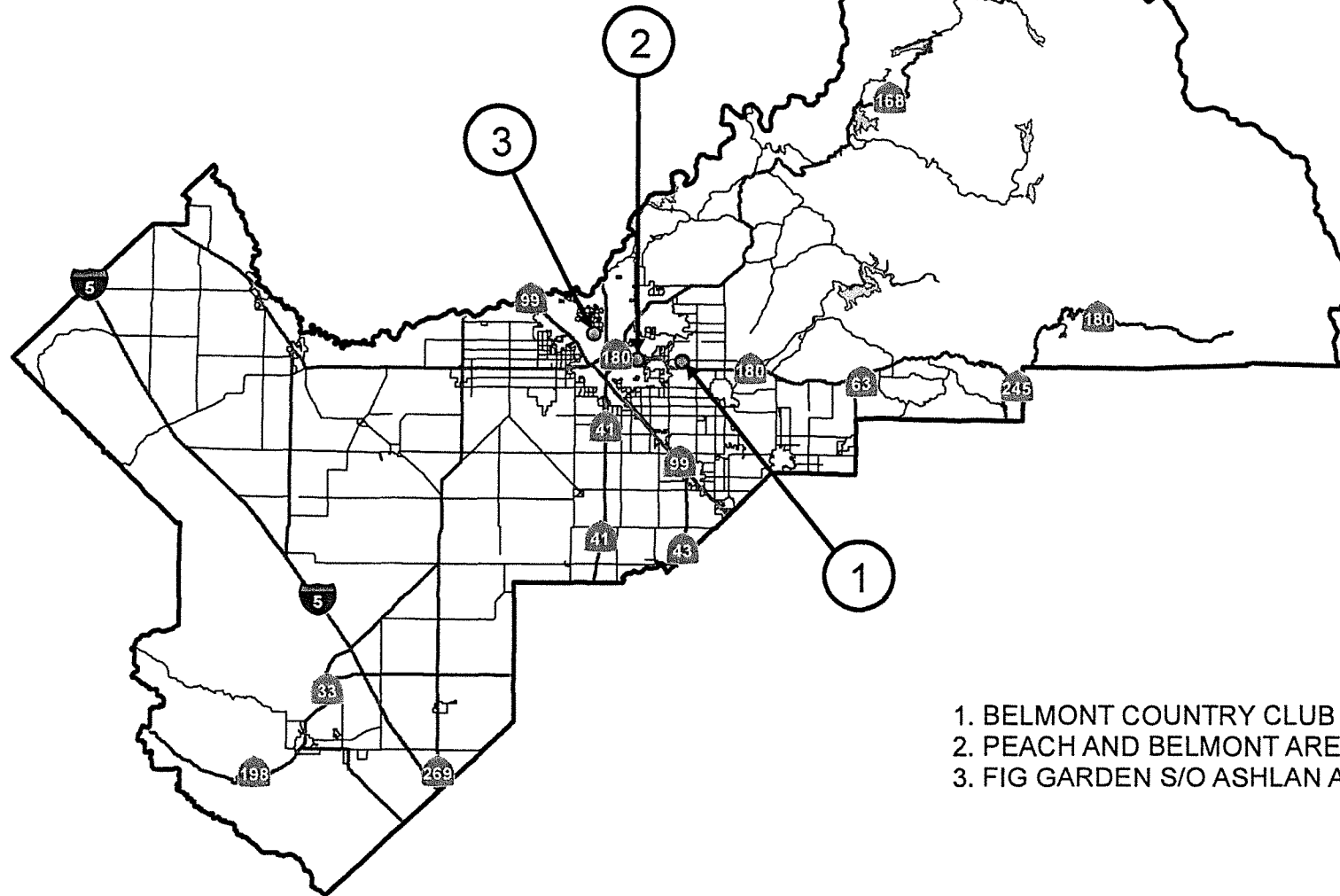

- 1. BELMONT COUNTRY CLUB AREA
- 2. PEACH AND BELMONT AREA
- 3. FIG GARDEN S/O ASHLAN AVE AREA

E202110000218

DATE:		NO SCALE			DEPARTMENT OF PUBLIC WORKS & PLANNING	
DESIGNED:	C.M.	01/12/2021	2020-2021 SLURRY SEAL VARIOUS LOCATIONS IN FRESNO COUNTY CONTRACT NUMBER 20-13-M			
DRAWN:	C.M.	01/12/2021				
CHECKED:						

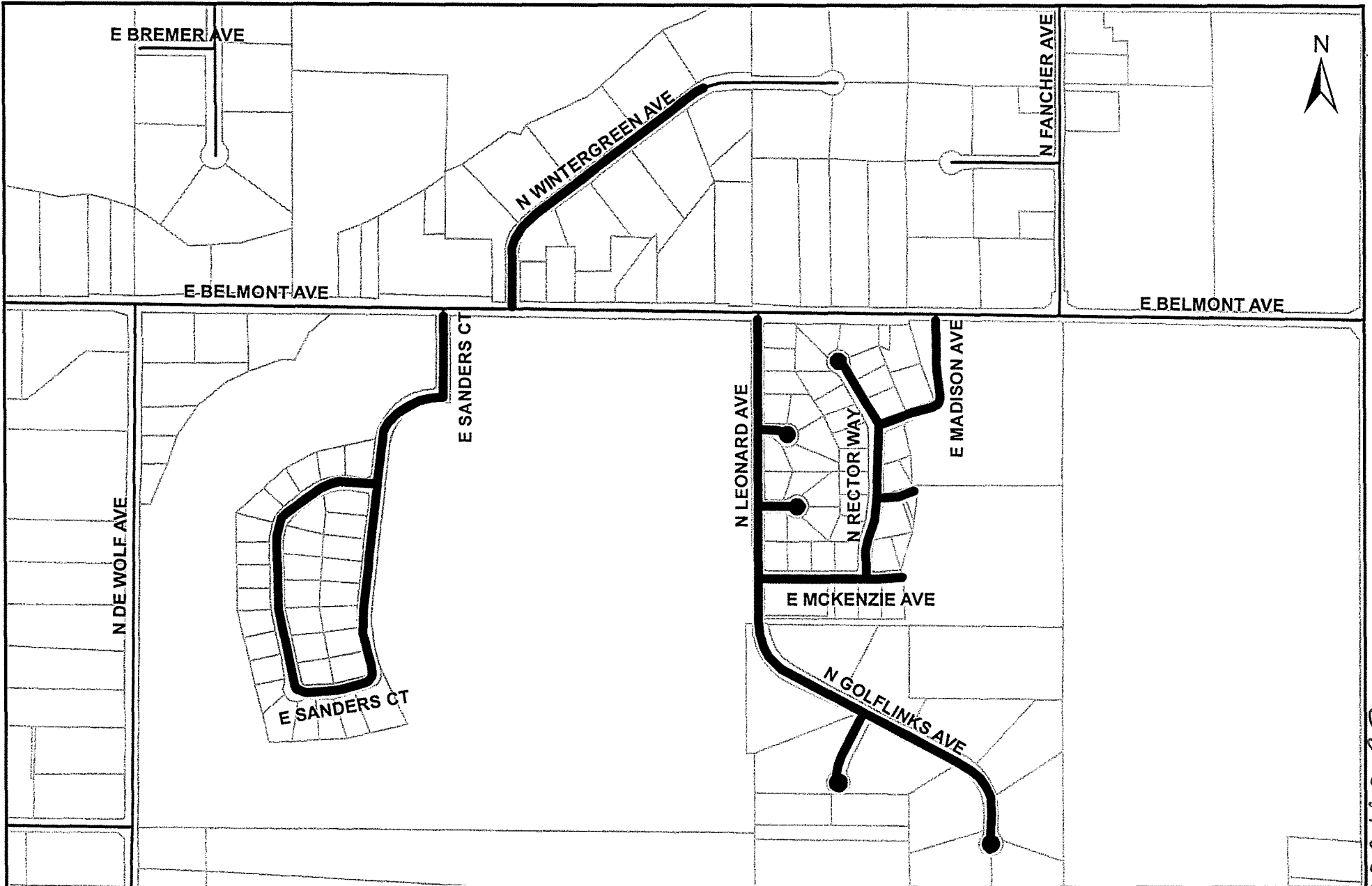

DATE:		01/12/2021
DESIGNED:	C.M.	01/12/2021
DRAWN:	C.M.	01/12/2021
CHECKED:		

0 500 1,000 Feet

LOCATION NO. 1
AREA NO. 1

DRAWING NO. 1 OF 1



DEPARTMENT OF PUBLIC WORKS & PLANNING

**2020-2021 SLURRY SEAL
BELMONT COUNTRY CLUB AREA
CONTRACT NUMBER 20-13-M**

E202110000218

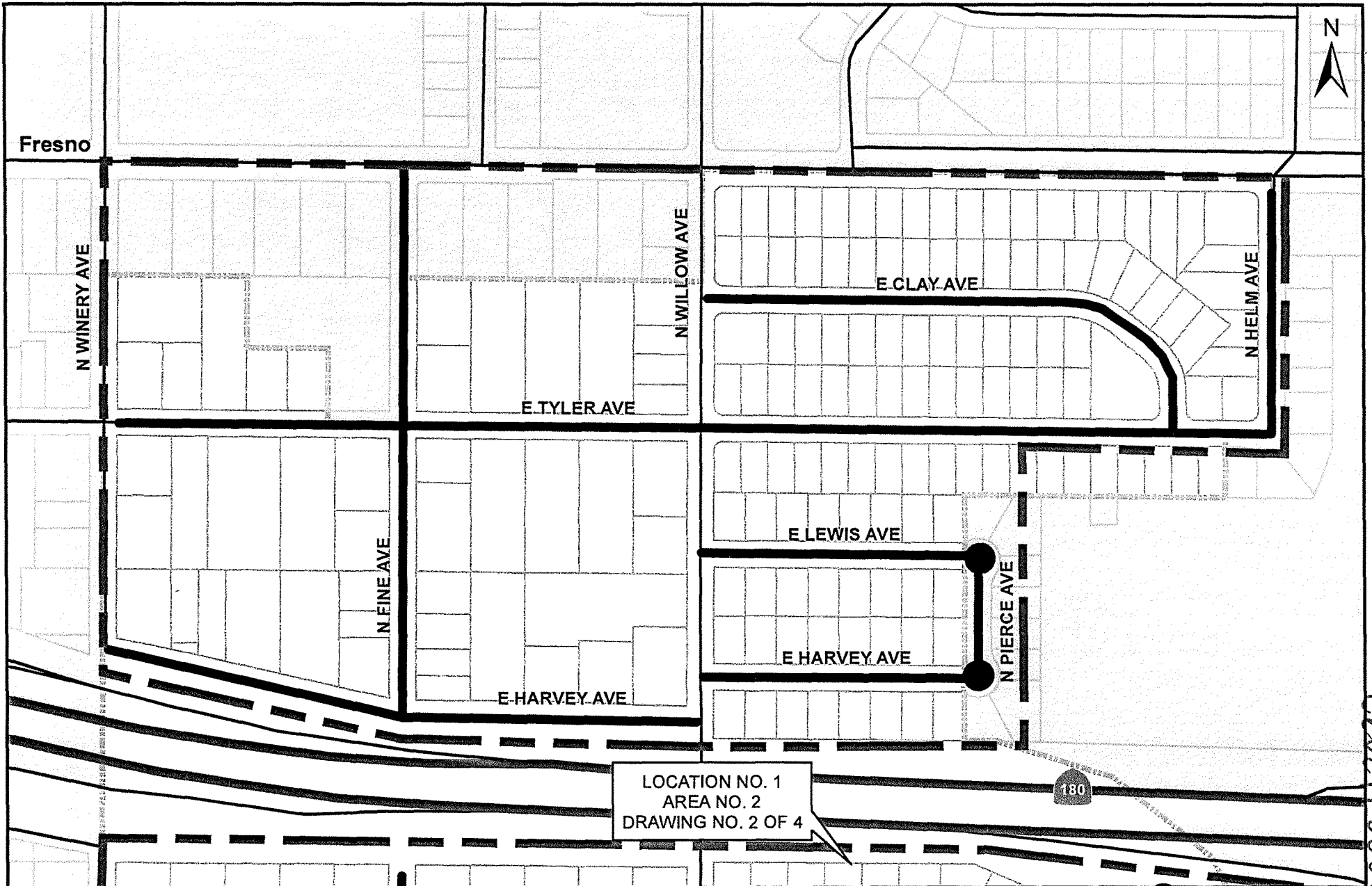

LOCATION NO. 1
 AREA NO. 2
 DRAWING NO. 2 OF 4

DATE:	
DESIGNED: C.M.	01/12/2021
DRAWN: C.M.	01/12/2021
CHECKED:	

0 250 500 Feet

LOCATION NO. 1
 AREA NO. 2
 DRAWING NO. 1 OF 4



DEPARTMENT OF PUBLIC WORKS & PLANNING

2020-2021 SLURRY SEAL
 PEACH AND BELMONT AREA
 CONTRACT NUMBER 20-13-M

E202110000218

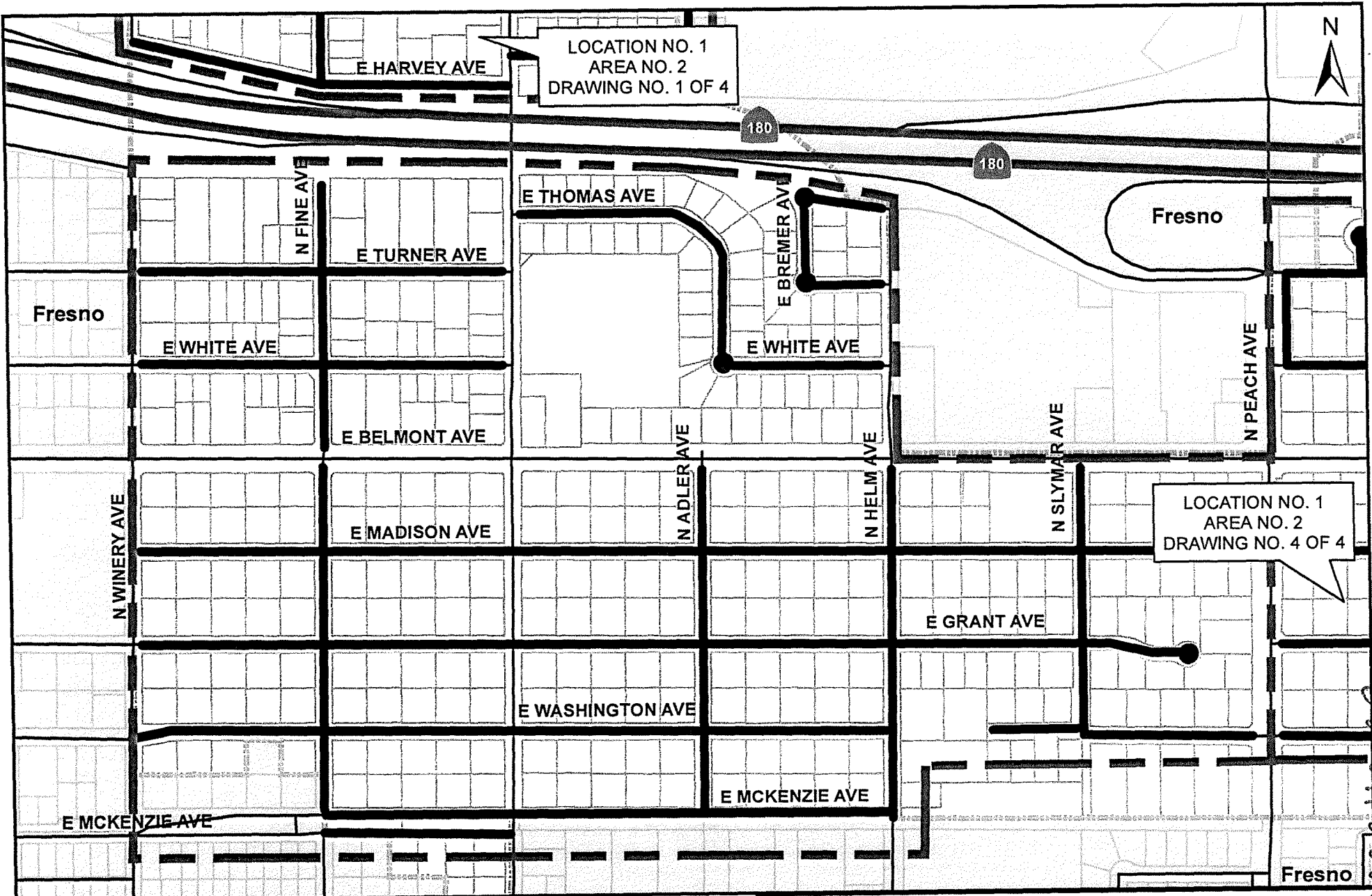

LOCATION NO. 1
 AREA NO. 2
 DRAWING NO. 1 OF 4

LOCATION NO. 1
 AREA NO. 2
 DRAWING NO. 4 OF 4

DATE:	
DESIGNED: C.M.	01/12/2021
DRAWN: C.M.	01/12/2021
CHECKED:	

0 250 500
 Feet

LOCATION NO. 1
 AREA NO. 2
 DRAWING NO. 2 OF 4



DEPARTMENT OF PUBLIC WORKS & PLANNING

2020-2021 SLURRY SEAL
 PEACH AND BELMONT AREA
 CONTRACT NUMBER 20-13-M

E202110000218

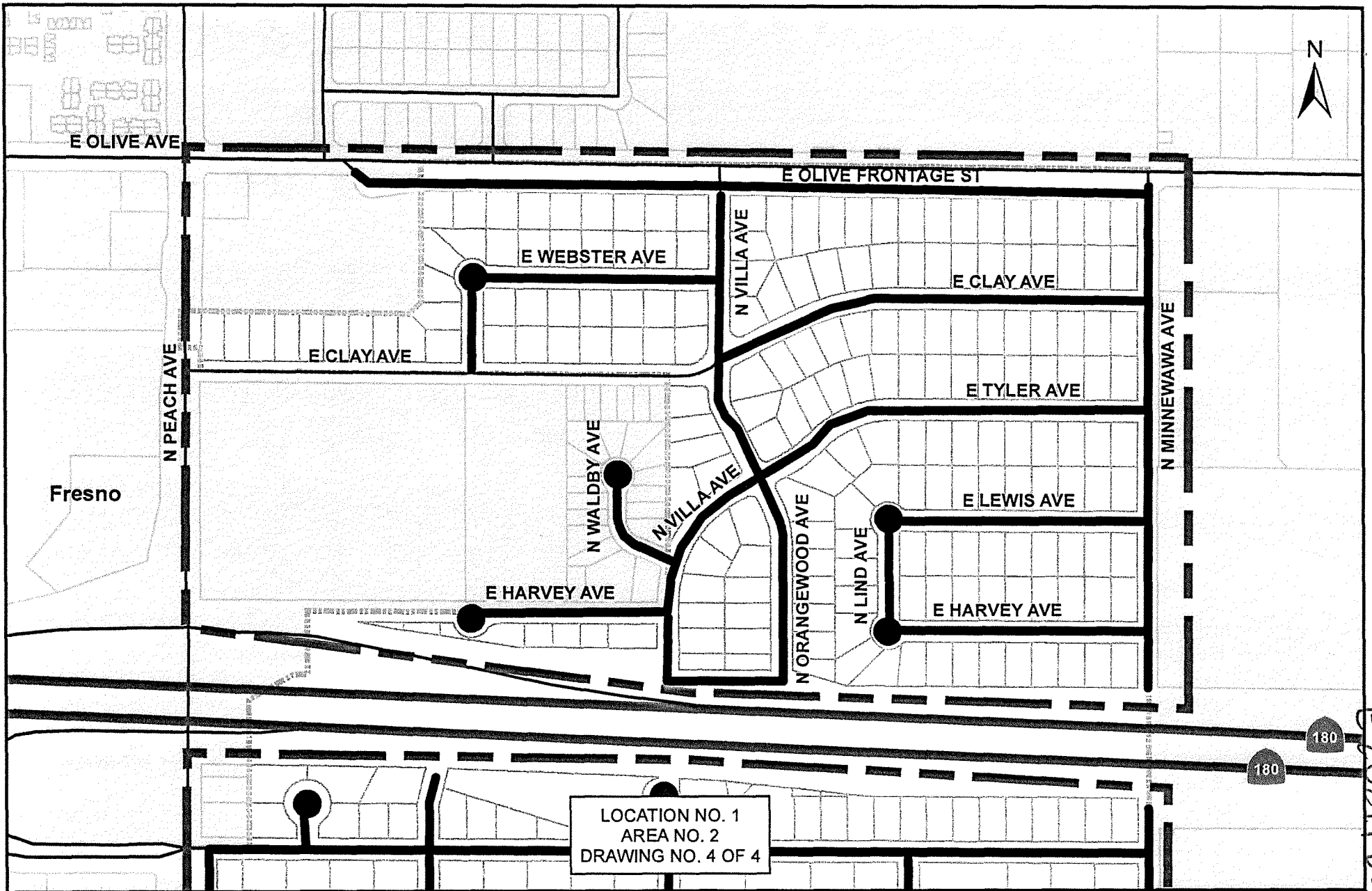

LOCATION NO. 1
 AREA NO. 2
 DRAWING NO. 4 OF 4

DATE:	
DESIGNED: C.M.	01/12/2021
DRAWN: C.M.	01/12/2021
CHECKED:	

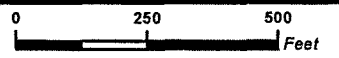

LOCATION NO. 1
 AREA NO. 2
 DRAWING NO. 3 OF 4



DEPARTMENT OF PUBLIC WORKS & PLANNING

**2020-2021 SLURRY SEAL
 PEACH AND BELMONT AREA
 CONTRACT NUMBER 20-13-M**

E202110000718

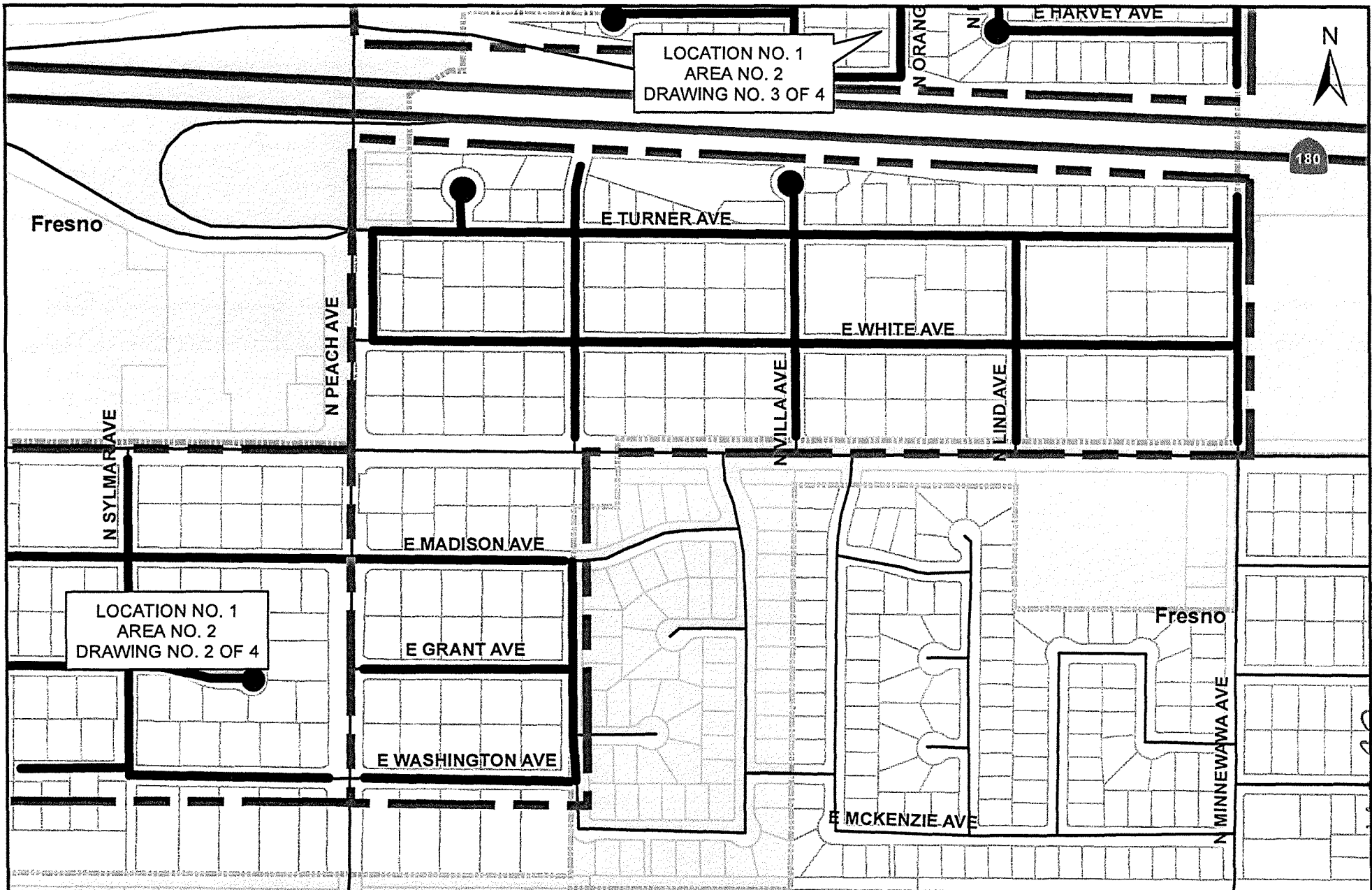

LOCATION NO. 1
 AREA NO. 2
 DRAWING NO. 3 OF 4

LOCATION NO. 1
 AREA NO. 2
 DRAWING NO. 2 OF 4

DATE:	
DESIGNED: C.M.	01/12/2021
DRAWN: C.M.	01/12/2021
CHECKED:	

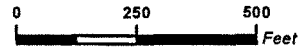

LOCATION NO. 1
 AREA NO. 2
 DRAWING NO. 4 OF 4



DEPARTMENT OF PUBLIC WORKS & PLANNING

2020-2021 SLURRY SEAL
 PEACH AND BELMONT AREA
 CONTRACT NUMBER 20-13-M

E202110000718

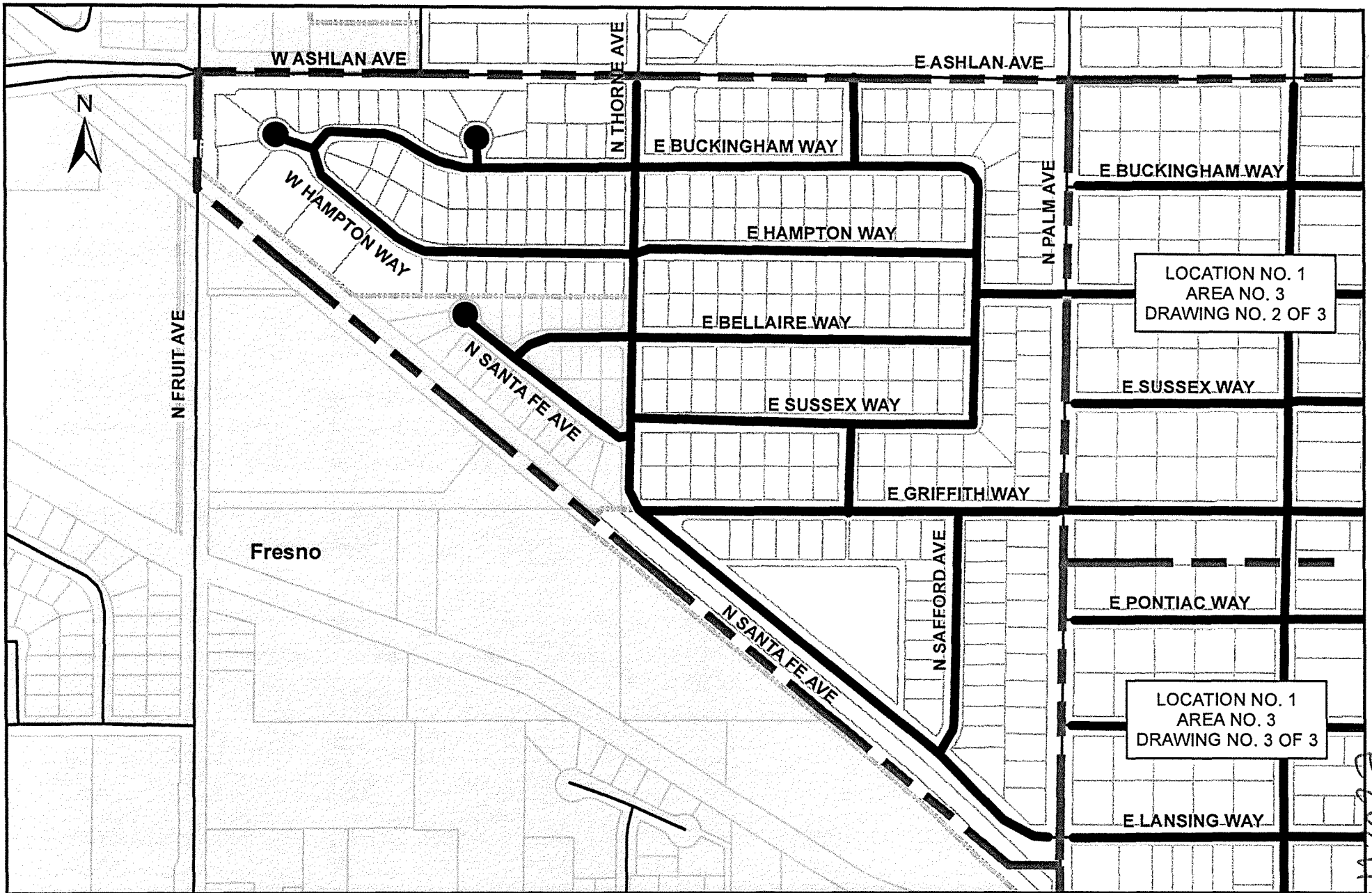

DATE:	
DESIGNED: C.M.	01/12/2021
DRAWN: C.M.	01/12/2021
CHECKED:	

0 250 500 Feet

LOCATION NO. 1
AREA NO. 3
DRAWING NO. 1 OF 3



DEPARTMENT OF PUBLIC WORKS & PLANNING

**2020-2021 SLURRY SEAL
FIG GARDEN S/O ASHLAN AVE AREA
CONTRACT NUMBER 20-13-M**

E202110000218

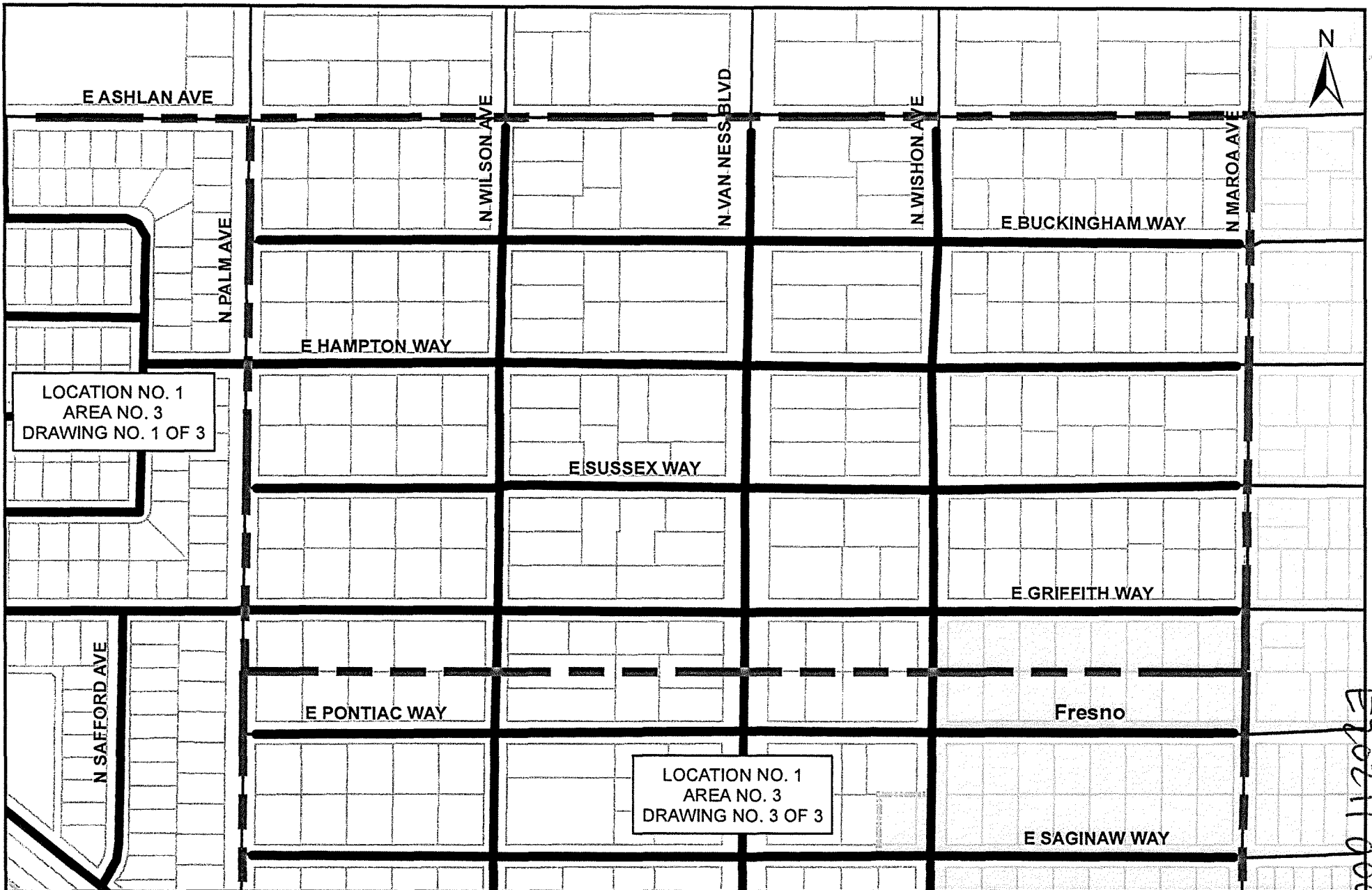

DATE:	
DESIGNED: C.M.	01/12/2021
DRAWN: C.M.	01/12/2021
CHECKED:	

0 250 500
Feet

LOCATION NO. 1
AREA NO. 3
DRAWING NO. 2 OF 3



DEPARTMENT OF PUBLIC WORKS & PLANNING

2020-2021 SLURRY SEAL
FIG GARDEN S/O ASHLAN AVE AREA
CONTRACT NUMBER 20-13-M

E 2021 0000210

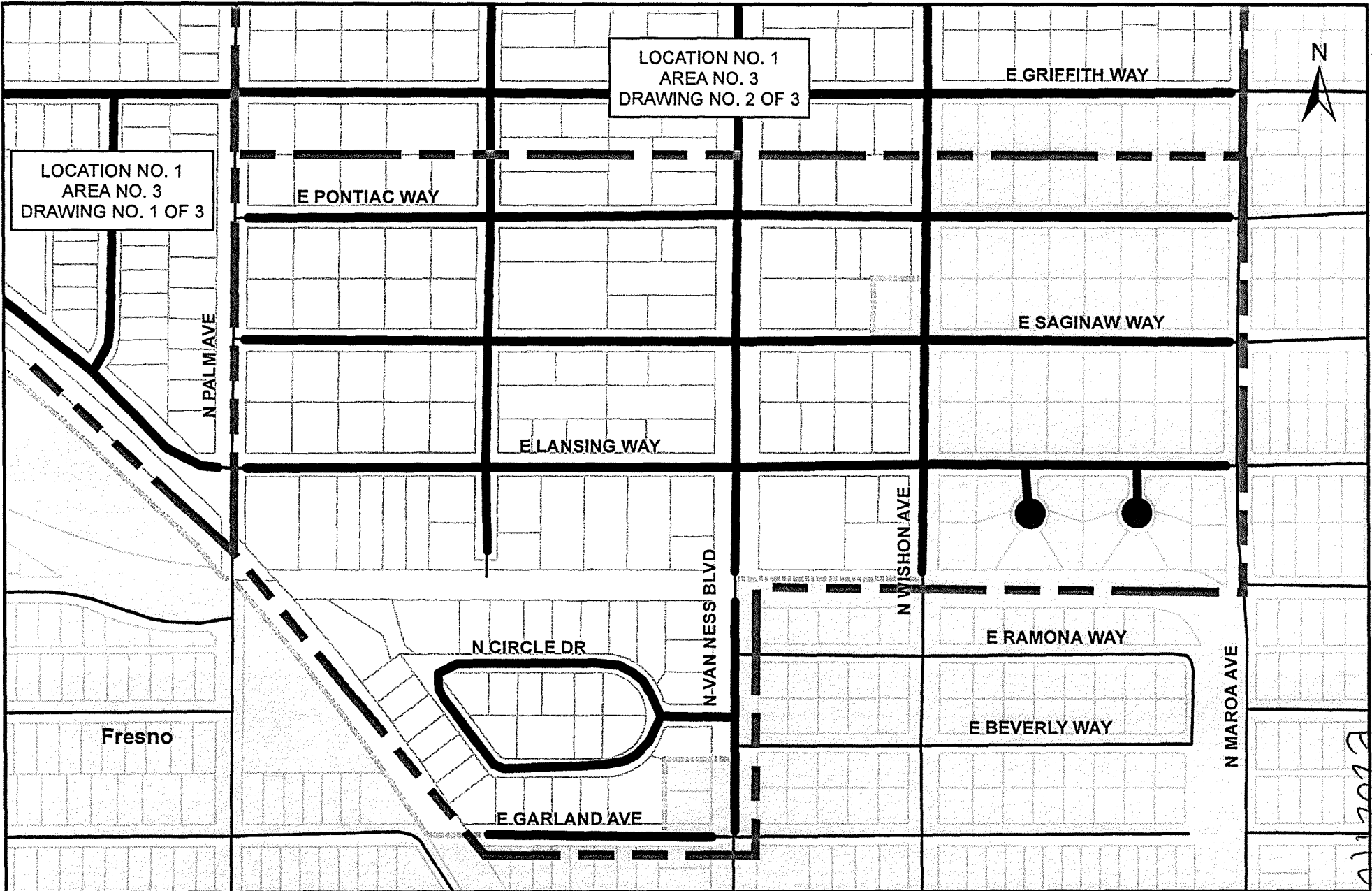

LOCATION NO. 1
 AREA NO. 3
 DRAWING NO. 2 OF 3

LOCATION NO. 1
 AREA NO. 3
 DRAWING NO. 1 OF 3

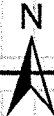

DATE:	
DESIGNED: C.M.	01/12/2021
DRAWN: C.M.	01/12/2021
CHECKED:	

0 250 500
 Feet

LOCATION NO. 1
 AREA NO. 3
 DRAWING NO. 3 OF 3



DEPARTMENT OF PUBLIC WORKS & PLANNING

2020-2021 SLURRY SEAL
 FIG GARDEN S/O ASHLAN AVE AREA
 CONTRACT NUMBER 20-13-M

E20210000210