

INDEX OF SHEETS:

- TS1.0 TITLE SHEET & LEGEND
- C1.0 SEWER MAIN PLAN & PROFILE STA. 1+00 TO 4+50
- C1.1 SEWER MAIN PLAN & PROFILE STA. 4+50 TO 7+03.93
- C1.2 SEWER MAIN PLAN & PROFILE STA. X+XX TO X+XX
- C2.0 SLURRY SEAL PLANS
- DT1.0 CONSTRUCTION DETAILS
- DT1.1 CONSTRUCTION DETAILS

ABBREVIATIONS:

- ABN ABANDON
- AC ASPHALT CONCRETE
- APPROX APPROXIMATE
- CB CATCH BASIN
- CO CLEAN OUT
- CONST CONSTRUCT
- DWY DRIVEWAY
- E EAST
- EG EXISTING GRADE
- EOP EDGE OF PAVEMENT
- ETW EDGE OF TRAVELED WAY
- EX, (E) EXISTING
- FG FINISH GRADE
- FH FIRE HYDRANT
- FL FLOWLINE
- FM FORCE MAIN
- FOC FACE OF CURB
- G GAS
- H HORIZONTAL
- HDPE HIGH DENSITY POLYETHYLENE
- ICV IRRIGATION CONTROL VALVE
- INV INVERT
- JP JOINT POLE
- L LENGTH
- LAT LATERAL
- MB METER BOX
- MH MANHOLE
- N NORTH
- (P) PROPOSED
- P&P PLAN & PROFILE
- PP POWER POLE
- PVC POLY VINYL CHLORIDE
- R RADIUS
- R/R REMOVE & REPLACE
- R/W RIGHT-OF-WAY
- SD STORM DRAIN
- S SOUTH
- SLOPE
- SS SANITARY SEWER
- STA STATION
- T TELEPHONE
- TC TOP OF CURB
- TV CABLE TELEVISION
- V VERTICAL
- VCP VITRIFIED CLAY PIPE
- W, WTR WATER
- W WEST
- WM WATER METER
- WM WATER VALVE

LEGEND:

- RIGHT-OF-WAY
- PROPERTY LINE
- X"SS SANITARY SEWER LINE
- X"FM SANITARY SEWER FORCE MAIN
- (E) SANITARY SEWER
- (E) SANITARY SEWER FORCE MAIN
- SD (E) STORM DRAIN
- W (E) WATER LINE
- G (E) GAS LINE
- CTV (E) CABLE TV LINE
- FO (E) FIBER OPTIC LINE
- E (E) ELECTRICAL LINE
- T (E) TELEPHONE LINE
- OH (E) OVERHEAD UTILITY
- /// ABANDON
- SS SANITARY SEWER MANHOLE
- CO CLEAN OUT
- VALVE
- UTILITY VAULT
- LINE CAP
- BENCH MARK
- SURVEY MONUMENT
- (E) STORM DRAIN MANHOLE
- (E) STORM DRAIN CATCH BASIN
- (E) WATER METER
- (E) FIRE HYDRANT
- (E) UTILITY POLE
- (E) LIGHT
- (E) TRAFFIC SIGNAL
- (E) WATER WELL
- (E) TREE
- (E) SIGN
- (E) SANITARY SEWER MANHOLE

GENERAL NOTES:

1. ALL CONSTRUCTION SHALL CONFORM TO THE FOLLOWING:
 - A. COUNTY OF SANTA CRUZ DESIGN CRITERIA
 - B. 2018 STATE STANDARD PLANS AND THE APPLICABLE PROVISIONS OF THE 2018 STATE STANDARD SPECIFICATIONS
 - C. PROJECT SPECIAL PROVISIONS
2. NO CHANGES IN THE APPROVED PROJECT PLANS SHALL BE MADE WITHOUT THE PRIOR APPROVAL OF THE ENGINEER.
3. LOCATION OF THE UNDERGROUND UTILITIES ON THE PLANS ARE APPROXIMATE ONLY. CALL "UNDERGROUND SERVICE ALERT" (USA) AT 800-642-2444 AT LEAST 48 HOURS BEFORE DIGGING.
4. IT IS THE CONTRACTOR'S RESPONSIBILITY TO VERIFY THE LOCATIONS AND DEPTHS OF THE EXISTING UTILITIES PRIOR TO CONSTRUCTION AND TO NOTIFY THE ENGINEER IN CASE OF CONFLICT.
5. LATERALS SHOWN ARE BASED UPON CCTV FOOTAGE UNLESS OTHERWISE NOTED. ADDITIONAL SEWER LATERALS MAY EXIST. IT IS THE CONTRACTOR'S RESPONSIBILITY TO LOCATE ALL ACTIVE LATERALS AND CONNECT THEM TO THE NEWLY CONSTRUCTED. ACCESS TO LATERALS MAY BE ON PRIVATE PROPERTY AND REQUIRE THE CONTRACTOR TO COORDINATE WITH THE PROPERTY OWNERS FOR ACCESS. THE CONTRACTOR IS RESPONSIBLE FOR REPLACING ANY PRIVATE IMPROVEMENTS REMOVED OR DAMAGED DURING WORK ON THE LATERALS.
6. SURVEY DATA IS COMBINATION RECORD DATA AND FIELD TOPOGRAPHIC SURVEYS:
 - SURVEY PERFORMED BY THE COUNTY OF SANTA CRUZ IN 2021.
 - DATUM IS NAVD 88
 - SCCO BM#26

SANTA CRUZ COUNTY SANITATION DISTRICT

PROJECT PLANS FOR CONSTRUCTION ON EDDY LANE SEWER RELOCATION PROJECT

To be supplemented by Standard Plans dated 2018

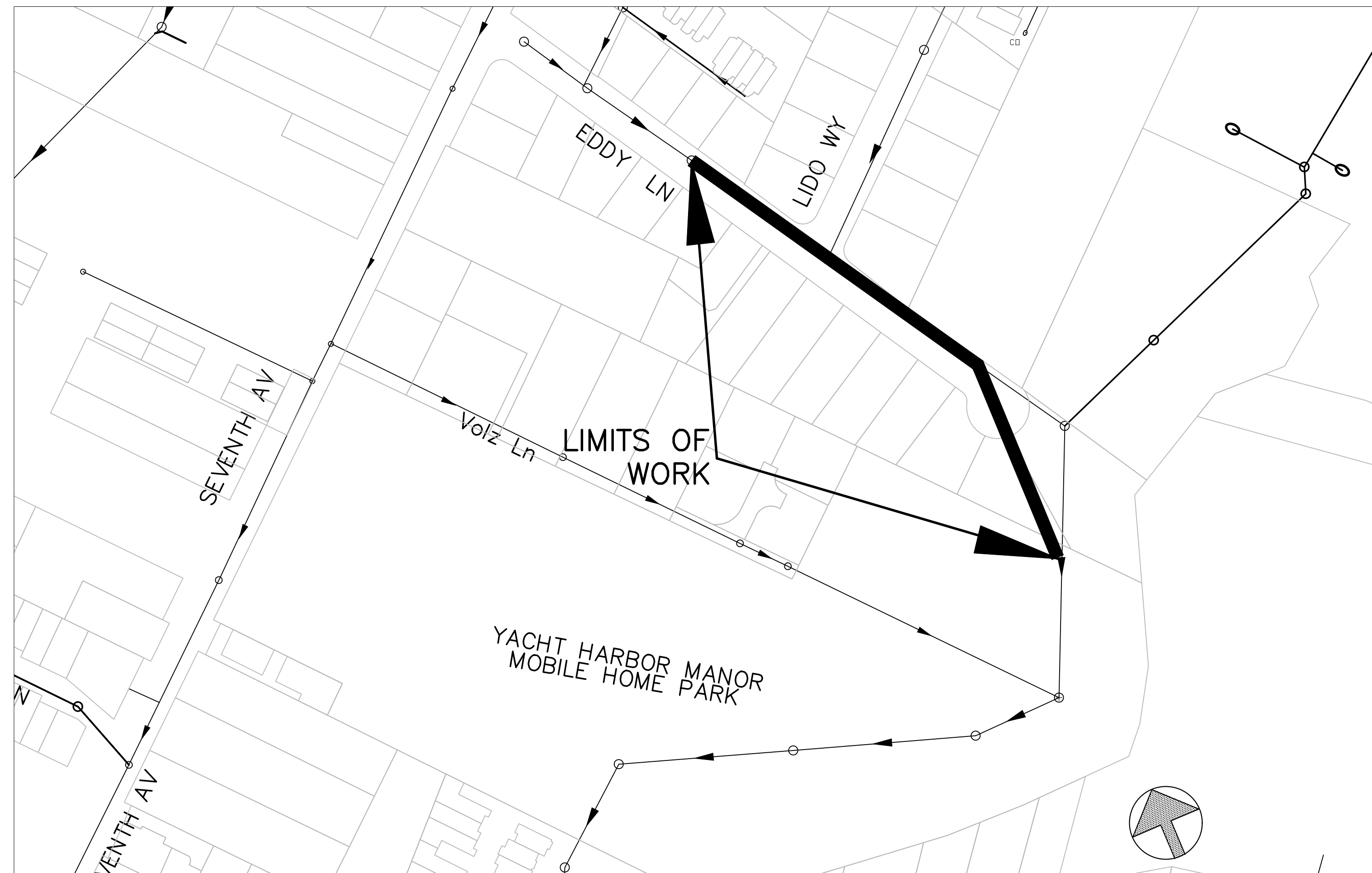

VICINITY MAP

NOT TO SCALE

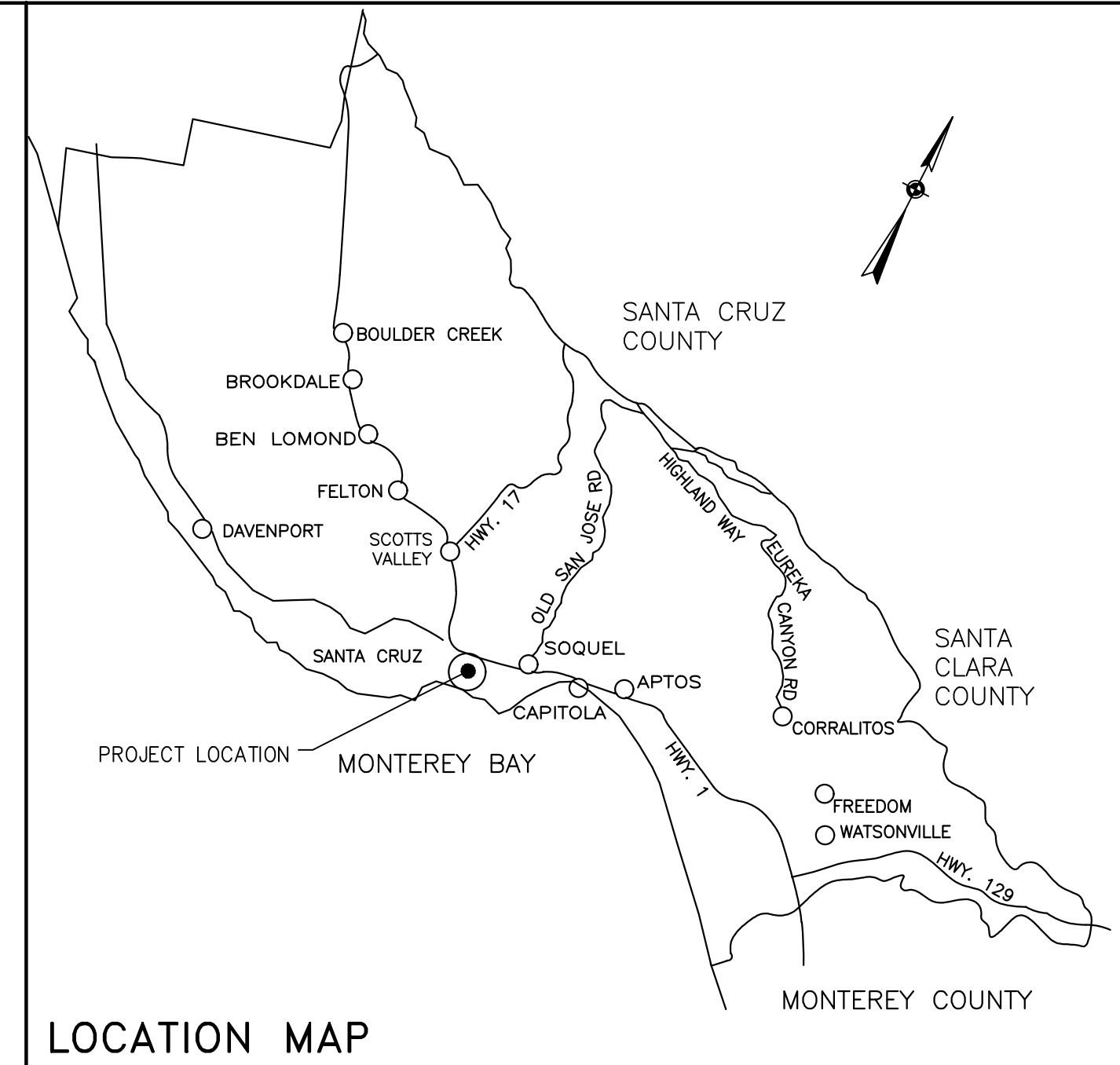

LOCATION MAP

Senior Civil Engineer

Assistant District Engineer

District Engineer

Chairperson of the Board

Plans Approval Date

| | | | |
|------------------|-----------------------|-------------------------------|--|
| Reviewed by: | Reviewed by: | Reviewed by: | |
| Traffic Engineer | Construction Engineer | Sanitation Operations Manager | |
| RUSSELL CHEN | CARISA DURAN | BEATRIZ BARRANCO | |

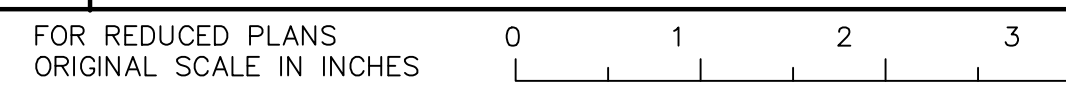

SHEET NAME: TITLE SHEET & LEGEND DRAWING NAME: **EDDY LANE SEWER RELOCATION PROJECT**

| | | | | | |
|--|----------|--------------|----------------------|------------------|--|
| DATE | REVISION | BY | | | |
| | | | | | |
| | | | | | |
| PROJECT ENGINEER | | | ASHLEIGH D. TRUJILLO | | |
| SANTA CRUZ COUNTY SANITATION DISTRICT EDDY LANE SEWER RELOCATION PROJECT TITLE SHEET & LEGEND | | | | | |
| DRAWN: BSW | | CHECKED: ADT | | DATE: 11/12/2021 | |
| JOB NO. P53827 | | SCALE: NONE | | SHEET TS1.0 | |
| | | | | OF 7 | |