

BEAR VALLEY ROAD

AMETHYST STREET

SIERRA ROAD

PLUTO DRIVE

ESTIMATED EARTHWORKS ANALYSIS -- SEPTEMBER 30, 2021

RAW VOLUMES	CUT CY	FILL CY
(4') BUILDING OVEREX	6,300	10,700
(1') PAVING OVEREX	16,133	16,133
UNDERGROUND DETENTION	1,000	11,253
(0.1') SUBSIDENCE		1,821
37'4" PAVEMENT SECTION	6,564	
8' BLDG FLOOR SECTION	2,432	
NET VOLUME	44,282	39,967
(10%) SHRINKAGE		4,428
ADJUSTED VOLUME	CUT	FILL
NET	44,282	44,395

NET 53 Import

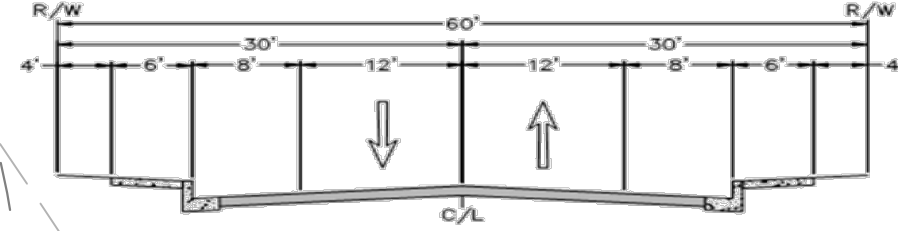

- LEGEND**
- PROPOSED LANDSCAPE AREA
 - PROPOSED UNDERGROUND DETENTION AREA
 - PROPOSED WQMP TREATMENT AREA
 - PROPOSED AC PAVEMENT
 - PROPOSED PCC PAVEMENT
 - PROPOSED STORM DRAIN PIPE
 - PROPOSED STORM DRAIN PIPE FLOW DIRECTION

ABBREVIATIONS

BFP	BACK FLOW PREVENTER	FG	FINISH GRADE	LF	LINEAR FEET	SWR	SEWER
C/L	CENTERLINE	FL	FLOW LINE	LP	LOW POINT	TG	TOP OF GRATE
C&G	CURB AND GUTTER	FH	FIRE HYDRANT	P/L	PROPERTY LINE	TYP	TYPICAL
CB	CATCH BASIN	FS	FINISH SURFACE	PE	PAD ELEVATION	WTR	WATER
EG	EXISTING GROUND	FUT.	FUTURE	PP	POWER POLE		
EL.	ELEVATION	GB	GRADE BREAK	PS	PIPE SLOPE		
ELEC.	ELECTRIC	GUY	GUY ANCHOR	PR.	PROPOSED		
EX.	EXISTING	HP	HIGH POINT	R/W	RIGHT OF WAY		
FF	FINISH FLOOR	INV	INVERT	ST.	STREET		

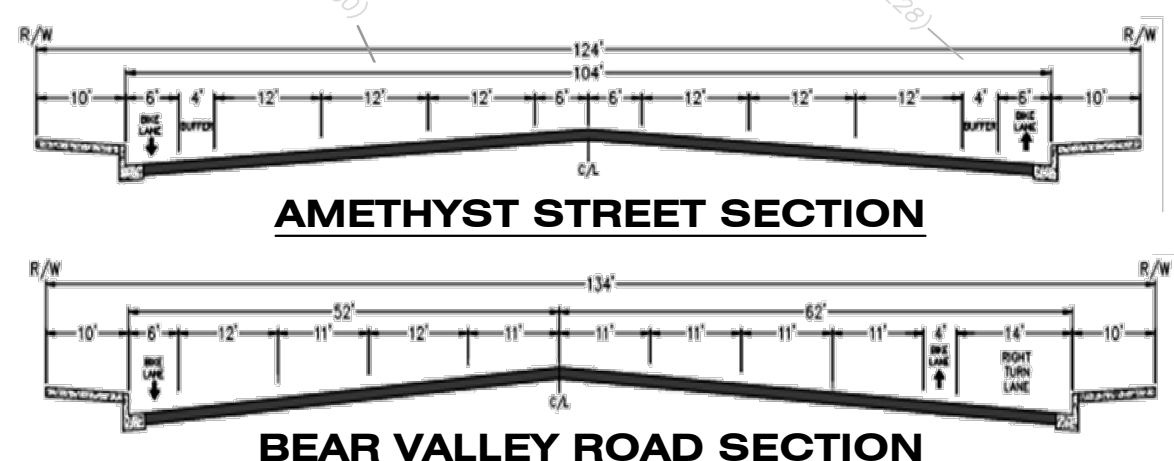
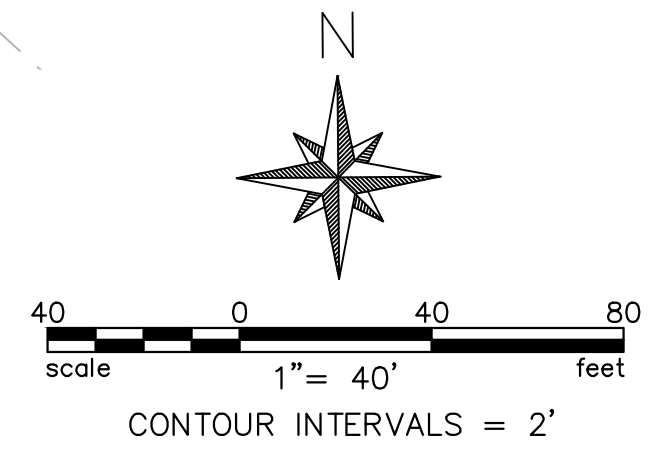

DAVID EVANS AND ASSOCIATES INC.
18484 Outer Highway 18 N Suite 225
Apple Valley California 92307
Phone: 760.524.9100
SSchubert@deainc.com

IN THE CITY OF VICTORVILLE
AMETHYST CROSSINGS

CONCEPTUAL GRADING AND DRAINAGE PLAN

DATE: 10/01/2021

FILE NO.
DRAWING NO.
SH. 1 OF 1

Plotted: 10/1/2021 3:15 PM
 By: Steve Schubert
 File: P:\HIC\000002\040\CAD\000002\CONCEPT PLANS\CONCEPT GRADING AND DRAINAGE PLAN.dwg
 Save Date: 10/1/2021 3:11 PM

NOT FOR CONSTRUCTION

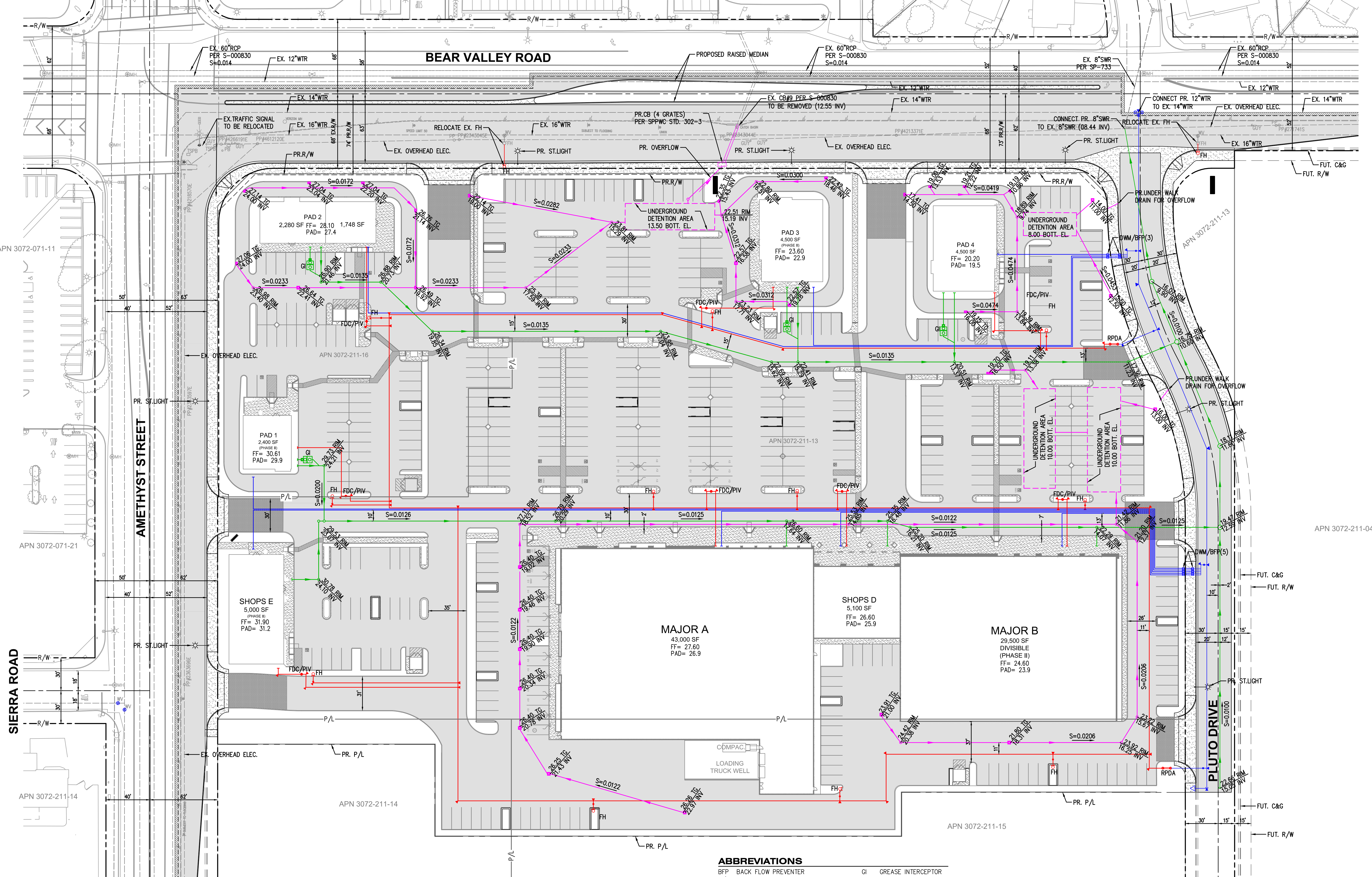

UTILITY LEGEND

- PROPOSED FIRE WATER SERVICE
- PROPOSED DOMESTIC WATER SERVICE/MAIN
- PROPOSED SEWER SERVICE/MAIN
- PROPOSED STORM DRAIN
- PROPOSED SEWER PIPE FLOW DIRECTION
- PROPOSED STORM DRAIN PIPE FLOW DIRECTION

ABBREVIATIONS

- | | |
|-------------------------------------|---|
| BFP BACK FLOW PREVENTER | GI GREASE INTERCEPTOR |
| C/L CENTERLINE | GUY GUY ANCHOR |
| C&G CURB AND GUTTER | INV INVERT |
| CB CATCH BASIN | P/L PROPERTY LINE |
| DCCA DOUBLE DETECTOR CHECK ASSEMBLY | PIV POST INDICATOR VALVE |
| DWM DOMESTIC WATER METER | PP POWER POLE |
| EG EXISTING GROUND | PS PIPE SLOPE |
| EL ELEVATION | PR. PROPOSED |
| ELEC. ELECTRIC | RPDA REDUCED PRESSURE DETECTOR ASSEMBLY |
| EX. EXISTING | R/W RIGHT OF WAY |
| FDC FIRE DEPARTMENT CONNECTION | ST. STREET |
| FF FINISH FLOOR | SWR SEWER |
| FH FIRE HYDRANT | TG TOP OF GRATE |
| FUT. FUTURE | TYP TYPICAL |
| | WTR WATER |

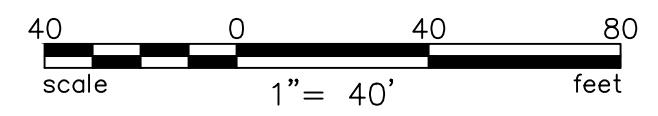
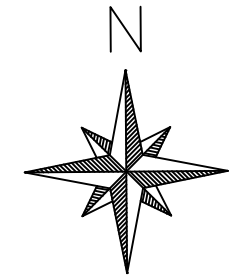

DAVID EVANS AND ASSOCIATES INC.
 18484 Outer Highway 18 N Suite 225
 Apple Valley California 92307
 Phone: 760.524.9100
 SShubert@deainc.com

IN THE CITY OF VICTORVILLE
 AMETHYST CROSSINGS

**CONCEPTUAL COMPOSITE
 WET UTILITY PLAN**

DATE: 10/01/2021

FILE NO.
DRAWING NO.
SH. 1 OF 1

Plotted: 10/10/2021 3:15 PM
 By: SShubert
 File Path: H:\Projects\3095-241-01\CONCEPT PLANS\CONCEPT UTILITY PLAN.dwg

NOT FOR CONSTRUCTION

CONSTRUCTION NOTES

- CALL "UNDERGROUND SERVICE ALERT" 1-800-422-4133 A MINIMUM OF 48 HOURS PRIOR TO ANY EXCAVATION. EVEN THOUGH EXISTING FACILITIES ARE MARKED BY DRY UTILITY REPRESENTATIVES, THE CONTRACTOR IS RESPONSIBLE FOR EXPOSING, AND IF NECESSARY, WORKING WITH CIVIL ENGINEER TO ESTABLISH TOP OF STRUCTURE AND BOTTOM OF STRUCTURE ELEVATIONS TO DETERMINE IF CONFLICTS OCCUR. IN THE EVENT OF CONFLICTS, THE CONTRACTOR SHALL ISSUE A RFI FOR REVIEW AND DIRECTION. THE CONTRACTOR SHALL PROTECT-IN-PLACE ANY EXISTING UTILITIES.
- ALL WORK IN STREET RIGHT-OF-WAY SHALL BE DONE IN ACCORDANCE WITH GOVERNING MUNICIPALITY STANDARD SPECIFICATIONS FOR PUBLIC WORKS CONSTRUCTION, LATEST EDITION AND ADDENDUM, UNLESS OTHERWISE SPECIFIED.
- CONSTRUCTION IN STREET RIGHT-OF-WAY SHALL BE PERMITTED AND FOLLOW W.A.T.C.H. MANUAL GUIDELINES AND / OR TRAFFIC CONTROL PLAN AS REQUIRED BY GOVERNING MUNICIPALITY.
- ALL TRAFFIC CONTROL SHALL BE DONE IN ACCORDANCE WITH THE MANUAL ON UNIFORM TRAFFIC CONTROL DEVICES, LATEST EDITION.
- GOVERNING MUNICIPALITY SHALL BE NOTIFIED AT LEAST 24 HOURS BEFORE START OF WORK IN STREET RIGHT-OF-WAY.
- ALL NEWLY PLACED CONDUIT SHALL MAINTAIN A MINIMUM COVER PER GOVERNING MUNICIPALITY REQUIREMENTS.
- UTILITY PRE-CONSTRUCTION MEETING: IT IS ADVISABLE THAT THE CONTRACTOR CONDUCT A PRE-CONSTRUCTION MEETING EARLY IN THE CONSTRUCTION PROJECT WITH EACH UTILITY INSPECTOR SEPARATELY FROM THE OTHER DISCIPLINES TO DISCUSS EACH UTILITY'S WORK OPERATIONS INCLUDING, BUT NOT LIMITED TO, REVIEW AND APPROVAL OF CONTRACTOR'S SHOP DRAWINGS FOR MATERIALS, SITE WORK PREPARATIONS PRIOR TO MOVE-IN, PHASING, CONTRACT WORK, PLACING MAKE-UP, SPLICING, SERVICE CUT-OVER, UTILITY OUTAGE AND FACILITY REMOVAL AS APPLICABLE PER PROJECT, AND SITE WORK PREPARATION THAT EACH UTILITY REQUIRES PRIOR TO DOING ANY WORK. CONTRACTOR IS TO ALLOW TIME IN SCHEDULING WORK OPERATIONS ACCORDINGLY.
 - POWER DISTRIBUTION: CONTRACTOR TO INSTALL CONDUITS AND STRUCTURES PER POWER PROVIDED PLAN. POWER CREWS WILL INSTALL CONDUITORS AND SET POWER EQUIPMENT IN AND / OR ON CUSTOMER-PROVIDED CONDUITS AND STRUCTURES. CITY WILL APPROVE AND RELEASE TO SCE SWITCHGEAR CLEARANCE BEFORE SCE WILL SCHEDULE THEIR CREWS TO INSTALL THEIR FACILITIES.
 - TELEPHONE DISTRIBUTION: CONTRACTOR TO PROVIDE AND INSTALL CONDUIT, STRUCTURES AND APPURTENANCES PER TELEPHONE COMPANY PLAN OR DRY UTILITY COMPOSITE PLAN (DUCP). TELEPHONE TO INSTALL CABLE THROUGH CUSTOMER-PROVIDED CONDUIT AND STRUCTURES AND SET TERMINAL.
 - CATV DISTRIBUTION: CONTRACTOR TO PROVIDE AND INSTALL CONDUIT, STRUCTURES AND APPURTENANCES PER DRY UTILITY COMPOSITE PLAN (DUCP). CATV TO INSTALL CABLE THROUGH CUSTOMER-PROVIDED CONDUIT AND STRUCTURES AND SET TERMINATION EQUIPMENT.
 - GAS DISTRIBUTION: CONTRACTOR TO PROVIDE TRENCH PER DUCP AND ADD 6" SAND BEDDING TO TRENCH. CONTRACTOR MUST SECURE THE SERVICES OF A GAS COMPANY-APPROVED TRENCHING CONTRACTOR TO BACKFILL AND COMPACT TRENCH AROUND AND ABOVE GAS PIPE. GAS COMPANY WILL PROVIDE PLAN FOR GAS MAIN PIPELINE WHICH MAY OR MAY NOT INCLUDE GAS SERVICE PIPELINE. PRIOR TO GAS COMPANY SETTING METER(S) THE BUILDING HOUSE LINE MUST BE INSPECTED, APPROVED AND RELEASED TO THE GAS COMPANY BY THE LOCAL MUNICIPALITY. ONLY AFTER THIS WILL GAS COMPANY SCHEDULE METER-SET DATES. CONTRACTOR SHOULD SCHEDULE WORK OPERATIONS ACCORDINGLY.
- PRE-TRENCH MEETING: CONTRACTOR IS TO NOTIFY UTILITY INSPECTORS A MINIMUM OF ONE (1) WEEK PRIOR TO PRE-TRENCH MEETING. PRE-TRENCH MEETING SHALL NOT BE LESS THAN (2) DAYS BEFORE TRENCHING.
- MINIMUM RADIUS (UNLESS NOTED OTHERWISE):
 - ELECTRIC=12"; TELEPHONE=12"; CATV=12"; FIBER=12"
- MANDREL ALL CONDUITS AND INSTALL PULL ROPE.
 - ALL CONDUITS SHALL BE MANDRELLER WITH UTILITY INSPECTOR APPROVAL.
 - INSTALL 3/8" PULL ROPE OR MULE TAPE IN ALL COMMUNICATIONS CONDUITS.
 - WHERE CONDUITS ARE PICKED-UP OR INTERCEPTED, CONTRACTOR TO MANDREL AND INSTALL PULL ROPE FROM STRUCTURE TO EXISTING STRUCTURE. COORDINATE WITH RESPECTIVE UTILITY INSPECTOR.
- "AS-BUILT" PLANS SHALL BE PROVIDED BY THE CONTRACTOR AND PROVIDED TO UTILITY INSPECTORS.
 - SHALL VERIFY STRUCTURE TIES.
 - SHALL VERIFY DUCT FOOTAGES PLACED PER THIS JOB.
 - SHALL RUN MULE-TAPE TO OBTAIN FINAL DUCT MEASUREMENTS.
 - VERIFICATION SHALL BE BY ANNOTATING ON DRY UTILITY COMPOSITE PLAN TO CONFIRM DATA OR TO CORRECT DATA.
- UNLESS OTHERWISE NOTED, CONTRACTOR IS TO CONTACT RESPECTIVE DRY UTILITY INSPECTORS BEFORE INTERCEPTING OR ENTERING LOW VOLTAGE EXISTING UTILITY STRUCTURES AND / OR CONDUITS. POWER WILL NOT ALLOW CONTRACTORS TO ENTER EXISTING STRUCTURES OR INTERCEPT EXISTING CONDUITS THAT HAVE ENERGIZED CABLES.

3RD PARTY PERMISSION NOTE:

PERMISSION TO PERFORM WORK ON ANY 3RD PARTY PRIVATE PROPERTY OWNER SHALL BE SECURED BY DEVELOPER. THIS SHALL INCLUDE, BUT NOT BE LIMITED TO, ACQUIRING UTILITY EASEMENT AND ACCESS PERMISSION.

KEY:

- ① POWER VAULT/SWITCHING STG./MANHOLE
TELEPHONE STRUCTURE
CATV STRUCTURE
- ② POWER TRANSFORMER STRUCTURE
TELEPHONE STRUCTURE
CATV STRUCTURE

DRY UTILITY COMPOSITE PLAN/UTILITY PLAN COORDINATION

WHILE IT IS UNDERSTOOD THAT THE CONTRACTOR IS TO CONSTRUCT EACH OF THE DRY UTILITY SYSTEMS IN ACCORDANCE WITH THE RESPECTIVE DRY UTILITY COMPANY'S PLANS AND STANDARDS, IT IS ALSO POSSIBLE THAT THE PLANS PREPARED BY EACH DRY UTILITY COMPANY MAY NOT HAVE BEEN GENERATED HAVING THE LATEST CIVIL AND/OR LANDSCAPE BASE INFORMATION. THE DEVELOPER AND PROJECT TEAM HAVE SPENT CONSIDERABLE EFFORTS TO DEVELOP A DRY UTILITY COMPOSITE PLAN TO MAINTAIN THE CURRENT STATUS OF ALL THE FACILITIES TO BE CONSTRUCTED WITHIN THE PROJECT AREA; AND, THE DRY UTILITY COMPOSITE PLAN SHOULD BE USED AS A REFERENCE FOR THE CONTRACTOR DURING THE PROJECT. THE CONTRACTOR SHALL COMPARE EACH OF THE FINAL DRY UTILITY PLANS WITH THE DRY UTILITY COMPOSITE PLAN PRIOR TO AND DURING CONSTRUCTION TO INSURE THAT ALL FACILITIES TO BE INSTALLED ARE CONSISTENT WITH THE DRY UTILITY COMPOSITE PLAN. IN THE EVENT THAT THE CONTRACTOR FINDS AN INSTANCE WHERE A DRY UTILITY COMPANY'S FINAL PLAN DOES NOT MATCH THE DRY UTILITY COMPOSITE PLAN, CONTRACTOR SHALL ISSUE AN "RFI" (REQUEST FOR INFORMATION) TO OBTAIN A CLARIFICATION PRIOR TO THE CONTRACTOR INITIATING THE CONSTRUCTION OF THE ITEM OR ITEMS IN QUESTION.

NOTE TO DRY UTILITY CONTRACTOR AND PLUMBING CONTRACTOR: PRIOR TO TRENCHING FOR GAS SERVICE LINES, DRY UTILITY CONTRACTOR AND PLUMBING CONTRACTOR SHALL MEET WITH GAS CO. INSPECTOR TO CONFIRM HOUSE LINE LOCATIONS AND GAS CO. RISER LOCATION-ALL SITES ON PROJECT.

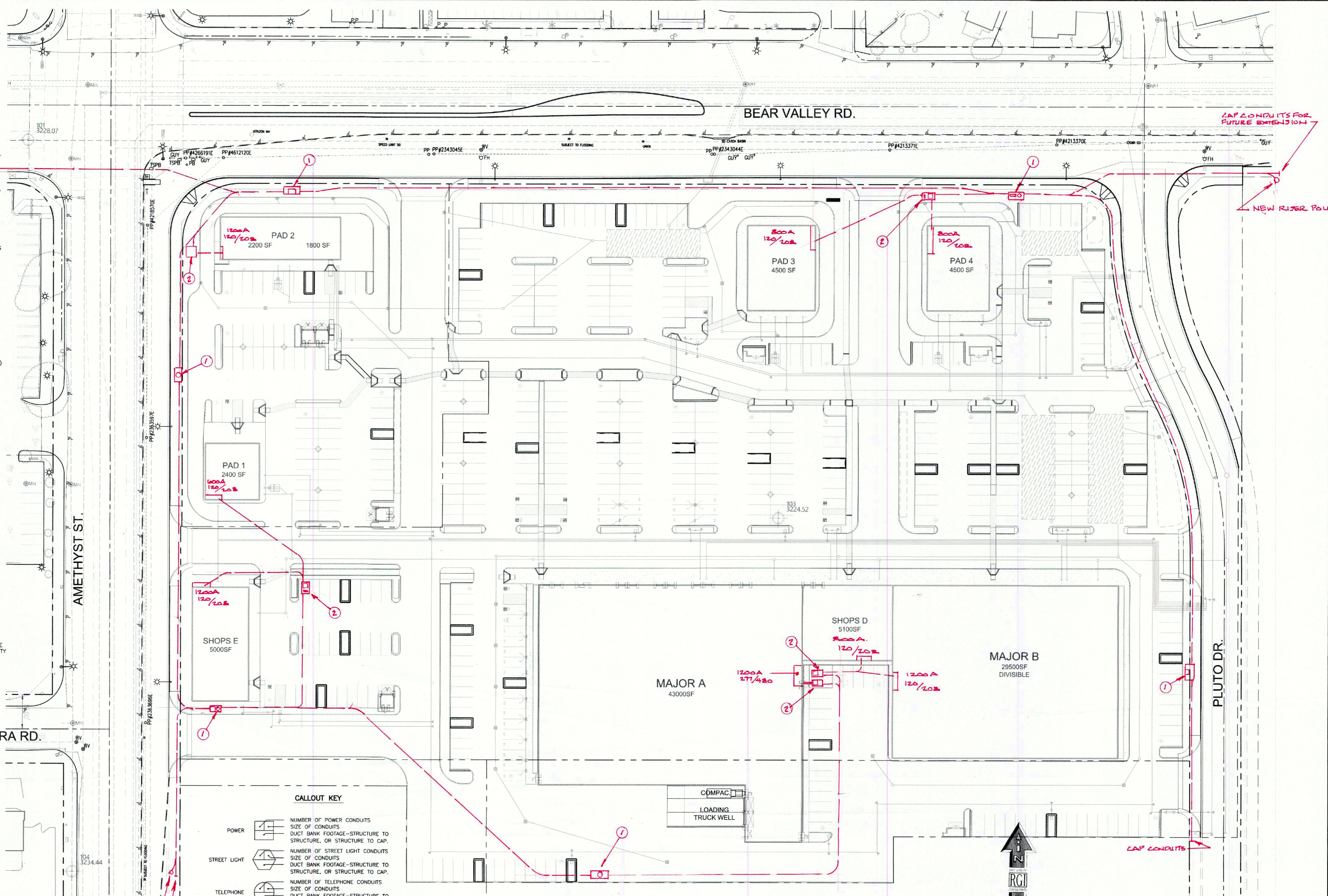

RISER POLE
CAP CONDUITS FOR FUTURE EXTENSION

CAP CONDUITS FOR FUTURE EXTENSION
NEW RISER POLE

CALLOUT KEY

- POWER: NUMBER OF POWER CONDUITS, SIZE OF CONDUITS, DUCT BANK FOOTAGE-STRUCTURE TO STRUCTURE, OR STRUCTURE TO CAP.
- STREET LIGHT: NUMBER OF STREET LIGHT CONDUITS, DUCT BANK FOOTAGE-STRUCTURE TO STRUCTURE, OR STRUCTURE TO CAP.
- TELEPHONE: NUMBER OF TELEPHONE CONDUITS, SIZE OF CONDUITS, DUCT BANK FOOTAGE-STRUCTURE TO STRUCTURE, OR STRUCTURE TO CAP.
- CATV: NUMBER OF CATV CONDUITS, SIZE OF CONDUITS, DUCT BANK FOOTAGE-STRUCTURE TO STRUCTURE, OR STRUCTURE TO CAP.
- COMPETITIVE ACCESS: NUMBER OF COMPETITIVE ACCESS CONDUITS, SIZE OF CONDUITS, DUCT BANK FOOTAGE-STRUCTURE TO STRUCTURE, OR STRUCTURE TO CAP.
- GAS: SIZE OF GAS PIPELINE, FOOTAGE OF PIPELINE-CONNECTION TO STRUCTURE, OR CONNECTION TO CAP.
- SECURITY: NUMBER OF SEC CONDUITS, SIZE OF SEC CONDUITS, DUCT BANK FOOTAGE-STRUCTURE TO STRUCTURE, OR STRUCTURE TO CAP.

REVISIONS	DATE	DESCRIPTION

UNDERGROUND SERVICE ALERT
CALL: **811**
WWW.DIGIALERT.ORG
TWO WORKING DAYS BEFORE YOU DIG

DEVELOPER:
COMPANY NAME
Address
Address

PLANS PREPARED BY:
RGI
UTILITY CONSULTANTS
A PROACTIVE COMPANY
200 S. Main St. - Suite 316
Corona, CA 92882-2211
(951) 123-4567
(951) 279-7900
Fax (951) 279-4116

DRY UTILITY COMPOSITE PLAN
AMETHYST CROSSING
VICTORVILLE, CA

DWN BY: MC, PG	PROJECT MANAGER: BOB GREGORY	DATE: 08/26/21
CKD BY: RGI	PROJECT#: 30,267,000	SHEET: 1 OF 1 SHEETS