

1 SILT FENCE DETAIL N.T.S.

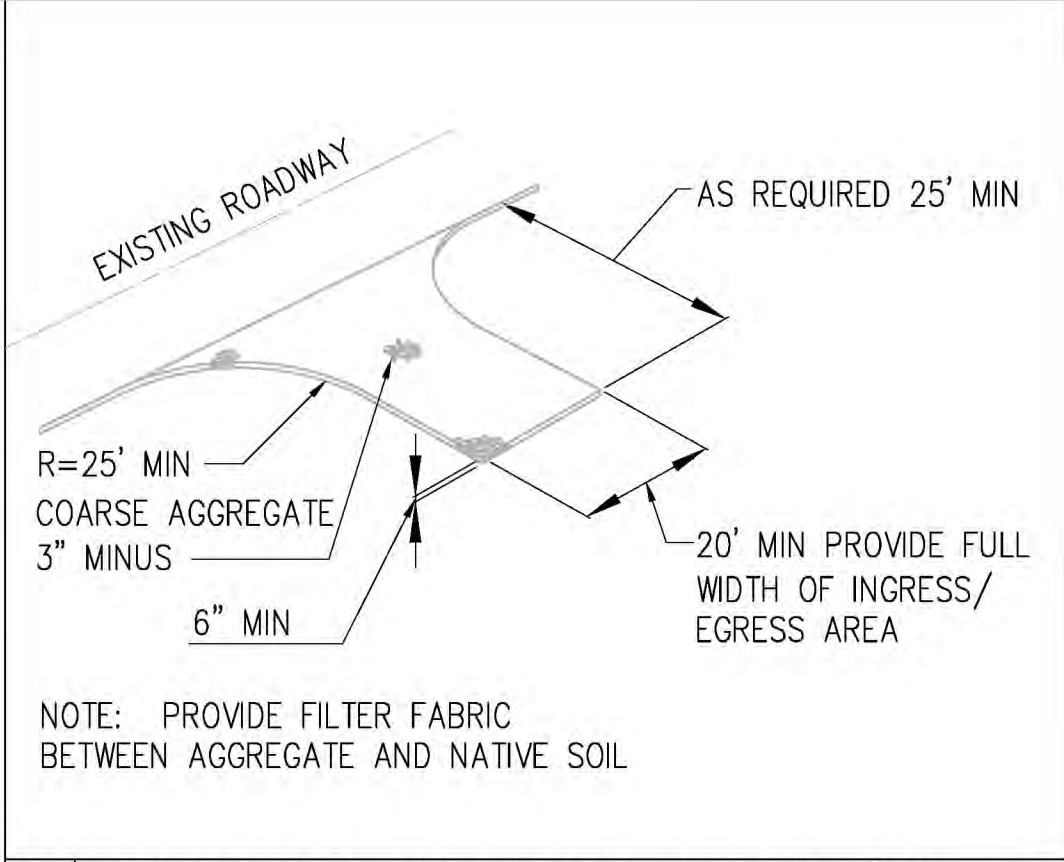

2 STABILIZED CONSTRUCTION ENTRANCE/EXIT N.T.S.

LEGEND:

- SILT FENCE
- EXISTING REINFORCED CONCRETE BOXES
- EXISTING CONCRETE DECK
- PROPOSED STABILIZED CONSTRUCTION ENTRANCE/EXIT
- PROPOSED ROADWAY
- VEGETATED SWALE

EROSION CONTROL KEY NOTES:

- 1 INSTALL SILT FENCE PER DETAIL
- 2 PROVIDE STABILIZED CONSTRUCTION ENTRANCE/EXIT PER CA STORMWATER BMP HANDBOOK REQUIREMENT TC-1

EROSION CONTROL NOTES:

1. ALL DISTURBED SLOPES SHALL BE HYDROSEEDDED.
2. CONTRACTOR TO PROVIDE CONCRETE WASH OUT FACILITY (CSP T59)
3. WHERE SILT FENCE CROSSES BEDROCK, OMIT LATH STAKES AND INSTALL GRAVEL BAGS 4 HIGH WITH SILT FENCE SECURED UNDER TOP BAG.
4. STAKES TO BE POSITIONED ON OUTSIDE OF FENCE.
5. JOINING SECTION STAKES TO OVERLAP WITH FENCE FABRIC FOLDED AROUND EACH STAKE ONE FULL TURN. SECURE FABRIC TO STAKE WITH 4 STAPLES.
6. STAKES TO BE DRIVEN TIGHTLY TOGETHER TO PREVENT POTENTIAL FLOW-THROUGH OF SEDIMENT AT JOINT. TOPS OF STAKES TO BE SECURED WITH WIRE.
7. FOR END STAKE, FENCE FABRIC SHALL BE FOLDED AROUND TWO STAKES ONE FULL TURN AND SECURED WITH 4 STAPLES.
8. MINIMUM 4 STAPLES PER STAKE, EQUALLY SPACED.
9. MAINTENANCE OPENINGS SHALL BE CONSTRUCTED IN A MANNER TO ENSURE SEDIMENT REMAINS BEHIND SILT FENCE.
10. JOINTING SECTIONS SHALL NOT BE PLACED AT SUMP LOCATIONS.
11. GRAVEL BAG ROWS AND LAYERS SHALL BE OFFSET TO ELIMINATE GAPS.
12. NO WORK HAVING POTENTIAL TO CAUSE WATER POLLUTION, AS DETERMINED BY THE ENGINEER, SHALL BE PERFORMED UNTIL THE WATER POLLUTION CONTROL PLAN (WPCP) HAS BEEN APPROVED BY THE ENGINEER.
13. THE CONTRACTOR SHALL CONSIDER OTHER CONTROL MEASURES, AS NECESSARY, TO SUPPLEMENT THE TEMPORARY CONTROL MEASURES SHOWN ON THESE PLANS, IN ORDER TO MEET THE WATER POLLUTION CONTROL OBJECTIVES.
14. ALL VEGETATION SHALL REMAIN, UNLESS OTHERWISE SPECIFIED.
15. CONTRACTOR SHALL MAINTAIN ALL EROSION CONTROL DEVICES AND INSTALL NEW DEVICES AS NEEDED.
16. CONTRACTOR SHALL REMOVE ALL BMP'S FROM SITE UPON COMPLETION OF PROJECT AS DIRECTED BY THE ENGINEER.
17. CONTRACTOR SHALL PLACE GRAVEL BAG BERMS AT THE TOE OF ALL TEMPORARY SLOPES.
18. ALL DISTURBED AREAS WITHIN THE PIA, EXCLUDING ROCK, SHALL BE COVERED WITH TYPE D EROSION CONTROL MATERIALS.
19. THIS PLAN IS A REPRESENTATION ON THE MINIMUM REQUIREMENTS FOR A WPCP. CONTRACTOR SHALL PREPARE AND IMPLEMENT THEIR PROJECT SPECIFIC WPCP PLAN IN ACCORDANCE WITH LOCAL AND STATE REQUIREMENTS.
20. THE CONTRACTOR SHALL BE RESPONSIBLE FOR IMPLEMENTING AND MAINTAINING THE EROSION AND SEDIMENT CONTROL MEASURES AND BMP'S SHOWN IN THE WPCP AND PROJECT SWPPP.
21. TEMPORARY EROSION CONTROL DEVICES SHOWN ON THE PLAN WHICH INTERFERE WITH THE GRADING WORK SHALL BE RELOCATED OR MODIFIED AS AND WHEN THE QSP, COUNTY INSPECTOR OR OWNER DIRECTS, AS THE WORK PROGRESSES TO MEET "AS GRADED" CONDITIONS.
22. ALL LOOSE SOIL AND DEBRIS SHALL BE REMOVED FROM THE STREET AREAS UPON STARTING OPERATIONS AND PERIODICALLY THEREAFTER AS DIRECTED BY THE OWNER.
23. EXCEPT WHEN THE QSP, COUNTY, OR OWNER DIRECTS OTHERWISE, ALL DEVICES SHOWN SHALL BE IN PLACE AT THE END OF EACH WORKING DAY WHEN RAIN IS FORECAST, AND SHALL BE MAINTAINED DURING THE RAINY SEASON.
24. GRAVEL BAGS SHALL BE STOCKPILED ON SITE, READY TO BE PLACED IN POSITION WHEN RAIN IS FORECAST, OR WHEN THE OWNER SO DIRECTS.
25. A "STANDBY EMERGENCY CREW" SHALL BE ALERTED BY THE PERMITTEE OR THE CONTRACTOR TO PERFORM EMERGENCY WORK DURING RAINSTORMS.
26. THE CONTRACTOR SHALL MONITOR THE WEATHER FORECAST, AS REQUIRED BY THE PROJECT SWPPP. IN THE EVENT THE FORECAST CALLS FOR A 50% CHANCE OF RAIN OR MORE WITHIN THE NEXT 48 HOUR WORK PERIOD, THE CONTRACTOR SHALL TAKE MEASURES TO MITIGATE THE WORK STOPPAGE DUE TO THE RAIN EVENT. THE CONTRACTOR SHALL LIMIT THE WORK THAT CAN ONLY BE PERFORMED WITHIN THE WORK DAY. EXPOSED EXCAVATIONS OR TRENCHES SHALL BE COVERED AND PROTECTED FROM WATER. CONTRACTOR SHALL GRADE AREAS SUCH THAT WATER DRAINS AWAY FROM WORK AREA.
27. CONTRACTOR SHALL INSTALL A TEMPORARY CONSTRUCTION ROADWAY (TC-2) OR GRAVEL MULCH (EC-16) IN ORDER TO PREVENT THE OFF-TRACKING OF SEDIMENT IF THE PROJECT QSP REQUIRES THE CONTRACTOR TO DO SO.
28. CONTRACTOR SHALL INSTALL PERIMETER FENCING AROUND WORK AREA IN CONFORMANCE WITH 2009 CASQA STORMWATER BMP MANUAL SECTION WE-1. FENCING SHALL BE CHAIN LINK, AT MINIMUM AND SHALL HAVE FENCE FABRIC ATTACHED.

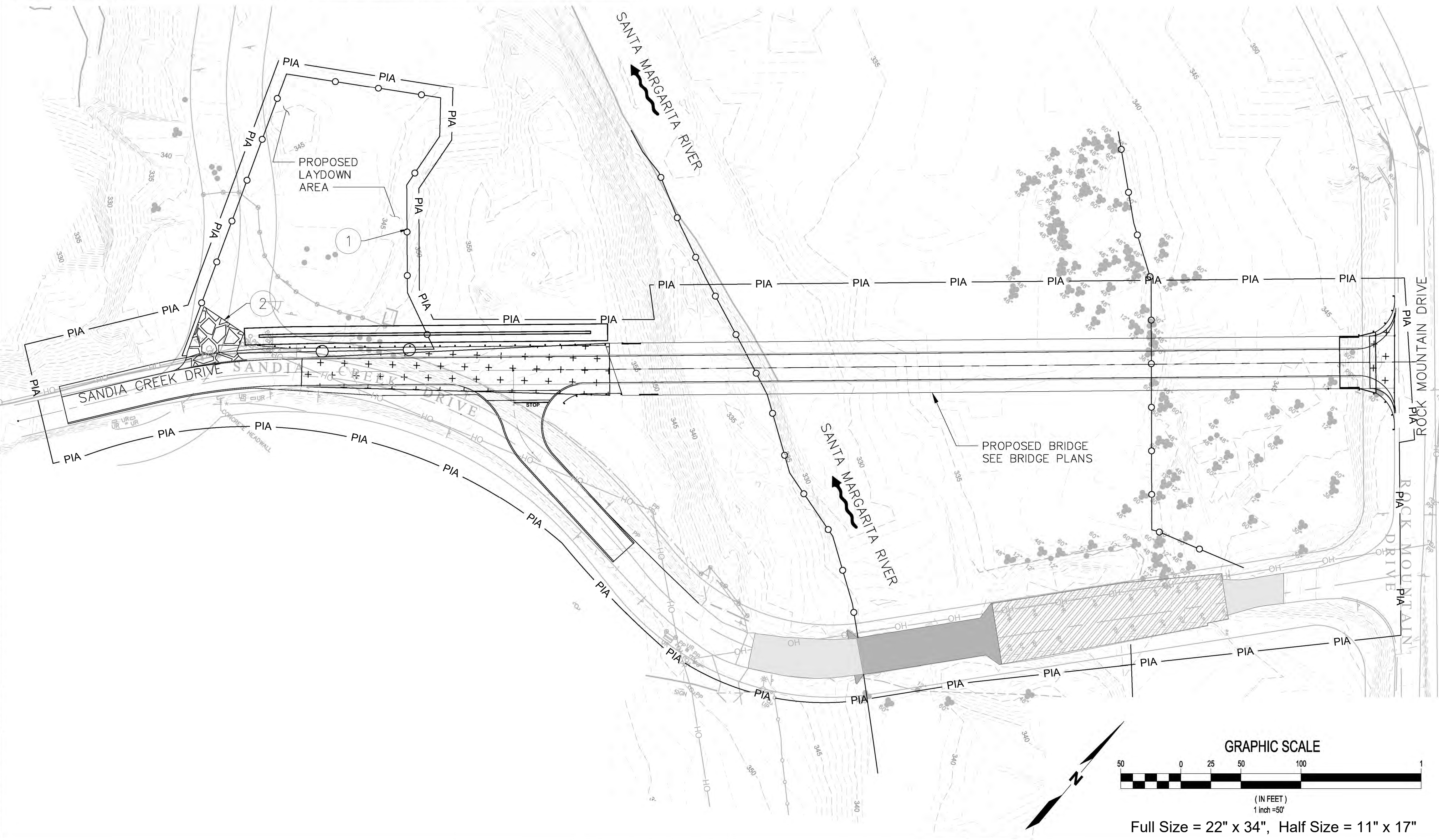

Plotted: Oct 08, 2021 - 4:39pm
 M:\2017\1700232 Santa Margarita River Fish Passage Drawings\Current\xxxxxx-C5-Water Pollution Control Plan.dwg
 Layout: C5
 kedwards
 M:\2017\1700232 Santa Margarita River Fish Passage Drawings\Current\xxxxxx-C5-Water Pollution Control Plan.dwg

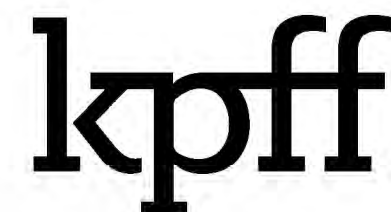

1601 5th Avenue, Suite 1300
 Seattle, Washington 98101
 (206) 382-0600 Fax (206) 382-0500

NO.	DATE	BY	REVISION

SANDIA CREEK ROAD BRIDGE REPLACEMENT

WATER POLLUTION CONTROL PLAN

DRAWN: DYU	PROJECT NO.: 2000118
DESIGN: RO	SCALE: AS SHOWN
CHECKED: TG	DATE: 2021-10-08
DRAWING NO.	C5
SHEET NO.	05 OF 54

FIRST IMPROVEMENT PLAN SUBMITTAL - NOT FOR CONSTRUCTION

Plotted: Oct 08, 2021 - 3:19pm
 M:\2017\1700232 Santa Margarita River Fish Passage\Drawings\Current\xxxxxx-C6-Traffic Control Plan.dwg

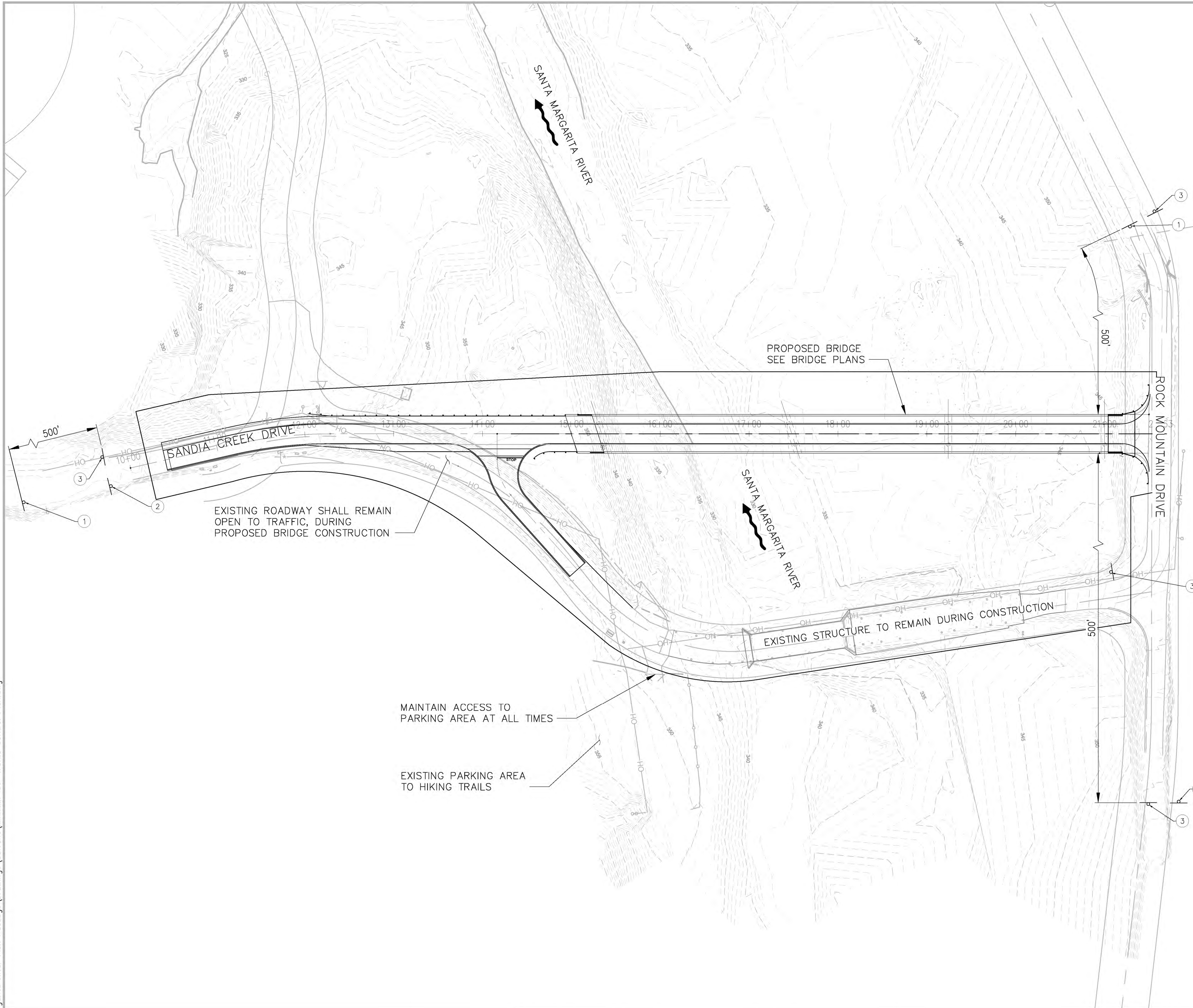

TRAFFIC CONTROL NOTES:

1. CONTRACTOR SHALL MAINTAIN ACCESS TO EXISTING STRUCTURE FOR TRAFFIC DURING CONSTRUCTION.
2. CONTRACTOR SHALL MAINTAIN ACCESS TO EXISTING BRIDGE AND HIKING TRAIL PARKING AREA AT ALL TIMES.
3. REFER TO CONSTRUCTION PHASING PLANS FOR PHASES OF CONSTRUCTION AND ADDITIONAL TRAFFIC CONTROL REQUIREMENTS.
4. CONTRACTOR SHALL PROVIDE FLAG PERSONNEL DURING ALL OPERATIONS REQUIRING THE PUBLIC ROADWAY.
5. EXISTING TRAFFIC SIGNS TO REMAIN IN PLACE, EXCEPT FOR SPEED LIMIT SIGNS WITHIN CONSTRUCTION ZONE.

LEGEND:

○ TRAFFIC SIGN

TRAFFIC CONTROL KEY NOTES:

- ① INSTALL W20-1 SIGN AS SHOWN (TYP 500' BEFORE CONSTRUCTION AREA)
- ② INSTALL W13-1 SIGN AS SHOWN
- ③ INSTALL G20-2 AS SHOWN

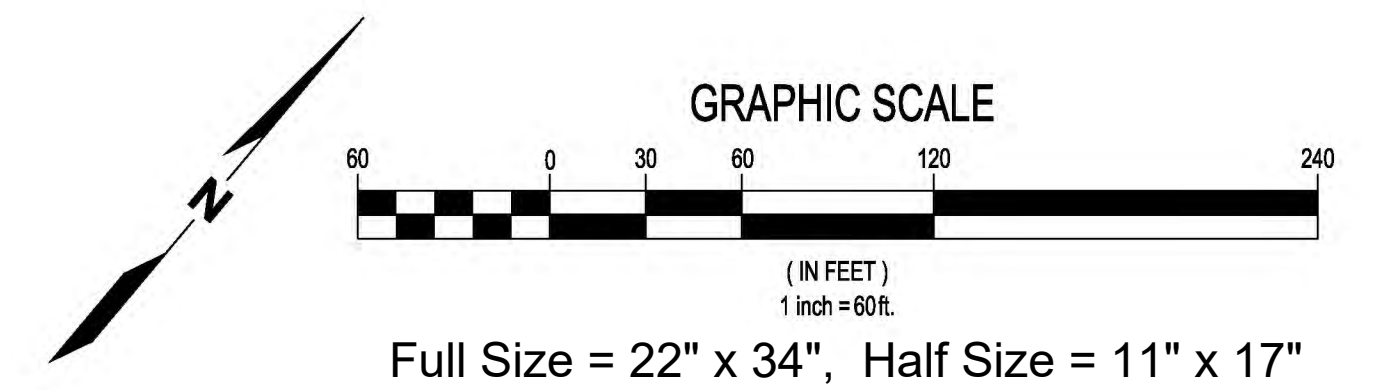
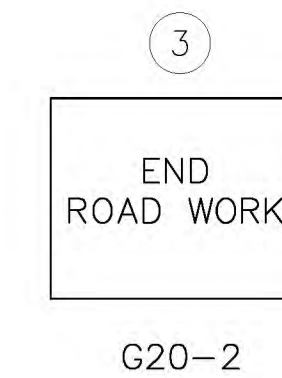
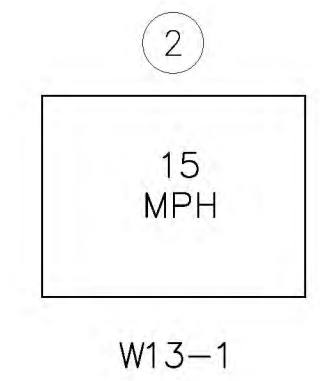

kpff

1601 5th Avenue, Suite 1300
 Seattle, Washington 98101
 (206) 382-0600 Fax (206) 382-0500

NO.	DATE	BY	REVISION

SANDIA CREEK ROAD BRIDGE REPLACEMENT

TRAFFIC CONTROL PLAN



DRAWN: DYU	PROJECT NO.: 2000118
DESIGN: RO	SCALE: AS SHOWN
CHECKED: TG	DATE: 2021-10-08
DRAWING NO.	C6
SHEET NO.	06 OF 54

FIRST IMPROVEMENT PLAN SUBMITTAL - NOT FOR CONSTRUCTION

NOTES:

1. CONTRACTOR SHALL PREVENT ANY MATERIAL FROM ENTERING THE RIVER.
2. EXISTING BRIDGE SHALL REMAIN OPERATIONAL UNTIL NEW BRIDGE IS OPEN TO TRAFFIC.
3. MAINTAIN ACCESS TO EXISTING HIKING TRAILS PARKING AREA.
4. REMOVAL OF EXISTING BRIDGE, ROADWAY, CONCRETE SUPPORTS, AND APPURTENANCES SHALL BE INCLUDED WITHIN THE LIMITS SHOWN ON THE PLANS.
5. CONTRACTOR SHALL REVIEW RECORD DRAWINGS FOR SANDIA CREEK DRIVE R.S. 741-1 WITH A PROJECT COMPLETION DATE OF 12-21-79.
6. UNLESS OTHERWISE SPECIFIED, CONTRACTOR SHALL PROTECT ALL EXISTING UTILITIES IN PLACE.
7. CONTRACTOR SHALL PROTECT THE COAST LIVE OAK TREES WITHIN THE LAYDOWN AREA.

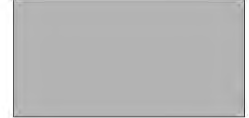
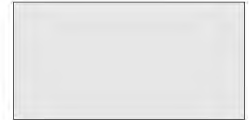
LEGEND:

- PIA — PROJECT IMPACT AREA LIMIT
-  EXISTING REINFORCED CONCRETE BOXES
-  EXISTING ROADWAY
-  EXISTING CONCRETE RETAINING STRUCTURE WITH ROADWAY
- - - - - SAW CUT BOUNDARY

DEMOLITION KEY NOTES:

- (20) REMOVE EXISTING CONCRETE BOX CULVERTS
- (21) REMOVE EXISTING PAVEMENT SECTION
- (22) REMOVE EXISTING CONCRETE SUPPORT STRUCTURE
- (23) REMOVE EXISTING SHEET PILE WALLS
- (24) INSTALL BARRICADES
- (25) REMOVE SIGN

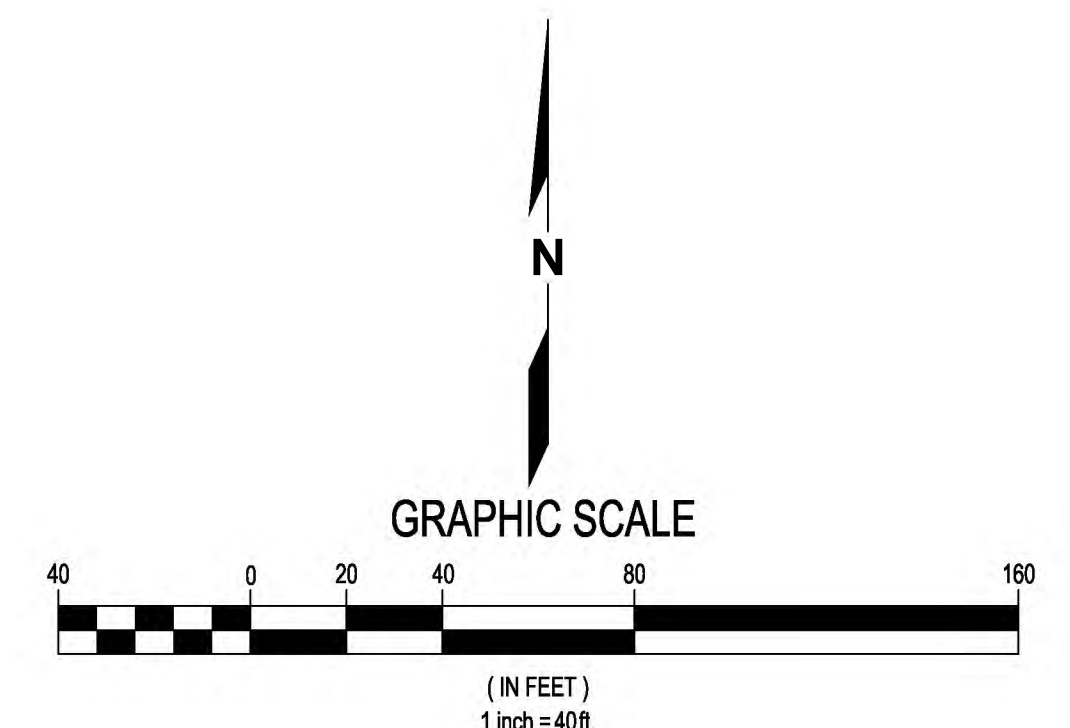

Full Size = 22" x 34", Half Size = 11" x 17"

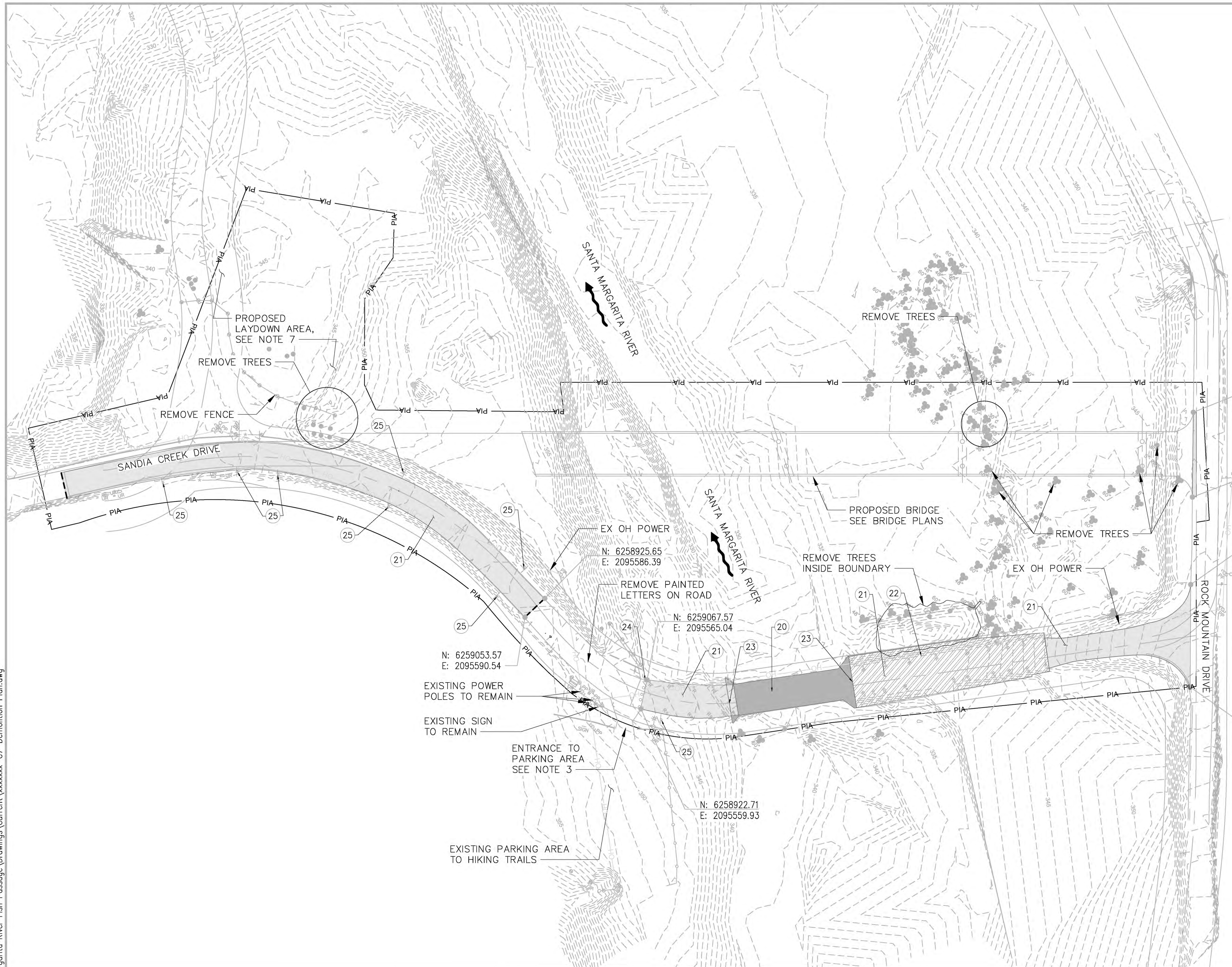

Plotted: Oct 08, 2021 - 3:07pm kedwards Layout: C7
M:\2017\1700232 Santa Margarita River Fish Passage\Drawings\Current\xxxxxx-C7-Demolition Plan.dwg

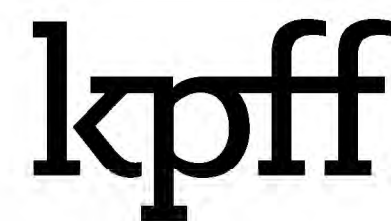

1601 5th Avenue, Suite 1300
Seattle, Washington 98101
(206) 382-0600 Fax (206) 382-0500

NO.	DATE	BY	REVISION

SANDIA CREEK ROAD BRIDGE REPLACEMENT

DEMOLITION PLAN

DRAWN: DYU	PROJECT NO.: 2000118
DESIGN: RO	SCALE: AS SHOWN
CHECKED: TG	DATE: 2021-10-08
DRAWING NO.	C7
SHEET NO.	07 OF 54

FIRST IMPROVEMENT PLAN SUBMITTAL - NOT FOR CONSTRUCTION

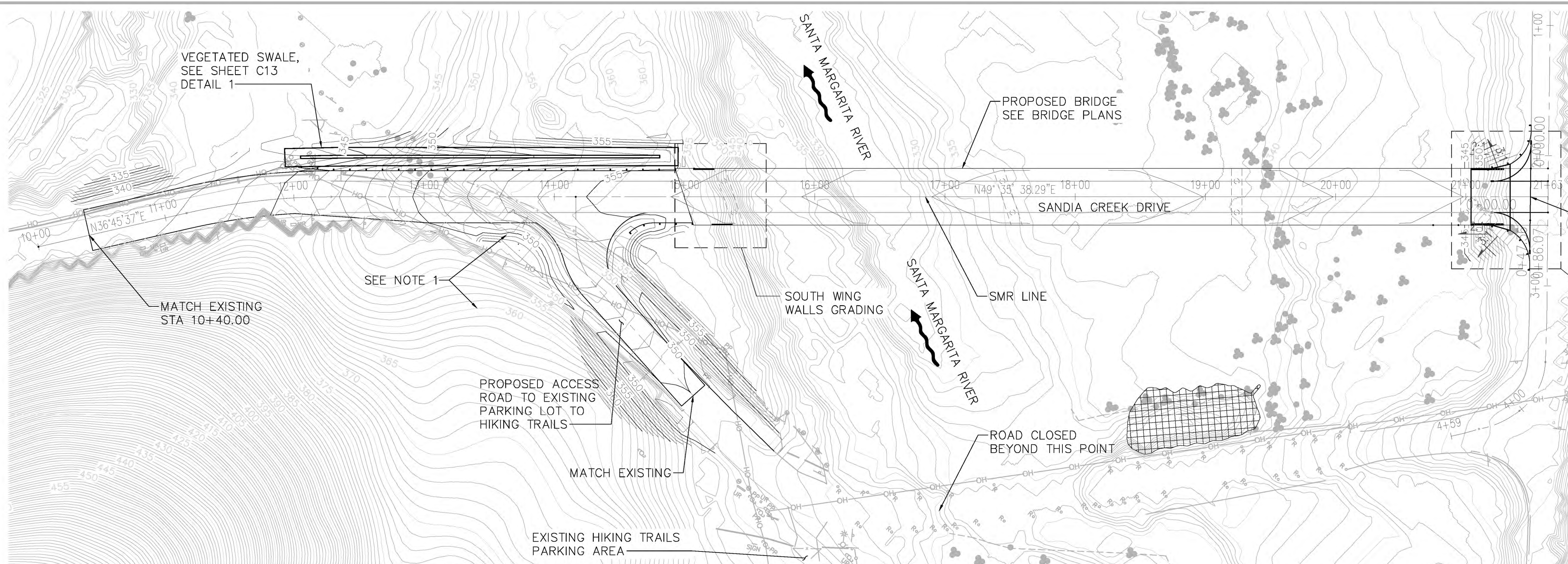

NOTES

- EXISTING CONTOUR LINES ARE SHOWN AT 5' INTERVALS FOR CLARITY. PROPOSED CONTOUR LINES ARE SHOWN AT 1' INTERVALS.

PLAN
1"=50'

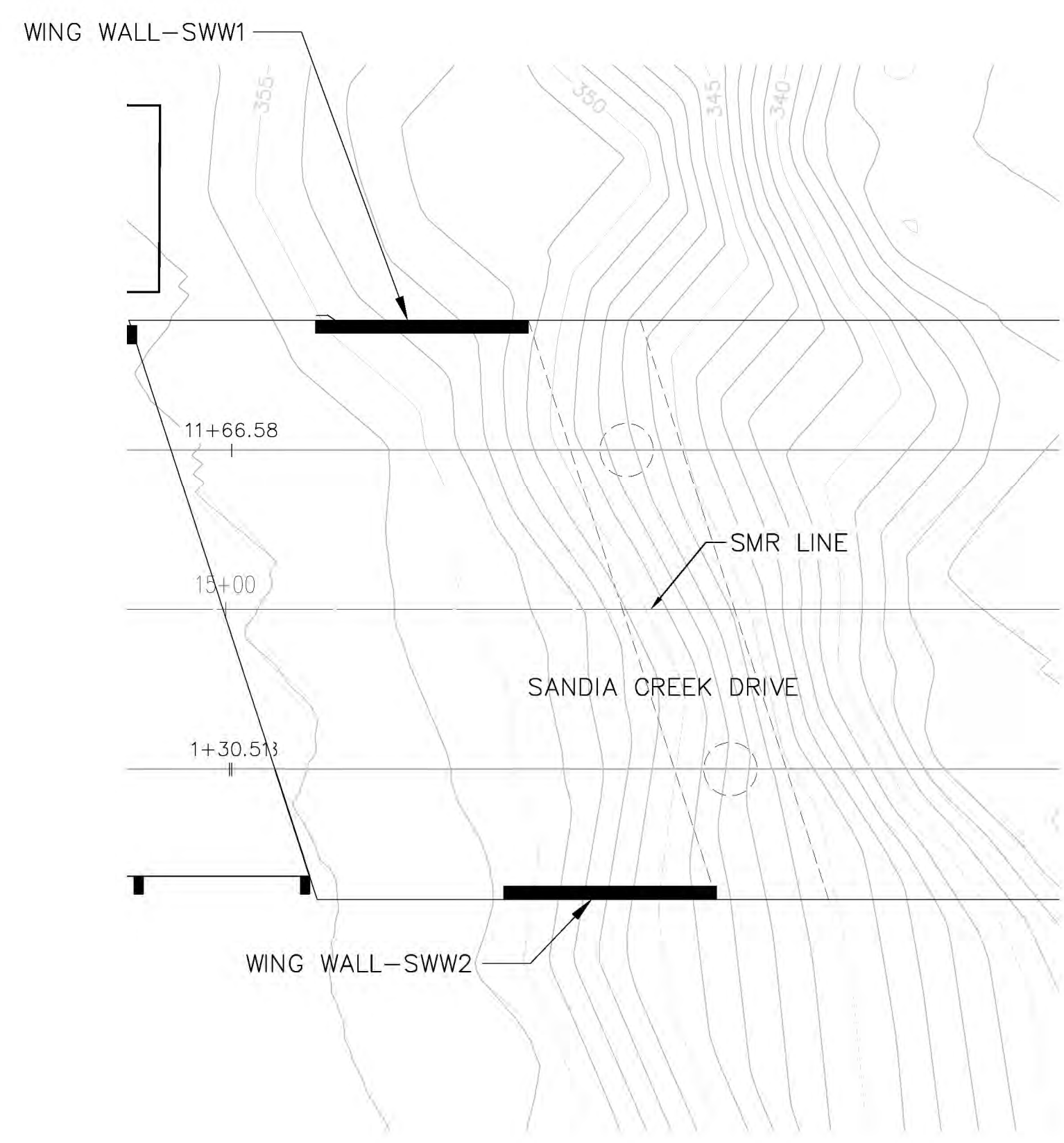

SOUTH WING WALLS GRADING
1"=10'

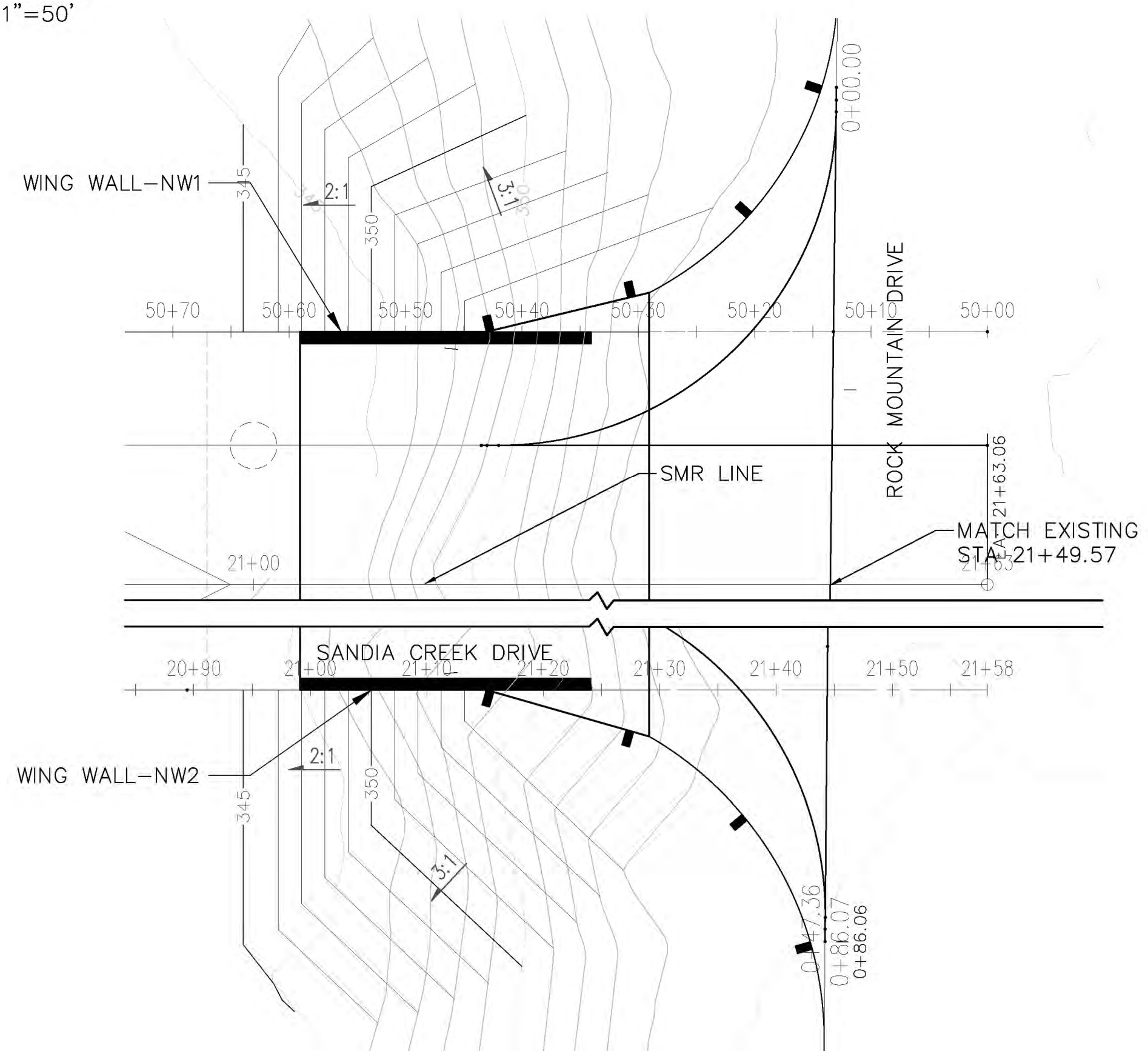

NORTH WING WALLS GRADING
1"=10'

LEGEND:

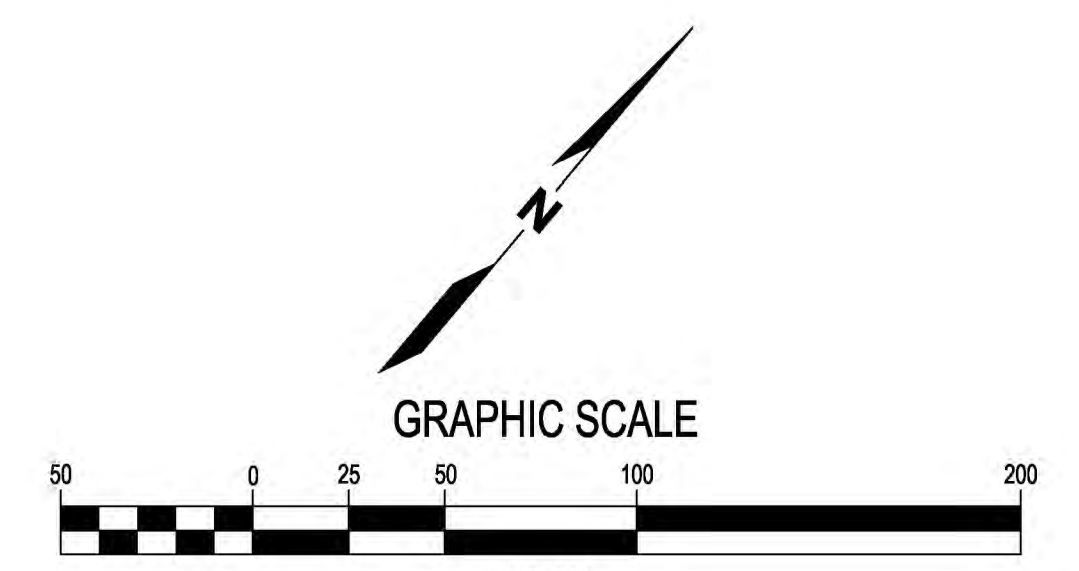

Full Size = 22" x 34", Half Size = 11" x 17"

Plotted: Oct 08, 2021 - 2:59pm
 M: \2017\1700232 Santa Margarita River Fish Passage Drawings\Current\xxxxxx-C8-Grading Plan.dwg
 Layout: C8
 kedwards
 backwards



1601 5th Avenue, Suite 1300
 Seattle, Washington 98101
 (206) 382-0600 Fax (206) 382-0500

NO.	DATE	BY	REVISION

SANDIA CREEK ROAD BRIDGE REPLACEMENT

GRADING PLAN

DRAWN: DYU	PROJECT NO.: 2000118
DESIGN: RO	SCALE: AS SHOWN
CHECKED: TG	DATE: 2021-10-08
DRAWING NO.	C8
SHEET NO.	08 OF 54

FIRST IMPROVEMENT PLAN SUBMITTAL - NOT FOR CONSTRUCTION

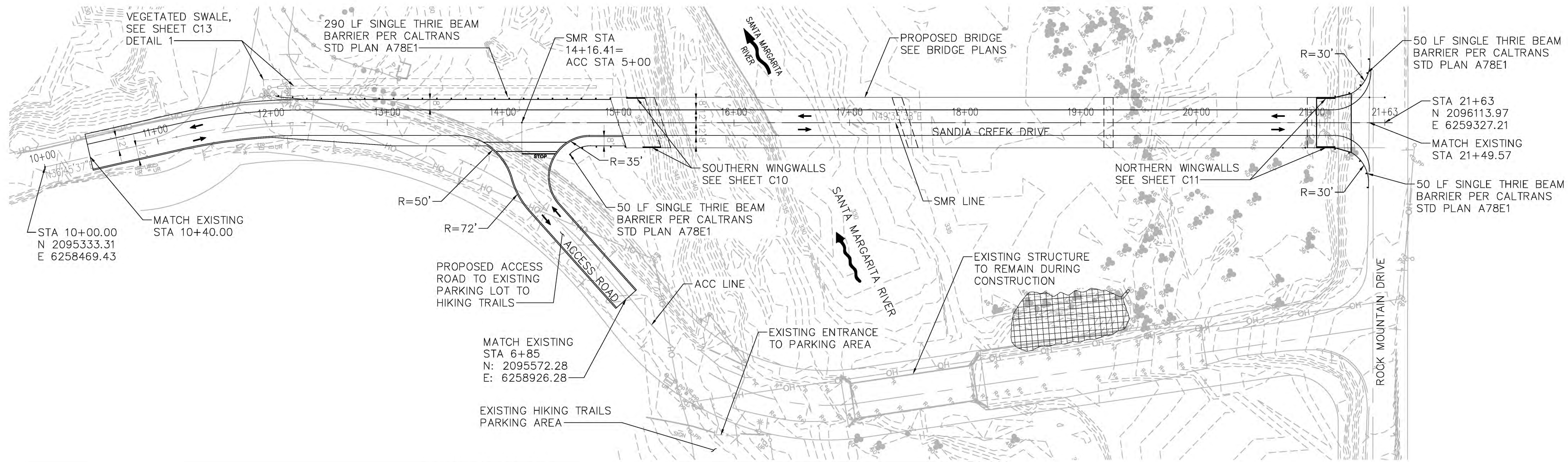

LEGEND:

FILLED SCOUR HOLE (IN CHANNEL)

CURVE DATA							
ALIGNMENT	PI STATION	DELTA	RADIUS	TANGENT	LENGTH	NORTHING	EASTING
SANDIA CREEK DRIVE	11+72.83	12°50'02"	500'	56.23'	112.00'	2095471.81	6258572.83
ACCESS ROAD	5+51.67	41°47'43"	60'	22.91'	43.77'	2095590.65	6258792.16

PLAN
1"=50'

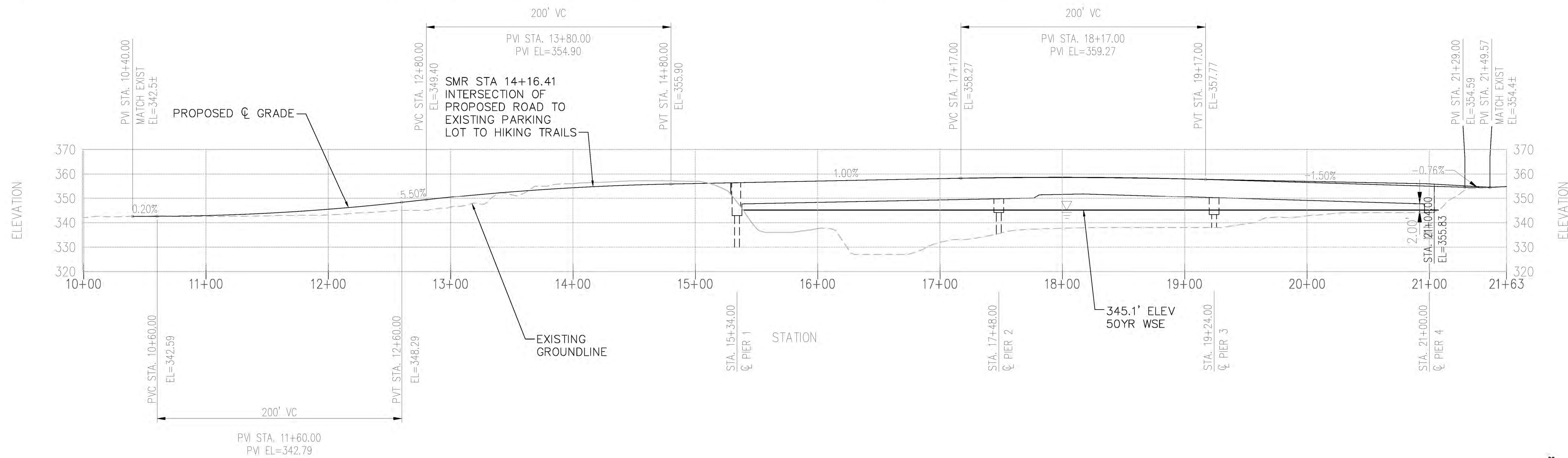

PROFILE

HOR: 1"=50'
VER: 1"=10'

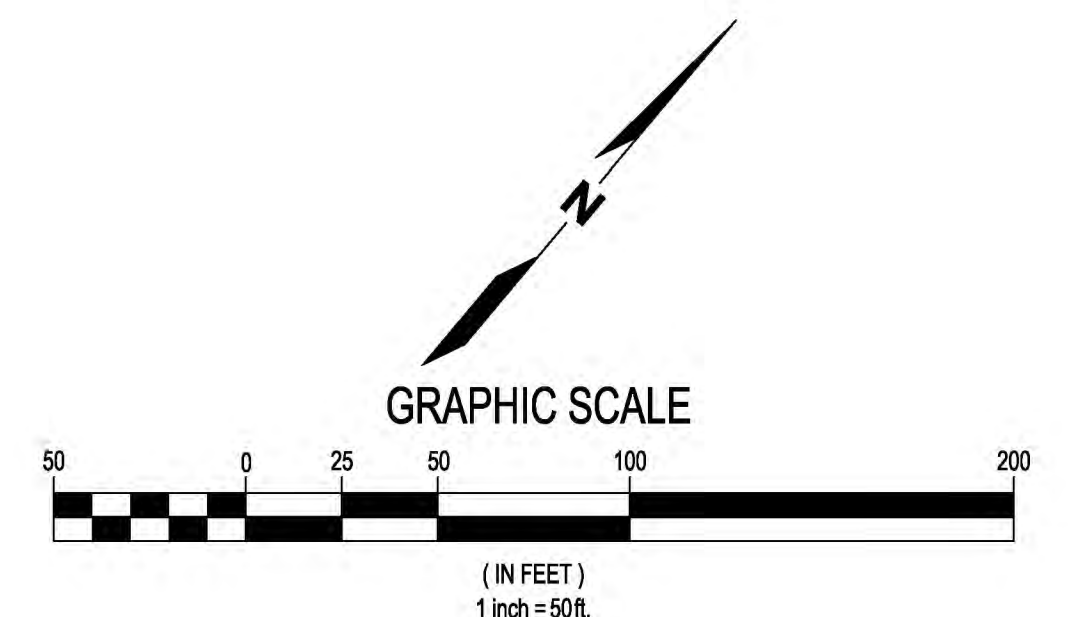

Full Size = 22" x 34", Half Size = 11" x 17"

Plotted: Oct 08, 2021 - 2:49pm
M: \2017\1700232_Santa Margarita River_Fish Passage\Drawings\C9-Roadway_Plan.dwg

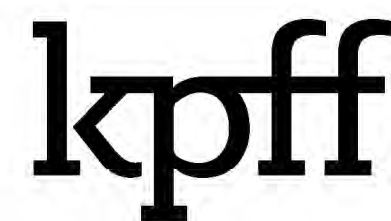

1601 5th Avenue, Suite 1300
Seattle, Washington 98101
(206) 382-0600 Fax (206) 382-0500

NO.	DATE	BY	REVISION

SANDIA CREEK ROAD BRIDGE REPLACEMENT

APPROACH ROADWAY PLAN AND PROFILE

DRAWN: DYU	PROJECT NO.: 2000118
DESIGN: RO	SCALE: AS SHOWN
CHECKED: TG	DATE: 2021-10-08
DRAWING NO.	C9
SHEET NO.	09 OF 54

FIRST IMPROVEMENT PLAN SUBMITTAL - NOT FOR CONSTRUCTION

Plotted: Oct 08, 2021 - 1:40pm
 M: \2017\1700232 Santa Margarita River Fish Passage\Drawings\Current\xxxxxx-C10_C11-Wingwall.dwg



PLAN

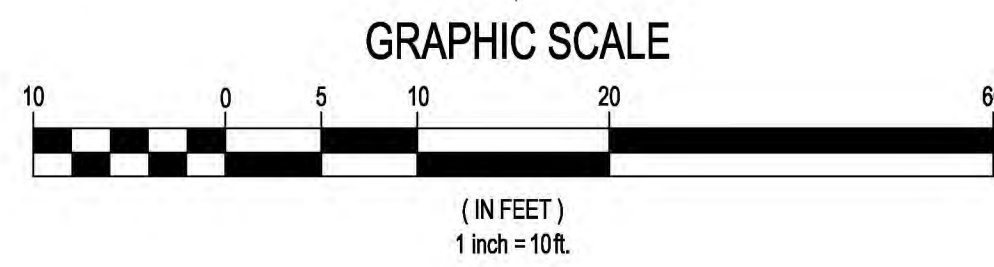

Full Size = 22" x 34", Half Size = 11" x 17"

LEGEND: WINGWALL

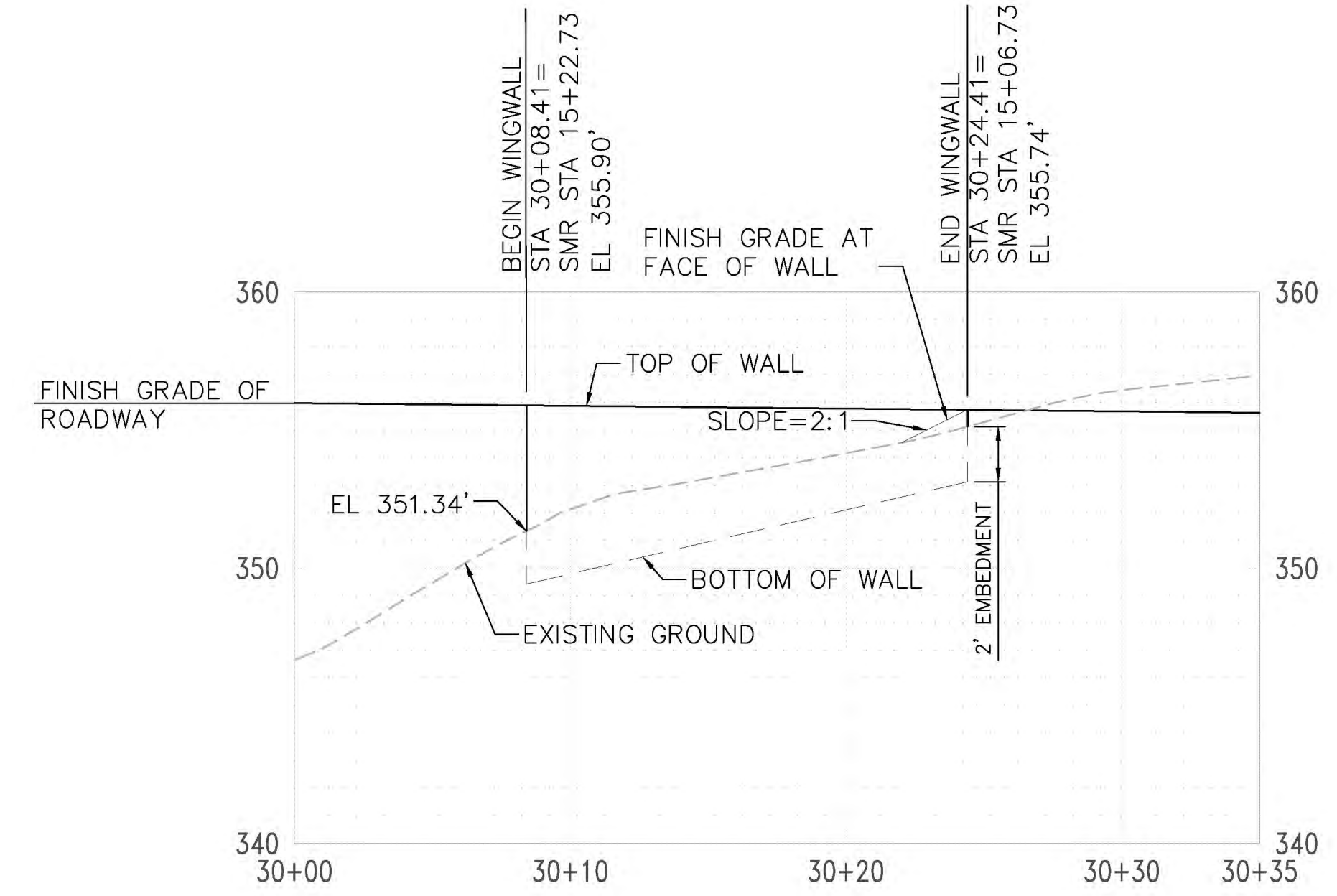

SOUTHERN WINGWALL 1 - SWW1

SCALE: 1 inch = 5 ft.

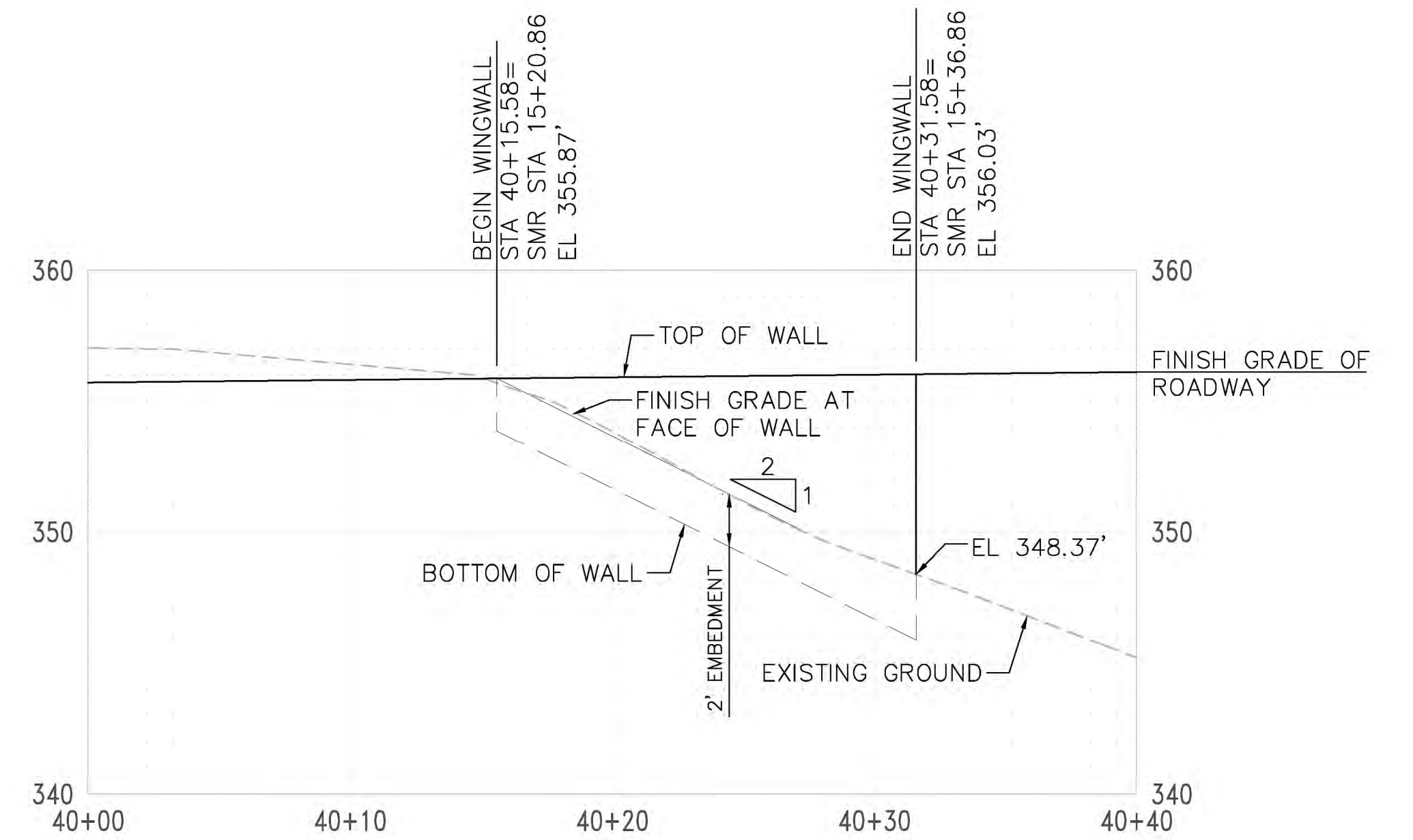

SOUTHERN WINGWALL 2 - SWW2

SCALE: 1 inch = 5 ft.

kpff

1601 5th Avenue, Suite 1300
 Seattle, Washington 98101
 (206) 382-0600 Fax (206) 382-0500

NO.	DATE	BY	REVISION

SANDIA CREEK ROAD BRIDGE REPLACEMENT

**WINGWALL PLAN
 SSW1 AND SSW2**

DRAWN: XXX	PROJECT NO.: 2000118
DESIGN: XXX	SCALE: AS SHOWN
CHECKED: XXX	DATE: 2021-10-08
DRAWING NO.	C10
SHEET NO.	10 OF 54

FIRST IMPROVEMENT PLAN SUBMITTAL - NOT FOR CONSTRUCTION

Plotted: Oct 08, 2021 - 1:49pm
 M:\2017\1700232 Santa Margarita River Fish Passage\Drawings\Current\xxxxxx-C10_C11-Wingwall.dwg

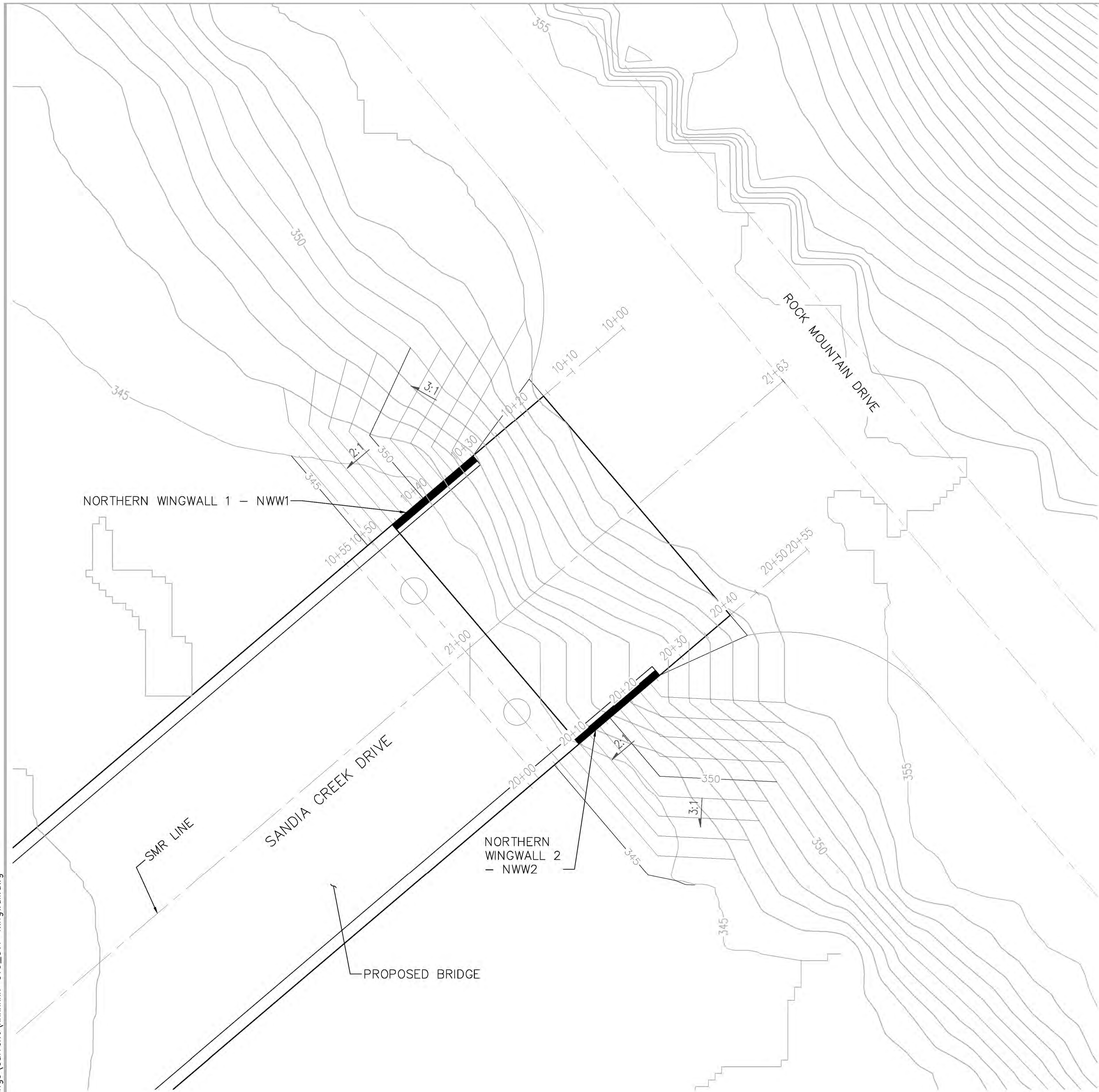

PLAN

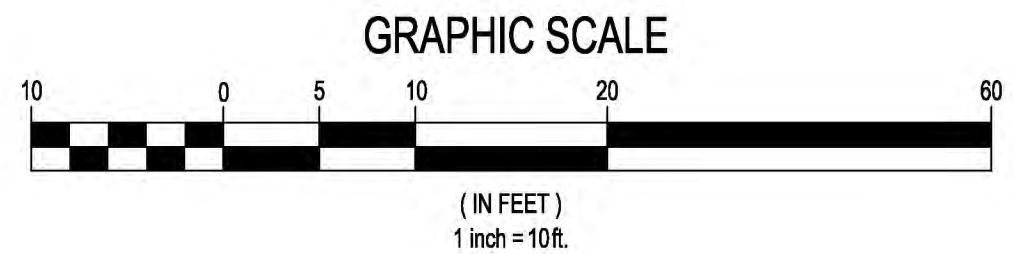

Full Size = 22" x 34", Half Size = 11" x 17"

LEGEND: WINGWALL

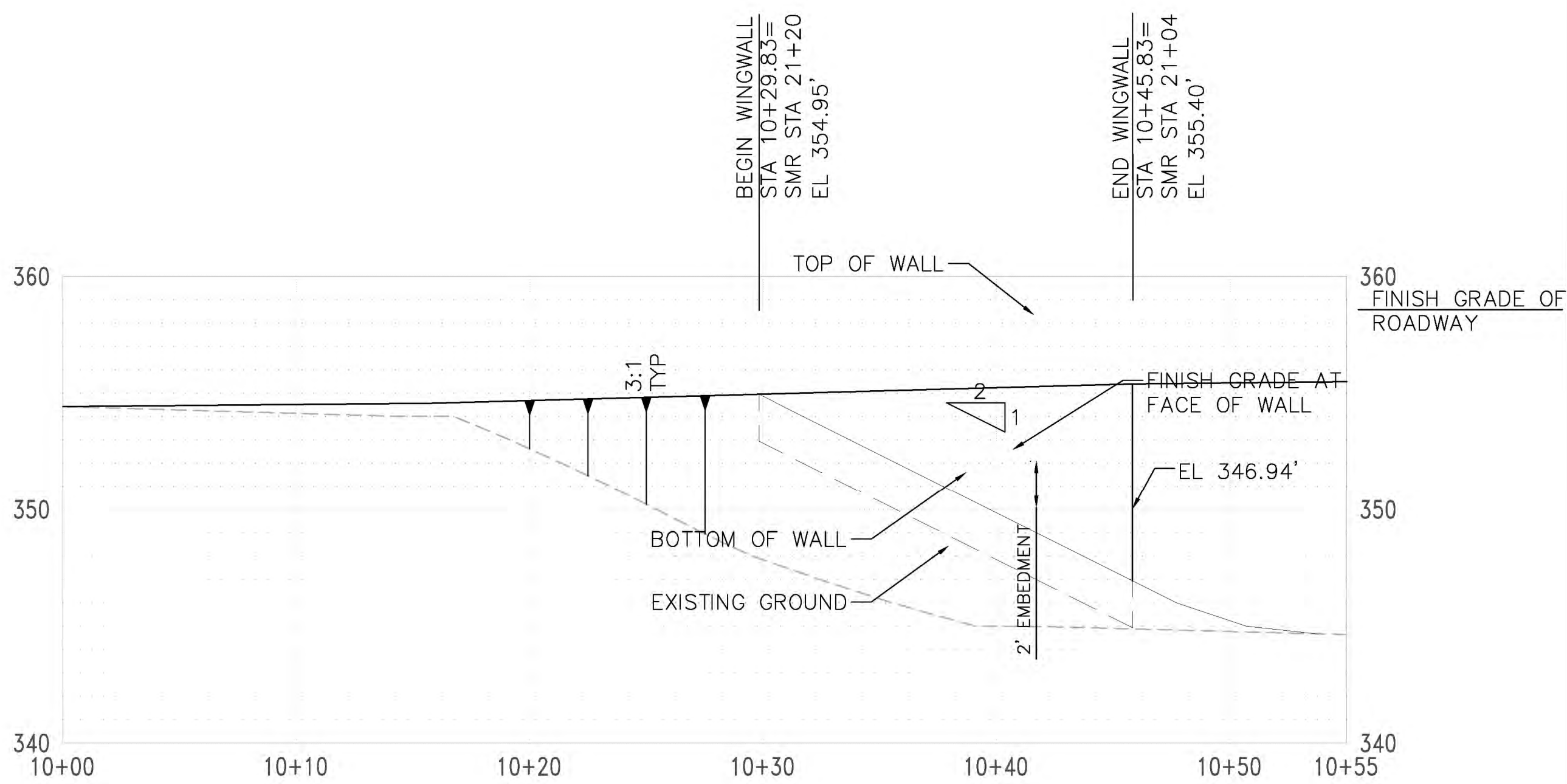

NORTHERN WINGWALL 1 - NWW1

SCALE: 1 inch = 5 ft.

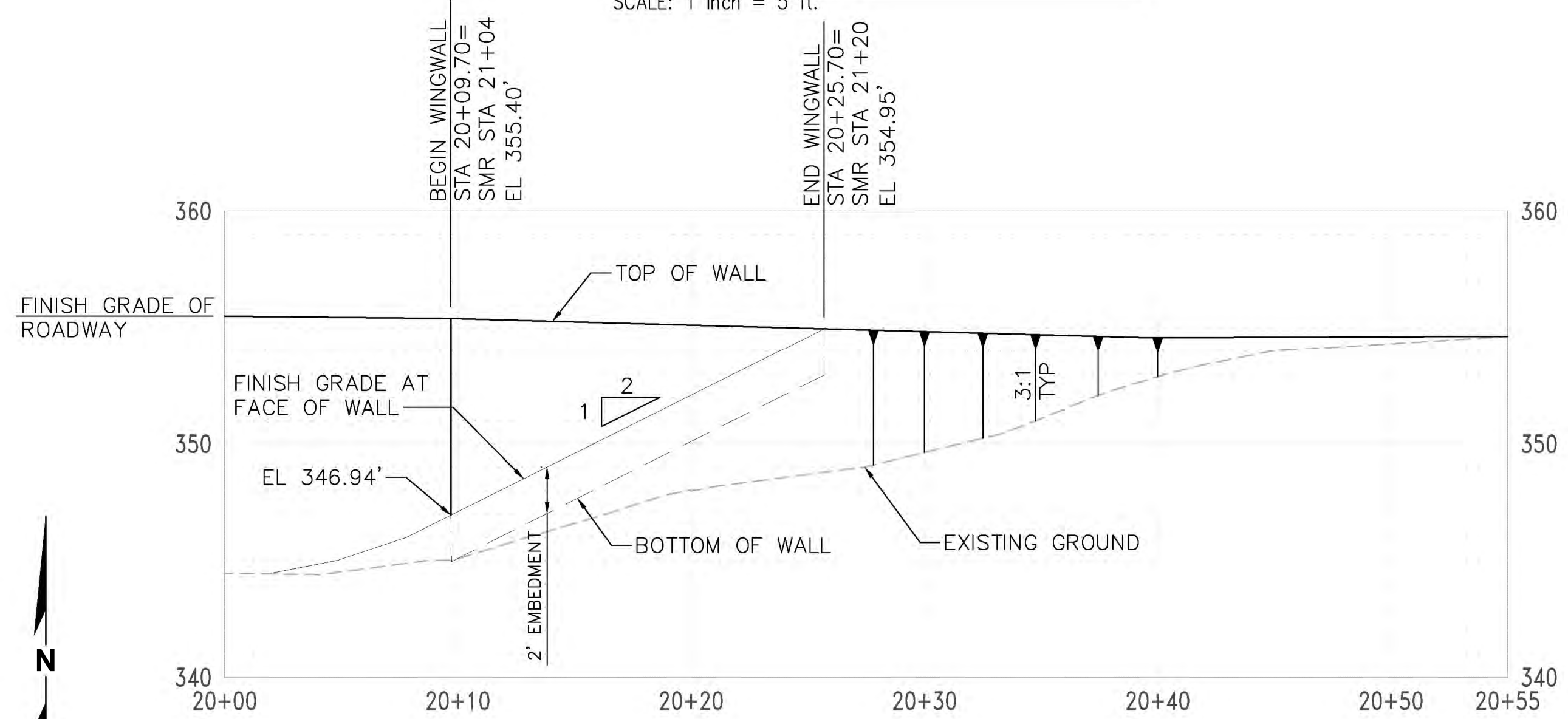

NORTHERN WINGWALL 2 - NWW2

SCALE: 1 inch = 5 ft.

kpff

1601 5th Avenue, Suite 1300
 Seattle, Washington 98101
 (206) 382-0600 Fax (206) 382-0500

NO.	DATE	BY	REVISION

SANDIA CREEK ROAD BRIDGE REPLACEMENT

**WINGWALL PLAN
 NWW1 AND NWW2**

DRAWN: XXX	PROJECT NO.: 2000118
DESIGN: XXX	SCALE: AS SHOWN
CHECKED: XXX	DATE: 2021-10-08
DRAWING NO.	C11
SHEET NO.	11 OF 54

FIRST IMPROVEMENT PLAN SUBMITTAL - NOT FOR CONSTRUCTION

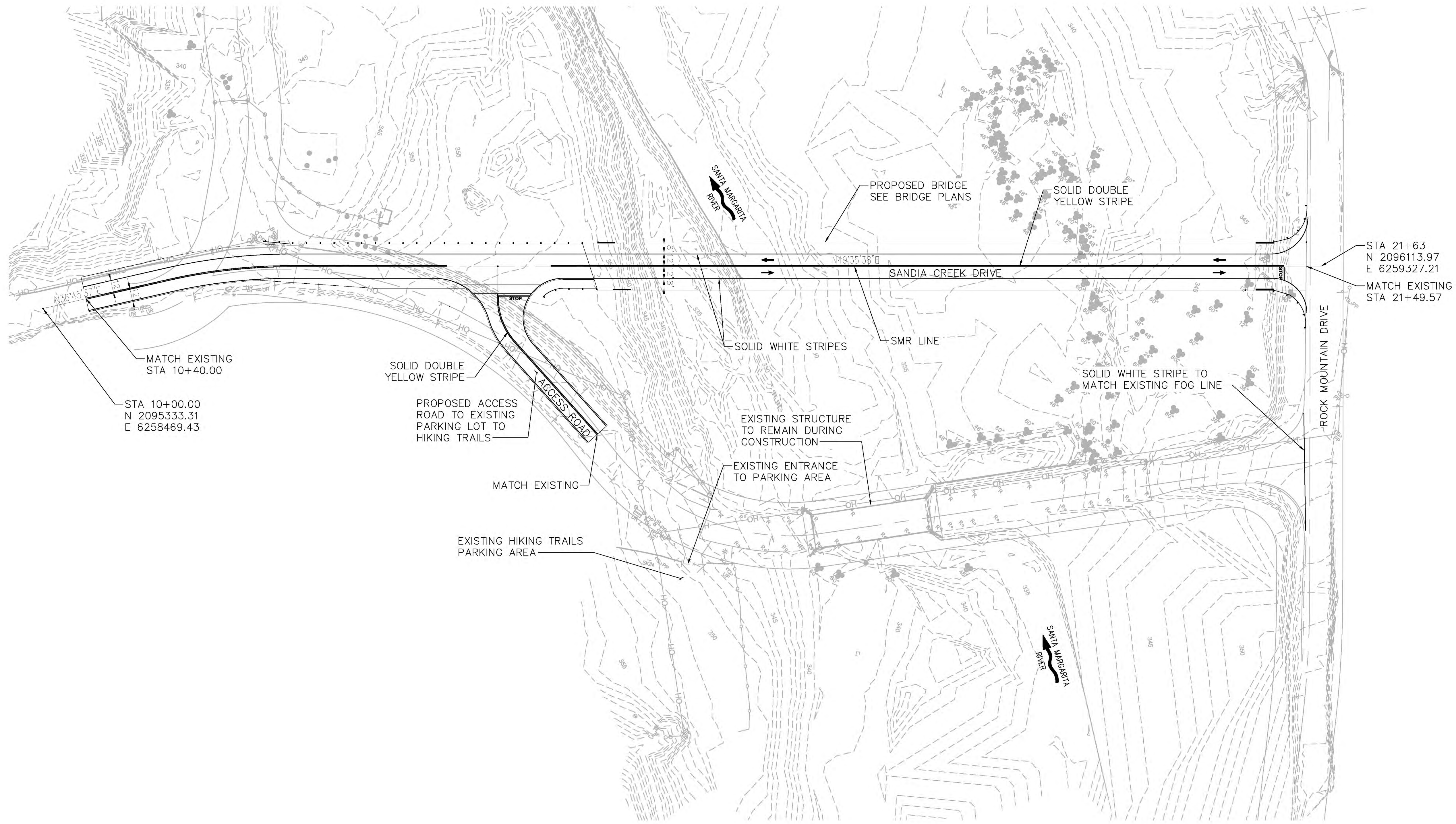

PLAN
1"=50'

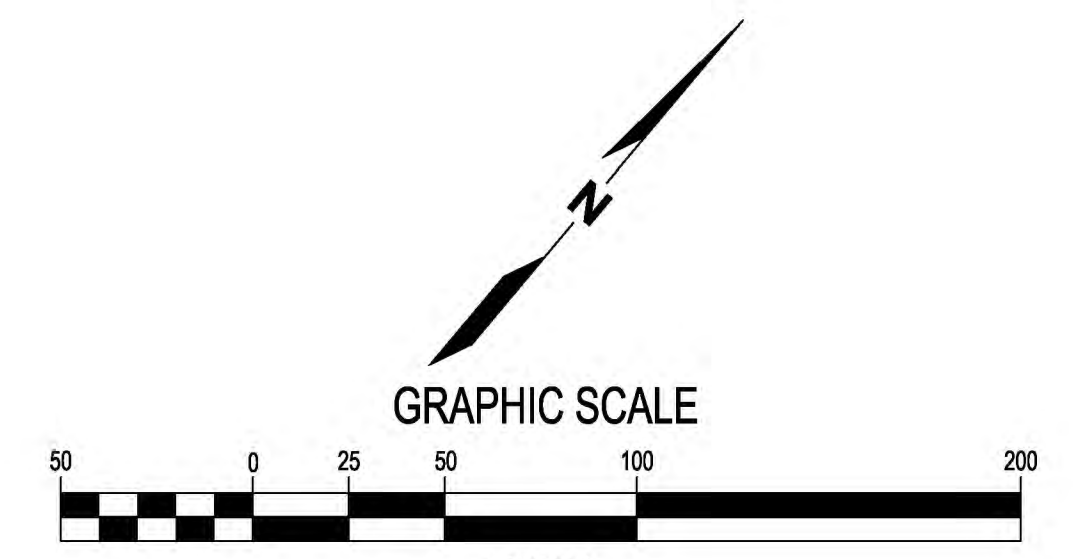

Full Size = 22" x 34", Half Size = 11" x 17"

Plotted: Oct 08, 2021 - 2:10pm kedwards Layout: C12
M:\2017\1700232 Santa Margarita River Fish Passage\Drawings\Current\xxxxxx-C12-Striping Plan.dwg

kpff

1601 5th Avenue, Suite 1300
Seattle, Washington 98101
(206) 382-0600 Fax (206) 382-0500

NO.	DATE	BY	REVISION

SANDIA CREEK ROAD BRIDGE REPLACEMENT

STRIPING PLAN

DRAWN: DYU	PROJECT NO.: 2000118
DESIGN: RO	SCALE: AS SHOWN
CHECKED: TG	DATE: 2021-10-08
DRAWING NO.	C12
SHEET NO.	12 OF 54

FIRST IMPROVEMENT PLAN SUBMITTAL - NOT FOR CONSTRUCTION

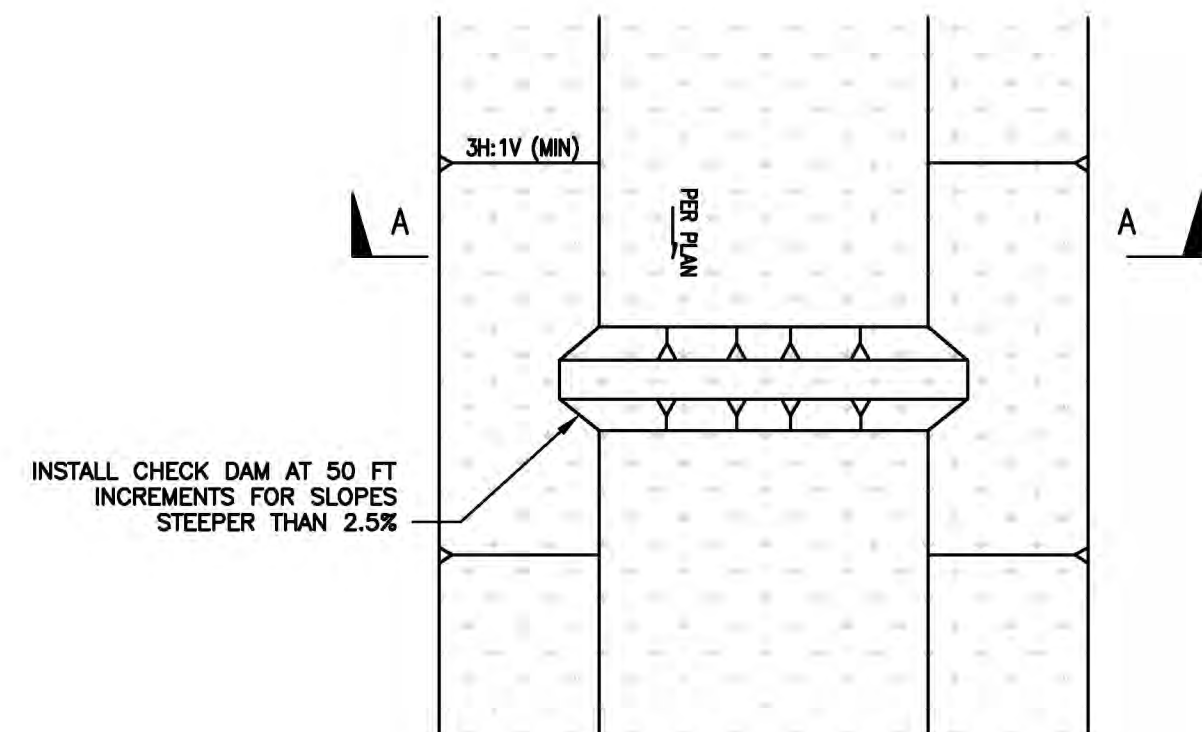

PLAN

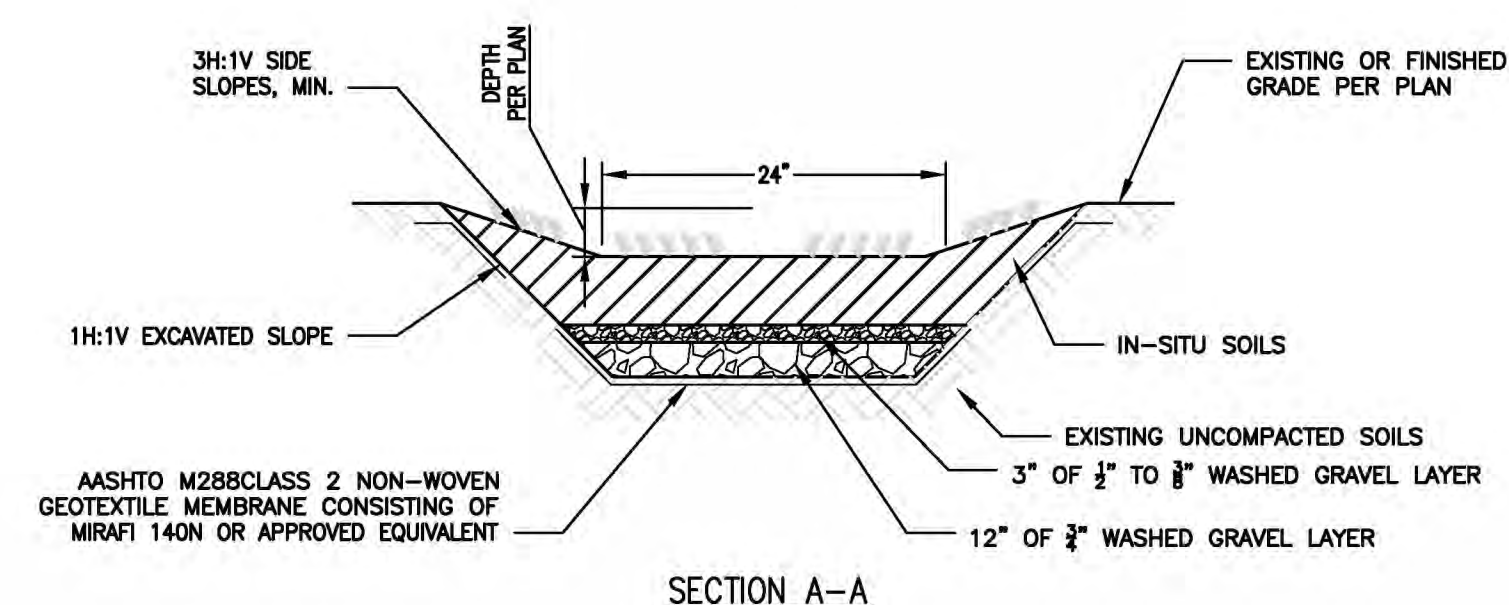

SECTION A-A

NOTES:

1. BUILD AND VEGETATE SWALE AS EARLY AS POSSIBLE TO ESTABLISH PLANTINGS BEFORE DIRECTING STORMWATER RUNOFF TO IT OR DIVERT STORMWATER AROUND FACILITY. PREFERABLY THIS PERIOD WOULD LAST A MINIMUM OF 3 MONTHS.
2. DURING INSTALLATION, DISTURB NATIVE SOILS AS LITTLE AS POSSIBLE.
3. REPAIR, SEED, OR RE-PLANT DAMAGED AREAS IMMEDIATELY.
4. VEGETATED SWALES SHALL NOT BE LOCATED ON SLOPES GREATER THAN 6%.
5. THE SWALE SHALL BE VEGETATED WITH A MIX OF EROSION-RESISTANT PLANT SPECIES THAT EFFECTIVELY BIND THE SOIL. PROPOSED VEGETATION SHOULD THE FOLLOWING SPECIFICATIONS:
 - a. VEGETATION SHALL BE NATIVE OR ADAPTED GRASSES PER COUNTY OF SAN DIEGO BMP DESIGN MANUAL. SUITABLE PLANT TYPES CAN ALSO BE FOUND AT [HTTP://CALFLORA.ORG](http://CALFLORA.ORG).
 - b. VEGETATIVE COVER SHOULD BE AT LEAST 4" IN HEIGHT, ALTHOUGH 6" IS PREFERRED.

1 | VEGETATED SWALE

N.T.S.

Plotted: Oct 06, 2021 - 8:23am
 User: dju
 Layout: C13
 File: \\2017\1700232 Santa Margarita River Fish Passage\Drawings\Current\coccococ-C13-Details.dwg

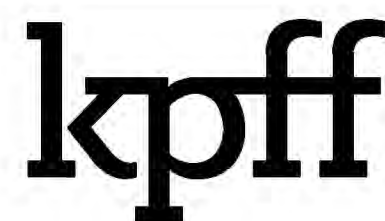

1601 5th Avenue, Suite 1300
 Seattle, Washington 98101
 (206) 382-0600 Fax (206) 382-0500

NO.	DATE	BY	REVISION

SANDIA CREEK ROAD BRIDGE REPLACEMENT

DETAILS

DRAWN: XXX	PROJECT NO.: 2000118
DESIGN: XXX	SCALE: AS SHOWN
CHECKED: XXX	DATE: 2021-10-08
DRAWING NO.	C13
SHEET NO.	13 of 54

FIRST IMPROVEMENT PLAN SUBMITTAL - NOT FOR CONSTRUCTION

Plotfile: Dec 15, 2021 - 12:47pm anunez Layout: C14
 M:\2017\1700232 Santa Margarita River Fish Passage\Drawings\Current\xxxxxx-C13-Details.dwg

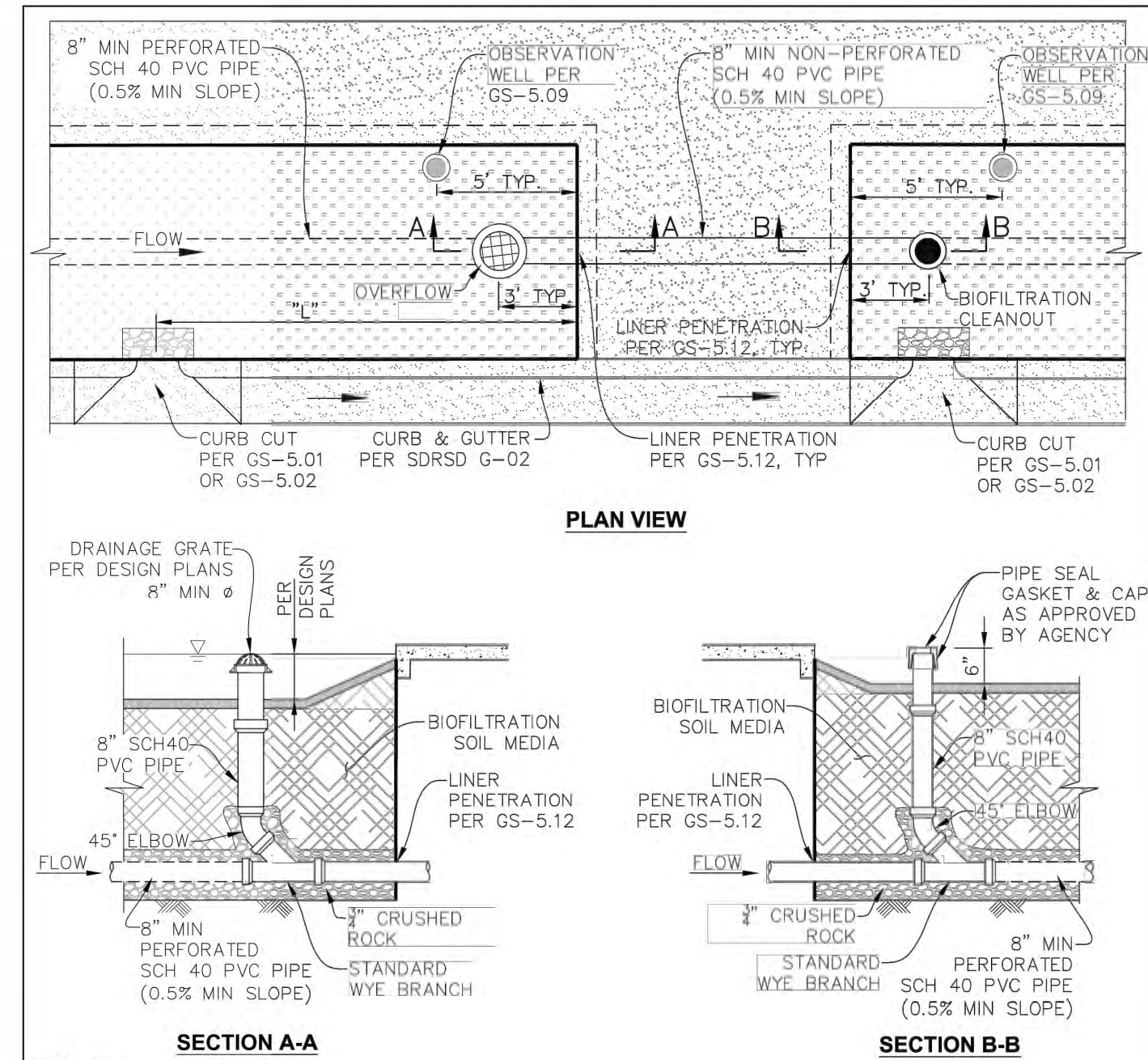

- NOTES:**
1. OBSERVATION WELL & CLEANOUT CAP ELEVATIONS ARE INDEPENDENT OF THE BMP PONDING DEPTHS.
 2. REFER TO SDRSD SC-01 FOR ANY OMITTED DIMENSIONS OR CALLOUTS RELATED TO CLEANOUTS.
 3. RECOMMENDED MAX CLEANOUT SPACING = 150-FT O.C.
 4. PLACE OBSERVATION WELLS STRATEGICALLY AS TO MEASURE BMP PERFORMANCE; PER DESIGN PLANS.
 5. OVERFLOW RISER MATERIAL AS SPECIFIED PER PROJECT-SPECIFIC DESIGN PLANS.
 6. OVERFLOW RISERS LARGER THAN 12-INCH DIAMETER SHALL DRAIN DIRECTLY TO PUBLIC STREET FACILITIES PER GS-5.12 & GS-5.13 (WHERE APPLICABLE).
 7. MINIMUM OVERFLOW RISER GRATE OPENING SIZE SHALL BE 1-1/4"; GRATE SHALL FIT SNUG AND BE REMOVABLE FOR MAINTENANCE PURPOSES.
 8. DISTANCE "L" IS DEPENDENT ON STREET SLOPE AND DESIGN PONDING DEPTH; REFER TO PROJECT-SPECIFIC DESIGN PLANS FOR SAID DIMENSION.

DRAWN BY: NRG	CHECKED BY: JRB	SAN DIEGO COUNTY DESIGN STANDARD		REVISIONS	APPROVED	DATE
RECOMMENDED BY: CHARLES MOHRLOK, P.E.		CLEANOUTS, OBSERVATION WELLS, & OVERFLOW RISERS ADJACENT TO BMP LIMITS	ORIGINAL			10-01-2019
APPROVED BY COUNTY ENGINEER			REVISED			
DATE: 3/15/21 WILLIAM P. MORGAN, P.E. R.C.E. NO. 49452, EXP. 9/30/2022		DRAWING NOT TO SCALE	DRAWING NUMBER		GS-5.10	

COUNTY TRAILS PROGRAM
COMMUNITY TRAILS MASTER PLAN

TYPE B - RURAL TRAIL

Trail type intended for medium volume of use generally associated within a rural setting. These trails are intended to function as recreation and transportation facilities. Although accessible to all trail users, some uses may not be practical in steep terrain.

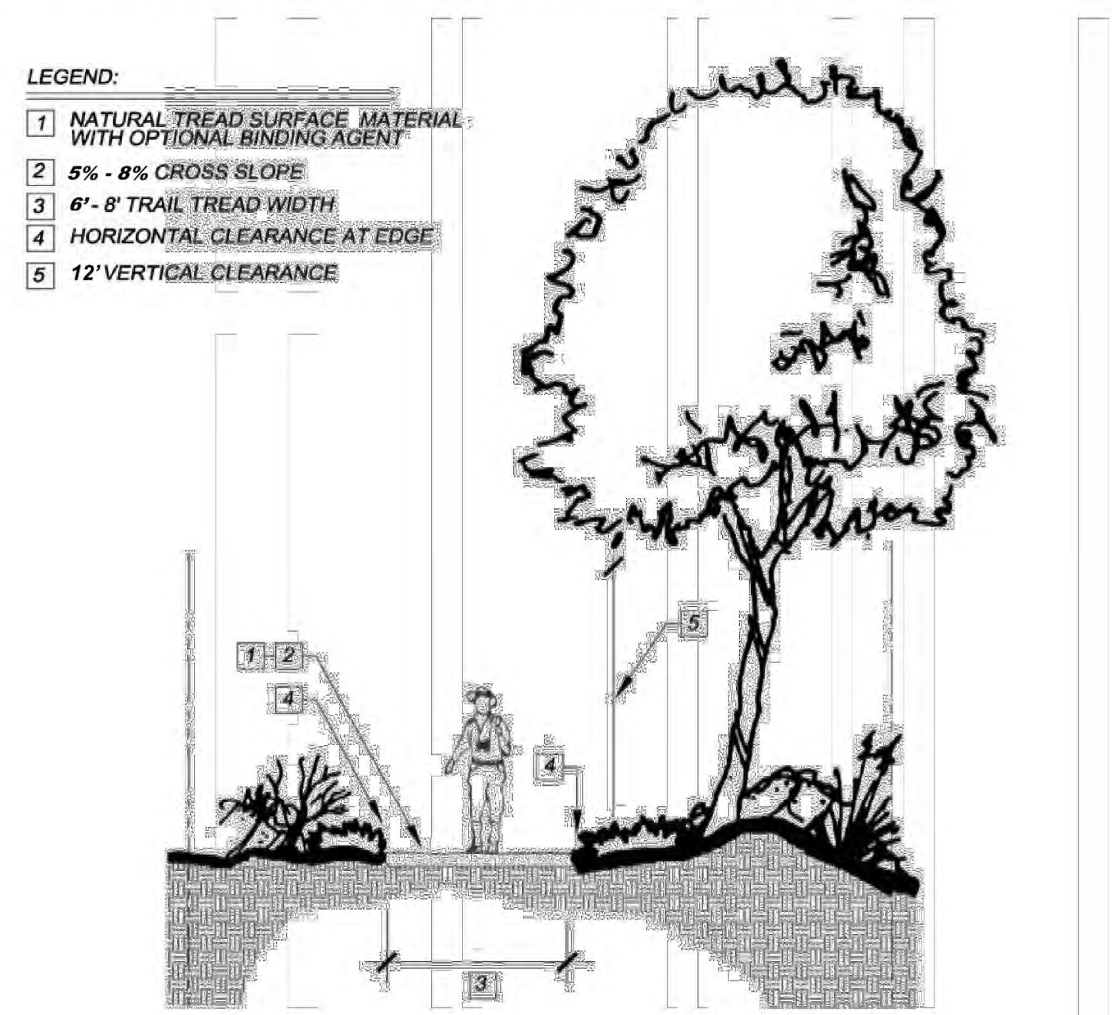

- Notes:**
1. "Optimum" The best or most favorable condition for a particular trail situation from the perspective of responsible management.
 2. See Trail Matrix Guidelines for "Optimum" guidelines and descriptions.

FIGURE DG-2

COUNTY OF SAN DIEGO
COMMUNITY TRAILS MASTER PLAN

1	CLEANOUT	N.T.S.	2	TYPE B - RURAL TRAIL	N.T.S.
---	----------	--------	---	----------------------	--------

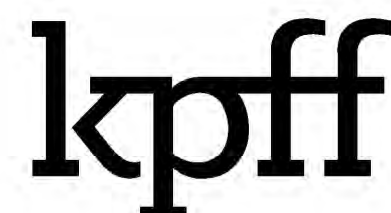

1601 5th Avenue, Suite 1300
Seattle, Washington 98101
(206) 382-0600 Fax (206) 382-0500

NO.	DATE	BY	REVISION

SANDIA CREEK ROAD BRIDGE REPLACEMENT

DETAILS

DRAWN: XXX	PROJECT NO.: 2000118
DESIGN: XXX	SCALE: AS SHOWN
CHECKED: XXX	DATE: 2021-10-08
DRAWING NO.	C14
SHEET NO.	14 OF 54

FIRST IMPROVEMENT PLAN SUBMITTAL - NOT FOR CONSTRUCTION