



701 N. Bullis Rd.  
Compton, CA 90224-9099

May 11, 2020

CAJA Environmental Services, LLC  
15350 Sherman Way, Suite 315  
Van Nuys, CA 91406  
Attn: Sherrie Cruz

**Subject: Maps - 6360-6366 Hollywood Blvd & 1646 Cosmo St**

Enclosed is the information you requested relating to the location of gas facilities within the area of your project. The information we have provided was obtained from a search of all our available records and are approximate in nature. Due to numerous factors, the depths of our facilities vary and should not be taken for granted. If exact depth location and information is required at points of possible interference, it will be necessary to physically check the facility in question.

It is extremely important that you furnish us with “**signed**” final plans and subsequent plan revisions as soon as they are available. A minimum of twelve (12) weeks is needed to analyze your plans and to design required alterations due to any conflicting facilities. Depending on the magnitude of the work involved, additional time may then be required to clear the conflict. Please keep us informed of construction schedules, preconstruction meetings, etc., so that our work can be scheduled accordingly.

Upon request, at least two (2) working days prior to the start of construction, we will locate and mark our active underground facilities for the contractor at no cost. Please call Underground Service Alert (USA) at (800) 422-4133.

You will also have to contact our Transmission Department regarding the above-mentioned request. CPUC Regulations require notification of both SoCal Gas Distribution and Transmission of all work being conducted. Please contact SoCal Gas Transmission, at 9400 Oakdale Avenue, Chatsworth, CA 91313, [socalgastransmissionutilityrequest@semprautilities.com](mailto:socalgastransmissionutilityrequest@semprautilities.com). They will need a notification letter and plans.

If you have any questions or require additional information please contact me at (310) 687-2011

Sincerely,

*Jason Sum*

Jason Sum

Pipeline Planning Assistant

SoCalGas-Compton HQ

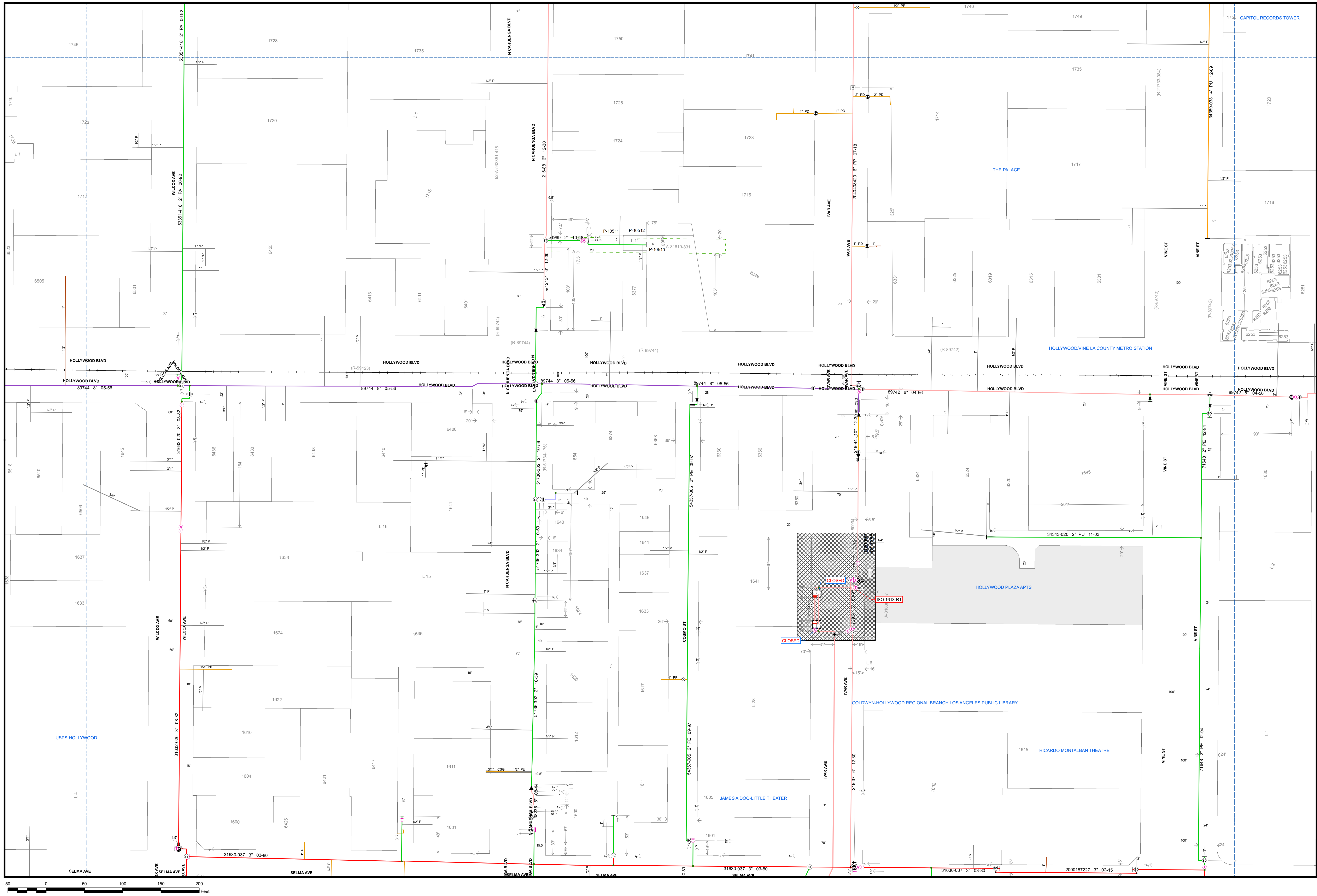

Map Type: Gas Asset Map  
 Printed By: Sum, Jason

**LIABILITY STATEMENT**  
 The facilities and their depiction on these maps are believed to be reasonably accurate, but the maps are not to be used in lieu of field verification or calling the Gas Company. No warranty, expressed or implied (including but not limited to merchantability or fitness for particular purpose) is made as to any meter, transmitter, or other equipment shown on these maps. The Gas Company is not responsible for any errors or omissions in the data or for any damage to property or persons arising from the use of these maps. The Gas Company has no liability for damages (direct, indirect, consequential, incidental or punitive) arising from the transmission, receipt or use by others of the maps or information contained in the maps.

