

CITY OF SANTA FE SPRINGS
NOTICE OF INTENT TO ADOPT A NEGATIVE DECLARATION

- PROJECT NAME:** Greencycle CUP Amendment (ACUP 524).
- SUBJECT:** Notice of Intent to Adopt a Negative Declaration - Environmental Review (California Environmental Quality Act, CEQA)
- LEAD AGENCY:** City of Santa Fe Springs
Planning and Development Department
11710 Telegraph Road
Santa Fe Springs, California 90670
- APPLICANT:** The Applicant is Greencycle with its main office located at 12815 Imperial Highway, Santa Fe Springs, California 90670.
- CITY/COUNTY:** Santa Fe Springs, Los Angeles County
- LOCATION:** 12815 Imperial Highway. Assessor Parcel Number (APN): 8026-041-039.
- DESCRIPTION:** Greencycle, a green waste receiving and transferring facility located in the City of Santa Fe Springs, is seeking approval of an Amendment to the existing Conditional Use Permit (CUP Case No. 524) to allow an increase in the permitted processing capacity of *inert* construction and demolition debris from 24.9 tons per day (TPD) to 49.9 TPD. No new construction or expansion will be required to accommodate the additional processing capacity should the current amendment be approved. No additional staff will be required. The Applicant is requesting the Amendment in the event there are unforeseen circumstances that warrant the need for increased CDI processing capacity in the future. The address of Greencycle is 12815 Imperial Highway, located in between Bloomfield Avenue and Shoemaker Avenue. CUP Case No. 524 was originally approved by the City of Santa Fe Springs Planning Commission in 1995 and permitted the receiving and temporary stockpiling of green waste (garden clippings, tree trimmings, etc.) for containerization and shipment to an off-site green waste chipping and grinding plant. Chipping and grinding of green waste were prohibited under the original CUP 524.
- The original CUP was first amended in 2016 to allow for the processing of CDI material and to conduct chipping and grinding operations on-site. CDI materials include material such as concrete, wood waste, clay tiles, plastic, metal, dimensional lumber (framing lumber and studs), and dry wall. The processing of CDI material involves the separation of the material into piles based on material type, and the chipping and grinding of the appropriate wood waste material. Since green waste loads are often mixed with small quantities of CDI material, processing also involves sorting or “combing” out the CDI materials from the green waste material. CDI materials that cannot be chipped and ground. The residual CDI materials are then transported off-site for further processing.
- The first CUP amendment allowed for the processing of up to 24.9 tons per day of CDI material. The current amendment will increase the processing capacity from the current permitted limit of 24.9 TPD to 49.9 TPD. No new construction or expansion will be required to accommodate the additional processing capacity should the current amendment be approved. No additional staff will be required. The Applicant is requesting the Amendment in the event there are unforeseen circumstances that warrant the need for increased CDI processing capacity in the future.
- FINDINGS:** The environmental analysis provided in the attached Initial Study indicates that the proposed project will not result in any significant impacts. For this reason, the City of Santa Fe Springs determined that a *Negative Declaration* is the appropriate CEQA

**CITY OF SANTA FE SPRINGS
NOTICE OF INTENT TO ADOPT A NEGATIVE DECLARATION**

document for the proposed project. The following findings may be made based on the analysis contained in the attached Initial Study:

- The proposed project *will not* have the potential to degrade the quality of the environment.
- The proposed project *will not* have the potential to achieve short-term goals to the disadvantage of long-term environmental goals.
- The proposed project *will not* have impacts that are individually limited, but cumulatively considerable, when considering planned or proposed development in the City.
- The proposed project *will not* have environmental effects that will adversely affect humans, either directly or indirectly.

The environmental analysis prepared for the proposed project is provided in the attached Initial Study. The project is also described in greater detail in the attached Initial Study.

REVIEW: The Initial Study and Negative Declaration will be available for public review at the following locations:

City of Santa Fe Springs Public Library (next to the City Hall)
11710 Telegraph Road
Santa Fe Springs, California, 90670
and

Planning and Development Department (Planning Counter)
11710 Telegraph Road
Santa Fe Springs, California, 90670

Copies of the IS/ND can also be found online at <http://www.santafesprings.org/>. Please send your comments to the attention of Vincent Velasco, Associate Planner, City of Santa Fe Springs, Planning and Development Department, 11710 Telegraph Road, Santa Fe Springs, California, 90670. Mr. Velasco's contact number with the City is (562) 868-0511. Your responses are requested by February 8, 2022, or within 30-days following receipt of this NOIA.

Vincent Velasco



Date: February 8, 2022

**CITY OF SANTA FE SPRINGS
NOTICE OF INTENT TO ADOPT A NEGATIVE DECLARATION**

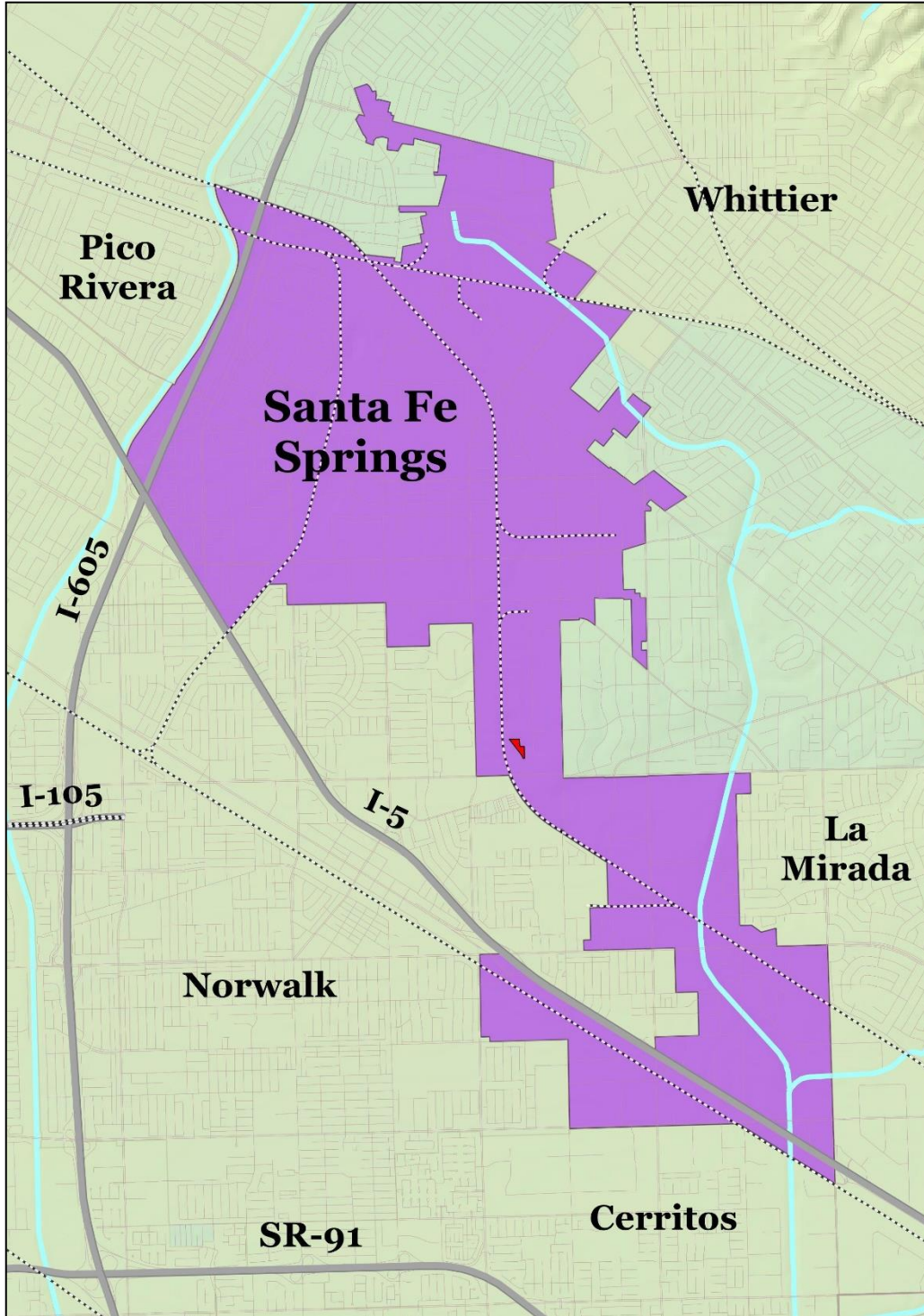

**EXHIBIT 1
CITY MAP**
Source: Quantum GIS

**CITY OF SANTA FE SPRINGS
NOTICE OF INTENT TO ADOPT A NEGATIVE DECLARATION**

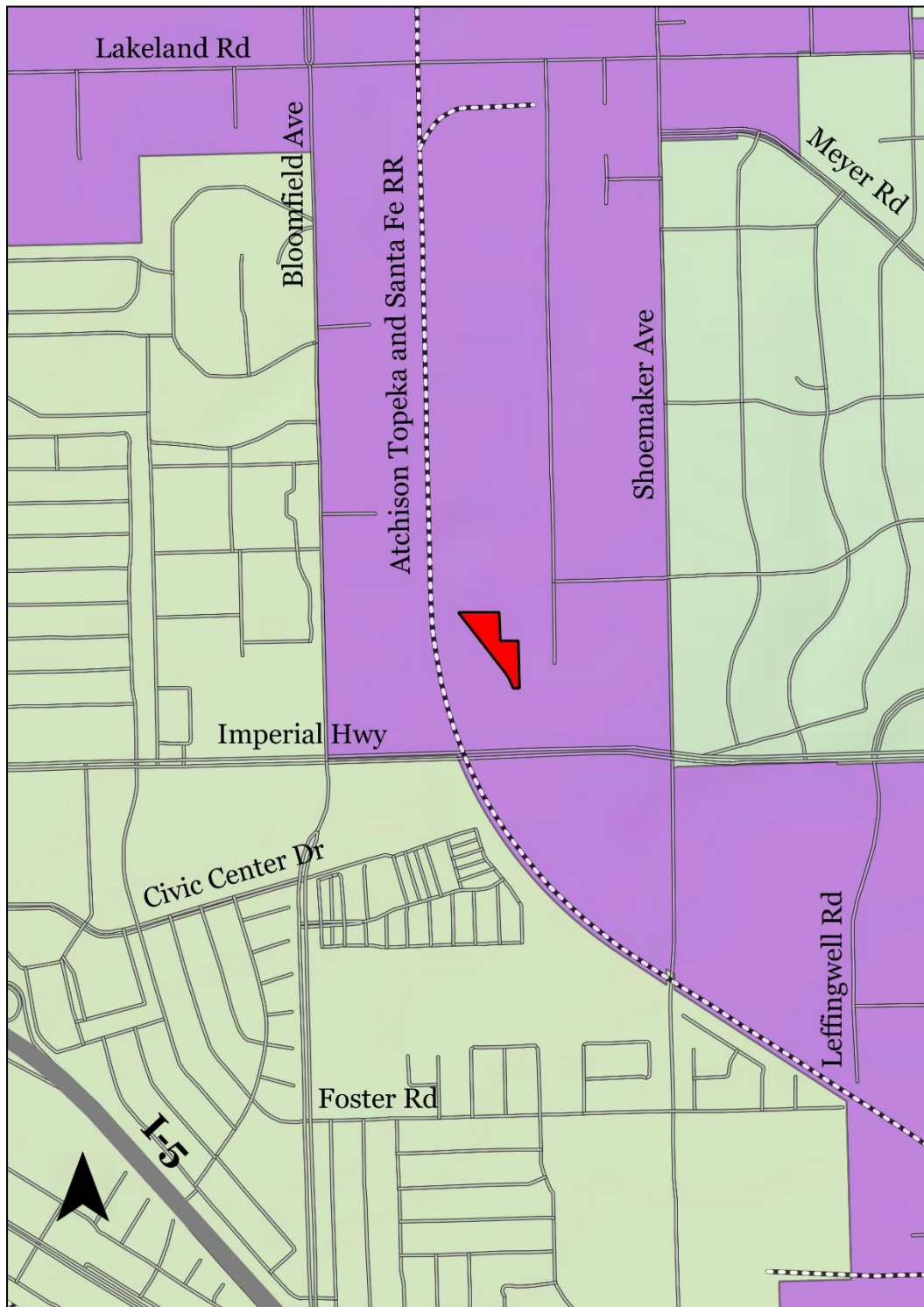

**EXHIBIT 2
VICINITY MAP**
Source: Quantum GIS