

# ENVIRONMENT | PLANNING | DEVELOPMENT SOLUTIONS, INC.

To: Keven Tsang  
From: Alex J, Garber  
Date: 7/15/2021  
Re: VMT Analysis for the Muranaka Project

---

This technical memorandum presents a screening analysis of the Vehicle Miles Traveled (VMT) for the proposed Muranaka Project, located south of Harley Knox Boulevard and east of Decker Road in the County of Riverside.

The purpose of this analysis is to determine whether a VMT Analysis would be required for the project. The project proposes the construction of a 240,582 square foot (sf) warehouse building. The project site is vacant. The project site plan is shown in Figure 1. An update to the project was done after the analysis was completed, however this change reduced the square footage to 239,308 sf. Therefore the analysis is a conservative estimate.

## Vehicle Miles Traveled

Senate Bill (SB) 743 was signed by Governor Brown in 2013 and required the Governor's Office of Planning and Research (OPR) to amend the CEQA Guidelines to provide an alternative to LOS for evaluating Transportation impacts. SB 743 specified that the new criteria should promote the reduction of greenhouse gas emissions, the development of multimodal transportation networks and a diversity of land uses. The bill also specified that delay-based level of service could no longer be considered an indicator of a significant impact on the environment. In response, Section 15064.3 was added to the CEQA Guidelines beginning January 1, 2019. Section 15064.3 - Determining the Significance of Transportation Impacts states that Vehicle Miles Traveled (VMT) is the most appropriate measure of transportation impacts and provides lead agencies with the discretion to choose the most appropriate methodology and thresholds for evaluating VMT. Section 15064.3(c) states that the provisions of the section shall apply statewide beginning on July 1, 2020.

The County of Riverside Transportation Department's *Transportation Analysis Guidelines for Level of Service Vehicle Miles Traveled* were adopted in December 2020. The County's guidelines Figure 3 contain the following screening thresholds to assess whether further VMT analysis is required.

1. Small Projects: This applies to projects with low trip generation (110 trips per day), or projects that have GHG emissions that are less than 3,000 metric tons of Carbon Dioxide Equivalent (MTCO<sub>2e</sub>).
2. Projects Near High Quality Transit: Projects which are located within a Transit Priority Area (TPA) are presumed to have a less than significant impact on VMT and therefore would not need to prepare a full VMT analysis.
3. Local Serving Retail: Retail that does not exceed 50,000sf
4. Affordable Housing: Residential Projects that have a high percentage of affordable housing.
5. Local Essential Services: Projects that include Day Care, Public School, and Police or Fire facilities.
6. Map Based Screening: Areas of development that is under threshold as shown on a screening map.
7. Redevelopment projects: Projects that replace existing land uses with an existing VMT that is higher than the propose project.

The project does not meet thresholds 2-7 and would generate more than 110 daily trips, so a GHG analysis was prepared using the California Emissions Estimator Model (CalEEMod) land use emission model.

Appendix G of the County's guidelines contain the methodology for analyzing a project using the GHG threshold. The following analysis assumptions are outlined in Appendix G:

- Institute of Transportation Engineers (ITE) 10<sup>th</sup> Edition rates used over the CalEEMod default 9<sup>th</sup> Edition Rates
- Rural trip lengths used over urban trip lengths
- CARB's Emissions Factor Model (EMFAC) 2017 mobile sources used over the CalEEMod default EMFAC 2014
- Carbon intensity factor adjusted to the Southern California Edison (SCE) current emission rate
- Energy savings from water conservation were not used
- Building Energy Efficiency Standards set in place January 1, 2020 were not used to be conservative

The analysis follows these county guidelines except for the trip rate. The trip generation analysis utilized the trip rates from the TUMF High-Cube Warehouse Trip Generation Study (WSP, January 29, 2019) which is higher than the ITE 10<sup>th</sup> Edition rate for High Cube Warehouse. Table 1 shows the trip generation used for the project to remain consistent with the project's Transportation Impact Analysis for Level of Service.

**Table 1: Trip Generation**

Land Use	Units	Daily	AM Peak Hour			PM Peak Hour		
			In	Out	Total	In	Out	Total
<u>Trip Rates</u>								
Fulfillment Center <sup>1</sup>		2.129	0.099	0.023	0.122	0.064	0.101	0.165
Cars	TSF	1.750	0.083	0.020	0.103	0.056	0.088	0.144
2-4 Axle	TSF	0.162	0.006	0.002	0.008	0.004	0.007	0.011
5 Axle	TSF	0.217	0.009	0.002	0.011	0.004	0.006	0.010
<b><u>Proposed Project Trip Generation (Total Vehicles)</u></b>								
Project (fulfillment Center)	240.582 TSF	512	24	6	29	15	24	40
<b><u>Vehicle Mix<sup>2</sup></u></b>								
	<b><u>Percent</u></b>							
Passenger Vehicles		421	20	5	25	14	21	35
2-Axle Trucks		13	1	0	1	0	1	1
3-Axle Trucks		13	1	0	1	0	1	1
4+-Axle Trucks		65	3	1	3	1	2	3
		512	24	6	29	15	24	40
<b><u>PCE Trip Generation<sup>3</sup></u></b>								
	<b><u>PCE Factor</u></b>							
Passenger Vehicles	1.0	421	20	5	25	14	21	35
2-Axle Trucks	1.5	19	1	0	1	0	1	1
3-Axle Trucks	2.0	26	1	0	1	1	1	2
4+-Axle Trucks	3.0	196	8	2	10	4	6	10
<b>Total PCE Trip Generation</b>		<b>662</b>	<b>30</b>	<b>7</b>	<b>37</b>	<b>18</b>	<b>30</b>	<b>48</b>

TSF = Thousand Square Feet

PCE = Passenger Car Equivalent

<sup>1</sup> Trip rates from TUMF High-Cube Warehouse Trip Generation Study, WSP, January 29, 2019. In/Out splits from the Institute of Transportation Engineers, *Trip Generation, 10th Edition, 2017*. Land Use Code 155 - High-Cube Fulfillment Center Warehouse.

<sup>2</sup> Vehicle Mix from TUMF High-Cube Warehouse Trip Generation Study, WSP, January 29, 2019. 2-4 Axle trucks were separated out, assuming equal amount of each.

<sup>3</sup> Passenger Car Equivalent (PCE) factors from San Bernardino County CMP, Appendix B - Guidelines for CMP Traffic Impact Analysis Reports in San Bernardino County, 2016

SCAQMD's Facility-Based Mobil Source Measures recommends using a 40-mile trip length for Truck trips, so the operational truck analysis was separated from the automobile and project operational analysis. Since the project site does not have access to bus transit, a conservative approach was used to analyze the automobile trips as a all trips utilizing 50% passenger vehicles (LDA) and 50% light-duty trucks (25% LDT1 and 25% LDT2).

Table 2 below shows the annual MTCO<sub>2e</sub> generated by the project. As seen in Table 2, the project generates 2,891 MTCO<sub>2e</sub> annually, less than the 3,000 MTCO<sub>2e</sub> screening threshold. Therefore, the project would be screened out and would not require further VMT analysis. The CalEEMod sheets can be found attached.

**Table 2: Project's GHG Emissions**

Activity	Annual GHG Emissions (MTCO <sub>2e</sub> )
<b>Project Operational Emissions</b>	
Area	0
Energy	169
Auto Mobil	820
Truck Mobil	1,530
Waste	114
Water	258
Total Project Gross Operation Emissions	2,891
Significance Threshold	3,000
<b>Threshold Exceeded?</b>	<b>No</b>

If you have any questions about this analysis, please contact me at (949) 316-4521 or at [alex@epdsolutions.com](mailto:alex@epdsolutions.com).

Figure 1: Project Site Plan

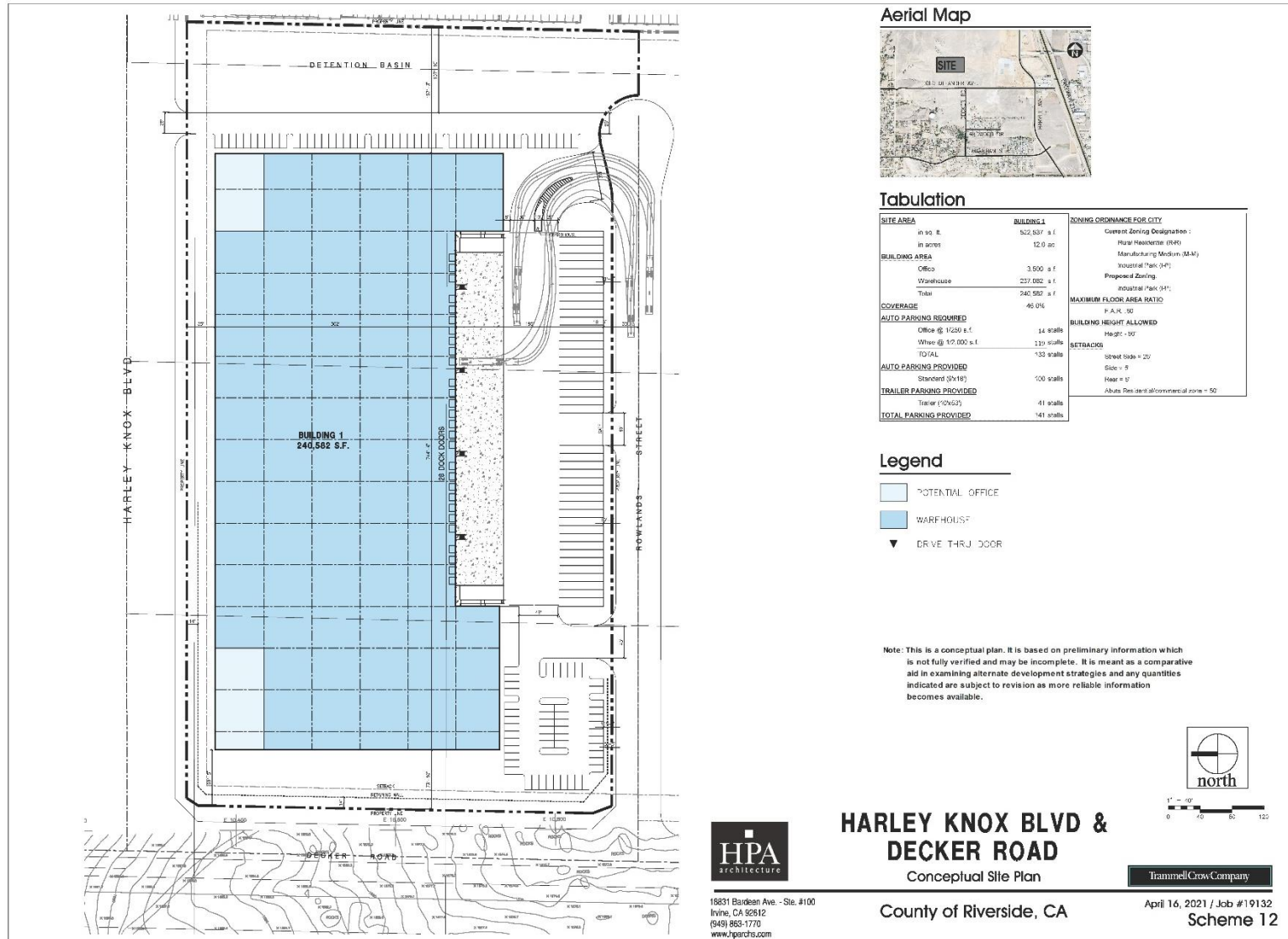

## CalEEMod Operational Analysis Sheets (Auto)

Muranaka Warehouse VMT - Riverside-South Coast County, Annual

**Muranaka Warehouse VMT**  
**Riverside-South Coast County, Annual**

**1.0 Project Characteristics**

**1.1 Land Usage**

Land Uses	Size	Metric	Lot Acreage	Floor Surface Area	Population
Unrefrigerated Warehouse-No Rail	240.58	1000sqft	5.52	240,582.00	0
Other Asphalt Surfaces	3.21	Acre	3.21	139,827.60	0
Parking Lot	141.00	Space	1.27	56,400.00	0
City Park	2.00	Acre	2.00	87,120.00	0

**1.2 Other Project Characteristics**

<b>Urbanization</b>	Rural	<b>Wind Speed (m/s)</b>	2.4	<b>Precipitation Freq (Days)</b>	28
<b>Climate Zone</b>	10			<b>Operational Year</b>	2023
<b>Utility Company</b>	Southern California Edison				
<b>CO2 Intensity (lb/MW hr)</b>	532.57	<b>CH4 Intensity (lb/MW hr)</b>	0.029	<b>N2O Intensity (lb/MW hr)</b>	0.006

**1.3 User Entered Comments & Non-Default Data**

## Muranaka Warehouse VMT - Riverside-South Coast County, Annual

Project Characteristics - SCE 2020-2029 CO2 Intensity Factor

Land Use -

Construction Phase - Operational Analysis Only

Off-road Equipment - Operational Analysis Only

Vehicle Trips - Used Project Trip Generation (EPD Solutions 2021)

Vehicle Emission Factors - EMFAC 2017 Rates

Vehicle Emission Factors - EMFAC 2017 Rates

Vehicle Emission Factors - EMFAC 2017 Rates

Energy Use -

Table Name	Column Name	Default Value	New Value
tblConstructionPhase	NumDays	10.00	0.00
tblFleetMix	HHD	0.07	0.00
tblFleetMix	LDA	0.55	0.50
tblFleetMix	LDT1	0.04	0.25
tblFleetMix	LDT2	0.19	0.25
tblFleetMix	LHD1	0.01	0.00
tblFleetMix	LHD2	4.8060e-003	0.00
tblFleetMix	MCY	4.5080e-003	0.00
tblFleetMix	MDV	0.11	0.00
tblFleetMix	MH	8.9800e-004	0.00
tblFleetMix	MHD	0.02	0.00
tblFleetMix	OBUS	1.4090e-003	0.00
tblFleetMix	SBUS	9.1800e-004	0.00
tblFleetMix	UBUS	1.1470e-003	0.00
tblProjectCharacteristics	CO2IntensityFactor	702.44	532.57
tblProjectCharacteristics	UrbanizationLevel	Urban	Rural

## Muranaka Warehouse VMT - Riverside-South Coast County, Annual

tblVehicleEF	LDA	3.3240e-003	2.4030e-003
tblVehicleEF	LDA	4.1920e-003	0.05
tblVehicleEF	LDA	0.51	0.63
tblVehicleEF	LDA	0.96	2.02
tblVehicleEF	LDA	235.32	257.60
tblVehicleEF	LDA	54.50	51.55
tblVehicleEF	LDA	0.04	0.03
tblVehicleEF	LDA	0.06	0.17
tblVehicleEF	LDA	1.5540e-003	1.5920e-003
tblVehicleEF	LDA	2.2370e-003	1.7540e-003
tblVehicleEF	LDA	1.4310e-003	1.4660e-003
tblVehicleEF	LDA	2.0570e-003	1.6130e-003
tblVehicleEF	LDA	0.04	0.05
tblVehicleEF	LDA	0.09	0.09
tblVehicleEF	LDA	0.03	0.05
tblVehicleEF	LDA	8.3520e-003	9.1620e-003
tblVehicleEF	LDA	0.03	0.20
tblVehicleEF	LDA	0.06	0.20
tblVehicleEF	LDA	2.3560e-003	2.5480e-003
tblVehicleEF	LDA	5.6100e-004	5.1000e-004
tblVehicleEF	LDA	0.04	0.05
tblVehicleEF	LDA	0.09	0.09
tblVehicleEF	LDA	0.03	0.05
tblVehicleEF	LDA	0.01	0.01
tblVehicleEF	LDA	0.03	0.20
tblVehicleEF	LDA	0.06	0.22
tblVehicleEF	LDA	3.7650e-003	2.5930e-003



## Muranaka Warehouse VMT - Riverside-South Coast County, Annual

tblVehicleEF	LDA	3.6350e-003	0.04
tblVehicleEF	LDA	0.62	0.71
tblVehicleEF	LDA	0.85	1.73
tblVehicleEF	LDA	256.22	270.90
tblVehicleEF	LDA	54.50	51.02
tblVehicleEF	LDA	0.04	0.03
tblVehicleEF	LDA	0.06	0.16
tblVehicleEF	LDA	1.5540e-003	1.5920e-003
tblVehicleEF	LDA	2.2370e-003	1.7540e-003
tblVehicleEF	LDA	1.4310e-003	1.4660e-003
tblVehicleEF	LDA	2.0570e-003	1.6130e-003
tblVehicleEF	LDA	0.09	0.08
tblVehicleEF	LDA	0.10	0.10
tblVehicleEF	LDA	0.06	0.07
tblVehicleEF	LDA	9.4470e-003	9.8010e-003
tblVehicleEF	LDA	0.03	0.19
tblVehicleEF	LDA	0.05	0.18
tblVehicleEF	LDA	2.5670e-003	2.6800e-003
tblVehicleEF	LDA	5.5900e-004	5.0500e-004
tblVehicleEF	LDA	0.09	0.08
tblVehicleEF	LDA	0.10	0.10
tblVehicleEF	LDA	0.06	0.07
tblVehicleEF	LDA	0.01	0.01
tblVehicleEF	LDA	0.03	0.19
tblVehicleEF	LDA	0.05	0.19
tblVehicleEF	LDA	3.2080e-003	2.3490e-003
tblVehicleEF	LDA	4.3060e-003	0.05

## Muranaka Warehouse VMT - Riverside-South Coast County, Annual

tblVehicleEF	LDA	0.48	0.61
tblVehicleEF	LDA	0.98	2.08
tblVehicleEF	LDA	229.53	253.28
tblVehicleEF	LDA	54.50	51.65
tblVehicleEF	LDA	0.04	0.03
tblVehicleEF	LDA	0.06	0.17
tblVehicleEF	LDA	1.5540e-003	1.5920e-003
tblVehicleEF	LDA	2.2370e-003	1.7540e-003
tblVehicleEF	LDA	1.4310e-003	1.4660e-003
tblVehicleEF	LDA	2.0570e-003	1.6130e-003
tblVehicleEF	LDA	0.04	0.05
tblVehicleEF	LDA	0.10	0.10
tblVehicleEF	LDA	0.03	0.04
tblVehicleEF	LDA	8.0650e-003	8.9700e-003
tblVehicleEF	LDA	0.04	0.23
tblVehicleEF	LDA	0.06	0.20
tblVehicleEF	LDA	2.2980e-003	2.5060e-003
tblVehicleEF	LDA	5.6100e-004	5.1100e-004
tblVehicleEF	LDA	0.04	0.05
tblVehicleEF	LDA	0.10	0.10
tblVehicleEF	LDA	0.03	0.04
tblVehicleEF	LDA	0.01	0.01
tblVehicleEF	LDA	0.04	0.23
tblVehicleEF	LDA	0.06	0.22
tblVehicleEF	LDT1	9.2940e-003	6.2400e-003
tblVehicleEF	LDT1	0.01	0.07
tblVehicleEF	LDT1	1.18	1.24

Muranaka Warehouse VMT - Riverside-South Coast County, Annual

tblVehicleEF	LDT1	2.73	2.19
tblVehicleEF	LDT1	295.40	305.25
tblVehicleEF	LDT1	68.37	61.74
tblVehicleEF	LDT1	0.11	0.10
tblVehicleEF	LDT1	0.17	0.24
tblVehicleEF	LDT1	2.2770e-003	2.3050e-003
tblVehicleEF	LDT1	3.3510e-003	2.4350e-003
tblVehicleEF	LDT1	2.0960e-003	2.1210e-003
tblVehicleEF	LDT1	3.0820e-003	2.2390e-003
tblVehicleEF	LDT1	0.18	0.13
tblVehicleEF	LDT1	0.30	0.19
tblVehicleEF	LDT1	0.12	0.10
tblVehicleEF	LDT1	0.02	0.03
tblVehicleEF	LDT1	0.18	0.65
tblVehicleEF	LDT1	0.19	0.32
tblVehicleEF	LDT1	2.9680e-003	3.0210e-003
tblVehicleEF	LDT1	7.3100e-004	6.1100e-004
tblVehicleEF	LDT1	0.18	0.13
tblVehicleEF	LDT1	0.30	0.19
tblVehicleEF	LDT1	0.12	0.10
tblVehicleEF	LDT1	0.03	0.40
tblVehicleEF	LDT1	0.18	0.65
tblVehicleEF	LDT1	0.21	0.35
tblVehicleEF	LDT1	0.01	6.6810e-003
tblVehicleEF	LDT1	0.01	0.06
tblVehicleEF	LDT1	1.43	1.38
tblVehicleEF	LDT1	2.40	1.88

## Muranaka Warehouse VMT - Riverside-South Coast County, Annual

tblVehicleEF	LDT1	320.93	318.70
tblVehicleEF	LDT1	68.37	61.12
tblVehicleEF	LDT1	0.11	0.09
tblVehicleEF	LDT1	0.16	0.22
tblVehicleEF	LDT1	2.2770e-003	2.3050e-003
tblVehicleEF	LDT1	3.3510e-003	2.4350e-003
tblVehicleEF	LDT1	2.0960e-003	2.1210e-003
tblVehicleEF	LDT1	3.0820e-003	2.2390e-003
tblVehicleEF	LDT1	0.36	0.20
tblVehicleEF	LDT1	0.37	0.20
tblVehicleEF	LDT1	0.24	0.15
tblVehicleEF	LDT1	0.03	0.03
tblVehicleEF	LDT1	0.18	0.61
tblVehicleEF	LDT1	0.16	0.29
tblVehicleEF	LDT1	3.2270e-003	3.1540e-003
tblVehicleEF	LDT1	7.2500e-004	6.0500e-004
tblVehicleEF	LDT1	0.36	0.20
tblVehicleEF	LDT1	0.37	0.20
tblVehicleEF	LDT1	0.24	0.02
tblVehicleEF	LDT1	0.04	0.04
tblVehicleEF	LDT1	0.18	0.61
tblVehicleEF	LDT1	0.18	0.31
tblVehicleEF	LDT1	8.9360e-003	6.1100e-003
tblVehicleEF	LDT1	0.01	0.07
tblVehicleEF	LDT1	1.11	1.20
tblVehicleEF	LDT1	2.78	2.26
tblVehicleEF	LDT1	287.77	300.74

## Muranaka Warehouse VMT - Riverside-South Coast County, Annual

tblVehicleEF	LDT1	68.37	61.87
tblVehicleEF	LDT1	0.11	0.10
tblVehicleEF	LDT1	0.17	0.24
tblVehicleEF	LDT1	2.2770e-003	2.3050e-003
tblVehicleEF	LDT1	3.3510e-003	2.4350e-003
tblVehicleEF	LDT1	2.0960e-003	2.1210e-003
tblVehicleEF	LDT1	3.0820e-003	2.2390e-003
tblVehicleEF	LDT1	0.16	0.12
tblVehicleEF	LDT1	0.33	0.21
tblVehicleEF	LDT1	0.10	0.10
tblVehicleEF	LDT1	0.02	0.03
tblVehicleEF	LDT1	0.21	0.77
tblVehicleEF	LDT1	0.19	0.33
tblVehicleEF	LDT1	2.8910e-003	2.9760e-003
tblVehicleEF	LDT1	7.3200e-004	6.1200e-004
tblVehicleEF	LDT1	0.16	0.12
tblVehicleEF	LDT1	0.33	0.21
tblVehicleEF	LDT1	0.10	0.10
tblVehicleEF	LDT1	0.03	0.04
tblVehicleEF	LDT1	0.21	0.77
tblVehicleEF	LDT1	0.21	0.36
tblVehicleEF	LDT2	4.7540e-003	4.0420e-003
tblVehicleEF	LDT2	5.7630e-003	0.06
tblVehicleEF	LDT2	0.68	0.89
tblVehicleEF	LDT2	1.27	2.55
tblVehicleEF	LDT2	330.23	324.20
tblVehicleEF	LDT2	76.02	66.04

## Muranaka Warehouse VMT - Riverside-South Coast County, Annual

tblVehicleEF	LDT2	0.06	0.07
tblVehicleEF	LDT2	0.10	0.25
tblVehicleEF	LDT2	1.6020e-003	1.6820e-003
tblVehicleEF	LDT2	2.3660e-003	1.7870e-003
tblVehicleEF	LDT2	1.4730e-003	1.5480e-003
tblVehicleEF	LDT2	2.1760e-003	1.6440e-003
tblVehicleEF	LDT2	0.06	0.07
tblVehicleEF	LDT2	0.10	0.12
tblVehicleEF	LDT2	0.05	0.07
tblVehicleEF	LDT2	0.01	0.02
tblVehicleEF	LDT2	0.06	0.39
tblVehicleEF	LDT2	0.08	0.28
tblVehicleEF	LDT2	3.3070e-003	3.2070e-003
tblVehicleEF	LDT2	7.8100e-004	6.5400e-004
tblVehicleEF	LDT2	0.06	0.07
tblVehicleEF	LDT2	0.10	0.12
tblVehicleEF	LDT2	0.05	0.07
tblVehicleEF	LDT2	0.02	0.02
tblVehicleEF	LDT2	0.06	0.39
tblVehicleEF	LDT2	0.09	0.31
tblVehicleEF	LDT2	5.3890e-003	4.3460e-003
tblVehicleEF	LDT2	5.0030e-003	0.06
tblVehicleEF	LDT2	0.83	0.99
tblVehicleEF	LDT2	1.13	2.18
tblVehicleEF	LDT2	359.32	337.23
tblVehicleEF	LDT2	76.02	65.36
tblVehicleEF	LDT2	0.06	0.06

## Muranaka Warehouse VMT - Riverside-South Coast County, Annual

tblVehicleEF	LDT2	0.10	0.24
tblVehicleEF	LDT2	1.6020e-003	1.6820e-003
tblVehicleEF	LDT2	2.3660e-003	1.7870e-003
tblVehicleEF	LDT2	1.4730e-003	1.5480e-003
tblVehicleEF	LDT2	2.1760e-003	1.6440e-003
tblVehicleEF	LDT2	0.12	0.12
tblVehicleEF	LDT2	0.12	0.12
tblVehicleEF	LDT2	0.10	0.11
tblVehicleEF	LDT2	0.01	0.02
tblVehicleEF	LDT2	0.06	0.37
tblVehicleEF	LDT2	0.07	0.25
tblVehicleEF	LDT2	3.6000e-003	3.3360e-003
tblVehicleEF	LDT2	7.7900e-004	6.4700e-004
tblVehicleEF	LDT2	0.12	0.12
tblVehicleEF	LDT2	0.12	0.12
tblVehicleEF	LDT2	0.10	0.11
tblVehicleEF	LDT2	0.02	0.03
tblVehicleEF	LDT2	0.06	0.37
tblVehicleEF	LDT2	0.07	0.28
tblVehicleEF	LDT2	4.5710e-003	3.9530e-003
tblVehicleEF	LDT2	5.9350e-003	0.06
tblVehicleEF	LDT2	0.63	0.86
tblVehicleEF	LDT2	1.30	2.62
tblVehicleEF	LDT2	321.50	319.83
tblVehicleEF	LDT2	76.02	66.19
tblVehicleEF	LDT2	0.06	0.07
tblVehicleEF	LDT2	0.10	0.26

## Muranaka Warehouse VMT - Riverside-South Coast County, Annual

tblVehicleEF	LDT2	1.6020e-003	1.6820e-003
tblVehicleEF	LDT2	2.3660e-003	1.7870e-003
tblVehicleEF	LDT2	1.4730e-003	1.5480e-003
tblVehicleEF	LDT2	2.1760e-003	1.6440e-003
tblVehicleEF	LDT2	0.05	0.07
tblVehicleEF	LDT2	0.11	0.13
tblVehicleEF	LDT2	0.04	0.07
tblVehicleEF	LDT2	0.01	0.02
tblVehicleEF	LDT2	0.07	0.46
tblVehicleEF	LDT2	0.08	0.29
tblVehicleEF	LDT2	3.2190e-003	3.1640e-003
tblVehicleEF	LDT2	7.8200e-004	6.5500e-004
tblVehicleEF	LDT2	0.05	0.07
tblVehicleEF	LDT2	0.11	0.13
tblVehicleEF	LDT2	0.04	0.07
tblVehicleEF	LDT2	0.02	0.02
tblVehicleEF	LDT2	0.07	0.46
tblVehicleEF	LDT2	0.09	0.32
tblVehicleTrips	CC_TTP	48.00	0.00
tblVehicleTrips	CNW_TTP	19.00	0.00
tblVehicleTrips	CNW_TTP	41.00	0.00
tblVehicleTrips	CW_TTP	33.00	0.00
tblVehicleTrips	CW_TTP	59.00	100.00
tblVehicleTrips	DV_TP	28.00	0.00
tblVehicleTrips	DV_TP	5.00	0.00
tblVehicleTrips	PB_TP	6.00	0.00
tblVehicleTrips	PB_TP	3.00	0.00



Muranaka Warehouse VMT - Riverside-South Coast County, Annual

tblVehicleTrips	PR_TP	66.00	0.00
tblVehicleTrips	PR_TP	92.00	100.00
tblVehicleTrips	ST_TR	22.75	0.00
tblVehicleTrips	ST_TR	1.68	1.75
tblVehicleTrips	SU_TR	16.74	0.00
tblVehicleTrips	SU_TR	1.68	1.75
tblVehicleTrips	WD_TR	1.89	0.00
tblVehicleTrips	WD_TR	1.68	1.75

**2.0 Emissions Summary**

---



Muranaka Warehouse VMT - Riverside-South Coast County, Annual

Quarter	Start Date	End Date	Maximum Unmitigated ROG + NOX (tons/quarter)	Maximum Mitigated ROG + NOX (tons/quarter)
		Highest		

2.2 Overall Operational

Unmitigated Operational

	ROG	NOx	CO	SO2	Fugitive PM10	Exhaust PM10	PM10 Total	Fugitive PM2.5	Exhaust PM2.5	PM2.5 Total	Bio- CO2	NBio- CO2	Total CO2	CH4	N2O	CO2e
Category	tons/yr										MT/yr					
Area	0.9975	4.0000e-005	4.9400e-003	0.0000		2.0000e-005	2.0000e-005		2.0000e-005	2.0000e-005	0.0000	9.6000e-003	9.6000e-003	3.0000e-005	0.0000	0.0102
Energy	2.6300e-003	0.0239	0.0201	1.4000e-004		1.8200e-003	1.8200e-003		1.8200e-003	1.8200e-003	0.0000	167.9874	167.9874	8.2300e-003	2.0800e-003	168.8119
Mobile	0.1964	0.2205	3.0292	8.9300e-003	1.0590	5.9200e-003	1.0649	0.2811	5.4500e-003	0.2865	0.0000	819.1828	819.1828	0.0190	0.0000	819.6585
Waste						0.0000	0.0000		0.0000	0.0000	45.9409	0.0000	45.9409	2.7150	0.0000	113.8167
Water						0.0000	0.0000		0.0000	0.0000	17.6501	181.3915	199.0416	1.8227	0.0449	257.9744
<b>Total</b>	<b>1.1966</b>	<b>0.2445</b>	<b>3.0543</b>	<b>9.0700e-003</b>	<b>1.0590</b>	<b>7.7600e-003</b>	<b>1.0667</b>	<b>0.2811</b>	<b>7.2900e-003</b>	<b>0.2884</b>	<b>63.5911</b>	<b>1,168.5712</b>	<b>1,232.1623</b>	<b>4.5650</b>	<b>0.0469</b>	<b>1,360.2717</b>

Muranaka Warehouse VMT - Riverside-South Coast County, Annual

**2.2 Overall Operational**

**Mitigated Operational**

	ROG	NOx	CO	SO2	Fugitive PM10	Exhaust PM10	PM10 Total	Fugitive PM2.5	Exhaust PM2.5	PM2.5 Total	Bio- CO2	NBio- CO2	Total CO2	CH4	N2O	CO2e
Category	tons/yr										MT/yr					
Area	0.9975	4.0000e-005	4.9400e-003	0.0000		2.0000e-005	2.0000e-005		2.0000e-005	2.0000e-005	0.0000	9.6000e-003	9.6000e-003	3.0000e-005	0.0000	0.0102
Energy	2.6300e-003	0.0239	0.0201	1.4000e-004		1.8200e-003	1.8200e-003		1.8200e-003	1.8200e-003	0.0000	167.9874	167.9874	8.2300e-003	2.0800e-003	168.8119
Mobile	0.1964	0.2205	3.0292	8.9300e-003	1.0590	5.9200e-003	1.0649	0.2811	5.4500e-003	0.2865	0.0000	819.1828	819.1828	0.0190	0.0000	819.6585
Waste						0.0000	0.0000		0.0000	0.0000	45.9409	0.0000	45.9409	2.7150	0.0000	113.8167
Water						0.0000	0.0000		0.0000	0.0000	17.6501	181.3915	199.0416	1.8227	0.0449	257.9744
<b>Total</b>	<b>1.1966</b>	<b>0.2445</b>	<b>3.0543</b>	<b>9.0700e-003</b>	<b>1.0590</b>	<b>7.7600e-003</b>	<b>1.0667</b>	<b>0.2811</b>	<b>7.2900e-003</b>	<b>0.2884</b>	<b>63.5911</b>	<b>1,168.5712</b>	<b>1,232.1623</b>	<b>4.5650</b>	<b>0.0469</b>	<b>1,360.2717</b>

	ROG	NOx	CO	SO2	Fugitive PM10	Exhaust PM10	PM10 Total	Fugitive PM2.5	Exhaust PM2.5	PM2.5 Total	Bio- CO2	NBio-CO2	Total CO2	CH4	N2O	CO2e
Percent Reduction	0.00	0.00	0.00	0.00	0.00	0.00	0.00	0.00	0.00	0.00	0.00	0.00	0.00	0.00	0.00	0.00

**3.0 Construction Detail**

**Construction Phase**

Phase Number	Phase Name	Phase Type	Start Date	End Date	Num Days Week	Num Days	Phase Description
1	Operational Analysis Only	Site Preparation	2/24/2021	2/23/2021	5	0	

**Acres of Grading (Site Preparation Phase): 0**

Muranaka Warehouse VMT - Riverside-South Coast County, Annual

**Acres of Grading (Grading Phase): 0**

**Acres of Paving: 4.48**

**Residential Indoor: 0; Residential Outdoor: 0; Non-Residential Indoor: 0; Non-Residential Outdoor: 0; Striped Parking Area: 0 (Architectural Coating – sqft)**

**OffRoad Equipment**

Phase Name	Offroad Equipment Type	Amount	Usage Hours	Horse Power	Load Factor
Operational Analysis Only	Rubber Tired Dozers	3	8.00	247	0.40
Operational Analysis Only	Tractors/Loaders/Backhoes	4	8.00	97	0.37

**Trips and VMT**

Phase Name	Offroad Equipment Count	Worker Trip Number	Vendor Trip Number	Hauling Trip Number	Worker Trip Length	Vendor Trip Length	Hauling Trip Length	Worker Vehicle Class	Vendor Vehicle Class	Hauling Vehicle Class
Operational Analysis Only	7	18.00	0.00	0.00	19.80	7.90	20.00	LD_Mix	HDT_Mix	HHDT

**3.1 Mitigation Measures Construction**



Muranaka Warehouse VMT - Riverside-South Coast County, Annual

**3.2 Operational Analysis Only - 2021**

**Mitigated Construction On-Site**

	ROG	NOx	CO	SO2	Fugitive PM10	Exhaust PM10	PM10 Total	Fugitive PM2.5	Exhaust PM2.5	PM2.5 Total	Bio- CO2	NBio- CO2	Total CO2	CH4	N2O	CO2e
Category	tons/yr										MT/yr					
Fugitive Dust	0.0000	0.0000	0.0000	0.0000	0.0000	0.0000	0.0000	0.0000	0.0000	0.0000	0.0000	0.0000	0.0000	0.0000	0.0000	0.0000
Off-Road	0.0000	0.0000	0.0000	0.0000	0.0000	0.0000	0.0000	0.0000	0.0000	0.0000	0.0000	0.0000	0.0000	0.0000	0.0000	0.0000
<b>Total</b>	<b>0.0000</b>	<b>0.0000</b>	<b>0.0000</b>	<b>0.0000</b>	<b>0.0000</b>	<b>0.0000</b>	<b>0.0000</b>	<b>0.0000</b>	<b>0.0000</b>	<b>0.0000</b>	<b>0.0000</b>	<b>0.0000</b>	<b>0.0000</b>	<b>0.0000</b>	<b>0.0000</b>	<b>0.0000</b>

**Mitigated Construction Off-Site**

	ROG	NOx	CO	SO2	Fugitive PM10	Exhaust PM10	PM10 Total	Fugitive PM2.5	Exhaust PM2.5	PM2.5 Total	Bio- CO2	NBio- CO2	Total CO2	CH4	N2O	CO2e
Category	tons/yr										MT/yr					
Hauling	0.0000	0.0000	0.0000	0.0000	0.0000	0.0000	0.0000	0.0000	0.0000	0.0000	0.0000	0.0000	0.0000	0.0000	0.0000	0.0000
Vendor	0.0000	0.0000	0.0000	0.0000	0.0000	0.0000	0.0000	0.0000	0.0000	0.0000	0.0000	0.0000	0.0000	0.0000	0.0000	0.0000
Worker	0.0000	0.0000	0.0000	0.0000	0.0000	0.0000	0.0000	0.0000	0.0000	0.0000	0.0000	0.0000	0.0000	0.0000	0.0000	0.0000
<b>Total</b>	<b>0.0000</b>	<b>0.0000</b>	<b>0.0000</b>	<b>0.0000</b>	<b>0.0000</b>	<b>0.0000</b>	<b>0.0000</b>	<b>0.0000</b>	<b>0.0000</b>	<b>0.0000</b>	<b>0.0000</b>	<b>0.0000</b>	<b>0.0000</b>	<b>0.0000</b>	<b>0.0000</b>	<b>0.0000</b>

**4.0 Operational Detail - Mobile**

---

Muranaka Warehouse VMT - Riverside-South Coast County, Annual

**4.1 Mitigation Measures Mobile**

	ROG	NOx	CO	SO2	Fugitive PM10	Exhaust PM10	PM10 Total	Fugitive PM2.5	Exhaust PM2.5	PM2.5 Total	Bio- CO2	NBio- CO2	Total CO2	CH4	N2O	CO2e
Category	tons/yr										MT/yr					
Mitigated	0.1964	0.2205	3.0292	8.9300e-003	1.0590	5.9200e-003	1.0649	0.2811	5.4500e-003	0.2865	0.0000	819.1828	819.1828	0.0190	0.0000	819.6585
Unmitigated	0.1964	0.2205	3.0292	8.9300e-003	1.0590	5.9200e-003	1.0649	0.2811	5.4500e-003	0.2865	0.0000	819.1828	819.1828	0.0190	0.0000	819.6585

**4.2 Trip Summary Information**

Land Use	Average Daily Trip Rate			Unmitigated	Mitigated
	Weekday	Saturday	Sunday	Annual VMT	Annual VMT
City Park	0.00	0.00	0.00		
Other Asphalt Surfaces	0.00	0.00	0.00		
Parking Lot	0.00	0.00	0.00		
Unrefrigerated Warehouse-No Rail	421.02	421.02	421.02	2,835,139	2,835,139
Total	421.02	421.02	421.02	2,835,139	2,835,139

**4.3 Trip Type Information**



Muranaka Warehouse VMT - Riverside-South Coast County, Annual

Land Use	Miles			Trip %			Trip Purpose %		
	H-W or C-W	H-S or C-C	H-O or C-NW	H-W or C-W	H-S or C-C	H-O or C-NW	Primary	Diverted	Pass-by
City Park	18.50	10.10	7.90	0.00	0.00	0.00	0	0	0
Other Asphalt Surfaces	18.50	10.10	7.90	0.00	0.00	0.00	0	0	0
Parking Lot	18.50	10.10	7.90	0.00	0.00	0.00	0	0	0
Unrefrigerated Warehouse-No Rail	18.50	10.10	7.90	100.00	0.00	0.00	100	0	0

4.4 Fleet Mix

Land Use	LDA	LDT1	LDT2	MDV	LHD1	LHD2	MHD	HHD	OBUS	UBUS	MCY	SBUS	MH
City Park	0.548600	0.036250	0.186898	0.112544	0.014284	0.004806	0.017604	0.070134	0.001409	0.001147	0.004508	0.000918	0.000898
Other Asphalt Surfaces	0.548600	0.036250	0.186898	0.112544	0.014284	0.004806	0.017604	0.070134	0.001409	0.001147	0.004508	0.000918	0.000898
Parking Lot	0.548600	0.036250	0.186898	0.112544	0.014284	0.004806	0.017604	0.070134	0.001409	0.001147	0.004508	0.000918	0.000898
Unrefrigerated Warehouse-No Rail	0.500000	0.250000	0.250000	0.000000	0.000000	0.000000	0.000000	0.000000	0.000000	0.000000	0.000000	0.000000	0.000000

5.0 Energy Detail

Historical Energy Use: N

5.1 Mitigation Measures Energy

Muranaka Warehouse VMT - Riverside-South Coast County, Annual

	ROG	NOx	CO	SO2	Fugitive PM10	Exhaust PM10	PM10 Total	Fugitive PM2.5	Exhaust PM2.5	PM2.5 Total	Bio- CO2	NBio- CO2	Total CO2	CH4	N2O	CO2e
Category	tons/yr										MT/yr					
Electricity Mitigated						0.0000	0.0000		0.0000	0.0000	0.0000	141.9255	141.9255	7.7300e-003	1.6000e-003	142.5952
Electricity Unmitigated						0.0000	0.0000		0.0000	0.0000	0.0000	141.9255	141.9255	7.7300e-003	1.6000e-003	142.5952
NaturalGas Mitigated	2.6300e-003	0.0239	0.0201	1.4000e-004		1.8200e-003	1.8200e-003		1.8200e-003	1.8200e-003	0.0000	26.0619	26.0619	5.0000e-004	4.8000e-004	26.2168
NaturalGas Unmitigated	2.6300e-003	0.0239	0.0201	1.4000e-004		1.8200e-003	1.8200e-003		1.8200e-003	1.8200e-003	0.0000	26.0619	26.0619	5.0000e-004	4.8000e-004	26.2168

5.2 Energy by Land Use - NaturalGas

Unmitigated

	NaturalGas Use	ROG	NOx	CO	SO2	Fugitive PM10	Exhaust PM10	PM10 Total	Fugitive PM2.5	Exhaust PM2.5	PM2.5 Total	Bio- CO2	NBio- CO2	Total CO2	CH4	N2O	CO2e
Land Use	kBTU/yr	tons/yr										MT/yr					
City Park	0	0.0000	0.0000	0.0000	0.0000		0.0000	0.0000		0.0000	0.0000	0.0000	0.0000	0.0000	0.0000	0.0000	0.0000
Other Asphalt Surfaces	0	0.0000	0.0000	0.0000	0.0000		0.0000	0.0000		0.0000	0.0000	0.0000	0.0000	0.0000	0.0000	0.0000	0.0000
Parking Lot	0	0.0000	0.0000	0.0000	0.0000		0.0000	0.0000		0.0000	0.0000	0.0000	0.0000	0.0000	0.0000	0.0000	0.0000
Unrefrigerated Warehouse-No Rail	488381	2.6300e-003	0.0239	0.0201	1.4000e-004		1.8200e-003	1.8200e-003		1.8200e-003	1.8200e-003	0.0000	26.0619	26.0619	5.0000e-004	4.8000e-004	26.2168
<b>Total</b>		<b>2.6300e-003</b>	<b>0.0239</b>	<b>0.0201</b>	<b>1.4000e-004</b>		<b>1.8200e-003</b>	<b>1.8200e-003</b>		<b>1.8200e-003</b>	<b>1.8200e-003</b>	<b>0.0000</b>	<b>26.0619</b>	<b>26.0619</b>	<b>5.0000e-004</b>	<b>4.8000e-004</b>	<b>26.2168</b>

Muranaka Warehouse VMT - Riverside-South Coast County, Annual

**5.2 Energy by Land Use - NaturalGas**

**Mitigated**

	NaturalGas Use	ROG	NOx	CO	SO2	Fugitive PM10	Exhaust PM10	PM10 Total	Fugitive PM2.5	Exhaust PM2.5	PM2.5 Total	Bio- CO2	NBio- CO2	Total CO2	CH4	N2O	CO2e
Land Use	kBTU/yr	tons/yr										MT/yr					
City Park	0	0.0000	0.0000	0.0000	0.0000		0.0000	0.0000		0.0000	0.0000	0.0000	0.0000	0.0000	0.0000	0.0000	0.0000
Other Asphalt Surfaces	0	0.0000	0.0000	0.0000	0.0000		0.0000	0.0000		0.0000	0.0000	0.0000	0.0000	0.0000	0.0000	0.0000	0.0000
Parking Lot	0	0.0000	0.0000	0.0000	0.0000		0.0000	0.0000		0.0000	0.0000	0.0000	0.0000	0.0000	0.0000	0.0000	0.0000
Unrefrigerated Warehouse-No Rail	488381	2.6300e-003	0.0239	0.0201	1.4000e-004		1.8200e-003	1.8200e-003		1.8200e-003	1.8200e-003	0.0000	26.0619	26.0619	5.0000e-004	4.8000e-004	26.2168
<b>Total</b>		<b>2.6300e-003</b>	<b>0.0239</b>	<b>0.0201</b>	<b>1.4000e-004</b>		<b>1.8200e-003</b>	<b>1.8200e-003</b>		<b>1.8200e-003</b>	<b>1.8200e-003</b>	<b>0.0000</b>	<b>26.0619</b>	<b>26.0619</b>	<b>5.0000e-004</b>	<b>4.8000e-004</b>	<b>26.2168</b>

Muranaka Warehouse VMT - Riverside-South Coast County, Annual

**5.3 Energy by Land Use - Electricity**

**Unmitigated**

	Electricity Use	Total CO2	CH4	N2O	CO2e
Land Use	kWh/yr	MT/yr			
City Park	0	0.0000	0.0000	0.0000	0.0000
Other Asphalt Surfaces	0	0.0000	0.0000	0.0000	0.0000
Parking Lot	19740	4.7686	2.6000e-004	5.0000e-005	4.7911
Unrefrigerated Warehouse-No Rail	567774	137.1569	7.4700e-003	1.5500e-003	137.8041
<b>Total</b>		<b>141.9255</b>	<b>7.7300e-003</b>	<b>1.6000e-003</b>	<b>142.5952</b>

## Murataka Warehouse VMT - Riverside-South Coast County, Annual

**5.3 Energy by Land Use - Electricity****Mitigated**

	Electricity Use	Total CO2	CH4	N2O	CO2e
Land Use	kWh/yr	MT/yr			
City Park	0	0.0000	0.0000	0.0000	0.0000
Other Asphalt Surfaces	0	0.0000	0.0000	0.0000	0.0000
Parking Lot	19740	4.7686	2.6000e-004	5.0000e-005	4.7911
Unrefrigerated Warehouse-No Rail	567774	137.1569	7.4700e-003	1.5500e-003	137.8041
<b>Total</b>		<b>141.9255</b>	<b>7.7300e-003</b>	<b>1.6000e-003</b>	<b>142.5952</b>

**6.0 Area Detail****6.1 Mitigation Measures Area**

Muranaka Warehouse VMT - Riverside-South Coast County, Annual

	ROG	NOx	CO	SO2	Fugitive PM10	Exhaust PM10	PM10 Total	Fugitive PM2.5	Exhaust PM2.5	PM2.5 Total	Bio- CO2	NBio- CO2	Total CO2	CH4	N2O	CO2e
Category	tons/yr										MT/yr					
Mitigated	0.9975	4.0000e-005	4.9400e-003	0.0000		2.0000e-005	2.0000e-005		2.0000e-005	2.0000e-005	0.0000	9.6000e-003	9.6000e-003	3.0000e-005	0.0000	0.0102
Unmitigated	0.9975	4.0000e-005	4.9400e-003	0.0000		2.0000e-005	2.0000e-005		2.0000e-005	2.0000e-005	0.0000	9.6000e-003	9.6000e-003	3.0000e-005	0.0000	0.0102

6.2 Area by SubCategory

Unmitigated

	ROG	NOx	CO	SO2	Fugitive PM10	Exhaust PM10	PM10 Total	Fugitive PM2.5	Exhaust PM2.5	PM2.5 Total	Bio- CO2	NBio- CO2	Total CO2	CH4	N2O	CO2e
SubCategory	tons/yr										MT/yr					
Architectural Coating	0.1142					0.0000	0.0000		0.0000	0.0000	0.0000	0.0000	0.0000	0.0000	0.0000	0.0000
Consumer Products	0.8829					0.0000	0.0000		0.0000	0.0000	0.0000	0.0000	0.0000	0.0000	0.0000	0.0000
Landscaping	4.6000e-004	4.0000e-005	4.9400e-003	0.0000		2.0000e-005	2.0000e-005		2.0000e-005	2.0000e-005	0.0000	9.6000e-003	9.6000e-003	3.0000e-005	0.0000	0.0102
<b>Total</b>	<b>0.9976</b>	<b>4.0000e-005</b>	<b>4.9400e-003</b>	<b>0.0000</b>		<b>2.0000e-005</b>	<b>2.0000e-005</b>		<b>2.0000e-005</b>	<b>2.0000e-005</b>	<b>0.0000</b>	<b>9.6000e-003</b>	<b>9.6000e-003</b>	<b>3.0000e-005</b>	<b>0.0000</b>	<b>0.0102</b>

Muranaka Warehouse VMT - Riverside-South Coast County, Annual

**6.2 Area by SubCategory**

**Mitigated**

	ROG	NOx	CO	SO2	Fugitive PM10	Exhaust PM10	PM10 Total	Fugitive PM2.5	Exhaust PM2.5	PM2.5 Total	Bio- CO2	NBio- CO2	Total CO2	CH4	N2O	CO2e
SubCategory	tons/yr										MT/yr					
Architectural Coating	0.1142					0.0000	0.0000		0.0000	0.0000	0.0000	0.0000	0.0000	0.0000	0.0000	0.0000
Consumer Products	0.8829					0.0000	0.0000		0.0000	0.0000	0.0000	0.0000	0.0000	0.0000	0.0000	0.0000
Landscaping	4.6000e-004	4.0000e-005	4.9400e-003	0.0000		2.0000e-005	2.0000e-005		2.0000e-005	2.0000e-005	0.0000	9.6000e-003	9.6000e-003	3.0000e-005	0.0000	0.0102
<b>Total</b>	<b>0.9976</b>	<b>4.0000e-005</b>	<b>4.9400e-003</b>	<b>0.0000</b>		<b>2.0000e-005</b>	<b>2.0000e-005</b>		<b>2.0000e-005</b>	<b>2.0000e-005</b>	<b>0.0000</b>	<b>9.6000e-003</b>	<b>9.6000e-003</b>	<b>3.0000e-005</b>	<b>0.0000</b>	<b>0.0102</b>

**7.0 Water Detail**

---

**7.1 Mitigation Measures Water**

Muranaka Warehouse VMT - Riverside-South Coast County, Annual

	Total CO2	CH4	N2O	CO2e
Category	MT/yr			
Mitigated	199.0416	1.8227	0.0449	257.9744
Unmitigated	199.0416	1.8227	0.0449	257.9744

**7.2 Water by Land Use**

**Unmitigated**

	Indoor/Outdoor Use	Total CO2	CH4	N2O	CO2e
Land Use	Mgal	MT/yr			
City Park	0 / 2.38296	6.3955	3.5000e-004	7.0000e-005	6.4257
Other Asphalt Surfaces	0 / 0	0.0000	0.0000	0.0000	0.0000
Parking Lot	0 / 0	0.0000	0.0000	0.0000	0.0000
Unrefrigerated Warehouse-No Rail	55.6341 / 0	192.6461	1.8224	0.0448	251.5487
<b>Total</b>		<b>199.0416</b>	<b>1.8227</b>	<b>0.0449</b>	<b>257.9744</b>



Muranaka Warehouse VMT - Riverside-South Coast County, Annual

**7.2 Water by Land Use**

**Mitigated**

	Indoor/Outdoor Use	Total CO2	CH4	N2O	CO2e
Land Use	Mgal	MT/yr			
City Park	0 / 2.38296	6.3955	3.5000e-004	7.0000e-005	6.4257
Other Asphalt Surfaces	0 / 0	0.0000	0.0000	0.0000	0.0000
Parking Lot	0 / 0	0.0000	0.0000	0.0000	0.0000
Unrefrigerated Warehouse-No Rail	55.6341 / 0	192.6461	1.8224	0.0448	251.5487
<b>Total</b>		<b>199.0416</b>	<b>1.8227</b>	<b>0.0449</b>	<b>257.9744</b>

**8.0 Waste Detail**

---

**8.1 Mitigation Measures Waste**

Muranaka Warehouse VMT - Riverside-South Coast County, Annual

**Category/Year**

	Total CO2	CH4	N2O	CO2e
	MT/yr			
Mitigated	45.9409	2.7150	0.0000	113.8167
Unmitigated	45.9409	2.7150	0.0000	113.8167

**8.2 Waste by Land Use**

**Unmitigated**

	Waste Disposed	Total CO2	CH4	N2O	CO2e
Land Use	tons	MT/yr			
City Park	0.17	0.0345	2.0400e-003	0.0000	0.0855
Other Asphalt Surfaces	0	0.0000	0.0000	0.0000	0.0000
Parking Lot	0	0.0000	0.0000	0.0000	0.0000
Unrefrigerated Warehouse-No Rail	226.15	45.9064	2.7130	0.0000	113.7312
<b>Total</b>		<b>45.9409</b>	<b>2.7150</b>	<b>0.0000</b>	<b>113.8167</b>

Muranaka Warehouse VMT - Riverside-South Coast County, Annual

**8.2 Waste by Land Use**

**Mitigated**

	Waste Disposed	Total CO2	CH4	N2O	CO2e
Land Use	tons	MT/yr			
City Park	0.17	0.0345	2.0400e-003	0.0000	0.0855
Other Asphalt Surfaces	0	0.0000	0.0000	0.0000	0.0000
Parking Lot	0	0.0000	0.0000	0.0000	0.0000
Unrefrigerated Warehouse-No Rail	226.15	45.9064	2.7130	0.0000	113.7312
<b>Total</b>		<b>45.9409</b>	<b>2.7150</b>	<b>0.0000</b>	<b>113.8167</b>

**9.0 Operational Offroad**

Equipment Type	Number	Hours/Day	Days/Year	Horse Power	Load Factor	Fuel Type
----------------	--------	-----------	-----------	-------------	-------------	-----------

**10.0 Stationary Equipment**

**Fire Pumps and Emergency Generators**

Equipment Type	Number	Hours/Day	Hours/Year	Horse Power	Load Factor	Fuel Type
----------------	--------	-----------	------------	-------------	-------------	-----------

**Boilers**

Equipment Type	Number	Heat Input/Day	Heat Input/Year	Boiler Rating	Fuel Type
----------------	--------	----------------	-----------------	---------------	-----------

**User Defined Equipment**

Muranaka Warehouse VMT - Riverside-South Coast County, Annual

Equipment Type	Number
----------------	--------

**11.0 Vegetation**

---

## CalEEMod Operational Analysis Sheets (Truck)

Muranaka Warehouse VMT - Riverside-South Coast County, Annual

**Muranaka Warehouse VMT**  
**Riverside-South Coast County, Annual**

**1.0 Project Characteristics**

**1.1 Land Usage**

Land Uses	Size	Metric	Lot Acreage	Floor Surface Area	Population
Unrefrigerated Warehouse-No Rail	240.58	1000sqft	5.52	240,582.00	0
Other Asphalt Surfaces	3.21	Acre	3.21	139,827.60	0
Parking Lot	141.00	Space	1.27	56,400.00	0
City Park	2.00	Acre	2.00	87,120.00	0

**1.2 Other Project Characteristics**

<b>Urbanization</b>	Rural	<b>Wind Speed (m/s)</b>	2.4	<b>Precipitation Freq (Days)</b>	28
<b>Climate Zone</b>	10			<b>Operational Year</b>	2023
<b>Utility Company</b>	Southern California Edison				
<b>CO2 Intensity (lb/MW hr)</b>	532.57	<b>CH4 Intensity (lb/MW hr)</b>	0.029	<b>N2O Intensity (lb/MW hr)</b>	0.006

**1.3 User Entered Comments & Non-Default Data**

## Muranaka Warehouse VMT - Riverside-South Coast County, Annual

Project Characteristics - SCE 2020-2029 CO2 Intensity Factor

Land Use -

Construction Phase - Operational Analysis Only

Off-road Equipment - Operational Analysis Only

Vehicle Trips - Used Project Trip Generation (EPD Solutions 2021)

Vehicle Emission Factors - EMFAC 2017 Rates

Vehicle Emission Factors - EMFAC 2017 Rates

Vehicle Emission Factors - EMFAC 2017 Rates

Energy Use -

Table Name	Column Name	Default Value	New Value
tblConstructionPhase	NumDays	10.00	0.00
tblFleetMix	HHD	0.07	0.57
tblFleetMix	LDA	0.55	0.00
tblFleetMix	LDT1	0.04	0.00
tblFleetMix	LDT2	0.19	0.00
tblFleetMix	LHD1	0.01	0.21
tblFleetMix	LHD2	4.8060e-003	0.00
tblFleetMix	MCY	4.5080e-003	0.00
tblFleetMix	MDV	0.11	0.00
tblFleetMix	MH	8.9800e-004	0.00
tblFleetMix	MHD	0.02	0.21
tblFleetMix	OBUS	1.4090e-003	0.00
tblFleetMix	SBUS	9.1800e-004	0.00
tblFleetMix	UBUS	1.1470e-003	0.00
tblProjectCharacteristics	CO2IntensityFactor	702.44	532.57
tblProjectCharacteristics	UrbanizationLevel	Urban	Rural

## Muranaka Warehouse VMT - Riverside-South Coast County, Annual

tblVehicleEF	HHD	0.96	0.03
tblVehicleEF	HHD	0.03	0.08
tblVehicleEF	HHD	0.08	0.00
tblVehicleEF	HHD	2.07	6.97
tblVehicleEF	HHD	0.41	0.42
tblVehicleEF	HHD	1.44	7.1540e-003
tblVehicleEF	HHD	6,147.84	1,163.16
tblVehicleEF	HHD	1,399.88	1,361.03
tblVehicleEF	HHD	4.72	0.06
tblVehicleEF	HHD	17.43	5.90
tblVehicleEF	HHD	0.97	2.45
tblVehicleEF	HHD	20.29	2.39
tblVehicleEF	HHD	5.1890e-003	3.0150e-003
tblVehicleEF	HHD	0.06	0.06
tblVehicleEF	HHD	0.04	0.04
tblVehicleEF	HHD	5.1440e-003	0.02
tblVehicleEF	HHD	3.9000e-005	1.0000e-006
tblVehicleEF	HHD	4.9650e-003	2.8850e-003
tblVehicleEF	HHD	0.03	0.03
tblVehicleEF	HHD	8.8620e-003	8.8720e-003
tblVehicleEF	HHD	4.9210e-003	0.02
tblVehicleEF	HHD	3.6000e-005	1.0000e-006
tblVehicleEF	HHD	7.3000e-005	4.0000e-006
tblVehicleEF	HHD	2.3430e-003	1.6700e-004
tblVehicleEF	HHD	0.55	0.47
tblVehicleEF	HHD	4.3000e-005	3.0000e-006
tblVehicleEF	HHD	0.04	0.02



## Muranaka Warehouse VMT - Riverside-South Coast County, Annual

tblVehicleEF	HHD	1.5400e-004	8.4500e-004
tblVehicleEF	HHD	0.04	2.0000e-006
tblVehicleEF	HHD	0.06	0.01
tblVehicleEF	HHD	0.01	0.01
tblVehicleEF	HHD	7.1000e-005	1.0000e-006
tblVehicleEF	HHD	7.3000e-005	4.0000e-006
tblVehicleEF	HHD	2.3430e-003	1.6700e-004
tblVehicleEF	HHD	0.63	0.54
tblVehicleEF	HHD	4.3000e-005	3.0000e-006
tblVehicleEF	HHD	0.08	0.10
tblVehicleEF	HHD	1.5400e-004	8.4500e-004
tblVehicleEF	HHD	0.04	2.0000e-006
tblVehicleEF	HHD	0.91	0.03
tblVehicleEF	HHD	0.03	0.08
tblVehicleEF	HHD	0.08	0.00
tblVehicleEF	HHD	1.50	6.87
tblVehicleEF	HHD	0.41	0.42
tblVehicleEF	HHD	1.38	6.7940e-003
tblVehicleEF	HHD	6,513.09	1,149.67
tblVehicleEF	HHD	1,399.88	1,361.03
tblVehicleEF	HHD	4.72	0.06
tblVehicleEF	HHD	17.99	5.63
tblVehicleEF	HHD	0.91	2.32
tblVehicleEF	HHD	20.28	2.39
tblVehicleEF	HHD	4.3760e-003	2.6330e-003
tblVehicleEF	HHD	0.06	0.06
tblVehicleEF	HHD	0.04	0.04

## Muranaka Warehouse VMT - Riverside-South Coast County, Annual

tblVehicleEF	HHD	5.1440e-003	0.02
tblVehicleEF	HHD	3.9000e-005	1.0000e-006
tblVehicleEF	HHD	4.1860e-003	2.5200e-003
tblVehicleEF	HHD	0.03	0.03
tblVehicleEF	HHD	8.8620e-003	8.8730e-003
tblVehicleEF	HHD	4.9210e-003	0.02
tblVehicleEF	HHD	3.6000e-005	1.0000e-006
tblVehicleEF	HHD	1.4000e-004	7.0000e-006
tblVehicleEF	HHD	2.6540e-003	1.7400e-004
tblVehicleEF	HHD	0.51	0.50
tblVehicleEF	HHD	8.2000e-005	5.0000e-006
tblVehicleEF	HHD	0.04	0.02
tblVehicleEF	HHD	1.5700e-004	8.3700e-004
tblVehicleEF	HHD	0.04	2.0000e-006
tblVehicleEF	HHD	0.06	0.01
tblVehicleEF	HHD	0.01	0.01
tblVehicleEF	HHD	7.0000e-005	1.0000e-006
tblVehicleEF	HHD	1.4000e-004	7.0000e-006
tblVehicleEF	HHD	2.6540e-003	1.7400e-004
tblVehicleEF	HHD	0.59	0.57
tblVehicleEF	HHD	8.2000e-005	5.0000e-006
tblVehicleEF	HHD	0.08	0.10
tblVehicleEF	HHD	1.5700e-004	8.3700e-004
tblVehicleEF	HHD	0.04	2.0000e-006
tblVehicleEF	HHD	1.04	0.03
tblVehicleEF	HHD	0.03	0.08
tblVehicleEF	HHD	0.08	0.00

## Muranaka Warehouse VMT - Riverside-South Coast County, Annual

tblVehicleEF	HHD	2.85	7.11
tblVehicleEF	HHD	0.41	0.42
tblVehicleEF	HHD	1.46	7.2060e-003
tblVehicleEF	HHD	5,643.45	1,181.80
tblVehicleEF	HHD	1,399.88	1,361.03
tblVehicleEF	HHD	4.72	0.06
tblVehicleEF	HHD	16.66	6.26
tblVehicleEF	HHD	0.96	2.42
tblVehicleEF	HHD	20.29	2.39
tblVehicleEF	HHD	6.3140e-003	3.5430e-003
tblVehicleEF	HHD	0.06	0.06
tblVehicleEF	HHD	0.04	0.04
tblVehicleEF	HHD	5.1440e-003	0.02
tblVehicleEF	HHD	3.9000e-005	1.0000e-006
tblVehicleEF	HHD	6.0400e-003	3.3890e-003
tblVehicleEF	HHD	0.03	0.03
tblVehicleEF	HHD	8.8620e-003	8.7250e-003
tblVehicleEF	HHD	4.9210e-003	0.02
tblVehicleEF	HHD	3.6000e-005	1.0000e-006
tblVehicleEF	HHD	5.5000e-005	5.0000e-006
tblVehicleEF	HHD	2.4340e-003	1.8900e-004
tblVehicleEF	HHD	0.59	0.43
tblVehicleEF	HHD	3.6000e-005	3.0000e-006
tblVehicleEF	HHD	0.04	0.02
tblVehicleEF	HHD	1.6500e-004	8.9800e-004
tblVehicleEF	HHD	0.04	2.0000e-006
tblVehicleEF	HHD	0.05	0.01

## Muranaka Warehouse VMT - Riverside-South Coast County, Annual

tblVehicleEF	HHD	0.01	0.01
tblVehicleEF	HHD	7.1000e-005	1.0000e-006
tblVehicleEF	HHD	5.5000e-005	5.0000e-006
tblVehicleEF	HHD	2.4340e-003	1.8900e-004
tblVehicleEF	HHD	0.68	0.50
tblVehicleEF	HHD	3.6000e-005	3.0000e-006
tblVehicleEF	HHD	0.08	0.10
tblVehicleEF	HHD	1.6500e-004	8.9800e-004
tblVehicleEF	HHD	0.04	2.0000e-006
tblVehicleEF	LHD1	4.9950e-003	5.2390e-003
tblVehicleEF	LHD1	8.5970e-003	4.7600e-003
tblVehicleEF	LHD1	0.02	0.01
tblVehicleEF	LHD1	0.14	0.18
tblVehicleEF	LHD1	0.81	0.55
tblVehicleEF	LHD1	2.14	1.03
tblVehicleEF	LHD1	9.25	8.93
tblVehicleEF	LHD1	596.36	646.70
tblVehicleEF	LHD1	29.33	11.66
tblVehicleEF	LHD1	0.09	0.06
tblVehicleEF	LHD1	1.91	0.71
tblVehicleEF	LHD1	0.93	0.31
tblVehicleEF	LHD1	9.6600e-004	8.2600e-004
tblVehicleEF	LHD1	0.01	9.7820e-003
tblVehicleEF	LHD1	0.01	6.8310e-003
tblVehicleEF	LHD1	7.9000e-004	2.5200e-004
tblVehicleEF	LHD1	9.2400e-004	7.9000e-004
tblVehicleEF	LHD1	2.5590e-003	2.4460e-003

## Muranaka Warehouse VMT - Riverside-South Coast County, Annual

tblVehicleEF	LHD1	0.01	6.5090e-003
tblVehicleEF	LHD1	7.2700e-004	2.3200e-004
tblVehicleEF	LHD1	3.6750e-003	2.3770e-003
tblVehicleEF	LHD1	0.10	0.07
tblVehicleEF	LHD1	0.02	0.02
tblVehicleEF	LHD1	1.8430e-003	1.4210e-003
tblVehicleEF	LHD1	0.07	0.05
tblVehicleEF	LHD1	0.31	0.49
tblVehicleEF	LHD1	0.23	0.07
tblVehicleEF	LHD1	9.2000e-005	8.7000e-005
tblVehicleEF	LHD1	5.8420e-003	6.3090e-003
tblVehicleEF	LHD1	3.3400e-004	1.1500e-004
tblVehicleEF	LHD1	3.6750e-003	2.3770e-003
tblVehicleEF	LHD1	0.10	0.07
tblVehicleEF	LHD1	0.02	0.03
tblVehicleEF	LHD1	1.8430e-003	1.4210e-003
tblVehicleEF	LHD1	0.08	0.06
tblVehicleEF	LHD1	0.31	0.49
tblVehicleEF	LHD1	0.25	0.08
tblVehicleEF	LHD1	4.9950e-003	5.2510e-003
tblVehicleEF	LHD1	8.7610e-003	4.8470e-003
tblVehicleEF	LHD1	0.02	0.01
tblVehicleEF	LHD1	0.14	0.18
tblVehicleEF	LHD1	0.82	0.56
tblVehicleEF	LHD1	2.04	0.99
tblVehicleEF	LHD1	9.25	8.93
tblVehicleEF	LHD1	596.36	646.72

## Muranaka Warehouse VMT - Riverside-South Coast County, Annual

tblVehicleEF	LHD1	29.33	11.58
tblVehicleEF	LHD1	0.09	0.06
tblVehicleEF	LHD1	1.80	0.66
tblVehicleEF	LHD1	0.90	0.30
tblVehicleEF	LHD1	9.6600e-004	8.2600e-004
tblVehicleEF	LHD1	0.01	9.7820e-003
tblVehicleEF	LHD1	0.01	6.8310e-003
tblVehicleEF	LHD1	7.9000e-004	2.5200e-004
tblVehicleEF	LHD1	9.2400e-004	7.9000e-004
tblVehicleEF	LHD1	2.5590e-003	2.4460e-003
tblVehicleEF	LHD1	0.01	6.5090e-003
tblVehicleEF	LHD1	7.2700e-004	2.3200e-004
tblVehicleEF	LHD1	6.8550e-003	3.6820e-003
tblVehicleEF	LHD1	0.11	0.08
tblVehicleEF	LHD1	0.02	0.02
tblVehicleEF	LHD1	3.4810e-003	2.1150e-003
tblVehicleEF	LHD1	0.07	0.05
tblVehicleEF	LHD1	0.32	0.47
tblVehicleEF	LHD1	0.22	0.07
tblVehicleEF	LHD1	9.2000e-005	8.6700e-004
tblVehicleEF	LHD1	5.8420e-003	6.3090e-003
tblVehicleEF	LHD1	3.3200e-004	1.1500e-004
tblVehicleEF	LHD1	6.8550e-003	3.6820e-003
tblVehicleEF	LHD1	0.11	0.08
tblVehicleEF	LHD1	0.02	0.03
tblVehicleEF	LHD1	3.4810e-003	2.1150e-003
tblVehicleEF	LHD1	0.09	0.06

## Muranaka Warehouse VMT - Riverside-South Coast County, Annual

tblVehicleEF	LHD1	0.32	0.47
tblVehicleEF	LHD1	0.24	0.07
tblVehicleEF	LHD1	4.9950e-003	5.2370e-003
tblVehicleEF	LHD1	8.5850e-003	4.7400e-003
tblVehicleEF	LHD1	0.02	0.01
tblVehicleEF	LHD1	0.14	0.18
tblVehicleEF	LHD1	0.81	0.55
tblVehicleEF	LHD1	2.14	1.04
tblVehicleEF	LHD1	9.25	8.93
tblVehicleEF	LHD1	596.36	646.70
tblVehicleEF	LHD1	29.33	11.67
tblVehicleEF	LHD1	0.09	0.06
tblVehicleEF	LHD1	1.89	0.69
tblVehicleEF	LHD1	0.92	0.31
tblVehicleEF	LHD1	9.6600e-004	8.2600e-004
tblVehicleEF	LHD1	0.01	9.7820e-003
tblVehicleEF	LHD1	0.01	6.8310e-003
tblVehicleEF	LHD1	7.9000e-004	2.5200e-004
tblVehicleEF	LHD1	9.2400e-004	7.9000e-004
tblVehicleEF	LHD1	2.5590e-003	2.4460e-003
tblVehicleEF	LHD1	0.01	6.5090e-003
tblVehicleEF	LHD1	7.2700e-004	2.3170e-003
tblVehicleEF	LHD1	3.2380e-003	2.4160e-003
tblVehicleEF	LHD1	0.11	0.08
tblVehicleEF	LHD1	0.02	0.02
tblVehicleEF	LHD1	1.6810e-003	1.3660e-003
tblVehicleEF	LHD1	0.07	0.05

## Muranaka Warehouse VMT - Riverside-South Coast County, Annual

tblVehicleEF	LHD1	0.33	0.53
tblVehicleEF	LHD1	0.23	0.07
tblVehicleEF	LHD1	9.2000e-005	8.7000e-005
tblVehicleEF	LHD1	5.8420e-003	6.3090e-003
tblVehicleEF	LHD1	3.3400e-004	1.1600e-004
tblVehicleEF	LHD1	3.2380e-003	2.4160e-003
tblVehicleEF	LHD1	0.11	0.08
tblVehicleEF	LHD1	0.02	0.03
tblVehicleEF	LHD1	1.6810e-003	1.3960e-003
tblVehicleEF	LHD1	0.08	0.06
tblVehicleEF	LHD1	0.33	0.53
tblVehicleEF	LHD1	0.25	0.08
tblVehicleEF	MHD	0.02	4.1870e-003
tblVehicleEF	MHD	2.5650e-003	1.7190e-003
tblVehicleEF	MHD	0.05	0.01
tblVehicleEF	MHD	0.32	0.38
tblVehicleEF	MHD	0.21	0.23
tblVehicleEF	MHD	5.07	1.22
tblVehicleEF	MHD	148.43	62.21
tblVehicleEF	MHD	1,056.49	1,004.76
tblVehicleEF	MHD	54.56	11.21
tblVehicleEF	MHD	0.41	0.33
tblVehicleEF	MHD	0.47	1.02
tblVehicleEF	MHD	11.43	1.61
tblVehicleEF	MHD	1.3500e-004	3.0500e-004
tblVehicleEF	MHD	2.6660e-003	6.4990e-003
tblVehicleEF	MHD	7.3000e-004	1.1900e-004



## Muranaka Warehouse VMT - Riverside-South Coast County, Annual

tblVehicleEF	MHD	1.2900e-004	2.9200e-004
tblVehicleEF	MHD	2.5470e-003	6.2130e-003
tblVehicleEF	MHD	6.7100e-004	1.1000e-004
tblVehicleEF	MHD	1.5020e-003	5.6700e-004
tblVehicleEF	MHD	0.04	0.02
tblVehicleEF	MHD	0.02	0.02
tblVehicleEF	MHD	7.6500e-004	3.6600e-004
tblVehicleEF	MHD	0.02	0.01
tblVehicleEF	MHD	0.02	0.12
tblVehicleEF	MHD	0.31	0.06
tblVehicleEF	MHD	1.4270e-003	5.9100e-004
tblVehicleEF	MHD	0.01	9.5990e-003
tblVehicleEF	MHD	6.3400e-004	1.1100e-004
tblVehicleEF	MHD	1.5020e-003	5.6700e-004
tblVehicleEF	MHD	0.04	0.02
tblVehicleEF	MHD	0.03	0.03
tblVehicleEF	MHD	7.6500e-004	3.6600e-004
tblVehicleEF	MHD	0.03	0.02
tblVehicleEF	MHD	0.02	0.12
tblVehicleEF	MHD	0.34	0.06
tblVehicleEF	MHD	0.02	3.9750e-003
tblVehicleEF	MHD	2.5980e-003	1.7520e-003
tblVehicleEF	MHD	0.05	0.01
tblVehicleEF	MHD	0.23	0.32
tblVehicleEF	MHD	0.21	0.23
tblVehicleEF	MHD	4.84	1.16
tblVehicleEF	MHD	157.22	62.22

Muranaka Warehouse VMT - Riverside-South Coast County, Annual

tblVehicleEF	MHD	1,056.49	1,004.76
tblVehicleEF	MHD	54.56	11.10
tblVehicleEF	MHD	0.42	0.32
tblVehicleEF	MHD	0.44	0.96
tblVehicleEF	MHD	11.41	1.61
tblVehicleEF	MHD	1.1400e-004	2.6000e-004
tblVehicleEF	MHD	2.6660e-003	6.4990e-003
tblVehicleEF	MHD	7.3000e-004	1.1900e-004
tblVehicleEF	MHD	1.0900e-004	2.4800e-004
tblVehicleEF	MHD	2.5470e-003	6.2130e-003
tblVehicleEF	MHD	6.7100e-004	1.1000e-004
tblVehicleEF	MHD	2.8970e-003	8.7600e-004
tblVehicleEF	MHD	0.05	0.02
tblVehicleEF	MHD	0.02	0.02
tblVehicleEF	MHD	1.4710e-003	5.4000e-004
tblVehicleEF	MHD	0.02	0.01
tblVehicleEF	MHD	0.02	0.11
tblVehicleEF	MHD	0.30	0.06
tblVehicleEF	MHD	1.5100e-003	5.9200e-004
tblVehicleEF	MHD	0.01	9.5990e-003
tblVehicleEF	MHD	6.3000e-004	1.1000e-004
tblVehicleEF	MHD	2.8970e-003	8.7600e-004
tblVehicleEF	MHD	0.05	0.02
tblVehicleEF	MHD	0.03	0.03
tblVehicleEF	MHD	1.4710e-003	5.4000e-004
tblVehicleEF	MHD	0.03	0.02
tblVehicleEF	MHD	0.02	0.11

## Muranaka Warehouse VMT - Riverside-South Coast County, Annual

tblVehicleEF	MHD	0.33	0.06
tblVehicleEF	MHD	0.02	4.4940e-003
tblVehicleEF	MHD	2.5410e-003	1.7070e-003
tblVehicleEF	MHD	0.05	0.01
tblVehicleEF	MHD	0.44	0.47
tblVehicleEF	MHD	0.21	0.23
tblVehicleEF	MHD	5.15	1.23
tblVehicleEF	MHD	136.28	62.19
tblVehicleEF	MHD	1,056.49	1,004.76
tblVehicleEF	MHD	54.56	11.22
tblVehicleEF	MHD	0.39	0.34
tblVehicleEF	MHD	0.46	1.01
tblVehicleEF	MHD	11.44	1.61
tblVehicleEF	MHD	1.6400e-004	3.6700e-004
tblVehicleEF	MHD	2.6660e-003	6.4990e-003
tblVehicleEF	MHD	7.3000e-004	1.1900e-004
tblVehicleEF	MHD	1.5700e-004	3.5100e-004
tblVehicleEF	MHD	2.5470e-003	6.2130e-003
tblVehicleEF	MHD	6.7100e-004	1.1000e-004
tblVehicleEF	MHD	1.0970e-003	5.5900e-004
tblVehicleEF	MHD	0.04	0.02
tblVehicleEF	MHD	0.02	0.02
tblVehicleEF	MHD	5.9600e-004	3.5200e-004
tblVehicleEF	MHD	0.02	0.01
tblVehicleEF	MHD	0.02	0.13
tblVehicleEF	MHD	0.31	0.06
tblVehicleEF	MHD	1.3130e-003	5.9100e-004

## Muranaka Warehouse VMT - Riverside-South Coast County, Annual

tblVehicleEF	MHD	0.01	9.5990e-003
tblVehicleEF	MHD	6.3600e-004	1.1100e-004
tblVehicleEF	MHD	1.0970e-003	5.5900e-004
tblVehicleEF	MHD	0.04	0.02
tblVehicleEF	MHD	0.03	0.03
tblVehicleEF	MHD	5.9600e-004	3.5200e-004
tblVehicleEF	MHD	0.03	0.02
tblVehicleEF	MHD	0.02	0.13
tblVehicleEF	MHD	0.34	0.06
tblVehicleTrips	CC_TTP	48.00	0.00
tblVehicleTrips	CNW_TTP	19.00	0.00
tblVehicleTrips	CNW_TTP	41.00	0.00
tblVehicleTrips	CW_TL	18.50	40.00
tblVehicleTrips	CW_TTP	33.00	0.00
tblVehicleTrips	CW_TTP	59.00	100.00
tblVehicleTrips	DV_TP	28.00	0.00
tblVehicleTrips	DV_TP	5.00	0.00
tblVehicleTrips	PB_TP	6.00	0.00
tblVehicleTrips	PB_TP	3.00	0.00
tblVehicleTrips	PR_TP	66.00	0.00
tblVehicleTrips	PR_TP	92.00	100.00
tblVehicleTrips	ST_TR	22.75	0.00
tblVehicleTrips	ST_TR	1.68	0.38
tblVehicleTrips	SU_TR	16.74	0.00
tblVehicleTrips	SU_TR	1.68	0.38
tblVehicleTrips	WD_TR	1.89	0.00
tblVehicleTrips	WD_TR	1.68	0.38



Muranaka Warehouse VMT - Riverside-South Coast County, Annual

	ROG	NOx	CO	SO2	Fugitive PM10	Exhaust PM10	PM10 Total	Fugitive PM2.5	Exhaust PM2.5	PM2.5 Total	Bio- CO2	NBio-CO2	Total CO2	CH4	N2O	CO2e
Percent Reduction	0.00	0.00	0.00	0.00	0.00	0.00	0.00	0.00	0.00	0.00	0.00	0.00	0.00	0.00	0.00	0.00

Quarter	Start Date	End Date	Maximum Unmitigated ROG + NOX (tons/quarter)	Maximum Mitigated ROG + NOX (tons/quarter)
		Highest		

2.2 Overall Operational

Unmitigated Operational

	ROG	NOx	CO	SO2	Fugitive PM10	Exhaust PM10	PM10 Total	Fugitive PM2.5	Exhaust PM2.5	PM2.5 Total	Bio- CO2	NBio- CO2	Total CO2	CH4	N2O	CO2e
Category	tons/yr										MT/yr					
Area	0.9975	4.0000e-005	4.9400e-003	0.0000		2.0000e-005	2.0000e-005		2.0000e-005	2.0000e-005	0.0000	9.6000e-003	9.6000e-003	3.0000e-005	0.0000	0.0102
Energy	2.6300e-003	0.0239	0.0201	1.4000e-004		1.8200e-003	1.8200e-003		1.8200e-003	1.8200e-003	0.0000	167.9874	167.9874	8.2300e-003	2.0800e-003	168.8119
Mobile	0.0552	2.7914	0.7687	0.0156	0.5842	0.0214	0.6056	0.1648	0.0205	0.1853	0.0000	1,528.101 <sub>3</sub>	1,528.101 <sub>3</sub>	0.0615	0.0000	1,529.639 <sub>5</sub>
Waste						0.0000	0.0000		0.0000	0.0000	45.9409	0.0000	45.9409	2.7150	0.0000	113.8167
Water						0.0000	0.0000		0.0000	0.0000	17.6501	181.3915	199.0416	1.8227	0.0449	257.9744
<b>Total</b>	<b>1.0554</b>	<b>2.8154</b>	<b>0.7937</b>	<b>0.0157</b>	<b>0.5842</b>	<b>0.0233</b>	<b>0.6074</b>	<b>0.1648</b>	<b>0.0223</b>	<b>0.1871</b>	<b>63.5911</b>	<b>1,877.489<sub>7</sub></b>	<b>1,941.080<sub>8</sub></b>	<b>4.6075</b>	<b>0.0469</b>	<b>2,070.252<sub>7</sub></b>

Muranaka Warehouse VMT - Riverside-South Coast County, Annual

**2.2 Overall Operational**

**Mitigated Operational**

	ROG	NOx	CO	SO2	Fugitive PM10	Exhaust PM10	PM10 Total	Fugitive PM2.5	Exhaust PM2.5	PM2.5 Total	Bio- CO2	NBio- CO2	Total CO2	CH4	N2O	CO2e
Category	tons/yr										MT/yr					
Area	0.9975	4.0000e-005	4.9400e-003	0.0000		2.0000e-005	2.0000e-005		2.0000e-005	2.0000e-005	0.0000	9.6000e-003	9.6000e-003	3.0000e-005	0.0000	0.0102
Energy	2.6300e-003	0.0239	0.0201	1.4000e-004		1.8200e-003	1.8200e-003		1.8200e-003	1.8200e-003	0.0000	167.9874	167.9874	8.2300e-003	2.0800e-003	168.8119
Mobile	0.0552	2.7914	0.7687	0.0156	0.5842	0.0214	0.6056	0.1648	0.0205	0.1853	0.0000	1,528.1013	1,528.1013	0.0615	0.0000	1,529.6395
Waste						0.0000	0.0000		0.0000	0.0000	45.9409	0.0000	45.9409	2.7150	0.0000	113.8167
Water						0.0000	0.0000		0.0000	0.0000	17.6501	181.3915	199.0416	1.8227	0.0449	257.9744
<b>Total</b>	<b>1.0554</b>	<b>2.8154</b>	<b>0.7937</b>	<b>0.0157</b>	<b>0.5842</b>	<b>0.0233</b>	<b>0.6074</b>	<b>0.1648</b>	<b>0.0223</b>	<b>0.1871</b>	<b>63.5911</b>	<b>1,877.4897</b>	<b>1,941.0808</b>	<b>4.6075</b>	<b>0.0469</b>	<b>2,070.2527</b>

	ROG	NOx	CO	SO2	Fugitive PM10	Exhaust PM10	PM10 Total	Fugitive PM2.5	Exhaust PM2.5	PM2.5 Total	Bio- CO2	NBio- CO2	Total CO2	CH4	N2O	CO2e
Percent Reduction	0.00	0.00	0.00	0.00	0.00	0.00	0.00	0.00	0.00	0.00	0.00	0.00	0.00	0.00	0.00	0.00

**3.0 Construction Detail**

**Construction Phase**

Phase Number	Phase Name	Phase Type	Start Date	End Date	Num Days Week	Num Days	Phase Description
1	Operational Analysis Only	Site Preparation	2/24/2021	2/23/2021	5	0	

**Acres of Grading (Site Preparation Phase): 0**

Muranaka Warehouse VMT - Riverside-South Coast County, Annual

**Acres of Grading (Grading Phase): 0**

**Acres of Paving: 4.48**

**Residential Indoor: 0; Residential Outdoor: 0; Non-Residential Indoor: 0; Non-Residential Outdoor: 0; Striped Parking Area: 0 (Architectural Coating – sqft)**

**OffRoad Equipment**

Phase Name	Offroad Equipment Type	Amount	Usage Hours	Horse Power	Load Factor
Operational Analysis Only	Rubber Tired Dozers	3	8.00	247	0.40
Operational Analysis Only	Tractors/Loaders/Backhoes	4	8.00	97	0.37

**Trips and VMT**

Phase Name	Offroad Equipment Count	Worker Trip Number	Vendor Trip Number	Hauling Trip Number	Worker Trip Length	Vendor Trip Length	Hauling Trip Length	Worker Vehicle Class	Vendor Vehicle Class	Hauling Vehicle Class
Operational Analysis Only	7	18.00	0.00	0.00	19.80	7.90	20.00	LD_Mix	HDT_Mix	HHDT

**3.1 Mitigation Measures Construction**





Muranaka Warehouse VMT - Riverside-South Coast County, Annual

**3.2 Operational Analysis Only - 2021**

**Mitigated Construction On-Site**

	ROG	NOx	CO	SO2	Fugitive PM10	Exhaust PM10	PM10 Total	Fugitive PM2.5	Exhaust PM2.5	PM2.5 Total	Bio- CO2	NBio- CO2	Total CO2	CH4	N2O	CO2e
Category	tons/yr										MT/yr					
Fugitive Dust	0.0000	0.0000	0.0000	0.0000	0.0000	0.0000	0.0000	0.0000	0.0000	0.0000	0.0000	0.0000	0.0000	0.0000	0.0000	0.0000
Off-Road	0.0000	0.0000	0.0000	0.0000	0.0000	0.0000	0.0000	0.0000	0.0000	0.0000	0.0000	0.0000	0.0000	0.0000	0.0000	0.0000
<b>Total</b>	<b>0.0000</b>	<b>0.0000</b>	<b>0.0000</b>	<b>0.0000</b>	<b>0.0000</b>	<b>0.0000</b>	<b>0.0000</b>	<b>0.0000</b>	<b>0.0000</b>	<b>0.0000</b>	<b>0.0000</b>	<b>0.0000</b>	<b>0.0000</b>	<b>0.0000</b>	<b>0.0000</b>	<b>0.0000</b>

**Mitigated Construction Off-Site**

	ROG	NOx	CO	SO2	Fugitive PM10	Exhaust PM10	PM10 Total	Fugitive PM2.5	Exhaust PM2.5	PM2.5 Total	Bio- CO2	NBio- CO2	Total CO2	CH4	N2O	CO2e
Category	tons/yr										MT/yr					
Hauling	0.0000	0.0000	0.0000	0.0000	0.0000	0.0000	0.0000	0.0000	0.0000	0.0000	0.0000	0.0000	0.0000	0.0000	0.0000	0.0000
Vendor	0.0000	0.0000	0.0000	0.0000	0.0000	0.0000	0.0000	0.0000	0.0000	0.0000	0.0000	0.0000	0.0000	0.0000	0.0000	0.0000
Worker	0.0000	0.0000	0.0000	0.0000	0.0000	0.0000	0.0000	0.0000	0.0000	0.0000	0.0000	0.0000	0.0000	0.0000	0.0000	0.0000
<b>Total</b>	<b>0.0000</b>	<b>0.0000</b>	<b>0.0000</b>	<b>0.0000</b>	<b>0.0000</b>	<b>0.0000</b>	<b>0.0000</b>	<b>0.0000</b>	<b>0.0000</b>	<b>0.0000</b>	<b>0.0000</b>	<b>0.0000</b>	<b>0.0000</b>	<b>0.0000</b>	<b>0.0000</b>	<b>0.0000</b>

**4.0 Operational Detail - Mobile**

---

Muranaka Warehouse VMT - Riverside-South Coast County, Annual

**4.1 Mitigation Measures Mobile**

	ROG	NOx	CO	SO2	Fugitive PM10	Exhaust PM10	PM10 Total	Fugitive PM2.5	Exhaust PM2.5	PM2.5 Total	Bio- CO2	NBio- CO2	Total CO2	CH4	N2O	CO2e
Category	tons/yr										MT/yr					
Mitigated	0.0552	2.7914	0.7687	0.0156	0.5842	0.0214	0.6056	0.1648	0.0205	0.1853	0.0000	1,528.1013	1,528.1013	0.0615	0.0000	1,529.6395
Unmitigated	0.0552	2.7914	0.7687	0.0156	0.5842	0.0214	0.6056	0.1648	0.0205	0.1853	0.0000	1,528.1013	1,528.1013	0.0615	0.0000	1,529.6395

**4.2 Trip Summary Information**

Land Use	Average Daily Trip Rate			Unmitigated	Mitigated
	Weekday	Saturday	Sunday	Annual VMT	Annual VMT
City Park	0.00	0.00	0.00		
Other Asphalt Surfaces	0.00	0.00	0.00		
Parking Lot	0.00	0.00	0.00		
Unrefrigerated Warehouse-No Rail	91.42	91.42	91.42	1,331,092	1,331,092
Total	91.42	91.42	91.42	1,331,092	1,331,092

**4.3 Trip Type Information**

Muranaka Warehouse VMT - Riverside-South Coast County, Annual

Land Use	Miles			Trip %			Trip Purpose %		
	H-W or C-W	H-S or C-C	H-O or C-NW	H-W or C-W	H-S or C-C	H-O or C-NW	Primary	Diverted	Pass-by
City Park	18.50	10.10	7.90	0.00	0.00	0.00	0	0	0
Other Asphalt Surfaces	18.50	10.10	7.90	0.00	0.00	0.00	0	0	0
Parking Lot	18.50	10.10	7.90	0.00	0.00	0.00	0	0	0
Unrefrigerated Warehouse-No Rail	40.00	10.10	7.90	100.00	0.00	0.00	100	0	0

4.4 Fleet Mix

Land Use	LDA	LDT1	LDT2	MDV	LHD1	LHD2	MHD	HHD	OBUS	UBUS	MCY	SBUS	MH
City Park	0.548600	0.036250	0.186898	0.112544	0.014284	0.004806	0.017604	0.070134	0.001409	0.001147	0.004508	0.000918	0.000898
Other Asphalt Surfaces	0.548600	0.036250	0.186898	0.112544	0.014284	0.004806	0.017604	0.070134	0.001409	0.001147	0.004508	0.000918	0.000898
Parking Lot	0.548600	0.036250	0.186898	0.112544	0.014284	0.004806	0.017604	0.070134	0.001409	0.001147	0.004508	0.000918	0.000898
Unrefrigerated Warehouse-No Rail	0.000000	0.000000	0.000000	0.000000	0.213720	0.000000	0.213720	0.572559	0.000000	0.000000	0.000000	0.000000	0.000000

5.0 Energy Detail

Historical Energy Use: N

5.1 Mitigation Measures Energy

Muranaka Warehouse VMT - Riverside-South Coast County, Annual

	ROG	NOx	CO	SO2	Fugitive PM10	Exhaust PM10	PM10 Total	Fugitive PM2.5	Exhaust PM2.5	PM2.5 Total	Bio- CO2	NBio- CO2	Total CO2	CH4	N2O	CO2e
Category	tons/yr										MT/yr					
Electricity Mitigated						0.0000	0.0000		0.0000	0.0000	0.0000	141.9255	141.9255	7.7300e-003	1.6000e-003	142.5952
Electricity Unmitigated						0.0000	0.0000		0.0000	0.0000	0.0000	141.9255	141.9255	7.7300e-003	1.6000e-003	142.5952
NaturalGas Mitigated	2.6300e-003	0.0239	0.0201	1.4000e-004		1.8200e-003	1.8200e-003		1.8200e-003	1.8200e-003	0.0000	26.0619	26.0619	5.0000e-004	4.8000e-004	26.2168
NaturalGas Unmitigated	2.6300e-003	0.0239	0.0201	1.4000e-004		1.8200e-003	1.8200e-003		1.8200e-003	1.8200e-003	0.0000	26.0619	26.0619	5.0000e-004	4.8000e-004	26.2168

5.2 Energy by Land Use - NaturalGas

Unmitigated

	NaturalGas Use	ROG	NOx	CO	SO2	Fugitive PM10	Exhaust PM10	PM10 Total	Fugitive PM2.5	Exhaust PM2.5	PM2.5 Total	Bio- CO2	NBio- CO2	Total CO2	CH4	N2O	CO2e
Land Use	kBTU/yr	tons/yr										MT/yr					
City Park	0	0.0000	0.0000	0.0000	0.0000		0.0000	0.0000		0.0000	0.0000	0.0000	0.0000	0.0000	0.0000	0.0000	0.0000
Other Asphalt Surfaces	0	0.0000	0.0000	0.0000	0.0000		0.0000	0.0000		0.0000	0.0000	0.0000	0.0000	0.0000	0.0000	0.0000	0.0000
Parking Lot	0	0.0000	0.0000	0.0000	0.0000		0.0000	0.0000		0.0000	0.0000	0.0000	0.0000	0.0000	0.0000	0.0000	0.0000
Unrefrigerated Warehouse-No Rail	488381	2.6300e-003	0.0239	0.0201	1.4000e-004		1.8200e-003	1.8200e-003		1.8200e-003	1.8200e-003	0.0000	26.0619	26.0619	5.0000e-004	4.8000e-004	26.2168
<b>Total</b>		<b>2.6300e-003</b>	<b>0.0239</b>	<b>0.0201</b>	<b>1.4000e-004</b>		<b>1.8200e-003</b>	<b>1.8200e-003</b>		<b>1.8200e-003</b>	<b>1.8200e-003</b>	<b>0.0000</b>	<b>26.0619</b>	<b>26.0619</b>	<b>5.0000e-004</b>	<b>4.8000e-004</b>	<b>26.2168</b>

Muranaka Warehouse VMT - Riverside-South Coast County, Annual

**5.2 Energy by Land Use - NaturalGas**

**Mitigated**

	NaturalGas Use	ROG	NOx	CO	SO2	Fugitive PM10	Exhaust PM10	PM10 Total	Fugitive PM2.5	Exhaust PM2.5	PM2.5 Total	Bio- CO2	NBio- CO2	Total CO2	CH4	N2O	CO2e
Land Use	kBTU/yr	tons/yr										MT/yr					
City Park	0	0.0000	0.0000	0.0000	0.0000		0.0000	0.0000		0.0000	0.0000	0.0000	0.0000	0.0000	0.0000	0.0000	0.0000
Other Asphalt Surfaces	0	0.0000	0.0000	0.0000	0.0000		0.0000	0.0000		0.0000	0.0000	0.0000	0.0000	0.0000	0.0000	0.0000	0.0000
Parking Lot	0	0.0000	0.0000	0.0000	0.0000		0.0000	0.0000		0.0000	0.0000	0.0000	0.0000	0.0000	0.0000	0.0000	0.0000
Unrefrigerated Warehouse-No Rail	488381	2.6300e-003	0.0239	0.0201	1.4000e-004		1.8200e-003	1.8200e-003		1.8200e-003	1.8200e-003	0.0000	26.0619	26.0619	5.0000e-004	4.8000e-004	26.2168
<b>Total</b>		<b>2.6300e-003</b>	<b>0.0239</b>	<b>0.0201</b>	<b>1.4000e-004</b>		<b>1.8200e-003</b>	<b>1.8200e-003</b>		<b>1.8200e-003</b>	<b>1.8200e-003</b>	<b>0.0000</b>	<b>26.0619</b>	<b>26.0619</b>	<b>5.0000e-004</b>	<b>4.8000e-004</b>	<b>26.2168</b>

## Murataka Warehouse VMT - Riverside-South Coast County, Annual

**5.3 Energy by Land Use - Electricity****Unmitigated**

	Electricity Use	Total CO2	CH4	N2O	CO2e
Land Use	kWh/yr	MT/yr			
City Park	0	0.0000	0.0000	0.0000	0.0000
Other Asphalt Surfaces	0	0.0000	0.0000	0.0000	0.0000
Parking Lot	19740	4.7686	2.6000e-004	5.0000e-005	4.7911
Unrefrigerated Warehouse-No Rail	567774	137.1569	7.4700e-003	1.5500e-003	137.8041
<b>Total</b>		<b>141.9255</b>	<b>7.7300e-003</b>	<b>1.6000e-003</b>	<b>142.5952</b>

## Murataka Warehouse VMT - Riverside-South Coast County, Annual

**5.3 Energy by Land Use - Electricity****Mitigated**

	Electricity Use	Total CO2	CH4	N2O	CO2e
Land Use	kWh/yr	MT/yr			
City Park	0	0.0000	0.0000	0.0000	0.0000
Other Asphalt Surfaces	0	0.0000	0.0000	0.0000	0.0000
Parking Lot	19740	4.7686	2.6000e-004	5.0000e-005	4.7911
Unrefrigerated Warehouse-No Rail	567774	137.1569	7.4700e-003	1.5500e-003	137.8041
<b>Total</b>		<b>141.9255</b>	<b>7.7300e-003</b>	<b>1.6000e-003</b>	<b>142.5952</b>

**6.0 Area Detail****6.1 Mitigation Measures Area**



Muranaka Warehouse VMT - Riverside-South Coast County, Annual

	ROG	NOx	CO	SO2	Fugitive PM10	Exhaust PM10	PM10 Total	Fugitive PM2.5	Exhaust PM2.5	PM2.5 Total	Bio- CO2	NBio- CO2	Total CO2	CH4	N2O	CO2e
Category	tons/yr										MT/yr					
Mitigated	0.9975	4.0000e-005	4.9400e-003	0.0000		2.0000e-005	2.0000e-005		2.0000e-005	2.0000e-005	0.0000	9.6000e-003	9.6000e-003	3.0000e-005	0.0000	0.0102
Unmitigated	0.9975	4.0000e-005	4.9400e-003	0.0000		2.0000e-005	2.0000e-005		2.0000e-005	2.0000e-005	0.0000	9.6000e-003	9.6000e-003	3.0000e-005	0.0000	0.0102

6.2 Area by SubCategory

Unmitigated

	ROG	NOx	CO	SO2	Fugitive PM10	Exhaust PM10	PM10 Total	Fugitive PM2.5	Exhaust PM2.5	PM2.5 Total	Bio- CO2	NBio- CO2	Total CO2	CH4	N2O	CO2e
SubCategory	tons/yr										MT/yr					
Architectural Coating	0.1142					0.0000	0.0000		0.0000	0.0000	0.0000	0.0000	0.0000	0.0000	0.0000	0.0000
Consumer Products	0.8829					0.0000	0.0000		0.0000	0.0000	0.0000	0.0000	0.0000	0.0000	0.0000	0.0000
Landscaping	4.6000e-004	4.0000e-005	4.9400e-003	0.0000		2.0000e-005	2.0000e-005		2.0000e-005	2.0000e-005	0.0000	9.6000e-003	9.6000e-003	3.0000e-005	0.0000	0.0102
<b>Total</b>	<b>0.9976</b>	<b>4.0000e-005</b>	<b>4.9400e-003</b>	<b>0.0000</b>		<b>2.0000e-005</b>	<b>2.0000e-005</b>		<b>2.0000e-005</b>	<b>2.0000e-005</b>	<b>0.0000</b>	<b>9.6000e-003</b>	<b>9.6000e-003</b>	<b>3.0000e-005</b>	<b>0.0000</b>	<b>0.0102</b>

Muranaka Warehouse VMT - Riverside-South Coast County, Annual

**6.2 Area by SubCategory**

**Mitigated**

	ROG	NOx	CO	SO2	Fugitive PM10	Exhaust PM10	PM10 Total	Fugitive PM2.5	Exhaust PM2.5	PM2.5 Total	Bio- CO2	NBio- CO2	Total CO2	CH4	N2O	CO2e
SubCategory	tons/yr										MT/yr					
Architectural Coating	0.1142					0.0000	0.0000		0.0000	0.0000	0.0000	0.0000	0.0000	0.0000	0.0000	0.0000
Consumer Products	0.8829					0.0000	0.0000		0.0000	0.0000	0.0000	0.0000	0.0000	0.0000	0.0000	0.0000
Landscaping	4.6000e-004	4.0000e-005	4.9400e-003	0.0000		2.0000e-005	2.0000e-005		2.0000e-005	2.0000e-005	0.0000	9.6000e-003	9.6000e-003	3.0000e-005	0.0000	0.0102
<b>Total</b>	<b>0.9976</b>	<b>4.0000e-005</b>	<b>4.9400e-003</b>	<b>0.0000</b>		<b>2.0000e-005</b>	<b>2.0000e-005</b>		<b>2.0000e-005</b>	<b>2.0000e-005</b>	<b>0.0000</b>	<b>9.6000e-003</b>	<b>9.6000e-003</b>	<b>3.0000e-005</b>	<b>0.0000</b>	<b>0.0102</b>

**7.0 Water Detail**

---

**7.1 Mitigation Measures Water**

Muranaka Warehouse VMT - Riverside-South Coast County, Annual

	Total CO2	CH4	N2O	CO2e
Category	MT/yr			
Mitigated	199.0416	1.8227	0.0449	257.9744
Unmitigated	199.0416	1.8227	0.0449	257.9744

**7.2 Water by Land Use**

**Unmitigated**

	Indoor/Outdoor Use	Total CO2	CH4	N2O	CO2e
Land Use	Mgal	MT/yr			
City Park	0 / 2.38296	6.3955	3.5000e-004	7.0000e-005	6.4257
Other Asphalt Surfaces	0 / 0	0.0000	0.0000	0.0000	0.0000
Parking Lot	0 / 0	0.0000	0.0000	0.0000	0.0000
Unrefrigerated Warehouse-No Rail	55.6341 / 0	192.6461	1.8224	0.0448	251.5487
<b>Total</b>		<b>199.0416</b>	<b>1.8227</b>	<b>0.0449</b>	<b>257.9744</b>

Muranaka Warehouse VMT - Riverside-South Coast County, Annual

**7.2 Water by Land Use**

**Mitigated**

	Indoor/Outdoor Use	Total CO2	CH4	N2O	CO2e
Land Use	Mgal	MT/yr			
City Park	0 / 2.38296	6.3955	3.5000e-004	7.0000e-005	6.4257
Other Asphalt Surfaces	0 / 0	0.0000	0.0000	0.0000	0.0000
Parking Lot	0 / 0	0.0000	0.0000	0.0000	0.0000
Unrefrigerated Warehouse-No Rail	55.6341 / 0	192.6461	1.8224	0.0448	251.5487
<b>Total</b>		<b>199.0416</b>	<b>1.8227</b>	<b>0.0449</b>	<b>257.9744</b>

**8.0 Waste Detail**

---

**8.1 Mitigation Measures Waste**

Muranaka Warehouse VMT - Riverside-South Coast County, Annual

**Category/Year**

	Total CO2	CH4	N2O	CO2e
	MT/yr			
Mitigated	45.9409	2.7150	0.0000	113.8167
Unmitigated	45.9409	2.7150	0.0000	113.8167

**8.2 Waste by Land Use**

**Unmitigated**

	Waste Disposed	Total CO2	CH4	N2O	CO2e
Land Use	tons	MT/yr			
City Park	0.17	0.0345	2.0400e-003	0.0000	0.0855
Other Asphalt Surfaces	0	0.0000	0.0000	0.0000	0.0000
Parking Lot	0	0.0000	0.0000	0.0000	0.0000
Unrefrigerated Warehouse-No Rail	226.15	45.9064	2.7130	0.0000	113.7312
<b>Total</b>		<b>45.9409</b>	<b>2.7150</b>	<b>0.0000</b>	<b>113.8167</b>

Muranaka Warehouse VMT - Riverside-South Coast County, Annual

**8.2 Waste by Land Use**

**Mitigated**

	Waste Disposed	Total CO2	CH4	N2O	CO2e
Land Use	tons	MT/yr			
City Park	0.17	0.0345	2.0400e-003	0.0000	0.0855
Other Asphalt Surfaces	0	0.0000	0.0000	0.0000	0.0000
Parking Lot	0	0.0000	0.0000	0.0000	0.0000
Unrefrigerated Warehouse-No Rail	226.15	45.9064	2.7130	0.0000	113.7312
<b>Total</b>		<b>45.9409</b>	<b>2.7150</b>	<b>0.0000</b>	<b>113.8167</b>

**9.0 Operational Offroad**

Equipment Type	Number	Hours/Day	Days/Year	Horse Power	Load Factor	Fuel Type
----------------	--------	-----------	-----------	-------------	-------------	-----------

**10.0 Stationary Equipment**

**Fire Pumps and Emergency Generators**

Equipment Type	Number	Hours/Day	Hours/Year	Horse Power	Load Factor	Fuel Type
----------------	--------	-----------	------------	-------------	-------------	-----------

**Boilers**

Equipment Type	Number	Heat Input/Day	Heat Input/Year	Boiler Rating	Fuel Type
----------------	--------	----------------	-----------------	---------------	-----------

**User Defined Equipment**

Muranaka Warehouse VMT - Riverside-South Coast County, Annual

Equipment Type	Number
----------------	--------

**11.0 Vegetation**

---