

# CITY OF VICTORVILLE VICTORVILLE CONNECTION

## GENERAL NOTES

1. ALL WORK SHALL BE DONE IN ACCORDANCE WITH THESE PLANS, SPECIAL PROVISIONS, THE CITY OF VICTORVILLE DEPARTMENT OF PUBLIC WORKS STANDARD SPECIFICATIONS FOR PUBLIC IMPROVEMENTS DATED APRIL 19, 1976, AND CALTRANS STANDARD PLANS AND SPECIFICATIONS DATED MAY, 2006.
2. THE CONTRACTOR AGREES THAT HE SHALL ASSUME SOLE AND COMPLETE RESPONSIBILITY FOR JOB SITE CONDITIONS DURING THE COURSE OF CONSTRUCTION OF THIS PROJECT, INCLUDING SAFETY OF ALL PERSONS AND PROPERTY. THAT THIS REQUIREMENT SHALL APPLY CONTINUALLY, AND NOT BE LIMITED TO NORMAL WORKING HOURS; AND THAT THE CONTRACTOR SHALL DEFEND, INDEMNIFY, AND HOLD THE CITY HARMLESS FROM ANY AND ALL LIABILITY, REAL OR ALLEGED, IN CONNECTION WITH THE PERFORMANCE OF WORK ON THIS PROJECT.
3. IT SHALL BE THE CONTRACTOR'S RESPONSIBILITY TO OBTAIN ANY PERMITS REQUIRED BY THE CITY OF VICTORVILLE ENGINEERING DEPARTMENT IN ORDER TO DO THE WORK SHOWN ON THESE PLANS.
4. IT SHALL BE THE CONTRACTOR'S RESPONSIBILITY TO PROTECT SURVEYING MONUMENTS IN PLACE, AND THE CONTRACTOR SHALL BE FINANCIALLY RESPONSIBLE FOR RESETTING DAMAGED OR DESTROYED MONUMENTS.
5. IT SHALL BE THE CONTRACTOR'S RESPONSIBILITY TO FAMILIARIZE HIMSELF/HERSELF WITH JOB SITE AND ANY UNDERGROUND UTILITIES/FACILITIES SHOWN OR NOT SHOWN ON THESE PLANS. CONTRACTOR SHALL CALL UNDERGROUND SERVICE ALERT AT 1 (800) 422-4133 TO LOCATE UNDERGROUND UTILITIES/FACILITIES AT LEAST TWO WORKING DAYS BEFORE DOING ANY EXCAVATION. ALL PIPELINES, SUBSTRUCTURES, OR UTILITIES OF ANY KIND, WHETHER SHOWN ON THESE PLANS OR NOT, SHALL BE PROTECTED IN PLACE OR, IF REQUIRED, BE REMOVED, RELOCATED, OR REINFORCED TO THE SATISFACTION OF THE CITY ENGINEER AND THE COMPANY OWNING THE FACILITY AT THE EXPENSE OF THE CONTRACTOR.
6. THE CONTRACTOR SHALL BE HELD RESPONSIBLE FOR ANY FIELD CHANGES MADE WITHOUT PRIOR WRITTEN AUTHORIZATION FROM THE CITY ENGINEER.
7. ACCESS TO ALL DRIVEWAYS SHALL BE MAINTAINED AT ALL TIMES EXCEPT WHEN PRECLUDED BY NECESSARY CONSTRUCTION FOR A REASONABLE PERIOD OF TIME AS APPROVED BY THE CITY ENGINEER.
8. THE CONTRACTOR SHALL REMOVE FROM THE VICINITY OF THE COMPLETED WORK ALL PLANTS, BUILDING RUBBISH, UNUSED MATERIALS, CONCRETE FORMS, AND EQUIPMENT BELONGING TO HIM/HER OR USED UNDER HIM/HER DIRECTION DURING CONSTRUCTION UNTIL ACCEPTANCE OF WORK BY THE CITY OF VICTORVILLE.
9. THE CONTRACTOR SHALL NOTIFY THE CITY ENGINEER OF ANY DISCREPANCIES OR UNUSUAL CONDITIONS ON THE PLANS, DETAILS OR CONSTRUCTION NOTES PRIOR TO FINALIZATION OF THE BIDS AND COMMENCEMENT OF ANY CONSTRUCTION.
10. THE CONTRACTOR SHALL GRADE, COMPACT AND MATCH ALL EXISTING DRIVEWAY/ROAD TO THE FINISHED ROAD ELEVATIONS WITHOUT IMPEDING ANY NATURAL DRAINAGE FLOW.
11. JOSHUA TREES SHALL BE PROTECTED IN PLACE OR RELOCATED AS APPROVED BY THE PARKS DIVISION OF THE CITY OF VICTORVILLE DEPARTMENT OF COMMUNITY SERVICES AT THE CONTRACTOR'S EXPENSE.
12. THE CONTRACTOR SHALL OBTAIN AN ENCROACHMENT PERMIT BEFORE ANY WORK MAY BE DONE IN OR NEAR THE STATE RIGHT-OF-WAY.

NOTE: WHERE CONTRACTOR APPEARS YOU MAY SUBSTITUTE OWNER, DEVELOPER OR ENGINEER.

### SPECIAL NOTE TO THE CONTRACTOR

THE EXISTENCE AND LOCATION OF ANY UNDERGROUND UTILITY PIPES OR STRUCTURES SHOWN ON THESE PLANS ARE OBTAINED BY A SEARCH OF ALL AVAILABLE RECORDS, TO THE BEST OF OUR KNOWLEDGE. THE CONTRACTOR IS REQUIRED TO TAKE DUE PRECAUTIONARY MEASURES TO PROTECT THE UTILITY LINES SHOWN AND ANY OTHER LINE NOT OF RECORD OR NOT SHOWN ON THESE PLANS. PRIOR TO EXCAVATION, THE CONTRACTOR SHALL CALL TOLL FREE 1-800-422-4133 TO VERIFY THE UNDERGROUND LOCATION OF ALL UTILITIES.

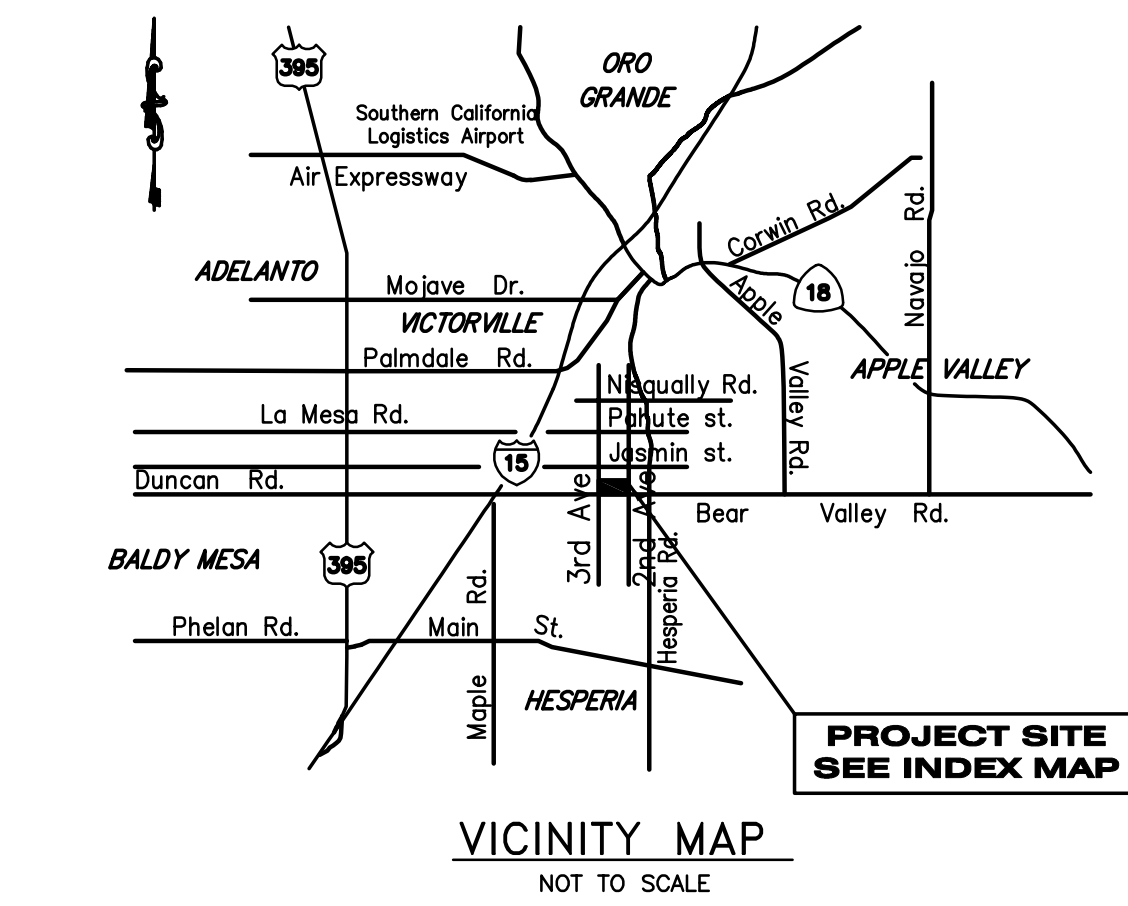
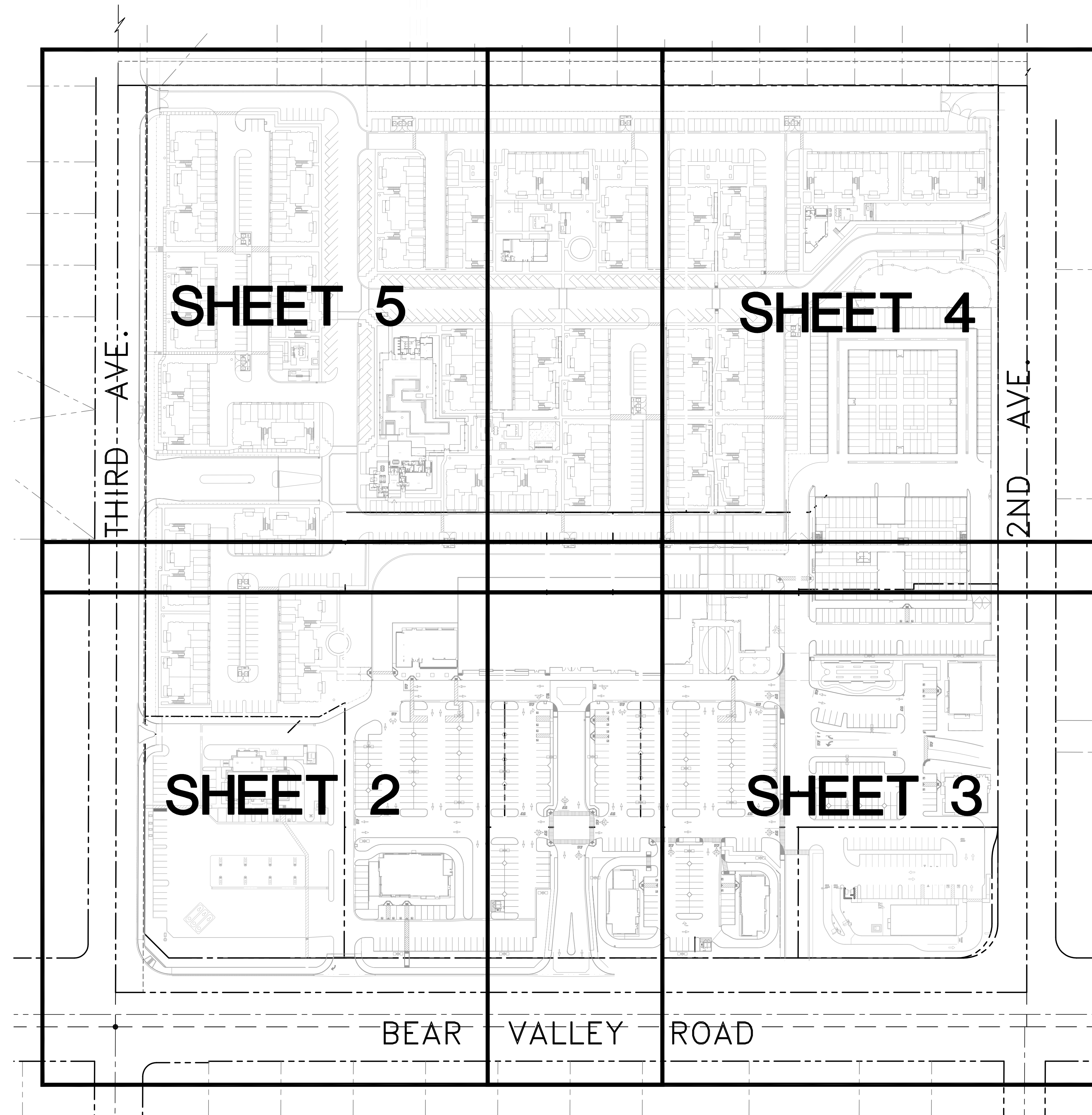

## SHEET INDEX

- 1 OF 5 - TITLE SHEET
- 2-5 OF 5 - GRADING PLAN

## CONSTRUCTION NOTES

- ① CONSTRUCT AC/4" AB PAVEMENT
- ② CONSTRUCT 6" CURB ONLY
- ③ CONSTRUCT 6" CURB AND 18" GUTTER PER CITY STD. S-01
- ④ CONSTRUCT 6" AC BERM
- ⑤ CONSTRUCT 4" THICK PCC SIDEWALK
- ⑥ CONSTRUCT CURB OPENING CATCH BASIN
- ⑦ CONSTRUCT COMMERCIAL DRIVEWAY PER CITY STD. PLAN S-03 (TYPE 3)
- ⑧ CONSTRUCT ACCESSIBLE CURB-CUT RAMP
- ⑨ CONSTRUCT 3" WIDE RIBBON GUTTER

## ABBREVIATIONS:

AC	ASPHALTIC CONCRETE	R	PROPERTY LINE
BW	BACK OF WALK	R	RIDGE LINE
CF	CURB FACE	RD	ROOF DRAIN
CL	CENTERLINE	R/W	RIGHT OF WAY
CO	CLEAN OUT	SD	STORM DRAIN
DS	DOWNSPOUT	SSMH	SEWER MANHOLE
EG	EXISTING GROUND	SS	SEWER
EX	EXISTING	TC	TOP OF CURB
FF	FINISHED FLOOR	TC	TOP OF GRATE
FG	FINISHED GRADE	TYP.	TYPICAL
FH	FIRE HYDRANT	T	TRANSFORMER
FL	FLOW LINE		
FS	FINISHED SURFACE		
GB	GRADE BREAK		
HP	HIGH POINT		
INV	INVERT OF PIPE		
LP	LOW POINT		
P.A.	PLANTER AREA		

	ACCESSIBLE PATH OF TRAVEL
	PROPERTY BOUNDARY LINE
	CENTER LINE
	1500 CONTOUR
	GRADE BREAK
	RIDGE LINE
	CURB LINE
	CURB AND GUTTER
	FLOW LINE
	SLOPE
	RATE OF GRADE

## PRELIM. EARTHWORK QUANTITIES

RAW CUT	49,330 CY
RAW FILL	36,730 CY
BLDG. OVEREX.	75,200 CY
PVMT. OVEREX.	28,000 CY
EARTH IMPORT	±1,300 CY

160 S. Old Springs Road  
Suite 210  
Anheim Hills, CA 92808  
714-665-6660

**MDRC**  
Civil Engineering/Land Surveying/Land Planning

DATE:	
NO.:	REVISION:

PROJECT: **VICTORVILLE CONNECTION  
BEAR VALLEY ROAD & 3RD AVE.  
VICTORVILLE, CA**

DRAWING NAME: **PRELIMINARY GRADING PLAN**

ISSUE: PRELIMINARY  
DATE: 05/21/21  
CHECKED: RS DRAWN: BJ  
DRAWING FILE: 20523CG  
PROJECT NO.: 20-523D  
SHEET NUMBER: **1**  
OF 5 SHEETS  
SCALE: PER PLAN

NOT FOR CONSTRUCTION

FILENAME: M:\2020\20-523 WestemCDE Victorville Bear Valley\20523CG 101.ctb; LAST SAVED ON: May 21 2021 11:38am; CDE



SEE SHEET 5

CONSTRUCTION NOTES

- 1 CONSTRUCT AC/4" AB PAVEMENT
- 2 CONSTRUCT 6" CURB ONLY
- 3 CONSTRUCT 6" CURB AND 18" GUTTER PER CITY STD. S-01
- 4 CONSTRUCT 6" AC BERM
- 5 CONSTRUCT 4" THICK PCC SIDEWALK
- 6 CONSTRUCT CURB OPENING CATCH BASIN
- 7 CONSTRUCT COMMERCIAL DRIVEWAY PER CITY STD. PLAN S-03 (TYPE 3)
- 8 CONSTRUCT ACCESSIBLE CURB-CUT RAMP
- 9 CONSTRUCT 3' WIDE RIBBON GUTTER

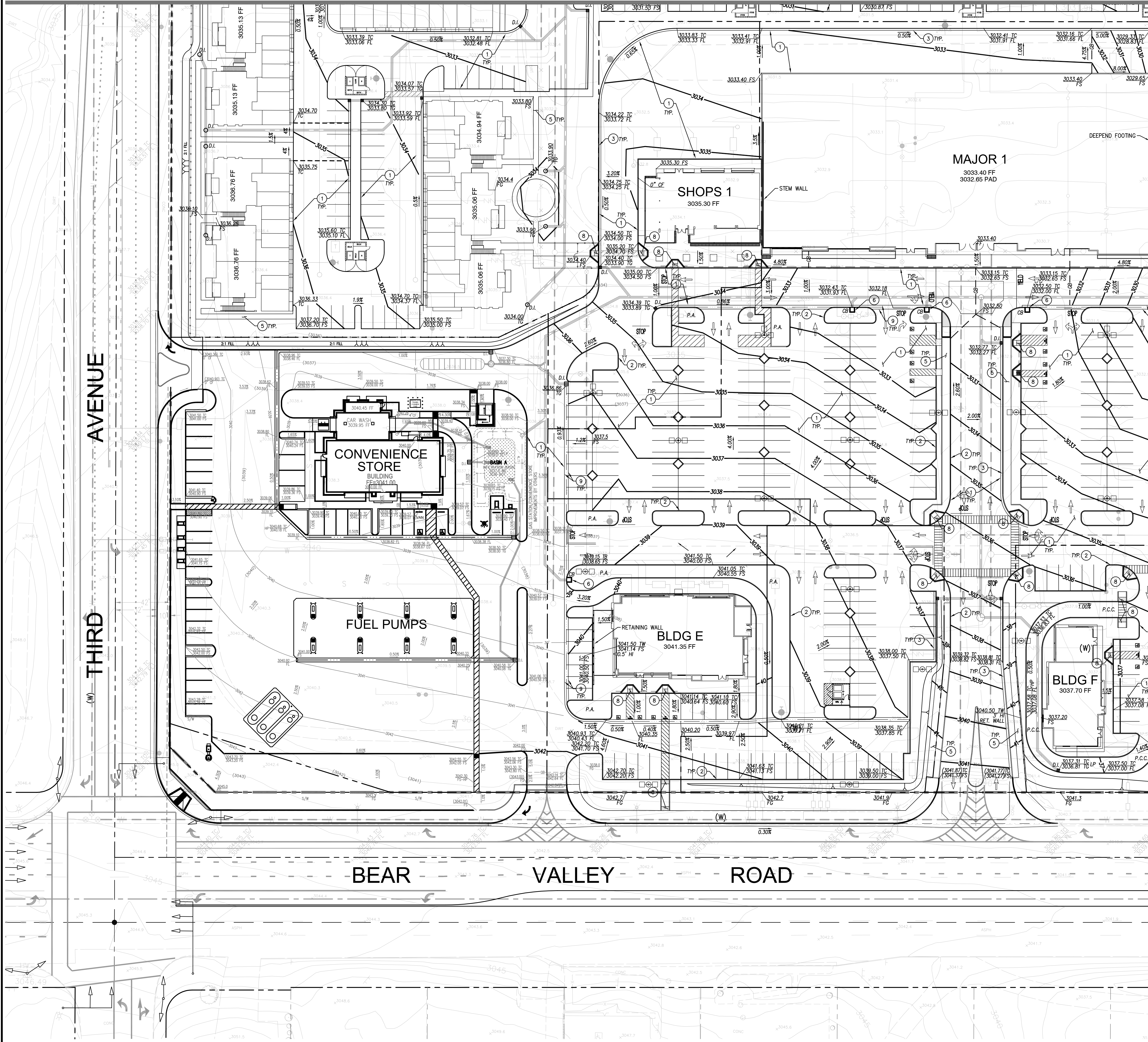

SEE SHEET 3

AVENUE

THIRD

BEAR VALLEY ROAD

MAJOR 1  
3033.40 FF  
3032.65 PAD

SHOPS 1  
3035.30 FF

CONVENIENCE STORE  
BUILDING  
3040.45 FF

FUEL PUMPS

BLDG E  
3041.35 FF

BLDG F  
3037.70 FF

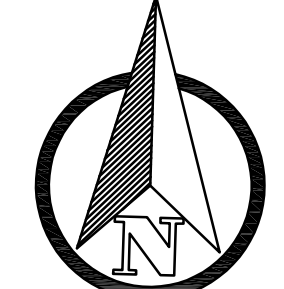

160 S. Old Springs Road  
Suite 210  
Anaheim Hills, CA 92808  
714-685-6680

**ORC** Engineering, Inc.  
Civil Engineering/Land Surveying/Land Planning

DATE:	
NO.:	
REVISION:	

PROJECT: **VICTORVILLE CONNECTION**  
**BEAR VALLEY ROAD & 3RD AVE.**  
**VICTORVILLE, CA**

DRAWING NAME: **PRELIMINARY GRADING PLAN**

ISSUE:	PRELIMINARY
DATE:	05/21/21
CHECKED:	RS
DRAWN:	BJ
DRAWING FILE:	20523CG
PROJECT NO.:	20-523D
SHEET NUMBER:	<b>2</b>
OF	5 SHEETS
SCALE:	PER PLAN

NOT FOR CONSTRUCTION



SEE SHEET 4

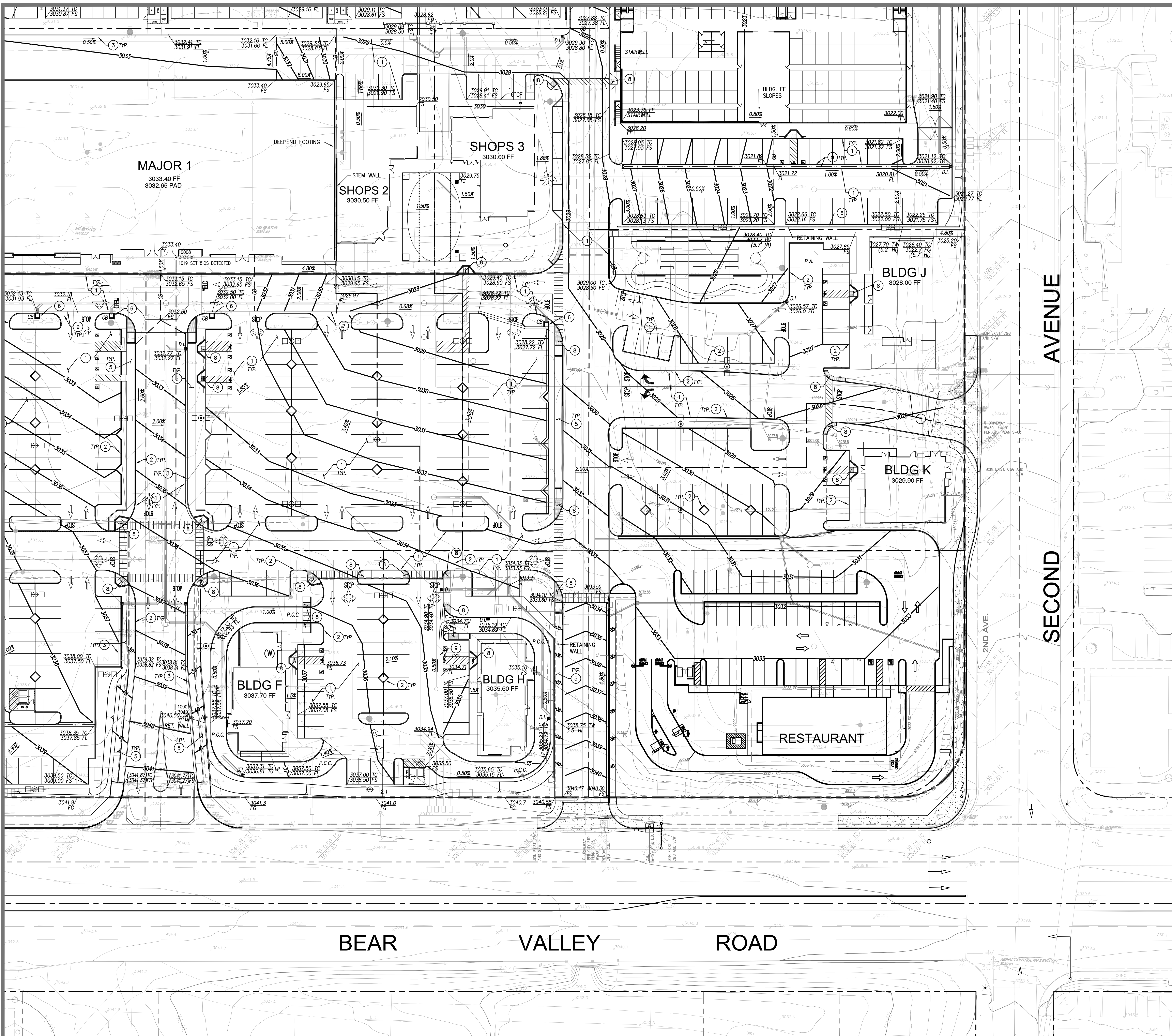

- CONSTRUCTION NOTES**
- 1 CONSTRUCT AC/4" AB PAVEMENT
  - 2 CONSTRUCT 6" CURB ONLY
  - 3 CONSTRUCT 6" CURB AND 18" GUTTER PER CITY STD. S-01
  - 4 CONSTRUCT 6" AC BERM
  - 5 CONSTRUCT 4" THICK PCC SIDEWALK
  - 6 CONSTRUCT CURB OPENING CATCH BASIN
  - 7 CONSTRUCT COMMERCIAL DRIVEWAY PER CITY STD. PLAN S-03 (TYPE 3)
  - 8 CONSTRUCT ACCESSIBLE CURB-CUT RAMP
  - 9 CONSTRUCT 3" WIDE RIBBON GUTTER

SEE SHEET 2

160 S. Old Springs Road  
 Suite 210  
 Anaheim Hills, CA 92808  
 714-665-6660

**ORC** Engineering, Inc.  
 Civil Engineering/Land Surveying/Land Planning

DATE:	
NO.:	
REVISION:	

**VICTORVILLE CONNECTION**  
**BEAR VALLEY ROAD & 3RD AVE.**  
**VICTORVILLE, CA**

**PRELIMINARY GRADING PLAN**

PROJECT: VICTORVILLE BEAR VALLEY CONNECTION  
 DRAWING NAME: PRELIMINARY GRADING PLAN  
 ISSUE: PRELIMINARY  
 DATE: 05/21/21  
 CHECKED: RS DRAWN: BJ  
 DRAWING FILE: 20523CG  
 PROJECT NO.: 20-523D  
 SHEET NUMBER:  
**3**  
 OF 5 SHEETS  
 SCALE: PER PLAN

NOT FOR CONSTRUCTION



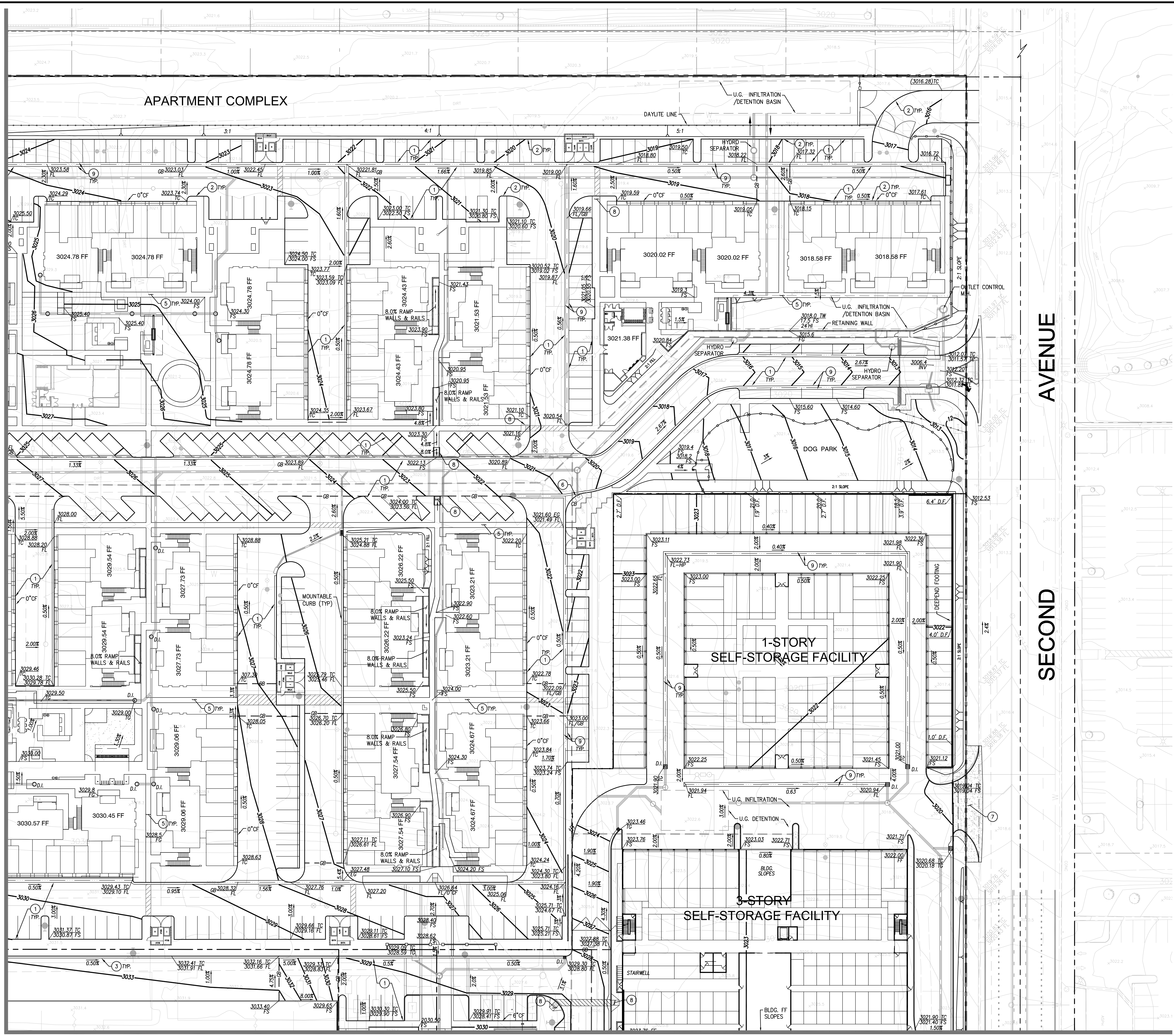

**CONSTRUCTION NOTES**

- 1 CONSTRUCT AC/4" AB PAVEMENT
- 2 CONSTRUCT 6" CURB ONLY
- 3 CONSTRUCT 6" CURB AND 18" GUTTER PER CITY STD. 5-01
- 4 CONSTRUCT 6" AC BERM
- 5 CONSTRUCT 4" THICK PCC SIDEWALK
- 6 CONSTRUCT CURB OPENING CATCH BASIN
- 7 CONSTRUCT COMMERCIAL DRIVEWAY PER CITY STD. PLAN 5-03 (TYPE 3)
- 8 CONSTRUCT ACCESSIBLE CURB-CUT RAMP
- 9 CONSTRUCT 3" WIDE RIBBON GUTTER

SEE SHEET 5

SEE SHEET 3

AVENUE  
SECOND

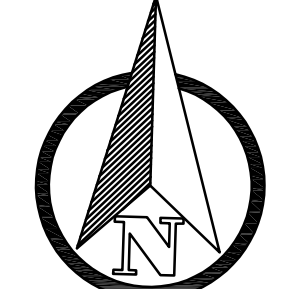

160 S. Old Springs Road  
Suite 210  
Anaheim Hills, CA 92808  
714-685-6680

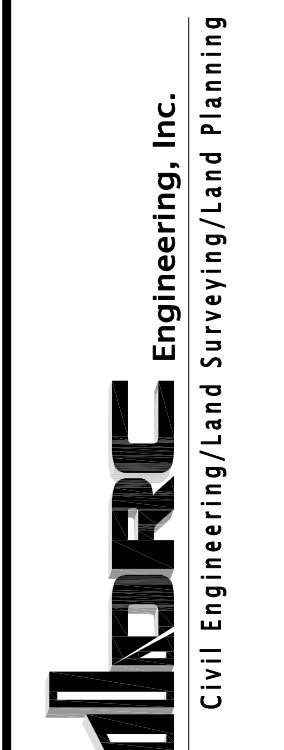

DATE:	
NO.: REVISION:	

**VICTORVILLE CONNECTION**  
**BEAR VALLEY ROAD & 3RD AVE.**  
**VICTORVILLE, CA**

**PRELIMINARY GRADING PLAN**

ISSUE:	PRELIMINARY
DATE:	05/21/21
CHECKED: RS	DRAWN: BJ
DRAWING FILE:	20523CG
PROJECT NO.:	20-523D
SHEET NUMBER:	4
OF	5 SHEETS
SCALE:	PER PLAN

NOT FOR CONSTRUCTION



