

RECEIVED WITH FEE
RECEIPT # 1774557
CEQA Transmittal # 4669

1022-63

RECEIVED
KERN COUNTY

Submitted to Department 10/4/2022 11:28:10 AM by TORRES, ALYSSA A

OCT 05 2022

Enter CEQA Information

Lead Agency: KERN COUNTY PLANNING AND NATURAL RESOURCES DEPARTMENT
BY: W. B. BEDARD, AUDITOR CONTROLLER-COUNTY CLERK DEPUTY

Project Title: PP22002- HOUSING ELEMENT IMPLEMENTATION 2022 - ZCC 123, MAP 230 (C)

Project Applicant Name: KERN COUNTY PLANNING AND NATURAL RESOURCES DEPARTMENT Phone Number: (661) 862-8629

Address: 2700 "M" STREET, SUITE #100 City: BAKERSFIELD

State: CA ZIP: 93301

Posting Period: 30 Days 45 Days Other 35

Project Applicant Type: Local Public Agency

Select Fee

- Notice of Intent
- Notice of Public Hearing
- Mitigated Negative Declaration/Negative Declaration
- Environmental Impact Report
- Other
- No Fish & Wildlife Fee
- Notice of Availability
- Notice of Preparation
- Notice of Exemption

Total: \$50.00

Proof of Payment

Please enter Proof of Payment:

Additional Information

Reference Number:

JV ACCOUNT STRING:
00001/2750/7700

Notes:

Enter JV Information (if needed)

JV Sequence Number 824950 (/journalvouchers/CreateJV.aspx?jvHeaderId=824950)

OK 10/22
10-4-22

22578

Notice of Environmental Document
Posted by County Clerk on 10-06-2022
and for 30 days thereafter, Pursuant to
Section 21152(C), Public Resources Code

Kern County
Clerks Office
1115 Truxtun Ave
Bakersfield CA 93301
661-868-3588

CEQA

County Clerk Fee
#22578

1 @ \$50.00
\$50.00

Total

\$50.00

JV #824950

\$50.00

Change

\$0.00

ORDER NO: 533192
MAIL
10/6/2022 9:54:26 AM
BAKERSFIELD
MARICELA HERNANDEZ

OCT 06 2022

MIRIAM B. BEDARD
AUDITOR CONTROLLER-COUNTY CLERK
BY M.H. DEPUTY

RECEIVED WITH FEE
RECEIPT # 15741187

**NOTICE OF EXEMPTION
(CALIFORNIA ENVIRONMENTAL QUALITY ACT OF 1970- CEQA)**

TO WHOM IT MAY CONCERN:

1. The Board of Supervisors of the County of Kern has approved the following project in the County of Kern, State of California:

- a. Applicant or sponsoring Agency or Department: Kern County Planning and Natural Resources Department (PP22002)
- b. Name of Project: Kern County Housing Element Implementation – 2022
- c. Street Address/Cross-Street of Project: Approximately 352 feet east of 20th Street West and approximately 170 feet south of Keith Lane in the unincorporated community of Rosamond (Case ID Reference No. 7)

Map of Project (if no street address): Attached
- d. Description of Project: Amendment of Zoning Map No. 230, Zone Change Case No. 123 - Zone Change to existing zone classifications to comply with the requirements of the adopted Housing Element, state law requirements and in the effort to promote various housing options for all income ranges; changes in zone classification for APN 473-031-09:

From R-2 (Medium Density Residential) to R-3 (High Density Residential) on approximately 2.50 acres.

2. Approval – Summary of Proceedings:

Adoption date September 27, 2022, Item No. 4 2:00 p.m.

3. The Board of Supervisors has determined that, under the provisions of Public Resources Code 21159.25, Public Resources Code 21083.3, Public Resources Code 21159.24, Public Resources Code 21155.1 Government Code 65457, CEQA Guidelines Section 15182, CEQA Guidelines Section 15183 and CEQA Guidelines Section 15303, the action is exempt from the requirements of CEQA and the State CEQA Guidelines concerning the evaluation of projects, further environmental review, and the preparation and review of environmental documents. Therefore, no environmental documents were required for consideration of the action taken.

Lorelei H. Oviatt, AICP, Director
Planning and Natural Resources Department
County of Kern, State of California

22578 *Lorelei Oviatt*
Notice of Environmental Document
Posted by County Clerk on 10-06-2022
and 30 days thereafter, Pursuant to
Section 21152(C), Public Resources Code



This project has been found to be categorically exempt from the requirement for preparation of environmental documents or further environmental review pursuant to Public Resources Code 21159.25, Public Resources Code 21083.3, Public Resources Code 21159.24, Public Resources Code 21155.1, Government Code 65457, CEQA Guidelines Section 115182, CEQA Guidelines Section 15183 and CEQA Guidelines Section 15303 exempt from the provisions of the California Environmental Quality Act.

CH : AT (September 30, 2022)

ZCC 123, Map No. 230

Vicinity Map

Kern County Planning and
Natural Resources

- ★ SITE
- STATE HWY
- Arterials
-  Kern County Boundary
-  Township/Range
- - - Sections
-  Unincorporated Cities

Sec 28, 9 N 12 W
APN: 473-031-09

Created on: 4/12/2022

0 2,600 5,200 7,800 10,400 Feet



Kern County
Planning & Natural
Resources Department

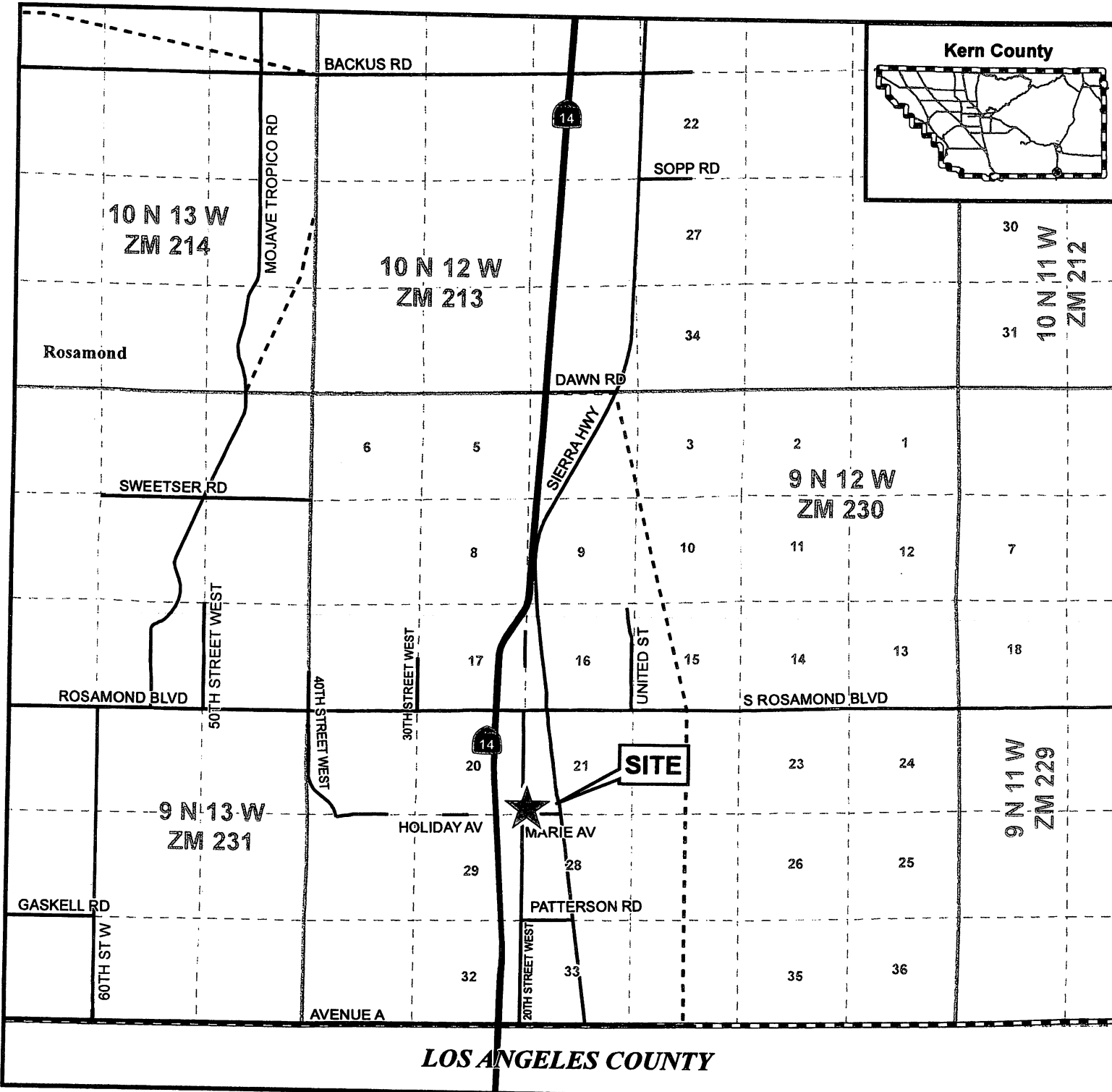
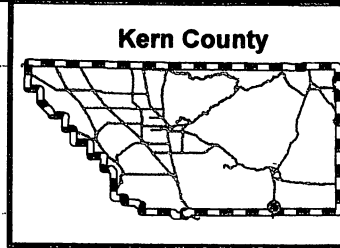



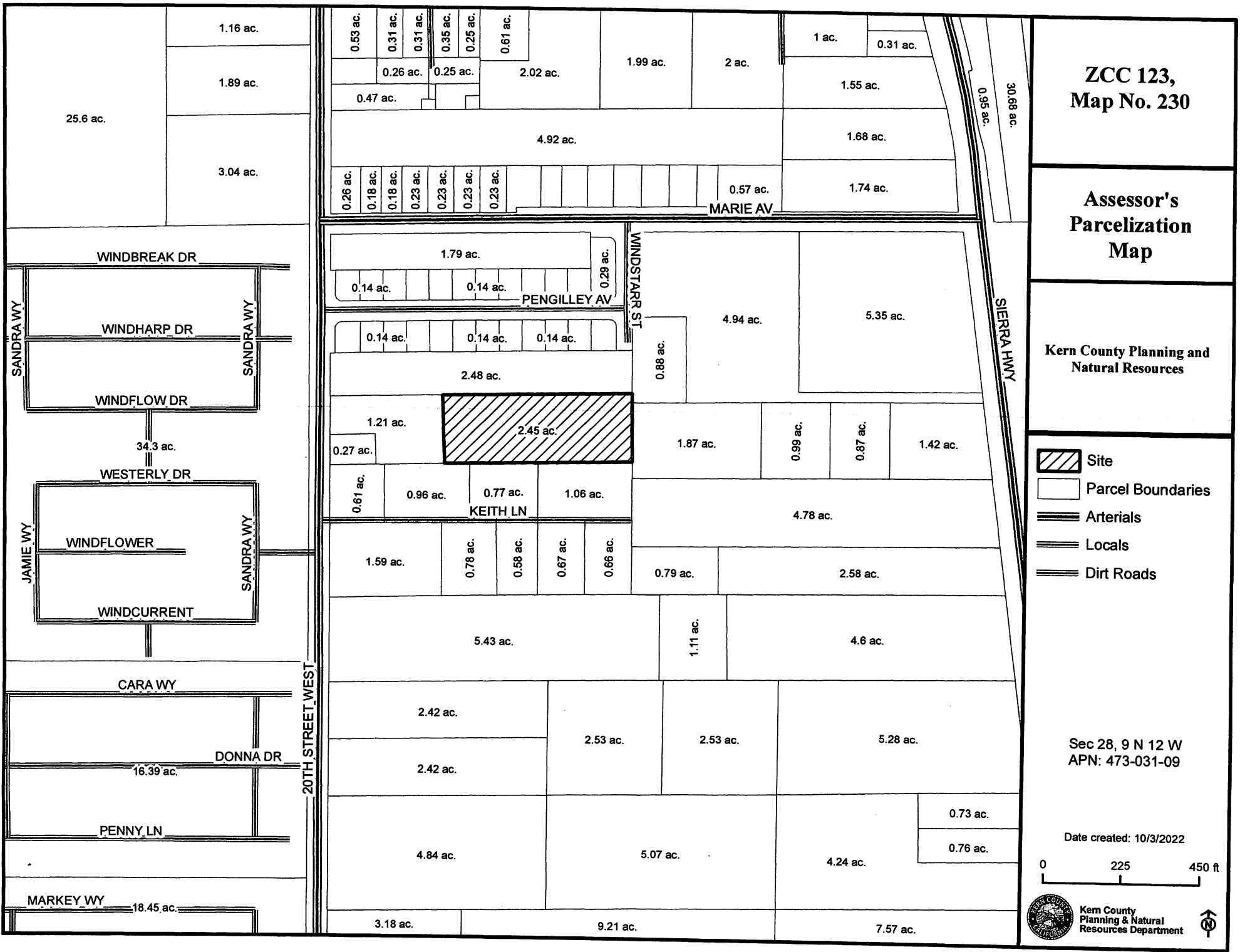

LOS ANGELES COUNTY



**ZCC 123,
Map No. 230**

**Assessor's
Parcelization
Map**

**Kern County Planning and
Natural Resources**

-  Site
-  Parcel Boundaries
-  Arterials
-  Locals
-  Dirt Roads

Sec 28, 9 N 12 W
APN: 473-031-09

Date created: 10/3/2022

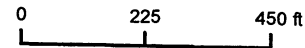

KERN COUNTY PLANNING COMMISSION

Board of Supervisors

STAFF REPORT

Date: September 27, 2022

FILE: Kern County Housing Element Implementation 2022
S.D.: All S.D.s

TITLE: Kern County Housing Element Implementation 2022: (2) ZCC 65, Map 213; (3) ZCC 20, Map 196-16; (4) ZCC 42, Map 203-21; (5) ZCC 122, Map 230; (6) ZCC 159, Map 231-13; (7) ZCC 123, Map 230; (8) ZCC 124, Map 230; (9) SPA 20; ZCC 125, Map 230; (10) ZCC 7, Map 52-02; (11) SPA 2; ZCC 8, Map 52-02; (12) SPA 1; ZCC 3, Map 52-03; (13) ZCC 25, Map 42-30; (15) GPA 6; ZCC 29, Map 124-31; (16) GPA 8; ZCC 28, Map 144; (17) GPA 24; ZCC 83, Map 124; (19) GPA 26; ZCC 85, Map 124; (20) GPA 13; ZCC 32, Map 104-30; (21) GPA 14; ZCC 33, Map 104-30; (23) GPA 7; ZCC 47, Map 103-36; (24) GPA 8; ZCC 48, Map 103-36; (25) GPA 4; ZCC 15, Map 103-33; (26) GPA 6; ZCC 32, Map 102-30; (27) GPA 4; ZCC 6, Map 143-01; (28) GPA 4; ZCC 10, Map 125-31; (29) GPA 7; ZCC 20, Map 103-07; (30) GPA 14; ZCC 40, Map 102-01; (31) GPA 8; ZCC 21, Map 103-07; (32) SPA 92; ZCC 200, Map 101; (33) SPA 93; ZCC 201, Map 101; (34) GPA 6; ZCC 27, Map 143; (35) SPA 14; ZCC 22, Map 101-26; (36) GPA 15; ZCC 41, Map 102-01; (37) GPA 2; ZCC 30, Map 103-34.

PROPOSAL: Various changes to existing land use designations to facilitate future higher density residential development as required by the adopted Kern County Housing Element. Proposed actions include amendments to existing General and Specific Plan map code designations and changes to existing zone classifications.

APPLICANT: Kern County Planning and Natural Resources Department (PP22002)

PROJECT SIZE: 447.23 acres

LOCATION: Countywide

PROJECT ANALYSIS: The project before your Board today includes a series of proposed Staff initiated changes to various land use designations on 56 parcels throughout unincorporated Kern County. The proposed project includes necessary actions that would establish land uses suitable for future high-density residential development projects. At this time, the proposed project does not include any proposed development. This proposal only includes changes in land use designations to facilitate future residential developmental ranging from apartment complexes to other owner-occupied higher density development projects.

The requested actions will implement the strategic goals of the adopted Kern County Housing Element, statewide housing inventory requirements and the Department's efforts to plan for and preserve adequate housing for all income segments based on the most recent Regional Housing Needs Allocation (RHNA).

Background

Housing Element Update 2015-2023

On April 26, 2016, your Board adopted the County of Kern Housing Element Update 2015-2023 (Resolution No. 2021-075) as a part of the Kern County General Plan and the Metropolitan Bakersfield General Plan.

The Housing Element of the General Plan has two (2) purposes:

1. To provide an assessment of both current and future housing needs, and constraints in meeting these needs; and
2. To provide a strategy that establishes housing goals, policies, and programs.

The Housing Element represents Kern County's long-term commitment to developing and improving housing with specific goals for the short-term 2015–2023 period. This element identifies strategies and programs that focus on:

1. Preserving and improving housing and neighborhoods;
2. Providing adequate housing sites;
3. Assisting in the provision of affordable housing;
4. Removing governmental and other constraints to housing investment; and
5. Promoting fair and equal housing opportunities.

According to the Regional Housing Needs Allocation (RHNA) prepared by Kern Council of Governments (Kern COG) and presented in the Housing Element (2015-2023), Kern County has a total projected need over the five-(5-)year planning cycle of 21,583 dwelling units. As part of the adopted Housing Element, the County committed to identifying an additional 33.57 acres of R-3 zoned land to meet its 4th cycle housing needs and an additional 180.57 acres of R-3 zoned land to meet its 5th cycle housing needs. Today's actions are necessary to ensure ongoing compliance with State housing laws.

The following language is directly from the California Department of Housing and Community Development website:

Since 1969, California has required that all local governments (cities and counties) adequately plan to meet the housing needs of everyone in the community. California's local governments meet this requirement by adopting housing plans as part of their "general plan" (also required by the state). General plans serve as the local government's blueprint" for how the city and/or county will grow and develop and include seven elements; land use, transportation, conservation, noise, open space, safety, and housing.

California's housing-element law acknowledges that in order for the private market to adequately address the housing needs and demand of Californians, local governments must adopt plans and regulatory systems that provided opportunities for (and do not unduly constrain), housing development. As a result, housing policy in California rests largely on the effective implementation of local general plans and, in particular, local housing elements.



State of California - Department of Fish and Wildlife
2022 ENVIRONMENTAL FILING FEE CASH RECEIPT
 DFW 753.5a (Rev. 1/01/22) Previously DFG 753.5a

RECEIPT NUMBER:
 15 — 10062022 — 15148587
 STATE CLEARINGHOUSE NUMBER (if applicable)

SEE INSTRUCTIONS ON REVERSE. TYPE OR PRINT CLEARLY.

LEAD AGENCY: KERN COUNTY PLANNING AND NATURAL RESOURCES
 COUNTY/STATE AGENCY OF FILING: Kern
 LEAD AGENCY EMAIL: _____
 DATE: 10/6/2022
 DOCUMENT NUMBER: 22578

PROJECT TITLE: PP22002- HOUSING ELEMENT IMPLEMENTATION 2022 - ZCC 123, MAP 230 (CASE REFERENCE # 7)
 PROJECT APPLICANT NAME: KERN COUNTY PLANNING AND NATURAL RESOURCES DE
 PROJECT APPLICANT ADDRESS: 2700 "M" STREET, SUITE #100
 PROJECT APPLICANT EMAIL: _____
 PHONE NUMBER: (661) 862-8629
 CITY: BAKERSFIELD STATE: CA ZIP CODE: 93301

PROJECT APPLICANT (check appropriate box)
 Local Public Agency School District Other Special District State Agency Private Entity

CHECK APPLICABLE FEES:

<input type="checkbox"/> Environmental Impact Report (EIR)	\$3,539.25	\$	0.00
<input type="checkbox"/> Mitigated/Negative Declaration (MND)(ND)	\$2,548.00	\$	0.00
<input type="checkbox"/> Certified Regulatory Program document (CRP)	\$1,203.25	\$	0.00
<input type="checkbox"/> Exempt from fee			
<input checked="" type="checkbox"/> Notice of Exemption (attach)			
<input type="checkbox"/> CDFW No Effect Determination (attach)			
<input type="checkbox"/> Fee previously paid (attach previously issued cash receipt copy)			

<input type="checkbox"/> Water Right Application or Petition Fee (State Water Resources Control Board only)	\$850.00	\$	0.00
<input checked="" type="checkbox"/> County documentary handling fee		\$	50.00
<input type="checkbox"/> Other _____		\$	

PAYMENT METHOD:
 Cash Credit Check Other TOTAL RECEIVED \$ 50.00

SIGNATURE: **X** *M.H*
 AGENCY OF FILING PRINTED NAME AND TITLE: M. HERNANDEZ, KERN COUNTY CLERK, FSS