

RECEIVED WITH FEE  
RECEIPT# **1550026**

MAR 21 2024

CEQA Transmittal #5704

AIMEE X. ESPINOZA  
AUDITOR-CONTROLLER-COUNTY CLERK  
BY **AD** DEPUTY

Submitted to Department: 3/20/2024 11:34:50 AM by TORRES, ALYSSA A

Enter CEQA Information

Lead Agency: KERN COUNTY PLANNING AND NATURAL RESOURCES DEPARTMENT

Project Title: PP22402 - MOJAVE MICRO MILL PROJECT

Project Applicant Name: PSGM3 HOLDINGS CORP (PACIFIC STEE Phone Number: (661) 862-5015

Address: 4805 MURPHY CANYON ROAD

City: SAN DIEGO

State: CA

ZIP: 92123

Posting Period:  30 Days  45 Days  Other 30

Project Applicant Type: Private Entity

Select Fee

- Notice of Intent
- Notice of Public Hearing
- Mitigated Negative Declaration/Negative Declaration
- Environmental Impact Report
- Other
- No Fish & Wildlife Fee
- Notice of Availability
- Notice of Preparation
- Notice of Exemption

Total: \$4,101.25

Proof of Payment

Please enter Proof of Payment: 465290 View Cashiering (/Cashiering/Placing%  
20Orders/OrderSummary.aspx?IsPending=false&ReceiptNo=465290)

Additional Information

Reference Number:

JV ACCT STRING:  
24010/2750/5730 \$4,051.25

Notes: 24012/2750/5730 \$50.00

Enter JV Information (if needed)

JV Sequence Number 784564 (/journalvouchers/CreateJV.aspx?jvHeaderId=784564)

*Okay / JJ 3/20/24  
hand deliver to Alyssa*

Notice of Environmental Document  
Posted by County Clerk on **03/21/2024**  
and for 30 days thereafter, Pursuant to  
Section 21152(C), Public Resources Code

**24782**

RECEIVED WITH FEE  
RECEIPT# 15150424

FILED  
KERN COUNTY

MAR 21 2024

AIMEE X. ESPINOZA  
AUDITOR CONTROLLER-COUNTY CLERK  
BY PS DEPUTY

NOTICE OF DETERMINATION  
(CALIFORNIA ENVIRONMENTAL QUALITY ACT OF 1970)

TO WHOM IT MAY CONCERN:

1. The Board of Supervisors of the County of Kern has approved the following described project in the County of Kern, State of California:

- a. Applicant, or sponsoring agency or department: PSGM3 Holdings Corp (Pacific Steel Group) (PP22402);
- b. Name of Project: (a) General Plan Amendment Case No. 3, Map 213; (b) Amendment of Zoning Map 213, Zone Change Case No. 62; (c) Conditional Use Permit Case No. 71, Map 213; (d) Conditional Use Permit Case No. 72, Map 213; (e) Precise Development Plan No. 3, Map 213; (f) Zone Variance Case No. 24, Map 213; (g) Zone Variance Case No. 25, Map 213;
- c. Street Address/Cross-Street of Project: The proposed project site is located at the southeast corner of Sierra Highway and Sopp Road in the unincorporated area of Southeastern Kern County; (APNs: 431-010-02 & 431-030-02)

Map of Project (if no street address): Attached

d. Description of Project The proposed Mojave Micro Mill Project is for the construction and operation of a micro steel mill facility and associated infrastructure necessary to produce rebar from scrap metal (e.g., shredded automobiles, appliances, structural and sheet metal, and other pre-processed steel bundles) through various recycling processes. Development would include an approximate 489,200-square-foot steel mill facility with an additional 61,721 square feet of accessory buildings and structures, for a total of 550,921 square feet, and an approximate 63-acre accessory solar array, all on 174 acres of privately owned land in unincorporated Kern County. The proposal includes:

- (a) Amendment to the Land Use, Open Space, and Conservation Element of the Kern County General Plan (GPA No. 3, Map 213) from Map Code 8.5 (Resource Management) to 7.3 (Heavy Industrial), or a more restrictive map code designation, on approximately 174 acres;
- (b) Change in zone classification (ZCC No. 62, Map 213) from A-1 (Limited Agriculture) to M-3 PD (Heavy Industrial – Precise Development Combining), or a more restrictive district, on approximately 174 acres;
- (c) Conditional Use Permit (CUP No. 71, Map 213) to allow on-site capture of carbon dioxide (CO<sub>2</sub>) and temporary storage for eventual transport for off-site distribution (Sections 19.08.085 & 19.06.920) on an approximate 174-acre project site;
- (d) Conditional Use Permit (CUP No. 72, Map 213) to allow an on-site water treatment plant (Section 19.40.030.K) on an approximate 174-acre project site;
- (e) Precise Development Plan (PD Plan No. 3, Map 213) to allow for the construction and operation of an approximate 489,200-square-foot micro steel mill facility with an additional 61,721 square feet of accessory buildings, for a total of 550,921 square

Notice of Environmental Document  
Posted by County Clerk on 03/21/2024  
and for 30 days thereafter, Pursuant to  
Section 21152(C), Public Resources Code

34782

MAR 21 2024

RECEIVED WITH FEE  
RECEIPT# 15152626

feet, served by a 63-acre solar array accessory to the proposed use, all on 17.1081 acres in the M-3 PD District (Sections 19.40.020.E.1 & 19.40.020.H); BY AMEE X. ESPINOZA AUDITOR/CONTROLLER-COUNTY CLERK DEPUTY

- (f) Zone Variance (ZV No. 24, Map 213) to allow for a reduction in the required number parking spaces from 993 spaces to 306 spaces;
  - (g) Zone Variance (ZV No. 25, No. 213) to allow for a maximum building and structure height of 165 feet where 150 feet is permitted (Sections 19.40.080.A & 19.08.160.B) in the M-3 PD (Heavy Industrial – Precise Development Combining) District
2. Approval – Summary of Proceedings:  
Adoption date March 19, 2024, Item No. 8 2:00 p.m.
  3. The Board of Supervisors of the County of Kern has determined that the project in its approved form will have a significant effect on the environment.
  4. An Environmental Impact Report (EIR) and a Mitigation Monitoring and Reporting Program were prepared pursuant to California Environmental Quality Act of 1970 (CEQA) and the State CEQA Guidelines and were received and considered by this Board and certified as required by Section 15090 the State CEQA Guidelines.
  5. Mitigation measures and a Mitigation Monitoring and Reporting Program were made as conditions of approval of the project. Findings were made pursuant to Section 15091 of the State CEQA Guidelines. A Statement of Overriding Considerations was adopted for the project, pursuant to Section 15093 of the State CEQA Guidelines.
  6. A copy of the EIR may be examined by any interested person during regular business hours at the following location: Kern County Administrative Center, 1115 Truxtun Avenue, Fifth Floor, Bakersfield, California 93301, Telephone No. 868-3585.

Lorelei H. Oviatt, AICP, Director  
Planning and Natural Resources Department  
County of Kern, State of California

*Lorelei H. Oviatt*

Telephone No. 862-8600

By: \_\_\_\_\_

MT:an

Notice of Environmental Document  
Posted by County Clerk on 03/21/2024  
and for 30 days thereafter, Pursuant to  
Section 21152(C), Public Resources Code













# Mojave Micro Mill

-by-  
PSGM3, LLC  
(Pacific Steel Group)

GPA No. 3; ZCC No. 62;  
CUP No. 71; CUP No. 72;  
PD Plan No. 3;  
ZV No. 24; ZV No. 25  
Map No. 213

## Vicinity Map

-  Site
-  NAMED ROAD
-  STATE HWY
-  Arterials
-  Kern County Boundary
-  Township/Range
-  Sections
-  Water Courses
-  City Limits
-  Unincorporated Cities

APN: 431-010-02 & 431-030-02

Sec. 27 - T10N/R12W

Created on: 9/3/2021



0 4,000 8,000 12,000 16,000 Feet



**Kern County**  
Planning & Natural  
Resources Department

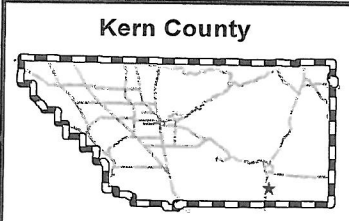
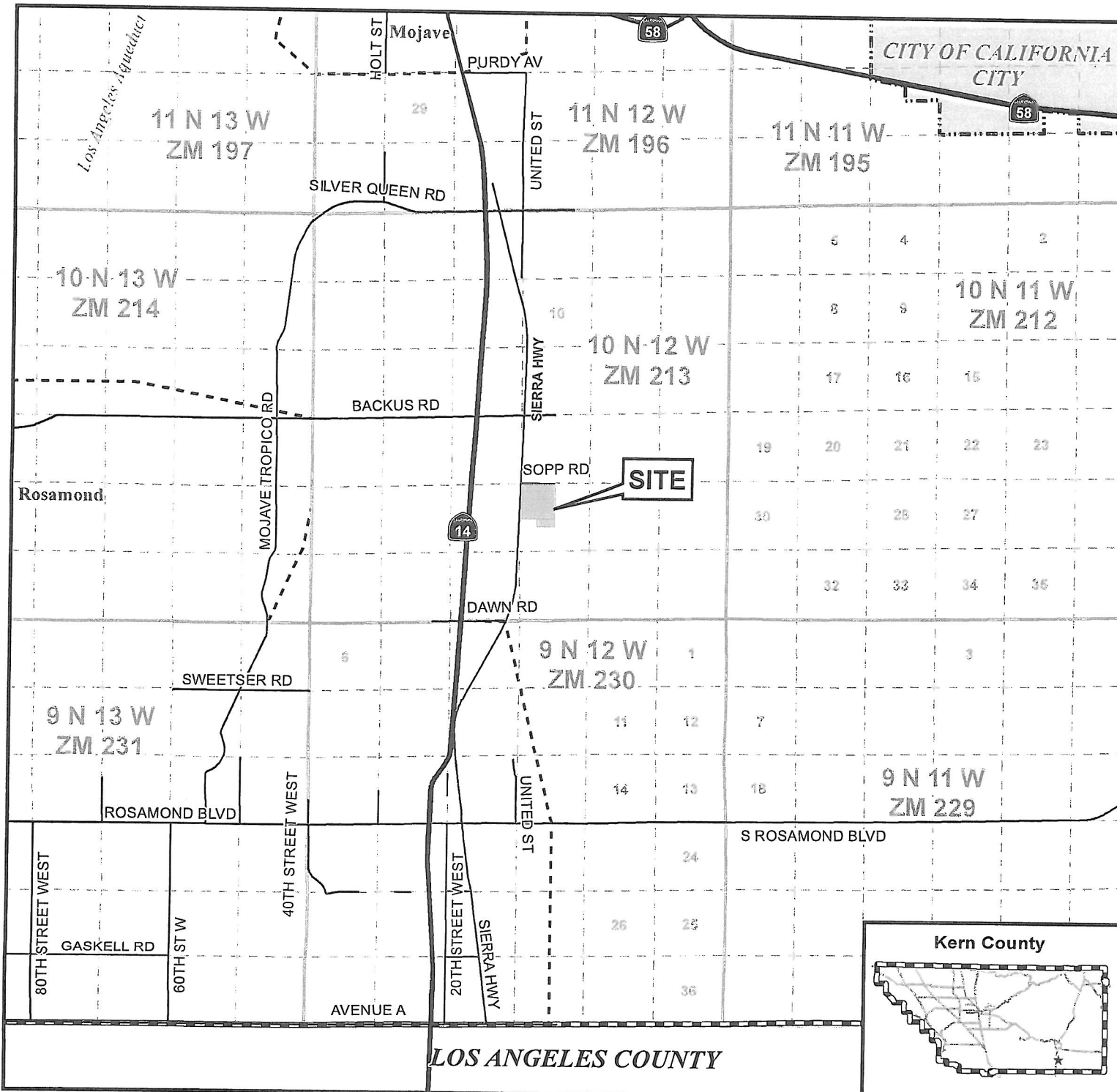

LOS ANGELES COUNTY

# Mojave Micro Mill Project

GPA No.3, Map No. 213  
ZCC No. 62, Map No. 213  
CUP No. 71, Map No. 213  
CUP No. 72, Map No. 213  
PD Plan No. 3, Map No. 213  
ZV No. 24, Map No. 213  
ZV No. 25, Map No. 213

## Proposed PD Plan – Overall PD Plan

PSGM3, LLC (Pacific Steel Group)

SHEET 3

SHEET 4

SHEET 5

SHEET 6

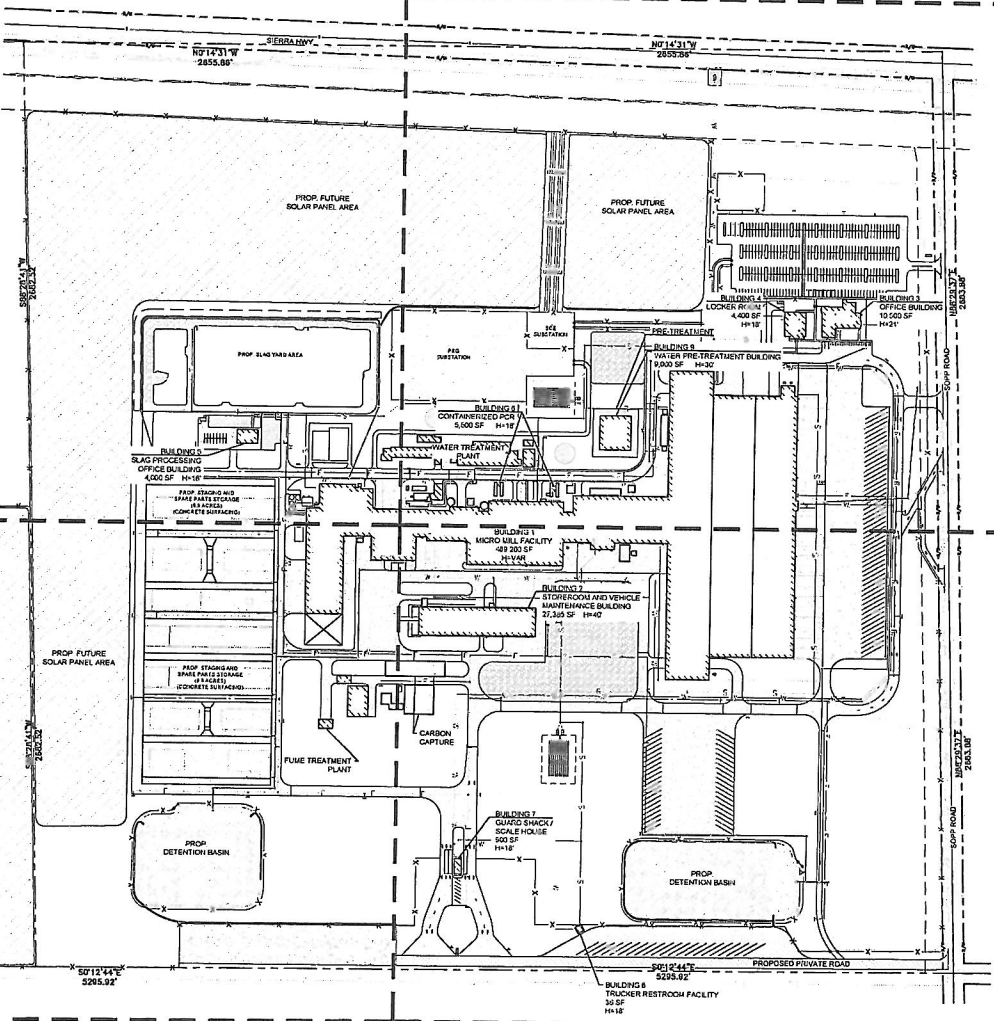

OVERALL PRELIMINARY SITE PLAN  
SCALE: 1" = 150'



APN: 431-010-02 & 431-030-02  
Sec. 27 - T10N/R12W





State of California - Department of Fish and Wildlife  
**2024 ENVIRONMENTAL DOCUMENT FILING FEE**  
**CASH RECEIPT**  
 DFW 753.5a (REV. 01/01/24) Previously DFG 753.5a

RECEIPT NUMBER:  
 15 — 03212024 — 15150626  
 STATE CLEARINGHOUSE NUMBER (If applicable)

**SEE INSTRUCTIONS ON REVERSE. TYPE OR PRINT CLEARLY.**

LEAD AGENCY KERN COUNTY PLANNING AND NATURAL RESOURCES DEPARTMENT	LEAD AGENCY EMAIL	DATE 3/21/2024
COUNTY/STATE AGENCY OF FILING Kern	DOCUMENT NUMBER 24782	

PROJECT TITLE  
**PP22402 - MOJAVE MICRO MILL PROJECT**

PROJECT APPLICANT NAME PSGM3 HOLDINGS CORP (PACIFIC STEEL GROUP)	PROJECT APPLICANT EMAIL	PHONE NUMBER (661) 862-5015
PROJECT APPLICANT ADDRESS 4805 MURPHY CANYON ROAD	CITY SAN DIEGO	STATE CA
		ZIP CODE 92123

**PROJECT APPLICANT** (Check appropriate box)

- Local Public Agency   
  School District   
  Other Special District   
  State Agency   
  Private Entity

**CHECK APPLICABLE FEES:**

- |   |            |    |                 |
|---|------------|----|-----------------|
| <input checked="" type="checkbox"/> Environmental Impact Report (EIR)                               | \$4,051.25 | \$ | <u>3,445.25</u> |
| <input type="checkbox"/> Mitigated/Negative Declaration (MND)(ND)                                   | \$2,916.75 | \$ | <u>0.00</u>     |
| <input type="checkbox"/> Certified Regulatory Program (CRP) document - payment due directly to CDFW | \$1,377.25 | \$ | <u>0.00</u>     |
| <br>  |            |    |                 |
| <input type="checkbox"/> Exempt from fee  |            |    |                 |
| <input type="checkbox"/> Notice of Exemption (attach)   |            |    |                 |
| <input type="checkbox"/> CDFW No Effect Determination (attach)                                      |            |    |                 |
| <input type="checkbox"/> Fee previously paid (attach previously issued cash receipt copy)           |            |    |                 |

- |   |          |    |                   |
|---|----------|----|-------------------|
| <input type="checkbox"/> Water Right Application or Petition Fee (State Water Resources Control Board only) | \$850.00 | \$ | <u>0.00</u>       |
| <input checked="" type="checkbox"/> County documentary handling fee   |          | \$ | <u>50.00</u>      |
| <input checked="" type="checkbox"/> Other   |          | \$ | <u>          </u> |

**PAYMENT METHOD:**

- Cash   
  Credit   
  Check   
  Other   
 TOTAL RECEIVED   
 \$ 4,101.25

SIGNATURE <b>X</b>	AGENCY OF FILING PRINTED NAME AND TITLE P. DEL VILLAR, KERN COUNTY CLERK, FST
-----------------------	--