

RECEIVED WITH CEQA Transmittal
RECEIPT # 15150627

FILED
KERN COUNTY

CEQA Transmittal #5705

MAR 21 2024

Submitted to Department: 3/20/2024 11:36:32 AM by TORRES, ALYSSA A

AIMEE X. ESPINOZA
AUDITOR CONTROLLER-COUNTY CLERK
BY *[Signature]* DEPUTY

Enter CEQA Information

Lead Agency: KERN COUNTY PLANNING AND NATURAL RESOURCES DEPARTMENT

Project Title: PP22404- BULLHEAD SOLAR PROJECT BY EDF RENEWABLES, LLC

Project Applicant Name: EDF RENEWABLES, LLC - SCOTT KULKE Phone Number: (661) 862-8793

Address: 1999 HARRISON STREET, SUITE 675 City: OAKLAND

State: CA ZIP: 94612

Posting Period: 30 Days 45 Days Other 30

Project Applicant Type: Private Entity

Select Fee

- Notice of Intent
- Notice of Public Hearing
- Mitigated Negative Declaration/Negative Declaration
- Environmental Impact Report
- Other
- No Fish & Wildlife Fee
- Notice of Availability
- Notice of Preparation
- Notice of Exemption

Total: \$4,101.25

Proof of Payment

Please enter Proof of Payment: 478905 View Cashiering (/Cashiering/Placing%
20Orders/OrderSummary.aspx?IsPending=false&ReceiptNo=478905)

Additional Information

Reference Number:
JV ACCT STRING:
24010/2750/5730 \$4,051.25
Notes: 24012/2750/5730 \$50.00

Enter JV Information (if needed)

JV Sequence Number 792096 (/journalvouchers/CreateJV.aspx?jvHeaderId=792096)

OKAY/JS 3/20/24
hand deliver to Alyssa

24783

Notice of Environmental Document
Posted by County Clerk on 03/21/2024
and for 30 days thereafter, Pursuant to
Section 21152(C), Public Resources Code

RECEIVED WITH FEE
RECEIPT # 15150621

FILED
KERN COUNTY

NOTICE OF DETERMINATION
(CALIFORNIA ENVIRONMENTAL QUALITY ACT OF 1970)

MAR 21 2024

AIMEE X. ESPINOZA
AUDITOR CONTROLLER-COUNTY CLERK
BY Aimee X. Espinoza DEPUTY

TO WHOM IT MAY CONCERN:

1. The Board of Supervisors of the County of Kern has approved the following described project in the County of Kern, State of California:
 - a. Applicant, or sponsoring agency or department: EDF Renewables, LLC (PP22404);
 - b. Name of Project: (a) General Plan Amendment Case No. 8, Map 214; (b) Conditional Use Permit Case No. 48, Map 214; (c) Conditional Use Permit Case No. 49, Map 214; (d) Agricultural Preserve Exclusion, Map 214; (e) Specific Plan Amendment No. 42, Map 231; (f) Specific Plan Amendment No. 43, Map 231; (g) Zone Change No. 158, Map 231; (h) Conditional Use Permit Case No. 121, Map 231; (i) Conditional Use Permit Case No. 122, Map 231; (j) Streets and Highways - Nonsummary Vacations - Map 231; (k) Specific Plan Amendment No. 35, Map 232; (l) Specific Plan Amendment No. 36, Map 232; (m) Zone Change No. 36, Map 232; (n) Conditional Use Permit Case No. 49, Map 232; (o) Conditional Use Permit Case No. 50, Map 232;
 - c. Street Address/Cross-Street of Project: Generally located at 100th Street West and Dawn Road, extending east, past Tehachapi Willow Springs Road in unincorporated Willow Springs/Rosamond area

Map of Project (if no street address): Attached
 - d. Description of Project The proposed Bullhead Solar Project involves the construction and operation of a photovoltaic solar facility and associated infrastructure necessary to generate up to 270 megawatts (MW) of renewable electrical energy with a battery energy storage system capable of storing approximately 270 MW, or 1,080 megawatt-hours (MWh) of energy, on approximately 1,343 acres of privately owned land near the existing Big Beau Solar Project. The proposal includes:

(a) Amendments to the Willow Springs Specific Plan Land Use Element:

From Map Codes 5.3/4.4 (Maximum 10 Units per Net Acre/Comprehensive Planning Area) to Map Code 5.3 (Maximum 10 Units per Net Acre) on approximately 288 acres, and from Map Code 6.2/4.4 (General Commercial/Comprehensive Planning area) to Map Code 6.2 (General Commercial) on approximately 15 acres (SPA No. 43, Map 231); From Map Code 5.3/4.4 (Maximum 10 Units per Net Acre/Comprehensive Planning Area) to Map Code 5.3 (Maximum 10 Units per Net Acre) on approximately 160 acres (SPA No. 35, Map 232);

(b) Changes in Zone Classification:

From E(5) RS MH FPS (Estate, 5 acres - Residential Suburban - Mobilehome Combining - Floodplain Secondary Combining) on approximately 115 acres and from E (2 1/2) RS MH FPS (Estate 2 1/2 acres - Residential Suburban - Mobilehome Combining - Floodplain Secondary Combining) on approximately 215.7 acres to A FPS (Exclusive Agricultural - Floodplain Secondary Combining), or a more restrictive district (ZCC No. 158, Map 231); From E(5) RS MH FPS (Estate, 5 acres - Residential

Notice of Environmental Document
Posted by County Clerk on 03/21/2024
and for 30 days thereafter, Pursuant to
Section 21152(C), Public Resources Code

24783

RECEIVED WITH FEE
PROJECT # 15150027

Suburban - Mobilehome Combining - Floodplain Secondary Combining) on approximately 8.4 acres and from E (2 1/2) RS FPS (Estate 2 1/2 acres – Residential Suburban - Mobilehome Combining – Floodplain Secondary Combining) on approximately 161.9 acres to A FPS (Exclusive Agricultural – Floodplain Secondary) district, or a more restrictive district (ZCC No. 36, Map 232);

- (c) Conditional Use Permits to allow for the construction and operation of a combined approximate 270 MW solar facility, as well as related ancillary structures including an approximate 270 MW battery energy storage system with up to 1,080 MWh of storage capacity (Section 19.12.030.F), on approximately 1,343 acres within the A (Exclusive Agriculture) zone district;

FILED
KERN COUNTY

Conditional Use Permit No. 48, Map 214 for approximately 842 acres; Conditional Use Permit No. 121, Map 231 for approximately 331 acres; Conditional Use Permit No. 50, Map 232 for approximately 160 acres;

AIMEE X. ESPINOZA
AUDITOR CONTROLLER-COUNTY CLERK
BY [Signature] DEPUTY

- (d) Conditional Use Permits to allow for the installation of a telecommunication tower (Section 19.12.030.F) in the A (Exclusive Agriculture) zone district:

Conditional Use Permit No. 49, Map 214; Conditional Use Permit No. 122, Map 231; Conditional Use Permit No. 49, Map 232;

- (e) Amendment to the Kern County General Plan Circulation Element to eliminate future road reservations along Section and Midsection lines in Sections 31, 32, and 33 of Township 10 North, Range 13 West (GPA No. 8, Map 214);

- (f) Amendments to the Willow Springs Specific Plan Circulation Element to eliminate future road reservations:

Along Section and midsection lines in Section 6 of Township 9 North, Range 13 West (SPA No. 42, Map 231); Along section and midsection lines in Section 1 of Township 9 North, Range 14 West (SPA No. 36, Map 232)

- (g) Petition for exclusion from the boundaries of Agricultural Preserve, Map 214 for approximately 842 acres;

- (h) A Nonsummary Vacation of: (a) A 30-foot-wide public access easement along Dawn Road from the westerly boundary of Parcel 1 of Parcel Map 6634 to the centerline intersection of Tehachapi-Willow Springs Road being approximately 3,935.61 feet in length as shown in Book 5517, Page 2343 and in Book 5233, Page 443 of Official Records; and (b) A 60-foot-wide public access easement along Patrick Place from the northerly boundary of Parcel 4 of Parcel Map 6634 to the centerline intersection of Dawn Road being approximately 1,038.65 feet in length as shown in Book 5517, Page 2343, of Official Records

2. Approval – Summary of Proceedings:

Adoption date March 19, 2024, Item No. CA 6 2:00 p.m.

3. The Board of Supervisors of the County of Kern has determined that the project in its approved form will have a significant effect on the environment.

24783

Notice of Environmental Document
Posted by County Clerk on 03/21/2024
and for 30 days thereafter, Pursuant to
Section 21152(C), Public Resources Code

RECEIVED WITH FEE
RECEIPT # 15150427

4. An Environmental Impact Report (EIR) and a Mitigation Monitoring and Reporting Program were prepared pursuant to California Environmental Quality Act of 1970 (CEQA) and the State CEQA Guidelines and were received and considered by this Board and certified as required by Section 15090 the State CEQA Guidelines.
5. Mitigation measures and a Mitigation Monitoring and Reporting Program were made as conditions of approval of the project. Findings were made pursuant to Section 15091 of the State CEQA Guidelines. A Statement of Overriding Considerations was adopted for the project, pursuant to Section 15093 of the State CEQA Guidelines.
6. A copy of the EIR may be examined by any interested person during regular business hours at the following location: Kern County Administrative Center, 1115 Truxtun Avenue, Fifth Floor, Bakersfield, California 93301, Telephone No. 868-3585.

Lorelei H. Oviatt, AICP, Director
Planning and Natural Resources Department
County of Kern, State of California

Lorelei H. Oviatt

Telephone No. 862-8600

By:

JM:an

**FILED
KERN COUNTY**

MAR 21 2024

**AIMEE X. ESPINOZA
AUDITOR CONTROLLER-COUNTY CLERK
BY *Aimee X. Espinoza* DEPUTY**

Notice of Environmental Document
Posted by County Clerk on 03/21/2024
and for 30 days thereafter, Pursuant to
Section 21152(C), Public Resources Code

24783

Bullhead Solar Project

Local Vicinity Map

EDF Renewables

-  Bullhead Solar Project
-  Big Beau Solar Project
-  Arterials
-  Collectors
-  Locals
-  Dirt Roads
-  Kern County Boundary
-  Township/Range
-  Sections
-  Water Courses
-  Unincorporated Cities

T10N/R13W - Sec. 31-33
 T9N/R14W - Sec. 1
 T9N/R13W - Sec. 5 & 6

Created on: 11/2/2022



0 0.3 0.6 0.9 1.2 Miles



Kern County
 Planning & Natural
 Resources Department

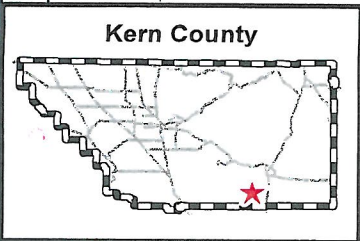
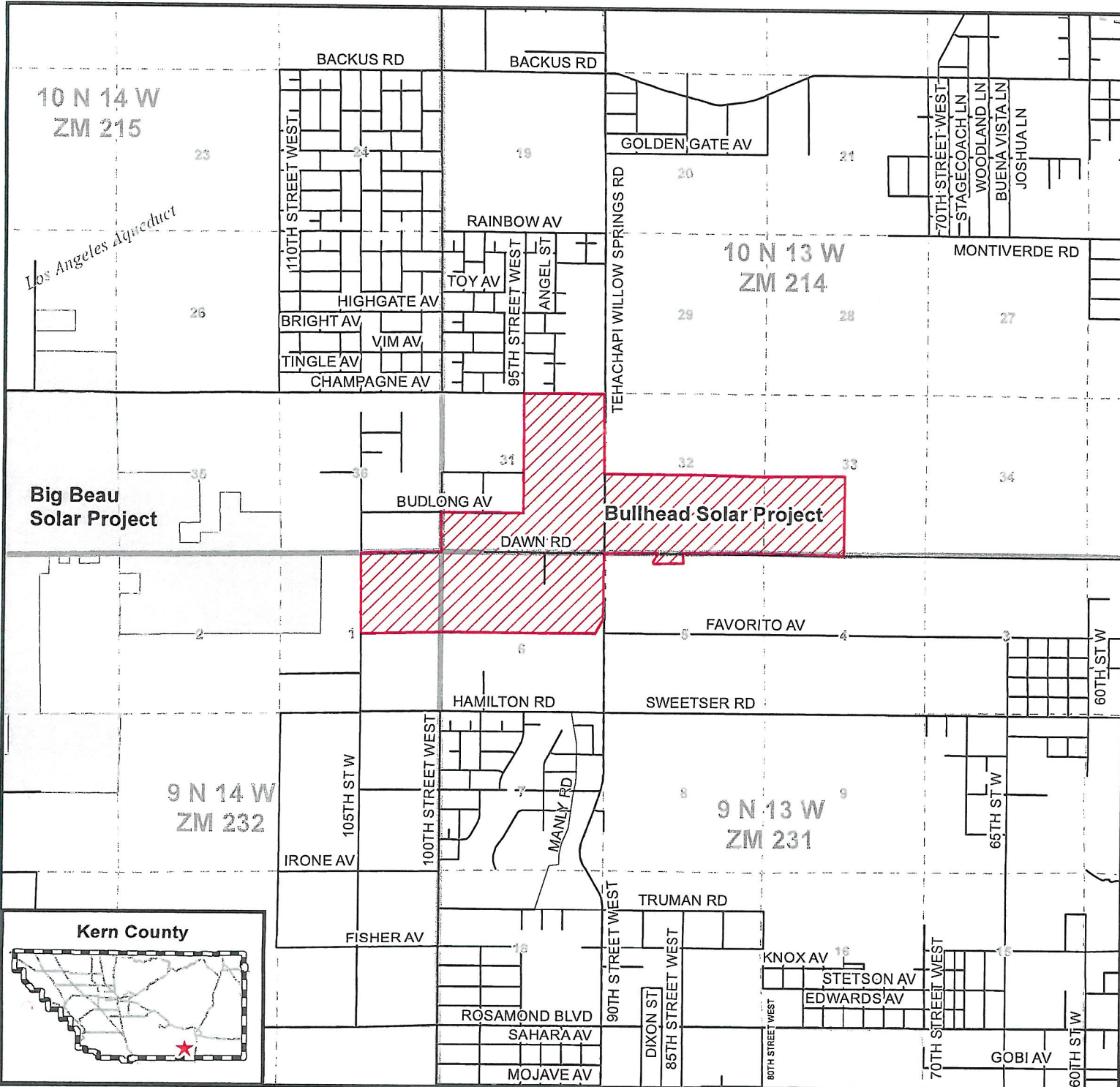

Los Angeles Aqueduct

LEGAL DESCRIPTION OF CUP BOUNDARY
SAN BERNARDINO MERIDIAN, STATE OF CALIFORNIA

ZONING MAP 214
T.10N., R.12W.,
1. SEC. 31, S1/2 OF LOTS 1 & 2 IN SW ¼, E1
2. SEC. 32, S1/2 (EXCEPT 450 WIDE CITY OF LOS ANGELES STRIP)
3. SEC. 33, SW¼

ZONING MAP 231
T.9N., R.13W.,
1. SEC. 5, N1/2 N1/2 W 30 acres N1/2 E 110 acres W 210 acres N1/2 (EXCEPT 450 WIDE CITY OF LOS ANGELES STRIP)
2. SEC. 4, N1/2 (EXCEPT 450 WIDE CITY OF LOS ANGELES STRIP)

ZONING MAP 232
T.9N., R.14W.,
1. NE¼

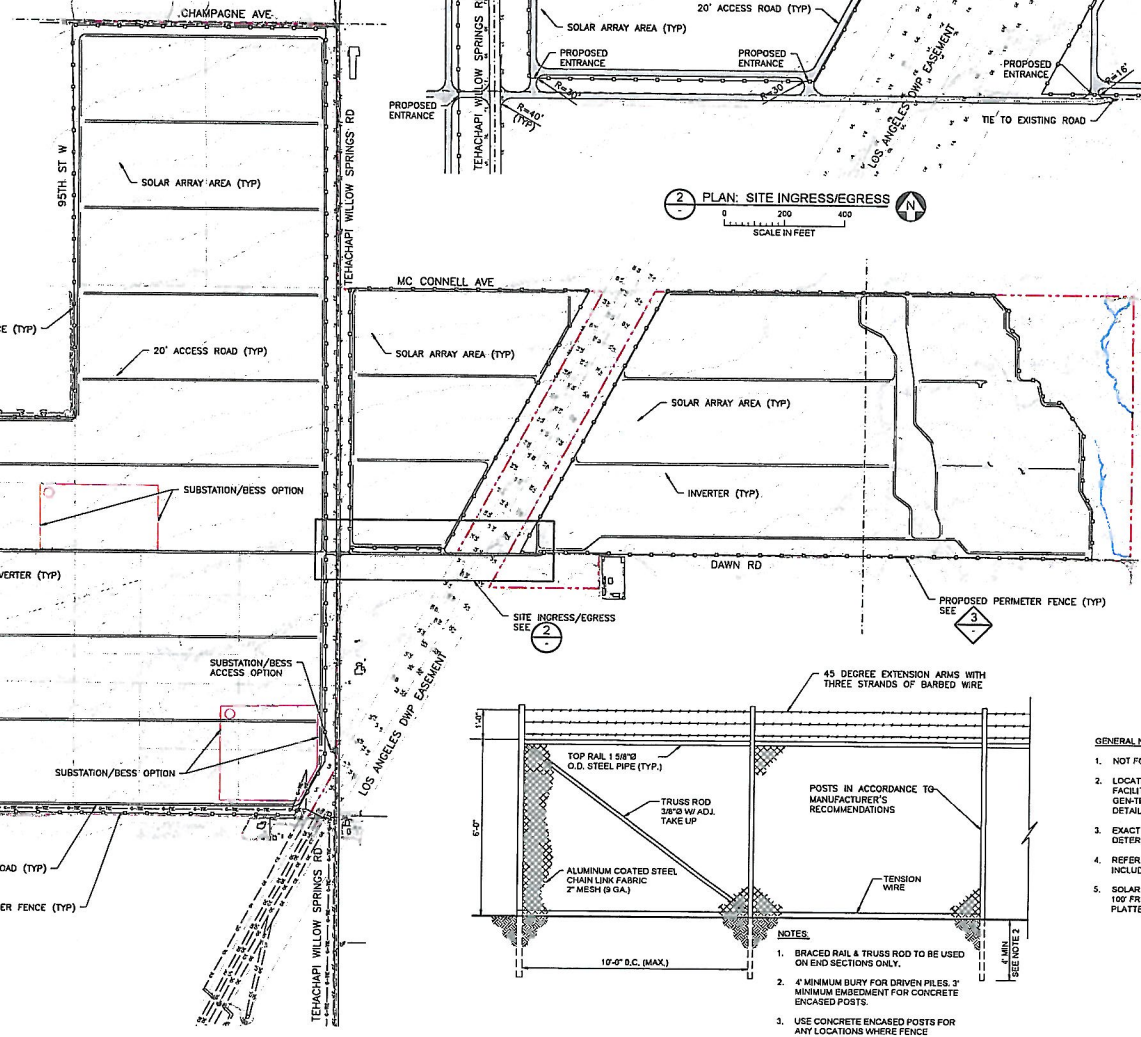

- LEGEND**
- EXISTING 25' CONTOUR
 - EXISTING 5' CONTOUR
 - SECTION LINES
 - PARCEL BOUNDARY
 - EXISTING UNPAVED ROAD
 - EXISTING PAVED ROAD
 - JURISDICTIONAL STREAM
 - EXISTING OVERHEAD POWER
 - PROJECT BOUNDARY
 - PROPOSED SOLAR ARRAY
 - PROPOSED ACCESS ROAD
 - PROPOSED PERIMETER FENCE
 - GEN-TIE OPTION
 - LAYDOWN YARD OPTION
 - SUBSTATION/BESS OPTION
 - WATER TANK OPTION

2 PLAN: SITE INGRESS/EGRESS
SCALE IN FEET

1 PLAN: PROPOSED SITE PLAN
SCALE IN FEET

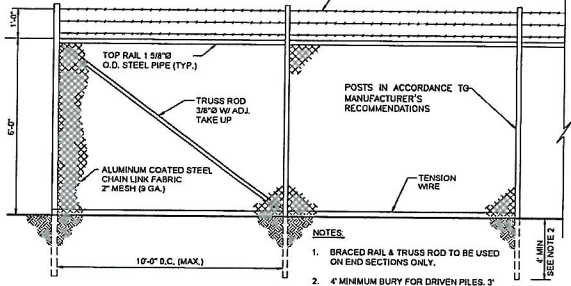

3 DETAIL: PERIMETER FENCE (TYP.)
NOT TO SCALE

GENERAL NOTES:

1. NOT FOR CONSTRUCTION
2. LOCATION OF SOLAR PANEL ARRAY, SUBSTATION, O&M FACILITY, LAYDOWN YARD, SUBSTATION, MET STATION, GEN-TIE AND ENTRANCES SUBJECT TO CHANGE DURING DETAIL DESIGN.
3. EXACT FENCE AND INTERIOR ROAD ALIGNMENT TO BE DETERMINED DURING DETAIL DESIGN
4. REFER TO THE ALTAIRNSPS SURVEY FOR LEGAL DESCRIPTION INCLUDING ALL EXCEPTIONS AND EASEMENTS
5. SOLAR ARRAYS WITHIN THE CUP BOUNDARY ARE SETBACK 100' FROM NEIGHBORING PARCELS & WITH ESTATE (E) OR PLATTED LANDS (PL) ZONING DESIGNATIONS.

- NOTES:**
1. BRACED RAIL & TRUSS ROD TO BE USED ON END SECTIONS ONLY.
 2. MINIMUM BURY FOR DRIVEN PILES, 2' MINIMUM EMBEDMENT FOR CONCRETE ENCASED POSTS.
 3. USE CONCRETE ENCASED POSTS FOR ANY LOCATIONS WHERE FENCE CHANGES DIRECTION.

**FOR REVIEW
NOT FOR CONSTRUCTION**
10/27/2022

NO.	BY	CHK	APP.	DATE	REVISION DESCRIPTION

REVIEW	05/14/22	05/14/22	05/16/22	05/16/22	05/16/22
DESIGN					
CONSTRUCTION					
RELEASED TO/FOR	A	B	C	D	E
DATE RELEASED					

BARR
BARR ENGINEERING CO.
4300 MARKEITPOINTE DRIVE
SUITE 200
MINNEAPOLIS, MN 55435
PH: 1-800-435-3377
FAX: (612) 435-3051
WWW.BARR.COM

edf
renewables

BULLHEAD SOLAR
KERN COUNTY, CALIFORNIA

BARR PROJECT No. 05/15-1075.00
CLIENT PROJECT No. -
PROPOSED SITE PLAN

DWG. No. FIG-01 REV. No. E



State of California - Department of Fish and Wildlife
2024 ENVIRONMENTAL DOCUMENT FILING FEE
CASH RECEIPT
 DFW 753.5a (REV. 01/01/24) Previously DFG 753.5a

RECEIPT NUMBER:
 15 — 03212024 — 15150627
 STATE CLEARINGHOUSE NUMBER (If applicable)

SEE INSTRUCTIONS ON REVERSE. TYPE OR PRINT CLEARLY.

LEAD AGENCY KERN COUNTY PLANNING AND NATURAL RESOURCES DEPARTMENT	LEAD AGENCY EMAIL	DATE 3/21/2024
COUNTY/STATE AGENCY OF FILING Kern	DOCUMENT NUMBER 24783	

PROJECT TITLE
 PP22404- BULLHEAD SOLAR PROJECT BY EDF RENEWABLES, LLC

PROJECT APPLICANT NAME EDF RENEWABLES, LLC - SCOTT KULKE	PROJECT APPLICANT EMAIL	PHONE NUMBER (661) 862-8793
PROJECT APPLICANT ADDRESS 1999 HARRISON STREET, SUITE 675	CITY OAKLAND	STATE CA
		ZIP CODE 94612

PROJECT APPLICANT (Check appropriate box)

Local Public Agency
 School District
 Other Special District
 State Agency
 Private Entity

CHECK APPLICABLE FEES:

<input checked="" type="checkbox"/> Environmental Impact Report (EIR)	\$4,051.25	\$	3,445.25
<input type="checkbox"/> Mitigated/Negative Declaration (MND)(ND)	\$2,916.75	\$	0.00
<input type="checkbox"/> Certified Regulatory Program (CRP) document - payment due directly to CDFW	\$1,377.25	\$	0.00
<input type="checkbox"/> Exempt from fee			
<input type="checkbox"/> Notice of Exemption (attach)			
<input type="checkbox"/> CDFW No Effect Determination (attach)			
<input type="checkbox"/> Fee previously paid (attach previously issued cash receipt copy)			
<hr/>			
<input type="checkbox"/> Water Right Application or Petition Fee (State Water Resources Control Board only)	\$850.00	\$	0.00
<input checked="" type="checkbox"/> County documentary handling fee		\$	50.00
<input checked="" type="checkbox"/> Other		\$	

PAYMENT METHOD:

Cash
 Credit
 Check
 Other
 TOTAL RECEIVED
 \$ 4,101.25

SIGNATURE 	AGENCY OF FILING PRINTED NAME AND TITLE M. CEDENO, KERN COUNTY CLERK, FST
--	--