

INITIAL STUDY/MITIGATED NEGATIVE DECLARATION

[Pursuant to Public Resources Code Section 21080(c) and California Code of Regulations, Title 14, Sections 15070-15071]

LEAD AGENCY: San Joaquin County Community Development Department

PROJECT APPLICANT: CK Bros Carrier, Inc/Satbir Singh Rai

PROJECT TITLE/FILE NUMBER(S): PA-2000174 (SA)

PROJECT DESCRIPTION: A Site Approval for a truck parking facility to be constructed in 2 phases over 5 years. Phase One includes the grading and paving for a maximum of 36 combined truck and trailer parking spaces. Phase Two, with permits issued within 5 years, includes the construction of an 18,000-square-foot office and truck service building. The project will utilize an onsite well and septic system. An onsite retention pond is proposed for storm water. The project site has direct access off the South State Route 99 E. Frontage Rd. The project site is not under a Williamson Act Contract. (Use Type: Truck Sales and Services - Parking)

The project site is located on the east side of South State Route 99 East Frontage Road, 490 feet south of East Clark Dr., Stockton.

ASSESSORS PARCEL NO(S): 179-172-56

ACRES: 11.31-acres

GENERAL PLAN: I/L (Limited Industrial), R/L (Low Density Residential)

ZONING: I-L (Limited Industrial)

POTENTIAL POPULATION, NUMBER OF DWELLING UNITS, OR SQUARE FOOTAGE OF USE(S):
A truck and trailer parking facility for a maximum of 36 trucks and trailers with a 18,000 square foot building for office and truck repair.

SURROUNDING LAND USES:

NORTH: Industrial

SOUTH: Industrial/Residential

EAST: Residential

WEST: State Route 99 Highway/City of Stockton

REFERENCES AND SOURCES FOR DETERMINING ENVIRONMENTAL IMPACTS:

Original source materials and maps on file in the Community Development Department including: all County and City general plans and community plans; assessor parcel books; various local and FEMA flood zone maps; service district maps; maps of geologic instability; maps and reports on endangered species such as the Natural Diversity Data Base; noise contour maps; specific roadway plans; maps and/or records of archeological/historic resources; soil reports and maps; etc.

Many of these original source materials have been collected from other public agencies or from previously prepared EIR's and other technical studies. Additional standard sources which should be specifically cited below include on-site visits by staff; staff knowledge or experience; and independent environmental studies submitted to the County as part of the project application (Air Impact Assessment approval dated December 21, 2022). Copies of these reports can be found by contacting the Community Development Department.

TRIBAL CULTURAL RESOURCES:

Have California Native American tribes traditionally and culturally affiliated with the project area requested consultation pursuant to Public Resources Code section 21080.3.1? If so, is there a plan for consultation that includes, for example, the determination of significance of impacts to tribal cultural resources, procedures regarding confidentiality, etc.?

No

GENERAL CONSIDERATIONS:

1. Does it appear that any environmental feature of the project will generate significant public concern or controversy?

Yes No

Nature of concern(s):

2. Will the project require approval or permits by agencies other than the County?

Yes No

Agency name(s): Air Pollution Control District

3. Is the project within the Sphere of Influence, or within two miles, of any city?

Yes No

City: Stockton

ENVIRONMENTAL FACTORS POTENTIALLY AFFECTED:

The environmental factors checked below would be potentially affected by this project, involving at least one impact that is a "**Potentially Significant Impact**" as indicated by the checklist on the following pages.

- | | | |
|--|---|---|
| <input type="checkbox"/> Aesthetics | <input type="checkbox"/> Agriculture and Forestry Resources | <input type="checkbox"/> Air Quality |
| <input type="checkbox"/> Biological Resources | <input type="checkbox"/> Cultural Resources | <input type="checkbox"/> Energy |
| <input type="checkbox"/> Geology / Soils | <input type="checkbox"/> Greenhouse Gas Emissions | <input type="checkbox"/> Hazards & Hazardous Materials |
| <input type="checkbox"/> Hydrology / Water Quality | <input type="checkbox"/> Land Use / Planning | <input type="checkbox"/> Mineral Resources |
| <input type="checkbox"/> Noise | <input type="checkbox"/> Population / Housing | <input type="checkbox"/> Public Services |
| <input type="checkbox"/> Recreation | <input type="checkbox"/> Transportation | <input type="checkbox"/> Tribal Cultural Resources |
| <input type="checkbox"/> Utilities / Service Systems | <input type="checkbox"/> Wildfire | <input type="checkbox"/> Mandatory Findings of Significance |

DETERMINATION: (To be completed by the Lead Agency) On the basis of this initial evaluation:

- I find that the proposed project **COULD NOT** have a significant effect on the environment, and a **NEGATIVE DECLARATION** will be prepared.
- I find that although the proposed project could have a significant effect on the environment, there will not be a significant effect in this case because revisions in the project have been made by or agreed to by the project proponent. A **MITIGATED NEGATIVE DECLARATION** will be prepared.
- I find that the proposed project MAY have a significant effect on the environment, and an **ENVIRONMENTAL IMPACT REPORT** is required.
- I find that the proposed project **MAY** have a "potentially significant impact" or "potentially significant unless mitigated" impact on the environment, but at least one effect 1) has been adequately analyzed in an earlier document pursuant to applicable legal standards, and 2) has been addressed by mitigation measures based on the earlier analysis as described on attached sheets. An **ENVIRONMENTAL IMPACT REPORT** is required, but it must analyze only the effects that remain to be addressed.
- I find that although the proposed project could have a significant effect on the environment, because all potentially significant effects (a) have been analyzed adequately in an earlier **EIR** or **NEGATIVE DECLARATION** pursuant to applicable standards, and (b) have been avoided or mitigated pursuant to that earlier **EIR** or **NEGATIVE DECLARATION**, including revisions or mitigation measures that are imposed upon the proposed project, nothing further is required.

Giuseppe Sanfilippo

Signature: Giuseppe Sanfilippo
Associate Planner

1/19/2023
Date

EVALUATION OF ENVIRONMENTAL IMPACTS:

- 1) A brief explanation is required for all answers except "No Impact" answers that are adequately supported by the information sources a lead agency cites in the parentheses following each question. A "No Impact" answer is adequately supported if the referenced information sources show that the impact simply does not apply to projects like the one involved (e.g., the project falls outside a fault rupture zone). A "No Impact" answer should be explained where it is based on project-specific factors as well as general standards (e.g., the project will not expose sensitive receptors to pollutants, based on a project-specific screening analysis).
- 2) All answers must take account of the whole action involved, including off-site as well as on-site, cumulative as well as project-level, indirect as well as direct, and construction as well as operational impacts.
- 3) Once the lead agency has determined that a particular physical impact may occur, then the checklist answers must indicate whether the impact is potentially significant, less than significant with mitigation, or less than significant. "Potentially Significant Impact" is appropriate if there is substantial evidence that an effect may be significant. If there are one or more "Potentially Significant Impact" entries when the determination is made, an EIR is required.
- 4) "Negative Declaration: Less Than Significant With Mitigation Incorporated" applies where the incorporation of mitigation measures has reduced an effect from "Potentially Significant Impact" to a "Less Than Significant Impact." The lead agency must describe the mitigation measures, and briefly explain how they reduce the effect to a less than significant level (mitigation measures from "Earlier Analyses," as described in (5) below, may be cross-referenced).
- 5) Earlier analyses may be used where, pursuant to the tiering, program EIR, or other CEQA process, an effect has been adequately analyzed in an earlier EIR or negative declaration. Section 15063(c)(3)(D). In this case, a brief discussion should identify the following:
 - a) Earlier Analysis Used. Identify and state where they are available for review.
 - b) Impacts Adequately Addressed. Identify which effects from the above checklist were within the scope of and adequately analyzed in an earlier document pursuant to applicable legal standards, and state whether such effects were addressed by mitigation measures based on the earlier analysis.
 - c) Mitigation Measures. For effects that are "Less than Significant with Mitigation Measures Incorporated," describe the mitigation measures which were incorporated or refined from the earlier document and the extent to which they address site-specific conditions for the project.
- 6) Lead agencies are encouraged to incorporate into the checklist references to information sources for potential impacts (e.g., general plans, zoning ordinances). Reference to a previously prepared or outside document should, where appropriate, include a reference to the page or pages where the statement is substantiated.
- 7) Supporting Information Sources: A source list should be attached, and other sources used or individuals contacted should be cited in the discussion.
- 8) This is only a suggested form, and lead agencies are free to use different formats; however, lead agencies should normally address the questions from this checklist that are relevant to a project's environmental effects in whatever format is selected.
- 9) The explanation of each issue should identify:
 - a) the significance criteria or threshold, if any, used to evaluate each question; and
 - b) the mitigation measure identified, if any, to reduce the impact to less than significance.

ISSUES:

Potentially Significant Impact	Less Than Significant with Mitigation Incorporated	Less Than Significant Impact	No Impact	Analyzed In The Prior EIR
---	---	---	----------------------	--

I. AESTHETICS.

Except as provided in Public Resources Code Section 21099, would the project:

a) Have a substantial adverse effect on a scenic vista?	<input type="checkbox"/>	<input type="checkbox"/>	<input type="checkbox"/>	<input checked="" type="checkbox"/>	<input type="checkbox"/>
b) Substantially damage scenic resources, including, but not limited to, trees, rock outcroppings, and historic buildings within a state scenic highway?	<input type="checkbox"/>	<input type="checkbox"/>	<input type="checkbox"/>	<input checked="" type="checkbox"/>	<input type="checkbox"/>
c) In non-urbanized areas, substantially degrade the existing visual character or quality of public views of the site and its surroundings? (Public views are those that are experienced from publically accessible vantage point). If the project is in an urbanized area, would the project conflict with applicable zoning and other regulations governing scenic quality?	<input type="checkbox"/>	<input type="checkbox"/>	<input type="checkbox"/>	<input checked="" type="checkbox"/>	<input type="checkbox"/>
d) Create a new source of substantial light or glare which would adversely affect day or nighttime views in the area?	<input type="checkbox"/>	<input type="checkbox"/>	<input type="checkbox"/>	<input checked="" type="checkbox"/>	<input type="checkbox"/>

Impact Discussion:

(a-d) This project is a Site Approval for a truck parking facility to be constructed in 2 phases over 5 years. Phase One includes the grading and paving for a maximum of 36 combined truck and trailer parking spaces. Phase Two, with permits issued within 5 years, includes the construction of an 18,000-square-foot office and truck service building. The project site is not located along a designated scenic route pursuant to 2035 General Plan Figure 12-2, and the surrounding area is a mixture of industrial and residential uses. As a result, the proposed project is not anticipated to have an impact on aesthetics.

Potentially Significant Impact	Less Than Significant with Mitigation Incorporated	Less Than Significant Impact	No Impact	Analyzed In The Prior EIR
--------------------------------------	---	------------------------------------	--------------	---------------------------------

II. AGRICULTURE AND FORESTRY RESOURCES.

In determining whether impacts to agricultural resources are significant environmental effects, lead agencies may refer to the California Agricultural Land Evaluation and Site Assessment Model (1997) prepared by the California Dept. of Conservation as an optional model to use in assessing impacts on agriculture and farmland. In determining whether impacts to forest resources, including timberland, are significant environmental effects, lead agencies may refer to information compiled by the California Department of Forestry and Fire Protection regarding the state's inventory of forest land, including the Forest and Range Assessment Project and the Forest Legacy Assessment project; and forest carbon measurement methodology provided in Forest Protocols adopted by the California Air Resources Board. -- Would the project:

a) Convert Prime Farmland, Unique Farmland, or Farmland of Statewide Importance (Farmland), as shown on the maps prepared pursuant to the Farmland Mapping and Monitoring Program of the California Resources Agency, to nonagricultural use?	<input type="checkbox"/>	<input type="checkbox"/>	<input type="checkbox"/>	<input checked="" type="checkbox"/>	<input type="checkbox"/>
b) Conflict with existing zoning for agricultural use, or a Williamson Act contract?	<input type="checkbox"/>	<input type="checkbox"/>	<input type="checkbox"/>	<input checked="" type="checkbox"/>	<input type="checkbox"/>
c) Conflict with existing zoning for, or cause rezoning of, forest land (as defined in Public Resources Code section 12220(g)), timberland (as defined by Public Resources Code section 4526), or timberland zoned Timberland Production (as defined by Government Code section 51104(g))?	<input type="checkbox"/>	<input type="checkbox"/>	<input type="checkbox"/>	<input checked="" type="checkbox"/>	<input type="checkbox"/>
d) Result in the loss of forest land or conversion of forest land to non-forest use?	<input type="checkbox"/>	<input type="checkbox"/>	<input type="checkbox"/>	<input checked="" type="checkbox"/>	<input type="checkbox"/>
e) Involve other changes in the existing environment which, due to their location or nature, could result in conversion of Farmland, to non-agricultural use or conversion of forest land to non-forest use?	<input type="checkbox"/>	<input type="checkbox"/>	<input type="checkbox"/>	<input checked="" type="checkbox"/>	<input type="checkbox"/>

Impact Discussion:

(a-e) This project is a Site Approval for a truck parking facility to be constructed in 2 phases over 5 years. Phase One includes the grading and paving for a maximum of 36 combined truck and trailer parking spaces. Phase Two, with permits issued within 5 years, includes the construction of an 18,000-square-foot office and truck service building. The current zoning for the property is I-L (Limited Industrial). The proposed project will not affect any agricultural uses, nor will it affect existing Williamson Act contracts. Therefore, the proposed application will have no impact on agriculture and forestry resources.

	Potentially Significant Impact	Less Than Significant with Mitigation Incorporated	Less Than Significant Impact	No Impact	Analyzed In The Prior EIR
--	--------------------------------	--	------------------------------	-----------	---------------------------

III. AIR QUALITY.

Where available, the significance criteria established by the applicable air quality management or air pollution control district may be relied upon to make the following determinations. Would the project:

a) Conflict with or obstruct implementation of the applicable air quality plan?	<input type="checkbox"/>	<input type="checkbox"/>	<input checked="" type="checkbox"/>	<input type="checkbox"/>	<input type="checkbox"/>
b) Result in a cumulatively considerable net increase of any criteria pollutant for which the project region is non-attainment under an applicable federal or state ambient air quality standard?	<input type="checkbox"/>	<input checked="" type="checkbox"/>	<input type="checkbox"/>	<input type="checkbox"/>	<input type="checkbox"/>
c) Expose sensitive receptors to substantial pollutant concentrations?	<input type="checkbox"/>	<input checked="" type="checkbox"/>	<input type="checkbox"/>	<input type="checkbox"/>	<input type="checkbox"/>
d) Result in substantial emissions (such as those leading to odors) adversely affecting a substantial number of people?	<input type="checkbox"/>	<input checked="" type="checkbox"/>	<input type="checkbox"/>	<input type="checkbox"/>	<input type="checkbox"/>

Impact Discussion:

(a-d) This project is a Site Approval for a truck parking facility to be constructed in 2 phases over 5 years. Phase One includes the grading and paving for a maximum of 36 combined truck and trailer parking spaces. Phase Two, with permits issued within 5 years, includes the construction of an 18,000-square-foot office and truck service building. The San Joaquin Valley Unified Air Pollution Control District (SJVAPCD) has been established by the State in an effort to control and minimize air pollution. On December 20, 2022, the SJVAPCD issued the final Air Impact Assessment (AIA) approval for the project. The SJVAPCD determined that the construction and operation for the project will be less than two-tons of NOx per year, and two tons PM10 per year. The SJVAPCD provided the following mitigation measures:

- For each project phase, within 30-days of issuance of the first certificate of occupancy, if applicable, submit to the District a summary report of the construction start, and end dates, and the date of issuance of the first certificate of occupancy. Otherwise, submit to the District a summary report of the construction start and end dates within 30 days of the end of each phase of construction.
- For each project phase, all records shall be maintained on site during construction and for a period of ten years following either the end of construction or the issuance of the first certificate of occupancy, whichever is later. Records shall be made available for District inspection upon request.
- For each project phase, maintain records of (1) the construction start and end dates and (2) the date of issuance of the first certificate of occupancy, if applicable.
- Increase project site Density.
- Increase Diversity since project is in an area of various land uses.
- Improve walkability to and from site.
- Improve Destination Accessibility within 0.5 miles of job center.

In addition to these measures, the project will be required to file a Dust Control Plan prior to commencing any earth moving activities and obtain an Authority to Construct prior to the installation of equipment that controls or may emit air contaminants, including but not limited to emergency internal combustion engines, boilers, and bag houses. As a result, air impacts are anticipated to be less than significant.

Potentially Significant Impact	Less Than Significant with Mitigation Incorporated	Less Than Significant Impact	No Impact	Analyzed In The Prior EIR
--------------------------------	--	------------------------------	-----------	---------------------------

IV. BIOLOGICAL RESOURCES.

Would the project:

a) Have a substantial adverse effect, either directly or through habitat modifications, on any species identified as a candidate, sensitive, or special status species in local or regional plans, policies, or regulations, or by the California Department of Fish and Game or U.S. Fish and Wildlife Service?	<input type="checkbox"/>	<input type="checkbox"/>	<input type="checkbox"/>	<input checked="" type="checkbox"/>	<input type="checkbox"/>
b) Have a substantial adverse effect on any riparian habitat or other sensitive natural community identified in local or regional plans, policies, regulations or by the California Department of Fish and Game or US Fish and Wildlife Service?	<input type="checkbox"/>	<input type="checkbox"/>	<input type="checkbox"/>	<input checked="" type="checkbox"/>	<input type="checkbox"/>
c) Have a substantial adverse effect on state or federally protected wetlands (including, but not limited to, marsh, vernal pool, coastal, etc.) through direct removal, filling, hydrological interruption, or other means?	<input type="checkbox"/>	<input type="checkbox"/>	<input type="checkbox"/>	<input checked="" type="checkbox"/>	<input type="checkbox"/>
d) Interfere substantially with the movement of any native resident or migratory fish or wildlife species or with established native resident or migratory wildlife corridors, or impede the use of native wildlife nursery sites?	<input type="checkbox"/>	<input checked="" type="checkbox"/>	<input type="checkbox"/>	<input type="checkbox"/>	<input type="checkbox"/>
e) Conflict with any local policies or ordinances protecting biological resources, such as a tree preservation policy or ordinance?	<input type="checkbox"/>	<input type="checkbox"/>	<input type="checkbox"/>	<input checked="" type="checkbox"/>	<input type="checkbox"/>
f) Conflict with the provisions of an adopted Habitat Conservation Plan, Natural Community Conservation Plan, or other approved local, regional, or state habitat conservation plan?	<input type="checkbox"/>	<input type="checkbox"/>	<input type="checkbox"/>	<input checked="" type="checkbox"/>	<input type="checkbox"/>

Impact Discussion:

(a-f) The Natural Diversity Database lists the burrowing owl (*Athene cunicularia*), Swainson's hawk (*Buteo swainsoni*), and the recurved larkspur (*Delphinium recurvatum*) as rare, endangered, or threatened species located on or near the project area. Referrals have been sent to the San Joaquin Council of Governments (SJCOG) for review. SJCOG has determined that the applicant may participate in the San Joaquin Multi-Species Habitat Conservation and Open Space Plan (SJMSCP), and the applicant has confirmed participation. As a result, the proposed project is consistent with the SJMSCP, as amended, as reflected in the conditions of project approval for this proposal. Pursuant to the *Final EIR/EIS for San Joaquin County Multi-Species Habitat Conservation and Open Space Plan (SJMSCP)*, dated November 15, 2000, and certified by SJCOG on December 7, 2000, implementation of the SJMSCP is expected to reduce impacts to biological resources resulting from the proposed project to a level of less-than-significant.

Potentially Significant Impact	Less Than Significant with Mitigation Incorporated	Less Than Significant Impact	No Impact	Analyzed In The Prior EIR
---	---	---	----------------------	--

V. CULTURAL RESOURCES.

Would the project:

- | | | | | | |
|--|--------------------------|--------------------------|-------------------------------------|--------------------------|--------------------------|
| a) Cause a substantial adverse change in the significance of a historical resource pursuant to § 15064.5? | <input type="checkbox"/> | <input type="checkbox"/> | <input checked="" type="checkbox"/> | <input type="checkbox"/> | <input type="checkbox"/> |
| b) Cause a substantial adverse change in the significance of an archaeological resource pursuant to § 15064.5? | <input type="checkbox"/> | <input type="checkbox"/> | <input checked="" type="checkbox"/> | <input type="checkbox"/> | <input type="checkbox"/> |
| c) Disturb any human remains, including those interred outside of dedicated cemeteries? | <input type="checkbox"/> | <input type="checkbox"/> | <input checked="" type="checkbox"/> | <input type="checkbox"/> | <input type="checkbox"/> |

Impact Discussion:

- (a-c) In the event human remains are encountered during any portion of the project, California state law requires that there shall be no further excavation or disturbance of the site or any nearby area reasonably suspected to overlie adjacent remains until the coroner of the county has determined manner and cause of death, and the recommendations concerning the treatment and disposition of the human remains have been made to the person responsible for the excavation (California Health and Safety Code - Section 7050.5). At the time development, if Human burials are found to be of Native American origin, the developer shall follow the procedures pursuant to Title 14, Division 6, Chapter 3, Article 5, Section 15064.5(e) of the California State Code of Regulations. There is no ground disturbance proposed with this application. Therefore, less than significant potential impacts are anticipated on cultural resources as a result of the project.

Potentially Significant Impact	Less Than Significant with Mitigation Incorporated	Less Than Significant Impact	No Impact	Analyzed In The Prior EIR
--------------------------------------	---	------------------------------------	--------------	---------------------------------

VI. ENERGY.

Would the project:

- | | | | | | |
|--|--------------------------|--------------------------|-------------------------------------|--------------------------|--------------------------|
| a) Result in a potentially significant environmental impact due to wasteful, inefficient, or unnecessary consumption of energy, or wasteful use of energy resources, during project construction or operation? | <input type="checkbox"/> | <input type="checkbox"/> | <input checked="" type="checkbox"/> | <input type="checkbox"/> | <input type="checkbox"/> |
| b) Conflict with or obstruct a state or local plan for renewable energy or energy efficiency? | <input type="checkbox"/> | <input type="checkbox"/> | <input checked="" type="checkbox"/> | <input type="checkbox"/> | <input type="checkbox"/> |

Impact Discussion:

- (a,b) The California Energy Code (also titled The Energy Efficiency Standards for Residential and Non-residential Buildings) was created by the California Building Standards Commission in response to a legislative mandate to reduce California's energy consumption. The code's purpose is to advance the state's energy policy, develop renewable energy sources and prepare for energy emergencies. These standards are updated periodically by the California Energy Commission. The code includes energy conservation standards applicable to most buildings throughout California. These requirements will be applicable to the proposed project, and will be triggered at the time of building permit application, ensuring that any impact to the environment due to wasteful, inefficient, or unnecessary consumption of energy will be less than significant and preventing any conflict with state or local plans for energy efficiency and renewable energy.

	Potentially Significant Impact	Less Than Significant with Mitigation Incorporated	Less Than Significant Impact	No Impact	Analyzed In The Prior EIR
<u>VII. GEOLOGY AND SOILS.</u>					
Would the project:					
a) Directly or indirectly cause potential substantial adverse effects, including the risk of loss, injury, or death involving:	<input type="checkbox"/>	<input type="checkbox"/>	<input checked="" type="checkbox"/>	<input type="checkbox"/>	<input type="checkbox"/>
i) Rupture of a known earthquake fault, as delineated on the most recent Alquist-Priolo Earthquake Fault Zoning Map issued by the State Geologist for the area or based on other substantial evidence of a known fault? Refer to Division of Mines and Geology Special Publication 42.	<input type="checkbox"/>	<input type="checkbox"/>	<input checked="" type="checkbox"/>	<input type="checkbox"/>	<input type="checkbox"/>
ii) Strong seismic ground shaking?	<input type="checkbox"/>	<input type="checkbox"/>	<input checked="" type="checkbox"/>	<input type="checkbox"/>	<input type="checkbox"/>
iii) Seismic-related ground failure, including liquefaction?	<input type="checkbox"/>	<input type="checkbox"/>	<input checked="" type="checkbox"/>	<input type="checkbox"/>	<input type="checkbox"/>
iv) Landslides?	<input type="checkbox"/>	<input type="checkbox"/>	<input checked="" type="checkbox"/>	<input type="checkbox"/>	<input type="checkbox"/>
b) Result in substantial soil erosion or the loss of topsoil?	<input type="checkbox"/>	<input type="checkbox"/>	<input checked="" type="checkbox"/>	<input type="checkbox"/>	<input type="checkbox"/>
c) Be located on a geologic unit or soil that is unstable, or that would become unstable as a result of the project, and potentially result in on- or off-site landslide, lateral spreading, subsidence, liquefaction or collapse?	<input type="checkbox"/>	<input type="checkbox"/>	<input type="checkbox"/>	<input checked="" type="checkbox"/>	<input type="checkbox"/>
d) Be located on expansive soil and create direct or indirect risks to life or property?	<input type="checkbox"/>	<input type="checkbox"/>	<input checked="" type="checkbox"/>	<input type="checkbox"/>	<input type="checkbox"/>
e) Have soils incapable of adequately supporting the use of septic tanks or alternative waste water disposal systems where sewers are not available for the disposal of waste water?	<input type="checkbox"/>	<input type="checkbox"/>	<input checked="" type="checkbox"/>	<input type="checkbox"/>	<input type="checkbox"/>
f) Directly or indirectly destroy a unique paleontological resource or site or unique geologic feature?	<input type="checkbox"/>	<input type="checkbox"/>	<input type="checkbox"/>	<input checked="" type="checkbox"/>	<input type="checkbox"/>

Impact Discussion:

(a-f) This project is a Site Approval for a truck parking facility to be constructed in 2 phases over 5 years. Phase One includes the grading and paving for a maximum of 36 combined truck and trailer parking spaces. Phase Two, with permits issued within 5 years, includes the construction of an 18,000-square-foot office and truck service building. The project site is in an area of expansive soil, with a soil expansive potential of moderate. At the time of future development, the Building Division will require a soils report to be submitted with a Building Permit application. Therefore, the effects of expansive soil to the underlying project are expected to be less than significant.

The proposed the project is not anticipated to cause seismic effects, erosion, safety effects, or impact water and geologic features. The proposed project will not cause the risk of injury or death as a result of a rupture of a known earthquake fault, seismic activity, or landslides because there are no fault lines in the project vicinity. The proposed

project will not result in substantial soil erosion or the loss of topsoil. The proposed project will not destroy a unique paleontological resource or site or unique geological feature. The proposed project is not located on a geologic unit or soil that is unstable, or that would become unstable as a result of the project, and potentially result in on- or off-site landslide, lateral spreading, subsidence, liquefaction or collapse.

Potentially Significant Impact	Less Than Significant with Mitigation Incorporated	Less Than Significant Impact	No Impact	Analyzed In The Prior EIR
---	---	---	----------------------	--

VIII. GREENHOUSE GAS EMISSIONS.

Would the project:

a) Generate greenhouse gas emissions, either directly or indirectly, that may have a significant impact on the environment?

<input type="checkbox"/>	<input type="checkbox"/>	<input checked="" type="checkbox"/>	<input type="checkbox"/>	<input type="checkbox"/>
--------------------------	--------------------------	-------------------------------------	--------------------------	--------------------------

b) Conflict with an applicable plan, policy or regulation adopted for the purpose of reducing the emissions of greenhouse gases?

<input type="checkbox"/>	<input type="checkbox"/>	<input checked="" type="checkbox"/>	<input type="checkbox"/>	<input type="checkbox"/>
--------------------------	--------------------------	-------------------------------------	--------------------------	--------------------------

Impact Discussion:

Emissions of GHGs contributing to global climate change are attributable in large part to human activities associated with the industrial/manufacturing, utility, transportation, residential, and agricultural sectors. Therefore, the cumulative global emissions of GHGs contributing to global climate change can be attributed to every nation, region, and city, and virtually every individual on earth. An individual project's GHG emissions are at a micro-scale level relative to global emissions and effects to global climate change; however, an individual project could result in a cumulatively considerable incremental contribution to a significant cumulative macro-scale impact. As such, impacts related to emissions of GHG are inherently considered cumulative impacts.

Implementation of the proposed project would cumulatively contribute to increases of GHG emissions. Estimated GHG emissions attributable to future development would be primarily associated with increases of carbon dioxide (CO₂) and, to a lesser extent, other GHG pollutants, such as methane (CH₄) and nitrous oxide (N₂O) associated with area sources, mobile sources or vehicles, utilities (electricity and natural gas), water usage, wastewater generation, and the generation of solid waste. The primary source of GHG emissions for the project would be mobile source emissions. The common unit of measurement for GHG is expressed in terms of annual metric tons of CO₂ equivalents (MTCO₂e/yr).

As noted previously, the proposed project will be subject to the rules and regulations of the SJVAPCD. The SJVAPCD has adopted the Guidance for Valley Land- use Agencies in Addressing GHG Emission Impacts for New Projects under CEQA and the District Policy – Addressing GHG Emission Impacts for Stationary Source Projects Under CEQA When Serving as the Lead Agency.¹¹ The guidance and policy rely on the use of performance-based standards, otherwise known as Best Performance Standards (BPS) to assess significance of project specific greenhouse gas emissions on global climate change during the environmental review process, as required by CEQA. To be determined to have a less-than-significant individual and cumulative impact with regard to GHG emissions, projects must include BPS sufficient to reduce GHG emissions by 29 percent when compared to Business As Usual (BAU) GHG emissions. Per the SJVAPCD, BAU is defined as projected emissions for the 2002-2004 baseline period. Projects which do not achieve a 29 percent reduction from BAU levels with BPS alone are required to quantify additional project-specific reductions demonstrating a combined reduction of 29 percent. Potential mitigation measures may include, but not limited to: on-site renewable energy (e.g. solar photovoltaic systems), electric vehicle charging stations, the use of alternative-fueled vehicles, exceeding Title 24 energy efficiency standards, the installation of energy-efficient lighting and control systems, the installation of energy-efficient mechanical systems, the installation of drought-tolerant landscaping, efficient irrigation systems, and the use of low-flow plumbing fixtures.

It should be noted that neither the SJVAPCD nor the County provide project-level thresholds for construction-related GHG emissions. Construction GHG emissions are a one-time release and are, therefore, not typically expected to generate a significant contribution to global climate change. As such, the analysis herein is limited to discussion of long-term operational GHG emissions.

¹¹ San Joaquin Valley Air Pollution Control District. Guidance for Valley Land-use Agencies in Addressing GHG Emission Impacts for New Projects under CEQA. December 17, 2009. San Joaquin Valley Air Pollution Control District. District Policy Addressing GHG Emission Impacts for Stationary Source Projects Under CEQA When Serving as the Lead Agency. December 17, 2009.

Potentially Significant Impact	Less Than Significant with Mitigation Incorporated	Less Than Significant Impact	No Impact	Analyzed In The Prior EIR
--------------------------------------	---	------------------------------------	--------------	---------------------------------

IX. HAZARDS AND HAZARDOUS MATERIALS.

Would the project:

a) Create a significant hazard to the public or the environment through the routine transport, use, or disposal of hazardous materials?	<input type="checkbox"/>	<input type="checkbox"/>	<input checked="" type="checkbox"/>	<input type="checkbox"/>	<input type="checkbox"/>
b) Create a significant hazard to the public or the environment through reasonably foreseeable upset and accident conditions involving the release of hazardous materials into the environment?	<input type="checkbox"/>	<input type="checkbox"/>	<input checked="" type="checkbox"/>	<input type="checkbox"/>	<input type="checkbox"/>
c) Emit hazardous emissions or handle hazardous or acutely hazardous materials, substances, or waste within one-quarter mile of an existing or proposed school?	<input type="checkbox"/>	<input type="checkbox"/>	<input checked="" type="checkbox"/>	<input type="checkbox"/>	<input type="checkbox"/>
d) Be located on a site which is included on a list of hazardous materials sites compiled pursuant to Government Code Section 65962.5 and, as a result, would it create a significant hazard to the public or the environment?	<input type="checkbox"/>	<input type="checkbox"/>	<input checked="" type="checkbox"/>	<input type="checkbox"/>	<input type="checkbox"/>
e) For a project located within an airport land use plan or, where such a plan has not been adopted, within two miles of a public airport or public use airport, would the project result in a safety hazard or excessive noise for people residing or working in the project area?	<input type="checkbox"/>	<input type="checkbox"/>	<input checked="" type="checkbox"/>	<input type="checkbox"/>	<input type="checkbox"/>
f) Impair implementation of or physically interfere with an adopted emergency response plan or emergency evacuation plan?	<input type="checkbox"/>	<input type="checkbox"/>	<input checked="" type="checkbox"/>	<input type="checkbox"/>	<input type="checkbox"/>
g) Expose people or structures, either directly or indirectly, to a significant risk of loss, injury or death involving wildland fires, including where wildlands are adjacent to urbanized areas or where residences are intermixed with wildlands?	<input type="checkbox"/>	<input type="checkbox"/>	<input checked="" type="checkbox"/>	<input type="checkbox"/>	<input type="checkbox"/>

Impact Discussion:

(a-g) The proposed application would not result in, create or induce hazards and associated risks to the public. Construction activities for the project typically involve the use of toxic or hazardous materials such as paint, fuels, and solvents. Construction activities would be subject to federal, state, and local laws and requirements designed to minimize and avoid potential health and safety risks associated with hazardous materials. No significant impacts are anticipated related to the transport, use, or storage of hazardous materials during construction activities are anticipated.

The project site falls within Zone 7a of the Airport Influence Area the comprehensive Airport Land Use Plan boundaries for the Stockton Metropolitan Airport. The project site is located approximately 1.7 miles north of the nearest runway. The project shall abide by the applicable Airport Land Use Plan for the Stockton Metropolitan Airport. A referral was sent to the Airport Land Use Commission and the Stockton Metropolitan Airport on December 11, 2020 for review. As a Condition of Approval, the project will be subject to the Airport Land Use Commission's rules and regulations. As a result, impacts to airport flight paths will be reduced to less than significant.

X. HYDROLOGY AND WATER QUALITY.

	Potentially Significant Impact	Less Than Significant with Mitigation Incorporated	Less Than Significant Impact	No Impact	Analyzed In The Prior EIR
--	--------------------------------	--	------------------------------	-----------	---------------------------

Would the project:

a) Violate any water quality standards or waste discharge requirements or otherwise substantially degrade surface or ground water quality?	<input type="checkbox"/>	<input type="checkbox"/>	<input checked="" type="checkbox"/>	<input type="checkbox"/>	<input type="checkbox"/>
b) Substantially decrease groundwater supplies or interfere substantially with groundwater recharge such that the project may impede sustainable groundwater management of the basin?	<input type="checkbox"/>	<input type="checkbox"/>	<input checked="" type="checkbox"/>	<input type="checkbox"/>	<input type="checkbox"/>
c) Substantially alter the existing drainage pattern of the site or area, including through the alteration of the course of a stream or river or through the addition of impervious surfaces, in a manner which would:	<input type="checkbox"/>	<input type="checkbox"/>	<input type="checkbox"/>	<input checked="" type="checkbox"/>	<input type="checkbox"/>
i) result in substantial erosion or siltation on- or off-site;	<input type="checkbox"/>	<input type="checkbox"/>	<input type="checkbox"/>	<input checked="" type="checkbox"/>	<input type="checkbox"/>
ii) substantially increase the rate or amount of surface runoff in a manner which would result in flooding on- or off-site;	<input type="checkbox"/>	<input type="checkbox"/>	<input type="checkbox"/>	<input checked="" type="checkbox"/>	<input type="checkbox"/>
iii) create or contribute runoff water which would exceed the capacity of existing or planned stormwater drainage systems or provide substantial additional sources of polluted runoff; or	<input type="checkbox"/>	<input type="checkbox"/>	<input type="checkbox"/>	<input checked="" type="checkbox"/>	<input type="checkbox"/>
iv) impede or redirect flood flows?	<input type="checkbox"/>	<input type="checkbox"/>	<input type="checkbox"/>	<input checked="" type="checkbox"/>	<input type="checkbox"/>
d) In flood hazard, tsunami, or seiche zones, risk release of pollutants due to project inundation?	<input type="checkbox"/>	<input type="checkbox"/>	<input type="checkbox"/>	<input checked="" type="checkbox"/>	<input type="checkbox"/>
e) Conflict with or obstruct implementation of a water quality control plan or sustainable groundwater management plan?	<input type="checkbox"/>	<input type="checkbox"/>	<input type="checkbox"/>	<input checked="" type="checkbox"/>	<input type="checkbox"/>

Impact Discussion:

- (a-e) The project site is located in the Flood Zone X flood designations. A referral was sent to the Department of Public Works Flood Control Division for comments. If approved, any new developments will have to comply with Development Title Section 9-1605 regarding flood hazards

The project site is located approximately 0.96-miles south of Duck Creek, and approximately 0.34 miles north of North Little John Creek. The proposed project will not violate any water quality standards or waste discharge requirements or otherwise substantially degrade surface or ground water quality, conflict with or obstruct implementation of a water quality control plan or sustainable groundwater management plan.

The project will not substantially decrease groundwater supplies or interfere substantially with groundwater recharge, substantially alter the existing drainage pattern of the site or area, including through the alteration of the course of a stream or river or through the addition of impervious surfaces, in a manner which would result in substantial erosion or siltation on- or off-site; substantially increase the rate or amount of surface runoff in a manner

which would result in flooding on- or off-site; create or contribute runoff water which would exceed the capacity of existing or planned stormwater drainage systems or provide substantial additional sources of polluted runoff; or impede or redirect flood flows. Additionally, the proposed project would not risk release of pollutants in flood hazard, tsunami, or seiche zones.

Potentially Significant Impact	Less Than Significant with Mitigation Incorporated	Less Than Significant Impact	No Impact	Analyzed In The Prior EIR
--------------------------------------	---	------------------------------------	--------------	---------------------------------

XI. LAND USE AND PLANNING.

Would the project:

- | | | | | | |
|--|--------------------------|--------------------------|-------------------------------------|-------------------------------------|--------------------------|
| a) Physically divide an established community? | <input type="checkbox"/> | <input type="checkbox"/> | <input type="checkbox"/> | <input checked="" type="checkbox"/> | <input type="checkbox"/> |
| b) Cause a significant environmental impact due to a conflict with any land use plan, policy, or regulation adopted for the purpose of avoiding or mitigating an environmental effect? | <input type="checkbox"/> | <input type="checkbox"/> | <input checked="" type="checkbox"/> | <input type="checkbox"/> | <input type="checkbox"/> |

Impact Discussion:

(a,b) A truck parking operation is classified under the Truck Sales and Service, Parking use type, and may be a conditionally permitted use in the I-L (Limited Industrial) zone subject to an approved Site Approval application. The project does not propose the construction of any buildings. The project site is surrounded by industrial, residential, commercial, and agricultural uses. Therefore, the project will not physically divide an established community and is consistent with surrounding land uses.

The zoning and the General Plan for the project site will remain the same if the project is approved. Additionally, the proposed project will have a less than significant impact to surrounding parcels and will not create premature development pressure on surrounding agricultural lands to convert land from agricultural uses to non-agricultural uses. Therefore, this project is not a growth-inducing action.

The proposed project will not be a conflict with any existing or planned uses or set a significant land use precedent. The proposed project is not in conflict with any Master Plans, Specific Plans, or Special Purpose Plans, or any other applicable plan adopted by the County.

	Potentially Significant Impact	Less Than Significant with Mitigation Incorporated	Less Than Significant Impact	No Impact	Analyzed In The Prior EIR
--	--------------------------------	--	------------------------------	-----------	---------------------------

XII. MINERAL RESOURCES.

Would the project:

- | | | | | | |
|--|--------------------------|--------------------------|-------------------------------------|--------------------------|--------------------------|
| a) Result in the loss of availability of a known mineral resource that would be of value to the region and the residents of the state? | <input type="checkbox"/> | <input type="checkbox"/> | <input checked="" type="checkbox"/> | <input type="checkbox"/> | <input type="checkbox"/> |
| b) Result in the loss of availability of a locally- important mineral resource recovery site delineated on a local general plan, specific plan or other land use plan? | <input type="checkbox"/> | <input type="checkbox"/> | <input checked="" type="checkbox"/> | <input type="checkbox"/> | <input type="checkbox"/> |

Impact Discussion:

- (a,b) The proposed project will not result in the loss of availability of a known mineral resource of a resource recovery site because the site does not contain minerals of significance or known mineral resources. San Joaquin County applies a mineral resource zone (MRZ) designation to land that meets the significant mineral deposits definition by the State Division of Mines and Geology. Although the project site is in an area designated MRZ-1, there is currently no mining activity in the area, and the surrounding area is developed with residential, industrial, and commercial uses. Therefore, the proposed project applications will have less than a significant impact on the availability of mineral resources or mineral resource recovery sites within San Joaquin County.

Potentially Significant Impact	Less Than Significant with Mitigation Incorporated	Less Than Significant Impact	No Impact	Analyzed In The Prior EIR
--------------------------------------	---	------------------------------------	--------------	---------------------------------

XIII. NOISE.

Would the project result in:

- | | | | | | |
|---|--------------------------|--------------------------|-------------------------------------|--------------------------|--------------------------|
| a) Generation of a substantial temporary or permanent increase in ambient noise levels in the vicinity of the project in excess of standards established in the local general plan or noise ordinance, or applicable standards of other agencies? | <input type="checkbox"/> | <input type="checkbox"/> | <input checked="" type="checkbox"/> | <input type="checkbox"/> | <input type="checkbox"/> |
| b) Generation of excessive groundborne vibration or groundborne noise levels? | <input type="checkbox"/> | <input type="checkbox"/> | <input checked="" type="checkbox"/> | <input type="checkbox"/> | <input type="checkbox"/> |
| c) For a project within the vicinity of a private airstrip or an airport land use plan, or where such a plan has not been adopted, within two miles of a public airport or public use airport, would the project expose people residing or working in the project area to excessive noise levels? | <input type="checkbox"/> | <input type="checkbox"/> | <input checked="" type="checkbox"/> | <input type="checkbox"/> | <input type="checkbox"/> |

Impact Discussion:

- a-c) This project is a Site Approval for a truck parking facility to be constructed in 2 phases over 5 years. Phase One includes the grading and paving for a maximum of 36 combined truck and trailer parking spaces. Phase Two, with permits issued within 5 years, includes the construction of an 18,000-square-foot office and truck service building. Additionally, the nearest single family residence is located approximately 870 feet southeast of the project site. Development Title Section 9-1025.9 lists the Residential use type as a noise sensitive land use. Development Title Section Table 9-1025.9 Part II states that the maximum sound level for stationary noise sources during the daytime is 70 dB and 65dB for nighttime. This applies to outdoor activity areas of the receiving use, or applies at the lot line if no activity area is known. Additionally, noise from construction activities are exempt from noise standards provided the construction occurs no earlier than 6:00 A.M. and no later than 9:00 P.M. The proposed project would be subject to these Development Title standards. Therefore, noise impacts from the proposed project are expected to be less than significant.

Potentially Significant Impact	Less Than Significant with Mitigation Incorporated	Less Than Significant Impact	No Impact	Analyzed In The Prior EIR
---	---	---	----------------------	--

XIV. POPULATION AND HOUSING.

Would the project:

- | | | | | | |
|---|--------------------------|--------------------------|--------------------------|-------------------------------------|--------------------------|
| a) Induce substantial unplanned population growth in an area, either directly (for example, by proposing new homes and businesses) or indirectly (for example, through extension of roads or other infrastructure)? | <input type="checkbox"/> | <input type="checkbox"/> | <input type="checkbox"/> | <input checked="" type="checkbox"/> | <input type="checkbox"/> |
| b) Displace substantial numbers of existing people or housing, necessitating the construction of replacement housing elsewhere? | <input type="checkbox"/> | <input type="checkbox"/> | <input type="checkbox"/> | <input checked="" type="checkbox"/> | <input type="checkbox"/> |

Impact Discussion:

- (a,b) The proposed request will not alter the location, distribution, density or growth rate of the human population in the area. The proposed project will not affect housing or create a demand for additional housing. The proposed project will not result in displacement of housing or people. Therefore, there will be no impact on existing housing and population.

Potentially Significant Impact	Less Than Significant with Mitigation Incorporated	Less Than Significant Impact	No Impact	Analyzed In The Prior EIR
---	---	---	----------------------	--

XV. PUBLIC SERVICES.

a) Would the project result in substantial adverse physical impacts associated with the provision of new or physically altered governmental facilities, need for new or physically altered governmental facilities, the construction of which could cause significant environmental impacts, in order to maintain acceptable service ratios, response times or other performance objectives for any of the public services:

Fire protection?	<input type="checkbox"/>	<input type="checkbox"/>	<input checked="" type="checkbox"/>	<input type="checkbox"/>	<input type="checkbox"/>
Police protection?	<input type="checkbox"/>	<input type="checkbox"/>	<input checked="" type="checkbox"/>	<input type="checkbox"/>	<input type="checkbox"/>
Schools?	<input type="checkbox"/>	<input type="checkbox"/>	<input checked="" type="checkbox"/>	<input type="checkbox"/>	<input type="checkbox"/>
Parks?	<input type="checkbox"/>	<input type="checkbox"/>	<input checked="" type="checkbox"/>	<input type="checkbox"/>	<input type="checkbox"/>
Other public facilities?	<input type="checkbox"/>	<input type="checkbox"/>	<input checked="" type="checkbox"/>	<input type="checkbox"/>	<input type="checkbox"/>

Impact Discussion:

(a) This project is a Site Approval for a truck parking facility to be constructed in 2 phases over 5 years. Phase One includes the grading and paving for a maximum of 36 combined truck and trailer parking spaces. Phase Two, with permits issued within 5 years, includes the construction of an 18,000-square-foot office and truck service building. The Montezuma Fire District provides the existing fire protection. Existing law enforcement protection is provided by the San Joaquin County Sheriff's Department, and the existing school services are provided by the Stockton Unified School District with the nearest school located approximately 1.5-miles north of the project site. No parks are impacted as a result of this project. Impacts to public services are also anticipated to be less than significant.

Potentially Significant Impact	Less Than Significant with Mitigation Incorporated	Less Than Significant Impact	No Impact	Analyzed In The Prior EIR
--------------------------------------	---	------------------------------------	--------------	---------------------------------

XVI. RECREATION.

a) Would the project increase the use of existing neighborhood and regional parks or other recreational facilities such that substantial physical deterioration of the facility would occur or be accelerated?

<input type="checkbox"/>	<input type="checkbox"/>	<input type="checkbox"/>	<input checked="" type="checkbox"/>	<input type="checkbox"/>
--------------------------	--------------------------	--------------------------	-------------------------------------	--------------------------

b) Does the project include recreational facilities or require the construction or expansion of recreational facilities which might have an adverse physical effect on the environment?

<input type="checkbox"/>	<input type="checkbox"/>	<input type="checkbox"/>	<input checked="" type="checkbox"/>	<input type="checkbox"/>
--------------------------	--------------------------	--------------------------	-------------------------------------	--------------------------

Impact Discussion:

a,b) The proposed project will not substantially increase the use of existing neighborhood and regional parks because no increase in housing or people is associated with this application. Additionally, the project does not include recreation facilities or require the construction or expansion of recreational facilities, which might have an adverse physical effect on the environment. Impacts to recreation opportunities are anticipated to be less than significant.

Potentially Significant Impact	Less Than Significant with Mitigation Incorporated	Less Than Significant Impact	No Impact	Analyzed In The Prior EIR
--------------------------------------	---	------------------------------------	--------------	---------------------------------

XVII. TRANSPORTATION.

Would the project:

a) Conflict with a program plan, ordinance, or policy addressing the circulation system, including transit, roadways, bicycle, and pedestrian facilities?	<input type="checkbox"/>	<input type="checkbox"/>	<input checked="" type="checkbox"/>	<input type="checkbox"/>	<input type="checkbox"/>
b) Would the project conflict or be inconsistent with CEQA Guidelines section 15064.3, subdivision (b)?	<input type="checkbox"/>	<input type="checkbox"/>	<input checked="" type="checkbox"/>	<input type="checkbox"/>	<input type="checkbox"/>
c) Substantially increase hazards due to a geometric design feature (e.g., sharp curves or dangerous intersections) or incompatible uses (e.g., farm equipment)?	<input type="checkbox"/>	<input type="checkbox"/>	<input type="checkbox"/>	<input checked="" type="checkbox"/>	<input type="checkbox"/>
d) Result in inadequate emergency access?	<input type="checkbox"/>	<input type="checkbox"/>	<input type="checkbox"/>	<input checked="" type="checkbox"/>	<input type="checkbox"/>

Impact Discussion:

a-d) The Department of Public Works has been notified of this project and there is no substantial evidence that the project will cause significant impacts to the State Route 99 Frontage road. Because the project is in a screened work related area pursuant to the Department of Public Works Vehicle Miles Traveled (VMT) screening tool, it was determined that this project will generate less than 110 automobile trips per day and, therefore, is considered a small project according to the Technical Advisory on Evaluating Transportation Impacts in CEQA, as published by the California Office of Planning and Research (OPR) in December 2018. According to this OPR guidance, a small project that generates or attracts “fewer than 110 trips per day generally may be assumed to cause a less-than-significant transportation impact” with regards to Vehicle Miles Traveled (VMT). Therefore, this project is anticipated to have a less than significant impact on traffic.

The project is not expected to conflict with a program plan, ordinance, or policy addressing the vehicle circulation system. There will be no changes to the geometric design of roads or to emergency access routes. The proposed project is not expected to result in inadequate emergency access.

The project site falls within Zone 7a of the Airport Influence Area the comprehensive Airport Land Use Plan boundaries for the Stockton Metropolitan Airport. The project site is located approximately 1.7 miles north of the nearest runway. The project shall abide by the applicable Airport Land Use Plan for the Stockton Metropolitan Airport. A referral was sent to the Airport Land Use Commission and the Stockton Metropolitan Airport on December 11, 2020 for review. As a Condition of Approval, the project will be subject to the Airport Land Use Commission’s rules and regulations. As a result, impacts to airport flight paths will be reduced to less than significant.

Potentially Significant Impact	Less Than Significant with Mitigation Incorporated	Less Than Significant Impact	No Impact	Analyzed In The Prior EIR
--------------------------------------	---	------------------------------------	--------------	---------------------------------

XVIII. TRIBAL CULTURAL RESOURCES.

a) Would the project cause a substantial adverse change in the significance of a tribal cultural resource, defined in Public Resources Code section 21074 as either a site, feature, place, cultural landscape that is geographically defined in terms of the size and scope of the landscape, sacred place, or object with cultural value to a California Native American tribe, and that is:

i) Listed or eligible for listing in the California Register of Historical Resources, or in a local register of historical resources as defined in Public Resources Code section 5020.1(k), or

<input type="checkbox"/>	<input type="checkbox"/>	<input type="checkbox"/>	<input checked="" type="checkbox"/>	<input type="checkbox"/>
--------------------------	--------------------------	--------------------------	-------------------------------------	--------------------------

ii) A resource determined by the lead agency, in its discretion and supported by substantial evidence, to be significant pursuant to criteria set forth in subdivision (c) of Public Resources Code Section 5024.1. In applying the criteria set forth in subdivision (c) of Public Resource Code Section 5024.1, the lead agency shall consider the significance of the resource to a California Native American tribe.

<input type="checkbox"/>	<input type="checkbox"/>	<input type="checkbox"/>	<input checked="" type="checkbox"/>	<input type="checkbox"/>
--------------------------	--------------------------	--------------------------	-------------------------------------	--------------------------

Impact Discussion:

a) This project is a Site Approval for a truck parking facility to be constructed in 2 phases over 5 years. Phase One includes the grading and paving for a maximum of 36 combined truck and trailer parking spaces. Phase Two, with permits issued within 5 years, includes the construction of an 18,000-square-foot office and truck service building. A referral was sent to the United Auburn Indian Community (UAIC), North Valley Yokuts Tribe, and the Buena Vista Rancheria for review.

If any suspected Tribal Cultural Resources (TCR) are discovered during ground disturbing construction activities, all work shall cease within 100 feet of the find. A Tribal Representative from culturally affiliated tribes shall be immediately notified and shall determine if the find is a TCR pursuant to Public Resources Code Section 21074. The Tribal Representative will make recommendations regarding the treatment of the discovery. Preservation in place is the preferred alternative under CEQA and UAIC protocols, and every effort must be made to preserve the resources in place, including through project redesign. Work at the discovery location cannot resume until all necessary investigation and evaluation of the discovery under the requirements of CEQA, including AB 52, has been satisfied. The contractor shall implement any measures deemed by the lead agency to be necessary and feasible to preserve in place, avoid, or minimize impacts to the resource, including but not limited to, facilitating the appropriate tribal treatment of the find, as necessary. This has been incorporated into the project's Conditions of Approval.

Additionally, should human remains be discovered during any ground disturbing activities, all work shall stop immediately in the vicinity (e.g., 100 feet) of the finds until they can be verified. The County coroner shall be immediately contacted in accordance with Health and Safety Code section 7050.5(b). Protocol and requirements outlined in Health and Safety Code sections 7050.5(b) and 7050.5(c) as well as Public Resources Code section 5097.98 shall be followed.

As a result of the Condition and existing Health and Safety Code regulations, any impact to tribal cultural resources is anticipated to be less than significant.

Potentially Significant Impact	Less Than Significant with Mitigation Incorporated	Less Than Significant Impact	No Impact	Analyzed In The Prior EIR
--------------------------------------	---	------------------------------------	--------------	---------------------------------

XIX. UTILITIES AND SERVICE SYSTEMS.

Would the project:

a) Require or result in the relocation or construction of new or expanded water, wastewater treatment, or storm water drainage, electric power, natural gas, or telecommunications facilities, the construction or relocation of which could cause significant environmental effects?	<input type="checkbox"/>	<input type="checkbox"/>	<input type="checkbox"/>	<input checked="" type="checkbox"/>	<input type="checkbox"/>
b) Have sufficient water supplies available to serve the project and reasonably foreseeable future development during normal, dry and multiple dry years?	<input type="checkbox"/>	<input type="checkbox"/>	<input checked="" type="checkbox"/>	<input type="checkbox"/>	<input type="checkbox"/>
c) Result in a determination by the wastewater treatment provider which serves or may serve the project that it has adequate capacity to serve the project's projected demand in addition to the provider's existing commitments?	<input type="checkbox"/>	<input type="checkbox"/>	<input checked="" type="checkbox"/>	<input type="checkbox"/>	<input type="checkbox"/>
d) Generate solid waste in excess of State or local standards, or in excess of the capacity of local infrastructure, or otherwise impair the attainment of solid waste reduction goals?	<input type="checkbox"/>	<input type="checkbox"/>	<input type="checkbox"/>	<input checked="" type="checkbox"/>	<input type="checkbox"/>
e) Comply with federal, state, and local management and reduction statutes and regulations related to solid waste?	<input type="checkbox"/>	<input type="checkbox"/>	<input type="checkbox"/>	<input checked="" type="checkbox"/>	<input type="checkbox"/>

Impact Discussion:

(a-e) This project proposes to install a new well for water supply and a septic system for waste water disposal, which will be required to be constructed under permit by the Environmental Health Department. The project site will be required to keep all storm drainage on site, and the Department of Public Works will determine the appropriate size of the proposed storm drainage retention pond. Therefore, the impact on public services will be less than significant.

Potentially Significant Impact	Less Than Significant with Mitigation Incorporated	Less Than Significant Impact	No Impact	Analyzed In The Prior EIR
--------------------------------	--	------------------------------	-----------	---------------------------

XX. WILDFIRE.

If located in or near state responsibility areas or lands classified as very high fire hazard severity zones, would the project:

a) Substantially impair an adopted emergency response plan or emergency evacuation plan?	<input type="checkbox"/>	<input type="checkbox"/>	<input type="checkbox"/>	<input checked="" type="checkbox"/>	<input type="checkbox"/>
b) Due to slope, prevailing winds, and other factors, exacerbate wildfire risks, and thereby expose project occupants to pollutant concentrations from a wildfire or the uncontrolled spread of a wildfire?	<input type="checkbox"/>	<input type="checkbox"/>	<input type="checkbox"/>	<input checked="" type="checkbox"/>	<input type="checkbox"/>
c) Require the installation or maintenance of associated infrastructure (such as roads, fuel breaks, emergency water sources, power lines or other utilities) that may exacerbate fire risk or that may result in temporary or ongoing impacts to the environment?	<input type="checkbox"/>	<input type="checkbox"/>	<input type="checkbox"/>	<input checked="" type="checkbox"/>	<input type="checkbox"/>
d) Expose people or structures to significant risks, including downslope or downstream flooding or landslides, as a result of runoff, post-fire slope instability, or drainage changes?	<input type="checkbox"/>	<input type="checkbox"/>	<input type="checkbox"/>	<input checked="" type="checkbox"/>	<input type="checkbox"/>

Impact Discussion:

a-d) This project is a Site Approval for a truck parking facility to be constructed in 2 phases over 5 years. Phase One includes the grading and paving for a maximum of 36 combined truck and trailer parking spaces. Phase Two, with permits issued within 5 years, includes the construction of an 18,000-square-foot office and truck service building. Pursuant to the San Joaquin Fire Severity Zone map, the project site is located in an area with non-wildland/non-urban fire zone designation.

The project site is accessed by the State Route 99 Frontage Road. Due to the proximity of the project site to a publically maintained road, the project will not require the installation or maintenance of additional infrastructure to mitigate fire risk or may result in impacts to the environment. As a result, the proposed project will have a less than significant impact on potential wildfire hazards.

Potentially Significant Impact	Less Than Significant with Mitigation Incorporated	Less Than Significant Impact	No Impact	Analyzed In The Prior EIR
--------------------------------	--	------------------------------	-----------	---------------------------

XXI. MANDATORY FINDINGS OF SIGNIFICANCE.

a) Does the project have the potential to substantially degrade the quality of the environment, substantially reduce the habitat of a fish or wildlife species, cause a fish or wildlife population to drop below self-sustaining levels, threaten to eliminate a plant or animal community, substantially reduce the number or restrict the range of a rare or endangered plant or animal or eliminate important examples of the major periods of California history or prehistory?

<input type="checkbox"/>	<input type="checkbox"/>	<input type="checkbox"/>	<input checked="" type="checkbox"/>	<input type="checkbox"/>
--------------------------	--------------------------	--------------------------	-------------------------------------	--------------------------

b) Does the project have impacts that are individually limited, but cumulatively considerable? ("Cumulatively considerable" means that the incremental effects of a project are considerable when viewed in connection with the effects of past projects, the effects of other current projects, and the effects of probable future projects)?

<input type="checkbox"/>	<input type="checkbox"/>	<input type="checkbox"/>	<input checked="" type="checkbox"/>	<input type="checkbox"/>
--------------------------	--------------------------	--------------------------	-------------------------------------	--------------------------

c) Does the project have environmental effects which will cause substantial adverse effects on human beings, either directly or indirectly?

<input type="checkbox"/>	<input type="checkbox"/>	<input type="checkbox"/>	<input checked="" type="checkbox"/>	<input type="checkbox"/>
--------------------------	--------------------------	--------------------------	-------------------------------------	--------------------------

Impact Discussion:

The proposed application does not have the potential to degrade the environment or eliminate a plant or animal community. The project would not result in significant cumulative impacts or cause substantial adverse effects on human beings, either directly or indirectly.

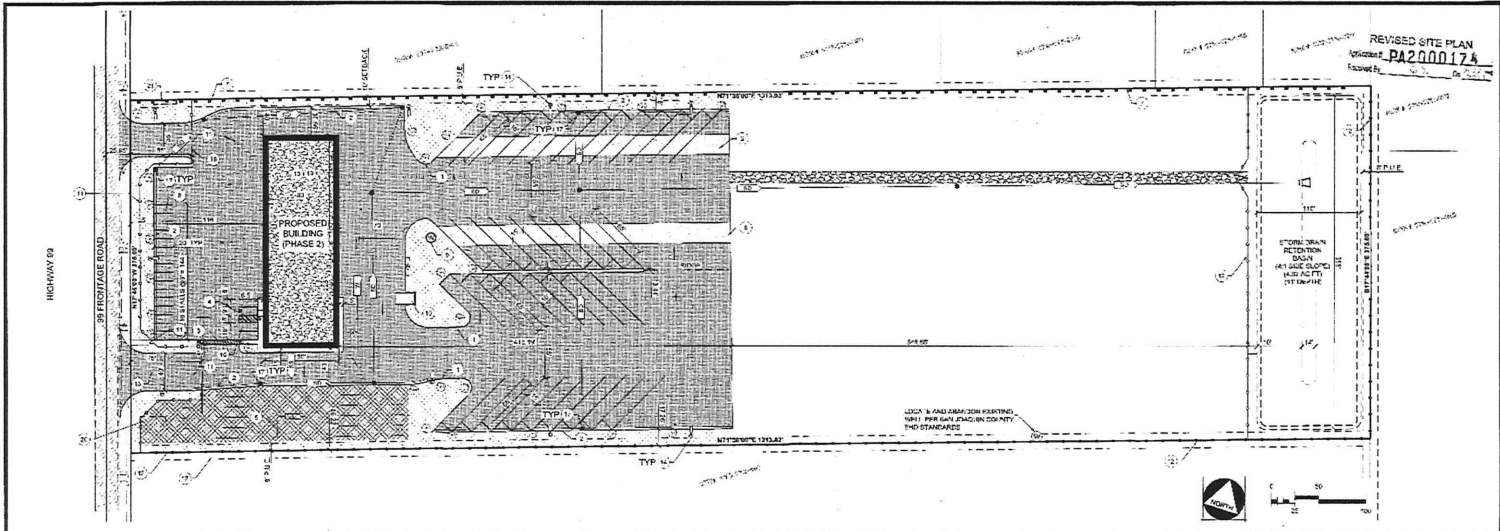

MCR ENGINEERING
 1242 DUPONT COURT
 MANTENCA, CA 95336
 TEL: (209) 239-6229
 FAX: (209) 239-8839



APPROVED: _____

PLAN REVISIONS		
NO.	DESCRIPTIONS	DATE

SITE PLAN INFORMATION

PROJECT LOCATION: 4082 SOUTH STATE ROUTE 99
 EAST FRONTAGE ROAD
 STOCKTON, CA 95215

ZONING: (IL) INDUSTRIAL LIGHT

EXISTING USE: VACANT

PROJECT DESCRIPTION: PROPOSED IMPROVEMENT TO SITE FOR BUILDING AND TRUCK PARKING

OWNER'S INFO: CK BROS. CARRIER INC AND SATBIR SINGH RAI

APPLICANT INFO: CK BROS. CARRIER INC AND SATBIR SINGH RAI
 16669 GOLD NUGGET TRAIL,
 LATHROP, CA. 95330

ASSESSOR'S PARCEL #: 179-172-560

AREA: 11.31 ACRES

PROPOSED PARKING: 36 TRUCK STALLS (65' X 15')
 18 CAR (20' X 9')
 1 VAN-ACCESSIBLE (PER CBC)
 1 CLEAN AIR/VANPOOLEVE (PER CBC)

WATER: PRIVATE WELL
 SEWER: PRIVATE SEPTIC
 STORM DRAINAGE: PRIVATE ON-SITE RETENTION BASIN



GENERAL NOTES:

- ALL JOB REQUIREMENTS SHALL BE OBSERVED AND CONTRACTOR SHALL NOTIFY EAST SAN JOAQUIN COUNTY STANDEARDS.
- CONSTRUCTION OF SEPTIC SYSTEM UNDER PERMITS BY ENVIRONMENTAL HEALTH IS REQUIRED.
- LEACH LINES SHALL BE A MINIMUM OF 12 FEET FROM STRUCTURES, 10 FEET FROM DRIVEWAYS, 10 FEET FROM WELLS, AND 5 FEET FROM PROPERTY LINES.
- NEW SEPTIC TANK SHALL BE A MINIMUM 48" X 80" X 10' WITH PROPERLY LINED STRUCTURE, DRIVEWAYS AND INLET FROM WELLS.
- ALL STORM DRAINAGE SHALL BE RETAINED ON SITE.

NOTES

- 1) UNIFORM CONCRETE CURB TYP.
- 2) 10" (1" ELEVATION) CURB AND FINISH.
- 3) ALL WELLS TO BE 12" DIA. WITH 12" DIA. SCHEDULE 40 STEEL PIPE. ALL WELLS SHALL BE A MINIMUM 48" X 80" X 10' WITH PROPERLY LINED STRUCTURE, DRIVEWAYS AND INLET FROM WELLS.
- 4) ADA PARKING STALL: LINE PARKING & LOADING STALLS PER CBC REQUIREMENTS.
- 5) 10' LEACH FIELD 15,000 SF.
- 6) 10' CONCRETE TR. 30" DIA. PIPE.
- 7) 10' (1" ELEVATION) CURB AND FINISH.
- 8) 3" (1" ELEVATION) CURB AND FINISH.
- 9) 10' WATER WELLS AND TANK LOCATION.
- 10) 10' CONCRETE TRASH AND RUBBER WITH SEEP FLOOR.
- 11) 20' X 40' 0" THROUGH IT FROM SLUING DATE.
- 12) 10' (1" ELEVATION) CURB AND FINISH.
- 13) 10' (1" ELEVATION) CURB AND FINISH.
- 14) 10' (1" ELEVATION) CURB AND FINISH.
- 15) 10' (1" ELEVATION) CURB AND FINISH.
- 16) 10' (1" ELEVATION) CURB AND FINISH.
- 17) 10' (1" ELEVATION) CURB AND FINISH.
- 18) 10' (1" ELEVATION) CURB AND FINISH.
- 19) 10' (1" ELEVATION) CURB AND FINISH.
- 20) 10' (1" ELEVATION) CURB AND FINISH.
- 21) 10' (1" ELEVATION) CURB AND FINISH.
- 22) 10' (1" ELEVATION) CURB AND FINISH.
- 23) 10' (1" ELEVATION) CURB AND FINISH.
- 24) 10' (1" ELEVATION) CURB AND FINISH.
- 25) 10' (1" ELEVATION) CURB AND FINISH.
- 26) 10' (1" ELEVATION) CURB AND FINISH.
- 27) 10' (1" ELEVATION) CURB AND FINISH.
- 28) 10' (1" ELEVATION) CURB AND FINISH.
- 29) 10' (1" ELEVATION) CURB AND FINISH.
- 30) 10' (1" ELEVATION) CURB AND FINISH.
- 31) 10' (1" ELEVATION) CURB AND FINISH.
- 32) 10' (1" ELEVATION) CURB AND FINISH.
- 33) 10' (1" ELEVATION) CURB AND FINISH.
- 34) 10' (1" ELEVATION) CURB AND FINISH.
- 35) 10' (1" ELEVATION) CURB AND FINISH.
- 36) 10' (1" ELEVATION) CURB AND FINISH.
- 37) 10' (1" ELEVATION) CURB AND FINISH.
- 38) 10' (1" ELEVATION) CURB AND FINISH.
- 39) 10' (1" ELEVATION) CURB AND FINISH.
- 40) 10' (1" ELEVATION) CURB AND FINISH.
- 41) 10' (1" ELEVATION) CURB AND FINISH.
- 42) 10' (1" ELEVATION) CURB AND FINISH.
- 43) 10' (1" ELEVATION) CURB AND FINISH.
- 44) 10' (1" ELEVATION) CURB AND FINISH.
- 45) 10' (1" ELEVATION) CURB AND FINISH.
- 46) 10' (1" ELEVATION) CURB AND FINISH.
- 47) 10' (1" ELEVATION) CURB AND FINISH.
- 48) 10' (1" ELEVATION) CURB AND FINISH.
- 49) 10' (1" ELEVATION) CURB AND FINISH.
- 50) 10' (1" ELEVATION) CURB AND FINISH.
- 51) 10' (1" ELEVATION) CURB AND FINISH.
- 52) 10' (1" ELEVATION) CURB AND FINISH.
- 53) 10' (1" ELEVATION) CURB AND FINISH.
- 54) 10' (1" ELEVATION) CURB AND FINISH.
- 55) 10' (1" ELEVATION) CURB AND FINISH.
- 56) 10' (1" ELEVATION) CURB AND FINISH.
- 57) 10' (1" ELEVATION) CURB AND FINISH.
- 58) 10' (1" ELEVATION) CURB AND FINISH.
- 59) 10' (1" ELEVATION) CURB AND FINISH.
- 60) 10' (1" ELEVATION) CURB AND FINISH.
- 61) 10' (1" ELEVATION) CURB AND FINISH.
- 62) 10' (1" ELEVATION) CURB AND FINISH.
- 63) 10' (1" ELEVATION) CURB AND FINISH.
- 64) 10' (1" ELEVATION) CURB AND FINISH.
- 65) 10' (1" ELEVATION) CURB AND FINISH.
- 66) 10' (1" ELEVATION) CURB AND FINISH.
- 67) 10' (1" ELEVATION) CURB AND FINISH.
- 68) 10' (1" ELEVATION) CURB AND FINISH.
- 69) 10' (1" ELEVATION) CURB AND FINISH.
- 70) 10' (1" ELEVATION) CURB AND FINISH.
- 71) 10' (1" ELEVATION) CURB AND FINISH.
- 72) 10' (1" ELEVATION) CURB AND FINISH.
- 73) 10' (1" ELEVATION) CURB AND FINISH.
- 74) 10' (1" ELEVATION) CURB AND FINISH.
- 75) 10' (1" ELEVATION) CURB AND FINISH.
- 76) 10' (1" ELEVATION) CURB AND FINISH.
- 77) 10' (1" ELEVATION) CURB AND FINISH.
- 78) 10' (1" ELEVATION) CURB AND FINISH.
- 79) 10' (1" ELEVATION) CURB AND FINISH.
- 80) 10' (1" ELEVATION) CURB AND FINISH.
- 81) 10' (1" ELEVATION) CURB AND FINISH.
- 82) 10' (1" ELEVATION) CURB AND FINISH.
- 83) 10' (1" ELEVATION) CURB AND FINISH.
- 84) 10' (1" ELEVATION) CURB AND FINISH.
- 85) 10' (1" ELEVATION) CURB AND FINISH.
- 86) 10' (1" ELEVATION) CURB AND FINISH.
- 87) 10' (1" ELEVATION) CURB AND FINISH.
- 88) 10' (1" ELEVATION) CURB AND FINISH.
- 89) 10' (1" ELEVATION) CURB AND FINISH.
- 90) 10' (1" ELEVATION) CURB AND FINISH.
- 91) 10' (1" ELEVATION) CURB AND FINISH.
- 92) 10' (1" ELEVATION) CURB AND FINISH.
- 93) 10' (1" ELEVATION) CURB AND FINISH.
- 94) 10' (1" ELEVATION) CURB AND FINISH.
- 95) 10' (1" ELEVATION) CURB AND FINISH.
- 96) 10' (1" ELEVATION) CURB AND FINISH.
- 97) 10' (1" ELEVATION) CURB AND FINISH.
- 98) 10' (1" ELEVATION) CURB AND FINISH.
- 99) 10' (1" ELEVATION) CURB AND FINISH.
- 100) 10' (1" ELEVATION) CURB AND FINISH.

LEGEND

- ASPHALT PAVING
- 30% GRAVEL ASPHALT PAVING AREA
- LANDSCAPING
- CONCRETE
- PHASE 1 - GRAVEL & PHASE 2 - BUILDING FOOTPRINT LOCATION
- MASONRY WALL
- 2" WOODEN BLOCK WITH 1/2" FENCE SLUING IN IN AND 2" BONDING COATS
- 4" HIGH CHAIN LINK FENCE WITH 3" X 6" WOODEN POSTS AND 1" X 6" WOODEN RAILS
- ON-SITE WATER WELL AND TANK
- WATER LINE
- WATER VALVE
- SANITARY SEWER LINE
- STORM SEWER MANHOLE
- STORM SEWER MANHOLE
- CATCH BASIN
- STORM SEWER MANHOLE
- PROPOSED DRAINAGE DIRECTION
- PARKING LOT AND SECURITY LIGHTING
- TERRAIN
- EXISTING POWER POLES
- EXISTING OVERHEAD ELECTRICAL ALONG TO FRONTAGE

TECH TRUCK & AUTO, INC.
 STOCKTON
 SITE PLAN
 APRIL 17, 2018

811
 Know what's below.
 Call before you dig.
 811 / 800-227-2600

DATE: 11/20/17
 SCALE: AS SHOWN
 DRAWN BY: RFL
 CHECKED BY: DC

SHEET NO.
1
 OF 1 SHEET

Mitigation Monitoring Reporting Plan-PA-2000174 (SA) January 9, 2023

Impact	Mitigation Measure/Condition	Type of Review		Agency for Monitoring and Reporting Compliance	Action Indicating Compliance or Review	Verification of Compliance or Annual Review of Conditions		
		Monitoring	Reporting			By	Date	Remarks
III. Air Quality	Construction and Operation - Exempt from Off-site Fee		X	San Joaquin Valley Air Pollution Control District	For each project phase, within 30-days of issuance of the first certificate of occupancy, if applicable, submit to the District a summary report of the construction start, and end dates, and the date of issuance of the first certificate of occupancy. Otherwise, submit to the District a summary report of the construction start and end dates within 30-days of the end of each phase of construction.			
III. Air Quality	Construction and Operation - Recordkeeping		X	San Joaquin Valley Air Pollution Control District	For each project phase, all records shall be maintained on site during construction and for a period of ten years following either the end of construction or the issuance of the first certificate of occupancy, whichever is later. Records shall be made available for District inspection upon request.			
III. Air Quality	Construction and Operational Dates		X	San Joaquin Valley Air Pollution Control District	For each project phase, maintain records of (1) the construction start and end dates and (2) the date of issuance of the first certificate of occupancy, if applicable			
III. Air Quality	Increase Density		X	San Joaquin Valley Air Pollution Control District	1.46 Jobs, unknown DU			
III. Air Quality	Increase Diversity		X	San Joaquin Valley Air Pollution Control District	Projects located in various land uses			
III. Air Quality	Improve walkability Design		X	San Joaquin Valley Air Pollution Control District	121.5 Nodes/Square Mile			
III. Air Quality	Improve Destination Accessibility		X	San Joaquin Valley Air Pollution Control District	0.5 miles (distance to downtown or job center)			
IV. Biological Resources	Participation in the SJMSCP	X		San Joaquin Council of Governments	The developer shall apply to the San Joaquin Council of Governments (SJCOG) for coverage under the San Joaquin County Multi-Species Open Space and Habitat Conservation Plan (SJMSCP). The project site shall be inspected by the SJMSCP biologist, who will recommend which Incidental Take Minimization Measures set forth in the SJMSCP should be applied to the project and implemented. The project applicant shall pay the required SJMSCP fee, if any, and be responsible for the implementation of the specified Incidental Take Minimization Measures.			



December 21, 2022

Planning Department
County of San Joaquin
1810 East Hazelton Avenue
Stockton, CA 95205

Re: Air Impact Assessment (AIA) Application Approval
ISR Project Number: C-20220465
Land Use Agency: County of San Joaquin
Land Use Agency ID Number: PA-2000174 (SA)

To Whom It May Concern:

The San Joaquin Valley Air Pollution Control District (District) has approved the Air Impact Assessment (AIA) application for the Ck Bros. Carrier Truck Yard project, located at 4082 State Route 99 E Frontage Road in Stockton, California. The Project consists of a truck and trailer parking lot on 11.31 acres, which includes 18 passenger vehicle parking spaces, 36 combined truck and trailer parking spaces, an 18,000 square foot service building, and a storm water retention pond. The District has determined that the mitigated baseline emissions for construction and operation will be less than two tons NOx per year and two tons PM10 per year. Pursuant to District Rule 9510 Section 4.3, this project is exempt from the requirements of Section 6.0 (General Mitigation Requirements) and Section 7.0 (Off-site Emission Reduction Fee Calculations and Fee Schedules) of the rule. As such, the District has determined that this project complies with the emission reduction requirements of District Rule 9510 and is not subject to payment of off-site fees.

Pursuant to District Rule 9510, Section 8.4, the District is providing you with the following information:

- A notification of AIA approval (this letter)
- A statement of tentative rule compliance (this letter)
- An approved Monitoring and Reporting Schedule
- A copy of the Air Impact Assessment Application

Certain emission mitigation measures proposed by the applicant may be subject to approval or enforcement by the County of San Joaquin. No provision of District Rule 9510 requires action on the part of the County of San Joaquin, however, please review the enclosed list of mitigation measures and notify the District if the proposed mitigation

Samir Sheikh
Executive Director(Air Pollution Control Officer)

Northern Region
4800 Enterprise Way
Modesto, CA 95356-8718
Tel: (209) 557-6400 FAX: (209) 557-6475

Central Region (Main Office)
1990 E. Gettysburg Avenue
Fresno, CA 93726-0244
Tel: (559) 230-8000 FAX: (559) 230-8081

Southern Region
34946 Flyover Court
Bakersfield, CA 93308-9725
Tel: (661) 392-5500 FAX: (661) 392-5586

Page 2

measures are inconsistent with your agency's requirements for this project. The District can provide the detailed emissions analysis upon request.

If you have any questions, please contact Mr. Harout A Sagherian by telephone at (559) 230-5860 or by email at harout.sagherian@valleyair.org.

Sincerely,

Brian Clements
Director of Permit Services

A handwritten signature in black ink, appearing to read 'Mark Montelongo', with a stylized flourish at the end.

For: Mark Montelongo
Program Manager

Enclosures

Indirect Source Review Complete Project Summary Sheet & Monitoring and Reporting Schedule

(District Enforced Emission Reduction Measures Continued)

Project Name:	CK BROS. CARRIER TRUCK YARD
Applicant Name:	CK BROS. CARRIER, INC
Project Location:	4082 STATE ROUTE 99 E FRONTAGE ROAD SR 99 E FRONTAGE ROAD AND CLARK DRIVE APN(s): 179-172-56
Project Description:	LAND USE: Other - 11 Acres - Other Other - 11 Acres - Other Other - 11 Acres - Other Commercial/Retail - 18000 Square Feet - Free-Standing Discount Store Commercial/Retail - 18000 Square Feet - Free-Standing Discount Store ACREAGE: 11.81
ISR Project ID Number:	C-20220465
Applicant ID Number:	C-303743
Permitting Public Agency:	COUNTY OF SAN JOAQUIN
Public Agency Permit No.	PA-2000174 (SA)

Existing Emission Reduction Measures

Enforcing Agency	Measure	Quantification	Notes
There are no Existing Measures for this project.			

Non-District Enforced Emission Reduction Measures

Enforcing Agency	Measure	Specific Implementation	Source Of Requirements
SAN JOAQUIN COUNTY	Improve Pedestrial Network	Within Project Site	
SAN JOAQUIN COUNTY	Install Electric Vehicle (EV) Chargers	Install electric vehicle charger with 1 outlets total	

Number of Non-District Enforced Measures: 2

District Enforced Emission Reduction Measures

Enforcing Agency	Measure	Specific Implementation	Measure For Compliance	District Review
------------------	---------	-------------------------	------------------------	-----------------

Indirect Source Review Complete Project Summary Sheet & Monitoring and Reporting Schedule

(District Enforced Emission Reduction Measures Continued)

Enforcing Agency	Measure	Specific Implementation	Measure For Compliance	District Review
SJVAPCD	Construction and Operation - Exempt from Off-site Fee	For each project phase, within 30-days of issuance of the first certificate of occupancy, if applicable, submit to the District a summary report of the construction start, and end dates, and the date of issuance of the first certificate of occupancy. Otherwise, submit to the District a summary report of the construction start and end dates within 30-days of the end of each phase of construction.	(Compliance Dept. Review)	
SJVAPCD	Construction and Operation - Recordkeeping	For each project phase, all records shall be maintained on site during construction and for a period of ten years following either the end of construction or the issuance of the first certificate of occupancy, whichever is later. Records shall be made available for District inspection upon request.	(Compliance Dept. Review)	
SJVAPCD	Construction and Operational Dates	For each project phase, maintain records of (1) the construction start and end dates and (2) the date of issuance of the first certificate of occupancy, if applicable.	(Compliance Dept. Review)	
SJVAPCD	Increase Density	1.46 Jobs, unknown DU	(Compliance Dept. Review)	
SJVAPCD	Increase Diversity	Project located in various land uses	(Compliance Dept. Review)	
SJVAPCD	Improve Walkability Design	121.5 Nodes/square mile	(Compliance Dept. Review)	
SJVAPCD	Improve Destination Accessibility	0.5 miles (distance to downtown or job center)	(Compliance Dept. Review)	

Number of District Enforced Measures: 7