

2023-00045

FILED

February 10, 2023

**KRISTIN B. CONNELLY
CLERK-RECORDER**

By *[Signature]*
Deputy clerk



**CALIFORNIA ENVIRONMENTAL QUALITY ACT
Notice of Exemption**

To: Office of Planning and Research
P.O. Box 3044, Room 113
Sacramento, CA 95812-3044

From: Contra Costa County
Department of Conservation and
Development
30 Muir Road
Martinez, CA 94553

County Clerk, County of Contra Costa

Project Title: San Miguel Drive Pedestrian Path, Project #: WO1025, CP#: 22-45

Project Applicant: Contra Costa County Public Works Dept., 255 Glacier Drive, Martinez CA 94553
Main: (925) 313-2000, Contact: Sandeep Singh, (925) 313-2022

Project Location: San Miguel Drive between Newell Avenue to Adeline Drive, City of Walnut Creek and unincorporated Walnut Creek, Contra Costa County

Lead Agency: Department of Conservation and Development, 30 Muir Road, Martinez, CA 94553
Main: (925) 655-2705, Contact: Syd Sotoodeh (925) 655-2877

Project Description: The project consists of constructing an all-weather, Americans with Disabilities Act (ADA) compliant pedestrian path on the south side of San Miguel Drive. The new pedestrian path will be constructed as an asphalt path with berm in unincorporated Walnut Creek, and as a concrete sidewalk with curb and gutter in the City of Walnut Creek. Existing shoulder material will be removed. Conforms between the existing residential driveways and new sidewalk will be constructed. Drainage improvements, such as new storm drain lines and inlet relocations, will be installed as needed. Existing roadside trees and residential improvements will be protected in place where feasible. Construction is anticipated to occur in 2025 and take approximately 60 days to complete. No night or weekend work will occur. Real Estate transactions, utility relocations, temporary traffic control, and tree and vegetation trimming may be necessary.

Exempt Status:

- Ministerial Project (Sec. 21080[b][1]; 15268)
- Categorical Exemption: Class 1(c)
- Declared Emergency (Sec. 21080[b][3]; 15269[a])
- General Rule of Applicability (Sec. 15061[b][3])
- Emergency Project (Sec. 21080[b][4]; 15269[b][c])
- Other Statutory Exemption (Sec.)

Reasons why project is exempt: The activity consists of constructing an ADA-compliant pedestrian path along an existing street with no expansion of use, pursuant to Article 19, Section 15301(c) of the CEQA Guidelines.

If filed by applicant:

1. Attach certified document of exemption finding.
2. Has a Notice of Exemption been filed by the public agency approving the Yes No project?

Signature: *Syd Sotoodeh* Date: 01/23/2023 Title: Senior Planner

Contra Costa County Department of Conservation and Development

- Signed by Lead Agency
- Signed by Applicant

AFFIDAVIT OF FILING AND POSTING

I declare that on FEB 10 2023 I received and posted this notice as required by California Public Resources Code Section 21152(c). Said notice will remain posted for 30 days from the filing date.

Signature 

Deputy Clerk
Title

Applicant

Public Works Department
255 Glacier Drive
Martinez, CA 94553
Attn: Sandeep Singh *JCS*
Environmental Services Division
Phone: (925) 313-2022

Department of Fish and Wildlife Fees Due

- De Minimis Finding - \$0
- County Clerk - \$50
- Conservation and Development - \$25

Total Due: \$75 Receipt #: _____

CONTRA COSTA COUNTY CALIFORNIA

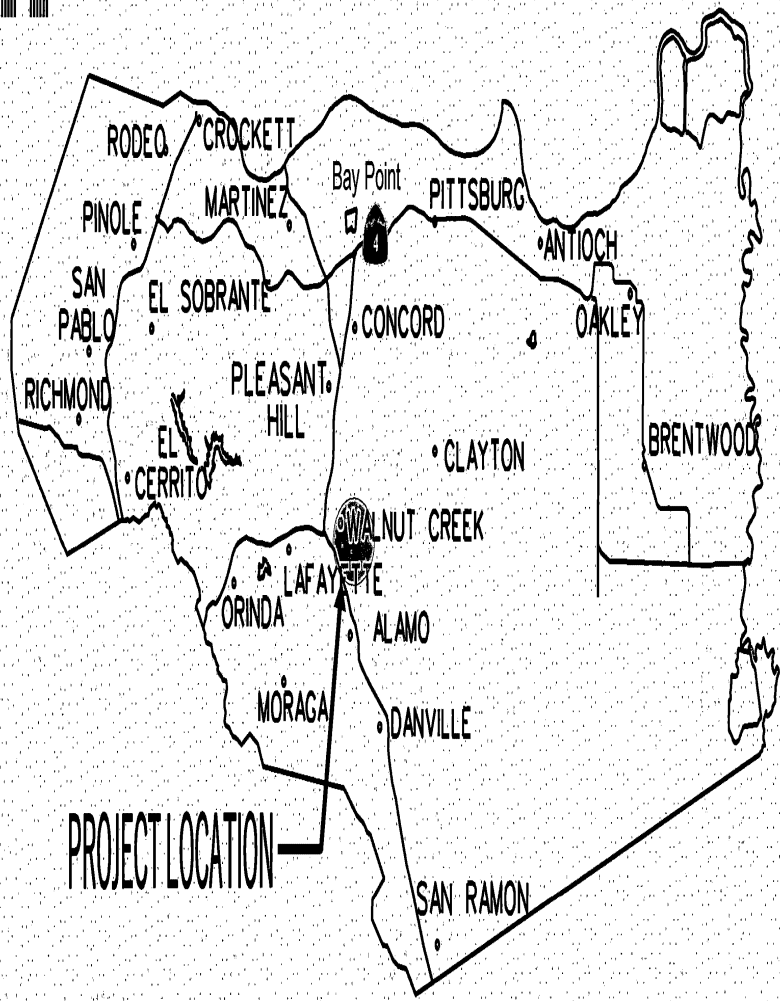

Contra Costa County
Public Works
Department

265 GLACIER DRIVE, MARTINEZ, CA 94553 PH: (925)313-2000 FAX: (925)313-2333

PROJECT LOCATION MAP

San Miguel Drive Pedestrian Path

DB: JS CB: JV DATE: NOV 22 SHEET: 1 OF 1

Figure 1: Regional Location Map

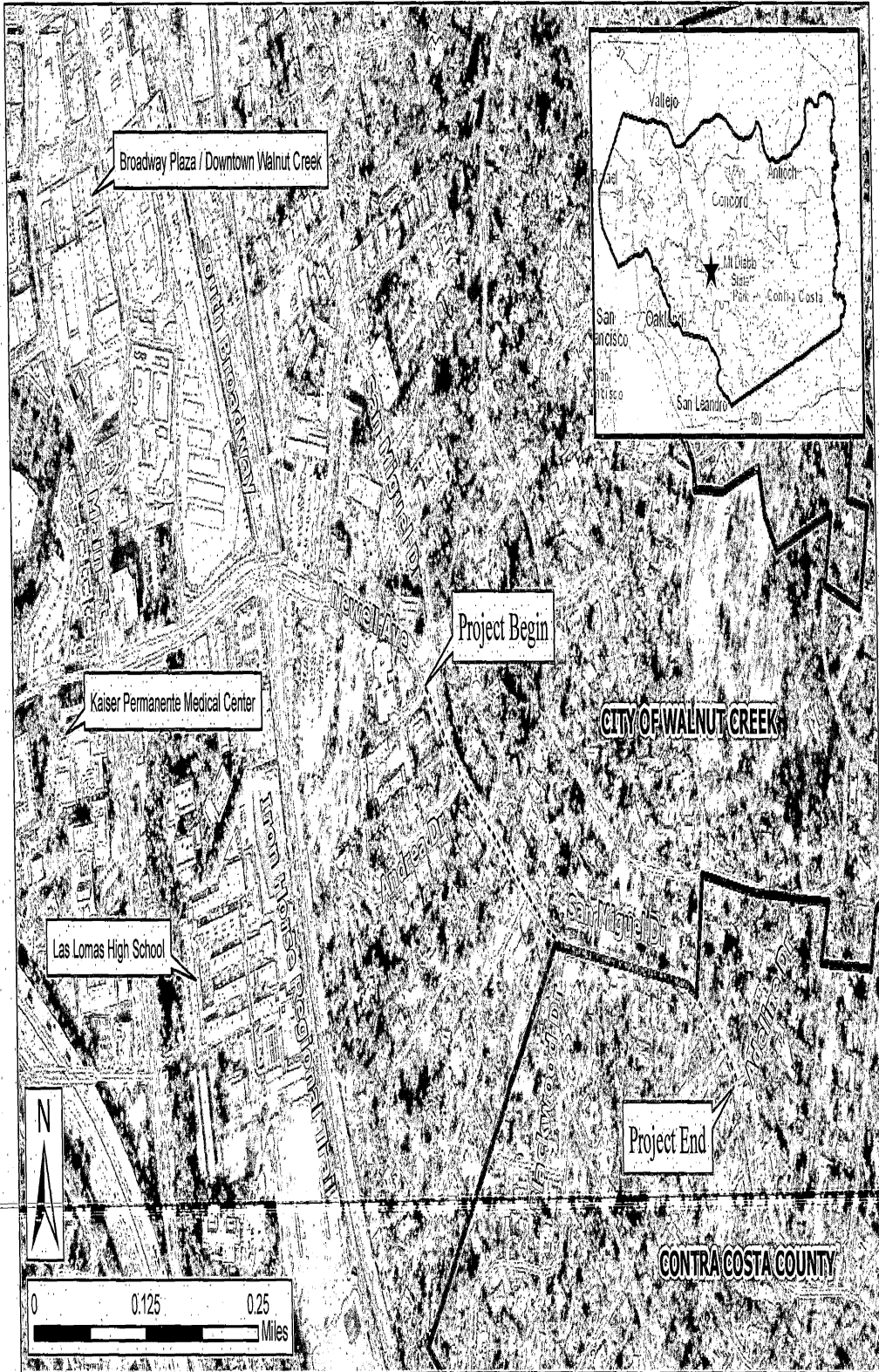

 <p>Contra Costa County Public Works Department</p> <p>255 GLACIER DRIVE MARTINEZ, CALIFORNIA 94533 PH: (925) 313-2000 FAX: (925) 313-2333</p>	PROJECT VICINITY MAP - CONTRA COSTA COUNTY		
	San Miguel Drive Pedestrian Path		
FEDERAL ID NO:	DB: JS CB: JV	DATE: JAN 2023	Page 1 of 1

Figure 2: Project Vicinity Map



- NOTES:**
1. Sidewalk within City of Walnut Creek shall conform to City Standard Plans CC-1 to CC-9.
 2. Drainage has not been finalized.
 3. Utility poles will typically have an AC dike or 6" curb, 10' before and after the pole, when possible.
 4. Obstructions may need to be relocated.
 5. Conform pathway to existing driveways.
 6. Curb ramps are Type C unless otherwise noted. Proposed curb ramp cases may change upon further design and as dictated by site conditions.

LEGEND

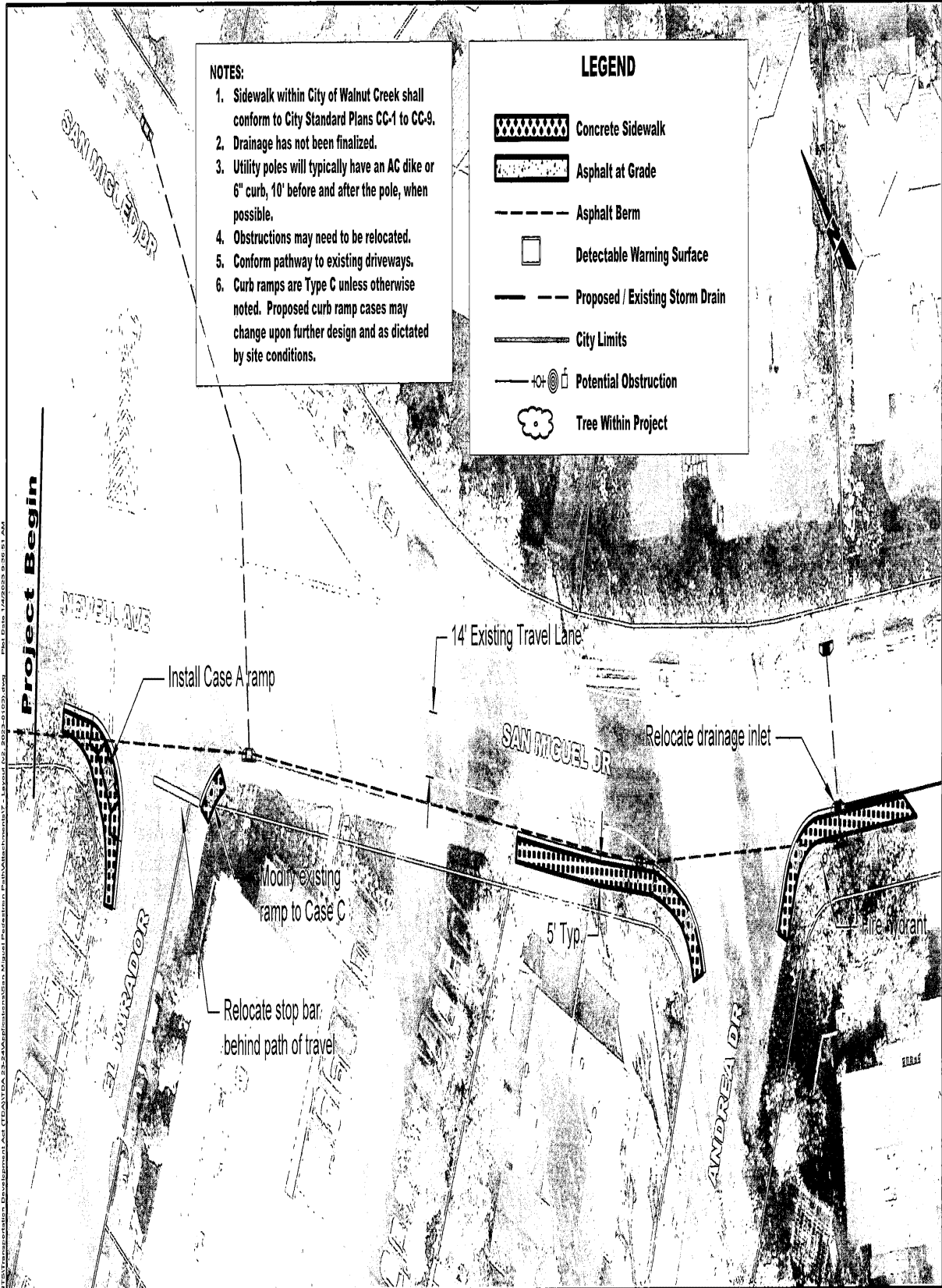
	Concrete Sidewalk
	Asphalt at Grade
	Asphalt Berm
	Detectable Warning Surface
	Proposed / Existing Storm Drain
	City Limits
	Potential Obstruction
	Tree Within Project

<p>Contra Costa County Public Works Department 255 Glacier Drive Martinez, CA 94553 PH: (925) 313-2000 FAX: (925) 313-2333</p>	CONCEPTUAL PLAN		DRAWN BY: JS	DATE: 01/03/2023	SCALE: 1" = 15'
	SAN MIGUEL DRIVE PEDESTRIAN PATH		CHECKED BY: JV	SHEET: 1 OF 5	
	NEWELL AVENUE TO ADELIN DRIVE		CAD FILE: SAN MIGUEL DRIVE PED PATH		

Figure 3: Sheet 1 of 5

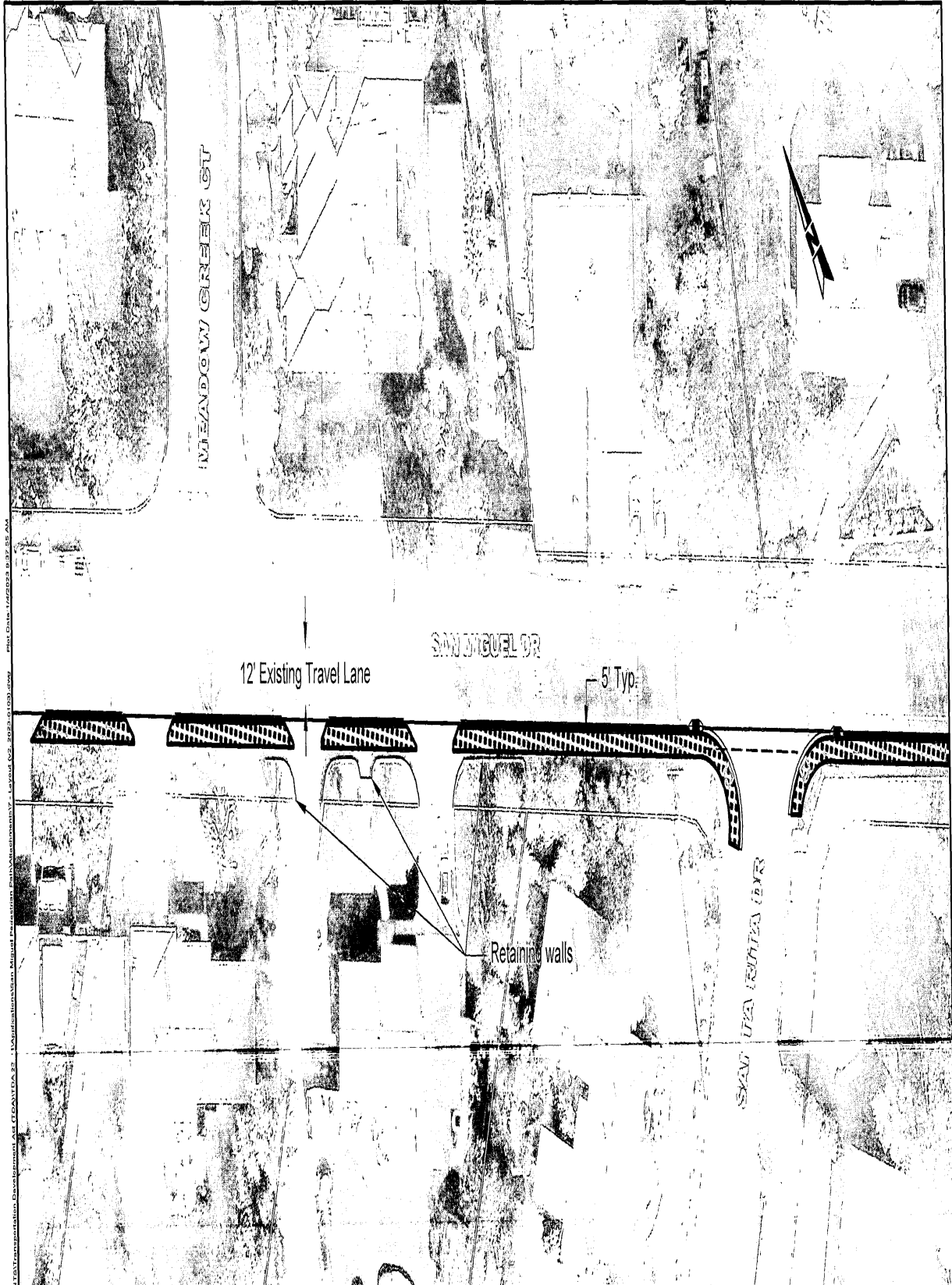

File Path: C:\Users\jjs\OneDrive\Documents\Projects\San Miguel Drive Ped Path\CONCEPTUAL PLAN - SAN MIGUEL DRIVE PED PATH.dwg
 Plot Date: 1/3/2023 10:35 AM
 Plot Scale: 1" = 15'

 Contra Costa County Public Works Department 255 Glacier Drive Martinez, CA 94553 PH: (925) 313-2000 FAX: (925) 313-2333	CONCEPTUAL PLAN		DRAWN BY: JS	DATE: 01/03/2023	SCALE: 1" = 15'
	SAN MIGUEL DRIVE PEDESTRIAN PATH		CHECKED BY: JV	SHEET: 2 OF 5	
	NEWELL AVENUE TO ADELINE DRIVE			CAD FILE: SAN MIGUEL DRIVE PED PATH	

Figure 3: Sheet 2 of 5



 Contra Costa County Public Works Department 255 Glacier Drive Martinez, CA 94553 PH: (925) 313-2000 FAX: (925) 313-2333	CONCEPTUAL PLAN		DRAWN BY: JS	DATE: 01/03/2023	SCALE: 1" = 15'
	SAN MIGUEL DRIVE PEDESTRIAN PATH		CHECKED BY: JV	SHEET: 3 OF 5	
	NEWELL AVENUE TO ADELINE DRIVE			CAD FILE: SAN MIGUEL DRIVE PED PATH	

Figure 3: Sheet 3 of 5



 <p>Contra Costa County Public Works Department 255 Glacier Drive Martinez, CA 94553 PH: (925) 313-2000 FAX: (925) 313-2333</p>	CONCEPTUAL PLAN		DRAWN BY: JS	DATE: 01/03/2023	SCALE:
	SAN MIGUEL DRIVE PEDESTRIAN PATH		CHECKED BY: JV	SHEET: 4 OF 5	1" = 15'
	NEWELL AVENUE TO ADELIN DRIVE		CAD FILE: SAN MIGUEL DRIVE PED PATH		

Figure 3: Sheet 4 of 5

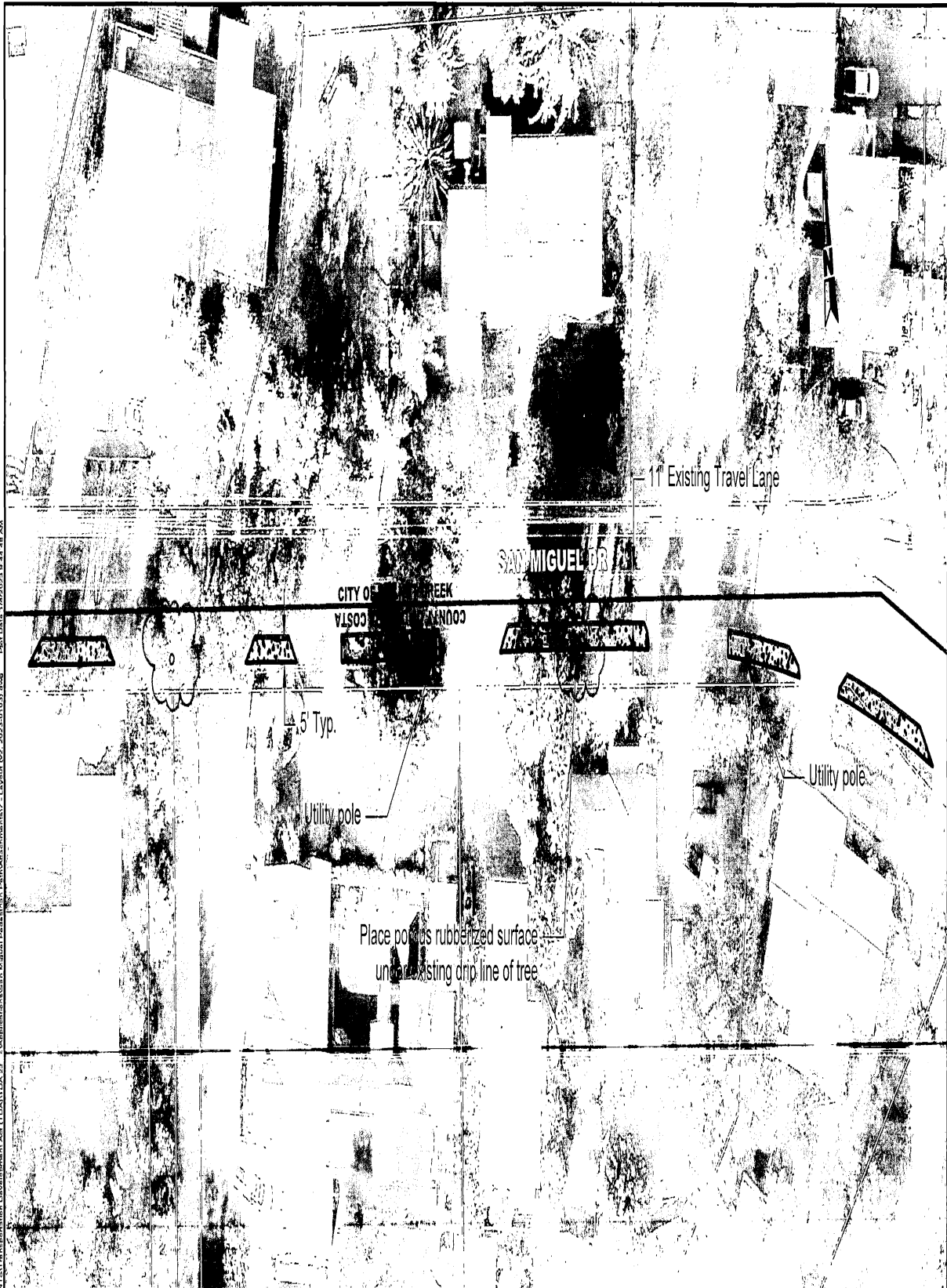

 Contra Costa County Public Works Department 255 Glacier Drive Martinez, CA 94553 PH: (925) 313-2000 FAX: (925) 313-2333	CONCEPTUAL PLAN		DRAWN BY: JS	DATE: 01/03/2023	SCALE: 1" = 45'
	SAN MIGUEL DRIVE PEDESTRIAN PATH		CHECKED BY: JV	SHEET: 5 OF 5	
	NEWELL AVENUE TO ADELINE DRIVE		CAD FILE: SAN MIGUEL DRIVE PED PATH		

Figure 3: Sheet 5 of 5