

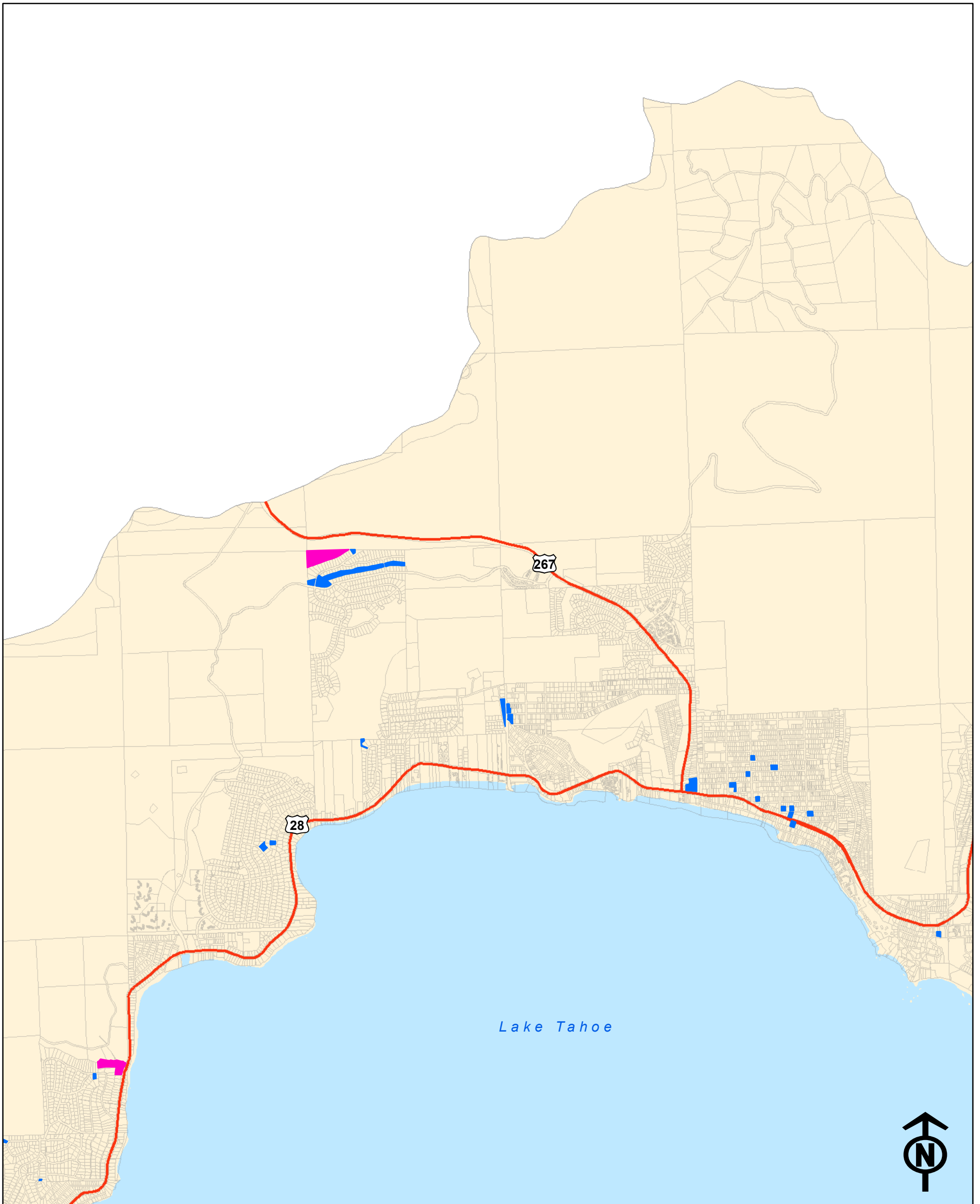

# Placer County Fuel Hazard Reduction- CTA 22037L



## CTA22037- Placer County Hand Thinning Project Area

-  No Limited Operating Period
-  Limited Operating Period- No work February 15 through September 15

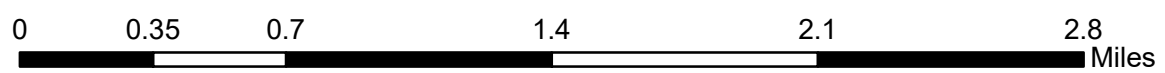

April 2023



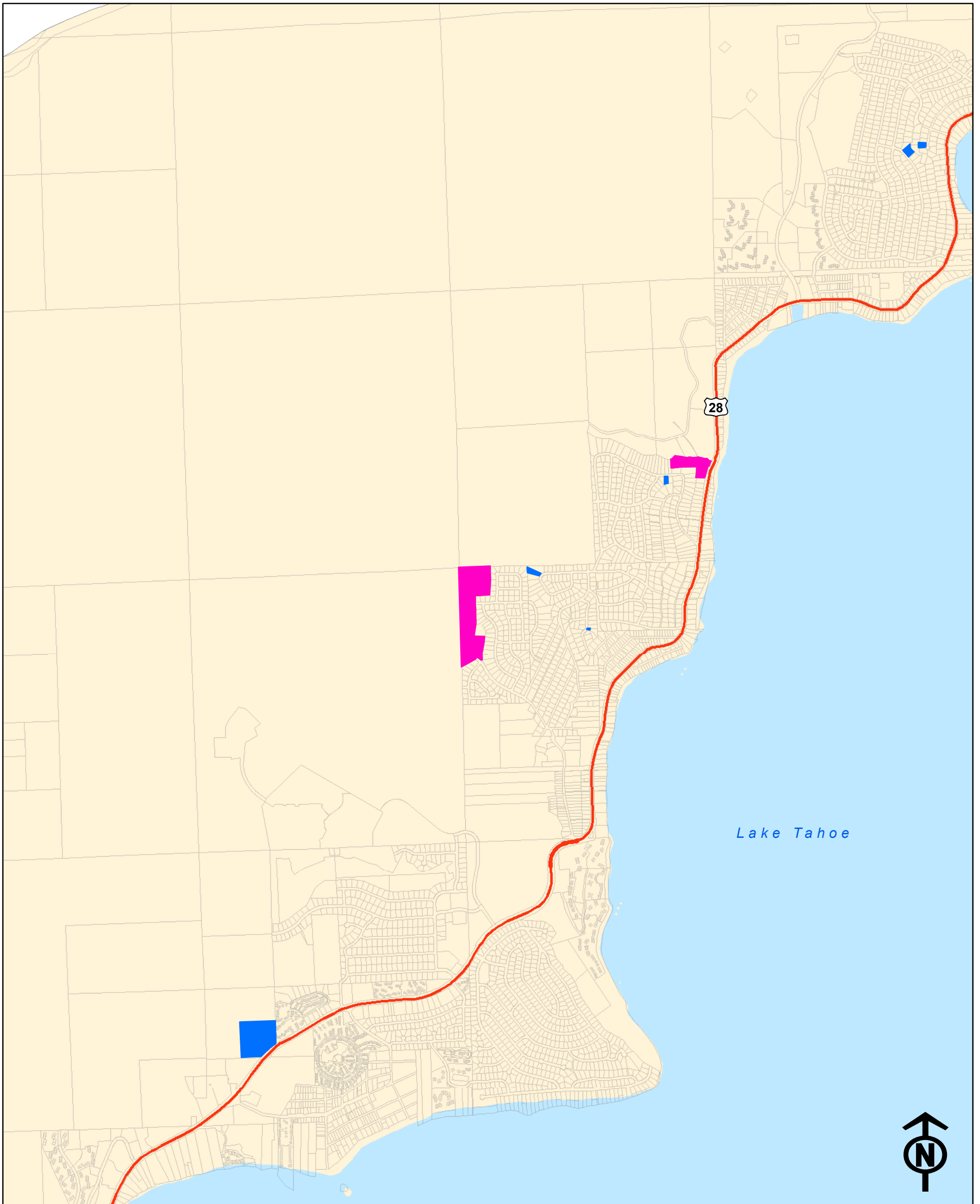

Source: CTC, TRPA

# Placer County Fuel Hazard Reduction- CTA 22037L

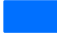

## CTA22037- Placer County Hand Thinning Project Area

-  No Limited Operating Period
-  Limited Operating Period- No work February 15 through September 15

April 2023

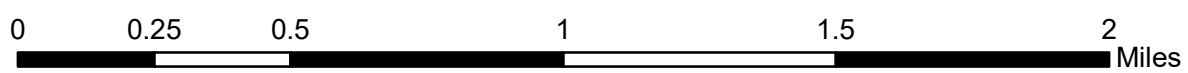

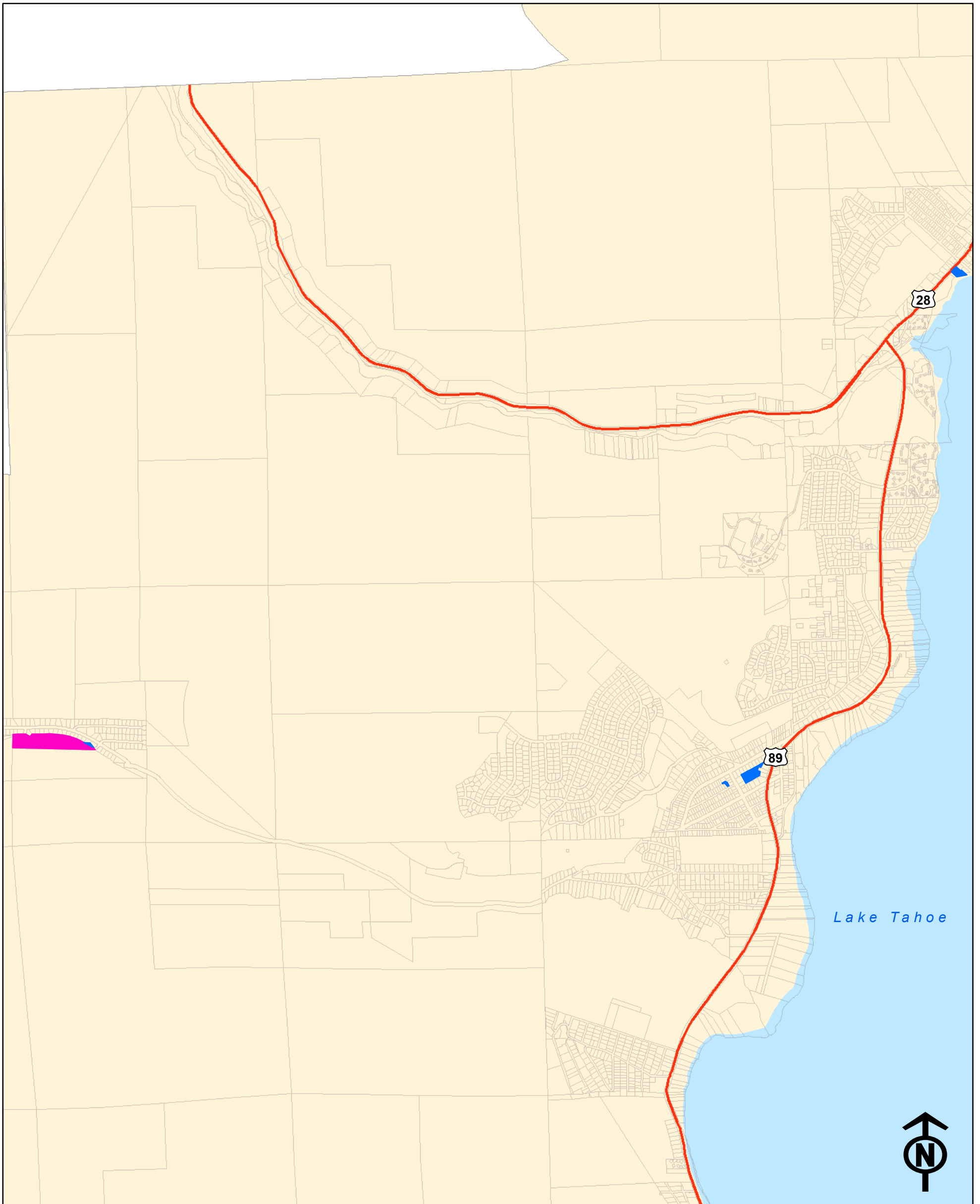

Source: CTC, TRPA

# Placer County Fuel Hazard Reduction- CTA 22037L

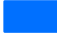

## CTA22037- Placer County Hand Thinning Project Area

-  No Limited Operating Period
-  Limited Operating Period- No work February 15 through September 15

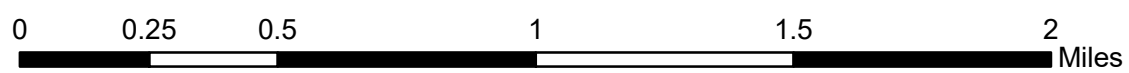

April 2023





Source: CTC, TRPA

# Placer County Fuel Hazard Reduction- CTA 22037L



## CTA22037- Placer County Hand Thinning Project Area

-  No Limited Operating Period
-  Limited Operating Period- No work February 15 through September 15

0 0.125 0.25 0.5 0.75 1 Miles

April 2023



Source: CTC, TRPA