



April 30, 2021

American Premiere Homes
7116 Valjean Avenue
Van Nuys, California 91406

Attn: Hagai Rapaport

**Subj: Cultural Resources Phase I Assessment for 163 Lot Single-Family Subdivision on W. Avenue I, West of W. 40th Street in Lancaster, California
(Envicom Project #2020-192-01)**

Dear Mr. Rapaport:

Envicom Corporation (Envicom) has completed a Cultural Resources Phase I Assessment (Phase I Assessment) for a proposed residential subdivision Project on W. Avenue I, West of W. 40th Street in the City of Lancaster, California (Project) (**Figure 1**). The Project is located in Los Angeles County, and involves the planned construction of 163 single family homes and associated infrastructure on 30 gross acres (Project site or Subject Property) (**Figure 2**). The general location of the Project site is as follows:

**United States Geological Survey 7.5' Quadrangle: Lancaster West
Township: 7 North; Range: 13 West
Latitude: 34° 42'26.46"North; Longitude: 118°12'18.56"West**

The Phase I Assessment included a cultural resource record search conducted by the South Central Coastal Information Center (SCCIC) and a Native American cultural resource record search conducted by the California Native American Heritage Commission (NAHC). Both record searches examined the Project site plus a 0.25-mile area ("study area") around the Project site (see Figure 1). Additional databases included historic regional maps, historic United States Geological Survey (USGS) maps, and historic Google Earth images. The University of California Santa Barbara (UCSB) Library Historic Aerial Photograph Database was also examined. In addition, because paleontological resources were of concern, a record search was requested from the Natural History Museum of Los Angeles County (NHM), with the same 0.25-mile Project study area.

The purpose of a cultural resource record search is to identify any known cultural resources previously recorded within, or immediately adjacent to, the Project site, to provide cultural resource context for the Project from the examination of the study area, and to assess the overall cultural resource sensitivity of the Project region. A cultural resource is often defined as any building, structure, object, or archaeological site older than 50-years in age and can include historic or prehistoric locations of human habitation or occupation.



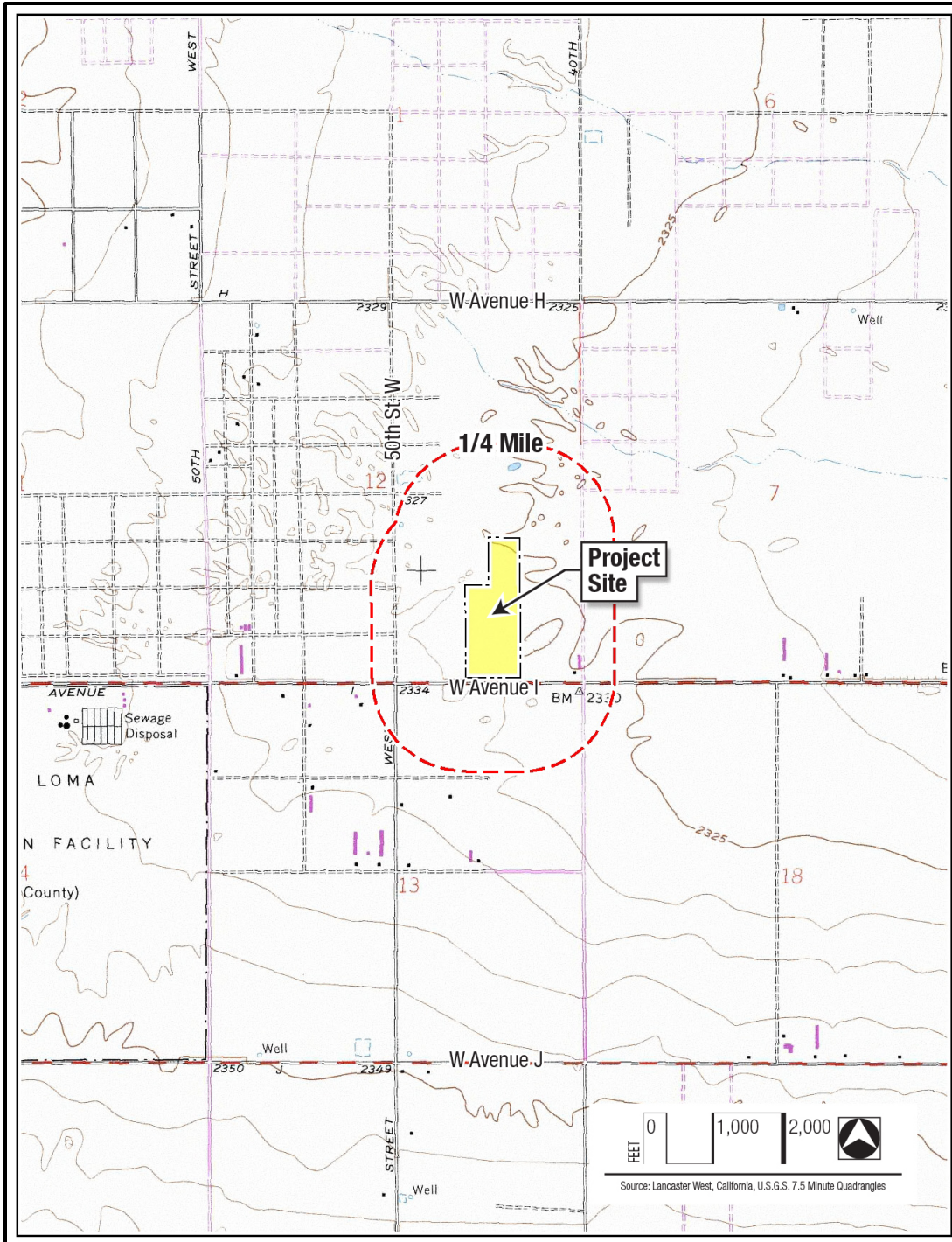

Figure 1: Project location in Los Angeles County, California, with the 0.25-mile study area shown (West Lancaster Quadrangle Topographic Map).



Figure 2: The Project property, showing the current conditions (2017 Google Earth Image).

RECORD SEARCH RESULTS

SCCIC and NAHC Record Searches

On March 5, 2021, Envicom submitted a request to the SCCIC to conduct a search of their database for cultural resources located within the Subject Property, and within the surrounding study area (defined as the Subject Property, plus a 0.25-mile buffer area) for regional cultural resource context (see Figure 1). The record search included a request for all complete site records for cultural resources within or adjacent to the Subject Property, as well as copies of all cultural resource technical reports that intersected with all or part of the Subject Property. Envicom also contacted the NAHC and the NHM on March 5, 2021, with a similar record search request.

Envicom received the record search results from the SCCIC on April 23, 2021. The SCCIC record search found no previously identified cultural resources located within the Subject Property nor within the 0.25-mile surrounding study area. The SCCIC did, however, identify one (1) cultural resource report that involved the entire Subject Property. A cultural resource report titled “Cultural Resources Technical Report, City of Lancaster General Plan Update” was written in 2006 by CRM TECH. This report produced a general cultural resource study for the City of Lancaster, which identified 700 cultural resources, within the City region, none of which have any issues of relevance for the Project. Since this Phase I Assessment involved only a record search with the SCCIC, the Property should be considered not previously surveyed for archaeological resources. An additional three (3) cultural resource reports involved part of the surrounding Project study area. None of these additional reports had information relevant to the Project. All relevant SCCIC cultural resource reports are summarized in **Appendix A**.

The results from the 2021 NAHC record search were received on March 16, 2021, with negative findings. If the Lead/Permitting Agency for the Project is required to perform an Assembly Bill (AB)-52 process, the NAHC letter should be made a part of the Native American consultation record. Envicom did not contact Native American groups on the NAHC list, as communications with Tribal Group representatives is the responsibility of the Lead/Permitting Agency, if required for this Project.

The SCCIC and NAHC findings were, therefore, negative for cultural resources within the Subject Property. The Subject Property was also determined to not be within a region considered sensitive for prehistoric or older historic cultural resources. Any findings from the SCCIC as to the physical location of cultural resources, except for public-knowledge built environment resources, are confidential by state law and are, therefore, not included in this Phase I Assessment. Copies of the request letter to the SCCIC, NAHC, and NHM are included in **Appendix B**, as are the response letters from the NAHC and NHM. The Principal Author’s resume is provided in **Appendix C**.

Historical Map Database Search

Examination of historical maps included fourteen (14) USGS maps, dating between 1915 and 1981. The 1915 Elizabeth Lake USGS map shows no development on the Subject Property, but does show limited regional development (**Figure 3**). The 1958 Lancaster USGS map also shows limited local development, and again no buildings within the Subject Property (**Figure 4**). The oldest aerial photograph in the UCSB Library historic aerial photography database is from 1928 (**Figure 5**). This photo shows the Subject Property as undeveloped. Google Earth satellite images show the local area and Project site from 1985 to current, with constant in-fill development of the surrounding region consisting of residential and commercial development, but no development of the Subject Property. The review of historical maps, satellite images, and aerial images indicated that the Project Property is not sensitive for older historic archaeological sites dating to prior to the 1940s (World War II), which is considered the limit for older historic cultural resource sensitivity for the region.

Field Survey Results

Envicom staff visited the Subject Property on March 19, 2021. The Subject Property is a undeveloped parcel that has been used for the dumping of construction material and trash for many years (**Figure 6, Figure 7, Figure 8, Figure 9, Figure 10, and Figure 11**). Ground visibility was good to poor, with most of the landscape surface having sparse to thick vegetation covering the site terrain. The surface survey did identify a specific area with a small number of older historic artifacts, but no prehistoric artifacts were observed. The cultural resource findings were, therefore, ***positive for a single older historic cultural resource within the Subject Property.***

Cultural Resource “Lancaster 1” is a small (15 meter by 15 meter) archaeological site that consists of a older historic can scatter of nine (9) cans with barbed wire dating to the 1930s-1940s (**Figure 12, Figure 13 and Figure 14**). The boundary of the cultural resource was determined by observed measurement of the area with artifacts, which was aided by excellent visibility. Each of the cans observed was opened using a “Church Key” opener. This style of can opener would puncture both sides of the top of a can, leaving two triangle cutouts in the metal. Based on a close study of the surface, the site does not appear to have any depth, and does not appear to have a subsurface component; all associated artifacts are on the surface. All information related to the cultural resource, therefore, has been provided in the State of California Department of Parks and Recreation site form labeled “Lancaster 1,” which will be submitted to the SCCIC.

The “Lancaster 1” cultural resource is very close to West Avenue I, and was probably oriented on that local travel route. The association of barbed wire from the same time period may indicate a linked event, such as installing or removing boundary fencing along the road. Overall, the site is evidence that people were working within, or traveling through, the Lancaster area in the 1930-1940s, but does not show anything else of significance about the area nor about California history.



*Figure 3: The 1915 Elizabeth Lake USGS Map
(red cross marks the Project location).*



*Figure 4: The 1958 Lancaster USGS Map
(red cross marks the Project location).*



*Figure 5: The Project area in 1928 image, showing the Subject Property (center)
(UCSB Historic Aerial Image Database).*



Figure 6: Overview of the Subject Property, facing south.



Figure 7: Overview of the Project site, showing one of the modern trash dumps.



Figure 8: Overview of the Subject Property, facing south.



Figure 9: Overview of Subject Property, showing some of the dumped modern construction material (facing east).



Figure 10: Overview of the Subject Property, facing north.



Figure 11: Overview of “Lancaster 1” Cultural Resource terrain.



Figure 12: One of the older “Church Key” opened cans.



Figure 13: The older historic cans, mixed in with older barbed wire strands.



Figure 14: The “Lancaster 1” cultural resource (center and left of center) is near Avenue I (shown in background).

Due to the ephemeral nature of the “Lancaster 1” site, with an absence of important artifactual information, no known association to events important to the State of California nor to Antelope Valley history, and due to no chance for additional information being discovered with further work at the site, “Lancaster 1” is recommended as not eligible to the California Register of Historic Resources (CRHR), and no additional assessment of the site is recommended. The site will be destroyed during the construction of the property.

Paleontological Record Search Results

The NHM record search findings were received on May 21, 2021 and confirmed that the Project is near areas considered to be sensitive for paleontological resources (see Appendix B). The NHM recommended a paleontological survey of the area. Envicom concurred with the NHM recommendation because the field survey encountered numerous areas with potential exposed caliche (calcium carbonate deposited under wetlands conditions, sometimes called “desert pavement”) on the surface of the Antelope Valley, with such formations possibly dating back to the Pleistocene Epoch or older (**Figure 15** and **Figure 16**).

PaleoWest conducted the paleontological survey on March 26, 2021 and also found that the ground visibility was limited. Though PaleoWest did not directly identify any fossils or fossil-bearing rock units on the surface, they recommended monitoring of any substantial extractions (e.g., excavated soil) within the Subject Property. If fossil material is found, PaleoWest recommended that a sediment sample be collected with the fossil. The PaleoWest paleontological survey is located in **Appendix D**.

RECOMMENDATIONS

The results of the SCCIC and NAHC database record searches were negative for cultural resources within and adjacent to the Subject Property, as was the Historical Map and Aerial Photograph Database record search. The surface assessment was positive for a single scant older historic cultural resource (“Lancaster 1”), which is recommended as not being significant, nor eligible for the CRHR. No additional assessment of this cultural resource is recommended by Envicom. Envicom, therefore, does not recommend further assessment of the Subject Property for cultural resources. Given the absence of prehistoric or older historic cultural resources within the Project region, the limited nature of the “Lancaster 1” cultural resource, and the recommended non-eligible status of the site, Envicom does not recommend archaeological or Native American monitoring during construction.

The NHM paleontological record search was negative for paleontological resources within the Project property, but did recommend a formal paleontological survey of the Project site. The paleontological survey was completed by PaleoWest as part of this Phase I Assessment and is included in Appendix D. PaleoWest did not find any fossil resources during the survey, but recommended paleontological monitoring during construction activities below 3-feet in depth. Envicom, therefore, recommends the following contingencies during construction phase:



Figure 15: An example of the possible caliche (calcium carbonate) found within the Project property.



Figure 16: The potential caliche deposits covered large portions of the Project property (facing north).

Recommendation 1: Paleontological Monitoring

A qualified paleontological monitor will be on site full time during grading-disturbing activities at or below 3-feet. The monitor will collect any fossil material uncovered through grading found within a disturbed context, and can halt construction within 30-feet of a potentially significant fossil resource if necessary. Fossils collected from a disturbed context or that do not warrant additional assessment can be collected, without the need to halt grading. However, if fossils are encountered, which cannot be removed during grading, and that the monitor believes will need further assessment, then the Project “discovery” protocol will be followed. Discovery situations that do not lead to further assessment, survey, evaluation, or data recovery can be described in the daily monitoring log.

If potentially significant intact fossils are encountered, then all work in that area shall be halted or diverted away from the discovery to a distance of 30-feet until a qualified senior paleontologist can evaluate the nature and/or significance of the find(s). If the senior paleontologist confirms that the discovery is potentially significant, then the Lead Agency will be contacted and informed of the discovery. Construction will not resume in the locality of the fossil discovery until consultation between the senior paleontologist, the owner’s Project manager, the Lead Agency, and any other concerned parties (such as additional regulatory agencies), takes place and reaches a conclusion approved by the Lead Agency. If a significant fossil resource is discovered during earth-moving, complete avoidance of the find is preferred. However, if the discovery cannot be avoided, further assessment work, evaluation tasks, or data recovery of the significant fossil resource may be required by the Lead Agency. The Lead Agency may also require changes to site monitoring, based on the discovery.

At the discretion of the qualified paleontologist, the monitor will periodically screen sediments to check for the presence of microfossils that can be seen with the aid of a hand lens (i.e., micro-vertebrates). Should significant micro-vertebrate fossils be encountered during the screening process, then bulk matrix samples will be taken for processing off site. For each fossiliferous horizon or paleosol, a standard sample (4.0 cubic yards or 6,000 pounds) will be collected for subsequent wet screening per Society of Vertebrate Paleontology (2010) guidelines. All fossils recovered that may be of importance to California paleontology, will be cleaned, analyzed, and described within a final Project Monitoring Report. All materials will be curated at the Natural History Museum of Los Angeles County or placed on public display by the owner. If important fossils are found during monitoring, a Curation Plan will be needed that is reviewed by the Lead Agency prior to the publication of the Monitoring Report. The costs of all reports and the processing, analysis, and curation of all fossils will be the responsibility of the applicant.

Recommendation 2: Archaeological Discovery Protocol

If potentially significant intact deposits are encountered within an undisturbed context, then a cultural resource “discovery” protocol will be followed. If older historic or prehistoric features, artifact concentrations, or larger significant artifacts are encountered during Project grading within native soils or original context, then all work in that area shall be halted or diverted away from the

discovery to a distance of 30-feet until a qualified senior archaeologist can evaluate the nature and/or significance of the find(s). If the senior archaeologist confirms that the discovery is potentially significant, then the Lead Agency will be contacted and informed of the discovery.

Construction will not resume in the locality of the discovery until consultation between the senior archaeologist, the owner's Project manager, the Lead Agency, and any other concerned parties (such as additional regulatory agencies), takes place and reaches a conclusion approved by the Lead Agency. If a significant cultural resource is discovered during earth-moving, complete avoidance of the find is preferred. However, if the discovery cannot be avoided, further survey work, evaluation tasks, or data recovery of the significant resource may be required by the Lead Agency. The Lead Agency may also require changes to site monitoring, based on the discovery.

All costs for any additional monitoring, discovery assessment, discovery evaluation, or data recovery of will be the responsibility of the applicant, within the cost parameters outlined under CEQA. Any individual reports generated by the discovery situation will be submitted to the South Central Coastal Information Center at the conclusion of construction.

Recommendation 3: Inadvertent Discovery of Human Remains

The inadvertent discovery of human remains is always a possibility during ground disturbances; State of California Health and Safety Code Section 7050.5 addresses these findings. This code section states that in the event human remains are uncovered, no further disturbance shall occur until the County Coroner has made a determination as to the origin and disposition of the remains pursuant to California Public Resources Code Section 5097.98. The Coroner must be notified of the find immediately, together with the City and the property owner.

If the human remains are determined to be prehistoric, the Coroner will notify the Native American Heritage Commission (NAHC), which will determine and notify a Most Likely Descendant (MLD). The MLD shall complete the inspection of the site within 48 hours of notification and may recommend scientific removal and nondestructive analysis of human remains and items associated with Native American burials and an appropriate re-internment site. The Lead Agency and a qualified archaeologist shall establish additional measures as appropriate for further site development, which may include additional archaeological and Native American monitoring or subsurface testing.

Sincerely,

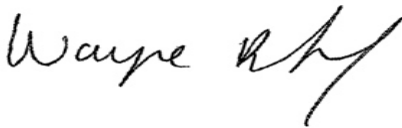

Dr. Wayne Bischoff
Envicom Director of Cultural Resources (Principal)
(and Ms. Samantha Renta)

April 30, 2021

Cultural Resources Phase I Assessment for 163 Lot Single-Family Subdivision on
W. Avenue I, West of W. 40th Street in Lancaster, California (*Envicom Project #2020-192-01*)

Page 16

ATTACHMENTS:

Appendix A: List of Previously Completed Cultural Resource Reports in the Project property and Surrounding Study Area.

Appendix B: SCCIC, NAHC, and NHM Request Letters, and the NAHC and NHM response letters.

Appendix C: Resume of Dr. Wayne Bischoff (author)

Appendix D: PaleoWest Project paleontology report.

APPENDIX A

**List of Previously Completed Cultural Resource Reports in the
Project property and Surrounding Study Area**

Report List

Report No.	Other IDs	Year	Author(s)	Title	Affiliation	Resources
LA-00131		1988	Gerry, Robert	Cultural Resource Assessment of the Proposed California State Prison, Lancaster, Los Angeles County, California		19-001412
LA-07991		2006	Tang, Bai "Tom", Michael Hogan, and Josh Smallwood	Cultural Resources Technical Report City of Lancaster General Plan Update	CRM Tech	19-186543
LA-08458		2004	Hudlow, Scott M.	A Phase I Cultural Resources Survey for Property at 40th West and Avenue H-8, City of Lancaster, California	Hudlow Cultural Resource Associates	
LA-12237		2012	Mason, Roger	Historic Property Survey Report for the Avenue I Widening at 40th Street West Project City of Lancaster, Los Angeles County, California	ECORP Consulting	19-003679, 19-187946, 19-187947

APPENDIX B
**SCCIC, NAHC, and NHM Request Letters,
and the NAHC and NHM Response Letters**

CHRIS Data Request Form

ACCESS AND USE AGREEMENT NO.: _____ **IC FILE NO.:** _____

To: _____ Information Center

Print Name: Samantha Renta Date: 3/5/21

Affiliation: Envicom Corporation

Address: 4165 E. Thousand Oaks Blvd

City: Westlake Village State: CA Zip: 91362

Phone: 818-879-4700 Fax: _____ Email: srenta@envicomcorporation.com

Billing Address (if different than above): _____

Billing Email: wbischoff@envicomcorporation.com Billing Phone: 818-879-4700

Project Name / Reference: W. Avenue I, West of W. 40th Street in Lancaster, Ca

Project Street Address: _____

County or Counties: Los Angeles

Township/Range/UTMs: T 7N, R 13W, 34.42'26.46"N, 118.12'18.56"W

USGS 7.5' Quad(s): Lancaster West

PRIORITY RESPONSE (Additional Fee): yes / no

TOTAL FEE NOT TO EXCEED: \$ 700.00

(If blank, the Information Center will contact you if the fee is expected to exceed \$1,000.00)

Special Instructions:

Information Center Use Only

Date of CHRIS Data Provided for this Request: _____

Confidential Data Included in Response: yes / no

Notes: _____

CHRIS Data Request Form

Mark the request form as needed. Attach a PDF of your project area (with the radius if applicable) mapped on a 7.5' USGS topographic quadrangle to scale 1:24000 ratio 1:1 neither enlarged nor reduced and include a shapefile of your project area, if available. Shapefiles are the current CHRIS standard for submitting digital spatial data for your project area or radius. **Check with the appropriate IC for current availability of digital data products.**

- Documents will be provided in PDF format. Paper copies will only be provided if PDFs are not available at the time of the request or under specially arranged circumstances.
- Location information will be provided as a digital map product (Custom Maps or GIS data) unless the area has not yet been digitized. In such circumstances, the IC may provide hand drawn maps.
- In addition to the \$150/hr. staff time fee, client will be charged the Custom Map fee when GIS is required to complete the request [e.g., a map printout or map image/PDF is requested and no GIS Data is requested, or an electronic product is requested (derived from GIS data) but no mapping is requested].

For product fees, see the CHRIS IC Fee Structure on the [OHP website](#).

1. Map Format Choice:

Select One: Custom GIS Maps GIS Data Custom GIS Maps and GIS Data No Maps

Any selection below left unmarked will be considered a "no."

Location Information:

	Within project area	Within <u>0.25</u> mi. radius
ARCHAEOLOGICAL Resource Locations¹	yes <input checked="" type="checkbox"/> / no <input type="checkbox"/>	yes <input checked="" type="checkbox"/> / no <input type="checkbox"/>
NON-ARCHAEOLOGICAL Resource Locations Report Locations¹	yes <input checked="" type="checkbox"/> / no <input type="checkbox"/>	yes <input checked="" type="checkbox"/> / no <input type="checkbox"/>
"Other" Report Locations²	yes <input type="checkbox"/> / no <input type="checkbox"/>	yes <input type="checkbox"/> / no <input type="checkbox"/>

3. Database Information:

(contact the IC for product examples, or visit the [SSJVIC website](#) for examples)

	Within project area	Within <u>0.25</u> mi. radius
ARCHAEOLOGICAL Resource Database¹		
List (PDF format)	yes <input checked="" type="checkbox"/> / no <input type="checkbox"/>	yes <input checked="" type="checkbox"/> / no <input type="checkbox"/>
Detail (PDF format)	yes <input checked="" type="checkbox"/> / no <input type="checkbox"/>	yes <input checked="" type="checkbox"/> / no <input type="checkbox"/>
Excel Spreadsheet	yes <input type="checkbox"/> / no <input checked="" type="checkbox"/>	yes <input type="checkbox"/> / no <input checked="" type="checkbox"/>
NON-ARCHAEOLOGICAL Resource Database		
List (PDF format)	yes <input checked="" type="checkbox"/> / no <input type="checkbox"/>	yes <input type="checkbox"/> / no <input checked="" type="checkbox"/>
Detail (PDF format)	yes <input checked="" type="checkbox"/> / no <input type="checkbox"/>	yes <input type="checkbox"/> / no <input checked="" type="checkbox"/>
Excel Spreadsheet	yes <input type="checkbox"/> / no <input checked="" type="checkbox"/>	yes <input type="checkbox"/> / no <input type="checkbox"/>
Report Database¹		
List (PDF format)	yes <input checked="" type="checkbox"/> / no <input type="checkbox"/>	yes <input checked="" type="checkbox"/> / no <input type="checkbox"/>
Detail (PDF format)	yes <input checked="" type="checkbox"/> / no <input type="checkbox"/>	yes <input checked="" type="checkbox"/> / no <input type="checkbox"/>
Excel Spreadsheet	yes <input type="checkbox"/> / no <input checked="" type="checkbox"/>	yes <input type="checkbox"/> / no <input checked="" type="checkbox"/>
Include "Other" Reports ²	yes <input type="checkbox"/> / no <input checked="" type="checkbox"/>	yes <input type="checkbox"/> / no <input checked="" type="checkbox"/>

4. Document PDFs (paper copy only upon request):

	Within project area	Within <u>0.25</u> mi. radius
ARCHAEOLOGICAL Resource Records ¹	yes <input checked="" type="checkbox"/> / no <input type="checkbox"/>	yes <input type="checkbox"/> / no <input checked="" type="checkbox"/>
NON-ARCHAEOLOGICAL Resource Records Reports ¹	yes <input checked="" type="checkbox"/> / no <input type="checkbox"/>	yes <input type="checkbox"/> / no <input checked="" type="checkbox"/>
"Other" Reports ²	yes <input checked="" type="checkbox"/> / no <input type="checkbox"/>	yes <input type="checkbox"/> / no <input checked="" type="checkbox"/>

CHRIS Data Request Form

5. Eligibility Listings and Documentation:

Within project area Within 0.25 mi. radius

OHP Built Environment Resources Directory³:

Directory listing only (Excel format)
Associated documentation⁴

yes / no
yes / no

yes / no
yes / no

OHP Archaeological Resources Directory^{1,5}:

Directory listing only (Excel format)
Associated documentation⁴

yes / no
yes / no

yes / no
yes / no

California Inventory of Historic Resources (1976):

Directory listing only (PDF format)
Associated documentation⁴

yes / no
yes / no

yes / no
yes / no

6. Additional Information:

The following sources of information may be available through the Information Center. However, several of these sources are now available on the [OHP website](#) and can be accessed directly. The Office of Historic Preservation makes no guarantees about the availability, completeness, or accuracy of the information provided through these sources. Indicate below if the Information Center should review and provide documentation (if available) of any of the following sources as part of this request.

Caltrans Bridge Survey	yes <input checked="" type="checkbox"/> / no <input type="checkbox"/>
Ethnographic Information	yes <input checked="" type="checkbox"/> / no <input type="checkbox"/>
Historical Literature	yes <input checked="" type="checkbox"/> / no <input type="checkbox"/>
Historical Maps	yes <input type="checkbox"/> / no <input checked="" type="checkbox"/>
Local Inventories	yes <input checked="" type="checkbox"/> / no <input type="checkbox"/>
GLO and/or Rancho Plat Maps	yes <input checked="" type="checkbox"/> / no <input type="checkbox"/>
Shipwreck Inventory	yes <input type="checkbox"/> / no <input checked="" type="checkbox"/>
Soil Survey Maps	yes <input type="checkbox"/> / no <input checked="" type="checkbox"/>

¹ In order to receive archaeological information, requestor must meet qualifications as specified in Section III of the current version of the California Historical Resources Information System Information Center Rules of Operation Manual and be identified as an Authorized User or Conditional User under an active CHRIS Access and Use Agreement.

² "Other" Reports GIS layer consists of report study areas for which the report content is almost entirely non-fieldwork related (e.g., local/regional history, or overview) and/or for which the presentation of the study area boundary may or may not add value to a record search.

³ Provided as Excel spreadsheets with no cost for the rows; the only cost for this component is IC staff time. Includes, but not limited to, information regarding National Register of Historic Places, California Register of Historical Resources, California State Historical Landmarks, California State Points of Historical Interest, and historic building surveys. Previously known as the HRI and then as the HPD, it is now known as the Built Environment Resources Directory (BERD). The Office of Historic Preservation compiles this documentation and it is the source of the official status codes for evaluated resources.

⁴ Associated documentation will vary by resource. Contact the IC for further details.

⁵ Provided as Excel spreadsheets with no cost for the rows; the only cost for this component is IC staff time. Previously known as the Archaeological Determinations of Eligibility, now it is known as the Archaeological Resources Directory (ARD). The Office of Historic Preservation compiles this documentation and it is the source of the official status codes for evaluated resources.

March 5, 2021

Native American Heritage Commission
1550 Harbor Boulevard, Room 100
West Sacramento, CA 95691

Subj: Cultural Resources Phase I Assessment for W. Avenue I, West of W. 40th Street in Lancaster, California (Envicom Project #2020-192-01)

To Whom it May Concern,

Envicom Corporation (Envicom) is requesting a record review of the Native American Heritage Commission (NAHC) records of cultural resources for the Project site, plus a **0.25-mile study area**. We also request a list of Tribal Group representatives for the area in the event we need to contact their offices. The Project site is located at:

**United States Geological Survey 7.5' Quadrangles: Lancaster West
Township: 7 North Range: 13 West
Latitude: 34° 42'26.46"North Longitude: 118°12'18.56"West
County: Los Angeles**

Envicom appreciates the NAHC's help with this request. For correspondence or questions regarding this Project, please contact Wayne Bischoff at 818-879-4700 (wbischoff@envicomcorporation.com).

Sincerely,

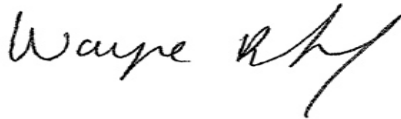

Dr. Wayne Bischoff
Director of Cultural Resources

Attachment:

Project vicinity map on 1:24,000 topographic map

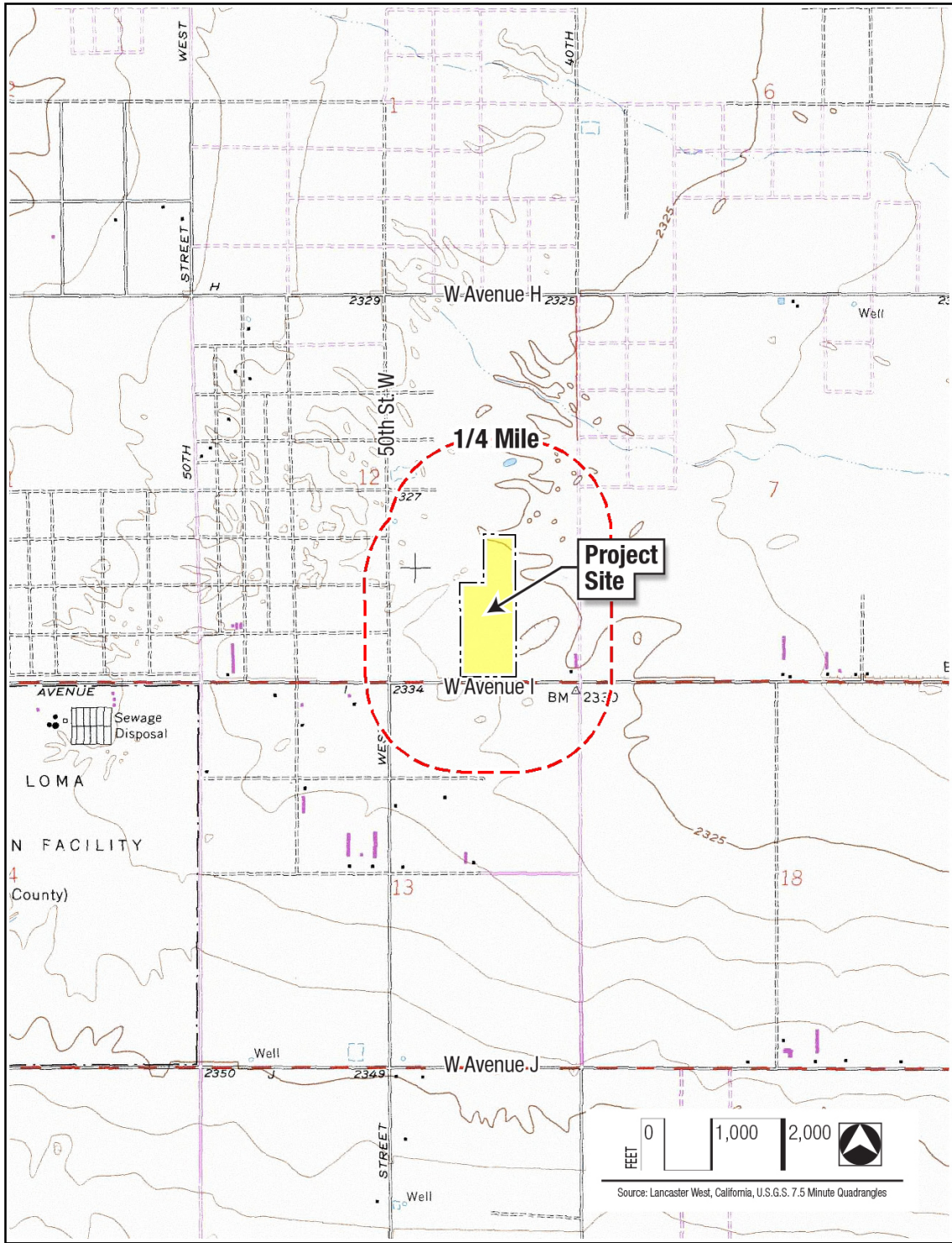

March 5, 2021

Natural History Museum of Los Angeles
900 Exposition Blvd.
Los Angeles, CA 90007

Subj: Cultural Resources Phase I Assessment for W. Avenue I, West of W. 40th Street in Lancaster, California (Envicom Project #2020-192-01)

To Whom It May Concern,

Envicom Corporation (Envicom) is requesting a record search of the Natural History Museum of Los Angeles County (NHM) database for paleontological resources/sensitivity for the Project site and surrounding area (within 0.25 mile of the Project site), as well as a map/listing of all paleontological resources previously identified within the attached Project site, plus the 0.25-mile study area. The Project site is located at:

**United States Geological Survey 7.5' Quadrangles: Lancaster West
Township: 7 North Range: 13 West
Latitude: 34° 42'26.46"North Longitude: 118°12'18.56"West**

Envicom appreciates the NHM's help with this request. For correspondence or questions regarding this Project, please contact Wayne Bischoff at 818-879-4700 (wbischoff@envicomcorporation.com).

Sincerely,

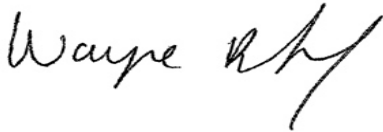

Dr. Wayne Bischoff
Director of Cultural Resources

Attachment:

Project vicinity map on 1:24,000 topographic map

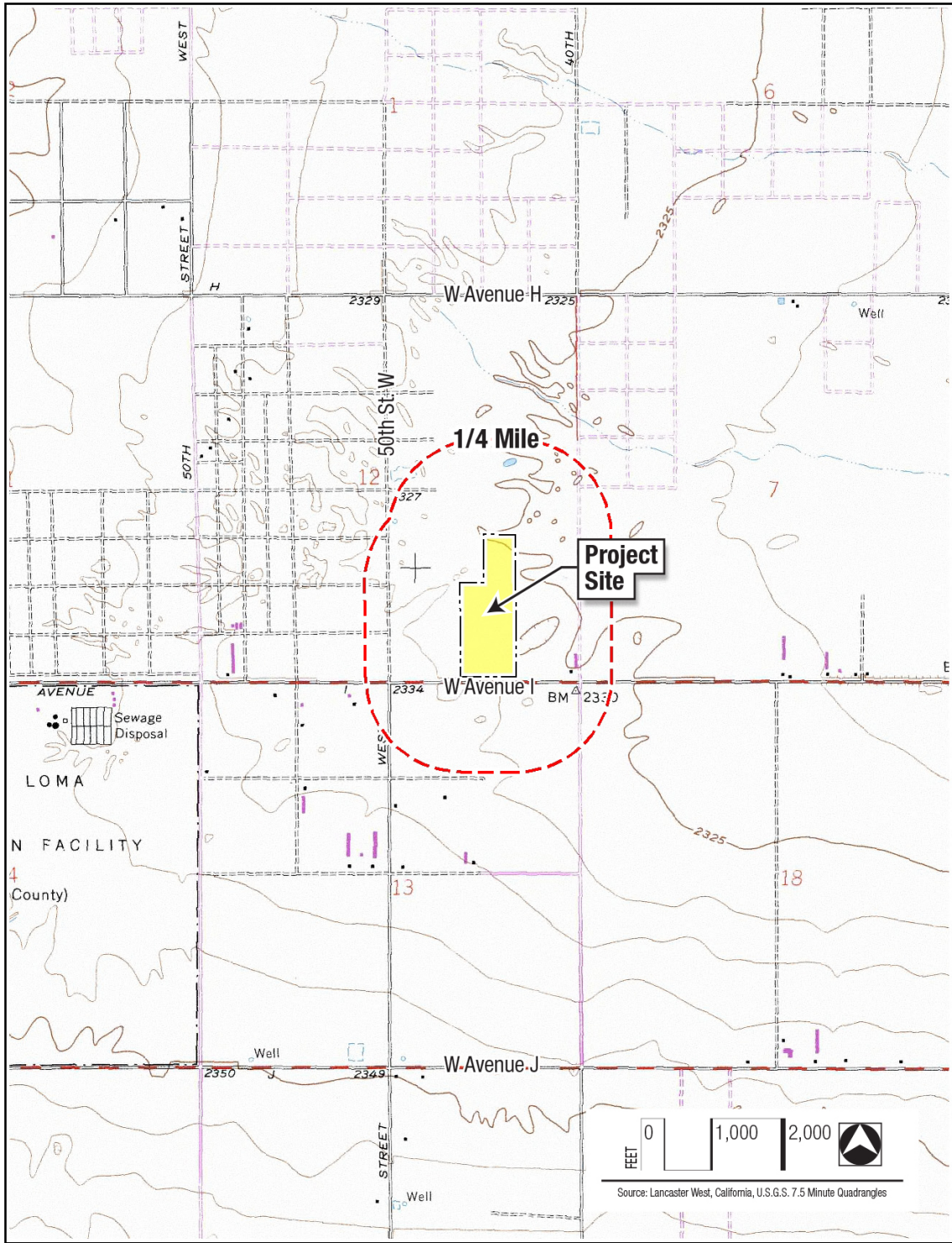

NATIVE AMERICAN HERITAGE COMMISSION

March 16, 2021

Wayne Bischoff
Envicom Corporation

Via Email to: wbischoff@envicomcorporation.com

Re: Cultural Resources Phase I Assessment for W. Avenue I, West of W. 40th Street in Lancaster, California Project, Los Angeles County

Dear Dr. Bischoff:

A record search of the Native American Heritage Commission (NAHC) Sacred Lands File (SLF) was completed for the information you have submitted for the above referenced project. The results were negative. However, the absence of specific site information in the SLF does not indicate the absence of cultural resources in any project area. Other sources of cultural resources should also be contacted for information regarding known and recorded sites.

Attached is a list of Native American tribes who may also have knowledge of cultural resources in the project area. This list should provide a starting place in locating areas of potential adverse impact within the proposed project area. I suggest you contact all of those indicated; if they cannot supply information, they might recommend others with specific knowledge. By contacting all those listed, your organization will be better able to respond to claims of failure to consult with the appropriate tribe. If a response has not been received within two weeks of notification, the Commission requests that you follow-up with a telephone call or email to ensure that the project information has been received.

If you receive notification of change of addresses and phone numbers from tribes, please notify me. With your assistance, we can assure that our lists contain current information.

If you have any questions or need additional information, please contact me at my email address: Andrew.Green@nahc.ca.gov.

Sincerely,

Andrew Green
Cultural Resources Analyst

Attachment



CHAIRPERSON
Laura Miranda
Luiseño

VICE CHAIRPERSON
Reginald Pagaling
Chumash

SECRETARY
Merri Lopez-Keifer
Luiseño

PARLIAMENTARIAN
Russell Attebery
Karuk

COMMISSIONER
William Mungary
Paiute/White Mountain
Apache

COMMISSIONER
Julie Tumamait-Stenslie
Chumash

COMMISSIONER
[Vacant]

COMMISSIONER
[Vacant]

COMMISSIONER
[Vacant]

EXECUTIVE SECRETARY
Christina Snider
Pomo

NAHC HEADQUARTERS
1550 Harbor Boulevard
Suite 100
West Sacramento,
California 95691
(916) 373-3710
nahc@nahc.ca.gov
NAHC.ca.gov

Natural History Museum
of Los Angeles County
900 Exposition Boulevard
Los Angeles, CA 90007

tel 213.763.DINO
www.nhm.org

Research & Collections

e-mail: paleorecords@nhm.org

March 8, 2021

Envicom Corporation

Attn: Wayne Bischoff

re: Paleontological resources for the W. Avenue I, West of W. 40th Street Project (Envicom Project #2020-192-01)

Dear Wayne:

I have conducted a thorough search of our paleontology collection records for the locality and specimen data for proposed development at the W. Avenue I, West of W. 40th Street project area as outlined on the portion of the Lancaster West USGS topographic quadrangle map that you sent to me via e-mail on March 5, 2021. We do not have any fossil localities that lie directly within the proposed project area, but we do have fossil localities nearby from the same sedimentary deposits that occur in the proposed project area, either at the surface or at depth.

The following table shows the closest known localities in the collection of the Natural History Museum of Los Angeles County.

Locality Number	Location	Formation	Taxa	Depth
LACM VP 7853	Waste Management of North America Lancaster Landfill	Unknown formation (Pleistocene; sandy loess under a dune deposit strand, sandy siltstone, siltstone to clayey siltstone)	fish, amphibians, reptiles, small mammals, and camel (Camelidae)	3-11 feet bgs
LACM VP 7884	E of the SE corner of the intersection of East 3rd Street & East Avenue H-13	Unknown formation (Pleistocene; fluvial brown clayey silt)	Camel (<i>Camelops hesternus</i>)	4 feet bgs
LACM VP 5946	E Avenue S & 90th St E	Unknown formation (Holocene)	Lizard (<i>Gambelia wislizenii</i>)	0-3 m bgs
LACM VP 5947	E avenue S between 115 St E and 121 St E	Unknown formation (Holocene)	Pocket gopher (<i>Thomomys</i>)	0-3 m bgs
LACM VP	E avenue S between	Unknown formation	Rabbit (<i>Sylvilagus</i>);	0-9 ft bgs

5952, 5942,
5945

180 St E and 200 St (Holocene)
E

pocket mouse
(*Chaetodippus*);
kangaroo rat
(*Dipodomys*)

VP, Vertebrate Paleontology; IP, Invertebrate Paleontology; bgs, below ground surface

This records search covers only the records of the Natural History Museum of Los Angeles County (“NHMLA”). It is not intended as a paleontological assessment of the project area for the purposes of CEQA or NEPA. Potentially fossil-bearing units are present in the project area, either at the surface or in the subsurface. As such, NHMLA recommends that a full paleontological assessment of the project area be conducted by a paleontologist meeting Bureau of Land Management or Society of Vertebrate Paleontology standards.

Sincerely,



Alyssa Bell, Ph.D.
Natural History Museum of Los Angeles County

enclosure: invoice

APPENDIX C

Resume of Dr. Wayne Bischoff (Principal)



WAYNE BISCHOFF, PH.D.

Professional Resume

Registered Professional Archaeologist (RPA #32450562)

Education

- 2000 - **Ph.D. in Anthropology (Historical Archaeology emphasis), Michigan State University, East Lansing, MI.**
- 1991 - **Bachelor of Arts (Anthropology, Education, and U.S. History), Purdue University, West Lafayette, IN.**

Professional Summary

- **Over 25 Years' Experience Managing Projects.** Projects completed under the California Environmental Quality Act (CEQA), Section 106 and 110 of the National Historic Preservation Act (NHPA), the National Environmental Protection Act (NEPA), as well as numerous other federal and state laws and permit regulations regarding cultural resources.
- **Successful Performance History.** Dr. Bischoff has managed up to 60 professional staff in multiple offices covering several states. He has completed challenged projects, developed successful cultural resource teams, and is experienced with budgeting and scoping projects, successful proposal writing, client and agency relationships, and large project management.
- **Numerous Market Sectors.** Dr. Bischoff has completed projects involving solar, wind, geothermal, and electric transmission lines; defense, public works, education, residential, and commercial development; telecommunication, mining, transportation, parks and trails, and water resources; and storm and sewer lines, industrial sites, and railroads.
- **Planning and Compliance Document Author.** Dr. Bischoff has been an author on Environmental Impact Reports (EIR), Mitigated Negative Declarations (MND), Environmental Impact Statements (EIS), Environmental Assessments (EA), Programmatic Agreements (PA), Memorandum of Agreements (MOA), Initial Studies (IS), ACOE permits, and Memorandum of Understanding (MOU).
- **Extensive Experience with Federal, State, County, and Local Agencies.** SHPOs, FHA, NPS, and CALTRANS. Multiple Bureau of Land Management districts (Barstow, Bishop, Moreno Valley, Needles, El Centro, Nevada). The Army and National Guard, Marine Corps, Navy, and Air Force. The GSA, the USDA, Forest Service, California Coastal Commission, and several USCOE districts, LACDPW, LADWP, and many regional water districts. Fish and Wildlife, the CPUC, and the Counties of Los Angeles, San Bernardino, Riverside, Ventura, Imperial, Kern, Santa Clara, Inyo, Mono, Santa Barbara, San Diego, and Orange. Many port authorities, state agencies, and local governments.
- **Consultation and Communication with Many Tribal Groups.** Tribal groups include the Chumash, Gabrielino, Tongva, Washo, Piute, Quechan, Cahuilla, Tataviam, San Manuel, Morongo, and Luiseno. *I am a professional expert in AB-52 compliance and Tribal consultation.*
- **Over 500 Cultural Resource Projects Completed in Eleven States.** Including hundreds of Phase I Surveys, Phase II Evaluations, Phase III Data Recoveries, and Monitoring Projects. I have authored cultural resource Monitoring Plans, Evaluation Plans, Data Recovery Plans, PRIMPs, Construction Phase Management Plans, WEAPs, Feasibility Studies, and National Register and National Landmark nominations. Reports have included Cultural, Paleontological, and Built Environment resources.
- **Historic Architecture Project Management.** Including built environment surveys and inventories, building assessments and evaluations, HABS/HAER mitigation reports, landscape studies, and indirect effects reports. Subjects have included houses, commercial buildings, roads, canals, and power lines.



Professional Experience

Cultural Resources Director, Envicom Inc., Westlake Village, CA February, 2014 – Current

As Cultural Resources Director at Envicom, I complete all cultural resource, archaeological, and paleontological phase I studies, all cultural resource evaluations and data recoveries, Native American consultation, and built environment projects for Envicom, and author cultural resource sections of permitting and planning documents, including MNDs and EIRs. Project area includes Ventura, Santa Barbara, Los Angeles, Riverside, Kern, Imperial, San Diego, and San Bernardino Counties. I oversee cultural staff and work with planning teams on larger projects. I am also responsible for business development and project management tasks. I write proposals, oversee quality control, develop agency relationships, write technical reports, and manage and develop project budgets.

Projects:

- **Paleontological Monitoring of 15353 Camarillo, Sherman Oaks, CA.** Principal and Project Manager for this paleontological monitoring project. (Upcoming).
- **Archaeological and Paleontological Monitoring of the Twin Lakes Water Tank Construction for the Las Virgenes Water District, Porter Ranch, CA.** Principal and Project Manager for this monitoring project. (Upcoming).
- **Cultural Resource Tasks Associated with the Arrowhead Estates Project, Banning, CA.** Principal and Project Manager for this 65-acre residential project, which will construct 170+ houses near the historic Saint Boniface Indian School (now demolished). This project involved the National Register nomination of the Indian School, a HAER-level documentation of a stone and concrete water channel, the curation of all artifacts with the Morongo Tribal Group, the installation of historic signage, and the archaeological and Native American monitoring of the project site grading. (Upcoming).
- **Archaeological Monitoring at the Sakioka Business Park, Oxnard, Ventura County, CA.** Project Manager for this large archaeological monitoring project. (October 2020 – Current).
- **Phase I survey of the proposed Little Rock Mobile Home Park, unincorporated Los Angeles County, CA (with Samantha Renta).** Principal and Project Manager for this project, which included an SCCIC record search and a site visit. (November 2020 – Current).
- **Phase I survey of 410 Tico Road, Ojai, Ventura County, CA (with Samantha Renta).** Principal and Project Manager for this project, which included an SCCIC record search and a site visit. (November 2020 – Current).
- **Native American Monitoring at the Los Angeles International Airport (LAX), City of Los Angeles, Los Angeles County, CA.** Project Manager for this long term Native American monitoring project, which includes a Discovery Plan and a final Monitoring Report. (October 2020 – Current).
- **Oakmont Senior Living Historic and Archaeological Display Production, Agoura Hills, Los Angeles County, CA.** Project Manager for this historical interpretation display project (October 2020 to Current).
- **Arts District Archaeological Monitoring Project, Los Angeles, CA.** Principal and Project Manager for this archaeological monitoring project. (October 2020 to Current).
- **Oakmont Senior Living Historic and Archaeological Display Production, Simi Valley, Ventura County, CA.** Project Manager for this historical interpretation display project (with the Strathearn Historic Park and Museum) (September 2020 to Current).

- **Phase I Survey of 122 acres of the Canyon Ostara residential development project, Malibu, Los Angeles County, CA (with Samantha Renta).** Principal and Project Manager for this project, which included an SCCIC and NAHC record search and a site survey. (August 2020 – Current).
- **Cultural Resource Monitoring for the Oasis Windmill Farm, Kern County, CA.** Project manager for the monitoring of impacts in six cultural resources as part of the Oasis Windmill Farm upgrade (August 2020 – Current).
- **Keyes Porsche Archaeological, Paleontological, and Native American Monitoring Project, Woodland Hills, CA.** Principal and Project Manager for this archaeological, paleontological, and Native American monitoring project. (August 2020 – Current).
- **Archaeological, Paleontological, and Native American Monitoring for the JPA/Las Virgenes Water District Solar Farm Expansion, Calabasas, CA.** Principal and Project Manager for this monitoring project. This project encountered elements of a very old prehistoric site at depth, which included lithic material, groundstone artifacts, and an intact multi-episodic hearth feature (April 2020 – Current).
- **Summit View Apartments Project Paleontological Monitoring for this Veterans Housing Project, City of Los Angeles, CA.** Principal and Project Manager for this paleontological monitoring project. (February 2020 – Current).
- **Oakmont Senior Housing Archaeological, Paleontological, and Native American Monitoring Project, Agoura Hills, CA.** Principal and Project Manager for this archaeological, paleontological, and Native American monitoring project. (January 2020 – Current).
- **Conrad N. Hilton Foundation Phase Ib of Proposed Phase II Building Locations, Agoura Hills, California.** This project involved the excavation of 48 shovel test pits within the western periphery of cultural resource CA-LAN-320 on Foundation property. (January 2020 – Current).
- **18800 Gale Avenue Archaeological, Biological, and Paleontological Monitoring Project, Rowland Heights, CA.** Principal and Project Manager for this archaeological, biological, and paleontological monitoring project. (November 2019 – Current).
- **Los Angeles Unified School District (LAUSD) Environmental On-Call for archaeological and paleontological tasks, Los Angeles County, CA.** Principal, Project Manager, and cultural resource task completion as needed. Envicom is one of three selected vendors for one year, with four potential renewable years in the contract. (February 2019 – Current).
- **Los Angeles Community College District Environmental On-Call (including cultural resources), Los Angeles County, CA.** Principal, Project Manager, and cultural resource consultant as needed. (February 2018 – Current).
- **Review of Technical Documents and EIR Cultural Section Writing for “The Agoura Village Expansion” project, Agoura Hills, Los Angeles County, CA.** Professional review of project cultural resource documents and authoring of cultural resource section of MND for this large mixed use project. The primary challenge is that the development is located on a significant prehistoric Native American cultural resource. (January 2018 – Current).
- **Los Angeles Unified Schools Department (LAUSD) Environmental On-Call (including cultural resources), City of Los Angeles, Los Angeles County, CA.** Principal, Project Manager, and cultural resource consultant as needed. Envicom was one of 15 companies to be awarded this large on-call contract. (February 2017 – Current).
- **CA-LAN-320 Phased Evaluation Project, Agoura Hills, Los Angeles County, CA.** Principal and Project Manager for the phased evaluation (Phase II) of CA-LAN-320 in response to potential impacts from the construction of the Conrad N. Hilton Foundation Phase 2 Campus Building. The site is a prehistoric Chumash residential and ceremonial center of over 80-acres in size and that was used by prehistoric Native Americans from 300 B.C. to the late 1700s. Dozens of test units, hundreds of shovel test pits, surface collection, and surface feature mapping have been completed to date planned. (August 2015 – Current).

- **Phase I Survey of a property within the Rancho Ojai subdivision, Ojai, Ventura County, CA (with Samantha Renta).** Principal and Project Manager for this project, which included an SCCIC record search and a site visit. (October 2020 – November 2020).
- **Fillmore Terrace Phase I and Native American Consultation, Fillmore, Venture County, CA (with Samantha Renta).** Principal and Project Manager for this large low-income housing project, which included an SCCIC record search, site visit, and Native American consultation on behalf of the City. (September 2020 – October 2020).
- **Phase I Survey of a property on Giles Road, Lake Sherwood, Ventura County, CA (with Samantha Renta).** Principal and Project Manager for this project, which included an SCCIC record search and a site visit. Exploration of all rock shelters and cache openings on the property for historic artifacts was part of this project (July 2020 – October 2020).
- **Phase I Survey of 730 South Vermont, City of Los Angeles, Los Angeles County, CA (with Samantha Renta).** Principal and Project Manager for this project, which included an SCCIC, NAHC, and NHM record searches and a site visit. (June 2020 – October 2020).
- **Phase I Survey of the Reconstruction of the Brookview Ranch Riding and Event Venue, School of Management Building, County of Los Angeles, CA (with Samantha Whittington).** Principal and Project Manager for this riding venue rebuild and expansion. Project included a SCCIC/NAHC record search and a site visit. One of the challenges has been integrating a prehistoric cultural resource immediately north of the project development, but on the project property, into the assessment recommendations (July 2019 – September 2020).
- **Phase I Survey of 715 Del Oro Drive, Ojai, Ventura County, CA (with Samantha Renta).** Principal and Project Manager for this project, which included an SCCIC record search and a site visit. (June 2020 – August 2020).
- **Phase I Survey of 604 Gridley Road, Ojai, Ventura County, CA (with Samantha Renta).** Principal and Project Manager for this project, which included an SCCIC record search and a site visit. (July 2020 – August 2020).
- **Phase I Survey of the Tehachapi Battery Storage Project, Terra Gen Windfarms, Kern County, CA (with Samantha Renta).** Principal and Project Manager for this project, which included a Bakersfield record search and a site survey. (July 2020 – August 2020).
- **Phase I Survey of the 5041 Lankershim Hotel Property, North Hollywood, Los Angeles County, CA (with Samantha Renta).** Principal and Project Manager for this project, which included an SCCIC, NHM, NAHC record searches and a site visit. (May 2020 – July 2020).
- **Phase II Evaluation of CA-LAN-41 within the Boundary of the Agoura Village project, City of Agoura Hills, Los Angeles County, CA.** Principal and Project Manager for the completion of an Evaluation (Phase II) of a complex prehistoric cultural resource within the boundary of the Agoura Village project. The Phase II involved the excavation of ten test units, dozens of shovel test pits, as well as more detailed mapping of the site. (January 2019 – July 2020).
- **Phase I Survey of 6544 Wandermere Road, Malibu, Los Angeles County, CA (with Samantha R3nta).** Principal and Project Manager for this project, which included an SCCIC record search and a site visit. (June 2020 – July 2020).
- **Phase I Survey of 5841 Busch Drive, Malibu, Los Angeles County, CA (with Samantha Renta).** Principal and Project Manager for this project, which included an SCCIC record search and a site visit. (May 2020 – July 2020).
- **Archaeological and Paleontological Monitoring for the Agoura Landmark Development Project, Agoura Hills, CA.** Principal and Project Manager for this monitoring project. A negative findings report was also completed and submitted to the City (January 2019 – July 2020).

- **Phase I Survey 505 Centre Street, City of Los Angeles, Los Angeles County, CA (with Samantha Renta).** Principal and Project Manager for this project, which included an SCCIC, NAHC, and NHM record searches and a site visit. This complex project had multiple built environment concerns, including the adjacent San Pedro Commercial Historic District (April 2020 – June 2020).
- **Paleontological Phase I Survey of an Agricultural Development Parcel in Balcom Canyon, City of Somis, Ventura County, CA.** Author for this project, which included a detailed geological and paleontological statement for the proposed project. (June 2020).
- **Cultural Resource Discovery Plan for the Oasis and Point Wind Windmill Farm, Kern County, CA.** Author of the discovery plan for upgrades to two large windmill farms for Terra Gen. (March – April 2020).
- **Phase II Evaluation of Six Native American Archaeological Sites for the Terra Gen Oasis Windmill Farm, Kern County, CA.** Principal and Project Manager for this archaeological evaluation project, which utilized shovel test pits and test units to evaluate six prehistoric Native American cultural resources that would be impacted by future windfarm development. (March 2020 – April 2020).
- **Phase I Survey of The Emerald Residential Project, Lancaster, Los Angeles County, CA (with Samantha Renta).** Principal and Project Manager for this approximately 5-acre housing project, which included an SCCIC/NAHC/NHM record searches and a site visit. (February 2020 – April 2020).
- **Phase I Survey of The West Palmdale Residential Complex Project, Palmdale, Los Angeles County, CA (with Samantha Renta).** Principal and Project Manager for this approximately 35-acre housing project, which included an SCCIC/NAHC/NHM record searches and a site visit. (February 2020 – April 2020).
- **Conrad N. Hilton Foundation Geotech Boring Archaeological and Paleontological Monitoring, Agoura Hills, California.** This project involved the monitoring of geotech trench and drilling sites within Foundation and Las Virgenes Water District properties within the City of Agoura Hills. (January 2020 – April 2020).
- **Phase I Survey of 4510 Via Vienta, Malibu, Los Angeles County, CA (with Samantha Renta).** Principal and Project Manager for this project, which included an SCCIC record search and a site visit. (January 2020 – April 2020).
- **Phase I Survey of the Proposed California Lutheran University, School of Management Building, Thousand Oaks, CA (with Samantha Renta).** Principal and Project Manager for this university project. Project included a SCCIC/NAHC record search and a site visit. (December 2019 – April 2020).
- **Phase I Survey of the Twin Lakes Water Tank Project, Porter Ranch, Los Angeles County, CA (with Samantha Whittington).** Principal and Project Manager for the completion of a SCCIC/NAHC record search, NAHC record search request, and a site survey for the Los Virgenes Municipal Water District. (October 2019 – April 2020).
- **Phase I Survey of the Castaic Apartments Project, Town of Castaic, Los Angeles County, CA (with Samantha Renta).** Principal and Project Manager for this large 105-acre mixed use development project, which included an SCCIC/NAHC record search, an NHM record search, and a site visit. The cultural survey discovered two complex older historic sites, which required extensive recordation and evaluation (July 2019 – April 2020).

- **Sierra West Assisted Living Project, Los Angeles County, CA (with Samantha Renta).** Principal and Project Manager for this group residential project. Project included NHM/SCCIC/NAHC record searches, and a site visit. A project challenge was addressing historic early 20th Century structures, including an early stagecoach station, which once were located on the property, as well as the proximity of the parcel to a historic (1880s) cemetery. (October 2019 – April 2020).
- **Phase I Survey of 1175 Camille Drive, Ojai, Ventura County, CA (with Samantha Renta).** Principal and Project Manager for this project, which included an SCCIC/NAHC record search and a site visit. (January 2020 – February 2020).
- **Vineland and Cleon Self Storage Project Phase I Cultural Survey, Burbank, CA (with Samantha Renta).** Principal and Project Manager for this commercial project. Project included NHM/SCCIC/NAHC record searches, but no site visit due to extensive urbanization. (December 2019 – January 2020).
- **Phase I Survey of 5617 Busch Drive, Malibu, Los Angeles County, CA (with Samantha Renta).** Principal and Project Manager for this project, which included an SCCIC record search and a site visit. (December 2019 – January 2020).
- **Cultural Resource Monitoring of the 21110 Oxnard Hotel project, Woodland Hills, Los Angeles County, CA (with Samantha Renta).** Principal and Project Manager for this monitoring project. (August 2019 – January 2020).
- **Phase I Survey of the Riverwalk II Mixed-Use Project, Santa Clarita, CA.** Principal and Project Manager for this commercial and Residential Project. Project included a SCCIC/NAHC record search and a site visit. (December 2019 – December 2019).
- **Phase I Survey of 5814 Philip Road, Malibu, Los Angeles County, CA (with Samantha Renta).** Principal and Project Manager for this project, which included an SCCIC record search and a site visit. (October 2019 – December 2019).
- **Phase I Survey of Improvements to the Coronado Golf Course, San Diego, San Diego County, CA (with Samantha Whittington).** Principal and Project Manager for this project, which included an SCCIC/NAHC record search only. (October 2019 – November 2019).
- **Phase I Survey of 6208 Tapia Drive, Malibu, Los Angeles County, CA (with Samantha Whittington).** Principal and Project Manager for this project, which included an SCCIC record search and a site visit. (October 2019 – November 2019).
- **Phase I Survey of 6711 Wandermere Road, Malibu, Los Angeles County, CA (with Samantha Whittington).** Principal and Project Manager for this project, which included an SCCIC record search and a site visit. (September 2019 – October 2019).
- **Phase I Survey of 5820 Foxview Drive, Malibu, Los Angeles County, CA (with Samantha Whittington).** Principal and Project Manager for residential project, which included an SCCIC/NAHC record search, an NHM record search, and a site visit. (September 2019 – October 2019).
- **Phase I Survey of the new Keyes Porsche Auto Dealership, Woodland Hills, Los Angeles County, CA (with Samantha Whittington).** Principal and Project Manager for this project, which included an SCCIC/NAHC/NHM record search, a site visit, and the production of a separate Ethnographic Assessment Report for the project. Envicom also supported the Lead Agency in AB-52 consultation with the Tataviam and Tongva Tribal Groups. (August 2019 – October 2019).
- **Cultural Resource Monitoring of the 21121 Van Owen development project, Canoga Park, Los Angeles County, CA.** Principal and Project Manager for this monitoring project. (September 2019).

- **Phase I Survey of the Avenue 34 Mixed-Use Development Project, City of Los Angeles, Los Angeles County, CA (with Samantha Whittington).** Principal and Project Manager for this project, which included an SCCIC/NAHC record search and a site visit. (August 2019 – September 2019).
- **Phase I Survey of the Faith Lutheran Senior Living Project, City of Inglewood, Los Angeles County, CA (with Samantha Whittington).** Principal and Project Manager for this project, which included an SCCIC/NAHC record search and a site visit. (August 2019 – September 2019).
- **Phase II Evaluation of Cultural Resource CA-LAN-513 within the Boundary of 6282 Sea Star Estates Residential Development within the City of Malibu, Los Angeles County, CA (with Samantha Whittington).** Principal and Project Manager for this Phase II evaluation, which involved surface examination only due to plowed field conditions. No evidence of a cultural resource was found. (September 2019).
- **Phase I Survey of an Agricultural Development Parcel in Balcom Canyon, City of Somis, Ventura County, CA (with Samantha Whittington).** Principal and Project Manager for this project, which included an SCCIC/NAHC record search, a site visit, and the recordation of a prehistoric site at the edge of the project boundary. (July 2019 – August 2019).
- **Phase I Survey of 31215 Bailard Road, City of Malibu, Los Angeles County, CA (with Samantha Whittington).** Principal and Project Manager for this project, which included an SCCIC record search and a site visit. (July 2019 – August 2019).
- **Phase II Evaluation of the Proposed Location of the Printz Colony House within the Strathearn Historic Park, City of Simi Hills, Ventura County, CA (with Samantha Whittington).** Principal and Project Manager for this Phase II evaluation of part of the 1880s Strathearn Farmstead. Evaluation tasks included the excavation of shovel test pits and a single test unit, construction monitoring, and a combined report for the Rancho Simi Recreation and Parks District (June 2019 – July 2019).
- **Phase I Survey of the Parks LA project, City of Los Angeles, Los Angeles County, CA (with Samantha Whittington).** Principal and Project Manager for this project, which included an SCCIC/NAHC/NHM record search, a site visit, and a Natural History Museum paleontological assessment. (June 2019 – July 2019).
- **Phase I Survey of the Rancho Malibu residential development project, City of Malibu, Los Angeles County, CA (with Samantha Whittington).** Principal and Project Manager for this project, which included an SCCIC/NAHC/NHM record search, a site visit, and a Natural History Museum paleontological assessment. (June 2019 – July 2019).
- **Phase I Survey of 380 South Rosemead, City of Los Angeles, Los Angeles County, CA (with Samantha Whittington).** Principal and Project Manager for this development project, which included an SCCIC/NAHC/NHM record search, a site visit, and a Natural History Museum paleontological assessment. (May 2019 – June 2019).
- **Phase II Evaluation of CA-LAN-129 and CA-LAN-129a, two prehistoric sites, and CA-LAN-4363H, an early historic site located in Calabasas, CA.** Principal and Project Manager for the evaluation of these three sites as part of permitting with the Corps of Engineers. The evaluation was written to NRHP/SHPO standards. (May 2019 – June 2019).
- **Phase I Survey of 1160 Sulphur Mountain Road, City of Ojai, Ventura County, CA.** Principal and Project Manager for this residential development project, which included a SCCIC/NAHC record search and a site visit (May 2019 – May 2019).
- **Phase I Survey of the Cal Grow Farms Project, City of Perris, Riverside County, CA.** Principal and Project Manager for this agricultural development project, which included a SCCIC/NAHC/NHM record search and a site visit. (March 2019 – May 2019).

- **Phase I Survey of the Riverwalk Mixed-Use Project, Santa Clarita, CA.** Principal and Project Manager for this commercial and Residential Project. Project included a SCCIC/NAHC record search and a site visit. (March 2019 – May 2019).
- **Phase I Survey of the West Village Project, Calabasas, CA.** Principal and Project Manager for this Army Corps of Engineers (ACOE) permitting project. Project included a SCCIC/NAHC/NHM record search and a site visit, as well as SHPO review of the final report. (March 2019 – May 2019).
- **Phase I Survey of the Belvedere Middle School Improvements Project, City of Los Angeles, Los Angeles County, CA.** Principal and Project Manager for the completion of a SCCIC/NAHC record search and NAHC record search request for LAUSD. (November 2018 – April 2019).
- **Phase I Survey “The Angel” Project, Los Angeles County, CA.** Principal and Project Manager for this low income housing project in the San Fernando Valley. Project included a SCCIC/NAHC record search and a site visit. (January 2019 – March 2019).
- **Fourth and Hewitt, City of Los Angeles, Los Angeles County, CA.** Principal and Project Manager for a cultural resource record search for the development of a new office building within a commercial urban environment. Project also included a paleontological assessment of the property due to an extensively deep planned parking garage and Native American concerns. Also completed with an Ethnographic Report to meet AB-52 criteria. Another key issue was determining whether a historic built environment assessment was needed. (February 2017 – March 2019).
- **Phase I Survey of the Deer Lake Water Tank Project, Porter Ranch, Los Angeles County, CA.** Principal and Project Manager for the completion of a SCCIC/NAHC record search, NAHC record search request, and a site survey for the Los Virgenes Municipal Water District. (November 2018 – March 2019).
- **Phase I Survey of the Sherwood Development Corporation, Tract 4409, Ventura County, CA.** Principal and Project Manager for this Army Corps of Engineers (ACOE) permitting project. Project included a SCCIC/NAHC record search and a site visit, as well as SHPO review. (January 2019 – February 2019).
- **City of Thousand Oaks Environmental On-Call (Including Cultural Resources), Los Angeles County, CA.** Envicom was selected as one of a limited number of on-call environmental firms for the City. (June 2015 – December 2018)
- **Phase II Evaluation of Cultural Resource CA-LAN-513 within the Boundary of 6361 Sea Star Estates Residential Development within the City of Malibu, Los Angeles County, CA.** Principal and Project Manager for this Phase II evaluation, which involved limited shovel test pits and surface examination. No evidence of a cultural resource was found. (November 2018 – December 2018)
- **Phase I Survey for the Massilia Spa Project, Los Angeles County, CA.** Principal and Project Manager for the completion of a SCCIC/NAHC record search, NAHC record search request, and a site survey. Project also includes an inventory and initial assessment of over a dozen 1930 through 1990 structures on the property (June 2018 – December 2018)
- **Phase I Survey of the Conejo Creek Park, City of Thousand Oaks, Ventura County, CA.** Principal and Project Manager for the completion of a SCCIC/NAHC record search, NAHC record search request, and a site survey. (August 2018 – November 2018)
- **Phase I Survey of the Butler Ranch, in Ventura County near west Simi Valley, California.** Principal and Project Manager for the completion of a Phase I record search, NAHC record search request, and a site survey of this 332-acre low density residential development project. (May 2018 – October 2018)
- **Valencia Travel Village, Valencia, Los Angeles County, CA.** Principal and Project Manager for the completion of a Phase I for trailer park and recreation center. (August 2018 – October 2018)

- **Phase I Survey of the JPA Solar Farm, Calabasas, Los Angeles County, CA.** Principal and Project Manager for the completion of a SCCIC/NAHC record search, NAHC record search request, and a site survey for the Los Virgenes Municipal Water District. This 20-acre solar project also addressed a large prehistoric Native American site located next to and partially on the property. Project included Native American consultation with the Lead Agency and the Tataviam and the recordation of two prehistoric petroglyphs (August 2018 – October 2018)
- **Simi BMX Course Phase I Survey, Simi Valley, CA.** Principal and Project Manager for the completion of a SCCIC/NAHC record search, NAHC record search request, and a site survey. (July 2018 – August 2018)
- **Phase I Paleontological Survey of the 3467 Camino de la Cumbre Property in Sherman Oaks, Los Angeles County, CA.** Principal and Project Manager for the completion of a Natural History Museum record search and paleo report. (August 2018)
- **Phase I Survey of the proposed 113-133 West Plymouth Street multiple unit residential development, Inglewood, Los Angeles County, CA (with Samantha Whittington, Debbie Balam, and Charlie Fazzino).** Principal and Project Manager for the completion of a SCCIC/NAHC record search, paleontological record search, NAHC record search request, and a site survey. Additional tasks included writing for the cultural section of the MND document (April 2018 – August 2018)
- **Phase I Survey for the 17-acre Olivas Park Extension commercial development project in Ventura, Ventura County, CA.** Principal and Project Manager for the completion of a SCCIC/NAHC record search, NAHC record search request, and a site survey, followed by limited monitoring. (January 2018 – June 2018)
- **Phase I(b) Survey of the proposed Forrest Club 50-acre private club development, Los Angeles County, CA (with Samantha Whittington and Charlie Fazzino).** Principal and Project Manager for the completion of a SCCIC/NAHC record search, NAHC record search request, and a site survey. In addition, 24 shovel test pits were excavated across the locations of two 1920s historic cabins. No further work was required. (April 2018 – June 2018)
- **Phase I Survey for the Ascension Lutheran Church Master Plan and MND, Thousand Oaks, California, Los Angeles County, CA.** Principal and Project Manager for the completion of a SCCIC/NAHC record search, NAHC record search request, and a site survey. (May 2018 – June 2018)
- **Cultural, Paleo, and Native American Monitoring for the Agoura Hills Marriott Development Project, Agoura Hills, CA.** Principal and Project Manager for this monitoring project. During monitoring, a prehistoric Chumash cultural resource was discovered (number not yet assigned), which led to artifact collection, analysis, and a final report of findings that was submitted to the City (January 2018 – June 2018)
- **Phase I Survey for the Mulholland Senior Living Project, Los Angeles County, CA.** Principal and Project Manager for the completion of a SCCIC/NAHC record search, NAHC record search request, and a site survey. (May 2018 – May 2018)
- **Phase I Survey of the proposed Tapo at Alamo EIR for a mixed-use development project, Simi Valley, Ventura County, CA (with Samantha Whittington and Debbie Balam).** Principal and Project Manager for the completion of a SCCIC/NAHC record search, NAHC record search request, and a site survey. (March 2018 – May 2018)
- **Phase I Survey of the Upper Bailey Road tract, Sylmar, Los Angeles County, CA (with Samantha Whittington and Debbie Balam).** Principal and Project Manager for the completion of a SCCIC/NAHC record search, NAHC record search request, and a site survey. (December 2017 – April 2018)

- **Phase I Survey of the Lower Bailey Road tract, Sylmar, Los Angeles County, CA (with Samantha Whittington and Debbie Balam).** Principal and Project Manager for the completion of a SCCIC/NAHC record search, NAHC record search request, and a site survey. (December 2017 – April 2018)
- **Historic Structure Evaluation of Blythe Elementary School for LAUSD.** Project Manager for this project, with Chattel, Inc., being the historic preservation consultant. (February 2018 – April 2018)
- **Historic Structure Evaluation of Robert Hill Lane Elementary School for LAUSD.** Project Manager for this project, with Chattel, Inc., being the historic preservation consultant. (February 2018 – April 2018)
- **Historic Structure Evaluation of James Madison Middle School for LAUSD.** Project Manager for this project, with Chattel, Inc., being the historic preservation consultant. School was found eligible for the CRHR. (February 2018 – April 2018)
- **Historic Structure Evaluation of 54th Street Elementary School for LAUSD.** Project Manager for this project, with Chattel, Inc., being the historic preservation consultant. School was found eligible for the CRHR. (February 2018 – April 2018)
- **Historic Structure Evaluation of Chapman Elementary School for LAUSD.** Project Manager for this project, with Chattel, Inc., being the historic preservation consultant. (February 2018 – April 2018)
- **Historic Structure Evaluation of Dena Street Elementary School for LAUSD.** Project Manager for this project, with Chattel, Inc., being the historic preservation consultant. (February 2018 – April 2018)
- **Historic Structure Evaluation of Patrick Henry Middle School for LAUSD.** Project Manager for this project, with Chattel, Inc., being the historic preservation consultant. School was found eligible for the CRHR. (February 2018 – April 2018)
- **Historic Structure Evaluation of Richland Avenue Elementary School for LAUSD.** Project Manager for this project, with Chattel, Inc., being the historic preservation consultant. (February 2018 – April 2018)
- **Marinette Road Residential Development, Pacific Palisades, Los Angeles County, CA.** Principal and project manager for this development project, which included a SCCIC/NAHC record search, site survey, Tribal Group scoping letters, and agency consultation. The major challenge was that the project property was within the Will Rogers State Monument and National Register site boundary. An update for this project was conducted in 2018 to include AB-52 compliance. (February 2015 – May 2015; January 2018 – April 2018)
- **Phase I Survey for 6956 Dume Drive, Malibu, California, Los Angeles County, CA (with Samantha Whittington).** Principal and Project Manager for the completion of an SCCIC record search, and a site survey. (February 2018 – March 2018)
- **Phase I Survey of roughly 50-acres for Improvements on the Saddlerock Ranch/Malibu Wines Property in the Santa Monica Mountains, Los Angeles County, CA.** Principal and Project Manager for the completion of a SCCIC/NAHC record search, NAHC scoping, and a site survey. This project involves upgrades to the winery existing structures and public buildings, as well as road and parking improvements. Part of this project is located near a National Register Chumash rock art site as well as other prehistoric resources (November 2016 – March 2018)
- **Phase I Survey for 28730 Grayfox, Malibu, California, Los Angeles County, CA (with Samantha Whittington).** Principal and Project Manager for the completion of an SCCIC and NAHC record search, and a site survey. (January 2018 – February 2018)

- **Phase I Survey for 11681 Foothill Boulevard, a multiple-unit residential project in Sylmar, California, Los Angeles County, CA.** Principal and Project Manager for the completion of a SCCIC/NAHC record search, NAHC record search request, and a site survey. This project also included a Native American Tribal Cultural Resource Assessment. (November 2017 – February 2018)
- **Phase I Survey for a single family property development along Yerba Buena Road, Ventura County, CA.** Principal and Project Manager for the completion of an SCCIC and NAHC record search, and a site survey. (December 2017 – January 2018)
- **Phase I Survey for 34134 Mulholland Highway, Los Angeles County, CA.** Principal and Project Manager for the completion of a SCCIC/NAHC record search, NAHC record search request, and a site survey. (December 2017 – January 2018)
- **Faunal, Osteological, Archaeological, and Fossil Consultation for Citadel Environmental and Turner-Hunt for the Hollywood Park Development Project (new Rams NFL Stadium).** Osteological and paleontological consultant for Kiewit, Turner, and Citadel for the construction of the new Rams NFL stadium in Inglewood. Project included discovery and recordation of modern and fossil mammal bones. We were the official on-call cultural/paleo resources team for the Rams Stadium project, being called in to deal with modern faunal and ancient fossil remains found during excavation. We worked closely with the construction team to get an expert on site within 24-hours of the discovery or quicker, with the goal of getting the discovery assessed and the construction team back to work as soon as possible. (December 2016 – January 2018)
- **Phase I Survey for 24600 Thousand Peaks Road, Calabasas, California, Los Angeles County, CA.** Principal and Project Manager for the completion of a SCCIC/NAHC record search, NAHC record search request, and a site survey. (November 2017 – January 2018)
- **Phase I Survey for 28929 Grayfox, Malibu, California, Los Angeles County, CA.** Principal and Project Manager for the completion of an SCCIC and NAHC record search, and a site survey. (November 2017 – January 2018)
- **Manzanita School Phase Ia Survey for a 20.27-acre private school development in Topanga Canyon, California, Los Angeles County, CA.** Principal and Project Manager for the completion of an SCCIC and NAHC record search, and a site survey. This project also assessed built environment resources, which included early 1900s buildings, early 1900s water control features, culverts, and bridges, and 1950s landscaping elements (May 2017 – January 2018)
- **Phase I Survey for the 181 to 187 Monterey Road Condominium Project, a small residential development near South Pasadena, California, Los Angeles County, CA.** P Principal and Project Manager for the completion of an SCCIC and NAHC record search, and a site survey. (July 2017 – January 2018)
- **Phase I Survey for the Agoura Village project, a 7.37-acre Commercial Subdivision in the City of Agoura Hills, Los Angeles County, CA.** Principal and Project Manager for the completion of a SCCIC/NAHC record search, NAHC scoping, and a Phase Ia site survey. The Phase Ia survey was followed by a Phase Ib subsurface survey and an updated site form for a previously known prehistoric cultural resource that includes the entire project area. (October 2016 – December 2017)
- **Phase I survey for 22866 Beckledge Terrace, Malibu, California.** Principal and Project Manager for the completion of a SCCIC/NAHC record search, NAHC record search request, and a site survey. (September 2017 – November 2017)
- **Lynn Road Residential Development Project, Construction Monitoring, Newbury Park, CA.** Principal and Project Manager for the surface collection and construction monitoring for this 10-acre residential construction project. (October 2017 – November 2017)

- **Phase II Evaluation of two cultural resources located on the Oakmont project property, City of Agoura Hills, Los Angeles County, CA.** Principal and Project Manager for the evaluation of a prehistoric cultural resource and a 1920s-1980s historic homestead cultural resource. Evaluation tasks included shovel test pits, and a test unit for the prehistoric cultural resource, and detailed mapping and documents research for the historic cultural resource. A combined report for both Oakmont projects was produced for the City. (August 2017 – October 2017)
- **City of Pomona Environmental On-Call (Including Cultural Resources), Los Angeles County, CA.** Envicom successful won inclusion as one of six on-call environmental firms for the City. (October 2014 – October 2017)
- **Phase I Survey for the Oakmont commercial project, a 5.75-acre development in the City of Agoura Hills, Los Angeles County, CA.** Principal and Project Manager for the completion of NAHC record search, and a Phase Ia site survey. The Phase Ia survey identified two cultural resources; a 1920s historic homestead foundation, and a large prehistoric archaeological site. (August 2017 – October 2017)
- **Phase I Assessment of the West Hills Crest 37-acre Residential Subdivision in West Hills, City of Los Angeles.** Principal and Project Manager for the completion of a SCCIC/NAHC record search and project area site survey. A key issue for this project was the record search being positive for a prehistoric cultural resource within the development area. This resource, CA-LAN-1223, was further investigated with 22 shovel test pits, and evaluated as not being a significant cultural resource. (February 2017 – October 2017)
- **San Bernardino County Cultural, Historic Architecture, and Paleontology On-Call, San Bernardino, CA.** Envicom successful won inclusion in the limited on-call pool. (October 2014 – October 2017)
- **Phase I Survey for 15498 LaPeyre Court, a residential development in Moorpark, Ventura County, CA.** Principal and Project Manager for the completion of a SCCIC/NAHC record search, NAHC record search request, and a site survey. Project also included coordination with numerous biology tasks. (August 2017 – September 2017)
- **Canyon View Estates Paleontological Survey, Santa Clarita, Los Angeles County, CA.** Principal and Project Manager for this paleontological record search, site survey, and report. (August – September 2017)
- **North Canyon Ranch 170-acre Residential Subdivision in Simi Valley, Ventura County, CA.** Principal and Project Manager for the completion of a SCCIC/NAHC record search and project area site survey. A key issue for this project was a previously disturbed cultural resource within the project area, the destruction of which needed to be addressed in the final report. (May 2017 – August 2017)
- **Phase I Survey for the 12300 Valley Boulevard Hotel, a commercial development in El Monte, Los Angeles, CA.** Principal and Project Manager for the completion of a SCCIC/NAHC record search, NAHC record search request, and a site survey for this small residential development. (June 2017 – August 2017)
- **Phase Ia Survey for the Holiday Inn Express Hotel, a commercial development in El Monte, Los Angeles, CA.** Principal and Project Manager for the completion of a SCCIC/NAHC record search, NAHC record search request, and a site survey for this small residential development. (July 2017 – August 2017)
- **Arcadia Town Homes MND Phase I Cultural Assessment for a multi-unit residential development in Arcadia, Los Angeles, CA.** Principal and Project Manager for the completion of a SCCIC/NAHC record search, NAHC record search request, and a site survey for this multi-unit residential development. (May 2017 – August 2017)

- **Phase I Survey for 3800 Figueroa, an apartment complex development in Los Angeles, Los Angeles County, CA.** Principal and Project Manager for the completion of a SCCIC/NAHC record search, NAHC record search request, and a site survey for apartment complex development. (June 2017 – August 2017)
- **Phase I Survey for the Copper Canyon Project, a 5-acre residential development near Santa Clarita, California, Los Angeles County, CA.** Principal and Project Manager for the completion of a SCCIC/NAHC record search, NAHC record search request, and a site survey. Also part of the project was the resurvey of two previously recorded cultural resources within the project boundary. (May 2017 – July 2017)
- **Phase Ia Survey for the Oneonta Hillside Drive, a residential development in South Pasadena, Los Angeles County, CA.** Principal and Project Manager for the completion of an SCCIC and NAHC record search, and a site survey. (May 2017 – July 2017)
- **Construction Monitoring for Parcel 2058-003-010, Lobo Canyon, Los Angeles County.** Principal and Project Manager for the surface collection and construction monitoring for this single family residential construction project. (July 2017).
- **Phase I Survey for the 6625 Bradley Road, a residential development in Somis, Ventura County, CA.** Principal and Project Manager for the completion of a SCCIC/NAHC record search, NAHC record search request, and a site survey for this small residential development. (June 2017 – July 2017)
- **11172 Santa Paula Road Phase Ia Survey for a 5.5-acre Agricultural property in Ojai, California, Ventura County, CA.** Principal and Project Manager for the completion of a SCCIC/NAHC record search, NAHC record search request, and a site survey. (May 2017 – June 2017)
- **Pepperdine University Campus Life Project: Updated Cultural Resources Record Search.** Principal and Project Manager for an updated record search and letter report for the Pepperdine Campus Life housing, facilities, and trail development project. This update was part of an amended campus-wide EIR (December 2017 – June 2017)
- **Pepperdine University Campus Life Project: Phase I survey of new Baseball Field development.** Principal and Project Manager for the addition of the campus baseball field as part of the larger Pepperdine Campus Life housing, facilities, and trail development project. (February 2017 – June 2017)
- **6658 Reseda Boulevard, City of Reseda, Los Angeles County, CA.** Principal and Project Manager for a Phase I record search for this urban mixed use project. (March 2017 – May 2017)
- **Paradise Valley Development Project Environmental Impact Report and Impact Statement, Riverside County, CA.** Author of the cultural section for this EIR for a housing and mixed use development of over 2200-acres east of Indio, California. Also reviewed original technical documents, and incorporated legal and agency comments. Mitigation measures included the management and monitoring of dozens of cultural resources, sensitive soils, and paleontological resources. (October 2014 – March 2017)
- **Phase I Cultural Resources Survey for Parcel 2058-003-010, Lobo Canyon, Los Angeles County, CA.** Principal and Project Manager for completion of a Phase I and Army Corps of Engineers permit for the project (ACOE, Los Angeles District). Extensive communications and consultation with the ACOE and SHPO. (July 2016 – March 2017)
- **Phase I Survey for a 1.33-acre Mixed-Use development in the City of Northridge at the corner of Nordoff and Darby Streets, Los Angeles County, CA.** Principal and Project Manager for the completion of a SCCIC/NAHC record search, NAHC scoping, and a site survey. This project included a built-environment assessment of existing historic structures (October 2016 – February 2017)

- **Phase I Survey for a 0.5-acre Residential Subdivision in the City of Los Angeles at the end of Crisler Way, Los Angeles County, CA.** Principal and Project Manager for the completion of a SCCIC/NAHC record search, NAHC record search request, and a site survey. (October 2016 – February 2017)
- **Deer Lake Residential Development Cultural Monitoring, Porter Ranch, Los Angeles, CA.** Principal and Project Manager for the cultural monitoring of eight cultural resources within the project development boundary. This project includes the writing of a final Monitoring Report. (May 2016 – February 2017)
- **Phase I Survey for a 0.5-acre Mixed Use Development Project on Camarillo Avenue in North Hollywood, Los Angeles County, CA.** Principal and Cultural Project Manager for the completion of a SCCIC/NAHC record search, NAHC scoping, and a site survey. This project also included a historic built environment assessment (November 2016 – January 2017)
- **Phase I Survey for a 14-acre Residential Subdivision in Woodland Hills, CA.** Principal and Project Manager for the completion of a SCCIC/NAHC record search, NAHC scoping, and a site survey. This project involved consultation with the City of Los Angeles on AB-52 (July 2016 – January 2017)
- **Lynn Road Residential Development Project, Newbury Park, CA.** Principal and Project Manager for the Phase Ia and Phase Ib survey of this 10-acre parcel. A large prehistoric Middle-Period seasonal settlement was discovered, which required subsurface testing and extensive mapping of surface hearths, yucca roasters, and dwelling features. Project included public testimony before the Thousand Oaks Planning Commission. (September 2015 – December 2016)
- **Pepperdine University Campus Life Project: Debris Basin Excavation Cultural and Paleontological Resource Monitoring, Los Angeles, CA.** Principal and Project Manager for cultural resource monitoring of Phase I of the Pepperdine Campus Life housing, facilities, and trail development project. (August – October 2016)
- **Trail Construction Monitoring, Conrad N. Hilton Foundation.** Principal and Project Manager for the development of a pedestrian foot trail loop between the Foundation and the nearby “Ridge” professional building, including the excavation of dozens of shovel test pits and a major surface collection of prehistoric artifacts, including trail construction monitoring. (August – September 2016)
- **Conrad N. Hilton Foundation Trail Project Cultural Assessment, Agoura Hills, Los Angeles County, CA.** Project Manager for the Phase Ib survey of a new pedestrian access trail linking off-site office space with the Foundation campus buildings. Project included the excavation of over 30 shovel test pits and the recording of numerous prehistoric features. (May – August 2016)
- **32640 PCH Phase I Cultural Resource Survey, Santa Monica, CA.** Principal and Project Manager for the Phase I cultural resource assessment of a ravine rehabilitation project between the Pacific Coast Highway and the Pacific Ocean. Included a SCCIC/NAHC record search, site survey, and technical report. (May 2015 – June 2016)
- **CA-LAN-320 Project Compliance Plans, and Native American and Lead Agency Consultation, Agoura Hills, Los Angeles County, CA.** Tasks included the authoring of a cultural resource Treatment and Data Recovery Plan, a cultural resource Management Plan, and a Curation Plan for all artifacts, as well as the organization of meetings with the Chumash Tribal Groups and the Lead Agency. (April 2015 – June 2016)
- **Canyon Park Homes, Sylmar, Los Angeles County, CA.** Native American Tribal Group consultation and pre-construction monitoring for this 80-acre residential property development, as well as EIR section writing. (February 2015 – March 2016)

- **Oakwood Schools Built Environment and Archaeological Assessment, North Hollywood, Los Angeles County, CA.** Principal and Project Manager for the Phase I cultural resource assessment of the project property prior to the construction of a new middle and high school campus within the North Hollywood area. Challenging tasks included Native American ghost writing for the lead agency (City of Los Angeles) and addressing a modern human cremation garden in the report (November 2015 – February 2016)
- **Floral Canyon Residential Development Cultural Resource Survey, North Hollywood, CA.** Principal and Project Manager for this Phase Ia cultural resource survey of an 8-acre property. The cultural resource parts of the CEQA checklist were also completed. (September – December 2015).
- **Hilton Property Phase 3 Construction Site Phase Ib Cultural Resources Survey, Agoura Hills, Los Angeles County, CA.** Principal and Project manager for this extensive preliminary survey project, including excavation of over 200 shovel test pits and 4 test units to define the boundaries of a prehistoric ceremonial site of over 80-acres in size, used by Chumash Native Americans from 400 A.D. to the late 1700s. Recordation of over 190-features and 11,500 artifacts. Second phase will include data recovery tasks and an amended Environmental Impact Report. (February 2014 – March 2015)
- **Blessed Theresa Church Construction, City of Winchester, Riverside County, CA.** Cultural consultation including cultural/paleo monitoring issues. (April 2014 – July 2014)
- **Village at Los Carneros, City of Goleta, Santa Barbara County, CA.** Reviewed all previous technical studies and wrote part of the cultural sections of the Environmental Impact Report for this residential house development project. (March 2014 – April 2014)
- **3121 Old Topanga Canyon Road Phase I Survey and Literature Search, City of Calabasas, Los Angeles County, CA.** Principal and Project manager for this residential development project, including NAHC letters, literature review, site survey, paleontological survey and literature search, final technical report, and the writing of the cultural resources section of the Environmental Impact Report. (March 2014 – April 2014)

**Cultural Division Director, Chambers Group, Inc., Santa Ana, CA
October, 2011 – October 2013**

As Cultural Director, I oversaw all existing cultural, paleontological, ethnographic, and built environment projects for Chambers Group. Projects were staged out of seven regional offices located within California and Nevada. I oversaw a permanent staff of 20 individuals and a temporary staff of up to 40 people. I also was responsible for business development and coordination of projects with multi-disciplinary teams, including Biology, Air Quality, SWPPP, and Planning professionals. I reviewed and authored cultural sections of EA, EIR, and EIS documents. I also wrote proposals, oversaw quality control, provided cultural compliance sections of technical reports, developed agency relationships, wrote technical reports, managed and developed budgets, and oversaw all cultural staff. I performed QA/QC on all documents and ensured that management and mitigation measures were clearly defined and legally-defendable. Yearly Division budget was up to 3-million dollars annually.

Energy Projects:

- **Beacon Solar, Hecate Energy and LADWP, Kern County, CA.** Business Developer for the archaeology and biological monitoring, pre-construction surveys, and desert tortoise fence monitoring for this large, 2000-acre solar project for the Los Angeles Department of Water and Power. (July – October 2013).
- **Q-Cells Solar Survey, Palm Springs, Riverside County, CA.** Principal and Project Manager for a cultural survey and record search of 36-acres north of Palm Springs for solar development. (October 2013 – October 2013)
- **Pacific Gas and Electric NERC Support Monitoring, sub to URS, Northern and Central California.** Principal and Project Manager for this 4-year project in support of the national NERC power pole reliability project for PG&E. Involves cultural, biological, and paleontological monitoring and field surveys. (October 2013 – October 2013)
- **Gold Bar Transmission Line Survey, McEwen Mining, Eureka County, NV.** Principal and Project Manager for this 2,577-acre cultural survey for the development of a 33-mile transmission line to service the Gold Bar Mine in Nevada. Bureau of Land Management was the principal Federal agency. (April 2013 – October 2013).
- **East Kern Wind Resource Area (EKWRA) Power Pole Replacement Project, Environmental Intelligence / Southern California Edison, Kern County, CA.** Principal and Project Manager. This two-year project included cultural resource surveys, the evaluation of numerous cultural sites, and cultural and paleontological monitoring for the construction of over 130-miles of new power poles and fiber optics lines to service Tehachapi Mountain wind farms. (January 2013 – October 2013)
- **Pure Source Power, Victorville, San Bernardino, CA.** Principal and Project Manager for a cultural survey and record search of 140-acres north of Palm Springs for solar development. (September 2013 – October 2013)
- **Dry Ranch Solar Project, Silverado Power, Los Angeles County, CA.** Principal. Dr. Bischoff managed this 64-acre solar project near Lancaster, which included a SCCIC/NAHC record search, field survey, and cultural report to meet CEQA compliance. This project included coordination with Southern California Edison for a gen-tie line and telecom attachments. (March - April 2013)
- **Plainview Solar Project, Silverado Power, Los Angeles County, CA.** Principal. Dr. Bischoff managed this 114-acre solar project near Lancaster, which included a SCCIC/NAHC record search, field survey, and cultural report to meet CEQA compliance. (April - May 2013)
- **Silverleaf Solar Project, Cultural and Paleontological Survey, Agile Energy, Imperial County, CA.** Principal and Project Manager. Dr. Bischoff provided general review and quality control for a large solar project south of San Diego. This project involved an over 2,000-acre survey of proposed solar fields and 5-miles of electrical transmission gen-tie lines. The bureau of Land Management was the principal Federal agency. (November 2011 - July 2012)
- **Desert Harvest Solar Project, Cultural Resources Survey, eneXco Energy, Riverside County, CA.** Project Manager. Dr. Bischoff was the project manager for the built environment survey of 1,600-acre solar field and 12-miles of electrical transmission gen-tie lines. (November 2011 - June 2012)
- **Silverleaf Solar Project, Built Environment Survey, Agile Energy, Imperial County, CA.** Project Manager. Project Manager. Dr. Bischoff was the project manager for the built environment survey of 2,000-acre solar field and 5-miles of electrical transmission gen-tie lines. This included the production of a separate technical report for the Bureau of Land Management that included a historic structure inventory, assessment of significance, and an indirect effects analysis. (November 2011 - July 2012)

- **IVSC2 Solar Project, County of Imperial, Imperial County, CA.** Principal and Project Manager. Dr. Bischoff provided oversight of the 140-acre solar project east of the Salton Sea. This project was notable for the quick response time required to field a survey crew and complete a draft report for the County (Sept-Oct 2012)
- **Desert Harvest Solar Project, Cultural and Paleontological Resource Survey, eneXco Energy, Riverside County, CA.** Principal and Project Manager. Dr. Bischoff provided general review and quality control for a large solar project northeast of Blythe, CA. This project involved an over 1,600-acre survey of proposed solar fields and 12-miles of electrical transmission gen-tie lines. Bureau of Land Management was the principal Federal agency. (November 2011 - July 2012)
- **Desert Harvest Solar Project, Build Environment Survey, eneXco Energy, Riverside County, CA.** Project Manager. Dr. Bischoff was the project manager for the built environment survey of 1,600-acre solar field and 12-miles of electrical transmission gen-tie lines. This included the production of a separate technical report for the Bureau of Land Management that included a historic structure inventory, assessment of significance, and an indirect effects analysis. (November 2011 - June 2012)

Telecommunication Projects:

- **AT&T Fiber-optics Renewal Project, Evaluations, Mitigations, and Monitoring, AT&T, San Bernardino County, CA.** Cultural Principal and Project Manager. Dr. Bischoff will provide project management, technical writing, and quality control for the cultural and paleontological evaluations, data recoveries, and monitoring efforts for the AT&T fiber renewal project. This project involved the survey of over 90 miles of proposed new fiber-optic line between Barstow and Las Vegas, NV, and the management of over 100-cultural sites. Bureau of Land Management and Mojave National Preserve were the principal Federal agencies. (July 2013 – October)
- **Fiber Node Evaluations, Freedom Communications, Orange County, CA.** Cultural Principal. Dr. Bischoff provided general project management and quality control for the cultural background record searches and surveys for dozens of telecommunication sites throughout the City of Irvine as part of the Freedom Communications site development project. Dozens more sites are expected to be tested in the coming year. (April 2012 – October 2013)
- **San Diego Churches and Public Building Historic Structure Evaluations, DePratti Inc., City of San Diego, CA.** Principal Investigator. Dr. Bischoff acted as Principal and QA/QC manager for this project, which involved the evaluation of dozens of historic structures as part of the DePratti Communication telecommunication attachment project in the City of San Diego. (November 2011 – October 2013)
- **The Plunge Evaluation, DePratti Inc., City of San Diego, San Diego County, CA.** Principal for this historic architecture project involving the structural evaluation and National Register documentation for The Plunge historic salt-water bath house in San Diego. (September 2013 – September 2013)
- **AT&T Fiber-optics Renewal Project, Surveys, Literature Searches, and Technical Studies, AT&T, San Bernardino County, CA.** Cultural Principal and Project Manager. Dr. Bischoff provided general project management and quality control for the cultural, paleontological, and ethnographic surveys, literature searches, and technical studies. This project involved the survey of over 90 miles of proposed new fiber-optic line between Barstow and Las Vegas, NV, and the management of over 100-cultural sites. Bureau of Land Management and Mojave National Preserve were the principal Federal agencies. (April 2012 – July 2013)

- **Digital West Fiber Line Feasibility Study, San Luis Obispo to Los Angeles, Counties of San Luis Obispo, Santa Barbara, Ventura, and Los Angeles, CA.** Project Manager for this large feasibility study for placing a new fiber line down the US 101 freeway corridor. Biological, cultural, paleontological, and permitting constraints were all examined. (April 2012 – July 2013)
- **Digital 395 Broadband Stimulus Project, Praxis and California Broadband Corporation, California and Nevada.** Cultural Director. Dr. Bischoff acted as the California report manager of the cultural division, directed fieldwork, and authored management documents and reports. This project involved the new installation of over 650 miles of fiber-optic line across California and Nevada. The programmatic agreement of this complex project included 10 federal, state, and tribal agencies, with another seven acting as interested parties, and the management, evaluation, and monitoring of over 170 cultural sites. NTIAA was the Principal Federal Agency, but also involved twelve other California and Nevada State and Federal agencies and Tribal Groups (November 2011 – April 2012)

Defense Projects:

- **Fort Irwin Cell Tower Geotech Boring Monitoring, Northrop-Grumman and Fort Irwin Army Post, San Bernardino County, CA.** Principal. This project involves the cultural and paleo monitoring of sensitive areas as part of the construction of over 24 new cell tower locations. (October 2013 – October 2013)
- **Edwards Airforce Base Telecommunication Cultural Monitoring, Team Fischel Company, Edwards AFB, Kern County, CA.** Project Manager and Principal for the cultural monitoring of 40-miles of telecommunication trenching on Edwards AFB, including pre-construction meetings and a final monitoring report. (May 2013 – Sept. 2013)
- **Fort Irwin Cell Tower Surveys and Monitoring, Northrop-Grumman and Fort Irwin Army Post, San Bernardino County, CA.** Principal. This project involves the cultural and paleo survey of over 24 new cell tower locations and associated access roads on Fort Irwin, as well as construction phase monitoring. (April 2013 – October 2013)
- **Marine Corps Base, Camp Pendleton, Cultural Resources Consultation, Marine Corps Base, Pendleton, San Diego County, CA.** On-Call Senior Cultural Resources Consultant. Dr. Bischoff provided senior-level cultural resource consultation related to Camp Pendleton’s Basewide Utilities Infrastructure Improvements project. He provided consulting on cultural resource management for several waste treatment and utility line systems as part of the Camp’s “Grow the Force” initiative. (2011 – October 2013)

Water Projects:

- **Pacoima Spreading Grounds Improvement Project, LACDPW, Los Angeles County, CA.** Cultural Principal. Dr. Bischoff managed the cultural resources record search and CEQA cultural section mitigation measures of an EIR for the improvement of the Pacoima spreading grounds and related canal resources. (April 2013 – October 2013)
- **Devil’s Gate Reservoir Sediment Removal and Management Project, LACDPW, Los Angeles County, CA.** Principal of Cultural Resources. This project involved removal of sediment within the Devil’s Gate Reservoir area, which required a preliminary cultural survey and record search under CEQA, as well as an EIR. Dr. Bischoff served as the cultural principal for the project and provided a recommended plan for dealing with sedimentary soils vs. native soils, monitoring criteria, and potential discovery situations. Dr. Bischoff helped write Environmental Impact Report sections, and worked with the Gabrieleno Tribal Group in the protection of archaeological and tribal cultural resources. (2011 – October 2013)

- **Peck Road Spreading Basin Improvement Project, LACDPW, Los Angeles County, CA.** Cultural Principal. Dr. Bischoff managed the cultural resources record searches, field survey, paleontological survey, and CEQA cultural section mitigation measures of an MND for the improvement of the Peck Road Spreading Basin, including a related new water discharge pipe. (June 2013 – September 2013)
- **Marina Del Rey Waterline Replacement Project Cultural Monitoring, LACDPW, Los Angeles County, CA.** Cultural Principal. This project with the Los Angeles Department of Public Works involved the cultural monitoring for the Marina Del Rey 18-inch Waterline Replacement. Chambers Group also provided a qualified archaeological monitor at the project site during excavation activities during construction. (March - May 2013)
- **Dieguito Wetlands Restoration Monitoring, Southern California Edison, Del Mar, San Diego County, CA.** Principal Investigator and Project Manager. This project involved the extensive rehabilitation of Southern California Edison property as part of the Dieguito Wetlands Restoration project. (April 2012 - January 2013)
- **Live Oaks Spreading Grounds Project, LACDPW, Los Angeles County, CA.** Cultural Principal. Dr. Bischoff managed the cultural resources record search and site visit for this public works project. (April 2013 – October 2013)
- **Los Penasquitos Wetlands Monitoring, AMEC, Del Mar, San Diego County, CA.** Principal Investigator. Dr. Bischoff managed the monitoring tasks, budgets, and professional standards for this project near the City of Del Mar as part of the Torrey Pines State Nature Reserve restoration. (October - December 2012)
- **San Geronio Creek Water Recharge Basin Construction Monitoring, Beaumont Cherry Valley Water District, Cherry Valley, Riverside County, CA.** Principal and Project Manager. This project involved paleontological and archaeological construction monitoring during construction, including emergency evaluation and monitoring when early 19th Century structures and materials were unexpectedly encountered during earth moving. (February 2012 – April 2012)
- **Penmar Golf Course Water Quality Improvement Project, Pacific Hydrotech and City of Santa Monica, Santa Monica, CA.** Principal Investigator. Dr. Bischoff managed QA/QC review, budgets, and professional standards for the project in the City of Venice. Penmar was a multi-year waterline and tank improvement project in which evidence of ethnic Japanese barrios and fossil Pleistocene animal bones were discovered. (November 2011 - November 2012)
- **Oxford Retention Basin Flood Protection Project, LACDPW, Los Angeles County, CA.** Principal and Project Manager. The Oxford Basin in Marina Del Rey was receiving enhancement, and Dr. Bischoff managed the completion of the cultural survey, literature review, and construction monitoring for the project. (2011 - 2012)

Public Works Projects:

- **Veterans Administration, VISN 21 On-Call, Western States, Teamed with KAL Architects.** This project will provide cultural and biological technical services for Veterans Administration projects from October 2013 to October 2018. (October 2013 – October 2013)
- **Historic Structure Evaluations for Statewide Weatherization Efforts, sub to ICF for the State of California, All Counties, CA.** Project Manager and Principal. This project involves meeting NEPA compliance for low-income subsidized weatherization efforts throughout the State of California. Hundreds of structures will be evaluated as part of this project by a Chambers Architectural Historian using an abbreviated format. (November 2011 to October 2013)
- **CEQA Services for Improvements to Polytechnic and Wilson High Schools, LBUSD, City of Long Beach, CA.** Cultural Principal. Dr. Bischoff provided oversight and incorporation of the historic architecture technical reports into the project CEQA documents. (June 2013 – August 2013)

- **Mill Creek Crew Room Cultural Monitoring, Angeles National Forest (ANF), Los Angeles County, CA.** The County of Los Angeles Department of Public Works proposed to replace the crew room building within the Angeles Forest Mill Creek Summit Maintenance Yard facility. This CEQA/NHPA project involved the preparation of a treatment and discovery plan document, ARPA permitting, constant consultation with the ANF, construction monitoring, and a final monitoring report. (April – July 2013)
- **Review of Technical Report and CEQA Documents Relating to the Proposed Demolition of Santa Ana Public Building #16, City of Santa Ana, Santa Ana, CA.** Principal. This project involved the review of technical documents, mitigation measures, and CEQA documents relating to the demolition of a 1950s public building in the City of Santa Ana. (May 2013 – July 2013)
- **Roosevelt School, LBUSD, City of Long Beach, CA.** Cultural Principal. Dr. Bischoff provided oversight, authorship, and counsel on the EIR for the demolition of the Roosevelt Elementary School in Long Beach. This proved to be a complex project, involving an historic built environment resource evaluation and mitigation plan, legal investigation, and extensive responses to public comments. This process resulted in a HABS/HAER mitigation project. (November 2011 - June 2012)

Transportation Projects:

- **Foothill Toll Road Cultural and Paleontological Monitoring, Ghiradelli and Associates, Orange County, CA.** Principal and Project Manager for cultural monitoring related to the upgrade of all toll road payment stations in Orange County. (October 2013 – October 2013)
- **9th Street Extension Historic Structure Inventory and Evaluation, City of Holtville, Imperial County, CA.** Principal and Project Manager. Dr. Bischoff managed and provided QA/QC for this project involving a Caltrans inventory of project APE historic built environment resources, and the historic evaluation of a canal feature. Final deliverables included a Historic Resources Evaluation Report and a Historic Property Survey Report to CALTRANS standards. (June 2013 – August 2013)
- **Francisquito Bridges Replacement (3-Total), LADWP/CALTRANS, Los Angeles County, CA.** Principal. Dr. Bischoff managed and oversaw the completion of this project in the Angeles Forest. This project involved the replacement of three existing bridges on San Francisquito Canyon Road over San Francisquito Canyon Creek. The proposed improvement project involved widening the two lane bridges, improvement of approachment roadway, and the placement and installation of retaining walls, concrete barriers with tubular-steel handrails, and metal beam guardrails. (2011 – September 2013)
- **Murrieta Whitewood Road Extension, City of Murrieta, Riverside County, CA.** Principal and Project Manager. This road extension project involved a cultural resource survey and records search, a paleontological field study, and native American Consultation due to the historic use of the nearby Murrieta Hot Springs by local Native Americans. (April – June 2012)
- **Nuevo Road/ I-215 Interchange Improvement in the City of Perris, CALTRANS, Riverside County, CA.** Principal. Dr. Bischoff managed and provided QA/QC for this project involving street widening and additional improvements at the Nuevo Road/ I-215 interchange. Final deliverables included a SCCIC/NAHC record search and a survey report to CALTRANS standards. (2011 – 2012)
- **Soledad Canyon Road Bridge Replacement Project, LACDPW, Los Angeles County, CA.** Principal. LADPW intends to replace a bridge on Soledad Canyon Road. Chambers Group completed a SCCIC/NAHC record search and NAHC records review for potential archaeological resources. This project is on-going and may in the future involve further work, including cultural and historic structure surveys and evaluation. (2011 – 2012)

Development Projects:

- **Grove Lumber Facility Cultural and Paleontological Technical Studies, Thatcher Engineering, City of Perris, Riverside County, CA.** Principal for the cultural technical studies for this development project, including cultural and paleontological record searches, NAHC letters, and a cultural study (October 2013 – October 2013)
- **Newport Beach Yacht Club Evaluation, Community Development Department, City of Newport Beach, Orange County, CA.** Principal for this historic architecture project involving the built environment evaluation of the Newport Beach Yacht House. (October 2013 – October 2013)
- **Blossom Plaza Historic Structure Evaluation, China Town, City of Los Angeles, CA.** Principal for this historic architecture project involving the updating of technical reports and a standing structure evaluation. (July 2013 – September 2013)
- **Moreno Valley Residential Building Evaluation, City of Moreno Valley, Riverside, CA.** Principal for the architectural assessment of the J. Langdon Ranch located at 11761 Davis Street, in the city of Moreno Valley, Riverside County, California. (April 2013)
- **Indian Wells Tennis Court Development Project, Indian Wells, Riverside County, CA.** Principal Provided technical review of the planning documents cultural section, as well as oversaw Native American Heritage Commission communication for this project to enhance the Indian Wells Tennis Garden complex. (December 2012 – April 2013)
- **Scripps Hospital Paleontological and Archaeological Monitoring, Worley-Parsons, City of Encinitas, CA.** Principal Investigator. Dr. Bischoff managed QA/QC review, budgets, and professional standards for the cultural and paleontological monitoring of this large development project. (2011 - 2013)

Mining Projects:

- **Mining Projects, Quality Control and Management Support – Ormat, Enviroscientists, Newmont, McEwen, Midway, Reno, Nevada.** Dr. Bischoff was directly involved with the management of dozens of mining-related surveys, monitoring, and site evaluation projects conducted from the Chambers Group Reno, Nevada, office. Bureau of Land Management was the principal Federal agency. (2011 – October 2013)
- **Ruth Mine Reclamation Cultural Survey and Evaluation, ERRG and USACE, Inyo County, CA.** Principal. Dr. Bischoff oversaw the Intensive Phase I mapping of the Ruth Mine site, evaluation of several site features, and negotiations with the Army Corps of Engineers and the BLM. Extensive mapping of Mine features and structures were completed as part of this project. Bureau of Land Management was the principal Federal agency. (2011 - 2012)

Staff Archaeologist, Marine Corps Base Camp Pendleton, San Diego County, CA. June 2011 – Oct. 2011

Dr. Bischoff was a staff cultural resources specialist at Camp Pendleton, and worked on NEPA, Section 106, and Section 110 compliance requirements for resource management and Base construction projects. Dr. Bischoff was responsible for writing, developing, and executing cultural sections of CATEXs, EAs, EISs, and organized/reviewed NHPA Section 106 and Section 110 reports. Types of projects included archaeological surveys and evaluations, historic research, and monitoring projects. He also performed historic structure surveys and evaluations, and wrote and prepared appropriate documentation to meet construction project cultural and environmental compliance requirements.

**Principle Investigator and Project Manager, Pacific Legacy, Inc., Lancaster, CA.
Sept. 2009 – June 2011**

While at Pacific Legacy, I acted as the cultural resource principal and project manager for various Pacific Legacy clients, including the San Jose Water District, Aera Energy, Berry Petroleum, Quad Knopf, AT&T, and **Southern California Edison**. My primary responsibility was the oversight of subcontracted services to Southern California Edison's Tehachapi Renewable Transmission Project (TRTP). The TRTP is one of the largest green-energy projects in the U.S. and involves the wreck-out and new construction of hundreds of transmission lines and power facilities to carry electricity from wind and solar generation sites to the greater Los Angeles area. During this time, I built the Lancaster office from a staff of two, to a fully-functioning regional office with a permanent staff of eight people and temporary staff of several dozen.

Major Projects:

- **Tehachapi Renewable Transmission Project (TRTP), Southern California Edison, Kern, Los Angeles, and San Bernardino Counties, CA.** Principal and Project Manager. Dr. Bischoff was responsible for all office and field operations that ensured the successful inventory and management of cultural resources related to this 300-mile transmission line project, including the management of standing historical structures and paleontological resources. He managed an annual budget in excess of \$4 million, a staff of up to 40 persons, wrote compliance documents (Programmatic Agreement Appendices, ARPA permits, Project Agency Yearly Reports, and Management Plans), and managed hazmat situations. Dr. Bischoff completed over 150 individual projects in southern California including survey, evaluation, mitigation, and resource monitoring. He wrote individual budgets for project-specific tasks, as well as construction-related administrative tasks, each with different scopes of work and budget amounts. He reconciled all budgets on a monthly basis and coordinated them with the master construction schedule. Dr. Bischoff managed field compliance with NEPA, with TRTP-specific environmental agency agreements, and with the cultural section of the project EIR/EIS and Programmatic Agreement. He also met legal and agency guidelines for Section 106 of NHPA, CEQA, NAGPRA, and TRTP Cultural Resource Management Plan. The Angeles National Forest was the lead Federal Agency, but the CPUC and other Federal and California State Agencies were also involved. (November 2009 - June 2011)
- **East Kern Wind Resource Area (EKWRA) Power Pole Replacement Project, Southern California Edison, Kern County, CA.** Principal and Project Manager. Dr. Bischoff managed original technical studies for a project designed to replace hundreds of power poles in the Tehachapi Mountains area in support of new wind farm construction. He conducted large area surveys, some on BLM properties, and developed a management plan for dozens of archaeological sites. Bureau of Land Management was the principal Federal agency. (February 2010 - June 2011)
- **San Jose Salt Barge HAER Documentation Project, USACE and Santa Clara Valley Water District, City of San Jose, CA.** Principal. Dr. Bischoff consulted on the excavation and evaluation of a shallow-water shipwreck discovered during a wetlands rehabilitation project. This project involved USACE, San Francisco District as lead agency and the Water District as client. (January – February 2011)
- **Operations and Maintenance Contract, Southern California Edison. Southern California.** I acted as the Principal for all work orders issued to our office under the O/M contract. A major task under this contract was the response to the Crown Fire in 2010. I worked directly with SCE during and immediately after the fire to evaluate and protect cultural resources. (Jan 2010 - June 2011)

- **Crown Fire Survey and Cultural Site Update, Southern California Edison, Los Angeles County, CA.** Project Manager. Dr. Bischoff led the cultural response to the Crown Fire, which included surveying and updating known cultural sites as part of the SCE post-fire power pole and access road inspection. (August – Sept. 2010)

APPENDIX D
PaleoWest Project Paleontology Report

April 1, 2021

Wayne Bischoff, Ph.D.
Director of Cultural Resources
Envicom Corporation
4165 East Thousand Oaks Boulevard, Suite 290
Westlake Village, California 91362
Transmitted via email to wbischoff@envicomcorporation.com

RE: Paleontological Resource Assessment for the 40th and I Project, Lancaster, Los Angeles County, California

Dear Dr. Bischoff,

At the request of Envicom Corporation (Envicom), PaleoWest LLC (PaleoWest) conducted a paleontological resource assessment for the 40th Street and I Avenue Project in the city of Lancaster, Los Angeles County, California. The goal of the assessment is to identify the geologic units that may be affected by development of the Project, determine the paleontological sensitivity of geologic units within the Project area, assess potential for impacts to paleontological resources from the development of the Project, and recommend mitigation measures to avoid or mitigate impacts to scientifically significant paleontological resources, as necessary.

This paleontological resource assessment includes the results of a fossil locality records search conducted by the Natural History Museum of Los Angeles County (NHMLAC), and a search of the University of California Museum of Paleontology's (UCMP) online database. The records search was supplemented by a review of existing geologic maps and primary literature regarding fossiliferous geologic units within the proposed Project vicinity and region. This technical memorandum, which was written in accordance with the guidelines set forth by the Society of Vertebrate Paleontology (SVP) (2010), has been prepared to support environmental review under the California Environmental Quality Act (CEQA).

PROJECT DESCRIPTION

The proposed Project is between West Avenue H to the north, 40th Street West to the east, West Avenue I the south, and 45th Street West to the west (Figure 1). The Project site consists of a parcel that totals approximately 30 acres in size. The Project area is in Section 12, Township 7 North, Range 13 West, of the Lancaster, CA 7.5' U.S. Geological Survey (USGS) topographic quadrangle. The Project proposes the development of the site for 163 single family homes for American Premiere Homes with connection to the county of Los Angeles sanitary sewer system, and an underground storm drain conduit. The subject property is a rectangularly-shaped site composed of four (4) parcels, including Assessor Parcel Numbers (APNs) 3108-018-014, 3108-018-044, 3108-018-045 and 3108-018-046.

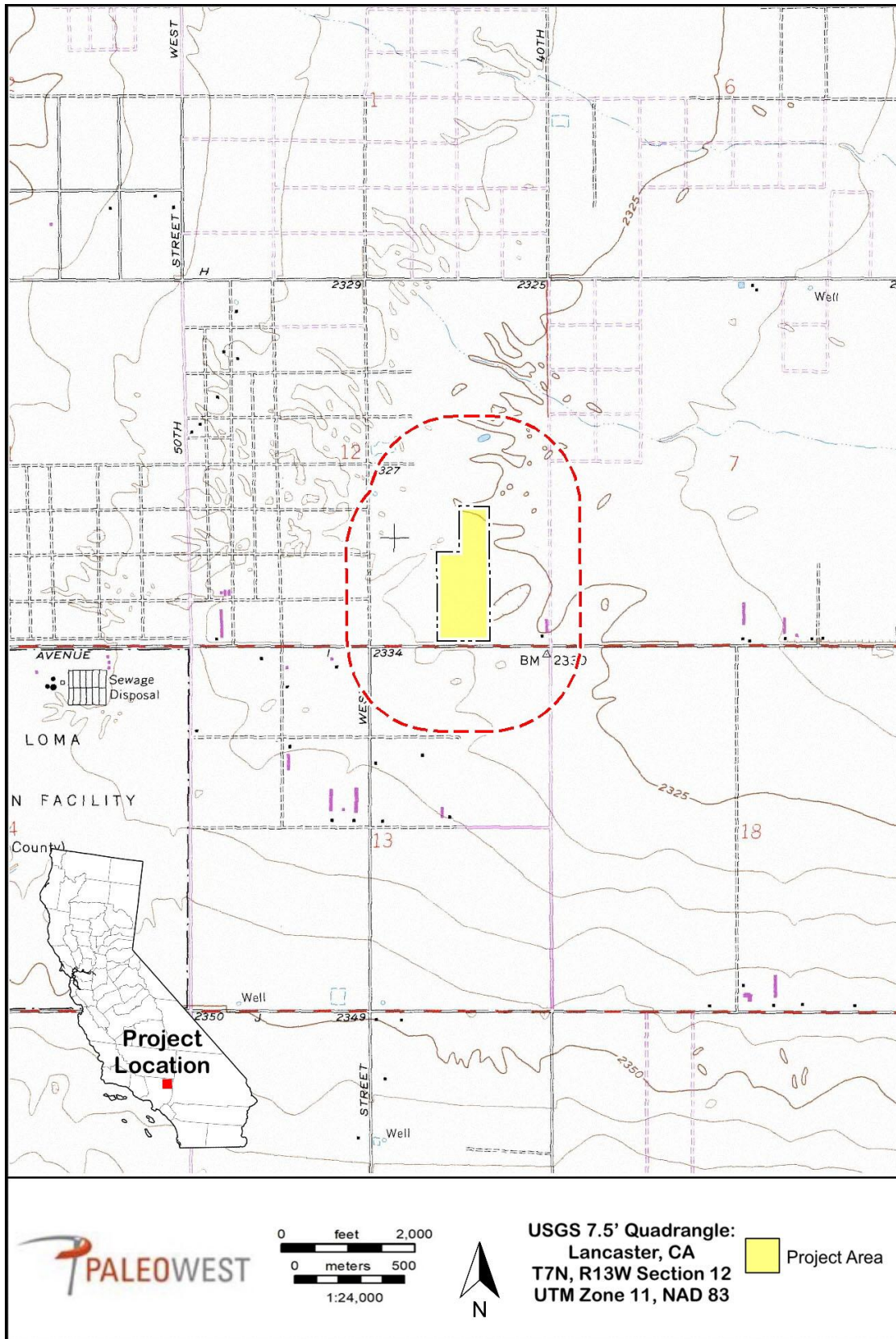

Figure 1. Project location map.

REGULATORY CONTEXT

CALIFORNIA ENVIRONMENTAL QUALITY ACT

CEQA requires that public agencies and private interests identify the potential environmental consequences of their Projects on any object or site of significance to the scientific annals of California (Division I, California Public Resources Code [PRC] Section 5020.1 [b]). Appendix G in Section 15023 provides an Environmental Checklist of questions (PRC 15023, Appendix G, Section VII, Part f) that includes the following: “Would the project directly or indirectly destroy a unique paleontological resource or site or unique geological feature?”

CEQA does not define “a unique paleontological resource or site.” However, the Society of Vertebrate Paleontology (SVP) has provided guidance specifically designed to support state and Federal environmental review. The SVP broadly defines significant paleontological resources as follows (SVP 2010, page 11):

“Fossils and fossiliferous deposits consisting of identifiable vertebrate fossils, large or small, uncommon invertebrate, plant, and trace fossils, and other data that provide taphonomic, taxonomic, phylogenetic, paleoecologic, stratigraphic, and/or biochronologic information. Paleontological resources are considered to be older than recorded human history and/or older than middle Holocene (i.e., older than about 5,000 radiocarbon years).”

Significant paleontological resources are determined to be fossils or assemblages of fossils that are unique, unusual, rare, diagnostically important, or are common but have the potential to provide valuable scientific information for evaluating evolutionary patterns and processes, or which could improve our understanding of paleochronology, paleoecology, paleophylogeography, or depositional histories. New or unique specimens can provide new insights into evolutionary history; however, additional specimens of even well represented lineages can be equally important for studying evolutionary pattern and process, evolutionary rates, and paleophylogeography. Even unidentifiable material can provide useful data for dating geologic units if radiometric dating is possible. As such, common fossils (especially vertebrates) may be scientifically important, and therefore considered significant.

CALIFORNIA PUBLIC RESOURCES CODE

Section 5097.5 of the Public Resources Code (PRC) states:

“No person shall knowingly and willfully excavate upon, or remove, destroy, injure, or deface any historic or prehistoric ruins, burial grounds, archaeological or vertebrate paleontological site, including fossilized footprints, inscriptions made by human agency, or any other archaeological, paleontological, or historical feature, situated on public lands, except with the express permission of the public agency having jurisdiction over such lands. Violation of this section is a misdemeanor.”

As used in this PRC section, “public lands” means lands owned by, or under the jurisdiction of, the state or any city, county, district, authority, or public corporation, or any agency thereof. Consequently, public agencies are required to comply with PRC 5097.5 for their own activities,

including construction and maintenance, as well as for permit actions (e.g., encroachment permits) undertaken by others.

PALEONTOLOGICAL RESOURCE POTENTIAL

Absent specific agency guidelines, most professional paleontologists in California adhere to the guidelines set forth by SVP (2010) to determine the course of paleontological mitigation for a given project. These guidelines establish protocols for the assessment of the paleontological resource potential of underlying geologic units and outline measures to mitigate adverse impacts that could result from Project development. Using baseline information gathered during a paleontological resource assessment, the paleontological resource potential of the geologic unit(s) (or members thereof) underlying a Project area can be assigned to one of four categories defined by SVP (2010). These categories include high, undetermined, low and no paleontological resource potential.

- High Sensitivity: Vertebrate fossils, as well as the respective stratigraphic units in which these vertebrate fossils were discovered, are likely present, and likely have significant scientific value. In areas of high sensitivity, full-time monitoring is recommended during Project-related ground disturbance.
- Low Sensitivity: Stratigraphic units that have yielded few fossils in the past, based upon review of available literature and museum collections records, are considered to possess low paleontological sensitivity. Monitoring is usually not recommended during excavation within a stratigraphic unit of low sensitivity, although spot monitoring may be recommended to confirm that disturbance remains restricted to low-sensitivity units.
- Undetermined Sensitivity: In certain instances, the lack of available literature on a particular geologic unit, or absence of exposures of that unit, make it difficult to determine a unit's likelihood of yielding fossiliferous remains. Under these circumstances, further studies may be recommended to assess the unit's paleontological resource potential (i.e., field survey). If a unit remains of "undetermined" paleontological sensitivity, then it is treated as possessing "high" sensitivity for purposes of initial monitoring and mitigation.
- No Sensitivity: This category includes geological strata that are either too young (<10,000 years old), too weathered, metamorphosed, or too coarse-grained to preserve significant fossilized remains. Metamorphic and plutonic igneous rocks normally do not contain fossils due to the high heat and pressure during their formation, and commonly possess no paleontological sensitivity.

METHODS

To assess whether a particular area has the potential to contain significant fossil resources at the subsurface, it is necessary to review published geologic mapping to determine the geology and stratigraphy of the area. Geologic units are considered to be "sensitive" for paleontological resources if they are known to contain significant fossils anywhere in their extent. Therefore, a search of pertinent local and regional museum repositories for paleontological localities within

and nearby the Project area is necessary to determine whether fossil localities have been previously discovered within a particular rock unit. For this Project, Envicom formally requested a museum records search at the NHMLAC. The museum records search was supplemented by a review of the UCMP online database, which contains paleontological records for Los Angeles County.

A pedestrian survey of the Project area was also conducted on March 22, 2021. The purpose of the field survey was to visually inspect the ground surface in areas of proposed disturbance related to Project development for exposed fossils and to evaluate geologic exposures for their potential to contain preserved fossil material at the subsurface.

RESOURCE CONTEXT

GEOLOGIC SETTING

The Project area is within the Antelope Valley, in the western-most region of the Mojave Desert (Norris and Webb 1976). The Mojave Desert is one of twelve geomorphic provinces of California. A geomorphic province is a region of unique topography and geology that is readily distinguished from other regions based on its landforms and tectonic history. The Mojave Desert geomorphic province extends from the San Andreas and Garlock faults toward the Great Basin Province and Colorado Desert (Dibblee and Hewett 1966). The Mojave Desert province is a physiographic designation for the smallest of the North American deserts (MacMahon and Wagner 1985). Uplift of the San Bernardino and Sierra Nevada mountain ranges during Neogene time (Meisling and Weldon 1989; Unruh 1991) resulted in orographic aridification of the leeward region that is now the Mojave Desert. The western portion of this region is tectonically controlled by transrotation of the Mojave crustal block that was coincident with the formation of the Transverse Ranges and a westward step over of the San Andreas plate boundary during the Miocene (MacFadden et al. 1990). The eastern portion of the Mojave Region is the central portion of the Basin and Range tectonic province (Dickinson 2002). This region has experienced extension through the Neogene as a result of accommodation of up to 20 percent of net movement between the Pacific and North American tectonic plates. This area is dominated today by high angle normal fault bound horsts separated by half grabens. Grabens are typically filled with Neogene sedimentary basin fill, Neogene volcanics, and Quaternary basin fill. Basin centers can have dry Pleistocene pluvial lake pans or playas (Reheis et al. 2014), whereas basin peripheries can contain fault-controlled ground water discharge deposits (Pigati et al. 2011).

SITE SPECIFIC GEOLOGY AND PALEONTOLOGY

Antelope Valley is a sedimentary basin found at the far western edge of the Mojave Desert, south of the Garlock Fault and Tehachapi Mountains, and north of the Transverse Ranges (Ponti 1985). Sediment basin fill is all within the last 2 million years, associated with uplift of the San Gabriel Mountains (Ponti 1985). Sedimentary facies include alluvial fans, washes, and playa deposits (Ponti 1985). According to published geologic maps, the Project area is immediately underlain by Holocene age surficial alluvium (Qa) and surficial alluvial fan deposits (Qf) (Dibblee and Minch 2008; Hernandez et al. 2010) (Figure 2). Alluvial fan deposits are inherently low in fossil preservation potential due to the energy and clast distribution of the rheology of their

formative depositional events. As well, they are geologically too young to contain significant fossil resources (SVP 2010). However, younger alluvium overlies older Pleistocene age alluvial deposits at an unknown but potentially shallow depth. Pleistocene age alluvial deposits have yielded significant vertebrate fossil localities throughout the Mojave Desert and nearby from within the same or similar geologic sediments underlying the Project area (Bell 2021; Cox et al. 2003; Jefferson 2003; Scott and Cox 2008; Springer et al. 2009).

RECORDS SEARCH RESULTS

The NHMLAC does not have on record any previously recorded vertebrate fossil localities directly within the Project boundaries; however, five previously documented localities have been documented from the vicinity from unknown formations ranging in age from Pleistocene to Holocene. LACM VP 7853, north-northwest of the Project area, yielded fish, amphibians, reptiles, small mammals, and Camelidae (camel) from Pleistocene age geologic deposits as shallow as three feet below the ground surface. An additional Pleistocene age locality east of the Project area yielded fossil specimens of *Camelops hesternus* (camel) four feet below the ground surface (Bell 2021).

A supplemental review of online museum collections records maintained by the UCMP returned no previously recorded vertebrate localities in the vicinity of the Project (UCMP 2020). Table 1 below summarizes the compiled information on known vertebrate localities from Holocene and Pleistocene alluvial deposits in the Project area per the NHMLAC.

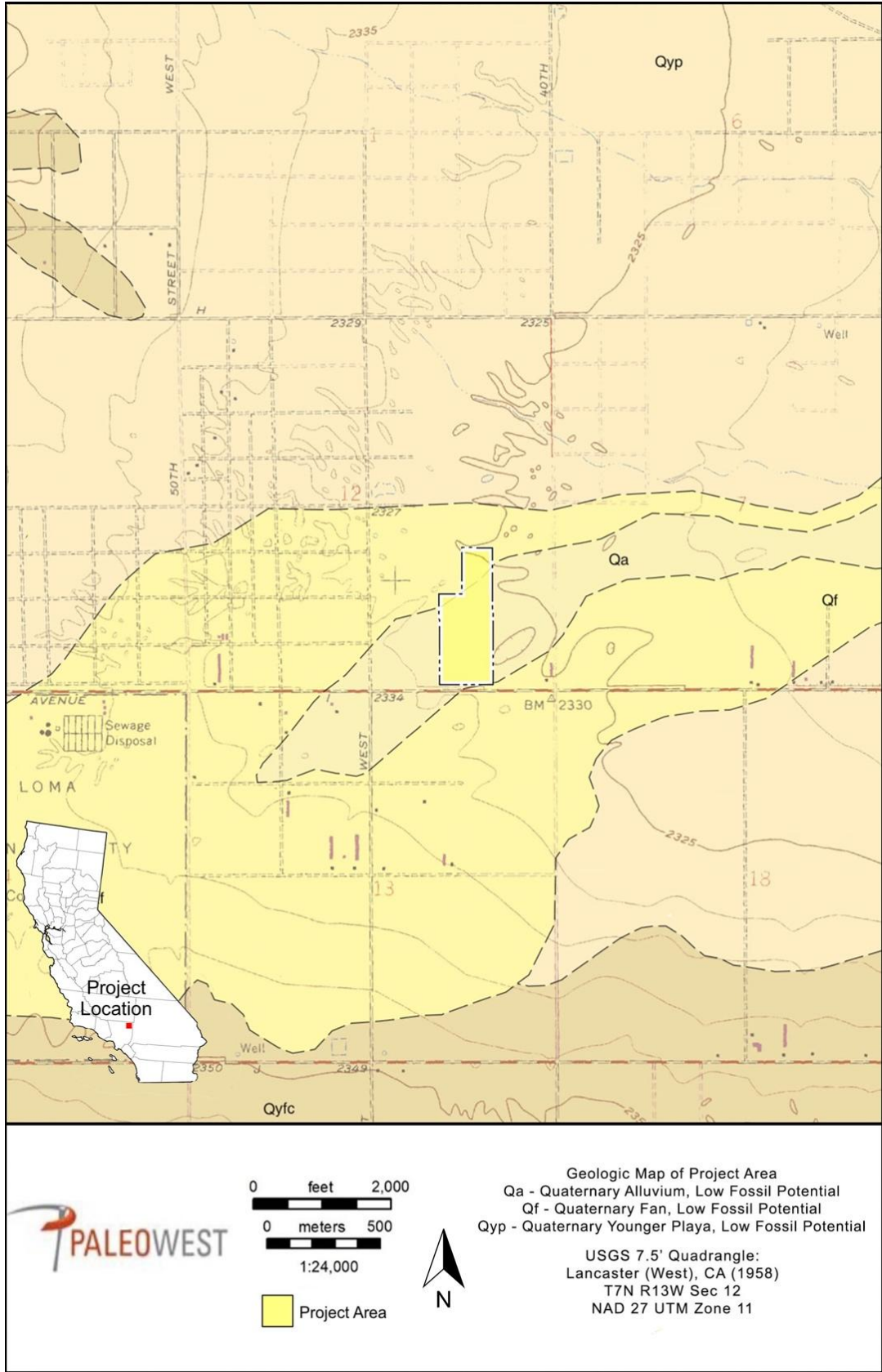

Figure 2. Geologic map.

Table 1. Vertebrate Localities Reported from Quaternary Units of the Vicinity of the Project

Locality No.	Geologic Unit	Age	Taxa
LACM VP 7853	Unknown formation (Pleistocene; sandy loess under a dune deposit strand, sandy siltstone, siltstone to clayey siltstone)	Pleistocene	Fish, amphibians, reptiles, small mammals, and camel (Camelidae)
LACM VP 7884	Unknown formation (Pleistocene; fluvial brown clayey silt)	Pleistocene	Camel (<i>Camelops hesternus</i>)
LACM VP 5946	Unknown formation (Holocene)	Holocene	Lizard (<i>Gambelia wislizenii</i>)
LACM VP 5947	Unknown formation (Holocene)	Holocene	Pocket gopher (<i>Thomomys</i>)
LACM VP 5952, 5942, 5945	Unknown formation (Holocene)	Holocene	Pocket mouse (<i>Chaetodipus</i>); kangaroo rat (<i>Dipodomys</i>)

Source: Bell 2021

FIELD SURVEY RESULTS

A pedestrian survey was conducted of the Project area by PaleoWest Associate Paleontologist Michaela Adler, M.S. In the field, Ms. Adler used a handheld Global Positioning System (GPS) unit, Google Earth imagery, topographic maps, and aerial photographs to locate geologic formation boundaries. Notes were taken on the geologic and lithology of each geologic deposit mapped in the Project area and photographs were taken to document the survey. No fossil resources were observed during this survey and no fresh rock outcroppings or active drainages were encountered. The Project area was found to be heavily agitated by anthropogenic activity and ground visibility was limited (Figures 3 and 4).



Figure 3. Project area showing modern disturbance of the Project area, view to the northeast.



Figure 4. Disturbed portion of the Project area, view to the east.

FINDINGS

In general, the potential for a given project to result in negative impacts to paleontological resources is directly proportional to the amount of ground disturbance associated with the Project; thus, the higher the amount of ground disturbances within geological deposits with a known paleontological sensitivity, the greater the potential for negative impacts to paleontological resources. Since this Project entails grading and excavating the Project area, new ground disturbances are anticipated. Surface and subsurface ground disturbance in the Project area will impact Holocene age alluvial deposits that have a low paleontological potential due to their young geologic age (SVP 2010). However, these deposits grade into older Pleistocene age alluvium at an unknown, but potentially shallow depth. Nearby fossil localities of Pleistocene age have been encountered as shallow as three feet below ground surface. Pleistocene age alluvial deposits in the Antelope Valley and throughout southern California have proven to yield significant vertebrate fossil localities and have a high paleontological resource potential. Consequently, the likelihood of impacting scientifically significant fossils because of Project development ranges from low to high, increasing with depth.

RECOMMENDATIONS

It is recommended that a qualified paleontologist be retained to implement paleontological monitoring during Project construction. The following measures have been developed in accordance with SVP guidelines; if implemented, these measures will satisfy the requirements of CEQA. These measures have been used by professional paleontologists for many years and have proven to be effective in reducing or eliminating adverse impacts to fossil resources as a result of private and public development projects throughout California and elsewhere.

PALEONTOLOGICAL MONITORING

Prior to the commencement of ground-disturbing activities, an SVP qualified and professional paleontologist should be retained to implement a paleontological monitoring program during initial Project excavations. Full-time monitoring should be required during ground-disturbing activities at or exceeding 3 feet below ground surface throughout the Project area. Monitoring will entail the visual inspection of excavated or graded areas and trench sidewalls for the presence of fossils. In the event that a paleontological resource is discovered, the monitor will have the authority to temporarily divert the construction equipment around the find until it is assessed for scientific significance and collected. Monitoring is largely a visual inspection of sediments; therefore, the most likely fossils to be observed will be macrofossils of vertebrates (bones, teeth, tusk) or invertebrates (shells). At the discretion of the qualified paleontologist, the monitor will periodically screen sediments to check for the presence of microfossils that can be seen with the aid of a hand lens (i.e., microvertebrates). Should microvertebrate fossils be encountered during the screening process, then bulk matrix samples will be taken for processing off site. For each fossiliferous horizon or paleosol, a standard sample (4.0 cubic yards or 6,000 pounds) will be collected for subsequent wet screening per SVP (2010) guidelines.

At any time, the qualified paleontologist may recommend to the CEQA Lead Agency to reduce paleontological monitoring based on observations of specific site conditions during initial monitoring (e.g., if the geologic setting precludes the occurrence of fossils). The recommendation to reduce or discontinue paleontological monitoring in the Project area shall be based on the professional opinion of the qualified paleontologist regarding the potential for fossils to be present after a reasonable extent of the geology and stratigraphy has been evaluated.

FOSSIL PREPARATION, CURATION, AND REPORTING

Upon completion of fieldwork, all significant fossils collected should be prepared in a properly equipped paleontology laboratory to a point ready for curation. Preparation should include the careful removal of excess matrix from fossil materials and stabilizing and repairing specimens, as necessary. Following laboratory work, all fossils specimens should be identified to the lowest taxonomic level, cataloged, analyzed, and curated. The fossil specimens must be delivered to the accredited museum repository identified on the permit and receipt(s) of collections will be submitted to the client. This delivery should be made as soon as practical but no later than 60 days after all fieldwork is completed. The cost of curation is assessed by the repository and will be the responsibility of the client.

At the conclusion of laboratory work and museum curation, a Paleontological Monitoring Report should be prepared describing the results of the paleontological mitigation monitoring efforts associated with the Project. The report should include a summary of the field and laboratory methods, an overview of the Project area geology and paleontology, a specimen inventory of all taxa recovered (if any), an analysis of fossils recovered (if any) and their scientific significance, the signed receipt of confirmation of museum deposition, and recommendations. The report should be submitted to the designated repository within 45 days following completion of monitoring and laboratory work.

It has been a pleasure working with you on this Project. If you have any questions, please do not hesitate to contact us.

Sincerely,

PALEOWEST



Michaela Adler, M.S. |
Associate Paleontologist



Jessica DeBusk, B.S., M.B.A. |
Principal Investigator, Paleontology

REFERENCES

- Bell, A.
2021 Unpublished museum records search of the Natural History Museum of Los Angeles County.
- Cox, B. F., Hillhouse, J.W., and Owen, L.A.
2003 Pliocene and Pleistocene Evolution of the Mojave River, and Associated Tectonic Development of the Transverse Ranges and Mojave Desert, Based on Borehole Stratigraphy Studies and Mapping of Landforms and Sediments near Victorville, California in Enzel, Y., Wells, S.G., and Lancaster, N., eds., *Paleoenvironments and Paleohydrology of the Mojave and Southern Great Basin Deserts. Geological Society of America Special Papers 368.*
- Dibblee, T.W., and Minch, J.A.
2008 Geologic map of the Lancaster & Alpine Butte 15 minute quadrangles, Los Angeles County, California: Dibblee Geological Foundation, Dibblee Foundation Map DF-386, scale 1:62,500.
- Dibblee, T.W., and Hewett, D.F.
1996 Geology of the Mojave Desert region, in Mineral resources of California: U.S. Congress, 89th. 2D Session, Interior and Insular Affairs Committee. *California Div. Mines and Geology Bulletin 191*, pp. 62-66.
- Dickinson, W.R.
2002 The Basin and Range Province as a composite extensional domain. *International Geology Review*, 44(1), pp.1-38.
- Hernandez, J.L., Gutierrez, C.I., Saucedo G.J.
2010 Geologic Map of the Lancaster West 7.5' Quadrangle Los Angeles County, California: A Digital Database: California Geological Survey, scale 1:24,000.
- Jefferson, G.T.
2003 Stratigraphy and Paleontology of the Middle to Late Pleistocene Manix Formation, and Paleoenvironments of the Central Mojave River, Southern California in Enzel, Y., Wells, S.G., and Lancaster, N., eds., *Paleoenvironments and Paleohydrology of the Mojave and Southern Great Basin Deserts. Geological Society of America Special Papers 368.*
- MacFadden, B.J., Woodburne, M.O. and Opdyke, N.D.
1990 Paleomagnetism and Neogene clockwise rotation of the northern Cady Mountains, Mojave Desert of southern California. *Journal of Geophysical Research: Solid Earth*, 95(B4), pp.4597-4608.
- MacMahon, J.A. and Wagner, F.H.
1985 The Mojave, Sonoran and Chihuahua deserts of North America. In *Ecosystems of the world* (pp. 105-202).

- Meisling, K.E. and Weldon, R.J.
 1989 Late Cenozoic tectonics of the northwestern San Bernardino Mountains, southern California. *Geological Society of America Bulletin*, 101(1), pp.106-128. Norris, R.M., and Webb, R.W., 1976, *Geology of California*. John Wiley & Sons, New York.
- Norris, R.M. and Webb, R.W.
 1976 *Geology of California*, John Wiley and Sons., New York.
- Pigati, J.S., Miller, D.M., Bright, J.E., Mahan, S.A., Nekola, J.C. and Paces, J.B.
 2011 Chronology, sedimentology, and microfauna of groundwater discharge deposits in the central Mojave Desert, Valley Wells, California. *Bulletin*, 123(11-12), pp.2224-2239.
- Ponti, D.J.
 1985 The Quaternary alluvial sequence of the Antelope Valley, California. In Weide, D. and Faber, M. eds., *Soils and Quaternary Geology of the Southwestern United States*, *Geological Society of America Special Paper*, 203, pp.79-96.
- Reheis, M.C., Adams, K.D., Oviatt, C.G. and Bacon, S.N.
 2014 Pluvial lakes in the Great Basin of the western United States—a view from the outcrop. *Quaternary Science Reviews*, 97, pp.33-57.
- Society of Vertebrate Paleontology (SVP)
 2010 Standard Procedures for the Assessment and Mitigation of Adverse Impacts to Paleontological Resources. Society of Vertebrate Paleontology Impact Mitigation Guidelines Revision Committee.
- Scott, E., and Cox, S.M.,
 2008 Late Pleistocene Distribution of Bison (Mammalia; Artiodactyla) in the Mojave Desert of Southern California and Nevada in Wang, X., and Barnes, L.G., eds., *Geology and Vertebrate Paleontology of Western and Southern North America*. *Natural History Museum of Los Angeles County Science Series* 41.
- Springer, K., Scott, E., Sagebiel, J.C. and Murray, L.K.
 2009 The Diamond Valley Lake local fauna: late Pleistocene vertebrates from inland southern California. *Papers on geology, vertebrate paleontology, and biostratigraphy in honor of Michael O. Woodburne*, 65, pp.217-235.
- University of California Museum of Paleontology (UCMP)
 2020 Online Fossil Catalog
- Unruh, J.R.
 1991 The uplift of the Sierra Nevada and implications for late Cenozoic epeirogeny in the western Cordillera. *Geological Society of America Bulletin*, 103(11), pp.1395-140