



E2024/0000019

County of Fresno

DEPARTMENT OF PUBLIC WORKS AND PLANNING
STEVEN E. WHITE, DIRECTOR

NOTICE OF EXEMPTION

- TO: Office of Planning and Research
1400 Tenth Street, Room 121
Sacramento, CA 95814
- County Clerk, County of Fresno
2221 Kern Street
Fresno, CA 93721

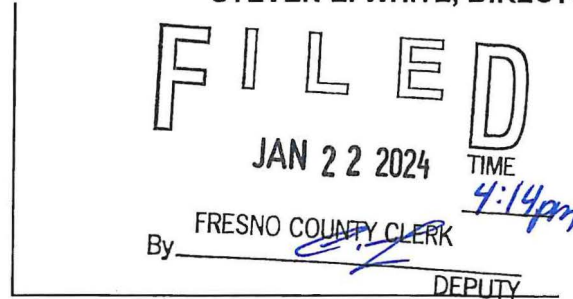

For County Clerk's Stamp

FROM: Fresno County Department of Public Works and Planning
Development Services and Capital Projects Division
2220 Tulare Street (corner of Tulare and "M") Suite "A", Fresno, CA 93721

PROJECT TITLE: Environmental Review No. 8529 – CSA 43 Water Well

PROJECT APPLICANT/SPONSOR: Fresno County Design Division

PROJECT LOCATION – COUNTY: The two potential project sites are located at the southeast corner of W. Fike Avenue and S. Ring Avenue in the unincorporated community of Raisin City. Site 1 (0.22 acre; APN 035-240-01T) is to the west of Raisin City Elementary School ground and Site 2 (0.11-acre; APN 035-240-42S) is to the east of Site 1.

DESCRIPTION OF PROJECT:

The Raisin City's (CSA 43) water distribution system currently consists of one (1) groundwater well for domestic water supply, an existing storage tank, and a hydro pneumatic tank on parcels identified by APN 035-240-40T & 41ST. The subject request is to install a new water well to provide a back-up source of water should the existing well need to be put out of service for maintenance purposes. The planned improvements include installing a new, redundant water well, and connecting it to the existing water facility. Two nearby sites as noted in Project Location above are under consideration that will require right-of-way acquisition. Both sites are immediately adjacent to the existing water facility and have been previously disturbed by other construction activities. Site 1 was disturbed when a school water storage tank was installed and is no longer in use. Site 2 was disturbed when the original CSA43 storage tank was installed. Work specific to Site 1 will also include the demolition of the water storage tank the school no longer uses. The work in general will consist of clearing and grubbing the area where the new well will be installed. The new well's depth and dimensions should be like the existing well. The required area to be cleared is approximately 500 square feet. Trenching for the new water main and electrical conduit will be required for either site. Either site will require up to 250 feet of trenching to install new 4-inch water main between the new well and existing water storage tank. They will also require an equal amount of trenching to install an electrical conduit to the new well. All conduits will be placed within previously disturbed areas.

NAME OF PUBLIC AGENCY APPROVING PROJECT: Fresno County Board of Supervisors,
Department of Public Works and Planning, Design Division.

NAME OF PERSON OR AGENCY CARRYING OUT PROJECT: Fresno County Department of Public Works and Planning, Design Division, Contact: Gloria Hensley (559) 600-0523

EXEMPT STATUS: Categorical exemption: Section 15301 (b) *Existing Facilities*

E202410000019

REASONS WHY THE PROJECT IS EXEMPT: The subject application proposes a new back-up water well for an existing water distribution system and involves no modification to the existing water infrastructure. The new well will provide a back-up source of water should the existing well need to be put out of service for maintenance purpose. It was determined that this project will have no impact on the environment.

LEAD AGENCY

CONTACT PERSON: Ejaz Ahmad

AREA CODE/TELEPHONE: (559) 600-4204

If filed by the applicant:

1. Attach certified document of exemption finding.
2. Has a Notice of Exemption been filed by the public agency approving the project?
 Yes No

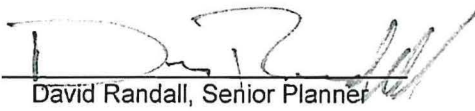
Signature: 
David Randall, Senior Planner

Date: 1/5/24

- Signed by Lead Agency Date received for filing at OPR: _____
 Signed by Applicant

LOCATION DETAIL



Source: Esri, Maxar, Earthstar Geographics, and the GIS User Community

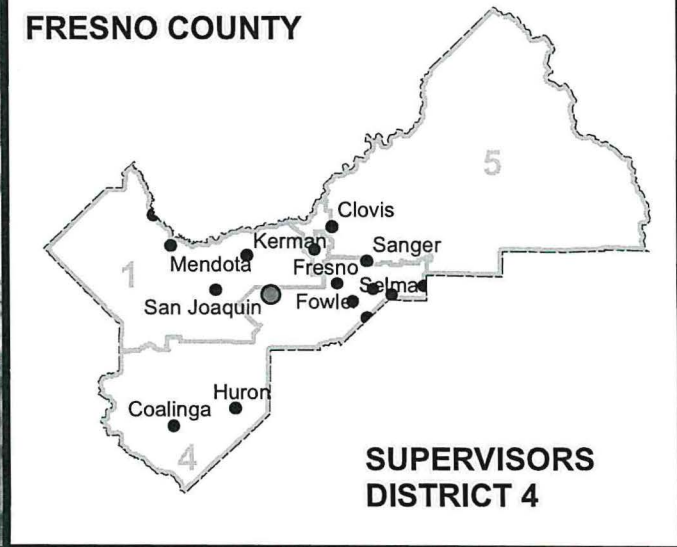
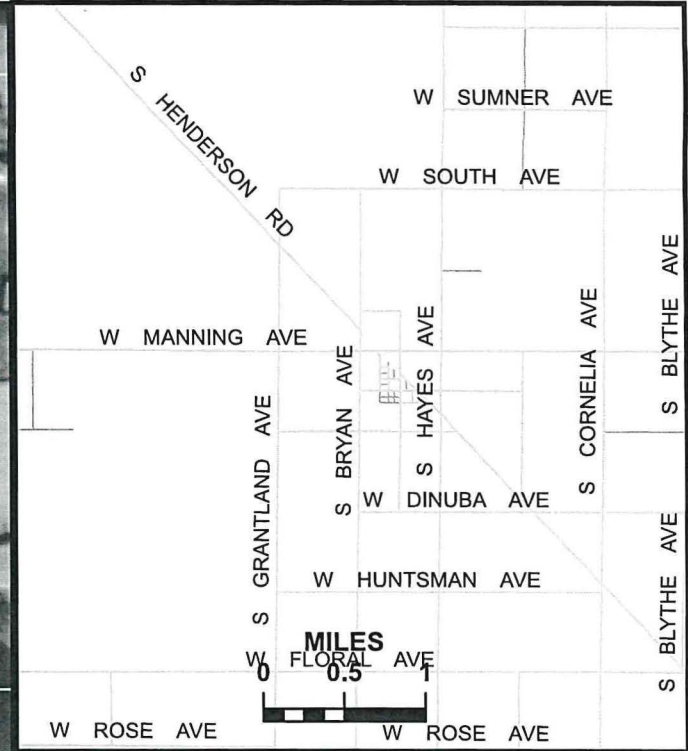

	DATE:	SCALE IN FEET
DESIGNED: G.H.	10/18/23	
DRAWN: G.H.	10/18/23	

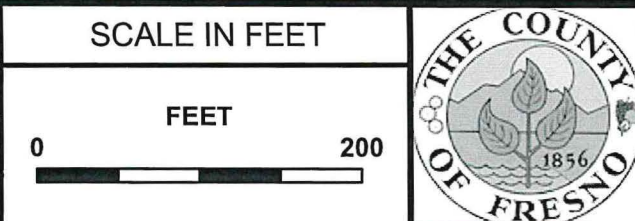

DEPARTMENT OF PUBLIC WORKS & PLANNING

CSA 43

RAISIN CITY WATER WELL

E-2024100019