

ACCENT SHRUBS - MEDIUM WATER USE
 PLANT FROM 5 GAL. CONTAINERS
 Abelia x grandiflora 'Edward Goucher' / Glossy Abelia
 Miscanthus transmontanus / Evergreen Eulalia
 Muhlenbergia lindheimeri / Lindheimer's Muhly
 Muhlenbergia lindheimeri 'Autumn Glow' TM / Lindheimer's Muhly
 Phormium tenax 'Tom Thumb' / Dwarf Green Flax
 Phormium tenax 'Yellow Wave' / New Zealand Flax
 Rhipidolys indica 'Jack Evans' / Indian Hawthorn
 Rosa floribunda 'Iceberg' / Iceberg Rose

ACCENT SHRUBS - LOW WATER USE
 PLANT FROM 5 GAL. CONTAINERS
 Agave attenuata / Agave
 Anigozanthos flavidus 'Big Red' / Red Kangaroo Paw
 Anigozanthos x 'Gold Velvet' / Kangaroo Paw
 Arbutus unedo / Strawberry Tree Shrub
 Berberis thunbergii 'Atropurpurea' / Red Leaf Japanese Barberry
 Callistemon citrinus 'Lemon Bottlebrush Shrub'
 Callistemon citrinus 'Little John' / Dwarf Bottle Brush
 Cassia artemisioides / Feathery Cassia
 Clivia x purpurea / Orchid Rockrose
 Dodonaea viscosa 'Purpurea' / Purple Leafed Hopseed Bush
 Eleagnus pungens 'Fruitlandi' / Silverberry
 Heteromeles arbutifolia / Toyon
 Leucophyllum frutescens 'Green Cloud' TM / Green Cloud Texas Ranger - Space 4' o.c.
 Muhlenbergia capillaris / Pink Muhly
 Nerium oleander 'Pette Pink' / Petite Pink Oleander
 Pennisetum 'Fairy Tales' / Fairy Tales Fountain Grass
 Rosmarinus officinalis 'Tuscan Blue' / Tuscan Blue Rosemary
 Salvia clevelandii 'Allen Chickering' / Cleveland Sage
 Salvia greggii 'Furnans Red' / Furnans' Red Salvia
 Westringia fruticosa 'Morning Light' / Dwarf Coast Rosemary

GROUND COVER PALETTE - LOW WATER USE
 PLANT FROM 1 GAL. CONTAINERS
 Acacia redolens 'Desert Carpet' TM / Bank Catclaw
 Baccharis pilularis 'Pigeon Point' / Coyote Brush
 Lantana montevidensis 'New Gold' / Trailing Lantana
 Lonicera japonica 'Halliana' / Halls Honeysuckle Flowering Vine
 Myoporum parvifolium 'Putah Creek' / Putah Creek Myoporum
 Rosmarinus officinalis 'Huntington Carpet' / Huntington Carpet Rosemary

GROUND COVER PALETTE - MEDIUM WATER USE
 PLANT FROM 1 GAL. CONTAINERS
 Dianella tasmanica 'Casa Blue' / Flax Lily
 Rosa x 'Flower Carpet Red' / Flower Carpet Red Rose
 Trachelospermum jasminoides / Star Jasmine

NOTES

- ALL TREES WITHIN 6' OF HARDSCAPE SHALL BE IN A SHAWTOWN LINEAR (WRAP AROUND NOT ALLOWED) ROOT BARRIER 24" HIGH LINEAR ROOT BARRIER SHALL BE CENTERED ON TREE AND EXTEND 5' IN BOTH DIRECTIONS FOR A TOTAL OF 10'
- NOTE: QUANTITIES AND AREA CALCULATIONS SHOWN IN LEGEND ARE FOR REFERENCE ONLY. CONTRACTOR RESPONSIBLE FOR ALL QUANTITY TAKE-OFFS AND AREA CALCULATIONS FOR DETERMINING COST AND DELIVERY OF MATERIALS TO SITE.

SHREDDED MULCH NOTE

ALL PLANTER AREAS TO RECEIVE A 3" LAYER OF SHREDDED COVER MULCH AVAILABLE FROM EARTHWORKS (951)782-0260

TREE LEGEND

TREES	BOTANICAL / COMMON NAME	CONT	WUCOLS	QTY
	Cercidium x 'Desert Museum' / Thornless Palo Verde	36"box	Low	8
	Koeleruteria bipinnata / Chinese Flame Tree - Standard	24"box	Med	7
	Lagerstroemia x 'Muskogee' / Lavender Crape Myrtle Std.	24"box	Med	10
	Pinus eiderica / Afghan Pine	24"box	Low	36
	Platanus x acerifolia / London Plane Tree	24"box	Med	9
	Rhus lancea / African Sumac	24"box	Low	6
	Tristania conferta / Brisbane Box	24"box	Med	15

CONCEPT PLANT SCHEDULE

- FOUNDATION PLANTING / HEDGE SCREEN - MED WATER**
 PLANT FROM 5 GAL. CONTAINERS
 Buxus microphylla japonica 'Green Beauty' / Green Beauty Boxwood
 Ligustrum texanum / Texas Privet
 Nandina domestica 'Gulf Stream' TM / Dwarf Heavenly Bamboo
 Pittosporum tenuifolium 'Silver Sheen' / Tawhihi
 Podocarpus gracilior 'Column' / Fern Pine
 Rhipidolys indica 'Jack Evans' / Indian Hawthorn
 Xylosma congestum / Shiny Xylosma
- LARGE SCALE FOUNDATION / PERIMETER SHRUB - LOW WATER**
 PLANT FROM 5 GAL. CONTAINERS
 Arbutus unedo / Strawberry Tree Shrub
 Callistemon citrinus / Lemon Bottlebrush Shrub
 Eleagnus pungens / Silverberry
 Heteromeles arbutifolia / Toyon
- SMALL SCALE FOUNDATION PLANTING / SCREEN - LOW WATER**
 PLANT FROM 5 GAL. CONTAINERS
 Callistemon citrinus 'Little John' / Dwarf Bottle Brush
 Eleagnus pungens / Silverberry
 Rosmarinus officinalis 'Tuscan Blue' / Tuscan Blue Rosemary
 Westringia fruticosa 'Morning Light' / Dwarf Coast Rosemary
- LARGE ACCENT SHRUBS IN DECORATIVE GRAVEL - LOW WATER**
 PLANT FROM 5 GAL. & 15 GAL. CONTAINERS
 Agave americana / Century Plant
 Agave americana 'Marginata' / Variegated Century Plant
 Dasyliroa wheeleri / Grey Desert Spon
- SMALLER ACCENT SHRUBS IN DECORATIVE GRAVEL - LOW WATER**
 PLANT FROM 1 GAL. & 5 GAL. CONTAINERS
 Agave attenuata / Agave
 Anigozanthos flavidus 'Big Red' / Red Kangaroo Paw
 Anigozanthos flavidus 'Gold Velvet' / Kangaroo Paw
 Baccharis pilularis 'Pigeon Point' / Coyote Brush
 Hesperaloe parviflora / Red Yucca
 Muhlenbergia capillaris / Pink Muhly
 Muhlenbergia lindheimeri 'Autumn Glow' TM / Lindheimer's Muhly
 Rosmarinus officinalis 'Huntington Carpet' / Huntington Carpet Rosemary
 Yucca recurvifolia 'Color Guard' / Soft Leaf Yucca

HARLEY KNOX BOULEVARD

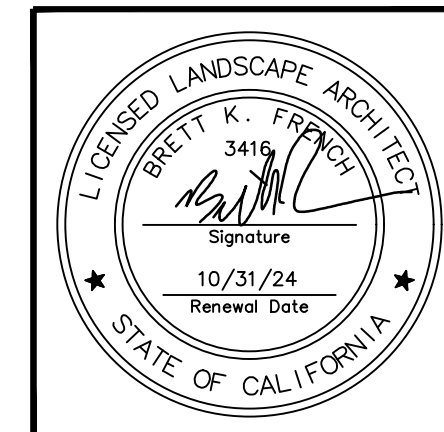
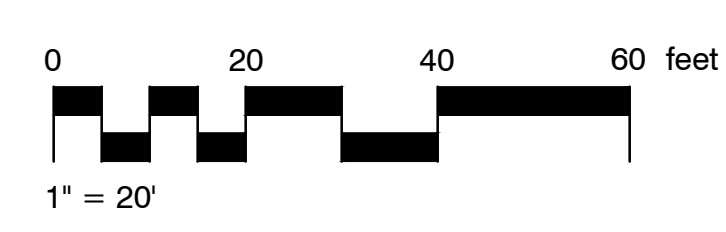
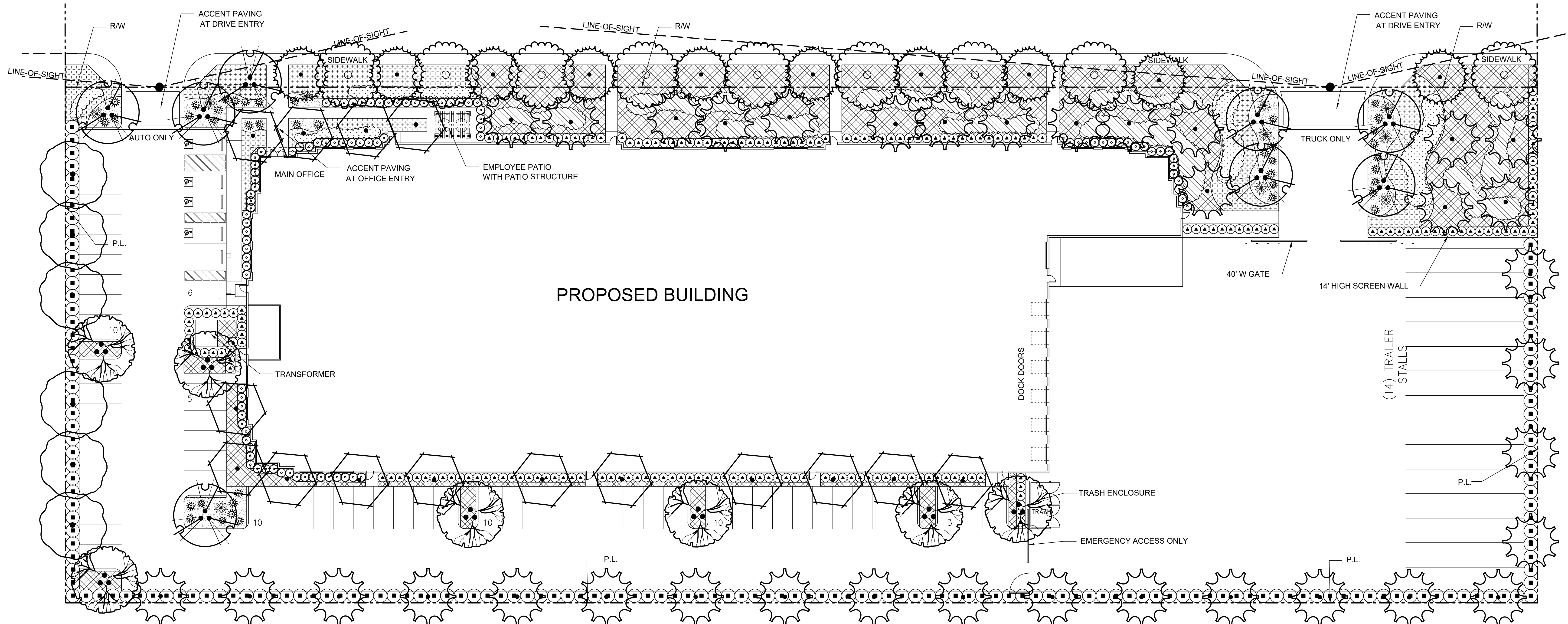

DEVELOPED BY:
PRELIMINARY LANDSCAPE PLAN
 PROPOSED DEVELOPMENT:
BREW HARLEY KNOX
 0000 HARLEY KNOX BLVD.,
 CITY OF PERRIS, CA

DRAWN BY: DATE
 BFK 11-02-22

JOB NO.
 RGA00174

SHEET NO.
L-1
 1 OF 1 SHEETS

