

## NOTICE OF EXEMPTION

**To:**  
Office of Planning and Research  
1400 10th Street, Room 121  
Sacramento, CA 95814

**From:**  
California Tahoe Conservancy  
1061 Third Street  
South Lake Tahoe, CA 96150

**Project Title:** Osborne Avenue Fencing

**Project Location – Specific:**

This project is located on El Dorado County Assessment Number (AN) 031-146-17 and is adjacent to 1148 Sierra Boulevard. (Exhibit A)

**Project Location – City:** South Lake Tahoe

**Project Location – County:** El Dorado County

**Description of Nature, Purpose, and Beneficiaries of Project:**

This project consists of the installation of single rail timber fencing at the back of the parcel to prevent future unauthorized use of Conservancy land. Also, the decompaction and revegetation of affected areas.

**Name of Public Agency Approving Project:** California Tahoe Conservancy (CTC)

**Name of Person or Agency Carrying Out Project:** California Tahoe Conservancy

**Exempt Status:**

- Ministerial (§ 15268)
- Declared Emergency (§ 15269(a))
- Emergency Project (§ 15269(b)(c))
- Categorical Exemption – Classes 3 & 4, §§ 15303 and 15304. (See also Cal. Code Regs., tit. 14, §§ 12102.3 and 12102.4.)

**Reasons Why Project is Exempt:**

This project is exempt because it involves the decompaction and revegetation of affected areas, which will result in minor alteration to the land. Also, it involves the installation of a single rail timber fence, which consists of the construction of new, small structures.

**Contact Person:** Haley Lazar

**Telephone Number:** (530) 208-8892

**Date Received for Filing:**

*Kevin Prior*

---

Kevin Prior  
Director of the Land Division

# Osborne Delineation

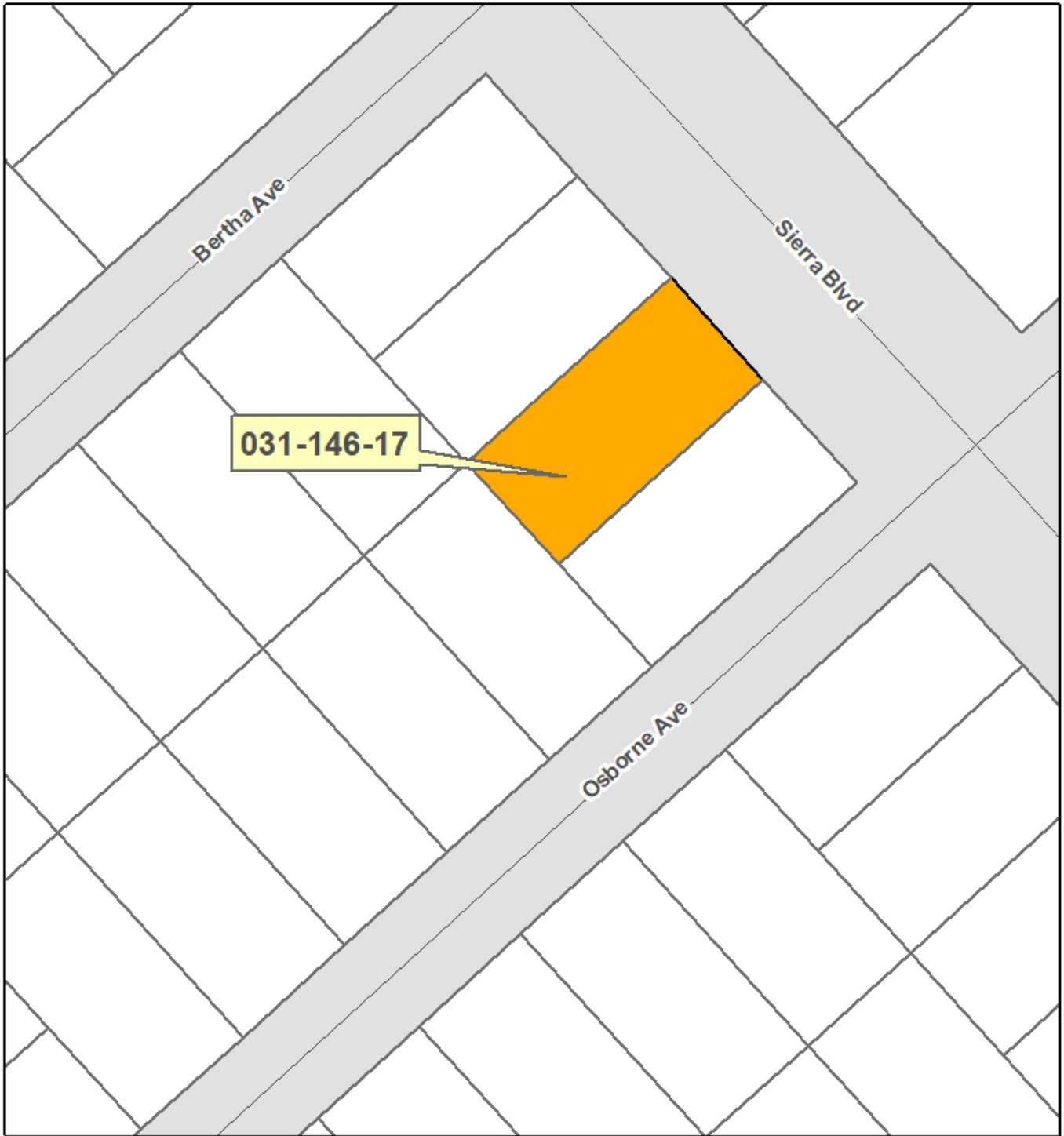

## Legend

### Parcels

#### OWNERSHIP

 CTC

 PRIVATE

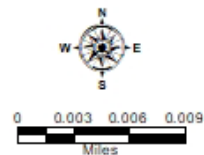

Sources:  
TRPA, CTC

California  
Tahoe Conservancy



November 2023

\*Map for reference  
purposes only.