

Notice of Completion & Environmental Document Transmittal

Mail to: State Clearinghouse, P.O. Box 3044, Sacramento, CA 95812-3044 (916) 445-0613
 For Hand Delivery/Street Address: 1400 Tenth Street, Sacramento, CA 95814

SCH #

Project Title: South of the Tule River Master Plan

Lead Agency: <u>City of Porterville</u>	Contact Person: <u>Claudia Calderon</u>
Mailing Address: <u>291 N Main Street</u>	Phone: <u>559-782-7460</u>
City: <u>Porterville</u>	County: <u>Tulare</u>
Zip: <u>93257</u>	

Project Location: County: Tulare City/Nearest Community: Porterville

Cross Streets: Westwood Street and State Route 190 Zip Code: 93257

Longitude/Latitude (degrees, minutes and seconds): 36 ° 3 ' 11.40 " N / -119 ° 3 ' 12.14 " W Total Acres: 447.30

Assessor's Parcel No.: Various, see attached Section: 33, 34 Twp.: 21S Range: 27E Base: Mt Diablo

Within 2 Miles: State Hwy #: 190, 65 Waterways: Tule River

Airports: Porterville Municipal Airport Railways: N/A Schools: See attached

Document Type:

CEQA: <input checked="" type="checkbox"/> NOP	<input type="checkbox"/> Draft EIR	NEPA: <input type="checkbox"/> NOI	Other: <input type="checkbox"/> Joint Document
<input checked="" type="checkbox"/> Early Cons	<input type="checkbox"/> Supplement/Subsequent EIR	<input type="checkbox"/> EA	<input type="checkbox"/> Final Document
<input type="checkbox"/> Neg Dec	(Prior SCH No.) _____	<input type="checkbox"/> Draft EIS	<input checked="" type="checkbox"/> Other: <u>Initial Study</u>
<input type="checkbox"/> Mit Neg Dec	Other: _____	<input type="checkbox"/> FONSI	_____

Local Action Type:

<input type="checkbox"/> General Plan Update	<input type="checkbox"/> Specific Plan	<input checked="" type="checkbox"/> Rezone	<input type="checkbox"/> Annexation
<input checked="" type="checkbox"/> General Plan Amendment	<input checked="" type="checkbox"/> Master Plan	<input type="checkbox"/> Prezone	<input type="checkbox"/> Redevelopment
<input type="checkbox"/> General Plan Element	<input type="checkbox"/> Planned Unit Development	<input checked="" type="checkbox"/> Use Permit	<input type="checkbox"/> Coastal Permit
<input type="checkbox"/> Community Plan	<input type="checkbox"/> Site Plan	<input type="checkbox"/> Land Division (Subdivision, etc.)	<input type="checkbox"/> Other: _____

Development Type:

<input type="checkbox"/> Residential: Units _____ Acres _____	<input type="checkbox"/> Transportation: Type _____
<input type="checkbox"/> Office: Sq.ft. _____ Acres _____ Employees _____	<input type="checkbox"/> Mining: Mineral _____
<input type="checkbox"/> Commercial: Sq.ft. _____ Acres _____ Employees _____	<input type="checkbox"/> Power: Type _____ MW _____
<input type="checkbox"/> Industrial: Sq.ft. _____ Acres _____ Employees _____	<input type="checkbox"/> Waste Treatment: Type _____ MGD _____
<input type="checkbox"/> Educational: _____	<input type="checkbox"/> Hazardous Waste: Type _____
<input type="checkbox"/> Recreational: _____	<input checked="" type="checkbox"/> Other: <u>No physical development proposed</u>
<input type="checkbox"/> Water Facilities: Type _____ MGD _____	

Project Issues Discussed in Document:

<input checked="" type="checkbox"/> Aesthetic/Visual	<input type="checkbox"/> Fiscal	<input checked="" type="checkbox"/> Recreation/Parks	<input checked="" type="checkbox"/> Vegetation
<input checked="" type="checkbox"/> Agricultural Land	<input checked="" type="checkbox"/> Flood Plain/Flooding	<input checked="" type="checkbox"/> Schools/Universities	<input checked="" type="checkbox"/> Water Quality
<input checked="" type="checkbox"/> Air Quality	<input type="checkbox"/> Forest Land/Fire Hazard	<input type="checkbox"/> Septic Systems	<input checked="" type="checkbox"/> Water Supply/Groundwater
<input checked="" type="checkbox"/> Archeological/Historical	<input checked="" type="checkbox"/> Geologic/Seismic	<input checked="" type="checkbox"/> Sewer Capacity	<input checked="" type="checkbox"/> Wetland/Riparian
<input checked="" type="checkbox"/> Biological Resources	<input checked="" type="checkbox"/> Minerals	<input checked="" type="checkbox"/> Soil Erosion/Compaction/Grading	<input checked="" type="checkbox"/> Growth Inducement
<input type="checkbox"/> Coastal Zone	<input checked="" type="checkbox"/> Noise	<input checked="" type="checkbox"/> Solid Waste	<input checked="" type="checkbox"/> Land Use
<input type="checkbox"/> Drainage/Absorption	<input checked="" type="checkbox"/> Population/Housing Balance	<input checked="" type="checkbox"/> Toxic/Hazardous	<input checked="" type="checkbox"/> Cumulative Effects
<input checked="" type="checkbox"/> Economic/Jobs	<input checked="" type="checkbox"/> Public Services/Facilities	<input checked="" type="checkbox"/> Traffic/Circulation	<input checked="" type="checkbox"/> Other: <u>GHG, Energy</u>

Present Land Use/Zoning/General Plan Designation:

See attached

Project Description: (please use a separate page if necessary)

See attached

Note: The State Clearinghouse will assign identification numbers for all new projects. If a SCH number already exists for a project (e.g. Notice of Preparation or previous draft document) please fill in.

Reviewing Agencies Checklist

Lead Agencies may recommend State Clearinghouse distribution by marking agencies below with and "X". If you have already sent your document to the agency please denote that with an "S".

- | | |
|---------------------------------------------------------------------------|------------------------------------------------------------------------------|
| <input checked="" type="checkbox"/> Air Resources Board | <input type="checkbox"/> Office of Historic Preservation |
| <input type="checkbox"/> Boating & Waterways, Department of | <input type="checkbox"/> Office of Public School Construction |
| <input type="checkbox"/> California Emergency Management Agency | <input type="checkbox"/> Parks & Recreation, Department of |
| <input type="checkbox"/> California Highway Patrol | <input type="checkbox"/> Pesticide Regulation, Department of |
| <input checked="" type="checkbox"/> Caltrans District # 6 | <input type="checkbox"/> Public Utilities Commission |
| <input type="checkbox"/> Caltrans Division of Aeronautics | <input checked="" type="checkbox"/> Regional WQCB # 5 |
| <input type="checkbox"/> Caltrans Planning | <input type="checkbox"/> Resources Agency |
| <input checked="" type="checkbox"/> Central Valley Flood Protection Board | <input type="checkbox"/> Resources Recycling and Recovery, Department of |
| <input type="checkbox"/> Coachella Valley Mtns. Conservancy | <input type="checkbox"/> S.F. Bay Conservation & Development Comm. |
| <input type="checkbox"/> Coastal Commission | <input type="checkbox"/> San Gabriel & Lower L.A. Rivers & Mtns. Conservancy |
| <input type="checkbox"/> Colorado River Board | <input type="checkbox"/> San Joaquin River Conservancy |
| <input type="checkbox"/> Conservation, Department of | <input type="checkbox"/> Santa Monica Mtns. Conservancy |
| <input type="checkbox"/> Corrections, Department of | <input checked="" type="checkbox"/> State Lands Commission |
| <input type="checkbox"/> Delta Protection Commission | <input type="checkbox"/> SWRCB: Clean Water Grants |
| <input type="checkbox"/> Education, Department of | <input type="checkbox"/> SWRCB: Water Quality |
| <input type="checkbox"/> Energy Commission | <input type="checkbox"/> SWRCB: Water Rights |
| <input checked="" type="checkbox"/> Fish & Game Region # 4 | <input type="checkbox"/> Tahoe Regional Planning Agency |
| <input type="checkbox"/> Food & Agriculture, Department of | <input type="checkbox"/> Toxic Substances Control, Department of |
| <input type="checkbox"/> Forestry and Fire Protection, Department of | <input type="checkbox"/> Water Resources, Department of |
| <input type="checkbox"/> General Services, Department of | Other: _____ |
| <input type="checkbox"/> Health Services, Department of | Other: _____ |
| <input type="checkbox"/> Housing & Community Development | |
| <input checked="" type="checkbox"/> Native American Heritage Commission | |

Local Public Review Period (to be filled in by lead agency)

Starting Date March 20, 2024 Ending Date April 19, 2024

Lead Agency (Complete if applicable):

Consulting Firm: <u>Precision Civil Engineering, Inc.</u>	Applicant: <u>City of Porterville</u>
Address: <u>1234 O Street</u>	Address: <u>291 N Main Street</u>
City/State/Zip: <u>Fresno/CA/93721</u>	City/State/Zip: <u>Porterville/CA/93257</u>
Contact: <u>Bonique Emerson</u>	Phone: <u>559-782-7460</u>
Phone: <u>559-449-4500</u>	

Signature of Lead Agency Representative: Claudia Caldito **Date:** 3/20/2024

Authority cited: Section 21083, Public Resources Code. Reference: Section 21161, Public Resources Code.

Notice of Completion Attachment

APNs:

259-150-001, 259-030-031, 259-270-004, 259-030-011, 259-040-041, 259-040-044, 259-040-028, 259-040-027, 259-040-026, 259-040-025, 259-040-043, 259-040-042, 259-040-045, 259-040-046, 259-040-010, 259-040-039, 259-320-001, 259-370-058, and 259-320-002

Schools:

Summit Charter Academy, Summit Charter Intermediate Academy, Summit Collegiate High School, West Putnam School, Jim Maples Academy, Burton Elementary School, Prospect Education Center School, Oak Grove Elementary School, Santa Fe Elementary School, Olive Street Elementary School, Porterville High School, Barlett Middle School, Saint Anne's School, Belleview Elementary School, Roche Avenue Elementary School

Present Land Use/Zoning/General Plan Designation:

The Project site has a City of Porterville 2030 General Plan (General Plan) land use designation of Low Density Residential, Parks, Education, and Retail Center.

The Project site is in the RS-1 – Very Low Density Residential, RS-2 – Low Density Residential, CR – Retail Centers, and PK – Parks and Public Recreation Facilities zoning districts.

Project Description:

South of Tule River (SoTu) Master Plan and the associated entitlements, including Conditional Use Permit (CUP) No. X, General Plan Amendment (GPA) No. 2024-001, and Pre-zone/Rezone (RZ) No. 2024-001, is filed by the City of Porterville (Applicant) and pertains to 19 parcels that are located directly southwest of the city limits of the City of Porterville in the jurisdiction of the County of Tulare, California. The SoTu Project Site is generally bound to the north by the Tule River, to the south by State Route 190, to the east by State Route 65, and to the west by Westwood Street ("Project site"). The site totals approximately 447.30 gross acres. The site is identified by the Tulare County Assessor as APNs 259-150-001, 259-030-031, 259-270-004, 259-030-011, 259-040-041, 259-040-044, 259-040-028, 259-040-027, 259-040-026, 259-040-025, 259-040-043, 259-040-042, 259-040-045, 259-040-046, 259-040-010, 259-040-039, 259-320-001, 259-370-058, and 259-320-002. CUP No. X facilitates the adoption of the SoTu Master Plan. GPA No. 2024-001 requests amendment of the existing land use designations to the mix of 10 different land uses proposed in the SoTu Master Plan. RZ No. 2024-001 requests a rezone from the existing zoning districts to zoning districts that are consistent with the proposed land use designation. No physical development is proposed.

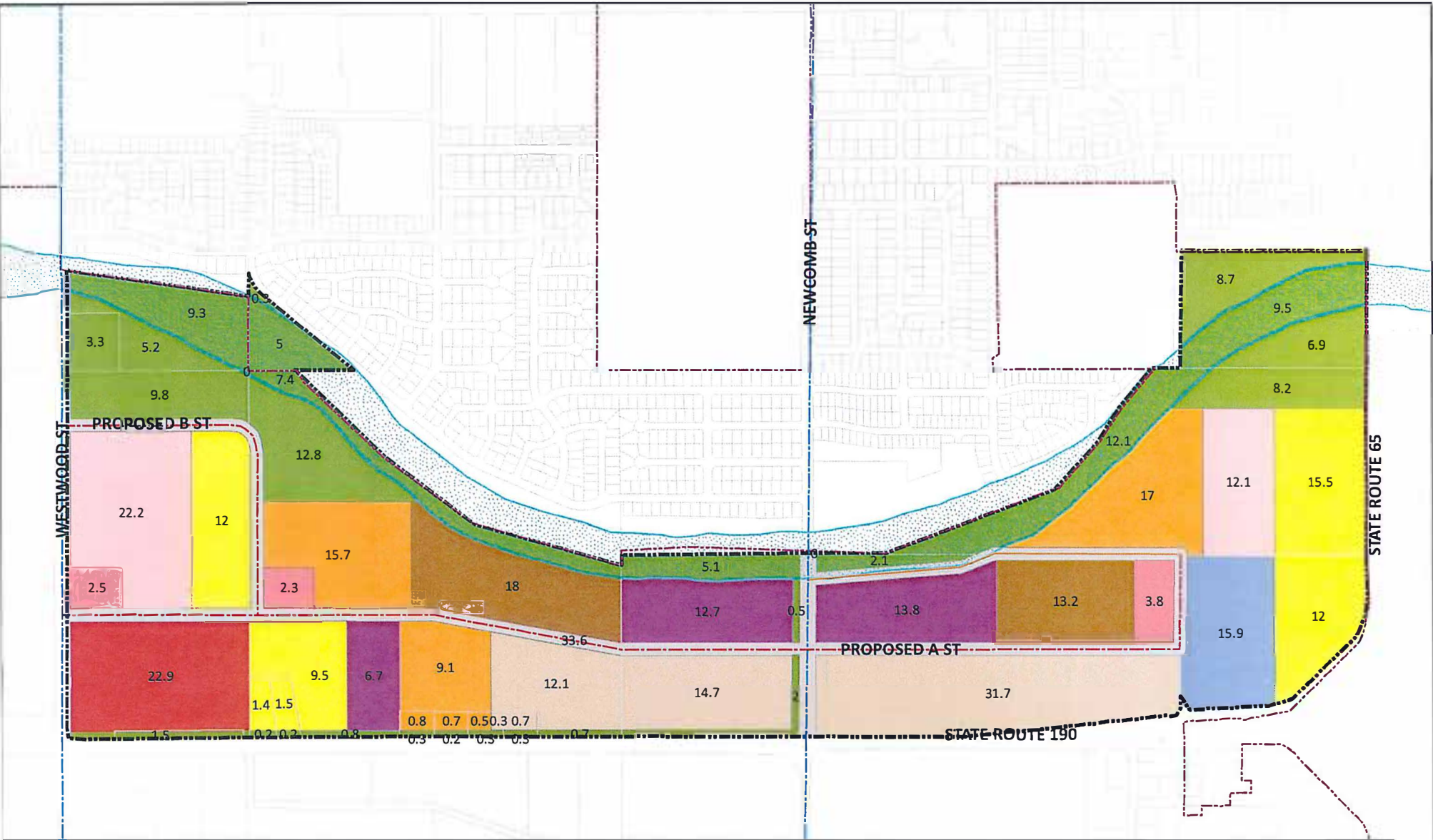

	City of Porterville City Limits	Proposed Circulation		Proposed Land Use Designation		Commercial Mixed Use		Industrial Park
	SoTu Master Plan Area			Low Density Residential		Retail Center		Parks and Recreation
	Floodway			Medium Density Residential		Neighborhood Commercial		Education
				High Density Residential		Professional Office		ROW

