

Notice of Exemption Rebecca Martinez, Madera County Clerk-Recorder

Appendix E

To: Office of Planning and Research
P.O. Box 3044, Room 113
Sacramento, CA 95812-3044

County Clerk
County of: Madera
200 W. 4th Street
Madera, CA 93637

From: (Public Agency): Madera Unified School District
1205 S. Madera Ave.
Madera, CA 93637

(Address)

Project Title: Lincoln Elementary School Improvements

Project Applicant: Madera Unified School District

Project Location - Specific:

The project is located at the NW corner of Sunset Avenue and Liberty Lane in Madera, CA. The proposed improvements would be located in the western area of the existing school campus.

Project Location - City: Madera Project Location - County: Madera

Description of Nature, Purpose and Beneficiaries of Project:

The project involves construction and operation of three Transitional-Kindergarten buildings for a total of six classrooms. Each classroom will accommodate 20 students for a total of 120 students. The project also includes installation of an adjacent play area and related landscape improvements.

Name of Public Agency Approving Project: Madera Unified School District

Name of Person or Agency Carrying Out Project: Rosalind Cox, Director of Facilities

Exempt Status: (check one):

- Ministerial (Sec. 21080(b)(1); 15268);
- Declared Emergency (Sec. 21080(b)(3); 15269(a));
- Emergency Project (Sec. 21080(b)(4); 15269(b)(c));
- Categorical Exemption. State type and section number: 15314 (Minor Additions to Schools)
- Statutory Exemptions. State code number: _____

Reasons why project is exempt:

The project will not increase existing student capacity by more than 25% and will only add six additional classrooms (the exemption allows for up to ten classrooms). Therefore, the project is exempt from CEQA.

Lead Agency
Contact Person: Rosalind Cox Area Code/Telephone/Extension: 559-675-4548

If filed by applicant:

1. Attach certified document of exemption finding.
2. Has a Notice of Exemption been filed by the public agency approving the project? Yes No

Signature: Rosalind Cox Date: 3/18/24 Title: Director of Facilities

Signed by Lead Agency Signed by Applicant

Authority cited: Sections 21083 and 21110, Public Resources Code.
Reference: Sections 21108, 21152, and 21152.1, Public Resources Code.

Date Received for filing at OPR: _____

ATTACHMENT A

Madera Unified School District

Lincoln Elementary School Improvements

Categorical Exemption - Supplemental Information

This information is being provided to supplement the proposed Categorical Exemption for the Lincoln Elementary School Improvements Project.

Description of Nature, Purpose and Beneficiaries of Project:

The Madera Unified School District (District) has outlined a variety of proposed improvements to Lincoln Elementary School (Lincoln). In order to proceed with the project, the District will need to comply with the California Environmental Quality Act (CEQA), which is the purpose and subject of this Categorical Exemption (CE).

The Lincoln Elementary campus is located at 650 Liberty Lane, Madera, CA 93637. The site is surrounded by residential land uses on all sides. The site is flat and includes landscaped fields used for athletics and other functions.

The project involves construction and operation of three Transitional-Kindergarten buildings for a total of six classrooms. Each classroom will accommodate 20 students. The project also includes installation of an adjacent play facility and related landscape improvements.

All of the improvements will occur on previously disturbed and/or paved areas of the campus. See attached site plans.

Construction is expected to occur from 2024 – 2025.

Reasons Why Project is Exempt:

1. The Project qualifies for CEQA 15314 – Minor Additions to Schools, which states:

Class 14 consists of minor additions to existing schools within existing school grounds where the addition does not increase original student capacity by more than 25% or ten classrooms, whichever is less. The addition of portable classrooms is included in this exemption.

Response: The project will not increase existing student capacity by more than 25% and will only add six additional classrooms (the exemption allows for up to ten classrooms). Therefore, the project is exempt from CEQA.

2. According to CEQA Guidelines Section 15300.2 (Exceptions), a Categorical Exemption cannot be used if the Project will result in, or have an impact upon the following:
 - a. **Cumulative Impact** – CEQA Guidelines Section 15064(i) states that a Lead Agency shall consider whether the cumulative impact of a project is significant and whether the effects of the project

ATTACHMENT A

are cumulatively considerable. The assessment of the significance of the cumulative effects of a project must, therefore, be conducted in connection with the effects of past projects, other current projects, and probable future projects. Due to the nature of the Project and consistency with environmental policies, incremental contributions to impacts are considered less than cumulatively considerable. The proposed Project would not contribute substantially to adverse cumulative conditions, or create any substantial indirect impacts (i.e., increase in population could lead to an increase need for housing, increase in traffic, air pollutants, etc.). The various improvements will occur within the existing footprint of the campus and are needed to fulfill existing and future enrollment trends.

- b. **Significant Effect** –The various improvements will occur within the existing footprint of the campus and an evaluation of potential environmental impacts resulting from implementation of the proposed Project was conducted. The existing campus is highly disturbed with buildings, paved parking lots, concrete/asphalt walkways, playfields and landscaping. Because of the nature of the improvements, the District determined that the Project would not result in significant impacts to any of the impact areas outlined in the CEQA Guidelines Appendix G as follows:
- I. Aesthetics – The Project will be similar in nature to the existing buildings on campus and will not impact any scenic vistas or aesthetic resources. Any new lighting will be shielded and directed downward so as to minimize glare. No significant impacts.
 - II. Agriculture/Forest Resources – No farmland or forests occur on site or in the City. No significant impacts.
 - III. Air Quality – The project qualifies for the San Joaquin Valley Air District’s “Small Project Analysis Level” which has predetermined that certain small projects are exempt from analysis. However, the School District’s contractor will be required to adhere to standard Air District rules and regulations such as dust control measures. No significant impacts.
 - IV. Biological Resources – No significant vegetation will be impacted by the Project and there are no biological resources on the campus due to the highly disturbed nature of the site. No significant impacts.
 - V. Cultural Resources – There are no known cultural resources on the Project site. However, in the event that undiscovered cultural resources are unearthed during ground disturbing activities, the District will be required to adhere to standard measures that include work stoppage and contacting local Native American Tribes and/or County Coroner so that potential cultural resources can be identified, preserved or removed. No significant impacts.
 - VI. Geology and Soils – The District will be required to adhere to State and local building design guidelines pertaining to seismic hazards, soil stability and related geotechnical issues. No significant impacts.

ATTACHMENT A

- VII. Energy – The District will be required to adhere to state-mandated energy efficiency regulations. In addition, the school is likely to benefit from a minor reduction in energy use as a result of some of the proposed modernization efforts.
- VIII. Greenhouse Gas Emissions - The project qualifies for the San Joaquin Valley Air District’s “Small Project Analysis Level” which has predetermined that certain small projects are exempt from analysis. No significant impacts.
- IX. Hazards & Hazardous Materials – Any hazardous materials used during construction are required to be transported and stored in compliance with applicable standards and regulations established by the Department of Toxic Substances Control (DTSC), the U.S. Environmental Protection Agency (EPA) and the Occupational Safety and Health Administration (OSHA). The site is not listed as being on or near a hazardous materials site. No significant impacts.
- X. Hydrology & Water Quality – The school receives its potable water from the City of Madera. The Project does not propose any uses that will impact water use or water quality. No significant impacts.
- XI. Land Use & Planning - The Project will be built out within the existing campus footprint. The Project has no characteristics that would physically divide the City of Madera. The Project is consistent with the City’s General Plan and there are no plans that the Project conflicts with. No significant impacts.
- XII. Mineral Resources – There are no known mineral resources on or around the school site. No significant impacts.
- XIII. Noise - Noise from schools is primarily associated with intermittent sounds of children’s voices while outside, school bells, and vehicular operation during student pick-up / drop-off times. The improvements and new construction associated with the project are not expected to generate new sources of noise within the campus. Noise generated from construction will be temporary and will be limited to hours identified by the City of Madera Municipal Code. No significant impacts.
- XIV. Population & Housing – The Project will not induce population growth. No significant impacts.
- XV. Public Services - Public services are currently provided to the District by the City of Madera. The Project has no design, construction or operational characteristics that would necessitate the need for new or expanded facilities related to fire protection, police protection, parks, or other public facilities. There is no housing related or population inducing component of the Project. No significant impacts.

ATTACHMENT A

- XVI. Recreation - The Project has no design, construction or operational characteristics that would necessitate the need for new or expanded facilities related to recreational facilities, which themselves could cause an environmental impact. No significant impacts.
- XVII. Transportation & Traffic – The campus is located in a primarily residential neighborhood. Access to and from the site will not change and traffic is not expected to substantially increase as a result of the Project. No significant impacts.
- XVIII. Tribal Cultural Resources – Tribal consultation is not a requirement under CEQA when preparing a Categorical Exemption. No significant impacts.
- XIX. Utilities & Service Systems – The City of Madera provides existing wastewater collection, treatment and disposal for the wastewater generated by the campus. Wastewater collection is provided through a series of existing sanitary sewer mains and trunk sewers that convey wastewater from the Project site and areas surrounding the campus to the City’s existing wastewater treatment plant (WWTP). The WWTP currently serves the campus and has adequate capacity to serve the minimal amount of wastewater generated by the Project. Given the nature of the wastewater generated by the Project (sinks, urinals, toilets) it is not anticipated that the quality of effluent will result in exceedance of RWQCB requirements nor will it impact any waste discharge requirements. The Project has no design, construction or operational characteristics that would necessitate the need for new or expanded facilities related to water or wastewater facilities, which themselves would cause an environmental impact. No significant impacts.
- XX. Wildfires – The location of the campus and lack of vegetation surrounding the campus precludes the possibility of impacts from or impacts to wildfires.
- c. **Scenic Highways** – There are no designated scenic highways located within the City or surrounding area.
- d. **Hazardous Waste Sites** – The improvements are located within an existing campus that is already in use as a school. Therefore, there are no hazardous waste sites on campus or that would otherwise impact the project.
- e. **Historical Resources** – There are no historical or cultural resources on the Project site.

Conclusion

Based on the information contained herein, the Madera Unified School District has determined that the proposed Project qualifies for the CEQA Exemption as discussed previously. The District will adopt the Exemption through Resolution.

NO.	REVISION	DATE
1	ISSUED FOR PERMITS	05/20/2018
2	REVISION	
3	REVISION	
4	REVISION	
5	REVISION	
6	REVISION	
7	REVISION	
8	REVISION	
9	REVISION	
10	REVISION	
11	REVISION	
12	REVISION	
13	REVISION	
14	REVISION	
15	REVISION	
16	REVISION	
17	REVISION	
18	REVISION	
19	REVISION	
20	REVISION	

PROJECT NUMBER: 2018-001

DATE: 05/20/2018

DRAWN BY: [Name]

CHECKED BY: [Name]

SCALE: AS SHOWN

PROJECT NAME: LINCOLN ELEMENTARY SCHOOL

PROJECT ADDRESS: 650 Liberty Ln, Modesto, CA 95357

STATUS: []

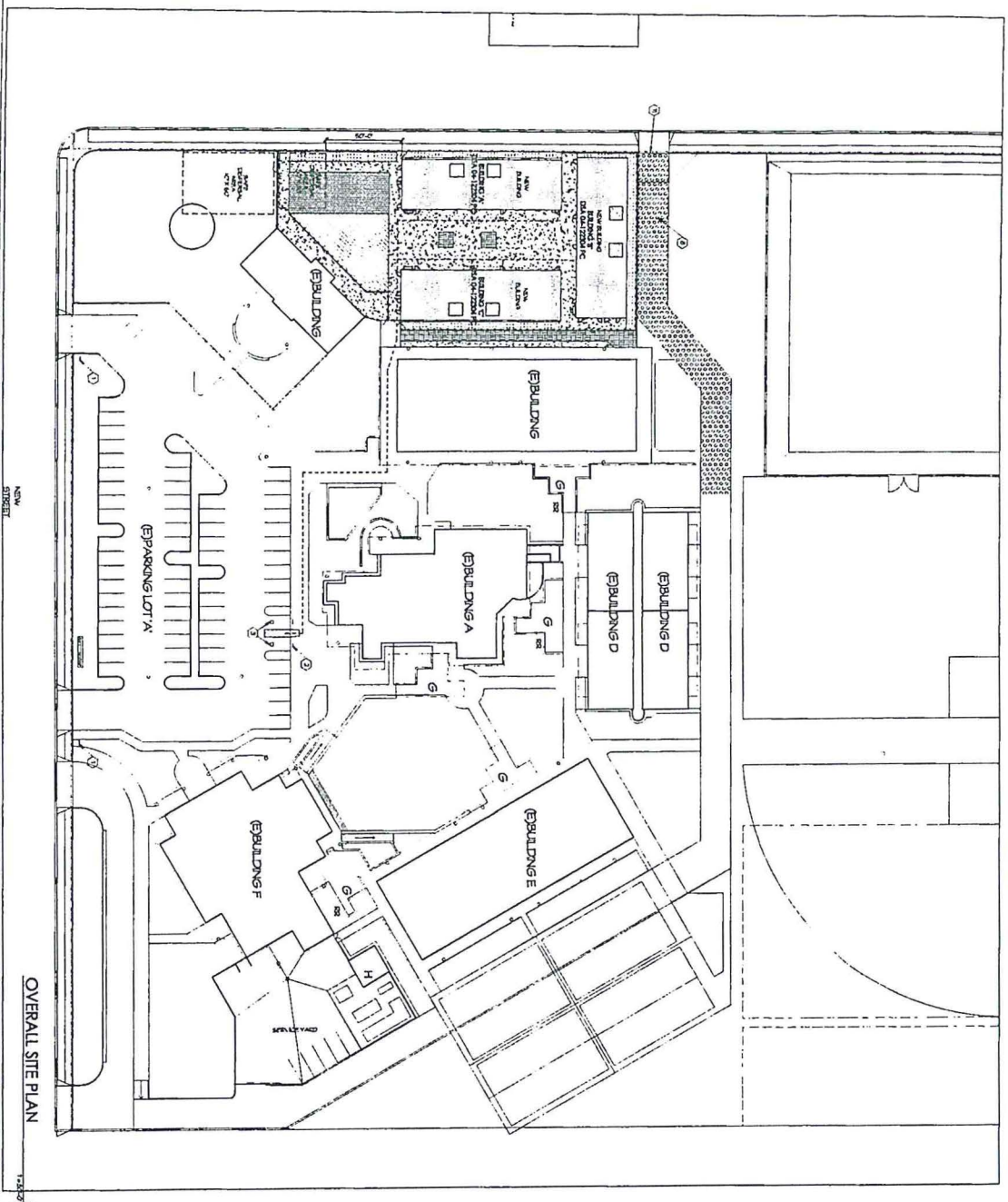

ACCESSIBLE ROUTE

1. ALL ACCESSIBLE ROUTES SHALL BE A MINIMUM OF 36 INCHES WIDE.
2. ALL ACCESSIBLE ROUTES SHALL BE SURFED WITH A FINISH THAT PROVIDES TRACTION AND IS FREE OF OBSTACLES, TRIP HAZARDS, AND OTHER HAZARDS TO THE MOBILITY IMPAIRED INDIVIDUAL.
3. ALL ACCESSIBLE ROUTES SHALL BE FREE OF OBSTACLES, TRIP HAZARDS, AND OTHER HAZARDS TO THE MOBILITY IMPAIRED INDIVIDUAL.
4. ALL ACCESSIBLE ROUTES SHALL BE FREE OF OBSTACLES, TRIP HAZARDS, AND OTHER HAZARDS TO THE MOBILITY IMPAIRED INDIVIDUAL.
5. ALL ACCESSIBLE ROUTES SHALL BE FREE OF OBSTACLES, TRIP HAZARDS, AND OTHER HAZARDS TO THE MOBILITY IMPAIRED INDIVIDUAL.
6. ALL ACCESSIBLE ROUTES SHALL BE FREE OF OBSTACLES, TRIP HAZARDS, AND OTHER HAZARDS TO THE MOBILITY IMPAIRED INDIVIDUAL.
7. ALL ACCESSIBLE ROUTES SHALL BE FREE OF OBSTACLES, TRIP HAZARDS, AND OTHER HAZARDS TO THE MOBILITY IMPAIRED INDIVIDUAL.
8. ALL ACCESSIBLE ROUTES SHALL BE FREE OF OBSTACLES, TRIP HAZARDS, AND OTHER HAZARDS TO THE MOBILITY IMPAIRED INDIVIDUAL.
9. ALL ACCESSIBLE ROUTES SHALL BE FREE OF OBSTACLES, TRIP HAZARDS, AND OTHER HAZARDS TO THE MOBILITY IMPAIRED INDIVIDUAL.
10. ALL ACCESSIBLE ROUTES SHALL BE FREE OF OBSTACLES, TRIP HAZARDS, AND OTHER HAZARDS TO THE MOBILITY IMPAIRED INDIVIDUAL.

SAFE DISPERSAL AREA

1. ALL SAFE DISPERSAL AREAS SHALL BE A MINIMUM OF 30 FEET WIDE.
2. ALL SAFE DISPERSAL AREAS SHALL BE SURFED WITH A FINISH THAT PROVIDES TRACTION AND IS FREE OF OBSTACLES, TRIP HAZARDS, AND OTHER HAZARDS TO THE MOBILITY IMPAIRED INDIVIDUAL.
3. ALL SAFE DISPERSAL AREAS SHALL BE FREE OF OBSTACLES, TRIP HAZARDS, AND OTHER HAZARDS TO THE MOBILITY IMPAIRED INDIVIDUAL.
4. ALL SAFE DISPERSAL AREAS SHALL BE FREE OF OBSTACLES, TRIP HAZARDS, AND OTHER HAZARDS TO THE MOBILITY IMPAIRED INDIVIDUAL.
5. ALL SAFE DISPERSAL AREAS SHALL BE FREE OF OBSTACLES, TRIP HAZARDS, AND OTHER HAZARDS TO THE MOBILITY IMPAIRED INDIVIDUAL.
6. ALL SAFE DISPERSAL AREAS SHALL BE FREE OF OBSTACLES, TRIP HAZARDS, AND OTHER HAZARDS TO THE MOBILITY IMPAIRED INDIVIDUAL.
7. ALL SAFE DISPERSAL AREAS SHALL BE FREE OF OBSTACLES, TRIP HAZARDS, AND OTHER HAZARDS TO THE MOBILITY IMPAIRED INDIVIDUAL.
8. ALL SAFE DISPERSAL AREAS SHALL BE FREE OF OBSTACLES, TRIP HAZARDS, AND OTHER HAZARDS TO THE MOBILITY IMPAIRED INDIVIDUAL.
9. ALL SAFE DISPERSAL AREAS SHALL BE FREE OF OBSTACLES, TRIP HAZARDS, AND OTHER HAZARDS TO THE MOBILITY IMPAIRED INDIVIDUAL.
10. ALL SAFE DISPERSAL AREAS SHALL BE FREE OF OBSTACLES, TRIP HAZARDS, AND OTHER HAZARDS TO THE MOBILITY IMPAIRED INDIVIDUAL.

REMARKS

1. ALL REMARKS SHALL BE CLEARLY IDENTIFIED ON THE DRAWING.
2. ALL REMARKS SHALL BE CLEARLY IDENTIFIED ON THE DRAWING.
3. ALL REMARKS SHALL BE CLEARLY IDENTIFIED ON THE DRAWING.
4. ALL REMARKS SHALL BE CLEARLY IDENTIFIED ON THE DRAWING.
5. ALL REMARKS SHALL BE CLEARLY IDENTIFIED ON THE DRAWING.
6. ALL REMARKS SHALL BE CLEARLY IDENTIFIED ON THE DRAWING.
7. ALL REMARKS SHALL BE CLEARLY IDENTIFIED ON THE DRAWING.
8. ALL REMARKS SHALL BE CLEARLY IDENTIFIED ON THE DRAWING.
9. ALL REMARKS SHALL BE CLEARLY IDENTIFIED ON THE DRAWING.
10. ALL REMARKS SHALL BE CLEARLY IDENTIFIED ON THE DRAWING.

SITE LEGEND

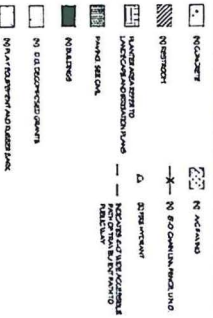

PROFESSIONAL SEAL

LINCOLN ELEMENTARY SCHOOL

650 Liberty Ln, Modesto, CA 95357

STATUS: []

PBK

OVERALL SITE PLAN

AS.1

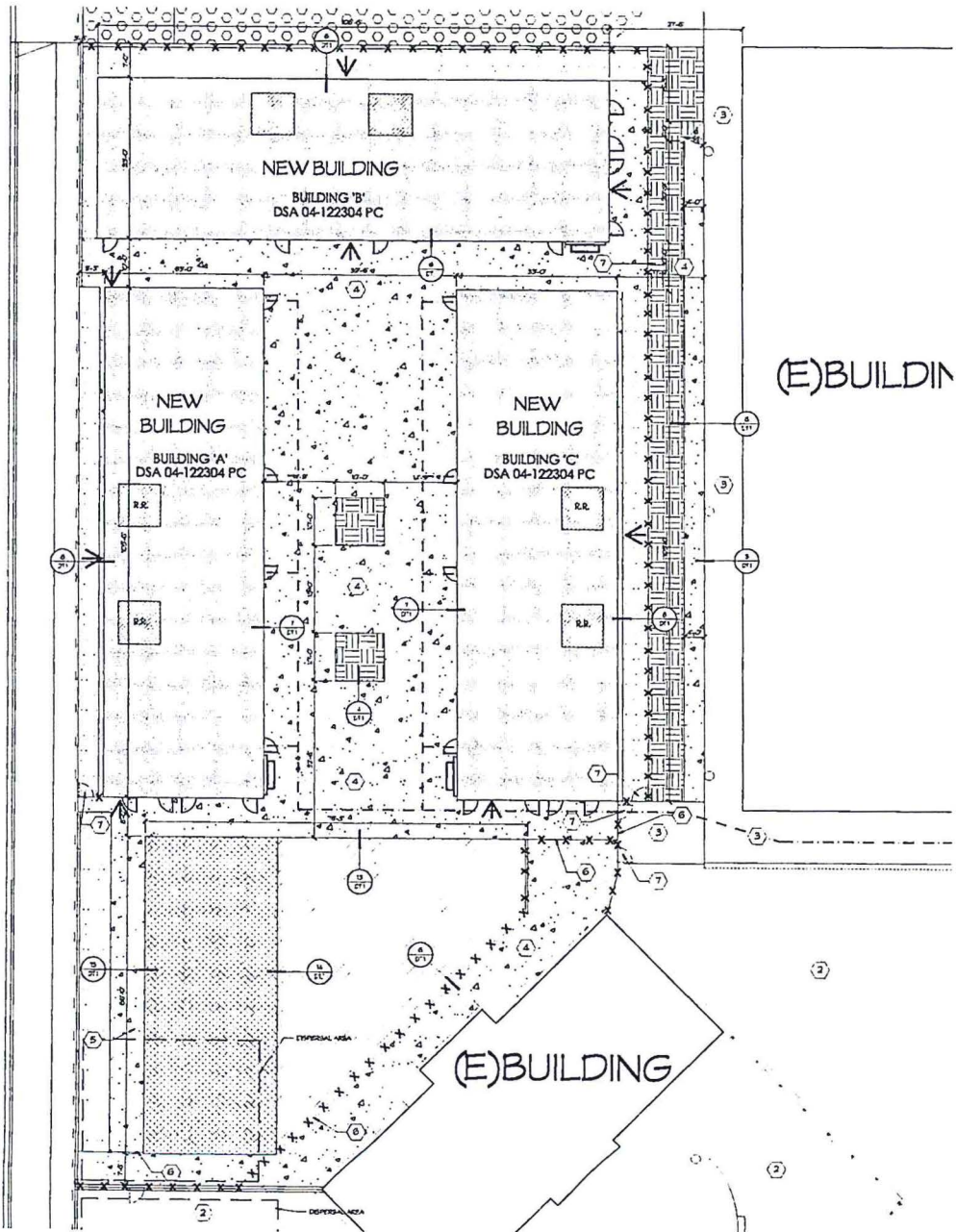

1 SITE PLAN
SCALE 1:100

SITE LEGEND

- IN CONCRETE
- IN RESTROOM
- PLANTING AREAS REFER TO LANDSCAPE ARCHITECTURE PLAN
- PAVING SEE G.S.
- IN BUILDING
- NEW 1/2" DIA. SCHEDULE 40 PIPE
- NEW PLAY EQUIPMENT AND RUBBER SAFETY MAT
- 20' WIDE FIRE ACCESS ROAD
- NEW AC PAVING
- 30' WIDE ACCESS PATH
- NEW 6'-0" OVERHEAD FENCE AND ...

KEYNOTES

- 1. NEW
- 2. EXISTING FLOOR TO REMAIN
- 3. EXISTING CONCRETE WALL TO REMAIN
- 4. NEW CONCRETE SLAB
- 5. NEW CONCRETE WALL
- 6. NEW 1/2" DIA. SCHEDULE 40 PIPE
- 7. NEW 30' WIDE OVERHEAD FENCE

GENERAL NOTES

- 1. NEW 6'-0" OVERHEAD FENCE AND ...



ARCHITECT PRK Architects, Inc.
 1700 Main Street
 Fresno, CA 93711
 (559) 484-0077
 (559) 484-0077
 PRK.com

LINCOLN ELEMENTARY SCHOOL

501 Liberty Ln, Madera, CA 93637
 STATUS



PROFESSIONAL SEAL



PROJECT NUMBER	220426
DATE	12/23
DSA APPLICATION NO.	02-121557
FILE NO.	10-72
PERM NO.	02142-141
DRAWN BY	AC/09

#	REVISIONS	DATE

ENLARGED
PARTIAL SITE
PLAN

AS.3



State of California - Department of Fish and Wildlife
2024 ENVIRONMENTAL DOCUMENT FILING FEE
CASH RECEIPT
 DFW 753.5a (REV. 01/01/24) Previously DFG 753.5a

RECEIPT NUMBER: 20-03182024-016
STATE CLEARINGHOUSE NUMBER (if applicable)

SEE INSTRUCTIONS ON REVERSE. TYPE OR PRINT CLEARLY.

LEAD AGENCY MADERA UNIFIED SCHOOL DISTRICT	LEAD AGENCY EMAIL rosalindcox@maderausd.org	DATE 03/18/2024
COUNTY/STATE AGENCY OF FILING MADERA		DOCUMENT NUMBER 2024016

PROJECT TITLE
LINCOLN ELEMENTARY SCHOOL IMPROVEMENTS

PROJECT APPLICANT NAME MADERA UNIFIED SCHOOL DISTRICT	PROJECT APPLICANT EMAIL rosalindcox@maderausd.org	PHONE NUMBER (559) 675-4548
PROJECT APPLICANT ADDRESS 1205 SOUTH MADERA AVENUE	CITY MADERA	STATE CA
		ZIP CODE 93637

PROJECT APPLICANT (Check appropriate box)

- Local Public Agency
 School District
 Other Special District
 State Agency
 Private Entity

CHECK APPLICABLE FEES:

- | | | |
|---|------------|----------|
| <input type="checkbox"/> Environmental Impact Report (EIR) | \$4,051.25 | \$ _____ |
| <input type="checkbox"/> Mitigated/Negative Declaration (MND)(ND) | \$2,916.75 | \$ _____ |
| <input type="checkbox"/> Certified Regulatory Program (CRP) document - payment due directly to CDFW | \$1,377.25 | \$ _____ |

- Exempt from fee
 Notice of Exemption (attach)
 CDFW No Effect Determination (attach)
 Fee previously paid (attach previously issued cash receipt copy)

- | | | |
|---|----------|------------------|
| <input type="checkbox"/> Water Right Application or Petition Fee (State Water Resources Control Board only) | \$850.00 | \$ _____ |
| <input checked="" type="checkbox"/> County documentary handling fee | | \$ _____ \$50.00 |
| <input type="checkbox"/> Other | | \$ _____ |

PAYMENT METHOD:

- Cash
 Credit
 Check
 Other

TOTAL RECEIVED \$ _____ \$50.00

SIGNATURE X 	AGENCY OF FILING PRINTED NAME AND TITLE Kyle Absher, Deputy County Clerk-Recorder
---	--

Rebecca Martinez
 County Clerk-Recorder
 200 W. 4th Street
 Madera, CA 93637
 Clerk (559) 675-7721; Recorder (559)
 675-7724; Elections (559) 675-7720

Receipt: 24-5218

Product	Name	Extended
FISH	CEQA FISH AND WILDLIFE FILING	\$50.00

Pages 7, Document # 20-03182024-016,
 Document Info: MADERA UNIFIED SCHOOL
 DISTRICT, Filing Type NOE, State Fee Prev
 Charged false, No Charge Clerk Fee false

Total	\$50.00
Tender (Check)	\$50.00
Paid By MADERA UNIFIED SCHOOL DISTRICT, Check # 010372	

Thank You
 Please retain this for your records

www.maderacounty.com

3/18/24 12:41 PM PST

MADERA UNIFIED SCHOOL PETTY CASH 1902 HOWARD RD., MADERA, CA 93637 - (559) 675-4500

VENDOR
 MADERA COUNTY CLERK RECORDER

No. 010372

DATE
 March 13, 2024

INVOICE NO.	P.O. NO.	AMOUNT	INVOICE NO.	P.O. NO.	AMOUNT	INVOICE NO.	P.O. NO.	AMOUNT
-------------	----------	--------	-------------	----------	--------	-------------	----------	--------

PROCESSING FEE FOR NOTICE OF EXEMPTION FOR UTK PROJECT AT
 LINCOLN ES

\$50.00

ACCT#	3500-77100-0-0000-8500-5800-00-470-7860	TOTAL	\$50.00
-------	---	-------	---------