

INITIAL STUDY/NEGATIVE DECLARATION

[Pursuant to Public Resources Code Section 21080(c) and California Code of Regulations, Title 14, Sections 15070-15071]

LEAD AGENCY: San Joaquin County Community Development Department

PROJECT APPLICANT: Schack and Company

PROJECT TITLE/FILE NUMBER(S): PA-2300198 (AUP)

PROJECT DESCRIPTION: This project is to infill, grade, and level a reclaimed quarry in two phases over five years to allow for the planting of a 24.84-acre site for agricultural production. Phase one will consist of filling the quarry with 1/3 of the total fill material. Phase 2 will consist of filling the quarry with the remaining 2/3 of the total fill material. Total fill quantity at the conclusion of the project will be approximately 866,944 cubic yards of fill dirt, which will bring the site to grade.

The project site is located on the east side of South Corral Hollow Road, approximately 2,600 feet south of West Linne Road, Tracy.

ASSESSOR PARCEL NO.: 253-110-19 and 253-110-32

ACRES: 24.84 acres

GENERAL PLAN: OS/RC (Open Space, Resource Conservation)

ZONING: AG-40 (General Agriculture 40-acre minimum)

POTENTIAL POPULATION, NUMBER OF DWELLING UNITS, OR SQUARE FOOTAGE OF USE(S):
No development is associated with the application. The applicant is proposing to utilize the property for agricultural production, however, once brought to grade, each parcel can be developed with a single-family residential unit, accessory dwelling unit, and accessory or agricultural structures.

SURROUNDING LAND USES:

- NORTH:** Industrial, City of Tracy, Residential
- SOUTH:** Agricultural with scattered residences, City of Tracy, Delta Mendota Canal, California Aqueduct
- EAST:** Agricultural with scattered residences, City of Tracy, Tracy Municipal Airport
- WEST:** Agriculture with scattered residences, City of Tracy

REFERENCES AND SOURCES FOR DETERMINING ENVIRONMENTAL IMPACTS:

Original source materials and maps on file in the Community Development Department including: all County and City general plans and community plans; assessor parcel books; various local and FEMA flood zone maps; service district maps; maps of geologic instability; maps and reports on endangered species such as the Natural Diversity Data Base; noise contour maps; specific roadway plans; maps and/or records of archeological/historic resources; soil reports and maps; etc.

Many of these original source materials have been collected from other public agencies or from previously prepared EIR's and other technical studies. Additional standard sources which should be specifically cited below include on-site visits by staff (December 19, 2023), staff knowledge or experience; and independent environmental studies submitted to the County as part of the project application. Copies of these reports can be found by contacting the Community Development Department.

TRIBAL CULTURAL RESOURCES:

Have California Native American tribes traditionally and culturally affiliated with the project area requested consultation pursuant to Public Resources Code section 21080.3.1? If so, is there a plan for consultation that includes, for example, the determination of significance of impacts to tribal cultural resources, procedures regarding confidentiality, etc.?

No

GENERAL CONSIDERATIONS:

1. Does it appear that any environmental feature of the project will generate significant public concern or controversy?
 Yes No

Nature of concern(s): Enter concern(s).

2. Will the project require approval or permits by agencies other than the County?
 Yes No

Agency name(s): Enter agency name(s).

3. Is the project within the Sphere of Influence, or within two miles, of any city?
 Yes No

City: City of Tracy

ENVIRONMENTAL FACTORS POTENTIALLY AFFECTED:

The environmental factors checked below would be potentially affected by this project, involving at least one impact that is a "Potentially Significant Impact" as indicated by the checklist on the following pages.

- | | | |
|--|---|---|
| <input type="checkbox"/> Aesthetics | <input type="checkbox"/> Agriculture and Forestry Resources | <input type="checkbox"/> Air Quality |
| <input type="checkbox"/> Biological Resources | <input type="checkbox"/> Cultural Resources | <input type="checkbox"/> Energy |
| <input type="checkbox"/> Geology / Soils | <input type="checkbox"/> Greenhouse Gas Emissions | <input type="checkbox"/> Hazards & Hazardous Materials |
| <input type="checkbox"/> Hydrology / Water Quality | <input type="checkbox"/> Land Use / Planning | <input type="checkbox"/> Mineral Resources |
| <input type="checkbox"/> Noise | <input type="checkbox"/> Population / Housing | <input type="checkbox"/> Public Services |
| <input type="checkbox"/> Recreation | <input type="checkbox"/> Transportation | <input type="checkbox"/> Tribal Cultural Resources |
| <input type="checkbox"/> Utilities / Service Systems | <input type="checkbox"/> Wildfire | <input type="checkbox"/> Mandatory Findings of Significance |

DETERMINATION: (To be completed by the Lead Agency) On the basis of this initial evaluation:

- I find that the proposed project COULD NOT have a significant effect on the environment, and a NEGATIVE DECLARATION will be prepared.
- I find that although the proposed project could have a significant effect on the environment, there will not be a significant effect in this case because revisions in the project have been made by or agreed to by the project proponent. A MITIGATED NEGATIVE DECLARATION will be prepared.
- I find that the proposed project MAY have a significant effect on the environment, and an ENVIRONMENTAL IMPACT REPORT is required.
- I find that the proposed project MAY have a "potentially significant impact" or "potentially significant unless mitigated" impact on the environment, but at least one effect 1) has been adequately analyzed in an earlier document pursuant to applicable legal standards, and 2) has been addressed by mitigation measures based on the earlier analysis as described on attached sheets. An ENVIRONMENTAL IMPACT REPORT is required, but it must analyze only the effects that remain to be addressed.
- I find that although the proposed project could have a significant effect on the environment, because all potentially significant effects (a) have been analyzed adequately in an earlier EIR or NEGATIVE DECLARATION pursuant to applicable standards, and (b) have been avoided or mitigated pursuant to that earlier EIR or NEGATIVE DECLARATION, including revisions or mitigation measures that are imposed upon the proposed project, nothing further is required.



Signature: Sol Jobrack
Associate Planner

4/3/2024

Date

EVALUATION OF ENVIRONMENTAL IMPACTS:

- 1) A brief explanation is required for all answers except "No Impact" answers that are adequately supported by the information sources a lead agency cites in the parentheses following each question. A "No Impact" answer is adequately supported if the referenced information sources show that the impact simply does not apply to projects like the one involved (e.g., the project falls outside a fault rupture zone). A "No Impact" answer should be explained where it is based on project-specific factors as well as general standards (e.g., the project will not expose sensitive receptors to pollutants, based on a project-specific screening analysis).
- 2) All answers must take account of the whole action involved, including off-site as well as on-site, cumulative as well as project-level, indirect as well as direct, and construction as well as operational impacts.
- 3) Once the lead agency has determined that a particular physical impact may occur, then the checklist answers must indicate whether the impact is potentially significant, less than significant with mitigation, or less than significant. "Potentially Significant Impact" is appropriate if there is substantial evidence that an effect may be significant. If there are one or more "Potentially Significant Impact" entries when the determination is made, an EIR is required.
- 4) "Negative Declaration: Less Than Significant with Mitigation Incorporated" applies where the incorporation of mitigation measures has reduced an effect from "Potentially Significant Impact" to a "Less Than Significant Impact." The lead agency must describe the mitigation measures, and briefly explain how they reduce the effect to a less than significant level (mitigation measures from "Earlier Analyses," as described in (5) below, may be cross-referenced).
- 5) Earlier analyses may be used where, pursuant to the tiering, program EIR, or other CEQA process, an effect has been adequately analyzed in an earlier EIR or negative declaration. Section 15063(c)(3)(D). In this case, a brief discussion should identify the following:
 - a) Earlier Analysis Used. Identify and state where they are available for review.
 - b) Impacts Adequately Addressed. Identify which effects from the above checklist were within the scope of and adequately analyzed in an earlier document pursuant to applicable legal standards, and state whether such effects were addressed by mitigation measures based on the earlier analysis.
 - c) Mitigation Measures. For effects that are "Less than Significant with Mitigation Measures Incorporated," describe the mitigation measures which were incorporated or refined from the earlier document and the extent to which they address site-specific conditions for the project.
- 6) Lead agencies are encouraged to incorporate into the checklist references to information sources for potential impacts (e.g., general plans, zoning ordinances). Reference to a previously prepared or outside document should, where appropriate, include a reference to the page or pages where the statement is substantiated.
- 7) Supporting Information Sources: A source list should be attached, and other sources used, or individuals contacted should be cited in the discussion.
- 8) This is only a suggested form, and lead agencies are free to use different formats; however, lead agencies should normally address the questions from this checklist that are relevant to a project's environmental effects in whatever format is selected.
- 9) The explanation of each issue should identify:
 - a) the significance criteria or threshold, if any, used to evaluate each question; and
 - b) the mitigation measure identified, if any, to reduce the impact to less than significance.

Potentially Significant Impact	Less Than Significant with Mitigation Incorporated	Less Than Significant Impact	No Impact	Analyzed In The Prior EIR
--------------------------------------	---	------------------------------------	--------------	---------------------------------

I. AESTHETICS.

Except as provided in Public Resources Code Section 21099, would the project:

- | | | | | | |
|---|--------------------------|--------------------------|--------------------------|-------------------------------------|--------------------------|
| a) Have a substantial adverse effect on a scenic vista? | <input type="checkbox"/> | <input type="checkbox"/> | <input type="checkbox"/> | <input checked="" type="checkbox"/> | <input type="checkbox"/> |
| b) Substantially damage scenic resources, including, but not limited to, trees, rock outcroppings, and historic buildings within a state scenic highway? | <input type="checkbox"/> | <input type="checkbox"/> | <input type="checkbox"/> | <input checked="" type="checkbox"/> | <input type="checkbox"/> |
| c) In non-urbanized areas, substantially degrade the existing visual character or quality of public views of the site and its surroundings? (Public views are those that are experienced from a publicly accessible vantage point). If the project is in an urbanized area, would the project conflict with applicable zoning and other regulations governing scenic quality? | <input type="checkbox"/> | <input type="checkbox"/> | <input type="checkbox"/> | <input checked="" type="checkbox"/> | <input type="checkbox"/> |
| d) Create a new source of substantial light or glare which would adversely affect day or nighttime views in the area? | <input type="checkbox"/> | <input type="checkbox"/> | <input type="checkbox"/> | <input checked="" type="checkbox"/> | <input type="checkbox"/> |

Impact Discussion:

- a-c) This project is to infill, grade, and level a reclaimed quarry in two phases over five years to allow for the planting of a 24.84-acre site for agricultural production. Phase one will consist of filling the quarry with 1/3 of the total fill material. Phase 2 will consist of filling the quarry with the remaining 2/3 of the total fill material, which will bring the site to grade. Total fill quantity at the conclusion of the project will be approximately 866,944 cubic yards of fill dirt.

The proposed project site is located on the east side of South Corral Hollow Road, South of West Linne Road just west of the City of Tracy. Pursuant to the 2035 General Plan, this area is not located along a scenic route. As a result, the project will not have a substantial, adverse effect on a scenic vista, nor will it substantially damage scenic resources. The proposed project is outside of an urbanized area. The area is currently zoned General Agriculture (AG-40), and the applicant is not proposing any development. If approved the project would be consistent with the proposed zoning and regulations that govern scenic quality. Therefore, the proposed project is anticipated to have a less than impact on scenic vistas and resources.

- d) The proposed project does not include any development. At the time of any future development, the applicant will be required to adhere to Lighting and Illumination requirements in San Joaquin County Development Title section 9-403, which requires shielding of outdoor lighting fixtures so as not to be directly visible from a public street or an adjacent lot with limited exceptions. As a result, the proposed project is not anticipated to create any new source of substantial light or glare affecting day or nighttime views in the area and is anticipated to have a less than significant impact on such views.

Potentially Significant Impact	Less Than Significant with Mitigation Incorporated	Less Than Significant Impact	No Impact	Analyzed In The Prior EIR
--------------------------------------	---	------------------------------------	--------------	---------------------------------

II. AGRICULTURE AND FORESTRY RESOURCES.

In determining whether impacts to agricultural resources are significant environmental effects, lead agencies may refer to the California Agricultural Land Evaluation and Site Assessment Model (1997) prepared by the California Dept. of Conservation as an optional model to use in assessing impacts on agriculture and farmland. In determining whether impacts to forest resources, including timberland, are significant environmental effects, lead agencies may refer to information compiled by the California Department of Forestry and Fire Protection regarding the state's inventory of forest land, including the Forest and Range Assessment Project and the Forest Legacy Assessment project; and forest carbon measurement methodology provided in Forest Protocols adopted by the California Air Resources Board. -- Would the project:

- | | | | | | |
|--|--------------------------|--------------------------|--------------------------|-------------------------------------|--------------------------|
| a) Convert Prime Farmland, Unique Farmland, or Farmland of Statewide Importance (Farmland), as shown on the maps prepared pursuant to the Farmland Mapping and Monitoring Program of the California Resources Agency, to nonagricultural use? | <input type="checkbox"/> | <input type="checkbox"/> | <input type="checkbox"/> | <input checked="" type="checkbox"/> | <input type="checkbox"/> |
| b) Conflict with existing zoning for agricultural use, or a Williamson Act contract? | <input type="checkbox"/> | <input type="checkbox"/> | <input type="checkbox"/> | <input checked="" type="checkbox"/> | <input type="checkbox"/> |
| c) Conflict with existing zoning for, or cause rezoning of, forest land (as defined in Public Resources Code section 12220(g)), timberland (as defined by Public Resources Code section 4526), or timberland zoned Timberland Production (as defined by Government Code section 51104(g))? | <input type="checkbox"/> | <input type="checkbox"/> | <input type="checkbox"/> | <input checked="" type="checkbox"/> | <input type="checkbox"/> |
| d) Result in the loss of forest land or conversion of forest land to non-forest use? | <input type="checkbox"/> | <input type="checkbox"/> | <input type="checkbox"/> | <input checked="" type="checkbox"/> | <input type="checkbox"/> |
| e) Involve other changes in the existing environment which, due to their location or nature, could result in conversion of Farmland, to non-agricultural use or conversion of forest land to non-forest use? | <input type="checkbox"/> | <input type="checkbox"/> | <input type="checkbox"/> | <input checked="" type="checkbox"/> | <input type="checkbox"/> |

Impact Discussion:

a-e) This project is to infill, grade, and level a reclaimed quarry in two phases over five years to allow for the planting of a 24.84-acre site for agricultural production. Phase one will consist of filling the quarry with 1/3 of the total fill material. Phase 2 will consist of filling the quarry with the remaining 2/3 of the total fill material, which will bring the site to grade. Total fill quantity at the conclusion of the project will be approximately 866,944 cubic yards of fill dirt.

The project site is zoned AG-40 (General Agriculture 40-acre minimum), and is not categorized as Prime Farmland, Unique Farmland, or Farmland of Statewide Importance. The project site is not under a Williamson Act contract. A referral for the project was sent to the San Joaquin County Farm Bureau on December 22, 2023. No comments were received.

There are also no forest resources or zoning for forestlands or timberland, as defined by Public Resources Code and Government Code, located on or near the project site. Therefore, the project will have no impact on forest land or timberland production; nor will it result in the loss or conversion of such land or the conversion of agricultural land. As a result, the project is anticipated to have no negative impact on agriculture and forestry resources. In fact,

as a result of the project, 24.84 acres will be returned to productive agricultural use.

Potentially Significant Impact	Less Than Significant with Mitigation Incorporated	Less Than Significant Impact	No Impact	Analyzed In The Prior EIR
--------------------------------------	---	------------------------------------	--------------	---------------------------------

III. AIR QUALITY.

Where available, the significance criteria established by the applicable air quality management or air pollution control district may be relied upon to make the following determinations. Would the project:

- | | | | | | |
|---|--------------------------|--------------------------|-------------------------------------|--------------------------|--------------------------|
| a) Conflict with or obstruct implementation of the applicable air quality plan? | <input type="checkbox"/> | <input type="checkbox"/> | <input checked="" type="checkbox"/> | <input type="checkbox"/> | <input type="checkbox"/> |
| b) Result in a cumulatively considerable net increase of any criteria pollutant for which the project region is non-attainment under an applicable federal or state ambient air quality standard? | <input type="checkbox"/> | <input type="checkbox"/> | <input checked="" type="checkbox"/> | <input type="checkbox"/> | <input type="checkbox"/> |
| c) Expose sensitive receptors to substantial pollutant concentrations? | <input type="checkbox"/> | <input type="checkbox"/> | <input checked="" type="checkbox"/> | <input type="checkbox"/> | <input type="checkbox"/> |
| d) Result in substantial emissions (such as those leading to odors) adversely affecting a substantial number of people? | <input type="checkbox"/> | <input type="checkbox"/> | <input checked="" type="checkbox"/> | <input type="checkbox"/> | <input type="checkbox"/> |

Impact Discussion:

- a-d) This project is to infill, grade, and level a reclaimed quarry in two phases over five years to allow for the planting of a 24.84-acre site for agricultural production. Phase one will consist of filling the quarry with 1/3 of the total fill material. Phase 2 will consist of filling the quarry with the remaining 2/3 of the total fill material, which will bring the site to grade. Total fill quantity at the conclusion of the project will be approximately 866,944 cubic yards of fill dirt.

The project site is located in the San Joaquin County Valley Air Basin, which is regulated by the San Joaquin County Valley Air Pollution Control District (SJVAPCD). The project was referred to the SJVAPCD for review on December 22, 2023. The SJVAPCD is the lead air quality regulatory agency for San Joaquin County. In the event that any new construction occurs, the project would be subject to the Air District's rules and regulations. As a result, any impacts to air quality will be reduced to less than significant.

Potentially Significant Impact	Less Than Significant with Mitigation Incorporated	Less Than Significant Impact	No Impact	Analyzed In The Prior EIR
--------------------------------------	---	------------------------------------	--------------	---------------------------------

IV. BIOLOGICAL RESOURCES:

Would the project:

- | | | | | | |
|--|--------------------------|-------------------------------------|-------------------------------------|--------------------------|--------------------------|
| a) Have a substantial adverse effect, either directly or through habitat modifications, on any species identified as a candidate, sensitive, or special status species in local or regional plans, policies, or regulations, or by the California Department of Fish and Game or U.S. Fish and Wildlife Service? | <input type="checkbox"/> | <input checked="" type="checkbox"/> | <input type="checkbox"/> | <input type="checkbox"/> | <input type="checkbox"/> |
| b) Have a substantial adverse effect on any riparian habitat or other sensitive natural community identified in local or regional plans, policies, regulations or by the California Department of Fish and Game or US Fish and Wildlife Service? | <input type="checkbox"/> | <input type="checkbox"/> | <input checked="" type="checkbox"/> | <input type="checkbox"/> | <input type="checkbox"/> |
| c) Have a substantial adverse effect on state or federally protected wetlands (including, but not limited to, marsh, vernal pool, coastal, etc.) through direct removal, filling, hydrological interruption, or other means? | <input type="checkbox"/> | <input type="checkbox"/> | <input checked="" type="checkbox"/> | <input type="checkbox"/> | <input type="checkbox"/> |
| d) Interfere substantially with the movement of any native resident or migratory fish or wildlife species or with established native resident or migratory wildlife corridors, or impede the use of native wildlife nursery sites? | <input type="checkbox"/> | <input type="checkbox"/> | <input checked="" type="checkbox"/> | <input type="checkbox"/> | <input type="checkbox"/> |
| e) Conflict with any local policies or ordinances protecting biological resources, such as a tree preservation policy or ordinance? | <input type="checkbox"/> | <input type="checkbox"/> | <input checked="" type="checkbox"/> | <input type="checkbox"/> | <input type="checkbox"/> |
| f) Conflict with the provisions of an adopted Habitat Conservation Plan, Natural Community Conservation Plan, or other approved local, regional, or state habitat conservation plan? | <input type="checkbox"/> | <input type="checkbox"/> | <input checked="" type="checkbox"/> | <input type="checkbox"/> | <input type="checkbox"/> |

Impact Discussion:

- a-f) This project is to infill, grade, and level a reclaimed quarry in two phases over five years to allow for the planting of a 24.84-acre site for agricultural production. Phase one will consist of filling the quarry with 1/3 of the total fill material. Phase 2 will consist of filling the quarry with the remaining 2/3 of the total fill material, which will bring the site to grade. Total fill quantity at the conclusion of the project will be approximately 866,944 cubic yards of fill dirt.

A referral was sent to the San Joaquin Council of Governments (SJCOG) on December 22, 2023, for review. The San Joaquin Council of Governments (SJCOG) has determined that the project is subject to the *San Joaquin County Multi-Species Habitat Conservation and Open Space Plan (SJMSCP)* for any future development that results in ground disturbance. Participation in the SJMSCP provides compensation for the conversion of Open Space to non-Open Space uses which affect the plant, fish and wildlife species covered by the Plan. If the Administrative Use Permit is approved, any future ground disturbance at the site would be subject to the SJMSCP as a Condition of Approval of the Minor Subdivision. As a result, the anticipated impact to Biological Resources is less than significant.

Potentially Significant Impact	Less Than Significant with Mitigation Incorporated	Less Than Significant Impact	No Impact	Analyzed In The Prior EIR
--------------------------------------	---	------------------------------------	--------------	---------------------------------

V. CULTURAL RESOURCES.

Would the project:

- | | | | | | |
|--|--------------------------|--------------------------|--------------------------|-------------------------------------|--------------------------|
| a) Cause a substantial adverse change in the significance of a historical resource pursuant to § 15064.5? | <input type="checkbox"/> | <input type="checkbox"/> | <input type="checkbox"/> | <input checked="" type="checkbox"/> | <input type="checkbox"/> |
| b) Cause a substantial adverse change in the significance of an archaeological resource pursuant to § 15064.5? | <input type="checkbox"/> | <input type="checkbox"/> | <input type="checkbox"/> | <input checked="" type="checkbox"/> | <input type="checkbox"/> |
| c) Disturb any human remains, including those interred outside of dedicated cemeteries? | <input type="checkbox"/> | <input type="checkbox"/> | <input type="checkbox"/> | <input checked="" type="checkbox"/> | <input type="checkbox"/> |

Impact Discussion:

- a-c) This project is to infill, grade, and level a reclaimed quarry in two phases over five years to allow for the planting of a 24.84-acre site for agricultural production. Phase one will consist of filling the quarry with 1/3 of the total fill material. Phase 2 will consist of filling the quarry with the remaining 2/3 of the total fill material, which will bring the site to grade. Total fill quantity at the conclusion of the project will be approximately 866,944 cubic yards of fill dirt.

In the event human remains are discovered at any point of the project, California state law requires that there shall be no further excavation or disturbance of the site, or any nearby area reasonably suspected to overlie adjacent remains until the coroner of the county has determined the manner and cause of death. Recommendations concerning the treatment and disposition of the human remains shall have been made to the person responsible for the excavation (California Health and Safety Code - Section 7050.5). At the time development, if Human burials are found to be of Native American origin, the developer shall follow the procedures pursuant to Title 14, Division 6, Chapter 3, Article 5, Section 15064.5(e) of the California State Code of Regulations.

As a result, the project is anticipated to have no impact on cultural resources.

	Potentially Significant Impact	Less Than Significant with Mitigation Incorporated	Less Than Significant Impact	No Impact	Analyzed In The Prior EIR
--	--------------------------------	--	------------------------------	-----------	---------------------------

VI. ENERGY.

Would the project:

- | | | | | | |
|--|--------------------------|--------------------------|--------------------------|-------------------------------------|--------------------------|
| a) Result in a potentially significant environmental impact due to wasteful, inefficient, or unnecessary consumption of energy, or wasteful use of energy resources, during project construction or operation? | <input type="checkbox"/> | <input type="checkbox"/> | <input type="checkbox"/> | <input checked="" type="checkbox"/> | <input type="checkbox"/> |
| b) Conflict with or obstruct a state or local plan for renewable energy or energy efficiency? | <input type="checkbox"/> | <input type="checkbox"/> | <input type="checkbox"/> | <input checked="" type="checkbox"/> | <input type="checkbox"/> |

Impact Discussion:

- a-b) This project is to infill, grade, and level a reclaimed quarry in two phases over five years to allow for the planting of a 24.84-acre site for agricultural production. Phase one will consist of filling the quarry with 1/3 of the total fill material. Phase 2 will consist of filling the quarry with the remaining 2/3 of the total fill material, which will bring the site to grade. Total fill quantity at the conclusion of the project will be approximately 866,944 cubic yards of fill dirt.

The California Energy Code (also titled The Energy Efficiency Standards for Residential and Non-residential Buildings) was created by the California Building Standards Commission in response to a legislative mandate to reduce California's energy consumption. The code's purpose is to advance the state's energy policy, develop renewable energy sources and prepare for energy emergencies. These standards are updated periodically by the California Energy Commission. The code includes energy conservation standards applicable to most buildings throughout California.

While there is no proposal for any development, if any future development for residential dwellings are proposed, the project will be subject to the California Energy Code (also titled The Energy Efficiency Standards for Residential and Non-residential Buildings). These requirements will also be applicable to any future proposed project ensuring that any impact to the environment due to wasteful, inefficient, or unnecessary consumption of energy will be less than significant and also preventing any conflict with state or local plans for energy efficiency and renewable energy.

VII. GEOLOGY AND SOILS.

Would the project:

	Potentially Significant Impact	Less Than Significant with Mitigation Incorporated	Less Than Significant Impact	No Impact	Analyzed In The Prior EIR
a) Directly or indirectly cause potential substantial adverse effects, including the risk of loss, injury, or death involving:	<input type="checkbox"/>	<input type="checkbox"/>	<input type="checkbox"/>	<input checked="" type="checkbox"/>	<input type="checkbox"/>
i) Rupture of a known earthquake fault, as delineated on the most recent Alquist-Priolo Earthquake Fault Zoning Map issued by the State Geologist for the area or based on other substantial evidence of a known fault? Refer to Division of Mines and Geology Special Publication 42.	<input type="checkbox"/>	<input type="checkbox"/>	<input type="checkbox"/>	<input checked="" type="checkbox"/>	<input type="checkbox"/>
ii) Strong seismic ground shaking?	<input type="checkbox"/>	<input type="checkbox"/>	<input type="checkbox"/>	<input checked="" type="checkbox"/>	<input type="checkbox"/>
iii) Seismic-related ground failure, including liquefaction?	<input type="checkbox"/>	<input type="checkbox"/>	<input type="checkbox"/>	<input checked="" type="checkbox"/>	<input type="checkbox"/>
iv) Landslides?	<input type="checkbox"/>	<input type="checkbox"/>	<input type="checkbox"/>	<input checked="" type="checkbox"/>	<input type="checkbox"/>
b) Result in substantial soil erosion or the loss of topsoil?	<input type="checkbox"/>	<input type="checkbox"/>	<input checked="" type="checkbox"/>	<input type="checkbox"/>	<input type="checkbox"/>
c) Be located on a geologic unit or soil that is unstable, or that would become unstable as a result of the project, and potentially result in on- or off-site landslide, lateral spreading, subsidence, liquefaction or collapse?	<input type="checkbox"/>	<input type="checkbox"/>	<input checked="" type="checkbox"/>	<input type="checkbox"/>	<input type="checkbox"/>
d) Be located on expansive soil and create direct or indirect risks to life or property?	<input type="checkbox"/>	<input type="checkbox"/>	<input type="checkbox"/>	<input checked="" type="checkbox"/>	<input type="checkbox"/>
e) Have soils incapable of adequately supporting the use of septic tanks or alternative wastewater disposal systems where sewers are not available for the disposal of waste water?	<input type="checkbox"/>	<input type="checkbox"/>	<input checked="" type="checkbox"/>	<input type="checkbox"/>	<input type="checkbox"/>
f) Directly or indirectly destroy a unique paleontological resource or site or unique geologic feature?	<input type="checkbox"/>	<input type="checkbox"/>	<input checked="" type="checkbox"/>	<input type="checkbox"/>	<input type="checkbox"/>

Impact Discussion:

This project is to infill, grade, and level a reclaimed quarry in two phases over five years to allow for the planting of a 24.84-acre site for agricultural production. Phase one will consist of filling the quarry with 1/3 of the total fill material. Phase 2 will consist of filling the quarry with the remaining 2/3 of the total fill material, which will bring the site to grade. Total fill quantity at the conclusion of the project will be approximately 866,944 cubic yards of fill dirt.

The project proposes to import soil to fill an existing pit in the ground created by a reclaimed quarry, as a result the soil type brought onto site may not be consistent with the Soil Survey of San Joaquin. The Soil Survey of San Joaquin classifies the soil in the area as Capay, Stomar, and Zacharias. This is moderately well drained, and fine textured. The project site proposes to plant an orchard for agricultural production and any soil brought onto site will need to be consistent with sustaining agriculture uses.

- a) According to the California Department of Conservation's California Geological Survey, the project site is not located within an earthquake fault zone. However, like other areas located in seismically active Northern California, the project area is susceptible to strong ground shaking during an earthquake, and the site would not be affected by ground shaking more than any other area in the region. The project site is relatively flat and is not anticipated to directly or indirectly cause potential substantial adverse effects related to seismic-related ground failure or landslides. Therefore, any related impacts are anticipated to be less than significant.

- b-c) There is no development proposed with this project. In the event that a future project is proposed, a soils report will be required for grading and foundations and all recommendations from a soils report must be incorporated into the construction plans. As a result of these grading recommendations, which are required by the California Building Code (CBC), the project would not be susceptible to the effects of any loss of topsoil, soil erosion, potential lateral spreading, subsidence, or liquefaction. Additionally, the proposed project is to fill a reclaimed quarry which result in offsite soil being brought onto the property. Compliance with the CBC and the engineering recommendations in the site-specific soils report would ensure structural integrity in the event that seismic-related issues are experienced at the project site. Therefore, impacts associated with unstable geologic units are expected to be less than significant.
- d) The proposed project is located on expansive soil; The Building Department will review the required soil study and will not issue a Grading Permit if it is found the development of the site could lead to the risk of a loss of life because of the expansiveness of the soil. As a result, it can be anticipated that any risk to life would be considered less than significant.
- e) The project site is not connected to any public wastewater system and does not have any septic systems on site. At the time of development, any proposed project will be required to meet the County Standards for Wells and Wastewater. The Environmental Health Department was notified of the project on December 22, 2023. All permits related to the expansion, or the proposal of a new septic system or leach line systems will require a permit from the San Joaquin County Environmental Health Department and be required to meet the county's standards. As such, the project is expected to have a less than significant impact related to adequately supporting a wastewater system.
- f) The project area has not been determined to contain significant historic or prehistoric archeological artifacts that could be disturbed by potential future site development. The project site also does not contain any known unique geologic features. Therefore, damage to unique paleontological resources, sites or geologic features is expected to be less than significant.

Potentially Significant Impact	Less Than Significant with Mitigation Incorporated	Less Than Significant Impact	No Impact	Analyzed In The Prior EIR
--------------------------------	--	------------------------------	-----------	---------------------------

VIII. GREENHOUSE GAS EMISSIONS.

Would the project:

a) Generate greenhouse gas emissions, either directly or indirectly, that may have a significant impact on the environment?

<input type="checkbox"/>	<input type="checkbox"/>	<input checked="" type="checkbox"/>	<input type="checkbox"/>	<input type="checkbox"/>
--------------------------	--------------------------	-------------------------------------	--------------------------	--------------------------

b) Conflict with an applicable plan, policy or regulation adopted for the purpose of reducing the emissions of greenhouse gases?

<input type="checkbox"/>	<input type="checkbox"/>	<input checked="" type="checkbox"/>	<input type="checkbox"/>	<input type="checkbox"/>
--------------------------	--------------------------	-------------------------------------	--------------------------	--------------------------

Impact Discussion:

a-b) This project is to infill, grade, and level a reclaimed quarry in two phases over five years to allow for the planting of a 24.84-acre site for agricultural production. Phase one will consist of filling the quarry with 1/3 of the total fill material. Phase 2 will consist of filling the quarry with the remaining 2/3 of the total fill material, which will bring the site to grade. Total fill quantity at the conclusion of the project will be approximately 866,944 cubic yards of fill dirt.

Emissions of GHGs contributing to global climate change are attributable in large part to human activities associated with the industrial/manufacturing, utility, transportation, residential, and agricultural sectors. Therefore, the cumulative global emissions of GHGs contributing to global climate change can be attributed to every nation, region, and city, and virtually every individual on earth. An individual project's GHG emissions are at a micro-scale level relative to global emissions and effects to global climate change; however, an individual project could result in a cumulatively considerable incremental contribution to a significant cumulative macro-scale impact. As such, impacts related to emissions of GHG are inherently considered cumulative impacts.

Implementation of the project would cumulatively contribute to increases of GHG emissions. Estimated GHG emissions attributable to future development would be primarily associated with increases of carbon dioxide (CO₂) and, to a lesser extent, other GHG pollutants, such as methane (CH₄) and nitrous oxide (N₂O) associated with area sources, mobile sources or vehicles, utilities (electricity and natural gas), water usage, wastewater generation, and the generation of solid waste. The primary source of GHG emissions for the project would be mobile source emissions. The common unit of measurement for GHG is expressed in terms of annual metric tons of CO₂ equivalents (MTCO₂e/yr).

As noted previously, the project will be subject to the rules and regulations of the SJVAPCD. The SJVAPCD has adopted the *Guidance for Valley Land-use Agencies in Addressing GHG Emission Impacts for New Projects under CEQA* and the *District Policy – Addressing GHG Emission Impacts for Stationary Source Projects Under CEQA When Serving as the Lead Agency*.¹ The guidance and policy rely on the use of performance-based standards, otherwise known as Best Performance Standards (BPS) to assess significance of project specific greenhouse gas emissions on global climate change during the environmental review process, as required by CEQA. To be determined to have a less-than-significant individual and cumulative impact with regard to GHG emissions, projects must include BPS sufficient to reduce GHG emissions by 29 percent when compared to Business As Usual (BAU) GHG emissions. Per the SJVAPCD, BAU is defined as projected emissions for the 2002-2004 baseline period. Projects which do not achieve a 29 percent reduction from BAU levels with BPS alone are required to quantify additional project-specific reductions demonstrating a combined reduction of 29 percent. Potential mitigation measures may include, but not limited to: on-site renewable energy (e.g. solar photovoltaic systems), electric vehicle charging stations, the use of alternative-fueled vehicles, exceeding Title 24 energy efficiency standards, the installation of energy-efficient lighting and control systems, the installation of energy-efficient mechanical systems, the installation of drought-tolerant landscaping, efficient irrigation systems, and the use of low-flow plumbing fixtures.

It should be noted that neither the SJVAPCD nor the County provide project-level thresholds for construction-related GHG emissions. Construction GHG emissions are a one-time release and are, therefore, not typically expected to generate a significant contribution to global climate change.

¹ San Joaquin Valley Air Pollution Control District. *Guidance for Valley Land-use Agencies in Addressing GHG Emission Impacts for New Projects under CEQA*. December 17, 2009. San Joaquin Valley Air Pollution Control

Potentially Significant Impact	Less Than Significant with Mitigation Incorporated	Less Than Significant Impact	Analized No Impact	In The Prior EIR
--------------------------------	--	------------------------------	--------------------	------------------

IX. HAZARDS AND HAZARDOUS MATERIALS.

Would the project:

- | | | | | | |
|---|--------------------------|--------------------------|-------------------------------------|-------------------------------------|--------------------------|
| a) Create a significant hazard to the public or the environment through the routine transport, use, or disposal of hazardous materials? | <input type="checkbox"/> | <input type="checkbox"/> | <input checked="" type="checkbox"/> | <input type="checkbox"/> | <input type="checkbox"/> |
| b) Create a significant hazard to the public or the environment through reasonably foreseeable upset and accident conditions involving the release of hazardous materials into the environment? | <input type="checkbox"/> | <input type="checkbox"/> | <input checked="" type="checkbox"/> | <input type="checkbox"/> | <input type="checkbox"/> |
| c) Emit hazardous emissions or handle hazardous or acutely hazardous materials, substances, or waste within one-quarter mile of an existing or proposed school? | <input type="checkbox"/> | <input type="checkbox"/> | <input checked="" type="checkbox"/> | <input type="checkbox"/> | <input type="checkbox"/> |
| d) Be located on a site which is included on a list of hazardous materials sites compiled pursuant to Government Code Section 65962.5 and, as a result, would it create a significant hazard to the public or the environment? | <input type="checkbox"/> | <input type="checkbox"/> | <input type="checkbox"/> | <input checked="" type="checkbox"/> | <input type="checkbox"/> |
| e) For a project located within an airport land use plan or, where such a plan has not been adopted, within two miles of a public airport or public use airport, would the project result in a safety hazard or excessive noise for people residing or working in the project area? | <input type="checkbox"/> | <input type="checkbox"/> | <input checked="" type="checkbox"/> | <input type="checkbox"/> | <input type="checkbox"/> |
| f) Impair implementation of or physically interfere with an adopted emergency response plan or emergency evacuation plan? | <input type="checkbox"/> | <input type="checkbox"/> | <input checked="" type="checkbox"/> | <input type="checkbox"/> | <input type="checkbox"/> |
| g) Expose people or structures, either directly or indirectly, to a significant risk of loss, injury or death involving wildland fires, including where wildlands are adjacent to urbanized areas or where residences are intermixed with wildlands? | <input type="checkbox"/> | <input type="checkbox"/> | <input checked="" type="checkbox"/> | <input type="checkbox"/> | <input type="checkbox"/> |

Impact Discussion:

a-c) This project is to infill, grade, and level a reclaimed quarry in two phases over five years to allow for the planting of a 24.84-acre site for agricultural production. Phase one will consist of filling the quarry with 1/3 of the total fill material. Phase 2 will consist of filling the quarry with the remaining 2/3 of the total fill material, which will bring the site to grade. Total fill quantity at the conclusion of the project will be approximately 866,944 cubic yards of fill dirt.

Pursuant to the Hazardous Materials Disclosure Survey submitted with the application, the project is not expected to use or store hazardous materials on site; therefore, the risk of hazard due to the transportation or use of hazardous materials is expected to have no impact. Additionally, as a Condition of Approval, all imported fill shall be free of contaminants and meet the California Regional Water Quality Control Board and Department of Toxic Substances control standards before any grading.

d) The project site is not listed as a hazardous materials site on the California Department of Toxic Substances Control EnviroStor database map, compiled pursuant to Government Code 65962.5 and as noted above, does not include the use or storage of hazardous materials on-site. Therefore, the project is anticipated to have no impact on creating a significant hazard to the public or the environment.

e) The project site is located within an airport land use plan. A notice was sent to the Airport Land Use Commission and Tracy Airport Service on December 22, 2023. A comment letter was received from the Airport Land Use

Commission, which provided standards and project design conditions that comply Airport Land Use Compatibility Plan. The applicant will be required to meet these requirements as a condition of approval for the project. As a result, any impacts associated with this project are expected to be less than significant.

- f) The project does not propose any new construction, any future development of the site would be reviewed for emergency access. As a result, impacts related to the impairing implementation of or physically interfering with an adopted emergency response plan or emergency evacuation plan are anticipated to be less than significant.

- g) The project location is just east of the City of Tracy and is not identified as a Community at Risk from Wildfire by Cal Fire's "Fire Risk Assessment Program". Communities at Risk from Wildfire are those places within 1.5 miles of areas of High or Very High wildfire threat as determined from CDF-FRAP fuels and hazard data. Therefore, the impact of wildfires on the project site, including people or structures, is expected to be less than significant.

X. HYDROLOGY AND WATER QUALITY.

Would the project:

	Potentially Significant Impact	Less Than Significant with Mitigation Incorporated	Less Than Significant Impact	No Impact	Analyzed In The Prior EIR
a) Violate any water quality standards or waste discharge requirements or otherwise substantially degrade surface or ground water quality?	<input type="checkbox"/>	<input type="checkbox"/>	<input checked="" type="checkbox"/>	<input type="checkbox"/>	<input type="checkbox"/>
b) Substantially decrease groundwater supplies or interfere substantially with groundwater recharge such that the project may impede sustainable groundwater management of the basin?	<input type="checkbox"/>	<input type="checkbox"/>	<input checked="" type="checkbox"/>	<input type="checkbox"/>	<input type="checkbox"/>
c) Substantially alter the existing drainage pattern of the site or area, including through the alteration of the course of a stream or river or through the addition of impervious surfaces, in a manner which would:	<input type="checkbox"/>	<input type="checkbox"/>	<input checked="" type="checkbox"/>	<input type="checkbox"/>	<input type="checkbox"/>
i) result in substantial erosion or siltation on- or off-site.	<input type="checkbox"/>	<input type="checkbox"/>	<input checked="" type="checkbox"/>	<input type="checkbox"/>	<input type="checkbox"/>
ii) substantially increase the rate or amount of surface runoff in a manner which would result in flooding on- or off-site.	<input type="checkbox"/>	<input type="checkbox"/>	<input checked="" type="checkbox"/>	<input type="checkbox"/>	<input type="checkbox"/>
iii) create or contribute runoff water which would exceed the capacity of existing or planned stormwater drainage systems or provide substantial additional sources of polluted runoff; or	<input type="checkbox"/>	<input type="checkbox"/>	<input checked="" type="checkbox"/>	<input type="checkbox"/>	<input type="checkbox"/>
iv) impede or redirect flood flows?	<input type="checkbox"/>	<input type="checkbox"/>	<input checked="" type="checkbox"/>	<input type="checkbox"/>	<input type="checkbox"/>
d) In flood hazard, tsunami, or seiche zones, risk release of pollutants due to project inundation?	<input type="checkbox"/>	<input type="checkbox"/>	<input checked="" type="checkbox"/>	<input type="checkbox"/>	<input type="checkbox"/>
e) Conflict with or obstruct implementation of a water quality control plan or sustainable groundwater management plan?	<input type="checkbox"/>	<input type="checkbox"/>	<input checked="" type="checkbox"/>	<input type="checkbox"/>	<input type="checkbox"/>

Impact Discussion:

- a-b,e) This project is to infill, grade, and level a reclaimed quarry in two phases over five years to allow for the planting of a 24.84-acre site for agricultural production. Phase one will consist of filling the quarry with 1/3 of the total fill material. Phase 2 will consist of filling the quarry with the remaining 2/3 of the total fill material, which will bring the site to grade. Total fill quantity at the conclusion of the project will be approximately 866,944 cubic yards of fill dirt.
- c) The project site is not located within 2 miles of a natural stream or river. Therefore, the project is expected to have a less than significant impact on the drainage pattern of the site.
- d) The project site is located within a Federal Emergency Management Agency Designated Flood Hazard Area Zone X, level protected and a 0.2 percent annual chance of flood designation. The project site is not located within a tsunami or seiche zone. A referral was sent to the Department of Public Works, Flood Control Division on December 22, 2023, for comments. No recommendations regarding flooding were provided. As a result, impacts related to flooding are anticipated to be less than significant.

	Potentially Significant Impact	Less Than Significant with Mitigation Incorporated	Less Than Significant Impact	No Impact	Analyzed In The Prior EIR
--	--------------------------------	--	------------------------------	-----------	---------------------------

XI. LAND USE AND PLANNING.

Would the project:

- | | | | | | |
|--|--------------------------|--------------------------|-------------------------------------|-------------------------------------|--------------------------|
| a) Physically divide an established community? | <input type="checkbox"/> | <input type="checkbox"/> | <input type="checkbox"/> | <input checked="" type="checkbox"/> | <input type="checkbox"/> |
| b) Cause a significant environmental impact due to a conflict with any land use plan, policy, or regulation adopted for the purpose of avoiding or mitigating an environmental effect? | <input type="checkbox"/> | <input type="checkbox"/> | <input checked="" type="checkbox"/> | <input type="checkbox"/> | <input type="checkbox"/> |

Impact Discussion:

- a-b) This project is to infill, grade, and level a reclaimed quarry in two phases over five years to allow for the planting of a 24.84-acre site for agricultural production. Phase one will consist of filling the quarry with 1/3 of the total fill material. Phase 2 will consist of filling the quarry with the remaining 2/3 of the total fill material, which will bring the site to grade. Total fill quantity at the conclusion of the project will be approximately 866,944 cubic yards of fill dirt.

The nearest residence is located approximately 2,800 feet north of the project site in a residential neighborhood north of West Linne Road within the City of Tracy. The proposed project is anticipated to have a less than significant impact to surrounding parcels and will not create premature development pressure on surrounding agricultural lands to convert land from agricultural uses to nonagricultural uses. Alternatively, the project will create 131.58 acres of productive agriculture land. If the Administrative Use Permit is approved, the proposed project will not be in conflict with any Master Plans, Specific Plans, or Special Purpose Plans, or any other applicable plan adopted by the County. Therefore, this project is not a growth-inducing action. The proposed project will not set a significant land use precedent and is consistent with all applicable plans adopted by the County.

Potentially Significant Impact	Less Than Significant with Mitigation Incorporated	Less Than Significant Impact	No Impact	Analyzed In The Prior EIR
--------------------------------------	---	------------------------------------	--------------	---------------------------------

XII. MINERAL RESOURCES.

Would the project:

- | | | | | | |
|--|--------------------------|--------------------------|--------------------------|-------------------------------------|--------------------------|
| a) Result in the loss of availability of a known mineral resource that would be of value to the region and the residents of the state? | <input type="checkbox"/> | <input type="checkbox"/> | <input type="checkbox"/> | <input checked="" type="checkbox"/> | <input type="checkbox"/> |
| b) Result in the loss of availability of a locally- important mineral resource recovery site delineated on a local general plan, specific plan or other land use plan? | <input type="checkbox"/> | <input type="checkbox"/> | <input type="checkbox"/> | <input checked="" type="checkbox"/> | <input type="checkbox"/> |

Impact Discussion:

- a-b) This project is to infill, grade, and level a reclaimed quarry in two phases over five years to allow for the planting of a 24.84-acre site for agricultural production. Phase one will consist of filling the quarry with 1/3 of the total fill material. Phase 2 will consist of filling the quarry with the remaining 2/3 of the total fill material, which will bring the site to grade. Total fill quantity at the conclusion of the project will be approximately 866,944 cubic yards of fill dirt.

The proposed project will not result in the loss of availability of a known mineral resource of a resource recovery site because the site does not contain minerals of significance or known mineral resources. San Joaquin County applies a mineral resource zone (MRZ) designation to land that meets the significant mineral deposits definition by the State Division of Mines and Geology. The project site is in the MRZ-1 zone, but no mining is proposed. Additionally, there currently is no mining activity in the area, and the surrounding area is developed with agricultural uses with scattered residences, commercial uses, and residential uses. Therefore, the proposed project will have less than a significant impact on the availability of mineral resources or mineral resource recovery sites within San Joaquin County.

Potentially Significant Impact	Less Than Significant with Mitigation Incorporated	Less Than Significant Impact	No Impact	Analyzed In The Prior EIR
--------------------------------------	---	------------------------------------	--------------	---------------------------------

XIII. NOISE.

Would the project result in:

- | | | | | | |
|---|--------------------------|--------------------------|--------------------------|-------------------------------------|--------------------------|
| a) Generation of a substantial temporary or permanent increase in ambient noise levels in the vicinity of the project in excess of standards established in the local general plan or noise ordinance, or applicable standards of other agencies? | <input type="checkbox"/> | <input type="checkbox"/> | <input type="checkbox"/> | <input checked="" type="checkbox"/> | <input type="checkbox"/> |
| b) Generation of excessive ground borne vibration or ground borne noise levels? | <input type="checkbox"/> | <input type="checkbox"/> | <input type="checkbox"/> | <input checked="" type="checkbox"/> | <input type="checkbox"/> |
| c) For a project within the vicinity of a private airstrip or an airport land use plan, or where such a plan has not been adopted, within two miles of a public airport or public use airport, would the project expose people residing or working in the project area to excessive noise levels? | <input type="checkbox"/> | <input type="checkbox"/> | <input type="checkbox"/> | <input checked="" type="checkbox"/> | <input type="checkbox"/> |

Impact Discussion:

- a-b) This project is to infill, grade, and level a reclaimed quarry in two phases over five years to allow for the planting of a 24.84-acre site for agricultural production. Phase one will consist of filling the quarry with 1/3 of the total fill material. Phase 2 will consist of filling the quarry with the remaining 2/3 of the total fill material, which will bring the site to grade. Total fill quantity at the conclusion of the project will be approximately 866,944 cubic yards of fill dirt.
- c) The project is located within two miles of a public airport, airport land use plan or private air strip. There is no proposed development with the project and the anticipated end use for the site is for agricultural production. As a result, there are no anticipated impacts related to excessive noise levels in relation to people residing or working in the project area.

Potentially Significant Impact	Less Than Significant with Mitigation Incorporated	Less Than Significant Impact	No Impact	Analyzed In The Prior EIR
--------------------------------------	---	------------------------------------	--------------	---------------------------------

XIV. POPULATION AND HOUSING.

Would the project:

- | | | | | | |
|---|--------------------------|--------------------------|--------------------------|-------------------------------------|--------------------------|
| a) Induce substantial unplanned population growth in an area, either directly (for example, by proposing new homes and businesses) or indirectly (for example, through extension of roads or other infrastructure)? | <input type="checkbox"/> | <input type="checkbox"/> | <input type="checkbox"/> | <input checked="" type="checkbox"/> | <input type="checkbox"/> |
| b) Displace substantial numbers of existing people or housing, necessitating the construction of replacement housing elsewhere? | <input type="checkbox"/> | <input type="checkbox"/> | <input type="checkbox"/> | <input checked="" type="checkbox"/> | <input type="checkbox"/> |

Impact Discussion:

- a-b) This project is to infill, grade, and level a reclaimed quarry in two phases over five years to allow for the planting of a 24.84-acre site for agricultural production. Phase one will consist of filling the quarry with 1/3 of the total fill material. Phase 2 will consist of filling the quarry with the remaining 2/3 of the total fill material, which will bring the site to grade. Total fill quantity at the conclusion of the project will be approximately 866,944 cubic yards of fill dirt.

As there is no proposed development with application there will be no increase in housing availability and the area is not planned for future residential development. The project will remain in agriculture use and is proposed to be farmed after to site is brought to grade. Therefore, the proposed project will not result in unplanned population growth. The proposed project will not alter the location distribution, density, or growth rate of the human population in the area. As a result, the project's impact on population and housing should have no impact.

Potentially Significant Impact	Less Than Significant with Mitigation Incorporated	Less Than Significant Impact	No Impact	Analyzed In The Prior EIR
--------------------------------------	---	------------------------------------	--------------	---------------------------------

XV. PUBLIC SERVICES.

a) Would the project result in substantial adverse physical impacts associated with the provision of new or physically altered governmental facilities, need for new or physically altered governmental facilities, the construction of which could cause significant environmental impacts, in order to maintain acceptable service ratios, response times or other performance objectives for any of the public services:

Fire protection?	<input type="checkbox"/>	<input type="checkbox"/>	<input checked="" type="checkbox"/>	<input type="checkbox"/>	<input type="checkbox"/>
Police protection?	<input type="checkbox"/>	<input type="checkbox"/>	<input checked="" type="checkbox"/>	<input type="checkbox"/>	<input type="checkbox"/>
Schools?	<input type="checkbox"/>	<input type="checkbox"/>	<input checked="" type="checkbox"/>	<input type="checkbox"/>	<input type="checkbox"/>
Parks?	<input type="checkbox"/>	<input type="checkbox"/>	<input checked="" type="checkbox"/>	<input type="checkbox"/>	<input type="checkbox"/>
Other public facilities?	<input type="checkbox"/>	<input type="checkbox"/>	<input checked="" type="checkbox"/>	<input type="checkbox"/>	<input type="checkbox"/>

Impact Discussion:

- a) This project is to infill, grade, and level a reclaimed quarry in two phases over five years to allow for the planting of a 24.84-acre site for agricultural production. Phase one will consist of filling the quarry with 1/3 of the total fill material. Phase 2 will consist of filling the quarry with the remaining 2/3 of the total fill material, which will bring the site to grade. Total fill quantity at the conclusion of the project will be approximately 866,944 cubic yards of fill dirt.

The project site is within the Tracy-Rural Fire District and is served by the San Joaquin County Sheriff's Office for police protection. A referral was sent to both agencies on December 22, 2023, and no responses were received. The proposed project will not result in substantial adverse physical impacts to existing service ratios, response times or other performance objectives for fire protection or police protection. The site is also within the Tracy Unified School District and the nearest County Park is American Legion Airport Park. No additional park area is required as a result of the proposed project. Therefore, the proposed project is anticipated to have a less than significant impact on public services.

	Potentially Significant Impact	Less Than Significant with Mitigation Incorporated	Less Than Significant Impact	No Impact	Analyzed In The Prior EIR
--	--------------------------------	--	------------------------------	-----------	---------------------------

XVI. RECREATION.

a) Would the project increase the use of existing neighborhood and regional parks or other recreational facilities such that substantial physical deterioration of the facility would occur or be accelerated?

<input type="checkbox"/>	<input type="checkbox"/>	<input type="checkbox"/>	<input checked="" type="checkbox"/>	<input type="checkbox"/>
--------------------------	--------------------------	--------------------------	-------------------------------------	--------------------------

b) Does the project include recreational facilities or require the construction or expansion of recreational facilities which might have an adverse physical effect on the environment?

<input type="checkbox"/>	<input type="checkbox"/>	<input type="checkbox"/>	<input checked="" type="checkbox"/>	<input type="checkbox"/>
--------------------------	--------------------------	--------------------------	-------------------------------------	--------------------------

Impact Discussion:

a-b) This project is to infill, grade, and level a reclaimed quarry in two phases over five years to allow for the planting of a 24.84-acre site for agricultural production. Phase one will consist of filling the quarry with 1/3 of the total fill material. Phase 2 will consist of filling the quarry with the remaining 2/3 of the total fill material, which will bring the site to grade. Total fill quantity at the conclusion of the project will be approximately 866,944 cubic yards of fill dirt.

As there is no proposed development associated with this project and the end use for the site is for agricultural production there are no impacts anticipated on recreation facilities.

	Potentially Significant Impact	Less Than Significant with Mitigation Incorporated	Less Than Significant Impact	No Impact	Analyzed In The Prior EIR
--	--------------------------------	--	------------------------------	-----------	---------------------------

XVII. TRANSPORTATION.

Would the project:

- | | | | | | |
|--|--------------------------|--------------------------|-------------------------------------|-------------------------------------|--------------------------|
| a) Conflict with a program plan, ordinance, or policy addressing the circulation system, including transit, roadways, bicycle, and pedestrian facilities? | <input type="checkbox"/> | <input type="checkbox"/> | <input checked="" type="checkbox"/> | <input type="checkbox"/> | <input type="checkbox"/> |
| b) Would the project conflict or be inconsistent with CEQA Guidelines section 15064.3, subdivision (b)? | <input type="checkbox"/> | <input type="checkbox"/> | <input checked="" type="checkbox"/> | <input type="checkbox"/> | <input type="checkbox"/> |
| c) Substantially increase hazards due to a geometric design feature (e.g., sharp curves or dangerous intersections) or incompatible uses (e.g., farm equipment)? | <input type="checkbox"/> | <input type="checkbox"/> | <input type="checkbox"/> | <input checked="" type="checkbox"/> | <input type="checkbox"/> |
| d) Result in inadequate emergency access? | <input type="checkbox"/> | <input type="checkbox"/> | <input type="checkbox"/> | <input checked="" type="checkbox"/> | <input type="checkbox"/> |

Impact Discussion:

- a-d) This project is to infill, grade, and level a reclaimed quarry in two phases over five years to allow for the planting of a 24.84-acre site for agricultural production. Phase one will consist of filling the quarry with 1/3 of the total fill material. Phase 2 will consist of filling the quarry with the remaining 2/3 of the total fill material, which will bring the site to grade. Total fill quantity at the conclusion of the project will be approximately 866,944 cubic yards of fill dirt. The proposed project anticipates 28 truck trips per day to bring fill dirt into the site.

A referral was sent to the Department Public Works December 22, 2023. In the review of the project, San Joaquin County determined the project will generate less than 110 automobile trips per day and, therefore, is considered a small project according to the Technical Advisory on Evaluating Transportation Impacts in CEQA, as published by the California Office of Planning and Research (OPR) in December 2018. According to this OPR guidance, a small project that generates or attracts "fewer than 110 trips per day generally may be assumed to cause a less-than-significant transportation impact" with regards to VMT. Therefore, this project is anticipated to have a less than significant impact on traffic.

The project is not expected to conflict with any program plans, ordinances, or policies addressing the vehicle circulation system. The road serving the subdivision is required to meet San Joaquin County roadway standards and will require an encroachment Permits from the County. As a result, proposed project will have adequate emergency access.

Potentially Significant Impact	Less Than Significant with Mitigation Incorporated	Less Than Significant Impact	No Impact	Analyzed In The Prior EIR
--------------------------------------	---	------------------------------------	--------------	---------------------------------

XVIII. TRIBAL CULTURAL RESOURCES.

a) Would the project cause a substantial adverse change in the significance of a tribal cultural resource, defined in Public Resources Code section 21074 as either a site, feature, place, cultural landscape that is geographically defined in terms of the size and scope of the landscape, sacred place, or object with cultural value to a California Native American tribe, and that is:

- | | | | | | |
|--|--------------------------|--------------------------|--------------------------|-------------------------------------|--------------------------|
| i) Listed or eligible for listing in the California Register of Historical Resources, or in a local register of historical resources as defined in Public Resources Code section 5020.1(k), or | <input type="checkbox"/> | <input type="checkbox"/> | <input type="checkbox"/> | <input checked="" type="checkbox"/> | <input type="checkbox"/> |
| ii) A resource determined by the lead agency, in its discretion and supported by substantial evidence, to be significant pursuant to criteria set forth in subdivision (c) of Public Resources Code Section 5024.1. In applying the criteria set forth in subdivision (c) of Public Resource Code Section 5024.1, the lead agency shall consider the significance of the resource to a California Native American tribe. | <input type="checkbox"/> | <input type="checkbox"/> | <input type="checkbox"/> | <input checked="" type="checkbox"/> | <input type="checkbox"/> |

Impact Discussion:

a) This project is to infill, grade, and level a reclaimed quarry in two phases over five years to allow for the planting of a 24.84-acre site for agricultural production. Phase one will consist of filling the quarry with 1/3 of the total fill material. Phase 2 will consist of filling the quarry with the remaining 2/3 of the total fill material, which will bring the site to grade. Total fill quantity at the conclusion of the project will be approximately 866,944 cubic yards of fill dirt.

On December 22, 2023, referrals were sent to United Auburn Indian Community, California Valley Miwok Tribe, California Tribal TANF Partnership, North Valley Yokuts Tribe, and Buena Vista Rancheria for review. If human burials found to be of Native American origin are encountered at the time of development all work shall halt in the vicinity and the County Coroner shall be notified immediately. At the same time, a qualified archaeologist shall be contacted to evaluate the find. The developer shall follow the procedures pursuant to Title 14, Division 6, Chapter 3, Article 5, Section 15064.5(e) of the California State Code of Regulations.

Potentially Significant Impact	Less Than Significant with Mitigation Incorporated	Less Than Significant Impact	No Impact	Analyzed In The Prior EIR
--------------------------------------	---	------------------------------------	--------------	---------------------------------

XIX. UTILITIES AND SERVICE SYSTEMS.

Would the project:

- | | | | | | |
|---|--------------------------|--------------------------|-------------------------------------|-------------------------------------|--------------------------|
| a) Require or result in the relocation or construction of new or expanded water, wastewater treatment, or storm water drainage, electric power, natural gas, or telecommunications facilities, the construction or relocation of which could cause significant environmental effects? | <input type="checkbox"/> | <input type="checkbox"/> | <input type="checkbox"/> | <input checked="" type="checkbox"/> | <input type="checkbox"/> |
| b) Have sufficient water supplies available to serve the project and reasonably foreseeable future development during normal, dry and multiple dry years? | <input type="checkbox"/> | <input type="checkbox"/> | <input checked="" type="checkbox"/> | <input type="checkbox"/> | <input type="checkbox"/> |
| c) Result in a determination by the wastewater treatment provider, which serves or may serve the project that it has adequate capacity to serve the project's projected demand in addition to the provider's existing commitments? | <input type="checkbox"/> | <input type="checkbox"/> | <input type="checkbox"/> | <input checked="" type="checkbox"/> | <input type="checkbox"/> |
| d) Generate solid waste in excess of State or local standards, or in excess of the capacity of local infrastructure, or otherwise impair the attainment of solid waste reduction goals? | <input type="checkbox"/> | <input type="checkbox"/> | <input type="checkbox"/> | <input checked="" type="checkbox"/> | <input type="checkbox"/> |
| e) Comply with federal, state, and local management and reduction statutes and regulations related to solid waste? | <input type="checkbox"/> | <input type="checkbox"/> | <input checked="" type="checkbox"/> | <input type="checkbox"/> | <input type="checkbox"/> |

Impact Discussion:

- a-e) This project is to infill, grade, and level a reclaimed quarry in two phases over five years to allow for the planting of a 24.84-acre site for agricultural production. Phase one will consist of filling the quarry with 1/3 of the total fill material. Phase 2 will consist of filling the quarry with the remaining 2/3 of the total fill material, which will bring the site to grade. Total fill quantity at the conclusion of the project will be approximately 866,944 cubic yards of fill dirt.

The is no proposed development of the site associated with this project. In the event the applicant proposes a septic or water system, it will be reviewed and be required to meet the standards of the Environmental Health Department. Additionally, the project site proposes natural storm drainage, which will be reviewed by the Department of Public Works at the time of a building or grading permit. Therefore, the impact on public services will be less than significant.

Potentially Significant Impact	Less Than Significant with Mitigation Incorporated	Less Than Significant Impact	No Impact	Analyzed In The Prior EIR
--------------------------------	--	------------------------------	-----------	---------------------------

XX. WILDFIRE.

If located in or near state responsibility areas or lands classified as very high fire hazard severity zones, would the project:

- | | | | | | |
|--|--------------------------|--------------------------|--------------------------|-------------------------------------|--------------------------|
| a) Substantially impair an adopted emergency response plan or emergency evacuation plan? | <input type="checkbox"/> | <input type="checkbox"/> | <input type="checkbox"/> | <input checked="" type="checkbox"/> | <input type="checkbox"/> |
| b) Due to slope, prevailing winds, and other factors, exacerbate wildfire risks, and thereby expose project occupants to pollutant concentrations from a wildfire or the uncontrolled spread of a wildfire? | <input type="checkbox"/> | <input type="checkbox"/> | <input type="checkbox"/> | <input checked="" type="checkbox"/> | <input type="checkbox"/> |
| c) Require the installation or maintenance of associated infrastructure (such as roads, fuel breaks, emergency water sources, power lines or other utilities) that may exacerbate fire risk or that may result in temporary or ongoing impacts to the environment? | <input type="checkbox"/> | <input type="checkbox"/> | <input type="checkbox"/> | <input checked="" type="checkbox"/> | <input type="checkbox"/> |
| d) Expose people or structures to significant risks, including downslope or downstream flooding or landslides, as a result of runoff, post-fire slope instability, or drainage changes? | <input type="checkbox"/> | <input type="checkbox"/> | <input type="checkbox"/> | <input checked="" type="checkbox"/> | <input type="checkbox"/> |

Impact Discussion:

- a-d) This project is to infill, grade, and level a reclaimed quarry in two phases over five years to allow for the planting of a 24.84-acre site for agricultural production. Phase one will consist of filling the quarry with 1/3 of the total fill material. Phase 2 will consist of filling the quarry with the remaining 2/3 of the total fill material, which will bring the site to grade. Total fill quantity at the conclusion of the project will be approximately 866,944 cubic yards of fill dirt.

The project location is just outside the City of Tracy and is not identified as a Community at Risk from Wildfire by Cal Fire's "Fire Risk Assessment Program". Communities at Risk from Wildfire are those places within 1.5 miles of areas of High or Very High wildfire threat as determined from CDF-FRAP fuels and hazard data. Therefore, no impact related to wildfires are anticipated.

Potentially Significant Impact	Less Than Significant with Mitigation Incorporated	Less Than Significant Impact	No Impact	Analyzed In The Prior EIR
--------------------------------------	---	------------------------------------	--------------	---------------------------------

XXI. MANDATORY FINDINGS OF SIGNIFICANCE

a) Does the project have the potential to substantially degrade the quality of the environment, substantially reduce the habitat of a fish or wildlife species, cause a fish or wildlife population to drop below self-sustaining levels, threaten to eliminate a plant or animal community, substantially reduce the number or restrict the range of a rare or endangered plant or animal or eliminate important examples of the major periods of California history or prehistory?

<input type="checkbox"/>	<input type="checkbox"/>	<input checked="" type="checkbox"/>	<input type="checkbox"/>	<input type="checkbox"/>
--------------------------	--------------------------	-------------------------------------	--------------------------	--------------------------

b) Does the project have impacts that are individually limited, but cumulatively considerable? ("Cumulatively considerable" means that the incremental effects of a project are considerable when viewed in connection with the effects of past projects, the effects of other current projects, and the effects of probable future projects)?

<input type="checkbox"/>	<input type="checkbox"/>	<input checked="" type="checkbox"/>	<input type="checkbox"/>	<input type="checkbox"/>
--------------------------	--------------------------	-------------------------------------	--------------------------	--------------------------

c) Does the project have environmental effects which will cause substantial adverse effects on human beings, either directly or indirectly?

<input type="checkbox"/>	<input type="checkbox"/>	<input checked="" type="checkbox"/>	<input type="checkbox"/>	<input type="checkbox"/>
--------------------------	--------------------------	-------------------------------------	--------------------------	--------------------------

Impact Discussion:

a-c) Review of this project has not indicated any features which might significantly impact the environmental quality of the site and/or surrounding area. Mitigation measures have been identified in areas where a potentially significant impact has been identified and these measures, included as conditions of approval, will reduce these impacts to a less than significant level.

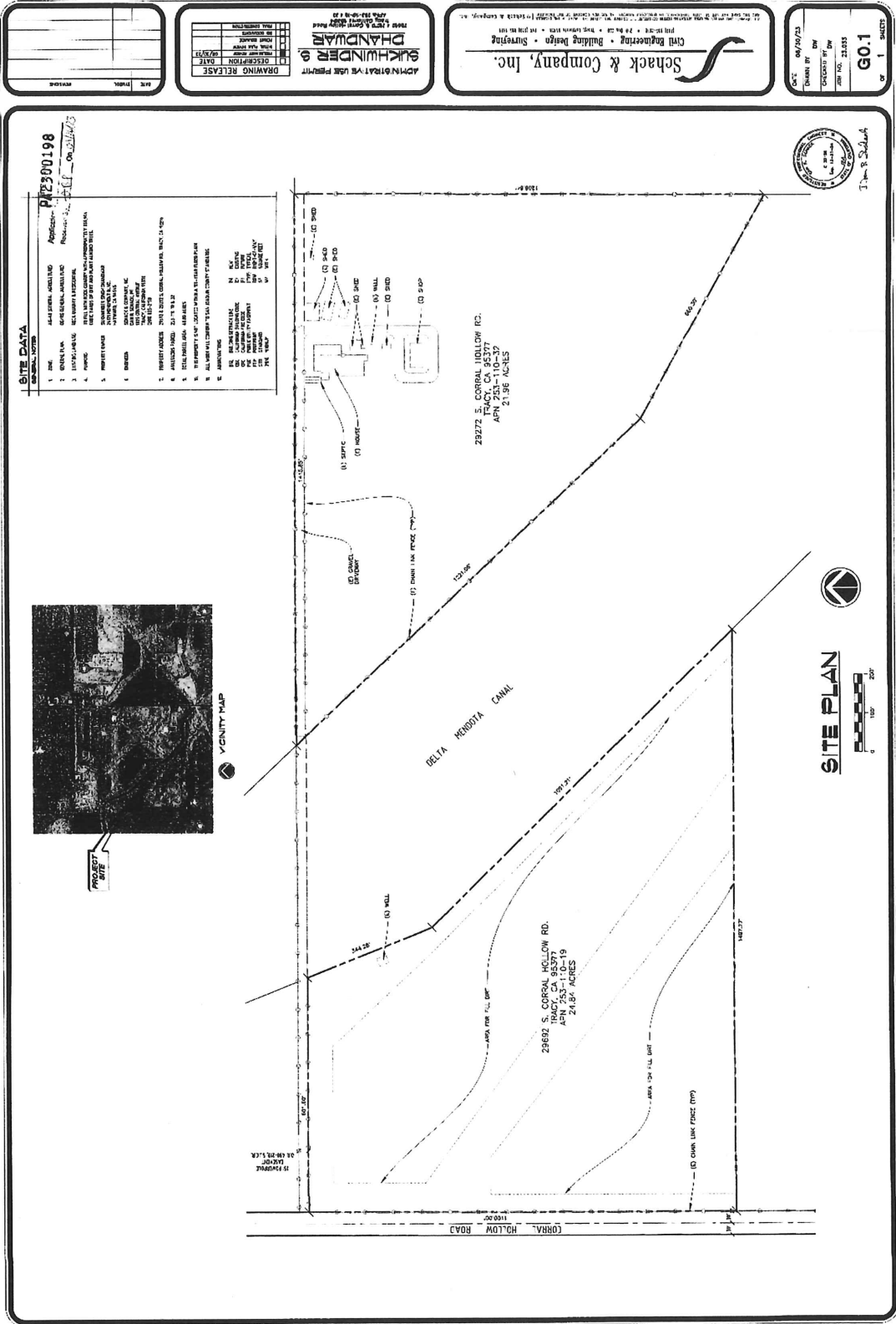

Date: March 30, 2024

Impact	Mitigation Measure/Condition	Type of Review		Agency for Monitoring and Reporting Compliance	Action Indicating Compliance or Review	Verification of Compliance or Annual Review of Conditions		Remarks
		Monitoring	Reporting			By	Date	
IV. Biological Resources	Participation in the SJMSCP	X		San Joaquin Council of Governments	Certificate of Payment and Signed ITMM			