

## NOTICE OF EXEMPTION

<p>TO:    <input checked="" type="checkbox"/> Office of Planning and Research                    P.O. Box 3044, Room 113                    Sacramento, CA 95812-3044</p> <p>          <input checked="" type="checkbox"/> County Clerk/Registrar-Recorder                    Los Angeles County                    12400 E. Imperial Highway, Rm 201</p>	<p>FROM:    City of Hermosa Beach                    1315 Valley Dr.                    Hermosa Beach, CA 90254</p>
---	---

1. Project Title:	CIP 421 Sewer Improvement – Phase 2
2. Project Location – County	Los Angeles
3. Project Location – City	Hermosa Beach
4. Project Location - Vicinity Map	See Attachment 1.
5. Description of Nature, Purpose, and Beneficiaries of Project	The project consists of the removal and replacement of approximately 4,870 linear feet of sewer, the removal and replacement of eight (8) maintenance holes, and the rehabilitation of 69 other maintenance holes. The project’s beneficiaries include the City’s sewer rate payers who will the benefit from the sewer being placed in a state of good repair, the City at large who will benefit from a safe and robust sewer system that will not collapse or surcharge, and the environment which will be less likely to experience sewage spill occurrences.
6. Name of Public Agency Approving Project	City of Hermosa Beach
7. Name of Person or Agency Carrying Out Project	City of Hermosa Beach
8. Exempt Status: (check one)	
(a) <input type="checkbox"/> Ministerial project	
(b) <input type="checkbox"/> Not a project.	
(c) <input type="checkbox"/> Emergency Project	
(d) <input checked="" type="checkbox"/> Categorical Exemption State type and class number	Section 15302 (Replacement or Reconstruction), Class 2.
(e) <input type="checkbox"/> Declared Emergency	
(f) <input type="checkbox"/> Statutory Exemption. State code section number:	
(g) <input type="checkbox"/> Other. Explanation:	
9. Reason Why Project Is Exempt:	The proposed work consists of replacement or reconstruction of existing structures and facilities where the new structure will be located on the same site as the structure

	replaced and will have substantially the same purpose and capacity as the structure replaced including but not limited to the replacement or reconstruction of existing utility systems and/or facilities involving negligible or no expansion of capacity.
10. Contact Person:	Brandon Araujo, Senior Engineer
Telephone:	310-318-0262

If filed by Applicant:

1. Attach certified document of exemption finding.
2. Has a Notice of Exemption been filed by the public agency approving the project?  
 YES       NO

Signature: \_\_\_\_\_ Date: 7/15/2024 Title: Senior Engineer

<b>County Clerk/Registrar-Recorder</b>	<b>Office of Planning and Research</b>
Date Received for Filing:  _____	Date Received for Filing:  _____
(Clerk Stamp Here)	

## CERTIFICATE OF DETERMINATION

1. Project Title:	CIP 421 Sewer Improvement – Phase 2
2. Project Location	See Attachment 1.
3. Project Description	The project consists of the removal and replacement of approximately 4,870 linear feet of sewer, the removal and replacement of eight (8) maintenance holes, and the rehabilitation of 69 other maintenance holes. The project’s beneficiaries include the City’s sewer rate payers who will the benefit from the sewer being placed in a state of good repair, the City at large who will benefit from a safe and robust sewer system that will not collapse or surcharge, and the environment which will be less likely to experience sewage spill occurrences.
4. Name of Public Agency Approving Project	City of Hermosa Beach
5. Name of Person or Agency Carrying Out Project	City of Hermosa Beach
6. Staff Determination: The Lead Agency’s staff, having undertaken and completed a preliminary review of this project in accordance with the 2024 California Environmental Quality Act Statute & Guidelines, has concluded that this project does not require further environmental assessment because:	
(a) <input type="checkbox"/> The proposed action does not constitute a project under CEQA.	
(b) <input type="checkbox"/> The project is a Ministerial project	
(c) <input type="checkbox"/> The project is an Emergency Project.	
(d) <input checked="" type="checkbox"/> The project is categorically exempt. Section 15302 (Replacement or Reconstruction), Class 2.	
<input type="checkbox"/> The project is statutorily exempt.	
<input type="checkbox"/> Other. Explanation:	
7. Contact Person:	Brandon Araujo, Senior Engineer
Telephone:	310-318-0262

7/15/2024

Signature: \_\_\_\_\_

Date: \_\_\_\_\_

**ATTACHMENT 1**

M:\2\HERO30503\WATERS\TASKS\FINAL DESIGN\SHEETS\G-04.dwg 12/22/23 - 10:04am ben.halbach

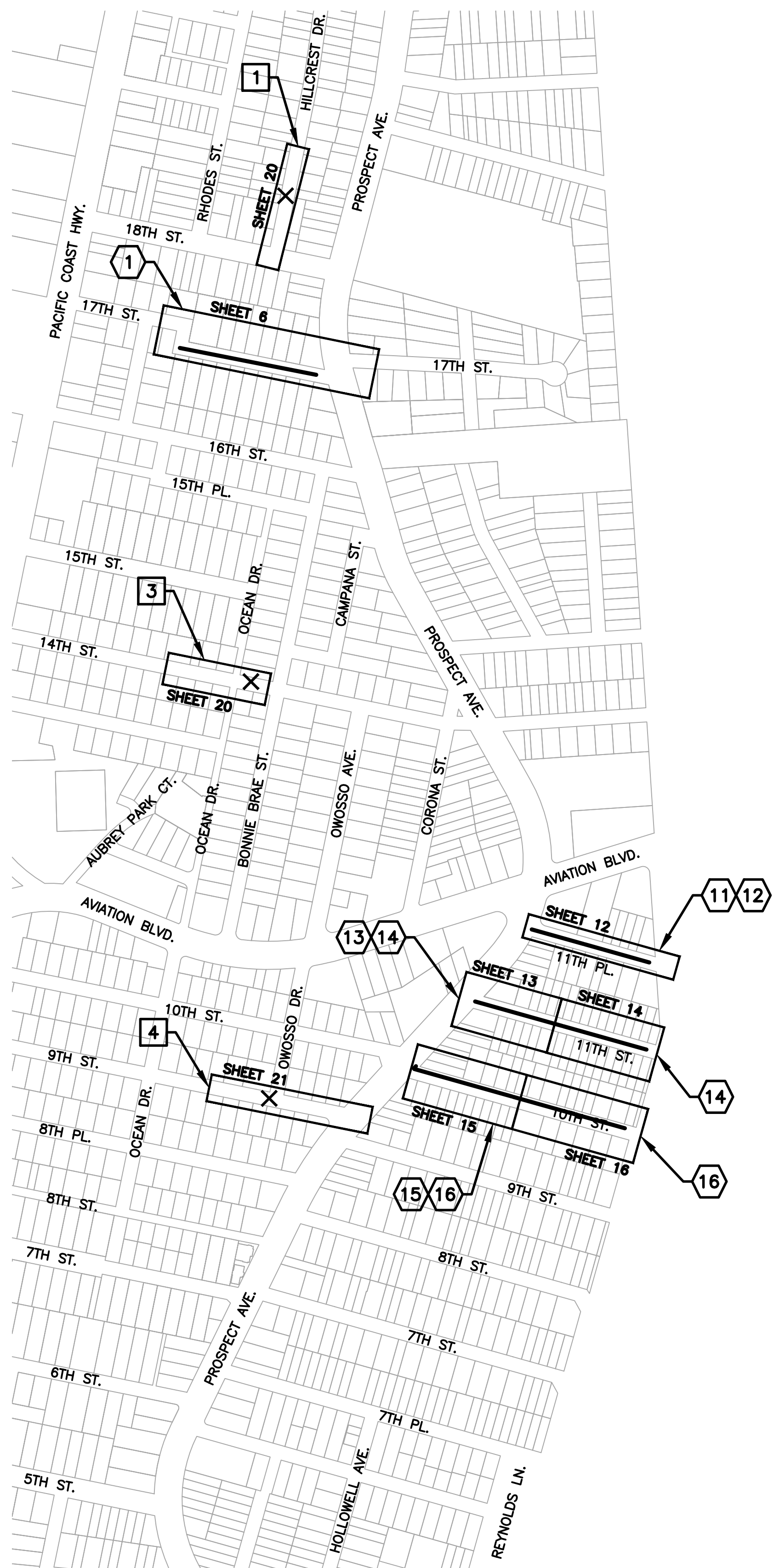

INDEX MAP A - AREAS 1 & 2

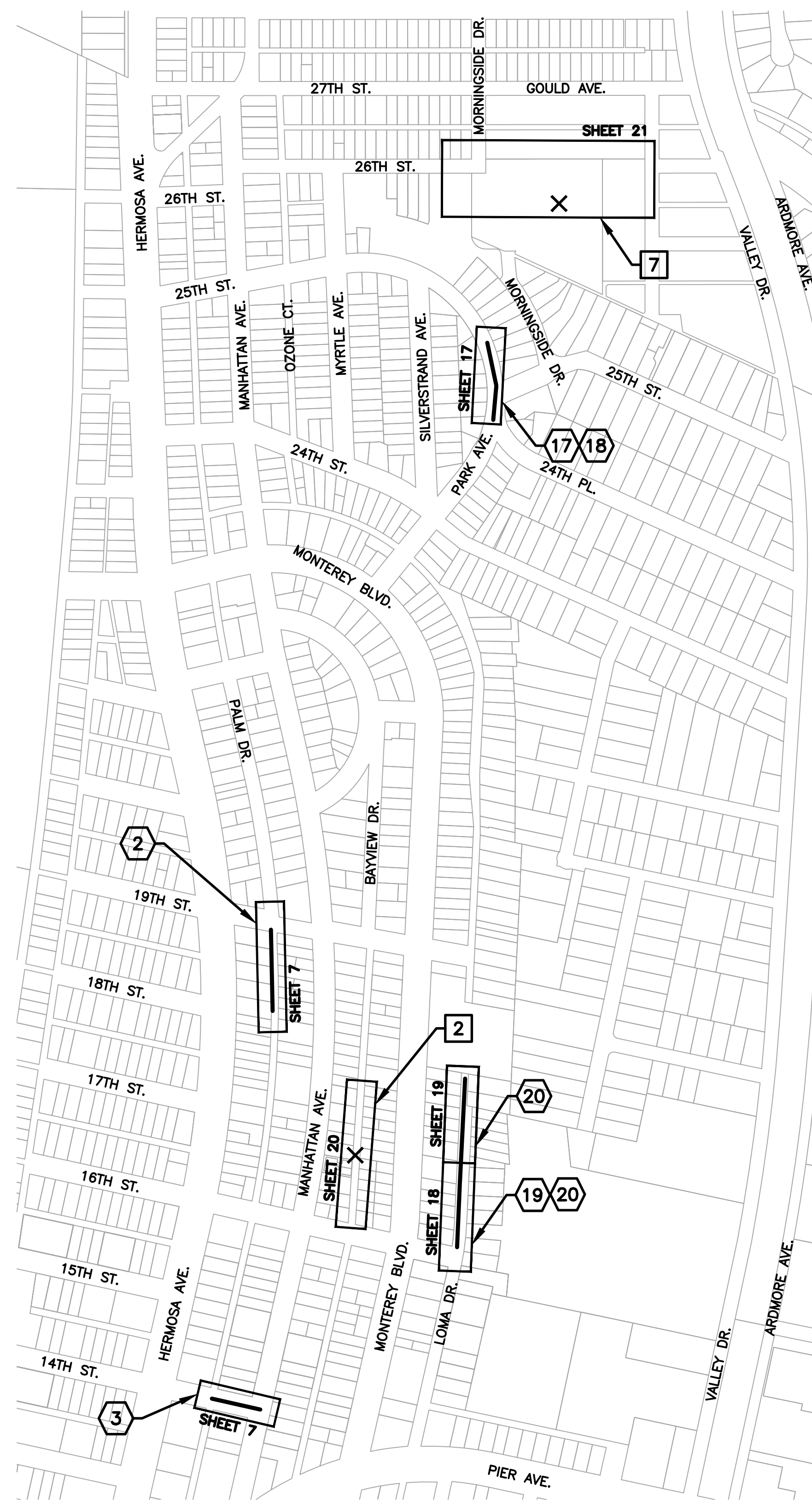

INDEX MAP B - AREAS 3, 4, & 6



INDEX MAP C - AREAS 5 & 6

**INDEX SHEET LEGEND**

- X POINT REPAIR (PIPE REPLACEMENT)
- 1 POINT REPAIR (PIPE REPLACEMENT)
- 1 REMOVE AND REPLACE



0 75 150  
SCALE: 1" = 75'

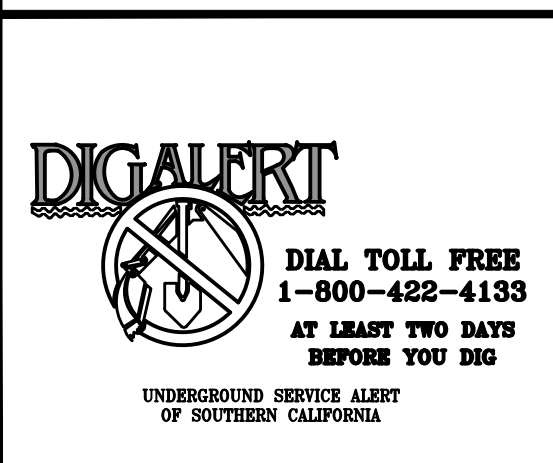

REVISIONS		
No.	DESCRIPTION	DATE

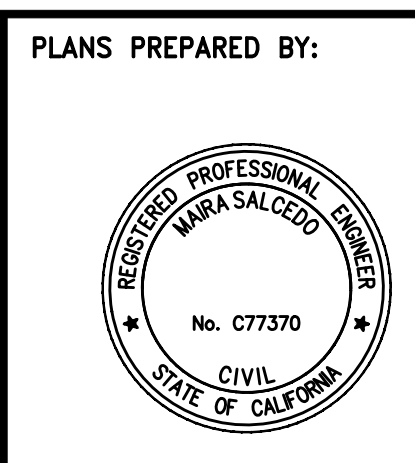

**PSOMAS**  
5 HUTTON CENTRE DRIVE, SUITE 300  
SANTA ANA, CA 92707  
TEL (714) 751-7373  
FAX (714) 545-8883

*M. Salcedo*  
12/22/23  
MAIRA SALCEDO, P.E., RCE 77370 DATE

CITY OF HERMOSA BEACH  
PUBLIC WORKS DEPARTMENT

RECOMMENDED FOR PERMIT ISSUANCE:

*[Signature]*  
5-15-24 DATE

CIP 421  
ANNUAL SEWER IMPROVEMENTS PHASE 2

PIPE REHABILITATION INDEX  
MAPS

FILE NUMBER  
23-010

**G-04**

SHT. 4 OF 31

M:\2\HERO30503\WATERS\TASKS\FINAL DESIGN\SHEETS\C-17-MANHOLE\_1.dwg 12/22/23 - 10:09am ben.habach

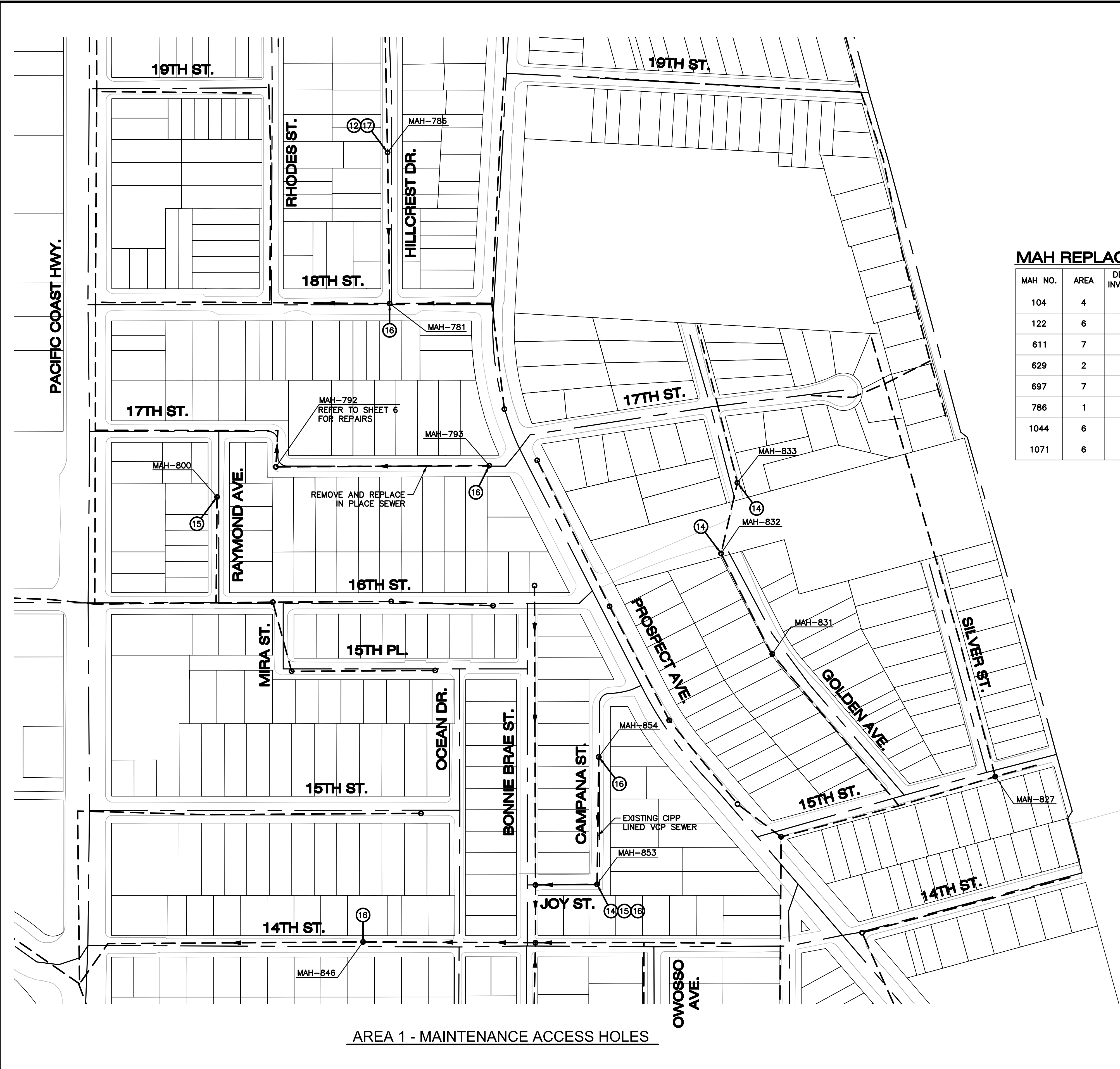

AREA 1 - MAINTENANCE ACCESS HOLES

**CONSTRUCTION NOTES**

- 12 CONSTRUCT 48" I.D. PRECAST REINFORCED CONCRETE MAINTENANCE ACCESS HOLE PER SPPWC STANDARD PLAN 200-4, WITH UTILITHANE COATING (OR APPROVED EQUAL) AND CUSTOM "CITY OF HERMOSA BEACH" FRAME AND COVER PER SPECIFICATION SECTION 33 01 38, AND AS INDICATED IN TABLE ON SHEET 24.
- 13 CONSTRUCT 48" I.D. PRECAST REINFORCED CONCRETE DROP MAINTENANCE ACCESS HOLE PER SPPWC STANDARD PLAN 202-2, WITH UTILITHANE COATING (OR APPROVED EQUAL) AND CUSTOM "CITY OF HERMOSA BEACH" FRAME AND COVER PER SPECIFICATION SECTION 33 01 38, AND AS INDICATED IN TABLE ON SHEET 24.
- 14 APPLY FULL DEPTH UTILITHANE SPRAY LINER (OR APPROVED EQUAL) FOR MAINTENANCE ACCESS HOLE REHABILITATION PER SPECIFICATION SECTION 33 01 38.
- 15 RECONSTRUCT MAINTENANCE ACCESS HOLE BENCH AND CHANNEL. CONTRACTOR TO VERIFY CORRECT FLOW DIRECTION.
- 16 REPLACE MAINTENANCE ACCESS HOLE FRAME AND COVER PER SPPWC STANDARD PLAN 210-4, USING CUSTOM "CITY OF HERMOSA BEACH" FRAME AND COVER. RESTORE SURFACE CONDITIONS.
- 17 REMOVE AND DISPOSE OF EXISTING MAINTENANCE ACCESS HOLE AND BASE.

**MAH REPLACEMENT SCHEDULE**

MAH NO.	AREA	DEPTH TO INVERT (FT.)	PAVEMENT	DETAIL
104	4	6.0	AC	DETAIL 5 ON SHEET 28
122	6	14.8	AC	DETAIL 7 ON SHEET 29
611	7	6.3	AC	DETAIL 12 ON SHEET 30
629	2	8.0	AC	DETAIL 3 ON SHEET 27
697	7	5.8	AC	DETAIL 13 ON SHEET 31
786	1	7.8	AC	DETAIL 1 ON SHEET 27
1044	6	8.0	CONC. (GUTTER)	DETAIL 9 ON SHEET 29
1071	6	5.9	AC	DETAIL 8 ON SHEET 29

**MAH REHABILITATION SCHEDULE**

MAH NO.	AREA	DEPTH	PAVEMENT	MAH NO.	AREA	DEPTH	PAVEMENT
105	4	4.6	AC	813	2	4.3	CONC. (GUTTER)
123	6	4.6	AC	815	2	4.1	AC/CONC. (GUTTER)
123A	6	4.0	CONC. (SWLK)	816	2	4.2	CONC. (CROSS-GUTTER)
126	6	10.8	AC	817	2	5.1	AC
126A	6	9.3	AC	827	1	5.2	BRICK (SWLK)
134	6	5.6	AC	831	1	4.2	CONC.
142	2	3.1	AC	832	1	5.2	CONC. (DVWY)
143X	6	4.6	AC	833	1	8.0	GRASS
172	8	7.6	CONC. (SWLK)	836	2	6.0	PKWY (GRASS)
215	9	4.5	AC	837	2	5.4	GRASS (SWLK)
571	4	UNK	DIRT/GRASS	844	2	2.8	PKWY (DIRT)
619	2	4.5	AC/CONC. (GUTTER)	846	1	UNK	AC
620	2	4.0	AC/CONC. (GUTTER)	853	1	2.6	AC
621	2	3.4	AC/CONC. (GUTTER)	854	1	4.7	AC
631	2	UNK	CONC. (GUTTER)	1043	NA	7.9	AC
633	2	3.5	CONC. (SWLK)	1062	6	3.6	BRICK (SWLK)
637	2	5.0	DVWY (CONC.)	1067	3	9.4	AC
638	2	4.2	CONC. (SWLK)	1068	3	5.9	AC
650	2	3.7	AC	1068A	3	5.4	AC
651	2	2.7	CONC.	1069	3	5.7	AC
665	2	5.3	CONC. (DVWY)	1070A	3	4.3	AC
666	2	UNK	DIRT/GRASS	1096A	5	4.5	AC
667	2	6.1	AC	1097A	5	3.8	AC
668	2	5.1	AC	1098	5	2.2	AC
669	2	6.3	CONC. (DVWY)	1099	5	1.9	CONC. (GUTTER)
670	2	5.2	CONC. (SWLK)	1116	6	11.5	AC/CONC. (GUTTER)
677	2	5.4	CONC. (SWLK)	1117	6	11.1	AC (NEAR GUTTER)
678	2	UNK	CONC. (DVWY)	1119	6	11.0	AC
679	2	5.7	CONC. (SWLK)	1121	2	12.5	AC
680	2	4.8	SWLK (CONC.)	1152	4	10.4	AC
681	2	3.3	CONC. (SWLK)	1153	4	5.4	AC
691	7	7.5	AC	1155	3	6.4	AC
694	7	2.7	AC	1156	3	7.4	AC
781	1	UNK	AC				
793	1	4.8	AC				
800	1	3.1	AC				

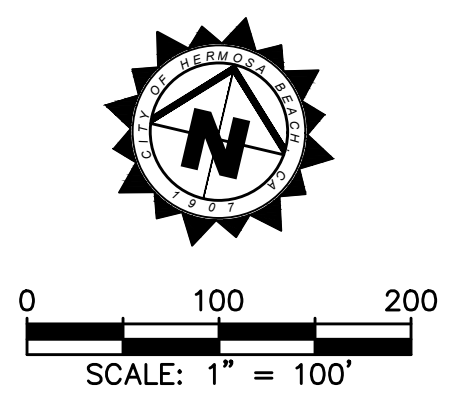

REVISIONS		
No.	DESCRIPTION	DATE

PLANS PREPARED BY:

**PSOMAS**  
 5 HUTTON CENTRE DRIVE, SUITE 300  
 SANTA ANA, CA 92707  
 TEL (714) 751-7373  
 FAX (714) 545-8883

*M. Salcedo*  
 MAIRA SALCEDO, P.E., RCE 77370 DATE 12/22/23

CITY OF HERMOSA BEACH  
 PUBLIC WORKS DEPARTMENT

RECOMMENDED FOR PERMIT ISSUANCE:

5-15-24 DATE

CIP 421  
 ANNUAL SEWER IMPROVEMENTS PHASE 2

**MANHOLE REHABILITATION - AREA 1**

FILE NUMBER  
 23-010

**C-17**

SHT. 22 OF 31

M:\2\HERO30503\WATERS\TASKS\FINAL DESIGN\SHEETS\C-18-MANHOLE\_2.dwg 12/22/23 - 10:09am ben.halbach



AREA 2 - MAINTENANCE ACCESS HOLES

**CONSTRUCTION NOTES**

- 12. CONSTRUCT 48" I.D. PRECAST REINFORCED CONCRETE MAINTENANCE ACCESS HOLE PER SPPWC STANDARD PLAN 200-4, WITH UTILITHANE COATING (OR APPROVED EQUAL) AND CUSTOM "CITY OF HERMOSA BEACH" FRAME AND COVER PER SPECIFICATION SECTION 33 01 38, AND AS INDICATED IN TABLE ON SHEET 24.
- 13. CONSTRUCT 48" I.D. PRECAST REINFORCED CONCRETE DROP MAINTENANCE ACCESS HOLE PER SPPWC STANDARD PLAN 202-2, WITH UTILITHANE COATING (OR APPROVED EQUAL) AND CUSTOM "CITY OF HERMOSA BEACH" FRAME AND COVER PER SPECIFICATION SECTION 33 01 38, AND AS INDICATED IN TABLE ON SHEET 24.
- 14. APPLY FULL DEPTH POLYURETHANE SPRAY LINER (OR APPROVED EQUAL) FOR MAINTENANCE ACCESS HOLE REHABILITATION PER SPECIFICATION SECTION 33 01 38.
- 15. RECONSTRUCT MAINTENANCE ACCESS HOLE BENCH AND CHANNEL. CONTRACTOR TO VERIFY CORRECT FLOW DIRECTION.
- 16. REPLACE MAINTENANCE ACCESS HOLE FRAME AND COVER PER SPPWC STANDARD PLAN 210-4, USING CUSTOM "CITY OF HERMOSA BEACH" FRAME AND COVER. RESTORE SURFACE CONDITIONS.
- 17. REMOVE AND DISPOSE OF EXISTING MAINTENANCE ACCESS HOLE AND BASE.

**NOTE:**

- 1. CONTRACTOR MUST VERIFY LOCATIONS OF LATERALS AND MARK LATERAL STATION ON PAVEMENT UPON COMPLETING PRE-CONSTRUCTION CCTV OF ENTIRE SEGMENT.
- 2. REFER TO SHEETS 24-28 FOR MAINTENANCE ACCESS HOLE ADDITIONAL REHABILITATION/MODIFICATIONS.

DIAL TOLL FREE  
1-800-422-4133  
AT LEAST TWO DAYS  
BEFORE YOU DIG  
UNDERGROUND SERVICE ALERT  
OF SOUTHERN CALIFORNIA

REVISIONS		
No.	DESCRIPTION	DATE

PLANS PREPARED BY:

**PSOMAS**  
5 HUTTON CENTRE DRIVE, SUITE 300  
SANTA ANA, CA 92707  
TEL (714) 751-7373  
FAX (714) 545-8883

*M. Salcedo*  
12/22/23  
MAIRA SALCEDO, P.E., RCE 77370 DATE

CITY OF HERMOSA BEACH  
PUBLIC WORKS DEPARTMENT

RECOMMENDED FOR PERMIT ISSUANCE:

5-15-24 DATE

CIP 421  
ANNUAL SEWER IMPROVEMENTS PHASE 2

MANHOLE REHABILITATION -  
AREA 2

FILE NUMBER  
23-010

**C-18**

SHT. 23 OF 31





M:\2\HERO30503\WATERS\TASKS\FINAL DESIGN\SHEETS\C-20-MANHOLE\_4.dwg 12/22/23 - 10:10am ben.habach

### CONSTRUCTION NOTES

- 7 REMOVE AND RECONSTRUCT LONGITUDINAL GUTTER PER SPPWC STANDARD PLAN NO. 122-3.
- 12 CONSTRUCT 48" I.D. PRECAST REINFORCED CONCRETE MAINTENANCE ACCESS HOLE PER SPPWC STANDARD PLAN 200-4, WITH UTILITHANE COATING (OR APPROVED EQUAL) AND CUSTOM "CITY OF HERMOSA BEACH" FRAME AND COVER PER SPECIFICATION SECTION 33 01 38, AND AS INDICATED IN TABLE ON SHEET 24.
- 13 CONSTRUCT 48" I.D. PRECAST REINFORCED CONCRETE DROP MAINTENANCE ACCESS HOLE PER SPPWC STANDARD PLAN 202-2, WITH UTILITHANE COATING (OR APPROVED EQUAL) AND CUSTOM "CITY OF HERMOSA BEACH" FRAME AND COVER PER SPECIFICATION SECTION 33 01 38, AND AS INDICATED IN TABLE ON SHEET 24.
- 14 APPLY FULL DEPTH POLYURETHANE SPRAY LINER (OR APPROVED EQUAL) FOR MAINTENANCE ACCESS HOLE REHABILITATION PER SPECIFICATION SECTION 33 01 38.
- 15 RECONSTRUCT MAINTENANCE ACCESS HOLE BENCH AND CHANNEL. CONTRACTOR TO VERIFY CORRECT FLOW DIRECTION.
- 16 REPLACE MAINTENANCE ACCESS HOLE FRAME AND COVER PER SPPWC STANDARD PLAN 210-4, USING CUSTOM "CITY OF HERMOSA BEACH" FRAME AND COVER. RESTORE SURFACE CONDITIONS.
- 17 REMOVE AND DISPOSE OF EXISTING MAINTENANCE ACCESS HOLE AND BASE.
- 18 CONSTRUCT 48" I.D. CONCENTRIC PRECAST REINFORCED CONCRETE SHALLOW MAINTENANCE ACCESS HOLE PER SPPWC 201-3, WITH UTILITHANE COATING (OR APPROVED EQUAL) AND CUSTOM "CITY OF HERMOSA BEACH" FRAME AND COVER PER SPECIFICATION SECTION 33 01 38, AND AS INDICATED IN TABLE ON SHEET 24.

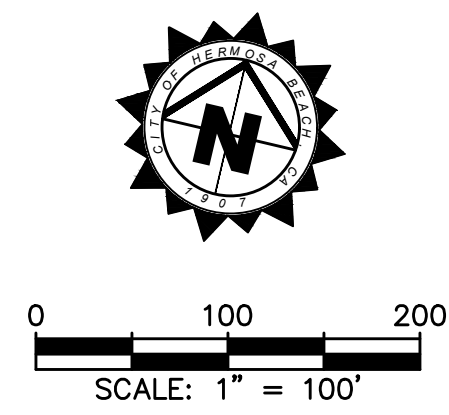

AREA 5 & 6 - MAINTENANCE ACCESS HOLES

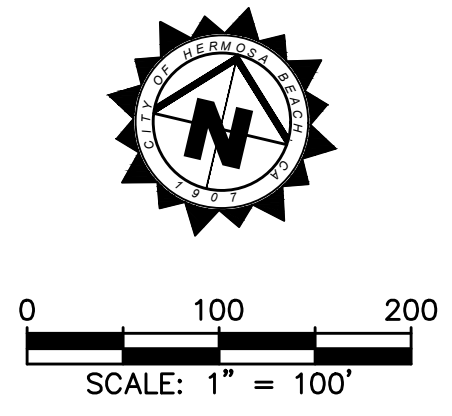
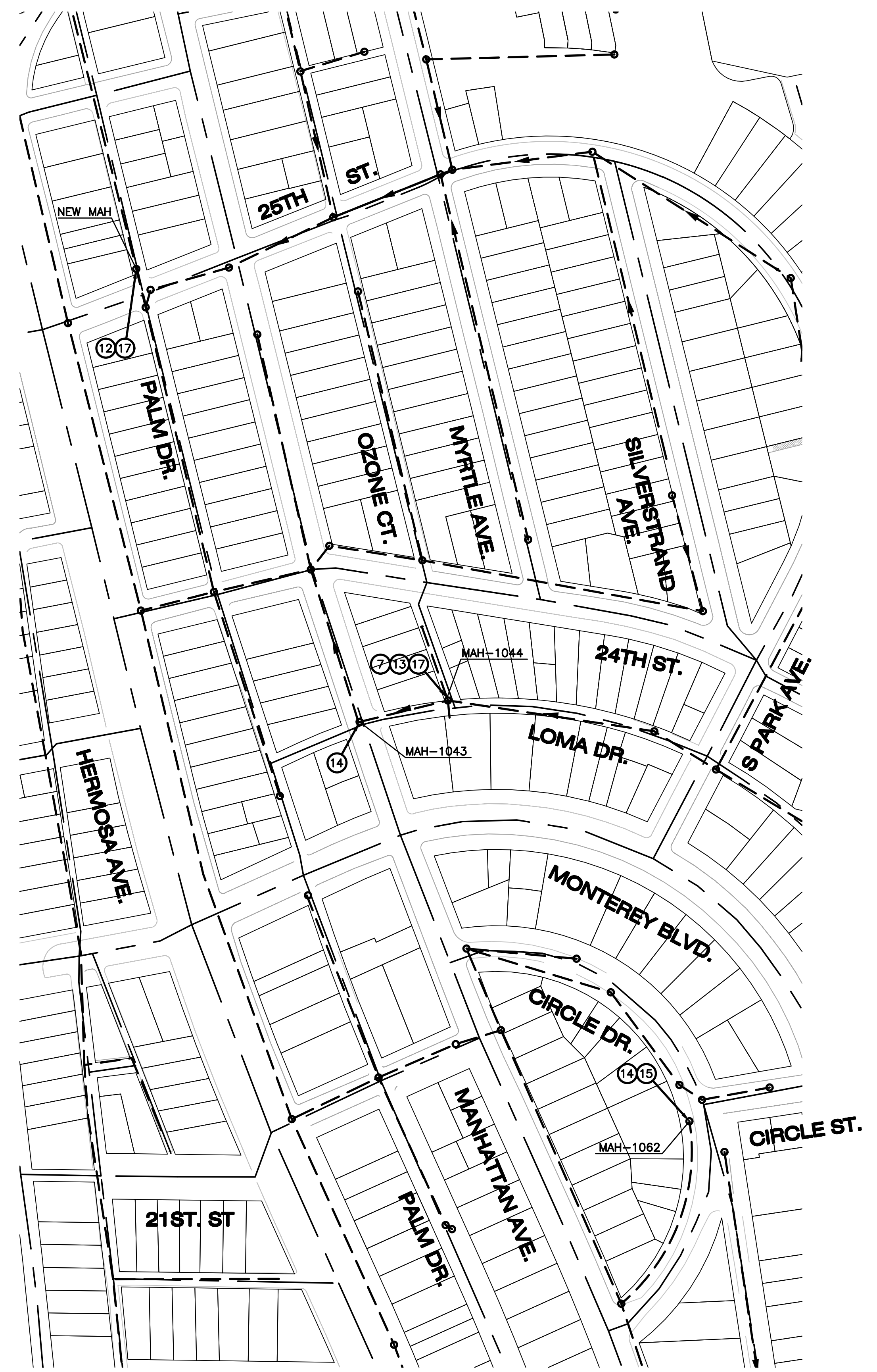

AREA 6 EXTENDED - MAINTENANCE ACCESS HOLES

REVISIONS		
No.	DESCRIPTION	DATE

PLANS PREPARED BY:

**PSOMAS**  
 5 HUTTON CENTRE DRIVE, SUITE 300  
 SANTA ANA, CA 92707  
 TEL (714) 751-7373  
 FAX (714) 545-8883

*M. Salcedo*  
 MAIRA SALCEDO, P.E., RCE 77370 DATE 12/22/23

CITY OF HERMOSA BEACH  
 PUBLIC WORKS DEPARTMENT

RECOMMENDED FOR PERMIT ISSUANCE:

*[Signature]*  
 DATE 5-15-24

CIP 421  
 ANNUAL SEWER IMPROVEMENTS PHASE 2

MANHOLE REHABILITATION -  
 AREA 4

FILE NUMBER  
 23-010

**C-20**

SHT. 25 OF 31

**CONSTRUCTION NOTES**

- 12 CONSTRUCT 48" I.D. PRECAST REINFORCED CONCRETE MAINTENANCE ACCESS HOLE PER SPPWC STANDARD PLAN 200-4, WITH UTILITHANE COATING (OR APPROVED EQUAL) AND CUSTOM "CITY OF HERMOSA BEACH" FRAME AND COVER PER SPECIFICATION SECTION 33 01 38, AND AS INDICATED IN TABLE ON SHEET 24.
- 14 APPLY FULL DEPTH POLYURETHANE SPRAY LINER (OR APPROVED EQUAL) FOR MAINTENANCE ACCESS HOLE REHABILITATION PER SPECIFICATION SECTION 33 01 38.
- 15 RECONSTRUCT MAINTENANCE ACCESS HOLE BENCH AND CHANNEL. CONTRACTOR TO VERIFY CORRECT FLOW DIRECTION.
- 16 REPLACE MAINTENANCE ACCESS HOLE FRAME AND COVER PER SPPWC STANDARD PLAN 210-4, USING CUSTOM "CITY OF HERMOSA BEACH" FRAME AND COVER. RESTORE SURFACE CONDITIONS.
- 17 REMOVE AND DISPOSE OF EXISTING MAINTENANCE ACCESS HOLE AND BASE.

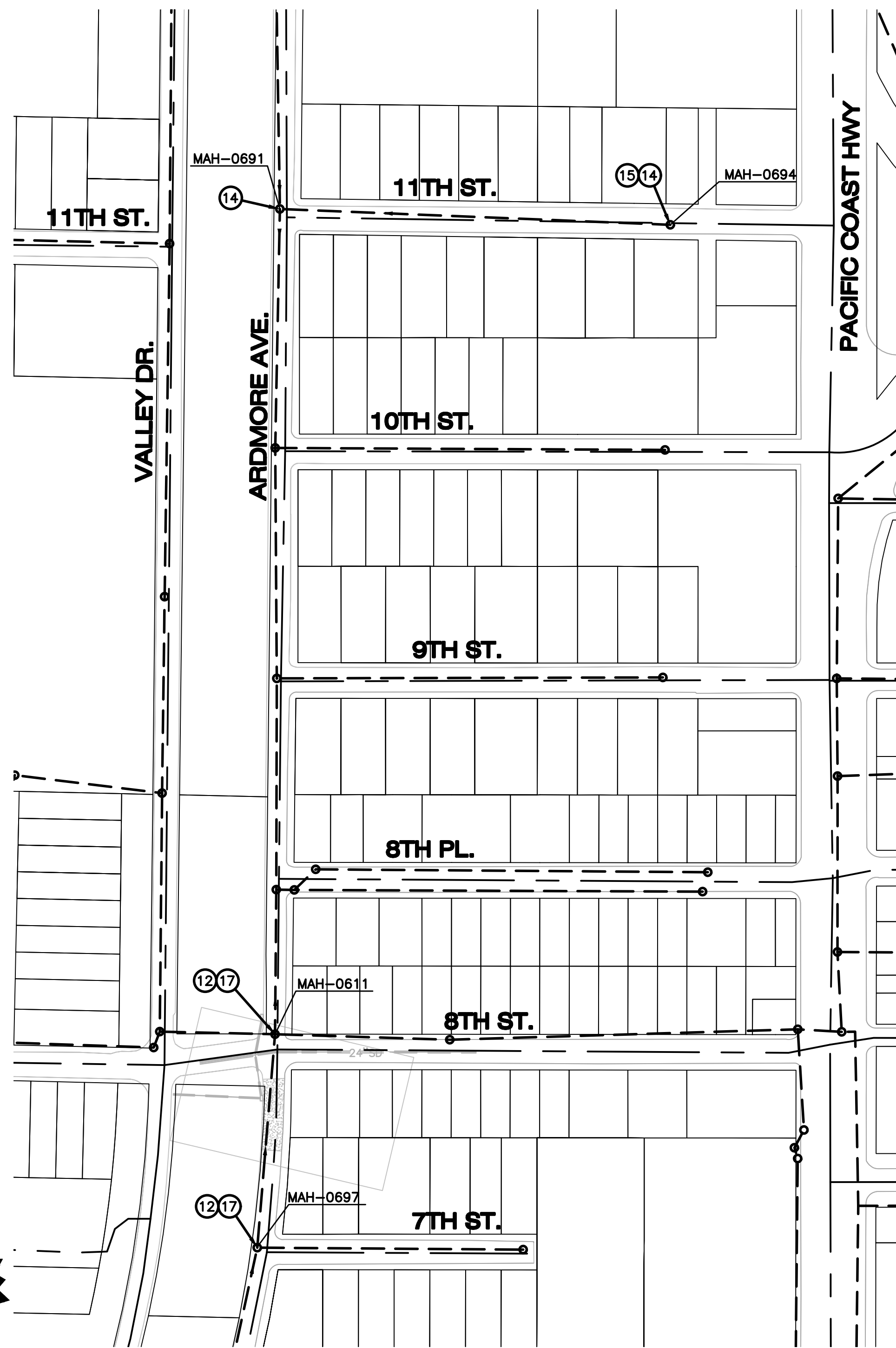

AREA 7 - MAINTENANCE ACCESS HOLES

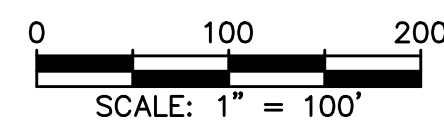

AREA 8 - MAINTENANCE ACCESS HOLES

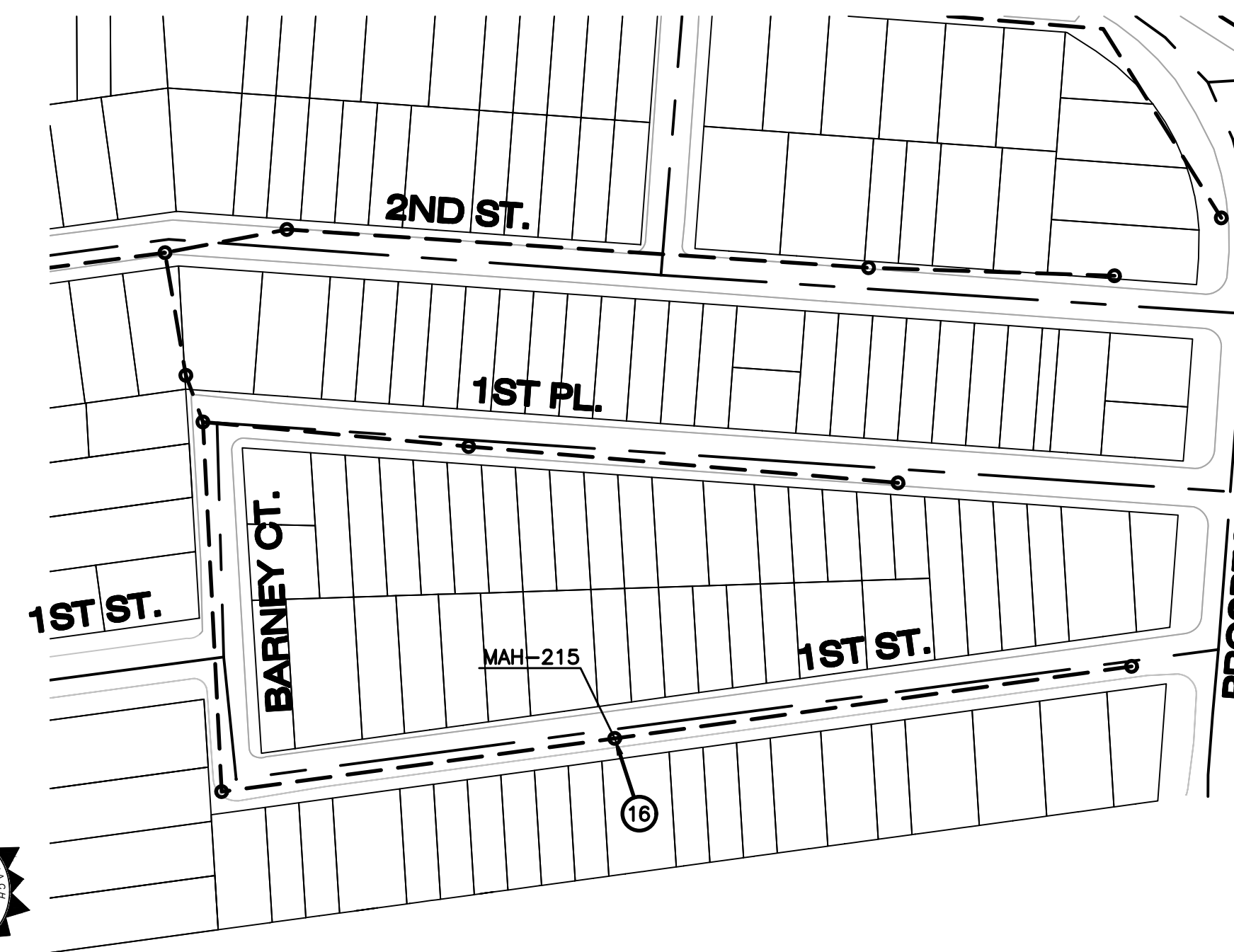
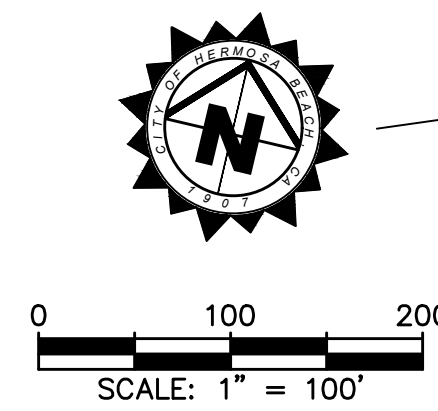

AREA 9 - MAINTENANCE ACCESS HOLES

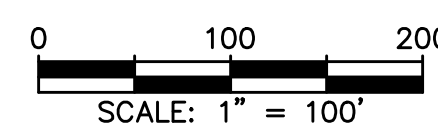

M:\2\HERO30503\WATERS\TASKS\FINAL DESIGN\SHEETS\C-21-MANHOLE\_5.dwg 12/22/23 - 10:10am ben.habach

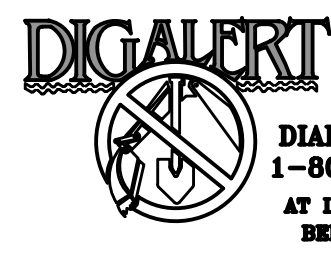

DIAL TOLL FREE  
1-800-422-4133  
AT LEAST TWO DAYS  
BEFORE YOU DIG  
UNDERGROUND SERVICE ALERT  
OF SOUTHERN CALIFORNIA

REVISIONS		
No.	DESCRIPTION	DATE

PLANS PREPARED BY:



**PSOMAS**  
5 HUTTON CENTRE DRIVE, SUITE 300  
SANTA ANA, CA 92707  
TEL (714) 751-7373  
FAX (714) 545-8883

*M. Salcedo*  
MAIRA SALCEDO, P.E., RCE 77370  
12/22/23  
DATE

CITY OF HERMOSA BEACH  
PUBLIC WORKS DEPARTMENT

RECOMMENDED FOR PERMIT ISSUANCE:

*[Signature]*  
5-15-24  
DATE

CIP 421  
ANNUAL SEWER IMPROVEMENTS PHASE 2

MANHOLE REHABILITATION -  
AREA 5

FILE NUMBER  
23-010

C-21

SHT. 26 OF 33