

DATE: September 26, 2023
TO: Frank Coyle, CASC Engineering & Consulting
FROM: Charlene So, Urban Crossroads
JOB NO: 15636-01 TG Letter



17969 RAILROAD STREET TRIP GENERATION ASSESSMENT

Urban Crossroads, Inc. is pleased to submit the following Trip Generation Assessment for the 17969 Railroad Street development (referred to as **Project**), which is located on the northwest corner of Lawson Street and Railroad Street in the City of Industry. This letter describes the proposed Project trip generation methodology and determines whether any traffic operations analysis is required based on the City of Industry Transportation Study Guidelines for Vehicle Miles Traveled and Level of Service Assessment (September 2020, referred to as **City's Guidelines**).

PROPOSED PROJECT

The Project site currently consists of a single industrial building, totaling 75,000 square feet. The existing on-site building, parking lots, and associated improvements will be demolished as a part of this Project. In addition to the proposed demolition and the construction of the new industrial building, site improvements include the construction of passenger vehicle parking spaces, bicycle racks, landscaped areas, and lighting.

The Project consists of the development of a new 213,500 square-foot tilt-up concrete industrial building. The proposed building is designed to accommodate one tenant with a wide variety of potential uses including manufacturing, logistics, and warehousing/distribution. The Project will be accessible via one forty-foot (40') wide driveway and one twenty-six-foot (26') wide driveway off Railroad Street and one thirty-foot (30') wide driveway off S. Lawson Street.

EXHIBIT 1: PRELIMINARY SITE PLAN

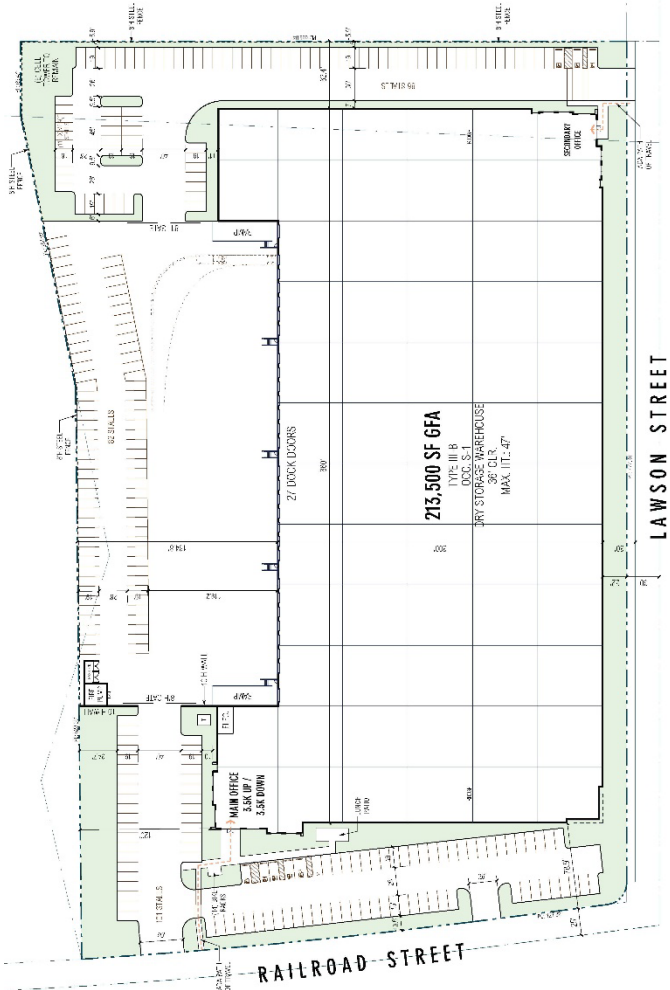

TRIP GENERATION

EXISTING TRAFFIC

As noted previously, the site currently consists of a single industrial building, totaling 75,000 square feet. In an effort to understand the existing traffic associated with the current use, traffic counts were collected at the driveways on Tuesday, September 12, 2023, through Thursday, September 14, 2023. A detailed summary of the count data collected at all driveway locations by day is shown in Attachment A.

Table 1 below summarizes the average existing trip generation based on the count data collected over the two days. The existing site currently generates an average of 188 two-way trips per day, with 27 trips during the AM peak hour and 20 trips during the PM peak hour.

TABLE 1: EXISTING TRIP GENERATION

Land Use	AM Peak Hour			PM Peak Hour			Daily
	In	Out	Total	In	Out	Total	
Existing Use							
Passenger Cars:	7	1	8	2	24	26	148
2-Axle Truck Trips:	0	0	0	2	2	3	18
3-Axle Truck Trips:	0	0	1	0	0	0	4
4+-Axle Truck Trips:	0	0	0	1	1	1	10
Total Truck Trips:	0	0	1	3	3	4	32
Total Trips (Actual Vehicles)¹	7	1	9	5	27	30	180

¹ Total Trips = Passenger Cars + Truck Trips.

PROPOSED PROJECT

The proposed Project consists of the development of a new 213,500 square-foot tilt-up concrete industrial building. In order to develop the traffic characteristics of the proposed project, trip-generation statistics published in the Institute of Transportation Engineers (**ITE**) Trip Generation Manual (11th Edition, 2021) were used to estimate the trip generation. For purposes of this trip generation assessment, the following ITE land use codes and vehicle mixes will be utilized for the Project:

- ITE land use code 110 (General Light Industrial) has been used to derive site specific trip generation estimates for up to 53,375 square feet of the proposed Project (25% of the overall building square footage). A light industrial facility is a free-standing facility devoted to a single use that has an emphasis on activities other than manufacturing. Typically, there is minimum office space. The vehicle mix has been obtained from the ITE's Trip Generation Manual. The truck percentages were further broken down by axle type per the following South Coast Air Quality Management District (SCAQMD) recommended truck mix: 2-Axle = 16.7%; 3-Axle = 20.7%; 4+-Axle = 62.6%.
- ITE land use code 150 (Warehousing) has been used to derive site specific trip generation estimates for up to 160,125 square feet (75% of the overall building square footage). A warehouse is primarily devoted to the storage of materials but may also include office and maintenance areas. The vehicle mix has been obtained from the ITE's Trip Generation Manual. The truck percentages were further broken down by axle type per the following SCAQMD recommended truck mix: 2-Axle = 16.7%; 3-Axle = 20.7%; 4+-Axle = 62.6%.

The trip generation rates used to estimate Project traffic are summarized in Table 2 for the proposed land uses (a mix of general light industrial and warehousing). As shown on Table 3, the proposed Project is anticipated to generate a total of 538 two-way trips per day with 65 AM peak hour trips and 64 PM peak hour trips.

TABLE 2: TRIP GENERATION RATES

Land Use ¹	Units ²	ITE LU Code	AM Peak Hour			PM Peak Hour			Daily
			In	Out	Total	In	Out	Total	
Actual Vehicle Trip Generation Rates									
General Light Industrial ³	TSF	110	0.651	0.089	0.740	0.091	0.559	0.650	4.870
Passenger Cars (AM=98.6%, PM=98.5%, Daily=94.9%)			0.645	0.085	0.730	0.086	0.554	0.640	4.620
2-Axle Trucks (AM=0.23%, PM=0.25%, Daily=0.85%)			0.001	0.001	0.002	0.001	0.001	0.002	0.042
3-Axle Trucks (AM=0.29%, PM=0.31%, Daily=1.05%)			0.001	0.001	0.002	0.001	0.001	0.002	0.052
4+-Axle Trucks (AM=0.88%, PM=0.94%, Daily=3.20%)			0.004	0.002	0.006	0.003	0.003	0.006	0.157
Warehousing ³	TSF	150	0.131	0.039	0.170	0.050	0.130	0.180	1.710
Passenger Cars (AM=88.2%, PM=83.3%, Daily=64.9%)			0.120	0.030	0.150	0.034	0.116	0.150	1.110
2-Axle Trucks (AM=1.97%, PM=2.79%, Daily=5.86%)			0.002	0.001	0.003	0.003	0.002	0.005	0.100
3-Axle Trucks (AM=2.44%, PM=3.46%, Daily=7.27%)			0.002	0.002	0.004	0.003	0.003	0.006	0.124
4+-Axle Trucks (AM=7.39%, PM=10.45%, Daily=21.97%)			0.007	0.006	0.013	0.010	0.009	0.019	0.376

¹ Trip Generation & Vehicle Mix Source: Institute of Transportation Engineers (ITE), Trip Generation Manual, Eleventh Edition (2021).

² TSF = thousand square feet

³ Truck Mix: South Coast Air Quality Management District's (SCAQMD) recommended truck mix, by axle type.

Normalized % - Without Cold Storage: 16.7% 2-Axle trucks, 20.7% 3-Axle trucks, 62.6% 4-Axle trucks.

TABLE 3: PROJECT TRIP GENERATION SUMMARY

Land Use	Quantity Units ¹	AM Peak Hour			PM Peak Hour			Daily
		In	Out	Total	In	Out	Total	
Actual Vehicles:								
General Light Industrial (25%)	53.375 TSF							
Passenger Cars:		34	5	39	5	30	35	246
2-axle Trucks:		0	0	0	0	0	0	4
3-axle Trucks:		0	0	0	0	0	0	4
4+-axle Trucks:		0	0	0	0	0	0	10
Total Truck Trips (Actual Vehicles):		0	0	0	0	0	0	18
Total Trips (Actual Vehicles) ²		34	5	39	5	30	35	264
Warehousing (75%)	160.125 TSF							
Passenger Cars:		19	5	24	6	19	25	178
2-axle Trucks:		0	0	0	0	0	0	16
3-axle Trucks:		0	0	0	0	1	1	20
4+-axle Trucks:		1	1	2	2	1	3	60
Total Truck Trips (Actual Vehicles):		1	1	2	2	2	4	96
Total Trips (Actual Vehicles) ²		20	6	26	8	21	29	274
Passenger Cars		53	10	63	11	49	60	424
Trucks		1	1	2	2	2	4	114
Total Trips (Actual Vehicles)²		54	11	65	13	51	64	538

¹ TSF = thousand square feet

² Total Trips = Passenger Cars + Truck Trips.

TRIP GENERATION COMPARISON

Table 4 shows the trip generation comparison between the existing use and proposed Project. The resulting net change in trips is identified on Table 4. As shown, the proposed Project is anticipated to result in a net increase of 358 two-way trips per day and a net increase of 56 AM peak hour trips and 34 PM peak hour trips as compared to the existing use.

TABLE 4: TRIP GENERATION COMPARISON

Land Use	AM Peak Hour			PM Peak Hour			Daily
	In	Out	Total	In	Out	Total	
Existing Use							
Passenger Cars	7	1	8	2	24	26	148
Trucks	0	0	1	3	3	4	32
Existing Use Total	7	1	9	5	27	30	180
Proposed Project							
Passenger Cars	53	10	63	11	49	60	424
Trucks	1	1	2	2	2	4	114
Proposed Project Total	54	11	65	13	51	64	538
Net Change in Trips							
Passenger Cars	46	9	55	9	25	34	276
Trucks	1	1	1	-1	-1	0	82
Total Net Change in Trips	47	10	56	8	24	34	358

FINDINGS

The City's Guidelines indicate that development projects that generate a net increase of 200 or more peak hour vehicle trips (and would contribute 100 or more peak hour trips to any off-site intersection) would require the preparation and submittal of a level of service (**LOS**) based Traffic Study. Projects that generate less than 200 peak hour trips typically do not affect LOS significantly once distributed to the local roadway network.

As shown in Table 4, the Project is anticipated to generate fewer than 100 net new peak hour trips during the peak hours. As such, the Project is anticipated to generate fewer than 200 net new peak hour trips and would contribute fewer than 100 net new peak hour trips to any off-site intersection. Based on the City's Guidelines, additional peak hour operations analyses of off-site intersections are not necessary for this Project.

If you have any questions or comments, I can be reached at cso@urbanxroads.com.

ATTACHMENT A: DRIVEWAY COUNTS SEPTEMBER 12-14, 2023

TABLE A-1: EXISTING TRIP GENERATION BY DAY

Land Use	AM Peak Hour			PM Peak Hour			Daily
	In	Out	Total	In	Out	Total	
Day 1: September 12, 2023							
Passenger Cars:	7	2	9	2	24	26	138
2-axle Trucks:	0	0	0	1	1	2	28
3-axle Trucks:	1	1	2	0	0	0	2
4+-axle Trucks:	0	0	0	1	1	2	8
Total Truck Trips:	1	1	2	2	2	4	38
Total Trips ¹	8	3	11	4	26	30	176
Day 2: September 13, 2023							
Passenger Cars:	7	0	7	0	23	23	138
2-axle Trucks:	0	0	0	1	1	2	10
3-axle Trucks:	0	0	0	0	0	0	4
4+-axle Trucks:	0	0	0	1	1	2	10
Total Truck Trips:	0	0	0	2	2	4	24
Total Trips ¹	7	0	7	2	25	27	162
Day 3: September 14, 2023							
Passenger Cars:	7	2	9	3	25	28	166
2-axle Trucks:	0	0	0	3	3	6	16
3-axle Trucks:	0	0	0	0	0	0	2
4+-axle Trucks:	0	0	0	0	0	0	8
Total Truck Trips:	0	0	0	3	3	6	26
Total Trips ¹	7	2	9	6	28	34	192

* Note: data collected on September 12 through 14, 2023.

¹ Total Trips = Passenger Cars + Total Truck Trips.



City: Industry
 Location: 17969 Railroad St
Total of all Driveways
 Date: Tuesday, September 12, 2023
 Count Type: Classified Driveway Count

	Entering				
	Pass Veh	Large 2 Axle	3 Axle	4+ Axle	Total
0:00	0	0	0	0	0
0:15	0	0	0	0	0
0:30	0	0	0	0	0
0:45	0	0	0	0	0
1:00	0	0	0	0	0
1:15	0	0	0	0	0
1:30	0	0	0	0	0
1:45	0	0	0	0	0
2:00	0	0	0	0	0
2:15	0	0	0	0	0
2:30	0	0	0	0	0
2:45	0	0	0	0	0
3:00	0	0	0	0	0
3:15	0	0	0	0	0
3:30	0	0	0	0	0
3:45	0	0	0	0	0
4:00	1	0	0	0	1
4:15	5	0	0	0	5
4:30	8	0	0	0	8
4:45	7	0	0	0	7
5:00	2	0	0	0	2
5:15	3	0	0	0	3
5:30	7	0	0	0	7
5:45	10	0	0	0	10
6:00	1	0	0	0	1
6:15	1	0	0	0	1
6:30	1	0	0	0	1
6:45	3	0	1	0	4
7:00	1	0	0	0	1
7:15	1	0	0	0	1
7:30	2	0	0	0	2
7:45	1	0	0	0	1
8:00	0	0	0	0	0
8:15	0	1	0	0	1
8:30	1	0	0	0	1
8:45	0	0	0	0	0
9:00	0	2	0	0	2
9:15	1	0	0	0	1
9:30	0	0	0	0	0
9:45	0	0	0	0	0
10:00	1	0	0	0	1
10:15	0	0	0	0	0
10:30	0	0	0	1	1
10:45	0	0	0	0	0
11:00	2	0	0	0	2
11:15	1	1	0	0	2
11:30	0	0	0	0	0
11:45	0	0	0	0	0

	Exiting				
	Pass Veh	Large 2 Axle	3 Axle	4+ Axle	Total
0:00	0	0	0	0	0
0:15	0	0	0	0	0
0:30	0	0	0	0	0
0:45	0	0	0	0	0
1:00	0	0	0	0	0
1:15	0	0	0	0	0
1:30	0	0	0	0	0
1:45	0	0	0	0	0
2:00	0	0	0	0	0
2:15	0	0	0	0	0
2:30	0	0	0	0	0
2:45	0	0	0	0	0
3:00	0	0	0	0	0
3:15	0	0	0	0	0
3:30	0	0	0	0	0
3:45	0	0	0	0	0
4:00	0	0	0	0	0
4:15	0	0	0	0	0
4:30	0	0	0	0	0
4:45	1	0	0	0	1
5:00	1	0	0	0	1
5:15	0	0	0	0	0
5:30	0	0	0	0	0
5:45	1	0	0	0	1
6:00	0	0	0	0	0
6:15	0	0	0	0	0
6:30	0	0	0	0	0
6:45	0	0	0	0	0
7:00	0	0	1	0	1
7:15	1	0	0	0	1
7:30	1	0	0	0	1
7:45	0	0	0	0	0
8:00	0	0	0	0	0
8:15	0	0	0	0	0
8:30	0	1	0	0	1
8:45	0	0	0	0	0
9:00	0	1	0	0	1
9:15	1	1	0	0	2
9:30	1	0	0	0	1
9:45	0	0	0	0	0
10:00	0	0	0	0	0
10:15	0	0	0	0	0
10:30	0	0	0	0	0
10:45	0	0	0	0	0
11:00	1	0	0	1	2
11:15	0	1	0	0	1
11:30	0	0	0	0	0
11:45	2	1	0	0	3



City: Industry
 Location: 17969 Railroad St
Total of all Driveways
 Date: Tuesday, September 12, 2023
 Count Type: Classified Driveway Count

	Entering				
	Pass Veh	Large 2 Axle	3 Axle	4+ Axle	Total
12:00	1	1	0	0	2
12:15	1	0	0	1	2
12:30	0	3	0	1	4
12:45	0	2	0	0	2
13:00	0	1	0	0	1
13:15	0	0	0	0	0
13:30	1	1	0	0	2
13:45	1	0	0	0	1
14:00	0	0	0	0	0
14:15	1	0	0	0	1
14:30	1	1	0	0	2
14:45	0	0	0	0	0
15:00	2	1	0	0	3
15:15	0	0	0	1	1
15:30	0	0	0	0	0
15:45	0	0	0	0	0
16:00	0	0	0	0	0
16:15	0	0	0	0	0
16:30	1	0	0	0	1
16:45	0	0	0	0	0
17:00	0	0	0	0	0
17:15	0	0	0	0	0
17:30	0	0	0	0	0
17:45	0	0	0	0	0
18:00	0	0	0	0	0
18:15	0	0	0	0	0
18:30	0	0	0	0	0
18:45	0	0	0	0	0
19:00	0	0	0	0	0
19:15	0	0	0	0	0
19:30	0	0	0	0	0
19:45	0	0	0	0	0
20:00	0	0	0	0	0
20:15	0	0	0	0	0
20:30	0	0	0	0	0
20:45	0	0	0	0	0
21:00	0	0	0	0	0
21:15	0	0	0	0	0
21:30	0	0	0	0	0
21:45	0	0	0	0	0
22:00	0	0	0	0	0
22:15	0	0	0	0	0
22:30	0	0	0	0	0
22:45	0	0	0	0	0
23:00	0	0	0	0	0
23:15	0	0	0	0	0
23:30	0	0	0	0	0
23:45	0	0	0	0	0
TOTAL	69	14	1	4	88

	Exiting				
	Pass Veh	Large 2 Axle	3 Axle	4+ Axle	Total
12:00	1	0	0	0	1
12:15	0	0	0	0	0
12:30	1	1	0	2	4
12:45	0	4	0	0	4
13:00	0	1	0	0	1
13:15	1	0	0	0	1
13:30	6	1	0	0	7
13:45	1	0	0	0	1
14:00	1	0	0	0	1
14:15	7	0	0	0	7
14:30	8	0	0	0	8
14:45	0	1	0	0	1
15:00	2	1	0	0	3
15:15	1	0	0	0	1
15:30	19	0	0	1	20
15:45	2	0	0	0	2
16:00	3	0	0	0	3
16:15	0	0	0	0	0
16:30	1	0	0	0	1
16:45	2	0	0	0	2
17:00	2	0	0	0	2
17:15	1	0	0	0	1
17:30	0	0	0	0	0
17:45	0	0	0	0	0
18:00	0	0	0	0	0
18:15	0	0	0	0	0
18:30	0	0	0	0	0
18:45	0	0	0	0	0
19:00	0	0	0	0	0
19:15	0	0	0	0	0
19:30	0	0	0	0	0
19:45	0	0	0	0	0
20:00	0	0	0	0	0
20:15	0	0	0	0	0
20:30	0	0	0	0	0
20:45	0	0	0	0	0
21:00	0	0	0	0	0
21:15	0	0	0	0	0
21:30	0	0	0	0	0
21:45	0	0	0	0	0
22:00	0	0	0	0	0
22:15	0	0	0	0	0
22:30	0	0	0	0	0
22:45	0	0	0	0	0
23:00	0	0	0	0	0
23:15	0	0	0	0	0
23:30	0	0	0	0	0
23:45	0	0	0	0	0
TOTAL	69	14	1	4	88



City: Industry
 Location: 17969 Railroad St
Total of all Driveways
 Date: Wednesday, September 13, 2023
 Count Type: Classified Driveway Count

	Entering				
	Pass Veh	Large 2 Axle	3 Axle	4+ Axle	Total
0:00	0	0	0	0	0
0:15	0	0	0	0	0
0:30	0	0	0	0	0
0:45	0	0	0	0	0
1:00	0	0	0	0	0
1:15	0	0	0	0	0
1:30	0	0	0	0	0
1:45	0	0	0	0	0
2:00	0	0	0	0	0
2:15	0	0	0	0	0
2:30	0	0	0	0	0
2:45	0	0	0	0	0
3:00	0	0	0	0	0
3:15	0	0	0	0	0
3:30	0	0	0	0	0
3:45	0	0	0	0	0
4:00	0	0	0	0	0
4:15	5	0	0	0	5
4:30	11	0	0	0	11
4:45	5	0	0	0	5
5:00	1	0	0	0	1
5:15	1	0	0	0	1
5:30	7	0	0	0	7
5:45	13	0	0	0	13
6:00	1	0	0	0	1
6:15	0	0	0	0	0
6:30	2	0	0	0	2
6:45	3	0	0	0	3
7:00	1	0	0	0	1
7:15	1	0	0	0	1
7:30	1	0	0	0	1
7:45	1	0	0	0	1
8:00	1	0	0	0	1
8:15	0	0	0	0	0
8:30	0	0	0	1	1
8:45	1	0	0	0	1
9:00	0	0	0	1	1
9:15	1	0	0	0	1
9:30	0	0	0	0	0
9:45	0	0	0	0	0
10:00	1	1	0	0	2
10:15	0	0	0	0	0
10:30	0	0	0	0	0
10:45	0	0	0	0	0
11:00	0	0	1	0	1
11:15	1	0	0	0	1
11:30	0	0	0	0	0
11:45	1	0	0	0	1

	Exiting				
	Pass Veh	Large 2 Axle	3 Axle	4+ Axle	Total
0:00	0	0	0	0	0
0:15	0	0	0	0	0
0:30	0	0	0	0	0
0:45	0	0	0	0	0
1:00	0	0	0	0	0
1:15	0	0	0	0	0
1:30	0	0	0	0	0
1:45	0	0	0	0	0
2:00	0	0	0	0	0
2:15	0	0	0	0	0
2:30	0	0	0	0	0
2:45	0	0	0	0	0
3:00	0	0	0	0	0
3:15	0	0	0	0	0
3:30	0	0	0	0	0
3:45	0	0	0	0	0
4:00	0	0	0	0	0
4:15	0	0	0	0	0
4:30	0	0	0	0	0
4:45	1	0	0	0	1
5:00	0	0	0	0	0
5:15	0	0	0	0	0
5:30	0	0	0	0	0
5:45	2	0	0	0	2
6:00	0	0	0	0	0
6:15	0	0	0	0	0
6:30	0	0	0	0	0
6:45	0	0	0	0	0
7:00	0	0	0	0	0
7:15	0	0	0	0	0
7:30	1	0	0	0	1
7:45	1	0	0	0	1
8:00	0	0	0	0	0
8:15	0	0	0	0	0
8:30	0	0	0	1	1
8:45	0	0	0	0	0
9:00	0	0	0	0	0
9:15	1	0	0	1	2
9:30	0	0	0	0	0
9:45	1	0	0	0	1
10:00	0	1	0	0	1
10:15	0	0	0	0	0
10:30	0	0	0	0	0
10:45	1	0	0	0	1
11:00	0	0	0	0	0
11:15	0	0	0	0	0
11:30	0	0	0	0	0
11:45	0	0	1	0	1



City: Industry
 Location: 17969 Railroad St
Total of all Driveways
 Date: Wednesday, September 13, 2023
 Count Type: Classified Driveway Count

	Entering				
	Pass Veh	Large 2 Axle	3 Axle	4+ Axle	Total
12:00	2	0	0	0	2
12:15	0	0	0	0	0
12:30	0	0	0	0	0
12:45	0	0	0	1	1
13:00	0	0	0	0	0
13:15	0	1	0	0	1
13:30	0	1	1	0	2
13:45	1	0	0	1	2
14:00	0	0	0	0	0
14:15	1	0	0	0	1
14:30	3	1	0	0	4
14:45	0	0	0	0	0
15:00	0	0	0	0	0
15:15	0	1	0	1	2
15:30	0	0	0	0	0
15:45	0	0	0	0	0
16:00	0	0	0	0	0
16:15	1	0	0	0	1
16:30	1	0	0	0	1
16:45	0	0	0	0	0
17:00	0	0	0	0	0
17:15	0	0	0	0	0
17:30	0	0	0	0	0
17:45	0	0	0	0	0
18:00	0	0	0	0	0
18:15	0	0	0	0	0
18:30	0	0	0	0	0
18:45	0	0	0	0	0
19:00	0	0	0	0	0
19:15	0	0	0	0	0
19:30	1	0	0	0	1
19:45	0	0	0	0	0
20:00	0	0	0	0	0
20:15	0	0	0	0	0
20:30	0	0	0	0	0
20:45	0	0	0	0	0
21:00	0	0	0	0	0
21:15	0	0	0	0	0
21:30	0	0	0	0	0
21:45	0	0	0	0	0
22:00	0	0	0	0	0
22:15	0	0	0	0	0
22:30	0	0	0	0	0
22:45	0	0	0	0	0
23:00	0	0	0	0	0
23:15	0	0	0	0	0
23:30	0	0	0	0	0
23:45	0	0	0	0	0
TOTAL	69	5	2	5	81

	Exiting				
	Pass Veh	Large 2 Axle	3 Axle	4+ Axle	Total
12:00	1	0	0	0	1
12:15	0	0	0	0	0
12:30	1	0	0	0	1
12:45	0	0	0	0	0
13:00	0	0	0	1	1
13:15	0	0	0	0	0
13:30	4	1	0	0	5
13:45	3	1	1	0	5
14:00	1	0	0	0	1
14:15	1	0	0	0	1
14:30	17	1	0	1	19
14:45	2	0	0	0	2
15:00	0	0	0	0	0
15:15	2	0	0	0	2
15:30	19	1	0	1	21
15:45	0	0	0	0	0
16:00	2	0	0	0	2
16:15	1	0	0	0	1
16:30	5	0	0	0	5
16:45	0	0	0	0	0
17:00	1	0	0	0	1
17:15	0	0	0	0	0
17:30	0	0	0	0	0
17:45	0	0	0	0	0
18:00	0	0	0	0	0
18:15	0	0	0	0	0
18:30	0	0	0	0	0
18:45	0	0	0	0	0
19:00	0	0	0	0	0
19:15	0	0	0	0	0
19:30	0	0	0	0	0
19:45	0	0	0	0	0
20:00	0	0	0	0	0
20:15	0	0	0	0	0
20:30	0	0	0	0	0
20:45	0	0	0	0	0
21:00	0	0	0	0	0
21:15	1	0	0	0	1
21:30	0	0	0	0	0
21:45	0	0	0	0	0
22:00	0	0	0	0	0
22:15	0	0	0	0	0
22:30	0	0	0	0	0
22:45	0	0	0	0	0
23:00	0	0	0	0	0
23:15	0	0	0	0	0
23:30	0	0	0	0	0
23:45	0	0	0	0	0
TOTAL	69	5	2	5	81



City: Industry
 Location: 17969 Railroad St
Total of all Driveways
 Date: Thursday, September 14, 2023
 Count Type: Classified Driveway Count

	Entering				
	Pass Veh	Large 2 Axle	3 Axle	4+ Axle	Total
0:00	0	0	0	0	0
0:15	0	0	0	0	0
0:30	0	0	0	0	0
0:45	0	0	0	0	0
1:00	0	0	0	0	0
1:15	0	0	0	0	0
1:30	0	0	0	0	0
1:45	0	0	0	0	0
2:00	0	0	0	0	0
2:15	0	0	0	0	0
2:30	0	0	0	0	0
2:45	0	0	0	0	0
3:00	0	0	0	0	0
3:15	1	0	0	0	1
3:30	0	0	0	0	0
3:45	0	0	0	0	0
4:00	0	0	0	0	0
4:15	5	0	0	0	5
4:30	10	0	0	0	10
4:45	7	0	0	0	7
5:00	2	1	0	0	3
5:15	1	0	0	0	1
5:30	5	0	0	0	5
5:45	15	0	0	0	15
6:00	1	0	0	0	1
6:15	1	0	0	0	1
6:30	1	0	0	0	1
6:45	2	0	0	0	2
7:00	2	0	0	0	2
7:15	1	0	0	0	1
7:30	3	0	0	0	3
7:45	1	0	0	0	1
8:00	0	0	0	0	0
8:15	1	0	0	0	1
8:30	0	0	0	0	0
8:45	1	1	0	0	2
9:00	1	0	0	0	1
9:15	0	0	0	0	0
9:30	1	0	0	0	1
9:45	1	0	0	1	2
10:00	0	0	0	0	0
10:15	0	1	1	0	2
10:30	1	0	0	0	1
10:45	0	0	0	0	0
11:00	0	0	0	0	0
11:15	2	1	0	0	3
11:30	0	0	0	0	0
11:45	3	0	0	0	3

	Exiting				
	Pass Veh	Large 2 Axle	3 Axle	4+ Axle	Total
0:00	0	0	0	0	0
0:15	0	0	0	0	0
0:30	0	0	0	0	0
0:45	0	0	0	0	0
1:00	0	0	0	0	0
1:15	0	0	0	0	0
1:30	0	0	0	0	0
1:45	0	0	0	0	0
2:00	0	0	0	0	0
2:15	0	0	0	0	0
2:30	0	0	0	0	0
2:45	0	0	0	0	0
3:00	0	0	0	0	0
3:15	0	0	0	0	0
3:30	0	0	0	0	0
3:45	0	0	0	0	0
4:00	0	0	0	0	0
4:15	0	0	0	0	0
4:30	0	0	0	0	0
4:45	0	0	0	0	0
5:00	1	0	0	0	1
5:15	2	1	0	0	3
5:30	0	0	0	0	0
5:45	1	0	0	0	1
6:00	0	0	0	0	0
6:15	0	0	0	0	0
6:30	0	0	0	0	0
6:45	0	0	0	0	0
7:00	0	0	0	0	0
7:15	0	0	0	0	0
7:30	1	0	0	0	1
7:45	1	0	0	0	1
8:00	0	0	0	0	0
8:15	0	0	0	0	0
8:30	1	0	0	0	1
8:45	0	1	0	0	1
9:00	0	0	0	0	0
9:15	1	0	0	0	1
9:30	0	0	0	0	0
9:45	1	0	0	0	1
10:00	0	0	0	0	0
10:15	0	0	1	1	2
10:30	1	1	0	0	2
10:45	1	0	0	0	1
11:00	1	0	0	0	1
11:15	2	1	0	0	3
11:30	0	0	0	0	0
11:45	0	0	0	0	0



City: Industry
 Location: 17969 Railroad St
Total of all Driveways
 Date: Thursday, September 14, 2023
 Count Type: Classified Driveway Count

	Entering				
	Pass Veh	Large 2 Axle	3 Axle	4+ Axle	Total
12:00	1	0	0	0	1
12:15	0	1	0	0	1
12:30	0	0	0	0	0
12:45	1	0	0	0	1
13:00	0	0	0	0	0
13:15	0	0	0	1	1
13:30	0	0	0	0	0
13:45	1	0	0	0	1
14:00	0	0	0	1	1
14:15	2	0	0	0	2
14:30	1	0	0	1	2
14:45	2	0	0	0	2
15:00	1	1	0	0	2
15:15	1	0	0	0	1
15:30	1	2	0	0	3
15:45	0	0	0	0	0
16:00	0	0	0	0	0
16:15	0	0	0	0	0
16:30	2	0	0	0	2
16:45	1	0	0	0	1
17:00	0	0	0	0	0
17:15	0	0	0	0	0
17:30	0	0	0	0	0
17:45	0	0	0	0	0
18:00	0	0	0	0	0
18:15	0	0	0	0	0
18:30	0	0	0	0	0
18:45	0	0	0	0	0
19:00	0	0	0	0	0
19:15	0	0	0	0	0
19:30	0	0	0	0	0
19:45	0	0	0	0	0
20:00	0	0	0	0	0
20:15	0	0	0	0	0
20:30	0	0	0	0	0
20:45	0	0	0	0	0
21:00	0	0	0	0	0
21:15	0	0	0	0	0
21:30	0	0	0	0	0
21:45	0	0	0	0	0
22:00	0	0	0	0	0
22:15	0	0	0	0	0
22:30	0	0	0	0	0
22:45	0	0	0	0	0
23:00	0	0	0	0	0
23:15	0	0	0	0	0
23:30	0	0	0	0	0
23:45	0	0	0	0	0
TOTAL	83	8	1	4	96

	Exiting				
	Pass Veh	Large 2 Axle	3 Axle	4+ Axle	Total
12:00	2	0	0	0	2
12:15	0	1	0	0	1
12:30	0	0	0	0	0
12:45	1	0	0	0	1
13:00	0	0	0	0	0
13:15	0	0	0	1	1
13:30	4	0	0	0	4
13:45	1	0	0	0	1
14:00	0	0	0	0	0
14:15	0	0	0	1	1
14:30	22	0	0	0	22
14:45	2	0	0	1	3
15:00	3	1	0	0	4
15:15	3	0	0	0	3
15:30	16	2	0	0	18
15:45	3	0	0	0	3
16:00	2	0	0	0	2
16:15	1	0	0	0	1
16:30	7	0	0	0	7
16:45	2	0	0	0	2
17:00	0	0	0	0	0
17:15	0	0	0	0	0
17:30	0	0	0	0	0
17:45	0	0	0	0	0
18:00	0	0	0	0	0
18:15	0	0	0	0	0
18:30	0	0	0	0	0
18:45	0	0	0	0	0
19:00	0	0	0	0	0
19:15	0	0	0	0	0
19:30	0	0	0	0	0
19:45	0	0	0	0	0
20:00	0	0	0	0	0
20:15	0	0	0	0	0
20:30	0	0	0	0	0
20:45	0	0	0	0	0
21:00	0	0	0	0	0
21:15	0	0	0	0	0
21:30	0	0	0	0	0
21:45	0	0	0	0	0
22:00	0	0	0	0	0
22:15	0	0	0	0	0
22:30	0	0	0	0	0
22:45	0	0	0	0	0
23:00	0	0	0	0	0
23:15	0	0	0	0	0
23:30	0	0	0	0	0
23:45	0	0	0	0	0
83	8	1	4	96	