



State of California - Department of Fish and Wildlife
2024 ENVIRONMENTAL DOCUMENT FILING FEE
CASH RECEIPT
 DFW 753.5a (REV. 01/01/24) Previously DFG 753.5a

RECEIPT NUMBER: 39-11042024-354
STATE CLEARINGHOUSE NUMBER (If applicable)

SEE INSTRUCTIONS ON REVERSE. TYPE OR PRINT CLEARLY.

LEAD AGENCY SAN JOAQUIN COUNTY PUBLIC WORKS	LEAD AGENCY EMAIL	DATE 11/04/2024
COUNTY/STATE AGENCY OF FILING SAN JOAQUIN	DOCUMENT NUMBER 39-11042024-354	

PROJECT TITLE
HANDEL ROAD RESURFACING

PROJECT APPLICANT NAME SAN JOAQUIN COUNTY PUBLIC WORKS	PROJECT APPLICANT EMAIL	PHONE NUMBER 209-468-3085 MARILISSA
PROJECT APPLICANT ADDRESS 1810 EAST HAZELTON AVE	CITY STOCKTON	STATE CA
		ZIP CODE 95205

PROJECT APPLICANT (Check appropriate box)

Local Public Agency
 School District
 Other Special District
 State Agency
 Private Entity

CHECK APPLICABLE FEES:

- Environmental Impact Report (EIR) \$4,051.25 \$ _____
- Mitigated/Negative Declaration (MND)(ND) \$2,916.75 \$ _____
- Certified Regulatory Program (CRP) document - payment due directly to CDFW \$1,377.25 \$ _____
- Exempt from fee
 - Notice of Exemption (attach)
 - CDFW No Effect Determination (attach)
 - Fee previously paid (attach previously issued cash receipt copy)
- Water Right Application or Petition Fee (State Water Resources Control Board only) \$850.00 \$ _____
- County documentary handling fee \$ _____ \$50.00
- Other \$ _____

PAYMENT METHOD:

- Cash
 Credit
 Check
 Other
 TOTAL RECEIVED \$ _____ \$50.00

SIGNATURE 	AGENCY OF FILING PRINTED NAME AND TITLE Kelley McHugh ,Deputy
---------------	--



NOTICE OF EXEMPTION

TO: Office of Planning and Research
CEQAnet Web Portal
<https://ceqasubmit.opr.ca.gov/>

FROM: San Joaquin County
Department of Public Works
1810 East Hazelton Avenue
Stockton, California 95205

County Clerk
County of San Joaquin California
44 North San Joaquin Street, Suite 260
Stockton, California 95202

Project Title: Handel Road Resurfacing

Project Location: See attached vicinity map

Description of Nature, Purpose, and Beneficiaries: See attached project description

Public Agency Approving Project: San Joaquin County Public Works Department

Name of Agency Carrying Out Project: San Joaquin County Public Works Department

This is to advise that the San Joaquin County Public Works Department has approved the above described project on 10/17/2024 and has made the determination that the project is exempt due to the following:

Exempt Status (check one):

- Ministerial (Sec. 21080 (b) (1); 15268)
- Declared Emergency (Sec. 21080 (b) (3); 15269(a))
- Emergency Project (Sec. 21080 (B) (4); 15269(b) (c))
- Categorical Exemption: Existing Facilities (Sec. 15301 (c))
- Statutory Exemption (Sec. 15282(l))

Reason(s) why project is exempt: The project will repair an existing road and will not result in any major alterations to the configuration of the road. No additional vehicle travel lanes will be constructed.

Lead Agency Contact Person: Marilissa Loera, Senior Planner, (209) 468-3085

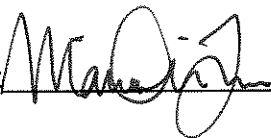
Signature:  Title: Senior Planner Date: 11/4/2024

HANDEL ROAD RESURFACING

Project Description

Project Location:

Handel Road: Alpine Road to eastern end. **See attached Vicinity Map.**

Project Justification:

The original construction date and existing roadway structure of Handel Road are unknown. The roadway is a two-lane 16 feet wide. The road has been periodically chip sealed with the most recent in 2014.

Existing pavement within the project location exhibits transverse and alligator cracking. There is also minor rutting.

Scope of Work:

The project will consist of:

1. Resurfacing existing roadway (16-foot-wide) with 0.25-foot Hot Mix Asphalt (HMA) (Type A).
2. Repairing pavement structure failure areas with full depth 0.25-foot HMA (Type A).
3. Paving 8-foot-wide driveways.
4. Replenishing 6-foot-wide gravel shoulders with specific slopes (2'/8% and 4'/conform).
5. Applying penetration treatment along curves and at all intersection radii plus 50 feet or to conform.
6. Adjusting existing survey monument frames and covers to finish grade.
7. Adjusting existing facilities to finish grade.

Environmental Setting:

In these portions of the San Joaquin County, land usage is primarily **rural with single family homes.**

There are many large trees adjacent to the project area. Nesting and migratory birds, protected by the Migratory Bird Treaty Act, may nest within these trees. Furthermore, the Swainson's Hawk, a raptor species of concern within the State of California and listed as threatened may nest adjacent to or within the project area. A pre-construction survey for nesting Swainson's Hawks and other migratory birds is recommended if construction is scheduled to occur from February 15th to September 1st.

Beneficiaries:

The public will see increased safety and fewer hazards with this well-maintained road. Overall, there will be reduced maintenance concerns and more reliability within the project area.

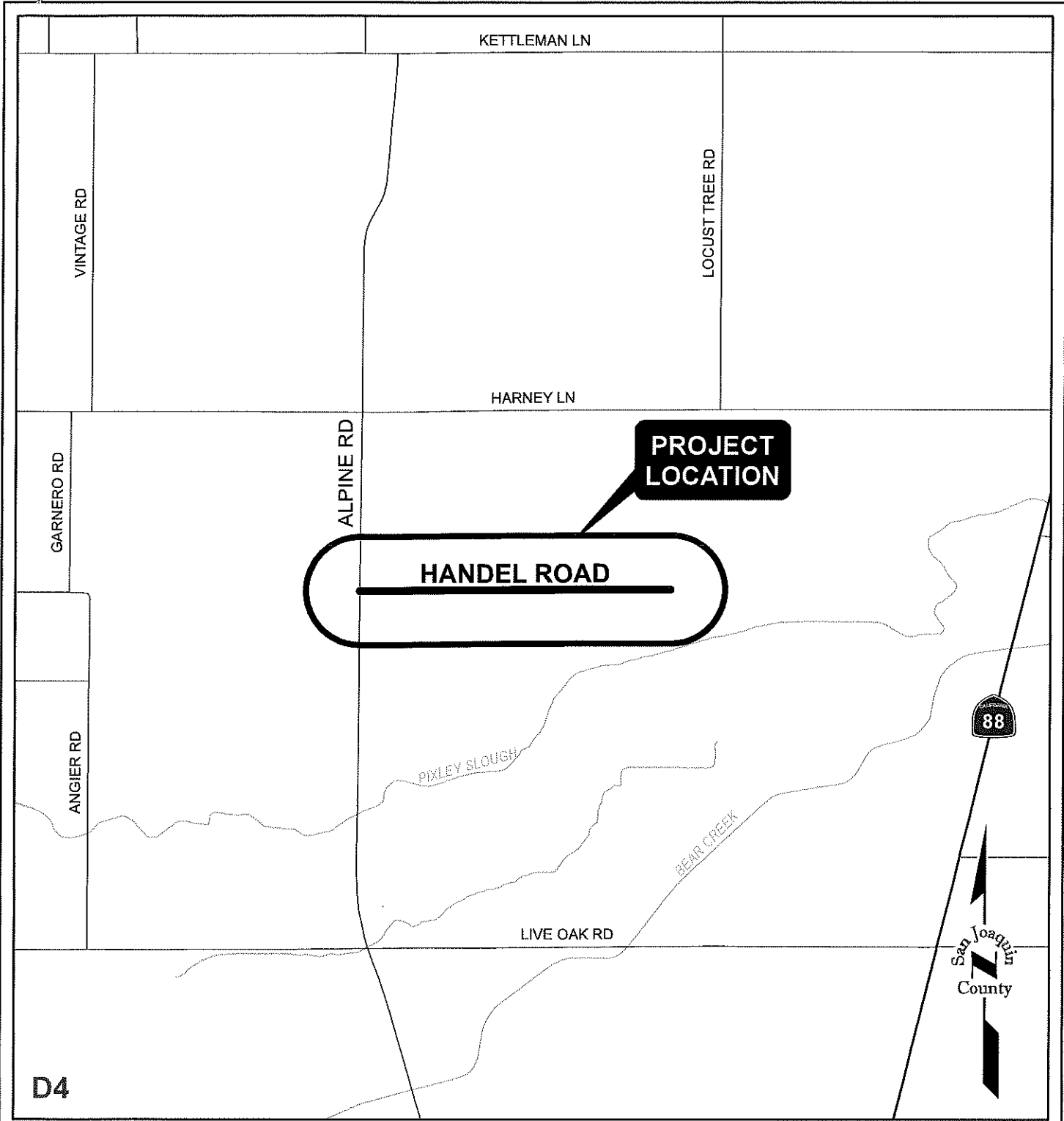

D4

NO SCALE

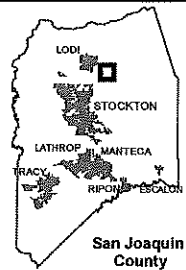

Vicinity Map
HANDEL ROAD RESURFACING
 (Alpine Road to East End)

