



State of California - Department of Fish and Wildlife  
**2024 ENVIRONMENTAL DOCUMENT FILING FEE**  
**CASH RECEIPT**  
 DFW 753.5a (REV. 01/01/24) Previously DFG 753.5a

RECEIPT NUMBER:  
39-11072024-362

STATE CLEARINGHOUSE NUMBER (if applicable)

SEE INSTRUCTIONS ON REVERSE. TYPE OR PRINT CLEARLY.

LEAD AGENCY SAN JOAQUIN COUNTY PUBLIC WORKS	LEAD AGENCY EMAIL	DATE 11/07/2024
--	-------------------	--------------------

COUNTY/STATE AGENCY OF FILING SAN JOAQUIN	DOCUMENT NUMBER 39-11072024-362
--	------------------------------------

PROJECT TITLE  
SUNNYSIDE ESTATES MAINTENANCE DISTRICT WATER MAIN UPGRADE

PROJECT APPLICANT NAME SAN JOAQUIN COUNTY PUBLIC WORKS	PROJECT APPLICANT EMAIL	PHONE NUMBER (209) 468-3085
---	-------------------------	--------------------------------

PROJECT APPLICANT ADDRESS 1810 EAST HAZELTON AVE	CITY STOCKTON	STATE CA	ZIP CODE 95205
---	------------------	-------------	-------------------

PROJECT APPLICANT (Check appropriate box)

Local Public Agency    
  School District    
  Other Special District    
  State Agency    
  Private Entity

CHECK APPLICABLE FEES:

<input type="checkbox"/> Environmental Impact Report (EIR)	\$4,051.25	\$ _____
<input type="checkbox"/> Mitigated/Negative Declaration (MND)(ND)	\$2,916.75	\$ _____
<input type="checkbox"/> Certified Regulatory Program (CRP) document - payment due directly to CDFW	\$1,377.25	\$ _____

Exempt from fee  
      Notice of Exemption (attach)  
      CDFW No Effect Determination (attach)  
 Fee previously paid (attach previously issued cash receipt copy)

<input type="checkbox"/> Water Right Application or Petition Fee (State Water Resources Control Board only)	\$850.00	\$ _____
<input checked="" type="checkbox"/> County documentary handling fee		\$ _____ \$50.00
<input type="checkbox"/> Other		\$ _____

PAYMENT METHOD:

Cash   
  Credit   
  Check   
  Other   
 TOTAL RECEIVED   
 \$ \_\_\_\_\_ \$50.00

SIGNATURE <b>X</b> <i>Samantha Landrum</i>	AGENCY OF FILING PRINTED NAME AND TITLE Samantha E. Treat-Landrum, Deputy
---	--



## NOTICE OF EXEMPTION

TO:  Office of Planning and Research  
CEQAnet Web Portal  
<https://ceqasubmit.opr.ca.gov/>

FROM: San Joaquin County  
Department of Public Works  
1810 East Hazelton Avenue  
Stockton, California 95205

County Clerk  
County of San Joaquin California  
44 North San Joaquin Street, Suite 260  
Stockton, California 95202

Project Title: Sunnyside Estates Maintenance District Water Main Upgrade

Project Location: See attached vicinity map

Description of Nature, Purpose, and Beneficiaries: See attached project description

Public Agency Approving Project: San Joaquin County Public Works Department

Name of Agency Carrying Out Project: San Joaquin County Public Works Department

This is to advise that the San Joaquin County Public Works Department has approved the above described project on 10/17/24 and has made the determination that the project is exempt due to the following:

Exempt Status (check one):

- Ministerial (Sec. 21080 (b) (1); 15268)
- Declared Emergency (Sec. 21080 (b) (3); 15269(a))
- Emergency Project (Sec. 21080 (B) (4); 15269(b) (c))
- Categorical Exemption: Existing Facilities (Sec. 15301(b), 15304(f))
- Statutory Exemption (Sec. 15282(l))

Reason(s) why project is exempt: The project will replace deficient portions of the existing water distribution system to decrease leaks.

Lead Agency Contact Person: Marilissa Loera, Senior Planner, (209) 468-3085

Signature:  Title: Senior Planner Date: 11/7/2024

# SUNNYSIDE ESTATES MAINTENANCE DISTRICT WATER MAIN UPGRADE

## Project Description

### **Project Location:**

**Sunnyside Estates Maintenance District:** Kristen Court, Hartley Lane, and Tehama Drive. **See attached Vicinity Map.**

### **Project Justification:**

Sunnyside Estates Maintenance District, established in 1967 in Lodi, currently provides water services to 21 properties. The existing water mains, also installed in 1967, consist of 4-to-6-inch steel pipes.

The existing water distribution system is aging and is prone to leaking water mains and service laterals, residential water service connections are unmetered.

### **Scope of Work:**

The project will consist of:

1. Replacing approximately 1,600 feet of aging, leaking pipelines, along with necessary valves, water service laterals, fire hydrants, and various pipeline appurtenances.
2. Upgrading the water mains to 8-inch polyvinyl chloride (PVC) C900 piping and installing new 1 inch water meters at all service connections according to the City of Lodi standard specifications. The new water mains will be installed within the roadway on Kristen Court, Hartley Lane, and Tehama Drive.
3. Installing an additional 280 feet of water main in a Public Utility Easement (P.U.E.) to connect the piping on Kristen Court to Tehama Drive.

### **Environmental Setting:**

In these portions of the San Joaquin County, land usage is primarily **residential with single family homes.**

**There are many large trees adjacent to the project area.** Nesting and migratory birds, protected by the Migratory Bird Treaty Act, may nest within these trees. Furthermore, the Swainson's Hawk, a raptor species of concern within the State of California and listed as threatened may nest adjacent to or within the project area. A pre-construction survey for nesting Swainson's Hawks and other migratory birds is recommended if construction is scheduled to occur from February 15<sup>th</sup> to September 1<sup>st</sup>.

### **Beneficiaries:**

The public will see decreased maintenance needed for the water distribution system, resulting in smoother operations. Additionally, the district will conserve water by eliminating water losses through leaks in the water main.

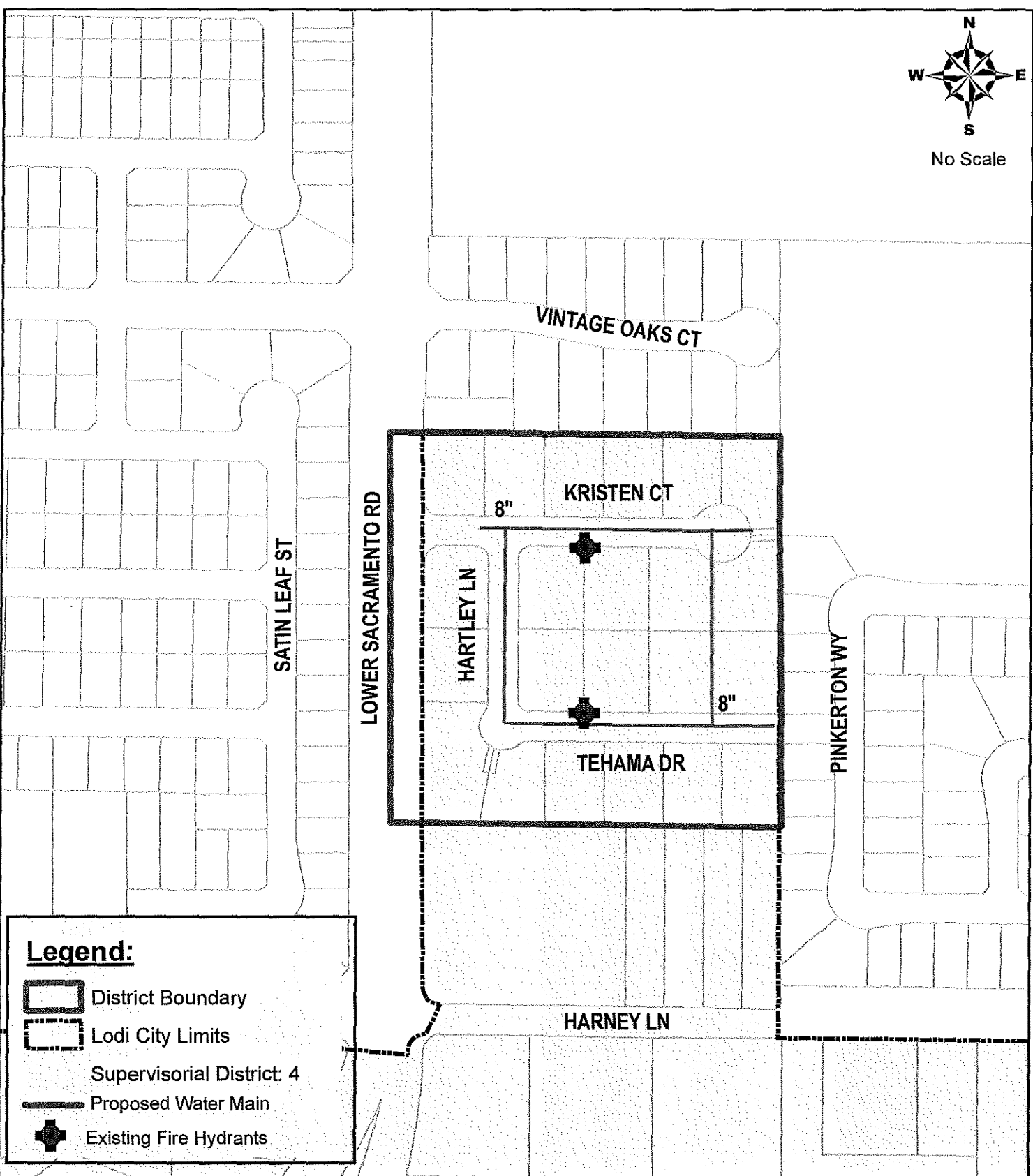

**Legend:**

- District Boundary
- Lodi City Limits
- Supervisorial District: 4
- Proposed Water Main
- Existing Fire Hydrants

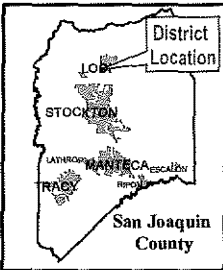

**VICINITY MAP**  
**SUNNYSIDE ESTATES WATER MAIN UPGRADE**

**SAN JOAQUIN COUNTY**  
 Department of Public Works, 1810 E. Hazelton Ave., Stockton, CA 95205  
 The County of San Joaquin does not warrant the accuracy, completeness, or suitability for any particular purpose.  
 The Information on this map is not intended to replace engineering, financial or primary records research.

