

THIS PRINT AND ITS COPYRIGHT ARE THE PROPERTY OF ELEMENTAL

NOT VALID FOR CONSTRUCTION

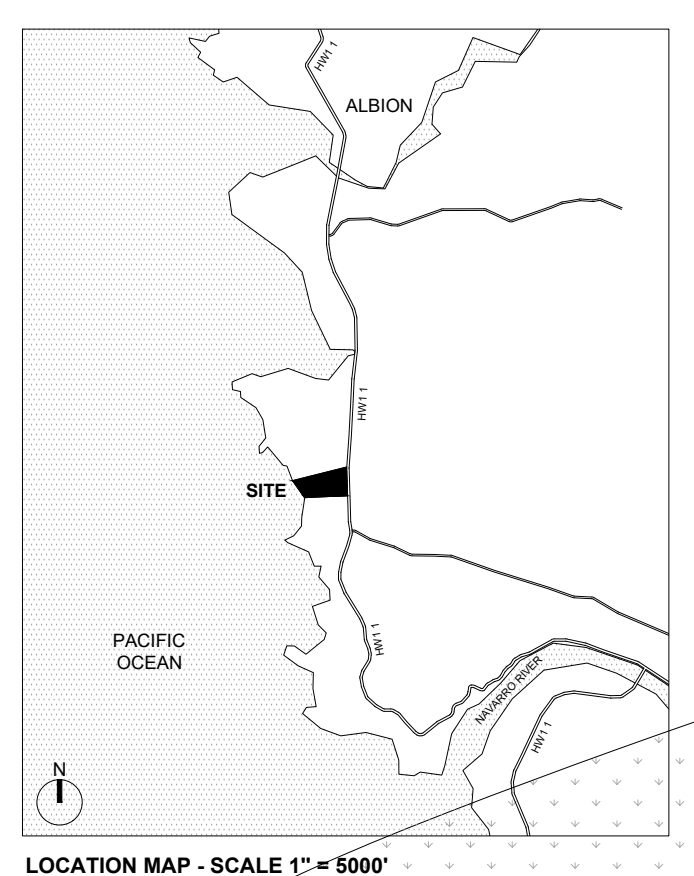

PROPERTY INFORMATION
 Assessor's Parcel 123-250-03
 2300 N Hwy 1, Albion, CA 95410
 12.55 Acres

PERMITS AND APPROVALS INFORMATION
 Coastal Development Permit: 1-81-85 (vested), 2024-004
 Septic Operations Permit: ST2022 (permitted, inspected and approved; current operations permit)
 Undergroud Utilities, Power, Irrigation: BF_2019-0593 (permitted, inspected and approved)
 Water Well Permit: 10960F - 1222F (operational)
 California DOT Highway Encroachment Permit: 0119-6-RS-3443 (approved and current)
 California State Fire Safe Regulations Conditional Approval: 114-22 (approved)
 2023 Biological Scoping Survey by Dark Gulch Environmental Consulting: 5-4-2023
 2023 Geotechnical Investigation by Bruning and Associates: 13264.01

GENERAL NOTES
 • All exterior lighting shall be downcast and shielded to prevent light and glare beyond the parcel boundaries.
 • The discharge of pollutants to any storm drainage system is prohibited.
 • No solid waste, petroleum byproducts, soil particulate, construction waste materials, or wastewater generated on construction sites or by construction activities shall be placed, conveyed or discharged into the street, gutter or storm drain system.

DIRECTORY: V:\07\ALB03_ALBH_DESIGN\01-ARCH\01-WP_ DWG\ALBH-NEW-PERMIT.DWG (PLOTTED ON: 2/12/2025 10:14:44 AM) BY USER: MC



REFERENCE IMAGE

01 SITE PLAN
SCALE: 1"=40'

DESIGN ARCHITECT
ELEMENTAL
EXECUTIVE ARCHITECT
SPARANO + MOONEY ARCHITECTURE
PROJECT TITLE:
REIMANN-SCHILKE RESIDENCE
SITE:
2300 N HIGHWAY 1, ALBION, CA 95410
CLIENT:
MARTIN REIMANN OLIVER SCHILKE
CONTENT:
SITE PLAN
ISSUED FOR:
NEW PERMIT APPLICATION
FILENAME:
ALBH-NEW-PERMIT.dwg
VERS DATE STAGE CHK
E 31/01/2025 DC DT
D 14/03/2024 DC DT
C 06/01/2024 DC DT
B 28/12/2023 DC DT
A 06/02/2023 DC DT
- 14/10/2022 DC DT
SHEET NUMBER: 01 OF 03

A01

DATE: 31/01/2025 SCALE: 1" = 40'
REV: E SIZE: ARCH D