



**RECORDING REQUESTED
WHEN RECORDING MAIL TO:**

County of Sacramento
Planning and Environmental Review
827 7th Street, Room 225
Sacramento, CA 95814
CONTACT PERSON: Julie Newton
TELEPHONE: (916)874-6141

SPACE ABOVE RESERVED FOR RECORDER'S USE

NOTICE OF EXEMPTION

Project Title:

AC Overlay 2025 Phase B (Contract No. 4649)

Control Number:

PLER2024-00176

Project Location:

Various – see table below and attached maps

Segment	Street	Beginning	End	Map
1	FF01B	South of Manzanita, North of Palm Avenue		1
2	FO08B	Buchanan Drive area		2
3	FO14C	Hidden Valley Circle area		3
4	TC04A	South of Marconi Avenue, North of El Camino Avenue		4
5	Fair Oaks Boulevard	Manzanita Avenue	Marshall Avenue	5
6	Elkhorn Boulevard	18 th Street	26 th Street	6
7	Grant Line Road	Jackson Road	Keifer Boulevard	7
8	Bradshaw Road	Folsom Boulevard	Hyannis Way	8
9	Isleton Road	1,100' North of Andrus Island Road	3,300' South of Andrus Island Road	9
10	Twin Cities Road	Cosumnes River Bridge	Pellandini Road	10

APN:

N/A – project is located within public roadways

Description of Project:

Roadways within the stated limits will receive a conventional or rubberized asphalt concrete overlay or a slurry seal. Associated work includes constructing ADA compliant curb ramps, repairing damaged pavement areas, conform grinding, adjusting manholes, and striping the roadways. All elements of the project will be within the developed roadway, and no new impervious surface area will be installed.

Name of Public Agency Approving Project:

Sacramento County – ceqa@saccounty.gov

Person or Agency Carrying out Project:

Daniel Lockett
 County of Sacramento, Department of Transportation
 4100 Traffic Way, Sacramento, CA 95827
 (916) 876-5850
 lockettd@saccounty.gov

Exempt Status:

Categorical Exemption (PRC Section 21084; CEQA Guidelines Sections 15300 -15333):

- CEQA Guidelines Section 15301 – Existing Facilities

Reasons Why Project is Exempt:

The project will be completed within the existing road rights-of-way and will not require the removal of structures, vegetation or trees. The project will result in the continued use of the existing facilities with little or no expansion of use and is therefore exempt from the provisions of CEQA.

Section 15300.2-Exceptions

Section 15300.2 of the CEQA Guidelines, Exceptions, provides conditions under which categorical exemptions are inapplicable. Review of the Project indicates that it will not violate any of the exceptions, as described in the following section.

1. *For Classes 3, 4, 5, 6, and 11, will the project have an impact on an environmental resource of hazardous or critical concern where designated, precisely mapped, and officially adopted pursuant to law by federal, state, or local agencies?*

The Project Exemption is not one of the above Classes and this exception does not apply.

2. *Will cumulative impacts be considerable because successive projects of the same type will occur at the same place over time?*

Implementation of the project will not result in significant impacts and consists of maintenance of existing facilities. Therefore, no cumulative impacts will result from the project and successive projects of the same type and at the same place over time.

3. *Is there a reasonable possibility that the activity will have a significant effect on the environment due to unusual circumstances?*

There are no known unusual circumstances that will have a significant effect on the environment. Construction of the project will involve earthwork and therefore is subject to applicable requirements by rules such as SMAQMD Rule 403 – fugitive dust.

4. *Will the project result in damage to scenic resources, including but not limited to trees, historic buildings, rock outcroppings, or similar resources within a highway officially designated as a scenic highway?*

A portion of Isleton Road from Isleton Bridge to State Route 160 at Paintersville Bridge is designated as a County Scenic Highway. The project includes a segment of this highway. However, the project will be completed within existing road right of way and does not include expansion of the roadway facilities or the removal of existing trees, buildings, rock outcroppings or similar resources. Therefore, implementation of the project would not result in damage to scenic resources within officially designated scenic highways.

5. *Is the project located on a site which is included on any list compiled pursuant to Section 65962.5 of the Government Code?*

The roadways are not included on any list compiled pursuant to Section 65962.5 of the Government Code. Therefore, there will be no impact related to being located on a hazardous waste site.

6. *Will the project cause a substantial adverse change in the significance of a historic resource?*

The roadways do not contain any historical resources.

Copy To:

County Clerk of Sacramento

County Clerk

3636 American River Drive, Suite 110

Sacramento, CA 95864

Office of Land Use and Climate Innovation

State Clearinghouse

1400 10th Street

Sacramento, CA 95814

Julie Newton

ENVIRONMENTAL COORDINATOR OF
SACRAMENTO COUNTY, STATE OF CALIFORNIA

AC Overlay Project 2025 Phase B Location Maps

Map 6



FF01B
(S/O Leader Avenue to N/O Palm Avenue)

AC Overlay Project 2025 Phase B Location Maps

Map 9



FO08B Partial
(Buchanan Drive – Kenneth Ave)

AC Overlay Project 2025 Phase B Location Maps

Map 8

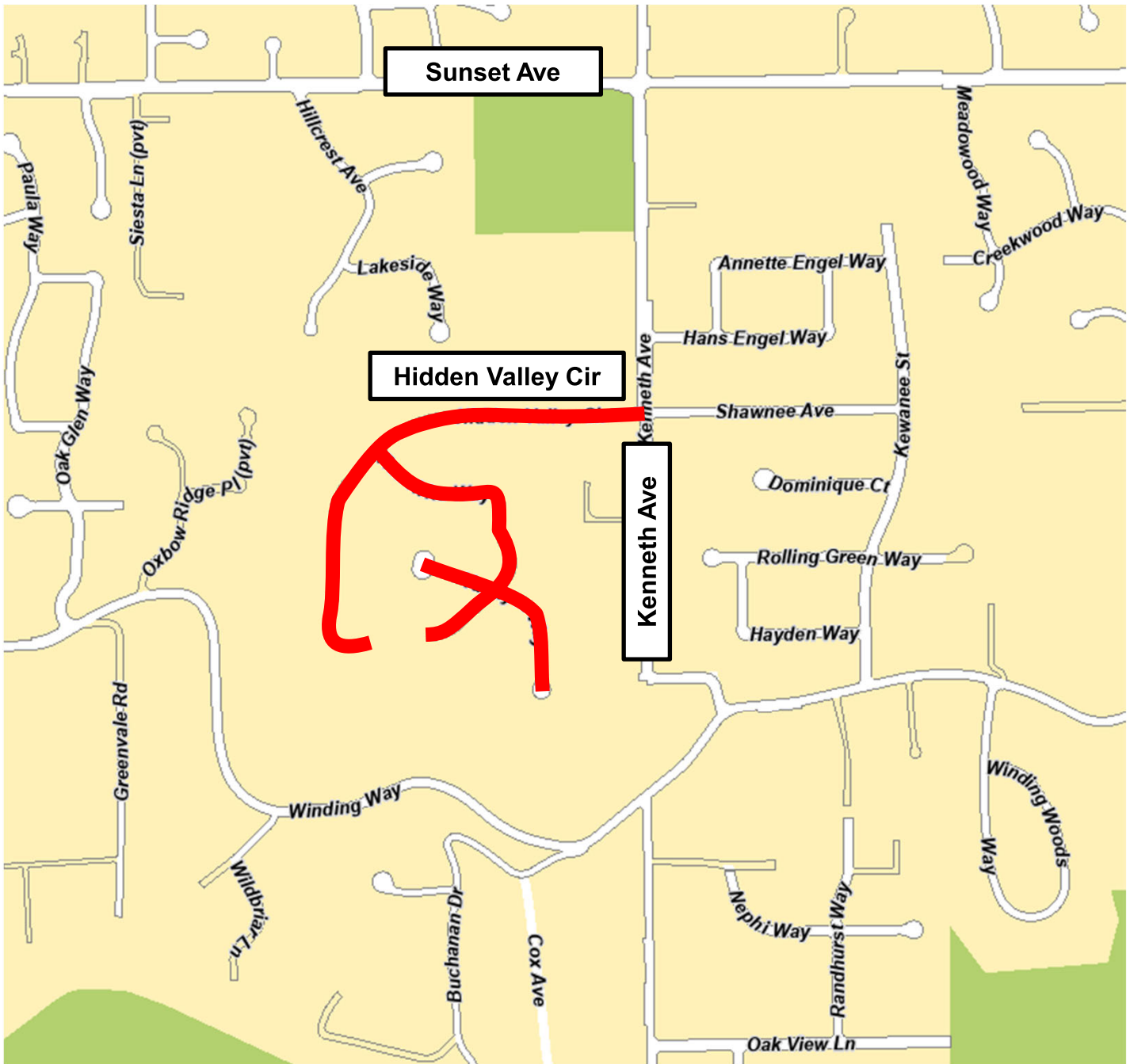

FO14C Partial
(Hidden Valley Circle)

AC Overlay Project 2025 Phase B Location Maps

Map 10

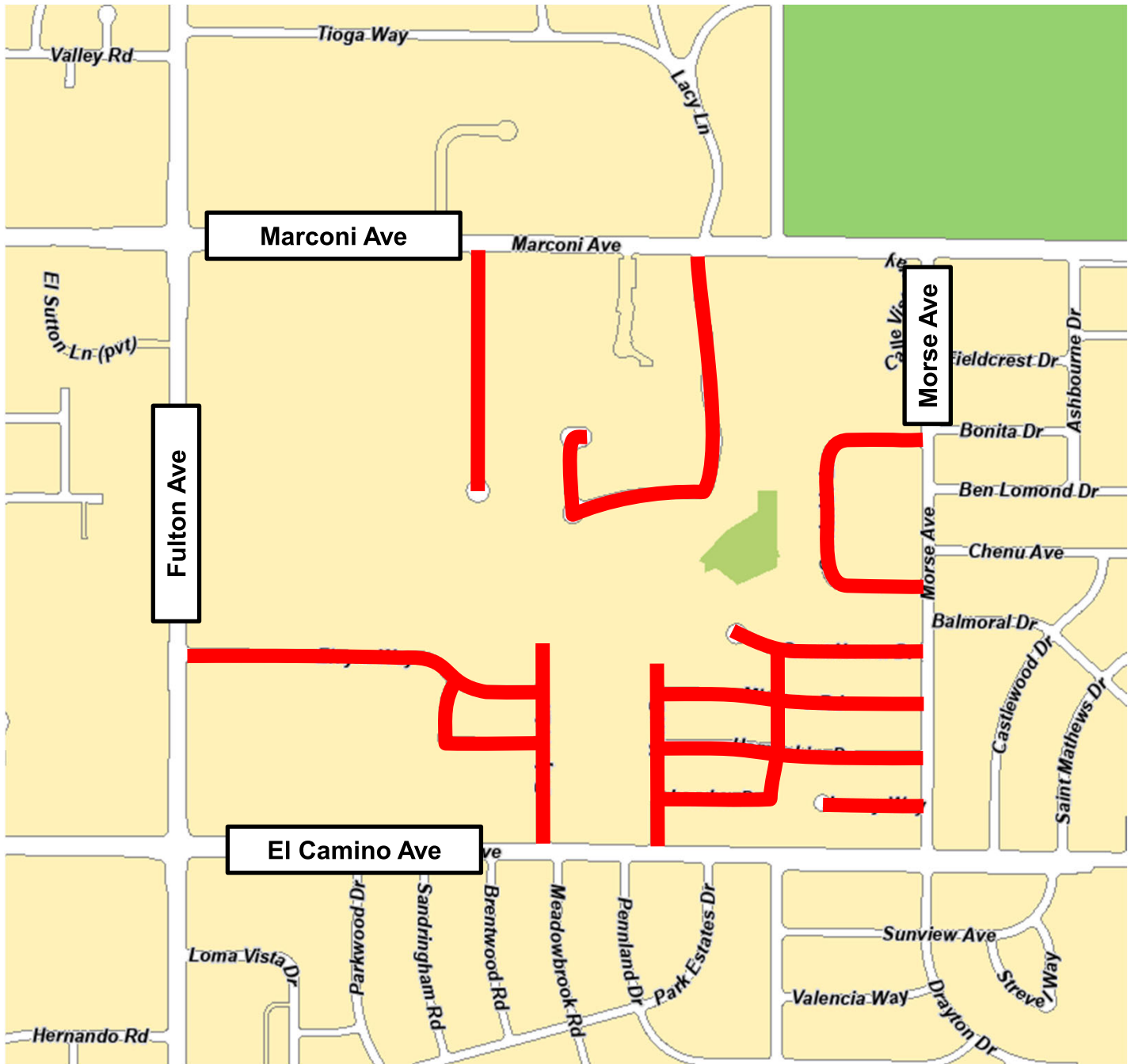

TC04A
(S/O Marconi Avenue to N/O El Camino Avenue)

AC Overlay Project 2025 Phase B Location Maps

Map 7



Fair Oaks Boulevard
(Manzanita Avenue to Marshall Avenue)

AC Overlay Project 2025 Phase B Location Maps

Map 1



Elkhorn Boulevard
(18th Street to 26th Street)

AC Overlay Project 2025 Phase B Location Maps

Map 2



Grant Line Road
(Jackson Road to Kiefer Boulevard)

AC Overlay Project 2025 Phase B Location Maps

Map 3

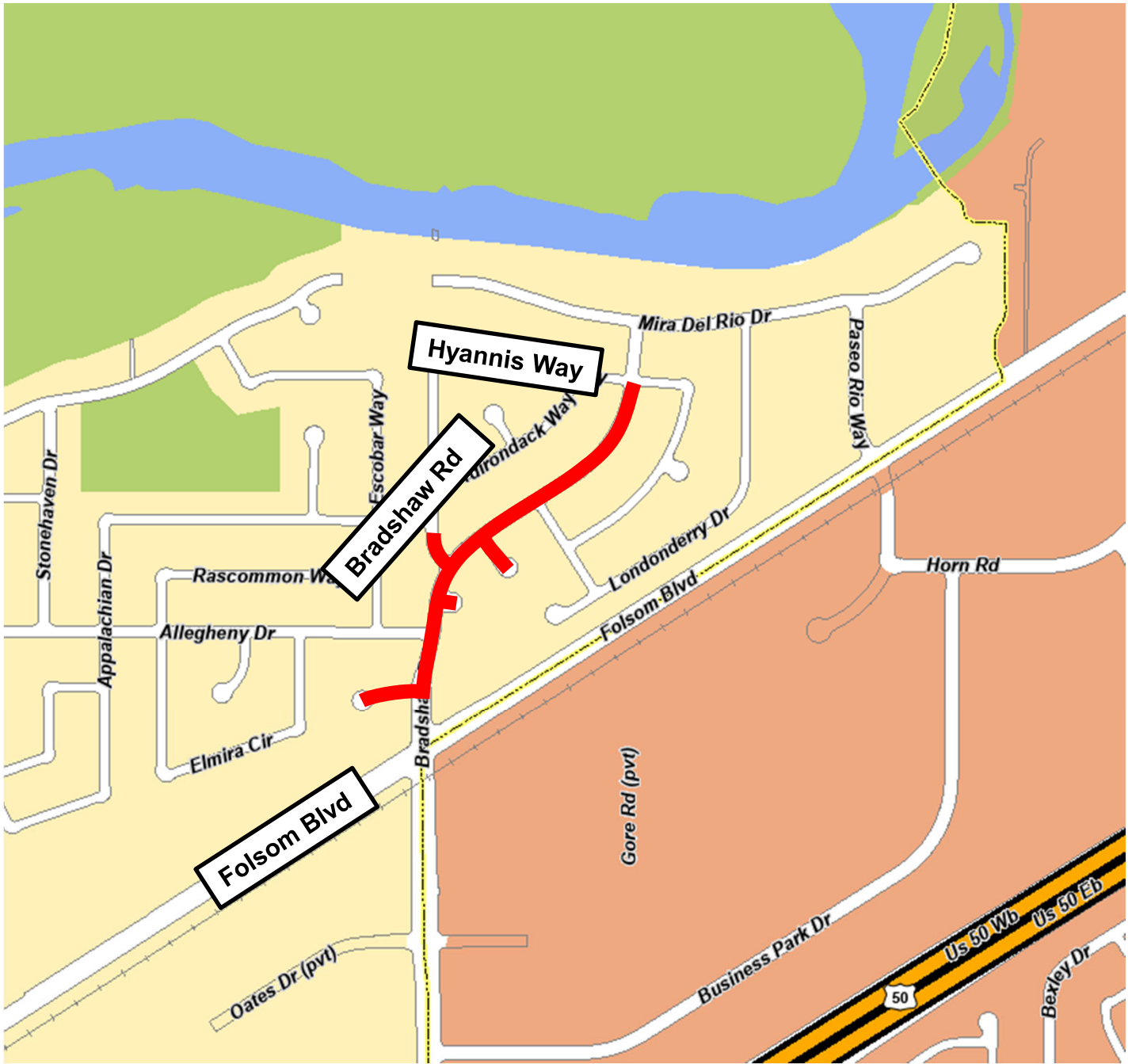

Bradshaw Road
(Folsom Boulevard to Hyannis Way)

AC Overlay Project 2025 Phase B Location Maps

Map 4

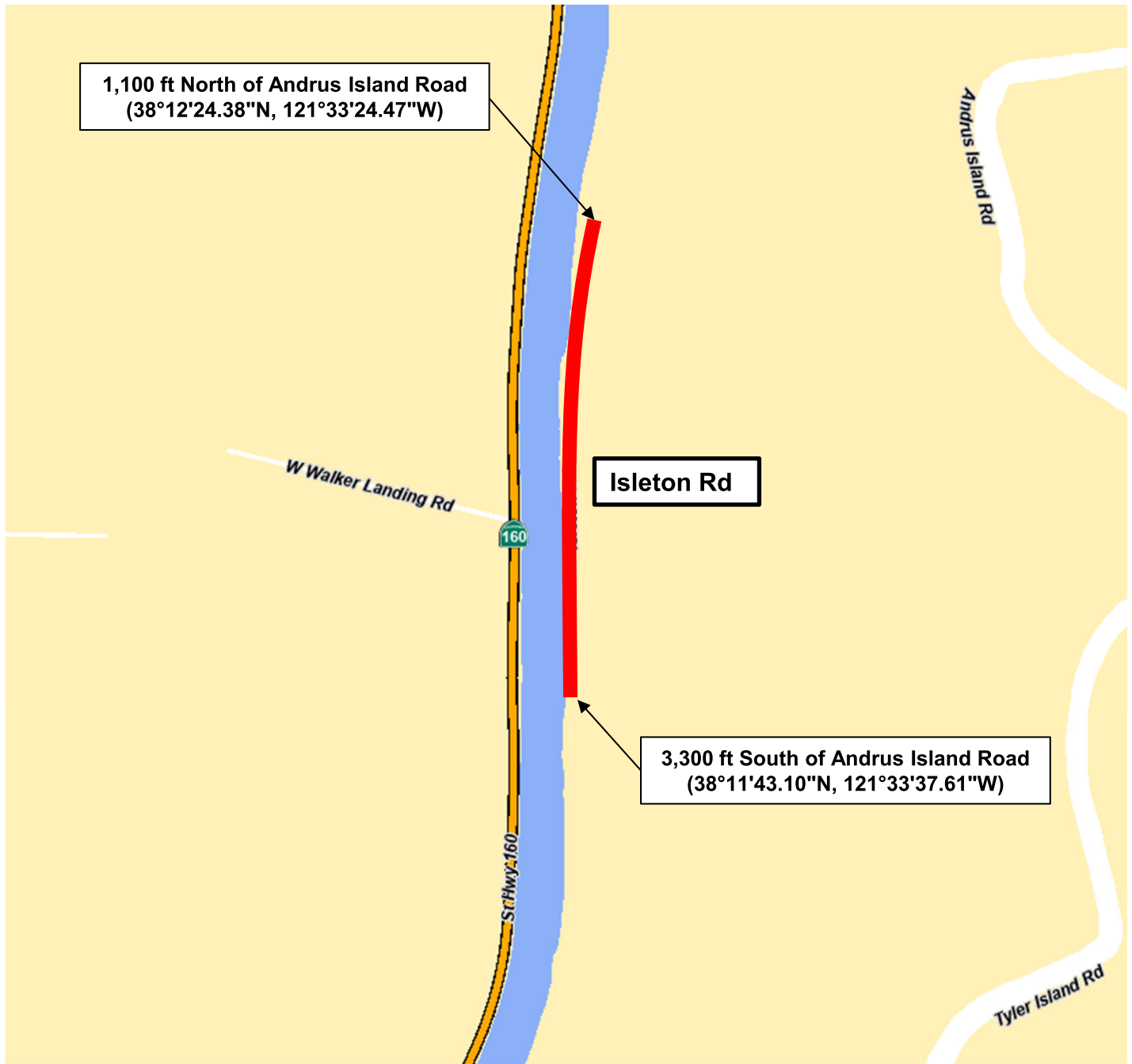

Isleton Road
(1,100 ft north of Andrus Island Rd to 3,300 ft south of Andrus Island Rd)

AC Overlay Project 2025 Phase B Location Maps

Map 5

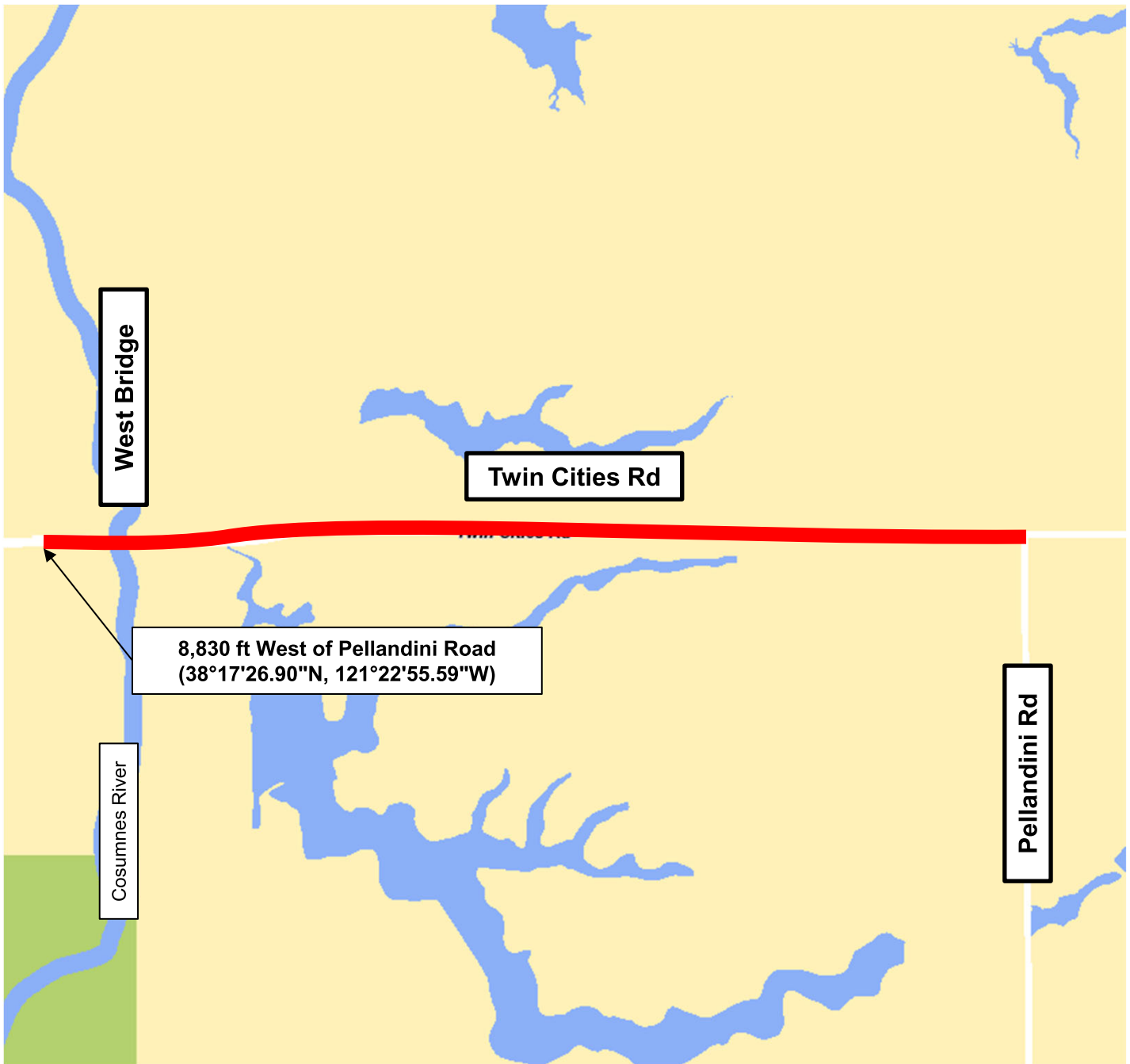

Twin Cities Road
(Cosumnes River Bridge to Pellandini Avenue)