

## Appendix C Cultural Letter Report

## Appendix

*This page intentionally left blank.*

June 4, 2024

Dwayne Mears, Principal  
PlaceWorks  
3 MacArthur Place, Suite 1100  
Santa Ana, California 92707

**RE:** PlaceWorks Santa Fe Elementary School Expansion Project, Porterville, Tulare County, California

Dear Mr. Mears:

This letter documents the completion of a Class III inventory/Phase I cultural resources survey for the PlaceWorks Santa Fe Elementary School Expansion Project (Project), Porterville, Tulare County, California. The Project is proposing the construction of new preschool and TK/kindergarten classrooms in addition to the existing school grounds. The proposed Project totals 5.7 acres in which all staging, laydown, and construction activities will occur. The Project study area is situated southeast of downtown Porterville in Tulare County, California (Figure 1). Specifically, the study area is in Section 36 (T21S/R27E; MDBM) of the Porterville USGS 7.5' quadrangle map. This study was conducted by ASM Affiliates to assist in compliance with the California Environmental Quality Act (CEQA). Peter A. Carey, M.A. RPA, served as Principal Investigator.

In summary, four previous studies have been conducted within the Project area, and three previously recorded cultural resources are mapped within the Project area. Nine previous studies have been conducted within 0.5-mile of the Project area and six previously recorded resources have been recorded within 0.5-mile of the Project area. No cultural resources of any kind were identified within the Project area during the survey, and a determination of no adverse effect/no significant impact is recommended for the Project.

### **Project Description and Location**

- The proposed Project consists of the construction of a new preschool and TK/kindergarten classrooms for the Santa Fe Elementary School. The Project is located at 286 E. Orange Avenue in a suburban area in Porterville. Major cross streets are South A Street to the west and East Locust Avenue to the southeast. The property is bounded by residential neighborhoods on all sides except for a large, cleared lot to the northwest.

### **Method of Study**

#### ***Records Search***

A records search was completed at the Southern San Joaquin Valley Information Center (IC), California State University, Bakersfield, on February 20, 2024. The records search review was completed in order to determine whether the study area had been previously surveyed for cultural resources, and/or whether any such resources were known to exist on it. The records search was

completed to determine: (i) if prehistoric or historical archaeological sites had previously been recorded within the study area; (ii) if the Project area had been systematically surveyed by archaeologists prior to the initiation of this field study; and/or (iii) whether the region of the field Project was known to contain archaeological sites and to thereby be archaeologically sensitive. Records examined included archaeological site files and maps, the National Register of Historic Places, Historic Property Data File, California Inventory of Historic Resources, the Office of Historic Preservation Built Environment Resources Directory, and the California Points of Historic Interest.

According to the IC records, four previous studies have been conducted within the Project area (Table 1) and three cultural resources are known to exist within it (Figure 2). Nine previous studies have been completed within 0.5-mi of the Project area (Table 3), and six cultural resources are known to exist within 0.5-mi of the Project area (Table 4). The results of the records search are provided in Appendix B.

**Table 1. Previous Reports in the Project area**

<b>Report No.</b>	<b>Year</b>	<b>Author (s)/Affiliation</b>	<b>Title</b>
TU-01031	2000	Kus, James S./ James S. Kus & Associates	Negative Archaeological Survey Report for Bicycle and Pedestrian Trail Construction Along the Abandoned Easement of the AT&SF Railroad Along the East Side of the City of Porterville, California
TU-01052	2001	Wren, Donald G./ Individual Consultant	A Cultural Resource Study Neighborhood Community Center Project and Mitigation Site, City of Porterville, Tulare County, California
TU-01061	1986	Vaughn, Wendell and Winckler, Terry/ Porterville Planning Staff	Historic Survey for the City of Porterville
TU-01971	2022	Whitley, David S. and Carey, Peter A./ ASM Affiliates, Inc.	Class III Inventory/ Phase I Survey, Heritage Park Project, Porterville, Tulare County, California

**Table 2. Previous Resources within the Project area**

<b>Primary #</b>	<b>Type</b>	<b>Description</b>
P-54-002906	District	Historic residential buildings
P-54-003900	Structure	Historic Canal
P-54-004632	Structure, Object, Site	Historic Railroad

**Table 3. Previous Reports within 0.5-miles of the Project area**

<b>Report No.</b>	<b>Year</b>	<b>Author (s)/Affiliation</b>	<b>Title</b>
TU-00419	1996	Parr, Robert E./ Center for Archaeological Research, California State University, Bakersfield	Archaeological Assessment of the Tule River Parkway (Phase I) In the City of Porterville, Tulare County, California

Report No.	Year	Author (s)/Affiliation	Title
TU-00532	1979	Varner, Dudley M. and Weinberger, Gay/ California State University, Fresno	Archaeological Reconnaissance On the Corona Heights Project
TU-00630	1975	Williams, Charlotte/ Individual Consultant	Archaeological Report for the Porta Vista Public Utility District Wastewater Collection System, Porterville, California
TU-01303	2006	Baloian, Randy and Nettles, Wendy M./ Applied EarthWorks, Inc.	Cultural Resources Investigations for the City of Porterville Murry Park Renovation and Expansion Project, Tulare County, California
TU-01329	2008	Switalski, Hubert J./ AMEC Earth and Environmental, Inc.	Archaeological Survey Report for Southern California Edison Company's Distribution Substation Plan and Pole Replacement Project Along the Success 12 kV Distribution Circuit, Porterville, Tulare County, California
TU-01334	2008	Peak, Melinda A./ Peak & Associates, Inc.	Determination of Eligibility and the Effect for the Villa Sienna Apartments Project, City of Porterville, California
TU-01886	2020	Whitley, David S. and Carey, Peter A./ ASM Affiliates, Inc.	Class III Inventory/Phase I Survey, Butterfield Corridor Project, Porterville, Tulare County, California
TU-01942	2020	Hudlow, Scott M./ Hudlow Cultural Resource Associates	A Phase I Cultural Resource Survey for Up Holdings/Self-Help Enterprises, City of Porterville, California
TU-01960	2021	Whitley, David S. and Azpitarte, Robert/ ASM Affiliates, Inc.	Phase I Survey, Main Street Parking Lot Project, Porterville, Tulare County, California

**Table 4. Previous Resources within 0.5-miles of the Project area**

Primary #	Type	Description
P-54-000573	Site	Prehistoric; Bedrock Mortars
P-54-002208	Structure, Site	Historic; Water Conveyance System
P-54-004032	Site	Historic bridges, canals, lake reservoir and monument
P-54-004355	Site	Historic refuse scatter
P-54-004356	Site	Historic foundation and fence
P-54-004626	Structure	Historic, Southern Pacific Railroad

Additionally, a *Sacred Lands File* request was submitted to the Native American Heritage Commission (NAHC) on February 5, 2024. The *Sacred Lands File* results were received on February 13, 2024, stating there were no known sacred sites or tribal cultural resources in the vicinity of the study area. Outreach letters were sent on February 23, 2024, to tribes listed on the NAHC contact list with follow-up letters sent on April 16, 2024. A response was received from the Tule River Indian Tribe on March 18, 2024, that reads in part, “We are familiar with the area, and have an understanding of the rich resources within the general area and in fairly close proximity of the site. As such, we’d like to

work with ASM and the City of Porterville to arrange Tribal Archaeological Monitors to be onsite during initial earth moving activities.”

No other responses have been received as of the writing of this memo. The results of the *Sacred Lands File* search are provided in Appendix A along with a table detailing the correspondence with tribes.

### ***Field Survey***

An intensive Class III Inventory/Phase I survey of the 5.7-acre study area was conducted on April 17, 2024, by ASM Assistant Archaeologist Maria Silva, B.A. The study area consists of a recently mowed and cleared field north of the existing school grounds (Figure 4) and a portion within it (Figures 5-7). The entire study area was surveyed using 15-meter parallel transects.

Soils are highly disturbed and turned via mechanical plowing. Native vegetation is absent throughout. Surface visibility was excellent throughout the entire study area. No cultural resources of any kind were identified. Previously recorded P-54-004632 (Burlington Northern and Southern Pacific Railroad) is mapped through the Project area; however, it was not relocated and appears to have been removed from the study area. P-54-002906 (historic residential buildings) was found to be outside of the survey area, beginning on the opposite side (west of) South A Street. Finally, P-54-003900 (Porterville Slough Ditch) is mapped near the northeast corner of the Project study area. The resource in this area was undergrounded and the exact alignment is unknown; however, it was seen to enter the parcel north of the Project study area on the northeast side facing South Plano Street. From that entrance to the undergrounded portion, the resource does not appear to be underneath the Project area.

### **Summary and Recommendations**

No cultural resources of any kind were identified during the Class III Inventory/Phase I survey of the proposed Santa Fe Elementary School Expansion Project area. Two previously recorded resources (P-54-002906 and P-54-003900) were identified near the Project area and one previously recorded resource (P-54-004632) was found to have been removed from the Project area. Therefore, the development and use of the Project area does not have the potential to result in adverse impacts to significant or unique cultural resources and a determination of no adverse effect/ no significant impact is recommended for the Project.

Please feel free to contact me if you have any questions.

Sincerely,

A handwritten signature in black ink that reads "Peter A. Carey". The signature is written in a cursive, flowing style.

Peter A. Carey, M.A., RPA  
Director

### **Attachments**

Figure 1. Location of study area, Santa Fe Elementary School Expansion Project, Porterville, Tulare County, California.

Figure 2. Previously Recorded Resources map of the Santa Fe Elementary School Expansion Project study area, Porterville, Tulare County, California.

Figure 3. Previous Studies map of the Santa Fe Elementary School Expansion Project study area, Porterville, Tulare County, California.

Figure 4. Project study area overview, facing west-southwest.

Figure 5. Overview of project area from inside existing school, facing south-southeast.

Figure 6. Overview of project area from inside existing school, facing east.

Figure 7. Overview of project area from within school grounds, facing east.

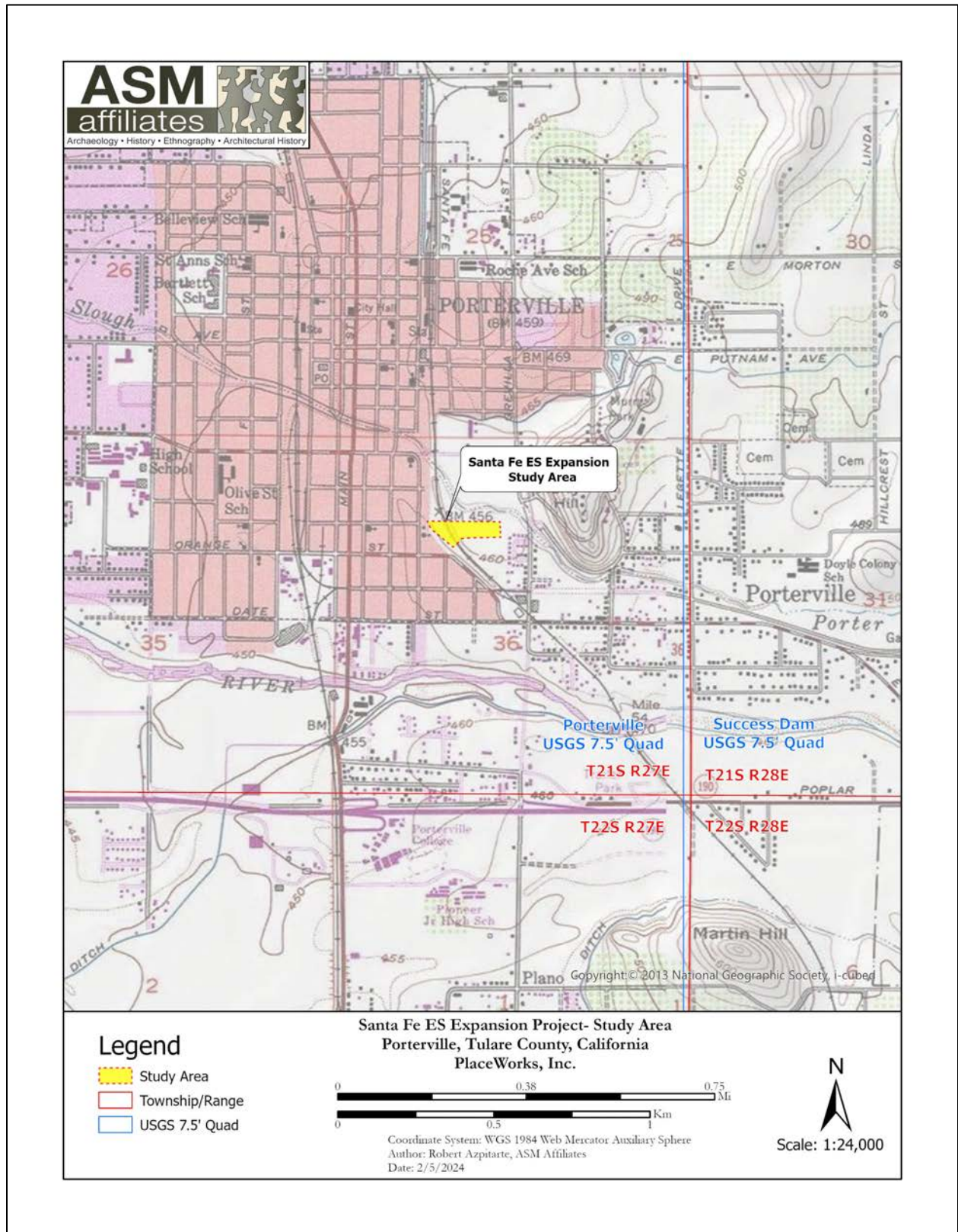
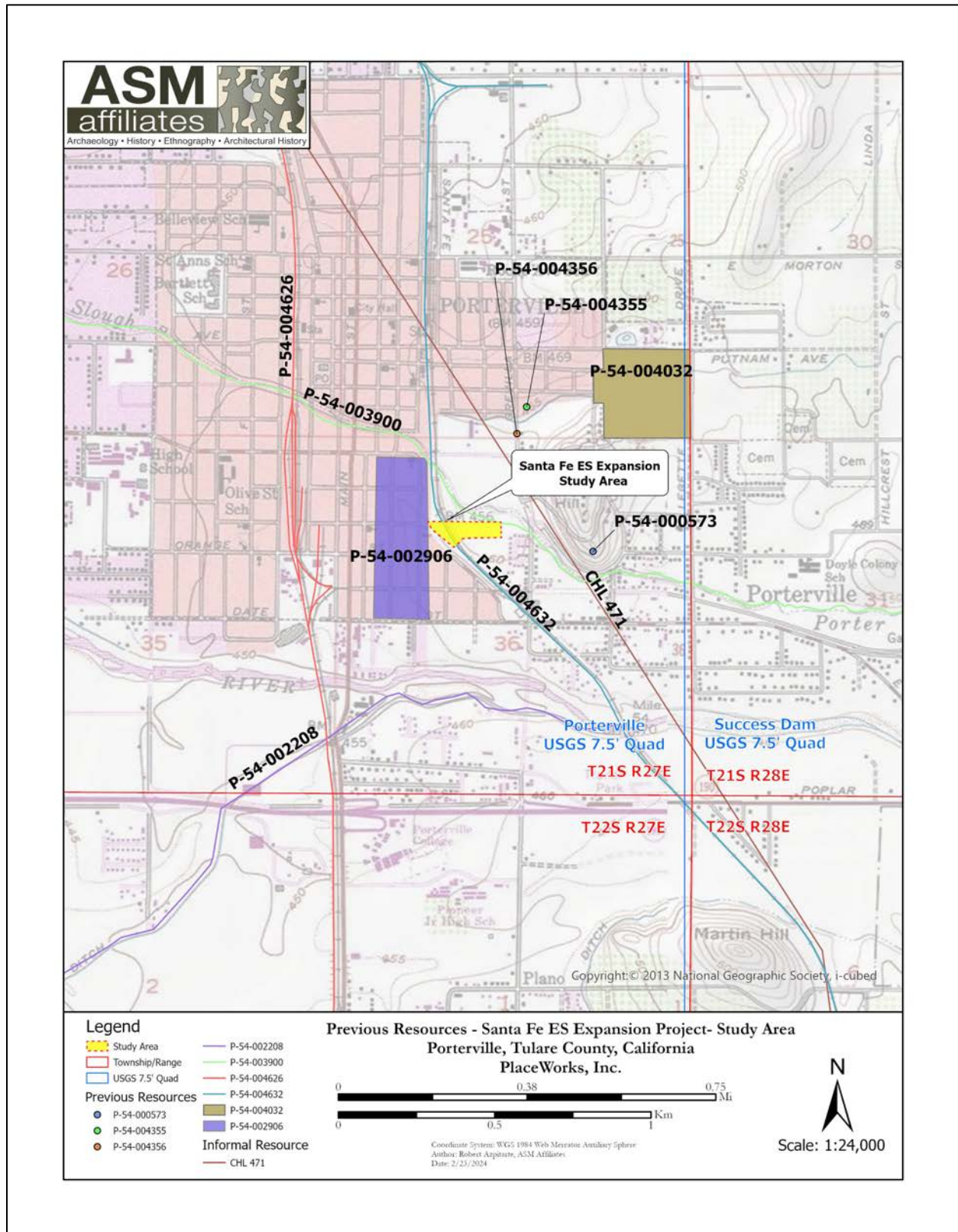
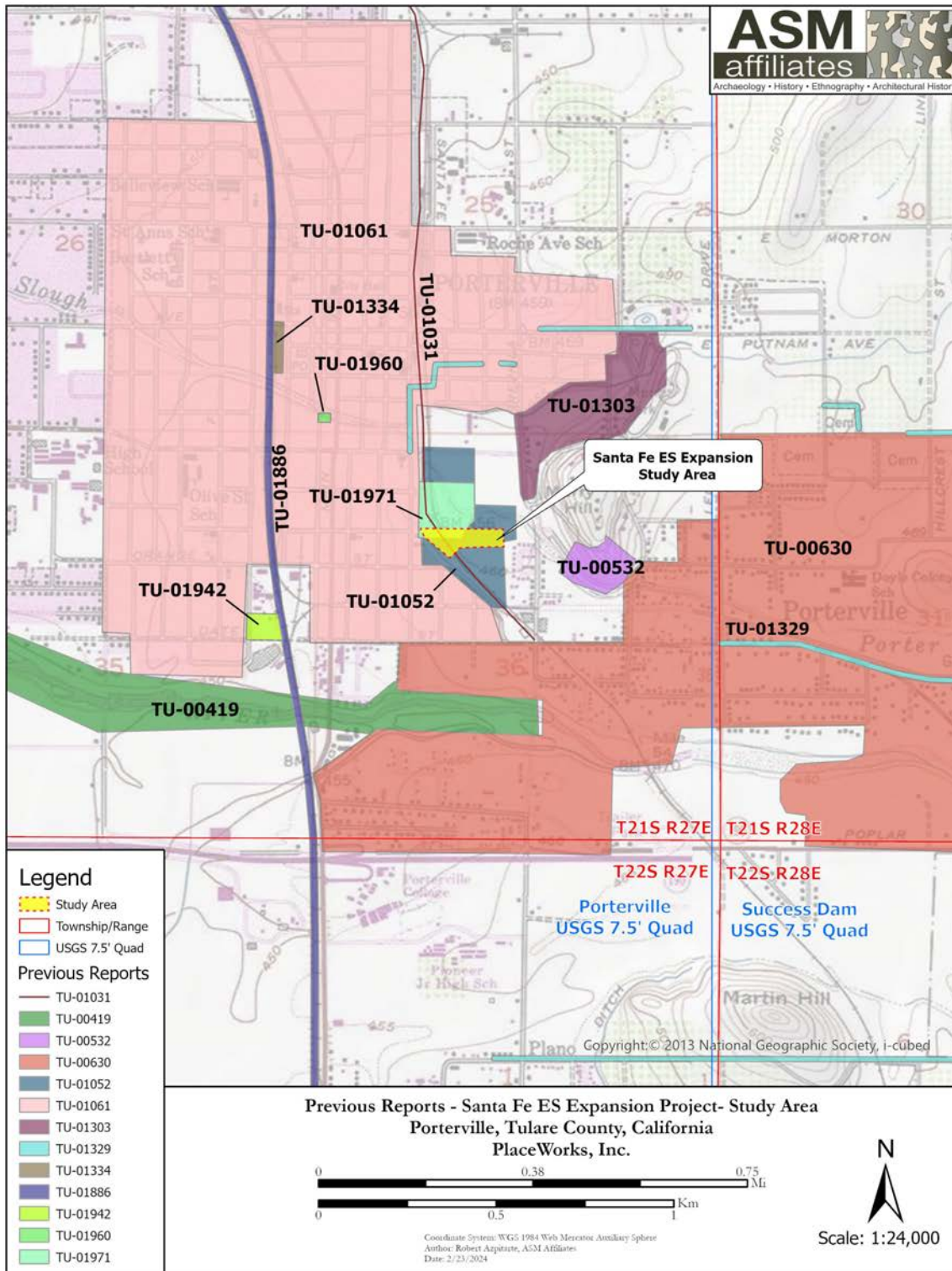

Figure 1. Location of study area, Santa Fe Elementary School Expansion Project, Porterville, Tulare County, California.





**Figure 2. Previously Recorded Resources map of the Santa Fe Elementary School Expansion Project study area, Porterville, Tulare County, California.**



**Figure 3. Previous Studies map of the Santa Fe Elementary School Expansion Project study area, Porterville, Tulare County, California.**



**Figure 4. Project study area overview, facing west-southwest.**



**Figure 5. Overview of project area from inside existing school, facing south-southeast.**

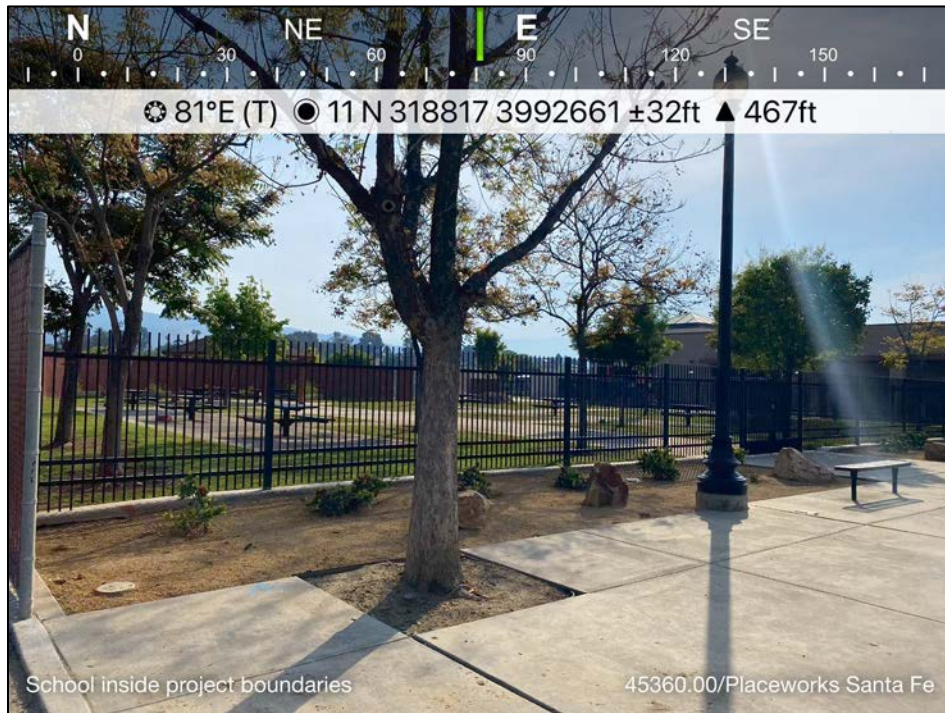

**Figure 6. Overview of project area from inside existing school, facing east**



**Figure 7. Overview of project area from within school grounds, facing east**

**Appendix A:**  
**Sacred Lands Files Results**

Page is intentionally blank

## NATIVE AMERICAN HERITAGE COMMISSION

February 13, 2024

Peter Carey  
ASM Affiliates

**Via Email to:** [pcarey@asmaffiliates.com](mailto:pcarey@asmaffiliates.com)

**Re: Placeworks Santa Fe ES Expansion Project, Tulare County**

Dear Mr. Carey:

A record search of the Native American Heritage Commission (NAHC) Sacred Lands File (SLF) was completed for the information you have submitted for the above referenced project. The results were negative. However, the absence of specific site information in the SLF does not indicate the absence of cultural resources in any project area. Other sources of cultural resources should also be contacted for information regarding known and recorded sites.

Attached is a list of Native American tribes who may also have knowledge of cultural resources in the project area. This list should provide a starting place in locating areas of potential adverse impact within the proposed project area. I suggest you contact all of those indicated; if they cannot supply information, they might recommend others with specific knowledge. By contacting all those listed, your organization will be better able to respond to claims of failure to consult with the appropriate tribe. If a response has not been received within two weeks of notification, the Commission requests that you follow-up with a telephone call or email to ensure that the project information has been received.

If you receive notification of change of addresses and phone numbers from tribes, please notify me. With your assistance, we can assure that our lists contain current information.

If you have any questions or need additional information, please contact me at my email address: [Cameron.vela@nahc.ca.gov](mailto:Cameron.vela@nahc.ca.gov).

Sincerely,

*Cameron Vela*

Cameron Vela  
Cultural Resources Analyst

Attachment



CHAIRPERSON  
**Reginald Pagaling**  
Chumash

VICE-CHAIRPERSON  
**Buffy McQuillen**  
Yokayo Pomo, Yuki,  
Nomlaki

SECRETARY  
**Sara Dutschke**  
Miwok

PARLIAMENTARIAN  
**Wayne Nelson**  
Luiseño

COMMISSIONER  
**Isaac Bojorquez**  
Ohlone-Costanoan

COMMISSIONER  
**Stanley Rodriguez**  
Kumeyaay

COMMISSIONER  
**Laurena Bolden**  
Serrano

COMMISSIONER  
**Reid Milanovich**  
Cahuilla

COMMISSIONER  
**Vacant**

EXECUTIVE SECRETARY  
**Raymond C. Hitchcock**  
Miwok, Nisenan

**NAHC HEADQUARTERS**  
1550 Harbor Boulevard  
Suite 100  
West Sacramento,  
California 95691  
(916) 373-3710  
[nahc@nahc.ca.gov](mailto:nahc@nahc.ca.gov)  
NAHC.ca.gov



Tribal Outreach  
 Project: Santa Fe Elementary School Expansion

Project No.: 45360

D Tribe:	Attempts:	Response:
Kern Valley Indian Community	<b>Mailer: 02/23/2024</b> <b>E-mail:03/06/2024</b> <b>Follow-ups:04/16/2024</b>	None
Kern Valley Indian Community_Kendricks	<b>Mailer: 02/23/2024</b> <b>E-mail:03/06/2024</b> <b>Follow-ups: 04/16/2024</b>	None
Tubatulabals of Kern Valley	<b>Mailer: 02/23/2024</b> <b>E-mail:03/06/2024</b> <b>Follow-ups: 04/16/2024</b>	None
Tule River Indian Tribe	<b>Mailer: 02/23/2024</b> <b>E-mail:03/06/2024</b> <b>Follow-ups: 04/16/2024</b>	<p>Good Afternoon Peter, thank you for your letter dated February 23, 2024 regarding the Placeworks Santa Fe Elementary School Expansion Project in Porterville, Tulare County. We are familiar with the area, and have an understanding of the rich resources within the general area and in fairly close proximity of the site. As such, we'd like to work with ASM and the City of Porterville to arrange Tribal Archaeological Monitors to be onsite during initial earth moving activities.</p> <p>Though we understand that there have not been any prehistoric resources detected on the site to date, we believe there is potential for inadvertently unveiling resources when digging.</p> <p>Please let me know how we can work with you and the City, to mitigate potential impacts during earthwork.</p> <p>Thanks again for your consultation efforts. We look forward to working with you.        Respectfully,</p> <p><b>Kerri Vera</b>  <i>Director</i>  <i>Department of Environmental Protection</i>  <i>Tule River Tribe of California</i></p>





Tribal Outreach  
 Project: Santa Fe Elementary School Expansion

Project No.: 45360

		POB 589, Porterville CA 93257 ph: 559-781-4271 ext:5041 email: <a href="mailto:tulriverenv@yahoo.com">tulriverenv@yahoo.com</a> Date: Monday, March 18, 2024
Wuksachi Indian Tribe/Eshom Valley Band	<b>Mailer: 02/23/2024</b> <b>E-mail:03/06/2024</b> <b>Follow-ups: 04/16/2024</b>	None

Page is intentionally blank

**Appendix B:**  
**Record Search Results**

Page is intentionally blank



2/20/2024

Peter Carey  
ASM Affiliates, Inc.  
4800 Stockdale Hwy., Suite 405  
Bakersfield, CA 93309

Re: Placeworks Santa Fe ES Expansion Project  
Records Search File No.: 24-058

The Southern San Joaquin Valley Information Center received your record search request for the project area referenced above, located on Porterville USGS 7.5' quad. The following reflects the results of the records search for the project area and the 0.5 mile radius:

As indicated on the data request form, the locations of resources and reports are provided in the following format:  custom GIS maps  GIS data

Resources within project area:	P-54-002906, 003900, 004632
Archaeological resources within 0.5 mile radius:	P-54-000573, 002208, 004032, 004355, 004356, 004626, CHL 471
Reports within project area:	TU-01031, 01052, 01061, 01971
Reports within 0.5 mile radius:	TU-00419, 00532, 00630, 01303, 01329, 01334, 01886, 01942, 01960

**Resource Database Printout (list):**  enclosed  not requested  nothing listed

**Resource Database Printout (details):**  enclosed  not requested  nothing listed

**Resource Digital Database Records:**  enclosed  not requested  nothing listed

**Report Database Printout (list):**  enclosed  not requested  nothing listed

**Report Database Printout (details):**  enclosed  not requested  nothing listed

**Report Digital Database Records:**  enclosed  not requested  nothing listed

**Resource Record Copies:**  enclosed  not requested  nothing listed

**Report Copies:**  enclosed  not requested  nothing listed

**OHP Built Environment Resources Directory:**  enclosed  not requested  nothing listed

**Archaeological Determinations of Eligibility:**  enclosed  not requested  nothing listed

**CA Inventory of Historic Resources (1976):**  enclosed  not requested  nothing listed

**Caltrans Bridge Survey:** Not available at SSJVIC; please see <https://dot.ca.gov/programs/environmental-analysis/cultural-studies/california-historical-bridges-tunnels>

**Ethnographic Information:** Not available at SSJVIC

**Historical Literature:** Not available at SSJVIC

**Historical Maps:** Not available at SSJVIC; please see <http://historicalmaps.arcgis.com/usgs/>

**Local Inventories:** Not available at SSJVIC

**GLO and/or Rancho Plat Maps:** Not available at SSJVIC; please see <http://www.gloreports.blm.gov/search/default.aspx#searchTabIndex=0&searchByTypeIndex=1> and/or <http://www.oac.cdlib.org/view?docid=h8489p15p;developer=local;style=oac4;doc.view=items>

**Shipwreck Inventory:** Not available at SSJVIC; please see <https://www.slc.ca.gov/shipwrecks/>

**Soil Survey Maps:** Not available at SSJVIC; please see <http://websoilsurvey.nrcs.usda.gov/app/WebSoilSurvey.aspx>

Please forward a copy of any resulting reports from this project to the office as soon as possible. Due to the sensitive nature of archaeological site location data, we ask that you do not include resource location maps and resource location descriptions in your report if the report is for public distribution. If you have any questions regarding the results presented herein, please contact the office at the phone number listed above.

The provision of CHRIS Data via this records search response does not in any way constitute public disclosure of records otherwise exempt from disclosure under the California Public Records Act or any other law, including, but not limited to, records related to archaeological site information maintained by or on behalf of, or in the possession of, the State of California, Department of Parks and Recreation, State Historic Preservation Office, Office of Historic Preservation, or the State Historical Resources Commission.

Due to processing delays and other factors, not all of the historical resource reports and resource records that have been submitted to the Office of Historic Preservation are available via this records search. Additional information may be available through the federal, state, and local agencies that produced or paid for historical resource management work in the search area. Additionally, Native American tribes have historical resource information not in the CHRIS Inventory, and you should contact the California Native American Heritage Commission for information on local/regional tribal contacts.

Should you require any additional information for the above referenced project, reference the record search number listed above when making inquiries. Invoices for Information Center services will be sent under separate cover from the California State University, Bakersfield Accounting Office.

Thank you for using the California Historical Resources Information System (CHRIS).

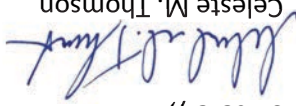
Sincerely,  
  
Celeste M. Thomson  
Coordinator

# Report Detail: TU-00419

SSJVIC Record Search 24-058

---

## Identifiers

Report No.: TU-00419

Other IDs: Type	Name
Submitter	CAR-96-06

Cross-refs:

## Citation information

Author(s): Parr, Robert E.

Year: 1996 (Jul)

Title: Archaeological Assessment of the Tule River Parkway (Phase I) In the City of Porterville, Tulare County, California

Affiliation: Center for Archaeological Research, California State University, Bakersfield

No. pages: 43

No. maps: 4

Attributes: Archaeological, Field study

Inventory size:

Disclosure: Not for publication

Collections: No

## General notes

### Associated resources

Primary No.	Trinomial	Name
P-54-002205		Tule River Bridge
P-54-002206		Main Street Bridge (#46C0075)
P-54-002207		Plano Street Bridge (#46C0076)
P-54-002208	CA-TUL-003230H	Poplar Ditch

No. resources: 4

Has informals: Yes

### Location information

County(ies): Tulare

USGS quad(s): Porterville

Address:

PLSS: T21S R27E Sec. 35, 36 MDBM

### Database record metadata

Date	User	Action taken
Entered: 7/6/2016	user1	
Last modified: 12/8/2017	User	
IC actions: Date	User	Action taken
7/6/2016	user1	Entered report: MMB

Record status: Database Complete

# Report Detail: TU-00532

SSJVIC Record Search 24-058

---

## Identifiers

Report No.: TU-00532

Other IDs:

Cross-refs:

## Citation information

Author(s): Varner, Dudley M. and Weinberger, Gay

Year: 1979 (May)

Title: Archaeological Reconnaissance On the Corona Heights Project

Affiliation: California State University, Fresno

No. pages: 34

No. maps: 6

Attributes: Archaeological, Field study

Inventory size: Nine acres

Disclosure: Not for publication

Collections: No

## General notes

### Associated resources

Primary No.	Trinomial	Name
P-54-000573	CA-TUL-000573	Chokowisho

No. resources: 1

Has informals: No

### Location information

County(ies): Tulare

USGS quad(s): Porterville

Address:

PLSS: T21S R27E Sec. 36 MDBM

### Database record metadata

Date	User	Action taken
Entered: 11/12/2013	ssjvic	report entered: cls
Last modified: 7/8/2016	user1	Entered report: MMB
IC actions: Date	User	Action taken
11/12/2013	ssjvic	report entered: cls
7/8/2016	user1	Entered report: MMB

Record status: Database Complete



# Report Detail: TU-00630

SSJVIC Record Search 24-058

---

## Identifiers

Report No.: TU-00630

Other IDs:

Cross-refs:

## Citation information

Author(s): Williams, Charlotte

Year: 1975 (Jan)

Title: Archaeological Report for the Porta Vista Public Utility District Wastewater Collection System, Porterville, California

Affiliation: Individual Consultant

No. pages: 7

No. maps: 2

Attributes: Archaeological, Field study

Inventory size:

Disclosure: Not for publication

Collections: No

## General notes

NEGATIVE

## Associated resources

No. resources: 0

Has informals: No

## Location information

County(ies): Tulare

USGS quad(s): Porterville, Success Dam

Address:

PLSS: T21S R27E

T21S R28E

## Database record metadata

	Date	User	Action taken
Entered:	11/12/2013	ssjvic	report entered: cls
Last modified:	7/11/2016	user1	Entered report: MMB
IC actions:	Date	User	
	11/12/2013	ssjvic	
	7/11/2016	user1	

Record status: Database Complete

# Report Detail: TU-01031

SSJVIC Record Search 24-058

---

## Identifiers

Report No.: TU-01031

Other IDs:

Cross-refs:

## Citation information

Author(s): Kus, James S.

Year: 2000 (Oct)

Title: Negative Archaeological Survey Report for Bicycle and Pedestrian Trail Construction Along the Abandoned Easement of the AT&SF Railroad Along the East Side of the City of Porterville, California

Affiliation: James S. Kus & Associates

No. pages: 10

No. maps: 1

Attributes: Archaeological, Field study

Inventory size: 22 acres

Disclosure: Not for publication

Collections: No

## General notes

NEGATIVE

## Associated resources

No. resources: 0

Has informals: No

## Location information

County(ies): Tulare

USGS quad(s): Porterville

Address:

PLSS: T21S R27E Sec. 24, 25, 36 MDBM

## Database record metadata

	Date	User	
Entered:	7/22/2016	user1	
Last modified:	7/22/2016	user1	
IC actions:	Date	User	Action taken
	7/22/2016	user1	Entered report: MMB
Record status:	Database Complete		

# Report Detail: TU-01052

SSJVIC Record Search 24-058

---

## Identifiers

Report No.: TU-01052

Other IDs:

Cross-refs: See also TU-01150

## Citation information

Author(s): Wren, Donald G.

Year: 2001 (Jul)

Title: A Cultural Resource Study Neighborhood Community Center Project and Mitigation Site, City of Porterville, Tulare County, California

Affiliation: Individual Consultant

No. pages: 12

No. maps: 3

Attributes: Archaeological, Field study

Inventory size:

Disclosure: Not for publication

Collections: No

## General notes

NEGATIVE

## Associated resources

No. resources: 0

Has informals: No

## Location information

County(ies): Tulare

USGS quad(s): Porterville, Success Dam

Address:

PLSS: T21S R27E Sec. 36 MDBM

## Database record metadata

	Date	User	Action taken
Entered:	11/12/2013	ssjvic	report entered: cls
Last modified:	11/3/2016	User	Entered report: MMB
IC actions:	Date	User	
	11/12/2013	ssjvic	
	8/1/2016	user1	

Record status: Database Complete

# Report Detail: TU-01061

SSJVIC Record Search 24-058

---

## Identifiers

Report No.: TU-01061

Other IDs:

Cross-refs:

## Citation information

Author(s): Vaughn, Wendell and Winckler, Terry

Year: 1986 (Jul)

Title: Historic Survey for the City of Porterville

Affiliation: Porterville Planning Staff

No. pages: 60

No. maps: 0

Attributes: Architectural/Historical, Field study

Inventory size:

Disclosure: Not for publication

Collections: No

## General notes

NEGATIVE

## Associated resources

No. resources: 0

Has informals: No

## Location information

County(ies): Tulare

USGS quad(s): Porterville, Success Dam

Address:

PLSS:

## Database record metadata

	Date	User	
Entered:	11/12/2013	ssjvic	
Last modified:	12/7/2016	User	
IC actions:	Date	User	Action taken
	11/12/2013	ssjvic	report entered: cls
Record status:	Database Complete		

# Report Detail: TU-01303

SSJVIC Record Search 24-058

---

## Identifiers

Report No.: TU-01303

Other IDs:

Cross-refs:

## Citation information

Author(s): Baloian, Randy and Nettles, Wendy M.

Year: 2006 (Sep)

Title: Cultural Resources Investigations for the City of Porterville Murry Park Renovation and Expansion Project, Tulare County, California

Affiliation: Applied EarthWorks, Inc.

No. pages: 105

No. maps: 15

Attributes: Archaeological, Field study

Inventory size: 35 acres

Disclosure: Not for publication

Collections: No

## General notes

### Associated resources

Primary No.	Trinomial	Name
P-54-004032	CA-TUL-002449H	Murry Park, Leslie Flouring Mill,
P-54-004354	CA-TUL-002655H	Pioneer Ditch
P-54-004355	CA-TUL-002656H	HR-1 / Trash Scatter
P-54-004356	CA-TUL-002657H	HR-2 / Former Residence
P-54-004358		HB-2 / 16 S. Plano Street
P-54-004359		HB-3 / 18 N. Plano Street
P-54-004360		HB-5 / 28 N. Plano Street
P-54-004361		HB-6 / Boy Scout Clubhouse

No. resources: 8

Has informals: No

### Location information

County(ies): Tulare

USGS quad(s): Porterville, Success Dam

Address:

PLSS: T21S R27E Sec. 25, 36 MDBM

### Database record metadata

Date	User	Action taken
Entered: 11/12/2013	ssjvic	report entered: cls
Last modified: 8/4/2016	user1	Entered report: MMB
IC actions: Date	User	
11/12/2013	ssjvic	
8/4/2016	user1	

Record status: Database Complete

# Report Detail: TU-01329

SSJVIC Record Search 24-058

---

## Identifiers

Report No.: TU-01329

Other IDs:

Cross-refs:

## Citation information

Author(s): Switalski, Hubert J.

Year: 2008 (Jan)

Title: Archaeological Survey Report for Southern California Edison Company's Distribution Substation Plan and Pole Replacement Project Along the Success 12 kV Distribution Circuit, Porterville, Tulare County, California

Affiliation: AMEC Earth and Environmental, Inc.

No. pages: 31

No. maps: 4

Attributes: Archaeological, Field study

Inventory size: 220 acres

Disclosure: Not for publication

Collections: No

## General notes

### Associated resources

Primary No.	Trinomial	Name
P-54-004032	CA-TUL-002449H	Murry Park, Leslie Flouring Mill,
P-54-004309	CA-TUL-002629H	Santa Fe Railroad
P-54-004354	CA-TUL-002655H	Pioneer Ditch
P-54-004700		Porterville Historic District
P-54-004701	CA-TUL-002925H	Success Circuit

No. resources: 5

Has informals: No

### Location information

County(ies): Tulare

USGS quad(s): Porterville, Success Dam

Address:

PLSS: T21S R27E Sec. 25 MDBM  
T22S R27E Sec. 1 MDBM  
T21S R28E Sec. 29-33 MDBM  
T22S R28E Sec. 3-6 MDBM

### Database record metadata

Date	User	Action taken
Entered: 11/12/2013	ssjvic	report entered: cls
Last modified: 8/4/2016	user1	Entered report: MMB
IC actions: Date	User	
11/12/2013	ssjvic	
8/4/2016	user1	

Record status: Database Complete

# Report Detail: TU-01334

SSJVIC Record Search 24-058

---

## Identifiers

Report No.: TU-01334

Other IDs: Type	Name
Submitter	Job #08-044

Cross-refs:

## Citation information

Author(s): Peak, Melinda A.

Year: 2008 (Apr)

Title: Determination of Eligibility and Effect for the Villa Sienna Apartments Project, City of Porterville, California

Affiliation: Peak & Associates, Inc.

No. pages: 24

No. maps: 1

Attributes: Archaeological, Field study

Inventory size: 2.7 acres

Disclosure: Not for publication

Collections: No

## General notes

NEGATIVE

## Associated resources

No. resources: 0

Has informals: No

## Location information

County(ies): Tulare

USGS quad(s): Porterville

Address:

PLSS: T21S R27E Sec. 26 MDBM

## Database record metadata

Date	User	Action taken
Entered: 8/4/2016	user1	
Last modified: 8/4/2016	user1	
IC actions: Date	User	Action taken
8/4/2016	user1	Entered report: MMB

Record status: Database Complete

# Report Detail: TU-01886

SSJVIC Record Search 24-058

---

## Identifiers

Report No.: TU-01886

Other IDs: Type	Name
Submitter	PN 34780.00

Cross-refs:

## Citation information

Author(s): Whitley, David S. and Carey, Peter A.

Year: 2020 (May)

Title: Class III Inventory/Phase I Survey, Butterfield Corridor Project, Porterville, Tulare County, California

Affiliation: ASM Affiliates, Inc.

No. pages: 50

No. maps: 5

Attributes: Archaeological, Architectural/historical, Field study

Inventory size: 110 acres

Disclosure: Not for publication

Collections: No

## General notes

### Associated resources

Primary No.	Trinomial	Name
P-54-002205		Tule River Bridge
P-54-002208	CA-TUL-003230H	Poplar Ditch
P-54-004354	CA-TUL-002655H	Pioneer Ditch
P-54-004614	CA-TUL-002873H	Friant-Kern Canal
P-54-004626	CA-TUL-002880H	Southern Pacific Railroad; San J

No. resources: 5

Has informals: No

### Location information

County(ies): Tulare

USGS quad(s): Lindsay, Porterville

Address:

PLSS: T20S R27E Sec. 33 MDBM  
T21S R27E Sec. 3, 4, 10, 14, 15, 23, 26, 35, 36 MDBM  
T22S R27E Sec. 1, 2, 11 MDBM

### Database record metadata

Date	User	Action taken
Entered: 6/25/2021	jdavid5	
Last modified: 7/8/2021	cthompson	
IC actions: Date	User	Action taken
6/25/2021	jdavid5	Entered Report

Record status: Database Complete



# Report Detail: TU-01942

SSJVIC Record Search 24-058

---

## Identifiers

Report No.: TU-01942

Other IDs:

Cross-refs:

## Citation information

Author(s): Hudlow, Scott M.

Year: 2020 (Jan)

Title: A Phase I Cultural Resource Survey for Up Holdings/Self-Help Enterprises, City of Porterville, California

Affiliation: Hudlow Cultural Resource Associates

No. pages: 17

No. maps: 1

Attributes: Archaeological, Architectural/historical, Field study

Inventory size: 3.076 acres

Disclosure: Unrestricted

Collections: No

## General notes

### Associated resources

No. resources: 0

Has informals: No

### Location information

County(ies): Tulare

USGS quad(s): Porterville

Address: Address

358 S. East Street

PLSS: T21S R27E Sec. 35 MDBM

City

Porterville

Assessor's parcel no.

Zip code

### Database record metadata

Date

User

Entered: 1/12/2023

cthomson

Last modified: 1/17/2023

jdavid5

IC actions: Date

User

Action taken

1/12/2023

cthomson

Entered

Record status: Verified

# Report Detail: TU-01960

SSJVIC Record Search 24-058

---

## Identifiers

Report No.: TU-01960

Other IDs: Type	Name
Submitter	PN 36510.05

Cross-refs:

## Citation information

Author(s): Whitley, David S. and Azpitarte, Robert

Year: 2021 (Nov)

Title: Phase I Survey, Main Street Parking Lot Project, Porterville, Tulare County, California

Affiliation: ASM Affiliates, Inc.

No. pages: 39

No. maps: 3

Attributes: Archaeological, Architectural/historical, Field study

Inventory size: 0.25 acres

Disclosure: Not for publication

Collections: No

## General notes

### Associated resources

Primary No.	Trinomial	Name
P-54-002990		J.C. Penney's; 53 North Main Str
P-54-003900	CA-TUL-003274H	Porterville Slough Ditch; Porter S

No. resources: 2

Has informals: No

### Location information

County(ies): Tulare

USGS quad(s): Porterville

Address: Address	City	Assessor's parcel no.	Zip code
53 North Main Street	Porterville		93257

PLSS: T21S R27E Sec. 25 MDBM

### Database record metadata

Date	User	Action taken
Entered: 5/24/2023	cthompson	
Last modified: 6/13/2023	jdavid5	
IC actions: Date	User	Action taken
5/24/2023	cthompson	Entered
6/13/2023	jdavid5	Verified DB, PDF, & GIS

Record status: Verified

# Report Detail: TU-01971

SSJVIC Record Search 24-058

---

## Identifiers

Report No.: TU-01971

Other IDs: Type	Name
Submitter	PN 36790.04

Cross-refs:

## Citation information

Author(s): Whitley, David S. and Carey, Peter A.

Year: 2022 (May)

Title: Class III Inventory/Phase I Survey, Heritage Park Project, Porterville, Tulare County, California

Affiliation: ASM Affiliates, Inc.

No. pages: 39

No. maps: 2

Attributes: Archaeological, Architectural/historical, Field study

Inventory size: 5 acres

Disclosure: Not for publication

Collections: No

## General notes

### Associated resources

No. resources: 0

Has informals: No

### Location information

County(ies): Tulare

USGS quad(s): Porterville

Address: Address	City	Assessor's parcel no.	Zip code
		261-140-024	

PLSS: T21S R27E Sec. 36 MDBM

### Database record metadata

Date	User	Action taken
Entered: 7/18/2023	cthompson	Entered
Last modified: 8/4/2023	jdavid5	Verified DB, GIS, & PDF
IC actions: Date	User	Action taken
7/18/2023	cthompson	Entered
8/4/2023	jdavid5	Verified DB, GIS, & PDF

Record status: Verified

# Resource Detail: P-54-000573

SSJVIC Record Search 24-058

---

## Identifying information

Primary No.: P-54-000573  
Trinomial: CA-TUL-000573  
Name: Chokowisho  
Other IDs: Type Name  
Resource Name Chokowisho  
Cross-refs:

## Attributes

Resource type: Site  
Age: Prehistoric  
Information base: Unknown  
Attribute codes: AH04 (Privies/dumps/trash scatters); AP02 (Lithic scatter); AP04 (Bedrock milling feature)  
Disclosure: Not for publication  
Collections: No  
Accession no(s):  
Facility:

## General notes

## Recording events

Date	Recorder(s)	Affiliation	Notes
5/12/1979	Gay Weinberger		
4/2/1999	Adele Baldwin		[SUPPLEMENT]

## Associated reports

Report No.	Year	Title	Affiliation
TU-00532	1979	Archaeological Reconnaissance On the Corona Heights Project	California State University, Fresno

## Location information

County: Tulare  
USGS quad(s): Porterville  
Address:  
PLSS: T21S R27E SW¼ of NE¼ of Sec. 36 MDBM  
UTMs: Zone 11 319545mE 3392420mN NAD27

## Management status

## Database record metadata

Date	User	Action taken
Entered: 11/26/2014	user	
Last modified: 6/30/2023	jdavid5	
IC actions: Date	User	Action taken
6/23/2023	kprince4	PDF Rescanned
6/30/2023	jdavid5	PDF Verified
11/26/2014	user	Entered resource: MMB

Record status: Database Complete

# Resource Detail: P-54-002208

SSJVIC Record Search 24-058

---

## Identifying information

Primary No.: P-54-002208

Trinomial: CA-TUL-003230H

Name: Poplar Ditch

Other IDs:	Type	Name
	Resource Name	Poplar Ditch
	Other	PL-POR-001H
	OHP Property Numb	118907
	OTIS Resource Num	551060
	Other	CWA20-172-1

Cross-refs: Subsumes 54-004330

## Attributes

Resource type: Structure, Site

Age: Historic

Information base: Survey

Attribute codes: AH02 (Foundations/structure pads); AH04 (Privies/dumps/trash scatters); AH06 (Water conveyance system); HP20 (Canal/aqueduct)

Disclosure: Not for publication

Collections: No

Accession no(s):

Facility:

## General notes

Entire resource mapped, though only certain segments have been recorded

## Recording events

Date	Recorder(s)	Affiliation	Notes
6/19/1996	R.E. Parr, D. Schuldies	Center for Archaeological Research	
6/4/2009	S. Melvin, R. Flores	JRP Historical Consulting, LLC.	[SUPPLEMENT]
8/23/2016	Shannon E. Foglia, Rachel Droessler	AECOM	[SUPPLEMENT]
5/1/2020	R. Azpitarte, S. Escamilla	ASM Affiliates, Inc.	[SUPPLEMENT]
7/12/2005	M. O'Neill and M. Elliott	Pacific Legacy Inc.	[SUPPLEMENT]

## Associated reports

Report No.	Year	Title	Affiliation
TU-00419	1996	Archaeological Assessment of the Tule River Parkway (Phase I) In the City of Porterville, Tulare County, California	Center for Archaeological Research, California State University, Bakersfield
TU-01251	2005	Reconnaissance Report for the Vandalia 12kV Circuit Reconductoring Project on Private Lands, Tulare County, California	Pacific Legacy, Inc.
TU-01886	2020	Class III Inventory/Phase I Survey, Butterfield Corridor Project, Porterville, Tulare County, California	ASM Affiliates, Inc.

## Location information

County: Tulare

USGS quad(s): Porterville, Woodville

Address:

PLSS: T22S R26E Sec. 4 MDBM  
T21S R26E Sec. 33 MDBM  
T21S R26E Sec. 34 MDBM  
T21S R26E Sec. 35 MDBM  
T21S R26E Sec. 36 MDBM  
T21S R27E Sec. 31 MDBM

# Resource Detail: P-54-002208

SSJVIC Record Search 24-058

---

T21S R27E Sec. 32 MDBM  
T21S R27E Sec. 33 MDBM  
T22S R27E Sec. 4 MDBM  
T22S R27E Sec. 3 MDBM  
T22S R27E Sec. 2 MDBM  
T21S R27E Sec. 35 MDBM  
T21S R27E Sec. 36 MDBM

UTMs: Zone 11 318620mE 3991800mN NAD83 (NAD not listed 6/19/1996)  
Zone 11 319290mE 3991720mN NAD83 (NAD not listed 6/19/1996)  
Zone 11 318290mE 3991810mN NAD83 (05/1/2020 Recording)  
Zone 11 313680mE 3992420mN NAD83 (7/12/2005 Recording)  
Zone 11 313930mE 3991427mN NAD27 (6/4/2009 Recording)  
Zone 11 305467mE 3991814mN NAD83 (8/23/16 recordation coordinates)

## Management status

### Database record metadata

<i>Date</i>	<i>User</i>	
<i>Entered:</i> 12/21/2014	user	
<i>Last modified:</i> 7/12/2023	kprince4	
<i>IC actions:</i> <i>Date</i>	<i>User</i>	<i>Action taken</i>
1/25/2017	User	entered supplement: cls
1/25/2017	User	resource mapped (in its entirety): cls
12/21/2014	user	Entered resource: MMB
7/8/2021	cthomson	Verified
7/12/2023	kprince4	PDF Verified
6/28/2021	jdavid5	Entered Supplement

*Record status:* Verified

# Resource Detail: P-54-002906

SSJVIC Record Search 24-058

---

## Identifying information

Primary No.: P-54-002906

Trinomial:

Name: DISTRICT 9 - A and B Streets Between Date and Olive

Other IDs: Type

Name

Resource Name DISTRICT 9 - A and B Streets Between Date and Olive

OHP PRN 3257-0010-9999

OTIS Resource Num 453869

OHP Property Numb 051558

Cross-refs: Physically overlaps or intersects 54-003900

## Attributes

Resource type: District

Age: Historic

Information base: Unknown

Attribute codes: HP02 (Single family property); HP39 (Other)

Disclosure: Unrestricted

Collections: No

Accession no(s):

Facility:

## General notes

## Recording events

Date	Recorder(s)	Affiliation	Notes
6/30/1986	Terry Winckler	City of Porterville	

## Associated reports

## Location information

County: Tulare

USGS quad(s): Porterville

Address: Address

City

Assessor's parcel no.

Zip code

Porterville

93257

PLSS:

UTMs: Zone 11 318709mE 3992805mN NAD83 (NAD not listed)

Zone 11 318950mE 3992805mN NAD83 (NAD not listed)

Zone 11 318708mE 3992103mN NAD83 (NAD not listed)

Zone 11 318952mE 3992101mN NAD83 (NAD not listed)

## Management status

## Database record metadata

Date User

Entered: 2/5/2015 user

Last modified: 7/21/2023 jdavid5

IC actions: Date User Action taken

7/17/2023 kprince4 PDF Rescanned

7/21/2023 jdavid5 PDF Verified

2/5/2015 user Entered resource: MMB

Record status: Database Complete

# Resource Detail: P-54-003900

SSJVIC Record Search 24-058

---

## Identifying information

Primary No.: P-54-003900

Trinomial: CA-TUL-003274H

Name: Porterville Slough Ditch; Porter Slough

Other IDs: 

Type	Name
Other	TR-5
Resource Name	Porterville Slough Ditch; Porter Slough
OTIS Resource Num	556076
OHP Property Numb	142038

Cross-refs: Physically overlaps or intersects 54-002906  
Physically overlaps or intersects 54-002990  
Physically overlaps or intersects 54-003311  
Physically overlaps or intersects 54-004614  
Physically overlaps or intersects 54-004626  
Physically overlaps or intersects 54-004632  
Physically overlaps or intersects 54-004700  
Physically overlaps or intersects 54-004701

## Attributes

Resource type: Structure

Age: Historic

Information base: Survey

Attribute codes: AH06 (Water conveyance system); HP20 (Canal/aqueduct)

Disclosure: Unrestricted

Collections: No

Accession no(s):

Facility:

## General notes

## Recording events

Date	Recorder(s)	Affiliation	Notes
1/22/2002	J. Dougherty, J. Barton, C. Baker, M. Schmidt	PAR Environmental Services, Inc.	
9/9/2021	R. Azpitarte	ASM Affiliates, Inc.	Update

## Associated reports

Report No.	Year	Title	Affiliation
TU-01116	2002	Cultural Resources Study of Two Parcels for the Tule River Basin Investigation, Lake Success Dam Enlargement Wetlands Mitigation Project in Tulare County, California	PAR Environmental Services, Inc.
TU-01960	2021	Phase I Survey, Main Street Parking Lot Project, Porterville, Tulare County, California	ASM Affiliates, Inc.

## Location information

County: Tulare

USGS quad(s): Porterville, Success Dam, Woodville

Address:

PLSS: T22S R28E Sec. 4 MDBM  
T21S R28E Sec. 33 MDBM  
T21S R28E Sec. 32 MDBM  
T21S R28E Sec. 31 MDBM  
T21S R27E Sec. 36 MDBM  
T21S R27E Sec. 25 MDBM  
T21S R27E Sec. 26 MDBM  
T21S R27E Sec. 27 MDBM  
T21S R27E Sec. 28 MDBM



# Resource Detail: P-54-003900

SSJVIC Record Search 24-058

---

T21S R27E Sec. 21 MDBM  
T21S R27E Sec. 20 MDBM  
T21S R27E Sec. 19 MDBM  
T21S R27E Sec. 18 MDBM  
T21S R26E Sec. 13 MDBM  
T21S R26E Sec. 12 MDBM  
T21S R26E Sec. 11 MDBM

UTMs: Zone 11 318380mE 3993185mN NAD83 (segment; 2021 recording)  
Zone 11 324590mE 3990810mN NAD27 (east end; 2002 recording)  
Zone 11 323968mE 3991189mN NAD27 (curve; 2002 recording)  
Zone 11 323715mE 3991196mN NAD27 (west end; 2002 recording)

## Management status

### Database record metadata

<i>Date</i>	<i>User</i>	
<i>Entered:</i> 2/18/2015	user	
<i>Last modified:</i> 7/24/2023	kprince4	
<i>IC actions:</i> <i>Date</i>	<i>User</i>	<i>Action taken</i>
7/24/2023	kprince4	PDF Verified
2/18/2015	user	Entered resource: MMB
9/27/2022	kprince4	Added Identifiers
6/13/2023	jdavid5	Verified DB, PDF, & GIS
5/24/2023	cthompson	Entered Update

*Record status:* Verified

# Resource Detail: P-54-004032

SSJVIC Record Search 24-058

## Identifying information

Primary No.: P-54-004032

Trinomial: CA-TUL-002449H

Name: Murry Park, Leslie Flouring Mill, Brewery

Other IDs:	Type	Name
	Resource Name	Murry Park, Leslie Flouring Mill, Brewery
	OHP PRN	3257-0055-0000
	OTIS Resource Num	558772
	OHP Property Numb	139208

Cross-refs: Subsumes 54-003154  
Subsumes 54-004357

## Attributes

Resource type: Site

Age: Historic

Information base: Survey

Attribute codes: AH02 (Foundations/structure pads); HP19 (Bridge); HP20 (Canal/aqueduct); HP22 (Lake/river/reservoir); HP26 (Monument/mural/gravestone); HP29 (Landscape architecture); HP30 (Trees/vegetation); HP31 (Urban open space)

Disclosure: Not for publication

Collections: No

Accession no(s):

Facility:

## General notes

## Recording events

Date	Recorder(s)	Affiliation	Notes
1/21/2003	Christopher Corey	Pacific Legacy, Inc.	
12/7/2007	Hubert Switalski	AMEC Earth and Environmental	[UPDATE]
2/13/2006	R. Baloian	Applied EarthWorks, Inc.	[UPDATE]
2/13/2006	Unknown	Applied Earthworks, Inc.	Originally P-54-004357. Specifically records Leslie Mill
7/1/1986	Terry Winckler	City of Porterville	Originally P-54-003154.

## Associated reports

Report No.	Year	Title	Affiliation
TU-01303	2006	Cultural Resources Investigations for the City of Porterville Murry Park Renovation and Expansion Project, Tulare County, California	Applied EarthWorks, Inc.
TU-01329	2008	Archaeological Survey Report for Southern California Edison Company's Distribution Substation Plan and Pole Replacement Project Along the Success 12 kV Distribution Circuit, Porterville, Tulare County, California	AMEC Earth and Environmental, Inc.

## Location information

County: Tulare

USGS quad(s): Porterville, Success Dam

Address:	Address	City	Assessor's parcel no.	Zip code
	500 E Putnam Ave	Porterville	253-100-31	93257

PLSS: T21S R27E SE¼ of SE¼ of Sec. 25 MDBM

UTMs: Zone 11 319701mE 3993150mN NAD27 (2006 mill recording)

Zone 11 319710mE 3993120mN NAD27 (2003 recording)

Zone 11 428278mE 3915747mN NAD27 (2007 recording)

Zone 11 319664mE 3993240mN NAD27 (Feature 1 - 2006 park recording)

Zone 11 319664mE 3993182mN NAD27 (Feature 2 - 2006 park recording)

## Resource Detail: P-54-004032

### SSJVIC Record Search 24-058

---

Zone 11 319689mE 3993109mN NAD27 (Feature 3- 2006 park recording)  
Zone 11 319637mE 3993115mN NAD27 (Feature 4- 2006 park recording)  
Zone 11 319664mE 3993134mN NAD27 (Feature 5- 2006 park recording)  
Zone 11 319710mE 3993129mN NAD27 (Feature 6- 2006 park recording)  
Zone 11 319694mE 3993101mN NAD27 (Feature 7- 2006 park recording)  
Zone 11 319636mE 3992948mN NAD27 (Feature 8- 2006 park recording)  
Zone 11 319627mE 3993121mN NAD27 (Feature 9- 2006 park recording)  
Zone 11 319629mE 3993143mN NAD27 (Feature 10- 2006 park recording)  
Zone 11 319611mE 3993141mN NAD27 (Feature 11- 2006 park recording)  
Zone 11 319595mE 3993139mN NAD27 (Feature 12- 2006 park recording)  
Zone 11 319619mE 3993168mN NAD27 (Feature 13- 2006 park recording)  
Zone 11 319597mE 3993195mN NAD27 (Feature 14- 2006 park recording)  
Zone 11 319609mE 3993215mN NAD27 (Feature 15- 2006 park recording)  
Zone 11 319619mE 3993280mN NAD27 (Feature 16- 2006 park recording)  
Zone 11 319802mE 3993260mN NAD27 (Feature 17- 2006 park recording)  
Zone 11 319801mE 3993288mN NAD27 (Feature 18- 2006 park recording)  
Zone 11 319619mE 3993280mN NAD27 (Feature 19 North- 2006 park record  
Zone 11 319640mE 3992912mN NAD27 (Feature 19 South- 2006 park recor

### Management status

#### Database record metadata

<i>Date</i>	<i>User</i>	<i>Action taken</i>
<i>Entered:</i> 11/12/2013	ssjvic	
<i>Last modified:</i> 7/28/2023	jdavid5	
<i>IC actions:</i> <i>Date</i>	<i>User</i>	<i>Action taken</i>
11/12/2013	ssjvic	resource entered: cls
7/25/2023	kprince4	PDF Rescanned
11/14/2019	cthompson	Subsumed P-54-003154 and P-54-004357.
11/14/2019	cthompson	Verified
2/19/2015	user	Entered location: MMB
9/27/2022	kprince4	Added Address and Identifiers
7/28/2023	jdavid5	PDF Verified

*Record status:* Verified

# Resource Detail: P-54-004355

SSJVIC Record Search 24-058

---

## Identifying information

Primary No.: P-54-004355  
Trinomial: CA-TUL-002656H  
Name: HR-1 / Trash Scatter  
Other IDs: Type Name  
Resource Name HR-1 / Trash Scatter  
Cross-refs:

## Attributes

Resource type: Site  
Age: Historic  
Information base: Survey  
Attribute codes: AH04 (Privies/dumps/trash scatters)  
Disclosure: Not for publication  
Collections: No  
Accession no(s):  
Facility:

## General notes

## Recording events

Date	Recorder(s)	Affiliation	Notes
2/6/2006	R. Baloian	Applied EarthWorks, Inc.	

## Associated reports

Report No.	Year	Title	Affiliation
TU-01303	2006	Cultural Resources Investigations for the City of Porterville Murry Park Renovation and Expansion Project, Tulare County, California	Applied EarthWorks, Inc.

## Location information

County: Tulare  
USGS quad(s): Porterville  
Address:  
PLSS: T21S R27E SW¼ of SE¼ of Sec. 25 MDBM  
UTMs: Zone 11 319050mE 3993075mN NAD27

## Management status

## Database record metadata

Date	User	Action taken
Entered: 11/12/2013	ssjvic	
Last modified: 8/3/2023	jdavid5	
IC actions: Date	User	Action taken
3/2/2015	user	Entered location: MMB
8/3/2023	jdavid5	PDF Verified
11/12/2013	ssjvic	resource entered: cls
7/26/2023	kprince4	PDF Rescanned

Record status: Database Complete

# Resource Detail: P-54-004356

SSJVIC Record Search 24-058

---

## Identifying information

Primary No.: P-54-004356

Trinomial: CA-TUL-002657H

Name: HR-2 / Former Residence

Other IDs: Type Name

Resource Name HR-2 / Former Residence

Cross-refs:

## Attributes

Resource type: Site

Age: Historic

Information base: Survey

Attribute codes: AH02 (Foundations/structure pads); AH11 (Walls/fences)

Disclosure: Not for publication

Collections: No

Accession no(s):

Facility:

## General notes

## Recording events

Date	Recorder(s)	Affiliation	Notes
2/6/2006		Applied EarthWorks, Inc.	

## Associated reports

Report No.	Year	Title	Affiliation
TU-01303	2006	Cultural Resources Investigations for the City of Porterville Murry Park Renovation and Expansion Project, Tulare County, California	Applied EarthWorks, Inc.

## Location information

County: Tulare

USGS quad(s): Porterville

Address:

PLSS: T21S R27E SW¼ of SE¼ of Sec. 25 MDBM

UTMs: Zone 11 319000mE 3992910mN NAD27

## Management status

## Database record metadata

Date	User	Action taken
Entered: 11/12/2013	ssjvic	
Last modified: 8/3/2023	jdavid5	
IC actions: Date	User	Action taken
3/2/2015	user	Entered location: MMB
8/3/2023	jdavid5	PDF Verified
11/12/2013	ssjvic	resource entered: cls
7/26/2023	kprince4	PDF Rescanned

Record status: Database Complete

# Resource Detail: P-54-004626

SSJVIC Record Search 24-058

---

## Identifying information

Primary No.: P-54-004626

Trinomial: CA-TUL-002880H

Name: Southern Pacific Railroad; San Joaquin Valley Railroad

Other IDs: Type	Name
Resource Name	Southern Pacific Railroad; San Joaquin Valley Railroad
Other	VIS MK4; TSC-4; Historic Railroad Segment; JTU-128; WPD-1; TR-1; LS-3
Resource Name	Porterville Northeastern Railway Segment; Stockton and Tulare Railroad
OHP Z-number	TUL-Z00005

Cross-refs: Extends into another county as 10-003930  
Extends into another county as 15-002050  
Extends into another county as 16-000122  
Physically overlaps or intersects 54-002172  
Physically overlaps or intersects 54-003900  
Physically overlaps or intersects 54-005249  
Physically overlaps or intersects 54-005252  
Physically overlaps or intersects 54-005575  
Subsumes 54-003902  
Subsumes 54-004019  
Subsumes 54-004813  
Subsumes 54-004834  
Subsumes 54-004898  
Subsumes 54-005055

## Attributes

Resource type: Structure

Age: Historic

Information base: Survey

Attribute codes: AH07 (Roads/trails/railroad grades); HP11 (Engineering structure); HP39 (Other) - Railroad grade

Disclosure: Not for publication

Collections: No

Accession no(s):

Facility:

## General notes

## Recording events

Date	Recorder(s)	Affiliation	Notes
2/23/2001	S. Ashkar, C. Fish	Jones & Stokes	
6/9/2009	Joseph Freeman and Jarma Jones	JRP Historical Consulting, LLC.	[UPDATE]
5/8/2012	M. O'Neill, M. Walton	Pacific Legacy, Inc.	[UPDATE]
2/1/2017	Josh Tibbett	Applied EarthWorks, Inc.	[UPDATE]
10/31/2017	Joy Lloyd	Applied EarthWorks, Inc.	[SUPPLEMENT]
1/3/2017	R. Azpitarte	ASM Affiliates, Inc.	[SUPPLEMENT]
8/24/2016	Shannon E. Foglia, Rachel Droessler	AECOM	Update
2/7/2014	Mark Kile	URS	Supplement
8/6/2012	Hubert Switalski	AMEC Environmental, Inc.	Supplement
3/27/2012	Hubert Switalski	AMEC Environmental, Inc.	Supplement
1/22/2002	Cindy Baker	PAR Environmental Services, Inc.	Supplement
12/5/2001	Tracy Bakic	PAR Environmental Services, Inc.	Supplemental
10/18/2019	Susan Zamudio-Gurrola	Rincon Consultants, Inc.	[UPDATE]
5/1/2020	R. Azpitarte, S. Escamilla	ASM Affiliates, Inc.	[SUPPLEMENT]

## Resource Detail: P-54-004626

### SSJVIC Record Search 24-058

---

5/10/2019	R. Azpitarte	ASM Affiliates, Inc.	[UPDATE]
6/18/2019	M. Darcangelo, K. Ross, A. Jorgenson	Far Western Anthropological Research Group, Inc.	Update Segment LS-3
3/18/2017	Jack Pfertsh, Patrick O'Day	US Army Corps of Engineers	Supplement recording segment LS-3

### Associated reports

<i>Report No.</i>	<i>Year</i>	<i>Title</i>	<i>Affiliation</i>
TU-01655	2014	Cultural Resources Assessment for the Visalia Downtown Stormwater Flood Control Project, Visalia, Tulare County, California	URS Corporation
TU-01764	2017	Cultural Resources Survey Report for the Proposed Southern California Edison North of Magunden Transmission Line Rating Remediation Project, Kern and Tulare Counties, California	AECOM
TU-01783	2017	Cultural Resource Inventory for the Deep Creek Restoration Project in Farmersville, Tulare County, California	Applied EarthWorks, Inc.
TU-01831	2018	Class III Inventory/Phase I Survey, Richgrove CSD Well and Pipeline Project, Tulare County, California	ASM Affiliates, Inc.
TU-01837	2017	Cultural Resource Inventory and Evaluation for the City of Tulare Pratt Water System Improvement Project, Tulare County, California	Applied EarthWorks, Inc.
TU-01872	2019	Rexford Solar Farm Project Cultural Resources Assessment Report	Rincon Consultants, Inc.
TU-01886	2020	Class III Inventory/Phase I Survey, Butterfield Corridor Project, Porterville, Tulare County, California	ASM Affiliates, Inc.
TU-01889	2019	Class III Inventory/Phase I Survey, Lindsay-Strathmore Irrigation District Pipeline Replacement Project, Tulare County, California	ASM Affiliates, Inc.

### Location information

*County:* Tulare

*USGS quad(s):* Burris Park, Delano East, Delano West, Ducor, Exeter, Goshen, Ivanhoe, Lindsay, Monson, Pixley, Porterville, Reedley, Richgrove, Rocky Hill, Selma, Success Dam, Tipton, Traver, Tulare, Visalia

*Address:*

*PLSS:* T16S R22E Sec. 26 MDBM  
T16S R22E Sec. 35 MDBM  
T16S R22E Sec. 36 MDBM  
T16S R23E Sec. 31 MDBM  
T17S R23E Sec. 6 MDBM  
T17S R23E Sec. 5 MDBM  
T17S R23E Sec. 8 MDBM  
T17S R23E Sec. 9 MDBM  
T17S R23E Sec. 16 MDBM  
T17S R23E Sec. 21 MDBM  
T17S R23E Sec. 22 MDBM  
T17S R23E Sec. 27 MDBM  
T17S R23E Sec. 34 MDBM  
T17S R23E Sec. 35 MDBM  
T18S R23E Sec. 2 MDBM  
T18S R23E Sec. 11 MDBM  
T18S R23E Sec. 12 MDBM  
T18S R23E Sec. 13 MDBM  
T18S R23E Sec. 14 MDBM  
T18S R23E Sec. 22 MDBM  
T18S R23E Sec. 23 MDBM  
T18S R23E Sec. 24 MDBM

## Resource Detail: P-54-004626

SSJVIC Record Search 24-058

---

T18S R24E Sec. 19 MDBM  
T18S R24E Sec. 20 MDBM  
T18S R24E Sec. 21 MDBM  
T18S R24E Sec. 22 MDBM  
T18S R24E Sec. 23 MDBM  
T18S R24E Sec. 26 MDBM  
T18S R24E Sec. 25 MDBM  
T18S R25E Sec. 30 MDBM  
T18S R25E Sec. 29 MDBM  
T18S R25E Sec. 28 MDBM  
T28S R25E Sec. 33 MDBM  
T19S R25E Sec. 4 MDBM  
T19S R25E Sec. 3 MDBM  
T19S R25E Sec. 2 MDBM  
T19S R25E Sec. 1 MDBM  
T19S R26E Sec. 6 MDBM  
T19S R26E Sec. 5 MDBM  
T19S R26E Sec. 4 MDBM  
T18S R24E Sec. 30 MDBM  
T18S R24E Sec. 31 MDBM  
T18S R24E Sec. 32 MDBM  
T19S R24E Sec. 5 MDBM  
T19S R24E Sec. 8 MDBM  
T19S R24E Sec. 9 MDBM  
T19S R24E Sec. 16 MDBM  
T19S R24E Sec. 15 MDBM  
T19S R24E Sec. 22 MDBM  
T19S R24E Sec. 27 MDBM  
T19S R24E Sec. 34 MDBM  
T20S R24E Sec. 3 MDBM  
T20S R24E Sec. 2 MDBM  
T20S R24E Sec. 11 MDBM  
T20S R24E Sec. 14 MDBM  
T20S R24E Sec. 23 MDBM  
T20S R24E Sec. 26 MDBM  
T20S R24E Sec. 35 MDBM  
T21S R24E Sec. 1 MDBM  
T21S R24E Sec. 12 MDBM  
T21S R24E Sec. 13 MDBM  
T21S R24E Sec. 24 MDBM  
T21S R25E Sec. 19 MDBM  
T21S R25E Sec. 30 MDBM  
T21S R25E Sec. 31 MDBM  
T22S R25E Sec. 6 MDBM  
T22S R25E Sec. 7 MDBM  
T22S R25E Sec. 18 MDBM  
T22S R25E Sec. 17 MDBM  
T22S R25E Sec. 20 MDBM  
T22S R25E Sec. 29 MDBM  
T22S R25E Sec. 32 MDBM  
T23S R25E Sec. 5 MDBM  
T23S R25E Sec. 8 MDBM  
T23S R25E Sec. 17 MDBM  
T23S R25E Sec. 16 MDBM  
T23S R25E Sec. 21 MDBM  
T23S R25E Sec. 28 MDBM  
T23S R25E Sec. 33 MDBM  
T24S R25E Sec. 4 MDBM  
T24S R25E Sec. 9 MDBM



## Resource Detail: P-54-004626

SSJVIC Record Search 24-058

---

T24S R25E Sec. 10 MDBM  
T24S R25E Sec. 15 MDBM  
T24S R25E Sec. 22 MDBM  
T24S R25E Sec. 27 MDBM  
T24S R25E Sec. 34 MDBM  
T24S R26E Sec. 32 MDBM  
T24S R26E Sec. 33 MDBM  
T24S R26E Sec. 34 MDBM  
T24S R26E Sec. 35 MDBM  
T24S R26E Sec. 36 MDBM  
T24S R27E Sec. 31 MDBM  
T24S R27E Sec. 30 MDBM  
T24S R27E Sec. 19 MDBM  
T24S R27E Sec. 20 MDBM  
T24S R27E Sec. 17 MDBM  
T24S R27E Sec. 9 MDBM  
T24S R27E Sec. 4 MDBM  
T24S R27E Sec. 3 MDBM  
T23S R27E Sec. 34 MDBM  
T23S R27E Sec. 27 MDBM  
T23S R27E Sec. 22 MDBM  
T23S R27E Sec. 15 MDBM  
T23S R27E Sec. 10 MDBM  
T23S R27E Sec. 3 MDBM  
T22S R27E Sec. 34 MDBM  
T22S R27E Sec. 27 MDBM  
T22S R27E Sec. 22 MDBM  
T22S R27E Sec. 23 MDBM  
T22S R27E Sec. 14 MDBM  
T22S R27E Sec. 11 MDBM  
T22S R27E Sec. 2 MDBM  
T22S R28E Sec. 4 MDBM  
T22S R28E Sec. 3 MDBM  
T21S R28E Sec. 32 MDBM  
T21S R28E Sec. 24 MDBM  
T21S R28E Sec. 13 MDBM  
T21S R29E Sec. 18 MDBM  
T21S R27E Sec. 35 MDBM  
T21S R27E Sec. 26 MDBM  
T21S R27E Sec. 23 MDBM  
T21S R27E Sec. 14 MDBM  
T21S R27E Sec. 15 MDBM  
T21S R27E Sec. 10 MDBM  
T21S R27E Sec. 3 MDBM  
T21S R27E Sec. 4 MDBM  
T20S R27E Sec. 33 MDBM  
T20S R27E Sec. 32 MDBM  
T20S R27E Sec. 29 MDBM  
T20S R27E Sec. 20 MDBM  
T20S R27E Sec. 17 MDBM  
T20S R27E Sec. 18 MDBM  
T20S R27E Sec. 7 MDBM  
T20S R27E Sec. 6 MDBM  
T20S R26E Sec. 1 MDBM  
T19S R26E Sec. 36 MDBM  
T19S R26E Sec. 25 MDBM  
T19S R26E Sec. 26 MDBM  
T19S R26E Sec. 23 MDBM  
T19S R26E Sec. 14 MDBM

## Resource Detail: P-54-004626

SSJVIC Record Search 24-058

---

T19S R26E Sec. 11 MDBM  
T19S R26E Sec. 10 MDBM  
T19S R26E Sec. 3 MDBM  
T18S R26E Sec. 34 MDBM  
T18S R26E Sec. 27 MDBM  
T18S R26E Sec. 28 MDBM  
T18S R26E Sec. 21 MDBM  
T18S R26E Sec. 20 MDBM  
T18S R26E Sec. 17 MDBM  
T18S R26E Sec. 18 MDBM  
T18S R26E Sec. 7 MDBM  
T18S R25E Sec. 12 MDBM  
T18S R25E Sec. 1 MDBM  
T18S R25E Sec. 2 MDBM  
T17S R25E Sec. 35 MDBM  
T17S R25E Sec. 34 MDBM  
T17S R25E Sec. 27 MDBM  
T17S R25E Sec. 28 MDBM  
T17S R25E Sec. 21 MDBM  
T17S R25E Sec. 20 MDBM  
T17S R25E Sec. 17 MDBM  
T17S R25E Sec. 18 MDBM  
T17S R25E Sec. 7 MDBM  
T17S R24E Sec. 12 MDBM  
T17S R24E Sec. 1 MDBM  
T17S R24E Sec. 2 MDBM  
T16S R24E Sec. 35 MDBM  
T16S R24E Sec. 34 MDBM  
T16S R24E Sec. 27 MDBM  
T16S R24E Sec. 28 MDBM  
T16S R24E Sec. 21 MDBM  
T16S R24E Sec. 20 MDBM  
T16S R24E Sec. 17 MDBM  
T16S R24E Sec. 18 MDBM  
T16S R24E Sec. 7 MDBM  
T16S R23E Sec. 12 MDBM  
T16S R23E Sec. 1 MDBM  
T16S R23E Sec. 2 MDBM

*UTMs:* Zone 11 312896mE 4006040mN NAD83 (SE End; 5/10/2019 recording)  
Zone 11 329335mE 3996248mN NAD83 (6/18/2019 recording)  
Zone 11 315408mE 3999931mN NAD83 (Feature 1; 5/1/2020 recording)  
Zone 11 315621mE 3999326mN NAD83 (Feature 2; 5/1/2020 recording)  
Zone 11 315768mE 3998904mN NAD83 (Feature 3; 5/1/2020 recording)  
Zone 11 316094mE 3997954mN NAD83 (Feature 4; 5/1/2020 recording)  
Zone 11 317305mE 3995745mN NAD83 (Feature 5; 5/1/2020 recording)  
Zone 11 318170mE 3993315mN NAD83 (Feature 6; 5/1/2020 recording)  
Zone 11 318301mE 3991222mN NAD83 (Feature 7; 5/1/2020 recording)  
Zone 11 318292mE 3990814mN NAD83 (Feature 8; 5/1/2020 recording)  
Zone 11 318242mE 3990149mN NAD83 (Feature 9; 5/1/2020 recording)  
Zone 11 285349mE 4047007mN NAD27 (Point A; 12/5/2001 recording)  
Zone 11 285390mE 4046964mN NAD27 (Point B; 12/5/2001 recording)  
Zone 11 325549mE 3991013mN NAD27 (East End; 1/22/2002 recording)  
Zone 11 325209mE 3990855mN NAD27 (Curve; 1/22/2002 recording)  
Zone 11 324633mE 3990859mN NAD27 (Curve; 1/22/2002 recording)  
Zone 11 323899mE 3991215mN NAD27 (West End; 1/22/2002 recording)  
Zone 11 294257mE 4036915mN NAD27 (Segment A; 6/9/2009 recording)  
Zone 11 294326mE 4036833mN NAD27 (Segment A; 6/9/2009 recording)  
Zone 11 308176mE 4017464mN NAD27 (Segment B; 6/9/2009 recording)  
Zone 11 308135mE 4017532mN NAD27 (Segment B; 6/9/2009 recording)

## Resource Detail: P-54-004626

### SSJVIC Record Search 24-058

---

Zone 11 288236mE 4043807mN NAD27 (Segment C; 6/9/2009 recording)  
Zone 11 288162mE 4043888mN NAD27 (Segment C; 6/9/2009 recording)  
Zone 11 301305mE 4028839mN NAD27 (Segment D; 6/9/2009 recording)  
Zone 11 301235mE 4028922mN NAD27 (Segment D; 6/9/2009 recording)  
Zone 11 304733mE 3963692mN NAD83 (3/27/2012 recording)  
Zone 11 298596mE 4020151mN NAD83 (South point; 5/8/2012 recording)  
Zone 11 298968mE 4031520mN NAD83 (North point; 5/8/2012 recording)  
Zone 11 311703mE 3968146mN NAD83 (8/6/2012 recording)  
Zone 11 295064mE 4023191mN NAD83 (2/7/2014 recording)  
Zone 11 311703mE 3968146mN NAD83 (8/24/2016 recording)  
Zone 11 309706mE 3964387mN NAD83 (1/3/2017 recording)  
Zone 11 289678mE 4004540mN NAD83 (North End; 2/2017 recording)  
Zone 11 289682mE 4004510mN NAD83 (South End; 2/2017 recording)  
Zone 11 329355mE 3996248mN NAD83 (3/18/2017 recording)  
Zone 11 302870mE 4020031mN NAD83 (10/31/2017 recording)  
Zone 11 312597mE 4006759mN NAD83 (NW End; 5/10/2019 recording)  
Zone 11 318236mE 3990102mN NAD83 (Feature 10; 5/1/2020 recording)  
Zone 11 317504mE 3988349mN NAD83 (Feature 11; 5/1/2020 recording)  
Zone 11 317703mE 3988705mN NAD83 (Feature 12 N End; 5/1/2020 recording)  
Zone 11 317521mE 3988354mN NAD83 (Feature 12 E End; 5/1/2020 recording)  
Zone 11 316621mE 3996588mN NAD27 (2/23/2001 recording)

### Management status

#### Database record metadata

<i>Date</i>	<i>User</i>	<i>Action taken</i>
<i>Entered:</i> 7/14/2013	ssjvic	
<i>Last modified:</i> 12/5/2023	jdavid5	
<i>IC actions:</i> <i>Date</i>	<i>User</i>	<i>Action taken</i>
8/28/2020	jdavid5	Entered Update
9/10/2020	cthomson	Verified
10/26/2023	cthomson	Entered LS-3 2017 & 2019 recordings
7/14/2013	ssjvic	primary entered: cls
8/3/2023	jdavid5	PDF Verified
1/23/2017	User	subsumed all known SP RR records into this number: cls
12/2/2014	user	Entered location: MMB
6/14/2017	User	entered update: cls
1/5/2018	User	entered supplement: cls
2/5/2019	User	Entered ASM Supplement: DB
2/7/2019	User	Verified: CT
7/8/2021	cthomson	Verified
7/9/2021	cthomson	Entered 5/10/19 Update
7/9/2021	cthomson	Verified
6/28/2021	jdavid5	Entered Supplement
7/28/2023	kprince4	PDF Edited

*Record status:* Verified

# Resource Detail: P-54-004632

SSJVIC Record Search 24-058

---

## Identifying information

Primary No.: P-54-004632

Trinomial: CA-TUL-002885H

Name: Atchison, Topeka, Santa Fe Railroad Branch Line; Santa Fe Railroad Grade

Other IDs:	Type	Name
	Other	JTU-204
	Resource Name	Atchison, Topeka, Santa Fe Railroad Branch Line
	Other	Historic Railroad Segment
	Resource Name	Santa Fe Railroad Grade

Cross-refs: Extends into another county as 10-004675  
Extends into another county as 15-000560  
Extends into another county as 16-000120  
Extends into another county as 20-002662  
Physically overlaps or intersects 54-002172  
Physically overlaps or intersects 54-003602  
Physically overlaps or intersects 54-003900  
Physically overlaps or intersects 54-005249  
Physically overlaps or intersects 54-005252  
Physically overlaps or intersects 54-005575  
Subsumes 54-002183  
Subsumes 54-004016

## Attributes

Resource type: Structure, Object, Site

Age: Historic

Information base: Survey

Attribute codes: AH04 (Privies/dumps/trash scatters); AH07 (Roads/trails/railroad grades); HP19 (Bridge); HP37 (Highway/trail) - Rail Road

Disclosure: Not for publication

Collections: No

Accession no(s):

Facility:

## General notes

### Recording events

Date	Recorder(s)	Affiliation	Notes
4/26/1995	Carrie D. Wills, Allen Estes	William Self Associates	
2/23/2001	S. Ashkar, C. Fish	Jones & Stokes	[UPDATE]
11/29/2007	M. Armstrong, R. Ottenhoff, P. Paramoure, L. MacDonald	Pacific Legacy, Inc.	[UPDATE]
6/5/2009	Steven J. Melvin, Rebecca Flores	JRP Historical Consulting, LLC.	[UPDATE]
5/4/2012	M. O'Neill, M. Walton	Pacific Legacy, Inc.	[UPDATE]
5/10/2019	Robert Azpitarte	ASM Affiliates, Inc.	[UPDATE]
4/17/2019	Denise Ruzicka	CAL FIRE	SUPPLEMENT

### Associated reports

Report No.	Year	Title	Affiliation
TU-01889	2019	Class III Inventory/Phase I Survey, Lindsay-Strathmore Irrigation District Pipeline Replacement Project, Tulare County, California	ASM Affiliates, Inc.
TU-01929	2020	An Archaeological Survey Report for the Gill Range Improvement Burn, Tulare County, California	CAL FIRE

### Location information

County: Tulare

# Resource Detail: P-54-004632

## SSJVIC Record Search 24-058

---

USGS quad(s): Ducor, Exeter, Fountain Springs, Ivanhoe, Lindsay, Monson, Orange Cove South, Paige, Porterville, Rocky Hill, Stokes Mtn., Success Dam, Tulare, Visalia, Waukena, Woodlake

Address:

PLSS: T20S R24E SE¼ of SE¼ of Sec. 3 MDBM  
T21S R27E NE¼ of SE¼ of Sec. 15 MDBM  
T16S R25E N½ of Sec. 34 MDBM  
T16S R25E Sec. 35 MDBM  
T17S R25E NE¼ of Sec. 12 MDBM  
T17S R25E SW¼ of Sec. 7 MDBM

UTMs: Zone 11 308510mE 4027095mN NAD83 (4/17/2019 Recording)  
Zone 11 312413mE 4011867mN NAD83 (5/10/2019 recording)  
Zone 11 288865mE 4009785mN NAD27 (1995 recording)  
Zone 10 316667mE 3996985mN NAD27 (2001 recording)  
Zone 11 299269mE 4041443mN NAD83 (2007 recording)  
Zone 11 300443mE 4039962mN NAD27 (2009 recording)  
Zone 11 301776mE 4038553mN NAD83 (NW end; 2012 recording)  
Zone 11 302081mE 4038186mN NAD83 (SE end; 2012 recording)

### Management status

#### Database record metadata

	<i>Date</i>	<i>User</i>	
<i>Entered:</i>	12/2/2014	user	
<i>Last modified:</i>	7/28/2023	kprince4	
<i>IC actions:</i>	<i>Date</i>	<i>User</i>	<i>Action taken</i>
	12/2/2014	user	Entered resource: MMB
	10/13/2022	cthompson	Verified
	7/9/2021	cthompson	Entered Update
	7/9/2021	cthompson	Verified
	6/5/2019	dbuehler	Linked other counties
	9/15/2022	jdavid5	Entered Supplement
	7/28/2023	kprince4	PDF Verified

*Record status:* Verified