



NOTICE OF EXEMPTION

Submitted to:

San Francisco Office of the County Clerk
City Hall, Room 160
One Dr Carlton B Goodlett Place
San Francisco, CA 94102

Office of Planning and Research
Submitted electronically via CEQASubmit

From: San Francisco Unified School District
135 Van Ness Avenue
San Francisco, CA 94102

PROJECT TITLE: Jefferson Elementary School – Outdoor Schoolyard Learning Project

Project Address: 1725 Irving Street
San Francisco, CA 94122

Assessor's Parcel Number: 1773/001
County of: San Francisco

Project Description: Schoolyard renovation to include the following: bioretention facility, bioretention basins, bioswales and associated landscaping, tree wells, above ground planters, planting areas, new playground structure and matting, playground regrading and playground restriping.

The project has been **approved by** and **will be carried out by** the San Francisco Unified School District.

Lead Agency Contact Person: LeeAnn Bailey, Grants and Compliance Manager
(bailey1@sfusd.edu) 415-241-6000

Signature: LeeAnn Bailey **Date:** 3/25/25

EXEMPT STATUS

Categorically Exempt **Classes:** 1 and 14

The project meets the categorical exemptions of Class 1 and 14.



NOTICE OF EXEMPTION – ADDITIONAL INFORMATION

ENVIRONMENTAL ANALYSIS

Reason Project is Exempt: The project described above is exempt under CEQA Guidelines Section 15301 (Existing Facilities) and Section 15314 (Minor Additions to Schools). The project meets the conditions for these exemptions as explained below.

Existing Facilities (Class 1, Section 15301). The project consists of the operation, repair, maintenance, permitting, leasing, licensing, or minor alteration of existing public or private structures, facilities, mechanical equipment, or topographical features, involving negligible or no expansion of existing or former use.

Minor Additions to Schools (Class 14, Section 15314). The project consists of minor additions within the existing school grounds and the additions do not increase original student capacity by more than 25% or ten classrooms, whichever is less.

Exceptions to Use of a Categorical Exemption:

A project does not have the potential to trigger any of the exceptions identified in CEQA Guidelines Section 15300.2 prohibiting the use of a categorical exemption.

- a. **Location.** Classes 3, 4, 5, 6, and 11 are qualified by consideration of where the project is to be located - a project that is ordinarily insignificant in its impact on the environment may, in a particularly sensitive environment, be significant. Therefore, these classes are considered to apply in all instances, except where the project may impact on an environmental resource of hazardous or critical concern where designated, precisely mapped, and officially adopted pursuant to law by federal, state, or local agencies.

Although the location exception does not apply to a Class 1 or 14 Categorical Exemptions, the environmental sensitivity of the project site was assessed as part of preparation of this Notice of Exemption and the project does not have an impact on a particularly sensitive environment.

- b. **Cumulative Impact.** All exemptions for these classes are inapplicable when the cumulative impact of successive projects of the same type in the same place, over time is significant.

The project does not contribute to any cumulative impact as there are no ongoing projects at this site or adjacent projects as confirmed by the SF Planning database.

- c. **Significant Effect.** A categorical exemption shall not be used for an activity where there is a

reasonable possibility that the activity will have a significant effect on the environment due to unusual circumstances.

The project does not create any unusual circumstances.

- d. Scenic Highways. A categorical exemption shall not be used for a project which may result in damage to scenic resources including, but not limited to, trees, historic buildings, rock outcroppings or similar resources, within a highway officially designated as a state scenic highway.

Not applicable. The project is not within proximity to a highway officially designated as a state scenic highway.

- e. Hazardous Waste Sites. A categorical exemption shall not be used for a project located on a site that is included on any list compiled pursuant to Section 65962.5 of the Government Code.

Not applicable. The project site is not on the Cortes List – State Database of Hazardous Sites.

- f. Historical Resources. A categorical exemption shall not be used for a project that may cause a substantial adverse change in the significance of a historical resource.

Not applicable. The project does not have a significant impact or substantial adverse change on a historical resource.

REFERENCES

California Department of Toxic Substances Control (DTSC). 2025. Envirostor.

<https://www.envirostor.dtsc.ca.gov/public/>. Accessed 3/15/2025.

California Department of Transportation (Caltrans). 2025. List of Eligible and Officially Designated State Scenic Highways.

State Water Resources Control Board (SWRCB). 2025. GeoTracker.

<https://geotracker.waterboards.ca.gov/>. Accessed 3/15/2025.

[End of Notice]

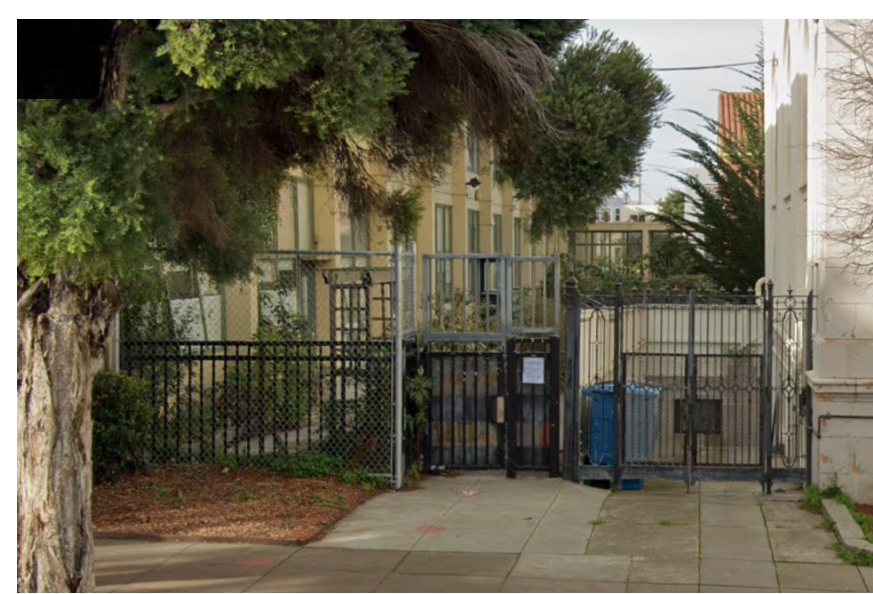

P3: REFERENCE PHOTO 2: (E) FENCE @ LIBRARY & CLASSROOM BLDG.

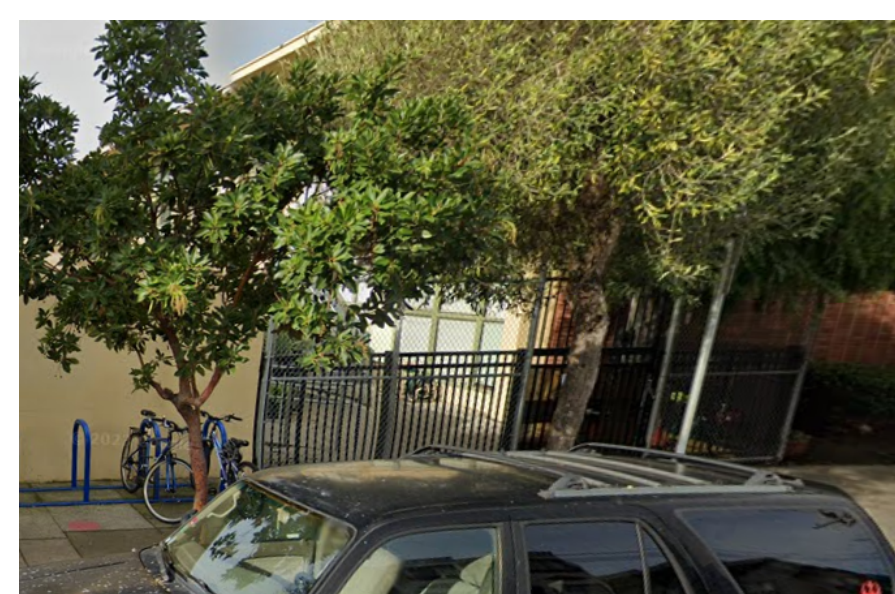

P4: REFERENCE PHOTO 2: (E) FENCE AT MIDDLE YARD GATE



P5: REFERENCE PHOTO 2: (E) FENCE @ TRASH ENCLOSURE

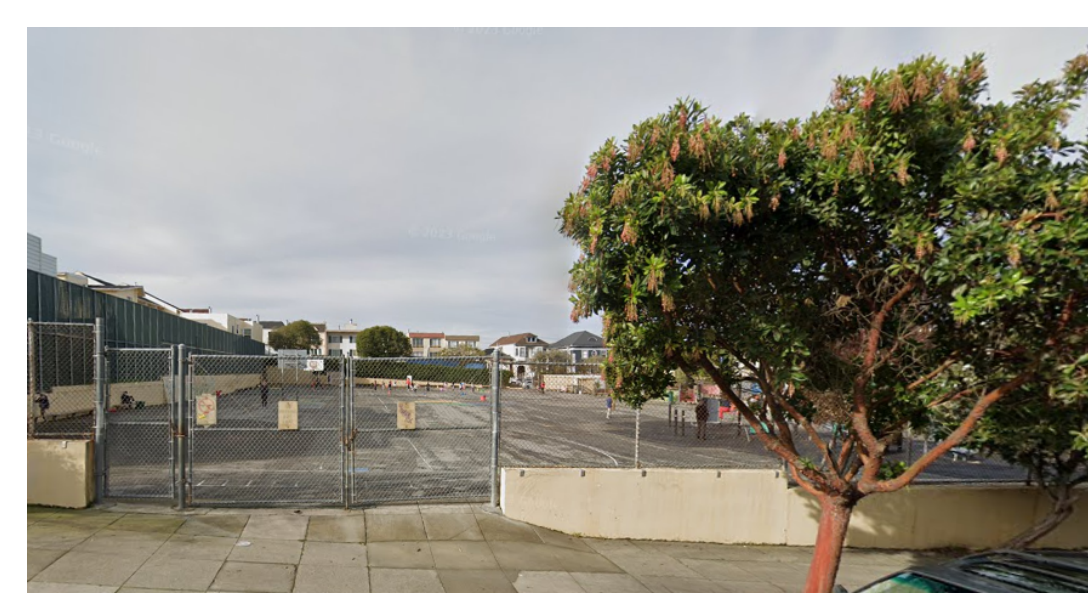

P6: REFERENCE PHOTO 2: (E) FENCE @ UPPER YARD

GATE SCHEDULE					
MARK	HEIGHT	WIDTH	HW SET	DESCRIPTION	NOTES
G1	8'-0"	6'-0"	1	REMOVABLE CENTER MULLION + PANIC HARDWARE	SEE SPEC
G2	8'-0"	6'-0"	2	FIXED CENTER MULLION + PANIC HARDWARE	SEE SPEC

PLAN LEGEND

- AREA OF WORK
- EXISTING BUILDING
- PROPERTY BOUNDARY (P.B.)
- INTERIOR PROPERTY LINE (P.L.)
- (E) TO BE REMOVED
- (E) TO REMAIN
- NEW CONSTRUCTION
- (E) DOOR TO REMAIN
- (N) NEW FENCE AND GATE WHERE CALLED OUT
- Gx (N) GATE, SEE GATE SCHEDULE
- (N) FOOTING AT FENCE POST

CONSTRUCTION PLAN NOTES

- SEE CIVIL AND LANDSCAPE FOR ADDITIONAL WORK NOT SHOWN IN ARCHITECTURAL DRAWING. CONTRACTOR TO REVIEW AND COORDINATE THE WORK OF OTHER DISCIPLINES WITH THE SCOPE OF ARCHITECTURAL.
- DO NOT SCALE DRAWINGS. USE DIMENSIONS INDICATED.
- CONTRACTOR SHALL VERIFY DIMENSIONS AND NOTIFY THE ARCHITECT OF ANY DISCREPANCIES PRIOR TO START OF WORK.
- ALL EXISTING CONSTRUCTION REMAINING BUT AFFECTED BY THE WORK UNDER THIS CONTRACT SHALL BE RESTORED AND REFINISHED TO MATCH THE MATERIALS, FINISH AND ALIGNMENT OF THE EXISTING ADJACENT CONSTRUCTION.

Key Value	Keynote Text
201	(E) 6' TALL CHAINLINK FENCE AND - 3/4" PERIMETER WALL. REMOVE (E) FENCE FABRIC AND KEEP EXISTING POSTS AND CROSS BRACES INTACT. SAND BLAST (E) POSTS, BRACING AND LOW WALL. PATCH ALL WALL CRACKS AND PAINT ALL SIDES OF RETAINING WALL. COLD-GALVANIZE ALL EXISTING POSTS AND BRACING AND INSTALL NEW 1"x1" VINYL COATED CHAINLINK FENCE FABRIC AND PRIVACY FABRIC. SEE IMAGE P6/AS101.
202	(E) 2' TALL CHAINLINK FENCE AND - 7" PERIMETER WALL WITH (E) TRASH AREA GATES TO REMAIN. REMOVE (E) FENCE FABRIC AND KEEP EXISTING POSTS AND CROSS BRACES INTACT. SAND BLAST (E) POSTS, BRACING AND RETAINING WALL. ALL SIDES. PATCH ALL WALL CRACKS AND PAINT ALL SIDES OF RETAINING WALL. COLD-GALVANIZE ALL EXISTING POSTS AND BRACING AND INSTALL NEW 1"x1" VINYL COATED CHAINLINK FENCE FABRIC AND PRIVACY FABRIC. SEE IMAGE P6/AS101.
203	(E) 10" PERIMETER WALL TO REMAIN. SANDBLAST ALL SIDES OF WALL AND REPAINT ALL SIDES OF WALL. SEE IMAGE P4/AS101.
204	(E) 8' TALL CHAINLINK FENCE GATES WITH (E) WROUGHT IRON FENCE. REMOVE (E) FENCE FABRIC AND KEEP EXISTING POSTS AND CROSS BRACES INTACT. SAND BLAST (E) POSTS, BRACING AND COLD-GALVANIZE ALL EXISTING POSTS AND BRACING AND INSTALL NEW 1"x1" VINYL COATED CHAINLINK FENCE FABRIC AND PRIVACY FABRIC. SEE IMAGE P3/AS101.

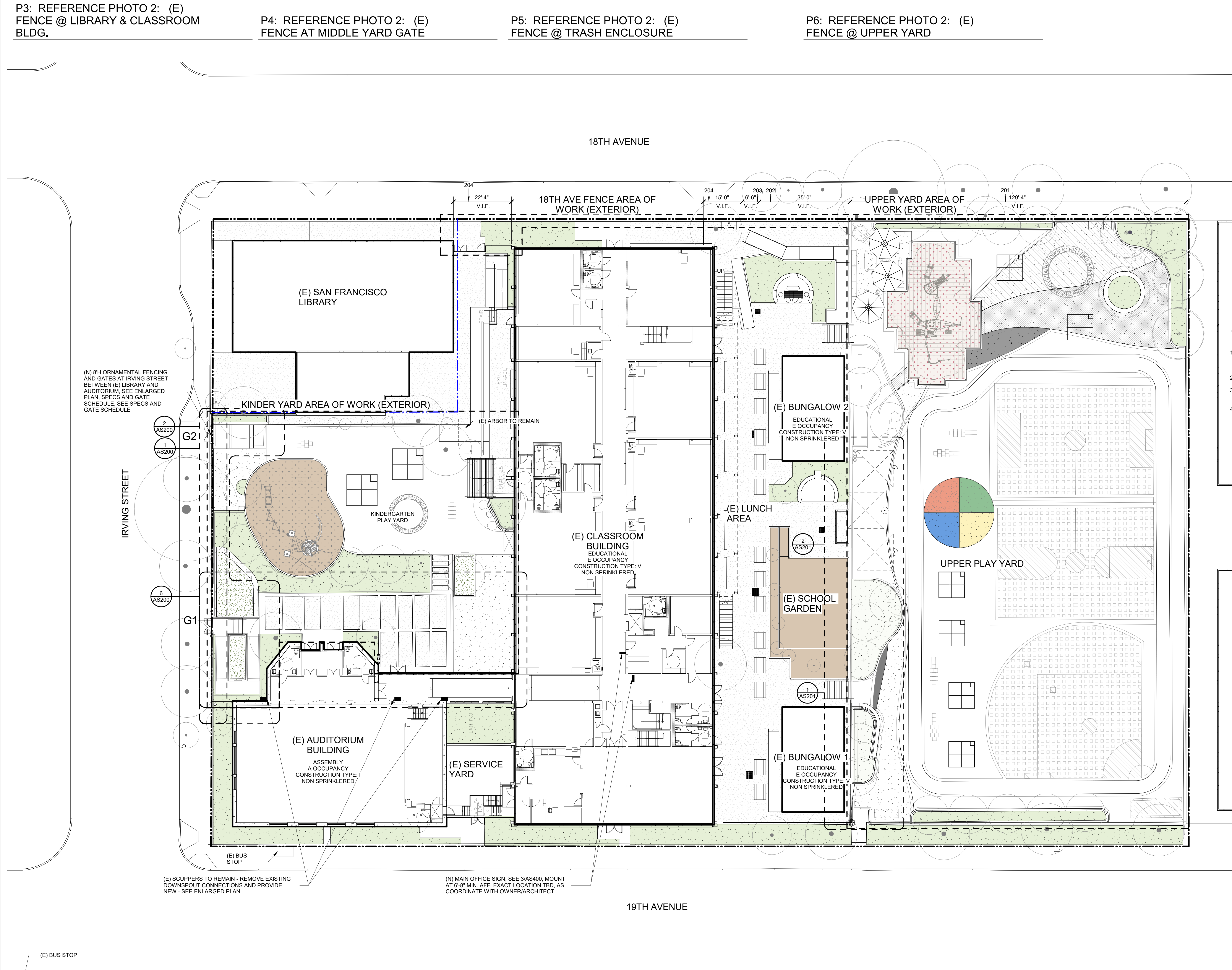

Approvals



2016 PROPOSITION A BOND PROGRAM
 135 Van Ness Avenue
 San Francisco, California 94102
 Tel (415) 241-6152
 Fax (415) 241-6148

Architect



Firm Name and Address and Logo

HED
 417 Montgomery Street
 Suite 400
 San Francisco, California
 94104 USA
 (415) 981-2345
 WWW.HED.DESIGN

Consultant

Project Name and Address

Jefferson ES Schoolyard Outdoor Learning Project
 1725 Irving St
 San Francisco, CA 94122

Δ	Date	Issued For
1	7/12/2024	Schematic Design
2	9/6/2024	100% Design Development
3	11/8/2024	100% Construction Documents

DRAWING TITLE

Architectural Site Plan

SHEET NO.

AS101

JOB NO.

2023-SF012-001

DATE:	DRAFTER:	CHECKED BY:	SITE NO.:
11.08.2024	AA	MR	

SCALE: As indicated S.F.U.S.D. PROJECT NO.

FOR REFERENCE ONLY NOT FOR CONSTRUCTION