

Notice of Exemption

Appendix E

To: Office of Planning and Research
P.O. Box 3044, Room 113
Sacramento, CA 95812-3044

County Clerk

County of: _____

From: (Public Agency): _____

(Address)

Project Title: _____

Project Applicant: _____

Project Location - Specific:

Project Location - City: _____ Project Location - County: _____

Description of Nature, Purpose and Beneficiaries of Project:

Name of Public Agency Approving Project: _____

Name of Person or Agency Carrying Out Project: _____

Exempt Status: **(check one):**

- Ministerial (Sec. 21080(b)(1); 15268);
- Declared Emergency (Sec. 21080(b)(3); 15269(a));
- Emergency Project (Sec. 21080(b)(4); 15269(b)(c));
- Categorical Exemption. State type and section number:** _____
- Statutory Exemptions. State code number: _____

Reasons why project is exempt:

Lead Agency

Contact Person: _____ Area Code/Telephone/Extension: _____

If filed by applicant:

1. Attach certified document of exemption finding.
2. Has a Notice of Exemption been filed by the public agency approving the project? Yes No

Signature: Mark Roberts Date: _____ Title: _____

Signed by Lead Agency Signed by Applicant

Authority cited: Sections 21083 and 21110, Public Resources Code.
Reference: Sections 21108, 21152, and 21152.1, Public Resources Code.

Date Received for filing at OPR: _____



**CALIFORNIA
ENGINEERING
COMPANY INC**
ESTD 1996

Project: CLEARLAKE GATEWAY SIGNS
Location: HWY 53 (NORTHERN ENTRANCE)
Client: CITY OF CLEARLAKE
Ref.:

By: MRH
Date: 6/5/2024
Rev. No.
2

Sheet No.
1 OF 5
Project No.
22-711

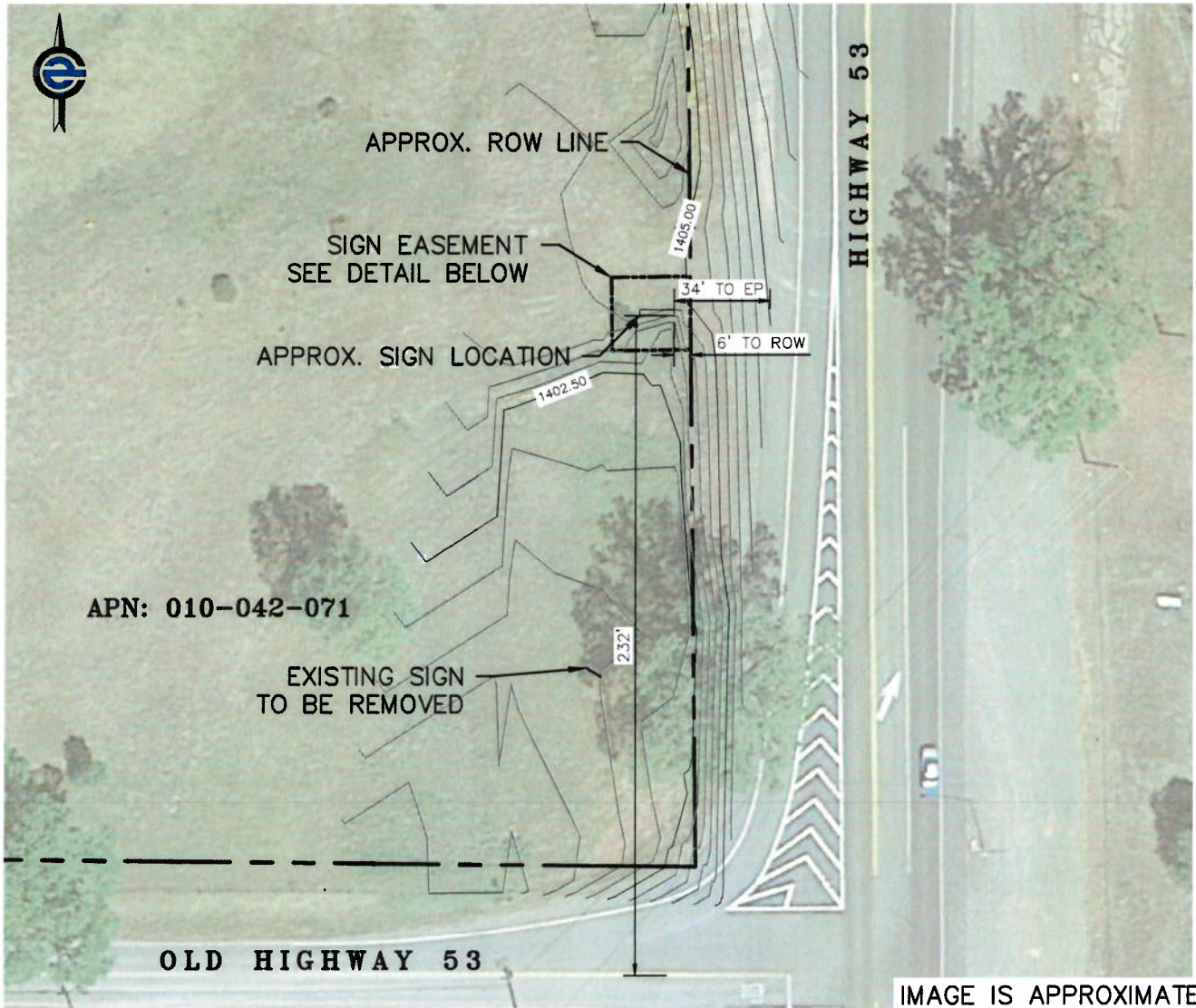
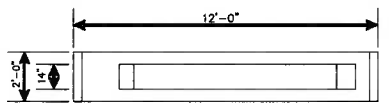
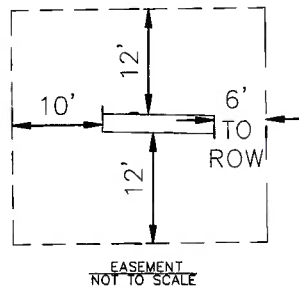

IMAGE IS APPROXIMATE

NOTE:
SIGN LOCATION WILL BE STAKED/SURVEYED PRIOR TO CONSTRUCTION TO ENSURE PLACEMENT IS WITHIN THE RIGHT OF WAY.

FOUNDATION PLANS ARE SHEETS S1.0 AND S2.0



TOP VIEW
NOT TO SCALE

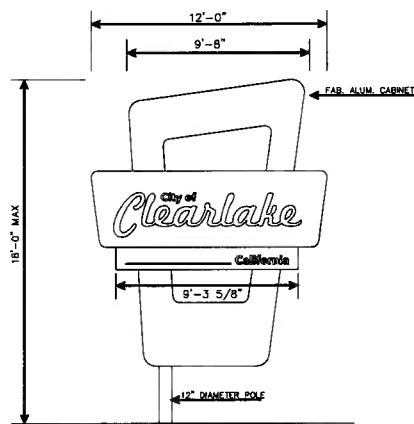

FRONT VIEW
NOT TO SCALE

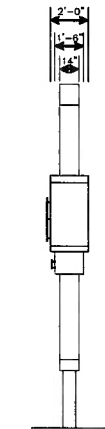

SIDE VIEW
NOT TO SCALE