

FILED
RECEIVED 1514981

FILED
KERN COUNTY

MAR 30 2023

NOTICE OF DETERMINATION
(CALIFORNIA ENVIRONMENTAL QUALITY ACT OF 1970)

AIMEE X. ESPINOZA
AUDITOR CONTROLLER-COUNTY CLERK
BY *[Signature]* DEPUTY

TO WHOM IT MAY CONCERN:

1. The Board of Supervisors of the County of Kern has approved the following described project in the County of Kern, State of California:

- a. Applicant, or sponsoring agency or department: Keyhole Wind Energy by EDF Renewables Inc. (QK Inc.) (PP23403);
- b. Name of Project: Amendment of Zoning Map No. 216, Zone Change Case No. 10; Amendment of Zoning Map No. 217, Zone Change Case No. 1; Amendment of Zoning Map No. 233, Zone Change Case No. 19; Conditional Use Permit Case No. 8, Map No. 216; Conditional Use Permit Case No. 3, Map No. 217; Conditional Use Permit Case No. 17, Map No. 233; General Plan Amendment Case No. 3, Map No. 216; General Plan Amendment Case No. 1, Map No. 217; General Plan Amendment Case No. 5, Map No. 233; Streets and Highways - Nonsummary Vacation - Map No. 233;
- c. Location of Project: 1/2 mile north of Rosamond Boulevard and east of Little Oak Canyon Road in the Northwest portion of the unincorporated community of Willow Springs in eastern Kern County;
- d. Description of Project: The Keyhole Wind Energy Project would allow the construction and operation of a wind energy facility and associated infrastructure necessary to generate 100 megawatts with up to 45 wind turbines for renewable electrical energy on approximately 3,920 acres. The project includes the following:
 - (1) Three (3) changes in zone classification from A (Exclusive Agriculture) to A WE (Exclusive Agriculture - Wind Energy) on 3,301.99 acres; E(10) RS (Estate - 10 acres - Residential Suburban Combining) to A WE (Exclusive Agriculture - Wind Energy) on 165 acres; E(20) RS FPS (Estate - 20 acres - Residential Suburban - Floodplain Secondary Combining) to A WE FP (Exclusive Agriculture - Wind Energy - Floodplain Combining) on 38.33 acres; E (2 1/2) RS (Estate 2 1/2 acres - Residential Suburban Combining) to A WE (Exclusive Agriculture - Wind Energy) on 20 acres; PL RS (Platted Lands - Residential Suburban) to A WE (Exclusive Agriculture - Wind Energy) on 154.06 acres.
 - (2) Three (3) Conditional Use Permits (CUP) to allow for two temporary concrete batch plants to support construction activities and the installation of two permanent microwave towers to support operations in the A WE (Exclusive Agriculture - Wind Energy) Zone District.
 - (3) Three (3) amendments to the Circulation Element of the Kern County General Plan to eliminate future road reservations at section and mid-section lines within the proposed project boundary.
 - (4) Nonsummary Street Vacations to remove roads and public streets that bisect the proposed wind energy generation facility

2. Approval – Summary of Proceedings:

Adoption date March 28, 2023 Item No. CA 6 2:00 p.m.
Notice of Environmental Document
Posted by County Clerk on 03/30/2023
and for 30 days thereafter, Pursuant to
Section 21152(C), Public Resources Code *23907*

3. The Board of Supervisors of the County of Kern has determined that the project in its approved form will have a significant effect on the environment.

4. An Addendum to the previously certified Environmental Impact Report (EIR) for the Pacific Wind Project (SCH #2009091127), certified on October 26, 2010, was prepared pursuant to State CEQA Guidelines Section 15164 and a Mitigation Measure Monitoring Program was prepared pursuant to CEQA and the State CEQA Guidelines. These documents were received and considered by this Board as required by Section 15090 of the State CEQA Guidelines.

5. Mitigation measures and a Mitigation Measure Monitoring Program were made as conditions of approval of the project. Findings were made pursuant to Section 15091 of the State CEQA Guidelines. A Statement of Overriding Considerations was adopted for the project, pursuant to Section 15093 of the State CEQA Guidelines.

6. A copy of the EIR and Addendum may be examined by any interested person during regular business hours at the following location: Fifth Floor, Kern County Administrative Center, 1115 Truxtun Avenue, Bakersfield, California, 93301, Telephone No. 868-3585

Lorelei H. Oviatt, AICP, Director
Planning and Natural Resources Department
County of Kern, State of California

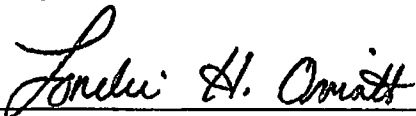

Telephone No. 862-8600

By:

KA:an (03/29/23)

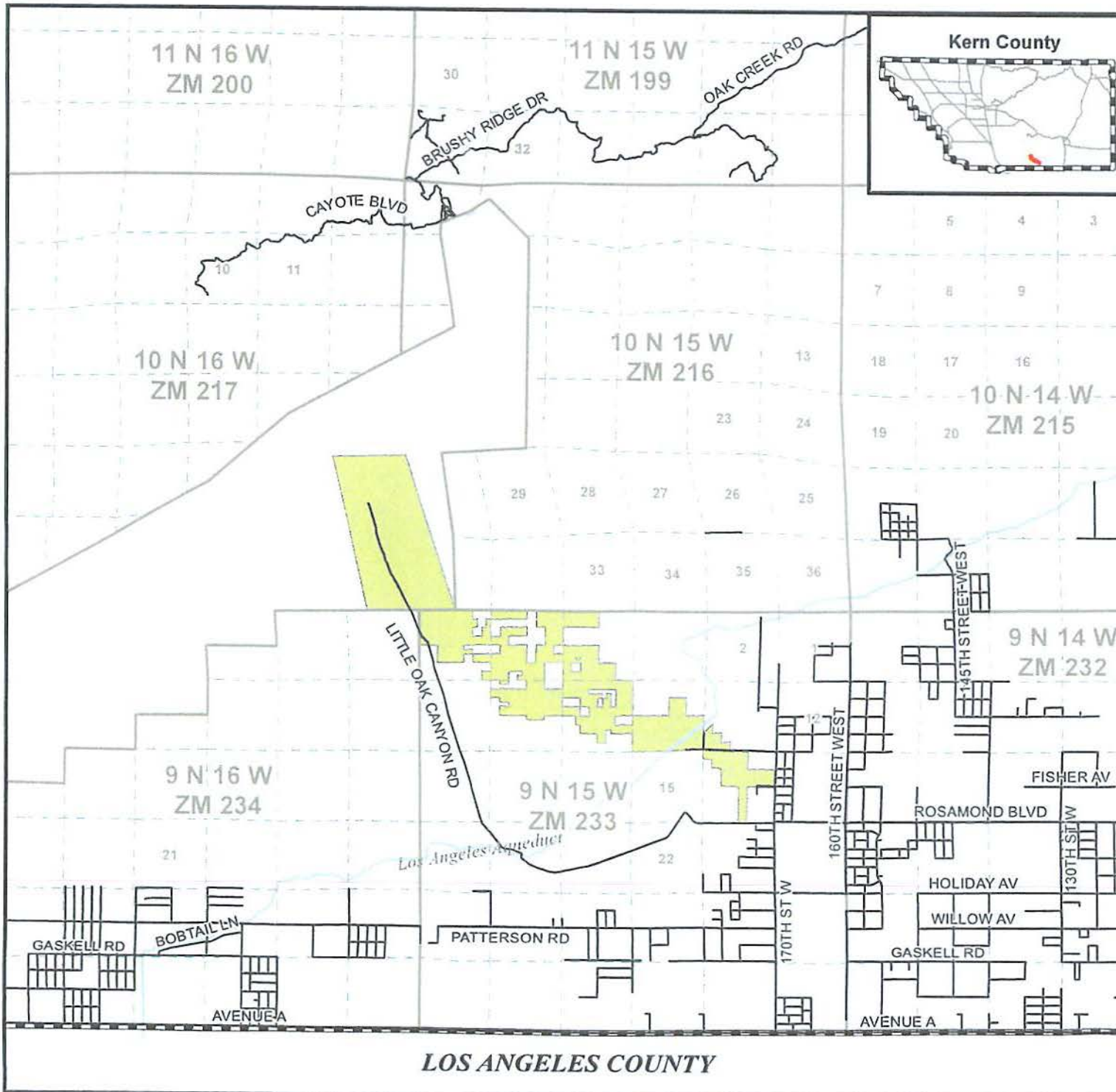

GPA 3, Map 216;
 GPA 1, Map 217;
 GPA 5, Map 233;
 ZCC 10, Map 216;
 ZCC 1, Map 217;
 ZCC 19, Map 233;
 CUP 8, Map 216;
 CUP 3, Map 217;
 CUP 17, Map 233
 Nonsummary Vacation

**Figure 1-
 Site Vicinity**

Keyhole Wind Project
 by: EDF Renewables, Inc.

- Keyhole Wind Project
- Arterials
- Locals
- Dirt Roads
- Kern County Boundary
- Township/Range
- Sections
- Water Courses

T9N/R15W -
 Sections 4-6; 8-11; 14

Created on: 2/2/2023



LOS ANGELES COUNTY



**Kern County
 Planning & Natural
 Resources Department**

Addendum No. 4
Certified Final Environmental Impact Report (SCH# 2009091127)
Pacific Wind Energy Project

KEYHOLE WIND ENERGY PROJECT
By EDF RENEWABLES

General Plan Amendment No. 3, Map 216
General Plan Amendment No. 1, Map 217
General Plan Amendment No. 5, Map 233
Specific Plan Amendment No. 6, Map 233
Zone Change Case No. 10, Map 216
Zone Change Case No. 1, Map 217
Zone Change Case No. 19, Map 233
Conditional Use Permit No 8, Map 216
Conditional Use Permit No 3, Map 217
Conditional Use Permit No 17, Map 233
Non-Summary Street Vacations



Kern County
Planning and Natural Resources Department
Bakersfield, California

February 2023



State of California—The Resources Agency
 DEPARTMENT OF FISH AND GAME
 2010 ENVIRONMENTAL FILING FEE CASH RECEIPT

EPT# 407269

STATE CLEARING HOUSE # (if applicable)

SEE INSTRUCTIONS ON REVERSE. TYPE OR PRINT CLEARLY

LEAD AGENCY Kern County Planning & Community Dev.		DATE 11/9/10
COUNTY/STATE AGENCY OF FILING Kern		DOCUMENT NUMBER 1317
PROJECT TITLE 1a) Amendment of zoning map no 2112, zone change from W-4 (1) Amendment		
PROJECT APPLICANT NAME Pacific Wind Energy Project Inc. a.k.a. Planning & Dev.		PHONE NUMBER (661) 562-8800
PROJECT APPLICANT ADDRESS	CITY	STATE ZIP CODE

PROJECT APPLICANT (Check appropriate box):
 Local Public Agency
 School District
 Other Special District
 State Agency
 Private Entity

CHECK APPLICABLE FEES:

<input checked="" type="checkbox"/> Environmental Impact Report (EIR)	\$2,792.25	\$ 2792.25
<input type="checkbox"/> Mitigated/Negative Declaration (ND)(MND)	\$2,010.25	\$ _____
<input type="checkbox"/> Application Fee Water Diversion (State Water Resources Control Board Only)	\$850.00	\$ _____
<input type="checkbox"/> Projects Subject to Certified Regulatory Programs (CRP)	\$949.50	\$ _____
<input checked="" type="checkbox"/> County Administrative Fee	\$50.00	\$ 50.00
<input type="checkbox"/> Project that is exempt from fees		
<input type="checkbox"/> Notice of Exemption		
<input type="checkbox"/> DFG No Effect Determination (Form Attached)		
<input type="checkbox"/> Other		\$ _____

PAYMENT METHOD:
 Cash
 Credit
 Check
 Other JV
 TOTAL RECEIVED \$ 2842.25

SIGNATURE X <u>[Signature]</u>	TITLE <u>OST</u>
-----------------------------------	---------------------



State of California - Department of Fish and Wildlife

2023 ENVIRONMENTAL FILING FEE CASH RECEIPT

DFW 753.5a (Rev. 1/01/23) Previously DFG 753.5a

RECEIPT NUMBER:

— 03302023 — 15149861

STATE CLEARINGHOUSE NUMBER (if applicable)

SEE INSTRUCTIONS ON REVERSE. TYPE OR PRINT CLEARLY.

LEAD AGENCY KERN COUNTY PLANNING AND NATURAL RESOURCES	LEAD AGENCY EMAIL	DATE 3/30/2023
---	-------------------	-------------------

COUNTY/STATE AGENCY OF FILING Kern	DOCUMENT NUMBER 23907
---------------------------------------	--------------------------

PROJECT TITLE
PP23403- KEYHOLE WIND ENERGY PROJECT BY QK, INC.

PROJECT APPLICANT NAME EDF RENEWABLES, INC.	PROJECT APPLICANT EMAIL	PHONE NUMBER (510) 457-2150
--	-------------------------	---------------------------------

PROJECT APPLICANT ADDRESS 1999 HARRISON STREET, SUITE 675	CITY OAKLAND	STATE CA	ZIP CODE 94612
--	-----------------	-------------	-------------------

PROJECT APPLICANT (check appropriate box)

Local Public Agency
 School District
 Other Special District
 State Agency
 Private Entity

CHECK APPLICABLE FEES:

- Environmental Impact Report (EIR) \$3,839.25 \$ _____
- Mitigated/Negative Declaration (MND)(ND) \$2,764.00 \$ _____
- Certified Regulatory Program document (CRP) \$1,305.25 \$ _____

- Exempt from fee
 - Notice of Exemption (attach)
 - CDFW No Effect Determination (attach)
- Fee previously paid (attach previously issued cash receipt copy)

- Water Right Application or Petition Fee (State Water Resources Control Board only) \$850.00 \$ _____
- County documentary handling fee \$ _____ 50.00
- Other _____ \$ _____

PAYMENT METHOD:

- Cash
 Credit
 Check
 Other
TOTAL RECEIVED \$ _____ 50.00

SIGNATURE 	AGENCY OF FILING PRINTED NAME AND TITLE J. LOZANO, KERN COUNTY CLERK, ADMINSTR COORD
---------------	---